

(來源：申請人於2016年10月27日提交)  
(SOURCE : SUBMITTED BY APPLICANT ON 27.10.2016)

參考編號  
REFERENCE No.  
R/S/I-DB/5-1 to 50

繪圖  
DRAWING  
H-1a

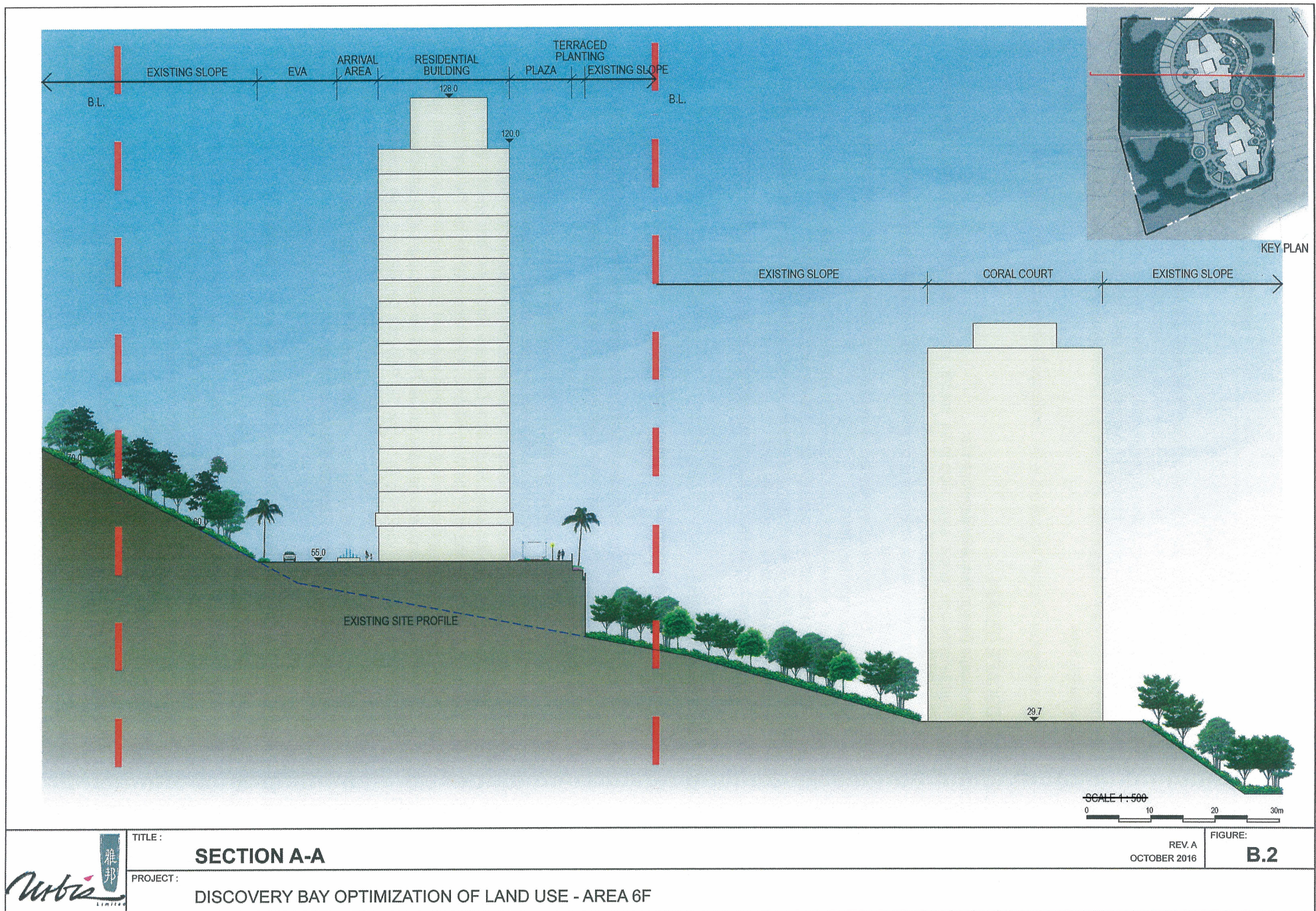



(來源：申請人於2016年10月27日提交)  
(SOURCE : SUBMITTED BY APPLICANT ON 27.10.2016)

參考編號  
REFERENCE No.  
R/S/I-DB/5-1 to 50

繪圖  
DRAWING  
H-1b





TITLE : **LANDSCAPE MASTER PLAN**

PROJECT : **DISCOVERY BAY OPTIMIZATION OF LAND USE - AREA 6F**

REV. B  
OCTOBER 2016

FIGURE: **B.1**



(來源：申請人於2016年10月27日提交)  
(SOURCE : SUBMITTED BY APPLICANT ON 27.10.2016)

參考編號  
REFERENCE No.  
R/S/I-DB/5-1 to 50

繪圖  
DRAWING  
H-1c



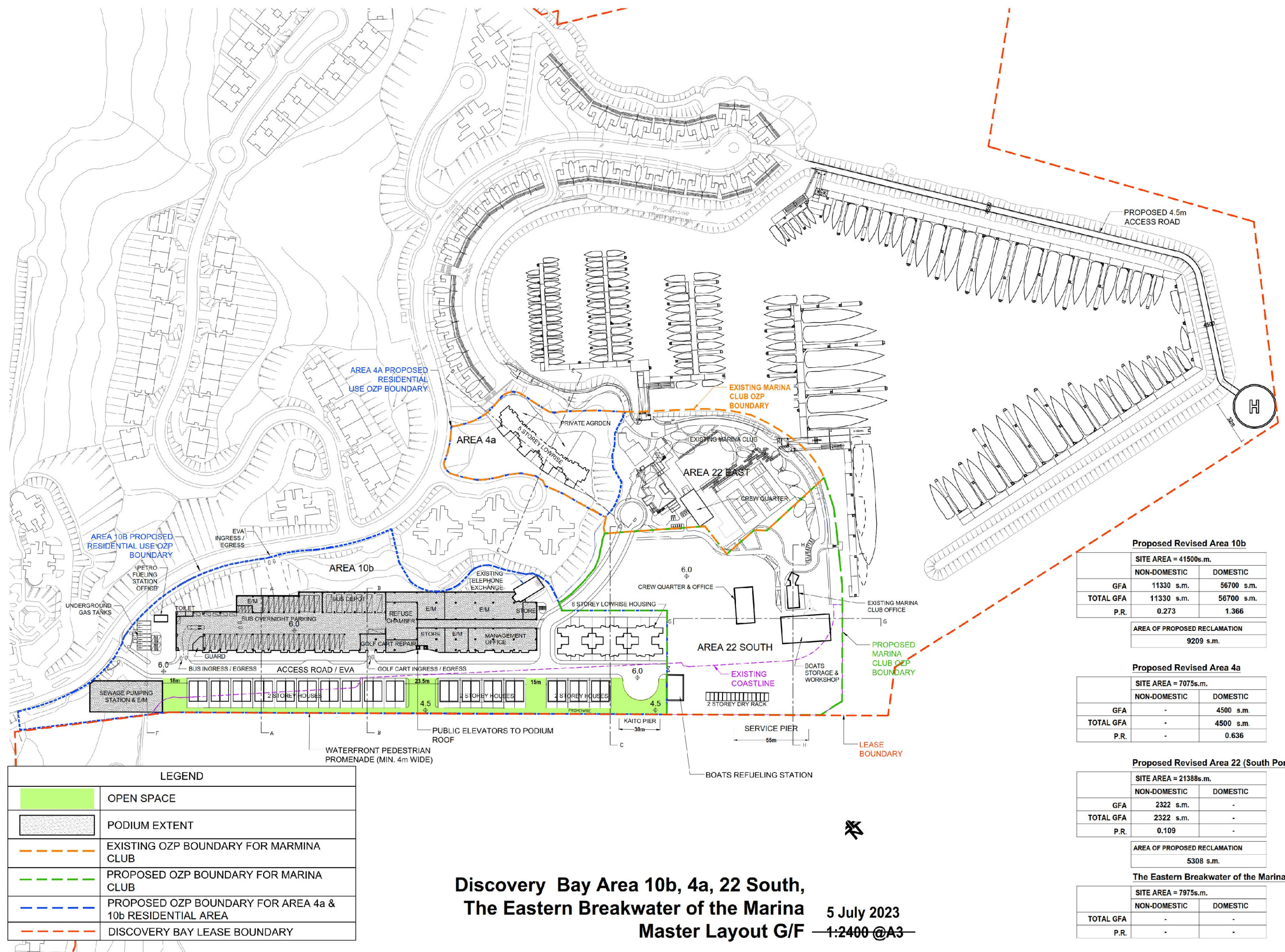

(來源：申請人於2023年7月27日提交)  
(SOURCE: SUBMITTED BY APPLICANT ON 27.7.2023)

參考編號  
REFERENCE No.  
R/S/I-DB/5-1 to 50

繪圖DRAWING  
H-2a





	<p>TITLE : <b>LANDSCAPE MASTER PLAN</b></p> <p>PROJECT : PLANNING APPLICATION FROM REZONING FOR A SITE AT DISCOVERY BAY FROM "OTHER SPECIFIED USES" ("OU") AND GOVERNMENT, INSTITUTION OR COMMUNITY (GIC) ZONES TO "RESIDENTIAL" ("R(C)") AND "SERVICE AREA &amp; SPORTS AND RECREATION CLUB" ZONES, DISCOVERY BAY, HONG KONG</p>	<p>FIGURE : <b>C.1</b></p> <p>REVISION : <b>A</b></p> <p>DATE : <b>JULY 2023</b></p>
---	---	--



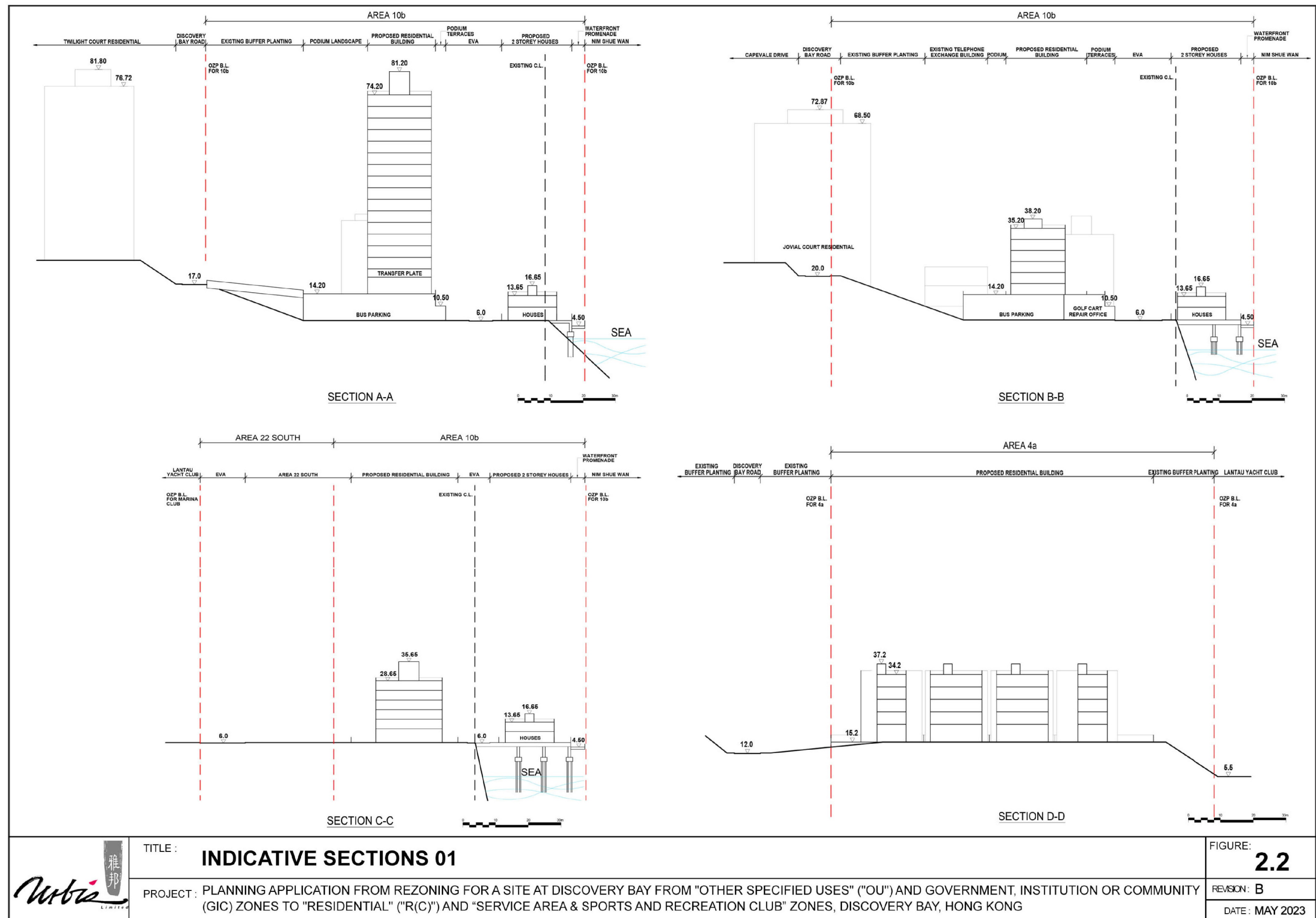

(來源：申請人於2023年7月27日提交)  
(SOURCE: SUBMITTED BY APPLICANT ON 27.7.2023)

參考編號  
REFERENCE No.  
R/S/I-DB/5-1 to 50

繪圖 DRAWING  
H-2c



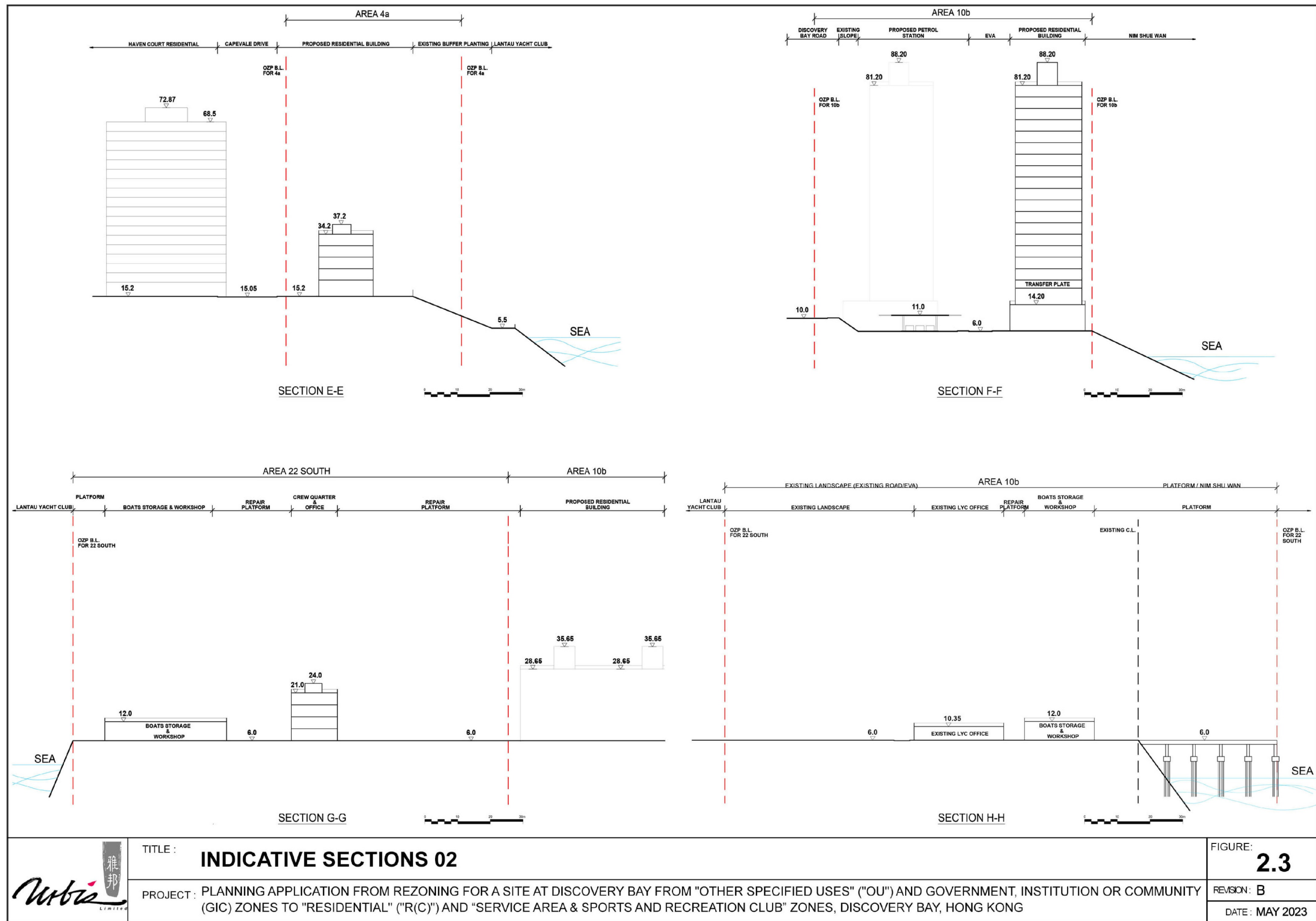

TITLE : **INDICATIVE SECTIONS 02**

PROJECT : PLANNING APPLICATION FROM REZONING FOR A SITE AT DISCOVERY BAY FROM "OTHER SPECIFIED USES" ("OU") AND GOVERNMENT, INSTITUTION OR COMMUNITY (GIC) ZONES TO "RESIDENTIAL" ("R(C)") AND "SERVICE AREA & SPORTS AND RECREATION CLUB" ZONES, DISCOVERY BAY, HONG KONG

FIGURE: **2.3**

REVISION: B

DATE: MAY 2023

(來源：申請人於2023年7月27日提交)  
(SOURCE: SUBMITTED BY APPLICANT ON 27.7.2023)

參考編號  
REFERENCE No.  
R/S/I-DB/5-1 to 50

繪圖 DRAWING  
H-2d





KEY PLAN

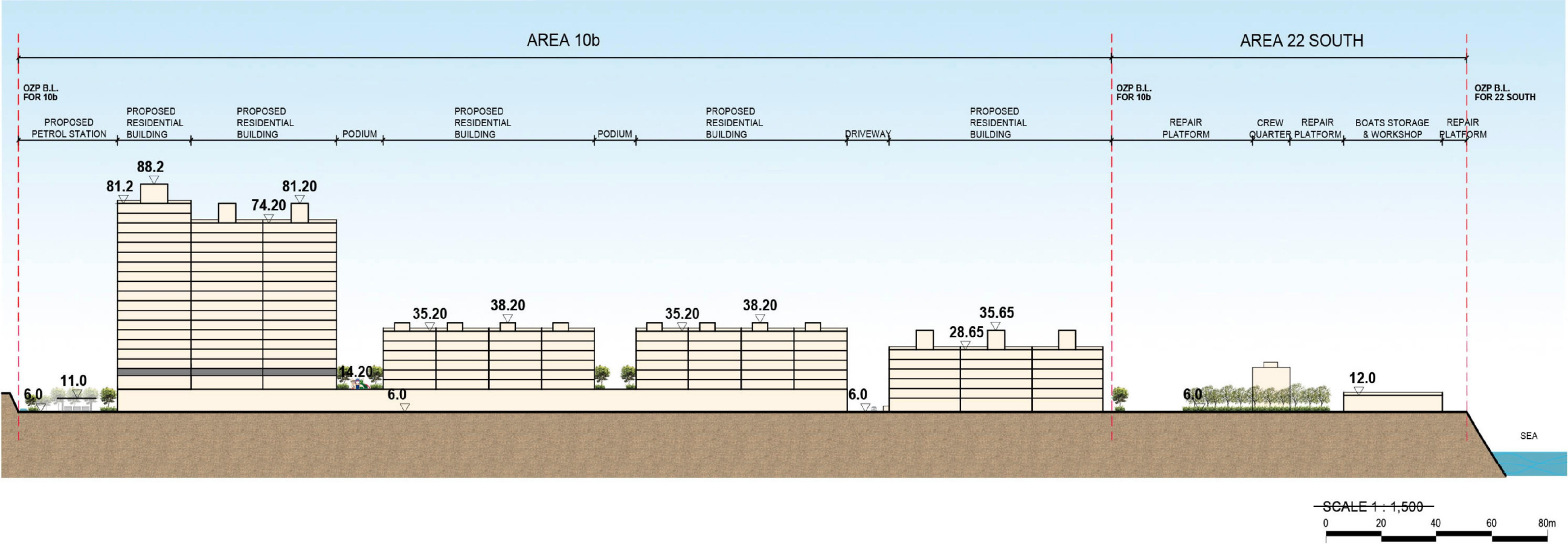

TITLE : **SECTION I-I**

PROJECT : PLANNING APPLICATION FROM REZONING FOR A SITE AT DISCOVERY BAY FROM "OTHER SPECIFIED USES" ("OU") AND GOVERNMENT, INSTITUTION OR COMMUNITY (GIC) ZONES TO "RESIDENTIAL" ("R(C)") AND "SERVICE AREA & SPORTS AND RECREATION CLUB" ZONES, DISCOVERY BAY, HONG KONG

FIGURE : **C.10**

REVISION : 0

DATE : JULY 2023

(來源：申請人於2023年7月27日提交)  
(SOURCE: SUBMITTED BY APPLICANT ON 27.7.2023)

參考編號  
REFERENCE No.  
R/S/I-DB/5-1 to 50

繪圖 DRAWING  
H-2e



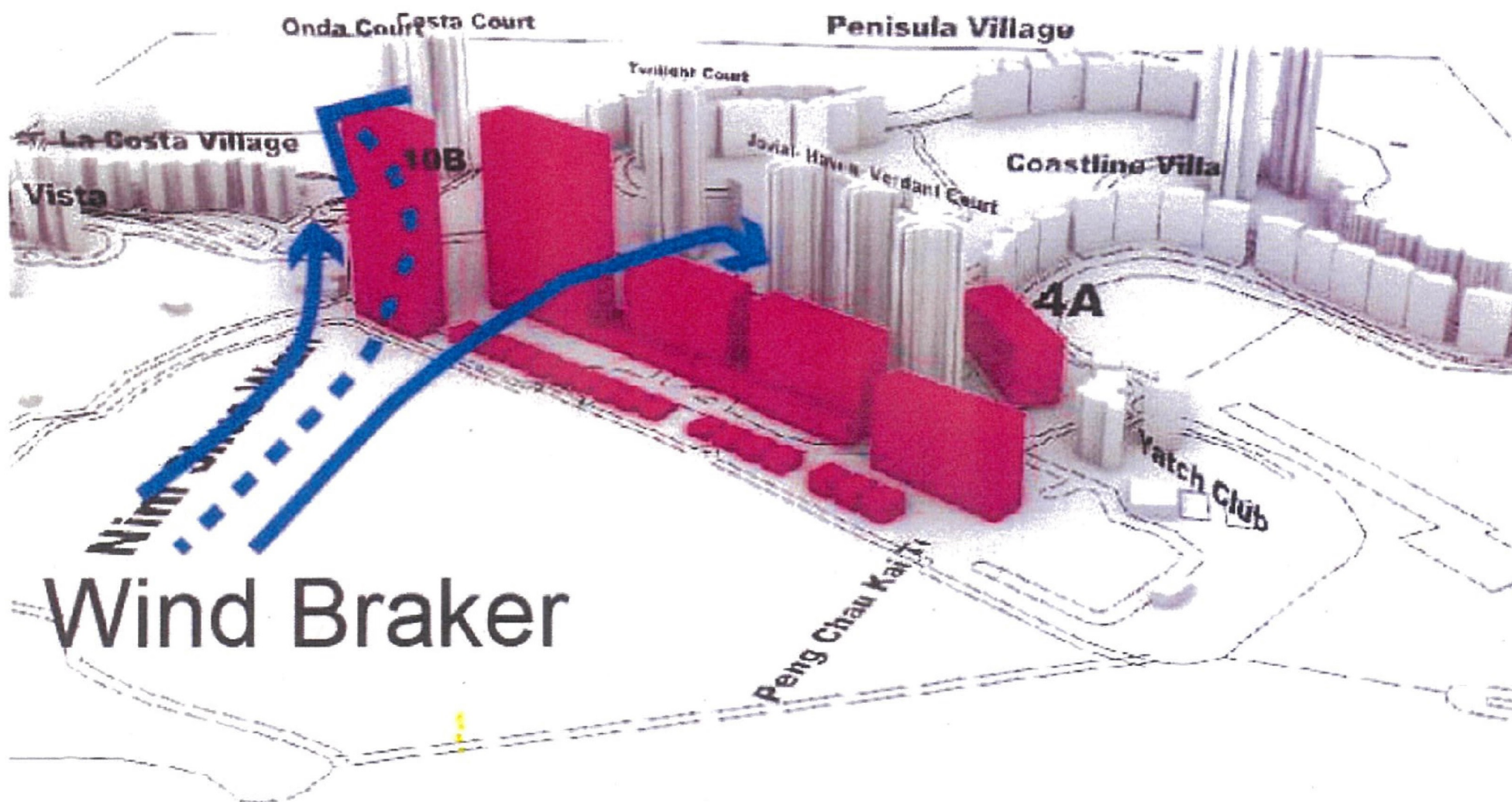

(摘取自申述編號R21提交的資料)

(Extracted from Information Submitted by Representation No. R21)

參考編號  
REFERENCE No.  
R/S/I-DB/5-1 to 50

繪圖 DRAWING  
H-3a



88.2 m height  
20 storeys walled  
building blocks

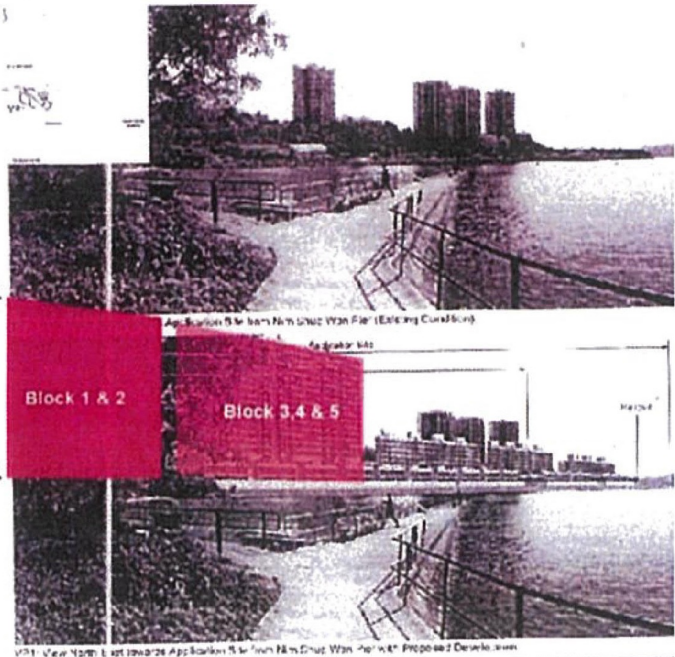

Photomontage – VP1 (VSR REC4) from Nim Shue Wan Pier.

10b zone

1/ 20 storeys blocks that defy planning principle of gradual descends to the water front

32

2/ It further breaks out the skyline silhouettes of the coastal environment

## Appendix 2 Elevations

S 12A Rezoning Application: Discovery Bay Outline Zoning Plan,  
Proposed Development Areas: 10b, 22 and 4a

### Discovery Bay Area 10b and 4a Master Layout Typical Floor Plan

4 July 2012

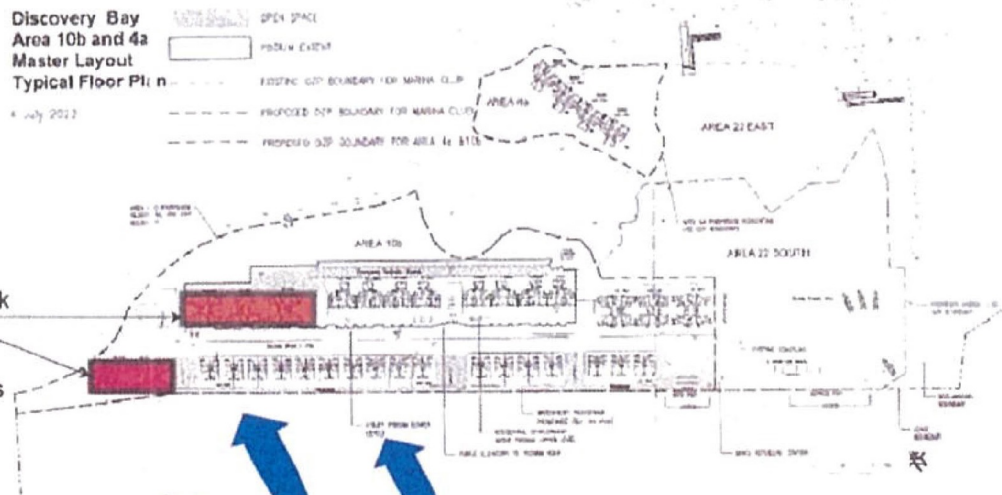

20 storeys residential block  
forming a 88.2 m high  
walled due to its  
high density developments

Figure 8: The development typical floor plan.

Prevailing winds

5 Blocks Mid Rise of 20 storeys 88.2 mPD that forms a specific Walled Building that will block prevailing winds and affected ventilation of micro environment to the surrounding neighborhood

## Appendix 3 Plan

(摘取自申述編號R21提交的資料)

(Extracted from Information Submitted by Representation No. R21)

參考編號  
REFERENCE No.  
R/S/I-DB/5-1 to 50

繪圖 DRAWING  
H-3b



## Mid rise Residential Block

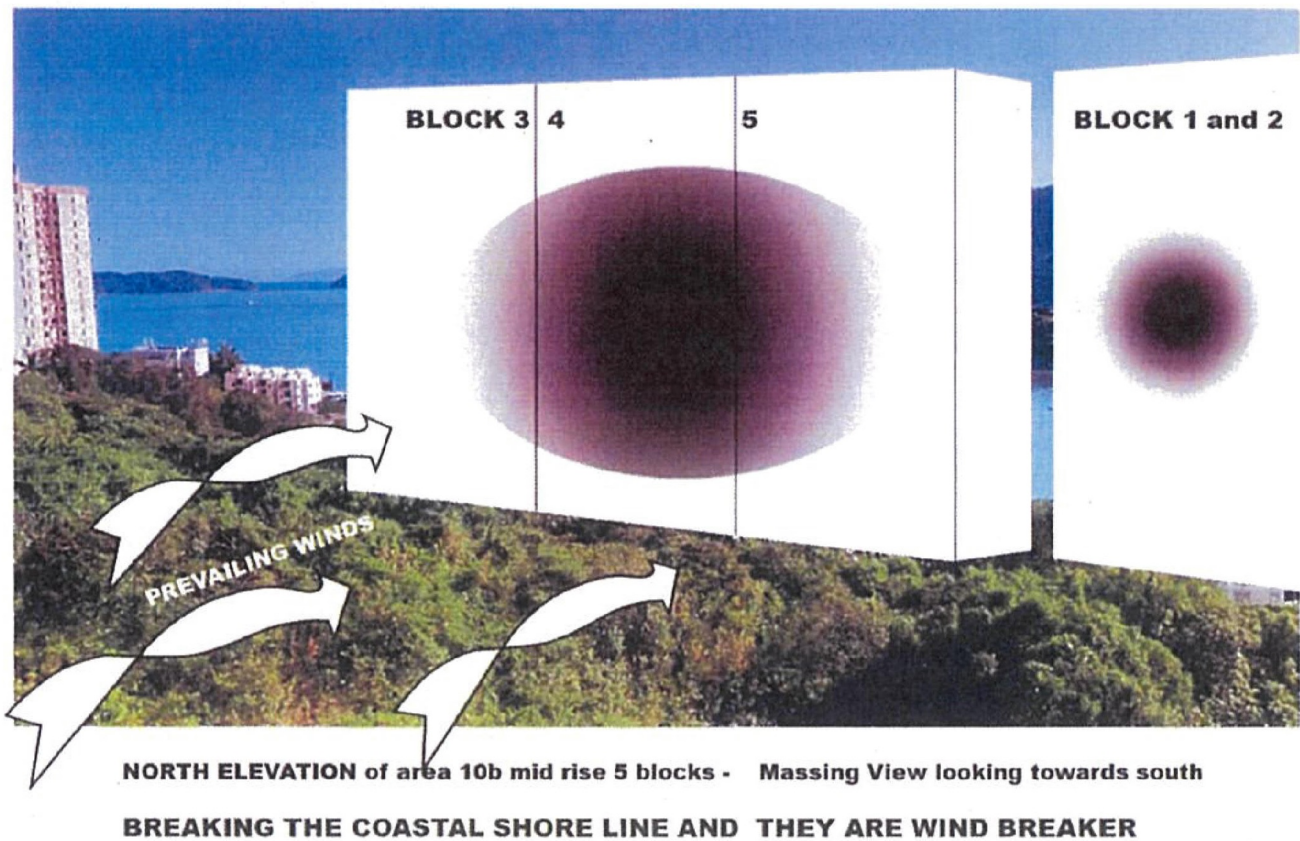

### Appendix 4 Looking from North West Corner

The only venturi wind break in the peninsula region will be blocked by the proposed walled buildings causing undesirable micro climatic condition.

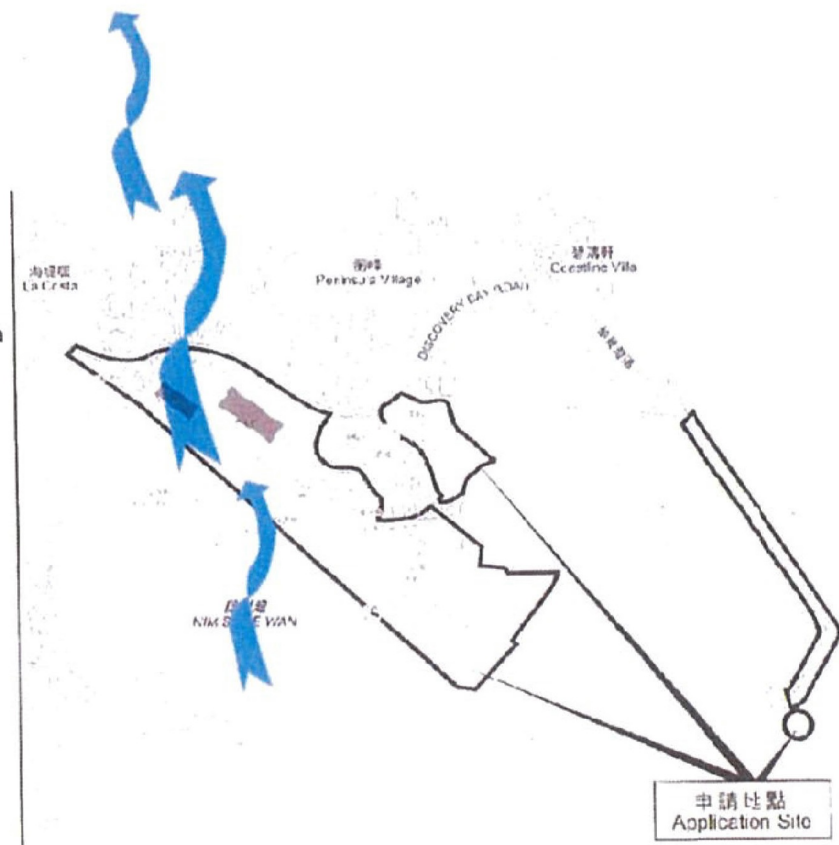

### Appendix 5 Master Plan

(摘取自申述編號R21提交的資料)  
(Extracted from Information Submitted by Representation No. R21)

參考編號  
REFERENCE No.  
R/S/I-DB/5-1 to 50

繪圖 DRAWING  
H-3c



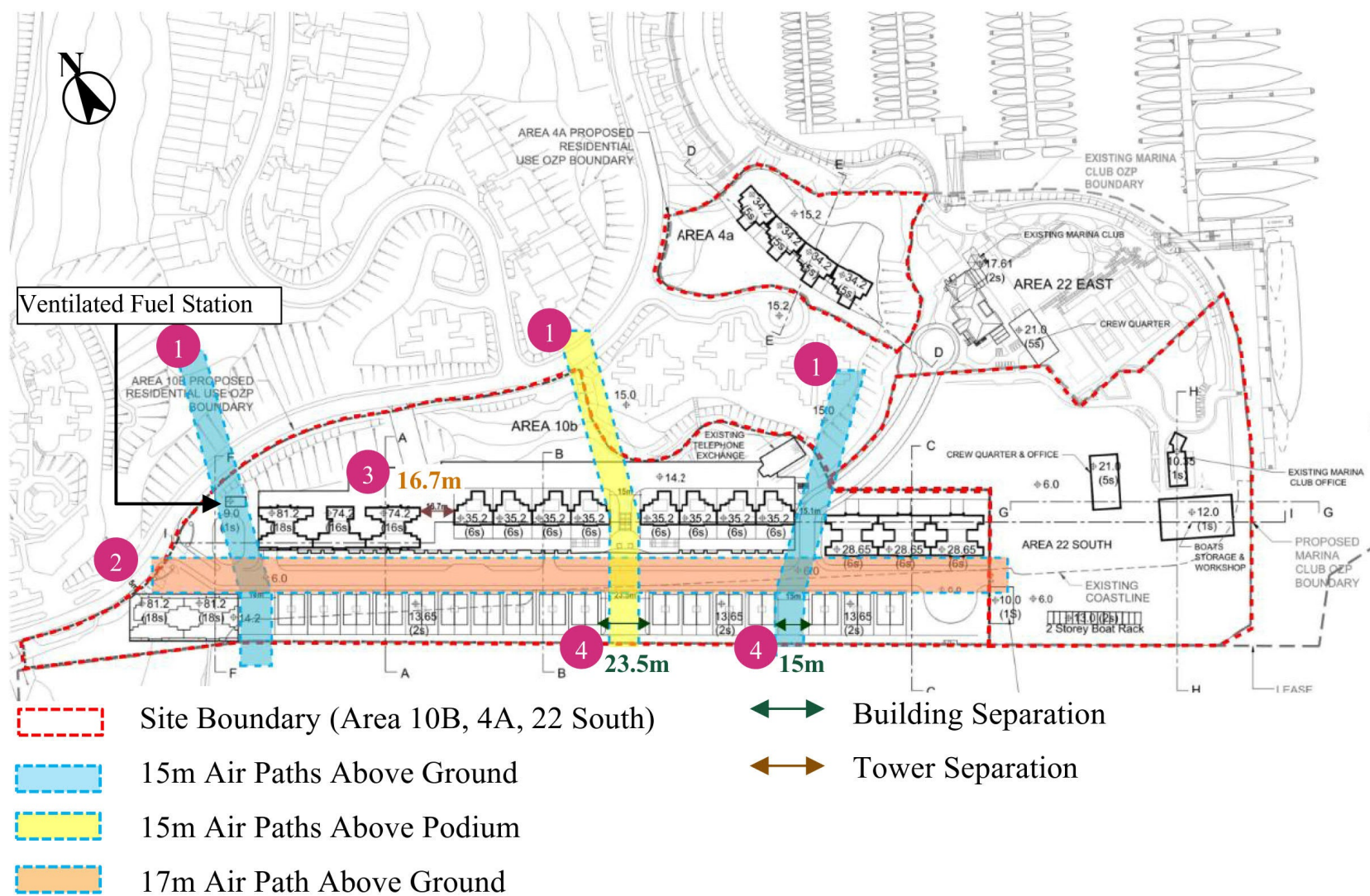
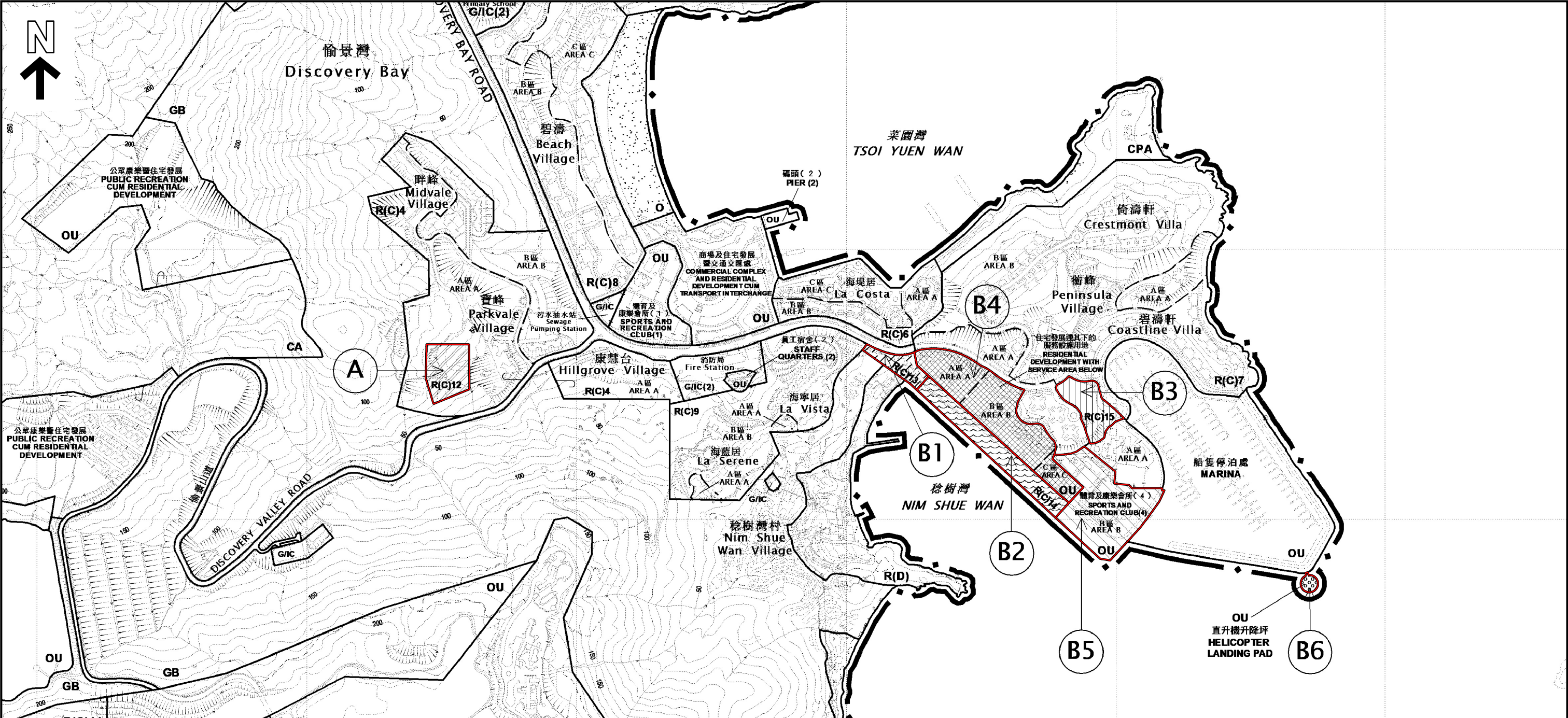

Figure 11 Block Layout Plan of Proposed Scheme





修訂項目 AMENDMENT ITEMS

<div><div><div></div></div></div> <p>申述個案編號 REPRESENTATIONS No. <b>R1 - R11, R26 - R42, R45, R47, R48</b> 由「其他指定用途」註明「員工宿舍（5）」地帶改劃為「住宅（丙類）12」地帶 REZONING FROM "OU" ANNOTATED "STAFF QUARTERS (5)" TO "R(C)12"</p>	<div><div><div></div></div></div> <p>申述個案編號 REPRESENTATIONS No. <b>R1 - R11, R13 - R49</b> 由「其他指定用途」註明「員工宿舍（1）」、「服務設施用地」、「危險品貯存庫／石油氣貯存庫」、「碼頭（3）」、「加油站」、「政府、機構或社區」和「住宅（丙類）7」地帶改劃為「其他指定用途」註明「住宅發展連其下的服務設施用地」地帶及於圖則上訂明支區 REZONING FROM "OU" ANNOTATED "STAFF QUARTERS (1)", "SERVICE AREA", "DANGEROUS GOODS STORE/LIQUEFIED PETROLEUM GAS STORE", "PIER (3)" AND "PFS", "G/I/C" AND "R(C)7" TO "OU" ANNOTATED "RESIDENTIAL DEVELOPMENT WITH SERVICE AREA BELOW" AND STIPULATING SUB-AREAS ON THE PLAN</p>
<div><div><div></div></div></div> <p>申述個案編號 REPRESENTATIONS No. <b>R1 - R48</b> 將部分稔樹灣海域納入規劃區並劃為「住宅（丙類）13」地帶，及由「政府、機構或社區」、「其他指定用途」註明「員工宿舍（1）」、「住宅（丁類）」地帶和「綠化地帶」改劃為「住宅（丙類）13」地帶 INCORPORATION OF A SEA AREA IN NIM SHUE WAN INTO THE PLANNING SCHEME AREA AND ZONING IT TO "R(C)13", AND REZONING FROM "G/I/C", "OU" ANNOTATED "STAFF QUARTERS (1)", "R(D)" AND "GB" TO "R(C)13"</p>	<div><div><div></div></div></div> <p>申述個案編號 REPRESENTATIONS No. <b>R1 - R11, R14 - R48, R50</b> 將部分稔樹灣海域納入規劃區並劃為「其他指定用途」註明「體育及康樂會所（4）」地帶並訂明為B區，及由「其他指定用途」註明「服務設施用地」、「船隻停泊處」和「加油站」地帶改劃為「其他指定用途」註明「體育及康樂會所（4）」地帶並訂明為B區 INCORPORATION OF A SEA AREA IN NIM SHUE WAN INTO THE PLANNING SCHEME AREA AND ZONING IT TO "OU" ANNOTATED "SPORTS AND RECREATION CLUB (4)" AND STIPULATING AS AREA B, AND REZONING FROM "OU" ANNOTATED "SERVICE AREA", "MARINA" AND "PFS" TO "OU" ANNOTATED "SPORTS AND RECREATION CLUB (4)" AND STIPULATING AS AREA B</p>
<div><div><div></div></div></div> <p>申述個案編號 REPRESENTATIONS No. <b>R1 - R48</b> 將部分稔樹灣海域納入規劃區並劃為「住宅（丙類）14」地帶，及由「其他指定用途」註明「員工宿舍（1）」、「服務設施用地」、「碼頭（3）」和「加油站」地帶改劃為「住宅（丙類）14」地帶 INCORPORATION OF A SEA AREA IN NIM SHUE WAN INTO THE PLANNING SCHEME AREA AND ZONING IT TO "R(C)14", AND REZONING FROM "OU" ANNOTATED "STAFF QUARTERS (1)", "SERVICE AREA", "PIER (3)" AND "PFS" TO "R(C)14"</p>	<div><div><div></div></div></div> <p>申述個案編號 REPRESENTATIONS No. <b>R1 - R11, R14 - R48</b> 將部分稔樹灣海域納入規劃區並劃為「其他指定用途」註明「直升機升降坪」地帶 INCORPORATION OF A SEA AREA IN NIM SHUE WAN INTO THE PLANNING SCHEME AREA AND ZONING IT TO "OU" ANNOTATED "HELICOPTER LANDING PAD"</p>
<div><div><div></div></div></div> <p>申述個案編號 REPRESENTATIONS No. <b>R1 - R48</b> 由「其他指定用途」註明「體育及康樂會所（4）」和「住宅（丙類）7」地帶改劃為「住宅（丙類）15」地帶 REZONING FROM "OU" ANNOTATED "SPORTS AND RECREATION CLUB (4)" AND "R(C)7" TO "R(C)15"</p>	

申述地點位置圖 LOCATION PLAN OF REPRESENTATION SITES

就愉景灣分區計劃大綱草圖編號S/I-D B/5  
提出的申述個案編號R 1至R 5 0作出考慮

CONSIDERATION OF REPRESENTATIONS No. R1 TO R50  
TO THE DRAFT DISCOVERY BAY OUTLINE ZONING PLAN No. S/I-DB/5

SCALE 1:7 500 比例尺

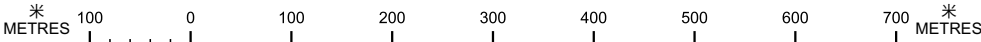

本摘要圖於2024年8月16日擬備，  
所根據的資料為於2024年4月12日  
展示的分區計劃大綱草圖編號S/I-DB/5  
EXTRACT PLAN PREPARED ON 16.8.2024  
BASED ON DRAFT OUTLINE ZONING PLAN No.  
S/I-DB/5 EXHIBITED ON 12.4.2024

規 劃 署  
PLANNING DEPARTMENT



參考編號  
REFERENCE No.  
R/S/I-DB/5-1 to 50

圖 PLAN  
H-1



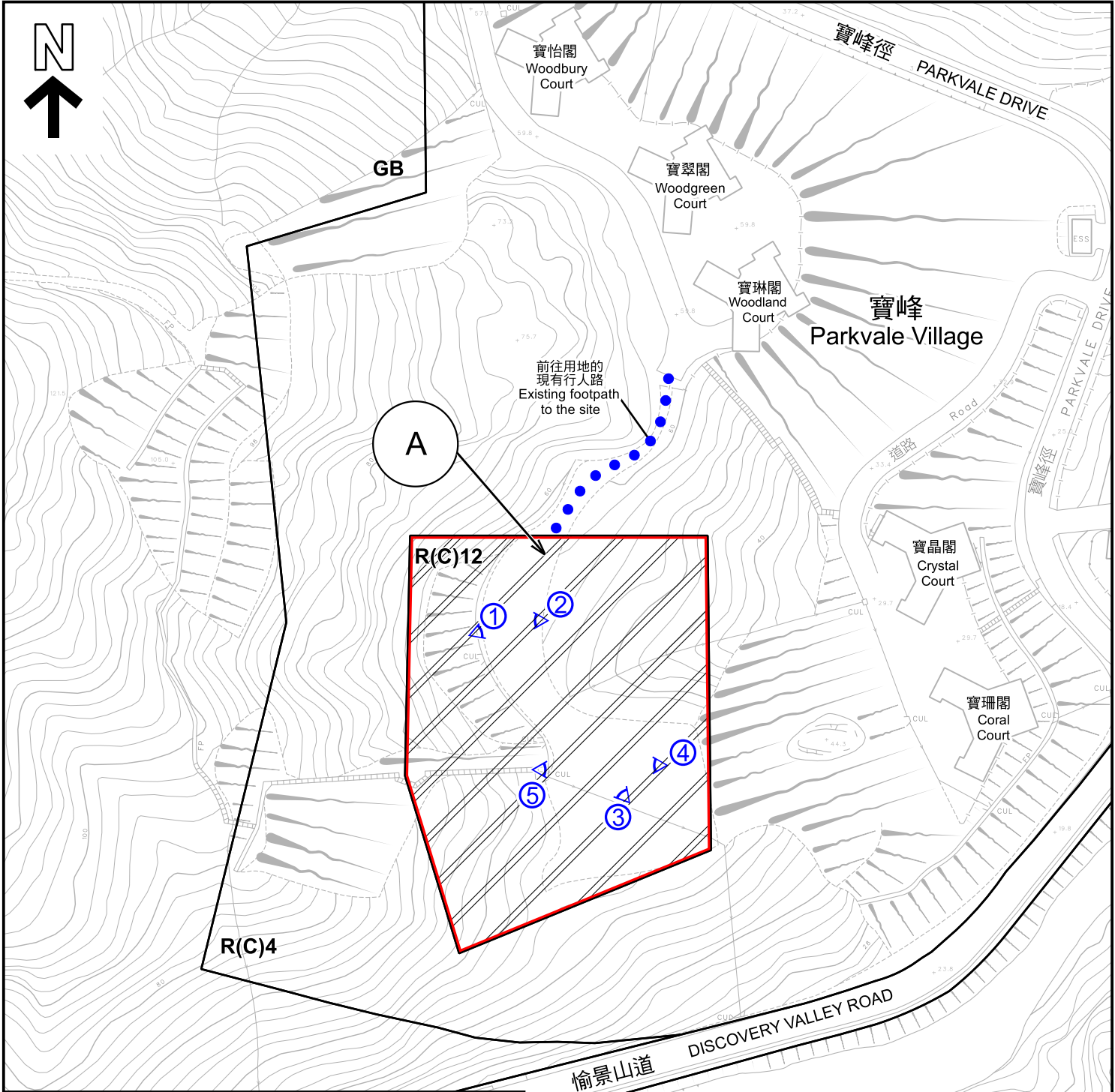

修訂項目 AMENDMENT ITEM	
	申述個案編號 REPRESENTATIONS No. <u>R1 - R11, R26 - R42, R45, R47, R48</u> 由「其他指定用途」註明「員工宿舍(5)」地帶改劃為「住宅(丙類)12」地帶 REZONING FROM "OU" ANNOTATED "STAFF QUARTERS (5)" TO "R(C)12"
圖例 LEGEND	
R(C)	住宅(丙類) RESIDENTIAL (GROUP C)
GB	綠化地帶 GREEN BELT
	實地照片的觀景點 VIEWING POINT OF SITE PHOTO
界線只作識別用 BOUNDARY FOR IDENTIFICATION PURPOSE ONLY	

本摘要圖於2024年8月16日擬備，  
所根據的資料為測量圖編號10-SW-3B及D

EXTRACT PLAN PREPARED ON  
16.8.2024 BASED ON SURVEY SHEETS  
No. 10-SW-3B&D

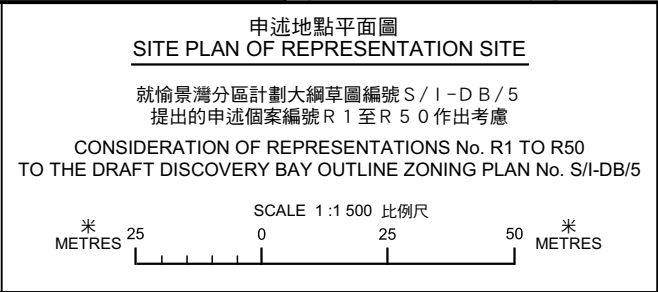

規劃署 PLANNING DEPARTMENT		
參考編號 REFERENCE No.	圖 PLAN	
R/S/I-DB/5-1 to 50	H-2a	





修訂項目 AMENDMENT ITEM

A

申述個案編號 REPRESENTATIONS No. **R1 - R11, R26 - R42, R45, R47, R48**  
由「其他指定用途」註明「員工宿舍（5）」地帶改劃為「住宅（丙類）12」地帶  
REZONING FROM "OU" ANNOTATED "STAFF QUARTERS (5)" TO "R(C)12"

界線只作識別用  
BOUNDARY FOR IDENTIFICATION PURPOSE ONLY

本摘要圖於2024年8月16日擬備，所根據的資料為真數碼正射影像圖（2023年11月） EXTRACT PLAN PREPARED ON 16.8.2024 BASED ON TRUE DIGITAL ORTHOPHOTO (NOV 2023)	申述地點航攝照片 <u>AERIAL PHOTO OF REPRESENTATION SITE</u>  就愉景灣分區計劃大綱草圖編號 S / I - D B / 5 提出的申述個案編號 R 1 至 R 5 0 作出考慮  CONSIDERATION OF REPRESENTATIONS No. R1 TO R50 TO THE DRAFT DISCOVERY BAY OUTLINE ZONING PLAN No. S/I-DB/5		規 劃 署 PLANNING DEPARTMENT 
	參考編號 REFERENCE No. R/S/I-DB/5-1 to 50		圖 PLAN H-2b



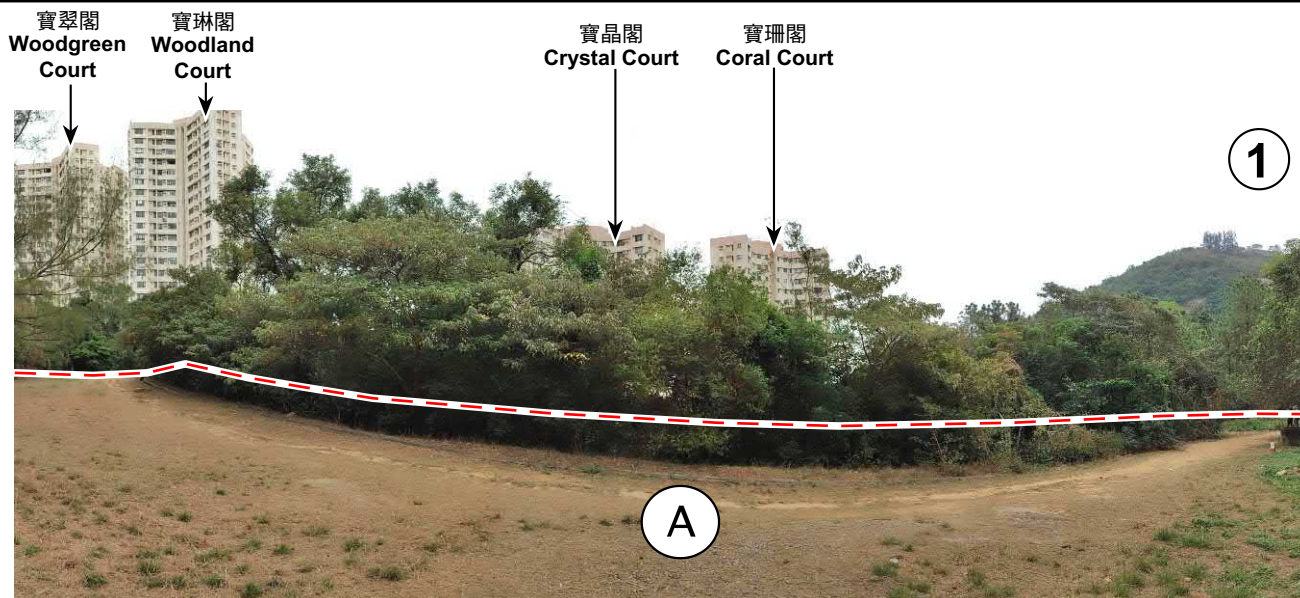

界線只作識別用  
BOUNDARY FOR IDENTIFICATION PURPOSE ONLY

### 實地照片 SITE PHOTOS

本圖於2024年8月6日擬備，所根據的資料為攝於2024年2月5日的實地照片  
PLAN PREPARED ON 6.8.2024  
BASED ON SITE PHOTOS  
TAKEN ON 5.2.2024

就愉景灣分區計劃大綱草圖編號 S/I-DB/5  
提出的申述個案編號 R 1 至 R 50 作出考慮  
CONSIDERATION OF REPRESENTATIONS No. R1 TO R50  
TO THE DRAFT DISCOVERY BAY OUTLINE ZONING PLAN No. S/I-DB/5

規劃署  
PLANNING  
DEPARTMENT



參考編號  
REFERENCE No.  
R/S/I-DB/5-1 to 50

圖 PLAN  
H-2c





### 實地照片 SITE PHOTOS

就愉景灣分區計劃大綱草圖編號 S / I - D B / 5  
提出的申述個案編號 R 1 至 R 5 0 作出考慮

CONSIDERATION OF REPRESENTATIONS No. R1 TO R50  
TO THE DRAFT DISCOVERY BAY OUTLINE ZONING PLAN No. S/I-DB/5

規劃署  
PLANNING  
DEPARTMENT



參考編號  
REFERENCE No.  
R/S/I-DB/5-1 to 50

圖 PLAN  
H-2d

本圖於2024年8月6日擬備，所根據的  
資料為攝於2024年2月5日的實地照片  
PLAN PREPARED ON 6.8.2024  
BASED ON SITE PHOTOS  
TAKEN ON 5.2.2024



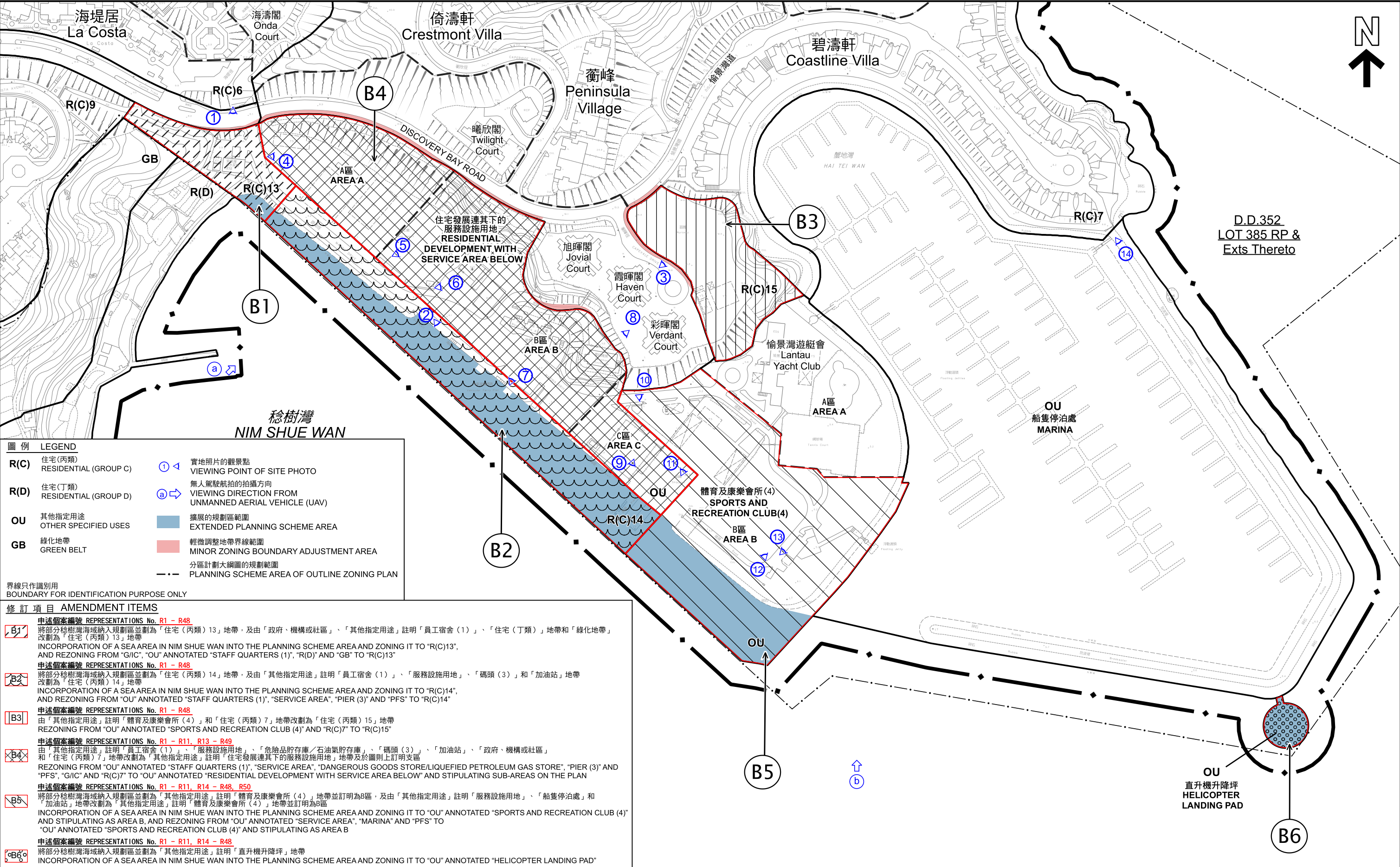

圖例	LEGEND
R(C)	住宅(丙類) RESIDENTIAL (GROUP C)
R(D)	住宅(丁類) RESIDENTIAL (GROUP D)
OU	其他指定用途 OTHER SPECIFIED USES
GB	綠化地帶 GREEN BELT
①	實地照片的觀景點 VIEWING POINT OF SITE PHOTO
Ⓐ	無人駕駛航拍的拍攝方向 VIEWING DIRECTION FROM UNMANNED AERIAL VEHICLE (UAV)
Blue wavy line	擴展的規劃區範圍 EXTENDED PLANNING SCHEME AREA
Red wavy line	輕微調整地帶界線範圍 MINOR ZONING BOUNDARY ADJUSTMENT AREA
Dashed line	分區計劃大綱圖的規劃範圍 PLANNING SCHEME AREA OF OUTLINE ZONING PLAN
界線只作識別用 BOUNDARY FOR IDENTIFICATION PURPOSE ONLY	

修訂項目	AMENDMENT ITEMS
B1	申述個案編號 REPRESENTATIONS No. <u>R1 - R48</u> 將部分稔樹灣海域納入規劃區並劃為「住宅(丙類)13」地帶, 及由「政府、機構或社區」、「其他指定用途」註明「員工宿舍(1)」、「住宅(丁類)」地帶和「綠化地帶」改劃為「住宅(丙類)13」地帶 INCORPORATION OF A SEA AREA IN NIM SHUE WAN INTO THE PLANNING SCHEME AREA AND ZONING IT TO "R(C)13", AND REZONING FROM "G/C", "OU" ANNOTATED "STAFF QUARTERS (1)", "R(D)" AND "GB" TO "R(C)13"
B2	申述個案編號 REPRESENTATIONS No. <u>R1 - R48</u> 將部分稔樹灣海域納入規劃區並劃為「住宅(丙類)14」地帶, 及由「其他指定用途」註明「員工宿舍(1)」、「服務設施用地」、「碼頭(3)」和「加油站」地帶改劃為「住宅(丙類)14」地帶 INCORPORATION OF A SEA AREA IN NIM SHUE WAN INTO THE PLANNING SCHEME AREA AND ZONING IT TO "R(C)14", AND REZONING FROM "OU" ANNOTATED "STAFF QUARTERS (1)", "SERVICE AREA", "PIER (3)" AND "PFS" TO "R(C)14"
B3	申述個案編號 REPRESENTATIONS No. <u>R1 - R48</u> 由「其他指定用途」註明「體育及康樂會所(4)」和「住宅(丙類)7」地帶改劃為「住宅(丙類)15」地帶 REZONING FROM "OU" ANNOTATED "SPORTS AND RECREATION CLUB (4)" AND "R(C)7" TO "R(C)15"
B4	申述個案編號 REPRESENTATIONS No. <u>R1 - R11, R13 - R49</u> 由「其他指定用途」註明「員工宿舍(1)」、「服務設施用地」、「危險品貯存庫/石油氣貯存庫」、「碼頭(3)」、「加油站」、「政府、機構或社區」和「住宅(丙類)7」地帶改劃為「其他指定用途」, 註明「住宅發展連其下的服務設施用地」地帶及於圖則上訂明支區 REZONING FROM "OU" ANNOTATED "STAFF QUARTERS (1)", "SERVICE AREA", "DANGEROUS GOODS STORE/LIQUEFIED PETROLEUM GAS STORE", "PIER (3)" AND "PFS", "G/C" AND "R(C)7" TO "OU" ANNOTATED "RESIDENTIAL DEVELOPMENT WITH SERVICE AREA BELOW" AND STIPULATING SUB-AREAS ON THE PLAN
B5	申述個案編號 REPRESENTATIONS No. <u>R1 - R11, R14 - R48, R50</u> 將部分稔樹灣海域納入規劃區並劃為「其他指定用途」, 註明「體育及康樂會所(4)」地帶並訂明為B區, 及由「其他指定用途」註明「服務設施用地」、「船隻停泊處」和「加油站」地帶改劃為「其他指定用途」, 註明「體育及康樂會所(4)」地帶並訂明為B區 INCORPORATION OF A SEA AREA IN NIM SHUE WAN INTO THE PLANNING SCHEME AREA AND ZONING IT TO "OU" ANNOTATED "SPORTS AND RECREATION CLUB (4)" AND STIPULATING AS AREA B, AND REZONING FROM "OU" ANNOTATED "SERVICE AREA", "MARINA" AND "PFS" TO "OU" ANNOTATED "SPORTS AND RECREATION CLUB (4)" AND STIPULATING AS AREA B
B6	申述個案編號 REPRESENTATIONS No. <u>R1 - R11, R14 - R48</u> 將部分稔樹灣海域納入規劃區並劃為「其他指定用途」, 註明「直升機升降坪」地帶 INCORPORATION OF A SEA AREA IN NIM SHUE WAN INTO THE PLANNING SCHEME AREA AND ZONING IT TO "OU" ANNOTATED "HELICOPTER LANDING PAD"

本摘要圖於2024年8月6日擬備, 所根據的資料為測量圖編號 10-SW-4A、B、C及D EXTRACT PLAN PREPARED ON 6.8.2024 BASED ON SURVEY SHEETS No. 10-SW-4A,B,C&D		申述地點平面圖 SITE PLAN OF REPRESENTATION SITES 就愉景灣分區計劃大綱草圖編號 S/I-DB/5 提出的申述個案編號 R 1 至 R 5 0 作出考慮 CONSIDERATION OF REPRESENTATIONS No. R1 TO R50 TO THE DRAFT DISCOVERY BAY OUTLINE ZONING PLAN No. S/I-DB/5 SCALE 1:2 500 比例尺		規劃署 PLANNING DEPARTMENT	
		參考編號 REFERENCE No. R/S/I-DB/5-1 to 50		圖 PLAN H-3a	



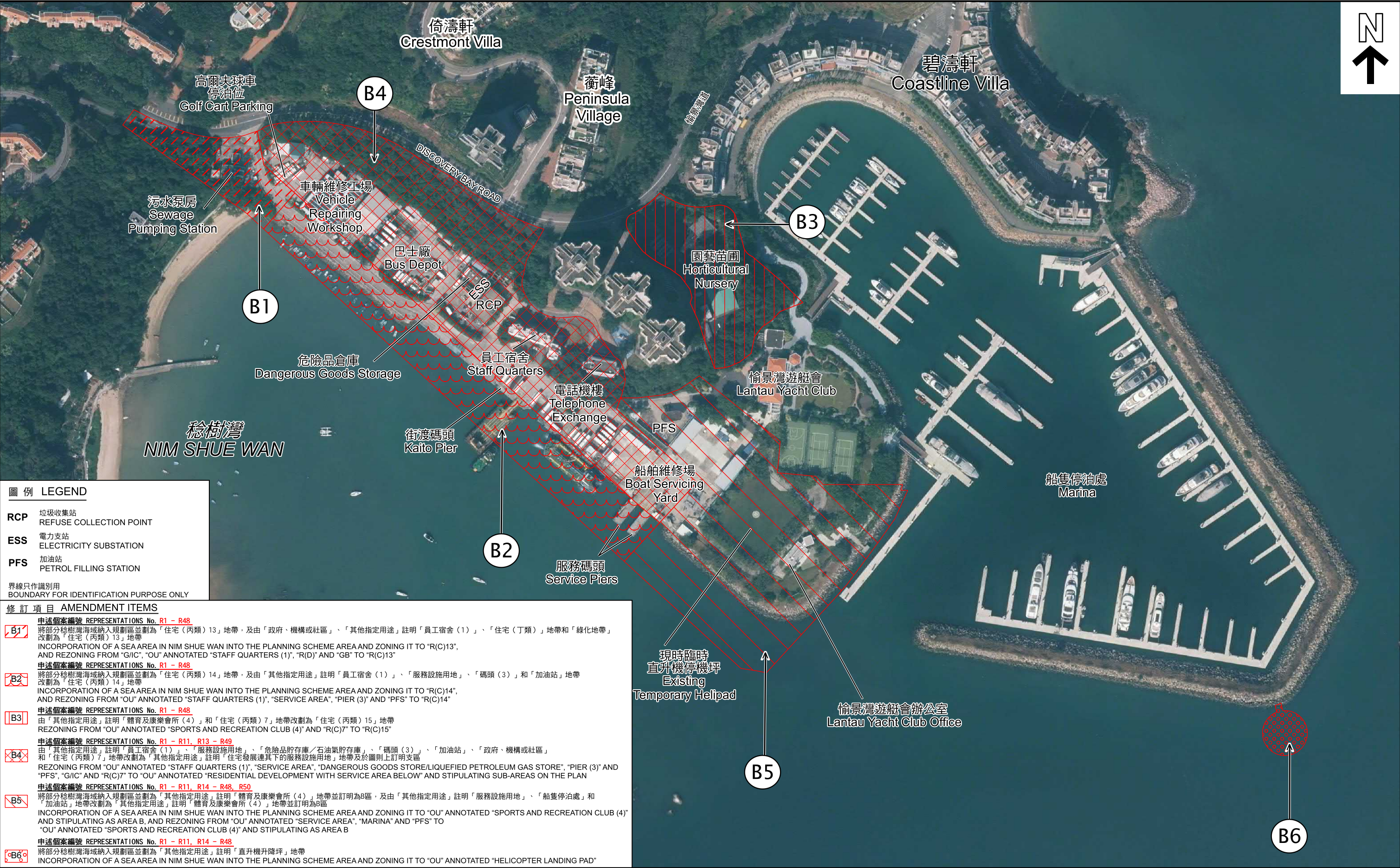

**圖例 LEGEND**

**RCP** 垃圾收集站  
REFUSE COLLECTION POINT

**ESS** 電力支站  
ELECTRICITY SUBSTATION

**PFS** 加油站  
PETROL FILLING STATION

界線只作識別用  
BOUNDARY FOR IDENTIFICATION PURPOSE ONLY

修訂項目 AMENDMENT ITEMS	
<div><div></div><div>B1</div></div>	<p>申述個案編號 REPRESENTATIONS No. <b>R1 - R48</b></p> <p>將部分稔樹灣海域納入規劃區並劃為「住宅（丙類）13」地帶，及由「政府、機構或社區」、「其他指定用途」註明「員工宿舍（1）」、「住宅（丁類）」地帶和「綠化地帶」改劃為「住宅（丙類）13」地帶</p> <p>INCORPORATION OF A SEA AREA IN NIM SHUE WAN INTO THE PLANNING SCHEME AREA AND ZONING IT TO "R(C)13", AND REZONING FROM "G/C", "OU" ANNOTATED "STAFF QUARTERS (1)", "R(D)" AND "GB" TO "R(C)13"</p>
<div><div></div><div>B2</div></div>	<p>申述個案編號 REPRESENTATIONS No. <b>R1 - R48</b></p> <p>將部分稔樹灣海域納入規劃區並劃為「住宅（丙類）14」地帶，及由「其他指定用途」註明「員工宿舍（1）」、「服務設施用地」、「碼頭（3）」和「加油站」地帶改劃為「住宅（丙類）14」地帶</p> <p>INCORPORATION OF A SEA AREA IN NIM SHUE WAN INTO THE PLANNING SCHEME AREA AND ZONING IT TO "R(C)14", AND REZONING FROM "OU" ANNOTATED "STAFF QUARTERS (1)", "SERVICE AREA", "PIER (3)" AND "PFS" TO "R(C)14"</p>
<div><div></div><div>B3</div></div>	<p>申述個案編號 REPRESENTATIONS No. <b>R1 - R48</b></p> <p>由「其他指定用途」註明「體育及康樂會所（4）」和「住宅（丙類）7」地帶改劃為「住宅（丙類）15」地帶</p> <p>REZONING FROM "OU" ANNOTATED "SPORTS AND RECREATION CLUB (4)" AND "R(C)7" TO "R(C)15"</p>
<div><div></div><div>B4</div></div>	<p>申述個案編號 REPRESENTATIONS No. <b>R1 - R11, R13 - R49</b></p> <p>由「其他指定用途」註明「員工宿舍（1）」、「服務設施用地」、「危險品貯存庫／石油氣貯存庫」、「碼頭（3）」、「加油站」、「政府、機構或社區」和「住宅（丙類）7」地帶改劃為「其他指定用途」註明「住宅發展連其下的服務設施用地」地帶及於圖則上訂明支區</p> <p>REZONING FROM "OU" ANNOTATED "STAFF QUARTERS (1)", "SERVICE AREA", "DANGEROUS GOODS STORE/LIQUEFIED PETROLEUM GAS STORE", "PIER (3)" AND "PFS", "G/C" AND "R(C)7" TO "OU" ANNOTATED "RESIDENTIAL DEVELOPMENT WITH SERVICE AREA BELOW" AND STIPULATING SUB-AREAS ON THE PLAN</p>
<div><div></div><div>B5</div></div>	<p>申述個案編號 REPRESENTATIONS No. <b>R1 - R11, R14 - R48, R50</b></p> <p>將部分稔樹灣海域納入規劃區並劃為「其他指定用途」註明「體育及康樂會所（4）」地帶並訂明為B區，及由「其他指定用途」註明「服務設施用地」、「船隻停泊處」和「加油站」地帶改劃為「其他指定用途」註明「體育及康樂會所（4）」地帶並訂明為B區</p> <p>INCORPORATION OF A SEA AREA IN NIM SHUE WAN INTO THE PLANNING SCHEME AREA AND ZONING IT TO "OU" ANNOTATED "SPORTS AND RECREATION CLUB (4)" AND STIPULATING AS AREA B, AND REZONING FROM "OU" ANNOTATED "SERVICE AREA", "MARINA" AND "PFS" TO "OU" ANNOTATED "SPORTS AND RECREATION CLUB (4)" AND STIPULATING AS AREA B</p>
<div><div></div><div>B6</div></div>	<p>申述個案編號 REPRESENTATIONS No. <b>R1 - R11, R14 - R48</b></p> <p>將部分稔樹灣海域納入規劃區並劃為「其他指定用途」註明「直升機升降坪」地帶</p> <p>INCORPORATION OF A SEA AREA IN NIM SHUE WAN INTO THE PLANNING SCHEME AREA AND ZONING IT TO "OU" ANNOTATED "HELICOPTER LANDING PAD"</p>



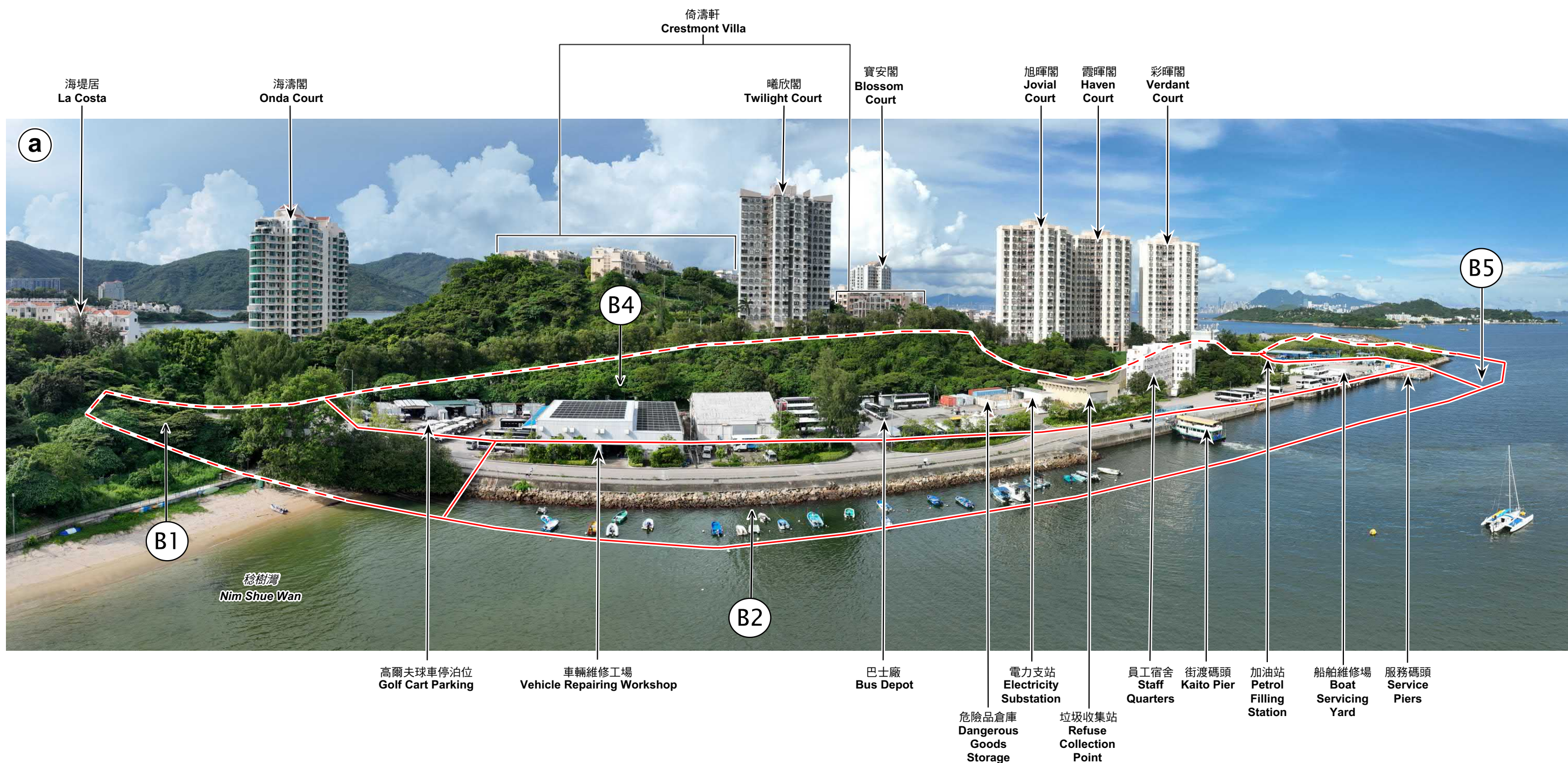

本圖於2024年8月7日擬備，所根據的資料為攝於2023年6月26日的無人駕駛航拍照片  
 PLAN PREPARED ON 7.8.2024  
 BASED ON UNMANNED AERIAL VEHICLE (UAV) PHOTO TAKEN ON 26.6.2023

實地照片 SITE PHOTO  
 就愉景灣分區計劃大綱草圖編號 S/I-DB/5  
 提出的申述個案編號 R 1 至 R 5 0 作出考慮  
 CONSIDERATION OF REPRESENTATIONS No. R1 TO R50  
 TO THE DRAFT DISCOVERY BAY OUTLINE ZONING PLAN No. S/I-DB/5

規 劃 署  
 PLANNING DEPARTMENT



參考編號  
 REFERENCE No.  
 R/S/I-DB/5-1 to 50

圖 PLAN  
 H-3c





本圖於2024年8月7日擬備，所根據的資料為攝於2023年6月26日的無人駕駛航拍照片  
 PLAN PREPARED ON 7.8.2024  
 BASED ON UNMANNED AERIAL VEHICLE (UAV) PHOTO TAKEN ON 26.6.2023

實地照片 SITE PHOTO  
 就愉景灣分區計劃大綱草圖編號S/I-DB/5  
 提出的申述個案編號R 1至R 50作出考慮  
 CONSIDERATION OF REPRESENTATIONS No. R1 TO R50  
 TO THE DRAFT DISCOVERY BAY OUTLINE ZONING PLAN No. S/I-DB/5

規劃署  
 PLANNING DEPARTMENT



參考編號  
 REFERENCE No.  
 R/S/I-DB/5-1 to 50

圖 PLAN  
 H-3d



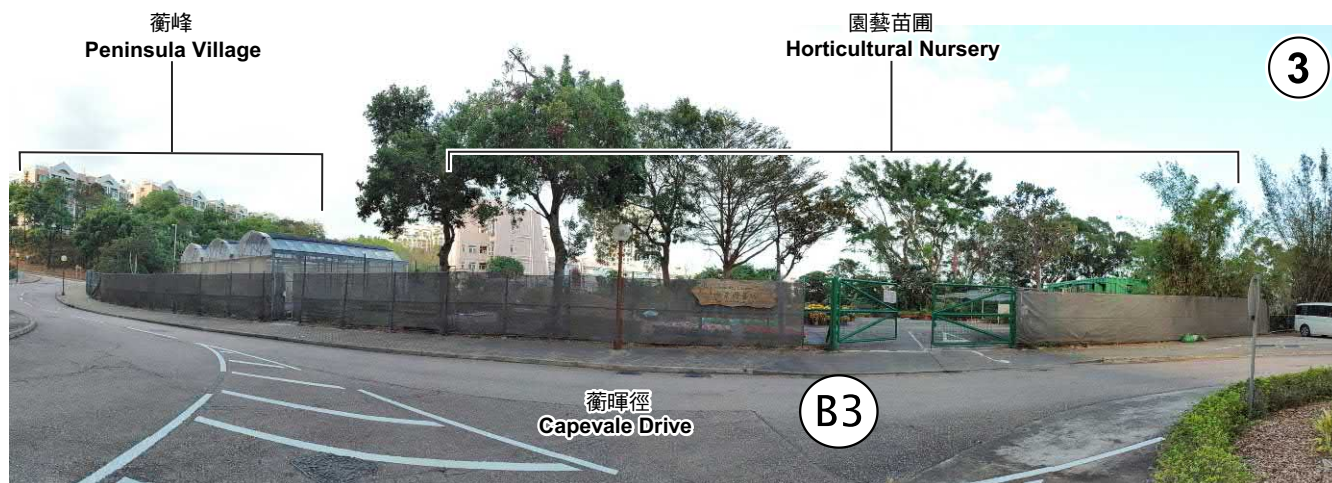

### 實地照片 SITE PHOTOS

本圖於2024年8月7日擬備，所根據的資料為攝於2024年2月5日的實地照片  
PLAN PREPARED ON 7.8.2024  
BASED ON SITE PHOTOS  
TAKEN ON 5.2.2024

就愉景灣分區計劃大綱草圖編號 S/I-DB/5  
提出的申述個案編號 R 1 至 R 5 0 作出考慮  
CONSIDERATION OF REPRESENTATIONS No. R1 TO R50  
TO THE DRAFT DISCOVERY BAY OUTLINE ZONING PLAN No. S/I-DB/5

規劃署  
PLANNING  
DEPARTMENT



參考編號  
REFERENCE No.  
R/S/I-DB/5-1 to 50

圖 PLAN  
H-3e



海濤閣  
Onda Court



B4

曦欣閣  
Twilight Court

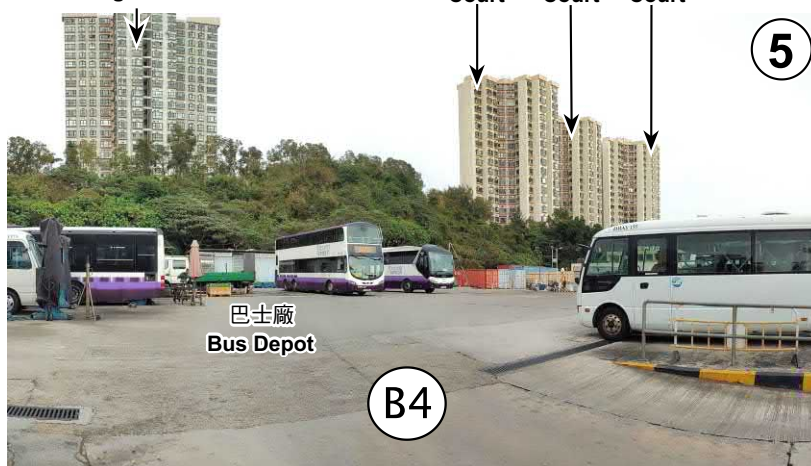

巴士廠  
Bus Depot

B4

旭暉閣  
Jovial Court

霞暉閣  
Haven Court

彩暉閣  
Verdant Court

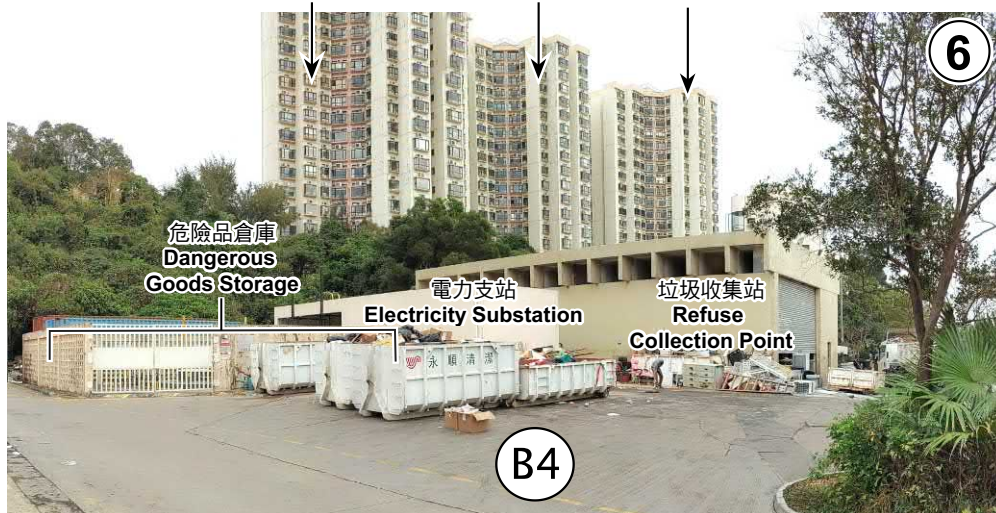

危險品倉庫  
Dangerous  
Goods Storage

電力支站  
Electricity Substation

垃圾收集站  
Refuse  
Collection Point

B4

## 實地照片 SITE PHOTOS

本圖於2024年8月7日擬備，所根據的資料為攝於2024年2月5日的實地照片  
PLAN PREPARED ON 7.8.2024  
BASED ON SITE PHOTOS  
TAKEN ON 5.2.2024

就愉景灣分區計劃大綱草圖編號 S/I-DB/5  
提出的申述個案編號 R 1 至 R 5 0 作出考慮  
CONSIDERATION OF REPRESENTATIONS No. R1 TO R50  
TO THE DRAFT DISCOVERY BAY OUTLINE ZONING PLAN No. S/I-DB/5

規劃署  
PLANNING  
DEPARTMENT



參考編號  
REFERENCE No.  
R/S/I-DB/5-1 to 50

圖 PLAN  
H-3f





### 實地照片 SITE PHOTOS

本圖於2024年8月7日擬備，所根據的資料為攝於2024年2月5日的實地照片  
PLAN PREPARED ON 7.8.2024  
BASED ON SITE PHOTOS  
TAKEN ON 5.2.2024

就愉景灣分區計劃大綱草圖編號 S/I-DB/5  
提出的申述個案編號 R 1 至 R 50 作出考慮  
CONSIDERATION OF REPRESENTATIONS No. R1 TO R50  
TO THE DRAFT DISCOVERY BAY OUTLINE ZONING PLAN No. S/I-DB/5

規劃署  
PLANNING  
DEPARTMENT



參考編號  
REFERENCE No.  
R/S/I-DB/5-1 to 50

圖 PLAN  
H-3g





# 實地照片 SITE PHOTOS

本圖於2024年8月7日擬備，所根據的資料為攝於2024年2月5日的實地照片  
PLAN PREPARED ON 7.8.2024  
BASED ON SITE PHOTOS  
TAKEN ON 5.2.2024

就愉景灣分區計劃大綱草圖編號 S/I-DB/5  
提出的申述個案編號 R 1 至 R 5 0 作出考慮  
CONSIDERATION OF REPRESENTATIONS No. R1 TO R50  
TO THE DRAFT DISCOVERY BAY OUTLINE ZONING PLAN No. S/I-DB/5

規劃署  
PLANNING  
DEPARTMENT



參考編號  
REFERENCE No.  
R/S/I-DB/5-1 to 50

圖 PLAN  
H-3h



愉景灣遊艇會辦公室  
Lantau Yacht Club Office



14



實地照片 SITE PHOTOS

本圖於2024年8月7日擬備，所根據的資料為攝於2024年2月5日的實地照片  
PLAN PREPARED ON 7.8.2024  
BASED ON SITE PHOTOS  
TAKEN ON 5.2.2024

就愉景灣分區計劃大綱草圖編號 S/I-DB/5  
提出的申述個案編號 R 1 至 R 5 0 作出考慮  
CONSIDERATION OF REPRESENTATIONS No. R1 TO R50  
TO THE DRAFT DISCOVERY BAY OUTLINE ZONING PLAN No. S/I-DB/5

規劃署  
PLANNING  
DEPARTMENT



參考編號  
REFERENCE No.  
R/S/I-DB/5-1 to 50

圖 PLAN  
H-3i



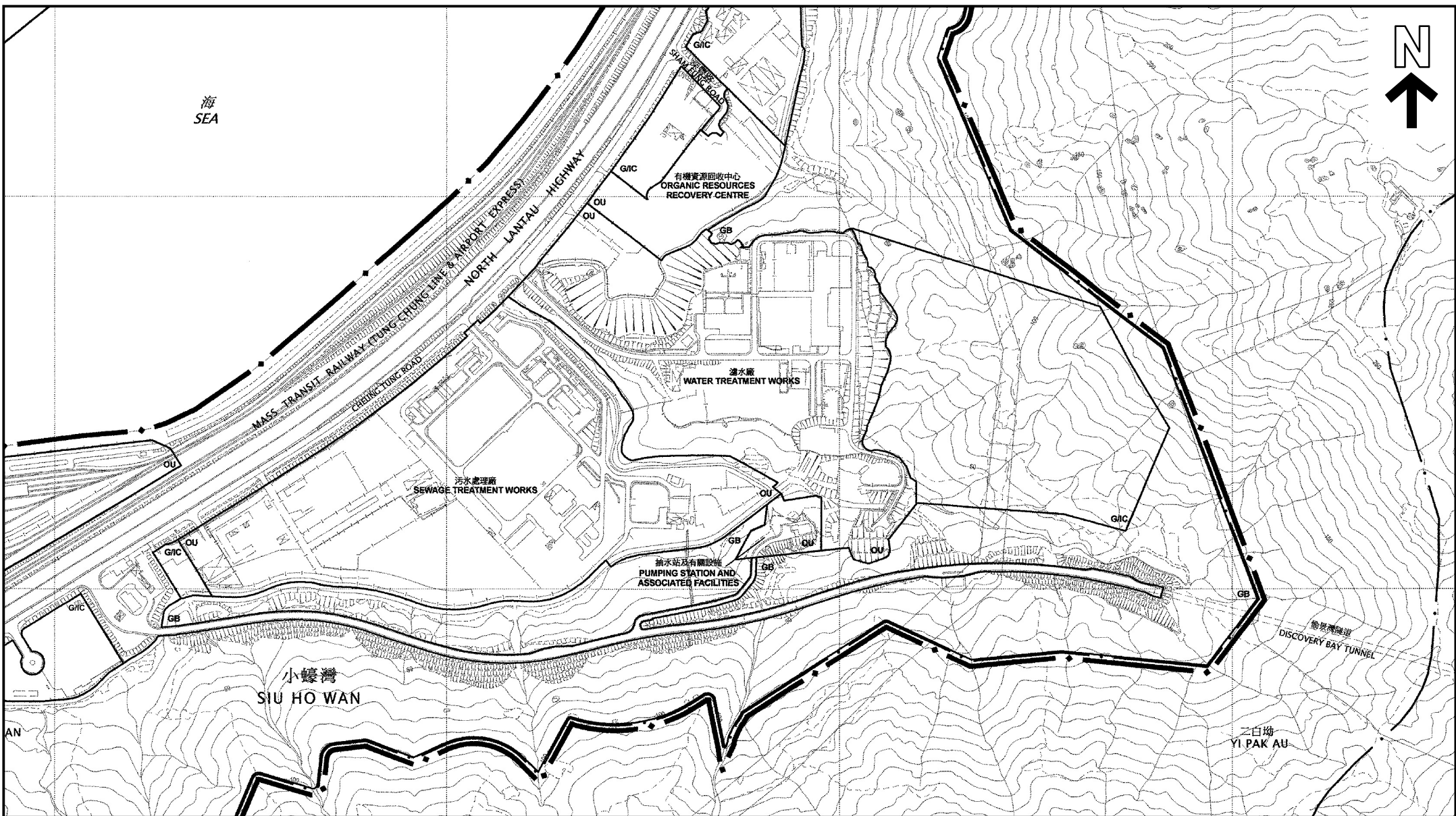

申述地點位置圖 LOCATION PLAN OF REPRESENTATION SITES

申述個案編號 R 2 5 建議的巴士維修車廠、巴士停泊處及廢物管理設施替代選址  
ALTERNATIVE LOCATION FOR BUS MAINTENANCE DEPOT, BUS PARKING AND  
WASTE MANAGEMENT FACILITIES PROPOSED BY R25

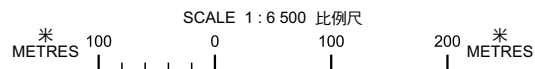

本摘要圖於2024年9月4日擬備，  
所根據的資料為於2019年2月12日  
核准的分區計劃大綱圖編號S/I-SHW/2

EXTRACT PLAN PREPARED ON 4.9.2024  
BASED ON OUTLINE ZONING PLAN  
No. S/I-SHW/2 APPROVED ON 12.2.2019

規劃署  
PLANNING  
DEPARTMENT



參考編號  
REFERENCE No.  
R/S/I-DB/5-1 to 50

圖 PLAN  
H-4