

地段索引圖 LOT INDEX PLAN

摘要說明：本地段索引圖在其背景的地形圖上標示了各種永久和短期持有的土地的地圖界線。這些土地包括私人地段、政府土地、短期租約的地、以及其他作核准用途的土地。請注意：(1)本索引圖上的資料會不時更新而不作事先通知；(2)索引圖的更新或會延後於有關資料的實際變更；以及(3)本索引圖中顯示的界線僅供識別之用，資料是否準確可靠，應徵詢專業土地測量師的意見。
免責說明：如因使用本地段索引圖，或因所依據的本索引圖資料出錯、遺漏、過時或有誤差而引致任何損失或損害，政府概不承擔任何法律責任。

Explanatory notes: This plan shows the graphical boundaries of different kinds of permanent and temporary land holdings with the topographic map in the backdrop. The land holdings as shown may include private lots, government land allocations, short term tenancies and other permitted uses of land. It must be noted that: (1) the information shown on this plan is subject to update without prior notification; (2) there may be time lag between an update and the related changes taken place; and (3) the graphical boundaries as shown are for identification purpose only and interpretation of their accuracy and reliability requires the advice from professional land surveyor.
Disclaimer: The Government shall not be responsible for any loss or damage howsoever arising from the use of this plan or in reliance upon its correctness, completeness, timeliness or accuracy.



地政總署測繪處
Survey and Mapping Office
Lands Department

香港特別行政區政府 — 版權所有
© Copyright reserved — Hong Kong SAR Government

比例尺 SCALE 1:1000
metres 10 0 10 20 30 40 50 metres

Locality :
Lot Index Plan No. : ags_S00000135397_0001
District Survey Office : Lands Information Center
Date : 15-Nov-2024
Reference No. : 6-NW-1C

For Identification Only

(摘錄自申請人於 22. 1. 2025 呈交的補充資料)
(Extract from Applicant's Supplementary
Information Submitted on 22.1.2025)

參考編號
REFERENCE No.
AYL-HTF/1185

繪圖 DRAWING
A-1

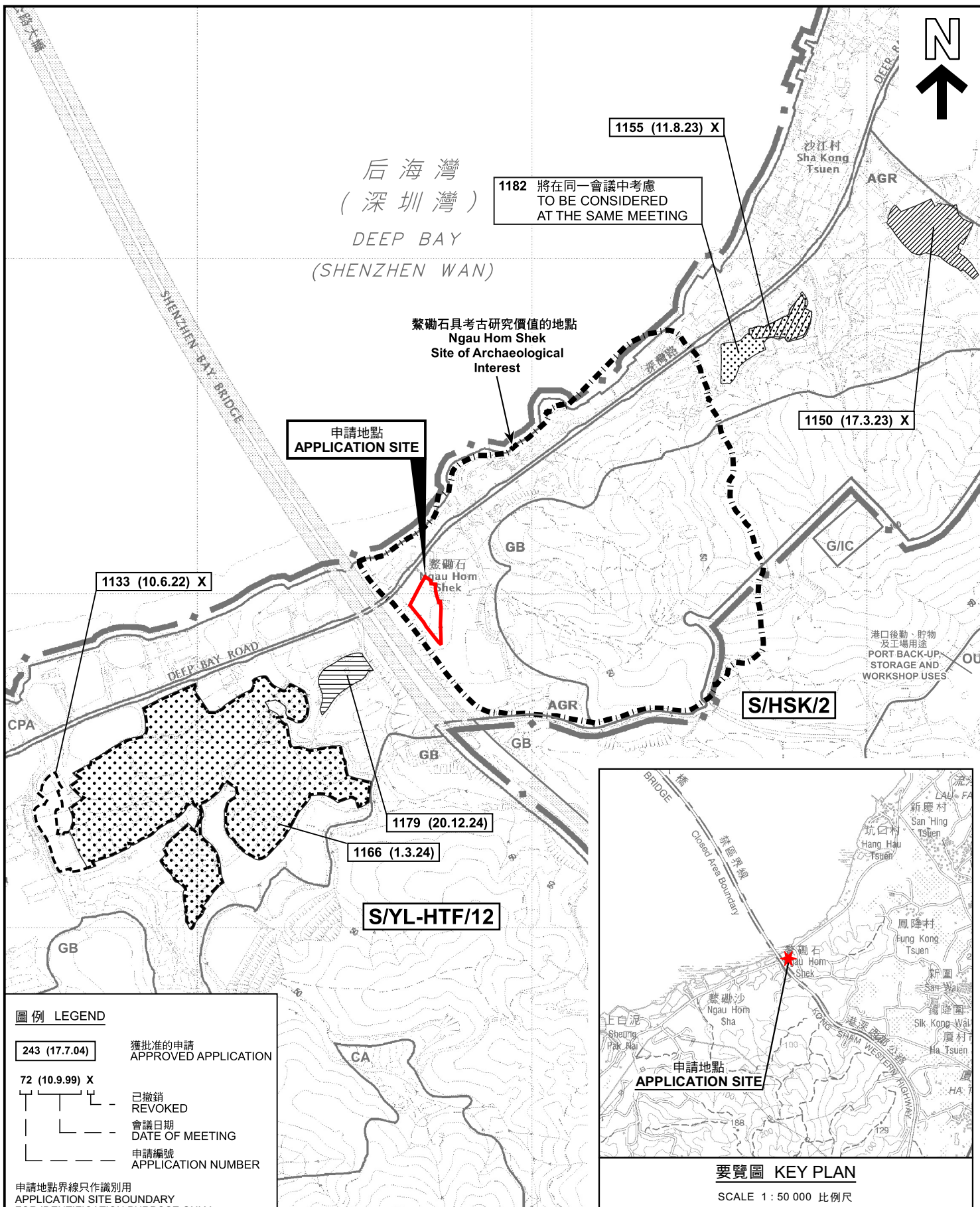

<p>本摘要圖於2025年5月6日擬備， 所根據的資料為於2018年10月16日 核准的分區計劃大綱圖編號 S/YL-HTF/12 EXTRACT PLAN PREPARED ON 6.5.2025 BASED ON OUTLINE ZONING PLAN No. S/YL-HTF/12 APPROVED ON 16.10.2018</p>	<p>位置圖及同類申請 LOCATION PLAN WITH SIMILAR APPLICATIONS</p> <p>擬議臨時露天存放建築物物料連附屬辦公室(為期3年)及相關填土工程 PROPOSED TEMPORARY OPEN STORAGE OF CONSTRUCTION MATERIALS WITH ANCILLARY SITE OFFICE FOR A PERIOD OF 3 YEARS AND ASSOCIATED FILLING OF LAND LOTS 368 RP AND 375 RP IN D.D.128 AND ADJOINING GOVERNMENT LAND, NGAU HOM SHEK, YUEN LONG, NEW TERRITORIES SCALE 1 : 7 500 比例尺</p> <p>米 100 0 100 200 300 米 METRES</p>	<p>規劃署 PLANNING DEPARTMENT</p> <p>參考編號 REFERENCE No. A/YL-HTF/1185</p> <p>圖 PLAN A-1a</p>
---	--	---

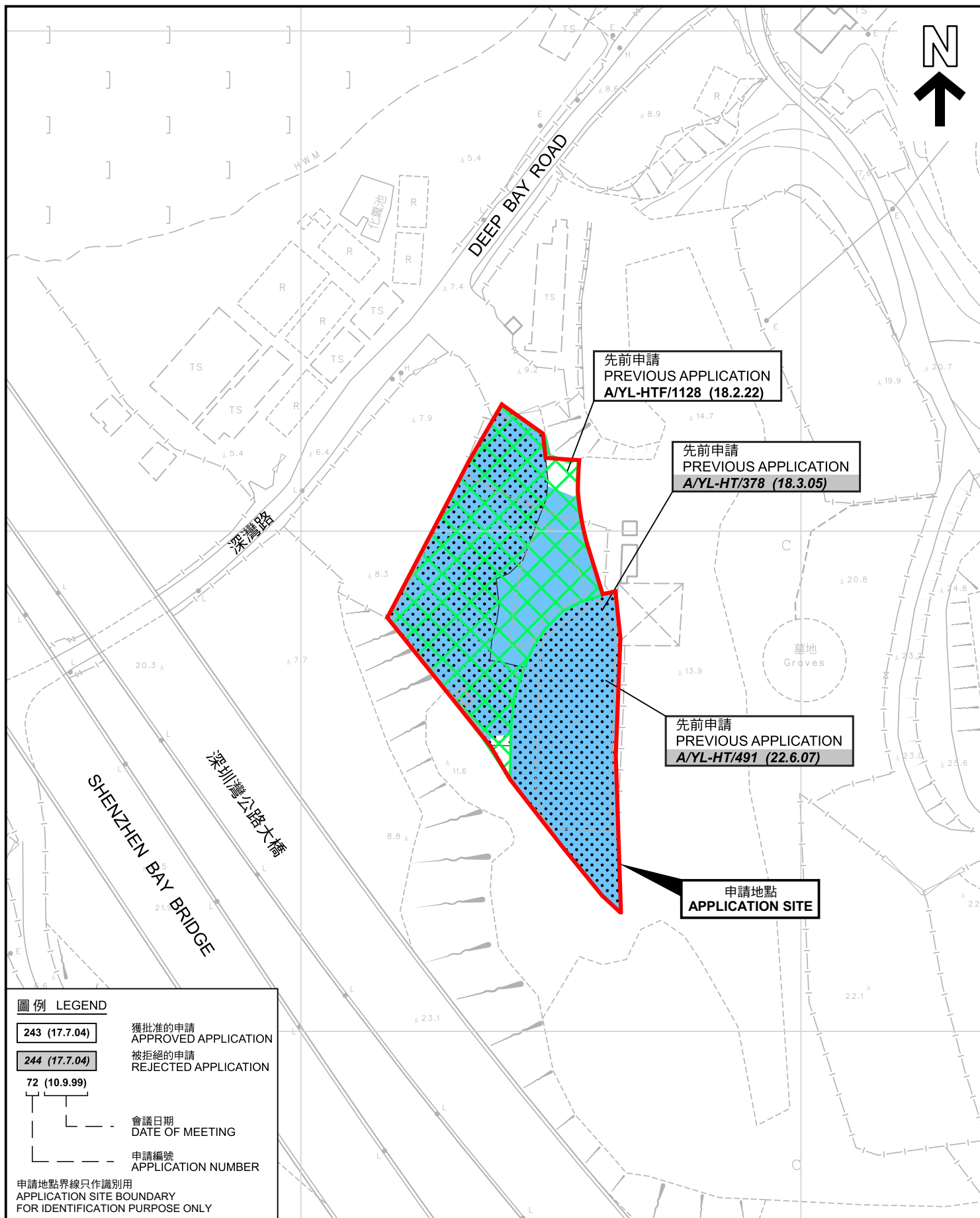

圖例 LEGEND

243 (17.7.04)

獲批准的申請
APPROVED APPLICATION

244 (17.7.04)

被拒絕的申請
REJECTED APPLICATION

72 (10.9.99)

會議日期
DATE OF MEETING

申請編號
APPLICATION NUMBER

申請地點界線只作識別用
APPLICATION SITE BOUNDARY
FOR IDENTIFICATION PURPOSE ONLY

先前申請圖 PREVIOUS APPLICATIONS PLAN

擬議臨時露天存放建築物物料連附屬辦公室(為期3年)及相關填土工程
PROPOSED TEMPORARY OPEN STORAGE OF CONSTRUCTION MATERIALS
WITH ANCILLARY SITE OFFICE FOR A PERIOD OF 3 YEARS
AND ASSOCIATED FILLING OF LAND
LOTS 368 RP AND 375 RP IN D.D.128 AND ADJOINING GOVERNMENT LAND, NGAU
HOM SHEK, YUEN LONG, NEW TERRITORIES

SCALE 1 : 1 000 比例尺

米 20 0 20 40 米
METRES

規劃署
PLANNING
DEPARTMENT



參考編號
REFERENCE No.
A/YL-HTF/1185

圖 PLAN
A-1b

本摘要圖於2025年5月6日擬備，所根據的
資料為測量圖編號 6-NW-1C
EXTRACT PLAN PREPARED ON 6.5.2025
BASED ON SURVEY SHEET No.
6-NW-1C

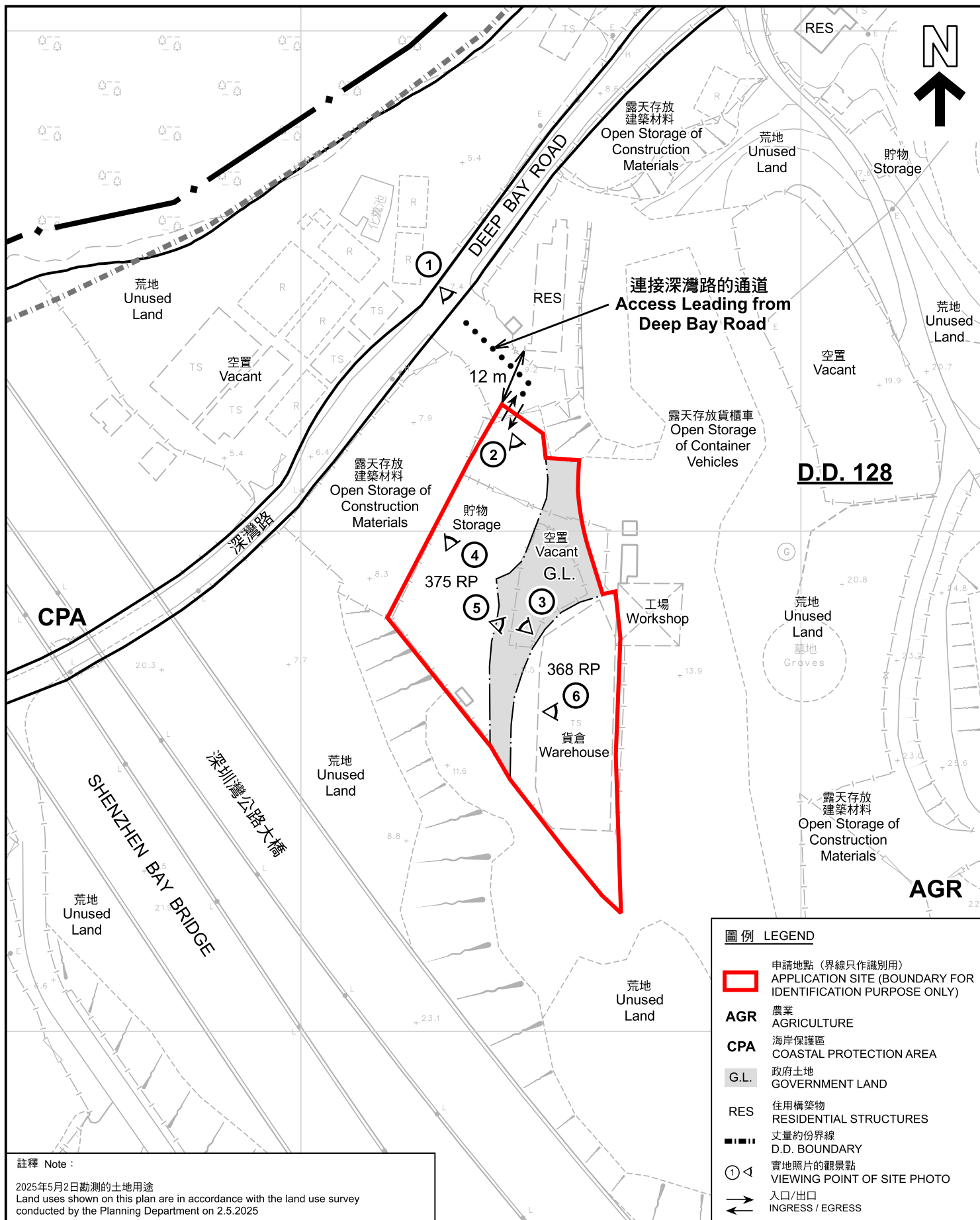

註釋 Note :
2025年5月2日勘測的土地用途
Land uses shown on this plan are in accordance with the land use survey
conducted by the Planning Department on 2.5.2025

本摘要圖於2025年5月6日擬備，所根據的
資料為測量圖編號 6-NW-1C
EXTRACT PLAN PREPARED ON 6.5.2025
BASED ON SURVEY SHEET No.
6-NW-1C

平面圖 SITE PLAN
擬議臨時露天存放建築物料連附屬辦公室(為期3年)及相關填土工程
新界元朗繁磡石丈量約份第128約地段第368號餘段及第375號餘段和毗連政府土地
PROPOSED TEMPORARY OPEN STORAGE OF CONSTRUCTION MATERIALS
WITH ANCILLARY SITE OFFICE FOR A PERIOD OF 3 YEARS
AND ASSOCIATED FILLING OF LAND
LOTS 368 RP AND 375 RP IN D.D.128 AND ADJOINING GOVERNMENT LAND,
NGAU HOM SHEK, YUEN LONG, NEW TERRITORIES

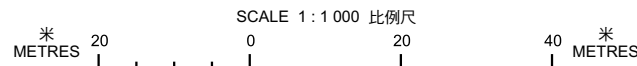

圖例 LEGEND	
	申請地點 (界線只作識別用) APPLICATION SITE (BOUNDARY FOR IDENTIFICATION PURPOSE ONLY)
AGR	農業 AGRICULTURE
CPA	海岸保護區 COASTAL PROTECTION AREA
G.L.	政府土地 GOVERNMENT LAND
RES	住用構築物 RESIDENTIAL STRUCTURES
	丈量約份界線 D.D. BOUNDARY
	實地照片的觀景點 VIEWING POINT OF SITE PHOTO
	入口/出口 INGRESS / EGRESS

規劃署 PLANNING DEPARTMENT		
參考編號 REFERENCE No.	圖 PLAN	
A/YL-HTF/1185	A-2	

后海灣
(深圳灣)
DEEP BAY
(SHENZHEN WAN)



DEEP BAY ROAD

鰲磡石
Ngau Hom
Shek

深灣路

連接深灣路的通道
Access Leading from
Deep Bay Road

深圳灣公路大橋

SHENZHEN BAY BRIDGE

圖例 LEGEND

 申請地點(界線只作識別用)
APPLICATION SITE
(BOUNDARY FOR IDENTIFICATION
PURPOSE ONLY)

本摘要圖於2025年3月6日擬備，所根據
的資料為地政總署於2024年3月17日拍得
的航攝照片編號 E219293C
EXTRACT PLAN PREPARED ON 6.3.2025
BASED ON AERIAL PHOTO No.
E219293C TAKEN ON 17.3.2024
BY LANDS DEPARTMENT

航攝照片 AERIAL PHOTO

擬議臨時露天存放建築物料連附屬辦公室(為期3年)及相關填土工程
新界元朗鰲磡石丈量約份第128約地段第375號餘段和毗連政府土地
PROPOSED TEMPORARY OPEN STORAGE OF CONSTRUCTION MATERIALS
WITH ANCILLARY SITE OFFICE FOR A PERIOD OF 3 YEARS
AND ASSOCIATED FILLING OF LAND
LOTS 368 RP AND 375 RP IN D.D.128 AND ADJOINING GOVERNMENT LAND,
NGAU HOM SHEK, YUEN LONG, NEW TERRITORIES

規劃署
PLANNING
DEPARTMENT



參考編號
REFERENCE No.
A/YL-HTF/1185

圖 PLAN
A-3



申請地點界線只作識別用 APPLICATION SITE BOUNDARY FOR IDENTIFICATION PURPOSE ONLY

實地照片 SITE PHOTOS

本圖於2025年5月8日擬備，所根據的資料為攝於2025年5月2日的實地照片
PLAN PREPARED ON 8.5.2025
BASED ON SITE PHOTOS
TAKEN ON 2.5.2025

擬議臨時露天存放建築物料連附屬辦公室(為期3年)及相關填土工程
新界元朗鰲磡石丈量約份第128約地段第375號餘段和毗連政府土地
PROPOSED TEMPORARY OPEN STORAGE OF CONSTRUCTION MATERIALS
WITH ANCILLARY SITE OFFICE FOR A PERIOD OF 3 YEARS
AND ASSOCIATED FILLING OF LAND
LOTS 368 RP AND 375 RP IN D.D.128 AND ADJOINING GOVERNMENT LAND,
NGAU HOM SHEK, YUEN LONG, NEW TERRITORIES

規劃署
PLANNING
DEPARTMENT



參考編號
REFERENCE No.
A/YL-HTF/1185

圖 PLAN
A-4a



實地照片 SITE PHOTOS

擬議臨時露天存放建築物料連附屬辦公室(為期3年)及相關填土工程
 新界元朗鰲石丈量約份第128約地段第375號餘段和毗連政府土地
 PROPOSED TEMPORARY OPEN STORAGE OF CONSTRUCTION MATERIALS
 WITH ANCILLARY SITE OFFICE FOR A PERIOD OF 3 YEARS
 AND ASSOCIATED FILLING OF LAND
 LOTS 368 RP AND 375 RP IN D.D.128 AND ADJOINING GOVERNMENT LAND,
 NGAU HOM SHEK, YUEN LONG, NEW TERRITORIES

規劃署
 PLANNING
 DEPARTMENT



參考編號
 REFERENCE No.
 A/YL-HTF/1185

圖 PLAN
 A-4b

本圖於2025年5月7日擬備，所根據的
 資料為攝於2025年5月2日的實地照片
 PLAN PREPARED ON 7.5.2025
 BASED ON SITE PHOTOS
 TAKEN ON 2.5.2025