

**Approved Scheme:**

**1/F (Library Wing & Chapel Wing)**

Residential Clubhouse  
Interpretation Area (22m<sup>2</sup> x 2 = 44m<sup>2</sup>)

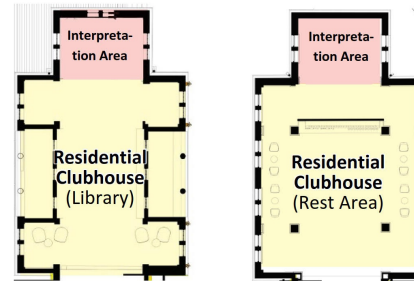

**Opportunities:**

- A few display panels
- A small physical model
- Spending majority of time of the 60-min guided tour at the forecourt

**Proposed Scheme:**

**G/F (Chapel Wing)**



**1/F (Chapel Wing)**



**G/F (Chapel Wing)**

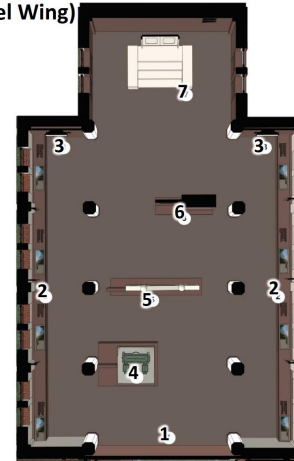

**1/F (Chapel Wing)**

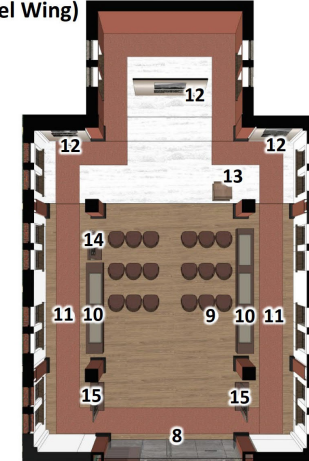

Heritage Gallery (298m<sup>2</sup>)

**Opportunities:**

1. Heritage gallery entrance (G/F)
2. Half Height display cases on Maryknoll's architectural history (left) and religious roots (right)
3. Video display
4. Scaled physical model
5. Salvaged staircase parapet
6. Salvaged floor tile samples
7. Salvaged entrance porch

8. Heritage gallery entrance (1/F)
9. Seating
10. Display cases
11. Visitor route
12. Information panel
13. Podium
14. Salvaged clear glass windows
15. Salvaged stained glass windows











申請地點界線只作識別用  
APPLICATION SITE BOUNDARY  
FOR IDENTIFICATION PURPOSE ONLY

### 航攝照片 AERIAL PHOTO

本摘要圖於2025年6月30日擬備，所根據的資料為地政總署於2024年8月7日拍得的航攝照片編號E227562C

EXTRACT PLAN PREPARED ON  
30.6.2025 BASED ON AERIAL PHOTO No.  
E227562C TAKEN ON 7.8.2024 BY  
LANDS DEPARTMENT

擬議寓保育於住宅發展，並放寬地積比率、建築物高度限制及上蓋面積限制  
香港赤柱赤柱村道44號  
PROPOSED PRESERVATION-CUM-RESIDENTIAL DEVELOPMENT WITH  
MINOR RELAXATION OF PLOT RATIO, BUILDING HEIGHT AND  
SITE COVERAGE RESTRICTIONS  
44 STANLEY VILLAGE ROAD, STANLEY, HONG KONG

規劃署  
PLANNING  
DEPARTMENT



參考編號  
REFERENCE No.  
A/H19/87

圖 PLAN  
FA - 3



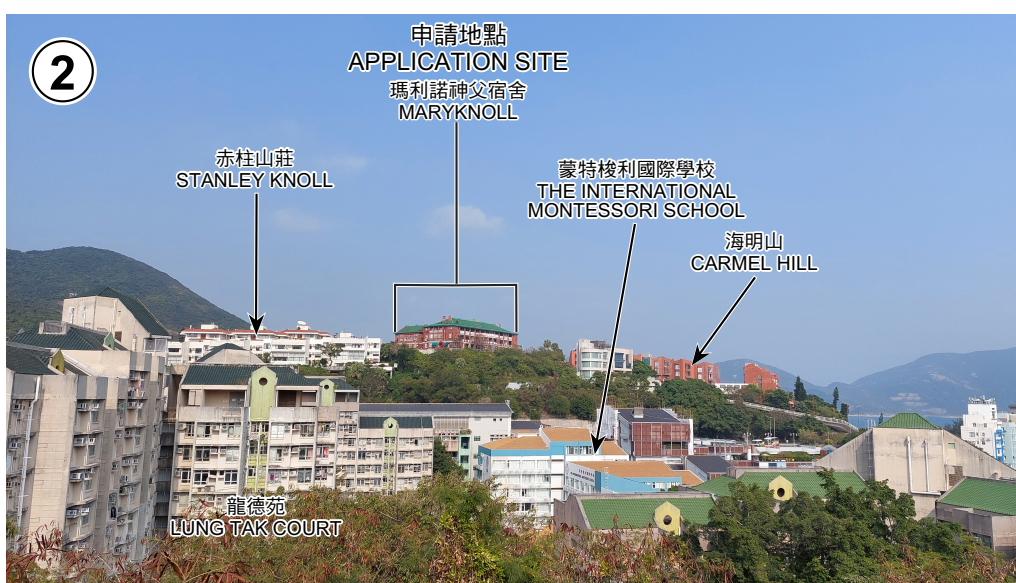

# 實地照片 SITE PHOTOS

本圖於2025年6月30日擬備，所根據的資料為攝於2025年2月18日的實地照片  
PLAN PREPARED ON 30.6.2025  
BASED ON SITE PHOTOS  
TAKEN ON 18.2.2025

擬議寓保育於住宅發展，並放寬地積比率、建築物高度限制及上蓋面積限制  
香港赤柱赤柱村道44號  
PROPOSED PRESERVATION-CUM-RESIDENTIAL DEVELOPMENT WITH  
MINOR RELAXATION OF PLOT RATIO, BUILDING HEIGHT AND  
SITE COVERAGE RESTRICTIONS  
44 STANLEY VILLAGE ROAD, STANLEY, HONG KONG

規劃署  
PLANNING  
DEPARTMENT



參考編號  
REFERENCE No.  
A/H19/87

圖 PLAN  
FA - 4





申請地點界線只作識別用  
APPLICATION SITE BOUNDARY FOR IDENTIFICATION PURPOSE ONLY

### 實地照片 SITE PHOTOS

本圖於2025年6月30日擬備，所根據的資料為攝於2025年2月18日的實地照片  
PLAN PREPARED ON 30.6.2025  
BASED ON SITE PHOTOS  
TAKEN ON 18.2.2025

擬議寓保育於住宅發展，並放寬地積比率、建築物高度限制及上蓋面積限制  
香港赤柱赤柱村道44號  
PROPOSED PRESERVATION-CUM-RESIDENTIAL DEVELOPMENT WITH  
MINOR RELAXATION OF PLOT RATIO, BUILDING HEIGHT AND  
SITE COVERAGE RESTRICTIONS  
44 STANLEY VILLAGE ROAD, STANLEY, HONG KONG

規劃署  
PLANNING  
DEPARTMENT



參考編號  
REFERENCE No.  
A/H19/87

圖 PLAN  
FA - 5





申請地點界線只作識別用  
APPLICATION SITE BOUNDARY FOR IDENTIFICATION PURPOSE ONLY

## 實地照片 SITE PHOTOS

本圖於2025年6月30日擬備，所根據的資料為攝於2025年2月18日的實地照片

PLAN PREPARED ON 30.6.2025  
BASED ON SITE PHOTOS  
TAKEN ON 18.2.2025

擬議寓保育於住宅發展，並放寬地積比率、建築物高度限制及上蓋面積限制  
香港赤柱赤柱村道44號  
PROPOSED PRESERVATION-CUM-RESIDENTIAL DEVELOPMENT WITH  
MINOR RELAXATION OF PLOT RATIO, BUILDING HEIGHT AND  
SITE COVERAGE RESTRICTIONS  
44 STANLEY VILLAGE ROAD, STANLEY, HONG KONG

規劃署  
PLANNING  
DEPARTMENT



參考編號  
REFERENCE No.  
A/H19/87

圖 PLAN  
FA - 6



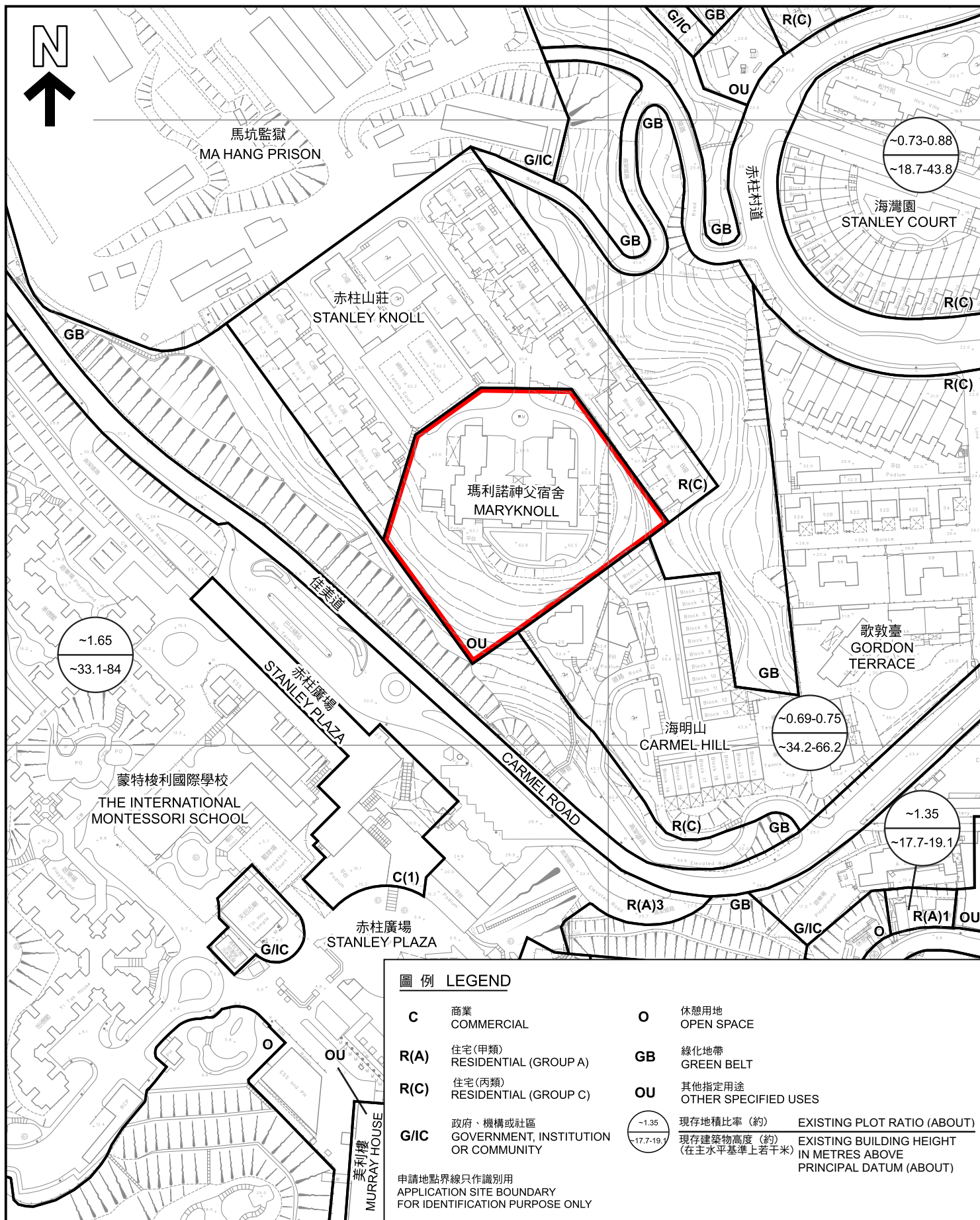

<p>本摘要圖於2025年6月30日擬備， 所根據的資料為測量圖編號 15-NE-12A、B、C及D EXTRACT PLAN PREPARED ON 30.6.2025 BASED ON SURVEY SHEETS No. 15-NE-12A, B, C &amp; D</p>	<p><b>平面圖 SITE PLAN</b></p> <p>擬議寓保育於住宅發展，並放寬地積比率、建築物高度限制及上蓋面積限制 PROPOSED PRESERVATION-CUM-RESIDENTIAL DEVELOPMENT WITH MINOR RELAXATION OF PLOT RATIO, BUILDING HEIGHT AND SITE COVERAGE RESTRICTIONS 44 STANLEY VILLAGE ROAD, STANLEY, HONG KONG</p> <p>SCALE 1:2 000 比例尺</p> <p>米 40 0 40 80 米 METRES</p>	<p><b>規劃署 PLANNING DEPARTMENT</b></p> <p>參考編號 REFERENCE No. A/H19/87</p> <p><b>圖 PLAN FA - 7</b></p>
--	--	--