

DEVELOPMENT PARAMETERS

APPLICATION SITE AREA	: 5,042 m ²	(ABOUT)
COVERED AREA	: 1,728 m ²	(ABOUT)
UNCOVERED AREA	: 4,196 m ²	(ABOUT)
PLOT RATIO	: 0.34	(ABOUT)
SITE COVERAGE	: 34 %	(ABOUT)
NO. OF STRUCTURE	: 8	
DOMESTIC GFA	: NOT APPLICABLE	
NON-DOMESTIC GFA	: 1,728 m ²	(ABOUT)
TOTAL GFA	: 1,728 m ²	(ABOUT)
BUILDING HEIGHT	: 6 m	(ABOUT)
NO. OF STOREY	: 1	

STRUCTURE	USE	COVERED AREA	GROSS FLOOR AREA	BUILDING HEIGHT
B1	WAREHOUSE (EXCLUDING D.G.G.)	225 m ² (ABOUT)	225 m ² (ABOUT)	6 m (ABOUT)(1-STOREY)
B2	WAREHOUSE (EXCLUDING D.G.G.), SITE OFFICE AND WASHROOM	225 m ² (ABOUT)	225 m ² (ABOUT)	6 m (ABOUT)(1-STOREY)
B3	WAREHOUSE (EXCLUDING D.G.G.)	180 m ² (ABOUT)	180 m ² (ABOUT)	6 m (ABOUT)(1-STOREY)
B4	WAREHOUSE (EXCLUDING D.G.G.)	216 m ² (ABOUT)	216 m ² (ABOUT)	6 m (ABOUT)(1-STOREY)
B5	WAREHOUSE (EXCLUDING D.G.G.)	216 m ² (ABOUT)	216 m ² (ABOUT)	6 m (ABOUT)(1-STOREY)
B6	WAREHOUSE (EXCLUDING D.G.G.)	216 m ² (ABOUT)	216 m ² (ABOUT)	6 m (ABOUT)(1-STOREY)
B7	WAREHOUSE (EXCLUDING D.G.G.), SITE OFFICE AND WASHROOM	225 m ² (ABOUT)	225 m ² (ABOUT)	6 m (ABOUT)(1-STOREY)
B8	WAREHOUSE (EXCLUDING D.G.G.)	225 m ² (ABOUT)	225 m ² (ABOUT)	6 m (ABOUT)(1-STOREY)
TOTAL		1,728 m ² (ABOUT)	1,728 m ² (ABOUT)	

*D.G.G. - DANGEROUS GOODS GODOWN

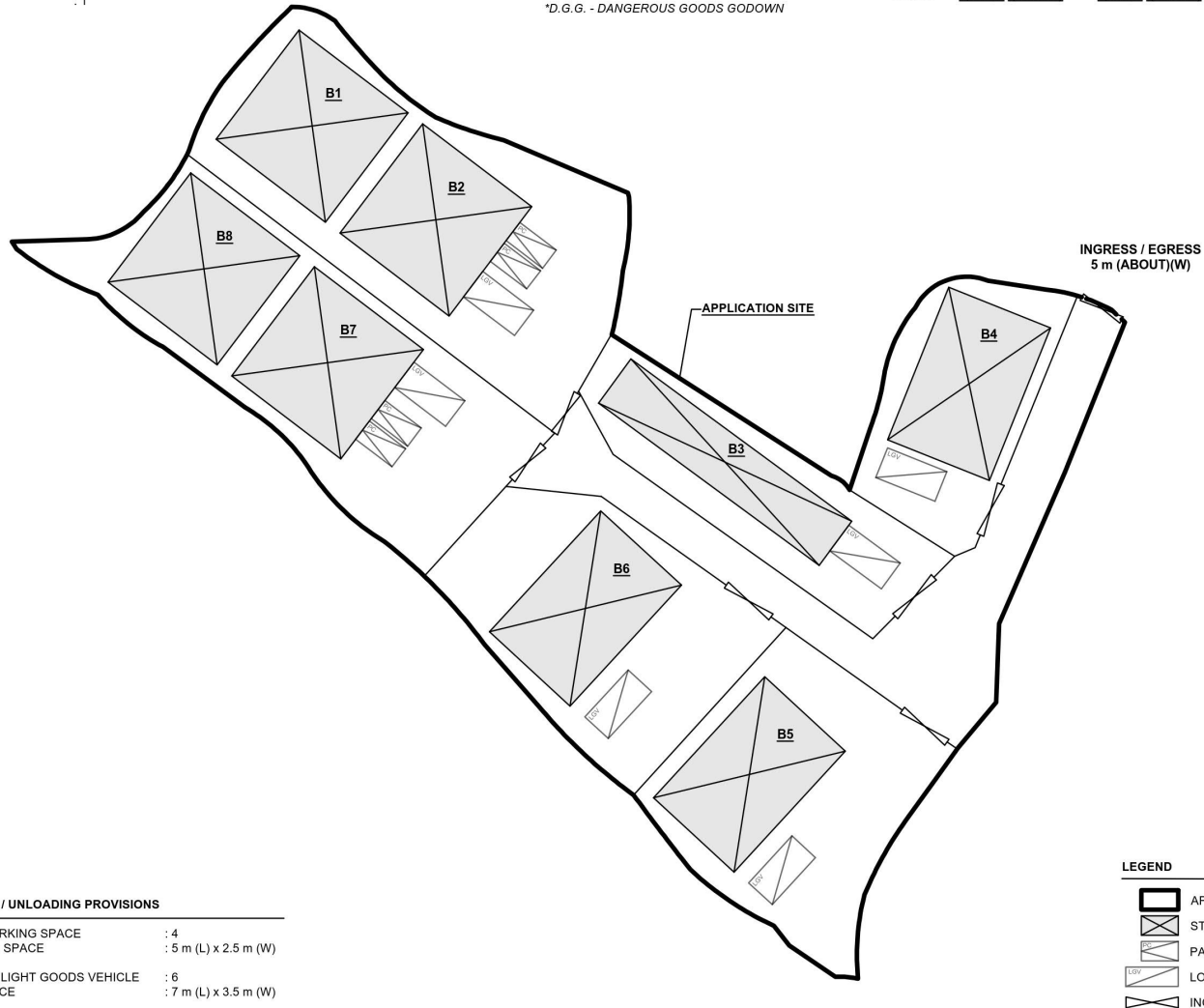

PARKING AND LOADING / UNLOADING PROVISIONS

NO. OF PRIVATE CAR PARKING SPACE	: 4
DIMENSION OF PARKING SPACE	: 5 m (L) x 2.5 m (W)
NO. OF L/L SPACE FOR LIGHT GOODS VEHICLE	: 6
DIMENSION OF L/L SPACE	: 7 m (L) x 3.5 m (W)

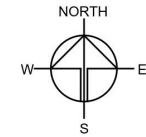

PLANNING CONSULTANT



PROJECT

PROPOSED WAREHOUSE (EXCLUDING DANGEROUS GOODS GODOWN) WITH ANCILLARY FACILITIES AND ASSOCIATED FILLING OF LAND FOR A PERIOD OF 3 YEARS

SITE LOCATION

VARIOUS LOTS IN D.D. 107, KAM TIN, YUEN LONG, NEW TERRITORIES

SCALE

1:700 @ A4

DRAWN BY

DN

DATE

8.7.2025

REVISED BY

DATE

APPROVED BY

DATE

DWG. TITLE

LAYOUT PLAN

DWG NO.

PLAN 4

VER.

004

(摘錄自申請人於 9.7.2025 呈交的進一步資料)
(Extract from Applicant's Further
Information Submitted on 9.7.2025)

參考編號
REFERENCE No.
A/YL-KTN/1126

繪圖
DRAWING
A - 1

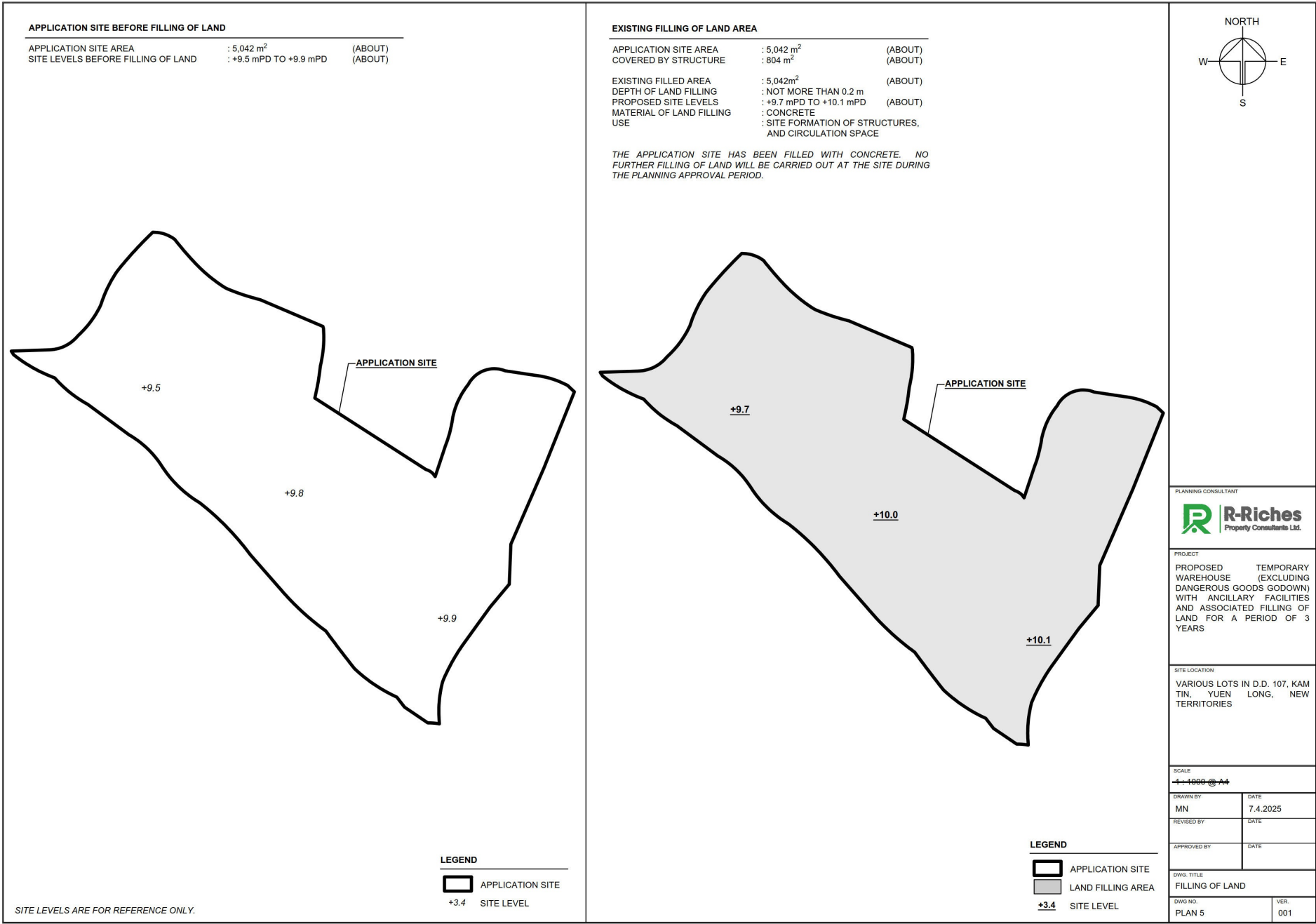

(摘錄自申請人於 3. 6. 2025 呈交的申請書)
(Extract from Applicant's
Submission of 3.6.2025)

參考編號
REFERENCE No.
A/YL-KTN/1126

繪圖
DRAWING
A - 2

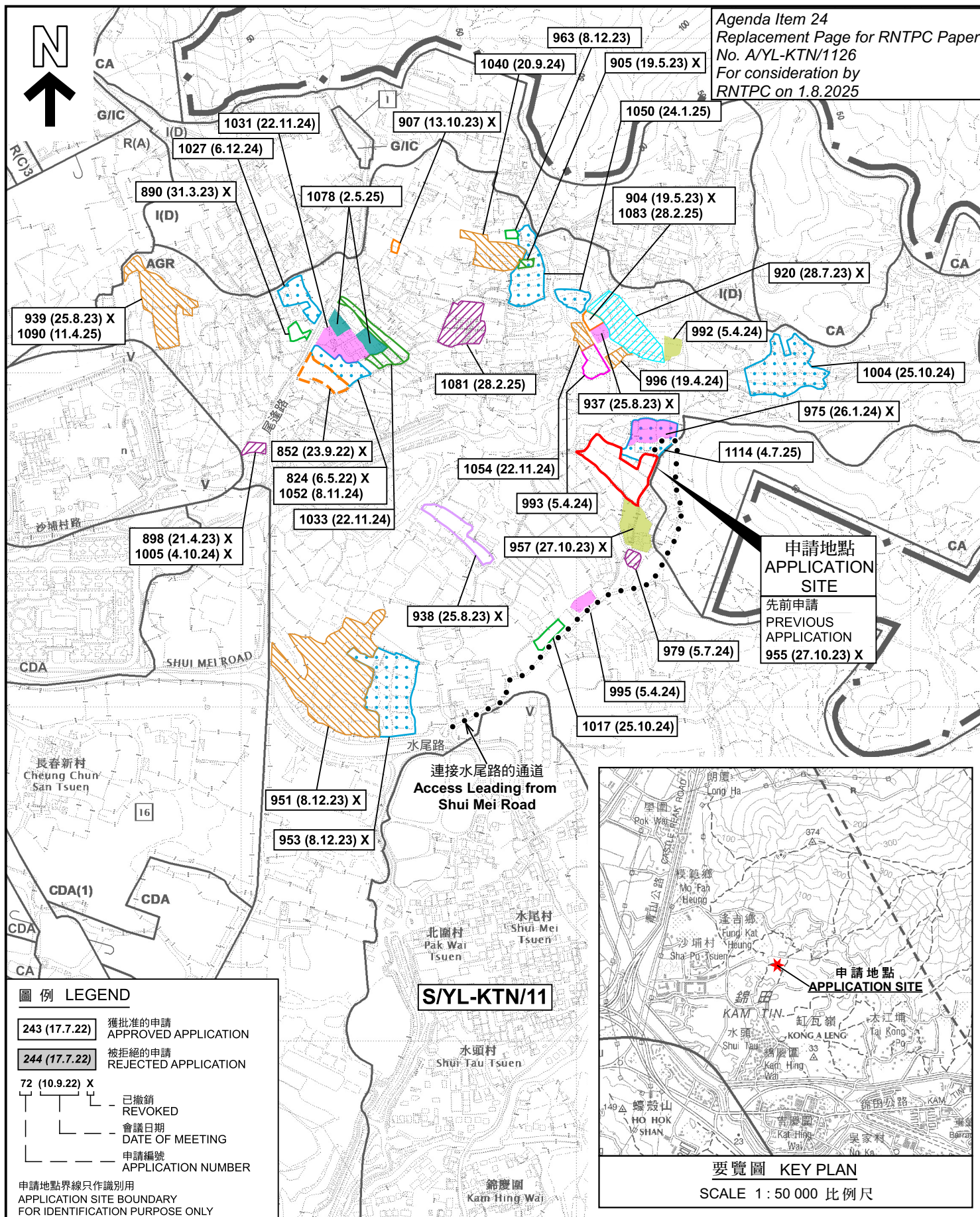
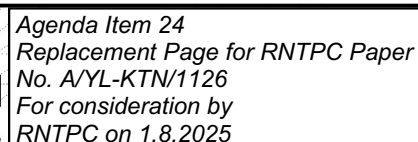

規劃署
PLANNING
DEPARTMENT



本摘要圖於2025年7月30日擬備，
所根據的資料為於2023年12月5日
核准的分區計劃大綱圖編號 S/YL-KTN/11
EXTRACT PLAN PREPARED ON 30.7.2025
BASED ON OUTLINE ZONING PLAN No.
S/YL-KTN/11 APPROVED ON 5.12.2023

擬議臨時貨倉(危險品倉庫除外)連附屬設施和相關的填土工程(為期3年)
 新界元朗錦田丈量約份第107約地段第1408號、第1409號、第1410號、
 第1411號、第1420號(部分)、第1421號(部分)及第1422號(部分)
**PROPOSED TEMPORARY WAREHOUSE (EXCLUDING DANGEROUS
 GOODS GODOWN) WITH ANCILLARY FACILITIES AND ASSOCIATED
 FILLING OF LAND FOR A PERIOD OF 3 YEARS**
 LOTS 1408, 1409, 1410, 1411, 1420 (PART), 1421 (PART) AND
 1422 (PART) IN D.D. 107, KAM TIN, YUEN LONG, NEW TERRITORIES

參考編號
REFERENCE No.
A/YL-KTN/1126

PLAN
A-1

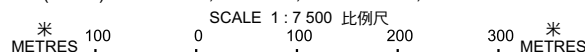

AGR

Agenda Item 24
Replacement Page for RNTPC Paper No. A/YL-KTN/1126
For consideration by RNTPC on 1.8.2025

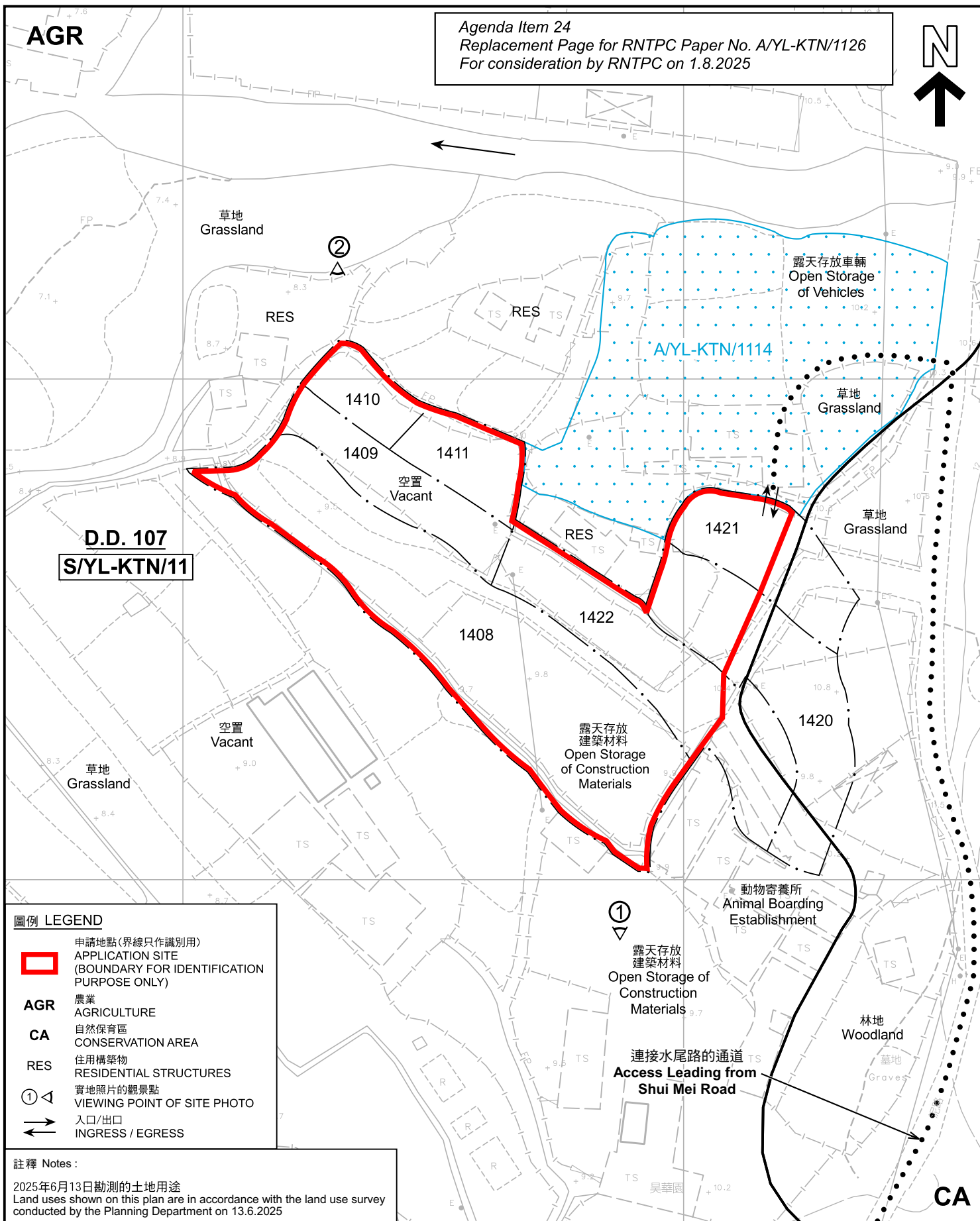

圖例 LEGEND



申請地點(界線只作識別用)
APPLICATION SITE
(BOUNDARY FOR IDENTIFICATION
PURPOSE ONLY)

AGR

農業
AGRICULTURE

CA

自然保育區
CONSERVATION AREA

RES

住用構築物
RESIDENTIAL STRUCTURES



實地照片的觀景點
VIEWING POINT OF SITE PHOTO



入口/出口
INGRESS / EGRESS

註釋 Notes:

2025年6月13日勘測的土地用途
Land uses shown on this plan are in accordance with the land use survey
conducted by the Planning Department on 13.6.2025

平面圖 SITE PLAN

擬議臨時貨倉(危險品倉庫除外)連附屬設施和相關的填土工程(為期3年)
新界元朗錦田丈量約份第107約地段第1408號、第1409號、第1410號、
第1411號、第1420號(部分)、第1421號(部分)及第1422號(部分)
**PROPOSED TEMPORARY WAREHOUSE (EXCLUDING DANGEROUS
GOODS GODOWN) WITH ANCILLARY FACILITIES AND ASSOCIATED
FILLING OF LAND FOR A PERIOD OF 3 YEARS**
LOTS 1408, 1409, 1410, 1411, 1420 (PART), 1421 (PART) AND
1422 (PART) IN D.D. 107, KAM TIN, YUEN LONG, NEW TERRITORIES
SCALE 1:1 000 比例尺

規劃署
PLANNING
DEPARTMENT



參考編號
REFERENCE No.
A/YL-KTN/1126

圖 PLAN
A-2

本摘要圖於2025年7月30日擬備，
所根據的資料為測量圖編號
6-NE-2C 及 7A
EXTRACT PLAN PREPARED ON 30.7.2025
BASED ON SURVEY SHEETS No.
6-NE-2C & 7A

米 20 0 20 40 米
METRES

逢吉鄉
FUNG KAT HEUNG

Agenda Item 24
Replacement Page for RNTPC Paper No. A/YL-KTN/1126
For consideration by RNTPC on 1.8.2025



連接水尾路的通道
Access Leading from
Shui Mei Road

圖例 LEGEND

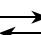
-  申請地點 (界線只作識別用)
APPLICATION SITE (BOUNDARY FOR IDENTIFICATION PURPOSE ONLY)
-  入口/出口
INGRESS / EGRESS

航攝照片 AERIAL PHOTO

本摘要圖於2025年7月30日擬備，
所根據的資料為地政總署於2024年10月24日
拍得的航攝照片編號 E237404C
EXTRACT PLAN PREPARED ON 30.7.2025
BASED ON AERIAL PHOTO No.
E237404C TAKEN ON 24.10.2024
BY LANDS DEPARTMENT

擬議臨時貨倉(危險品倉庫除外)連附屬設施和相關的填土工程(為期3年)
新界元朗錦田丈量約份第107約地段第1408號、第1409號、第1410號、
第1411號、第1420號(部分)、第1421號(部分)及第1422號(部分)
**PROPOSED TEMPORARY WAREHOUSE (EXCLUDING DANGEROUS
GOODS GODOWN) WITH ANCILLARY FACILITIES AND ASSOCIATED
FILLING OF LAND FOR A PERIOD OF 3 YEARS**
LOTS 1408, 1409, 1410, 1411, 1420 (PART), 1421 (PART) AND
1422 (PART) IN D.D. 107, KAM TIN, YUEN LONG, NEW TERRITORIES

規劃署
PLANNING
DEPARTMENT



參考編號
REFERENCE No.
A/YL-KTN/1126

圖 PLAN
A-3

1

Agenda Item 24

Replacement Page for RNTPC Paper No. A/YL-KTN/1126

For consideration by RNTPC on 1.8.2025

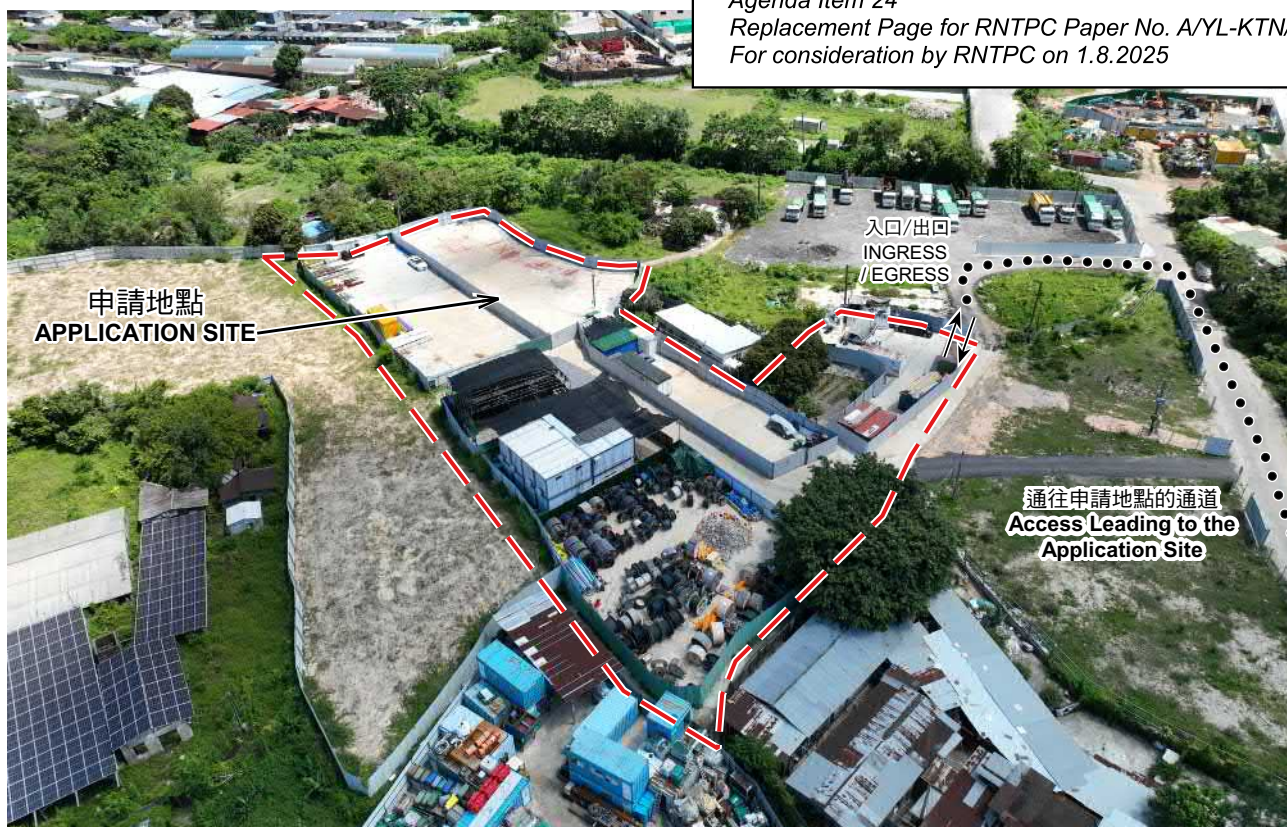

2



申請地點界線只作識別用 APPLICATION SITE BOUNDARY FOR IDENTIFICATION PURPOSE ONLY

實地照片 SITE PHOTOS

本圖於2025年7月30日擬備，所根據的資料為攝於2025年6月10日的實地照片
PLAN PREPARED ON 30.7.2025
BASED ON SITE PHOTOS
TAKEN ON 10.6.2025

擬議臨時貨倉(危險品倉庫除外)連附屬設施和相關的填土工程(為期3年)
新界元朗錦田丈量約份第107約地段第1408號、第1409號、第1410號、
第1411號、第1420號(部分)、第1421號(部分)及第1422號(部分)
**PROPOSED TEMPORARY WAREHOUSE (EXCLUDING DANGEROUS
GOODS GODOWN) WITH ANCILLARY FACILITIES AND ASSOCIATED
FILLING OF LAND FOR A PERIOD OF 3 YEARS**
LOTS 1408, 1409, 1410, 1411, 1420 (PART), 1421 (PART) AND
1422 (PART) IN D.D. 107, KAM TIN, YUEN LONG, NEW TERRITORIES

規劃署
PLANNING
DEPARTMENT



參考編號
REFERENCE No.
A/YL-KTN/1126

圖 PLAN
A-4