





**LEGEND:**

-  ORIGINAL F.R.R. S.C. DOOR BY BUILDING
-  EXISTING FULL HT. APPROVED SOLID WALL/ COLUMN
-  FULL HT. WOODEN PARTITION
-  FULL HT. 2 HRS. F.R.R. BRICK WALL PARTITION
-  FULL HT. DOOR
-  LOW DOOR

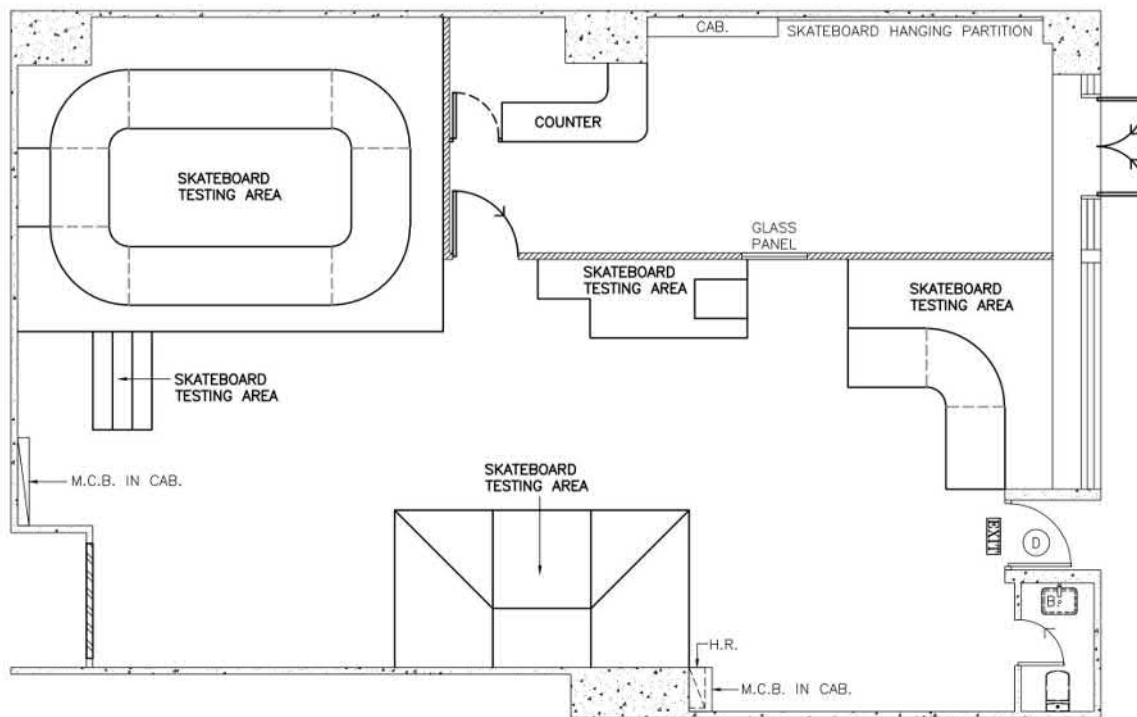

NOTE :

- ALL MEASUREMENT MUST BE CHECKED AT SITE.
- DO NOT SCALE DRAWING.
- DRAWING IS NOT VALID FOR CONSTRUCTION UNLESS EXPRESSEDLY CERTIFIED.
- DRAWING AND COPY-RIGHT ARE PROPERTY OF THE CREATE LICENCE CONSULTANTS LIMITED.

REVISIONS AND ISSUES		
REV	REVISION DESCRIPTION	DATE
A	NEW APPLICATION	21-03-23
B	REVISED PLAN	20-05-23
C	REVISED PLAN	15-08-25
D		
E		
F		
G		



UNIT 3, 20/F., GLOBAL GATEWAY TOWER,  
NO. 63 WING HONG STREET,  
CHEUNG SHA WAN, KOWLOON.  
TEL: 3707 3180 FAX: 3616 3433  
www.q-licence.com.hk  
e-mail: info@q-licence.com.hk

DRAWN	INITIAL	SIGNATURE	DATE
CT			15-08-25
DESIGNED	--		--
CHECKED	--		--
APPROVED	--		--

CLIENT  
-

TITLE	SCALE
LAYOUT PLAN	1:100 A4

PROJECT  
Factory 04, G/F., Topsall Plaza,  
11 On Sum Street, Sha Tin,  
N.T.

FUEL USED:	ELECTRICITY ONLY
FEMD-REF. NO.:	--
SD-REF. NO.:	--
FSD-REF. NO.:	--
VD-REF. NO.:	--
CUSTOMER CODE	QCC-0452
LICENCE TYPE	-
REV.	C
PAGE	1/1
DRAWN NO.:	

參考編號 REFERENCE No. A/ST/1040 繪圖 DRAWING A-1

(來源: 申請人於2025年8月19日呈交的進一步資料內的繪圖)  
(SOURCE: DRAWING IN THE APPLICANT'S SUBMITTED  
FURTHER INFORMATION ON 19.8.2025)

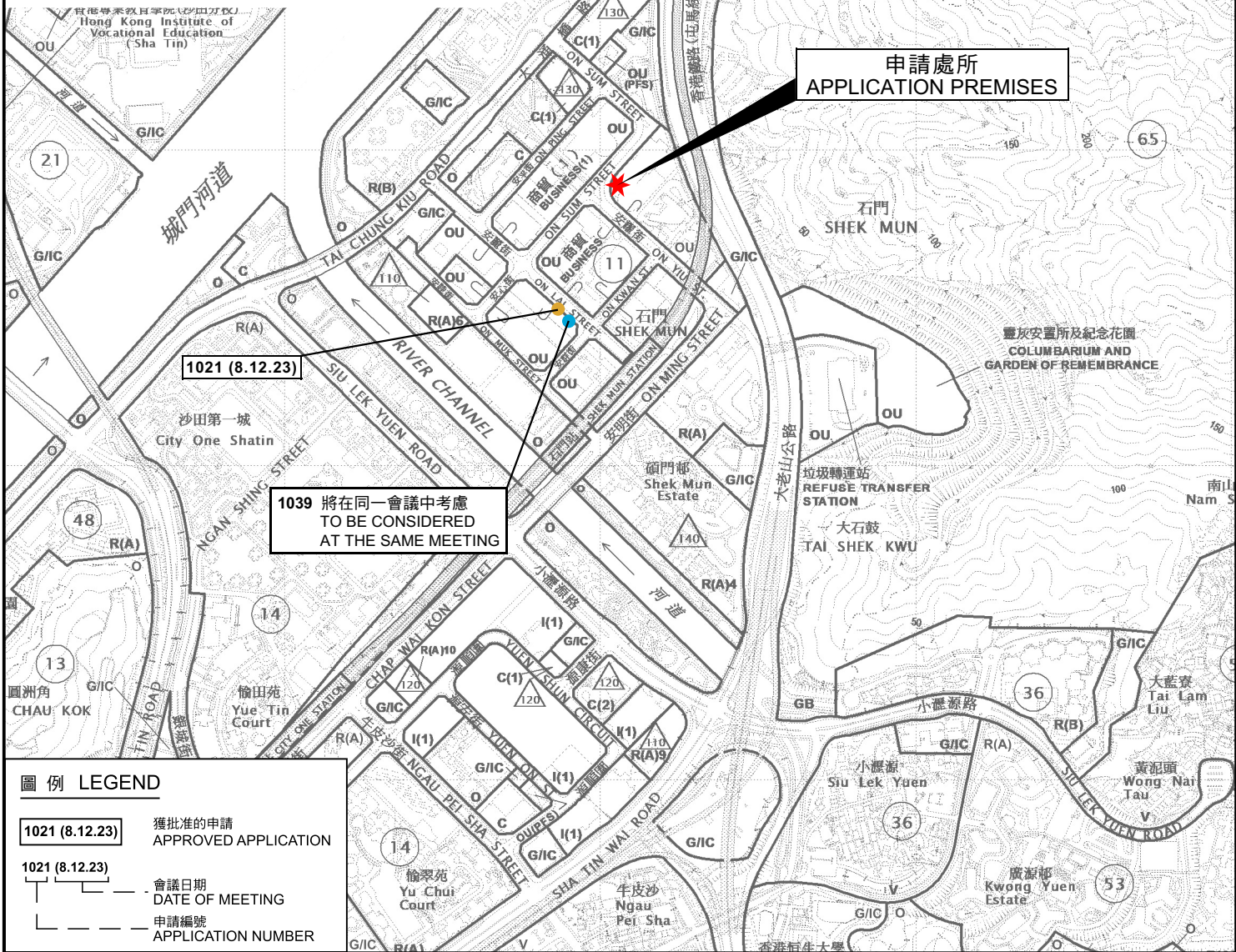
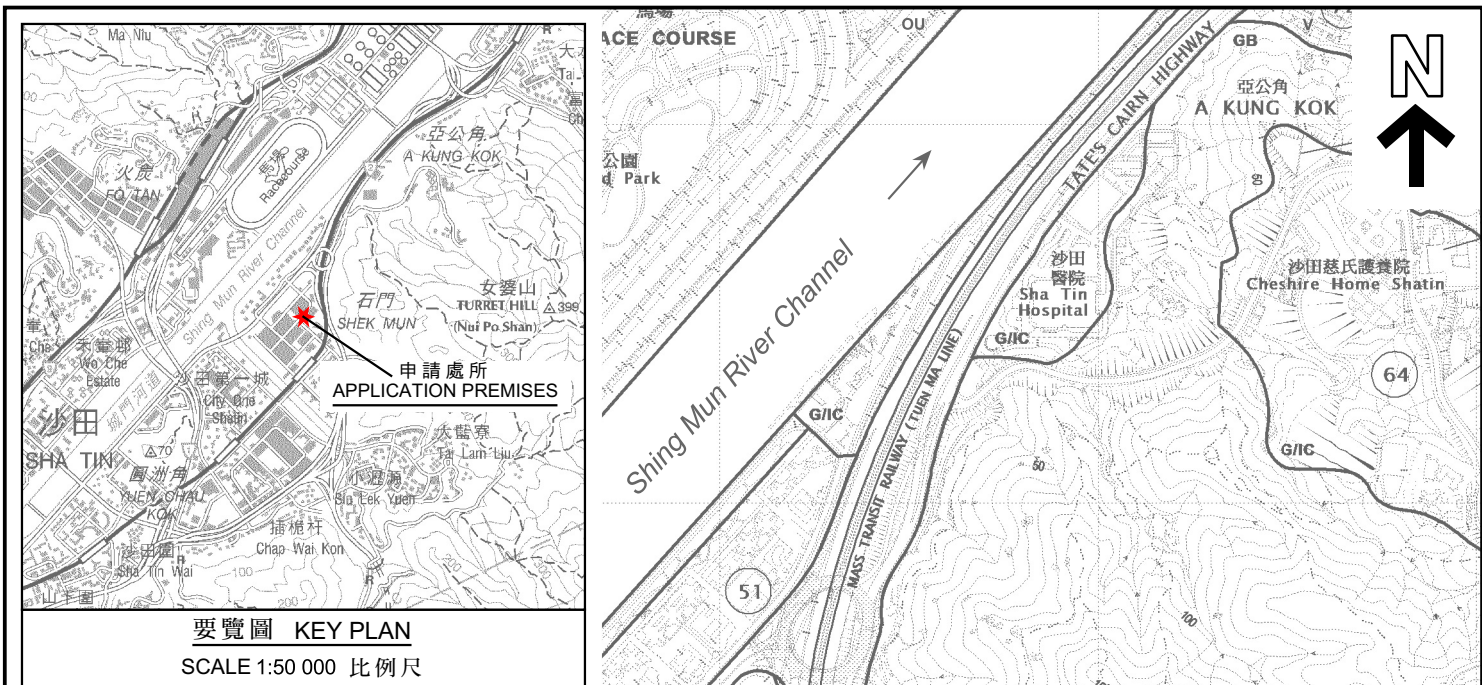

**圖例 LEGEND**

1021 (8.12.23)	獲批准的申請 APPROVED APPLICATION
1021 (8.12.23)	會議日期 DATE OF MEETING
---	申請編號 APPLICATION NUMBER

本摘要圖於2025年8月21日擬備，所根據的資料為於2024年5月28日核准的分區計劃大綱圖編號S/ST/38 EXTRACT PLAN PREPARED ON 21.8.2025 BASED ON OUTLINE ZONING PLAN No. S/ST/38 APPROVED ON 28.5.2024



**規劃署  
PLANNING  
DEPARTMENT**

參考編號  
REFERENCE No.  
**A/ST/1040**

圖 PLAN  
**A-1**



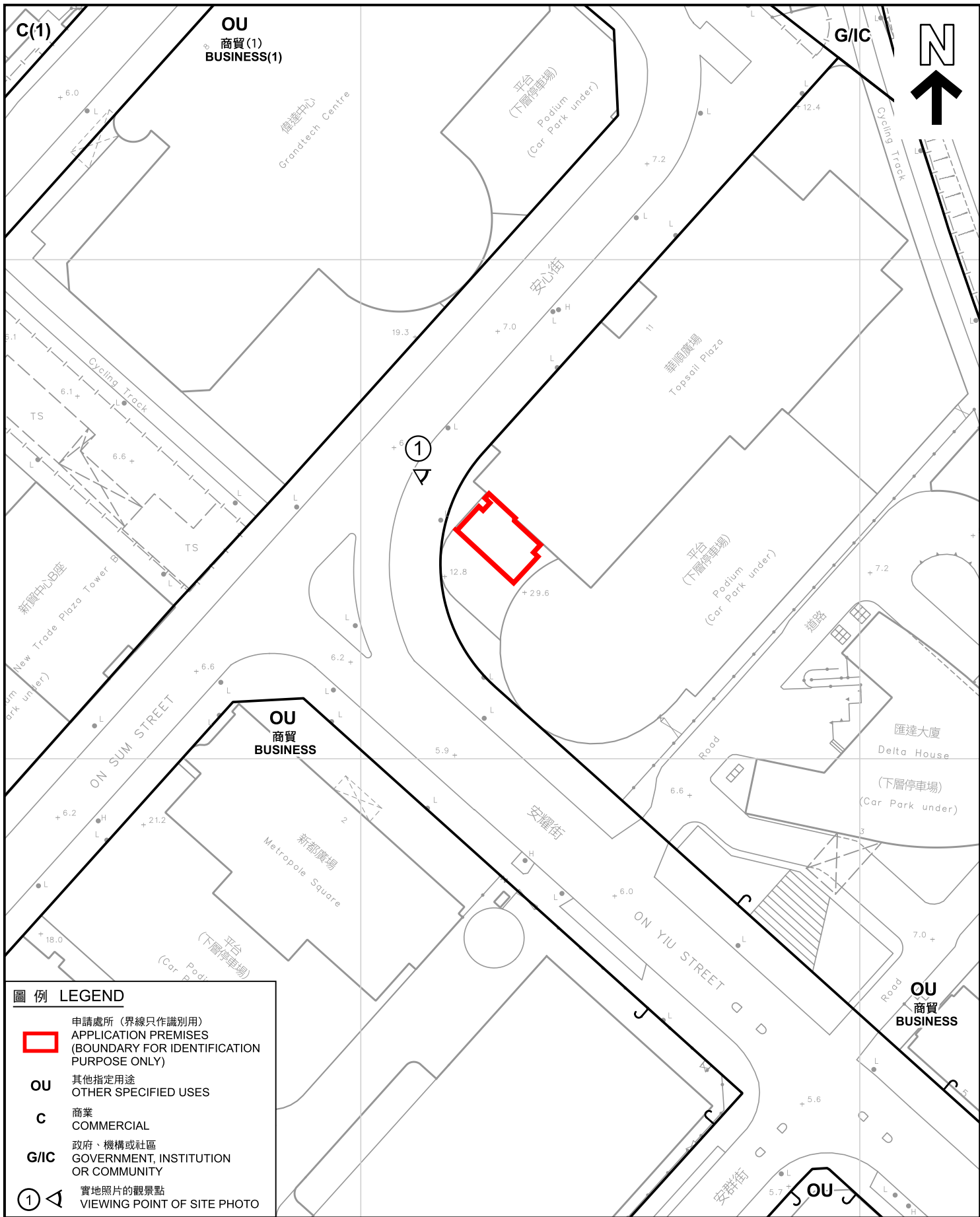

**圖例 LEGEND**

-  申請處所 (界線只作識別用)  
APPLICATION PREMISES  
(BOUNDARY FOR IDENTIFICATION  
PURPOSE ONLY)
- OU** 其他指定用途  
OTHER SPECIFIED USES
- C** 商業  
COMMERCIAL
- G/IC** 政府、機構或社區  
GOVERNMENT, INSTITUTION  
OR COMMUNITY
-  實地照片的觀景點  
VIEWING POINT OF SITE PHOTO

**平面圖 SITE PLAN**

擬議商店及服務行業  
 新界沙田安心街11號華順廣場地下4號室  
 PROPOSED SHOP AND SERVICES  
 UNIT 4, G/F, TOPSAIL PLAZA, 11 ON SUM STREET,  
 SHA TIN, NEW TERRITORIES

本摘要圖於2025年8月13日擬備，  
 所根據的資料為測量圖編號  
 7-SE-7C  
 EXTRACT PLAN PREPARED ON 13.8.2025  
 BASED ON SURVEY SHEET No.  
 7-SE-7C

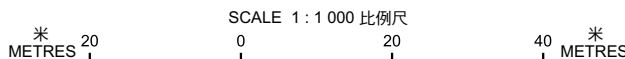

**規劃署**  
**PLANNING**  
**DEPARTMENT**



參考編號  
 REFERENCE No.  
**A/ST/1040**

**圖 PLAN**  
**A-2**

安心街

ON SUM STREET



安耀街  
ON YIU STREET

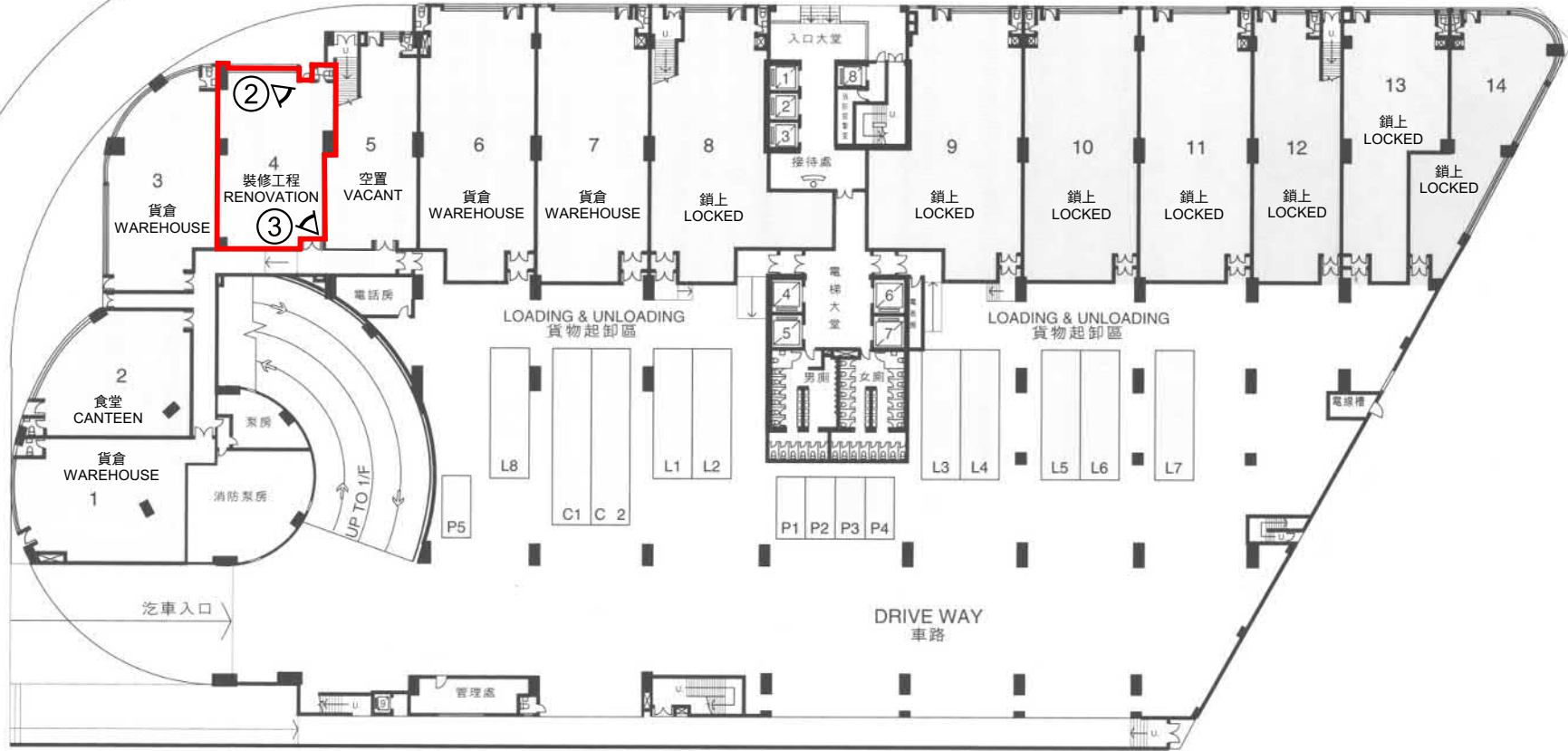

圖例 LEGEND

 申請處所 (界線只作識別用)  
APPLICATION PREMISES  
(BOUNDARY FOR IDENTIFICATION  
PURPOSE ONLY)

 實地照片的觀景點  
VIEWING POINT OF SITE PHOTO

地下平面圖 GROUND FLOOR PLAN

樓面平面圖 FLOOR PLAN

本摘要圖於2025年8月22日擬備，  
所根據的資料為樓宇平面圖  
(調查日期：2025年7月18日)  
EXTRACT PLAN PREPARED ON 22.8.2025  
BASED ON BUILDING FLOOR PLAN  
(DATE OF SURVEY：18.7.2025)

擬議商店及服務行業  
新界沙田安心街11號華順廣場地下4號室  
PROPOSED SHOP AND SERVICES  
UNIT 4, G/F, TOPSAIL PLAZA, 11 ON SUM STREET,  
SHA TIN, NEW TERRITORIES

規劃署  
PLANNING  
DEPARTMENT



參考編號  
REFERENCE No.  
A/ST/1040

圖 PLAN  
A-3



申請處所 APPLICATION PREMISES



申請處所 APPLICATION PREMISES

申請處所界線只作識別用  
APPLICATION PREMISES BOUNDARY FOR IDENTIFICATION PURPOSE ONLY

實地照片 SITE PHOTO

本摘要圖於2025年8月27日擬備，  
所根據的資料為攝於2025年7月18日  
的實地照片  
EXTRACT PLAN PREPARED ON 27.8.2025  
BASED ON SITE PHOTOS  
TAKEN ON 18.7.2025

擬議商店及服務行業  
新界沙田安心街11號華順廣場地下4號室  
PROPOSED SHOP AND SERVICES  
UNIT 4, G/F, TOPSAIL PLAZA, 11 ON SUM STREET,  
SHA TIN, NEW TERRITORIES

規劃署  
PLANNING  
DEPARTMENT



參考編號  
REFERENCE No.  
A/ST/1040

圖 PLAN  
A-4