

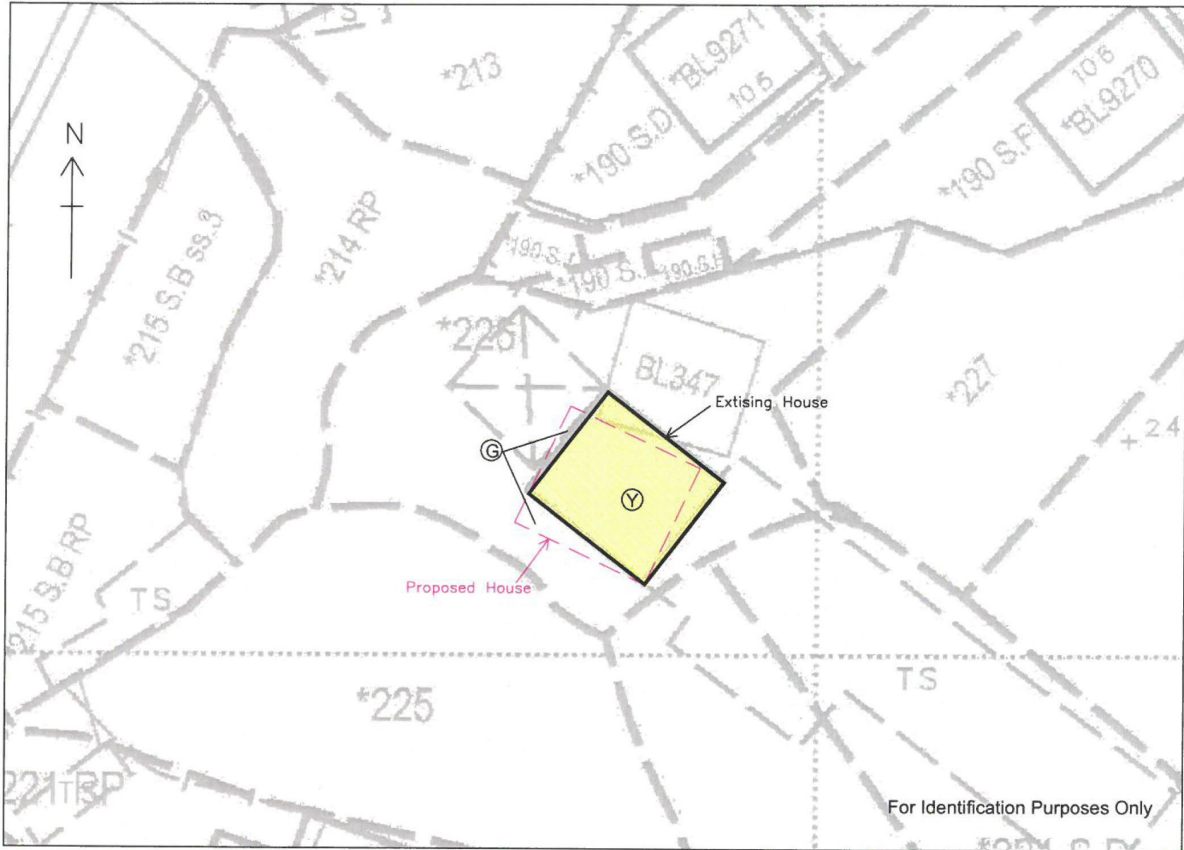



Plan of Lot No. 226 in D.D.111



SCALE 1 : 400

Legend

-  Extising House
-  Proposed House
-  Proposed land filling area
(Coloured Yellow)



Survey District: Yuen Long	Survey Sheet No.: 6-NE-9B
Date: 12-06-2025	Plan No.: YL/4224/D1



Winner Surveying Consultants Co.
O/B CHEUNG KWONG MING DEVELOPMENT LIMITED

(摘錄自申請人於 18.7.2025 提交的進一步資料)
(Extract from Applicant's Further
Information Submitted on 18.7.2025)

參考編號 REFERENCE No. A/YL-PH/1045	繪圖 DRAWING A - 1
---------------------------------------	------------------------

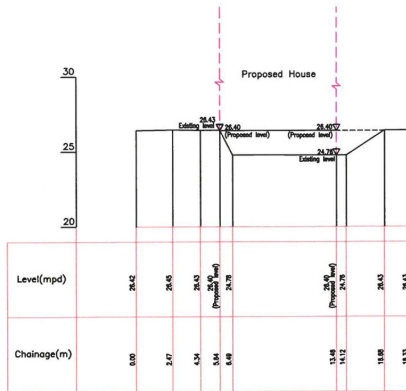

Section A-A
South to North

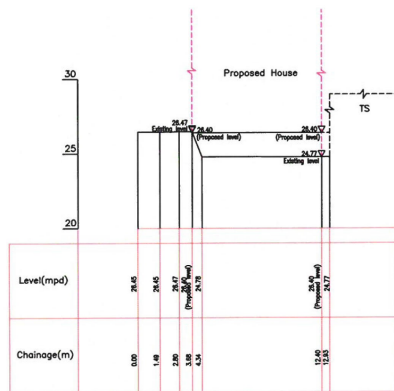

Section B-B
West to East

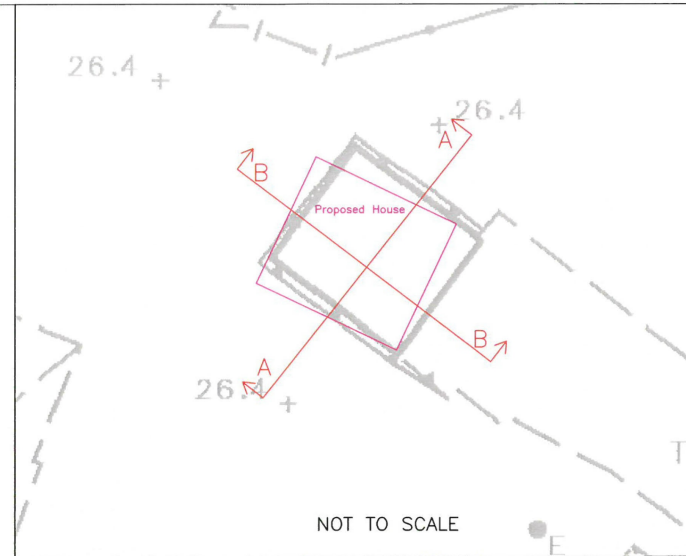

Note

- All levels are in meters above P.D.
- Grid lines are in H.K. 1980 Metric Grid.

Legend

- +39.50 Spot Level
- Proposed House
- Fence
- TS Temporary Structure
- Electric Pole

Plan Title
Sectional Plan of Lot 226 in D.D.111
D.D.111, Yuen Long

Plan No.	Survey Date	N/A
Sections/DD111/226/01	Scale	1:300 (A3)
Rev. 00	Survey Sheet No.	6-NE-99

C K Lau Surveyors Limited

Certified by:

C. K. LAU
MSc. FHKIS FRICS R.P.S.(LS)(PFM) ALS
Authorized Land Surveyor
Date: 10th January 2024

(摘錄自申請人於 18.7.2025 呈交的進一步資料)
(Extract from Applicant's Further
Information Submitted on 18.7.2025)

參考編號
REFERENCE No.
A/YL-PH/1045

繪圖
DRAWING
A - 2

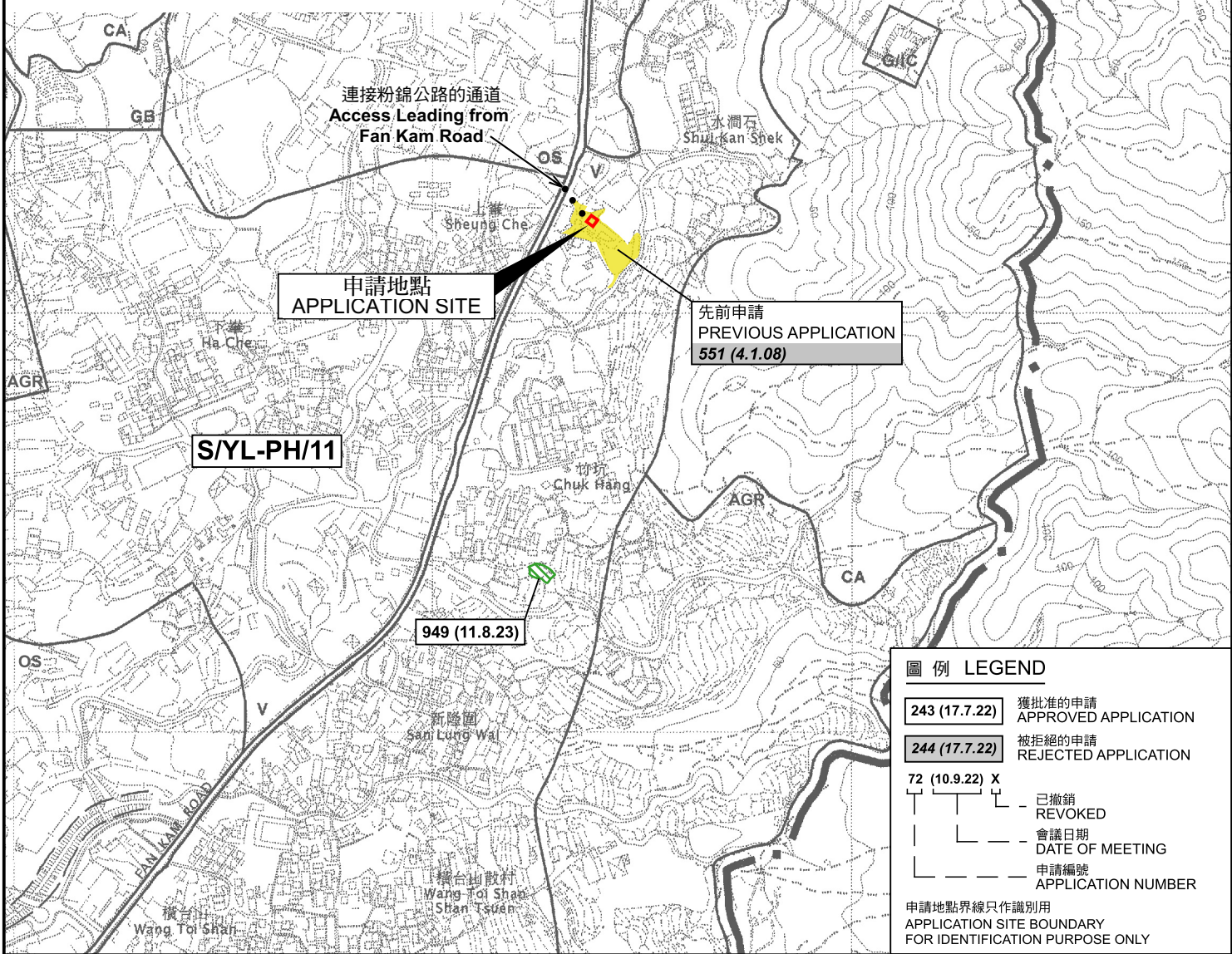
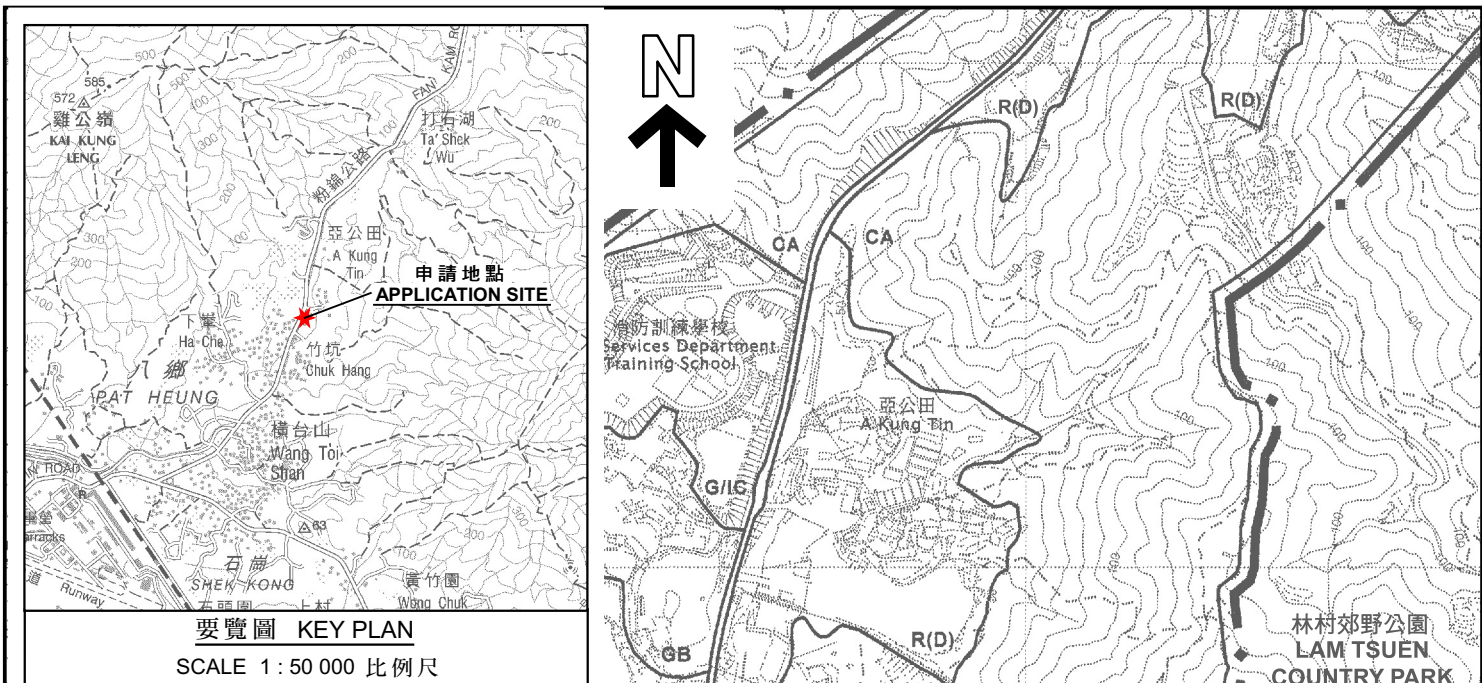

本摘要圖於2025年8月12日擬備，
所根據的資料為於2006年10月17日
核准的分區計劃大綱圖編號 S/YL-PH/11
EXTRACT PLAN PREPARED ON 12.8.2025
BASED ON OUTLINE ZONING PLAN No.
S/YL-PH/11 APPROVED ON 17.10.2006

位置圖 LOCATION PLAN

擬議填土及挖土以作准許的屋宇(新界豁免管制屋宇)用途
元朗八鄉丈量約份第111約地段第226號(部分)
PROPOSED FILLING AND EXCAVATION OF LAND
FOR PERMITTED HOUSE (NEW TERRITORIES EXEMPTED HOUSE)
LOT 226 (PART) IN D.D. 111, PAT HEUNG, YUEN LONG

SCALE 1 : 7 500 比例尺
米 METRES 0 100 200 300 米 METRES

**規劃署
PLANNING
DEPARTMENT**



參考編號
REFERENCE No.
A/YL-PH/1045

圖 PLAN
A-1

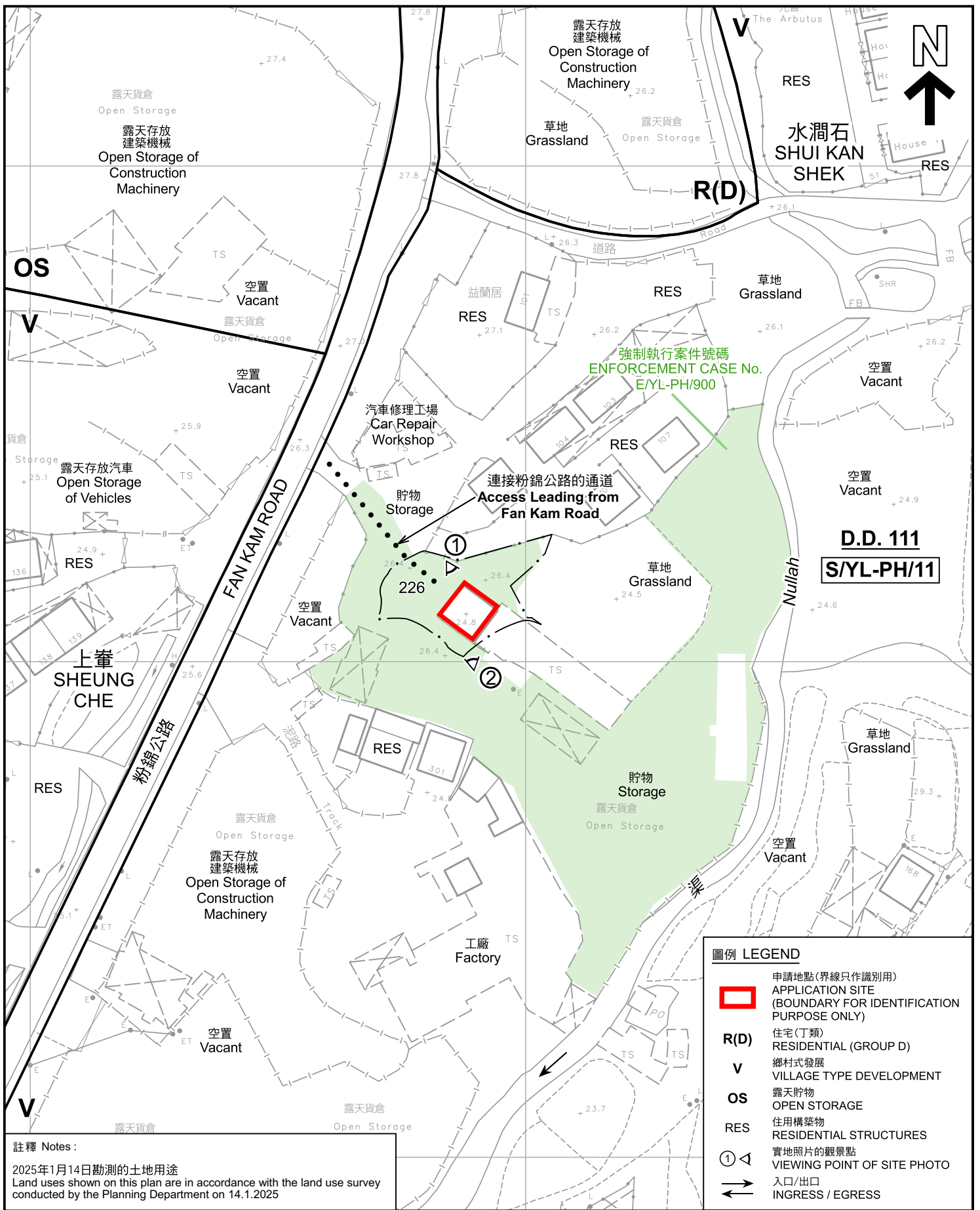

註釋 Notes:
 2025年1月14日勘測的土地用途
 Land uses shown on this plan are in accordance with the land use survey conducted by the Planning Department on 14.1.2025

本摘要圖於2025年8月28日擬備，
 所根據的資料為測量圖編號
 6-NE-9B
 EXTRACT PLAN PREPARED ON 28.8.2025
 BASED ON SURVEY SHEET No.
 6-NE-9B

平面圖 SITE PLAN

擬議填土及挖土以作准許的屋宇(新界豁免管制屋宇)用途
 元朗八鄉丈量約份第111約地段第226號(部分)
 PROPOSED FILLING AND EXCAVATION OF LAND
 FOR PERMITTED HOUSE (NEW TERRITORIES EXEMPTED HOUSE)
 LOT 226 (PART) IN D.D. 111, PAT HEUNG, YUEN LONG

SCALE 1 : 1 000 比例尺
 0 20 40
 METRES METRES METRES

**規劃署
 PLANNING
 DEPARTMENT**

參考編號
 REFERENCE No.
 A/YL-PH/1045

**圖 PLAN
 A-2**

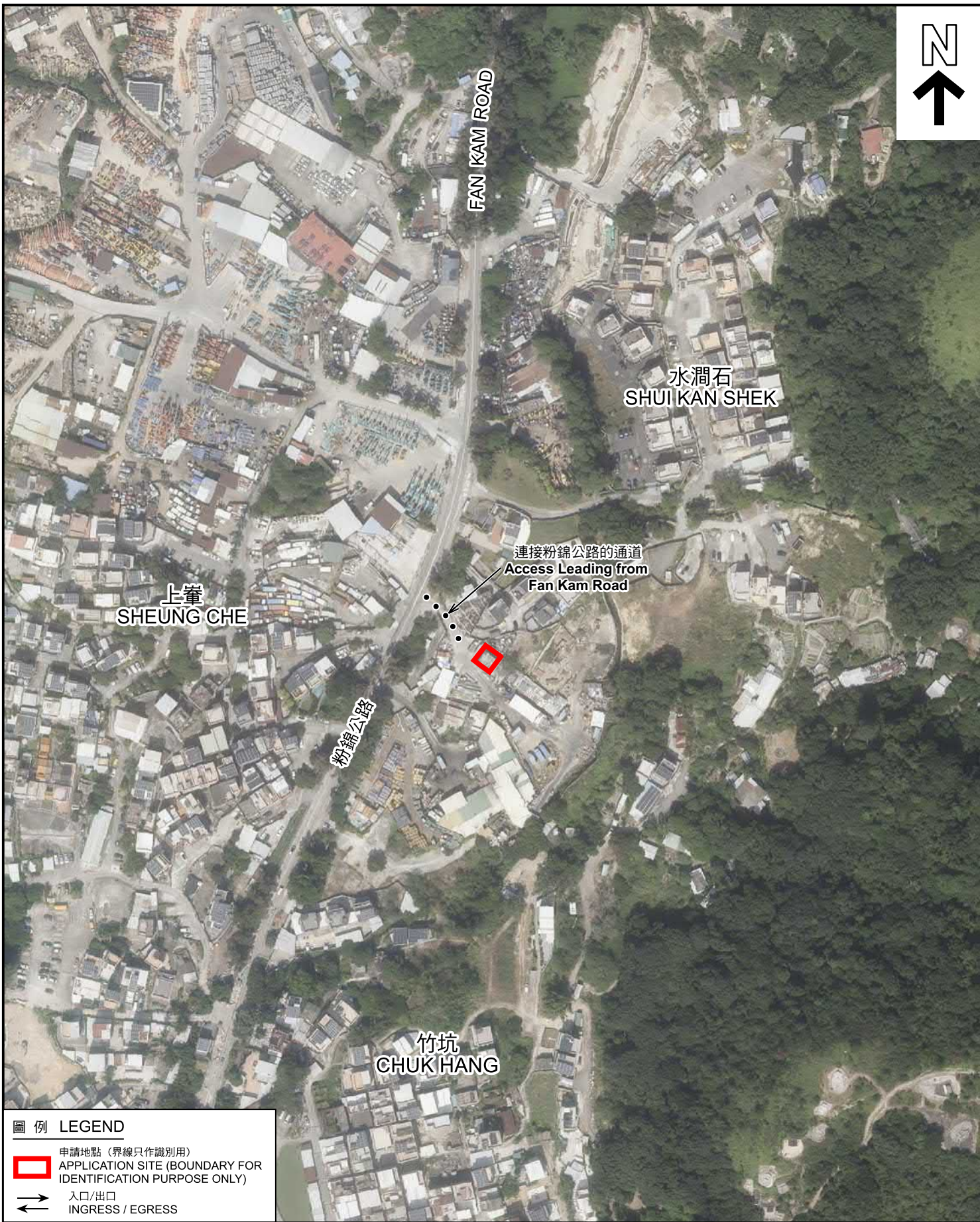

圖例 LEGEND

-  申請地點 (界線只作識別用)
APPLICATION SITE (BOUNDARY FOR IDENTIFICATION PURPOSE ONLY)
-  入口/出口
INGRESS / EGRESS

航攝照片 AERIAL PHOTO

擬議填土及挖土以作准許的屋宇 (新界豁免管制屋宇) 用途
元朗八鄉丈量約份第111約地段第226號 (部分)
PROPOSED FILLING AND EXCAVATION OF LAND
FOR PERMITTED HOUSE (NEW TERRITORIES EXEMPTED HOUSE)
LOT 226 (PART) IN D.D. 111, PAT HEUNG, YUEN LONG

規劃署
PLANNING
DEPARTMENT



參考編號
REFERENCE No.
AYL-PH/1045

圖 PLAN
A-3

本摘要圖於2025年8月27日擬備，
所根據的資料為地政總署於2024年10月24日
拍得的航攝照片編號E237387C
EXTRACT PLAN PREPARED ON 27.8.2025
BASED ON AERIAL PHOTO No.
E237387C TAKEN ON 24.10.2024
BY LANDS DEPARTMENT

1



2



申請地點界線只作識別用 APPLICATION SITE BOUNDARY FOR IDENTIFICATION PURPOSE ONLY

實地照片 SITE PHOTOS

本圖於2025年8月27日擬備，所根據的資料為攝於2025年3月31日的實地照片
PLAN PREPARED ON 27.8.2025
BASED ON SITE PHOTOS
TAKEN ON 31.3.2025

擬議填土及挖土以作准許的屋宇(新界豁免管制屋宇)用途
元朗八鄉丈量約份第111約地段第226號(部分)
PROPOSED FILLING AND EXCAVATION OF LAND
FOR PERMITTED HOUSE (NEW TERRITORIES EXEMPTED HOUSE)
LOT 226 (PART) IN D.D. 111, PAT HEUNG, YUEN LONG

規劃署
PLANNING
DEPARTMENT



參考編號
REFERENCE No.
AYL-PH/1045

圖 PLAN
A-4