

Appendix I - As-built Drainage Plan

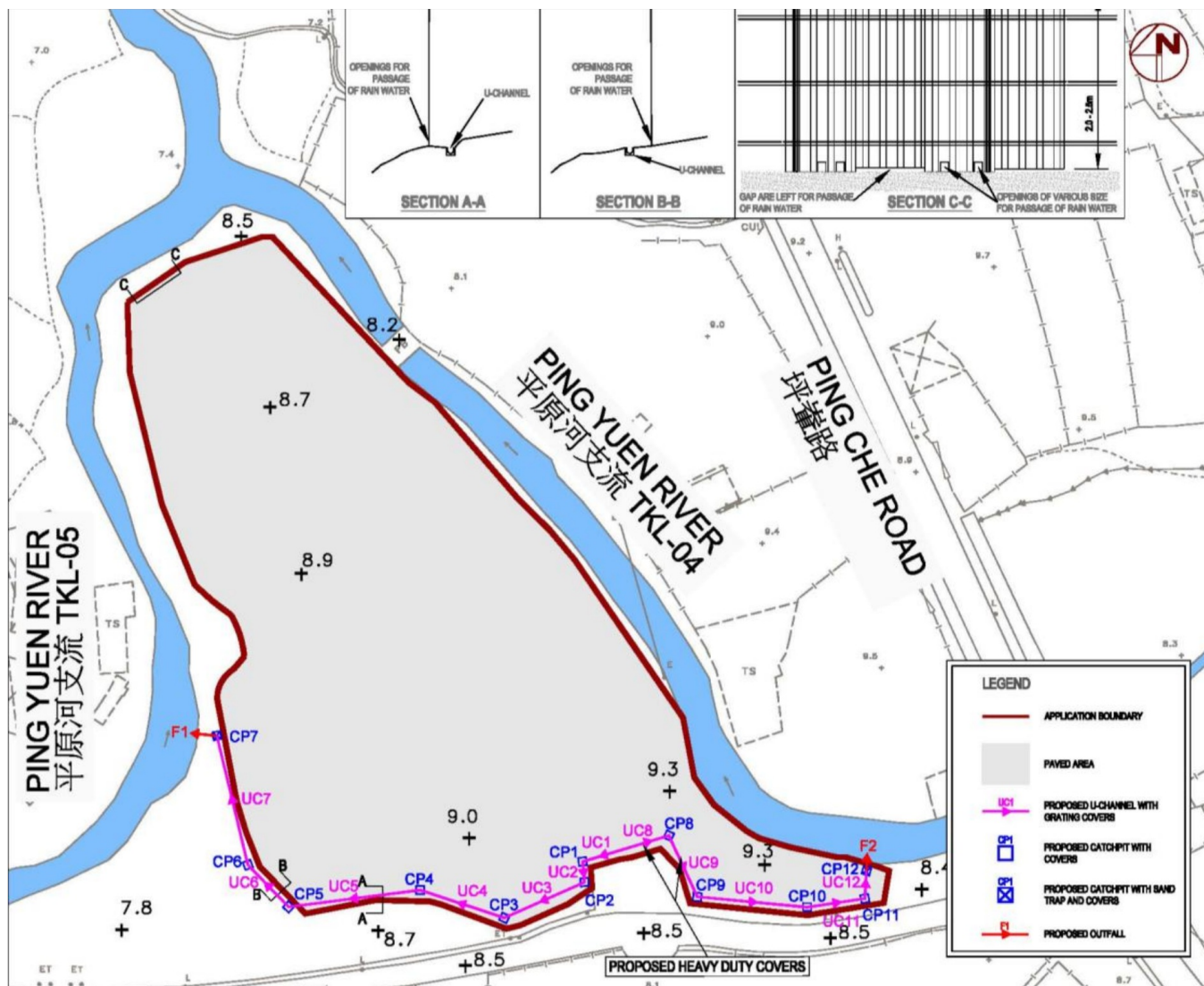

參考編號
REFERENCE No.

A/NE-TKL/821

繪圖

DRAWING A-3

(來源：申請人於2025年10月13日呈交的資料)
(SOURCE: APPLICANT'S SUBMISSION ON 13.10.2025)

DEVELOPMENT PARAMETERS

APPLICATION SITE AREA	: 8,579 m ²	(ABOUT)
COVERED AREA	: 166 m ²	(ABOUT)
UNCOVERED AREA	: 8,413 m ²	(ABOUT)
PLOT RATIO	: 0.02	(ABOUT)
SITE COVERAGE	: 2 %	(ABOUT)
NO. OF STRUCTURE	: 9	
DOMESTIC GFA	: NOT APPLICABLE	
NON-DOMESTIC GFA	: 166 m ²	(ABOUT)
TOTAL GFA	: 166 m ²	(ABOUT)
BUILDING HEIGHT	: 3 m - 7 m	(ABOUT)
NO. OF STOREY	: 1 - 2	
OPEN STORAGE AREA	: 4,625 m ²	(ABOUT)
STACKING HEIGHT	: NOT MORE THAN 3 m	

PARKING AND LOADING/UNLOADING PROVISIONS

NO. OF PRIVATE CAR PARKING SPACE	: 4
DIMENSION OF PARKING SPACE	: 5 m (L) X 2.5 m (W)
NO. OF L/U/L SPACE FOR CONTAINER VEHICLE	: 2
DIMENSION OF L/U/L SPACE	: 16 m (L) X 3.5 m (W)

FIRE SERVICE INSTALLATIONS

-  STAND-ALONE FIRE DETECTOR
-  4 KG DRY POWDER TYPE FIRE EXTINGUISHER

FS NOTES:

- 1) SUFFICIENT STAND-ALONE FIRE DETECTOR SHALL BE PROVIDED THROUGHOUT THE ENTIRE BUILDING IN ACCORDANCE WITH "STAND-ALONE FIRE DETECTOR GENERAL GUIDELINES ON PURCHASE, INSTALLATION & MAINTENANCE [SEP 2021]".
- 2) IN RELATION TO 1) ABOVE, WHERE TWO OR MORE STAND-ALONE FIRE DETECTORS ARE INSTALLED IN AN ENCLOSED STRUCTURE, ALL STAND-ALONE DETECTORS SHALL BE INTERCONNECTED (EITHER WIRED OR WIRELESSLY) SUCH THAT WHEN ONE OF THE STAND-ALONE FIRE DETECTOR IS TRIGGERED, ALL CONNECTED STAND-ALONE FIRE DETECTORS SHALL SOUND AN ALARM SIMULTANEOUSLY.
- 3) PORTABLE HAND-OPERATED APPROVED APPLIANCE SHALL BE PROVIDED AS REQUIRED BY OCCUPANCY.
- 4) ACCESS IS PROVIDED FOR EMERGENCY VEHICLE TO REACH 30m OF ALL PART OF STRUCTURES.

SITE BOUNDARY FOR IDENTIFICATION PURPOSE ONLY.

STRUCTURE	USE	COVERED AREA	GROSS FLOOR AREA	BUILDING HEIGHT
B1	SITE OFFICE AND STORAGE OF TOOLS	46 m ² (ABOUT)	92 m ² (ABOUT)	7 m (ABOUT)(2-STOREY)
B2 TO B8	STORAGE OF TOOLS	15 m ² (ABOUT) EACH	15 m ² (ABOUT) EACH	3 m (ABOUT)(1-STOREY)
B9	SITE OFFICE	15 m ² (ABOUT)	15 m ² (ABOUT)	3 m (ABOUT)(1-STOREY)
TOTAL		166 m ² (ABOUT)	212 m ² (ABOUT)	

*STRUCTURES B2 TO B9 ARE CONTAINER-CONVERTED STRUCTURES

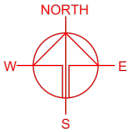
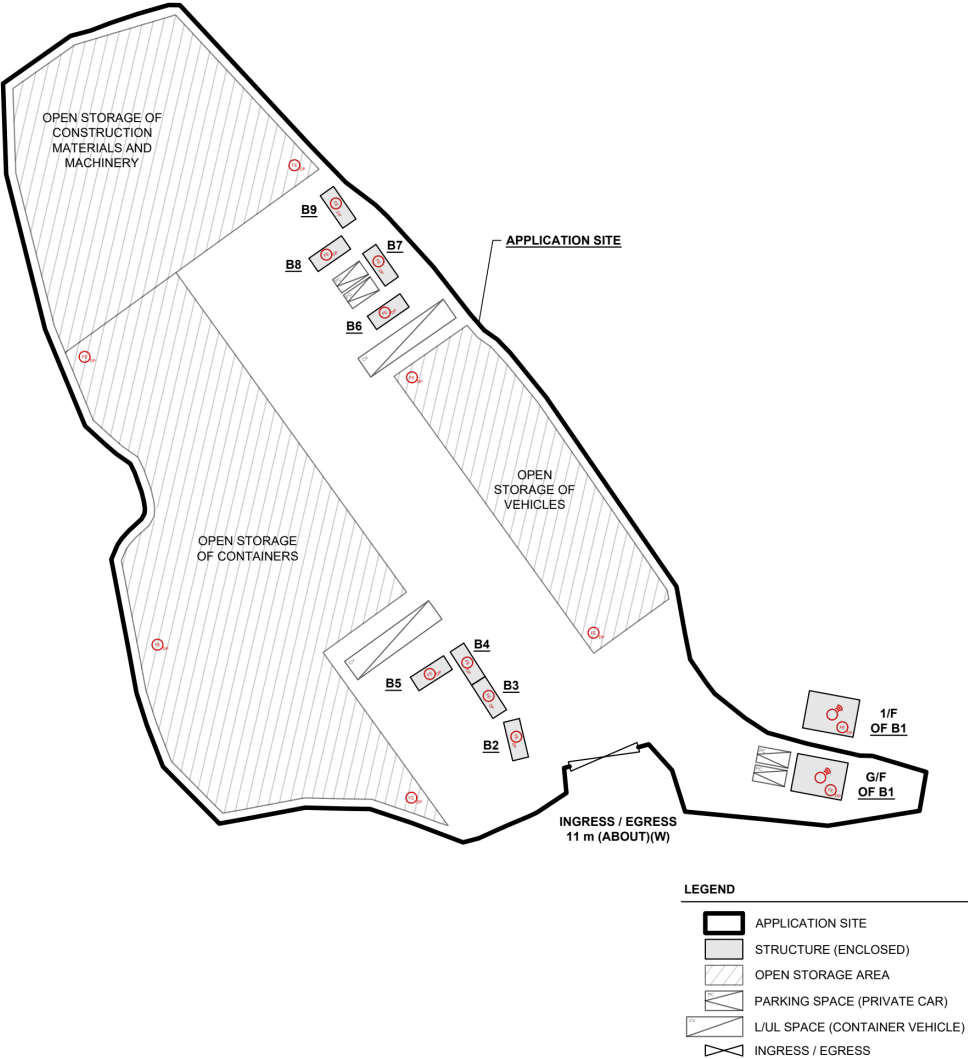

PLANNING CONSULTANT



PROJECT

PROPOSED TEMPORARY OPEN STORAGE OF CONSTRUCTION MATERIALS AND MACHINERY, CONTAINERS AND VEHICLES AND ASSOCIATED FILLING OF LAND FOR A PERIOD OF 3 YEARS

SITE LOCATION

LOTS 1344 (PART) AND 1345 (PART) IN D.D. 82, PING CHE, TA KWU LING, NEW TERRITORIES

SCALE

1:1000 @ A4

DRAWN BY

MN

DATE

10.9.2025

CHECKED BY

DATE

APPROVED BY

DATE

DWG. TITLE

FSIs PROPOSAL

DWG NO.

APPENDIX

VER

001

參考編號

REFERENCE No.

A/NE-TKL/821

繪圖

DRAWING A-4

(來源：申請人於2025年10月13日呈交的資料)

(SOURCE：APPLICANT'S SUBMISSION ON 13.10.2025)

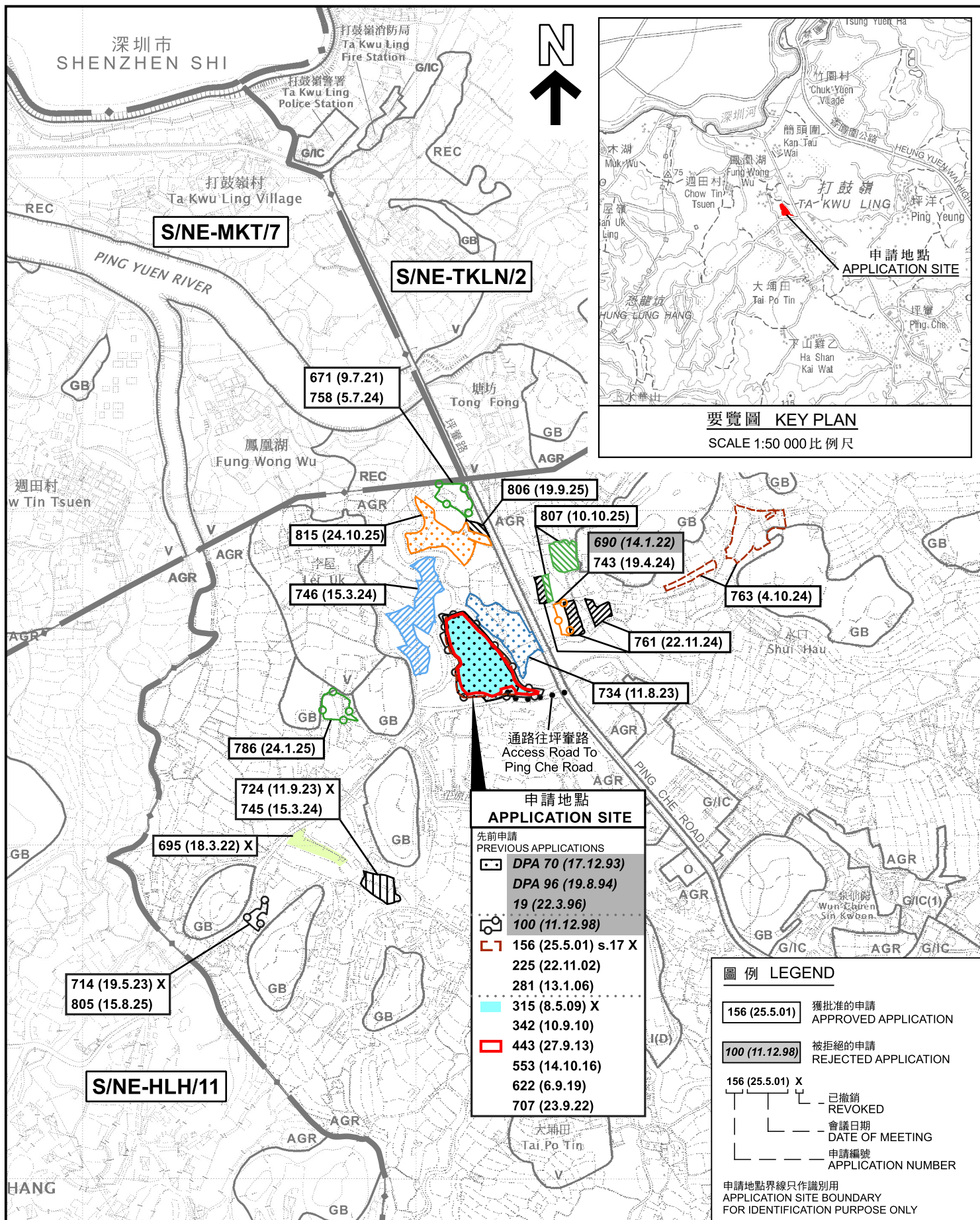

位置圖 LOCATION PLAN

臨時露天存放建築材料和機械及貨櫃和車輛及相關填土工程(為期3年)
 新界打鼓嶺坪壩丈量約份第82約地段第1344號(部分)及第1345號(部分)
 TEMPORARY OPEN STORAGE OF CONSTRUCTION MATERIALS AND
 MACHINERY, CONTAINERS AND VEHICLES
 AND ASSOCIATED FILLING OF LAND FOR A PERIOD OF 3 YEARS
 LOTS 1344 (PART) AND 1345 (PART) IN D.D. 82,
 PING CHE, TA KWU LING, N.T.

SCALE 1:7 500 比例尺

米 100 0 100 200 300 米
 METRES



規劃署
 Planning Department

參考編號
 REFERENCE No.
 A/NE-TKL/821

圖 PLAN
 A-1

本摘要圖於2025年12月2日擬備，
 所根據的資料為：

於2017年12月5日核准的分區計劃大綱圖編號S/NE-HLH/11、
 於2025年10月28日核准的分區計劃大綱圖編號S/NE-MKT/7、
 於2010年2月2日核准的分區計劃大綱圖編號S/NE-TKL/14及
 於2016年5月3日核准的分區計劃大綱圖編號S/NE-TKLN/2
 EXTRACT PLAN PREPARED ON 2.12.2025
 BASED ON OUTLINE ZONING PLANS No.
 S/NE-HLH/11 APPROVED ON 5.12.2017,
 S/NE-MKT/7 APPROVED ON 28.10.2025,
 S/NE-TKL/14 APPROVED ON 2.2.2010 AND
 S/NE-TKLN/2 APPROVED ON 3.5.2016

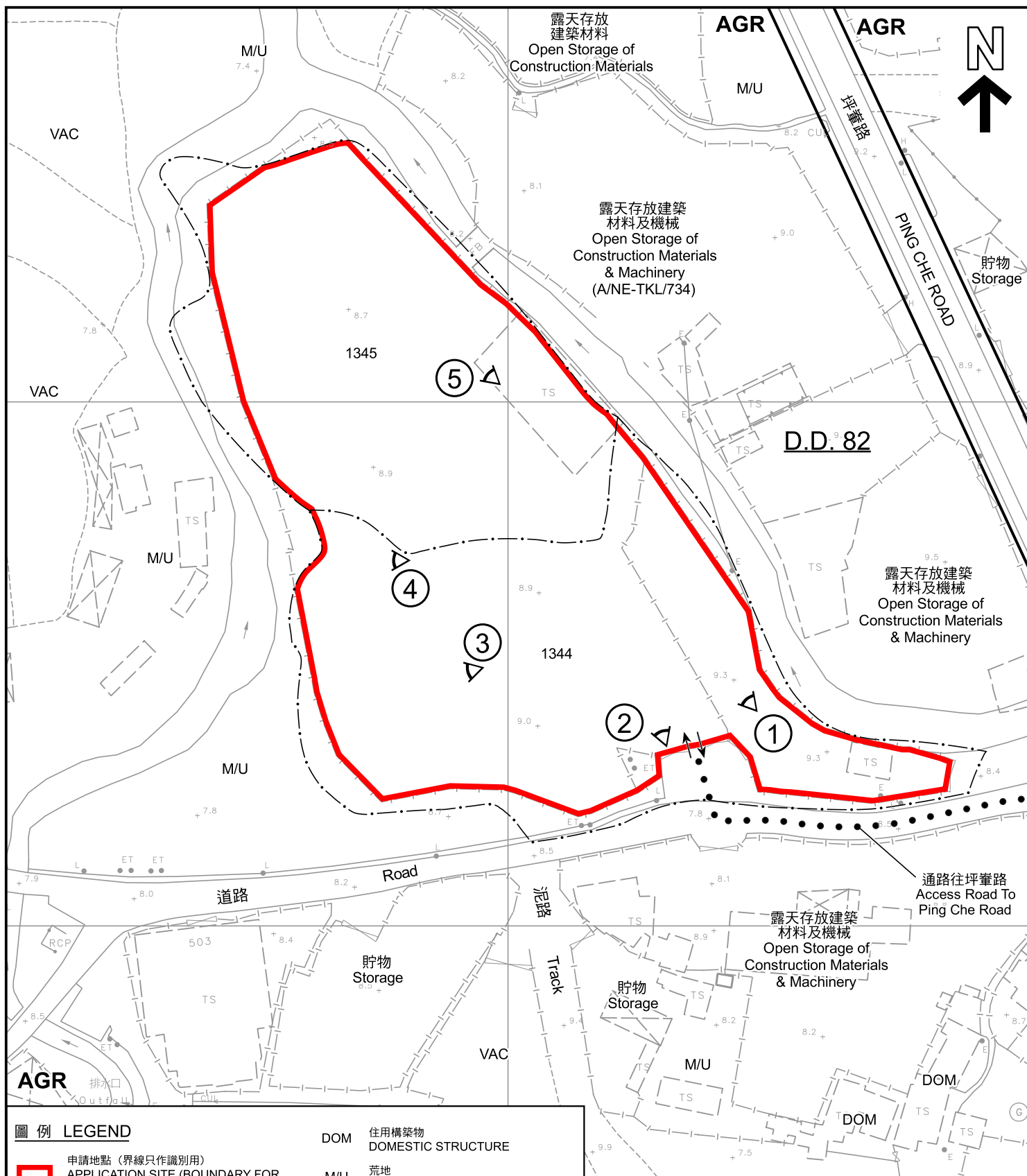

圖例 LEGEND



申請地點 (界線只作識別用)
APPLICATION SITE (BOUNDARY FOR IDENTIFICATION PURPOSE ONLY)

AGR

農業
AGRICULTURE



入口/出口
INGRESS / EGRESS

DOM

住用構築物
DOMESTIC STRUCTURE

M/U

荒地
UNUSED LAND

VAC

空置
VACANT



實地照片的觀景點
VIEWING POINT OF SITE PHOTO

註釋 Notes :

2025年10月21日勘测的土地用途

Land uses shown on this plan are in accordance with the land use survey conducted by the Planning Department on 21.10.2025

平面圖 SITE PLAN

臨時露天存放建築材料和機械及貨櫃和車輛及相關填土工程(為期3年)
新界打鼓嶺坪輦丈量約份第82約地段第1344號(部分)及第1345號(部分)
TEMPORARY OPEN STORAGE OF CONSTRUCTION MATERIALS AND MACHINERY, CONTAINERS AND VEHICLES AND ASSOCIATED FILLING OF LAND FOR A PERIOD OF 3 YEARS
LOTS 1344 (PART) AND 1345 (PART) IN D.D. 82,
PING CHE, TA KWU LING, N.T.
SCALE 1 : 1 000 比例尺

米 METRES 20 0 20 40 米 METRES



規劃署
Planning Department

參考編號
REFERENCE No.
A/NE-TKL/821

圖 PLAN
A-2

本摘要圖於2025年11月19日擬備，
所根據的資料為測量圖編號

3-NW-18A及18C

EXTRACT PLAN PREPARED ON 19.11.2025
BASED ON SURVEY SHEETS No.
3-NW-18A & 18C



圖例 LEGEND

 申請地點 (界線只作識別用)
APPLICATION SITE (BOUNDARY FOR IDENTIFICATION PURPOSE ONLY)

本摘要圖於2025年11月7日擬備，
所根據的資料為地政總署於2024年11月7日
拍得的航攝照片編號E241225C
EXTRACT PLAN PREPARED ON 7.11.2025
BASED ON AERIAL PHOTO No. E241225C
TAKEN ON 7.11.2024 BY
LANDS DEPARTMENT

航攝照片 AERIAL PHOTO

臨時露天存放建築材料和機械及貨櫃和車輛及相關填土工程 (為期3年)
新界打鼓嶺坪輦丈量約份第82約地段第1344號(部分)及第1345號(部分)
TEMPORARY OPEN STORAGE OF CONSTRUCTION MATERIALS AND
MACHINERY, CONTAINERS AND VEHICLES
AND ASSOCIATED FILLING OF LAND FOR A PERIOD OF 3 YEARS
LOTS 1344 (PART) AND 1345 (PART) IN D.D. 82,
PING CHE, TA KWU LING, N.T.



規劃署
Planning Department

參考編號
REFERENCE No.
A/NE-TKL/821

圖 PLAN
A-3



申請地點界線只作識別用
APPLICATION SITE BOUNDARY FOR IDENTIFICATION PURPOSE ONLY

實地照片 SITE PHOTOS

本圖於2025年11月6日擬備，
所根據的資料為攝於2025年10月21日
的實地照片
PLAN PREPARED ON 6.11.2025
BASED ON SITE PHOTOS TAKEN ON
21.10.2025

臨時露天存放建築材料和機械及貨櫃及車輛及相關填土工程(為期3年)
新界打鼓嶺坪輦丈量約份第82約地段第1344號(部分)及第1345號(部分)
TEMPORARY OPEN STORAGE OF CONSTRUCTION MATERIALS AND
MACHINERY, CONTAINERS AND VEHICLES
AND ASSOCIATED FILLING OF LAND FOR A PERIOD OF 3 YEARS
LOTS 1344 (PART) AND 1345 (PART) IN D.D. 82,
PING CHE, TA KWU LING, N.T.



規劃署
Planning Department

參考編號
REFERENCE No.
A/NE-TKL/821

圖 PLAN
A-4a



申請地點界線只作識別用
APPLICATION SITE BOUNDARY FOR IDENTIFICATION PURPOSE ONLY

實地照片 SITE PHOTOS

本圖於2025年11月6日擬備，
所根據的資料為攝於2025年10月21日
的實地照片
PLAN PREPARED ON 6.11.2025
BASED ON SITE PHOTOS TAKEN ON
21.10.2025

臨時露天存放建築材料和機械及貨櫃和車輛及相關填土工程(為期3年)
新界打鼓嶺坪輦丈量約份第82約地段第1344號(部分)及第1345號(部分)
TEMPORARY OPEN STORAGE OF CONSTRUCTION MATERIALS AND
MACHINERY, CONTAINERS AND VEHICLES
AND ASSOCIATED FILLING OF LAND FOR A PERIOD OF 3 YEARS
LOTS 1344 (PART) AND 1345 (PART) IN D.D. 82,
PING CHE, TA KWU LING, N.T.



規劃署
Planning Department

參考編號
REFERENCE No.
A/NE-TKL/821

圖 PLAN
A-4b