

- APPLICATION BOUNDARY
- ◆ ENTRANCE ACCESS TO SUBJECT PREMISES
- WAITING SPACE FOR LIFT : 46M²
- GFA : 106.5M²
- NFA : 93.2M²
- LOOSE FURNITURE
- BUILD-IN FURNITURE
- - - EXISTING WALL TO BE DEMOLISH
- PARAPET WALL
- NEW GYPSUM BOARD WALL
- NEW BLOCK WALL

THEO TEXTURE total design & build
 unit 1205 12/11 hk o see view estate 2 waton rd north
 p 2520 0720 f 2520 0760 www.theotexture.com

REV.	DESCRIPTION	DAT

GENERAL NOTES
 All dimensions and site conditions should be as prior to commencement of any work. Refer to dimensions only. Do not scale this drawing. This drawing should be read in conjunction with all drawings and materials.

Copyright of the design and information shown this drawing belongs to THEO TEXTURE. Any reproduction or use of the design is illegal without prior written consent by THEO TEXTURE.

PROJECT TITLE
 MANDARIN BIBLE CHURCH

DRAWING TITLE
 G/F FLOOR PLAN

SCALE	DRAWN BY	PROJECT NO.
1:100	EH	T12551
DATE	CHECKED BY	DWG NO.
01.12.2025	BW	PL01D

(資料來源：由申請人於2026年1月15日提交的進一步資料)
 (Source: Further information submitted by the applicant on 15.1.2026)

參考編號
 REFERENCE No.
 A/H1/105

繪圖
 DRAWING
 A - 2

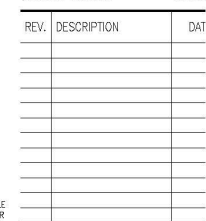
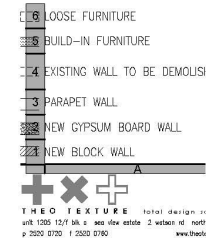

GENERAL NOTES

All dimensions and site conditions should be as shown prior to commencement of any work. Refer to drawings for dimensions only. Do not scale this drawing. This drawing should be read in conjunction with all drawings and materials.

Copyright of the design and information shown in this drawing belongs to THEO TEXTURE. Any reproduction or use of the design is illegal without prior written consent by THEO TEXTURE.

PROJECT TITLE

MANDARIN BIBLE CHURCH

DRAWING TITLE
1/F FLOOR PLAN

SCALE	DRAWN BY	PROJECT NO.
1:200	EH	TT2551
DATE	CHECKED BY	DWG NO.
01.12.2025	BW	PL02D

(資料來源:由申請人於2025年12月10日提交)
(Source: Submitted by the applicant on 10.12.2025)

參考編號
REFERENCE No.
A/H1/105

繪圖
DRAWING
A - 3

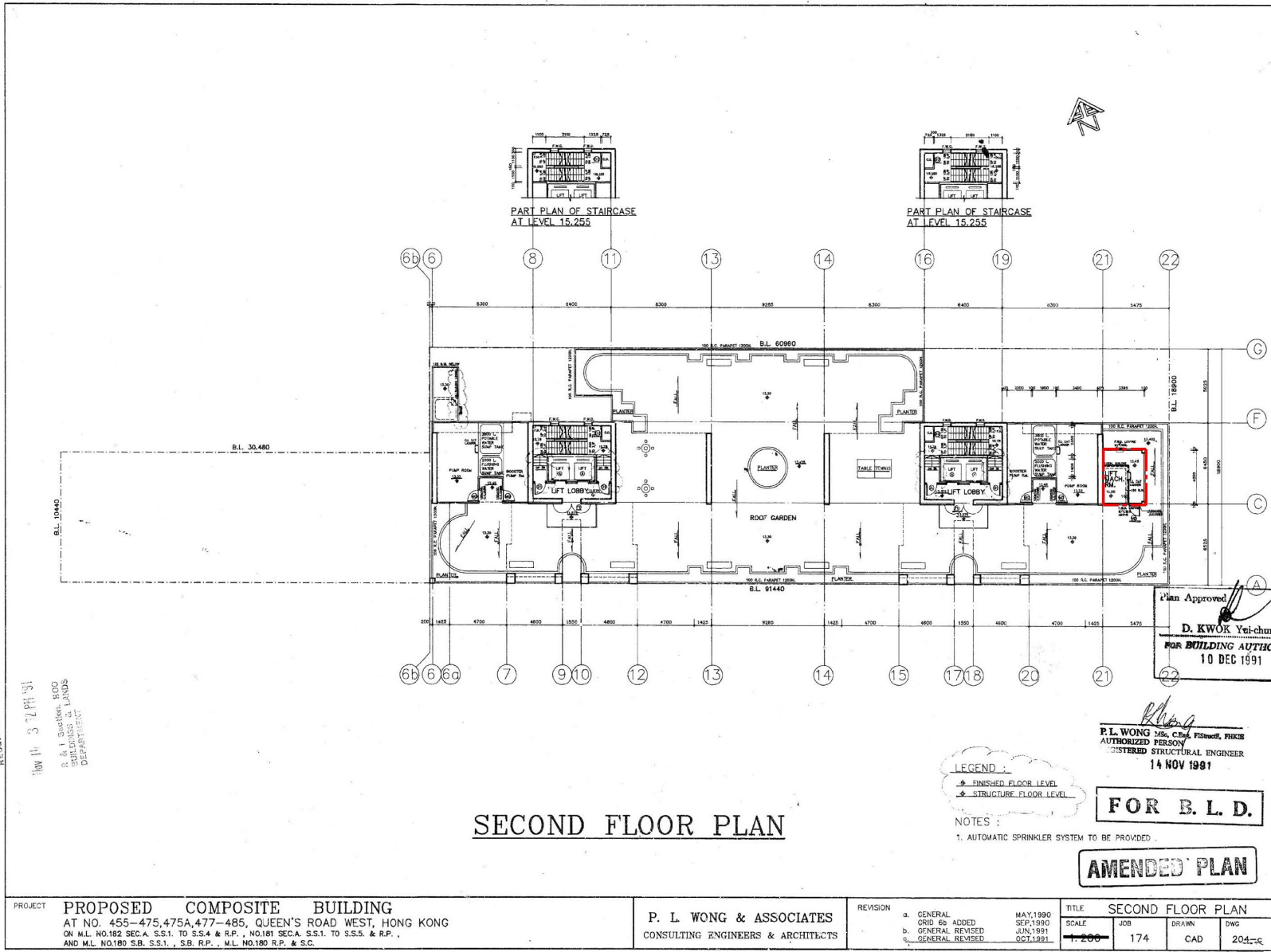

--- APPLICATION BOUNDARY

UFA : 14.4M²

GFA : 15.4M²

□ LOOSE FURNITURE

▨ BUILD-IN FURNITURE

--- EXISTING WALL TO BE DEMOLISHED

— PARAPET WALL

▨ NEW GYPSUM BOARD WALL

▨ NEW BLOCK WALL

THEO TEXTURE total design solution
unit 1202 12/1 blk c sea view estate 2 wai tan rd north point hk
p 2520 0720 f 2520 0760 www.theotexture.com

REV.	DESCRIPTION	DATE

GENERAL NOTES
All dimensions and site conditions should be checked prior to commencement of any work. Refer to figure dimensions only. Do not scale this drawing. This drawing should be read in conjunction with all related drawings and materials.

Copyright of the design and information shown on this drawing belongs to THEO TEXTURE. Any reproduction or use of the design is illegal without prior written consent by THEO TEXTURE.

PROJECT TITLE

MANDARIN BIBLE CHURCH

DRAWING TITLE

2/F FLOOR PLAN

SCALE	DRAWN BY	PROJECT NO.
1:100	EH	TT2551
DATE	CHECKED BY	DWG NO.
09.12.2025	BW	PL03

參考編號
REFERENCE No.
A/H1/105

繪圖
DRAWING
A - 4

(資料來源: 由申請人於2025年12月10日提交)
(Source: Submitted by the applicant on 10.12.2025)



公眾貨物裝卸區
PUBLIC CARGO WORKING AREA

申請處所
APPLICATION PREMISES

- 二樓
2/F
- 一樓
1/F
- 地下
G/F

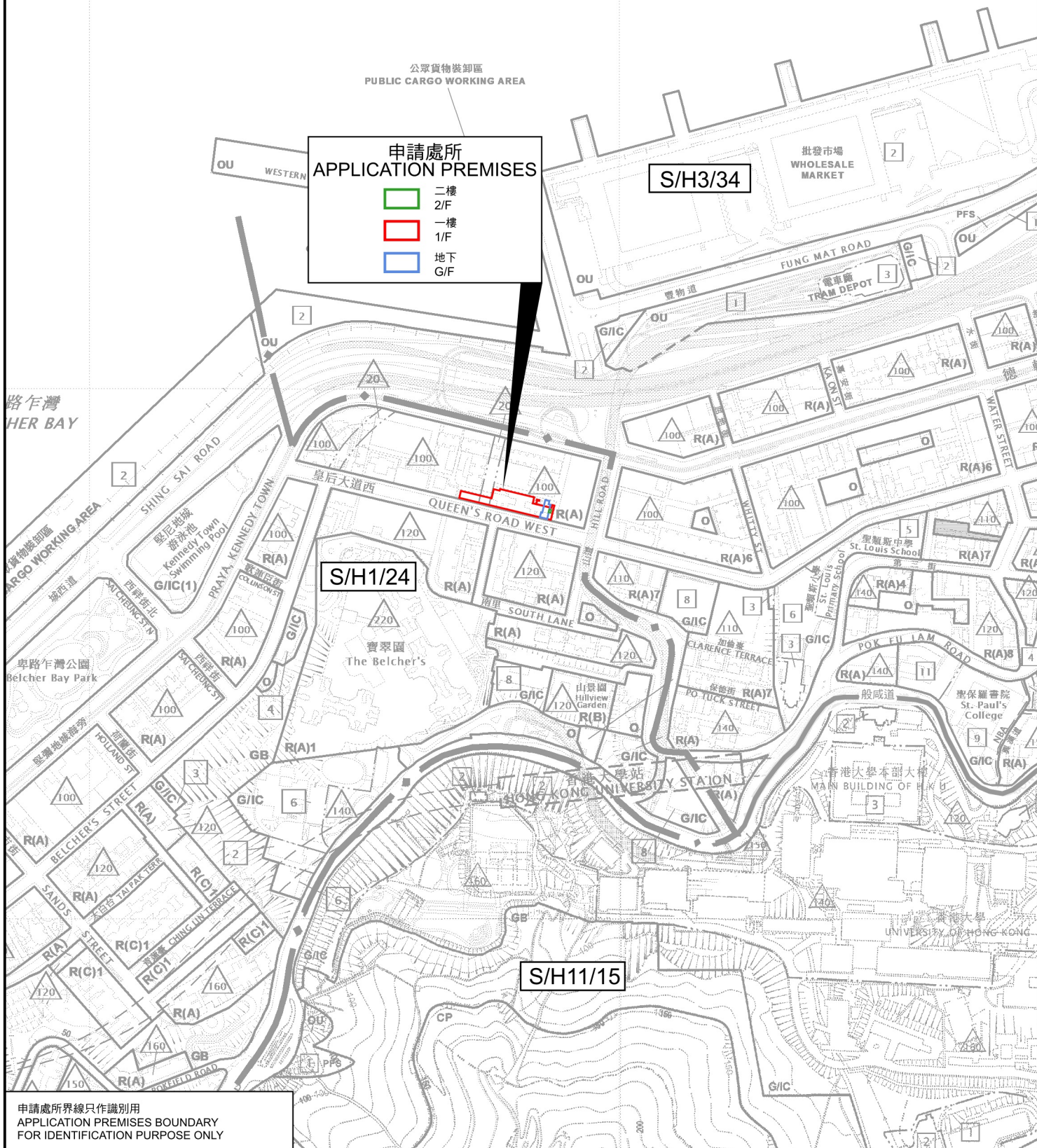

申請處所界線只作識別用
APPLICATION PREMISES BOUNDARY
FOR IDENTIFICATION PURPOSE ONLY

位置圖 LOCATION PLAN

擬議宗教機構(教堂)
香港皇后大道西455至485號龍輝花園地下商舖2號及3號、一樓及二樓(部分)
PROPOSED RELIGIOUS INSTITUTION (CHURCH)
SHOPS 2 AND 3 ON G/F, 1/F AND 2/F (PORTION),
DRAGONFAIR GARDEN, 455-485 QUEEN'S ROAD WEST, HONG KONG

SCALE 1:5 000 比例尺

米 100 0 100 200 米
METRES



規劃署
Planning Department

參考編號
REFERENCE No.
A/H1/105

圖 PLAN
A - 1

本摘要圖於2025年12月23日擬備，
所根據的資料為：
於2023年10月3日核准的分區計劃大綱圖編號S/H1/24，
於2020年11月3日核准的分區計劃大綱圖編號S/H3/34，
於2010年3月2日核准的分區計劃大綱圖編號S/H11/15

EXTRACT PLAN PREPARED ON 23.12.2025
BASED ON OUTLINE ZONING PLANS No.
S/H1/24 APPROVED ON 3.10.2023,
S/H3/34 APPROVED ON 3.11.2020 AND
S/H11/15 APPROVED ON 2.3.2010

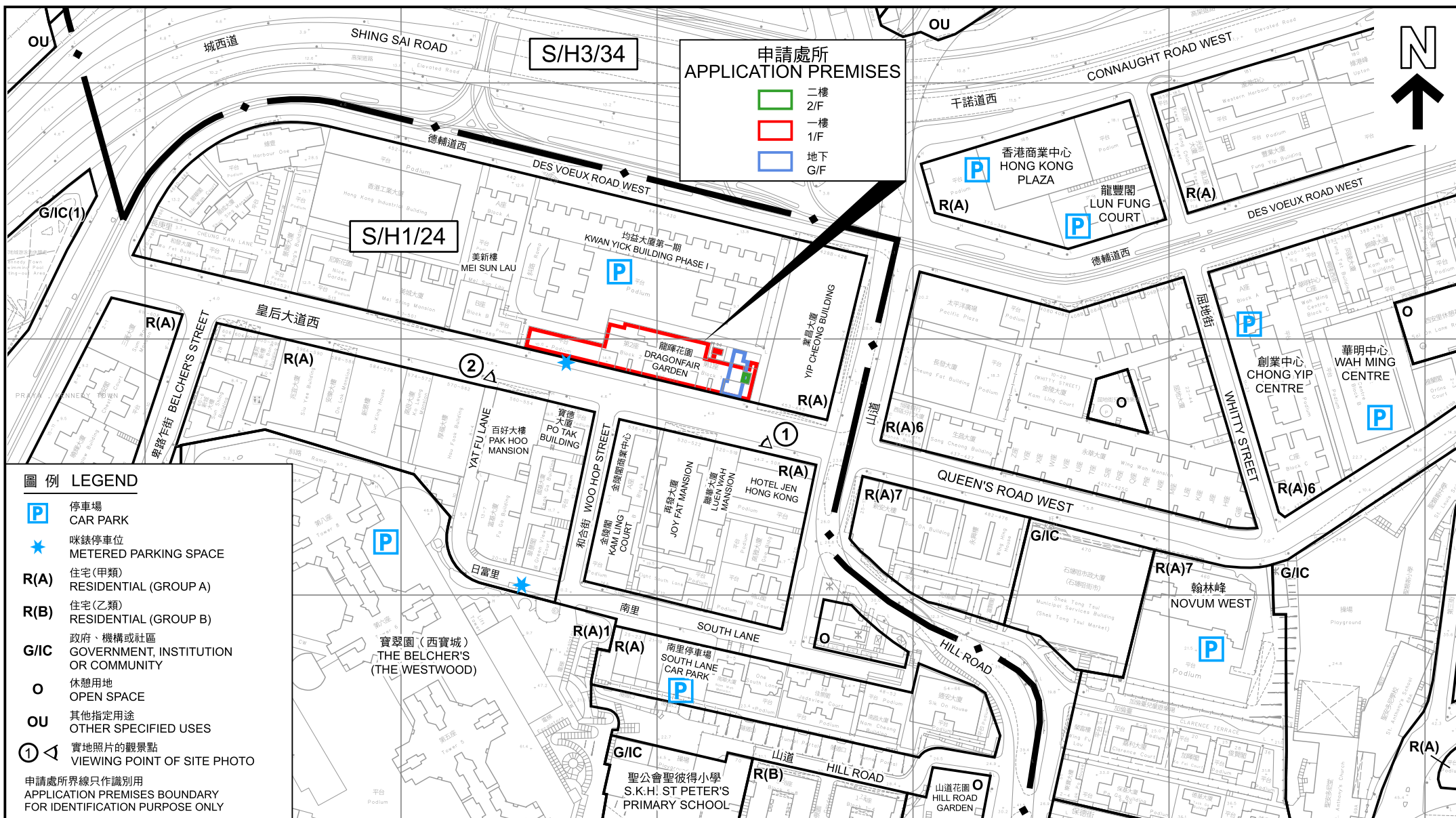

平面圖 SITE PLAN

本摘要圖於2026年1月16日擬備，所根據的資料為測量圖編號11-SW-7A

EXTRACT PLAN PREPARED ON 16.1.2026
BASED ON SURVEY SHEET No. 11-SW-7A

擬議宗教機構(教堂)
香港皇后大道西455至485號龍輝花園地下商舖2號及3號、一樓及二樓(部分)
PROPOSED RELIGIOUS INSTITUTION (CHURCH)
SHOPS 2 AND 3 ON G/F, 1/F AND 2/F (PORTION),
DRAGONFAIR GARDEN, 455-485 QUEEN'S ROAD WEST, HONG KONG

SCALE 1:2 000 比例尺
米 METRES 40 0 40 80 米 METRES



規劃署
Planning Department

參考編號
REFERENCE No.
A/H1/105

圖 PLAN
A - 2



申請處所界線只作識別用
APPLICATION PREMISES BOUNDARY
FOR IDENTIFICATION PURPOSE ONLY

實地照片 SITE PHOTOS

本圖於2025年12月31日擬備，所根據的資料為攝於2025年12月12日的實地照片

PLAN PREPARED ON 31.12.2025
BASED ON SITE PHOTOS
TAKEN ON 12.12.2025

擬議宗教機構(教堂)
香港皇后大道西455至485號龍暉花園地下商舖2號及3號、一樓及二樓(部分)

PROPOSED RELIGIOUS INSTITUTION (CHURCH)
SHOPS 2 AND 3 ON G/F, 1/F AND 2/F (PORTION),
DRAGONFAIR GARDEN, 455-485 QUEEN'S ROAD WEST, HONG KONG



規劃署
Planning Department

參考編號
REFERENCE No.
A/H1/105

圖 PLAN
A - 3

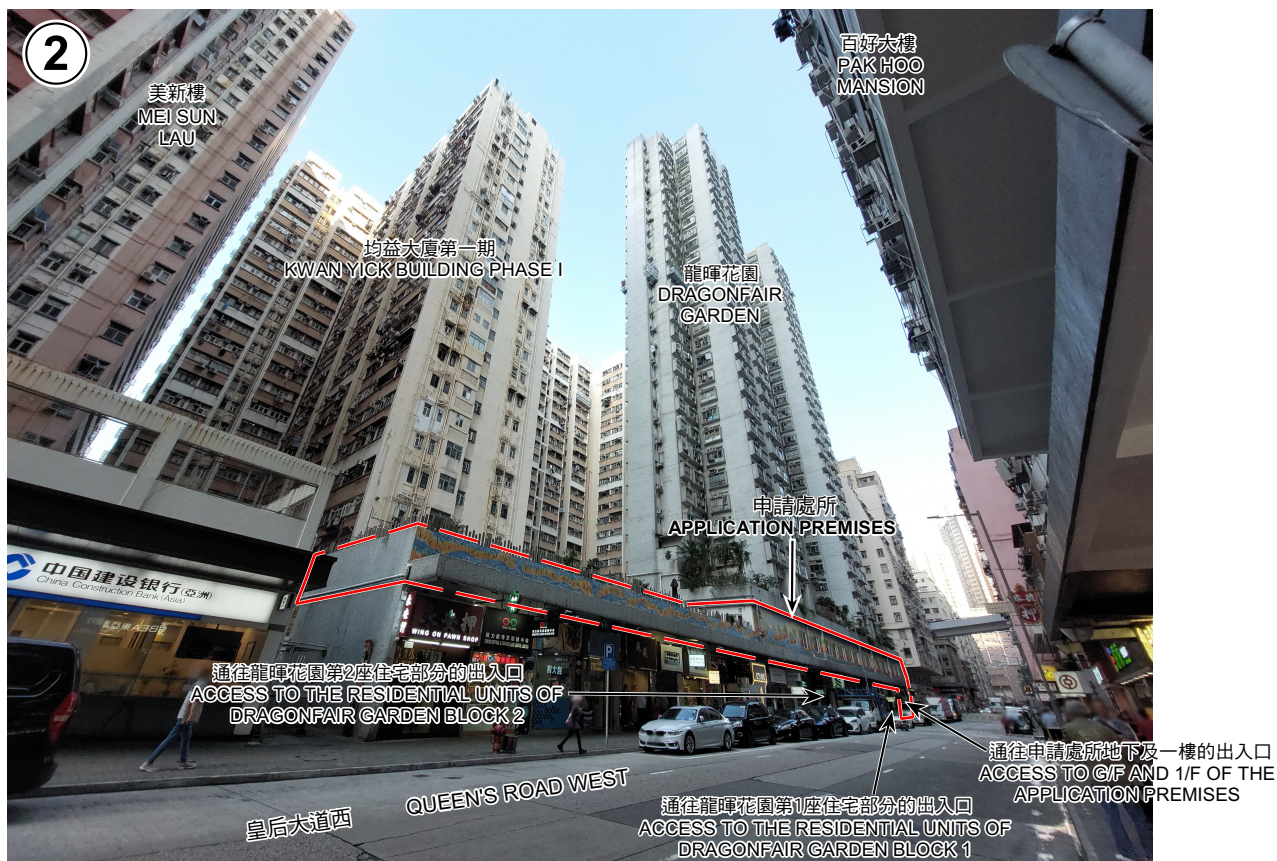

申請處所界線只作識別用
APPLICATION PREMISES BOUNDARY
FOR IDENTIFICATION PURPOSE ONLY

實地照片 SITE PHOTOS

本圖於2026年1月7日擬備，所根據的
資料為攝於2025年12月12日的實地照片

PLAN PREPARED ON 7.1.2026
BASED ON SITE PHOTOS
TAKEN ON 12.12.2025

擬議宗教機構(教堂)
香港皇后大道西455至485號龍嘢花園地下商舖2號及3號、一樓及二樓(部分)

PROPOSED RELIGIOUS INSTITUTION (CHURCH)
SHOPS 2 AND 3 ON G/F, 1/F AND 2/F (PORTION),
DRAGONFAIR GARDEN, 455-485 QUEEN'S ROAD WEST, HONG KONG



規劃署
Planning Department

參考編號
REFERENCE No.
A/H1/105

圖 PLAN
A - 4



申請處內部景觀 (地下)
INTERNAL VIEW OF APPLICATION PREMISES (G/F)

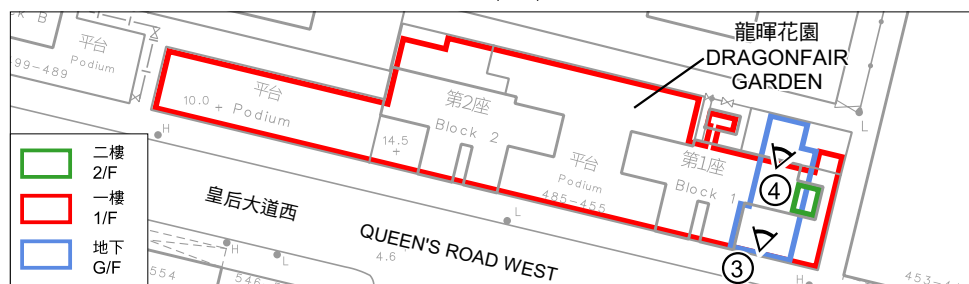

圖例 LEGEND

③ 實地照片的觀景點
VIEWING POINT OF SITE PHOTO

申請地點界線只作識別用
APPLICATION PREMISES BOUNDARY
FOR IDENTIFICATION PURPOSE ONLY

二樓
2/F

一樓
1/F

地下
G/F

實地照片 SITE PHOTOS

本圖於2026年1月7日擬備，所根據的資料為攝於2025年12月12日的實地照片
PLAN PREPARED ON 7.1.2026
BASED ON SITE PHOTOS TAKEN
ON 12.12.2025

擬議宗教機構(教堂)
香港皇后大道西455至485號龍嘢花園地下商舖2號及3號、一樓及二樓(部分)
PROPOSED RELIGIOUS INSTITUTION (CHURCH)
SHOPS 2 AND 3 ON G/F, 1/F AND 2/F (PORTION),
DRAGONFAIR GARDEN, 455-485 QUEEN'S ROAD WEST, HONG KONG



規劃署
Planning Department

參考編號
REFERENCE No.
A/H1/105

圖 PLAN
A - 5



申請處所內部景觀（一樓）
INTERNAL VIEW OF APPLICATION PREMISES (1/F)

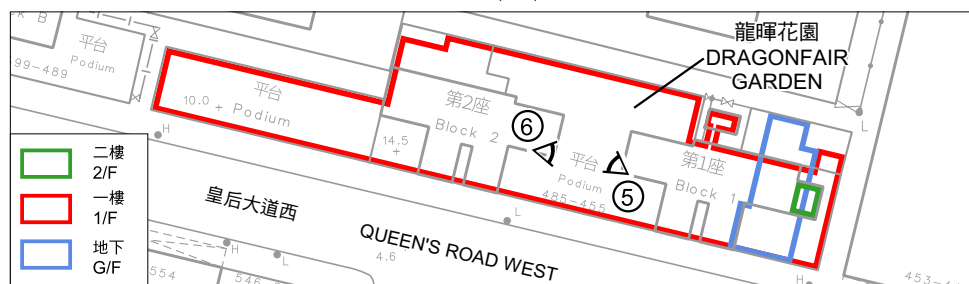

圖例 LEGEND

⑤ ◁ 實地照片的觀景點
VIEWING POINT OF SITE PHOTO

實地照片 SITE PHOTOS

本圖於2026年1月7日擬備，所根據的資料為攝於2025年12月12日的實地照片
PLAN PREPARED ON 7.1.2026
BASED ON SITE PHOTOS TAKEN ON 12.12.2025

擬議宗教機構(教堂)
香港皇后大道西455至485號龍暉花園地下商舖2號及3號、一樓及二樓(部分)
PROPOSED RELIGIOUS INSTITUTION (CHURCH)
SHOPS 2 AND 3 ON G/F, 1/F AND 2/F (PORTION),
DRAGONFAIR GARDEN, 455-485 QUEEN'S ROAD WEST, HONG KONG



規劃署
Planning Department

參考編號
REFERENCE No.
A/H1/105

圖 PLAN
A - 6



申請處所內部景觀（一樓）
INTERNAL VIEW OF APPLICATION PREMISES (1/F)

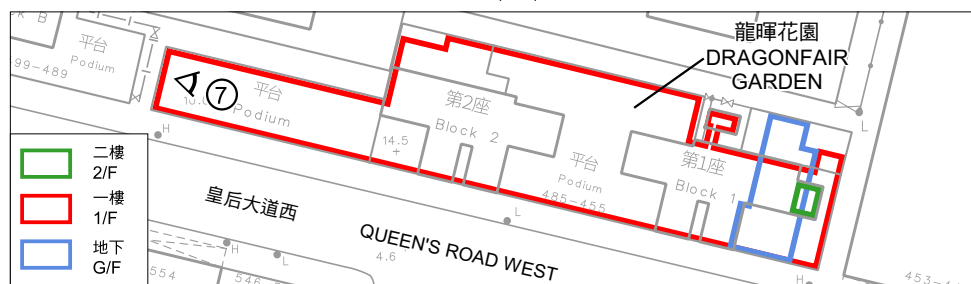

圖例 LEGEND

⑦ 實地照片的觀景點
VIEWING POINT OF SITE PHOTO

申請地點界線只作識別用
APPLICATION PREMISES BOUNDARY
FOR IDENTIFICATION PURPOSE ONLY

實地照片 SITE PHOTOS

本圖於2026年1月19日擬備，所根據的資料為攝於2025年12月12日的實地照片
PLAN PREPARED ON 19.1.2026
BASED ON SITE PHOTOS TAKEN ON 12.12.2025

擬議宗教機構(教堂)
香港皇后大道西455至485號龍輝花園地下商舖2號及3號、一樓及二樓(部分)
PROPOSED RELIGIOUS INSTITUTION (CHURCH)
SHOPS 2 AND 3 ON G/F, 1/F AND 2/F (PORTION),
DRAGONFAIR GARDEN, 455-485 QUEEN'S ROAD WEST, HONG KONG



規劃署
Planning Department

參考編號
REFERENCE No.
A/H1/105

圖 PLAN
A - 7



申請處所內部景觀（二樓）
INTERNAL VIEW OF APPLICATION PREMISES (2/F)

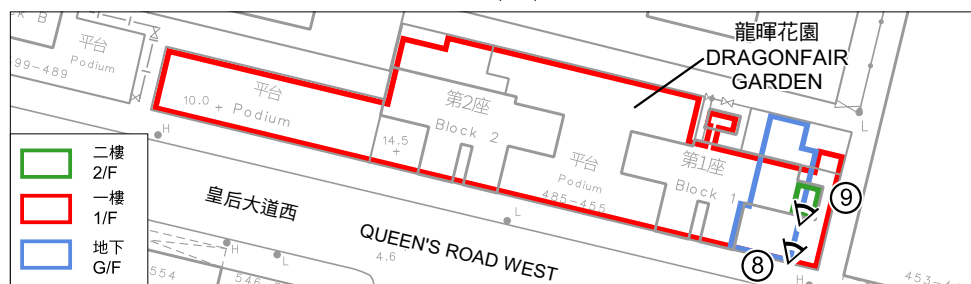

圖例 LEGEND

⑧ ◁ 實地照片的觀景點
VIEWING POINT OF SITE PHOTO

申請地點界線只作識別用
APPLICATION PREMISES BOUNDARY
FOR IDENTIFICATION PURPOSE ONLY

實地照片 SITE PHOTOS

本圖於2026年1月7日擬備，所根據的
資料為攝於2025年12月12日的實地照片
PLAN PREPARED ON 7.1.2026
BASED ON SITE PHOTOS TAKEN
ON 12.12.2025

擬議宗教機構(教堂)
香港皇后大道西455至485號龍暉花園地下商舖2號及3號、一樓及二樓(部分)
PROPOSED RELIGIOUS INSTITUTION (CHURCH)
SHOPS 2 AND 3 ON G/F, 1/F AND 2/F (PORTION),
DRAGONFAIR GARDEN, 455-485 QUEEN'S ROAD WEST, HONG KONG



規劃署
Planning Department

參考編號
REFERENCE No.
A/H1/105

圖 PLAN
A - 8