

LOT 491 RP IN D.D.130 LAM TEI

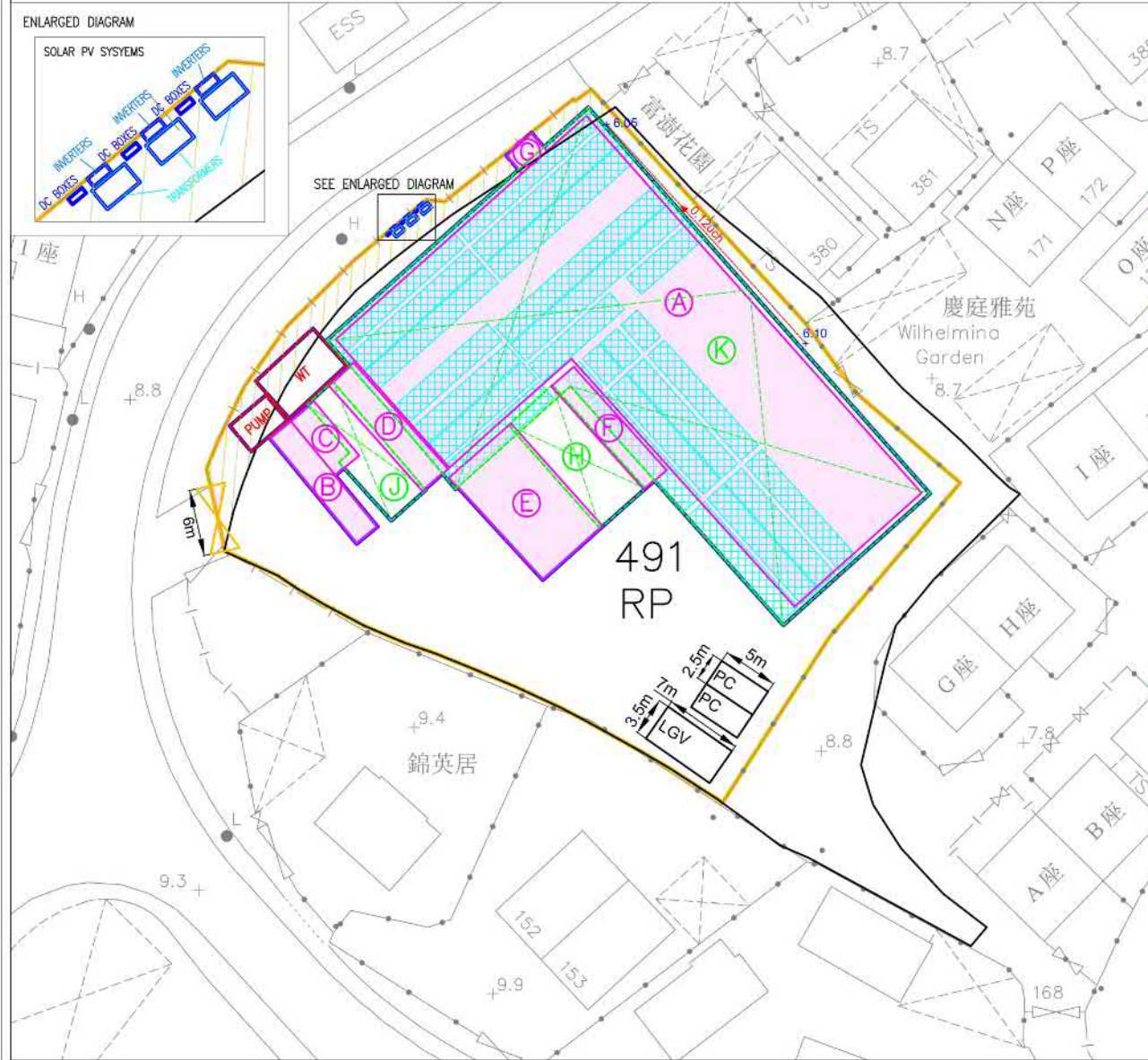

PROPOSED APPLICATION:

- LOT 491 RP BOUNDARY
- APPLICATION SITE: 2378.5 sq.m (about)
 - AREA WITHIN GOVERNMENT LAND APPLICATION SITE: 131.9 sq.m (about)
 - AREA WITHIN LOT 491 RP APPLICATION SITE: 2246.6 sq.m (about)

STRUCTURES

LEGEND	FEATURE	TYPE	HEIGHT (m)	FLOOR AREA (sq.m. about)	OVERLAPPED AREA (for information)	STOREY
	A	SHOP	6.0	929.2	-	2 [^]
	B	OFFICE	2.9	30.0	-	1
	C	OFFICE	2.7	17.7	-	1
	D	OFFICE	2.8	38.9	-	1
	E	STORAGE	3.8	91.4	-	1
	F	STORAGE	3.4	33.4	-	1
	C	TOILET	2.7	8.6	-	1
	H	SHELTER	4.5	61.9*	5.5	-
	J	SHELTER	3.1	38.0*	9.9	-
	K	SHELTER	7.4	99.4*	970.2	-
TOTAL FLOOR AREA OF A TO K				1346.5		

FIRE SERVICES FACILITIES

LEGEND	FEATURE	AREA (sq.m. about)
	SPRINKLER & F.S PUMP ROOM	12.9
	WATER TANK	31.5
TOTAL AREA		44.4

SUPPORTING FACILITIES FOR SOLAR PV SYSTEMS

LEGEND	FEATURE	DIMENSIONS (m)	TOTAL NUMBERS	TOTAL AREA (sq.m. about)
	TRANSFORMERS	0.95W x 1.0H x 0.54D	3	1.5
	INVERTERS	0.52W x 0.66H x 0.23D	3	0.4
	DC BOXES	0.4W x 0.5H x 0.15D	3	0.2
TOTAL AREA				2.1

TOTAL FLOOR AREA OF APPLIED USE(sq.m.):
 (SUM OF FEATURES A TO K, FIRE SERVICES FACILITIES AND SUPPORTING FACILITIES FOR SPV SYSTEM, EXCLUDING OVERLAPPED AREA & PV PANELS) **1393.0**

LEGEND	FEATURE	DIMENSIONS (m)	TOTAL NUMBERS	TOTAL AREA (sq.m. about)
	SOLAR PV PANELS (OVERLAID ON SHELTER K)	2,108L x 1,048W x 0,3H	291	642.9

REMARKS:
 ^ THE 2 STOREYS WILL BE REPLACED BY 1 STOREY UPON S16 APPROVAL.
 * EXCLUDED OVERLAPPED AREA WITH STRUCTURES.

- OTHER FEATURES:**
- PROPOSED SITE ENTRANCE: WIDTH 6.0m (about)
 - PC PROPOSED PRIVATE CAR PARKING SPACES: 5.0m(L) x 2.5m(W)
 - LGV PROPOSED LIGHT GOODS VEHICLE LOADING AND UNLOADING SPACE: 7.0m(L) x 3.5m(W)
 - 0.12m EXISTING DRAINAGE 0.12m WIDE U-CHANNEL 8.89 DRAINAGE BOTTOM LEVEL

PROPOSED APPLICATION
 Date: 30 DEC 2025(rev8) Scale: 1:350(A3)

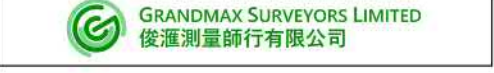

參考編號 REFERENCE No. A/TM-LTYT/500	繪圖 DRAWING A-1
---	--------------------------

(摘錄自申請人於6. 1. 2026呈交的進一步資料)
 (Extract from Applicant's Further Information Submitted on 6.1.2026)

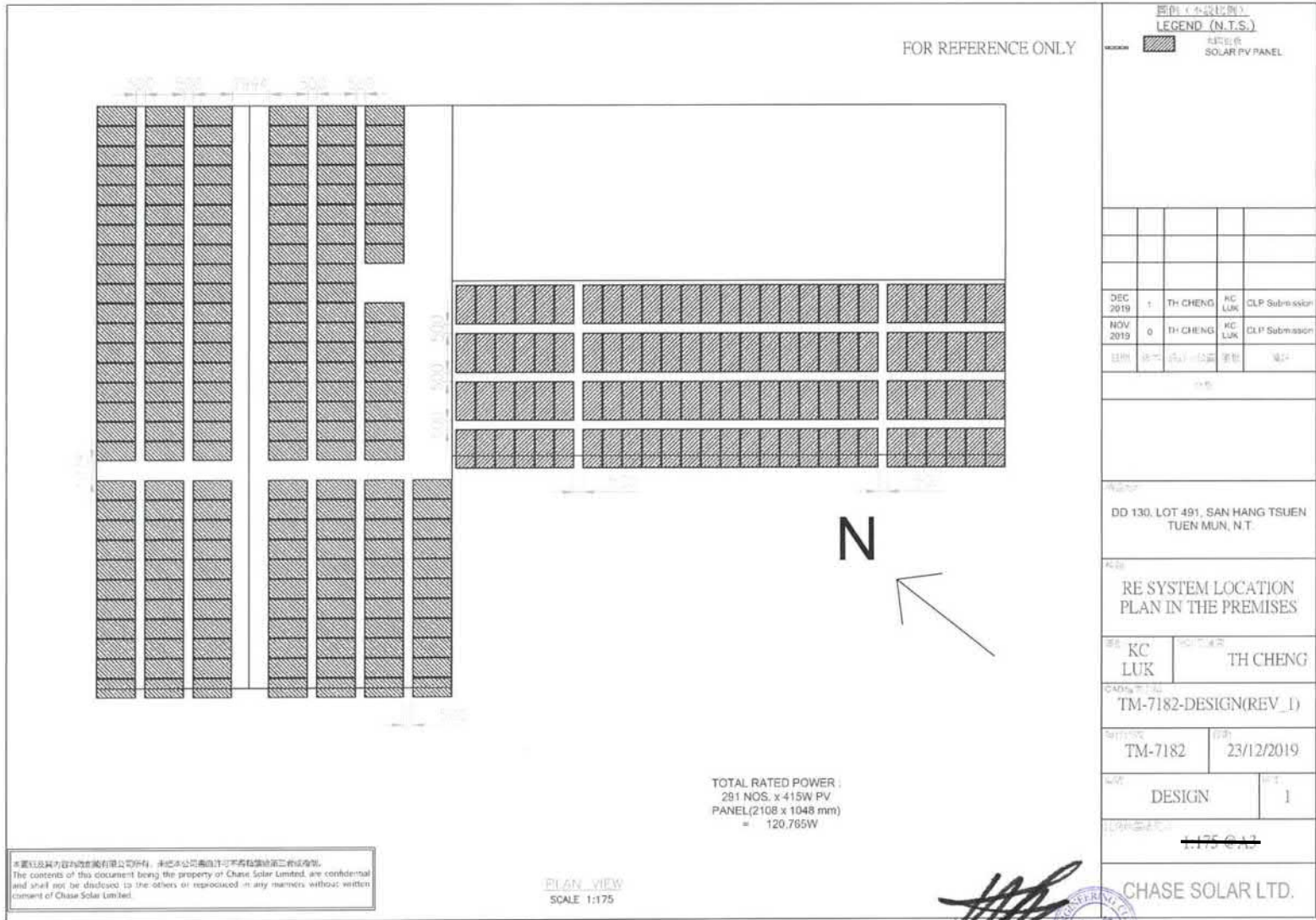

參考編號 REFERENCE No. A/TM-LTYYY/500	繪圖 DRAWING A-2
--	--------------------------

(摘錄自申請人於6. 1. 2026呈交的進一步資料)
(Extract from Applicant's Further Information Submitted on 6.1.2026)

Installation of Solar Photovoltaic System at DD130 Lot 491RP (Part)

Section Plan of Solar Panels (for indicative purpose)

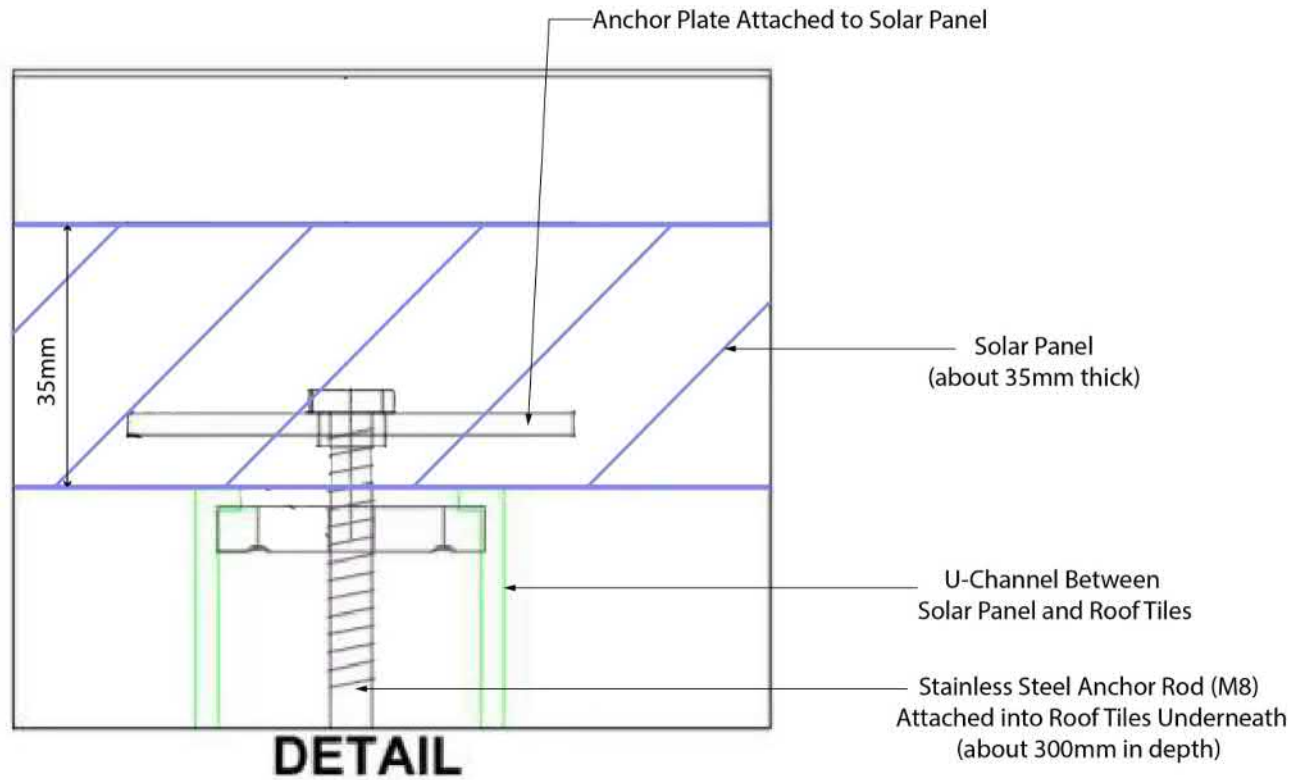

參考編號
REFERENCE No.
A/TM-LTYT/500

繪圖 DRAWING
A-3

(摘錄自申請人於6. 1. 2026呈交的進一步資料)
(Extract from Applicant's Further
Information Submitted on 6.1.2026)

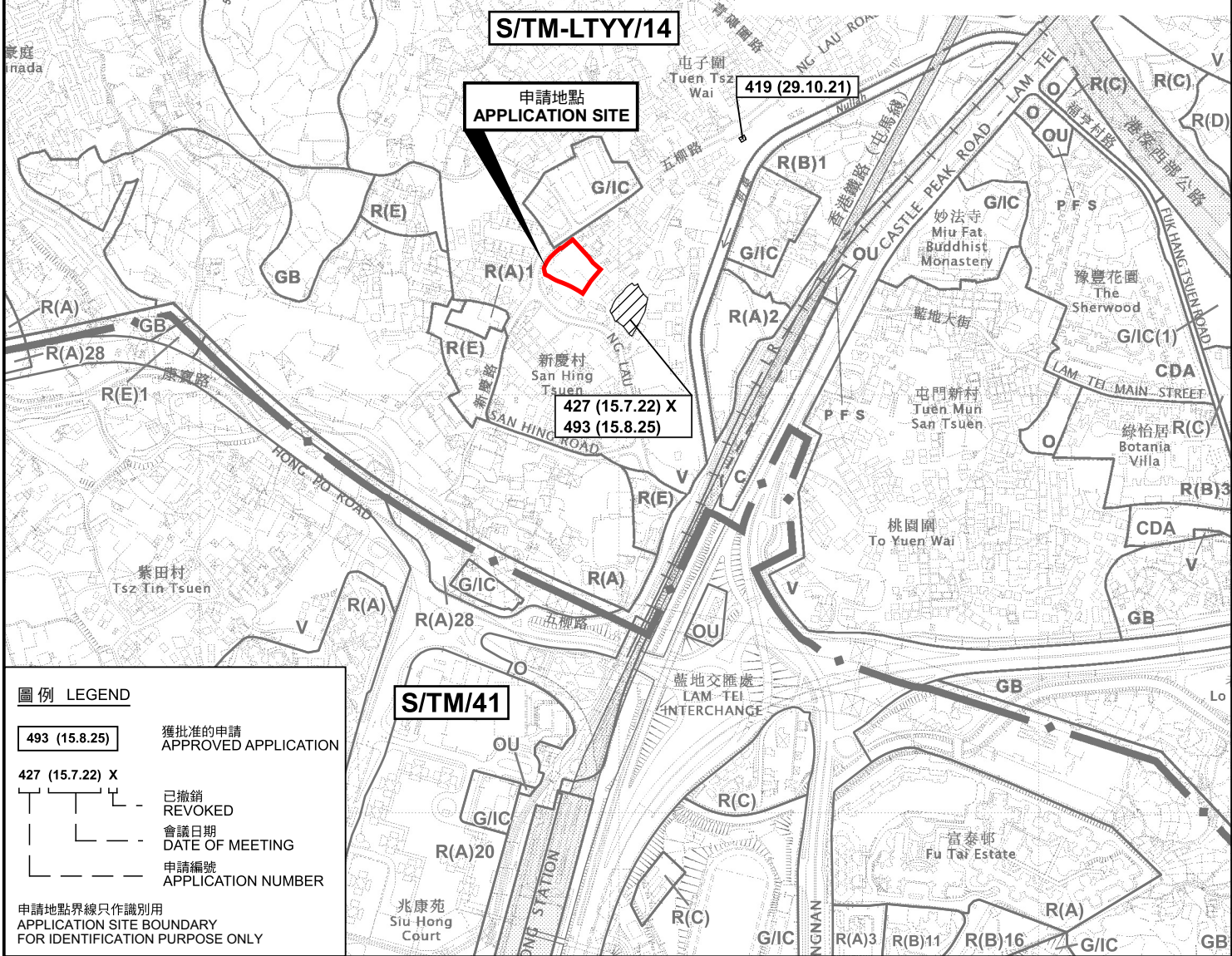
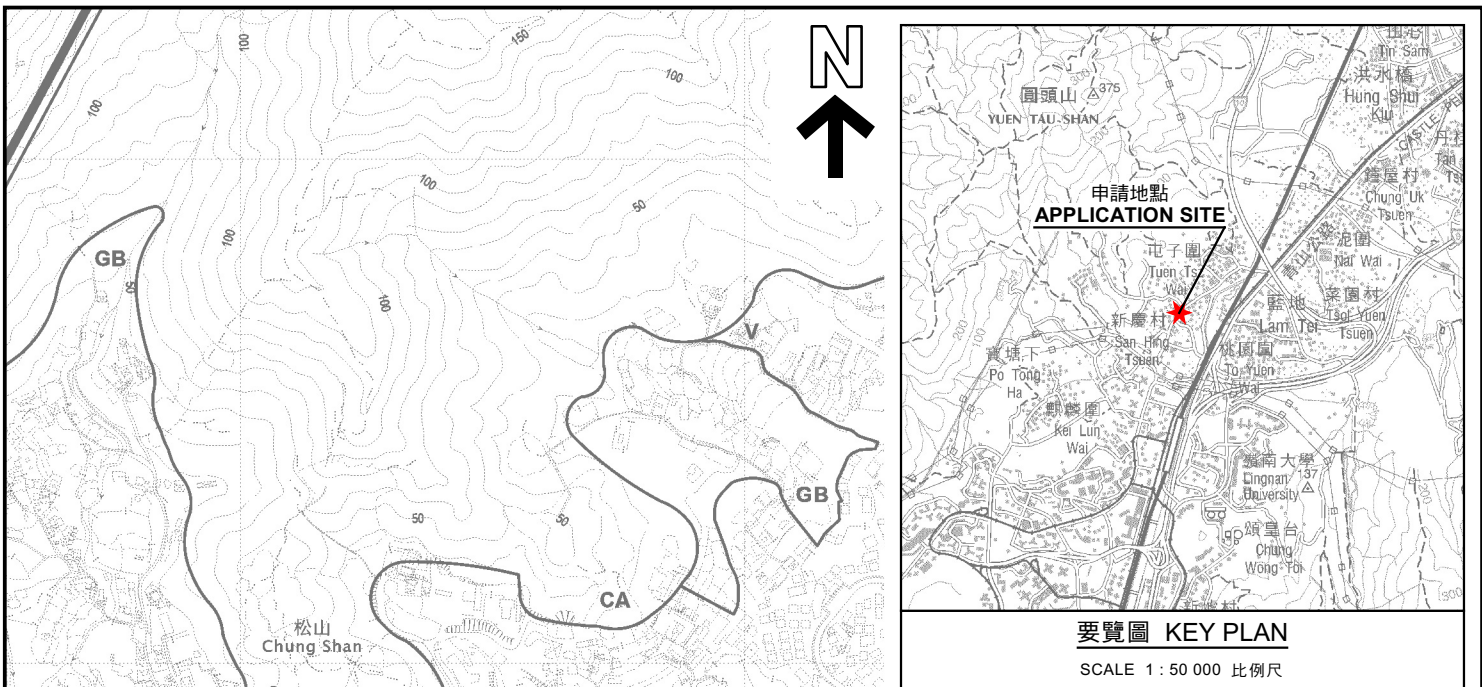

圖例 LEGEND

493 (15.8.25)	獲批准的申請 APPROVED APPLICATION
427 (15.7.22) X	已撤銷 REVOKED
—	會議日期 DATE OF MEETING
---	申請編號 APPLICATION NUMBER

申請地點界線只作識別用
APPLICATION SITE BOUNDARY
FOR IDENTIFICATION PURPOSE ONLY

本摘要圖於2026年3月31日擬備，所根據的資料為於2026年3月17日核准的分區計劃大綱圖編號 S/TM-LTY/14 EXTRACT PLAN PREPARED ON 31.3.2026 BASED ON OUTLINE ZONING PLAN No. S/TM-LTY/14 APPROVED ON 17.3.2026

位置圖 LOCATION PLAN

擬議臨時商店及服務行業(金屬製品及建築材料及器材)及公用事業設施裝置(太陽能光伏系統)連附屬設施(為期3年)
PROPOSED TEMPORARY SHOP AND SERVICES (METALWARE AND CONSTRUCTION MATERIALS AND EQUIPMENT) AND PUBLIC UTILITY INSTALLATION (SOLAR PHOTOVOLTAIC SYSTEM) WITH ANCILLARY FACILITIES FOR A PERIOD OF 3 YEARS
LOT 491 RP (PART) IN D.D. 130 AND ADJOINING GOVERNMENT LAND, LAM TEI, TUEN MUN, NEW TERRITORIES

SCALE 1 : 7 500 比例尺

米 100 0 100 200 300 米
METRES

 **規畫署**
Planning Department

參考編號 REFERENCE No.	圖 PLAN
A/TM-LTY/500	A-1

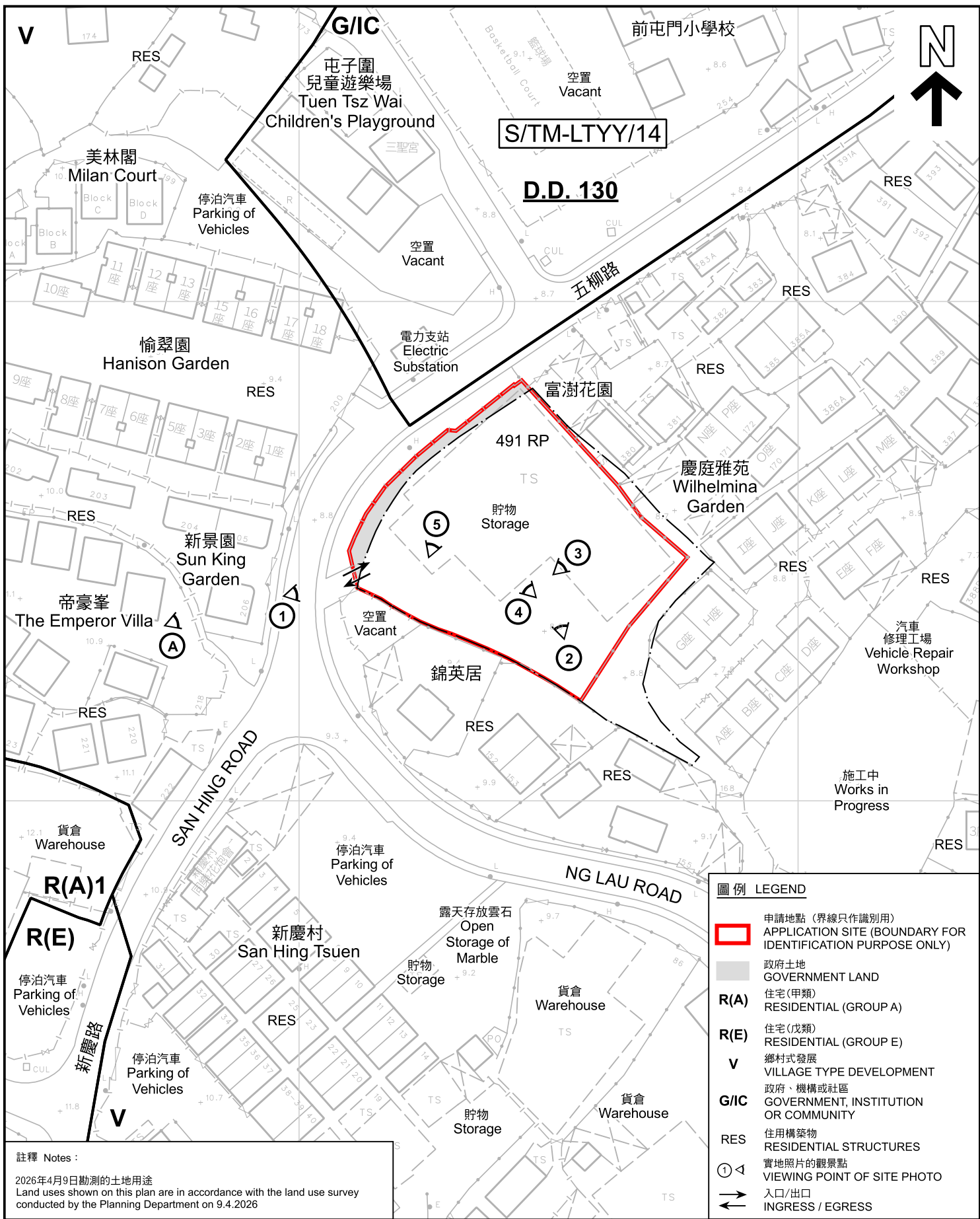

圖例 LEGEND

- 申請地點 (界線只作識別用)
APPLICATION SITE (BOUNDARY FOR IDENTIFICATION PURPOSE ONLY)
- 政府土地
GOVERNMENT LAND
- R(A)** 住宅(甲類)
RESIDENTIAL (GROUP A)
- R(E)** 住宅(戊類)
RESIDENTIAL (GROUP E)
- V** 鄉村式發展
VILLAGE TYPE DEVELOPMENT
- G/I/C** 政府、機構或社區
GOVERNMENT, INSTITUTION OR COMMUNITY
- RES** 住用構築物
RESIDENTIAL STRUCTURES
- ① ◁ 實地照片的觀景點
VIEWING POINT OF SITE PHOTO
- ↔ 入口/出口
INGRESS / EGRESS

註釋 Notes :

2026年4月9日勘測的土地用途
Land uses shown on this plan are in accordance with the land use survey conducted by the Planning Department on 9.4.2026

平面圖 SITE PLAN

本摘要圖於2026年4月10日擬備，所根據的資料為測量圖編號 6-NW-16D 和 6-NW-21B
EXTRACT PLAN PREPARED ON 10.4.2026 BASED ON SURVEY SHEETS No. 6-NW-16D and 6-NW-21B

擬議臨時商店及服務行業(金屬製品及建築材料及器材)及公用事業設施裝置(太陽能光伏系統)連附屬設施(為期3年)
PROPOSED TEMPORARY SHOP AND SERVICES (METALWARE AND CONSTRUCTION MATERIALS AND EQUIPMENT) AND PUBLIC UTILITY INSTALLATION (SOLAR PHOTOVOLTAIC SYSTEM) WITH ANCILLARY FACILITIES FOR A PERIOD OF 3 YEARS
LOT 491 RP (PART) IN D.D. 130 AND ADJOINING GOVERNMENT LAND, LAM TEI, TUEN MUN, NEW TERRITORIES

SCALE 1:1 000 比例尺

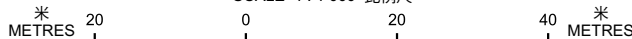

規劃署
Planning Department

參考編號
REFERENCE No.
A/TM-LTY/500

圖 PLAN
A-2



圖例 LEGEND



申請地點 (界線只作識別用)
APPLICATION SITE
(BOUNDARY FOR IDENTIFICATION
PURPOSE ONLY)

本摘要圖於2026年4月13日擬備，所根據的資料為地政總署於2024年10月10日拍得的航攝照片編號 E229865C
EXTRACT PLAN PREPARED ON 13.4.2026
BASED ON AERIAL PHOTO No.
E229865C TAKEN ON 10.10.2024
BY LANDS DEPARTMENT

航攝照片 AERIAL PHOTO

擬議臨時商店及服務行業 (金屬製品及建築材料及器材) 及公用事業設施裝置 (太陽能光伏系統) 連附屬設施 (為期3年)
新界屯門藍地丈量約份第130約地段第491號餘段 (部分) 和毗連政府土地
PROPOSED TEMPORARY SHOP AND SERVICES (METALWARE AND CONSTRUCTION MATERIALS AND EQUIPMENT) AND PUBLIC UTILITY INSTALLATION (SOLAR PHOTOVOLTAIC SYSTEM) WITH ANCILLARY FACILITIES FOR A PERIOD OF 3 YEARS
LOT 491 RP (PART) IN D.D. 130 AND ADJOINING GOVERNMENT LAND,
LAM TEI, TUEN MUN, NEW TERRITORIES



規劃署
Planning Department

參考編號
REFERENCE No.
A/TM-LTYT/500

圖 PLAN
A-3

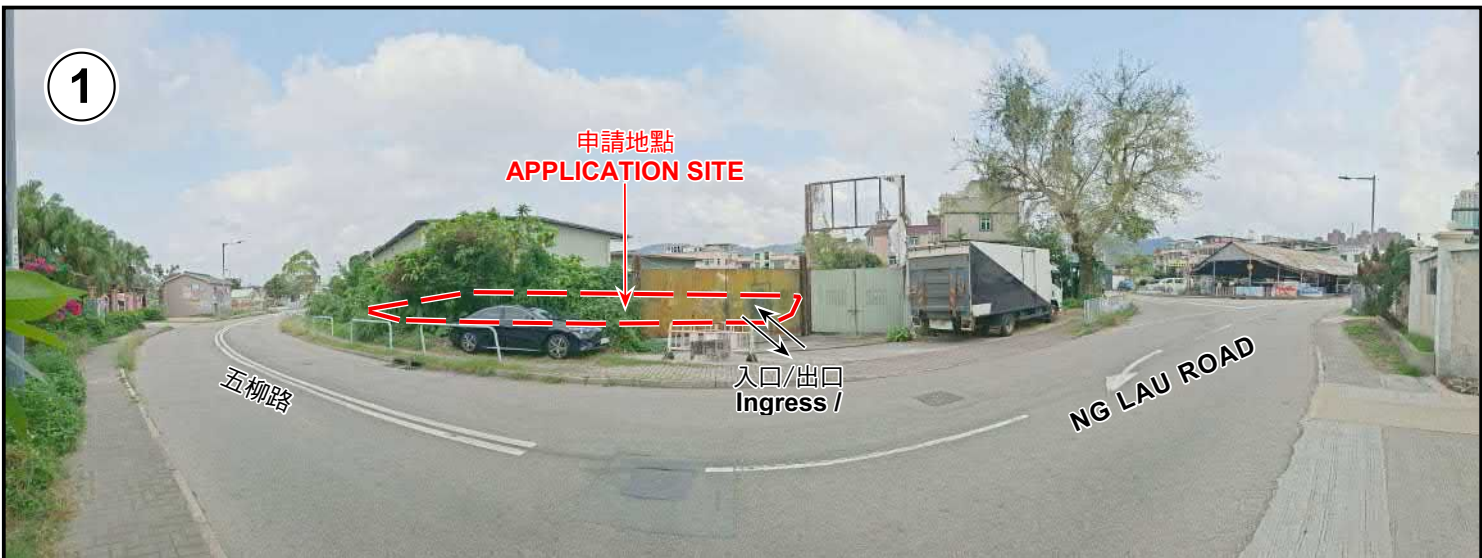

申請地點界線只作識別用 APPLICATION SITE BOUNDARY FOR IDENTIFICATION PURPOSE ONLY

實地照片 SITE PHOTOS

本圖於2026年4月10日擬備，所根據的資料為攝於2026年4月9日的實地照片
 PLAN PREPARED ON 10.4.2026
 BASED ON SITE PHOTOS
 TAKEN ON 9.4.2026

擬議臨時商店及服務行業（金屬製品及建築材料及器材）及公用事業設施裝置（太陽能光伏系統）連附屬設施（為期3年）
 PROPOSED TEMPORARY SHOP AND SERVICES (METALWARE AND CONSTRUCTION MATERIALS AND EQUIPMENT) AND PUBLIC UTILITY INSTALLATION (SOLAR PHOTOVOLTAIC SYSTEM) WITH ANCILLARY FACILITIES FOR A PERIOD OF 3 YEARS
 LOT 491 RP (PART) IN D.D. 130 AND ADJOINING GOVERNMENT LAND, LAM TEI, TUEN MUN, NEW TERRITORIES



規劃署
 Planning Department

參考編號
 REFERENCE No.
 A/TM-LTYT/500

圖 PLAN
 A-4a

4



申請地點
APPLICATION SITE

攝於2026年4月9日的實地照片
SITE PHOTO TAKEN ON 9.4.2026

5



申請地點
APPLICATION SITE

攝於2026年4月9日的實地照片
SITE PHOTO TAKEN ON 9.4.2026

A



申請地點
APPLICATION SITE

入口/出口
Ingress / Egress

攝於2026年3月12日的實地照片
SITE PHOTO TAKEN ON 12.3.2026

申請地點界線只作識別用 APPLICATION SITE BOUNDARY FOR IDENTIFICATION PURPOSE ONLY

實地照片 SITE PHOTOS

本圖於2026年4月10日擬備，所根據的資料為攝於2026年3月12日及2026年4月9日的實地照片
PLAN PREPARED ON 10.4.2026
BASED ON SITE PHOTOS
TAKEN ON 12.3.2026 & 9.4.2026

擬議臨時商店及服務行業(金屬製品及建築材料及器材)及公用事業設施裝置(太陽能光伏系統)連附屬設施(為期3年)
新界屯門藍地丈量約份第130約地段第491號餘段(部分)和毗連政府土地
PROPOSED TEMPORARY SHOP AND SERVICES (METALWARE AND CONSTRUCTION MATERIALS AND EQUIPMENT) AND PUBLIC UTILITY INSTALLATION (SOLAR PHOTOVOLTAIC SYSTEM) WITH ANCILLARY FACILITIES FOR A PERIOD OF 3 YEARS
LOT 491 RP (PART) IN D.D. 130 AND ADJOINING GOVERNMENT LAND,
LAM TEI, TUEN MUN, NEW TERRITORIES



規劃署
Planning Department

參考編號
REFERENCE No.
A/TM-LTYT/500

圖 PLAN
A-4b