



**Structure 3**  
Toilet  
GFA: 8m<sup>2</sup> (About)  
No. of storey: 1  
Height: 3m (About)

**Structure 4**  
Meter Room  
GFA: 1m<sup>2</sup> (About)  
No. of storey: 1  
Height: 3m (About)

**Structure 5**  
Site office, Security and surveillance camera room  
GFA: 30m<sup>2</sup> (About)  
No. of storey: 2  
Height: 6m (About)

**Structure 6**  
Reception and storage room  
GFA: 30m<sup>2</sup> (About)  
No. of storey: 2  
Height: 6m (About)

**Structure 2**  
Warehouse  
GFA: 200m<sup>2</sup> (About)  
No. of storey: 1  
Height: Not exceeding 9m

**Structure 1**  
Warehouse  
GFA: 220m<sup>2</sup> (About)  
No. of storey: 1  
Height: Not exceeding 9m

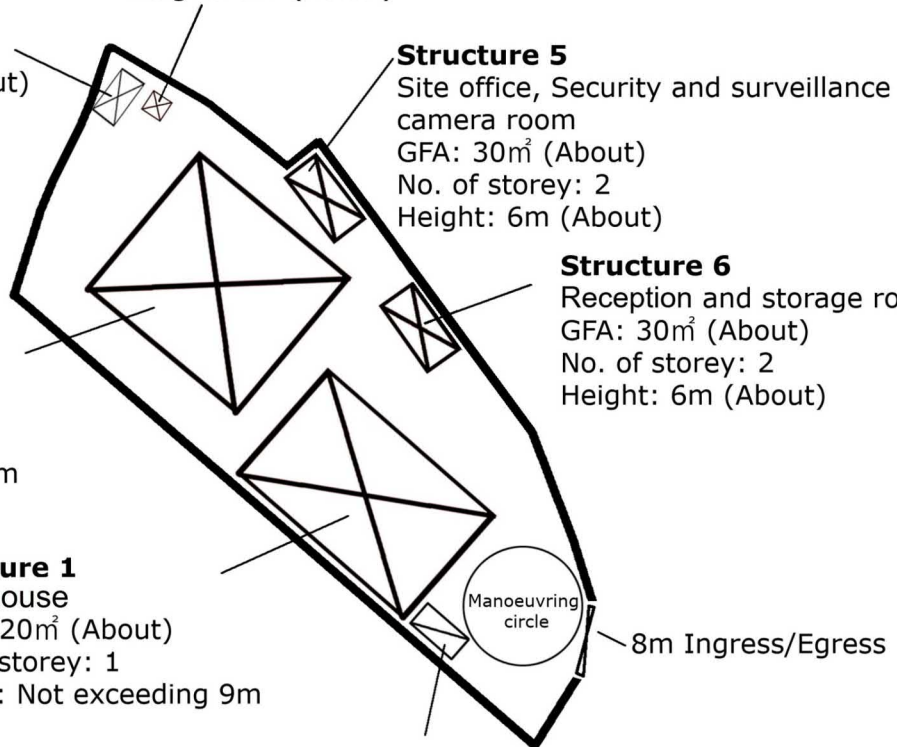

1 Loading/unloading bay of 7m x 3.5m for light goods vehicle

<p>Project 項目名稱: <b>Proposed Temporary Warehouse (Hardware Accessories) with Ancillary Office for a period of 3 Years at Lot 2205 S.B in D.D. 92, Kam Tsin Village, Sheung Shui, New Territories</b></p>	<p>Drawing Title 圖紙標題: <b>Layout Plan</b></p>		<p>Remarks 備註:</p> <ul style="list-style-type: none"> <li> Light goods vehicle</li> <li> Structure</li> </ul>
<p>Drawing No. 圖號:</p>		<p>Scale 比例:</p>	

(摘錄自申請人於 25. 3. 2026 呈交的申請書)  
(Extract from Applicant's Submission of 25.3.2026)

<p>參考編號 REFERENCE No. <b>A/NE-KTS/575</b></p>	<p>繪圖 DRAWING <b>A - 1</b></p>
---	--

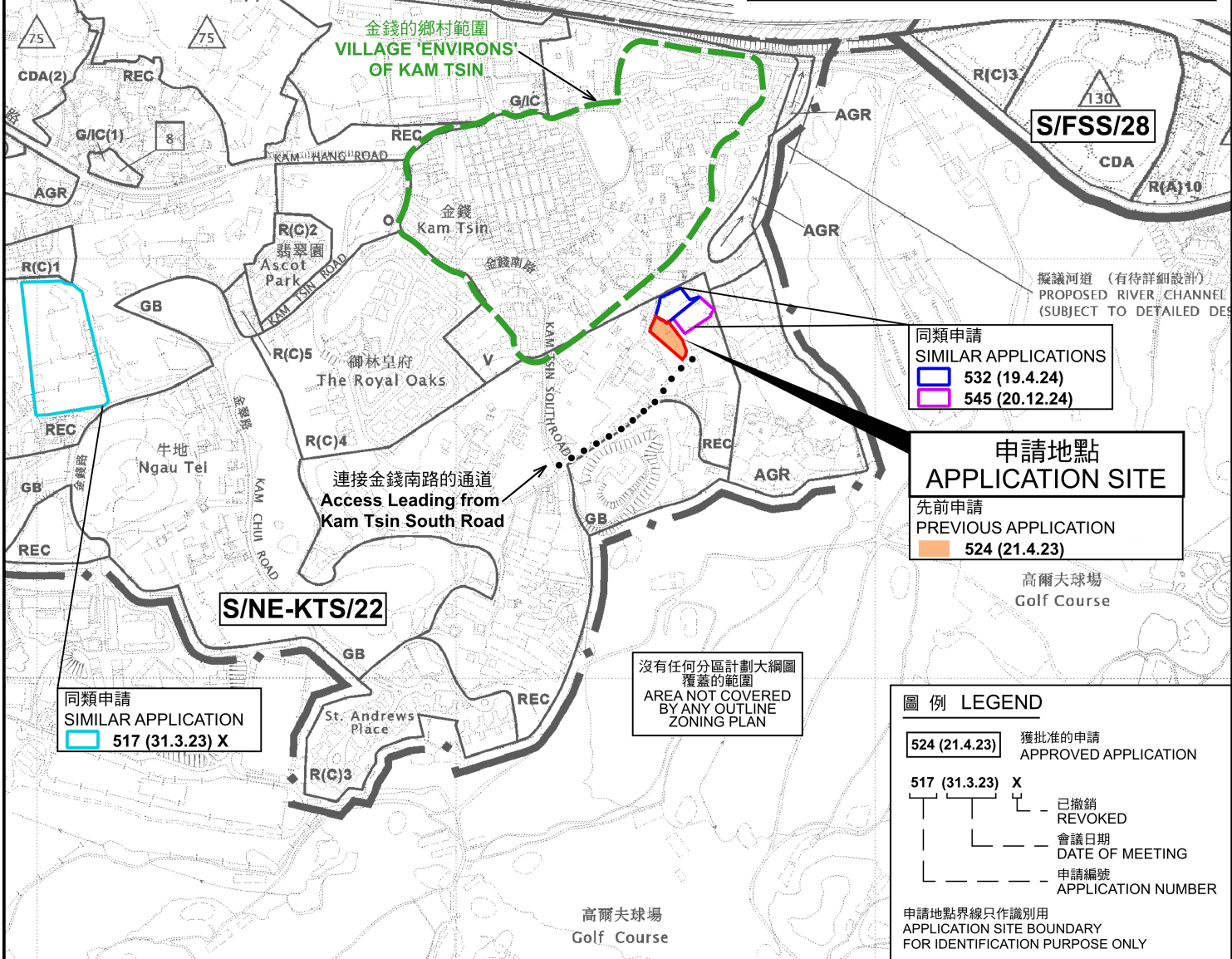
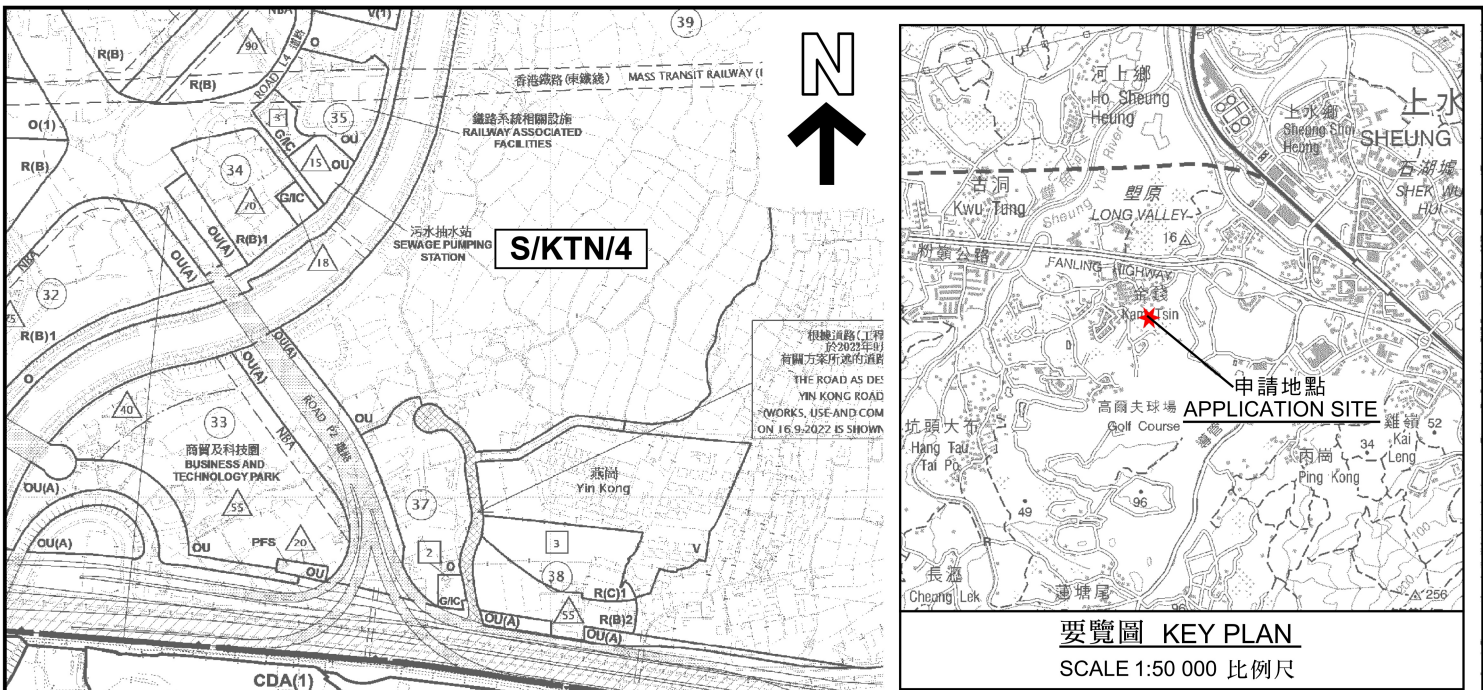

本摘要圖於2026年5月13日擬備，所根據的資料為於2025年2月11日核准的分區計劃大綱圖編號 S/NE-KTS/22

EXTRACT PLAN PREPARED ON 13.5.2026 BASED ON OUTLINE ZONING PLAN No. S/NE-KTS/22 APPROVED ON 11.2.2025

位置圖 LOCATION PLAN

臨時貨倉(五金零件)連附屬辦公室(為期3年)  
上水古洞南金錢村丈量約份第92約地段第2205號B分段  
TEMPORARY WAREHOUSE (HARDWARE ACCESSORIES)  
WITH ANCILLARY OFFICE FOR A PERIOD OF 3 YEARS  
LOT 2205 S.B IN D.D.92, KAM TSIN VILLAGE,  
KWU TUNG SOUTH, SHEUNG SHUI

SCALE 1:7 500 比例尺

米 METRES 100 0 100 200 300 米 METRES

規劃署 Planning Department

參考編號 REFERENCE No. A/NE-KTS/575

圖 PLAN A-1

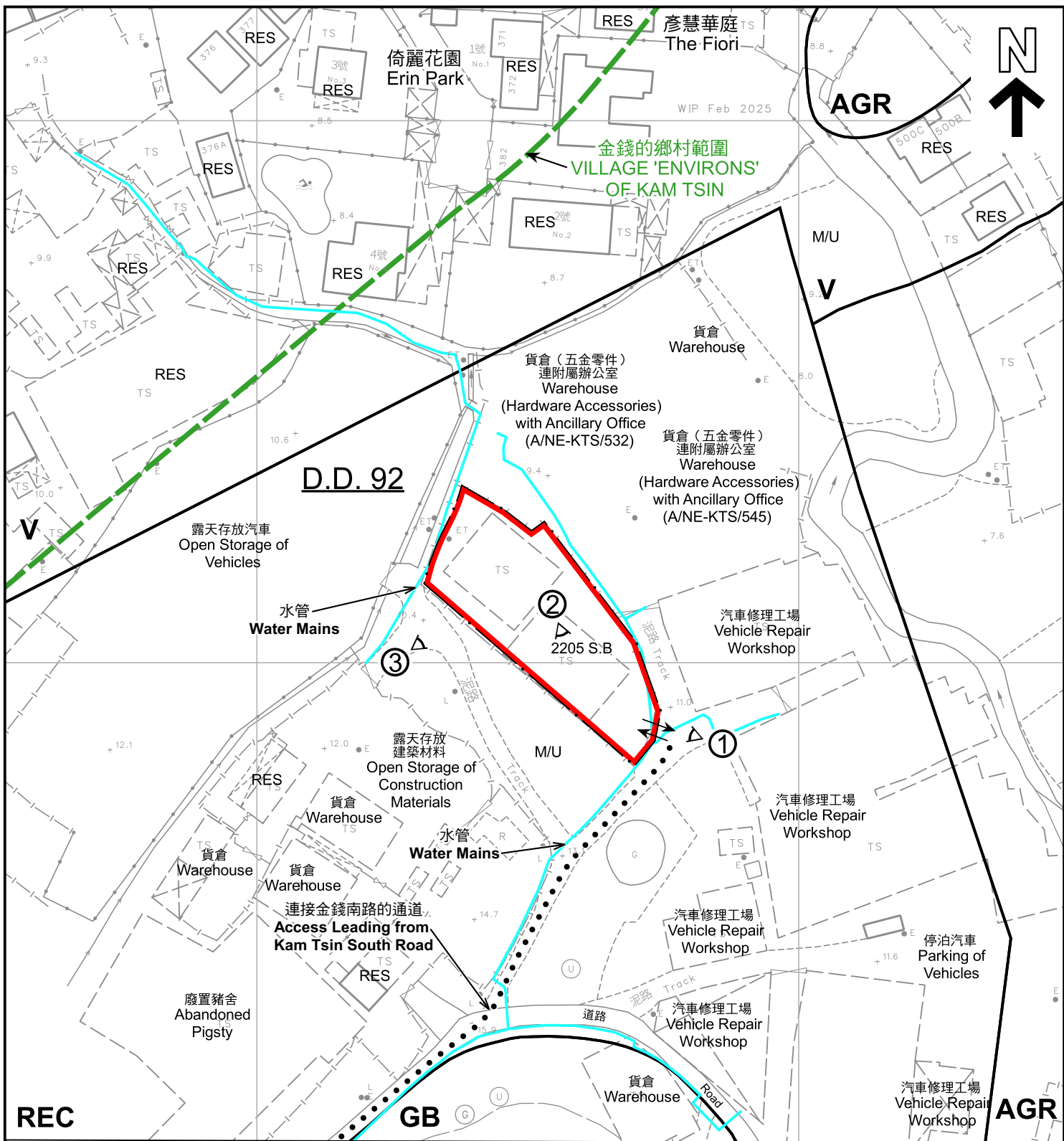

<b>圖例 LEGEND</b>			
	申請地點(界線只作識別用) APPLICATION SITE (BOUNDARY FOR IDENTIFICATION PURPOSE ONLY)	<b>AGR</b>	農業 AGRICULTURE
<b>V</b>	鄉村式發展 VILLAGE TYPE DEVELOPMENT	<b>GB</b>	綠化地帶 GREEN BELT
<b>REC</b>	康樂 RECREATION	<b>RES</b>	住用構築物 RESIDENTIAL STRUCTURES
		<b>M/U</b>	荒地 Unused Land
			入口/出口 INGRESS / EGRESS
			實地照片的觀景點 VIEWING POINT OF SITE PHOTO
		<b>註釋 Note :</b>	
		2026年3月31日勘测的土地用途 Land uses shown on this plan are in accordance with the land use survey conducted by the Planning Department on 31.3.2026	

本摘要圖於2026年5月13日擬備， 所根據的資料為測量圖編號 2-SE-10D EXTRACT PLAN PREPARED ON 13.5.2026 BASED ON SURVEY SHEET No. 2-SE-10D	<b>平面圖 SITE PLAN</b>  臨時貨倉(五金零件)連附屬辦公室(為期3年) 上古洞南金錢村丈量約份第92約地段第2205號B分段 TEMPORARY WAREHOUSE (HARDWARE ACCESSORIES) WITH ANCILLARY OFFICE FOR A PERIOD OF 3 YEARS LOT 2205 S.B IN D.D.92, KAM TSIN VILLAGE, KWU TUNG SOUTH, SHEUNG SHUI		 <b>規劃署</b> Planning Department
	SCALE 1 : 1 000 比例尺 		



**圖例 LEGEND**

-  申請地點 (界線只作識別用)  
APPLICATION SITE  
(BOUNDARY FOR IDENTIFICATION  
PURPOSE ONLY)
-  入口/出口  
INGRESS / EGRESS

**航攝照片 AERIAL PHOTO**

本摘要圖於2026年4月20日擬備，  
所根據的資料為地政總署於2025年6月10日  
拍得的航攝照片編號 E257882C  
EXTRACT PLAN PREPARED ON 20.4.2026  
BASED ON AERIAL PHOTO No.  
E257882C TAKEN ON 10.6.2025  
BY LANDS DEPARTMENT

臨時貨倉 (五金零件) 連附屬辦公室 (為期3年)  
上古洞南金錢村丈量約份第92約地段第2205號B分段  
TEMPORARY WAREHOUSE (HARDWARE ACCESSORIES)  
WITH ANCILLARY OFFICE FOR A PERIOD OF 3 YEARS  
LOT 2205 S.B IN D.D.92, KAM TSIN VILLAGE,  
KWU TUNG SOUTH, SHEUNG SHUI



**規劃署**  
Planning Department

參考編號  
REFERENCE No.  
**A/NE-KTS/575**

圖 PLAN  
**A-3**



申請地點界線只作識別用  
APPLICATION SITE BOUNDARY FOR IDENTIFICATION PURPOSE ONLY

### 實地照片 SITE PHOTOS

本圖於2026年5月6日擬備，所根據的資料為攝於2026年4月10日及5月5日的實地照片  
PLAN PREPARED ON 6.5.2026  
BASED ON SITE PHOTOS  
TAKEN ON 10.4.2026 & 5.5.2026

臨時貨倉（五金零件）連附屬辦公室（為期3年）  
上水古洞南金錢村丈量約份第92約地段第2205號B分段  
TEMPORARY WAREHOUSE (HARDWARE ACCESSORIES)  
WITH ANCILLARY OFFICE FOR A PERIOD OF 3 YEARS  
LOT 2205 S.B IN D.D.92, KAM TSIN VILLAGE,  
KWU TUNG SOUTH, SHEUNG SHUI



規劃署  
Planning Department

參考編號  
REFERENCE No.  
A/NE-KTS/575

圖 PLAN  
A-4