

(摘錄自申請人於 10. 9. 2025 呈交的申請書)  
 (Extract from Applicant's Submission of 10.9.2025)

參考編號 REFERENCE No. A/YL-TT/737	繪圖 DRAWING A-1
--------------------------------------	-------------------

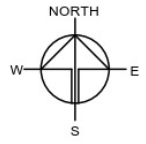

**DEVELOPMENT PARAMETERS**

APPLICATION SITE AREA	: 2,109 m <sup>2</sup>	(ABOUT)
COVERED AREA	: 1,806 m <sup>2</sup>	(ABOUT)
UNCOVERED AREA	: 303 m <sup>2</sup>	(ABOUT)
PLOT RATIO	: 0.86	(ABOUT)
SITE COVERAGE	: 86%	(ABOUT)
NO. OF STRUCTURE	: 2	
DOMESTIC GFA	: NOT APPLICABLE	
NON-DOMESTIC GFA	: 1,806 m <sup>2</sup>	(ABOUT)
TOTAL GFA	: 1,806 m <sup>2</sup>	(ABOUT)
BUILDING HEIGHT	: 9 m	(ABOUT)
NO. OF STOREY	: 1	

STRUCTURE	USE	COVERED AREA	GROSS FLOOR AREA	BUILDING HEIGHT
B1	WAREHOUSE (EXCLUDING D.G.G.), SITE OFFICE AND WASHROOM	1,806 m <sup>2</sup> (ABOUT)	1,806 m <sup>2</sup> (ABOUT)	9 m (ABOUT)(1-STOREY)
<b>TOTAL</b>		<b>1,806 m<sup>2</sup> (ABOUT)</b>	<b>1,806 m<sup>2</sup> (ABOUT)</b>	

\*D.G.G. - DANGEROUS GOODS GODOWN

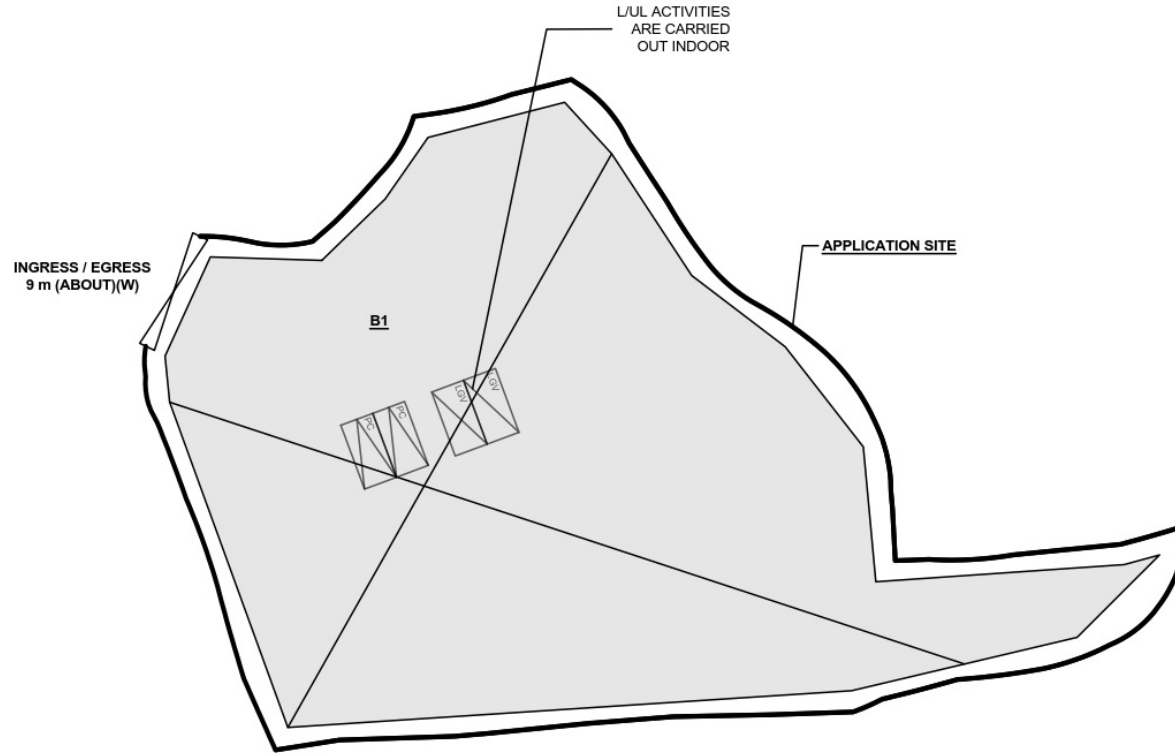

**PARKING PROVISION**

NO. OF PRIVATE CAR PARKING SPACE	: 2
DIMENSION OF PARKING SPACE	: 5 m (L) X 2.5 m (W)

**LOADING/UNLOADING (L/UL) PROVISION**

NO. OF L/UL SPACE FOR LIGHT GOODS VEHICLE	: 2
DIMENSION OF LOADING/UNLOADING SPACE	: 7 m (L) X 3.5 m (W)

**LEGEND**

- APPLICATION SITE
- STRUCTURE (ENCLOSED)
- PARKING SPACE (PC)
- LOADING / UNLOADING SPACE (LGV)
- INGRESS / EGRESS

PLANNING CONSULTANT	
PROJECT	
PROPOSED WAREHOUSE (EXCLUDING DANGEROUS GOODS GODOWN) WITH ANCILLARY FACILITIES AND ASSOCIATED FILLING OF LAND FOR A PERIOD OF 3 YEARS	TEMPORARY (EXCLUDING DANGEROUS GOODS GODOWN)
SITE LOCATION	
LOTS 1937 (PART) AND 1938 IN D.D. 118, TAI TONG, YUEN LONG, NEW TERRITORIES	
SCALE	
1:500 @ A1	
DRAWN BY	DATE
DN	5.3.2026
CHECKED BY	DATE
APPROVED BY	DATE
DWG. TITLE	
LAYOUT PLAN	
DWG NO.	VER.
PLAN 4	001

(摘錄自申請人於 16. 4. 2026 呈交的進一步資料)  
**(Extract from Applicant's Further Information Submitted on 16.4.2026)**

參考編號 REFERENCE No. <b>A/YL-TT/737</b>	繪圖 DRAWING <b>A-2</b>
---	--------------------------

**EXISTING CONDITION OF THE APPLICATION SITE**

APPLICATION SITE AREA	: 2,109 m <sup>2</sup>	(ABOUT)
EXISTING SOILED GROUND AREA	: 2,109 m <sup>2</sup>	(ABOUT)
EXISTING PAVED AREA	: 1,672 m <sup>2</sup>	(ABOUT)
EXISTING UNPAVED AREA	: 437 m <sup>2</sup>	(ABOUT)
EXISTING SITE LEVELS	: + 19.6 mPD to + 19.8 mPD	(ABOUT)

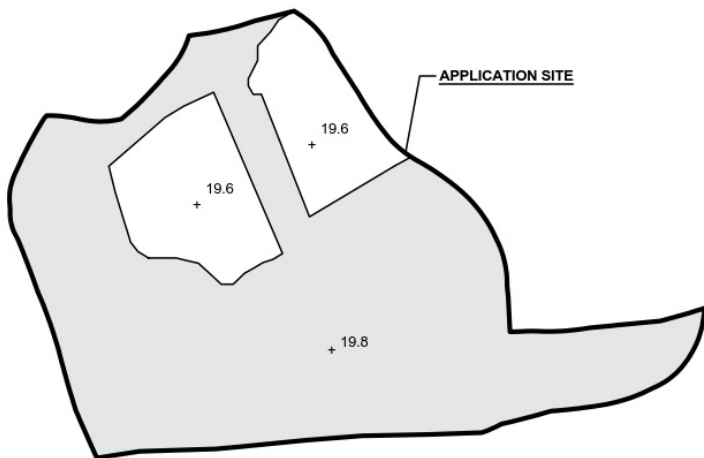

SITE BOUNDARY FOR IDENTIFICATION PURPOSE ONLY.

**FILLING OF LAND AREA OF THE APPLICATION SITE**

APPLICATION SITE AREA	: 2,109 m <sup>2</sup>	(ABOUT)
COVERED BY STRUCTURE	: 1,806 m <sup>2</sup>	(ABOUT)
PROPOSED FILLING OF LAND AREA	: 2,040 m <sup>2</sup>	(ABOUT)
DEPTH OF LAND FILLING	: NOT MORE THAN 0.2 m	
PROPOSED SITE LEVEL	: +19.8 mPD to +19.8 mPD	(ABOUT)
MATERIAL OF LAND FILLING	: CONCRETE	
PURPOSE OF LAND FILLING	: SITE FORMATION OF STRUCTURES AND CIRCULATION AREA	

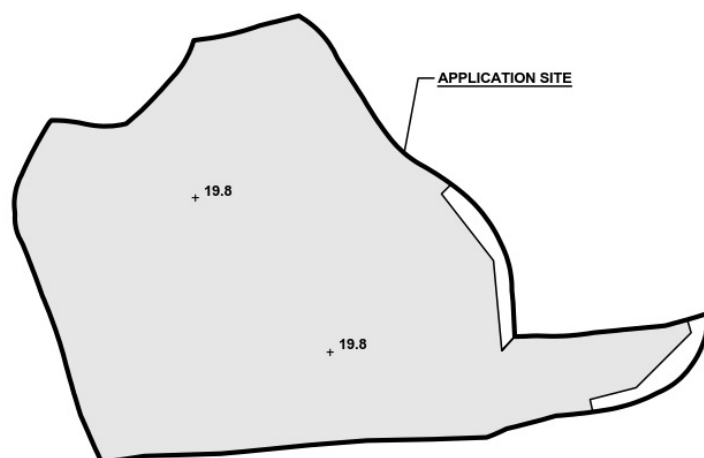

**LEGEND**

- APPLICATION SITE
- FILLING OF LAND AREA
- PROPOSED SITE LEVEL

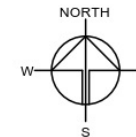

PLANNING CONSULTANT



PROJECT

PROPOSED WAREHOUSE (EXCLUDING DANGEROUS GOODS GODOWN) WITH ANCILLARY FACILITIES AND ASSOCIATED FILLING OF LAND FOR A PERIOD OF 3 YEARS

SITE LOCATION

LOTS 1937 (PART) AND 1938 IN D.D. 118, TAI TONG, YUEN LONG, NEW TERRITORIES

SCALE

1:750 @ A1

DRAWN BY	DATE
DN	16.4.2026
CHECKED BY	DATE
APPROVED BY	DATE

DWG. TITLE  
FILLING OF LAND AREA

DWG NO. PLAN 5	VER. 001
-------------------	-------------

(摘錄自申請人於 16. 4. 2026 呈交的進一步資料)  
(Extract from Applicant's Further Information Submitted on 16.4.2026)

參考編號  
REFERENCE No.  
A/YL-TT/737

繪圖 DRAWING  
A-3

**SWEPT PATH ANALYSIS**

TYPE OF VEHICLE : CONTAINER VEHICLE  
 DIMENSION OF VEHICLE : 2.5 m (W) X 16 m (L)

SWEPT PATHS GENERATED BY AUTODESK VEHICLE TRACKING

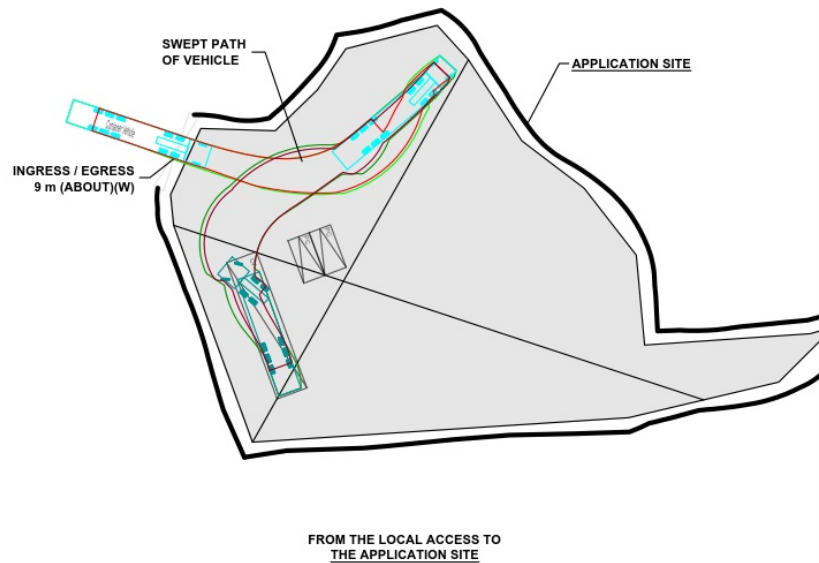

FROM THE LOCAL ACCESS TO THE APPLICATION SITE

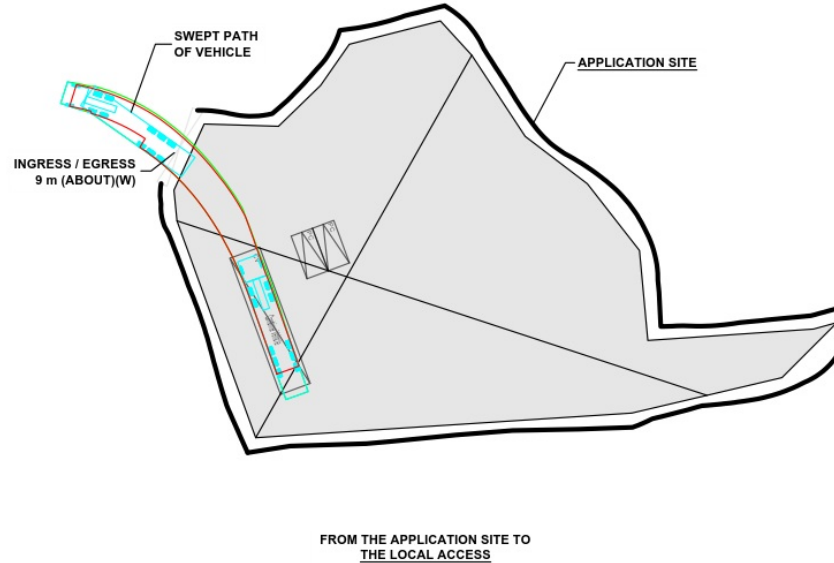

FROM THE APPLICATION SITE TO THE LOCAL ACCESS

SITE BOUNDARY FOR IDENTIFICATION PURPOSE ONLY.

**LEGEND**

- APPLICATION SITE
- STRUCTURE
- PARKING SPACE (PC)
- LOADING / UNLOADING SPACE (CV)
- INGRESS / EGRESS
- CONTAINER VEHICLE
- SWEPT PATH OF VEHICLE

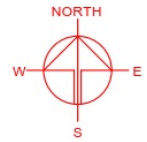

PLANNING CONSULTANT



PROJECT

PROPOSED WAREHOUSE WITH ANCILLARY FACILITIES AND ASSOCIATED FILLING OF LAND FOR A PERIOD OF 3 YEARS (EXCLUDING DANGEROUS GOODS GODOWN)

SITE LOCATION

LOTS 1937 (PART) AND 1938 IN D.D. 118, TAI TONG, YUEN LONG, NEW TERRITORIES

SCALE

1:750 @ A1

DRAWN BY

MN

DATE

31.7.2025

CHECKED BY

DATE

APPROVED BY

DATE

DWG. TITLE

SWEPT PATH ANALYSIS

DWG NO.

PLAN 6

VER.

001

(摘錄自申請人於 10. 9. 2025 呈交的申請書)  
 (Extract from Applicant's Submission of 10.9.2025)

參考編號  
 REFERENCE No.  
 A/YL-TT/737

繪圖 DRAWING  
 A-4

**LANDSCAPE PROPOSAL**

APPLICATION SITE AREA	: 2,109 m <sup>2</sup>	(ABOUT)
COVERED AREA	: 1,806 m <sup>2</sup>	(ABOUT)
UNCOVERED AREA	: 303 m <sup>2</sup>	(ABOUT)

NO. OF NEW TREES TO BE PLANTED	: 15 (N1 TO N15)
SPECIES OF NEW TREES	: BAUHINIA BLAKEANA
HEIGHT OF NEW TREES	: NO LESS THAN 2.75 m
SPACING OF NEW TREES	: NOT LESS THAN 3 m
DIMENSION OF PLANTING STRIP	: 1 m (W) 1 m X (L) X 1.2 m (D)

**NOTES:**

- 1) THE APPLICANT WILL MAINTAIN TREES IN GOOD CONDITION DURING THE PLANNING APPROVAL PERIOD.
- 2) THE APPLICANT WILL REPLACE TREES WHICH ARE DYING OR DEAD DURING THE PLANNING APPROVAL PERIOD.
- 3) THE APPLICANT WILL PROVIDE ADEQUATE IRRIGATION FOR TREES.

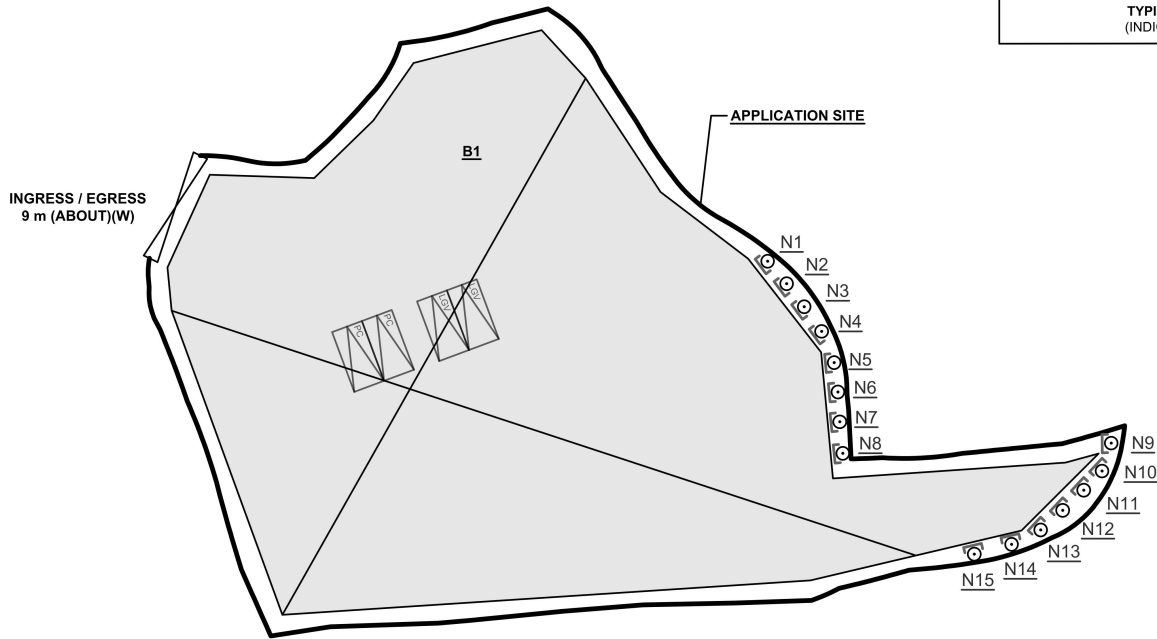
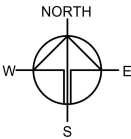
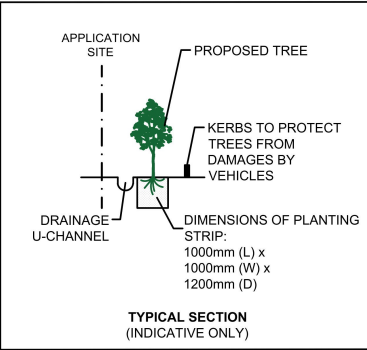

PLANNING CONSULTANT



PROJECT  
 PROPOSED TEMPORARY WAREHOUSE (EXCLUDING DANGEROUS GOODS GODOWN) WITH ANCILLARY FACILITIES AND ASSOCIATED FILLING OF LAND FOR A PERIOD OF 3 YEARS

SITE LOCATION  
 LOTS 1937 (PART) AND 1938 IN D.D. 118, TAI TONG, YUEN LONG, NEW TERRITORIES

SCALE  
 1:500 @ A4

DRAWN BY DN	DATE 5.3.2026
CHECKED BY	DATE
APPROVED BY	DATE

DWG. TITLE  
 LANDSCAPE PROPOSAL

DWG NO. PLAN 7	VER. 001
-------------------	-------------

**PARKING PROVISION**

NO. OF PRIVATE CAR PARKING SPACE	: 2
DIMENSION OF PARKING SPACE	: 5 m (L) X 2.5 m (W)

**LOADING/UNLOADING (L/UL) PROVISION**

NO. OF L/UL SPACE FOR LIGHT GOODS VEHICLE	: 2
DIMENSION OF LOADING/UNLOADING SPACE	: 7 m (L) X 3.5 m (W)

**LEGEND**

- APPLICATION SITE
- STRUCTURE (ENCLOSED)
- PARKING SPACE (PC)
- LOADING / UNLOADING SPACE (LGV)
- INGRESS / EGRESS

(摘錄自申請人於 16. 4. 2026 呈交的進一步資料)  
 (Extract from Applicant's Further Information Submitted on 16.4.2026)

參考編號  
 REFERENCE No.  
 A/YL-TT/737

繪圖 DRAWING  
 A-5

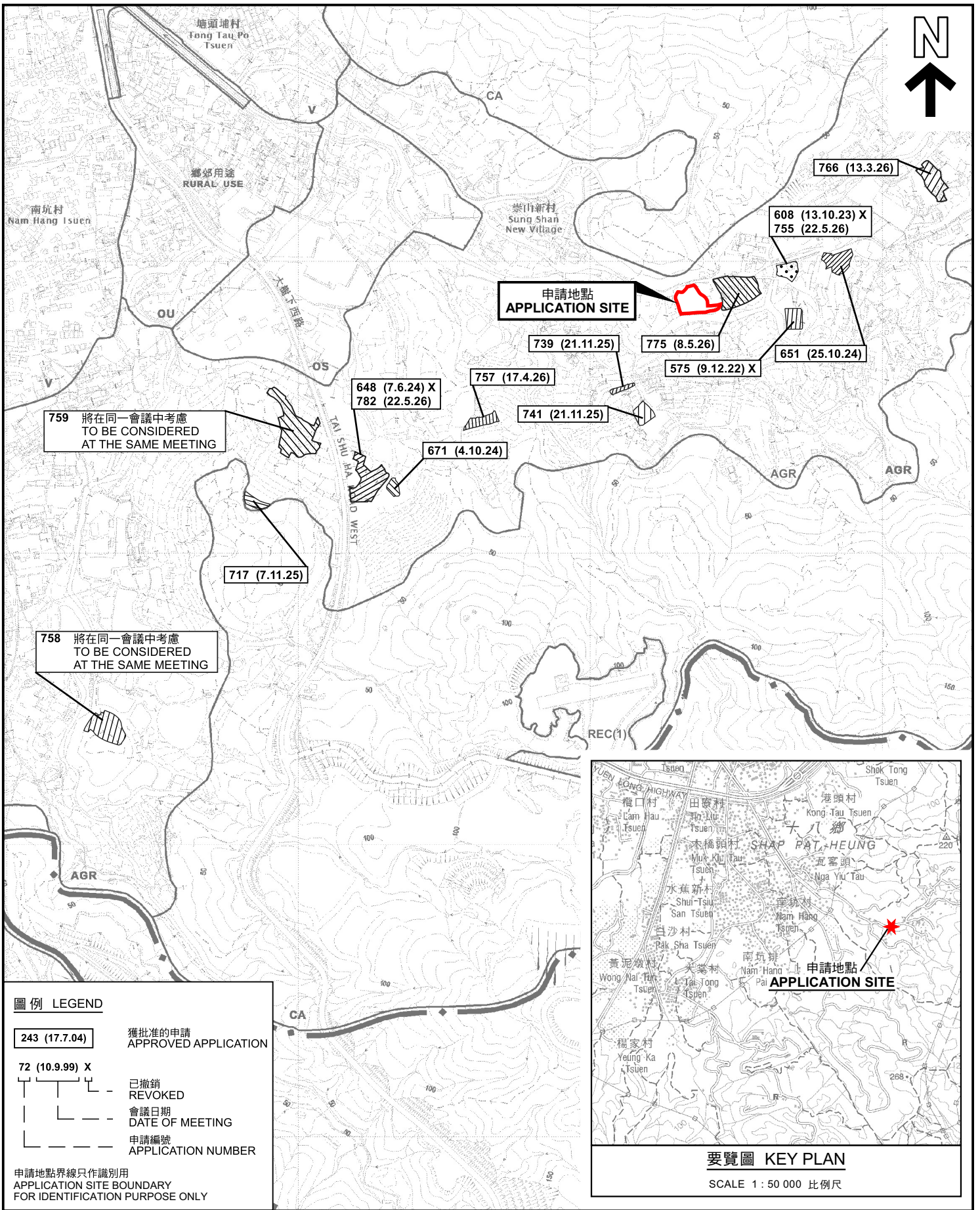

**圖例 LEGEND**

**243 (17.7.04)** 獲批准的申請  
APPROVED APPLICATION

**72 (10.9.99) X** 已撤銷  
REVOKED

— 會議日期  
DATE OF MEETING

— 申請編號  
APPLICATION NUMBER

申請地點界線只作識別用  
APPLICATION SITE BOUNDARY  
FOR IDENTIFICATION PURPOSE ONLY

**要覽圖 KEY PLAN**

SCALE 1 : 50 000 比例尺

本摘要圖於2026年5月28日擬備，  
所根據的資料為於2023年12月5日  
核准的分區計劃大綱圖編號 S/YL-TT/20  
EXTRACT PLAN PREPARED ON 28.5.2026  
BASED ON OUTLINE ZONING PLAN No.  
S/YL-TT/20 APPROVED ON 5.12.2023

**位置圖及同類申請 LOCATION PLAN WITH SIMILAR APPLICATIONS**

擬議臨時貨倉(危險品倉庫除外)連附屬設施及相關的填土工程(為期3年)  
元朗大棠丈量約份第118約地段第1937號(部分)及1938號  
PROPOSED TEMPORARY WAREHOUSE (EXCLUDING  
DANGEROUS GOODS GODOWN) WITH ANCILLARY FACILITIES  
AND ASSOCIATED FILLING OF LAND FOR A PERIOD OF 3 YEARS  
LOTS 1937 (PART) AND 1938 IN D.D.118, TAI TONG, YUEN LONG

SCALE 1 : 8 500 比例尺

米 100 0 100 200 300 400 米  
METRES METRES

**規畫署**  
Planning Department

參考編號  
REFERENCE No.  
**A/YL-TT/737**

**圖 PLAN**  
A-1a

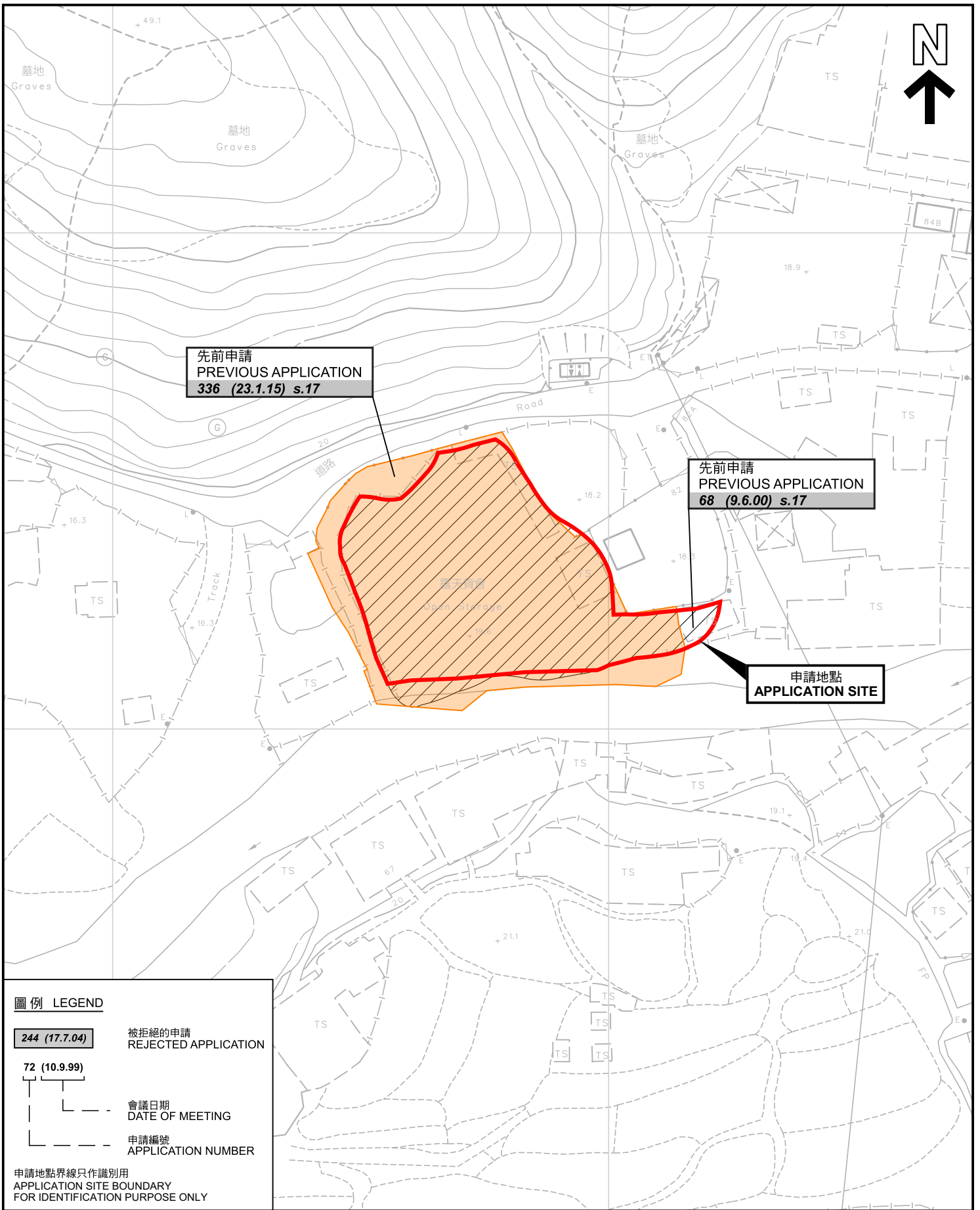

先前申請  
PREVIOUS APPLICATION  
336 (23.1.15) s.17

先前申請  
PREVIOUS APPLICATION  
68 (9.6.00) s.17

申請地點  
APPLICATION SITE

**圖例 LEGEND**

- 244 (17.7.04) 被拒絕的申請  
REJECTED APPLICATION
- 72 (10.9.99) 會議日期  
DATE OF MEETING
- 申請編號  
APPLICATION NUMBER

申請地點界線只作識別用  
APPLICATION SITE BOUNDARY  
FOR IDENTIFICATION PURPOSE ONLY

**先前申請圖 PREVIOUS APPLICATIONS PLAN**

擬議臨時貨倉(危險品倉庫除外)連附屬設施及相關的填土工程(為期3年)  
元朗大棠丈量約份第118約地段第1937號(部分)及1938號  
PROPOSED TEMPORARY WAREHOUSE (EXCLUDING  
DANGEROUS GOODS GODOWN) WITH ANCILLARY FACILITIES  
AND ASSOCIATED FILLING OF LAND FOR A PERIOD OF 3 YEARS  
LOTS 1937 (PART) AND 1938 IN D.D.118, TAI TONG, YUEN LONG



**規劃署**  
Planning Department

參考編號  
REFERENCE No.  
**A/YL-TT/737**

**圖 PLAN**  
**A-1b**

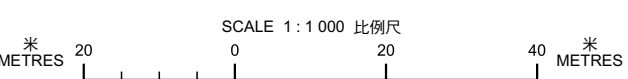

本摘要圖於2026年5月14日擬備，所根據的  
資料為測量圖編號 6-NE-16C  
EXTRACT PLAN PREPARED ON 14.5.2026  
BASED ON SURVEY SHEET No.  
6-NE-16C

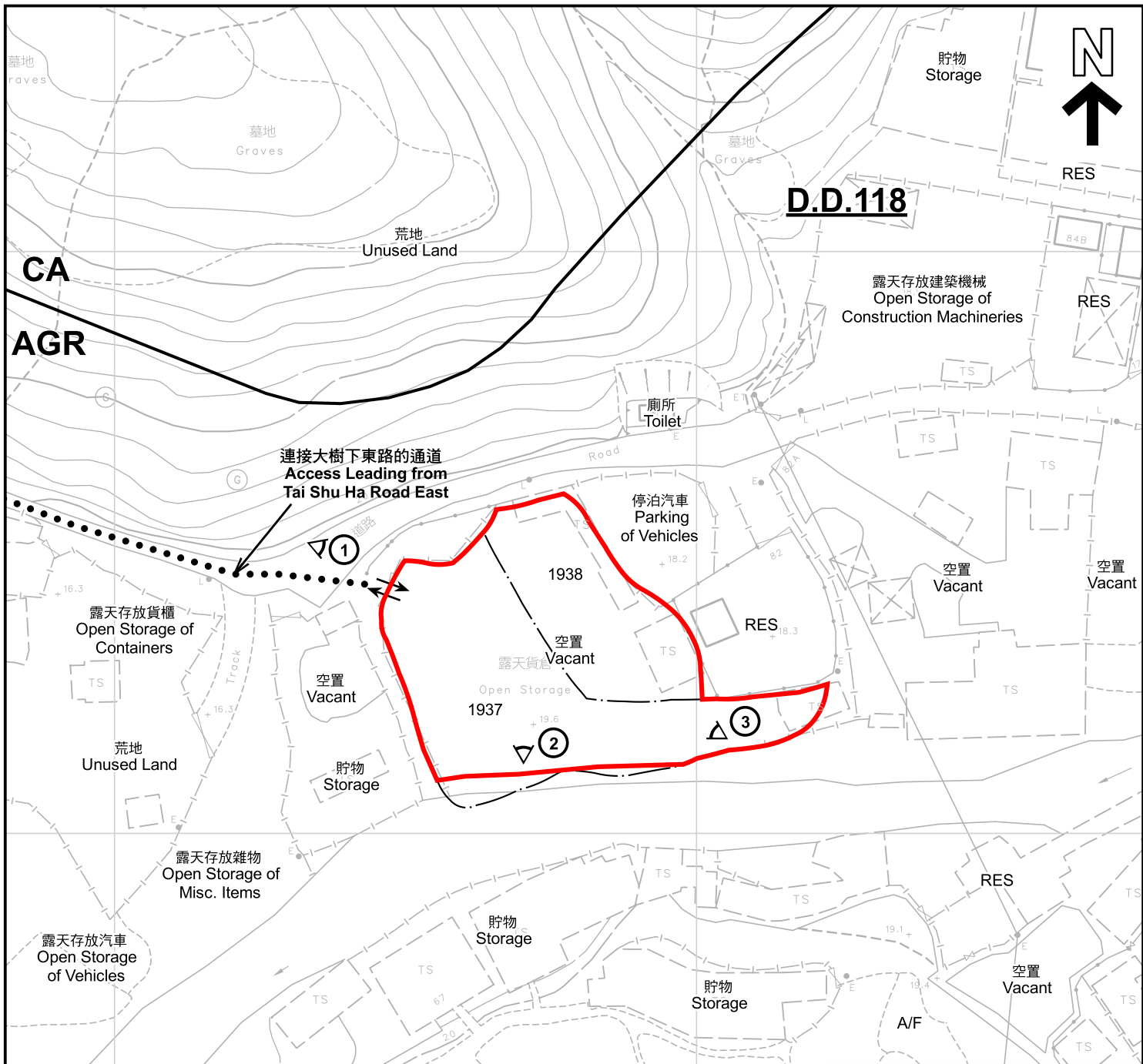

圖例 LEGEND	
	申請地點 (界線只作識別用) APPLICATION SITE (BOUNDARY FOR IDENTIFICATION PURPOSE ONLY)
<b>AGR</b>	農業 AGRICULTURE
<b>CA</b>	自然保育區 CONSERVATION AREA
<b>RES</b>	住用構築物 RESIDENTIAL STRUCTURES
<b>A/F</b>	休耕農地 FALLOW AGRICULTURAL LAND
<b>A/C</b>	常耕農地 CULTIVATED AGRICULTURAL LAND
	實地照片的觀景點 VIEWING POINT OF SITE PHOTO
	入口/出口 INGRESS / EGRESS

註釋 Notes :  
 2026年4月28日勘測的土地用途  
 Land uses shown on this plan are in accordance with the land use survey conducted by the Planning Department on 28.4.2026

本摘要圖於2026年5月18日擬備，所根據的資料為測量圖編號 6-NE-16C  
 EXTRACT PLAN PREPARED ON 18.5.2026 BASED ON SURVEY SHEET No. 6-NE-16C

**平面圖 SITE PLAN**

擬議臨時貨倉(危險品倉庫除外)連附屬設施及相關的填土工程(為期3年)  
 元朗大棠丈量約份第118約地段第1937號(部分)及1938號  
 PROPOSED TEMPORARY WAREHOUSE (EXCLUDING DANGEROUS GOODS GODOWN) WITH ANCILLARY FACILITIES AND ASSOCIATED FILLING OF LAND FOR A PERIOD OF 3 YEARS  
 LOTS 1937 (PART) AND 1938 IN D.D.118, TAI TONG, YUEN LONG

SCALE 1: 1 000 比例尺

米 METRES 20 0 20 40 米 METRES

**規劃署**  
Planning Department

參考編號 REFERENCE No. <b>A/YL-TT/737</b>	圖 PLAN <b>A-2</b>
---	----------------------



崇山新村  
Sung Shan  
New Village

大樹下東路  
TAI SHU HA  
ROAD EAST

連接大樹下東路的通道  
Access Leading from  
Tai Shu Ha Road East



圖例 LEGEND



申請地點(界線只作識別用)  
APPLICATION SITE  
(BOUNDARY FOR IDENTIFICATION  
PURPOSE ONLY)

本摘要圖於2026年5月14日擬備，所根據的資料為地政總署於2025年1月3日拍得的航攝照片編號 E246879C  
EXTRACT PLAN PREPARED ON 14.5.2026  
BASED ON AERIAL PHOTO No.  
E246879C TAKEN ON 3.1.2025 BY  
LANDS DEPARTMENT

航攝照片 AERIAL PHOTO

擬議臨時貨倉(危險品倉庫除外)連附屬設施及相關的填土工程(為期3年)  
元朗大棠丈量約份第118約地段第1937號(部分)及1938號  
PROPOSED TEMPORARY WAREHOUSE (EXCLUDING  
DANGEROUS GOODS GODOWN) WITH ANCILLARY FACILITIES  
AND ASSOCIATED FILLING OF LAND FOR A PERIOD OF 3 YEARS  
LOTS 1937 (PART) AND 1938 IN D.D.118, TAI TONG, YUEN LONG



規劃署  
Planning Department

參考編號  
REFERENCE No.  
A/YL-TT/737

圖 PLAN  
A-3



**實地照片 SITE PHOTOS**

本圖於2026年5月14日擬備，所根據的資料為攝於2026年4月28日的實地照片  
 PLAN PREPARED ON 14.5.2026  
 BASED ON SITE PHOTOS  
 TAKEN ON 28.4.2026

擬議臨時貨倉(危險品倉庫除外)連附屬設施及相關的填土工程(為期3年)  
 元朗大棠丈量約份第118約地段第1937號(部分)及1938號  
 PROPOSED TEMPORARY WAREHOUSE (EXCLUDING  
 DANGEROUS GOODS GODOWN) WITH ANCILLARY FACILITIES  
 AND ASSOCIATED FILLING OF LAND FOR A PERIOD OF 3 YEARS  
 LOTS 1937 (PART) AND 1938 IN D.D.118, TAI TONG, YUEN LONG



規劃署  
 Planning Department

參考編號  
 REFERENCE No.  
 A/YL-TT/737

圖 PLAN  
 A-4