

**LCH Planning and Development  
Consultants Limited**

Figure 4 : Revised Indicative Layout Plan

(For reference only. Not to scale.)

Section 16 Application for Proposed Temporary Public Vehicle Park (Private Cars Only) and Eating Place with Ancillary Electric Vehicle Charging Facilities and Solar Panels for a Period of 3 Years at Lots 333 S.B RP, 346, 348 RP, 349 RP and 350 in D.D. 221, Tai Mong Tsai Road, Sai Kung, New Territories

(資料來源：申請人於 26.05.2026 呈交的資料)  
(Source : Applicant's Submission on 26.05.2026)

參考編號  
REFERENCE No.  
A/SK-PK/310

繪圖  
DRAWING  
A-1

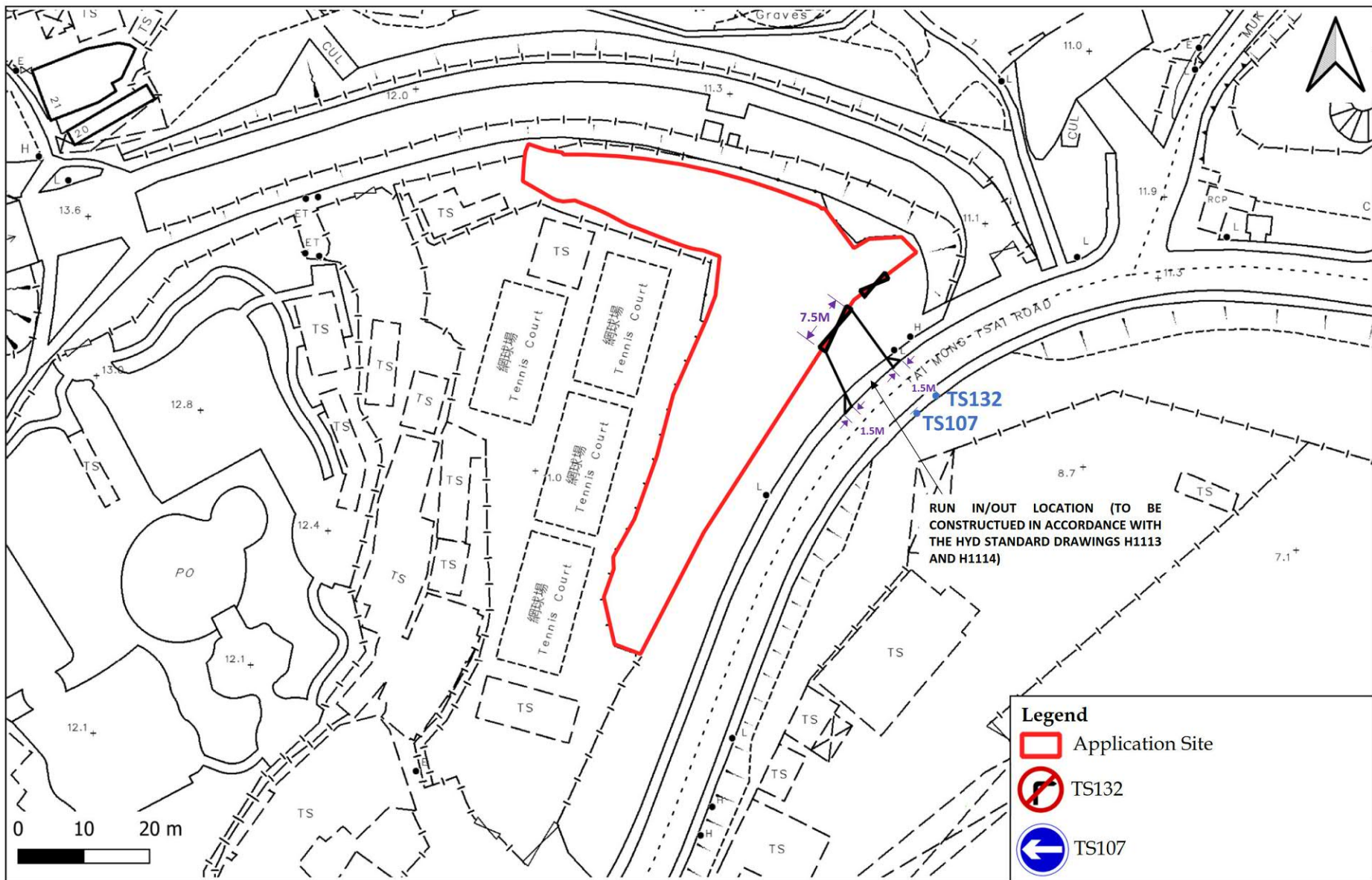

**LCH Planning and Development  
Consultants Limited**

Annex 2a : Revised Indicative Access Design (for Temporary Run-in/out)

Section 16 Application for Proposed Temporary Public Vehicle Park (Private Cars Only) and Eating Place with Ancillary Electric Vehicle Charging Facilities and Solar Panels for a Period of 3 Years at Lots 333 S.B RP, 346, 348 RP, 349 RP and 350 in D.D. 221, Tai Mong Tsai Road, Sai Kung, New Territories

(Source: HK GEODATA STORE, HKSAR Government)

**Legend**

-  Application Site
-  TS132
-  TS107

參考編號  
REFERENCE No.  
**A/SK-PK/310**

繪圖  
DRAWING  
A-2

(資料來源：申請人於 27.04.2026 呈交的資料)  
(Source : Applicant's Submission on 27.04.2026)

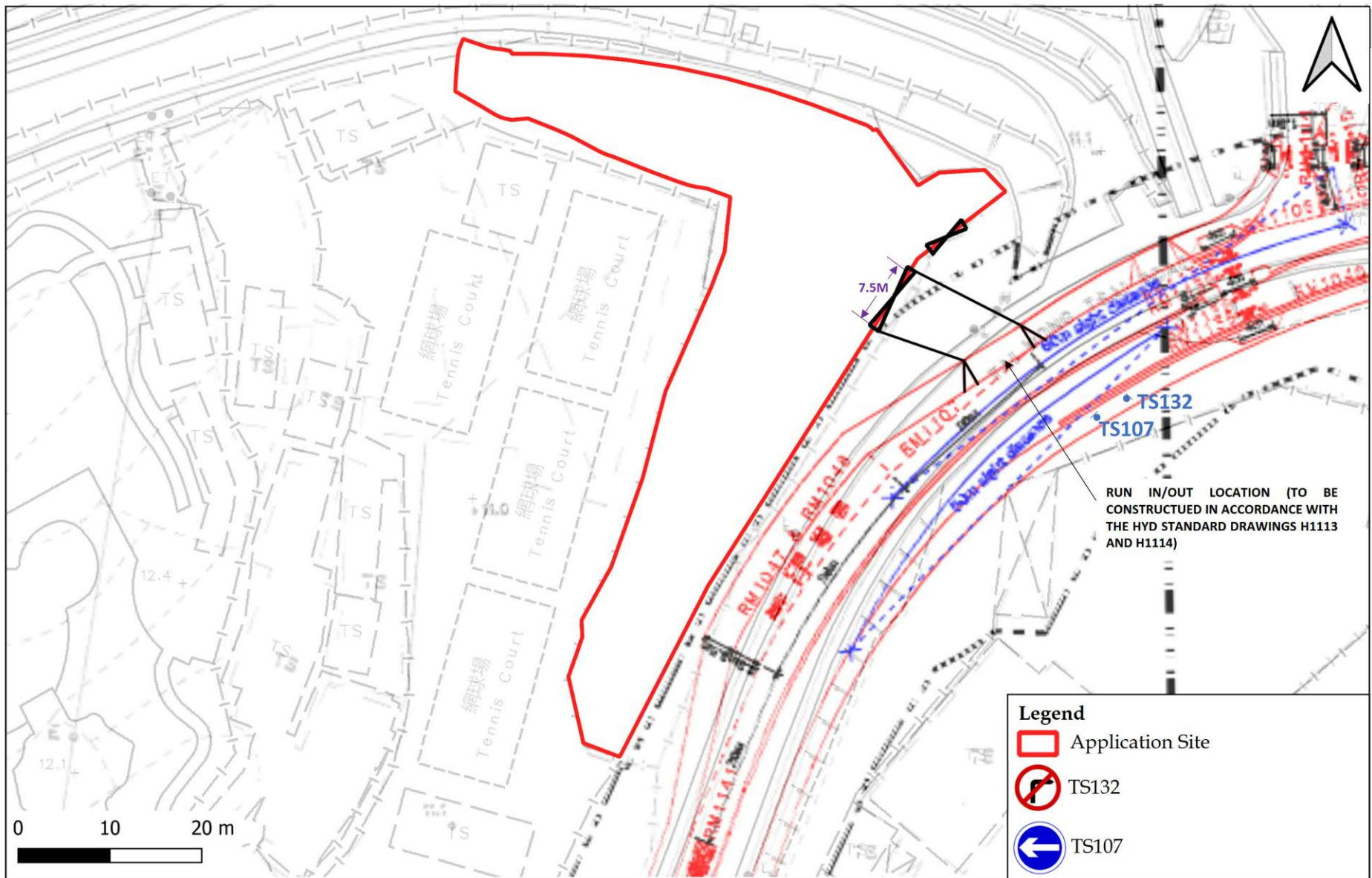

RUN IN/OUT LOCATION (TO BE CONSTRUCTED IN ACCORDANCE WITH THE HYD STANDARD DRAWINGS H1113 AND H1114)

- Legend**
- Application Site
  - ↗ TS132
  - ← TS107

**LCH Planning and Development Consultants Limited**

Annex 2b : Revised Indicative Access Design (for Permanent Run-in/out)

Section 16 Application for Proposed Temporary Public Vehicle Park (Private Cars Only) and Eating Place with Ancillary Electric Vehicle Charging Facilities and Solar Panels for a Period of 3 Years at Lots 333 S.B RP, 346, 348 RP, 349 RP and 350 in D.D. 221, Tai Mong Tsai Road, Sai Kung, New Territories

(Source: HK GEODATA STORE, HKSAR Government and Highways Department)

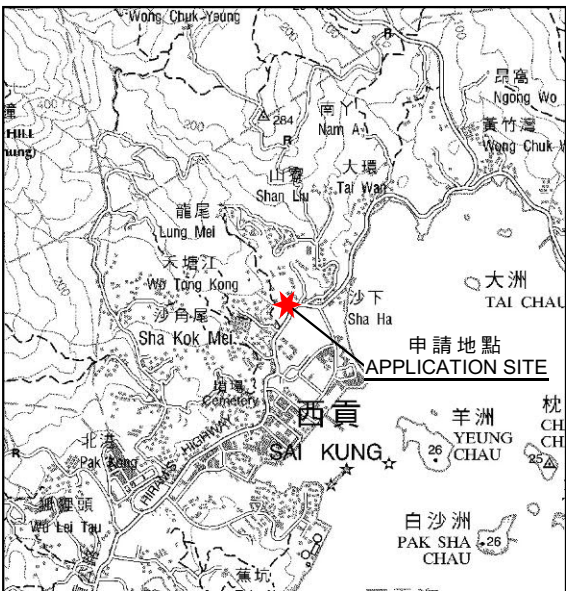
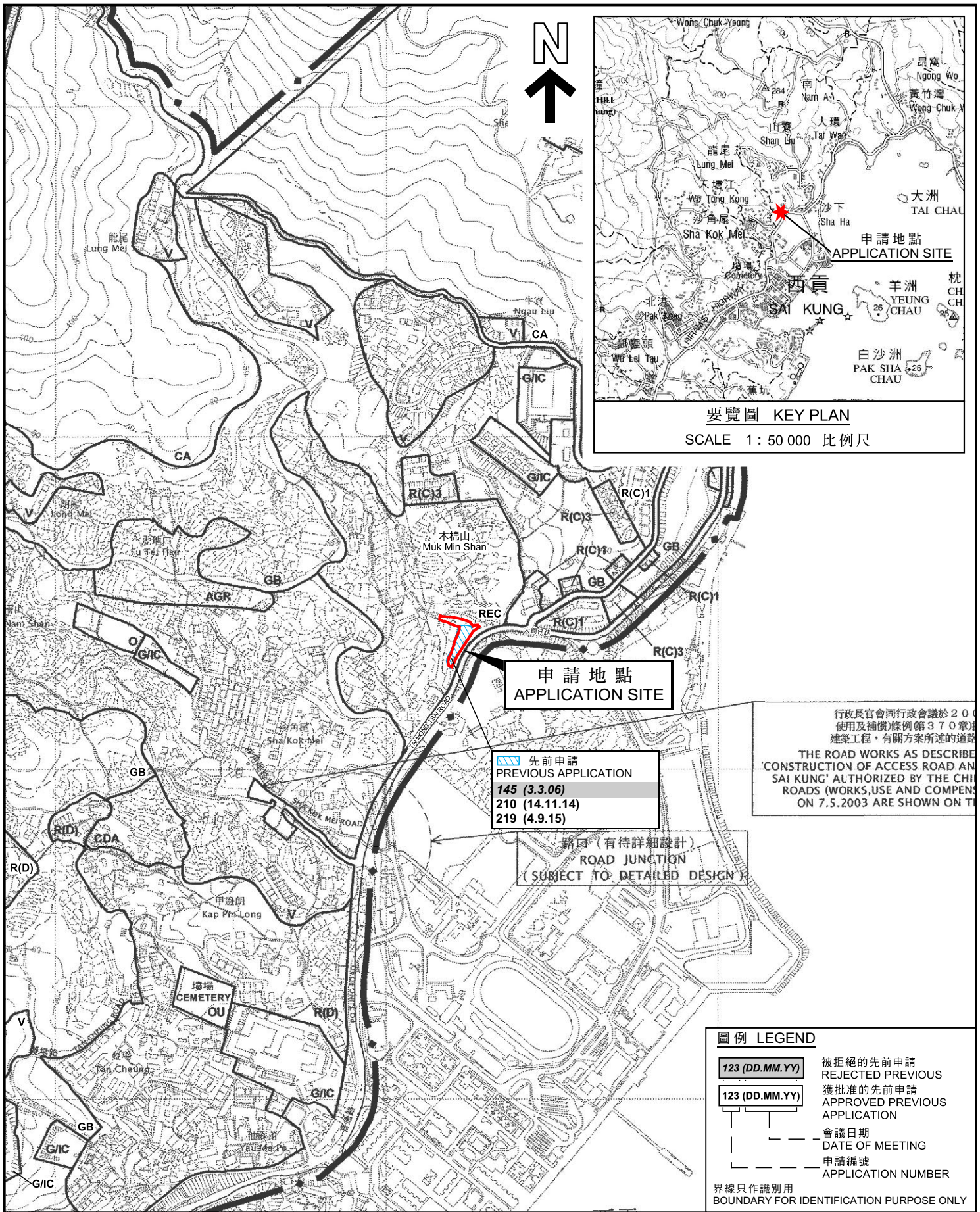

要覽圖 KEY PLAN  
SCALE 1: 50 000 比例尺

申請地點  
APPLICATION SITE

先前申請  
PREVIOUS APPLICATION  
145 (3.3.06)  
210 (14.11.14)  
219 (4.9.15)

路口 (有待詳細設計)  
ROAD JUNCTION  
(SUBJECT TO DETAILED DESIGN)

行政長官會同行政會議於2003年7月5日根據《道路(工程、使用及補償)條例》(第370章)批准有關方案所述的道路工程。  
THE ROAD WORKS AS DESCRIBED IN THE 'CONSTRUCTION OF ACCESS ROAD AND 'SAI KUNG' AUTHORIZED BY THE CHIEF EXECUTIVE OFFICER AND THE ADMINISTRATIVE COUNCIL ON 7.5.2003 ARE SHOWN ON THE MAP.

**圖例 LEGEND**

- 123 (DD.MM.YY) 被拒絕的先前申請  
REJECTED PREVIOUS APPLICATION
- 123 (DD.MM.YY) 獲批准的先前申請  
APPROVED PREVIOUS APPLICATION
- 會議日期  
DATE OF MEETING
- 申請編號  
APPLICATION NUMBER

界線只作識別用  
BOUNDARY FOR IDENTIFICATION PURPOSE ONLY

**位置圖 LOCATION PLAN**

本摘要圖於2025年10月14日擬備，所根據的資料為於2006年10月17日核准的分區計劃大綱圖編號S/SK-PK/11  
EXTRACT PLAN PREPARED ON 14.10.2025 BASED ON OUTLINE ZONING PLAN No. S/SK-PK/11 APPROVED ON 17.10.2006

擬議臨時公眾停車場 (只限私家車)  
和食肆連附屬電動車充電設施和太陽能板 (為期3年)  
新界西貢大網仔路丈量約份第221約地段第333號B分段餘段、第346號、第348號餘段、第349號餘段及第350號  
PROPOSED TEMPORARY PUBLIC VEHICLE PARK (PRIVATE CARS ONLY) AND EATING PLACE WITH ANCILLARY ELECTRIC VEHICLE CHARGING FACILITIES AND SOLAR PANELS FOR A PERIOD OF 3 YEARS  
LOTS 333 S.B RP, 346, 348 RP, 349 RP AND 350 IN D.D. 221, TAI MONG TSAI ROAD, SAI KUNG, NEW TERRITORIES  
SCALE 1: 7 500 比例尺

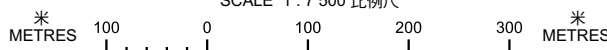

規劃署  
Planning Department

參考編號  
REFERENCE No.  
A/SK-PK/310

圖 PLAN  
A-1

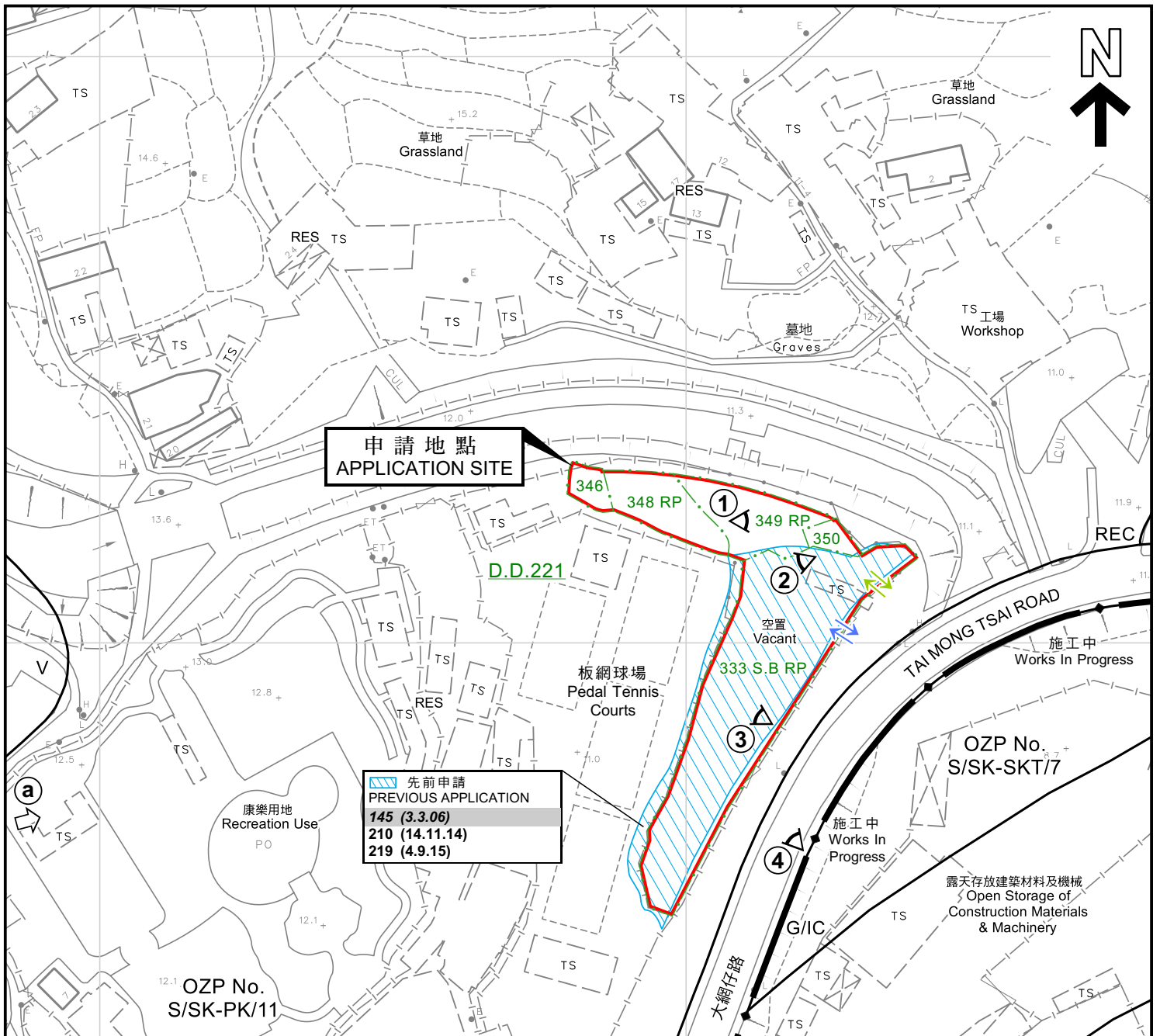

申請地點  
APPLICATION SITE

先申請  
PREVIOUS APPLICATION  
145 (3.3.06)  
210 (14.11.14)  
219 (4.9.15)

圖例 LEGEND

- |                |   |      |   |
|----------------|---|------|---|
| 123 (DD.MM.YY) | 被拒絕的先申請<br>REJECTED PREVIOUS APPLICATION            | TS   | 寮屋<br>TEMPORARY STRUCTURES  |
| 123 (DD.MM.YY) | 獲批准的先申請<br>APPROVED PREVIOUS APPLICATION            | RES  | 住用構築物<br>RESIDENTIAL STRUCTURES                                     |
|                | 會議日期<br>DATE OF MEETING                             | CDA  | 綜合發展區<br>COMPREHENSIVE DEVELOPMENT AREA                             |
|                | 申請編號<br>APPLICATION NUMBER                          | G/IC | 政府、機構或社區<br>GOVERNMENT, INSTITUTION OR COMMUNITY                    |
|                | 擬議行人出入口<br>PROPOSED PEDESTRIAN INGRESS / EGRESS     | REC  | 康樂<br>RECREATION  |
|                | 擬議汽車出入口<br>PROPOSED VEHICLE INGRESS / EGRESS        | V    | 鄉村式發展<br>VILLAGE TYPE DEVELOPMENT                                   |
|                | 界線只作識別用<br>BOUNDARY FOR IDENTIFICATION PURPOSE ONLY | ①    | 實地照片的觀景點<br>VIEWING POINT OF SITE PHOTO                             |
|                |   | Ⓐ    | 無人駕駛航拍的拍攝方向<br>VIEWING DIRECTION FROM UNMANNED AERIAL VEHICLE (UAV) |

註釋 Notes :

2026年5月8日勘測的土地用途  
Land uses shown on this plan are in accordance with the land use survey conducted by the Planning Department on 8.5.2026

平面圖 SITE PLAN

本摘要圖於2026年6月4日擬備，  
所根據的資料為測量圖編號8-SW-6D 及11B

EXTRACT PLAN PREPARED ON  
4.6.2026 BASED ON SURVEY SHEET  
No. 8-SW-6D & 11B

擬議臨時公眾停車場（只限私家車）  
和食肆連附屬電動車充電設施和太陽能板（為期3年）  
新界西貢大網仔路丈量約份第221約地段第333號B分段餘段、  
第346號、第348號餘段、第349號餘段及第350號  
PROPOSED TEMPORARY PUBLIC VEHICLE PARK (PRIVATE CARS ONLY)  
AND EATING PLACE WITH ANCILLARY ELECTRIC VEHICLE CHARGING FACILITIES  
AND SOLAR PANELS FOR A PERIOD OF 3 YEARS  
LOTS 333 S.B. RP, 346, 348 RP, 349 RP AND 350 IN D.D. 221,  
TAI MONG TSAI ROAD, SAI KUNG, NEW TERRITORIES  
SCALE 1:1 000 比例尺

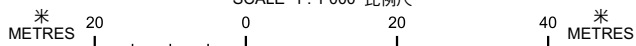

規劃署  
Planning Department

參考編號  
REFERENCE No.  
A/SK-PK/310



圖 PLAN  
A-2



申請地點  
APPLICATION SITE



圖例 LEGEND

-  擬議行人出入口  
PROPOSED PEDESTRIAN  
INGRESS / EGRESS
-  擬議汽車出入口  
PROPOSED VEHICLE  
INGRESS / EGRESS

界線只作識別用  
BOUNDARY FOR IDENTIFICATION PURPOSE ONLY

航攝照片 AERIAL PHOTO

本摘要圖於2026年5月18日擬備，所根據的資料為地政總署於2024年10月22日拍得的航攝照片編號E233379C

EXTRACT PLAN PREPARED ON 18.5.2026  
BASED ON AERIAL PHOTO No. E233379C  
TAKEN ON 22.10.2024  
BY LANDS DEPARTMENT

擬議臨時公眾停車場（只限私家車）  
和食肆連附屬電動車充電設施和太陽能板（為期3年）  
新界西貢大網仔路丈量約份第221約地段第333號B分段餘段、  
第346號、第348號餘段、第349號餘段及第350號  
PROPOSED TEMPORARY PUBLIC VEHICLE PARK (PRIVATE CARS ONLY)  
AND EATING PLACE WITH ANCILLARY ELECTRIC VEHICLE CHARGING FACILITIES  
AND SOLAR PANELS FOR A PERIOD OF 3 YEARS  
LOTS 333 S.B RP, 346, 348 RP, 349 RP AND 350 IN D.D. 221,  
TAI MONG TSAI ROAD, SAI KUNG, NEW TERRITORIES



規劃署  
Planning Department

參考編號  
REFERENCE No.  
A/SK-PK/310

圖 PLAN  
A-3

1



申請地點  
APPLICATION SITE

2



申請地點  
APPLICATION SITE

界線只作識別用  
BOUNDARY FOR IDENTIFICATION PURPOSE ONLY

實地照片 SITE PHOTO

擬議臨時公眾停車場（只限私家車）  
和食肆連附屬電動車充電設施和太陽能板（為期3年）  
新界西貢大網仔路丈量約份第221約地段第333號B分段餘段、  
第346號、第348號餘段、第349號餘段及第350號

PROPOSED TEMPORARY PUBLIC VEHICLE PARK (PRIVATE CARS ONLY)  
AND EATING PLACE WITH ANCILLARY ELECTRIC VEHICLE CHARGING FACILITIES  
AND SOLAR PANELS FOR A PERIOD OF 3 YEARS  
LOTS 333 S.B RP, 346, 348 RP, 349 RP AND 350 IN D.D. 221,  
TAI MONG TSAI ROAD, SAI KUNG, NEW TERRITORIES



規劃署  
Planning Department

參考編號  
REFERENCE No.  
A/SK-PK/310

圖 PLAN  
A-4a

本圖於2026年5月18日擬備，所根據的資料  
為攝於2026年5月8日的實地照片  
PLAN PREPARED ON 18.5.2026  
BASED ON SITE PHOTOS  
TAKEN ON 8.5.2026

3



申請地點  
APPLICATION SITE



4



申請地點  
APPLICATION SITE

大網仔路  
TAI MONG TSAI ROAD

圖例 LEGEND

-  擬議行人出入口  
PROPOSED PEDESTRIAN  
INGRESS / EGRESS
-  擬議汽車出入口  
PROPOSED VEHICLE  
INGRESS / EGRESS

界線只作識別用  
BOUNDARY FOR IDENTIFICATION PURPOSE ONLY

實地照片 SITE PHOTO

擬議臨時公眾停車場（只限私家車）  
和食肆連附屬電動車充電設施和太陽能板（為期3年）  
新界西貢大網仔路丈量約份第221約地段第333號B分段餘段、  
第346號、第348號餘段、第349號餘段及第350號

PROPOSED TEMPORARY PUBLIC VEHICLE PARK (PRIVATE CARS ONLY)  
AND EATING PLACE WITH ANCILLARY ELECTRIC VEHICLE CHARGING FACILITIES  
AND SOLAR PANELS FOR A PERIOD OF 3 YEARS  
LOTS 333 S.B RP, 346, 348 RP, 349 RP AND 350 IN D.D. 221,  
TAI MONG TSAI ROAD, SAI KUNG, NEW TERRITORIES



規劃署  
Planning Department

參考編號  
REFERENCE No.  
A/SK-PK/310



圖 PLAN  
A-4b

本圖於2026年5月18日擬備，所根據的資料  
為攝於2026年5月8日的實地照片  
PLAN PREPARED ON 18.5.2026  
BASED ON SITE PHOTOS  
TAKEN ON 8.5.2026

a



圖例 LEGEND

-  擬議行人出入口  
PROPOSED PEDESTRIAN  
INGRESS / EGRESS
-  擬議汽車出入口  
PROPOSED VEHICLE  
INGRESS / EGRESS

界線只作識別用  
BOUNDARY FOR IDENTIFICATION PURPOSE ONLY

實地照片 SITE PHOTO

本圖於2026年5月18日擬備，所根據的資料  
為攝於2026年5月8日的無人駕駛航拍照片  
PLAN PREPARED ON 18.5.2026 BASED ON  
UNMANNED AERIAL VEHICLE (UAV) PHOTO  
TAKEN ON 8.5.2026

擬議臨時公眾停車場（只限私家車）  
和食肆連附屬電動車充電設施和太陽能板（為期3年）  
新界西貢大網仔路丈量約份第221約地段第333號B分段餘段、  
第346號、第348號餘段、第349號餘段及第350號

PROPOSED TEMPORARY PUBLIC VEHICLE PARK (PRIVATE CARS ONLY)  
AND EATING PLACE WITH ANCILLARY ELECTRIC VEHICLE CHARGING FACILITIES  
AND SOLAR PANELS FOR A PERIOD OF 3 YEARS  
LOTS 333 S.B RP, 346, 348 RP, 349 RP AND 350 IN D.D. 221,  
TAI MONG TSAI ROAD, SAI KUNG, NEW TERRITORIES



規劃署  
Planning Department

參考編號  
REFERENCE No.  
A/SK-PK/310

圖 PLAN  
A-4c