

G/F PLAN

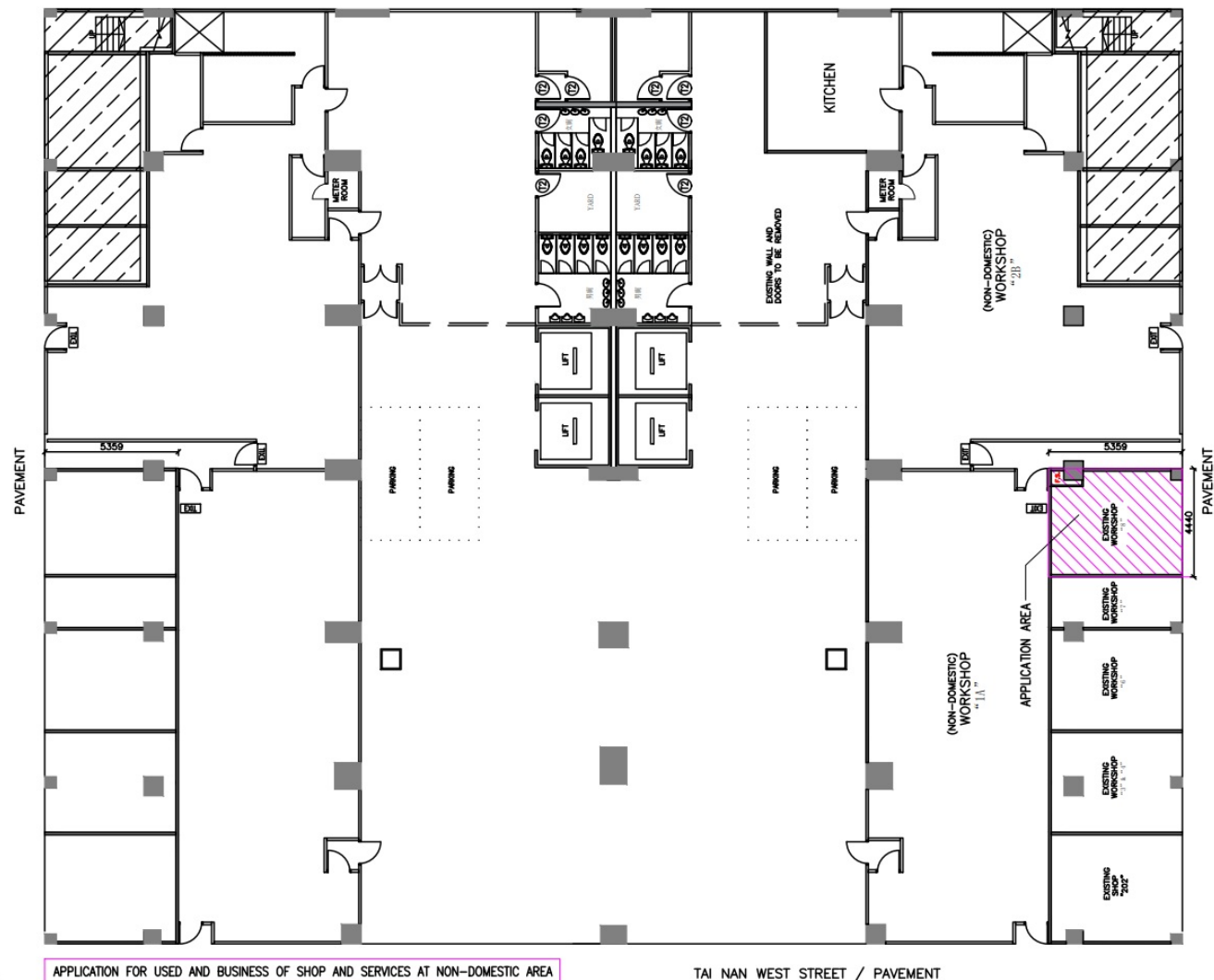

APPLICATION FOR USED AND BUSINESS OF SHOP AND SERVICES AT NON-DOMESTIC AREA

TAI NAN WEST STREET / PAVEMENT

CASTLE PEAK ROAD

怡豐飲食牌照顧問有限公司
一站式食肆牌照顧問服務

Http://picl.hk
 Email: info@picl.hk

Flat 3, 4/F, Trans Asia Centre, No. 18 Kin Hong St. Kwai Chung N.T. H.K.
 Tel: 3565 0150 Mobile: 6890 9484 Fax: 3565 0190

CLIENT: N/A
 LOCATION: SHOP 8, UNIT 2, G/F., WING KUT INDUSTRIAL BUILDING, NO. 608 CASTLE PEAK ROAD, SHAM SHUI PO, KOWLOON
 LICENCE TYPE: S16-I
 DRAWING TITLE: GROUND FLOOR LOCATION PLAN

PROJECT NO.: N/A
 DWN NO.: GP-02
 SCALE: 1:250 (A4)
 FUEL: ELECTRICITY ONLY
 CAD FILE NAME: GP-02_A4 (2025.02.04).DWG

REV.	DATE	REV. BY
1	2025.01.08	KEVIN L.
2	2025.02.04	KEVIN L.

Important Notes:

1. Do not scale from this Drawings.
 2. All dimensions are in millimeter & levels are in meter unless otherwise stated.
 3. Contractor shall verify all dimensions on site prior commencement of works.
 4. Contractor shall coordinate all interfacing works.
 5. This CAD Drawing for PICL & PICL Internal use and copyright only.
 請尊重智識產權，任何人士如未經本公司許可而採用任何方式，包括複製、修改、展示及未經本公司許可向他人 / 其公司 進行其他商業活動等等，任何直接或間接侵犯版權行為本公司將會以法律途徑作出處。
 Please respect any intellectual property rights and any person who, without the permission of the Company, uses any means, including reproduction, modification, display and other business activities without permission from the Company or his company, etc. Any direct or indirect infringement of copyright will be dealt with by legal means.

參考編號
 REFERENCE No.
 A/K5/874

繪圖 DRAWING
 A-1

(來源：附錄 I)
 (Source : Appendix I)

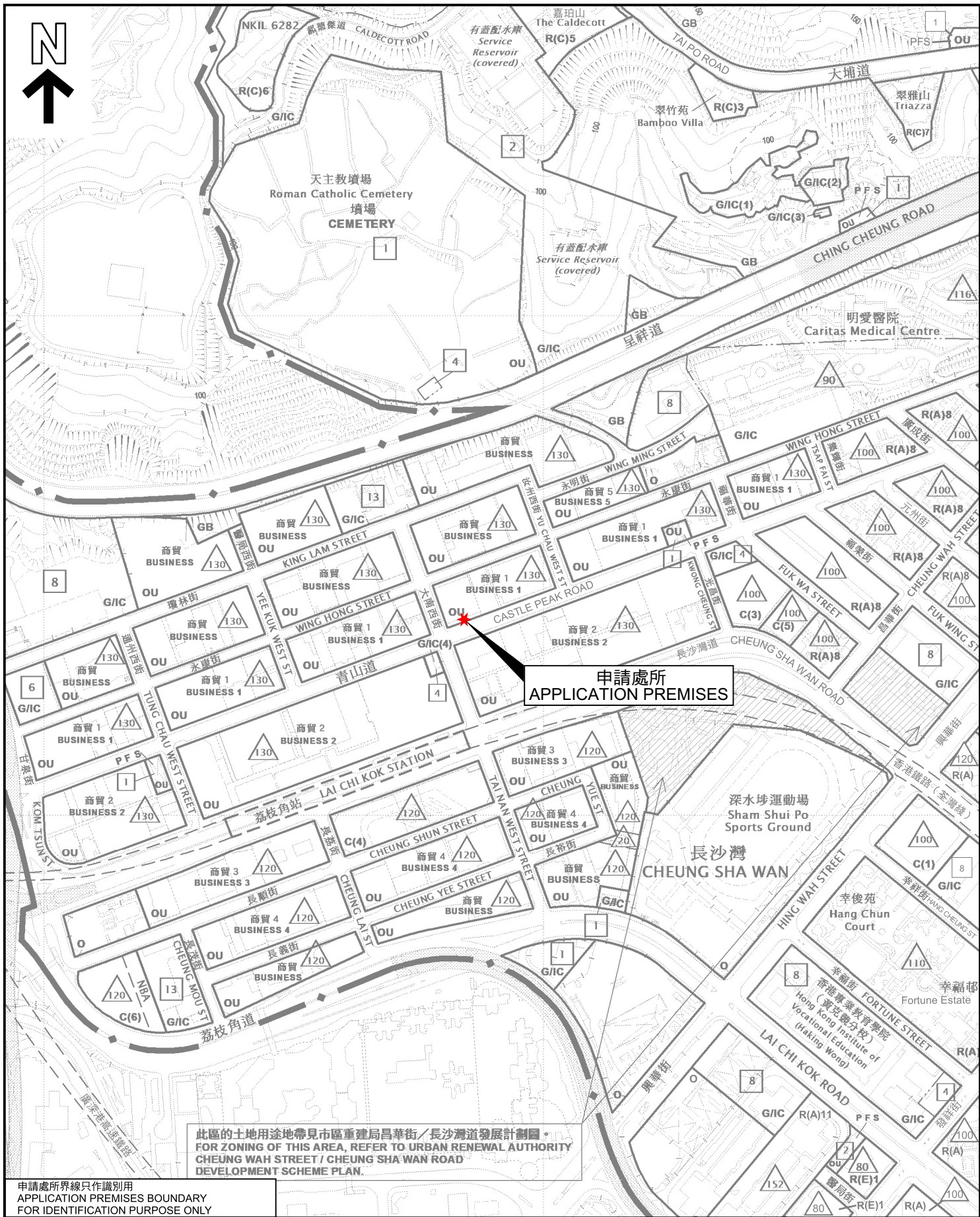

申請處所界線只作識別用
APPLICATION PREMISES BOUNDARY
FOR IDENTIFICATION PURPOSE ONLY

本摘要圖於2025年3月5日擬備，
所根據的資料為於2023年2月7日
核准的分區計劃大綱圖編號S/K5/39
EXTRACT PLAN PREPARED ON
5.3.2025 BASED ON OUTLINE ZONING
PLAN No. S/K5/39 APPROVED ON
7.2.2023

位置圖 LOCATION PLAN

擬議商店及服務行業
PROPOSED SHOP AND SERVICES
SHOP 8, UNIT 2, G/F, WING KUT INDUSTRIAL BUILDING,
608 CASTLE PEAK ROAD,
CHEUNG SHA WAN, KOWLOON

SCALE 1:5 000 比例尺
米 100 0 100 200 米
METRES

規劃署
PLANNING
DEPARTMENT



參考編號
REFERENCE No.
A/K5/874

圖 PLAN
A-1

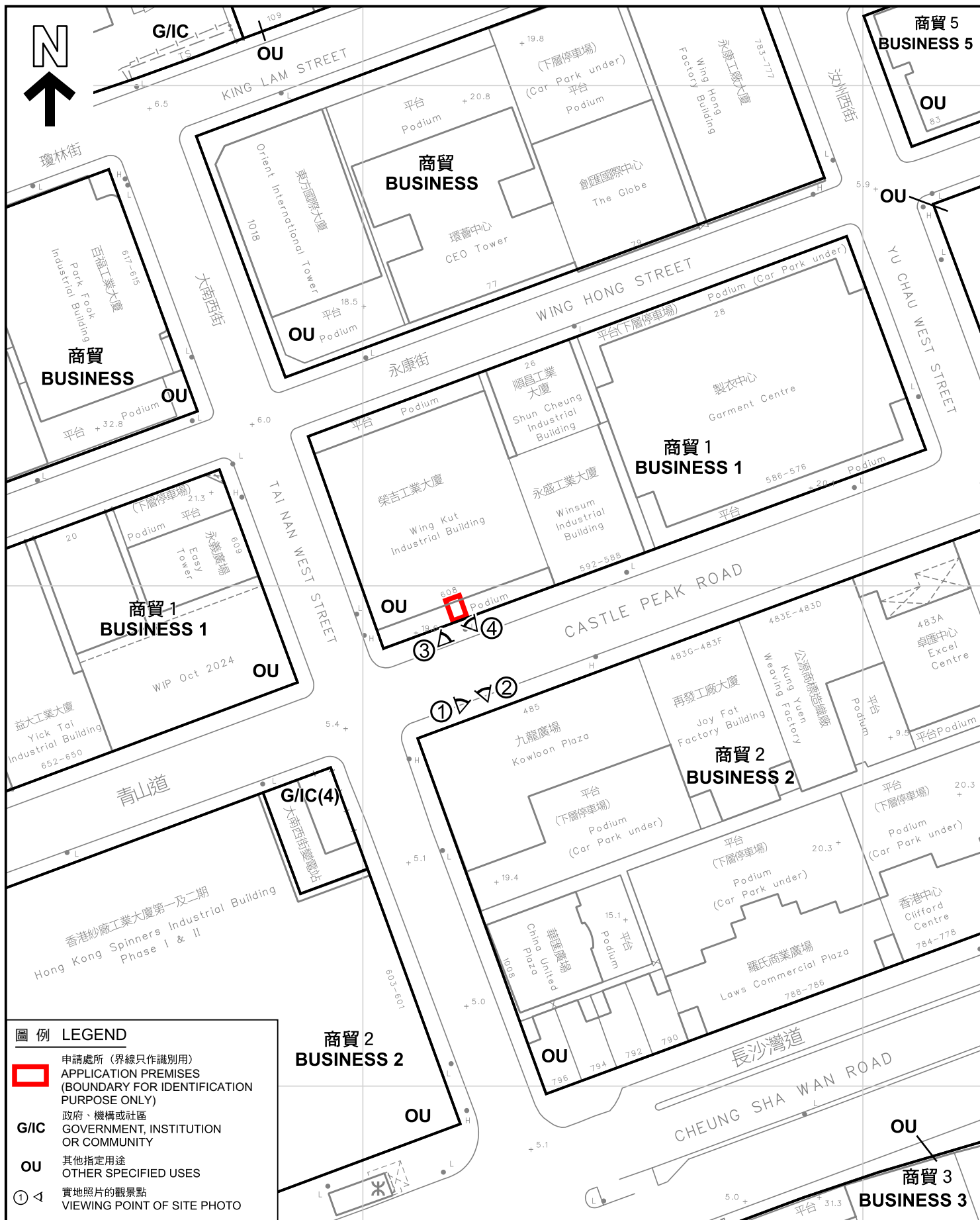

圖例 LEGEND

-  申請處所 (界線只作識別用)
APPLICATION PREMISES
(BOUNDARY FOR IDENTIFICATION
PURPOSE ONLY)
- G/IC** 政府、機構或社區
GOVERNMENT, INSTITUTION
OR COMMUNITY
- OU** 其他指定用途
OTHER SPECIFIED USES
- ① ◁ 實地照片的觀景點
VIEWING POINT OF SITE PHOTO

平面圖 SITE PLAN

擬議商店及服務行業
PROPOSED SHOP AND SERVICES
SHOP 8, UNIT 2, G/F, WING KUT INDUSTRIAL BUILDING,
608 CASTLE PEAK ROAD,
CHEUNG SHA WAN, KOWLOON

SCALE 1:1 000 比例尺

米 20 0 20 米
METRES

規劃署
PLANNING
DEPARTMENT



參考編號
REFERENCE No.
A/K5/874

圖 PLAN
A-2

本摘要圖於2025年3月5日擬備，
所根據的資料為測量圖編號
11-NW-8A及C
EXTRACT PLAN PREPARED ON
5.3.2025 BASED ON SURVEY SHEETS
No. 11-NW-8A & C

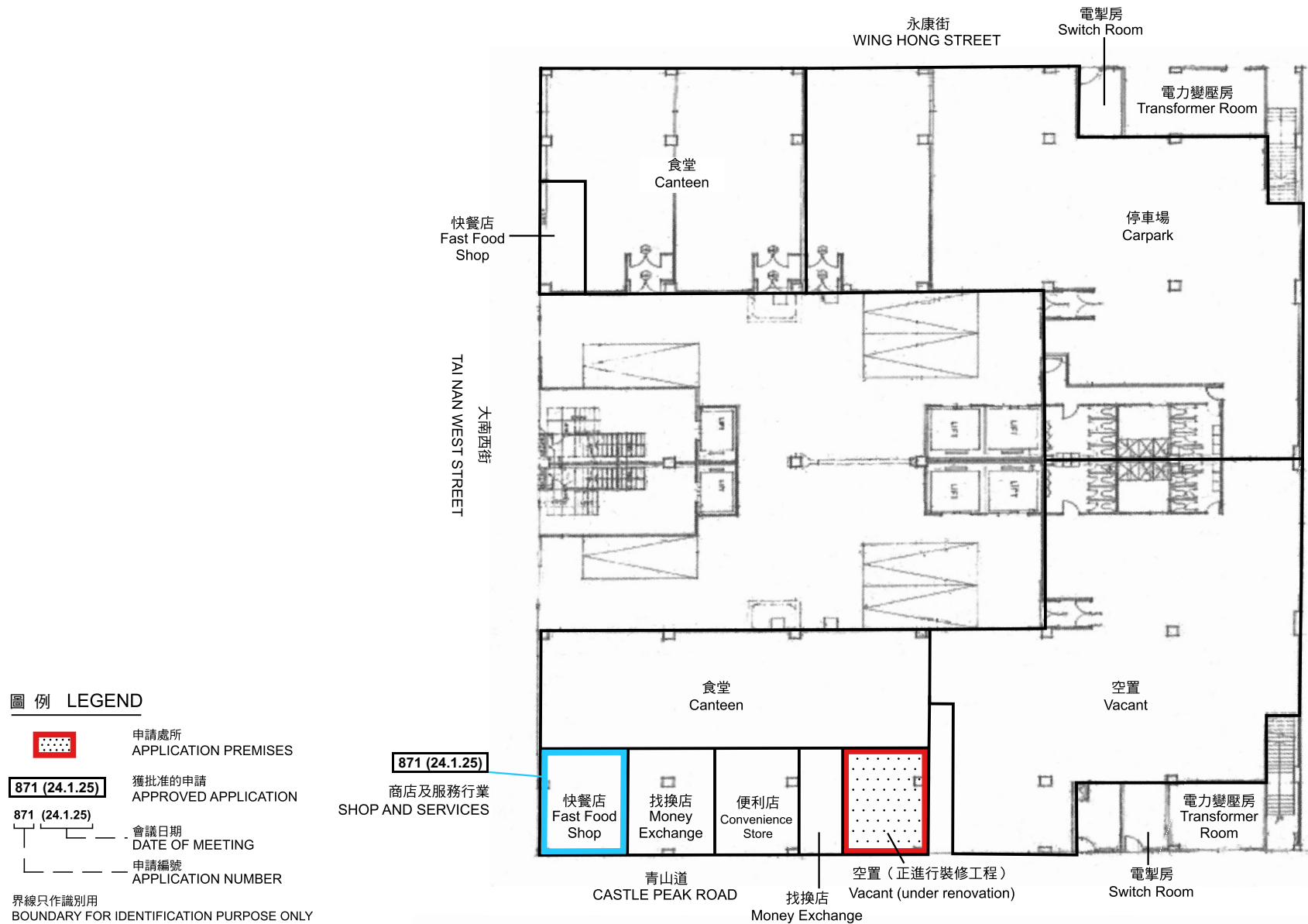

本摘要圖於2025年3月5日擬備
EXTRACT PLAN PREPARED ON 5.3.2025

地下用途圖
FLOOR USE PLAN OF GROUND FLOOR

擬議商店及服務行業
PROPOSED SHOP AND SERVICES

九龍長沙灣青山道 608 號榮吉工業大廈地下 2 號舖 8 號室
SHOP 8, UNIT 2, G/F, WING KUT INDUSTRIAL BUILDING,
608 CASTLE PEAK ROAD,
CHEUNG SHA WAN, KOWLOON

規劃署
PLANNING
DEPARTMENT



參考編號
REFERENCE No.
A/K5/874

圖 PLAN
A-3

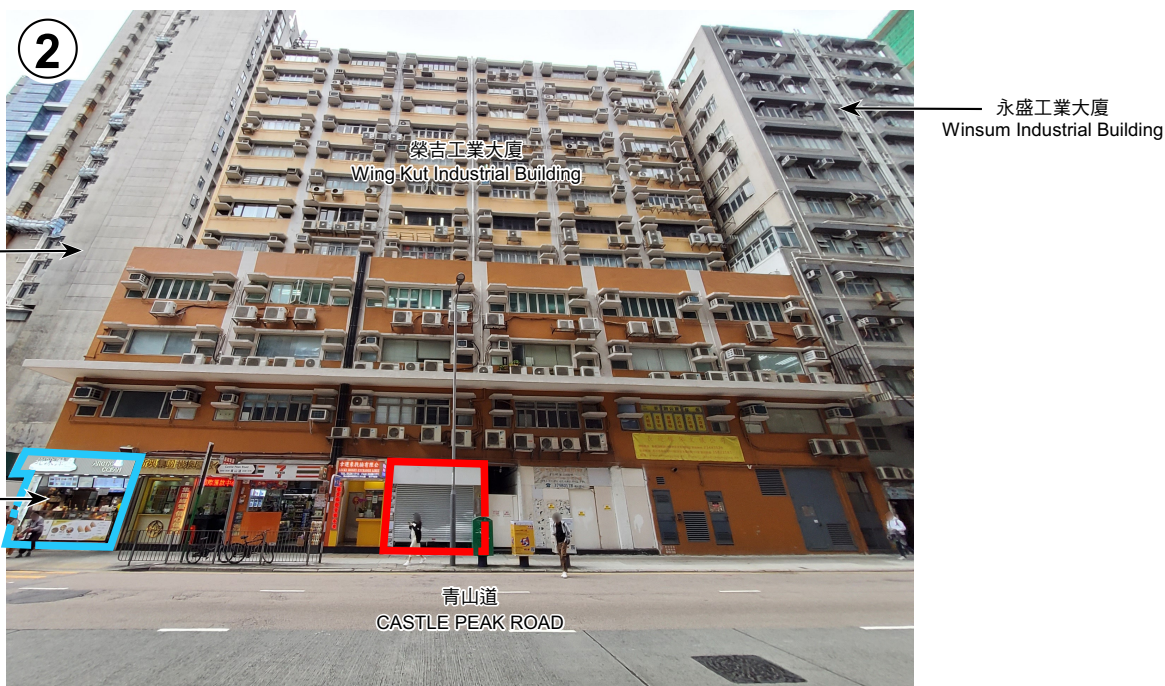

 申請處所界線只作識別用
APPLICATION PREMISES BOUNDARY
FOR IDENTIFICATION PURPOSE ONLY

實地照片 SITE PHOTOS

本圖於2025年3月20日擬備，所根據的資料為攝於2025年2月11日和2025年3月20日的實地照片
PLAN PREPARED ON 20.3.2025
BASED ON SITE PHOTOS
TAKEN ON 11.2.2025 AND 20.3.2025

擬議商店及服務行業
九龍長沙灣青山道 6 0 8 號榮吉工業大廈地下 2 號舖 8 號室
PROPOSED SHOP AND SERVICES
SHOP 8, UNIT 2, G/F, WING KUT INDUSTRIAL BUILDING,
608 CASTLE PEAK ROAD,
CHEUNG SHA WAN, KOWLOON

規劃署
PLANNING
DEPARTMENT



參考編號
REFERENCE No.
A/K5/874

圖 PLAN
A-4



榮吉工業大廈
Wing Kut Industrial Building



申請處所界線只作識別用
APPLICATION PREMISES BOUNDARY
FOR IDENTIFICATION PURPOSE ONLY

本圖於2025年3月5日擬備，所根據的
資料為攝於2025年2月11日的實地照片

PLAN PREPARED ON 5.3.2025
BASED ON SITE PHOTOS
TAKEN ON 11.2.2025

實地照片 SITE PHOTOS

擬議商店及服務行業
九龍長沙灣青山道608號榮吉工業大廈地下2號舖8號室
PROPOSED SHOP AND SERVICES
SHOP 8, UNIT 2, G/F, WING KUT INDUSTRIAL BUILDING,
608 CASTLE PEAK ROAD,
CHEUNG SHA WAN, KOWLOON

規劃署
PLANNING
DEPARTMENT



參考編號
REFERENCE No.

A/K5/874

圖 PLAN

A-5