

DEVELOPMENT PARAMETERS

APPLICATION SITE AREA : 1,892m² (ABOUT)
COVERED AREA : 39m² (ABOUT)
UNCOVERED AREA : 1,853m² (ABOUT)

FLOT RATIO : 0.02 (ABOUT)
SITE COVERAGE : 2 % (ABOUT)

NO. OF STRUCTURE : 6
DOMESTIC GFA : NOT APPLICABLE
NON-DOMESTIC GFA : 39m² (ABOUT)
TOTAL GFA : 39m² (ABOUT)

BUILDING HEIGHT : 3m (ABOUT)
NO. OF STOREY : 1

STRUCTURE	USE	COVERED AREA	GFA	BUILDING HEIGHT
B1	STORAGE OF CAMPING GOODS	12m ² (ABOUT)	12m ² (ABOUT)	3m (ABOUT)(1-STOREY)
B2	SITE OFFICE	15m ² (ABOUT)	15m ² (ABOUT)	3m (ABOUT)(1-STOREY)
B3	WASH-ROOM & CHANGING ROOM	4m ² (ABOUT)	4m ² (ABOUT)	3m (ABOUT)(1-STOREY)
B4	WASH-ROOM & CHANGING ROOM	4m ² (ABOUT)	4m ² (ABOUT)	3m (ABOUT)(1-STOREY)
B5	WASH-ROOM & CHANGING ROOM	4m ² (ABOUT)	4m ² (ABOUT)	3m (ABOUT)(1-STOREY)
TOTAL		39m ² (ABOUT)	39m ² (ABOUT)	

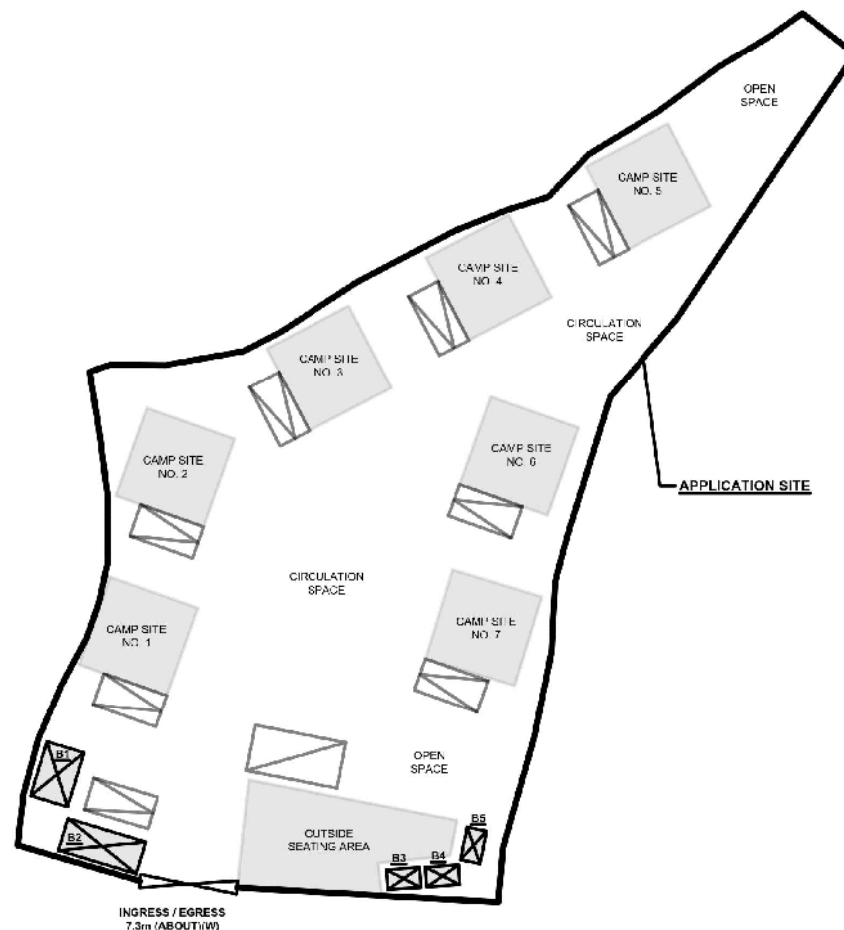
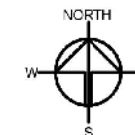

PARKING AND LOADING/UNLOADING PROVISIONS

NO. OF PRIVATE CAR PARKING SPACE : 8
DIMENSION OF PARKING SPACE : 5m (L) X 2.5m (W)

NO. OF LUL SPACE FOR LIGHT GOODS VEHICLE : 1
DIMENSION OF LUL SPACE : 7m (L) X 3.5m (W)

LEGEND

- APPLICATION SITE
- STRUCTURE
- PARKING SPACE
- LOADING / UNLOADING SPACE
- INGRESS / EGRESS

PLANNING CONSULTANT

R-RICHES PROPERTY
CONSULTANTS LIMITED

PROJECT

PROPOSED TEMPORARY
HOLIDAY CAMP WITH
ANCILLARY FACILITIES FOR A
PERIOD OF 3 YEARS

SITE LOCATION

LOTS 78 (PART) AND 79 RP
(PART) IN U.D. 52, HANLING,
NEW TERRITORIES

SCALE

1:500 @ A1

DRAWING

M/N

DATE

8.5.2022

REVISION

NO.

DATE

APPROVAL

DATE

SUB TITLE

LAYOUT PLAN

DRAWING

PLAN 1

NO.

002

(資料來源:申請人於 13. 5. 2022 呈交的資料)
(Source : Applicant's Submission of 13.5.2022)

參考編號
REFERENCE No.
A/FLN/29

繪圖 DRAWING
A-1

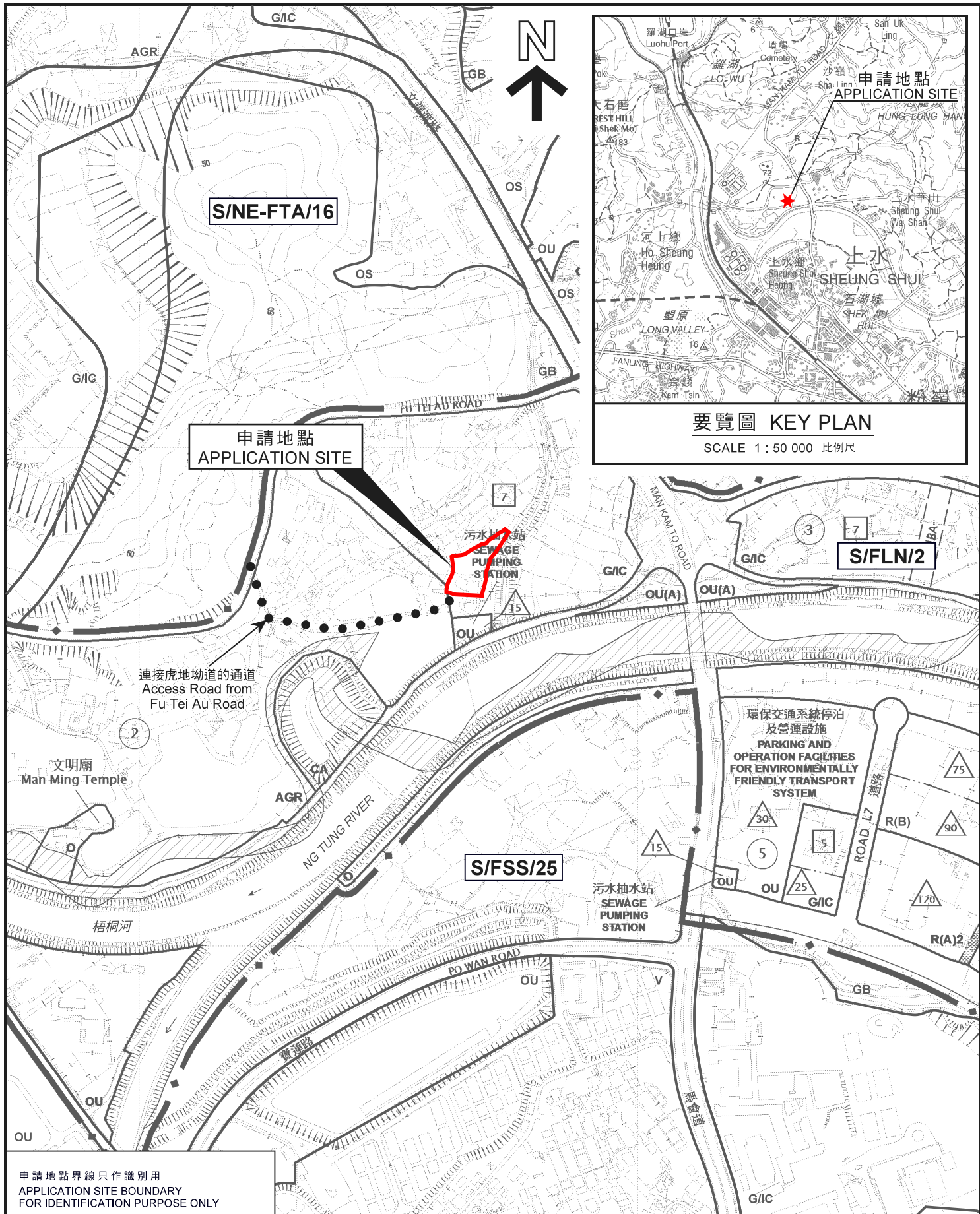

本摘要圖於2022年4月22日擬備，
所根據的資料為分別於2015年6月16日
核准的分區計劃大綱圖編號S/FLN/2
EXTRACT PLAN PREPARED ON
22.4.2022 BASED ON OUTLINE ZONING
PLAN No. S/FLN/2 APPROVED ON 16.6.2015

SCALE 1 : 5 000 比例尺
0 100 200
METRES

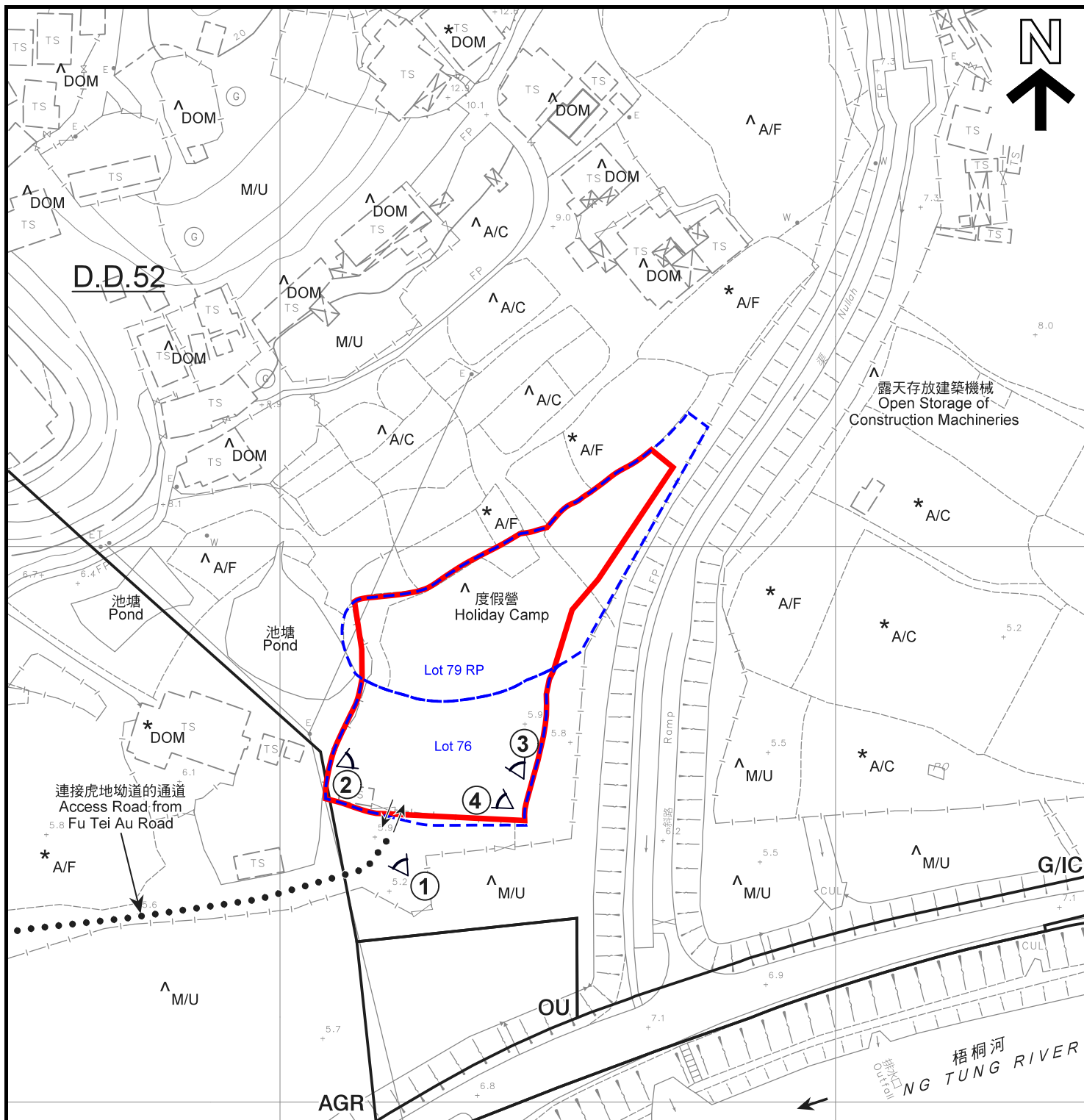

圖例 LEGEND

- 申請地點** (界線只作識別用)
APPLICATION SITE
(BOUNDARY FOR IDENTIFICATION
PURPOSE ONLY)
- AGR** 農業
AGRICULTURE
- G/IC** 政府、機構或社區
GOVERNMENT, INSTITUTION OR
COMMUNITY
- OU** 其他指定用途
OTHER SPECIFIED USES

- 入口 / 出口
INGRESS / EGRESS
- A/C 常耕農地
CULTIVATED AGRICULTURAL LAND
- A/F 休耕農地
FALLOW AGRICULTURAL LAND
- DOM 住用構築物
DOMESTIC STRUCTURE
- M/U 荒地
UNUSED LAND

- ① 實地照片的觀景點
VIEWING POINT OF SITE PHOTO

註釋 Notes:

- (1) 2022年4月14日勘測的土地用途
Land uses shown on this plan are in accordance with the land use survey conducted by the Planning Department on 14.4.2022
- (2) * 土地用途跟1991年勘測的土地用途一致
Indicates that the use is the same as that revealed by the land use survey conducted by the Planning Department in 1991
- (3) ^ 土地用途跟1991年勘測的土地用途有別
Indicates that the use is different from that revealed by the land use survey conducted by the Planning Department on 1991

本摘要圖於2022年5月16日擬備，
所根據的資料為測量圖編號
3-SW-1B
EXTRACT PLAN PREPARED ON 16.5.2022
BASED ON SURVEY SHEETS No.
3-SW-1B

平面圖 SITE PLAN

擬議臨時度假營及附屬設施 (為期 3 年)
粉嶺丈量約份第 52 約地段第 76 號 (部分)
及第 79 號餘段 (部分)
PROPOSED TEMPORARY HOLIDAY CAMP AND ANCILLARY FACILITIES
FOR A PERIOD OF 3 YEARS
LOTS 76 (PART) AND 79 RP (PART) IN D.D. 52, FANLING

SCALE 1 : 1 000 比例尺
0 20 40
米 METRES

規劃署
PLANNING
DEPARTMENT



參考編號
REFERENCE No.
A/FLN/29

圖 PLAN
A-2



圖例 LEGEND



申請地點(界線只作識別用)
APPLICATION SITE
(BOUNDARY FOR IDENTIFICATION
PURPOSE ONLY)



入口/出口
INGRESS / EGRESS

本摘要圖於2022年4月22日擬備，所根據的資料為地政總署於2021年1月14日拍得的航攝照片編號 E124092C 及 E124720C EXTRACT PLAN PREPARED ON 22.4.2021 BASED ON AERIAL PHOTO No. E124092C AND E124720C TAKEN ON 14.1.2021 BY LANDS DEPARTMENT

航攝照片 AERIAL PHOTO

擬議臨時度假營及附屬設施(為期 3 年)
粉嶺丈量約份第 52 約地段第 76 號(部分)
及第 79 號餘段(部分)

PROPOSED TEMPORARY HOLIDAY CAMP AND ANCILLARY FACILITIES
FOR A PERIOD OF 3 YEARS
LOTS 76 (PART) AND 79 RP (PART) IN D.D. 52, FANLING

規劃署
PLANNING
DEPARTMENT



參考編號
REFERENCE No.
A/FLN/29

圖 PLAN
A-3



申請地點界線只作識別用
APPLICATION SITE BOUNDARY FOR IDENTIFICATION PURPOSE ONLY

實地照片 SITE PHOTO

本圖於2022年4月26日擬備，所根據的資料為攝於2022年4月14日的實地照片

PLAN PREPARED ON 26.4.2022 BASED ON SITE PHOTOS TAKEN ON 14.4.2022

擬議臨時度假營及附屬設施（為期 3 年）
粉嶺丈量約份第 52 約地段第 76 號（部分）
及第 79 號餘段（部分）
PROPOSED TEMPORARY HOLIDAY CAMP AND ANCILLARY FACILITIES
FOR A PERIOD OF 3 YEARS
LOTS 76 (PART) AND 79 RP (PART) IN D.D. 52, FANLING

規 劃 署
PLANNING
DEPARTMENT



參考編號
REFERENCE No.
A/FLN/29

圖 PLAN
A-4