

<p>Project 項目名稱:</p> <p>Proposed Temporary Public Vehicle Park for Private Car & Light Goods Vehicle for a Period of 3 Years at Lot 1007 RP (Part) in D.D. 125 and Adjoining Government Land, Ha Tsuen, Yuen Long, N.T.</p>	<p>Drawing Title 圖目:</p> <p>Proposed Layout Plan</p> <p>Drawing No. 圖號:</p> <p>Figure 3</p>	<p>Remarks 備註:</p> <p>Scale 比例:</p> <p>1:1000</p>
---------------------------------------------------------------------------------------------------------------------------------------------------------------------------------------------------------------------------------	---------------------------------------------------------------------------------------------	---------------------------------------------------

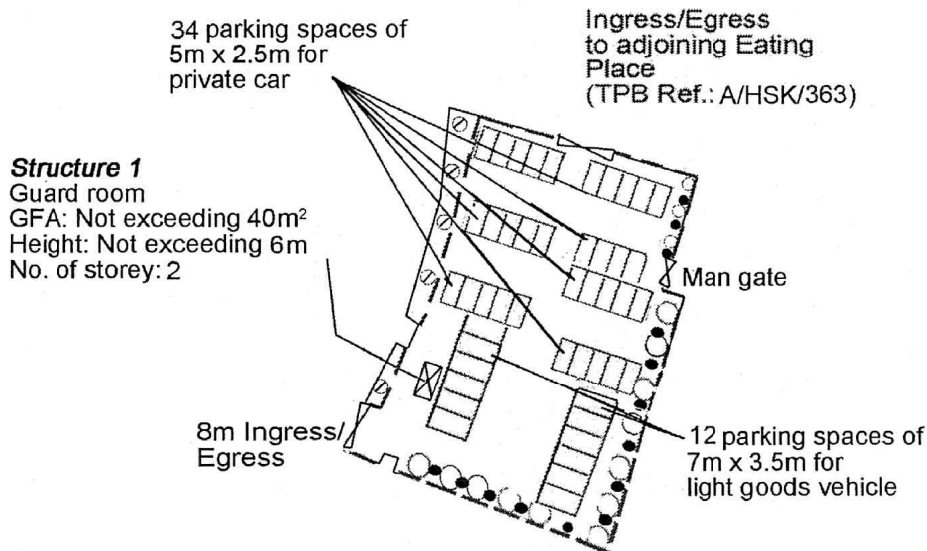

Tree	Approximate Height	Spacing	Quantity
○ Existing <i>Bauhinia blakeana</i> to be preserved	3m to 4.5m	4m	15
◉ Existing <i>Melaleuca leucadendron</i> to be preserved	5m to 5.5m	4m	5
● Existing <i>Dyopsis lutescens</i>	2m	4m	14



Project 項目名稱:

Proposed Temporary Public Vehicle Park for Private Car & Light Goods Vehicle for a Period of 3 Years at Lot 1007 RP (Part) in D.D. 125 and Adjoining Government Land, Ha Tsuen, Yuen Long, N.T.

Drawing Title 圖目:

Proposed Landscape & Tree Preservation Plan

Drawing No. 圖號:

Figure 4

Remarks 備註:

-- Existing fencing location

Scale 比例:

1:1000

(摘錄自申請人於 24. 6. 2022 呈交的申請書)
(Extract from Applicant's
Submission of 24.6.2022)

參考編號
REFERENCE No.
A/HSK/386

繪圖 DRAWING
A-2

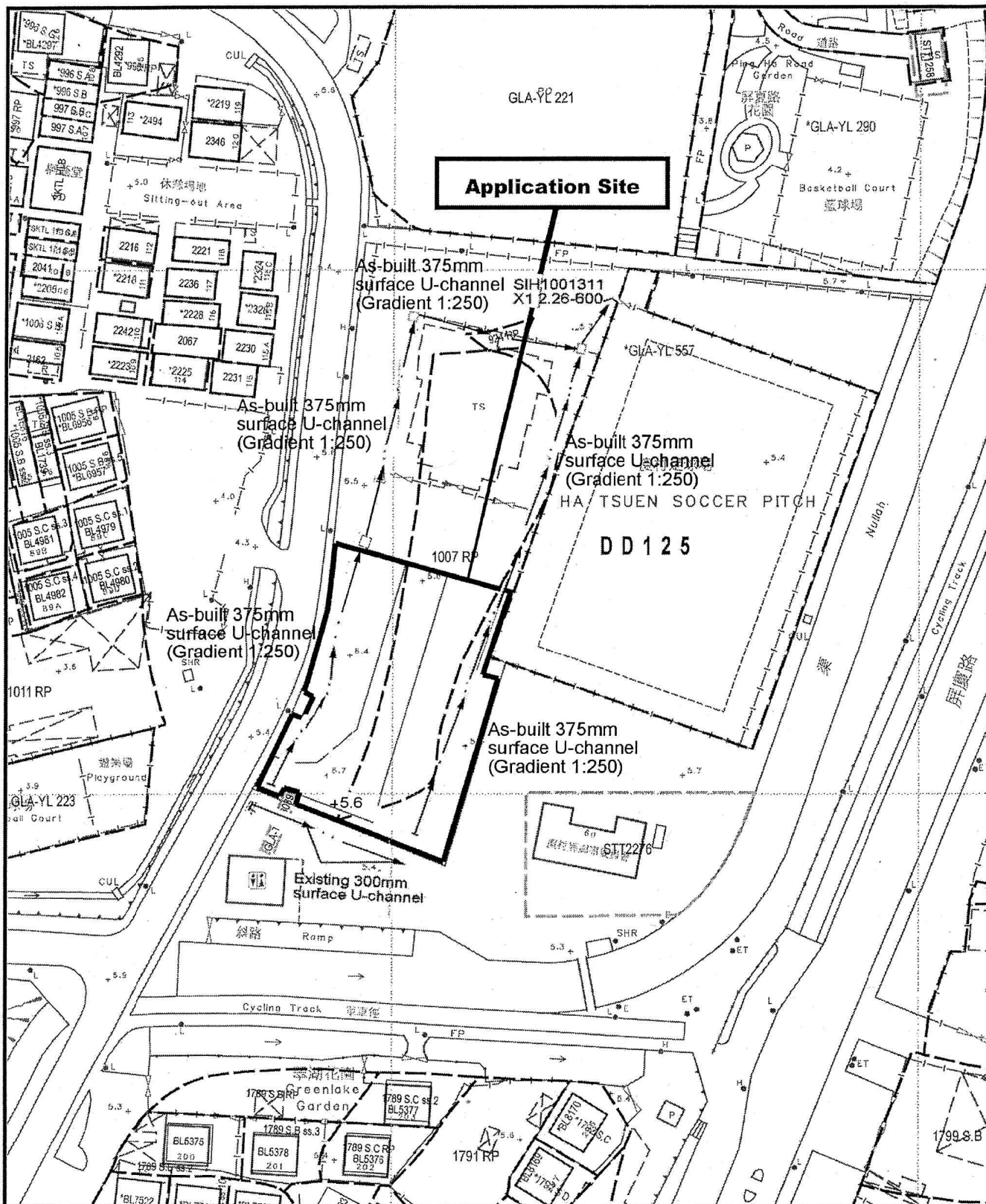

Project 項目名稱:

Proposed Temporary Public Vehicle Park for Private Car & Light Goods Vehicle for a Period of 3 Years at Lot 1007 RP (Part) in D.D. 125 and Adjoining Government Land, Ha Tsuen, Yuen Long, N.T.

Drawing Title 圖目:

As-built Drainage Plan

Drawing No. 圖號:

Figure 5

Remarks 備註:

+5.6 Level (in mPD)

← Flow of surface runoff

□ Catchpit

Scale 比例:

1:1000

(摘錄自申請人於 24. 6. 2022 呈交的申請書)
(Extract from Applicant's
Submission of 24.6.2022)

參考編號
REFERENCE No.
A/HSK/386

繪圖 DRAWING
A-3

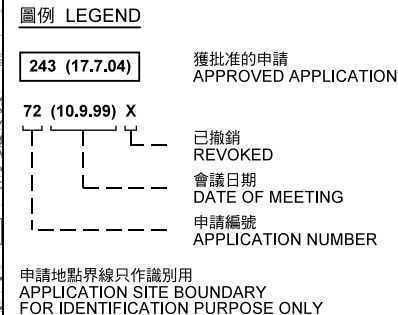
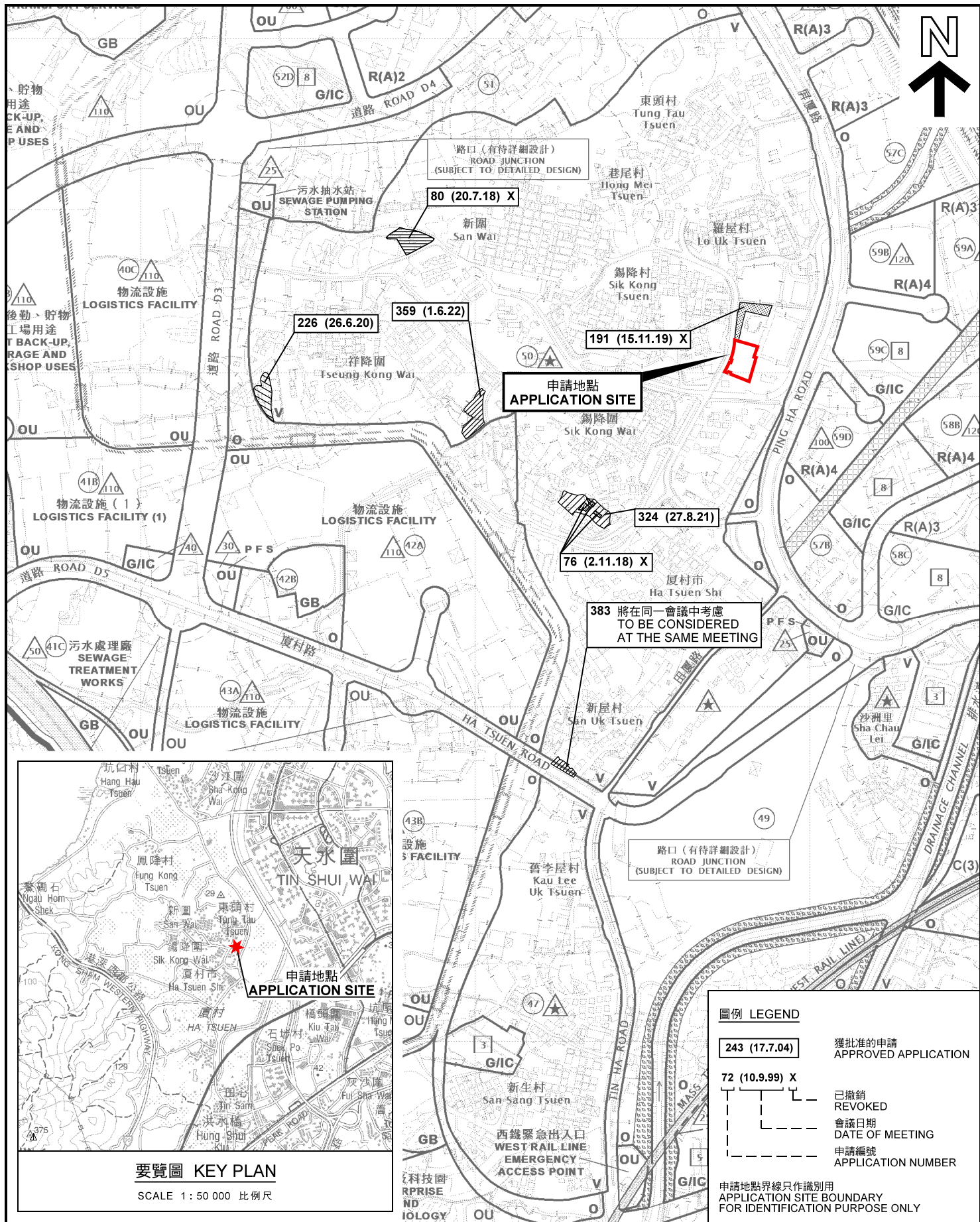

本摘要圖於2022年7月13日擬備，
所根據的資料為2018年10月16日
核准的分區計劃大綱圖編號 S/HSK/2
EXTRACT PLAN PREPARED ON 13.7.2022
BASED ON OUTLINE ZONING PLAN No.
S/HSK/2 APPROVED ON 16.10.2018

位置圖及同類申請 LOCATION PLAN WITH SIMILAR APPLICATIONS

臨時公眾停車場(私家車及輕型貨車)(為期3年)
元朗厦村丈量約份第125約地段
第1007號餘段(部分)和毗連政府土地
TEMPORARY PUBLIC VEHICLE PARK
(PRIVATE CAR AND LIGHT GOODS VEHICLE)
FOR A PERIOD OF 3 YEARS
LOT 1007 RP (PART) IN D.D.125 AND
ADJOINING GOVERNMENT LAND, HA TSUEN, YUEN LONG
SCALE 1:7 500 比例尺

米 100 0 100 200 300 米
METRES

**規劃署
PLANNING
DEPARTMENT**

參考編號
REFERENCE No.
A/HSK/386

**圖 PLAN
A-1a**

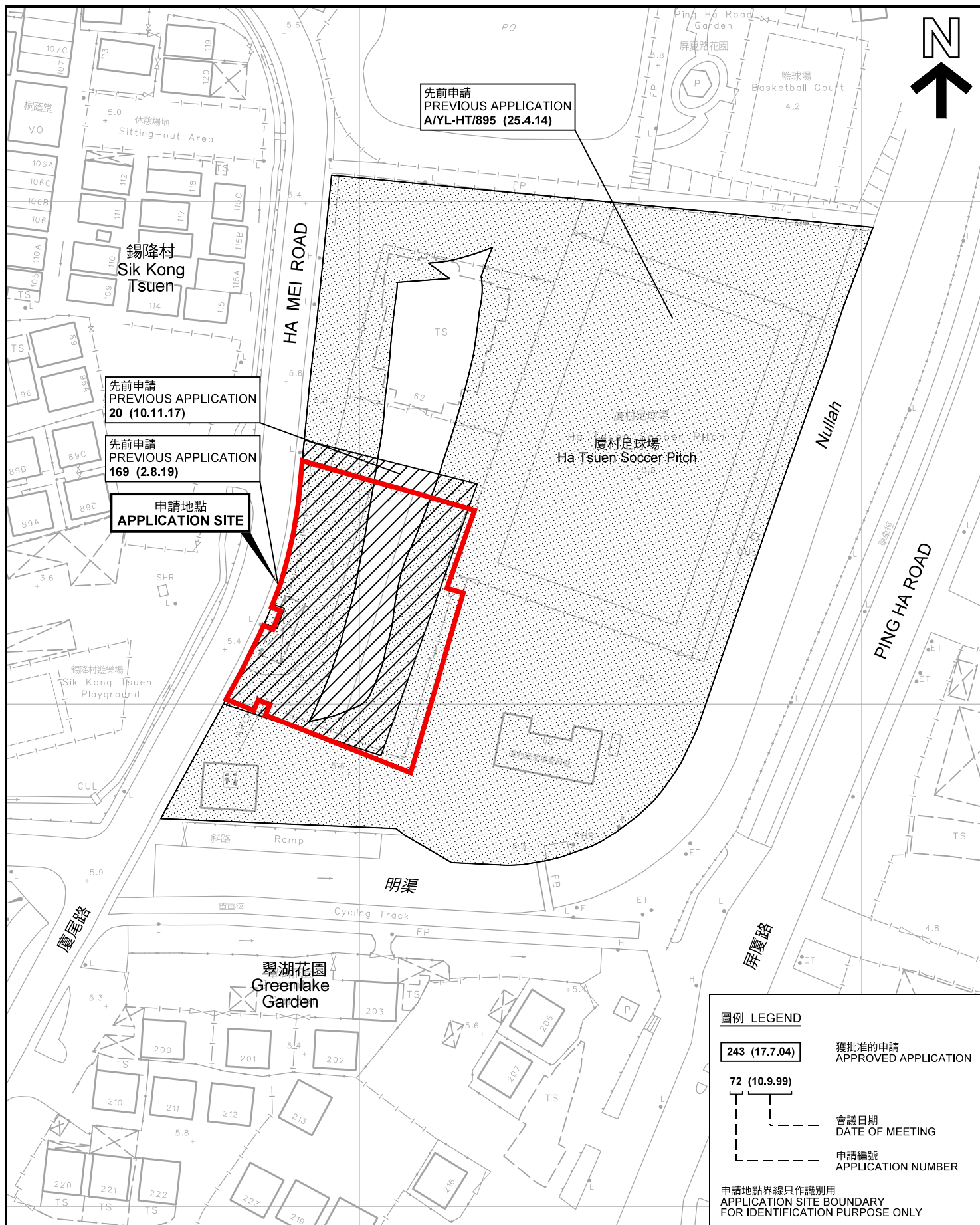

圖例 LEGEND

- 243 (17.7.04)** 獲批准的申請 APPROVED APPLICATION
- 72 (10.9.99)** 會議日期 DATE OF MEETING
- 申請編號 APPLICATION NUMBER

申請地點界線只作識別用
APPLICATION SITE BOUNDARY
FOR IDENTIFICATION PURPOSE ONLY

先前申請圖 PREVIOUS APPLICATIONS PLAN

臨時公眾停車場(私家車及輕型貨車)(為期3年)

元朗厦村丈量約份第125約地段
第1007號餘段(部分)和毗連政府土地
TEMPORARY PUBLIC VEHICLE PARK
(PRIVATE CAR AND LIGHT GOODS VEHICLE)
FOR A PERIOD OF 3 YEARS

LOT 1007 RP (PART) IN D.D.125 AND
ADJOINING GOVERNMENT LAND, HA TSUEN, YUEN LONG
SCALE 1 : 1 000 比例尺

米 20 0 20 40 米
METRES

本摘要圖於2022年7月26日擬備，所根據的
資料為測量圖編號 6-NW-7B
EXTRACT PLAN PREPARED ON 26.7.2022
BASED ON SURVEY SHEET No.
6-NW-7B

規劃署
PLANNING
DEPARTMENT



參考編號
REFERENCE No.
A/HSK/386

圖 PLAN
A-1b

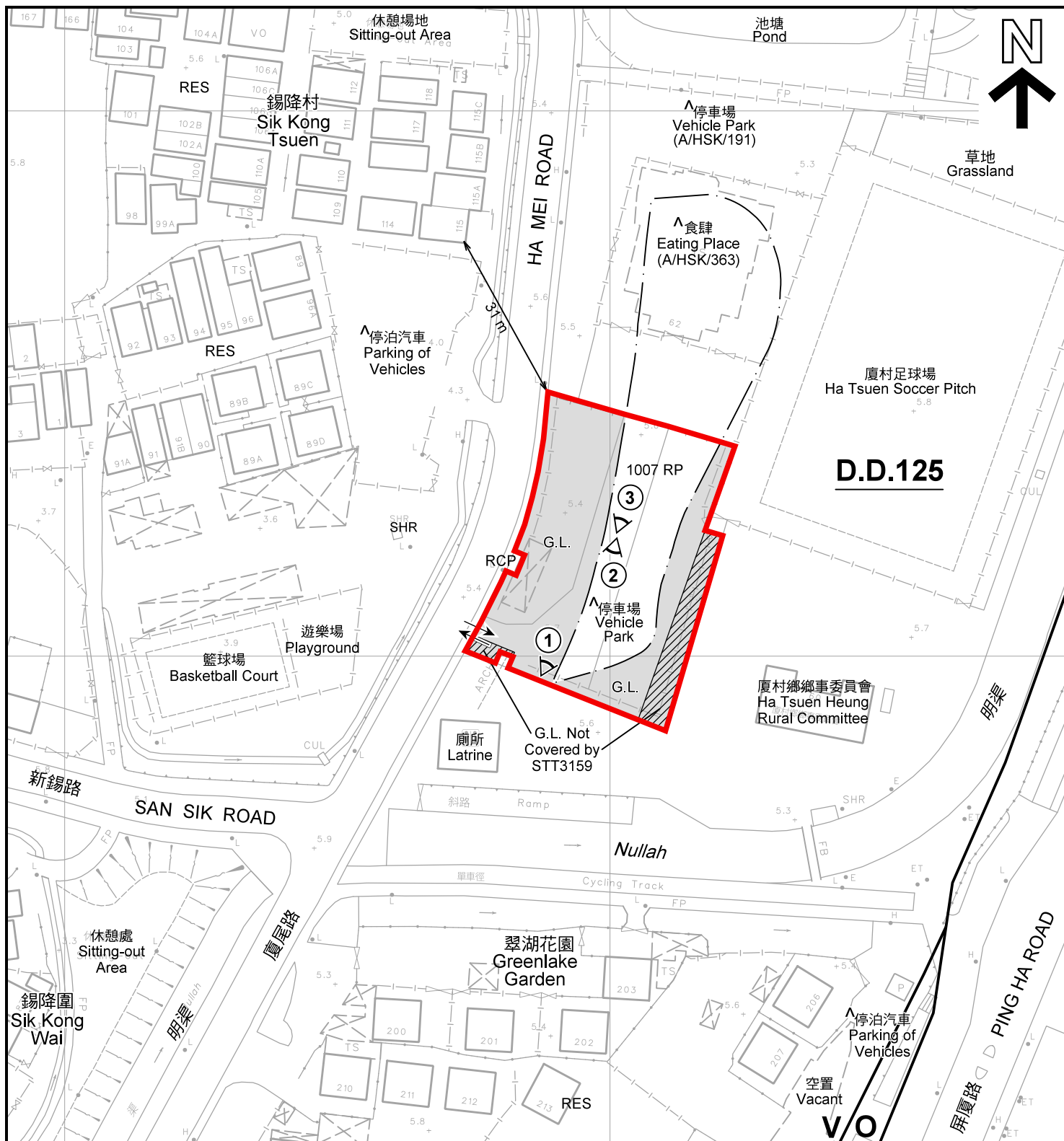

註釋 Notes :

- (1) 2022年7月5日勘測的土地用途
Land uses shown on this plan are in accordance with the land use survey conducted by the Planning Department on 5.7.2022
- (2) * 土地用途跟1992年3月勘測的土地用途一致
Indicates that the use is the same as that revealed by the land use survey conducted by the Planning Department in Mar 1992
- (3) ^ 土地用途跟1992年3月勘測的土地用途有別
Indicates that the use is different from that revealed by the land use survey conducted by the Planning Department in Mar 1992

圖例 LEGEND



申請地點(界線只作識別用)
APPLICATION SITE
(BOUNDARY FOR IDENTIFICATION
PURPOSE ONLY)



鄉村式發展
VILLAGE TYPE DEVELOPMENT



休憩用地
OPEN SPACE



政府土地
GOVERNMENT LAND

RES 住用構築物
RESIDENTIAL STRUCTURES

RCP 垃圾收集站
REFUSE COLLECTION POINT

SHR 神龕
SHRINE

① 實地照片的觀景點
VIEWING POINT OF SITE PHOTO

↔ 入口/出口
INGRESS / EGRESS

平面圖 SITE PLAN

臨時公眾停車場(私家車及輕型貨車)(為期3年)

元朗厦村丈量約份第125約地段

第1007號餘段(部分)和毗連政府土地

TEMPORARY PUBLIC VEHICLE PARK
(PRIVATE CAR AND LIGHT GOODS VEHICLE)

FOR A PERIOD OF 3 YEARS

LOT 1007 RP (PART) IN D.D.125 AND
ADJOINING GOVERNMENT LAND, HA TSUEN, YUEN LONG

SCALE 1 : 1 000 比例尺

米 20 0 20 40 米
METRES

本摘要圖於2022年7月27日擬備，所根據的
資料為測量圖編號 6-NW-7B
EXTRACT PLAN PREPARED ON 27.7.2022
BASED ON SURVEY SHEET No.
6-NW-7B

**規劃署
PLANNING
DEPARTMENT**



參考編號
REFERENCE No.
A/HSK/386

圖 PLAN
A-2



圖例 LEGEND



申請地點(界線只作識別用)
APPLICATION SITE
(BOUNDARY FOR IDENTIFICATION
PURPOSE ONLY)

本摘要圖於2022年7月21日擬備，所根據的資料為地政總署於2021年7月24日拍得的航攝照片編號 E140427C
EXTRACT PLAN PREPARED ON 21.7.2022
BASED ON AERIAL PHOTO No.
E140427C TAKEN ON 24.7.2021
BY LANDS DEPARTMENT

航攝照片 AERIAL PHOTO

臨時公眾停車場(私家車及輕型貨車)(為期3年)
元朗厦村丈量約份第125約地段
第1007號餘段(部分)和毗連政府土地
TEMPORARY PUBLIC VEHICLE PARK
(PRIVATE CAR AND LIGHT GOODS VEHICLE)
FOR A PERIOD OF 3 YEARS
LOT 1007 RP (PART) IN D.D.125 AND
ADJOINING GOVERNMENT LAND, HA TSUEN, YUEN LONG

規劃署
PLANNING
DEPARTMENT



參考編號
REFERENCE No.
A/HSK/386

圖 PLAN
A-3



實地照片 SITE PHOTOS

臨時公眾停車場(私家車及輕型貨車)(為期3年)
元朗廈村丈量約份第125約地段
第1007號餘段(部分)和毗連政府土地
TEMPORARY PUBLIC VEHICLE PARK
(PRIVATE CAR AND LIGHT GOODS VEHICLE)
FOR A PERIOD OF 3 YEARS
LOT 1007 RP (PART) IN D.D.125 AND
ADJOINING GOVERNMENT LAND, HA TSUEN, YUEN LONG

規劃署
PLANNING
DEPARTMENT



參考編號
REFERENCE No.
A/HSK/386

圖 PLAN
A-4

本圖於2022年7月19日擬備，所根據的
資料為攝於2022年7月5日的實地照片
PLAN PREPARED ON 19.7.2022
BASED ON SITE PHOTOS
TAKEN ON 5.7.2022