

(摘錄自申請人於 26. 6. 2023 呈交的申請書)
(Extract from Applicant's
Submission of 26.6.2023)

參考編號
REFERENCE No.
A/HSK/472

繪圖 DRAWING
A-1

DEVELOPMENT PARAMETERS

APPLICATION SITE AREA	: 680 m ²	(ABOUT)
COVERED AREA	: 310 m ²	(ABOUT)
UNCOVERED AREA	: 370 m ²	(ABOUT)
PLOT RATIO	: 0.46	(ABOUT)
SITE COVERAGE	: 46 %	(ABOUT)
NO. OF STRUCTURE	: 1	
DOMESTIC GFA	: NOT APPLICABLE	
NON-DOMESTIC GFA	: 310 m ²	(ABOUT)
TOTAL GFA	: 310 m ²	(ABOUT)
BUILDING HEIGHT	: 5 m (ABOUT)	
NO. OF STOREY	: 1	

STRUCTURE	USE	COVERED AREA	GFA	BUILDING HEIGHT
B1	WAREHOUSE (EXCLUDING D.G.G.) SITE OFFICE, WASHROOM, FSIs	310 m ² (ABOUT)	310 m ² (ABOUT)	5 m (ABOUT)(1-STOREY)
TOTAL		310 m ² (ABOUT)	310 m ² (ABOUT)	

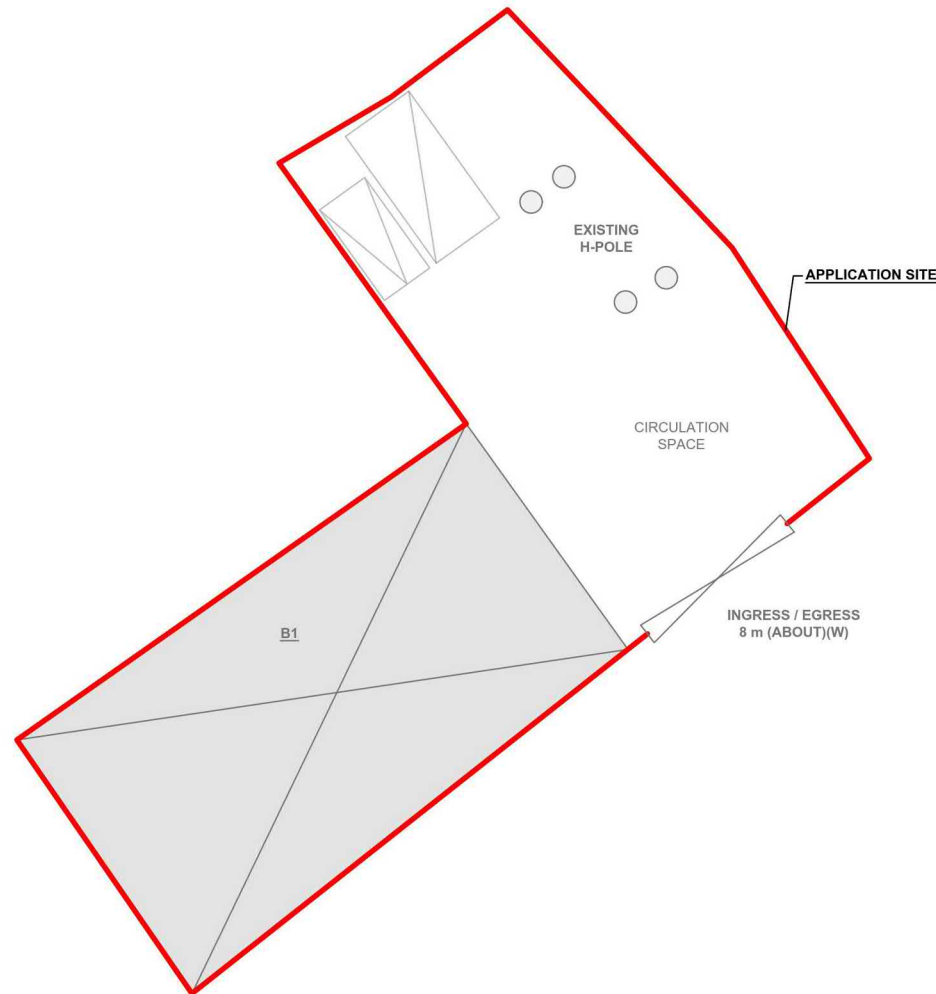
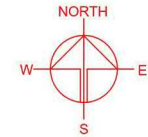

PARKING AND LOADING/UNLOADING PROVISIONS

NO. OF PRIVATE CAR PARKING SPACE	: 1
DIMENSION OF PARKING SPACE	: 5 m (L) X 2.5 m (W)
NO. OF L/U/L SPACE FOR LGV	: 1
DIMENSION OF PARKING SPACE	: 7 m (L) X 3.5 m (W)

LEGEND

	APPLICATION SITE
	STRUCTURE
	PARKING SPACE
	L/U/L SPACE
	INGRESS / EGRESS

PLANNING CONSULTANT



PROJECT

PROPOSED WAREHOUSE (EXCLUDING DANGEROUS GOODS GODOWN) WITH ANCILLARY FACILITIES FOR A PERIOD OF 3 YEARS

SITE LOCATION

VARIOUS LOTS IN D.D. 125, HA TSUEN, YUEN LONG, NEW TERRITORIES

SCALE

1:100 @ A4

DRAWN BY MN	DATE 1.6.2023
REVISED BY OL	DATE 30.6.2023
APPROVED BY	DATE

DWG. TITLE
LAYOUT PLAN

DWG NO. P04	VER. 001
----------------	-------------

(摘錄自申請人於 30.6.2023 呈交的補充資料)
(Extract from Applicant's Supplementary
Information Submitted on 30.6.2023)

參考編號
REFERENCE No.
A/HSK/472

繪圖 DRAWING
A-2

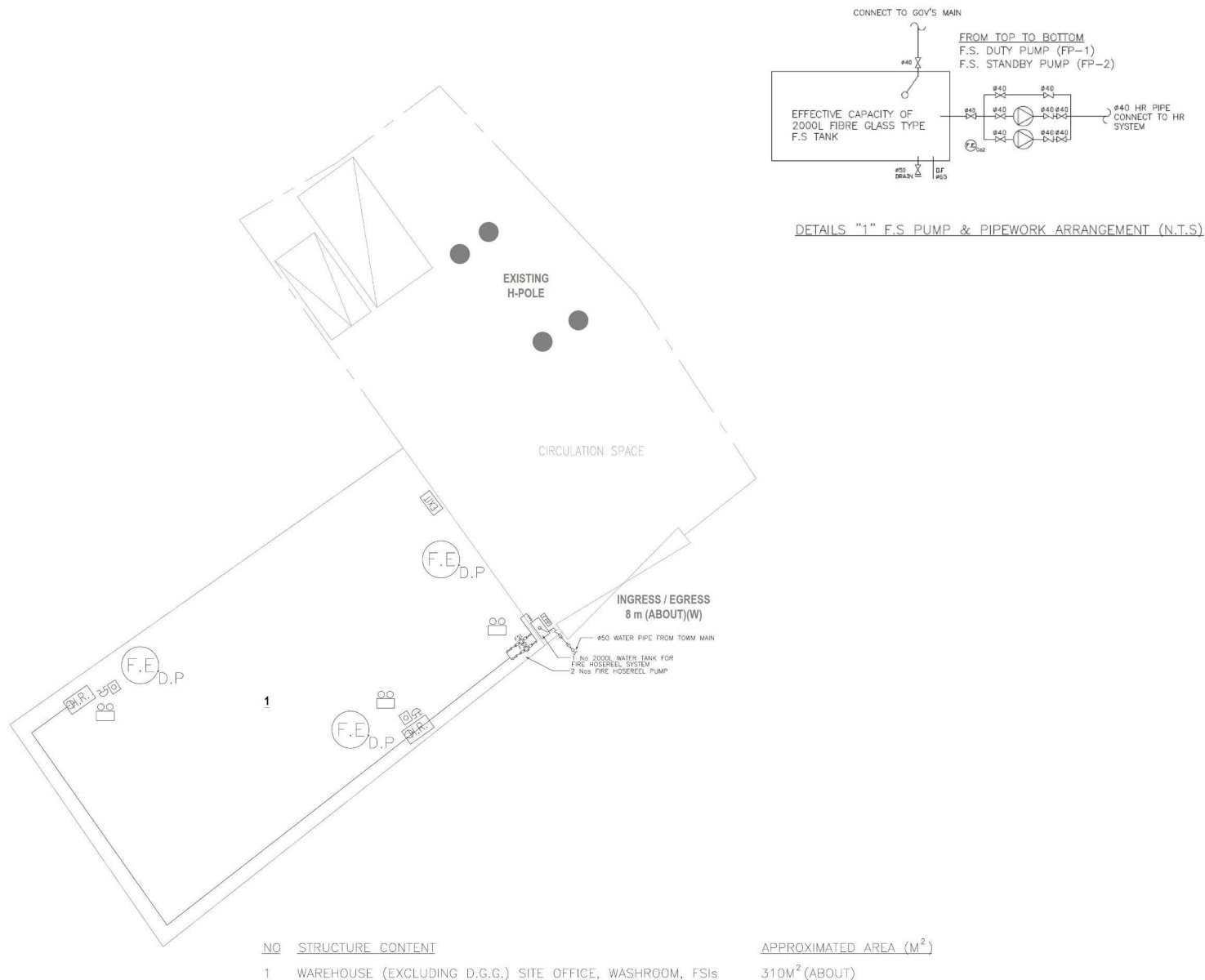

NO STRUCTURE CONTENT

1 WAREHOUSE (EXCLUDING D.G.G.) SITE OFFICE, WASHROOM, FSIs

APPROXIMATED AREA (M²)

310M²(ABOUT)

REV	DESCRIPTION	DATE
E	PD SUBMISSION	13-08-2021
C	PD SUBMISSION	11-10-2022
B	PD SUBMISSION	20-12-2021
A	PD SUBMISSION	08-05-2019
REV	DESCRIPTION	DATE
PD CONTRACTOR		
East Power Engineering Limited		
PROJECT		
PROPOSED TEMPORARY WAREHOUSE (EXCLUDING CHANGING ROOMS) LOCATED WITHIN ANGLANTY FACILITIES FOR A PERIOD OF 3 YEARS (VARIOUS LOTS IN LOT 10A HA TSIEN, TAIPEI, NEW TERRITORIES)		
DRAWING TITLE		
F.S. LAYOUT PLAN (ON GROUND) FLOOR		
NO.	DESCRIPTION	DATE
DRAWN BY	CAD	07-12-2021
DESIGN BY	JACK	07-12-2021
CHECK BY	CM	08-12-2021
APPROVED BY	-	-
PROJECT NO.	ALPH/472	
PAPER SIZE	A1	PLOT SCALE
DRAWING NO.	EP-HSK472-1202	
SCALE	1:1	REVISION

(摘錄自申請人於 14. 8. 2023 呈交的進一步資料)
(Extract from Applicant's Further
Information Submitted on 14.8.2023)

參考編號
REFERENCE No.
A/HSK/472

繪圖 DRAWING
A-3

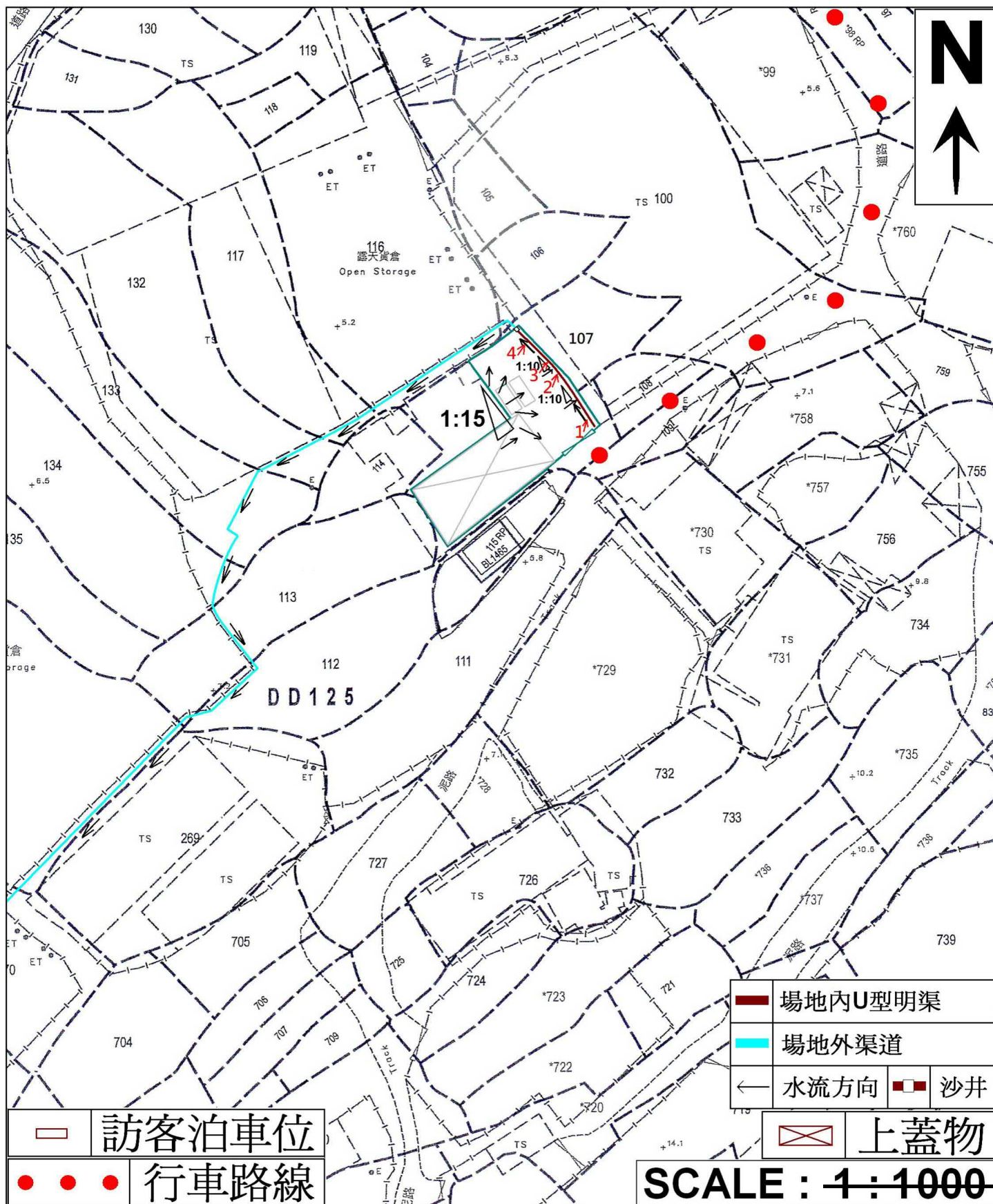

(摘錄自申請人於 30.6.2023 呈交的補充資料)
(Extract from Applicant's Supplementary
Information Submitted on 30.6.2023)

參考編號
REFERENCE No.
A/HSK/472

繪圖 DRAWING
A-4

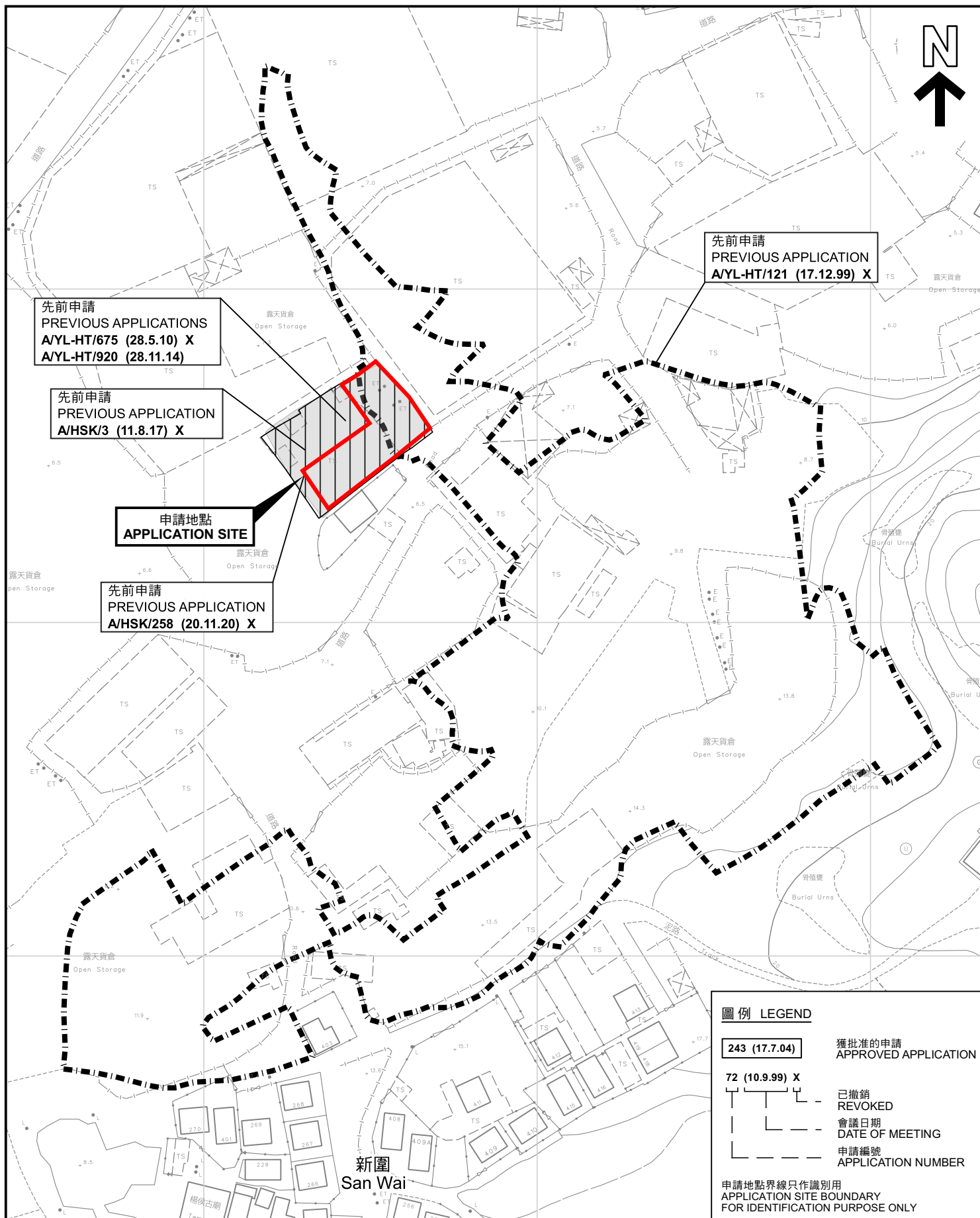

先前申請圖 PREVIOUS APPLICATIONS PLAN

擬議臨時貨倉(危險品倉庫除外)連附屬設施(為期3年)
元朗厦村丈量約份第125約地段第107號(部分)、第110號(部分)及第115號A分段(部分)
PROPOSED TEMPORARY WAREHOUSE
(EXCLUDING DANGEROUS GOODS GODOWN) WITH ANCILLARY FACILITIES
FOR A PERIOD OF 3 YEARS
LOTS 107 (PART), 110 (PART) AND 115 S.A (PART) IN D.D.125,
HA TSUEN, YUEN LONG

SCALE 1:1 500 比例尺
米 25 0 25 50 米
METRES

規 劃 署
PLANNING
DEPARTMENT



參考編號
REFERENCE No.
A/HSK/472

圖 PLAN
A-1b

本摘要圖於2023年8月10日擬備，所根據的
資料為測量圖編號 6-NW-2C
EXTRACT PLAN PREPARED ON 10.8.2023
BASED ON SURVEY SHEET No.
6-NW-2C

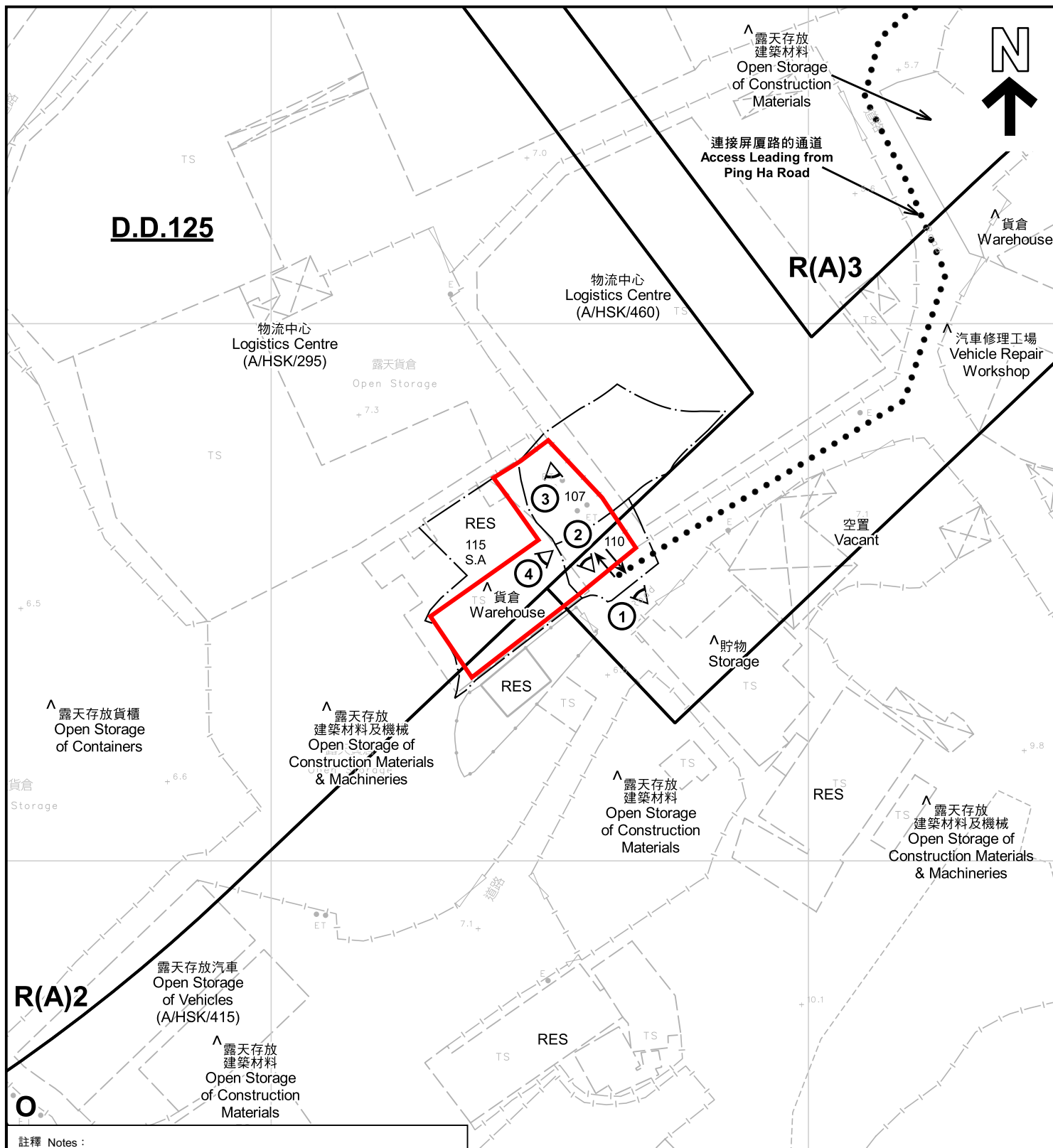

註釋 Notes :

- (1) 2023年7月4日勘測的土地用途
Land uses shown on this plan are in accordance with the land use survey conducted by the Planning Department on 4.7.2023
- (2) * 土地用途跟1992年3月勘測的土地用途一致
Indicates that the use is the same as that revealed by the land use survey conducted by the Planning Department in Mar 1992
- (3) ^ 土地用途跟1992年3月勘測的土地用途有別
Indicates that the use is different from that revealed by the land use survey conducted by the Planning Department in Mar 1992

圖例 LEGEND

- | | | | |
|------|---|-----|---|
| | 申請地點 (界線只作識別用)
APPLICATION SITE (BOUNDARY FOR IDENTIFICATION PURPOSE ONLY) | RES | 住用構築物
RESIDENTIAL STRUCTURES |
| R(A) | 住宅 (甲類)
RESIDENTIAL (GROUP A) | | 實地照片的觀景點
VIEWING POINT OF SITE PHOTO |
| O | 休憩用地
OPEN SPACE | | 入口/出口
INGRESS / EGRESS |

平面圖 SITE PLAN

擬議臨時貨倉(危險品倉庫除外)連附屬設施(為期3年)
元朗厦村丈量約份第125約地段第107號(部分)、第110號(部分)及第115號A分段(部分)
PROPOSED TEMPORARY WAREHOUSE
(EXCLUDING DANGEROUS GOODS GODOWN) WITH ANCILLARY FACILITIES
FOR A PERIOD OF 3 YEARS
LOTS 107 (PART), 110 (PART) AND 115 S.A (PART) IN D.D.125,
HA TSUEN, YUEN LONG

SCALE 1 : 1 000 比例尺

米 20 0 20 40 米
METRES

規劃署
PLANNING
DEPARTMENT



參考編號
REFERENCE No.
A/HSK/472

圖 PLAN
A-2

本摘要圖於2023年8月10日擬備，所根據的
資料為測量圖編號 6-NW-2C
EXTRACT PLAN PREPARED ON 10.8.2023
BASED ON SURVEY SHEET No.
6-NW-2C



圖例 LEGEND

 申請地點(界線只作識別用)
APPLICATION SITE
(BOUNDARY FOR IDENTIFICATION
PURPOSE ONLY)

本摘要圖於2023年7月28日擬備，所根據
的資料為地政總署於2022年3月8日拍得
的航攝照片編號 E153041C
EXTRACT PLAN PREPARED ON 28.7.2023
BASED ON AERIAL PHOTO No.
E153041C TAKEN ON 8.3.2022
BY LANDS DEPARTMENT

航攝照片 AERIAL PHOTO

擬議臨時貨倉(危險品倉庫除外)連附屬設施(為期3年)
元朗廈村丈量約份第125約地段第107號(部分)、第110號(部分)及第115號A分段(部分)
PROPOSED TEMPORARY WAREHOUSE
(EXCLUDING DANGEROUS GOODS GODOWN) WITH ANCILLARY FACILITIES
FOR A PERIOD OF 3 YEARS
LOTS 107 (PART), 110 (PART) AND 115 S.A (PART) IN D.D.125,
HA TSUEN, YUEN LONG

規 劃 署
PLANNING
DEPARTMENT



參考編號
REFERENCE No.
A/HSK/472

圖 PLAN
A-3



申請地點界線只作識別用 APPLICATION SITE BOUNDARY FOR IDENTIFICATION PURPOSE ONLY

實地照片 SITE PHOTOS

擬議臨時貨倉(危險品倉庫除外)連附屬設施(為期3年)
元朗廈村丈量約份第125約地段第107號(部分)、第110號(部分)及第115號A分段(部分)
PROPOSED TEMPORARY WAREHOUSE
(EXCLUDING DANGEROUS GOODS GODOWN) WITH ANCILLARY FACILITIES
FOR A PERIOD OF 3 YEARS
LOTS 107 (PART), 110 (PART) AND 115 S.A (PART) IN D.D.125,
HA TSUEN, YUEN LONG

規劃署
PLANNING
DEPARTMENT



參考編號
REFERENCE No.
A/HSK/472

圖 PLAN
A-4

本圖於2023年8月10日擬備，所根據的資料為攝於2023年7月4日的實地照片
PLAN PREPARED ON 10.8.2023
BASED ON SITE PHOTOS
TAKEN ON 4.7.2023