

(資料來源:申請人於 23.2.2022 呈交的資料)  
(Source : Applicant's Submission of 23.2.2022)

參考編號  
REFERENCE No.  
A/KTN/84

繪圖 DRAWING  
A-1

BUILDING HEIGHT RESTRICTION  
(BHR) TO BE RELAXED FROM  
145.00 mPD TO 151.00 mPD

# PHASE 1A

# PHASE 1B

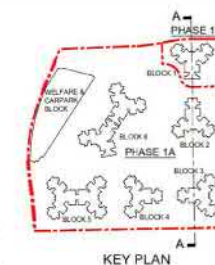

SITE SECTION A-A (PHASES 1A AND 1B)  
1 : 750

PRELIMINARY DESIGN  
SCHEME 31 (11.2021)

FOR IDENTIFICATION  
PURPOSE (DESIGN  
SUBJECT TO CHANGE)

PROJECT  
PUBLIC HOUSING DEVELOPMENT  
AT KWU TUNG NORTH AREA 19

DRAWING TITLE  
SECTION A - A (WEST)



房屋署  
HOUSING DEPARTMENT

SCALE  
1 : 750

DATE  
11/11/2021

(資料來源:申請人於 23.2.2022 呈交的資料)  
(Source : Applicant's Submission of 23.2.2022)

參考編號  
REFERENCE No.  
A/KTN/84

繪圖 DRAWING  
A-2



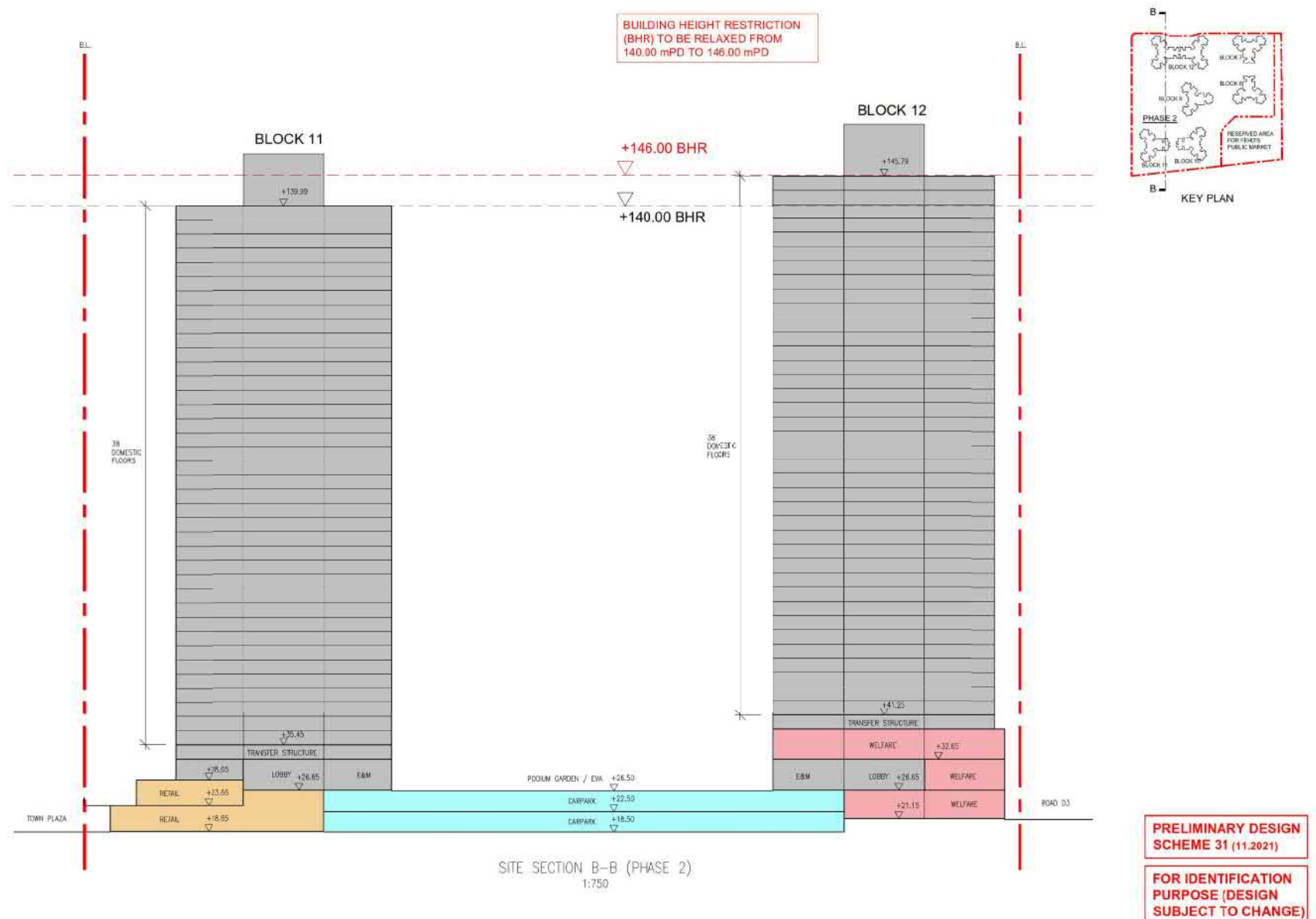

PROJECT  
PUBLIC HOUSING DEVELOPMENT  
AT KWU TUNG NORTH AREA 19

DRAWING TITLE  
SECTION B - B (EAST)



房屋署  
HOUSING DEPARTMENT

SCALE:  
1:750

DATE:  
11/11/2021

(資料來源:申請人於 23.2.2022 呈交的資料)  
(Source : Applicant's Submission of 23.2.2022)

參考編號  
REFERENCE No.  
A/KTN/84

繪圖 DRAWING  
A-4



# Legend

- Site Boundary
- Planting Area
- Vertical Greening
- Tree Planting
- Children's Play Area
- Badminton Court
- Bench
- Trellis
- Feature Trellis
- Basketball Court
- Table Tennis Table
- Bicycle Parking
- Covered Walkway
- Water Works Reserve Area

## \* Development Parameters of KTN area 19

Site Area	6.87 Ha	
	Required	Complied (Y/N)
Green Ratio	30%	Y
Site coverage of greening	2.06Ha	Y
Local Open Space	22,700m <sup>2</sup>	Y



## PROPOSED PUBLIC HOUSING DEVELOPMENT AT KWU TUNG NORTH AREA 19 LANDSCAPE MASTER PLAN OF KTN19 PHASE 1 (OVERALL)

DRAWING NO.  
Figure 8

SCALE  
1:800 (A3)

DATE  
23.3.2022

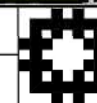

房屋署  
HOUSING DEPARTMENT

(資料來源:申請人於 12.4.2022 呈交的資料)  
(Source : Applicant's Submission of 12.4.2022)

參考編號  
REFERENCE No.  
A/KTN/84

繪圖 DRAWING  
A-5



# LEGEND

- Planting Area
- Green roof
- Vertical Green
- Ball Court
- Table Tennis Table
- Children's Play Area
- Feature Trellis
- Covered Walkway
- Trellis
- Bicycle Parking

## \* Development Parameters of KTN area 19

Site Area	6.87 Ha	
	Required	Complied (Y/N)
Green Ratio	30%	Y
Site coverage of greening	2.06Ha	Y
Local Open Space	22,700m <sup>2</sup>	Y



The LMP is for indication and information only, which is subject to detailed design and not for approval purpose.

## PROPOSED PUBLIC HOUSING DEVELOPMENT AT KWU TUNG NORTH AREA 19 LANDSCAPE MASTER PLAN - 2

DRAWING NO.  
Figure 9

SCALE  
1:600 (A3)

DATE  
13/1/2022

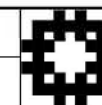

房屋署  
HOUSING DEPARTMENT

(資料來源:申請人於 23.2.2022 呈交的資料)  
(Source : Applicant's Submission of 23.2.2022)

參考編號  
REFERENCE No.  
A/KTN/84

繪圖 DRAWING  
A-6

## Current Scheme



## Proposed Scheme



### LEGEND:

-  Approved s16 application no. A/KTN/54 (Current Scheme)
-  The OZP Compliance Scheme
-  Planned Public Housing Site at Kwu Tung North NDA (Not part of this application and subject to detailed design)
-  Application Site

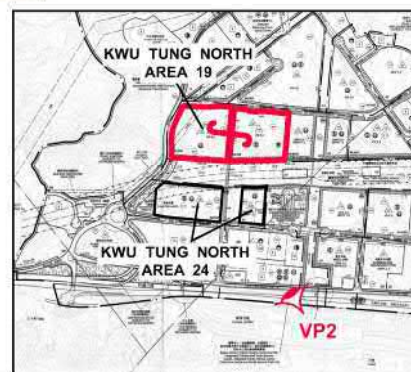

**PHOTOMONTAGE OF VIEWPOINT 2  
(VIEW FROM FOOTPATH ALONG FANLING  
HIGHWAY NEAR KWU TUNG SOUTH ROAD)**



**HOUSING DEPARTMENT  
PLANNING SECTIONS**

**PLAN 3**

**DATE :  
7. 2. 2022**

(資料來源:申請人於 23. 2. 2022 呈交的資料)  
(Source : Applicant's Submission of 23.2.2022)

參考編號  
REFERENCE No.  
A/KTN/84

繪圖 DRAWING  
A-7



## Current Scheme

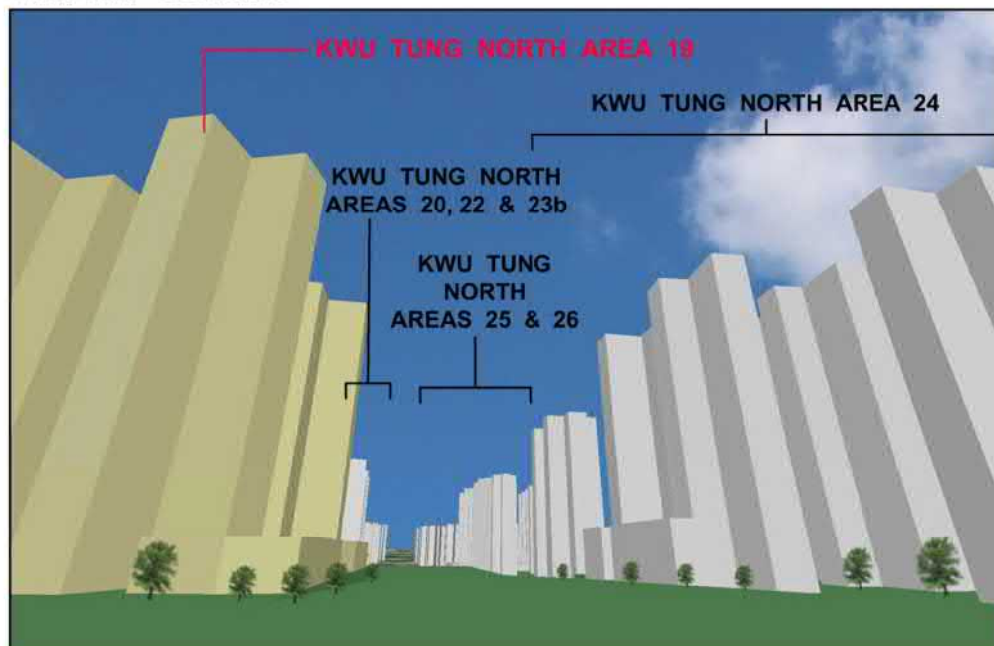

## Proposed Scheme

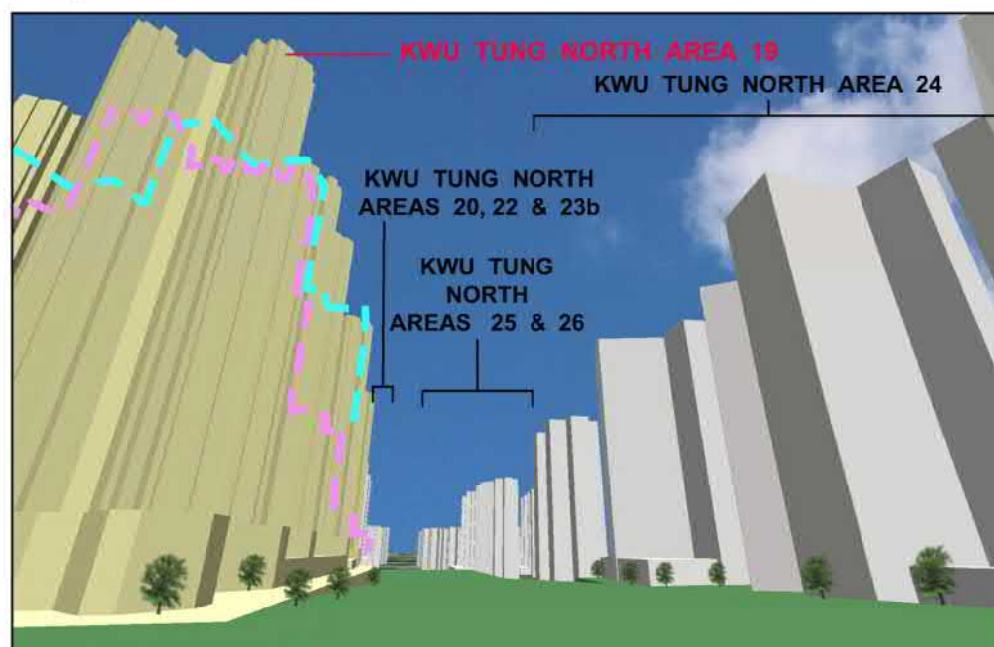

### LEGEND:

-  Approved s16 application no. A/KTN/54 (Current Scheme)
-  The OZP Compliance Scheme
-  Planned Public Housing Site at Kwu Tung North NDA (Not part of this application and subject to detailed design)
-  Application Site

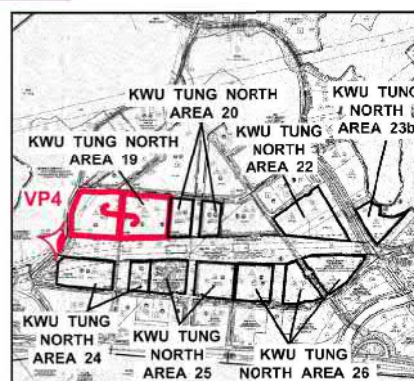

## PHOTOMONTAGE OF VIEWPOINT 4 (VIEW FROM PLANNED ROAD P1 NEAR AREA 24)



HOUSING DEPARTMENT  
PLANNING SECTIONS

PLAN 5

DATE :  
7. 2. 2022

(資料來源:申請人於 23. 2. 2022 呈交的資料)  
(Source : Applicant's Submission of 23.2.2022)

參考編號  
REFERENCE No.  
A/KTN/84

繪圖 DRAWING  
A-8



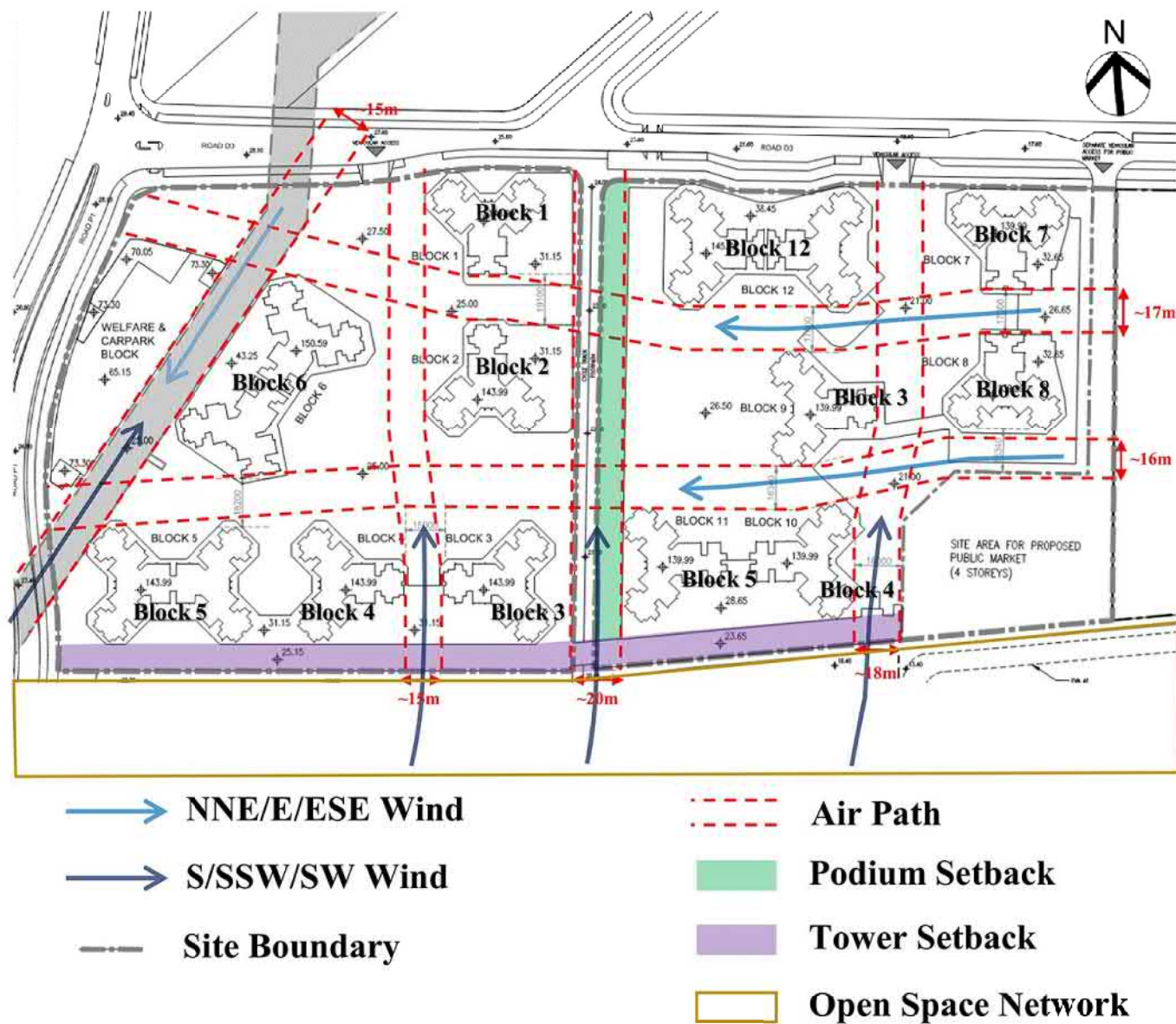

Wind Enhancement Features

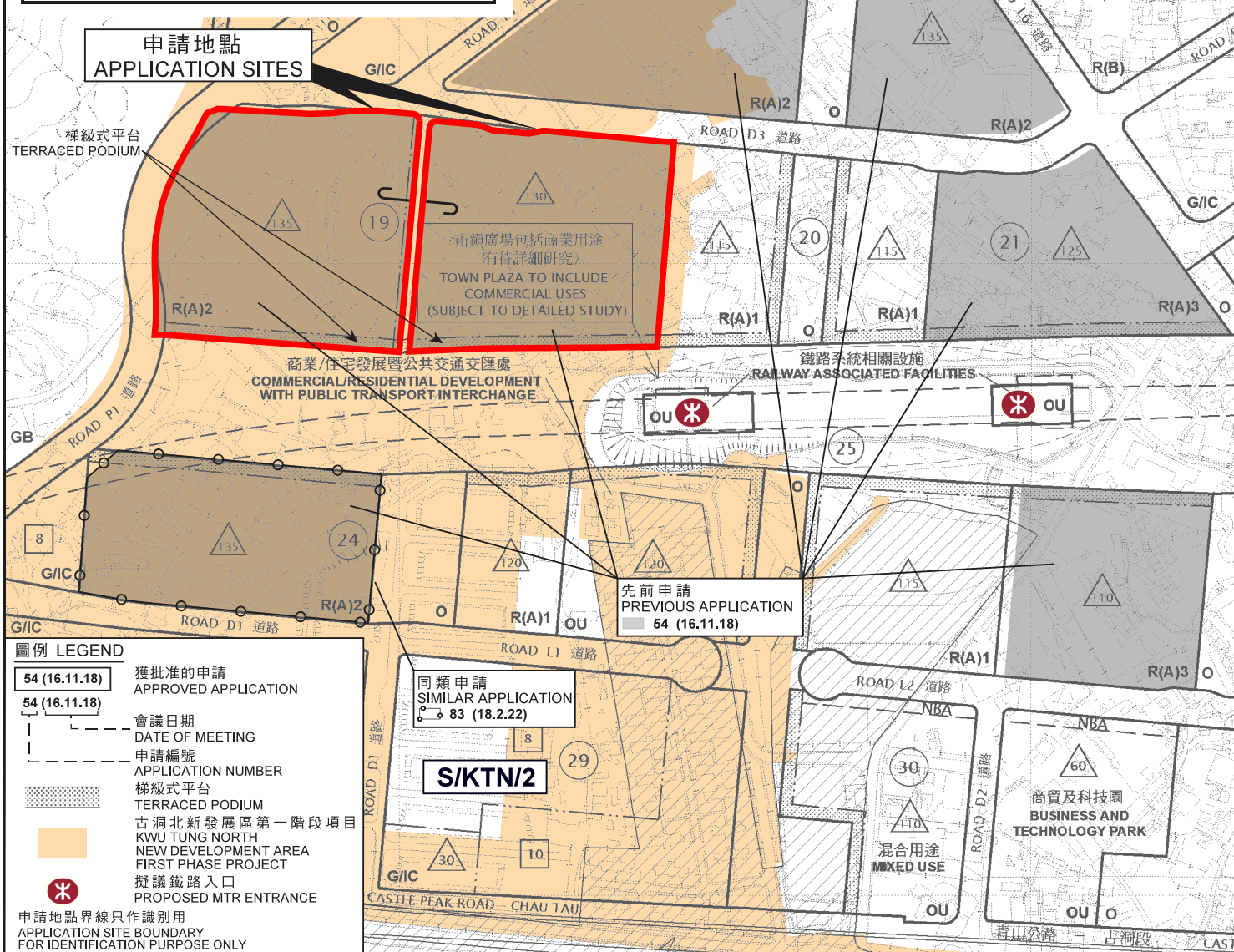

### 位置圖 LOCATION PLAN

擬議略為放寬地積比率及建築物高度限制以作准許的公營房屋發展  
新界古洞北新發展區第19區  
PROPOSED MINOR RELAXATION OF PLOT RATIO AND BUILDING HEIGHT RESTRICTIONS FOR PERMITTED PUBLIC HOUSING DEVELOPMENT  
AREA 19, KWU TUNG NORTH  
NEW DEVELOPMENT AREA, NEW TERRITORIES  
SCALE 1 : 5 000

METRES 100 0 100 200 METRES

規劃署  
PLANNING  
DEPARTMENT



參考編號  
REFERENCE No.  
A/KTN/84

圖 PLAN  
A-1

本摘要圖於2022年4月12日擬備，  
所根據的資料為於2015年6月16日核准的  
分區計劃大綱圖編號S/KTN/2

EXTRACT PLAN PREPARED ON 12.4.2022  
BASED ON OUTLINE ZONING PLAN No.  
S/KTN/2 APPROVED ON 16.6.2015



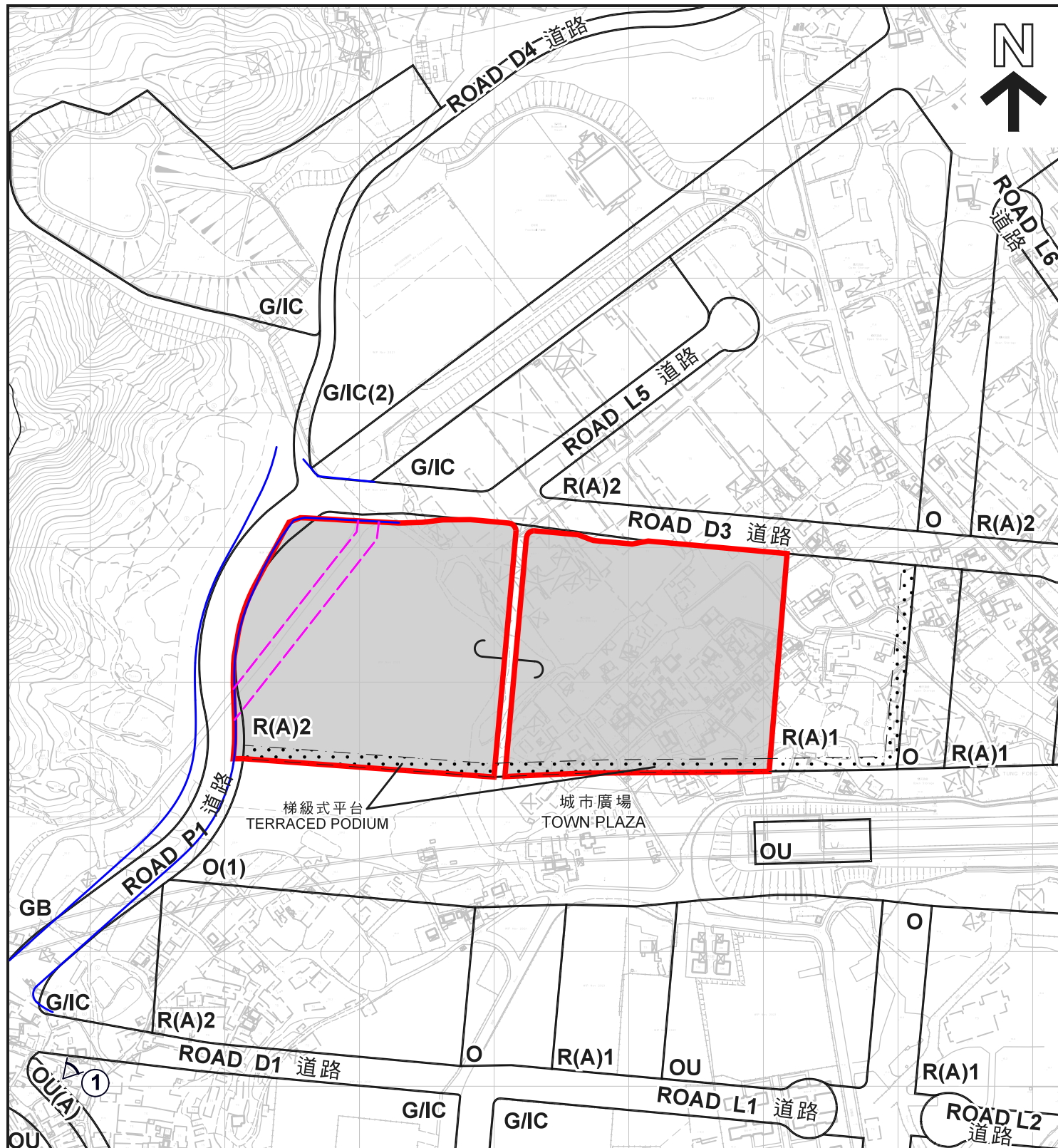

#### 圖例 LEGEND

- 申請地點 (界線只作識別用)  
APPLICATION SITE (BOUNDARY FOR IDENTIFICATION PURPOSE ONLY)
- R(A)** 住宅 (甲類)  
RESIDENTIAL (GROUP A)
- G/IC** 政府、機構或社區  
GOVERNMENT, INSTITUTION OR COMMUNITY
- O** 休憩用地  
OPEN SPACE
- OU** 其他指定用途  
OTHER SPECIFIED USES
- G.L.** 政府土地  
GOVERNMENT LAND
- ①** 實地照片的觀景點  
VIEWING POINT OF SITE PHOTO

- 渠務 / 水務工程保留地  
DRAINAGE / WATER WORK RESERVE
- 修訂的 P1 道路  
REVISED ROAD P1

本摘要圖於2022年4月12日擬備，  
所根據的資料為測量圖編號  
2-SE-4A、4B、4C、4D、9A 及 9B  
EXTRACT PLAN PREPARED ON 12.4.2022  
BASED ON SURVEY SHEETS No.  
2-SE-4A, 4B, 4C, 4D, 9A & 9B

**平面圖 SITE PLAN**  
擬議略為放寬地積比率及建築物  
高度限制以作准許的公營房屋發展  
新界古洞北新發展區第19區  
PROPOSED MINOR RELAXATION OF PLOT RATIO AND  
BUILDING HEIGHT RESTRICTIONS  
FOR PERMITTED PUBLIC HOUSING DEVELOPMENT  
AREA 19, KWU TUNG NORTH  
NEW DEVELOPMENT AREA, NEW TERRITORIES  
SCALE 1 : 4 000 比例尺

米 80 0 80 160 米  
METRES

**規劃署  
PLANNING  
DEPARTMENT**



參考編號  
REFERENCE No.  
**A/KTN/84**

圖 **PLAN**  
**A-2**





#### 圖例 LEGEND



申請地點（界線只作識別用）  
APPLICATION SITE  
(BOUNDARY FOR IDENTIFICATION  
PURPOSE ONLY)

#### 航攝照片 AERIAL PHOTO

擬議略為放寬地積比率及建築物  
高度限制以作准許的公營房屋發展  
新界古洞北新發展區第19區

PROPOSED MINOR RELAXATION OF PLOT RATIO AND  
BUILDING HEIGHT RESTRICTIONS  
FOR PERMITTED PUBLIC HOUSING DEVELOPMENT  
AREA 19, KWU TUNG NORTH  
NEW DEVELOPMENT AREA, NEW TERRITORIES

規 劃 署  
PLANNING  
DEPARTMENT



參考編號  
REFERENCE No.  
A/KTN/84

圖 PLAN  
A-3

本摘要圖於2022年3月8日擬備，  
所根據的資料為地政總署  
於2020年4月15日拍得的航攝照片  
編號E093942C

EXTRACT PLAN PREPARED ON 8.3.2022  
BASED ON AERIAL PHOTO No. E093942C  
TAKEN ON 15.4.2020 BY  
LANDS DEPARTMENT





申請地點界線只作識別用  
APPLICATION SITE BOUNDARY FOR IDENTIFICATION PURPOSE ONLY

<p>本摘要圖於2022年3月29日擬備， 所根據的資料為攝於 2022年1月4日的實地照片 PLAN PREPARED ON 29.3.2022 BASED ON SITE PHOTOS TAKEN ON 4.1.2022</p>	<p><b>實地照片 SITE PHOTO</b></p> <p>擬議略為放寬地積比率及建築物 高度限制以作准許的公營房屋發展 新界古洞北新發展區第19區 PROPOSED MINOR RELAXATION OF PLOT RATIO AND BUILDING HEIGHT RESTRICTIONS FOR PERMITTED PUBLIC HOUSING DEVELOPMENT AREA 19, KWU TUNG NORTH NEW DEVELOPMENT AREA, NEW TERRITORIES</p>	<p>規劃署 PLANNING DEPARTMENT</p> <p>參考編號 REFERENCE No. <b>A/KTN/84</b></p> <p>圖 PLAN <b>A-4</b></p> 	
--	---	---	--