

2023年 1月 3 日

Appendix I of RNTPC
Paper No. A/NE-FTA/222

此文件在 收到 城市規劃委員會
只會在收到所有必要的資料及文件後才正式承認收到
申請的日期。

This document is received on 31 JAN 2023
The Town Planning Board will formally acknowledge
the date of receipt of the application only upon receipt
of all the required information and documents.

Form No. S16-II
表格第 S16-II 號

APPLICATION FOR PERMISSION
UNDER SECTION 16 OF
THE TOWN PLANNING ORDINANCE
(CAP.131)

根據《城市規劃條例》(第131章)
第16條遞交的許可申請

Applicable to Proposal Only Involving Construction of
“New Territories Exempted House(s)”

適用於只涉及興建「新界豁免管制屋宇」的建議

Applicant who would like to publish the notice of application in local newspapers to meet one of the Town Planning Board's requirements of taking reasonable steps to obtain consent of or give notification to the current land owner, please refer to the following link regarding publishing the notice in the designated newspapers:
https://www.info.gov.hk/tpb/en/plan_application/apply.html

申請人如欲在本地報章刊登申請通知，以採取城市規劃委員會就取得現行土地擁有人的同意或通知現行土地擁有人所指定的其中一項合理步驟，請瀏覽以下網址有關在指定的報章刊登通知：
https://www.info.gov.hk/tpb/tc/plan_application/apply.html

General Note and Annotation for the Form
填寫表格的一般指引及註解

“Current land owner” means any person whose name is registered in the Land Registry as that of an owner of the land to which the application relates, as at 6 weeks before the application is made
「現行土地擁有人」指在提出申請前六星期，其姓名或名稱已在土地註冊處註冊為該申請所關乎的土地的擁有人的人

& Please attach documentary proof 請夾附證明文件

^ Please insert number where appropriate 請在適當地方註明編號

Please fill “NA” for inapplicable item 請在不適用的項目填寫「不適用」

Please use separate sheets if the space provided is insufficient 如所提供的空間不足，請另頁說明

Please insert a 「✓」 at the appropriate box 請在適當的方格內上加上「✓」號

2203347 23/12 BY HAND

For Official Use Only 請勿填寫此欄	Application No. 申請編號	A/NE-FTA/222
	Date Received 收到日期	31 JAN 2023

1. The completed form and supporting documents (if any) should be sent to the Secretary, Town Planning Board (the Board), 15/F, North Point Government Offices, 333 Java Road, North Point, Hong Kong.
申請人須將填妥的申請表格及其他支持申請的文件(倘有), 送交香港北角渣甸道333號北角政府合署15樓城市規劃委員會(下稱「委員會」)秘書收。
2. Please read the "Guidance Notes" carefully before you fill in this form. The document can be downloaded from the Board's website at <http://www.info.gov.hk/tplb/>. It can also be obtained from the Secretariat of the Board at 15/F, North Point Government Offices, 333 Java Road, North Point, Hong Kong (Tel: 2231 4810 or 2231 4835), and the Planning Enquiry Counters of the Planning Department (Hotline: 2231 5000) (17/F, North Point Government Offices, 333 Java Road, North Point, Hong Kong and 14/F, Sha Tin Government Offices, 1 Sheung Wo Che Road, Sha Tin, New Territories).
請先細閱《申請須知》的資料單張, 然後填寫此表格。該份文件可從委員會的網頁下載(網址: <http://www.info.gov.hk/tplb/>)。亦可向委員會秘書處(香港北角渣甸道333號北角政府合署15樓 - 電話: 2231 4810 或 2231 4835)及規劃處的規劃資料查詢處(熱線: 2231 5000) (香港北角渣甸道333號北角政府合署17樓及新界沙田上禾輋路1號沙田政府合署14樓)索取。
3. This form can be downloaded from the Board's website, and obtained from the Secretariat of the Board and the Planning Enquiry Counters of the Planning Department. The form should be typed or completed in block letters. The processing of the application may be refused if the required information or the required copies are incomplete.
此表格可從委員會的網頁下載, 亦可向委員會秘書處及規劃處的規劃資料查詢處索取。申請人須以打印方式或以正楷填寫表格。如果申請人所提交的資料或文件副本不齊全, 委員會可拒絕處理有關申請。

1. Name of Applicant 申請人姓名/名稱

(Mr. 先生 / Mrs. 夫人 / Miss 小姐 / Ms. 女士 / Company 公司 / Organisation 機構)

LIM KAM HOI 梁錦海
LIU, DEREK, CHI-KEAT 廖德傑
LIK, JEFFREY, CHI-HONK 梁智康

2. Name of Authorised Agent (if applicable) 獲授權代理人姓名/名稱 (如適用)

(Mr. 先生 / Mrs. 夫人 / Miss 小姐 / Ms. 女士 / Company 公司 / Organisation 機構)

CHIN POON ON 錢本恩

3. Application Site 申請地點

(a) Full address / location / demarcation district and lot number (if applicable)
詳細地址 / 地點 / 丈量約份及地段號碼 (如適用)

DDT2
LOT 208A
LOT 208B
LOT 208C

(b) Site area and/or gross floor area involved
涉及的地盤面積及 / 或總樓面面積

Site area 地盤面積 410.9 sq.m 平方米 About 約
Gross floor area 總樓面面積 585.27 sq.m 平方米 About 約

(c) Area of Government land included (if any)
所包括的政府土地面積 (倘有)

..... sq.m 平方米 About 約

(d) Name and number of the related statutory plan(s) 有關法定圖則的名稱及編號	S/NE - FTA /16
(e) Land use zone(s) involved 涉及的土地用途地帶	AGR
(f) Current use(s) 現時用途	空置土地

(If there are any Government, institution or community facilities, please illustrate on plan and specify the use and gross floor area)
(如有任何政府、機構或社區設施，請在圖則上顯示，並註明用途及總樓面面積)

4. "Current Land Owner" of Application Site 申請地點的「現行土地擁有人」

The applicant 申請人 -

- ☐ is the sole "current land owner"[#] (please proceed to Part 6 and attach documentary proof of ownership).
是唯一的「現行土地擁有人」[#] (請繼續填寫第 6 部分，並夾附業權證明文件)。
- ☒ is one of the "current land owners"[#] (please attach documentary proof of ownership).
是其中一名「現行土地擁有人」[#] (請夾附業權證明文件)。
- ☐ is not a "current land owner"[#].
並不是「現行土地擁有人」[#]。

- ☐ The application site is entirely on Government land (please proceed to Part 6).
申請地點完全位於政府土地上 (請繼續填寫第 6 部分)。

5. Statement on Owner's Consent/Notification

就土地擁有人的同意/通知土地擁有人的陳述

- (a) According to the record(s) of the Land Registry as at (DD/MM/YYYY), this application involves a total of "current land owner(s)"[#].
根據土地註冊處截至 2022 年 12 月 20 日的記錄，這宗申請共牽涉 1 名「現行土地擁有人」[#]。

(b) The applicant 申請人 -

- ☐ has obtained consent(s) of "current land owner(s)"[#].
已取得 名「現行土地擁有人」[#]的同意。

Details of consent of "current land owner(s)" [#] obtained 取得「現行土地擁有人」 [#] 同意的詳情		
No. of 'Current Land Owner(s)' 「現行土地擁有人」數目	Lot number/address of premises as shown in the record of the Land Registry where consent(s) has/have been obtained 根據土地註冊處記錄已獲得同意的地段號碼/處所地址	Date of consent obtained (DD/MM/YYYY) 取得同意的日期 (日/月/年)
	L14, DEREK CHI-KEAT 廖智傑 DD 52 LOT 208A	30/11/2022
	L14, JEFFREY CHI-HONK 廖智康 DD 52 LOT 208C	30/11/2022

(Please use separate sheets if the space of any box above is insufficient. 如上列任何方格的空間不足，請另頁說明)

- ☐ has notified "current land owner(s)"[#]
已通知 名「現行土地擁有人」[#]。

Details of the "current land owner(s)" [#] notified 已獲通知「現行土地擁有人」 [#] 的詳細資料		
No. of 'Current Land Owner(s)' 「現行土地擁有人」數目	Lot number/address of premises as shown in the record of the Land Registry where notification(s) has/have been given 根據土地註冊處記錄已發出通知的地段號碼／處所地址	Date of notification given (DD/MM/YYYY) 通知日期(日/月/年)

(Please use separate sheets if the space of any box above is insufficient. 如上列任何方格的空間不足，請另頁說明)

- ☐ has taken reasonable steps to obtain consent of or give notification to owner(s):
已採取合理步驟以取得土地擁有人的同意或向該人發給通知。詳情如下：

Reasonable Steps to Obtain Consent of Owner(s) 取得土地擁有人的同意所採取的合理步驟

- ☐ sent request for consent to the "current land owner(s)" on (DD/MM/YYYY)^{#&}
於 (日/月/年)向每一名「現行土地擁有人」[#]郵遞要求同意書[&]

Reasonable Steps to Give Notification to Owner(s) 向土地擁有人發出通知所採取的合理步驟

- ☐ published notices in local newspapers on (DD/MM/YYYY)[&]
於 (日/月/年)在指定報章就申請刊登一次通知[&]
- ☐ posted notice in a prominent position on or near application site/premises on (DD/MM/YYYY)[&]
於 (日/月/年)在申請地點／申請處所或附近的顯明位置貼出關於該申請的通知[&]
- ☐ sent notice to relevant owners' corporation(s)/owners' committee(s)/mutual aid committee(s)/management office(s) or rural committee on (DD/MM/YYYY)[&]
於 (日/月/年)把通知寄往相關的業主立案法團/業主委員會/互助委員會或管理處，或有關的鄉事委員會[&]

Others 其他

- ☐ others (please specify)
其他（請指明）

Note: May insert more than one 「✓」.

Information should be provided on the basis of each and every lot (if applicable) and premises (if any) in respect of the application.

註：可在多於一個方格內加上「✓」號

申請人須就申請涉及的每一地段（倘適用）及處所（倘有）分別提供資料

6. Development Proposal 擬議發展計劃			
(a) Name(s) of indigenous villager(s) (if applicable) 原居民姓名 (如適用)	廖錦海 廖智傑 廖智康		
(b) 原居民所屬的原居鄉村 (如適用) The related indigenous village of the indigenous villager(s) (if applicable)	上水圍內村		
(c) Proposed gross floor area 擬議總樓面面積	585-27 sq.m 平方米 <input type="checkbox"/> About 約		
(d) Proposed number of house(s) 擬議房屋幢數	3	Proposed number of storeys of each house 每幢房屋的擬議層數	3
(e) Proposed roofed over area of each house 每幢房屋的擬議上蓋面積	65.03 sq.m 平方米	Proposed building height of each house 每幢房屋的擬議高度	8.23 m 米
(f) Proposed use(s) of uncovered area (if any) 露天地方 (倘有) 的擬議用途	沒有其他用途 (Please illustrate on plan the total number and dimension of each car parking space, and/or location of septic tank, where applicable) (請在圖則上顯示, 並註明車位總數, 以及每個車位的長度和寬度及/或化粪池的位置 (如適用))		
(g) Any vehicular access to the site/subject building? 是否有車路通往地盤/有關建築物?	Yes 是 <input checked="" type="checkbox"/> No 否 <input type="checkbox"/>	<input checked="" type="checkbox"/> There is an existing access. (please indicate the street name, where appropriate) 有一條現有車路。(請註明車路名稱(如適用)) <input type="checkbox"/> There is a proposed access. (please illustrate on plan and specify the width) 有一條擬議車路。(請在圖則顯示, 並註明車路的闊度)	
(h) Can the proposed house(s) be connected to public sewer? 擬議的屋宇發展能否接駁至公共污水渠?	Yes 是 <input type="checkbox"/> No 否 <input checked="" type="checkbox"/>	(Please indicate on plan the sewerage connection proposal. 請用圖則顯示接駁公共污水渠的路線) (Please indicate on plan the location of the proposed septic tank. 請用圖則顯示化粪池的位置)	

7. Impacts of Development Proposal 擬議發展計劃的影響

If necessary, please use separate sheets to indicate the proposed measures to minimise possible adverse impacts or give justifications/reasons for not providing such measures.
如需要的話，請另頁註明可盡量減少可能出現不良影響的措施，否則請提供理據/理由。

<p>Does the development proposal involve alteration of existing building? 擬議發展計劃是否包括現有建築物的改動?</p>	<p>Yes 是 <input type="checkbox"/> Please provide details 請提供詳情</p> <p>No 否 <input checked="" type="checkbox"/></p>																														
<p>Does the development proposal involve the operation on the right? 擬議發展是否涉及右列的工程?</p>	<p>Yes 是 <input type="checkbox"/> (Please indicate on site plan the boundary of concerned land/pond(s), and particulars of stream diversion, the extent of filling of land/pond(s) and/or excavation of land) (請用地盤平面圖顯示有關土地/池塘界線，以及河道改道、填塘、填土及/或挖土的細節及/或範圍)</p> <p><input type="checkbox"/> Diversion of stream 河道改道</p> <p><input type="checkbox"/> Filling of pond 填塘 Area of filling 填塘面積 sq.m 平方米 <input type="checkbox"/> About 約 Depth of filling 填塘深度 m 米 <input type="checkbox"/> About 約</p> <p><input type="checkbox"/> Filling of land 填土 Area of filling 填土面積 sq.m 平方米 <input type="checkbox"/> About 約 Depth of filling 填土厚度 m 米 <input type="checkbox"/> About 約</p> <p><input type="checkbox"/> Excavation of land 挖土 Area of excavation 挖土面積 sq.m 平方米 <input type="checkbox"/> About 約 Depth of excavation 挖土深度 m 米 <input type="checkbox"/> About 約</p> <p>No 否 <input checked="" type="checkbox"/></p>																														
<p>Would the development proposal cause any adverse impacts? 擬議發展計劃會否造成不良影響?</p>	<table border="0"> <tr> <td>On environment 對環境</td> <td>Yes 會 <input type="checkbox"/></td> <td>No 不會 <input checked="" type="checkbox"/></td> </tr> <tr> <td>On traffic 對交通</td> <td>Yes 會 <input type="checkbox"/></td> <td>No 不會 <input checked="" type="checkbox"/></td> </tr> <tr> <td>On water supply 對供水</td> <td>Yes 會 <input type="checkbox"/></td> <td>No 不會 <input checked="" type="checkbox"/></td> </tr> <tr> <td>On drainage 對排水</td> <td>Yes 會 <input type="checkbox"/></td> <td>No 不會 <input checked="" type="checkbox"/></td> </tr> <tr> <td>On slopes 對斜坡</td> <td>Yes 會 <input type="checkbox"/></td> <td>No 不會 <input checked="" type="checkbox"/></td> </tr> <tr> <td>Affected by slopes 受斜坡影響</td> <td>Yes 會 <input type="checkbox"/></td> <td>No 不會 <input checked="" type="checkbox"/></td> </tr> <tr> <td>Landscape Impact 構成景觀影響</td> <td>Yes 會 <input type="checkbox"/></td> <td>No 不會 <input checked="" type="checkbox"/></td> </tr> <tr> <td>Tree Felling 砍伐樹木</td> <td>Yes 會 <input type="checkbox"/></td> <td>No 不會 <input checked="" type="checkbox"/></td> </tr> <tr> <td>Visual Impact 構成視覺影響</td> <td>Yes 會 <input type="checkbox"/></td> <td>No 不會 <input checked="" type="checkbox"/></td> </tr> <tr> <td>Others (Please Specify) 其他 (請列明)</td> <td>Yes 會 <input type="checkbox"/></td> <td>No 不會 <input checked="" type="checkbox"/></td> </tr> </table> <p>.....</p> <p>Please state measure(s) to minimise the impact(s). For tree felling, please state the number, diameter at breast height and species of the affected trees (if possible) 請註明盡量減少影響的措施。如涉及砍伐樹木，請說明受影響樹木的數目、及胸高度的樹幹直徑及品種(倘可)</p> <p>.....</p>	On environment 對環境	Yes 會 <input type="checkbox"/>	No 不會 <input checked="" type="checkbox"/>	On traffic 對交通	Yes 會 <input type="checkbox"/>	No 不會 <input checked="" type="checkbox"/>	On water supply 對供水	Yes 會 <input type="checkbox"/>	No 不會 <input checked="" type="checkbox"/>	On drainage 對排水	Yes 會 <input type="checkbox"/>	No 不會 <input checked="" type="checkbox"/>	On slopes 對斜坡	Yes 會 <input type="checkbox"/>	No 不會 <input checked="" type="checkbox"/>	Affected by slopes 受斜坡影響	Yes 會 <input type="checkbox"/>	No 不會 <input checked="" type="checkbox"/>	Landscape Impact 構成景觀影響	Yes 會 <input type="checkbox"/>	No 不會 <input checked="" type="checkbox"/>	Tree Felling 砍伐樹木	Yes 會 <input type="checkbox"/>	No 不會 <input checked="" type="checkbox"/>	Visual Impact 構成視覺影響	Yes 會 <input type="checkbox"/>	No 不會 <input checked="" type="checkbox"/>	Others (Please Specify) 其他 (請列明)	Yes 會 <input type="checkbox"/>	No 不會 <input checked="" type="checkbox"/>
On environment 對環境	Yes 會 <input type="checkbox"/>	No 不會 <input checked="" type="checkbox"/>																													
On traffic 對交通	Yes 會 <input type="checkbox"/>	No 不會 <input checked="" type="checkbox"/>																													
On water supply 對供水	Yes 會 <input type="checkbox"/>	No 不會 <input checked="" type="checkbox"/>																													
On drainage 對排水	Yes 會 <input type="checkbox"/>	No 不會 <input checked="" type="checkbox"/>																													
On slopes 對斜坡	Yes 會 <input type="checkbox"/>	No 不會 <input checked="" type="checkbox"/>																													
Affected by slopes 受斜坡影響	Yes 會 <input type="checkbox"/>	No 不會 <input checked="" type="checkbox"/>																													
Landscape Impact 構成景觀影響	Yes 會 <input type="checkbox"/>	No 不會 <input checked="" type="checkbox"/>																													
Tree Felling 砍伐樹木	Yes 會 <input type="checkbox"/>	No 不會 <input checked="" type="checkbox"/>																													
Visual Impact 構成視覺影響	Yes 會 <input type="checkbox"/>	No 不會 <input checked="" type="checkbox"/>																													
Others (Please Specify) 其他 (請列明)	Yes 會 <input type="checkbox"/>	No 不會 <input checked="" type="checkbox"/>																													

8. Justifications 理由

The applicant is invited to provide justifications in support of the application. Use separate sheets if necessary.
現請申請人提供申請理由及支持其申請的資料。如有需要，請另頁說明。

本人一家 13 口，將會由加拿大回香港
現時並沒有足夠處所安頓家人。所以
在本人的私家土地上申請興建新界
豁免管制屋宇小型屋宇，以便安頓家
人。

9. Declaration 聲明

I hereby declare that the particulars given in this application are correct and true to the best of my knowledge and belief.
本人謹此聲明，本人就這宗申請提交的資料，據本人所知及所信，均屬真實無誤。

I hereby grant a permission to the Board to copy all the materials submitted in this application and/or to upload such materials to the Board's website for browsing and downloading by the public free-of-charge at the Board's discretion.
本人現准許委員會酌情將本人就此申請所提交的所有資料複製及/或上載至委員會網站，供公眾免費瀏覽或下載。

Signature
簽署

☐ Applicant 申請人 / ☒ Authorised Agent 獲授權代理人

.....
Name in Block Letters
姓名（請以正楷填寫）

Position (if applicable)
職位（如適用）

Professional Qualification(s) 專業資格 ☐ Member 會員 / ☐ Fellow of 資深會員
☐ HKIP 香港規劃師學會 / ☐ HKIA 香港建築師學會 /
☐ HKIS 香港測量師學會 / ☐ HKIE 香港工程師學會 /
☐ HKILA 香港園境師學會 / ☐ HKIUD 香港城市設計學會
☐ RPP 註冊專業規劃師
 Others 其他

on behalf of
代表

☐ Company 公司 / ☐ Organisation Name and Chop (if applicable) 機構名稱及蓋章（如適用）

Date 日期 23-12-2022 (DD/MM/YYYY 日/月/年)

Remark 備註

The materials submitted in this application and the Board's decision on the application would be disclosed to the public. Such materials would also be uploaded to the Board's website for browsing and free downloading by the public where the Board considers appropriate.

委員會會向公眾披露申請人所遞交的申請資料和委員會對申請所作的決定。在委員會認為合適的情況下，有關申請資料亦會上載至委員會網頁供公眾免費瀏覽及下載。

Warning 警告

Any person who knowingly or wilfully makes any statement or furnish any information in connection with this application, which is false in any material particular, shall be liable to an offence under the Crimes Ordinance.

任何人在明知或故意的情況下，就這宗申請提出在任何要項上是虛假的陳述或資料，即屬違反《刑事罪行條例》。

Statement on Personal Data 個人資料的聲明

- The personal data submitted to the Board in this application will be used by the Secretary of the Board and Government departments for the following purposes:
委員會就這宗申請所收到的個人資料會交給委員會秘書及政府部門，以根據《城市規劃條例》及相關的城市規劃委員會規劃指引的規定作以下用途：
 (a) the processing of this application which includes making available the name of the applicant for public inspection when making available this application for public inspection; and
處理這宗申請，包括公布這宗申請供公眾查閱，同時公布申請人的姓名供公眾查閱；以及
 (b) facilitating communication between the applicant and the Secretary of the Board/Government departments.
方便申請人與委員會秘書及政府部門之間進行聯絡。
- The personal data provided by the applicant in this application may also be disclosed to other persons for the purposes mentioned in paragraph 1 above.
申請人就這宗申請提供的個人資料，或亦會向其他人士披露，以作上述第 1 段提及的用途。
- An applicant has a right of access and correction with respect to his/her personal data as provided under the Personal Data (Privacy) Ordinance (Cap. 486). Request for personal data access and correction should be addressed to the Secretary of the Board at 15/F, North Point Government Offices, 333 Java Road, North Point, Hong Kong.
根據《個人資料(私隱)條例》(第 486 章)的規定，申請人有權查閱及更正其個人資料。如欲查閱及更正個人資料，應向委員會秘書提出有關要求，其地址為香港北角渣華道 333 號北角政府合署 15 樓。

Gist of Application 申請摘要

(Please provide details in both English and Chinese as far as possible. This part will be circulated to relevant consultees, uploaded to the Town Planning Board's Website for browsing and free downloading by the public and available at the Planning Enquiry Counters of the Planning Department for general information.)
(請盡量以英文及中文填寫。此部分將會發送予相關諮詢人士、上載至城市規劃委員會網頁供公眾免費瀏覽及下載及於規劃署規劃資料查詢處供一般參閱。)

Application No. 申請編號	(For Official Use Only) (請勿填寫此欄)		
Location/address 位置/地址	DD 52 LOT 208A LOT 208B LOT 208C		
Site area 地盤面積	410.9 (includes Government land of 包括政府土地	sq.m 平方米	<input checked="" type="checkbox"/> About 約
Plan 圖則	S/NE - FTA/16		
Zoning 地帶	AGR		
Applied use/ development 申請用途/發展	New Territories Exempted House 新界豁免管制屋宇 <input checked="" type="checkbox"/> Small House 小型屋宇		
(i) Proposed Gross floor area 擬議總樓面面積	585.27	sq.m 平方米	<input checked="" type="checkbox"/> About 約
(ii) Proposed No. of house(s) 擬議房屋幢數	3		
(iii) Proposed building height/No. of storeys 建築物高度/層數	8.23	m 米	<input checked="" type="checkbox"/> (Not more than 不多於)
	3	Storeys(s) 層	

Submitted Plans, Drawings and Documents 提交的圖則、繪圖及文件

	Chinese 中文	English 英文
Plans and Drawings 圖則及繪圖		
Master layout plan(s)/Layout plan(s) 總綱發展藍圖／布局設計圖	<input type="checkbox"/>	<input type="checkbox"/>
Block plan(s) 樓宇位置圖	<input type="checkbox"/>	<input type="checkbox"/>
Floor plan(s) 樓宇平面圖	<input type="checkbox"/>	<input type="checkbox"/>
Sectional plan(s) 截視圖	<input type="checkbox"/>	<input type="checkbox"/>
Elevation(s) 立視圖	<input type="checkbox"/>	<input type="checkbox"/>
Photomontage(s) showing the proposed development 顯示擬議發展的合成照片	<input type="checkbox"/>	<input type="checkbox"/>
Master landscape plan(s)/Landscape plan(s) 園境設計總圖／園境設計圖	<input type="checkbox"/>	<input type="checkbox"/>
Others (please specify) 其他（請註明）	<input checked="" type="checkbox"/>	<input type="checkbox"/>
Landscape plan		

Reports 報告書

Planning Statement/Justifications 規劃綱領/理據	<input type="checkbox"/>	<input type="checkbox"/>
Environmental assessment (noise, air and/or water pollutions) 環境評估（噪音、空氣及／或水的污染）	<input type="checkbox"/>	<input type="checkbox"/>
Traffic impact assessment (on vehicles) 就車輛的交通影響評估	<input type="checkbox"/>	<input type="checkbox"/>
Traffic impact assessment (on pedestrians) 就行人的交通影響評估	<input type="checkbox"/>	<input type="checkbox"/>
Visual impact assessment 視覺影響評估	<input type="checkbox"/>	<input type="checkbox"/>
Landscape impact assessment 景觀影響評估	<input type="checkbox"/>	<input type="checkbox"/>
Tree Survey 樹木調查	<input type="checkbox"/>	<input type="checkbox"/>
Geotechnical impact assessment 土力影響評估	<input type="checkbox"/>	<input type="checkbox"/>
Drainage impact assessment 排水影響評估	<input type="checkbox"/>	<input type="checkbox"/>
Sewerage impact assessment 排污影響評估	<input type="checkbox"/>	<input type="checkbox"/>
Risk Assessment 風險評估	<input type="checkbox"/>	<input type="checkbox"/>
Others (please specify) 其他（請註明）	<input type="checkbox"/>	<input type="checkbox"/>

Note: May insert more than one "✓" 註：可在多於一個方格內加上「✓」號

Note: The information in the Gist of Application above is provided by the applicant for easy reference of the general public. Under no circumstances will the Town Planning Board accept any liabilities for the use of the information nor any inaccuracies or discrepancies of the information provided. In case of doubt, reference should always be made to the submission of the applicant.
註：上述申請摘要的資料是由申請人提供以方便市民大眾參考。對於所載資料在使用上的問題及文義上的歧異，城市規劃委員會概不負責。若有任何疑問，應查閱申請人提交的文件。

TCYL12010
4-12-2018

北
西
東
南

藍色建築屋
黃色分界線
綠色界線
粉紅色露台
橙色化糞池

208C
140.1m²
擬建屋
B/L 65.03m²

208B
140.3m²
擬建屋
B/L 65.03m²

208A
130.5m²
擬建屋
B/L 65.03m²

Total Area: 21,000m² (about)

Total Area: 410.4 m^2 (about)

圖：香港特別行政區政府提供的衛星地圖

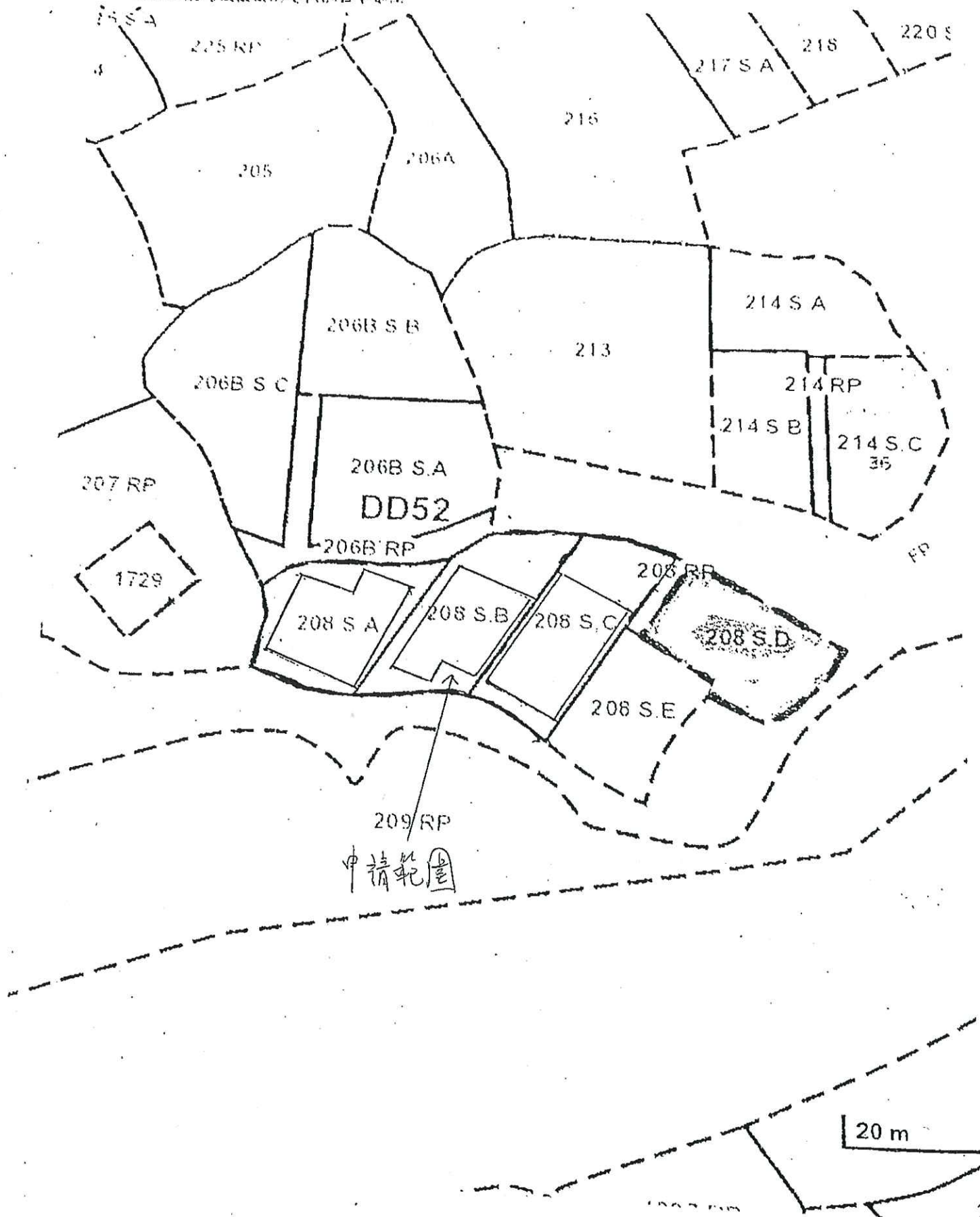

☐ Urgent ☐ Return Receipt Requested ☐ Sign ☐ Encrypt ☐ Mark Subject Restricted ☐ Expand personal&publ



Fw: 轉寄 : A/NE-FTA/222 - To Authorised Agent of the Applicant
20/03/2023 16:26

From: <tpbpd@pland.gov.hk>
To: <stndpo@pland.gov.hk>
Date: 20/03/2023 01:57 PM
Subject: FW: 轉寄 : A/NE-FTA/222 - To Authorised Agent of the Applicant

From:
Sent: Monday, March 20, 2023 12:50 PM
To: tpbpd@pland.gov.hk
Subject: 轉寄 : A/NE-FTA/222 - To Authorised Agent of the Applicant

----- 轉寄的郵件 -----

寄件人

收件人 : "kcscho@pland.gov.hk" <kcscho@pland.gov.hk>

副本 :

寄件備份 : 2023 年 3 月 月 20 日 週一 , 時間 : 12:38

主旨 : 回覆 : A/NE-FTA/222 - To Authorised Agent of the Applicant

敬啟者 :

廖錦海是現時DD52 LOT 208S.A LOT208S.B及LOT 208SC唯一合法擁有人，而貴署接受他的申請，他會將LOT 208SB 轉送給他的兒子廖智傑而LOT 208SC則轉送給他的兒子廖智康。

Relevant Interim Criteria for Consideration of
Application for New Territories Exempted House (NTEH)/Small House in New Territories
(promulgated on 7.9.2007)

- (a) sympathetic consideration may be given if not less than 50% of the proposed NTEH/Small House footprint falls within the village 'environs' ('VE') of a recognized village and there is a general shortage of land in meeting the demand for Small House development in the "Village Type Development" ("V") zone of the village;
- (b) if more than 50% of the proposed NTEH/Small House footprint is located outside the 'VE', favourable consideration could be given if not less than 50% of the proposed NTEH/Small House footprint falls within the "V" zone, provided that there is a general shortage of land in meeting the demand for Small House development in the "V" zone and the other criteria can be satisfied;
- (c) development of NTEH/Small House with more than 50% of the footprint outside both the 'VE' and the "V" zone would normally not be approved unless under very exceptional circumstances (e.g. the application site has a building status under the lease, or approving the application could help achieve certain planning objectives such as phasing out of obnoxious but legal existing uses);
- (d) application for NTEH/Small House with previous planning permission lapsed will be considered on its own merits. In general, proposed development which is not in line with the criteria would normally not be allowed. However, sympathetic consideration may be given if there are specific circumstances to justify the cases, such as the site is an infill site among existing NTEHs/Small Houses, the processing of the Small House grant is already at an advance stage;
- (e) if an application site involves more than one NTEH/Small House, application of the above criteria would be on individual NTEH/Small House basis;
- (f) the proposed development should not frustrate the planning intention of the particular zone in which the application site is located;
- (g) the proposed development should be compatible in terms of land use, scale, design and layout, with the surrounding area/development;
- (h) the proposed development should not encroach onto the planned road network and should not cause adverse traffic, environmental, landscape, drainage, sewerage and geotechnical impacts on the surrounding areas. Any such potential impacts should be mitigated to the satisfaction of relevant Government departments;
- (i) the proposed development, if located within water gathering grounds, should be able to be connected to existing or planned sewerage system in the area except under very special circumstances (e.g. the application site has a building status under the lease or the applicant can demonstrate that the water quality within water gathering grounds will not be affected by the proposed development*);
- (j) the provision of fire service installations and emergency vehicular access, if required, should be appropriate with the scale of the development and in compliance with relevant standards; and

- (k) all other statutory or non-statutory requirements of relevant Government departments must be met. Depending on the specific land use zoning of the application site, other Town Planning Board guidelines should be observed, as appropriate.
- *i.e. the applicant can demonstrate that effluent discharge from the proposed development will be in compliance with the effluent standards as stipulated in the Water Pollution Control Ordinance Technical Memorandum.

Previous S.16 Applications

Rejected Application

Application No.	Uses/ Development	Date of Consideration	Rejection Reasons
A/NE-FTA/191	Proposed 5 Houses (New Territories Exempted House – Small House)	25.10.2019 (on review)	R1 & R2

Rejection Reasons:

- R1 The proposed development was not in line with the planning intention of the “Agriculture” zone in the Fu Tei Au and Sha Ling area which was primarily to retain and safeguard good quality agricultural land/farm/fish ponds for agricultural purposes and to retain fallow arable land with good potential for rehabilitation for cultivation and other agricultural purposes. There was no strong planning justification in the submission for a departure from the planning intention.
- R2 Land was still available within the “Village Type Development” zone of Wa Shan Village where land was primarily intended for Small House development. It was considered more appropriate to concentrate the proposed Small House development close to the existing village cluster for orderly development pattern, efficient use of land and provision of infrastructures and services.

**Similar S.16 Applications for Proposed House
(New Territories Exempted House – Small House)
within/partly within the “Agriculture” zone in the vicinity of the application site
in the Fu Tei Au and Sha Ling Area**

Approved Applications

Application No.	Uses/ Development	Date of Consideration
A/NE-FTA/90 ^{*1}	Proposed House (New Territories Exempted House – Small House)	23.1.2009
A/NE-FTA/95	Proposed 2 Houses (New Territories Exempted House – Small House)	21.8.2009
A/NE-FTA/132 ^{*2}	Proposed House (New Territories Exempted House – Small House)	7.2.2014
A/NE-FTA/164 ^{*1}	Proposed House (New Territories Exempted House – Small House)	11.11.2016
A/NE-FTA/219 ^{*2}	Proposed House (New Territories Exempted House – Small House)	29.7.2022

Remarks

^{*1}: The application nos. A/NE-FTA/90 and A/NE-FTA/164 are the same site

^{*2}: The application nos. A/NE-FTA/132 and A/NE-FTA/219 are the same site

Rejected Applications

Application No.	Uses/ Development	Date of Consideration	Rejection Reasons
A/NE-FTA/188	Proposed House (New Territories Exempted House – Small House)	18.1.2019	R1 & R2
A/NE-FTA/204	Proposed House (New Territories Exempted House – Small House)	23.7.2021	R1 & R2

Rejection Reasons:

- R1 The proposed development was not in line with the planning intention of the “Agriculture” zone in the Fu Tei Au and Sha Ling area which was primarily to retain and safeguard good quality agricultural land/farm/fish ponds for agricultural purposes and to retain fallow arable land with good potential for rehabilitation for cultivation and other agricultural purposes. There was no strong planning justification in the submission for a departure from the planning intention.
- R2 Land was still available within the “Village Type Development” zone of Wa Shan Village where land was primarily intended for Small House development. It was considered more appropriate to concentrate the proposed Small House development close to the existing village cluster for orderly development pattern, efficient use of land and provision of infrastructures and services.

Detailed Comments from Government Departments

1. Land Administration

Comments of the District Lands Officer/North, Lands Department (DLO/N, LandsD):

- (a) the Site falls entirely within the village environs of Sheung Shui Wa Shan;
- (b) the applicants claimed themselves to be the indigenous villagers of Sheung Shui Wai Loi Village, their eligibilities for Small House grant have yet to be ascertained;
- (c) the Site is not covered by any Building Licence nor Modification of Tenancy;
- (d) the number of outstanding Small House applications and the number of 10-year Small House demand forecast for Wa Shan Village is 56 and 430 respectively; and
- (e) no Small House application in respect to the Site has been received by her office;

2. Traffic

Comments of the Commissioner of Transport (C of T):

- (a) she has reservation on the application. Such type of development should be confined within the “Village Type Development” (“V”) zone as far as possible. Although additional traffic generated by the proposed development is not expected to be significant, such type of development outside the “V” zone, if permitted, will set an undesirable precedent case for similar applications in the future. The resulting cumulative adverse traffic impact could be substantial;
- (b) notwithstanding the above, the application only involve the construction of one Small House. He considers that the application can be tolerated unless being rejected on other grounds; and
- (c) the local track/ footpath leading the Site is not, managed by TD. The land status, management and maintenance responsibilities of the local track should be clarified with the relevant lands and maintenance authorities accordingly;

Comments of the Chief Highway Engineer/ New Territories East. Highway Department (CHE/NTE, HyD):

- (a) no comment on the application; and
- (b) the road leading from Man Kam To Road to the application site is not maintained by HyD.

3. **Environment**

Comments of the Director of Environmental Protection (DEP):

- (a) in view of the small scale of the proposed development, the application is unlikely to cause major pollution; and
- (b) septic tank and soakaway system is an acceptable means for collection, treatment and disposal of the sewage provided that its design and construction follow the requirements of the ProPECC PN 5/93 “Drainage Plans subject to Comment by the Environmental Protection Department” and are duly certified by an Authorized Person.

4. **Landscape**

Comments of the Chief Town Planner/Urban Design and Landscape, Planning Department (CTP/UD&L, PlanD):

- (a) she has no objection to the application from the landscape planning perspective;
- (b) according to the aerial photo of 2022, the Site is located in an area of rural inland plains landscape character comprising of clusters of tree groups, vegetated area, small houses and temporary structures. The Site is covered by wild grass and occupied by a temporary structure. A *Mangifera indica* (芒果) in good condition is observed in close proximity to the southeastern boundary outside the Site. Significant adverse impact on the landscape character and the existing landscape resources within the Site arising from the proposed use is not anticipated;
- (c) the applicant should be advised that approval of the application does not imply approval of tree works such as pruning, transplanting and felling under lease. The applicant is reminded to seek approval for any proposed tree works from relevant department prior to commencement of the works; and
- (d) should the application be approved by the Board, it is considered not necessary to impose a landscape condition as there is no major public frontage along the Site boundary and the effect of additional landscaping on enhancing the quality of public realm is not apparent.

5. **Drainage**

Comments of the Chief Engineer/Mainland North, Drainage Services Department (CE/MN, DSD):

- (a) he has no objection to the application from the public drainage viewpoint; and
- (b) should the application be approved, a condition should be included to request the applicant to submit and implement a drainage proposal for the Site to ensure that it will not cause adverse drainage impact on the adjacent area, and the drainage system should be properly maintained at all times during the planning approval period and rectified if they are found inadequate / ineffective during operation.

6. **Water Supply**

Comments of the Chief Engineer/Construction, Water Supplies Department (CE/C, WSD):

- (a) he has no objection to the application; and
- (b) existing water mains are inside the proposed lot and will be affected. The applicant is required to either divert or protect the water mains found on site. Detailed comments are at **Appendix VII**.

7. **Agriculture**

Comments of the Director of Agriculture, Fisheries and Conservation (DAFC):

- (a) the application is not supported from agricultural perspective as the Site possesses potential for agricultural rehabilitation; and
- (b) the Site falls within the “AGR” zone and is abandoned. The agricultural activities are active in the vicinity, and agricultural infrastructures such as road access and water sources are also available. The Site can be used for agricultural activities such as open-field cultivation, greenhouses, plant nurseries, etc.

8. **Fire Safety**

Comments of the Director of Fire Services (D of FS):

- (a) he has no in-principle objection to the application provided that the proposed house would not encroach onto any existing emergency vehicular access (EVA) or planned EVA under application in accordance with LandsD’s record; and
- (b) the applicant is reminded to observe ‘New Territories Exempted Houses – A Guide to Fire Safety Requirements’ published by LandsD. Detailed fire safety requirements will be formulated upon receipt of formal application via LandsD.

9. **District Officer’s Comments**

Comments of the District Officer (North), Home Affairs Department (DO(N), HAD):

- he has consulted the locals regarding the application. All consultees, including the Chairman of Sheung Shui District Rural Committee, the Indigenous Inhabitant Representative (IIR) and the Resident Representative of Wa Shan Village, have no comment.

10. Demand and Supply of Small House Sites

According to DLO/N's records, the total number of outstanding Small House applications for Wa Shan Village is 56 while the 10-year Small House demand forecast for the same village is 430. According to the latest estimate by PlanD, about 2.53 ha (equivalent to 101 Small House sites) of land are available within the "V" zones of Wa Shan Village for Small House development. There is insufficient land in the "V" zones of Wa Shan Village to meet the future demand of land for Small House development (i.e. about 12.15 ha of land which is equivalent to 486 Small House sites).

Appendix VI of RNTPC
Paper No. A/NE-FTA/222 /

致城市規劃委員會秘書：

專人送遞或郵遞：香港北角渣華道 333 號北角政府合署 15 樓

傳真：2877 0245 或 2522 8426

電郵：tpbpd@pland.gov.hk

To : Secretary, Town Planning Board

By hand or post : 15/F, North Point Government Offices, 333 Java Road, North Point, Hong Kong

By Fax : 2877 0245 or 2522 8426

By e-mail : tpbpd@pland.gov.hk

有關的規劃申請編號 The application no. to which the comment relates

A/NE-FTA/222

意見詳情 (如有需要，請另頁說明)

Details of the Comment (use separate sheet if necessary)

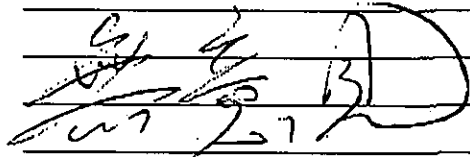
「提意見人」姓名/名稱 Name of person/company making this comment 侯志強簽署 Signature 侯志強 日期 Date 2023.2.16

☐ Urgent ☐ Return Receipt Requested ☐ Sign ☐ Encrypt ☐ Mark Subject Restricted ☐ Expand personal&publi



A/NE-FTA/222 DD 52 Wa Shan New Town

28/02/2023 02:09

From:

To: tpbpd <tpbpd@pland.gov.hk>

File Ref:

A/NE-FTA/222

Lots 208 S.A, 208 S.B and 208 S.C in D.D. 52, Sheung Shui Wa Shan, Sheung Shui

Site area: About 410.9sq.m

Zoning: "Agriculture"

Applied development : 3 NET Houses

Dear TPB Members,

Application 191 for 5 houses was rejected on review 25 Oct 2019.

There is no way that circumstances would have changed in a short time frame.

Members must again reject the application.

Mary Mulvihill

From:

To: tpbpd <tpbpd@pland.gov.hk>

Date: Monday, 19 August 2019 2:24 AM CST

Subject: Re: A/NE-FTA/191 DD 52 Wa Shan New Town

Dear TPB Members,

Plan D: land available within the "V" zone was insufficient to fully meet the future Small House demand, **land was still available within the "V" zone and capable to meet the outstanding Small House applications.** It was considered more appropriate to concentrate the proposed Small House developments within the "V" zone for more orderly development pattern, efficient use of land and provision of infrastructure and services.

Application clearly has no merit.

Mary Mulvihill

From:

To: "tpbpd" <tpbpd@pland.gov.hk>

Sent: Tuesday, May 28, 2019 2:50:02 AM

Subject: A/NE-FTA/191 DD 52 Wa Shan New Town

A/NE-FTA/191

Lots 208 S.A to S.E & RP in D.D. 52, Sheung Shui Wa Shan, Sheung Shui

Site area : About 659m²

Zoning : "Agriculture"

Applied Development : 5 NET Houses

Dear TPB Members,

These appear to be the same 5 houses under withdrawn application 175-179 IN 2017.

The sites are outside the VTD and zoned Agriculture.

With ref to a more recent application 188 that was rejected

DAFC did not support the application. Regarding the Interim Criteria for Consideration of Application for NTEH/Small House in New Territories, land was still available within the "V" zone of Man Shan Village to meet the outstanding Small House applications. It was more appropriate to concentrate Small House developments within the "V" zone for more orderly development pattern, efficient use of land and provision of infrastructures and services.

This application appears to have no merit.

Mary Mulvihill

From: "tpbpd" <tpbpd@pland.gov.hk>

To:

Cc: "stndpo" <stndpo@pland.gov.hk>

Sent: Friday, December 21, 2018 3:04:14 PM

Subject: RE: A/NE-FTA/175/6/7/8/9 Wa Shan New Town

Dear Mary,

Your email dated 20.12.2018 to the Town Planning Board Secretariat refers.

Please be informed that S.16 Application No. A/NE-FTA/175, A/NE-FTA/176, A/NE-FTA/177, A/NE-FTA/178 and A/NE-FTA/179 were withdrawn by the applicants on 1.9.2017. As such, there was no meeting minutes for the above planning applications. The status of these applications can be inspected at "Statutory Planning Portal 2" on TPB's website.

(Christina TSE)

Town Planning Board Secretariat

From:

Sent: Thursday, December 20, 2018 3:04 AM

To: tpbpd

Subject: Re: A/NE-FTA/175/6/7/8/9 Wa Shan New Town

Dear Secretariat,

I cannot find the meeting minutes for these applications. Please note that I have tried both Google and OZP site.

Regards

Mary

From:

To: "tpbpd" <tpbpd@pland.gov.hk>

Sent: Friday, August 11, 2017 2:06:58 AM

Subject: A/NE-FTA/175/6/7/8/9 Wa Shan New Town

A/NE-FTA/175/6/7/8/9

Lots in D.D. 52, Sheung Shui Wa Shan, Sheung Shui

Zoning "Agriculture"

Applied Development : 5 NET Houses

Dear TPB Members,

The 5 applications will be considered together as they are adjacent and well into the AG zoning.

So many applications for the same area raise the suspicion that this is another example of the exploitation of 'ding' rights.

- It is a duty of the Town Planning Board to ensure it is not aiding and abetting unlawful schemes. It must first make sure that it has full knowledge of the background of the applications by verifying that the Lands Department undertook extensive investigations, including by soliciting the help from other agencies including the Immigration Department, Police and ICAC directly by the Board or by making sure the Lands Department has done so, including but not limited to the following information:

1. Were the captioned applications to the Town Planning Board fully coordinated and submitted as a whole by the same agent?
2. Who owns and has owned the land, and for what values was the land exchanged?
3. Which companies have been involved in the transactions and financing, where were they located and who are/were the directors?
4. Do the applicants ordinarily reside in Hong Kong according to entry and exit information from the Immigration Department?
5. And so forth.

- Having considered the above information, the Board should ensure it is fully satisfied that it would be unreasonable to suspect that the applications are misrepresentations to Government and the Board, and that the small house applicants are indeed applying for permission to build for themselves. If it can't be fully satisfied it should ask for further information and clarifications, or reject the captioned applications.

Applications are not in line with the intention of the "Agriculture" zone which is to retain and safeguard good agricultural land for agricultural purposes. This zone is also intended to retain fallow arable land with good potential for rehabilitation. No strong planning justification has been given in the submission for a departure from the planning intention.

- the applications do not comply with the Interim Criteria for Consideration of Application for New Territories Exempted House/Small House in New Territories in that the proposed development would cause adverse landscape impact on the surrounding area;

- approval of the applications would set an undesirable precedent for similar

applications in the area. The cumulative effect of approving such applications would result in adverse impacts on the natural environment, infrastructure capacities and landscape character of the area.

- as announced in the 2016 Policy Address, the Government would implement the New Agriculture Policy to facilitate the sustainable agricultural development in Hong Kong. Supportive measures would be implemented to enhance the competitiveness of local farms by facilitating enhancement in productivity and business viability.

The development of so many houses with septic tanks is contrary to the recommendation of the Audit Commission on 28 October 2016.

These applications are certainly not compatible with stated government policy.

Moreover during 23 June 2017 meeting PD revealed that "land was still available within the "V" zone to meet the outstanding Small House applications' of this village.

TPB must reject these applications.

Mary Mulvihill

☐ Urgent ☐ Return Receipt Requested ☐ Sign ☐ Encrypt ☐ Mark Subject Restricted ☐ Expand personal&publi



KFBG's comments on four planning applications

01/03/2023 21:52

From: EAP KFBG <eap@kfbg.org>
To: "tpbpd@pland.gov.hk" <tpbpd@pland.gov.hk>
File Ref:

4 attachments



230301 s17 TCTC 61.pdf 230301 s16 TKLN 51.pdf 230301 s16 TKL 716.pdf 230301 s16 FTA 222.pdf

Dear Sir/ Madam,

Attached please see our comments regarding four applications. There are four pdf files attached to this email. If you cannot see/ download/ open these files, please notify us through email.

Thank You and Best Regards,

Ecological Advisory Programme
Kadoorie Farm and Botanic Garden

Email Disclaimer:

The information contained in this e-mail (including any attachments) is confidential and is intended solely for the addressee. If you are not the intended recipient, please notify the sender immediately and delete this e-mail from your system. Any unauthorised use, disclosure, copying, printing, forwarding or dissemination of any part of this information is prohibited. KFBG does not accept responsibility and shall not be liable for the content of any e-mail transmitted by its staff for any reason other than bona fide official purposes. There is no warranty that this e-mail is error or virus free. You should not rely on any information that is not transmitted via secure technology.

The Secretary,
Town Planning Board,
15/F, North Point Government Offices,
333, Java Road, North Point,
Hong Kong.
(Email: tpbpd@pland.gov.hk)

1st March, 2023.

By email only

Dear Sir/ Madam,

Proposed Three Houses (New Territories Exempted Houses - Small Houses)
(A/NE-FTA/222)

1. We refer to the captioned.
2. According to the Statutory Planning Portal 2 website, there is a rejected application for five Small Houses (i.e., A/NE-FTA/191¹) covering the current application site; the reasons for the rejection of the review of this application are listed below.

(a) the proposed developments are not in line with the planning intention of the "Agriculture" zone in the Fu Tei Au and Sha Ling area which is primarily to retain and safeguard good quality agricultural land/farm/fish ponds for agricultural purposes and to retain fallow arable land with good potential for rehabilitation for cultivation and other agricultural purposes. There is no strong planning justification in the submission for a departure from the planning intention; and

(b) land is still available within the "Village Type Development" zone of Wa Shan Village where land is primarily intended for Small House development. It is considered more appropriate to concentrate the proposed Small House development close to the existing village cluster for orderly development pattern, efficient use of land and provision of infrastructures and services.

¹ https://www2.ozp.tpb.gov.hk/gist/apply/en_tc/A_NE-FTA_191_TC.pdf

3. Based on our recent on-site observation, there would still be active cultivation activities nearby within the same Agriculture (AGR) zone. We urge the Board to consider the potential cumulative impact of approving this application as the approval will set a precedent for similar applications.
4. We urge the Board to reject this application as the proposed use is not in line with the planning intention of AGR zone.
5. Thank you for your attention.

Ecological Advisory Programme
Kadoorie Farm and Botanic Garden

Recommended Advisory Clauses

- (a) to note the comments of Director of Fire Services that the applicant should observe ‘New Territories Exempted Houses – A Guide to Fire Safety Requirements’ published by Lands Department (LandsD). Detailed fire safety requirements will be formulated upon receipt of formal application via LandsD;
- (b) to note the comments of the Director of Environmental Protection that septic tank and soakaway system is an acceptable means for collection, treatment and disposal of the sewage provided that its design and construction follow the requirements of the ProPECC PN 5/93 “Drainage Plans subject to Comment by the Environmental Protection Department” and are duly certified by an Authorized Person;
- (c) to note the comments of the Chief Engineer/Mainland North, Drainage Services Department that;
 - (i) the Site is in an area where no public sewer connection is available;
 - (ii) the applicant is advised on the following general requirements of the drainage proposal:
 - surface channel with grating covers should be provided along the site boundary;
 - a drainage plan should be provided clearly showing the size, levels and routes of the proposed drainage. The details (invert level, gradient, general sections etc.) of the proposed drain/ surface channel, catchpits and the discharge structure shall be provided;
 - the cover levels of proposed channels should be flush with the existing adjoining ground level;
 - a catchpit with covers should be provided where there is a change of direction of the channel/drain. The details of the catchpit with covers shall be provided;
 - catchpits with sand trap shall be provided at the outlets of the proposed drainage system. The details of the catchpit with sand trap should be provided;
 - the applicant should check and ensure that the existing drainage downstream to which the proposed connection will be made have adequate capacity and satisfactory condition to cater for the additional discharge from the Site. The applicant should also ensure that the flow from the Site will not overload the existing drainage system;
 - the applicant is reminded that where walls are erected or kerbs are laid along the boundary of the same, peripheral channels should be provided on both sides of the walls or kerbs, and/or adequate openings should be provided at the walls/kerbs to allow existing overland flow passing through the Site to be intercepted by the drainage system of the Site with details to be agreed by DSD, unless justified not necessary;

- the applicant is reminded that all existing flow paths as well as the run-off falling onto and passing through the Site should be intercepted and disposed of via proper discharge points. The applicant shall also ensure that no works, including any site formation works, shall be carried out as may adversely interfere with the free flow condition of the existing drains, channels and watercourses on or in the vicinity of the Site any time during or after the works;
 - the proposed drainage works, whether within or outside the site boundary, should be constructed and maintained properly by the applicant and rectify the system if it is found to be inadequate or ineffective during operation at his/her own expense;
 - for works to be undertaken outside the lot boundary, the applicant should obtain prior consent and agreement from DLO/N and/or relevant private lot owners;
 - the applicant should make good all the adjacent affected areas upon the completion of the drainage works;
 - the applicant shall allow all time free access for the Government and its agent to conduct site inspection on his completed drainage works;
 - the applicant and the successive lot owners shall allow connections from the adjacent lots to the completed drainage works on Government Land when so required;
 - photos should be submitted clearly showing the current conditions of the area around the Site, the existing drainage/flowpaths around the Site, the proposed drainage from the Site to the downstream existing watercourse and the existing watercourse at about 20 m intervals. The locations of the camera and the direction of each photo should also be indicated on a plan
- (d) to note the comments of the C of T that the local track/ footpath leading the Site is not managed by TD. The land status, management and maintenance responsibilities of the local track should be clarified with the relevant lands and maintenance authorities accordingly;
- (e) to note the comments of the CTP/UD&L, PlanD on the following:
- (i) the applicant is advised to adjust the layout/location of the proposed small house located at Lot 208 S.C of application site to minimise impact on the tree canopy of the existing tree (i.e. *Mangifera indica* 杧果) in good condition located to the southeast of the site; and
 - (ii) the applicant should be advised that approval of the application does not imply approval of tree works such as pruning, transplanting and felling under lease. The applicant is reminded to seek approval for any proposed tree works from relevant departments prior to commencement of the works;

- (f) to note the following comments of the Chief Engineer/Construction, Water Supplies Department:
- (i) existing water mains are inside the proposed lot and will be affected. The applicant is required to either divert or protect the water mains found on site with detailed comments appended below:
1. if diversion is required, existing water mains inside the proposed lot are needed to be diverted outside the site boundary of the proposed development to lie in Government land. A strip of land of minimum 1.5m in width should be provided for the diversion of existing water mains. The cost of diversion of existing water mains upon request will have to be borne by the grantee/applicant. The applicant shall submit all relevant proposal to WSD for consideration and agreement before the works commence;
 2. if diversion is not required, the following conditions shall apply:
 - existing water mains are affected and no development which requires resiting of water mains will be allowed;
 - details of site formation works shall be submitted to the Director of Water Supplies for approval prior to commencement of works;
 - no structures shall be built or materials stored within 1.5m from the centrelines of water mains. Free access shall be made available at all times for staff of the DWS or their contractor to carry out construction, inspection, operation, maintenance and repair works;
 - no trees or shrubs with penetrating roots may be planted within the Water Works Reserve or in the vicinity of the water mains. No change of existing site condition may be undertaken within the aforesaid area without the prior agreement of the DWS. Rigid root barriers may be required if the clear distance between the proposed tree and the pipe is 2.5m or less, and the barrier must extend below the invert level of the pipe;
 - no planting or obstruction of any kind except turfing shall be permitted within the space of 1.5m around the cover of any valve or within a distance of 1m from any hydrant outlet; and
 - tree planting may be prohibited in the event that the DWS considers that there is any likelihood of damage being caused to water mains;
- (g) to note that the permission is only given to the development under application. If provision of an access road is required for the proposed development, the applicant should ensure that such access road (including any necessary filling/excavation of land) complies with the provisions of the relevant statutory plan and obtain planning permissions from the Town Planning Board where required before carrying out the road works.