

DEVELOPMENT PARAMETERS

APPLICATION SITE AREA	: 3,110 m ²	(ABOUT)
COVERED AREA	: 216 m ²	(ABOUT)
UNCOVERED AREA	: 2,894 m ²	(ABOUT)
PLOT RATIO	: 0.07	(ABOUT)
SITE COVERAGE	: 7 %	(ABOUT)
NO. OF STRUCTURE	: 1	
DOMESTIC GFA	: NOT APPLICABLE	
NON-DOMESTIC GFA	: 216 m ²	(ABOUT)
TOTAL GFA	: 216 m ²	(ABOUT)
BUILDING HEIGHT	: 5 m	(ABOUT)
NO. OF STOREY	: 1	

STRUCTURE	USE	COVERED AREA	GFA	BUILDING HEIGHT
B1	STORAGE OF CONSTRUCTION MATERIAL AND MACHINERY, SITE OFFICE AND WASHROOM	216 m ² (ABOUT)	216 m ² (ABOUT)	5 m (ABOUT)(1-STOREY)
TOTAL		216 m ² (ABOUT)	216 m ² (ABOUT)	

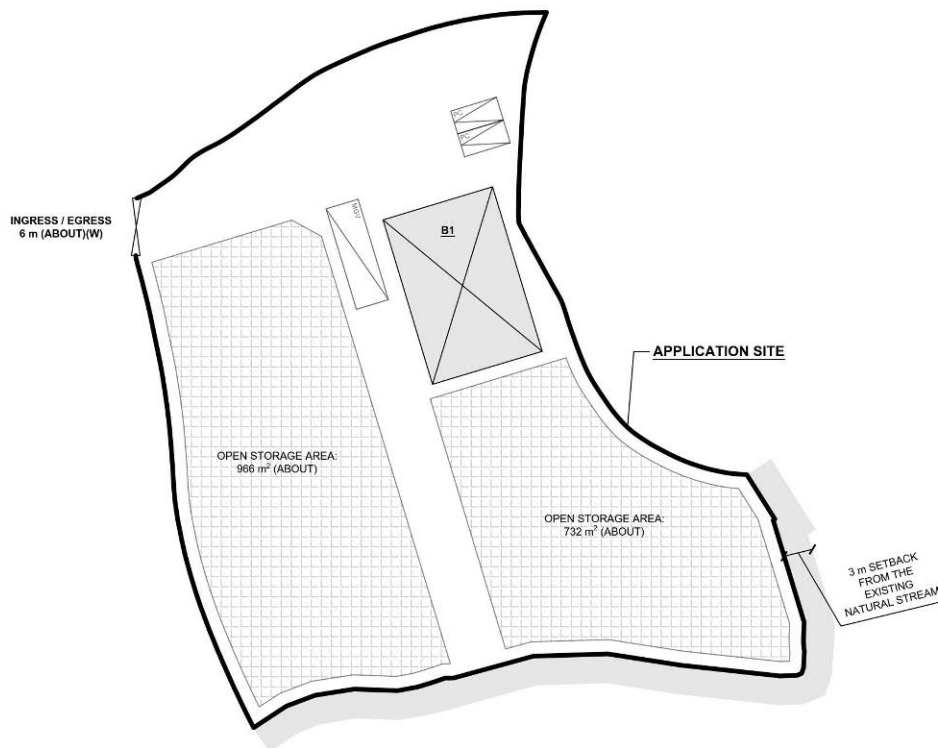
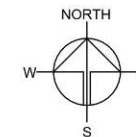

PARKING AND LOADING/UNLOADING PROVISIONS

NO. OF PRIVATE CAR PARKING SPACE	: 2
DIMENSION OF PARKING SPACE	: 5 m (L) X 2.5 m (W)
NO. OF L/U/L SPACE FOR MEDIUM GOODS VEHICLE	: 1
DIMENSION OF L/U/L SPACE	: 11 m (L) X 3.5 m (W)

LEGEND

	APPLICATION SITE
	STRUCTURE
	OPEN STORAGE AREA
	PARKING SPACE (PRIVATE CAR)
	L/U/L SPACE (MEDIUM GOODS VEHICLE)
	INGRESS / EGRESS

PLANNING CONSULTANT



PROJECT

PROPOSED TEMPORARY OPEN STORAGE OF CONSTRUCTION MATERIAL AND MACHINERY WITH ANCILLARY FACILITIES FOR A PERIOD OF 3 YEARS AND ASSOCIATED FILLING OF LAND

SITE LOCATION

LOTS 357 (PART) AND 359 (PART) IN D.D. 87, HUNG LUNG HANG, NEW TERRITORIES

SCALE

1:700 @ 1/4"

DRAWN BY	DATE
MN	16.5.2024
CHECKED BY	DATE
APPROVED BY	DATE
DWG. TITLE	
LAYOUT PLAN	
DWG NO.	VER.
PLAN 5	001

參考編號

REFERENCE No. A/NE-FTA/246

繪圖 DRAWING A-1

(來源: 申請人於2024年6月18日呈交的規劃申請表內的繪圖)
(SOURCE: DRAWING IN THE APPLICANT'S SUBMITTED APPLICATION FORM ON 18.6.2024)

LEGEND:

- APPLICATION SITE BOUNDARY (FOR IDENTIFICATION PURPOSE ONLY)
- PROPOSED CATCHPIT
- PROPOSED UCHANNEL
- PROPOSED UCHANNEL 2m FOR IMPROVEMENT WORKS
- PROPOSED UCHANNEL 600mm FOR IMPROVEMENT WORKS

PROPOSED IMPROVEMENT - 600 CHANNEL

CONNECTION DETAIL A

*CONNECTION LEVEL TO BE VERIFY ON SITE

APPLICATION SITE BOUNDARY (FOR IDENTIFICATION PURPOSE ONLY)

PROPOSED IMPROVEMENT - 600 CHANNEL

CONNECTION DETAIL A

PROPOSED 2m WIDTH CHANNEL BESIDE THE EXISTING CHANNEL

CONNECT TO THE IL OF THE EXISTING CHANNEL

CONNECTION TO 2m Channel

PROPOSED IMPROVEMENT - 600 CHANNEL (ALONG AND OUTSIDE BOUNDARY LINE)

UCHANNEL TYPE

UCHANNEL 1 (UC1) - 375mm, MIN. 1 IN 250

UCHANNEL 2 (UC2) - 450mm, MIN. 1 IN 250

UCHANNEL 3 (UC3) - 525mm, MIN. 1 IN 250

NOTES:

1. INVERT LEVEL OF CONNECTION POINT SHOULD BE VERIFIED ON SITE BEFORE CONSTRUCTION.

REV	DESCRIPTION	DATE

DRAWING TITLE

PROPOSED DRAINAGE SYSTEM

DRAWING NUMBER

FIGURE 3

PROJECT:
Proposed Temporary Open
Storage of Construction Material
and Machinery with Ancillary
Facilities for a Period of 3 Years
and Associated Filling of Land in
"Agriculture" Zone, Lots 357 (Part)
and 359 (Part) in D.D.87,
Hung Lung Hang, N.T.

REV	DESCRIPTION	DATE
-----	-------------	------

DRAWING TITLE
PROPOSED DRAINAGE
SYSTEM

DRAWING NUMBER
FIGURE 3

參考編號
REFERENCE No. A/NE-FTA/246

繪圖 DRAWING A-2

(來源:申請人於2024年9月2日呈交的進一步資料內的繪圖)
(SOURCE: DRAWING IN THE APPLICANT'S SUBMITTED
FURTHER INFORMATION ON 2.9.2024)

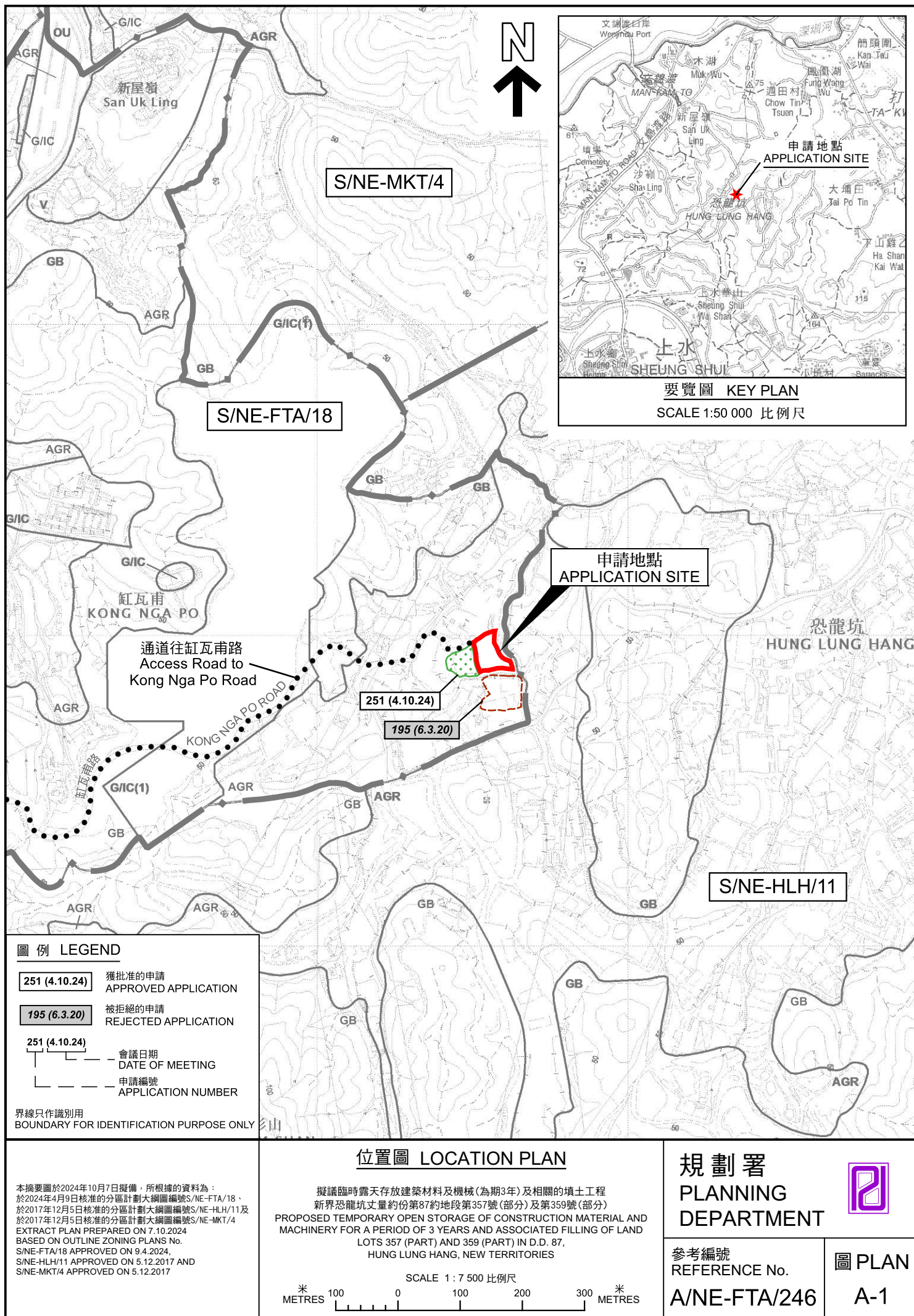

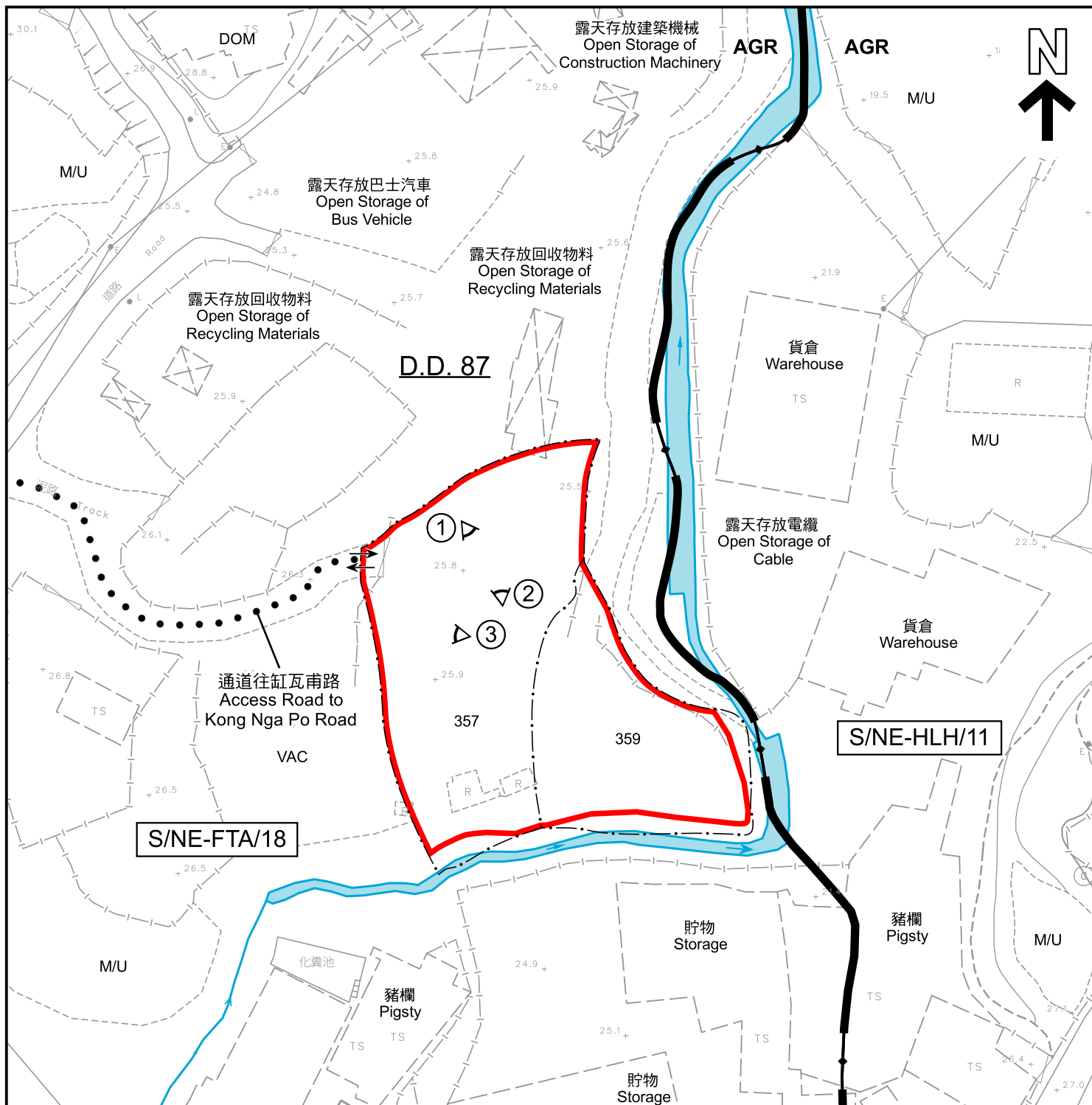

圖例 LEGEND

- | | | | |
|-----|------------------------------|--|-----------------------------------------|
| | 申請地點
APPLICATION SITE | | 河道
STREAM COURSE |
| AGR | 農業
AGRICULTURE | | 入口/出口
INGRESS / EGRESS |
| M/U | 荒地
UNUSED LAND | | 實地照片的觀景點
VIEWING POINT OF SITE PHOTO |
| DOM | 住用構築物
DOMESTIC STRUCTURES | | |
| VAC | 空置
VACANT | | |

界線只作識別用
BOUNDARY FOR IDENTIFICATION PURPOSE ONLY

註釋 Note :

- (1) 2024年7月19日勘測的土地用途
Land uses shown on this plan are in accordance with the land use survey conducted by the Planning Department on 19.7.2024

平面圖 SITE PLAN

擬議臨時露天存放建築材料及機械(為期3年)及相關的填土工程
新界恐龍坑丈量約份第87約地段第357號(部分)及第359號(部分)
PROPOSED TEMPORARY OPEN STORAGE OF CONSTRUCTION MATERIAL AND
MACHINERY FOR A PERIOD OF 3 YEARS AND ASSOCIATED FILLING OF LAND
LOTS 357 (PART) AND 359 (PART) IN D.D. 87,
HUNG LUNG HANG, NEW TERRITORIES

SCALE 1 : 1 000 比例尺
米 20 0 20 40 米
METRES

規劃署
PLANNING
DEPARTMENT



參考編號
REFERENCE No.
A/NE-FTA/246

圖 PLAN
A-2

本摘要圖於2024年10月10日擬備，
所根據的資料為測量圖編號
3-NW-22A及22B
EXTRACT PLAN PREPARED ON 10.10.2024
BASED ON SURVEY SHEETS No.
3-NW-22A & 22B



圖例 LEGEND

 申請地點
APPLICATION SITE

界線只作識別用
BOUNDARY FOR IDENTIFICATION PURPOSE ONLY

航攝照片 AERIAL PHOTO

擬議臨時露天存放建築材料及機械(為期3年)及相關的填土工程
新界恐龍坑丈量約份第87約地段第357號(部分)及第359號(部分)
PROPOSED TEMPORARY OPEN STORAGE OF CONSTRUCTION MATERIAL AND
MACHINERY FOR A PERIOD OF 3 YEARS AND ASSOCIATED FILLING OF LAND
LOTS 357 (PART) AND 359 (PART) IN D.D. 87,
HUNG LUNG HANG, NEW TERRITORIES

規劃署
PLANNING
DEPARTMENT



參考編號
REFERENCE No.
A/NE-FTA/246

圖 PLAN
A-3

本摘要圖於2024年10月4日擬備，
所根據的資料為地政總署
於2022年12月18日拍得的航攝照片
編號E174939C
EXTRACT PLAN PREPARED ON 4.10.2024
BASED ON AERIAL PHOTO No. E174939C
TAKEN ON 18.12.2022 BY
LANDS DEPARTMENT



界線只作識別用
BOUNDARY FOR IDENTIFICATION PURPOSE ONLY

實地照片 SITE PHOTO

本摘要圖於2024年10月10日擬備，
所根據的資料為攝於2024年7月19日
的實地照片
EXTRACT PLAN PREPARED ON 10.10.2024
BASED ON SITE PHOTOS
TAKEN ON 19.7.2024

擬議臨時露天存放建築材料及機械(為期3年)及相關的填土工程
新界恐龍坑丈量約份第87約地段第357號(部分)及第359號(部分)
PROPOSED TEMPORARY OPEN STORAGE OF CONSTRUCTION MATERIAL AND
MACHINERY FOR A PERIOD OF 3 YEARS AND ASSOCIATED FILLING OF LAND
LOTS 357 (PART) AND 359 (PART) IN D.D. 87,
HUNG LUNG HANG, NEW TERRITORIES

規 劃 署
PLANNING
DEPARTMENT



參考編號
REFERENCE No.
A/NE/FTA/246

圖 PLAN
A-4