

DEVELOPMENT PARAMETERS

| | | |
|-----------------------|----------------------|---------|
| APPLICATION SITE AREA | : 344 m ² | (ABOUT) |
| COVERED AREA | : 333 m ² | (ABOUT) |
| UNCOVERED AREA | : 11 m ² | (ABOUT) |
| PLOT RATIO | : 1 | (ABOUT) |
| SITE COVERAGE | : 97 % | (ABOUT) |
| NO. OF STRUCTURE | : 2 | |
| DOMESTIC GFA | : NOT APPLICABLE | |
| NON-DOMESTIC GFA | : 333 m ² | (ABOUT) |
| TOTAL GFA | : 333 m ² | (ABOUT) |
| BUILDING HEIGHT | : 4 m | (ABOUT) |
| NO. OF STOREY | : 1 | |

| STRUCTURE | USE | COVERED AREA | GFA | BUILDING HEIGHT |
|-----------|---|---------------------------|---------------------------|----------------------|
| B1 | PARKING AND CIRCULATION SPACES RAIN SHELTER (3-SIDE OPENED CANOPY) | 147m ² (ABOUT) | 147m ² (ABOUT) | 4m (ABOUT)(1-STOREY) |
| B2 | ANIMAL BOARDING ESTABLISHMENT | 186m ² (ABOUT) | 186m ² (ABOUT) | 4m (ABOUT)(1-STOREY) |
| TOTAL | | 333m ² (ABOUT) | 333m ² (ABOUT) | |

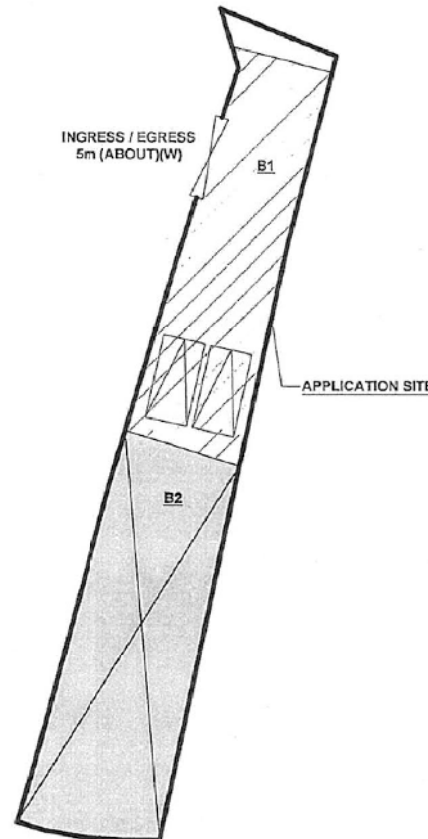
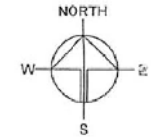

PLANNING CONSULTANT
R-RICHES PROPERTY
CONSULTANTS LIMITED

PROJECT
PROPOSED TEMPORARY
ANIMAL BOARDING
ESTABLISHMENT FOR A PERIOD
OF 5 YEARS AND LAND FILLING

SITE LOCATION
LOTS 599 S.K AND 599 S.L IN
D.D. 98, KWU TUNG SOUTH,
SHEUNG SHUI, NEW
TERRITORIES

SCALE
1:100 @ 1/4" = 1m

DRAWN BY
MN

DATE
16.2.2022

CHECKED BY

DATE

APPROVED BY

DATE

DWG. TITLE
LAYOUT PLAN

DWG. NO.
P04

VER.
001

LEGEND

- APPLICATION SITE
- STRUCTURE (ENCLOSED)
- STRUCTURE (CANOPY)
- PARKING SPACE
- INGRESS / EGRESS

PARKING AND LOADING/UNLOADING PROVISIONS

| | |
|----------------------------------|---------------------|
| NO. OF PRIVATE CAR PARKING SPACE | : 2 |
| DIMENSION OF PARKING SPACE | : 5m (L) X 2.5m (W) |
| MINIMUM HEADROOM | : 3m |

(資料來源:申請人於 19. 4. 2022 呈交的資料)
(Source : Applicant's Submission of 19.4.2022)

參考編號
REFERENCE No.
A/NE-KTS/508

繪圖 DRAWING
A-1

PAVED RATIO OF THE APPLICATION SITE

| | |
|--------------------------|--|
| APPLICATION SITE AREA | : 344 m ² (ABOUT) |
| COVERED BY STRUCTURE | : 333 m ² (97%)(ABOUT) |
| LAND FILLING AREA | : 344 m ² (100%)(ABOUT) |
| DEPTH OF LAND FILLING | : NOT MORE THAN 0.2m (ABOUT) |
| MATERIAL OF LAND FILLING | : CONCRETE |
| PURPOSE OF LAND FILLING | : SITE FORMATION OF STRUCTURES AND CIRCULATION SPACE |

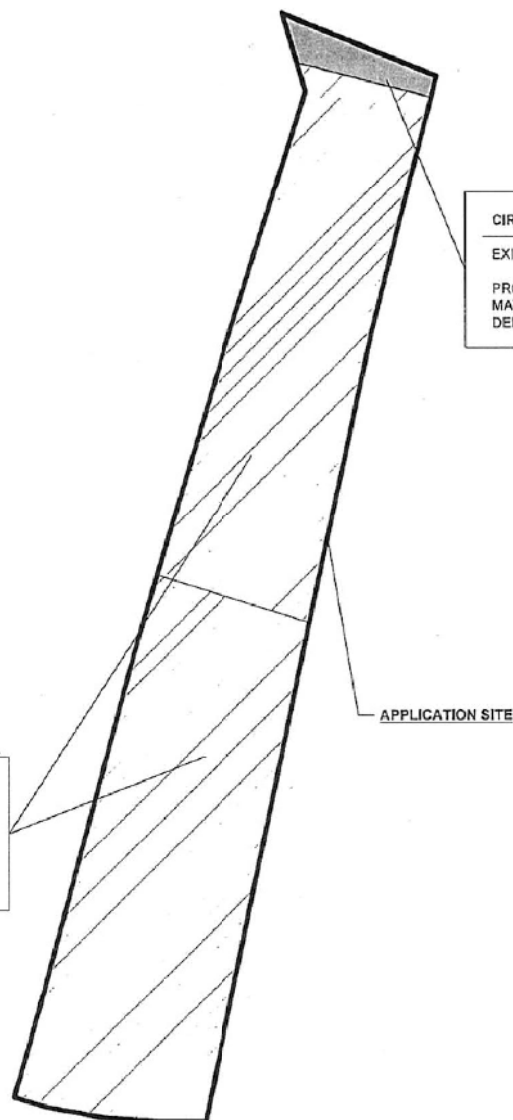

| | |
|---------------------|----------------------|
| CIRCULATION SPACE | |
| EXISTING SITE LEVEL | : 14.8 mPD (ABOUT) |
| PROPOSED SITE LEVEL | : 14.9 mPD (ABOUT) |
| MATERIAL OF FILLING | : CONCRETE |
| DEPTH OF FILLING | : NOT MORE THAN 0.1m |

| | |
|-----------------------------|----------------------|
| SITE FORMATION OF STRUCTURE | |
| EXISTING SITE LEVEL | : 14.8 mPD (ABOUT) |
| PROPOSED SITE LEVEL | : 15.0 mPD (ABOUT) |
| MATERIAL OF FILLING | : CONCRETE |
| DEPTH OF FILLING | : NOT MORE THAN 0.2m |

LEGEND

| | |
|--|------------------------------------|
| | APPLICATION SITE |
| | LAND FILLING AREA (SITE FORMATION) |
| | LAND FILLING (CIRCULATION SPACE) |

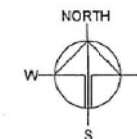

PLANNING CONSULTANT

R-RICHES PROPERTY
CONSULTANT LIMITED

PROJECT

PROPOSED TEMPORARY
ANIMAL BOARDING
ESTABLISHMENT FOR A PERIOD
OF 5 YEARS AND LAND FILLING

SITE LOCATION

LOTS 598 S.K AND 599 S.L. IN
D.D. 98, KWU TUNG SOUTH,
SHEUNG SHUI, NEW
TERRITORIES

SCALE

1:500 @ A1

DRAWN BY MN DATE 16.2.2022

CHECKED BY DATE

APPROVED BY DATE

DWG. TITLE
PAVED RATIO

DWG NO.
P05

VER.
001

(資料來源:申請人於 19.4.2022 呈交的資料)
(Source : Applicant's Submission of 19.4.2022)

參考編號
REFERENCE No.
A/NE-KTS/508

繪圖 DRAWING
A-2

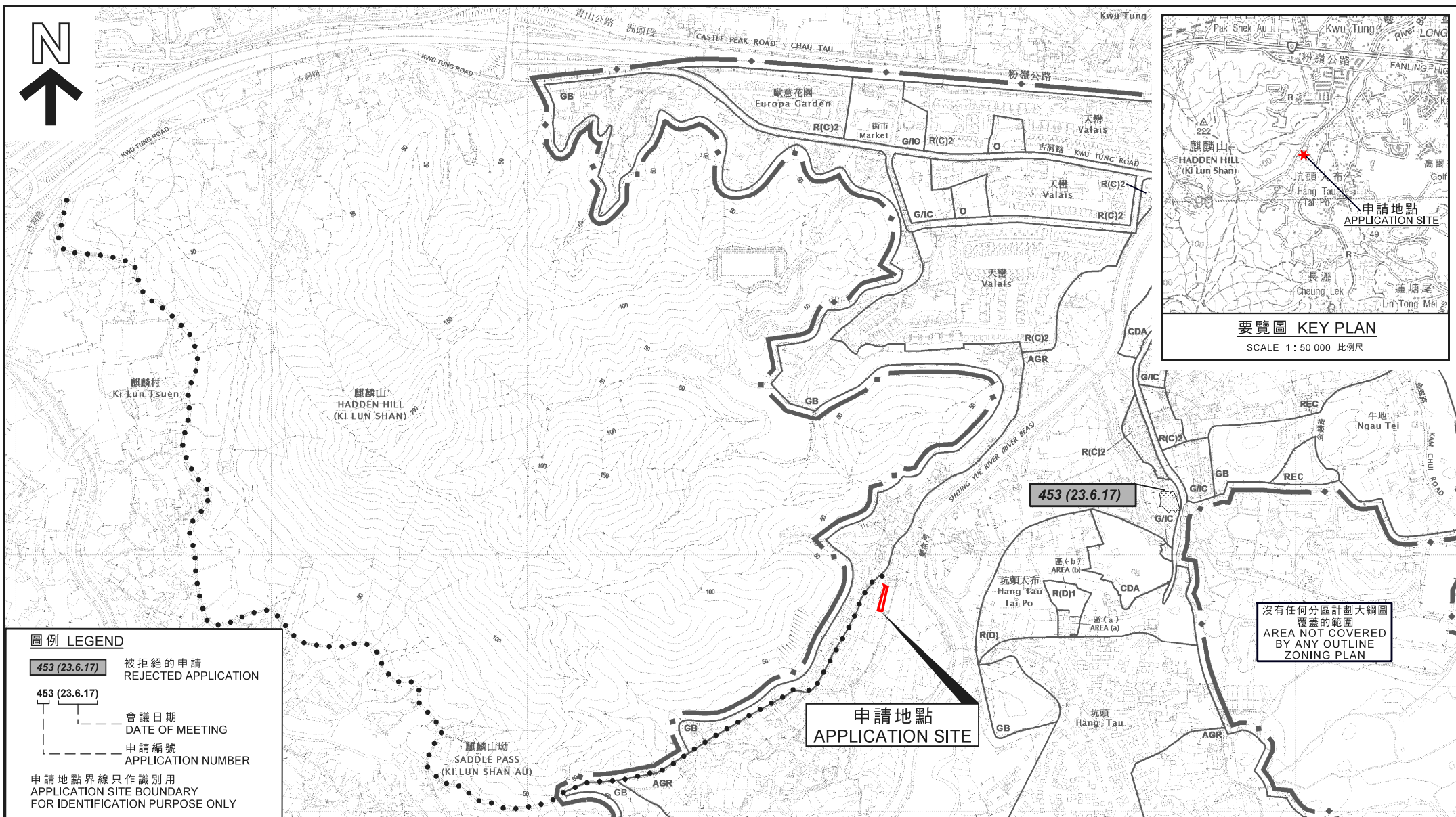

位置圖 LOCATION PLAN

擬議臨時動物寄養所（為期5年）及填土工程
 新界上水古洞南丈量約份第98約地段第599號K分段及第599號L分段
 PROPOSED TEMPORARY ANIMAL BOARDING ESTABLISHMENT
 (FOR A PERIOD OF 5 YEARS) AND FILLING OF LAND
 LOTS 599 S.K AND 599 S.L IN D.D. 98, KWU TUNG SOUTH,
 SHEUNG SHUI, NEW TERRITORIES

SCALE 1: 10 000 比例尺
 100 0 100 200 300 400 500 米 METRES

本摘要圖於2022年5月27日擬備，
 所根據的資料為於2022年1月4日核准的
 分區計劃大綱圖編號S/NE-KTS/18

EXTRACT PLAN PREPARED ON 27.5.2022
 BASED ON OUTLINE ZONING PLAN
 No. S/NE-KTS/18 APPROVED ON 4.1.2022

規劃署
 PLANNING
 DEPARTMENT



參考編號
 REFERENCE No.
 A/NE-KTS/508

圖 PLAN
 A-1

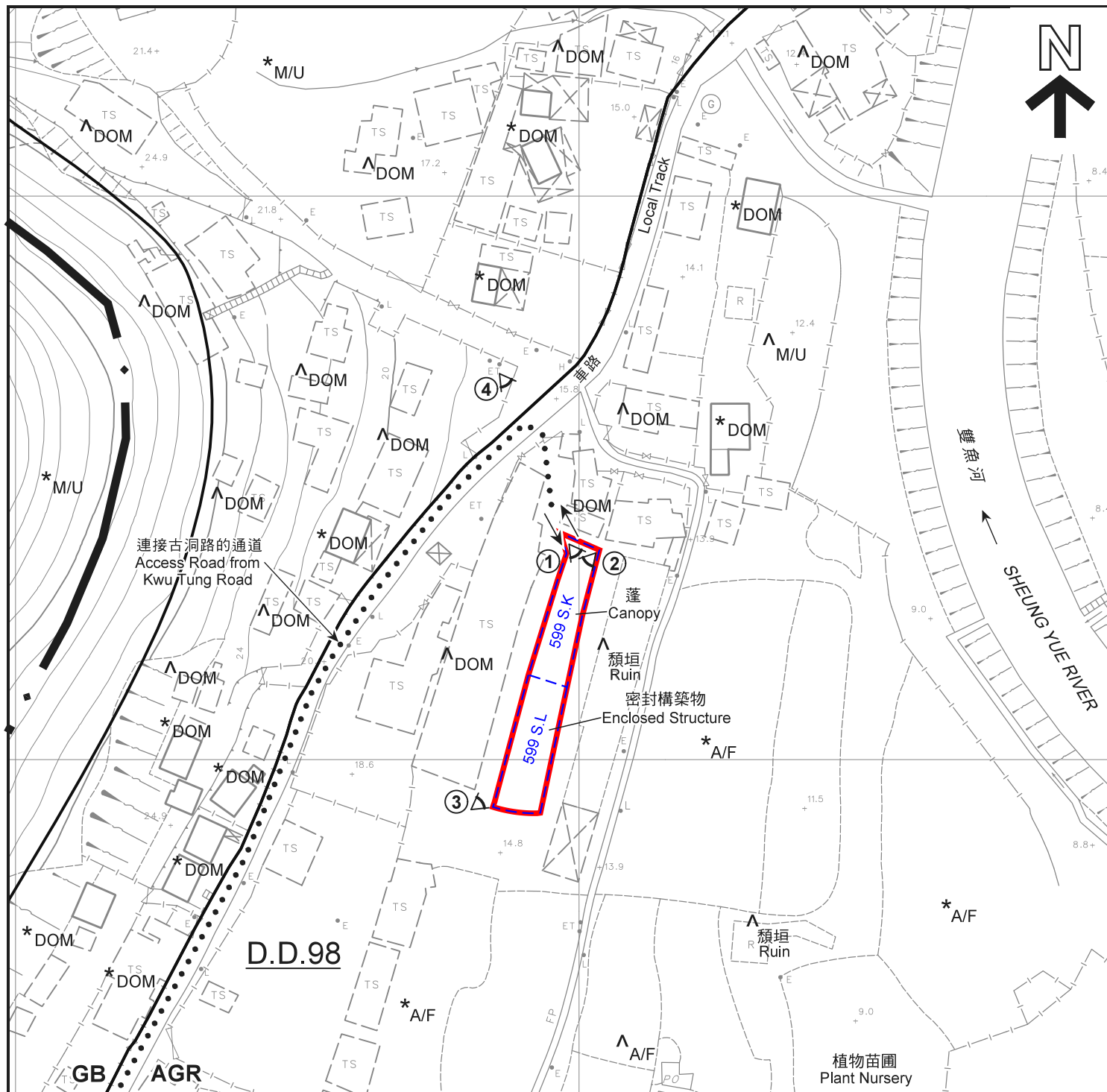

圖例 LEGEND

申請地點(界線只作識別用)
APPLICATION SITE (BOUNDARY FOR IDENTIFICATION PURPOSE ONLY)

AGR 農業
AGRICULTURE

GB 綠化地帶
GREEN BELT

A/C 常耕農地
ACTIVE AGRICULTURAL LAND

A/F 休耕農地
FALLOW AGRICULTURAL LAND

DOM 住用構築物
DOMESTIC STRUCTURE

M/U 荒地
UNUSED LAND

VAC 空置
VACANT
↔ 入口/出口
INGRESS / EGRESS
① ◁ 實地照片的觀景點
VIEWING POINT OF SITE PHOTO

註釋 Notes:

- (1) 2022年4月29日勘測的土地用途
Land uses shown on this plan are in accordance with the land use survey conducted by the Planning Department on 29.4.2022
- (2) * 土地用途跟1991年勘測的土地用途一致
Indicates that the use is the same as that revealed by the land use survey conducted by the Planning Department in 1991
- (3) ^ 土地用途跟1991年勘測的土地用途有別
Indicates that the use is different from that revealed by the land use survey conducted by the Planning Department in 1991

本摘要圖於2022年6月1日擬備，
所根據的資料為測量圖編號
2-SE-14B

EXTRACT PLAN PREPARED ON 1.6.2022
BASED ON SURVEY SHEET No.
2-SE-14B

平面圖 SITE PLAN

擬議臨時動物寄養所(為期5年)及填土工程
PROPOSED TEMPORARY ANIMAL BOARDING ESTABLISHMENT
(FOR A PERIOD OF 5 YEARS) AND FILLING OF LAND
LOTS 599 S.K AND 599 S.L IN D.D. 98, KWU TUNG SOUTH,
SHEUNG SHUI, NEW TERRITORIES

SCALE 1 : 1 000 比例尺
米 20 0 20 40 米
METRES

規劃署
PLANNING
DEPARTMENT



參考編號
REFERENCE No.
A/NE-KTS/508

圖 PLAN
A-2



圖例 LEGEND

- 申請地點 (界線只作識別用)
APPLICATION SITE
(BOUNDARY FOR IDENTIFICATION
PURPOSE ONLY)
- 入口 / 出口
INGRESS / EGRESS

航攝照片 AERIAL PHOTO

擬議臨時動物寄養所 (為期5年) 及填土工程
新界上水古洞南丈量約份第98約地段第599號K分段及第599號L分段
PROPOSED TEMPORARY ANIMAL BOARDING ESTABLISHMENT
(FOR A PERIOD OF 5 YEARS) AND FILLING OF LAND
LOTS 599 S.K AND 599 S.L IN D.D. 98, KWU TUNG SOUTH,
SHEUNG SHUI, NEW TERRITORIES

規劃署
PLANNING
DEPARTMENT



本摘要圖於2022年6月1日擬備，
所根據的資料為地政總署
於2021年1月14日拍得的航攝照片
編號E124791C
EXTRACT PLAN PREPARED ON 1.6.2022
BASED ON AERIAL PHOTO No. E124791C
TAKEN ON 14.1.2021 BY
LANDS DEPARTMENT

參考編號
REFERENCE No.
A/NE-KTS/508

圖 PLAN
A-3



實地照片 SITE PHOTOS

擬議臨時動物寄養所（為期5年）及填土工程
新界上水古洞南丈量約份第98約地段第599號K分段及第599號L分段
PROPOSED TEMPORARY ANIMAL BOARDING ESTABLISHMENT
(FOR A PERIOD OF 5 YEARS) AND FILLING OF LAND
LOTS 599 S.K AND 599 S.L IN D.D. 98, KWU TUNG SOUTH,
SHEUNG SHUI, NEW TERRITORIES

規劃署
PLANNING
DEPARTMENT



參考編號
REFERENCE No.
A/NE-KTS/508

圖 PLAN
A-4a

本摘要圖於2022年5月17日擬備，
所根據的資料為攝於
2022年4月29日的實地照片
PLAN PREPARED ON 17.5.2022
BASED ON SITE PHOTOS
TAKEN ON 29.4.2022



實地照片 SITE PHOTOS

本摘要圖於2022年5月17日擬備，
所根據的資料為攝於
2022年4月29日的實地照片
PLAN PREPARED ON 17.5.2022
BASED ON SITE PHOTOS
TAKEN ON 29.4.2022

擬議臨時動物寄養所（為期5年）及填土工程
新界上水古洞南丈量約份第98約地段第599號K分段及第599號L分段
PROPOSED TEMPORARY ANIMAL BOARDING ESTABLISHMENT
(FOR A PERIOD OF 5 YEARS) AND FILLING OF LAND
LOTS 599 S.K AND 599 S.L IN D.D. 98, KWU TUNG SOUTH,
SHEUNG SHUI, NEW TERRITORIES

規劃署
PLANNING
DEPARTMENT



參考編號
REFERENCE No.
A/NE-KTS/508

圖 PLAN
A-4b