

LAYOUT PLAN

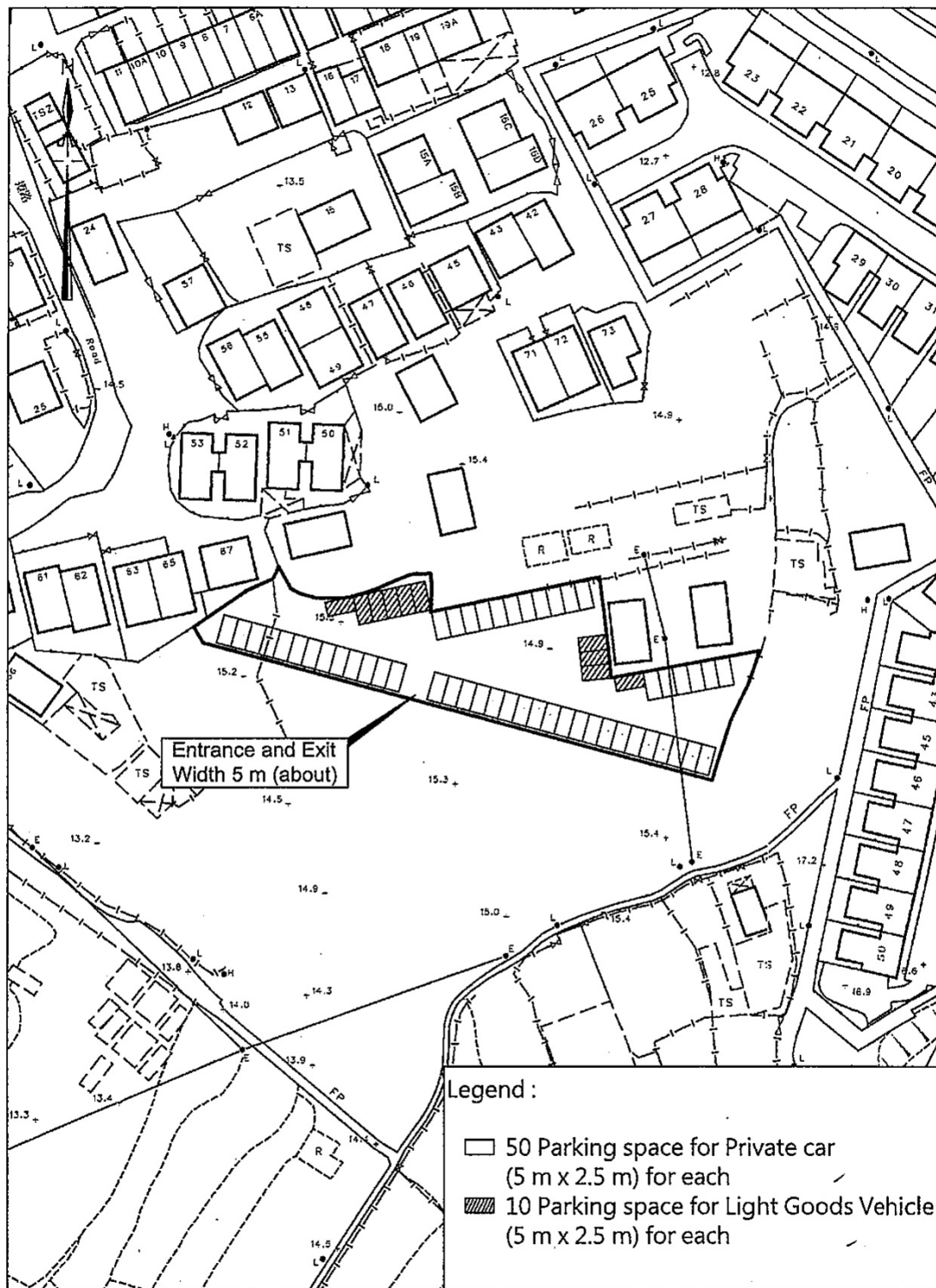

Scale : 1 : 1000

Survey Sheet No. : 3-SW-11B

3-SW-12A

Date : February 2023

參考編號

REFERENCE No.

A/NE-PK/184

繪圖 DRAWING A-1

(來源 : 申請人建議書)

(SOURCE : APPLICANT'S SUBMISSION PLAN)

ACCESS PLAN



Legend :

- 50 Parking space for Private car (5 m x 2.5 m) for each
- 10 Parking space for Light Goods Vehicle (5 m x 2.5 m) for each

Scale : 1 : 1000

Survey Sheet No. : 3-SW-11B
3-SW-12A

Date : April 2023

參考編號

REFERENCE No.

A/NE-PK/184

繪圖 DRAWING A-2

(來源 : 申請人呈交的進一步資料)

(SOURCE : APPLICANT'S SUBMITTED FURTHER INFORMATION)

Entrance and Exit Path

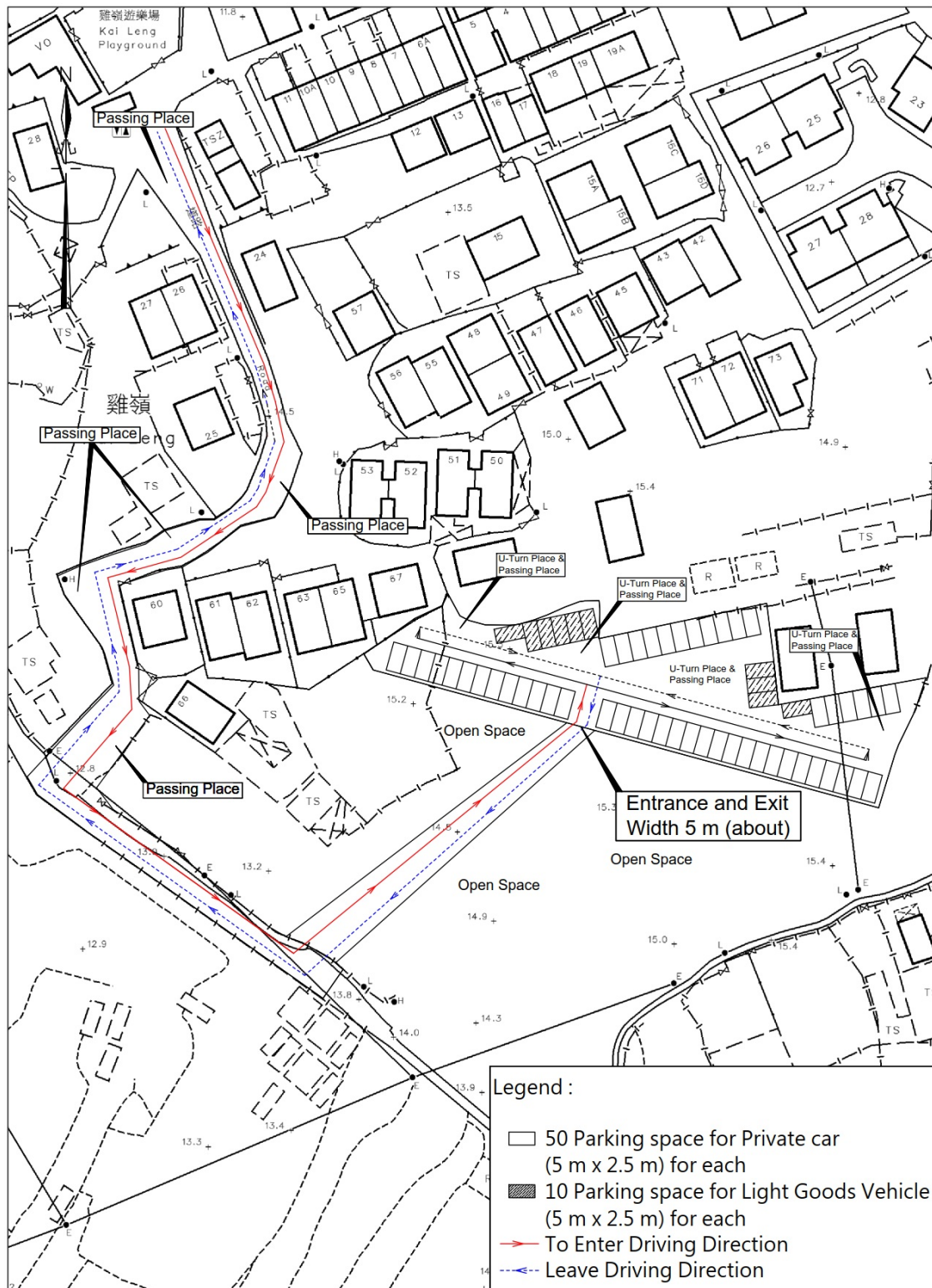

Scale : 1 : 1000

Survey Sheet No. : 3-SW-11B
3-SW-12A

Date : April 2023

參考編號
REFERENCE No. A/NE-PK/184

繪圖 DRAWING A-3

(來源 : 申請人呈交的進一步資料)
(SOURCE : APPLICANT'S SUBMITTED FURTHER INFORMATION)

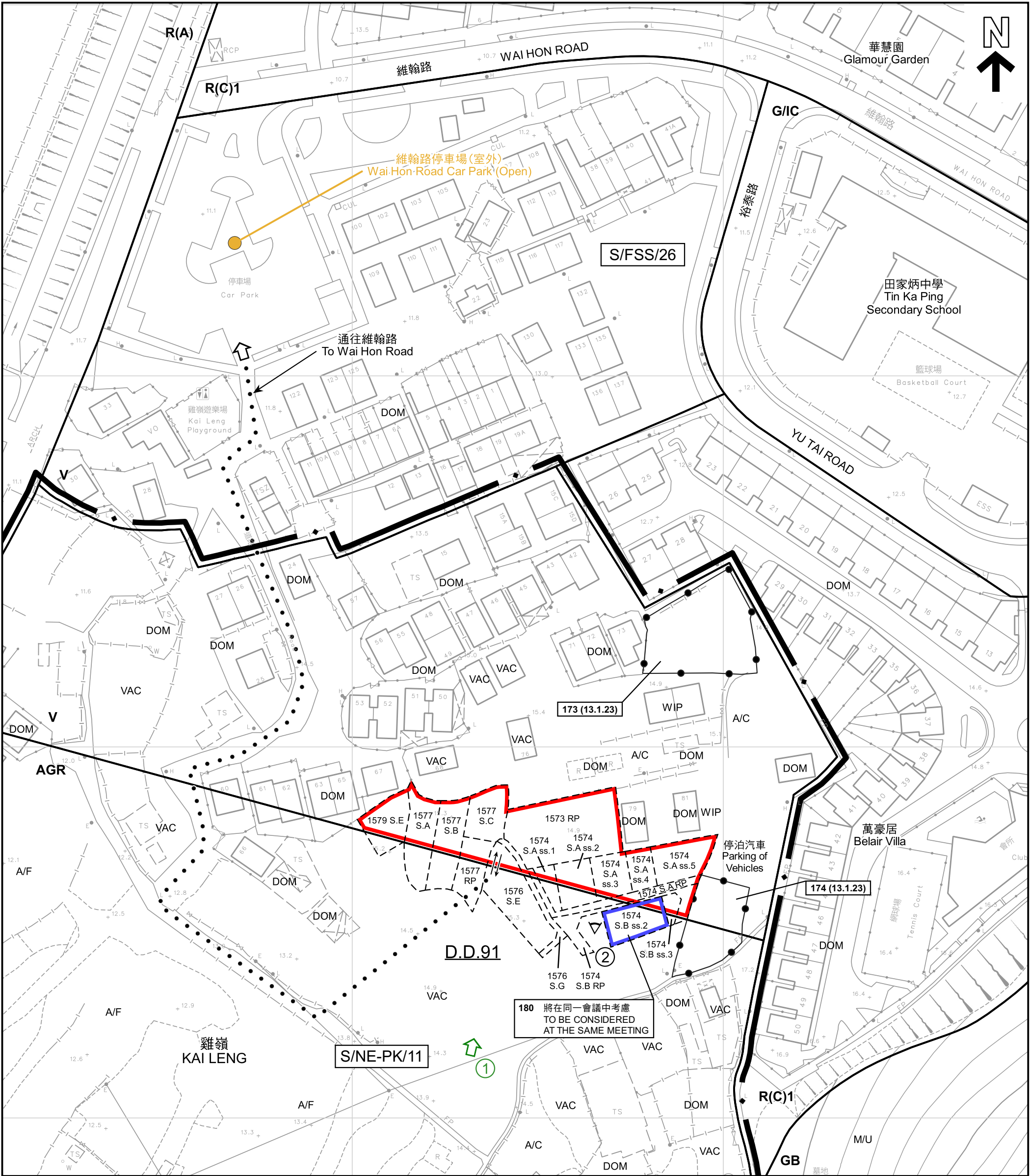

圖例 LEGEND

- 申請地點 (界線只作識別用)**
APPLICATION SITE (BOUNDARY FOR IDENTIFICATION PURPOSE ONLY)
- R(A)** 住宅(甲類)
RESIDENTIAL (GROUP A)
- R(C)** 住宅(丙類)
RESIDENTIAL (GROUP C)
- V** 鄉村式發展
VILLAGE TYPE DEVELOPMENT

- G/IC** 政府、機構或社區
GOVERNMENT, INSTITUTION OR COMMUNITY
- AGR** 農業
AGRICULTURE
- GB** 綠化地帶
GREEN BELT
- 入口/出口
INGRESS / EGRESS
- 現有行車通道
EXISTING VEHICLE ACCESS

- A/C** 常耕農地
ACTIVE AGRICULTURAL LAND
- A/F** 休耕農地
FALLOW AGRICULTURAL LAND
- DOM** 住用構築物
DOMESTIC STRUCTURES
- M/U** 荒地
UNUSED LAND

- VAC** 空置
VACANT
- WIP** 施工中
WORKS IN PROGRESS

- ①** 無人駕駛航拍的拍攝方向
VIEWING DIRECTION FROM UNMANNED AERIAL VEHICLE (UAV)
- ②** 實地照片的觀景點
VIEWING POINT OF SITE PHOTO

註釋 Note :
(1) 2023年4月19日勘測的土地用途
Land uses shown on this plan are in accordance with the land use survey conducted by the Planning Department on 19.4.2023

平面圖 SITE PLAN

臨時私人停車場(私家車及輕型貨車)(為期3年)
新界上水雞嶺丈量約份第91約多個地段
TEMPORARY PRIVATE VEHICLE PARK
(PRIVATE CAR AND LIGHT GOODS VEHICLE) FOR A PERIOD OF 3 YEARS
VARIOUS LOTS IN D.D. 91,
KAI LENG, SHEUNG SHUI, NEW TERRITORIES

SCALE 1 : 1 000 比例尺

米 METRES 20 0 20 40 60 80 米 METRES

規劃署
PLANNING
DEPARTMENT



參考編號
REFERENCE No.
A/NE-PK/184

圖 PLAN
A-2



圖例 LEGEND



申請地點 (界線只作識別用)
APPLICATION SITE (BOUNDARY FOR
IDENTIFICATION PURPOSE ONLY)

航攝照片 AERIAL PHOTO

臨時私人停車場(私家車及輕型貨車) (為期3年)
新界上水雞嶺丈量約份第91約多個地段
TEMPORARY PRIVATE VEHICLE PARK
(PRIVATE CAR AND LIGHT GOODS VEHICLE) FOR A PERIOD OF 3 YEARS
VARIOUS LOTS IN D.D. 91,
KAI LENG, SHEUNG SHUI, NEW TERRITORIES

規劃署
PLANNING
DEPARTMENT



參考編號
REFERENCE No.
A/NE-PK/184

圖 PLAN
A-3

本摘要圖於2023年5月3日擬備，
所根據的資料為地政總署於2022年2月14日
拍得的航攝照片編號E149556C
EXTRACT PLAN PREPARED ON 3.5.2023
BASED ON AERIAL PHOTO No. E149556C
TAKEN ON 14.2.2022 BY
LANDS DEPARTMENT



攝於2023年3月29日的無人駕駛航拍照片 UNMANNED AERIAL VEHICLE (UAV) PHOTO TAKEN ON 29.3.2023



攝於2023年4月4日的實地照片 SITE PHOTO TAKEN ON 4.4.2023

申請地點界線只作識別用
APPLICATION SITE BOUNDARY FOR IDENTIFICATION PURPOSE ONLY

實地照片 SITE PHOTOS

臨時私人停車場(私家車及輕型貨車)(為期3年)
新界上水雞嶺丈量約份第91約多個地段
TEMPORARY PRIVATE VEHICLE PARK
(PRIVATE CAR AND LIGHT GOODS VEHICLE) FOR A PERIOD OF 3 YEARS
VARIOUS LOTS IN D.D. 91,
KAI LENG, SHEUNG SHUI, NEW TERRITORIES

規劃署
PLANNING
DEPARTMENT



參考編號
REFERENCE No.
A/NE-PK/184

圖 PLAN
A-4

本圖於2023年5月9日擬備
PLAN PREPARED ON 9.5.2023