

PROPOSED BUILDING LICENCE LOT Nos. 1511 S.P & 1595 S.A IN D.D.91

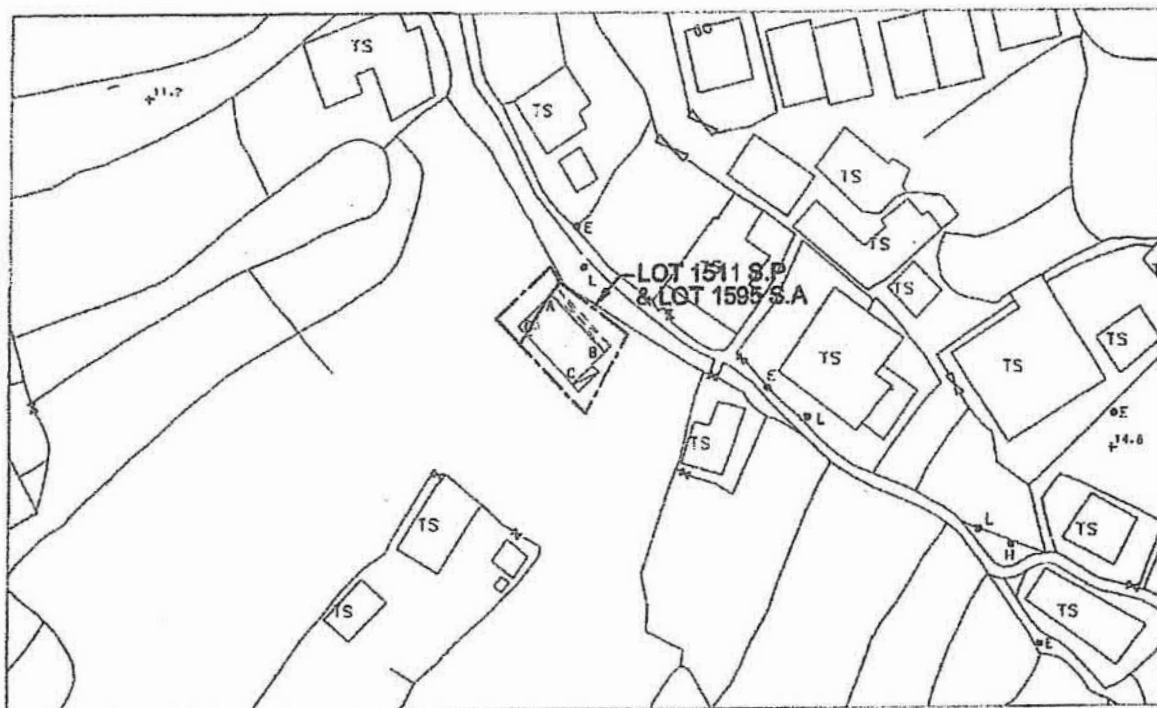

LOCATION PLAN



COLOURED PINK AREA : 65.03 SQUARE METRES (ABOUT)

Line	Bearing	Distance(m)	Northing(m)	Easting(m)	Pt.
A-B	46° 13' 26"	6.096	839250.412	831339.328	A
B-C	136° 13' 26"	10.668	839254.630	831343.730	B
C-D	226° 13' 26"	6.096	839246.927	831351.110	C
D-A	316° 13' 26"	10.668	839242.710	831346.709	D

Dated this 16th day of September, 2014.

Legends:

- Septic Tank (4' x 12')
- Balcony (6.096 m x 1.220m)

Scale 1:1000

Survey Sheet No.: 3-SW-11B

Date: September 2014

Plan No. : GL1177/BL/16

LEUNG Chi-yan, George
MIS Aust MNZIS HKIS MRICS RPS(LS) ACIArb
Authorized Land Surveyor

參考編號

REFERENCE No.

A/NE-PK/193

繪圖 DRAWING A-1

(來源 : 申請人建議書)

(SOURCE : APPLICANT'S SUBMISSION PLAN)

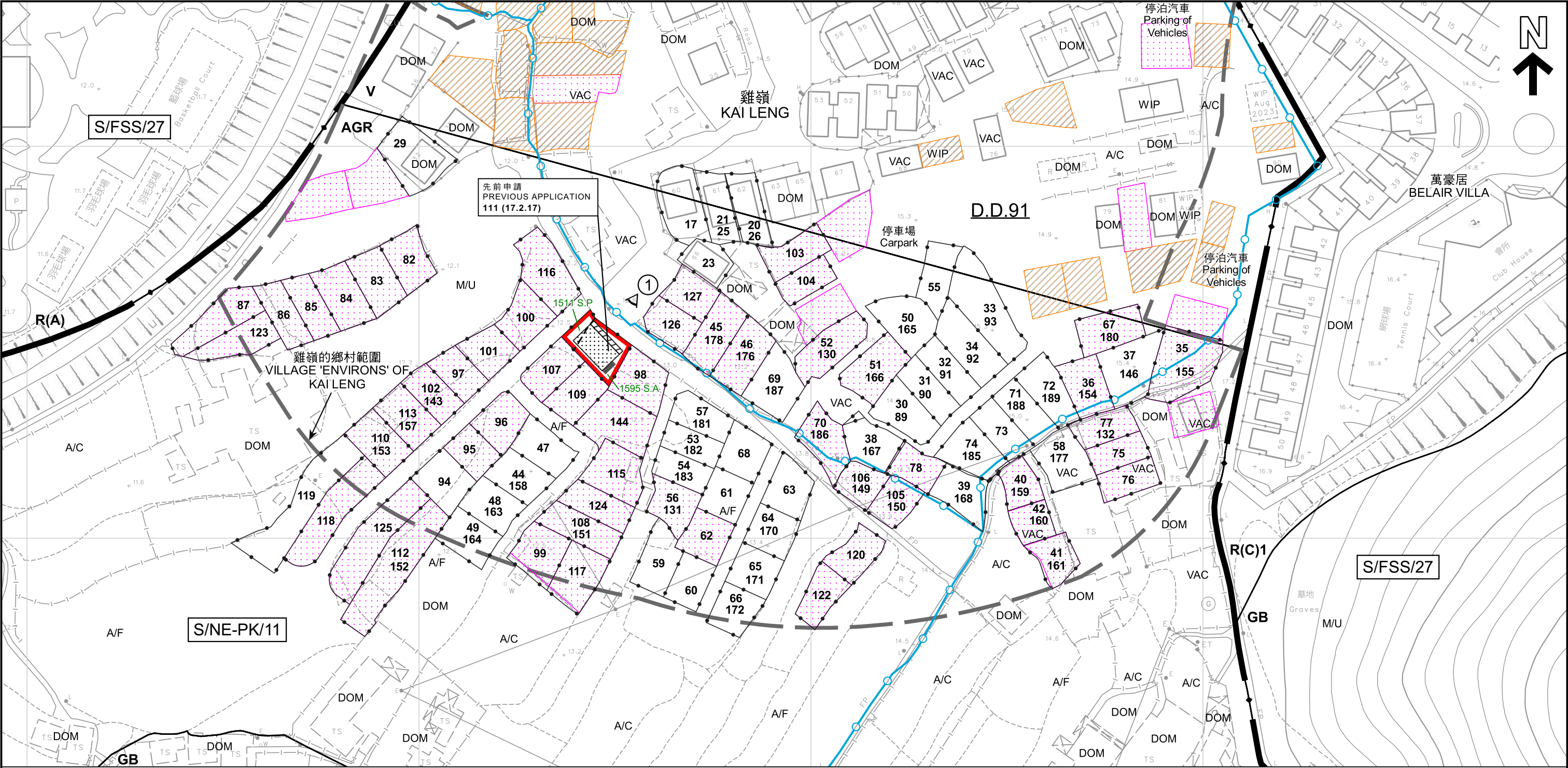

圖例 LEGEND		實地照片的觀景點 VIEWING POINT OF SITE PHOTO		V 鄉村式發展 VILLAGE TYPE DEVELOPMENT		A/C 常耕農地 ACTIVE AGRICULTURAL LAND		VAC 空置 VACANT	
	申請地點 (界線只作識別用) APPLICATION SITE (BOUNDARY FOR IDENTIFICATION PURPOSE ONLY)		獲地政處批准的小型屋宇批地/ 重建新界豁免管制屋宇申請 SMALL HOUSE GRANT / NTEH REDEVELOPMENT APPLICATION APPROVED BY DLO		住宅(甲類) RESIDENTIAL (GROUP A)		A/F 休耕農地 FALLOW AGRICULTURAL LAND		WIP 施工中 WORKS IN PROGRESS
	擬議小型屋宇 PROPOSED SMALL HOUSE		獲得規劃許可作小型房屋的地盤(申請編號) SITES WITH PLANNING APPROVALS FOR SMALL HOUSES (APPLICATION NUMBER)		住宅(丙類) RESIDENTIAL (GROUP C)		DOM 住用構築物 DOMESTIC STRUCTURES	註釋 Note : (1) 2023年11月7日勘測的土地用途 Land uses shown on this plan are in accordance with the land use survey conducted by the Planning Department on 7.11.2023	
	擬議露台 PROPOSED BALCONY		化糞池 SEPTIC TANK		農業 AGRICULTURE		M/U 荒地 UNUSED LAND		
	正在處理中的小型屋宇批地申請 SMALL HOUSE GRANT APPLICATION BEING PROCESSED		現有水管 EXISTING WATER MAIN		綠化地帶 GREEN BELT				

本摘要圖於2023年11月30日擬備，
所根據的資料為測量圖編號3-SW-11B及12A
EXTRACT PLAN PREPARED ON 30.11.2023
BASED ON SURVEY SHEETS No. 3-SW-11B & 12A

平面圖 SITE PLAN

擬議屋宇 (新界豁免管制屋宇-小型屋宇)
新界上水雞嶺丈量約份第91約地段第1511號P分段及第1595號A分段
PROPOSED HOUSE (NEW TERRITORIES EXEMPTED HOUSE - SMALL HOUSE)
LOTS 1511 S.P AND 1595 S.A IN D.D. 91, KAI LENG, SHEUNG SHUI, NEW TERRITORIES

SCALE 1:1 000 比例尺

米 20 0 20 40 60 80 米
METRES

規劃署
PLANNING DEPARTMENT

參考編號
REFERENCE No.
A/NE-PK/193

圖 PLAN
A-2a

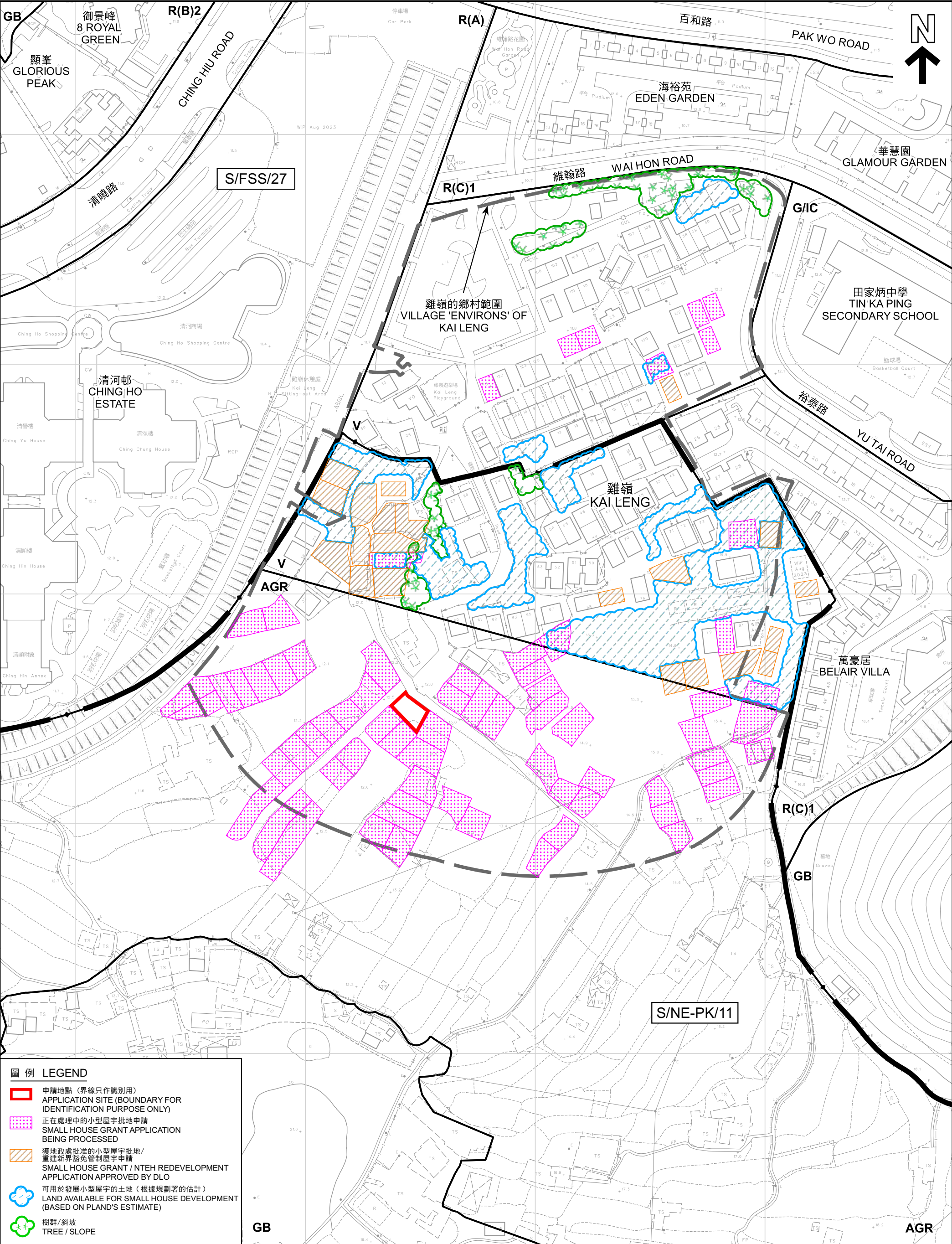

圖例

LEGEND

申請地點 (界線只作識別用)

APPLICATION SITE (BOUNDARY FOR IDENTIFICATION PURPOSE ONLY)

正在處理中的小型屋宇批地申請

SMALL HOUSE GRANT APPLICATION BEING PROCESSED

獲地政處批准的小型屋宇批地 / 重建新界豁免管制屋宇申請

SMALL HOUSE GRANT / NTEH REDEVELOPMENT APPLICATION APPROVED BY DLO

可用於發展小型屋宇的土地 (根據規劃署的估計)

LAND AVAILABLE FOR SMALL HOUSE DEVELOPMENT (BASED ON PLAND'S ESTIMATE)

樹群 / 斜坡

TREE / SLOPE

本摘要圖於2023年11月30日擬備，
所根據的資料為測量圖編號
3-SW-11B及12A
EXTRACT PLAN PREPARED ON 30.11.2023
BASED ON SURVEY SHEETS No.
3-SW-11B & 12A

在「鄉村式發展」地帶內預計可供發展小型屋宇的土地數量
ESTIMATED AMOUNT OF LAND AVAILABLE FOR
SMALL HOUSE DEVELOPMENT WITHIN THE "V" ZONE

擬議屋宇 (新界豁免管制屋宇-小型屋宇)
新界上水雞嶺丈量約份第91約地段第1511號P分段及第1595號A分段
PROPOSED HOUSE (NEW TERRITORIES EXEMPTED HOUSE - SMALL HOUSE)
LOTS 1511 S.P AND 1595 S.A IN D.D. 91, KAI LENG, SHEUNG SHUI, NEW TERRITORIES

SCALE 1 : 1 500 比例尺

米 20 0 20 40 60 80 100 120 米

METRES

規劃署
PLANNING
DEPARTMENT

參考編號
REFERENCE No.
A/NE-PK/193

圖 PLAN
A-2b

S/FSS/27 覆蓋的範圍
AREA COVERED BY
S/FSS/27



雞嶺
KAI LENG

AGR

雞嶺的鄉村範圍
VILLAGE 'ENVIRONS' OF
KAI LENG

S/NE-PK/11

圖例 LEGEND



申請地點 (界線只作識別用)
APPLICATION SITE (BOUNDARY FOR
IDENTIFICATION PURPOSE ONLY)

航攝照片 AERIAL PHOTO

本摘要圖於2023年11月30日擬備，
所根據的資料為地政總署
於2022年12月18日拍得的航攝照片
編號E174758C

EXTRACT PLAN PREPARED ON 30.11.2023
BASED ON AERIAL PHOTO No. E174758C
TAKEN ON 18.12.2022 BY
LANDS DEPARTMENT

擬議屋宇 (新界豁免管制屋宇-小型屋宇)
新界上水雞嶺丈量約份第91約地段第1511號P分段及第1595號A分段
PROPOSED HOUSE
(NEW TERRITORIES EXEMPTED HOUSE - SMALL HOUSE)
LOTS 1511 S.P AND 1595 S.A IN D.D. 91,
KAI LENG, SHEUNG SHUI, NEW TERRITORIES

規劃署
PLANNING
DEPARTMENT



參考編號
REFERENCE No.
A/NE-PK/193

圖 PLAN
A-3

1



申請地點界線只作識別用
APPLICATION SITE BOUNDARY FOR IDENTIFICATION PURPOSE ONLY

本圖於2023年11月30日擬備，
所根據的資料為攝於2023年11月7日
的實地照片
PLAN PREPARED ON 30.11.2023
BASED ON SITE PHOTO
TAKEN ON 7.11.2023

實地照片 SITE PHOTO

擬議屋宇（新界豁免管制屋宇-小型屋宇）
新界上水雞嶺丈量約份第91約地段第1511號P分段及第1595號A分段
PROPOSED HOUSE
(NEW TERRITORIES EXEMPTED HOUSE - SMALL HOUSE)
LOTS 1511 S.P AND 1595 S.A IN D.D. 91,
KAI LENG, SHEUNG SHUI, NEW TERRITORIES

規劃署
PLANNING
DEPARTMENT



參考編號
REFERENCE No.
A/NE-PK/193

圖 PLAN
A-4