

Total Site Area	About 3,776m² (including 47m² Government Land)
Uncovered Area	About 3,715m² (98.4%)
Covered Area	About 61m² (1.6%)
Proposed Use(s)	Temporary Public Vehicle Park (Excluding Container Vehicle) for a Period of Three Years
Container No(s).	4 (1 storey)
Proposed Use(s)	Security Control Room, Site Office, Electricity Supply Room and Store Room
No. of Storeys and Dimension Floor Area for Containers (4 Nos.)	1-storey; 6.1m(L) x 2.4m(W) x 2.44m(H) each About 58.56m ²
Structure No(s).	1
Proposed Use(s)	Security Guard Post
No. of Storeys and Dimension Floor Area for Structure (1 No.)	1-storey; 1.5m(L) x 1.5m(W) x 2.44m(H) About 2.25m ²
Total Floor Area	About 60.81m ²
No. of Parking Spaces (Types and No. of Parking Spaces)	78 (Including 40 private car parking spaces and 38 van-type LGV parking spaces)
Operation Hours	24 hours, from Monday to Sunday (including public holidays)
Width of Ingress/Egress	8m (about)
Project: Section 16 Planning Application for Proposed Temporary Public Vehicle Park (Excluding Container Vehicle) for a Period of Three Years at Lots 388 S.A, 388 S.B, 388 RP (Part) and 390 RP (Part) in D.D.78 and Adjoining Government Land, Tsung Yuen Ha, Ta Kwu Ling North, New Territories	
Title: Indicative Layout Plan	

LEGEND:

- [Dashed Red Line] The Application Site Boundary
 - [Hatched Box] Ingress/Egress
- (For Identification Only)

Figure:
4

Scale:
Not to Scale

Date:
Feb 2021



參考編號
REFERENCE No.

A/NE-TKLN/37

繪圖 DRAWING A-1

(來源 : 附件 Ic)
(Source : Appendix Ic)

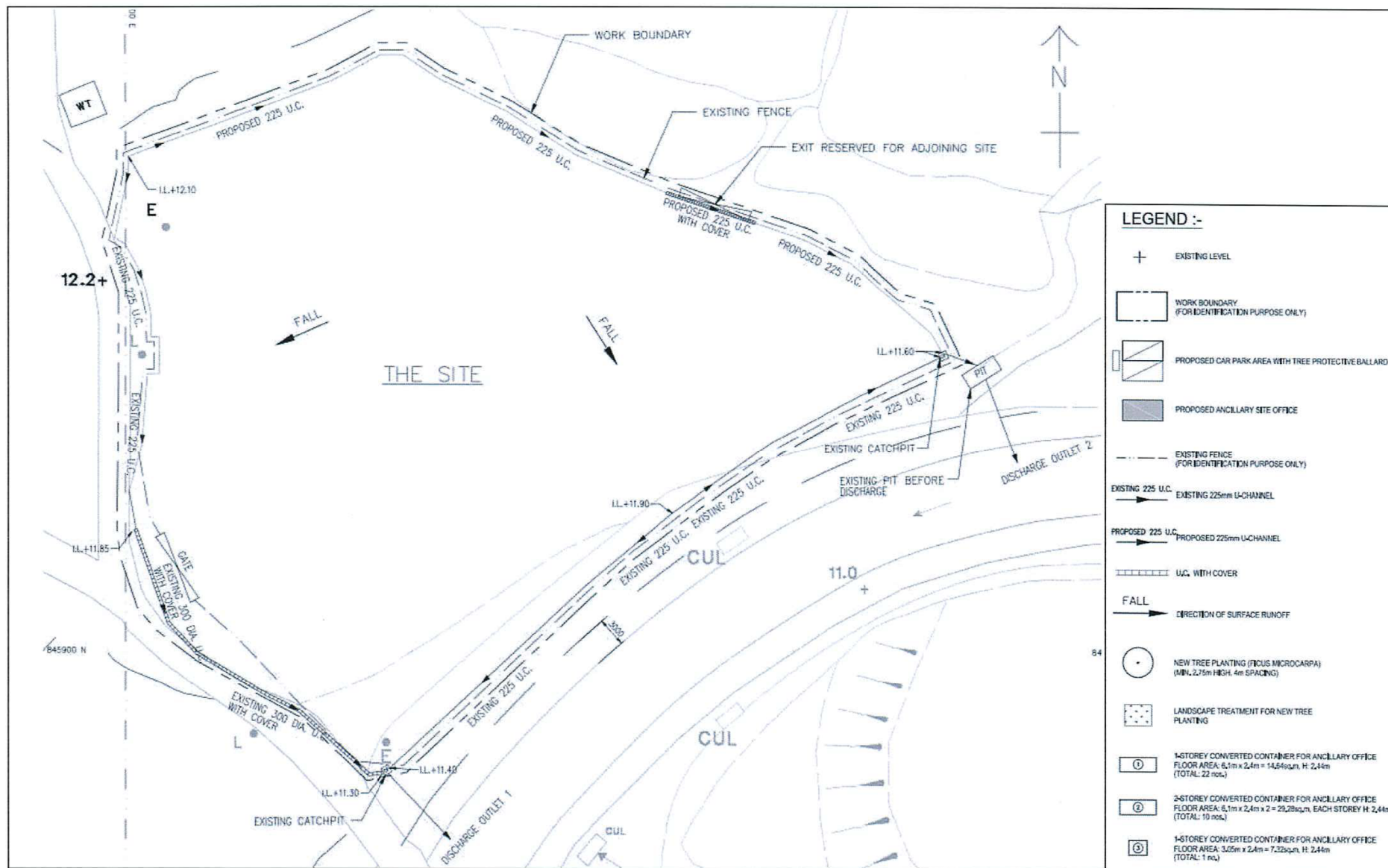

LEGEND :-

- + EXISTING LEVEL
- WORK BOUNDARY (FOR IDENTIFICATION PURPOSE ONLY)
- PROPOSED CAR PARK AREA WITH TREE PROTECTIVE BALLARD
- PROPOSED ANCILLARY SITE OFFICE
- EXISTING FENCE (FOR IDENTIFICATION PURPOSE ONLY)
- EXISTING 225 U.C. EXISTING 225mm U-CCHANNEL
- PROPOSED 225 U.C. PROPOSED 225mm U-CCHANNEL
- U.C. WITH COVER
- FALL DIRECTION OF SURFACE RUNOFF
- NEW TREE PLANTING (FICUS MICROCARPA) (MIN. 2.75m HIGH, 4m SPACING)
- LANDSCAPE TREATMENT FOR NEW TREE PLANTING
- 1-STOREY CONVERTED CONTAINER FOR ANCILLARY OFFICE FLOOR AREA: 6.1m x 2.4m = 14.64sqm, H: 2.44m (TOTAL: 22 nos.)
- 2-STOREY CONVERTED CONTAINER FOR ANCILLARY OFFICE FLOOR AREA: 6.1m x 2.4m x 2 = 29.28sqm, EACH STOREY H: 2.44m (TOTAL: 10 nos.)
- 1-STOREY CONVERTED CONTAINER FOR ANCILLARY OFFICE FLOOR AREA: 3.05m x 2.4m = 7.32sqm, H: 2.44m (TOTAL: 1 no.)

Project:

Section 16 Planning Application for Proposed Temporary Public Vehicle Park (Excluding Container Vehicle) for a Period of Three Years at Lots 388 S.A, 388 S.B, 388 RP (Part) and 390 RP (Part) in D.D.78 and Adjoining Government Land, Tsung Yuen Ha, Ta Kwu Ling North, New Territories

Title:

Approved Drainage Proposal under Previous Application No. A/NE-TKLN/8

Figure: 6

Scale: N/A

Date: Sept 2020

Ref.: ADCL/PLG-10208-R001/F006



AIKON DEVELOPMENT CONSULTANCY LTD.

參考編號

REFERENCE No. A/NE-TKLN/37

繪圖 DRAWING A-3

(來源 : 附件 1a)
(Source : Appendix 1a)



要覽圖 KEY PLAN

SCALE 1 : 50 000 比例尺

深圳市
SHENZHEN SHI

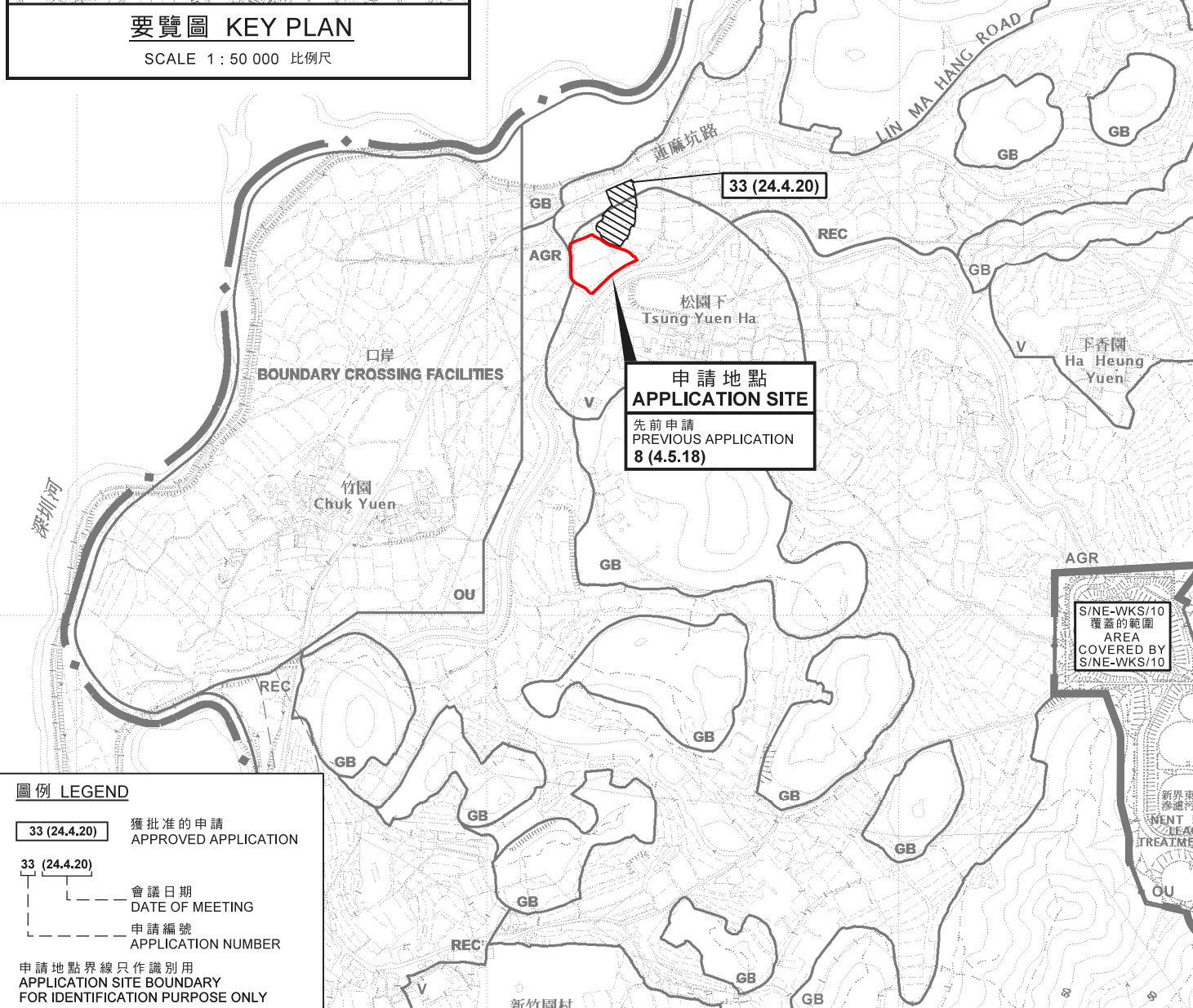

圖例 LEGEND

33 (24.4.20) 獲批准的申請
APPROVED APPLICATION

33 (24.4.20) 會議日期
DATE OF MEETING
申請編號
APPLICATION NUMBER

申請地點界線只作識別用
APPLICATION SITE BOUNDARY
FOR IDENTIFICATION PURPOSE ONLY

位置圖 LOCATION PLAN

擬議臨時公眾停車場（貨櫃車除外）（為期3年）
新界打鼓嶺北松園下丈量約份第78約地段第388號A分段、
第388號B分段、第388號餘段（部分）及第390號餘段（部分）和毗連政府土地
PROPOSED TEMPORARY PUBLIC VEHICLE PARK
(EXCLUDING CONTAINER VEHICLE) FOR A PERIOD OF 3 YEARS
LOTS 388 S.A. 388 S.B. 388 RP (PART) AND 390 RP (PART) IN D.D. 78 AND
ADJOINING GOVERNMENT LAND, TSUNG YUEN HA, TA KWU LING NORTH, N.T.

SCALE 1 : 7 500 比例尺
米 100 0 100 200 300 米
METRES

規劃署
PLANNING
DEPARTMENT



參考編號
REFERENCE No.
A/NE-TKLN/37

圖 PLAN
A-1

本摘要圖於2021年5月18日擬備，
所根據的資料為於2016年5月3日核准的
分區計劃大綱圖編號S/NE-TKLN/2及
2009年10月6日核准的
分區計劃大綱圖編號S/NE-WKS/10
EXTRACT PLAN PREPARED ON 18.5.2021
BASED ON OUTLINE ZONING PLAN
No. S/NE-TKLN/2 APPROVED ON 3.5.2016
AND OUTLINE ZONING PLAN
No. S/NE-WKS/10 APPROVED ON 6.10.2009



圖例 LEGEND



申請地點（界線只作識別用）
APPLICATION SITE
(BOUNDARY FOR IDENTIFICATION
PURPOSE ONLY)

航攝照片 AERIAL PHOTO

擬議臨時公眾停車場（貨櫃車除外）（為期3年）
新界打鼓嶺北松園下丈量約份第78約地段第388號A分段、
第388號B分段、第388號餘段（部分）及第390號餘段（部分）和毗連政府土地
PROPOSED TEMPORARY PUBLIC VEHICLE PARK
(EXCLUDING CONTAINER VEHICLE) FOR A PERIOD OF 3 YEARS
LOTS 388 S.A, 388 S.B, 388 RP (PART) AND 390 RP (PART) IN D.D. 78 AND
ADJOINING GOVERNMENT LAND, TSUNG YUEN HA, TA KWU LING NORTH, N.T.

規劃署
PLANNING
DEPARTMENT



參考編號
REFERENCE No.
A/NE-TKLN/37

圖 PLAN
A-3

本摘要圖於2021年5月18日擬備，
所根據的資料為地政總署
於2019年11月4日拍得的航攝照片
編號E074494C_R
EXTRACT PLAN PREPARED ON 18.5.2021
BASED ON AERIAL PHOTO No. E074494C_R
TAKEN ON 4.11.2019 BY
LANDS DEPARTMENT



申請地點界線只作識別用

APPLICATION SITE BOUNDARY FOR IDENTIFICATION PURPOSE ONLY

實地照片 SITE PHOTO

本圖於2021年5月18日擬備，所根據的資料為攝於2021年5月4日的實地照片
PLAN PREPARED ON 18.5.2021 BASED ON SITE PHOTO TAKEN ON 4.5.2021

擬議臨時公眾停車場（貨櫃車除外）（為期3年）
新界打鼓嶺北松園下丈量約份第78約地段第388號A分段、
第388號B分段、第388號餘段（部分）及第390號餘段（部分）和毗連政府土地
PROPOSED TEMPORARY PUBLIC VEHICLE PARK
(EXCLUDING CONTAINER VEHICLE) FOR A PERIOD OF 3 YEARS
LOTS 388 S.A, 388 S.B, 388 RP (PART) AND 390 RP (PART) IN D.D. 78 AND
ADJOINING GOVERNMENT LAND, TSUNG YUEN HA, TA KWU LING NORTH, N.T.

規劃署
PLANNING
DEPARTMENT



參考編號
REFERENCE No.
A/NE-TKLN/37

圖 PLAN
A-4a



實地照片 SITE PHOTOS

本圖於2021年5月6日擬備，所根據的資料為攝於2021年4月26日的實地照片
PLAN PREPARED ON 6.5.2021 BASED ON SITE PHOTOS TAKEN ON 26.4.2021

擬議臨時公眾停車場（貨櫃車除外）（為期3年）
新界打鼓嶺北松園下丈量約份第78約地段第388號A分段、
第388號B分段、第388號餘段（部分）及第390號餘段（部分）和毗連政府土地
PROPOSED TEMPORARY PUBLIC VEHICLE PARK
(EXCLUDING CONTAINER VEHICLE) FOR A PERIOD OF 3 YEARS
LOTS 388 S.A, 388 S.B, 388 RP (PART) AND 390 RP (PART) IN D.D. 78 AND
ADJOINING GOVERNMENT LAND, TSUNG YUEN HA, TA KWU LING NORTH, N.T.

規劃署
PLANNING
DEPARTMENT



參考編號
REFERENCE No.
A/NE-TKLN/37

圖 PLAN
A-4b