



## DEVELOPMENT PARAMETERS

APPLICATION SITE AREA	: 11 m <sup>2</sup>	(ABOUT)
COVERED AREA	: 7.5 m <sup>2</sup>	(ABOUT)
UNCOVERED AREA	: 3.5 m <sup>2</sup>	(ABOUT)
PLOT RATIO	: 0.68	(ABOUT)
SITE COVERAGE	: 68 %	(ABOUT)
NO. OF STRUCTURE	: 1	
DOMESTIC GFA	: NOT APPLICABLE	
NON-DOMESTIC GFA	: 7.5 m <sup>2</sup>	(ABOUT)
TOTAL GFA	: 7.5 m <sup>2</sup>	(ABOUT)
BUILDING HEIGHT	: 2.8 m	(ABOUT)
NO. OF STOREY	: 1	

## DETAILS OF FILLING OF LAND

FILLING OF LAND AREA	: 11 m <sup>2</sup>	(ABOUT)
FILLING RATIO	: 100%	
MATERIAL OF FILLING	: CONCRETE	
DEPTH OF FILLING	: NOT MORE THAN 0.2 m	
PURPOSE OF FILLING	: SITE FORMATION OF STRUCTURE	
SITE LEVEL AFTER FILLING	: +12.0 mPD (ABOUT)	

THE SITE HAS BEEN FILLED WITH CONCRETE, NO FURTHER FILLING WILL BE CARRIED OUT DURING THE PLANNING APPROVAL PERIOD.

STRUCTURE	USE	COVERED AREA	GFA	BUILDING HEIGHT
B1	SECURITY GUARD ROOM LAVATORY AND PORCH	7.5 m <sup>2</sup> (ABOUT)	7.5 m <sup>2</sup> (ABOUT)	2.8 m (ABOUT) (1-STOREY)
TOTAL		7.5 m <sup>2</sup> (ABOUT)	7.5 m <sup>2</sup> (ABOUT)	

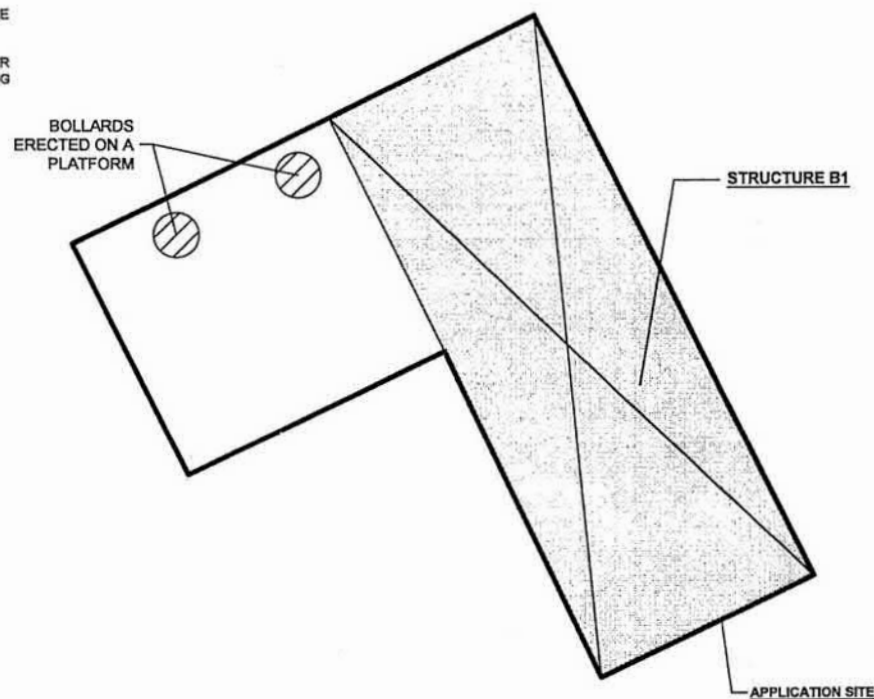
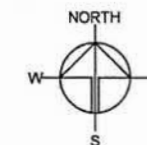

## LEGEND

	APPLICATION SITE
	STRUCTURE
	BOLLARD

NO PARKING NOR LOADING / UNLOADING SPACE IS PROVIDED AT THE APPLICATION SITE

PLANNING CONSULTANT



PROJECT

PROPOSED TEMPORARY  
SECURITY GUARD ROOM FOR A  
PERIOD OF 3 YEARS AND  
ASSOCIATED FILLING OF LAND

SITE LOCATION

LOT 435 S.D. ss.1 S.A. IN D.D. 244  
(PART) AND ADJOINING  
GOVERNMENT LAND, HO  
CHUNG, SAI KUNG, NEW  
TERRITORIES

SCALE

1:1000

DRAWN BY	DATE
MN	24.7.2023
REVIEWED BY	DATE
APPROVED BY	DATE

DWG. TITLE  
LAYOUT PLAN

DWG. NO.	VER.
PLAN 4	001

(資料來源：申請人於 08.08.2023 呈交的資料)  
(Source : Applicant's Submission of 08.08.2023)

參考編號  
REFERENCE No.  
A/SK-HC/345

繪圖  
DRAWING  
A-2



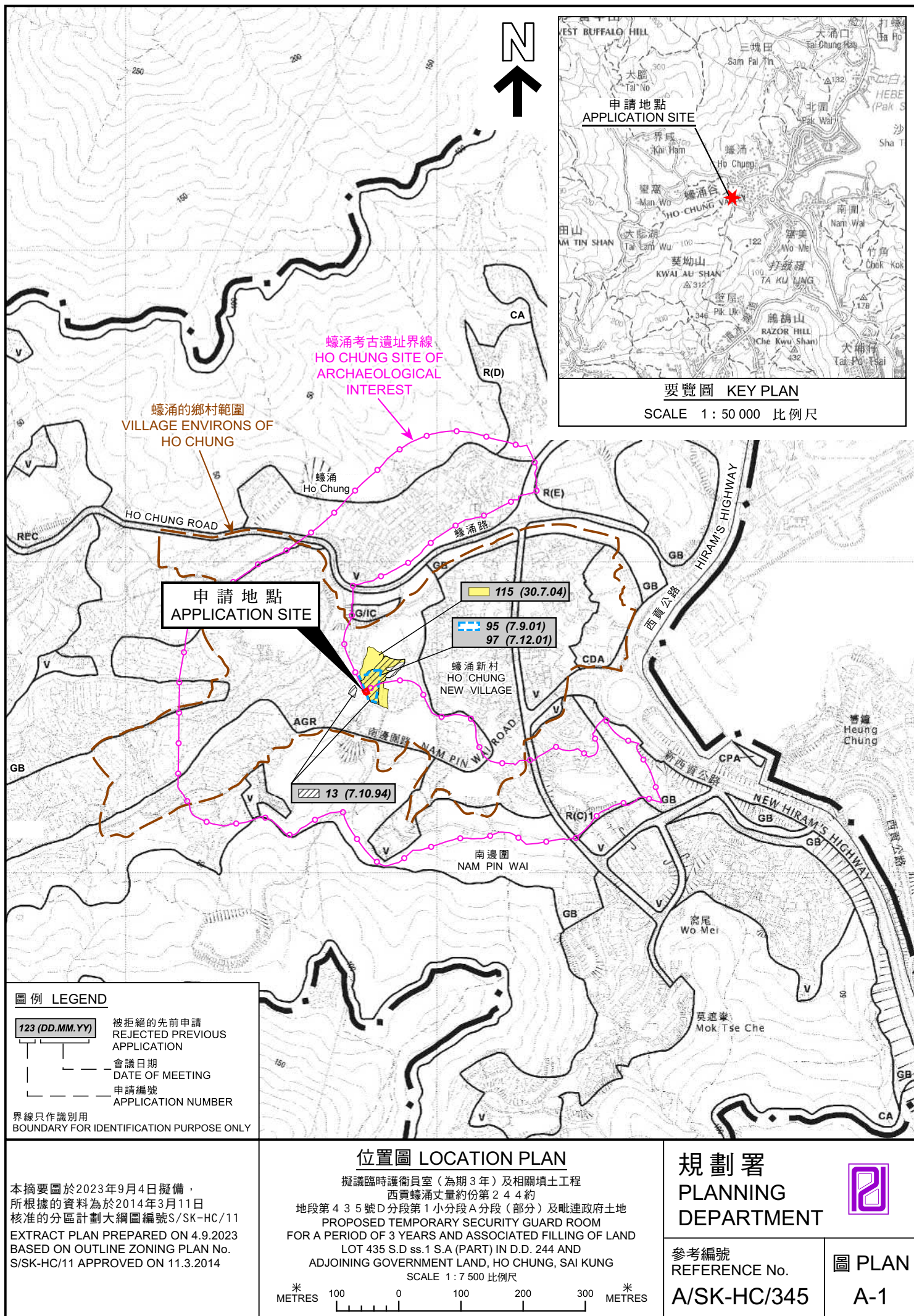



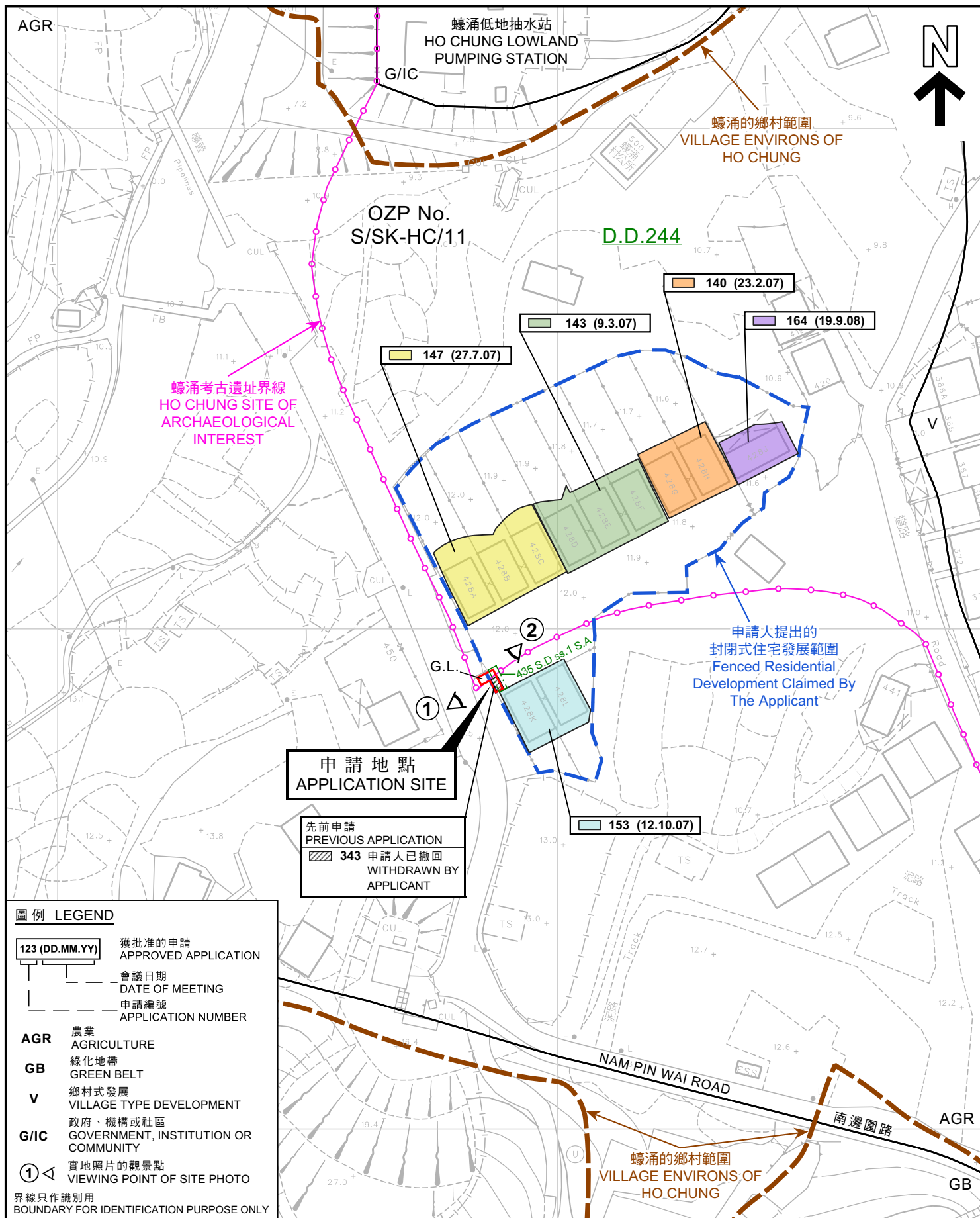

#### 圖例 LEGEND

123 (DD.MM.YY)

獲批准的申請  
APPROVED APPLICATION

會議日期  
DATE OF MEETING

申請編號  
APPLICATION NUMBER

AGR 農業  
AGRICULTURE

GB 綠化地帶  
GREEN BELT

V 鄉村式發展  
VILLAGE TYPE DEVELOPMENT

G/IC 政府、機構或社區  
GOVERNMENT, INSTITUTION OR COMMUNITY

① 實地照片的觀景點  
VIEWING POINT OF SITE PHOTO

界線只作識別用  
BOUNDARY FOR IDENTIFICATION PURPOSE ONLY

#### 平面圖 SITE PLAN

擬議臨時護衛員室（為期3年）及相關填土工程  
西貢蠔涌丈量約份第244約  
地段第435號D分段第1小分段A分段（部分）及毗連政府土地  
PROPOSED TEMPORARY SECURITY GUARD ROOM  
FOR A PERIOD OF 3 YEARS AND ASSOCIATED FILLING OF LAND  
LOT 435 S.D ss.1 S.A (PART) IN D.D. 244 AND  
ADJOINING GOVERNMENT LAND, HO CHUNG, SAI KUNG

SCALE 1:1 000 比例尺

米 20 0 20 40 米  
METRES

規劃署  
PLANNING  
DEPARTMENT



參考編號  
REFERENCE No.  
A/SK-HC/345

圖 PLAN  
A-2

本摘要圖於2023年9月13日擬備，  
所根據的資料為測量圖編號  
11-NE-4B  
EXTRACT PLAN PREPARED ON 13.9.2023  
BASED ON SURVEY SHEET No.  
11-NE-4B



蠔涌低地抽水站  
HO CHUNG LOWLAND  
PUMPING STATION



蠔涌新村  
HO CHUNG  
NEW VILLAGE

申請地點  
APPLICATION SITE

NAM PIN WAI ROAD

南邊圍路

界線只作識別用  
BOUNDARY FOR IDENTIFICATION PURPOSE ONLY

### 航攝照片 AERIAL PHOTO

本摘要圖於2023年9月4日擬備，  
所根據的資料為地政總署於2022年3月9日  
拍得的航攝照片編號E153923C  
EXTRACT PLAN PREPARED ON 4.9.2023  
BASED ON AERIAL PHOTO No.E153923C  
TAKEN ON 9.3.2022  
BY LANDS DEPARTMENT

擬議臨時護衛員室（為期3年）及相關填土工程  
西貢蠔涌丈量約份第244約  
地段第435號D分段第1小分段A分段（部分）及毗連政府土地  
PROPOSED TEMPORARY SECURITY GUARD ROOM  
FOR A PERIOD OF 3 YEARS AND ASSOCIATED FILLING OF LAND  
LOT 435 S.D ss.1 S.A (PART) IN D.D. 244 AND  
ADJOINING GOVERNMENT LAND, HO CHUNG, SAI KUNG

規劃署  
PLANNING  
DEPARTMENT



參考編號  
REFERENCE No.  
A/SK-HC/345

圖 PLAN  
A-3



1

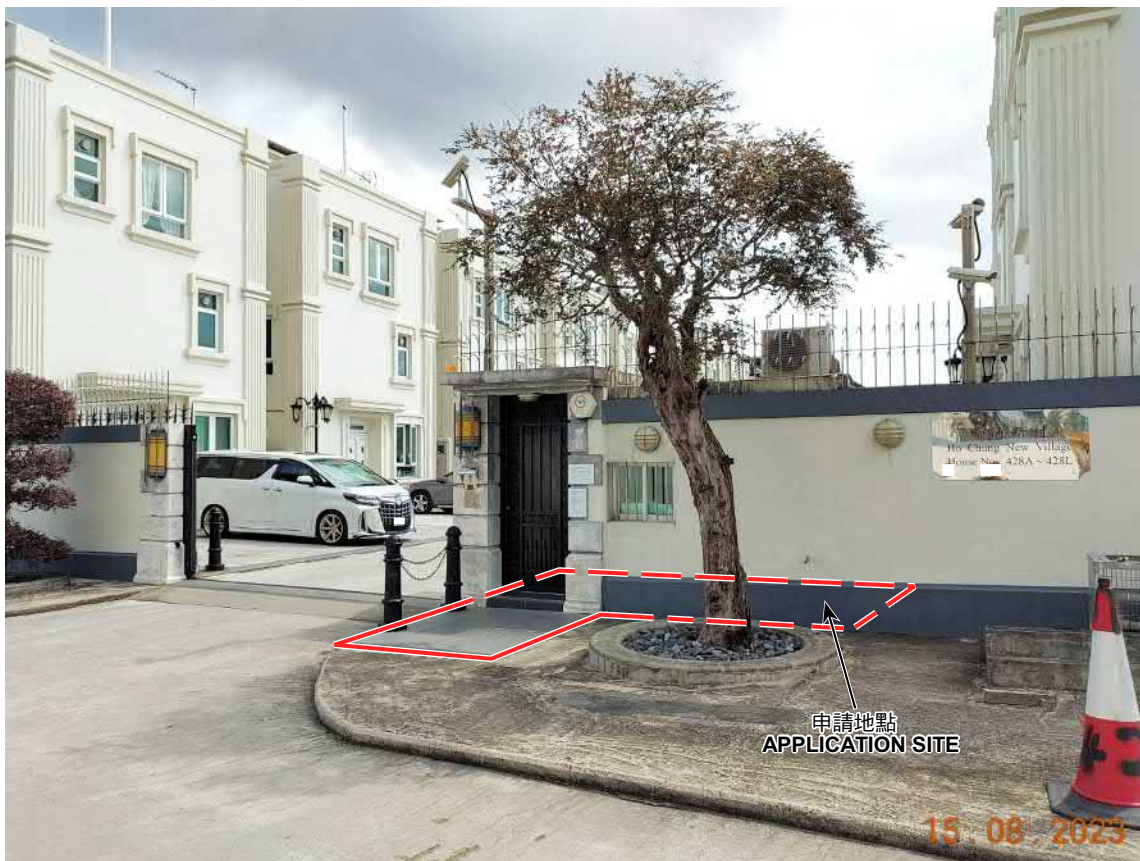

申請地點  
APPLICATION SITE

2



申請地點  
APPLICATION SITE

界線只作識別用  
BOUNDARY FOR IDENTIFICATION PURPOSE ONLY

### 實地照片 SITE PHOTOS

擬議臨時護衛員室（為期3年）及相關填土工程  
西貢蠔涌丈量約份第244約  
地段第435號D分段第1小分段A分段（部分）及毗連政府土地  
PROPOSED TEMPORARY SECURITY GUARD ROOM  
FOR A PERIOD OF 3 YEARS AND ASSOCIATED FILLING OF LAND  
LOT 435 S.D ss.1 S.A (PART) IN D.D. 244 AND  
ADJOINING GOVERNMENT LAND, HO CHUNG, SAI KUNG

規劃署  
PLANNING  
DEPARTMENT



參考編號  
REFERENCE No.  
A/SK-HC/345

圖 PLAN  
A-4

本圖於2023年9月5日擬備，所根據的  
資料為攝於2023年8月15日的實地照片  
PLAN PREPARED ON 5.9.2023  
BASED ON SITE PHOTOS  
TAKEN ON 15.8.2023