

Form No. S16-I
表格第 S16-I 號

This document is received on 10 AUG 2021
The Town Planning Board will formally acknowledge
the date of receipt of the application only upon receipt
of all the required information and documents.

APPLICATION FOR PERMISSION UNDER SECTION 16 OF THE TOWN PLANNING ORDINANCE (CAP.131)

根據《城市規劃條例》(第131章)
第16條遞交的許可申請

Applicable to proposals not involving or not only involving:
適用於建議不涉及或不祇涉及:

- (i) **Construction of “New Territories Exempted House(s)”;**
興建「新界豁免管制屋宇」;
- (ii) **Temporary use/development of land and/or building not exceeding 3 years in rural areas; and**
位於鄉郊地區土地上及/或建築物內進行為期不超過三年的臨時用途/發展;及
- (iii) **Renewal of permission for temporary use or development in rural areas**
位於鄉郊地區的臨時用途或發展的許可續期

Applicant who would like to publish the notice of application in local newspapers to meet one of the Town Planning Board's requirements of taking reasonable steps to obtain consent of or give notification to the current land owner, please refer to the following link regarding publishing the notice in the designated newspapers:
https://www.info.gov.hk/tpb/en/plan_application/apply.html

申請人如欲在本地報章刊登申請通知，以採取城市規劃委員會就取得現行土地擁有人的同意或通知現行土地擁有人所指定的其中一項合理步驟，請瀏覽以下網址有關在指定的報章刊登通知：
https://www.info.gov.hk/tpb/tc/plan_application/apply.html

General Note and Annotation for the Form **填寫表格的一般指引及註解**

“Current land owner” means any person whose name is registered in the Land Registry as that of an owner of the land to which the application relates, as at 6 weeks before the application is made
「現行土地擁有人」指在提出申請前六星期，其姓名或名稱已在土地註冊處註冊為該申請所關乎的土地的擁有人的人

& Please attach documentary proof 請夾附證明文件

^ Please insert number where appropriate 請在適當地方註明編號

Please fill “NA” for inapplicable item 請在不適用的項目填寫「不適用」

Please use separate sheets if the space provided is insufficient 如所提供的空間不足，請另頁說明

Please insert a 「✓」 at the appropriate box 請在適當的方格內上加上「✓」號

For Official Use Only 請勿填寫此欄	Application No. 申請編號	A/ST/1001
	Date Received 收到日期	10 AUG 2021

- The completed form and supporting documents (if any) should be sent to the Secretary, Town Planning Board (the Board), 15/F, North Point Government Offices, 333 Java Road, North Point, Hong Kong.
申請人須把填妥的申請表格及其他支持申請的文件 (倘有), 送交香港北角渣華道 333 號北角政府合署 15 樓城市規劃委員會(下稱「委員會」)秘書收。
- Please read the "Guidance Notes" carefully before you fill in this form. The document can be downloaded from the Board's website at <http://www.info.gov.hk/tpb/>. It can also be obtained from the Secretariat of the Board at 15/F, North Point Government Offices, 333 Java Road, North Point, Hong Kong (Tel: 2231 4810 or 2231 4835), and the Planning Enquiry Counters of the Planning Department (Hotline: 2231 5000) (17/F, North Point Government Offices, 333 Java Road, North Point, Hong Kong and 14/F, Sha Tin Government Offices, 1 Sheung Wo Che Road, Sha Tin, New Territories). 請先細閱《申請須知》的資料單張, 然後填寫此表格。該份文件可從委員會的網頁下載 (網址: <http://www.info.gov.hk/tpb/>), 亦可向委員會秘書處 (香港北角渣華道 333 號北角政府合署 15 樓 - 電話: 2231 4810 或 2231 4835) 及規劃署的規劃資料查詢處(熱線: 2231 5000) (香港北角渣華道 333 號北角政府合署 17 樓及新界沙田上禾輦路 1 號沙田政府合署 14 樓) 索取。
- This form can be downloaded from the Board's website, and obtained from the Secretariat of the Board and the Planning Enquiry Counters of the Planning Department. The form should be typed or completed in block letters. The processing of the application may be refused if the required information or the required copies are incomplete.
此表格可從委員會的網頁下載, 亦可向委員會秘書處及規劃署的規劃資料查詢處索取。申請人須以打印方式或以正楷填寫表格。如果申請人所提交的資料或文件副本不齊全, 委員會可拒絕處理有關申請。

1. Name of Applicant 申請人姓名/名稱

(☐ Mr. 先生 / ☐ Mrs. 夫人 / ☐ Miss 小姐 / ☐ Ms. 女士 ☒ Company 公司 / ☐ Organisation 機構)

HK JEBN ASSETS MANAGEMENT LIMITED

2. Name of Authorised Agent (if applicable) 獲授權代理人姓名/名稱 (如適用)

(☐ Mr. 先生 / ☐ Mrs. 夫人 / ☐ Miss 小姐 / ☐ Ms. 女士 ☒ Company 公司 / ☐ Organisation 機構)

RHL SURVEYORS LIMITED

3. Application Site 申請地點

(a) Full address / location / demarcation district and lot number (if applicable) 詳細地址/地點/丈量約份及地段號碼 (如適用)	PORTION OF GROUND FLOOR, HK JEBN GROUP CENTER, NOS.13-15 SHING WAN ROAD, TAI WAI, NEW TERRITORIES
(b) Site area and/or gross floor area involved 涉及的地盤面積及/或總樓面面積	<input type="checkbox"/> Site area 地盤面積sq.m 平方米 <input type="checkbox"/> About 約 <input checked="" type="checkbox"/> Gross floor area 總樓面面積448.....sq.m 平方米 <input checked="" type="checkbox"/> About 約
(c) Area of Government land included (if any) 所包括的政府土地面積 (倘有)	-- NOT APPLICABLE -- sq.m 平方米 <input type="checkbox"/> About 約

(d) Name and number of the related statutory plan(s) 有關法定圖則的名稱及編號	APPROVED SHA TIN OZP NO.S/ST/34
(e) Land use zone(s) involved 涉及的土地用途地帶	INDUSTRIAL.
(f) Current use(s) 現時用途	SHOP AND SERVICES. (If there are any Government, institution or community facilities, please illustrate on plan and specify the use and gross floor area) (如有任何政府、機構或社區設施，請在圖則上顯示，並註明用途及總樓面面積)

4. “Current Land Owner” of Application Site 申請地點的「現行土地擁有人」

The applicant 申請人 –

- ☒ is the sole “current land owner”^{#&} (please proceed to Part 6 and attach documentary proof of ownership).
是唯一的「現行土地擁有人」^{#&} (請繼續填寫第 6 部分，並夾附業權證明文件)。
- ☐ is one of the “current land owners”^{#&} (please attach documentary proof of ownership).
是其中一名「現行土地擁有人」^{#&} (請夾附業權證明文件)。
- ☐ is not a “current land owner”[#].
並不是「現行土地擁有人」[#]。
- ☐ The application site is entirely on Government land (please proceed to Part 6).
申請地點完全位於政府土地上 (請繼續填寫第 6 部分)。

5. Statement on Owner's Consent/Notification

就土地擁有人的同意/通知土地擁有人的陳述

- (a) According to the record(s) of the Land Registry as at (DD/MM/YYYY), this application involves a total of “current land owner(s)”[#].
根據土地註冊處截至 年 月 日的記錄，這宗申請共牽涉 名「現行土地擁有人」[#]。

(b) The applicant 申請人 –

- ☐ has obtained consent(s) of “current land owner(s)”[#].
已取得 名「現行土地擁有人」[#]的同意。

Details of consent of “current land owner(s)” [#] obtained 取得「現行土地擁有人」 [#] 同意的詳情		
No. of ‘Current Land Owner(s)’ 「現行土地擁有人」數目	Lot number/address of premises as shown in the record of the Land Registry where consent(s) has/have been obtained 根據土地註冊處記錄已獲得同意的地段號碼/處所地址	Date of consent obtained (DD/MM/YYYY) 取得同意的日期 (日/月/年)

(Please use separate sheets if the space of any box above is insufficient. 如上列任何方格的空間不足，請另頁說明)

- ☐ has notified “current land owner(s)”[#]
已通知 名「現行土地擁有人」[#]。

Details of the “current land owner(s)” [#] notified 已獲通知「現行土地擁有人」 [#] 的詳細資料		
No. of ‘Current Land Owner(s)’ 「現行土地擁有人」數目	Lot number/address of premises as shown in the record of the Land Registry where notification(s) has/have been given 根據土地註冊處記錄已發出通知的地段號碼／處所地址	Date of notification given (DD/MM/YYYY) 通知日期(日/月/年)

(Please use separate sheets if the space of any box above is insufficient. 如上列任何方格的空間不足，請另頁說明)

- ☐ has taken reasonable steps to obtain consent of or give notification to owner(s):
已採取合理步驟以取得土地擁有人的同意或向該人發給通知。詳情如下：

Reasonable Steps to Obtain Consent of Owner(s) 取得土地擁有人的同意所採取的合理步驟

- ☐ sent request for consent to the “current land owner(s)” on _____ (DD/MM/YYYY)^{#&}
於_____ (日/月/年)向每一名「現行土地擁有人」[#]郵遞要求同意書[&]

Reasonable Steps to Give Notification to Owner(s) 向土地擁有人發出通知所採取的合理步驟

- ☐ published notices in local newspapers on _____ (DD/MM/YYYY)[&]
於_____ (日/月/年)在指定報章就申請刊登一次通知[&]
- ☐ posted notice in a prominent position on or near application site/premises on _____ (DD/MM/YYYY)[&]
於_____ (日/月/年)在申請地點／申請處所或附近的顯明位置貼出關於該申請的通知[&]
- ☐ sent notice to relevant owners’ corporation(s)/owners’ committee(s)/mutual aid committee(s)/management office(s) or rural committee on _____ (DD/MM/YYYY)[&]
於_____ (日/月/年)把通知寄往相關的業主立案法團／業主委員會／互助委員會或管理處，或有關的鄉事委員會[&]

Others 其他

- ☐ others (please specify)
其他（請指明）

Note: May insert more than one 「✓」.

Information should be provided on the basis of each and every lot (if applicable) and premises (if any) in respect of the application.

註：可在多於一個方格內加上「✓」號

申請人須就申請涉及的每一地段（倘適用）及處所（倘有）分別提供資料

6. Type(s) of Application 申請類別

- ☒ Type (i) Change of use within existing building or part thereof
第(i)類 更改現有建築物或其部分內的用途
- ☐ Type (ii) Diversion of stream / excavation of land / filling of land / filling of pond as required under Notes of Statutory Plan(s)
第(ii)類 根據法定圖則《註釋》內所要求的河道改道／挖土／填土／填塘工程
- ☐ Type (iii) Public utility installation / Utility installation for private project
第(iii)類 公用事業設施裝置/私人發展計劃的公用設施裝置
- ☐ Type (iv) Minor relaxation of stated development restriction(s) as provided under Notes of Statutory Plan(s)
第(iv)類 略為放寬於法定圖則《註釋》內列明的發展限制
- ☐ Type (v) Use / development other than (i) to (iii) above
第(v)類 上述的(i)至(iii)項以外的用途／發展

Note 1: May insert more than one 「✓」.

註 1：可在多於一個方格內加上「✓」號

Note 2: For Development involving columbarium use, please complete the table in the Appendix.

註 2：如發展涉及靈灰安置所用途，請填妥於附件的表格。

(i) For Type (i) application 供第(i)類申請

(a) Total floor area involved 涉及的總樓面面積	ABOUT 448 sq.m 平方米		
(b) Proposed use(s)/development 擬議用途/發展	SHOP AND SERVICES (RENEWAL OF PERMISSION FOR TEMPORARY USE OF 3 YEARS, PREVIOUS NO.: A/ST/962.) (If there are any Government, institution or community facilities, please illustrate on plan and specify the use and gross floor area) (如有任何政府、機構或社區設施，請在圖則上顯示，並註明用途及總樓面面積)		
(c) Number of storeys involved 涉及層數		Number of units involved 涉及單位數目	1
(d) Proposed floor area 擬議樓面面積	Domestic part 住用部分 sq.m 平方米 <input type="checkbox"/> About 約		
	Non-domestic part 非住用部分 448 sq.m 平方米 <input checked="" type="checkbox"/> About 約		
	Total 總計 448 sq.m 平方米 <input checked="" type="checkbox"/> About 約		
(e) Proposed uses of different floors (if applicable) 不同樓層的擬議用途(如適用) (Please use separate sheets if the space provided is insufficient) (如所提供的空間不足，請另頁說明)	Floor(s) 樓層	Current use(s) 現時用途	Proposed use(s) 擬議用途
	-- NOT APPLICABLE --	-- NOT APPLICABLE --	-- NOT APPLICABLE --

(ii) For Type (ii) application 供第(ii)類申請

(a) Operation involved 涉及工程	<input type="checkbox"/> Diversion of stream 河道改道 <input type="checkbox"/> Filling of pond 填塘 Area of filling 填塘面積 sq.m 平方米 <input type="checkbox"/> About 約 Depth of filling 填塘深度 m 米 <input type="checkbox"/> About 約 <input type="checkbox"/> Filling of land 填土 Area of filling 填土面積 sq.m 平方米 <input type="checkbox"/> About 約 Depth of filling 填土厚度 m 米 <input type="checkbox"/> About 約 <input type="checkbox"/> Excavation of land 挖土 Area of excavation 挖土面積 sq.m 平方米 <input type="checkbox"/> About 約 Depth of excavation 挖土深度 m 米 <input type="checkbox"/> About 約 (Please indicate on site plan the boundary of concerned land/pond(s), and particulars of stream diversion, the extent of filling of land/pond(s) and/or excavation of land) (請用圖則顯示有關土地／池塘界線，以及河道改道、填塘、填土及／或挖土的細節及／或範圍)
	(b) Intended use/development 有意進行的用途／發展

(iii) For Type (iii) application 供第(iii)類申請

(a) Nature and scale 性質及規模	<input type="checkbox"/> Public utility installation 公用事業設施裝置 <input type="checkbox"/> Utility installation for private project 私人發展計劃的公用設施裝置 Please specify the type and number of utility to be provided as well as the dimensions of each building/structure, where appropriate 請註明有關裝置的性質及數量，包括每座建築物／構築物(倘有)的長度、高度和闊度												
	<table border="1"> <thead> <tr> <th data-bbox="491 1339 796 1469">Name/type of installation 裝置名稱／種類</th> <th data-bbox="798 1339 967 1469">Number of provision 數量</th> <th data-bbox="968 1339 1481 1469">Dimension of each installation /building/structure (m) (LxWxH) 每個裝置／建築物／構築物的尺寸 (米) (長 x 闊 x 高)</th> </tr> </thead> <tbody> <tr> <td data-bbox="491 1469 796 1599"></td> <td data-bbox="798 1469 967 1599"></td> <td data-bbox="968 1469 1481 1599"></td> </tr> <tr> <td data-bbox="491 1599 796 1729"></td> <td data-bbox="798 1599 967 1729"></td> <td data-bbox="968 1599 1481 1729"></td> </tr> <tr> <td data-bbox="491 1729 796 1859"></td> <td data-bbox="798 1729 967 1859"></td> <td data-bbox="968 1729 1481 1859"></td> </tr> </tbody> </table>	Name/type of installation 裝置名稱／種類	Number of provision 數量	Dimension of each installation /building/structure (m) (LxWxH) 每個裝置／建築物／構築物的尺寸 (米) (長 x 闊 x 高)									
	Name/type of installation 裝置名稱／種類	Number of provision 數量	Dimension of each installation /building/structure (m) (LxWxH) 每個裝置／建築物／構築物的尺寸 (米) (長 x 闊 x 高)										
(Please illustrate on plan the layout of the installation 請用圖則顯示裝置的布局)													

(iv) For Type (iv) application 供第(iv)類申請

(a) Please specify the proposed minor relaxation of stated development restriction(s) and **also fill in the proposed use/development and development particulars in part (v) below** –

請列明擬議略為放寬的發展限制並填妥於第(v)部分的擬議用途/發展及發展細節 –

- ☐ Plot ratio restriction 地積比率限制 From 由 to 至
- ☐ Gross floor area restriction 總樓面面積限制 From 由sq. m 平方米 to 至sq. m 平方米
- ☐ Site coverage restriction 上蓋面積限制 From 由% to 至 %
- ☐ Building height restriction 建築物高度限制
From 由m 米 to 至 m 米
From 由 mPD 米 (主水平基準上) to 至mPD 米 (主水平基準上)
From 由 storeys 層 to 至 storeys 層
- ☐ Non-building area restriction 非建築用地限制 From 由m to 至 m
- ☐ Others (please specify) 其他 (請註明)

(v) For Type (v) application 供第(v)類申請

(a) Proposed use(s)/development
擬議用途/發展

(Please illustrate the details of the proposal on a layout plan 請用平面圖說明建議詳情)

(b) Development Schedule 發展細節表

- Proposed gross floor area (GFA) 擬議總樓面面積 sq.m 平方米 ☐ About 約
- Proposed plot ratio 擬議地積比率 ☐ About 約
- Proposed site coverage 擬議上蓋面積 % ☐ About 約
- Proposed no. of blocks 擬議座數
- Proposed no. of storeys of each block 每座建築物的擬議層數 storeys 層
☐ include 包括.....storeys of basements 層地庫
☐ exclude 不包括.....storeys of basements 層地庫
- Proposed building height of each block 每座建築物的擬議高度 mPD 米(主水平基準上) ☐ About 約
..... m 米 ☐ About 約

☐ Domestic part 住用部分

GFA 總樓面面積 sq. m 平方米 ☐ About 約
 number of Units 單位數目
 average unit size 單位平均面積sq. m 平方米 ☐ About 約
 estimated number of residents 估計住客數目

☐ Non-domestic part 非住用部分

GFA 總樓面面積

☐ eating place 食肆 sq. m 平方米 ☐ About 約
☐ hotel 酒店 sq. m 平方米 ☐ About 約

(please specify the number of rooms

請註明房間數目)

☐ office 辦公室 sq. m 平方米 ☐ About 約

☐ shop and services 商店及服務行業 sq. m 平方米 ☐ About 約

☐ Government, institution or community facilities (please specify the use(s) and concerned land
 政府、機構或社區設施 area(s)/GFA(s) 請註明用途及有關的地面面積／總
 樓面面積)

.....

.....

.....

☐ other(s) 其他 (please specify the use(s) and concerned land
 area(s)/GFA(s) 請註明用途及有關的地面面積／總
 樓面面積)

.....

.....

.....

☐ Open space 休憩用地 (please specify land area(s) 請註明地面面積)

☐ private open space 私人休憩用地 sq. m 平方米 ☐ Not less than 不少於

☐ public open space 公眾休憩用地 sq. m 平方米 ☐ Not less than 不少於

(c) Use(s) of different floors (if applicable) 各樓層的用途 (如適用)

[Block number] [座數]	[Floor(s)] [層數]	[Proposed use(s)] [擬議用途]
.....
.....
.....
.....
.....

(d) Proposed use(s) of uncovered area (if any) 露天地方 (倘有) 的擬議用途

.....

7. Anticipated Completion Time of the Development Proposal 擬議發展計劃的預計完成時間

Anticipated completion time (in month and year) of the development proposal (by phase (if any)) (e.g. June 2023)

擬議發展計劃預期完成的年份及月份 (分期 (倘有)) (例: 2023 年 6 月)

(Separate anticipated completion times (in month and year) should be provided for the proposed public open space and Government, institution or community facilities (if any))

(申請人須就擬議的公眾休憩用地及政府、機構或社區設施 (倘有) 提供個別擬議完成的年份及月份)

RENEWAL OF PERMISSION FOR TEMPORARY USE OF 3 YEARS,

FROM 20 OCTOBER 2021 TO 19 OCTOBER 2024.

8. Vehicular Access Arrangement of the Development Proposal 擬議發展計劃的行車通道安排

<p>Any vehicular access to the site/subject building? 是否有車路通往地盤／有關建築物？</p>	<p>Yes 是</p> <p>No 否</p>	<p><input checked="" type="checkbox"/> There is an existing access. (please indicate the street name, where appropriate) 有一條現有車路。(請註明車路名稱(如適用))</p> <p>.....</p> <p><input type="checkbox"/> There is a proposed access. (please illustrate on plan and specify the width) 有一條擬議車路。(請在圖則顯示，並註明車路的闊度)</p> <p><input type="checkbox"/></p>
<p>Any provision of parking space for the proposed use(s)? 是否有為擬議用途提供停車位？</p>	<p>Yes 是</p> <p>No 否</p>	<p><input type="checkbox"/> (Please specify type(s) and number(s) and illustrate on plan) 請註明種類及數目並於圖則上顯示)</p> <p>Private Car Parking Spaces 私家車車位 _____</p> <p>Motorcycle Parking Spaces 電單車車位 _____</p> <p>Light Goods Vehicle Parking Spaces 輕型貨車泊車位 _____</p> <p>Medium Goods Vehicle Parking Spaces 中型貨車泊車位 _____</p> <p>Heavy Goods Vehicle Parking Spaces 重型貨車泊車位 _____</p> <p>Others (Please Specify) 其他 (請列明) _____</p> <p>_____</p> <p>_____</p>
<p>Any provision of loading/unloading space for the proposed use(s)? 是否有為擬議用途提供上落客貨車位？</p>	<p>Yes 是</p> <p>No 否</p>	<p><input type="checkbox"/> (Please specify type(s) and number(s) and illustrate on plan) 請註明種類及數目並於圖則上顯示)</p> <p>Taxi Spaces 的士車位 _____</p> <p>Coach Spaces 旅遊巴車位 _____</p> <p>Light Goods Vehicle Spaces 輕型貨車車位 _____</p> <p>Medium Goods Vehicle Spaces 中型貨車車位 _____</p> <p>Heavy Goods Vehicle Spaces 重型貨車車位 _____</p> <p>Others (Please Specify) 其他 (請列明) _____</p> <p>_____</p> <p>_____</p>

9. Impacts of Development Proposal 擬議發展計劃的影響

If necessary, please use separate sheets to indicate the proposed measures to minimise possible adverse impacts or give justifications/reasons for not providing such measures.

如需要的話，請另頁表示可盡量減少可能出現不良影響的措施，否則請提供理據/理由。

<p>Does the development proposal involve alteration of existing building? 擬議發展計劃是否包括現有建築物的改動?</p>	<p>Yes 是</p> <p>No 否</p>	<p><input type="checkbox"/> Please provide details 請提供詳情</p> <p>.....</p> <p>.....</p> <p>.....</p> <p>.....</p> <p>.....</p> <p><input checked="" type="checkbox"/></p>																														
<p>Does the development proposal involve the operation on the right? 擬議發展是否涉及右列的工程? (Note: where Type (ii) application is the subject of application, please skip this section. 註：如申請涉及第(ii)類申請，請跳至下一條問題。)</p>	<p>Yes 是</p> <p>No 否</p>	<p><input type="checkbox"/> (Please indicate on site plan the boundary of concerned land/pond(s), and particulars of stream diversion, the extent of filling of land/pond(s) and/or excavation of land) (請用地盤平面圖顯示有關土地／池塘界線，以及河道改道、填塘、填土及／或挖土的細節及／或範圍)</p> <p><input type="checkbox"/> Diversion of stream 河道改道</p> <p><input type="checkbox"/> Filling of pond 填塘 Area of filling 填塘面積 sq.m 平方米 <input type="checkbox"/> About 約 Depth of filling 填塘深度 m 米 <input type="checkbox"/> About 約</p> <p><input type="checkbox"/> Filling of land 填土 Area of filling 填土面積 sq.m 平方米 <input type="checkbox"/> About 約 Depth of filling 填土厚度 m 米 <input type="checkbox"/> About 約</p> <p><input type="checkbox"/> Excavation of land 挖土 Area of excavation 挖土面積..... sq.m 平方米 <input type="checkbox"/> About 約 Depth of excavation 挖土深度m 米 <input type="checkbox"/> About 約</p> <p><input checked="" type="checkbox"/></p>																														
<p>Would the development proposal cause any adverse impacts? 擬議發展計劃會否造成不良影響？</p>		<table border="0"> <tr> <td>On environment 對環境</td> <td>Yes 會 <input type="checkbox"/></td> <td>No 不會 <input checked="" type="checkbox"/></td> </tr> <tr> <td>On traffic 對交通</td> <td>Yes 會 <input type="checkbox"/></td> <td>No 不會 <input checked="" type="checkbox"/></td> </tr> <tr> <td>On water supply 對供水</td> <td>Yes 會 <input type="checkbox"/></td> <td>No 不會 <input checked="" type="checkbox"/></td> </tr> <tr> <td>On drainage 對排水</td> <td>Yes 會 <input type="checkbox"/></td> <td>No 不會 <input checked="" type="checkbox"/></td> </tr> <tr> <td>On slopes 對斜坡</td> <td>Yes 會 <input type="checkbox"/></td> <td>No 不會 <input checked="" type="checkbox"/></td> </tr> <tr> <td>Affected by slopes 受斜坡影響</td> <td>Yes 會 <input type="checkbox"/></td> <td>No 不會 <input checked="" type="checkbox"/></td> </tr> <tr> <td>Landscape Impact 構成景觀影響</td> <td>Yes 會 <input type="checkbox"/></td> <td>No 不會 <input checked="" type="checkbox"/></td> </tr> <tr> <td>Tree Felling 砍伐樹木</td> <td>Yes 會 <input type="checkbox"/></td> <td>No 不會 <input checked="" type="checkbox"/></td> </tr> <tr> <td>Visual Impact 構成視覺影響</td> <td>Yes 會 <input type="checkbox"/></td> <td>No 不會 <input checked="" type="checkbox"/></td> </tr> <tr> <td>Others (Please Specify) 其他 (請列明)</td> <td>Yes 會 <input type="checkbox"/></td> <td>No 不會 <input type="checkbox"/></td> </tr> </table> <p>.....</p> <p>.....</p> <p>Please state measure(s) to minimise the impact(s). For tree felling, please state the number, diameter at breast height and species of the affected trees (if possible) 請註明盡量減少影響的措施。如涉及砍伐樹木，請說明受影響樹木的數目、及胸高度的樹幹直徑及品種(倘可)</p> <p>.....</p> <p>.....</p> <p>.....</p> <p>.....</p> <p>.....</p>	On environment 對環境	Yes 會 <input type="checkbox"/>	No 不會 <input checked="" type="checkbox"/>	On traffic 對交通	Yes 會 <input type="checkbox"/>	No 不會 <input checked="" type="checkbox"/>	On water supply 對供水	Yes 會 <input type="checkbox"/>	No 不會 <input checked="" type="checkbox"/>	On drainage 對排水	Yes 會 <input type="checkbox"/>	No 不會 <input checked="" type="checkbox"/>	On slopes 對斜坡	Yes 會 <input type="checkbox"/>	No 不會 <input checked="" type="checkbox"/>	Affected by slopes 受斜坡影響	Yes 會 <input type="checkbox"/>	No 不會 <input checked="" type="checkbox"/>	Landscape Impact 構成景觀影響	Yes 會 <input type="checkbox"/>	No 不會 <input checked="" type="checkbox"/>	Tree Felling 砍伐樹木	Yes 會 <input type="checkbox"/>	No 不會 <input checked="" type="checkbox"/>	Visual Impact 構成視覺影響	Yes 會 <input type="checkbox"/>	No 不會 <input checked="" type="checkbox"/>	Others (Please Specify) 其他 (請列明)	Yes 會 <input type="checkbox"/>	No 不會 <input type="checkbox"/>
On environment 對環境	Yes 會 <input type="checkbox"/>	No 不會 <input checked="" type="checkbox"/>																														
On traffic 對交通	Yes 會 <input type="checkbox"/>	No 不會 <input checked="" type="checkbox"/>																														
On water supply 對供水	Yes 會 <input type="checkbox"/>	No 不會 <input checked="" type="checkbox"/>																														
On drainage 對排水	Yes 會 <input type="checkbox"/>	No 不會 <input checked="" type="checkbox"/>																														
On slopes 對斜坡	Yes 會 <input type="checkbox"/>	No 不會 <input checked="" type="checkbox"/>																														
Affected by slopes 受斜坡影響	Yes 會 <input type="checkbox"/>	No 不會 <input checked="" type="checkbox"/>																														
Landscape Impact 構成景觀影響	Yes 會 <input type="checkbox"/>	No 不會 <input checked="" type="checkbox"/>																														
Tree Felling 砍伐樹木	Yes 會 <input type="checkbox"/>	No 不會 <input checked="" type="checkbox"/>																														
Visual Impact 構成視覺影響	Yes 會 <input type="checkbox"/>	No 不會 <input checked="" type="checkbox"/>																														
Others (Please Specify) 其他 (請列明)	Yes 會 <input type="checkbox"/>	No 不會 <input type="checkbox"/>																														

10. Justifications 理由

The applicant is invited to provide justifications in support of the application. Use separate sheets if necessary.
現請申請人提供申請理由及支持其申請的資料。如有需要，請另頁說明。

PLEASE REFER TO THE ATTACHED SUPPLEMENTARY SHEET FOR JUSTIFICATIONS.

11. Declaration 聲明

I hereby declare that the particulars given in this application are correct and true to the best of my knowledge and belief.
本人謹此聲明，本人就這宗申請提交的資料，據本人所知及所信，均屬真實無誤。

I hereby grant a permission to the Board to copy all the materials submitted in an application to the Board and/or to upload such materials to the Board's website for browsing and downloading by the public free-of-charge at the Board's discretion.
本人現准許委員會酌情將本人就此申請所提交的所有資料複製及/或上載至委員會網站，供公眾免費瀏覽或下載。

Signature
簽署

☐ Applicant 申請人 ☒ Authorised Agent 獲授權代理人

KEITH, SIU LEUNG HUNG

DIRECTOR

Name in Block Letters
姓名（請以正楷填寫）

Position (if applicable)
職位（如適用）

Professional Qualification(s)
專業資格

☒ Member 會員 / ☐ Fellow of 資深會員

☐ HKIP 香港規劃師學會 /

☐ HKIA 香港建築師學會 /

☒ HKIS 香港測量師學會 /

☐ HKIE 香港工程師學會 /

☐ HKILA 香港園境師學會 /

☐ HKIUD 香港城市設計學會 /

☐ RPP 註冊專業規劃師

Others 其他

on behalf of
代表

RHL SURVEYORS LIMITED

☒ Company 公司 / ☐ Organisation 機構名稱及蓋章（如適用）

Date 日期

28 JUN 2021

(DD/MM/YYYY 日/月/年)

Remark 備註

The materials submitted in an application to the Board and the Board's decision on the application would be disclosed to the public. Such materials would also be uploaded to the Board's website for browsing and free downloading by the public where the Board considers appropriate.

委員會會向公眾披露申請人所遞交的申請資料和委員會對申請所作的決定。在委員會認為合適的情況下，有關申請資料亦會上載至委員會網頁供公眾免費瀏覽及下載。

Warning 警告

Any person who knowingly or wilfully makes any statement or furnish any information in connection with this application, which is false in any material particular, shall be liable to an offence under the Crimes Ordinance.

任何人在明知或故意的情況下，就這宗申請提出在任何要項上是虛假的陳述或資料，即屬違反《刑事罪行條例》。

Statement on Personal Data 個人資料的聲明

1. The personal data submitted to the Board in this application will be used by the Secretary of the Board and Government departments for the following purposes:

委員會就這宗申請所收到的個人資料會交給委員會秘書及政府部門，以根據《城市規劃條例》及相關的城市規劃委員會規劃指引的規定作以下用途：

- (a) the processing of this application which includes making available the name of the applicant for public inspection when making available this application for public inspection; and
處理這宗申請，包括公布這宗申請供公眾查閱，同時公布申請人的姓名供公眾查閱；以及
(b) facilitating communication between the applicant and the Secretary of the Board/Government departments.
方便申請人與委員會秘書及政府部門之間進行聯絡。

2. The personal data provided by the applicant in this application may also be disclosed to other persons for the purposes mentioned in paragraph 1 above.

申請人就這宗申請提供的個人資料，或亦會向其他人士披露，以作上述第 1 段提及的用途。

3. An applicant has a right of access and correction with respect to his/her personal data as provided under the Personal Data (Privacy) Ordinance (Cap. 486). Request for personal data access and correction should be addressed to the Secretary of the Board at 15/F, North Point Government Offices, 333 Java Road, North Point, Hong Kong.

根據《個人資料(私隱)條例》(第 486 章)的規定，申請人有權查閱及更正其個人資料。如欲查閱及更正個人資料，應向委員會秘書提出有關要求，其地址為香港北角渣華道 333 號北角政府合署 15 樓。

For Developments involving Columbarium Use, please also complete the following:
如發展涉及靈灰安置所用途，請另外填妥以下資料：

Ash interment capacity 骨灰安放容量[@]

Maximum number of sets of ashes that may be interred in the niches

在龕位內最多可安放骨灰的數量

Maximum number of sets of ashes that may be interred other than in niches

在非龕位的範圍內最多可安放骨灰的數量

Total number of niches 龕位總數

Total number of single niches

單人龕位總數

Number of single niches (sold and occupied)

單人龕位數目 (已售並佔用)

Number of single niches (sold but unoccupied)

單人龕位數目 (已售但未佔用)

Number of single niches (residual for sale)

單人龕位數目 (待售)

Total number of double niches

雙人龕位總數

Number of double niches (sold and fully occupied)

雙人龕位數目 (已售並全部佔用)

Number of double niches (sold and partially occupied)

雙人龕位數目 (已售並部分佔用)

Number of double niches (sold but unoccupied)

雙人龕位數目 (已售但未佔用)

Number of double niches (residual for sale)

雙人龕位數目 (待售)

Total no. of niches other than single or double niches (please specify type)

除單人及雙人龕位外的其他龕位總數 (請列明類別)

Number. of niches (sold and fully occupied)

龕位數目 (已售並全部佔用)

Number of niches (sold and partially occupied)

龕位數目 (已售並部分佔用)

Number of niches (sold but unoccupied)

龕位數目 (已售但未佔用)

Number of niches (residual for sale)

龕位數目 (待售)

Proposed operating hours 擬議營運時間

[@] Ash interment capacity in relation to a columbarium means –

就靈灰安置所而言，骨灰安放容量指：

- the maximum number of containers of ashes that may be interred in each niche in the columbarium;
每個龕位內可安放的骨灰容器的最高數目；
- the maximum number of sets of ashes that may be interred other than in niches in any area in the columbarium; and
在該靈灰安置所並非龕位的範圍內，總共最多可安放多少份骨灰；以及
- the total number of sets of ashes that may be interred in the columbarium.
在該骨灰安置所內，總共最多可安放多少份骨灰。

Gist of Application 申請摘要			
(Please provide details in both English and Chinese <u>as far as possible</u> . This part will be circulated to relevant consultees, uploaded to the Town Planning Board's Website for browsing and free downloading by the public and deposited at the Planning Enquiry Counters of the Planning Department for general information.) (請盡量以英文及中文填寫。此部分將會發送予相關諮詢人士、上載至城市規劃委員會網頁供公眾免費瀏覽及下載及存放於規劃署規劃資料查詢處以供一般參閱。)			
Application No. 申請編號	(For Official Use Only) (請勿填寫此欄)		
Location/address 位置/地址	PORTION OF GROUND FLOOR, HK JEBN GROUP CENTER, NOS.13-15 SHING WAN ROAD, TAI WAI, NEW TERRITORIES 新界大圍成運路13至15號樓上集團中心地下(部分)		
Site area 地盤面積	-- NOT APPLICABLE -- sq. m 平方米 <input type="checkbox"/> About 約 (includes Government land of 包括政府土地 sq. m 平方米 <input type="checkbox"/> About 約)		
Plan 圖則	APPROVED SHA TIN OZP NO.S/ST/34 沙田分區計劃大綱核准圖編號 NO.S/ST/34		
Zoning 地帶	INDUSTRIAL. 工業		
Applied use/ development 申請用途/發展	RENEWAL OF PLANNING APPROVAL FOR TEMPORARY USE OF SHOP AND SERVICES FOR A PERIOD OF 3 YEARS. 更新規劃許可作臨時商店及服務行業用途，為期三年		
(i) Gross floor area and/or plot ratio 總樓面面積及/或 地積比率		sq.m 平方米	Plot Ratio 地積比率
	Domestic 住用	<input type="checkbox"/> About 約 <input type="checkbox"/> Not more than 不多於	<input type="checkbox"/> About 約 <input type="checkbox"/> Not more than 不多於
	Non-domestic 非住用	448 <input checked="" type="checkbox"/> About 約 <input type="checkbox"/> Not more than 不多於	<input type="checkbox"/> About 約 <input type="checkbox"/> Not more than 不多於
(ii) No. of block 幢數	Domestic 住用		
	Non-domestic 非住用		
	Composite 綜合用途		

(iii) Building height/No. of storeys 建築物高度／層數	Domestic 住用	m 米 <input type="checkbox"/> (Not more than 不多於)
		mPD 米(主水平基準上) <input type="checkbox"/> (Not more than 不多於)
		Storeys(s) 層 <input type="checkbox"/> (Not more than 不多於) (<input type="checkbox"/> Include 包括/ <input type="checkbox"/> Exclude 不包括 <input type="checkbox"/> Carport 停車間 <input type="checkbox"/> Basement 地庫 <input type="checkbox"/> Refuge Floor 防火層 <input type="checkbox"/> Podium 平台)
	Non-domestic 非住用	m 米 <input type="checkbox"/> (Not more than 不多於)
		mPD 米(主水平基準上) <input type="checkbox"/> (Not more than 不多於)
		Storeys(s) 層 <input type="checkbox"/> (Not more than 不多於) (<input type="checkbox"/> Include 包括/ <input type="checkbox"/> Exclude 不包括 <input type="checkbox"/> Carport 停車間 <input type="checkbox"/> Basement 地庫 <input type="checkbox"/> Refuge Floor 防火層 <input type="checkbox"/> Podium 平台)
	Composite 綜合用途	m 米 <input type="checkbox"/> (Not more than 不多於)
		mPD 米(主水平基準上) <input type="checkbox"/> (Not more than 不多於)
		Storeys(s) 層 <input type="checkbox"/> (Not more than 不多於) (<input type="checkbox"/> Include 包括/ <input type="checkbox"/> Exclude 不包括 <input type="checkbox"/> Carport 停車間 <input type="checkbox"/> Basement 地庫 <input type="checkbox"/> Refuge Floor 防火層 <input type="checkbox"/> Podium 平台)
(iv) Site coverage 上蓋面積	% <input type="checkbox"/> About 約	
(v) No. of units 單位數目		
(vi) Open space 休憩用地	Private 私人	sq.m 平方米 <input type="checkbox"/> Not less than 不少於
	Public 公眾	sq.m 平方米 <input type="checkbox"/> Not less than 不少於

(vii) No. of parking spaces and loading / unloading spaces 停車位及上落客貨車位數目	Total no. of vehicle parking spaces 停車位總數 Private Car Parking Spaces 私家車車位 Motorcycle Parking Spaces 電單車車位 Light Goods Vehicle Parking Spaces 輕型貨車泊車位 Medium Goods Vehicle Parking Spaces 中型貨車泊車位 Heavy Goods Vehicle Parking Spaces 重型貨車泊車位 Others (Please Specify) 其他 (請列明) _____	
	Total no. of vehicle loading/unloading bays/lay-bys 上落客貨車位／停車處總數 Taxi Spaces 的士車位 Coach Spaces 旅遊巴車位 Light Goods Vehicle Spaces 輕型貨車車位 Medium Goods Vehicle Spaces 中型貨車車位 Heavy Goods Vehicle Spaces 重型貨車車位 Others (Please Specify) 其他 (請列明) _____	

Submitted Plans, Drawings and Documents 提交的圖則、繪圖及文件

	<u>Chinese</u> 中文	<u>English</u> 英文
<u>Plans and Drawings 圖則及繪圖</u>		
Master layout plan(s)/Layout plan(s) 總綱發展藍圖／布局設計圖	<input type="checkbox"/>	<input checked="" type="checkbox"/>
Block plan(s) 樓宇位置圖	<input type="checkbox"/>	<input type="checkbox"/>
Floor plan(s) 樓宇平面圖	<input type="checkbox"/>	<input checked="" type="checkbox"/>
Sectional plan(s) 截視圖	<input type="checkbox"/>	<input type="checkbox"/>
Elevation(s) 立視圖	<input type="checkbox"/>	<input type="checkbox"/>
Photomontage(s) showing the proposed development 顯示擬議發展的合成照片	<input type="checkbox"/>	<input type="checkbox"/>
Master landscape plan(s)/Landscape plan(s) 園境設計總圖／園境設計圖	<input type="checkbox"/>	<input type="checkbox"/>
Others (please specify) 其他 (請註明)	<input type="checkbox"/>	<input checked="" type="checkbox"/>
LOCATION PLAN		
<u>Reports 報告書</u>		
Planning Statement/Justifications 規劃綱領/理據	<input type="checkbox"/>	<input type="checkbox"/>
Environmental assessment (noise, air and/or water pollutions) 環境評估 (噪音、空氣及／或水的污染)	<input type="checkbox"/>	<input type="checkbox"/>
Traffic impact assessment (on vehicles) 就車輛的交通影響評估	<input type="checkbox"/>	<input type="checkbox"/>
Traffic impact assessment (on pedestrians) 就行人的交通影響評估	<input type="checkbox"/>	<input type="checkbox"/>
Visual impact assessment 視覺影響評估	<input type="checkbox"/>	<input type="checkbox"/>
Landscape impact assessment 景觀影響評估	<input type="checkbox"/>	<input type="checkbox"/>
Tree Survey 樹木調查	<input type="checkbox"/>	<input type="checkbox"/>
Geotechnical impact assessment 土力影響評估	<input type="checkbox"/>	<input type="checkbox"/>
Drainage impact assessment 排水影響評估	<input type="checkbox"/>	<input type="checkbox"/>
Sewerage impact assessment 排污影響評估	<input type="checkbox"/>	<input type="checkbox"/>
Risk Assessment 風險評估	<input type="checkbox"/>	<input type="checkbox"/>
Others (please specify) 其他 (請註明)	<input type="checkbox"/>	<input type="checkbox"/>

Note: May insert more than one 「✓」, 註：可在多於一個方格內加上「✓」號

Note: The information in the Gist of Application above is provided by the applicant for easy reference of the general public. Under no circumstances will the Town Planning Board accept any liabilities for the use of the information nor any inaccuracies or discrepancies of the information provided. In case of doubt, reference should always be made to the submission of the applicant.

註：上述申請摘要的資料是由申請人提供以方便市民大眾參考。對於所載資料在使用上的問題及文義上的歧異，城市規劃委員會概不負責。若有任何疑問，應查閱申請人提交的文件。

10. JUSTIFICATIONS

This Section 16-I application is to seek renewal of planning approval for permission involving temporary use of building not exceeding 3 years for shop and services uses at the application premises. The existing temporary permission granted is to be due on 19th October 2021 (A/ST/962) which approval condition had been considered complied with by the Director of Fire Services. The application premises is zoned “Industrial” uses on the Approved Sha Tin Outline Zoning Plan No. S/ST/34.

The ground floors of other existing buildings in the area are used mainly for industrial uses with several utilized as other commercial purposes such as cycling products shops, metalware shops, property agencies and other commercial uses.

The design of the ground floor of the Subject Building is typical of similar industrial buildings in that the whole ground floor can be used for commercial purposes. The floor loading and fire-proof period are satisfied as the new uses are lesser stringent than industrial use.

The accessibility of the Subject Building is reasonable. The MTR East Rail Line/ Tuen Ma Line Tai Wai interchange station is located within a 10-minute walking distance away from the Subject Building. Various bus routes are also serving the vicinity.

The application premises is used to sell the applicant’s products, *“including swallow's nests, cordyceps, sea cucumbers and dried abalones and other dried seafood along with herbal tonics, various other Japanese, Korean and international products etc.”*, as quoted from its website.

The potential shoppers are mainly public but local ones. They live in or work in the area and take the opportunity to do shopping or to order services. Shoppers coming from other districts purely to do shopping are unlikely to take place there as the area is an established industrial area rather than being a shopping area and the applicant provides a wide network of shop branches across the city. Meanwhile, there are existing loading and unloading facilities in the building. The increase in traffic, as analyzed by the traffic consultant in related to the precedent planning approval (A/ST/873), was considered to be minimal.

Hence, the application for renewal of permission involving temporary use of building not exceeding 3 years for shop and services at the application premises on the ground floor are compatible with the existing uses in the area.

Location Plan

永利行測量師有限公司
RHL Surveyors Limited
Real Estate Solution & Surveying Practice

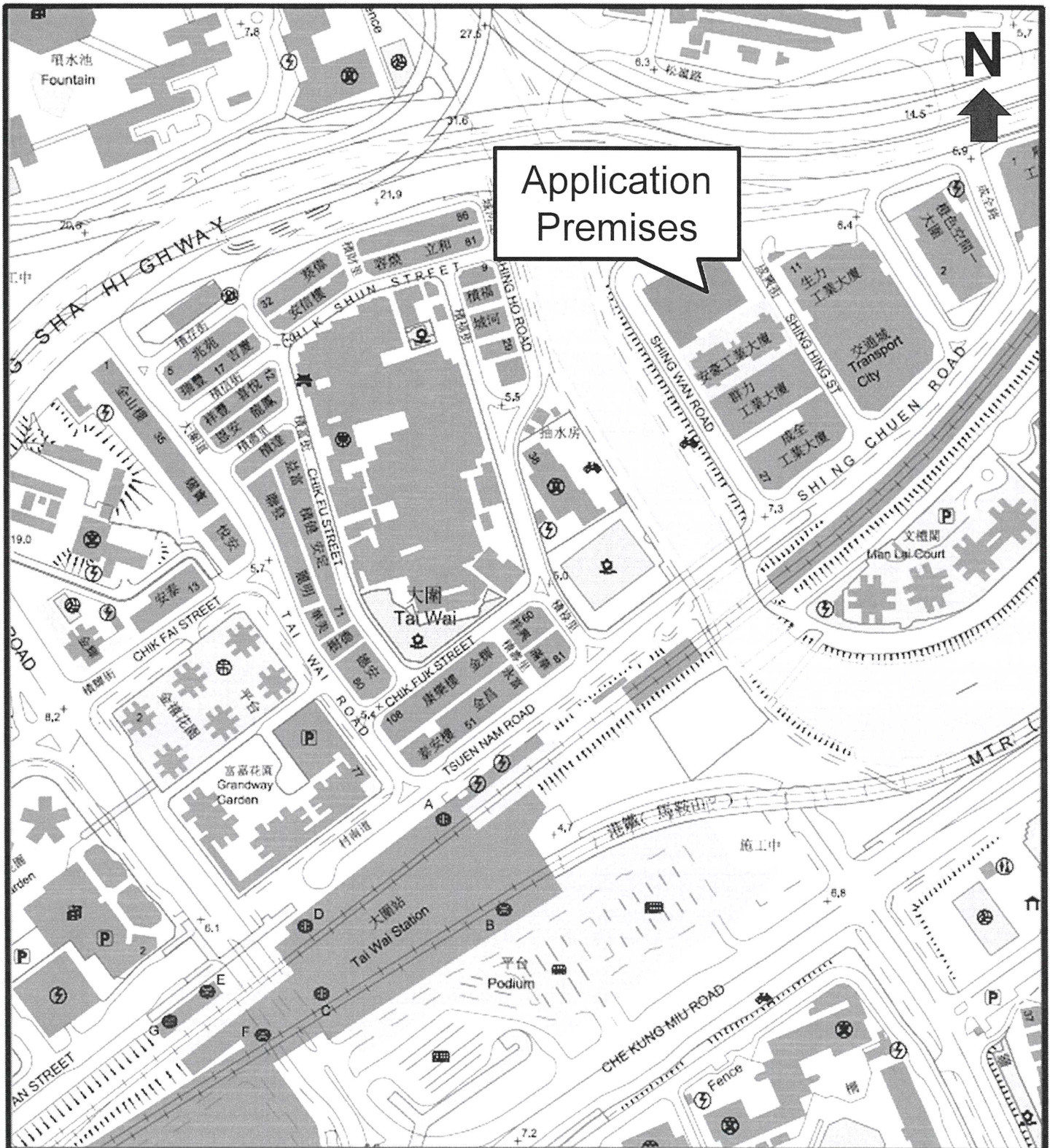

Not to scale – for identification purpose only

永利行集團成員 | Member of RHL International

Your Professional • Your Solution

info@rhl-int.com | www.rhl-int.com

Site Plan

永利行測量師有限公司
RHL Surveyors Limited
Real Estate Solution & Surveying Practice

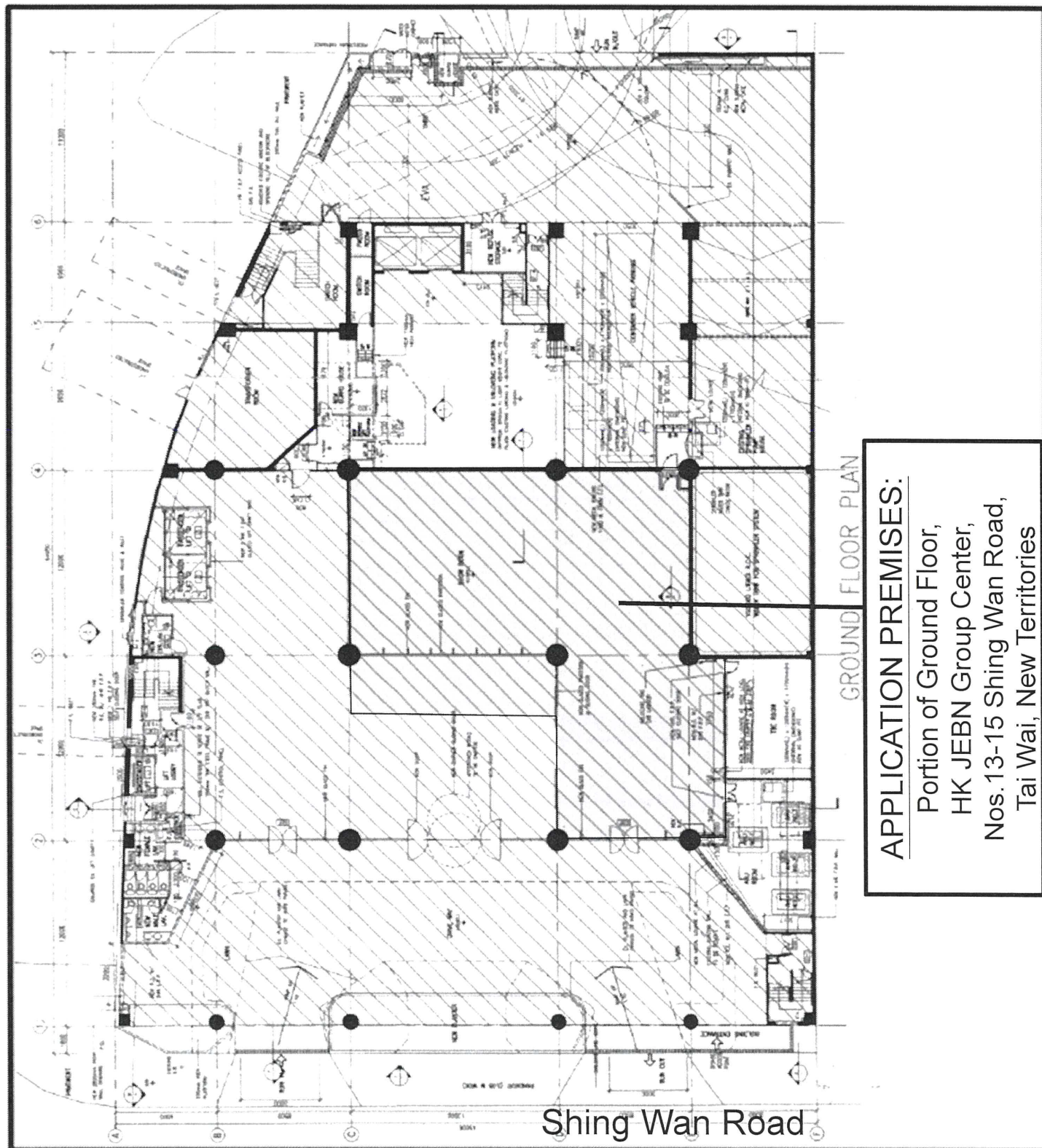

Not to scale – for identification purpose only

永利行集團成員 | Member of RHL International

Your Professional • Your Solution

info@rhl-int.com | www.rhl-int.com

Site Plan

永利行測量師有限公司
RHL Surveyors Limited
Real Estate Solution & Surveying Practice

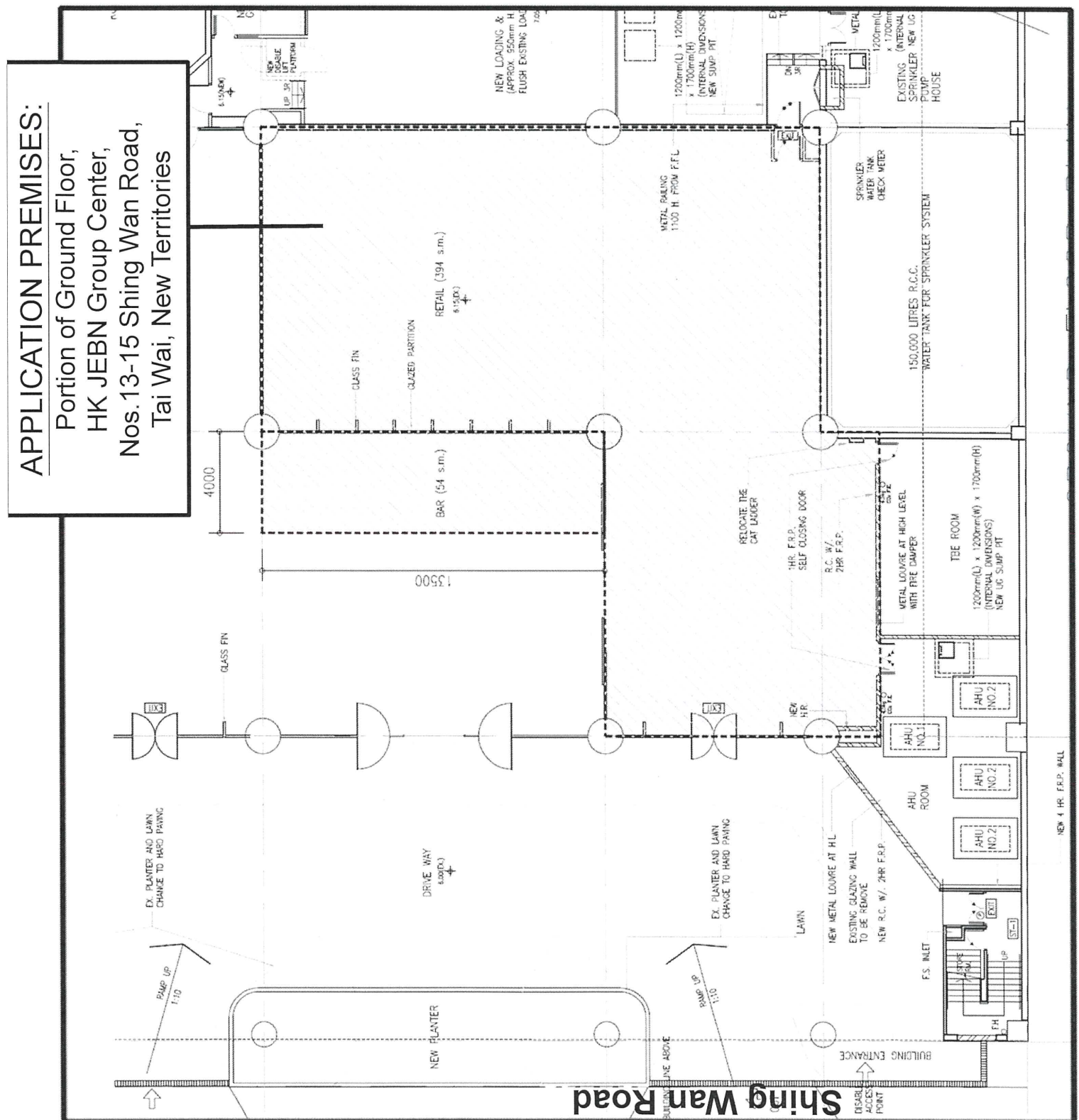

Not to scale – for identification purpose only

永利行集團成員 | Member of RHL International

Your Professional • Your Solution

info@rhl-int.com | www.rhl-int.com

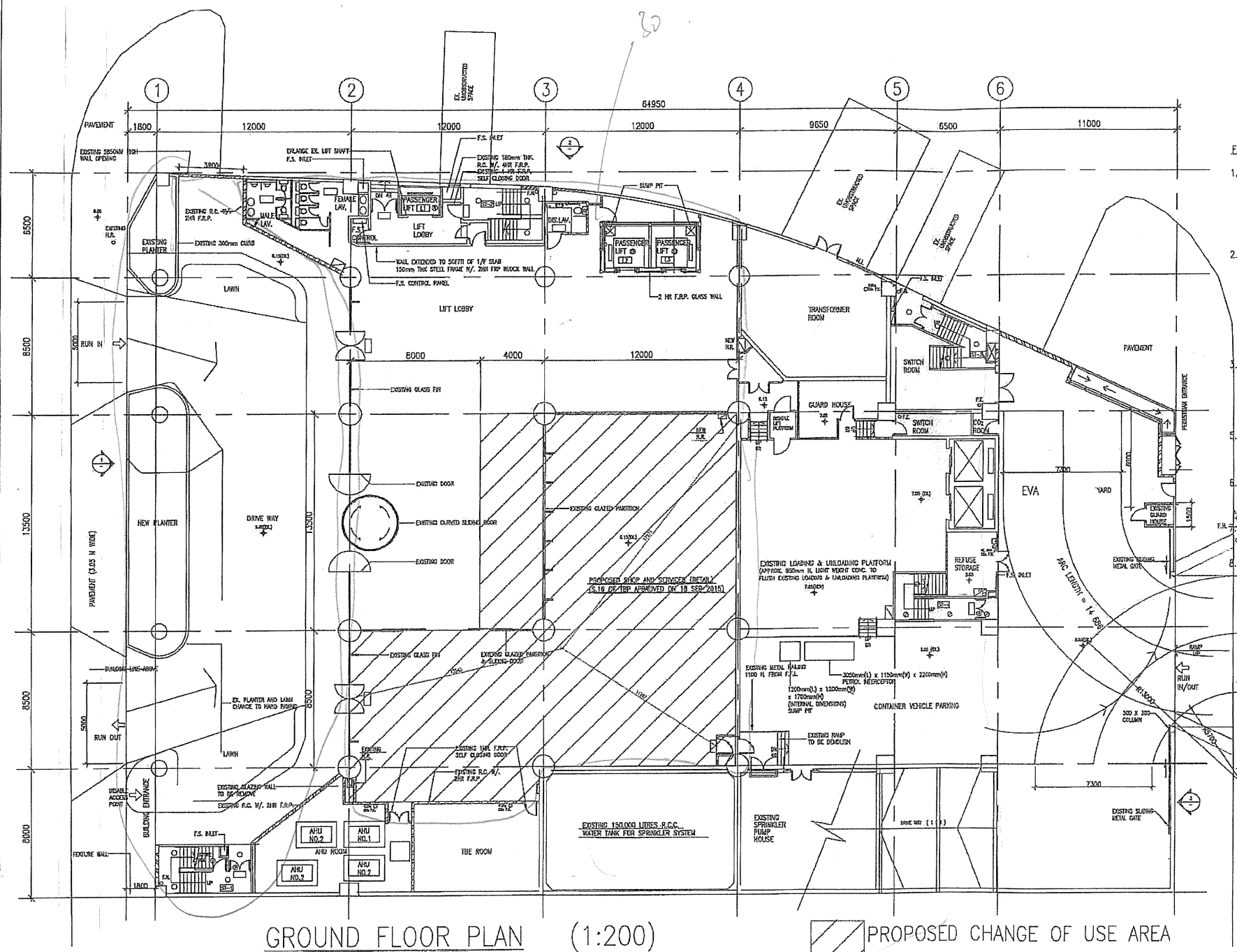

FIRE SERVICES INSTALLATION NOTES: FOR THE PROPOSED SHOP AND SERVICE (RETAIL)

- 1. AUTOMATIC SPRINKLER SYSTEM**
AN AUTOMATIC SPRINKLER SYSTEM TO BE PROVIDED AND INSTALLED IN ACCORDANCE WITH THE LPC RULES FOR AUTOMATIC SPRINKLER INSTALLATIONS INCORPORATING BS EN 12845 : 2003 AND FSD CIRCULAR LETTERS NO. 3/2006 AND NO. 3/2012.
a. SPRINKLERS TO BE EXTENDED FROM EXISTING SPRINKLER SYSTEM (OHIII CLASS) EXCEPT E/M PLANT ROOM, E&M SERVICE DUCTS AND SUIT NEW LAYOUT.
b. EXISTING 150,000 LITRES SPRINKLER WATER TANK & PUMPS AT G/F TO BE RETAINED.
- 2. HOSE REEL SYSTEM / FIRE HYDRANT / MANUAL FIRE ALARM SYSTEM**
a. NEW HR TO BE EXTENDED FROM EXISTING HR SYSTEM.
b. BREAKGLASS UNITS AND FIRE ALARM BELLS TO BE LOCATED AT ALL HOSE REEL POINTS. THE MANUAL FIRE ALARM SYSTEM TO BE INCORPORATED IN THE HR SYSTEM AND EXTEND FROM EXISTING.
c. HOSE REELS SHALL BE PROVIDED TO ENSURE THAT EVERY PART OF THE BUILDING CAN BE REACHED BY A LENGTH OF NOT MORE THAN 30m OF HOSE REEL TUBING.
d. EXISTING 36,000 LITRES F.S. WATER TANK AT 7/F TO BE RETAINED.
e. EX. FIRE HYDRANT WITHIN THE BUILDING TO BE RETAINED.
- 3. VISUAL FIRE ALARM SYSTEM**
a. VISUAL ALARM SIGNALS (FLASHING RED LIGHTS) TO A&A AREA TO BE EXTENDED FROM EXISTING SYSTEM.
THE VISUAL ALARM SIGNALS TO BE INSTALLED IN ACCORDANCE WITH THE FSD CIRCULAR LETTERS NO. 2/2012, BS 5839-1 : 2002 + A2 : 2008 AND DESIGN MANUAL : BARRIER FREE ACCESS 2008.
b. UPON ACTUATION OF ANY FIRE ALARM SIGNALS, ALL FIRE ALARM BELLS AND FLASHING RED LIGHTS WILL BE ACTIVATED.
- 4. EMERGENCY LIGHTING**
EMERGENCY LIGHTING TO BE PROVIDED THROUGHOUT THE HATCHED AREA AND ALL EXIT ROUTES LEADING TO GROUND LEVEL GROUND LEVEL IN ACCORDANCE WITH BS5266:1 + BS EN 1838.
- 5. EXIT SIGN**
SUFFICIENT DIRECTIONAL AND EXIT SIGNS TO BE PROVIDED IN ACCORDANCE WITH F.S.D. CIRCULAR LETTER 5/2008 TO ENSURE THAT ALL EXIT ROUTES TO BE CLEARLY INDICATED AS REQUIRED.
- 6. PORTABLE HAND-OPERATED APPROVED APPLIANCE**
PORTABLE FIRE EXTINGUISHERS TO BE PROVIDED AT POSITIONS AS INDICATED ON PLAN.
- 7. VENTILATION / AIR CONDITIONING CONTROL SYSTEM**
WHERE A VENTILATION / AIR CONDITIONING CONTROL SYSTEM IS PROVIDED, IT SHALL STOP MECHANICAL INCLUDED AIR MOVEMENT WITHIN A DESIGNATED FIRE COMPARTMENT.

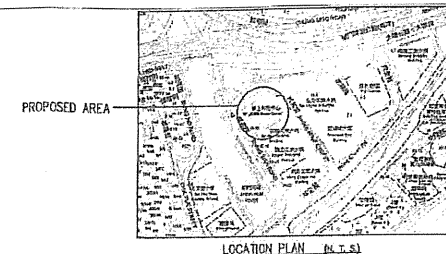

REVISION :
A/ST/873

NOTES:
1. THIS FIRE SERVICE INSTALLATION SHALL BE PROVIDED IN ACCORDANCE WITH THE LPC RULES FOR AUTOMATIC SPRINKLER INSTALLATIONS INCORPORATING BS EN 12845 : 2003 AND FSD CIRCULAR LETTERS NO. 3/2006 AND NO. 3/2012.
2. THIS DRAWING SHALL BE USED IN CONJUNCTION WITH THE EXISTING STRUCTURAL DRAWINGS OF THE BUILDING.
3. THE EXISTING STRUCTURAL DRAWINGS SHALL BE USED IN CONJUNCTION WITH THE EXISTING ELECTRICAL DRAWINGS.
4. THE EXISTING ELECTRICAL DRAWINGS SHALL BE USED IN CONJUNCTION WITH THE EXISTING MECHANICAL DRAWINGS.
5. THE EXISTING MECHANICAL DRAWINGS SHALL BE USED IN CONJUNCTION WITH THE EXISTING PLUMBING DRAWINGS.
6. THE EXISTING PLUMBING DRAWINGS SHALL BE USED IN CONJUNCTION WITH THE EXISTING SANITARY DRAWINGS.
7. THE EXISTING SANITARY DRAWINGS SHALL BE USED IN CONJUNCTION WITH THE EXISTING DRAINAGE DRAWINGS.
8. THE EXISTING DRAINAGE DRAWINGS SHALL BE USED IN CONJUNCTION WITH THE EXISTING WASTE WATER DRAWINGS.
9. THE EXISTING WASTE WATER DRAWINGS SHALL BE USED IN CONJUNCTION WITH THE EXISTING SEWAGE DRAWINGS.
10. THE EXISTING SEWAGE DRAWINGS SHALL BE USED IN CONJUNCTION WITH THE EXISTING RAIN WATER DRAWINGS.
11. THE EXISTING RAIN WATER DRAWINGS SHALL BE USED IN CONJUNCTION WITH THE EXISTING GROUND WATER DRAWINGS.
12. THE EXISTING GROUND WATER DRAWINGS SHALL BE USED IN CONJUNCTION WITH THE EXISTING SURFACE WATER DRAWINGS.
13. THE EXISTING SURFACE WATER DRAWINGS SHALL BE USED IN CONJUNCTION WITH THE EXISTING SUBSURFACE WATER DRAWINGS.
14. THE EXISTING SUBSURFACE WATER DRAWINGS SHALL BE USED IN CONJUNCTION WITH THE EXISTING UNDERGROUND WATER DRAWINGS.
15. THE EXISTING UNDERGROUND WATER DRAWINGS SHALL BE USED IN CONJUNCTION WITH THE EXISTING OVERGROUND WATER DRAWINGS.
16. THE EXISTING OVERGROUND WATER DRAWINGS SHALL BE USED IN CONJUNCTION WITH THE EXISTING ABOVEGROUND WATER DRAWINGS.
17. THE EXISTING ABOVEGROUND WATER DRAWINGS SHALL BE USED IN CONJUNCTION WITH THE EXISTING BELOWGROUND WATER DRAWINGS.
18. THE EXISTING BELOWGROUND WATER DRAWINGS SHALL BE USED IN CONJUNCTION WITH THE EXISTING ABOVEGROUND WATER DRAWINGS.
19. THE EXISTING ABOVEGROUND WATER DRAWINGS SHALL BE USED IN CONJUNCTION WITH THE EXISTING BELOWGROUND WATER DRAWINGS.
20. THE EXISTING BELOWGROUND WATER DRAWINGS SHALL BE USED IN CONJUNCTION WITH THE EXISTING ABOVEGROUND WATER DRAWINGS.

REVISION	DATE

RESERVED FOR CERTIFIED TRUE COPY

RESERVED FOR OFFICIAL USE

RESERVED FOR APPROVAL CHOP

DATE	CHECKED	SCALE
DEC/2015	DW	AS SHOWN
JOB NO.	DWG. NO.	
B5201	FS/01	
PROJECT CODE	PROJECT NAME	
16-165201-0010 (N-120)	Group Centre (Fire Safety Work)	
STATUS : FIRST SUBMISSION		

FIRE SERVICE (INSTALLATIONS AND EQUIPMENT) REGULATIONS

消防(裝置及設備)規例

(Regulation 9(1))

(第九條(1)款)

CERTIFICATE OF FIRE SERVICE INSTALLATION AND EQUIPMENT

消防裝置及設備證書

FSD Ref.:
消防處檔號

Serial Number

10455211643

Name of Client 顧客姓名

樓上有限公司

Address 地址

沙田大圍 成運路13號

Type of Building 樓宇類型: ☒ Industrial 工業 ☐ Commercial 商業 ☐ Domestic 住宅 ☐ Composite 綜合 ☐ Licensed premises 持牌處所 ☐ Institutional 社團

Part 1 Annual Maintenance ONLY

第一部 只適用於年檢事項

In accordance with Regulation 8(b) of the Fire Service (Installations and Equipment) Regulations, the owner of any fire service installation or equipment which is installed in any premises shall have such fire service installation or equipment inspected by a registered contractor at least once in every 12 months. 根據消防(裝置及設備)規例第八條(b)款, 擁有裝置在任何處所內的任何消防裝置或設備的人, 須每12個月由一名註冊承辦商檢查該等消防裝置或設備至少一次。

Code 編碼 (1-35)	Type of FSI 裝置類型	Location(s) 位置	Comment on Condition 狀況評述	Completion Date 完成日期 (DD/MM/YYYY)	Next Due Date 下次到期日 (DD/MM/YYYY)
11	Emergency Lighting - 15nos. emergency lighting	G/F	Conforms with FSD requirements	28/07/2021	27/07/2022
12	Exit Sign - 2nos. exit sign	G/F	Conforms with FSD requirements	28/07/2021	27/07/2022

Part 2 第二部 Installation / Modification / Repair / Inspection works 裝置/改裝/修理/檢查工作

Code 編碼 (1-35)	Type of FSI 裝置類型	Location(s) 位置	Nature of Work Carried out 完成之工作內容	Comment on Condition 狀況評述	Completion Date 完成日期 (DD/MM/YYYY)
28	Sprinkler System	G/F	Inspect of sprinkler head distance & coverage area	Conforms with FSD requirements	28/07/2021

Part 3 第三部 Defects 損壞事項

Code 編碼 (1-35)	Type of FSI 裝置類型	Location(s) 位置	Outstanding Defects 未修缺點	Comment on Defects 缺點評述

Remark 備註

I/We hereby certify that the above installations/equipment have been tested and found to be in efficient working order in accordance with the Codes of Practice for Minimum Fire Service Installations and Equipment and Inspection, Testing and Maintenance of Installations and Equipment published from time to time by the Director of Fire Services. Defects are listed in Part 3.

本人藉此證明以上之消防裝置及設備經試驗, 證明性能良好, 符合消防處處長不時公佈的最低限度之消防裝置及設備守則與裝置及設備之檢查測試及保養守則的規格, 損壞事項列於第三部。

如證書涉及年檢事項, 應張貼於大廈或處所當眼處以供消防處人員查核

This certificate should be displayed at prominent location of the building or premises for FSD's inspection if any annual maintenance work is involved.

Authorized

Signature:

受權人簽署

Name:

姓名

Chan Yiu Lam

FSD/RC No.:

消防處註冊號碼

RC1 / 0455 RC2 / 0627

Company Name:

公司名稱

德耀消防工程
有限公司

Telephone:

聯絡電話

Date:

日期

28/07/2021

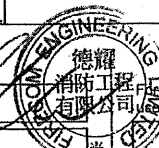

Inspected

Key-in

Verified



Serial Number

10455 211643

Name of Client 顧客姓名

樓上有限公司

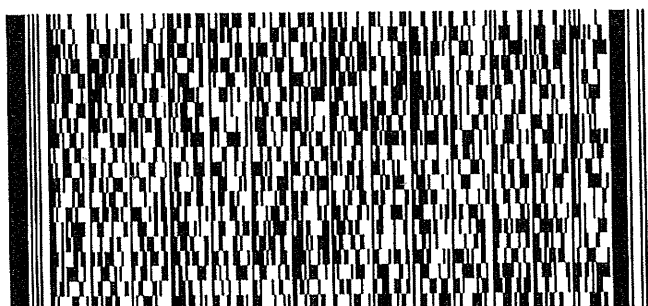
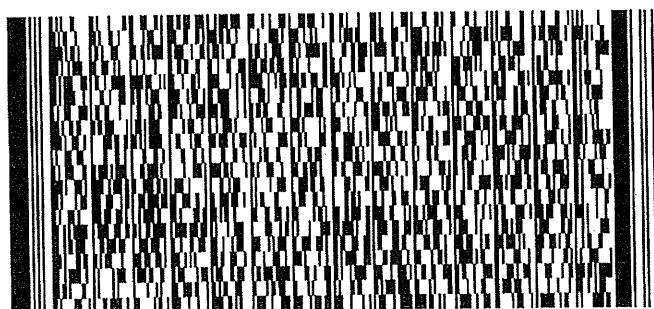
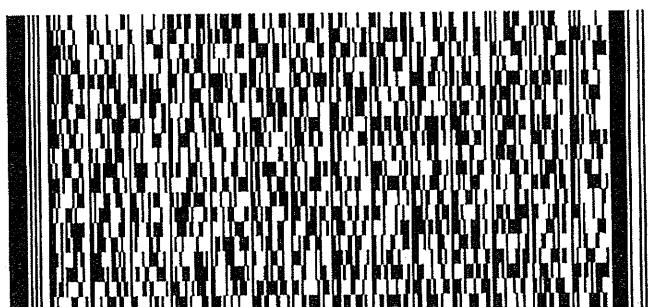
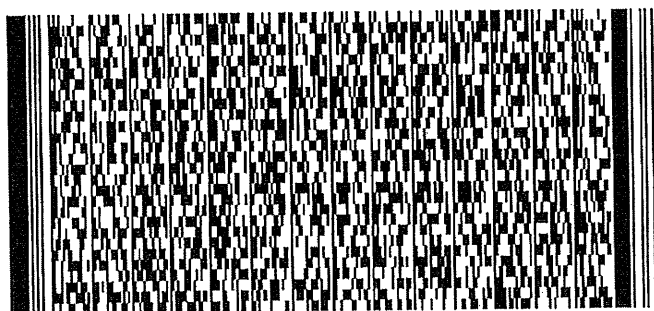
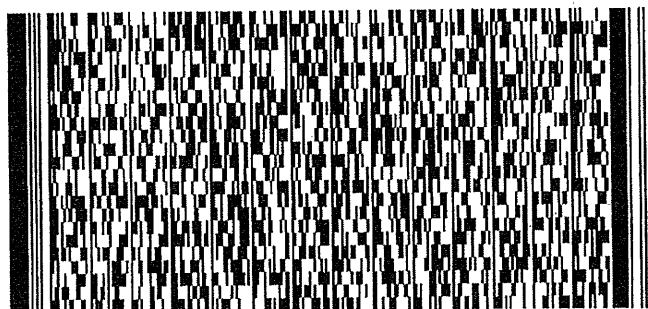
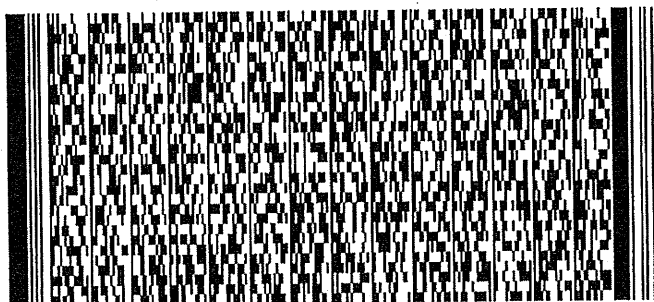
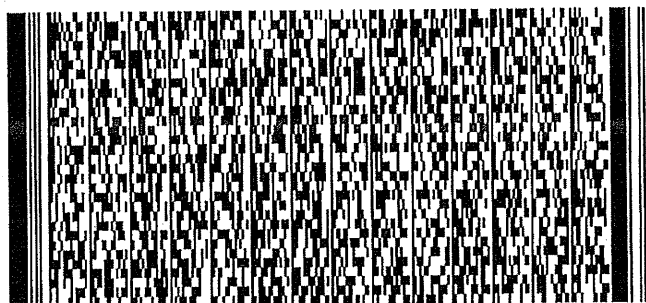
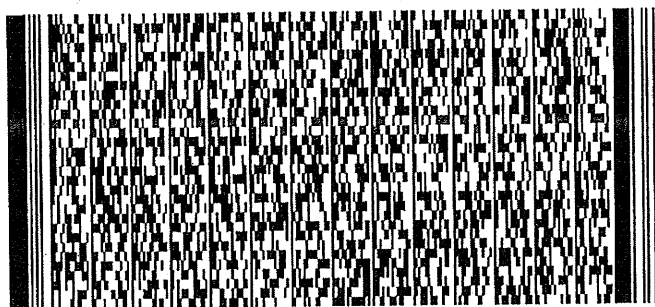

FIRE SERVICE (INSTALLATIONS AND EQUIPMENT) REGULATIONS

消防(裝置及設備)規例

(Regulation 9(1))

(第九條(1)款)

CERTIFICATE OF FIRE SERVICE INSTALLATION AND EQUIPMENT

消防裝置及設備證書

FSD Ref.:
消防處編號

Serial Number

30635 111968

Name of Client 顧客姓名

樓上

Address 地址

新界大圍 成運路13-15號

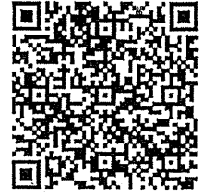
Type of Building 樓宇類型: ☐ Industrial 工業 ☒ Commercial 商業 ☐ Domestic 住宅 ☐ Composite 綜合 ☐ Licensed premises 持牌處所 ☐ Institutional 社團

Part 1 Annual Maintenance ONLY

第一部 只適用於年檢事項

In accordance with Regulation 8(b) of the Fire Service (Installations and Equipment) Regulations, the owner of any fire service installation or equipment which is installed in any premises shall have such fire service installation or equipment inspected by a registered contractor at least once in every 12 months. 根據消防(裝置及設備)規例第八條(b)款, 擁有裝置在任何處所內的任何消防裝置或設備的人, 須每12個月由一名註冊承辦商檢查該等消防裝置或設備至少一次。

Code 編碼 (1-35)	Type of FSI 裝置類型	Location(s)位置	Comment on Condition 狀況評述	Completion Date 完成日期 (DD/MM/YYYY)	Next Due Date 下次到期日 (DD/MM/YYYY)
24	Portable Fire Extinguisher - 1no. 2kg dry powder F.E. - 1no. 5kg dry powder F.E.	G/F	Conforms with FSD requirements	28/07/2021	27/07/2022
24	Portable Fire Extinguisher - 2nos. 5kg CO2 gas type F.E.	G/F	Conforms with FSD requirements	28/07/2021	27/07/2022

Part 2 第二部 Installation / Modification / Repair / Inspection works 裝置/改裝/修理/檢查工作

Code 編碼 (1-35)	Type of FSI 裝置類型	Location(s)位置	Nature of Work Carried out 完成之工作內容	Comment on Condition 狀況評述	Completion Date 完成日期 (DD/MM/YYYY)

Part 3 第三部 Defects 損壞事項

Code 編碼 (1-35)	Type of FSI 裝置類型	Location(s)位置	Outstanding Defects 未修缺點	Comment on Defects 缺點評述

Remark 備註

I/We hereby certify that the above installations/equipment have been tested and found to be in efficient working order in accordance with the Codes of Practice for Minimum Fire Service Installations and Equipment and Inspection, Testing and Maintenance of Installations and Equipment published from time to time by the Director of Fire Services. Defects are listed in Part 3.

本人藉此證明以上之消防裝置及設備經試驗, 證明性能良好, 符合消防處處長不時公佈的最低限度之消防裝置及設備守則與裝置及設備之檢查測試及保養守則的規格, 損壞事項列於第三部。

如證書涉及年檢事項, 應張貼於大廈或處所當眼處以供消防處人員查核

This certificate should be displayed at prominent location of the building or premises for FSD's inspection if any annual maintenance work is involved.

Authorized
Signature:
受權人簽署Name:
姓名

Chow Wai Chiu

FSD/RC No.:
消防處註冊號碼

RC3 / 0635

Company Name:
公司名稱

Chow Wai Chiu

Telephone:
聯絡電話Date:
日期

28/07/2021

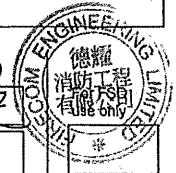

Inspected

Key-in

Verified



Serial Number

30635111968

Name of Client 顧客姓名

樓上

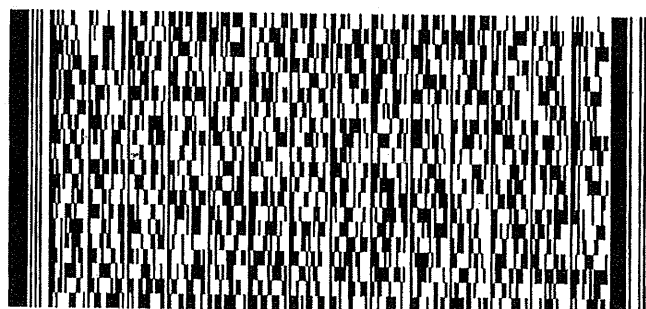
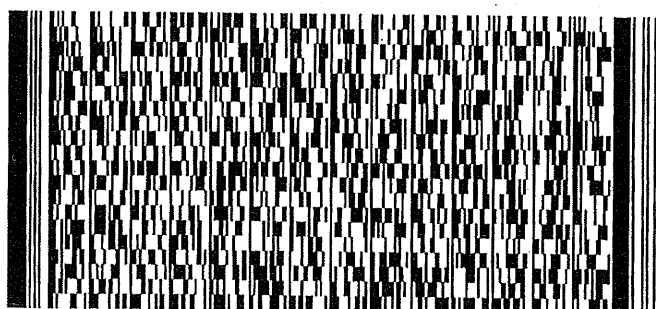
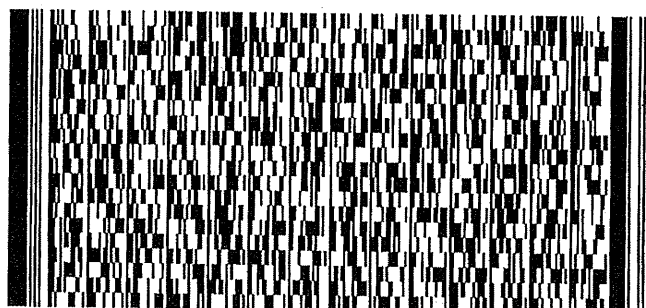
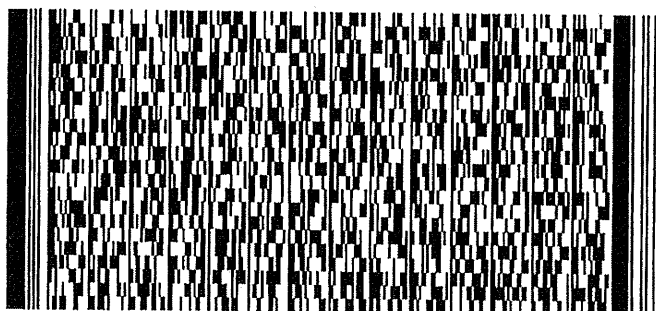
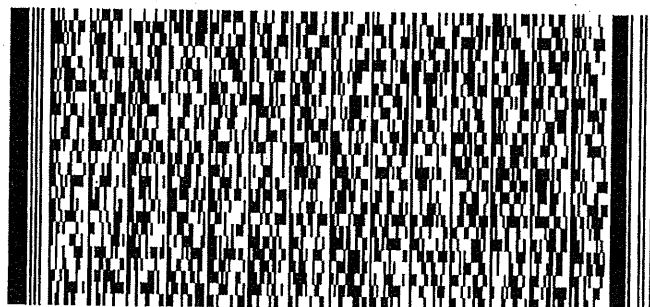
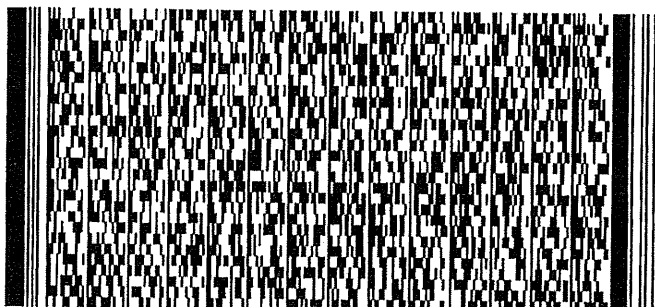
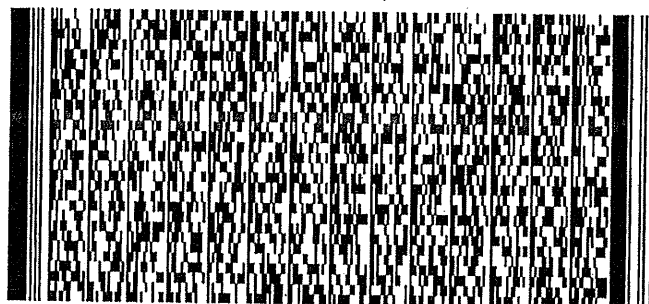
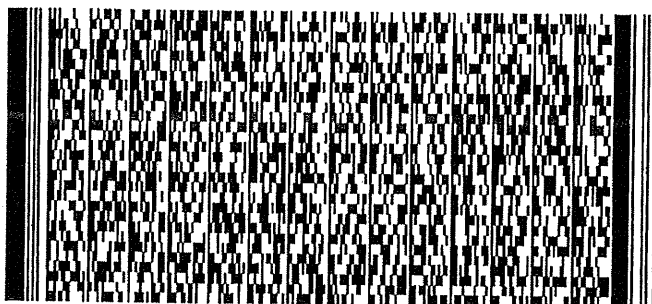

1. 此圖乃根據
 2. 建築師事務所
 3. 於 2017 年 12 月 21 日
 4. 向消防處提交之
 5. 圖則編號為 FSD/2017/001
 6. 圖則編號為 FSD/2017/001

REVISION			
No.	DATE	REVISION	BY
1.	2017/12/21	INITIAL DESIGN	
2.	2017/12/21	INITIAL DESIGN	
3.	2017/12/21	INITIAL DESIGN	
4.	2017/12/21	INITIAL DESIGN	
5.	2017/12/21	INITIAL DESIGN	
6.	2017/12/21	INITIAL DESIGN	
7.	2017/12/21	INITIAL DESIGN	
8.	2017/12/21	INITIAL DESIGN	
9.	2017/12/21	INITIAL DESIGN	
10.	2017/12/21	INITIAL DESIGN	
11.	2017/12/21	INITIAL DESIGN	
12.	2017/12/21	INITIAL DESIGN	
13.	2017/12/21	INITIAL DESIGN	
14.	2017/12/21	INITIAL DESIGN	
15.	2017/12/21	INITIAL DESIGN	
16.	2017/12/21	INITIAL DESIGN	
17.	2017/12/21	INITIAL DESIGN	
18.	2017/12/21	INITIAL DESIGN	
19.	2017/12/21	INITIAL DESIGN	
20.	2017/12/21	INITIAL DESIGN	

INJECTION
 INTERIOR
 DESIGN STUDIO
 樓上燕窩社
 香港新界大圍
 成運街13-15號
 樓上燕窩中心

Project No. _____ Date _____
 Project Name _____
 Design By _____
 Scale 1:100 (A3)
 Drawing No. E2-01

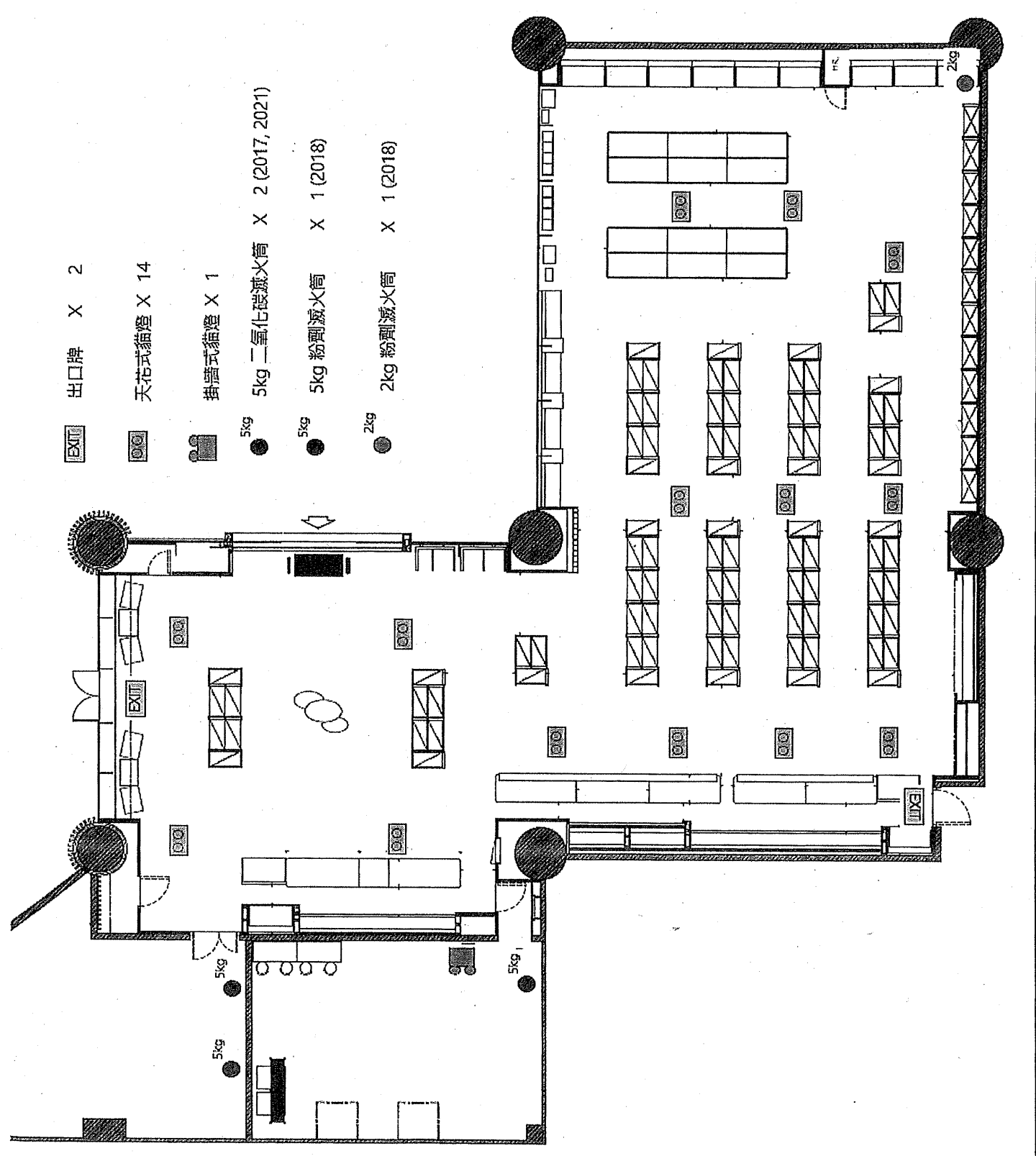

- 出口牌 X 2
- 天花式貓燈 X 14
- 掛牆式貓燈 X 1
- 5kg 二氧化碳滅火筒 X 2 (2017, 2021)
- 5kg 粉劑滅火筒 X 1 (2018)
- 2kg 粉劑滅火筒 X 1 (2018)

Comments of the Director of Food and Environment Hygiene (DFEH):

- i. No Food and Environmental Hygiene Department's (FEHD) facilities will be affected.
- ii. Proper licence / permit issued by this Department is required if there is any food business / catering service / activities regulated by the Director of Food and Environmental Hygiene (DFEH) under the Public Health and Municipal Services Ordinance (Cap. 132) and other relevant legislation for the public. The operation of any eating place should be under a food licence issued by the FEHD. If the operator intends to operate a restaurant business in the territory, a restaurant licence should be obtained from FEHD in accordance with the Public Health and Municipal Services Ordinance (Cap. 132). For the operation of other types of food business, relevant food licences should also be obtained from FEHD in accordance with Cap. 132. Under the Food Business Regulation, Cap. 132X, a Food Factory Licence should be obtained from this department for food business which involves the preparation of food for sale for human consumption off the premises before commencement of such business. The application for food business licences under Cap.132, if acceptable by FEHD, will be referred to relevant government departments for comment. If there is no objection from the departments concerned, a letter of requirements will be issued to the applicant for compliance and the licence will be issued upon compliance of all the requirements.
- iii. If the proposal involves any commercial/trading activities, no environmental nuisance should be generated to the surroundings. Also, for any waste generated from the commercial/trading activities, the applicant should handle on their own/at their expenses. Please also remind the applicant that the operation of the food business place must not cause any environmental nuisance to the surrounding. The refuse generated by the proposed eating place are regarded as trade refuse. The management or owner of the site is responsible for its removal and disposal at their expenses. The operation of any business should not cause any obstruction or environmental nuisance in the vicinity.

**Previous Applications at Portion of G/F, HK JEBN Group Centre,
13-15 Shing Wan Road, Tai Wai, New Territories**

Applications approved by the RNTPC

No.	Application No.	Application Premises (Unit)	Applied Use	Floor Area (m²) (about)	Date of Consideration	Approval Conditions
1.	A/ST/873	G/F (Portion)	Shop and Services	450	4.9.2015 (expired)	A1, A2, A3, A4
2.	A/ST/962	G/F (Portion)	Temporary Shop and Services for a Period of 5 years	448	19.10.2018	A1, A5, A6

Approval Conditions

- A1. Approved on a temporary basis for a period of 3 years
- A2. The submission of fire service installations proposal within 6 months from the date of planning approval to the satisfaction of the Director of Fire Services or of the Town Planning Board by 4.3.2016
- A3. In relation to A2 above, the provision of fire service installations within 9 months from the date of planning approval to the satisfaction of the Director of Fire Services or of the Town Planning Board by 4.6.2016
- A4. If any of the above planning conditions (a) or (b) (as stated in A2 and A3) is not complied with by the specified date, the approval hereby given shall cease to have effect and shall on the same date be revoked without further notice
- A5. The submission and implementation of the fire safety measures within 6 months from the date of the approval to the satisfaction of the Director of Fire Services or of the Town Planning Board by 19.4.2019
- A6. If the above planning condition (as stated in A5) is not complied with by the specified date, the approval hereby given shall cease to have effect and shall on the same date be revoked without further notice

**Similar Applications for Shop and Services on
G/F of Industrial Building in the same “I” Zone**

Applications approved by the RNTPC

No.	Application No.	Address	Applied Use	Floor Area (m²) (about)	Date of Consideration	Approval Conditions
1.	A/ST/785	Unit 9, G/F, Transport City Building, 1-7 Shing Wan Road, Sha Tin	Shop and Services (Bicycle Rental and Service Shop)*	172	24.8.2012 (revoked)	A1, A2, A3
2.	A/ST/827	Unit 9 (Part), G/F, Transport City Building, 1-7 Shing Wan Road, Tai Wai, Sha Tin	Shop and Services (Bicycle Repair and Storage)*	32	27.9.2013 (revoked)	A1, A4, A5, A6

* Application was revoked due to the non-compliance with approval condition by the specified date

Approval Conditions

A1. Approved on a temporary basis for a period of 3 years

A2. The submission and implementation of the fire safety measures within 6 months from the date of approval to the satisfaction of the Director of Fire Services or of the Town Planning Board by 24.2.2013

A3. If the above planning condition (a) (as stated in A2) above was not complied with by the specified date, the approval hereby given should cease to have effect and should on the same date be revoked without further notice

A4. The submission of the fire safety measures within 3 months from the date of planning approval to the satisfaction of the Director of Fire Services or of the Town Planning Board by 27.12.2013

A5. In relation to A4 above, the implementation of the fire safety measures within 6 months from the date of planning approval to the satisfaction of the Director of Fire Services or of the Town Planning Board by 27.3.2014

A6. If any of the above planning condition (a) or (b) (as stated in A4 and A5) is not complied with by the specified date, the approval hereby given shall cease to have effect and shall on the same date be revoked without further notice

Recommended Advisory Clauses

- (a) to note the comments of the Chief Building Surveyor/Hong Kong East & Heritage, Buildings Department that:
 - (i) adequate exit door with individual and total widths complying with the Code of Practice for Fire Safety in Building 2011 should be provided;
 - (ii) adequate provision of sanitary fitments should be provided for the proposed use; and
 - (iii) further detailed comments will be given at plan submission stage.
- (b) to note the comments of the Director of Food and Environmental Hygiene that:
 - (i) proper licence / permit issued by this Department is required if there is any food business / catering service / activities regulated by the Director of Food and Environmental Hygiene (DFEH) under the Public Health and Municipal Services Ordinance (Cap. 132) and other relevant legislation for the public. The operation of any eating place should be under a food licence issued by the FEHD. If the operator intends to operate a restaurant business in the territory, a restaurant licence should be obtained from FEHD in accordance with the Public Health and Municipal Services Ordinance (Cap. 132). For the operation of other types of food business, relevant food licences should also be obtained from FEHD in accordance with Cap. 132. Under the Food Business Regulation, Cap. 132X, a Food Factory Licence should be obtained from this department for food business which involves the preparation of food for sale for human consumption off the premises before commencement of such business. The application for food business licences under Cap.132, if acceptable by FEHD, will be referred to relevant government departments for comment. If there is no objection from the departments concerned, a letter of requirements will be issued to the applicant for compliance and the licence will be issued upon compliance of all the requirements; and
 - (ii) if the proposal involves any commercial/trading activities, no environmental nuisance should be generated to the surroundings. Also, for any waste generated from the commercial/trading activities, the applicant should handle on their own/at their expenses. Please also be reminded that the operation of the food business place must not cause any environmental nuisance to the surrounding. The refuse generated by the proposed eating place are regarded as trade refuse. The management or owner of the site is responsible for its removal and disposal at their expenses. The operation of any business should not cause any obstruction or environmental nuisance in the vicinity.