

LEGEND

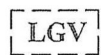

6.7m wide Vehicular Ingress/ Egress



Parking space for light goods vehicles
(7m (L) x 3.5(W))

Site Area: about 430.5m²

No.	Structure Use	Covered Area (about)	Floor Area (about)	Height	No. of Storeys
1.	G/F: Greenhouse for Plant Showroom and Nursery	84m ²	84m ²	7m	2
	U/F: Greenhouse for Plant Showroom and Nursery		15m ²		
2	G/F: Agricultural Storeroom	50m ²	50m ²	7m	2
	U/F: Agricultural Storeroom		37m ²		
3	Open Shed for Rain Shelter	20m ²	20m ²	2.6m	1
4	Pantry	7m ²	7m ²	3m	1
5	Toilet	13m ²	13m ²	3m	1
6	Open Shed for Rain Shelter	14m ²	14m ²	3m	1
7	Open Shed for Rain Shelter	12m ²	12m ²	7m	1
Total:		200m ²	252m ²		

1:250	Layout Plan Lots 335 S.B, 337 (part) in D.D. 128 and adjoining Government Land Yuen Long, New Territories	Goldrich Planners & Surveyors Ltd.
July 2023		Plan 3 (P 15129)

(摘錄自申請人於 11.7.2023 呈交的申請書)
(Extract from Applicant's
Submission of 11.7.2023)

參考編號

REFERENCE No.

A/YL-HTF/1156

繪圖 DRAWING

A-1

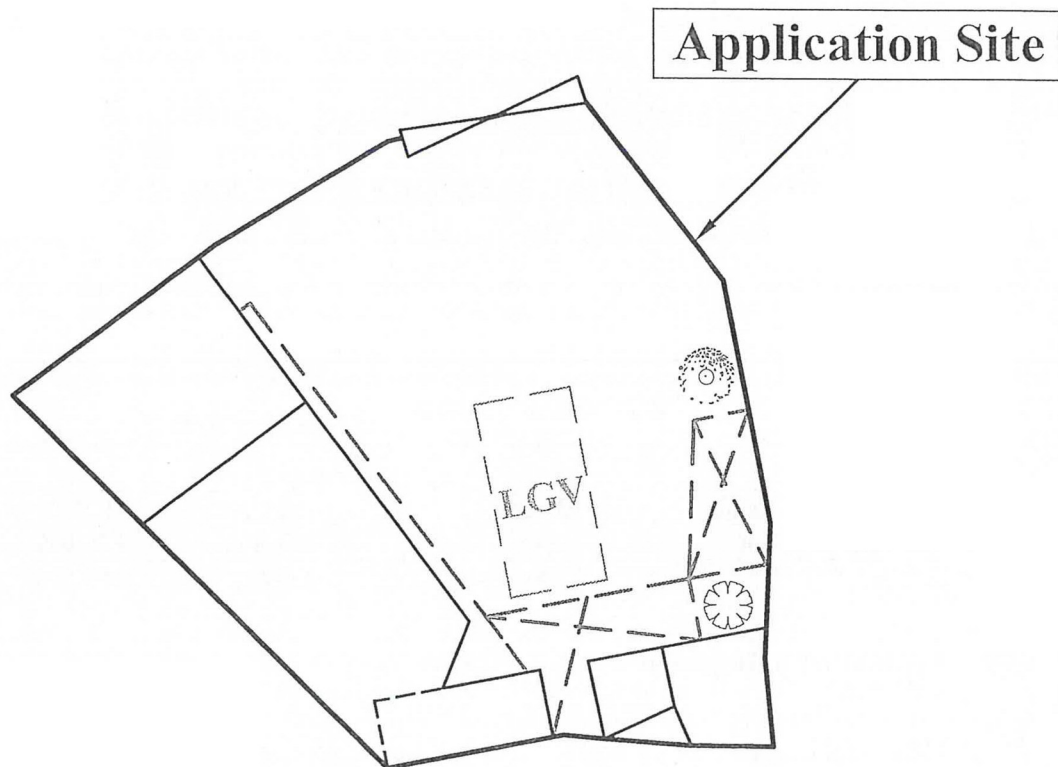

	Min. Size (Height)	Quantity
 Existing Podocarpus Macrophyllus (羅漢松)	2.75m	1
 Proposed Bauhinia Blakeana (洋紫荊)	2.75m	1
1:250	Tree Preservation and Landscape Proposal Lots 335 S.B, 337 (part) in D.D. 128 and adjoining Government Land Yuen Long, New Territories	Goldrich Planners & Surveyors Ltd.
July 2023		Plan 6 (P 15129)

(摘錄自申請人於 11.7.2023 呈交的申請書)
(Extract from Applicant's Submission of 11.7.2023)

參考編號
 REFERENCE No.
A/YL-HTF/1156

繪圖 DRAWING
A-2

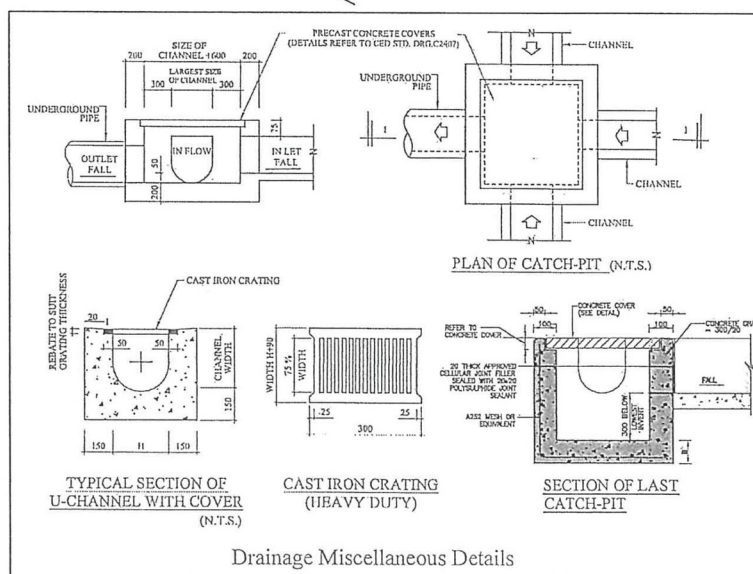
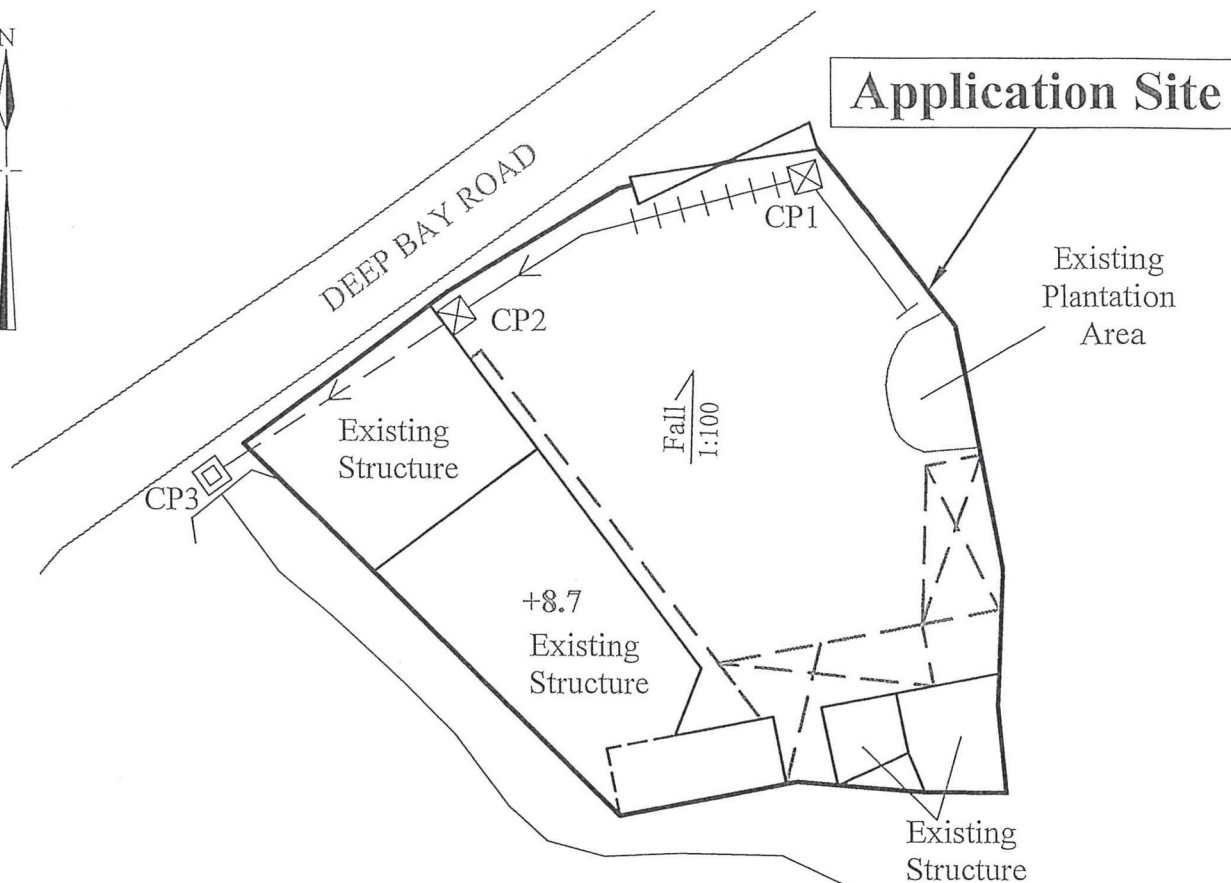

Legend:

-  Proposed Last Catch-pit
-  Proposed Catch-pit
-  Proposed 250mm U-Channel
-  Proposed 250mm U-Channel
-  Proposed 250mm U-Channel with C.I. cover

Note: According to the Technical Note to Prepare a Drainage Submission by DSD of November 2001 (p.6), 225mm is the acceptable size of U-channels within catchment area between 500m² and 1,200m².

Site Area: about 430.5m²

Catch-pit No.	G.L.(mP.D.)	I.L.(mP.D.)
CP 1	+ 8.7	+ 8.43
CP 2	+ 8.7	+ 8.31
CP 3	+ 8.7	+ 8.22

1:250	Drainage Proposal	Goldrich Planners & Surveyors Ltd.
July 2023	Lots 335 S.B, 337 (part) in D.D. 128 and adjoining Government Land Yuen Long, New Territories	Plan 4 (P 15129)

(摘錄自申請人於 11.7.2023 呈交的申請書)
(Extract from Applicant's
Submission of 11.7.2023)

參考編號
REFERENCE No.
AYL-HTF/1156

繪圖 DRAWING
A-3

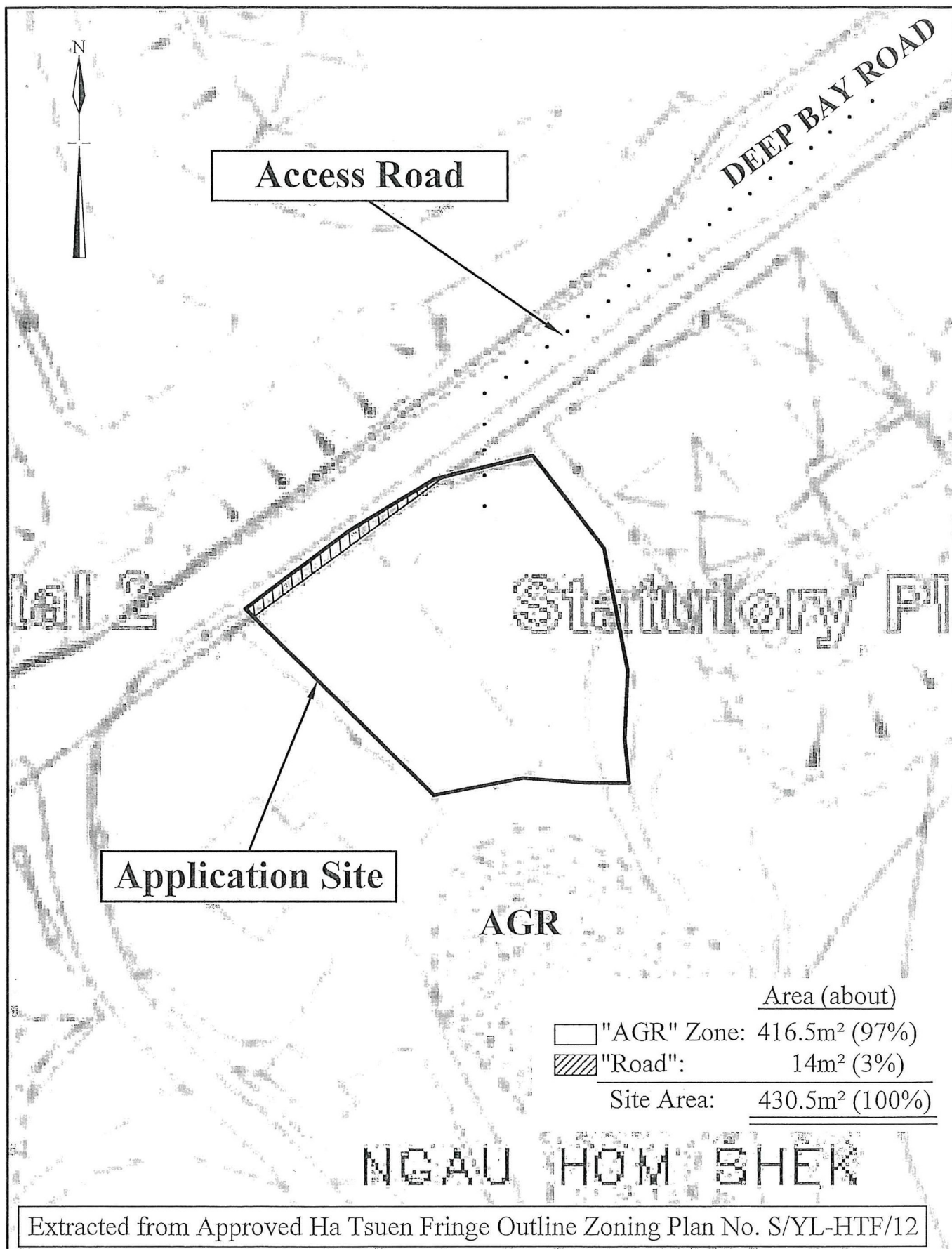

Extracted from Approved Ha Tsuen Fringe Outline Zoning Plan No. S/YL-HTF/12

N.T.S	Location Plan Lots 335 S.B, 337 (part) in D.D. 128 and adjoining Government Land Yuen Long, New Territories	Goldrich Planners & Surveyors Ltd.
July 2023		Plan 1 (P15129)

(摘錄自申請人於 11.7.2023 呈交的申請書)
(Extract from Applicant's
Submission of 11.7.2023)

參考編號
REFERENCE No.
A/YL-HTF/1156

繪圖 DRAWING
A-4

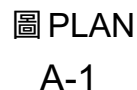
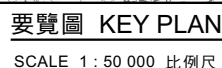

本摘要圖於2023年8月29日擬備，
所根據的資料為於2018年10月16日
核准的分區計劃大綱圖編號 S/YL-HTF/12
EXTRACT PLAN PREPARED ON 29.8.2023
BASED ON OUTLINE ZONING PLAN No.
S/YL-HTF/12 APPROVED ON 16.10.2018

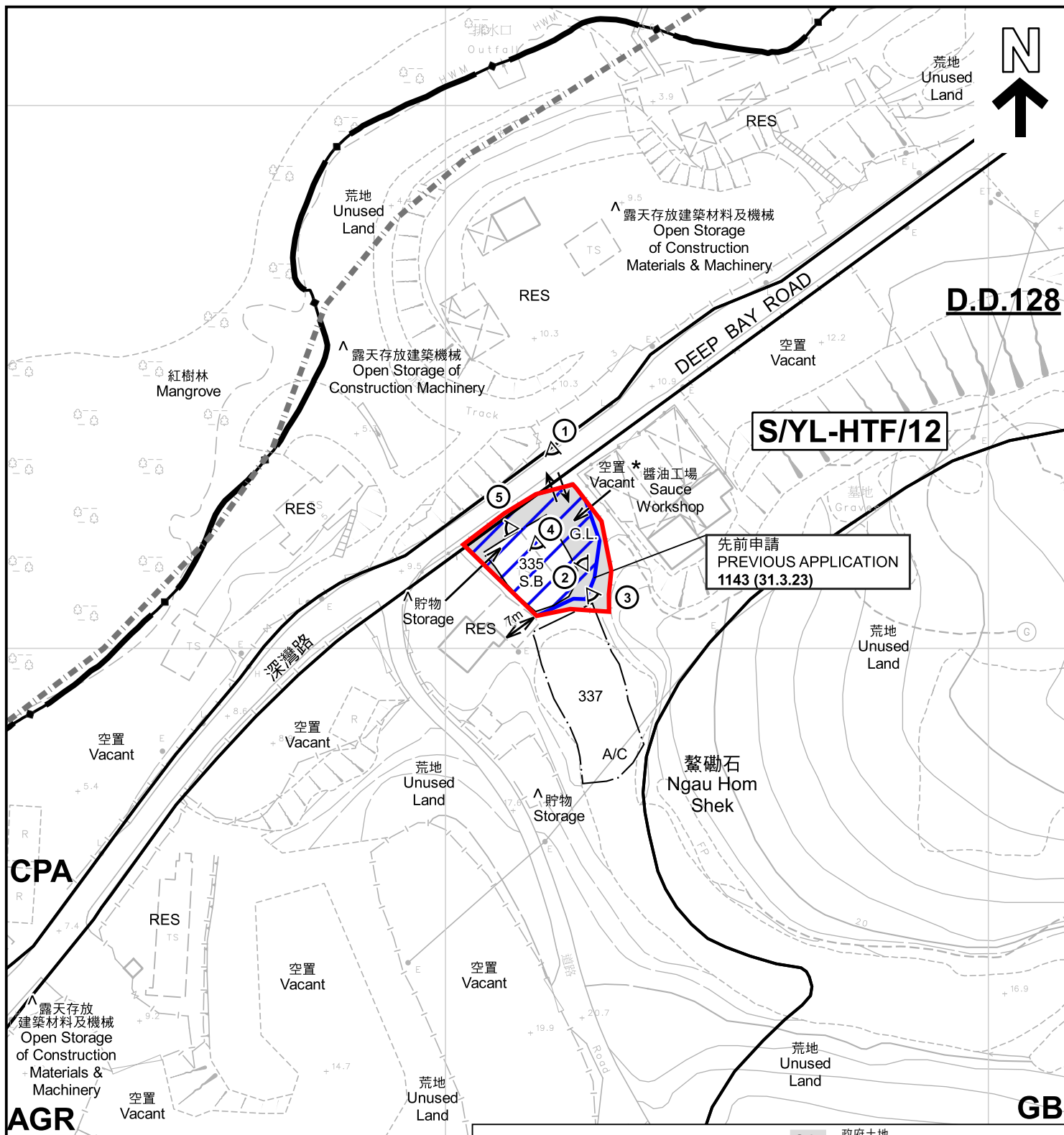

註釋 Notes:

- (1) 2023年7月25日勘測的土地用途
Land uses shown on this plan are in accordance with the land use survey conducted by the Planning Department on 25.7.2023
- (2) * 土地用途跟1992年3月勘測的土地用途一致
Indicates that the use is the same as that revealed by the land use survey conducted by the Planning Department in Mar 1992
- (3) ^ 土地用途跟1992年3月勘測的土地用途有別
Indicates that the use is different from that revealed by the land use survey conducted by the Planning Department in Mar 1992

圖例 LEGEND

- 申請地點 (界線只作識別用)
APPLICATION SITE (BOUNDARY FOR IDENTIFICATION PURPOSE ONLY)
- AGR 農業
AGRICULTURE
- GB 綠化地帶
GREEN BELT
- CPA 海岸保護區
COASTAL PROTECTION AREA

- G.L. 政府土地
GOVERNMENT LAND
- RES 住用構築物
RESIDENTIAL STRUCTURES
- A/C 常耕農地
CULTIVATED AGRICULTURAL LAND
- 丈量約份界線
D.D. BOUNDARY
- 實地照片的觀景點
VIEWING POINT OF SITE PHOTO
- 入口/出口
INGRESS / EGRESS

平面圖 SITE PLAN

擬議臨時商店及服務行業 (植物陳列室) 及植物苗圃連附屬設施 (為期3年)
PROPOSED TEMPORARY SHOP AND SERVICES (PLANT SHOWROOM)
AND PLANT NURSERY WITH ANCILLARY FACILITIES
FOR A PERIOD OF 3 YEARS
LOTS 335 S.B AND 337 (PART) IN D.D. 128 AND
ADJOINING GOVERNMENT LAND, YUEN LONG, NEW TERRITORIES
SCALE 1:1 000 比例尺

米 20 0 20 40 米
METRES

規劃署
PLANNING
DEPARTMENT



參考編號
REFERENCE No.
A/YL-HTF/1156

圖 PLAN
A-2

本摘要圖於2023年8月30日擬備, 所根據的
資料為測量圖編號 6-NW-1C
EXTRACT PLAN PREPARED ON 30.8.2023
BASED ON SURVEY SHEET No.
6-NW-1C



后海灣
(深圳灣)
DEEP BAY
(SHENZHEN WAN)

DEEP BAY ROAD

深灣路

鰲磡石
Ngau Hom
Shek

SHENZHEN BAY BRIDGE
深圳灣公路大橋

圖例 LEGEND



申請地點(界線只作識別用)
APPLICATION SITE
(BOUNDARY FOR IDENTIFICATION
PURPOSE ONLY)

航攝照片 AERIAL PHOTO

本摘要圖於2023年8月22日擬備，所根據的資料為地政總署於2022年3月8日拍得的航攝照片編號 E152768C
EXTRACT PLAN PREPARED ON 22.8.2023
BASED ON AERIAL PHOTO No.
E152768C TAKEN ON 8.3.2022
BY LANDS DEPARTMENT

擬議臨時商店及服務行業(植物陳列室)及植物苗圃連附屬設施(為期3年)
新界元朗丈量約份第128約地段第335號B分段及第337號(部分)和毗連政府土地
PROPOSED TEMPORARY SHOP AND SERVICES (PLANT SHOWROOM)
AND PLANT NURSERY WITH ANCILLARY FACILITIES
FOR A PERIOD OF 3 YEARS
LOTS 335 S.B AND 337 (PART) IN D.D. 128 AND
ADJOINING GOVERNMENT LAND, YUEN LONG, NEW TERRITORIES

規劃署
PLANNING
DEPARTMENT



參考編號
REFERENCE No.
A/YL-HTF/1156

圖 PLAN
A-3

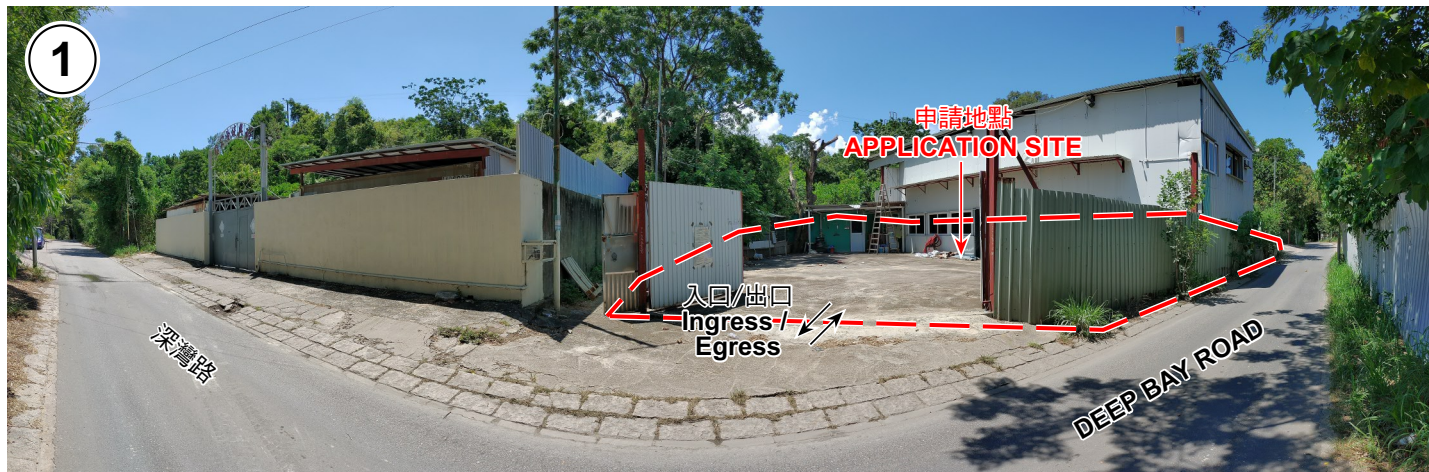

申請地點界線只作識別用 APPLICATION SITE BOUNDARY FOR IDENTIFICATION PURPOSE ONLY

實地照片 SITE PHOTOS

本圖於2023年8月22日擬備，所根據的資料為攝於2023年7月25日的實地照片
PLAN PREPARED ON 22.8.2023
BASED ON SITE PHOTOS
TAKEN ON 25.7.2023

擬議臨時商店及服務行業（植物陳列室）及植物苗圃連附屬設施（為期3年）
新界元朗丈量約份第128約地段第335號B分段及第337號（部分）和毗連政府土地
PROPOSED TEMPORARY SHOP AND SERVICES (PLANT SHOWROOM)
AND PLANT NURSERY WITH ANCILLARY FACILITIES
FOR A PERIOD OF 3 YEARS
LOTS 335 S.B AND 337 (PART) IN D.D. 128 AND
ADJOINING GOVERNMENT LAND, YUEN LONG, NEW TERRITORIES

規 劃 署
PLANNING
DEPARTMENT



參考編號
REFERENCE No.
A/YL-HTF/1156

圖 PLAN
A-4a



實地照片 SITE PHOTOS

擬議臨時商店及服務行業（植物陳列室）及植物苗圃連附屬設施（為期3年）
 新界元朗丈量約份第128約地段第335號B分段及第337號（部分）和毗連政府土地
 PROPOSED TEMPORARY SHOP AND SERVICES (PLANT SHOWROOM)
 AND PLANT NURSERY WITH ANCILLARY FACILITIES
 FOR A PERIOD OF 3 YEARS
 LOTS 335 S.B AND 337 (PART) IN D.D. 128 AND
 ADJOINING GOVERNMENT LAND, YUEN LONG, NEW TERRITORIES

規劃署
 PLANNING
 DEPARTMENT



參考編號
 REFERENCE No.
 A/YL-HTF/1156

圖 PLAN
 A-4b

本圖於2023年8月22日擬備，所根據的
 資料為攝於2023年7月25日的實地照片
 PLAN PREPARED ON 22.8.2023
 BASED ON SITE PHOTOS
 TAKEN ON 25.7.2023