

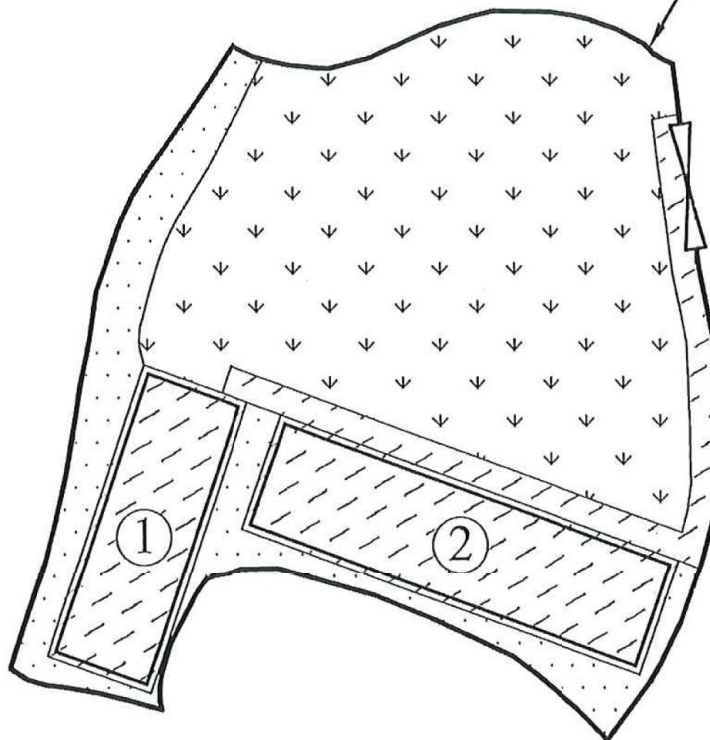

Application Site



Legend



Pedestrian Access



Farm Area (1,029m², 55%)



Unpaved Area (280m², 15%)



Paved Area (578m², 30%)

Site Area: 1,887m² (about)

No.	Structure / Use	Covered Area	Floor Area	Height
1	Reception, Office, Changing Room and Seating Room	147m ²	147m ²	4.5m
2	Storage of farming tools, materials and crops, Works Area and Agricultural Education Room	228m ²	228m ²	4.5m
Total:		375m ²	375m ²	
—1:500—		Layout Plan		Goldrich Planners & Surveyors Ltd.
February 2021		Lot 1353 in D. D. 109		Plan 3b (P 20084)

(摘錄自申請人於30. 3. 2021呈交的進一步資料)
(Extract from Applicant's Further
Information Submitted on 30.3.2021)

參考編號

REFERENCE No.

A/YL-KTN/746

繪圖 DRAWING

A-1

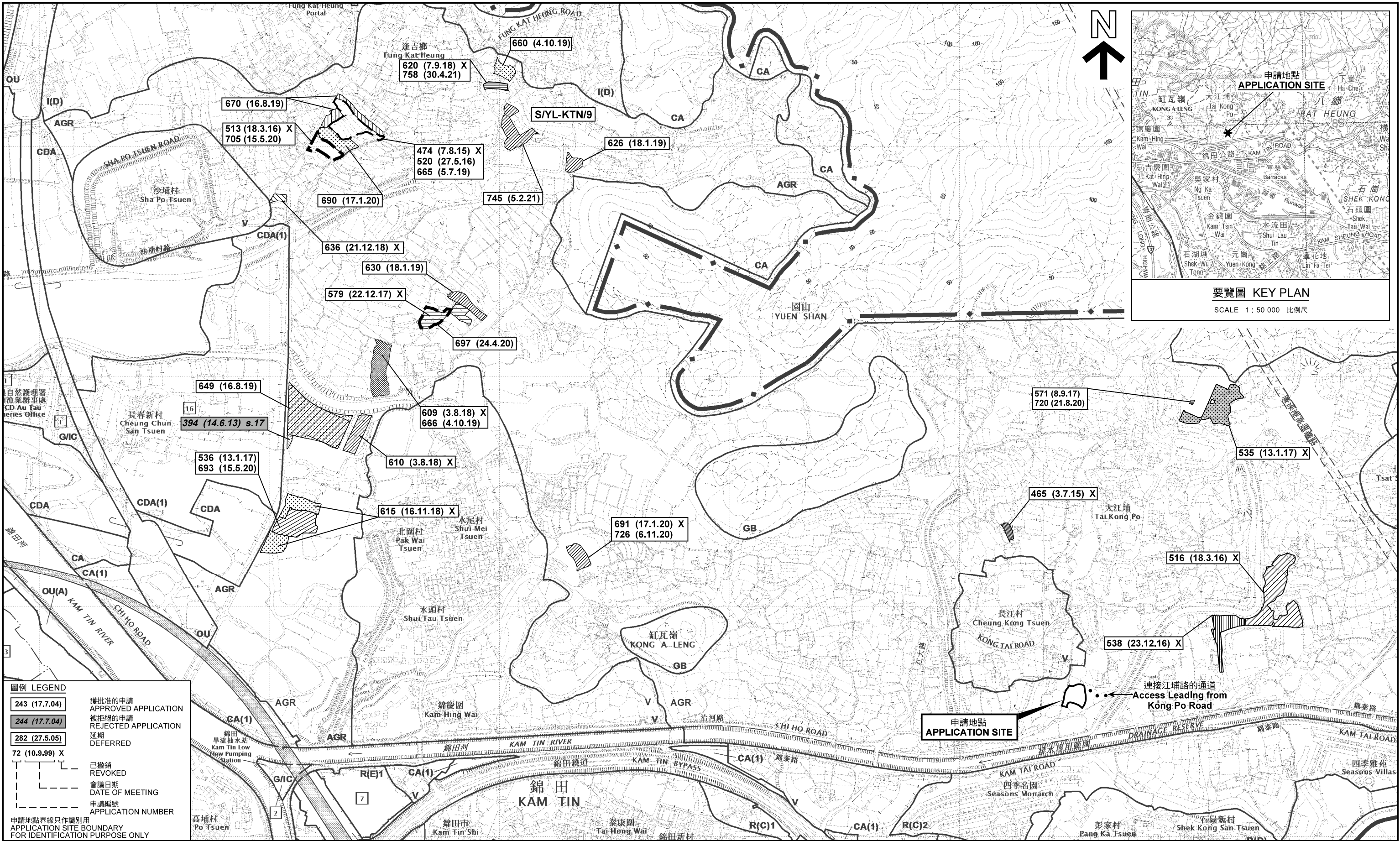

規劃署
PLANNING DEPARTMENT



參考編號 REFERENCE No.
A/YL-KTN/746

圖 PLAN
A-1

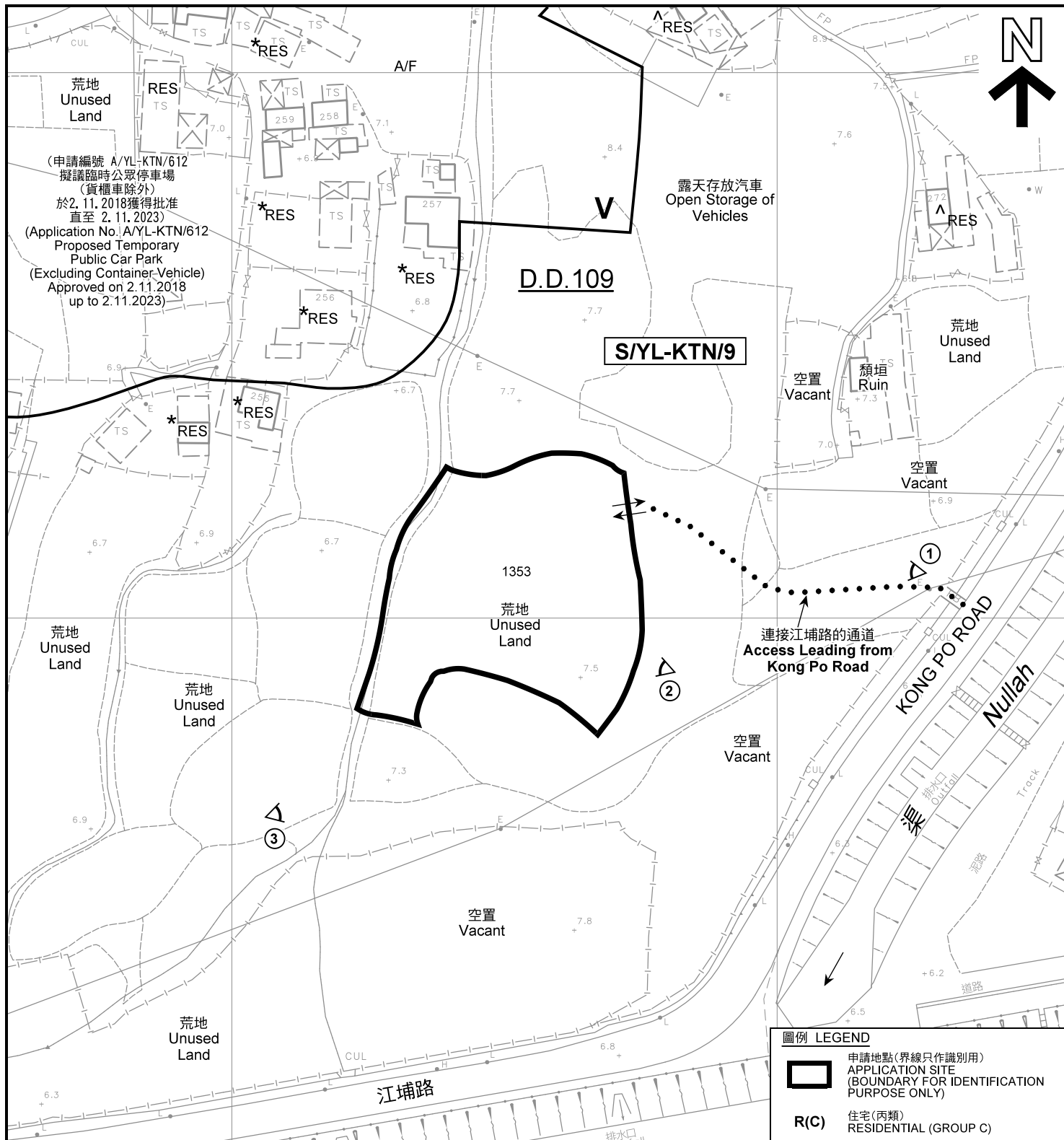

註釋 Notes :

- (1) 2021年5月11日勘測的土地用途
Land uses shown on this plan are in accordance with the land use survey conducted by the Planning Department on 11.5.2021
- (2) * 土地用途跟1992年2月勘測的土地用途一致
Indicates that the use is the same as that revealed by the land use survey conducted by the Planning Department in Feb 1992
- (3) ^ 土地用途跟1992年2月勘測的土地用途有別
Indicates that the use is different from that revealed by the land use survey conducted by the Planning Department in Feb 1992

平面圖 SITE PLAN

擬議臨時康體文娛場所 (休閒農場) (為期 3 年)
新界元朗丈量約份第109約地段第1353號
PROPOSED TEMPORARY PLACE OF RECREATION,
SPORTS OR CULTURE (HOBBY FARM)
FOR A PERIOD OF 3 YEARS
LOT 1353 IN D.D. 109, YUEN LONG, NEW TERRITORIES

SCALE 1 : 1 000 比例尺

米 20 0 20 40 米
METRES

圖例 LEGEND

- 申請地點(界線只作識別用)
APPLICATION SITE
(BOUNDARY FOR IDENTIFICATION
PURPOSE ONLY)
- R(C) 住宅(丙類)
RESIDENTIAL (GROUP C)
- V 鄉村式發展
VILLAGE TYPE DEVELOPMENT
- AGR 農業
AGRICULTURE
- RES 住用構築物
RESIDENTIAL STRUCTURES
- A/F 休耕農地
FALLOW AGRICULTURAL LAND
- ① 實地照片的觀景點
VIEWING POINT OF SITE PHOTO
- 入口/出口
INGRESS / EGRESS

規劃署
PLANNING
DEPARTMENT



參考編號
REFERENCE No.
A/YL-KTN/746

圖 PLAN
A-2



圖例 LEGEND



申請地點(界線只作識別用)
APPLICATION SITE
(BOUNDARY FOR IDENTIFICATION
PURPOSE ONLY)

本摘要圖於2021年5月7日擬備，所根據
的資料為地政總署於2020年11月25日拍得
的航攝照片編號 E105141C
EXTRACT PLAN PREPARED ON 7.5.2021
BASED ON AERIAL PHOTO No.
E105141C TAKEN ON 25.11.2020
BY LANDS DEPARTMENT

航攝照片 AERIAL PHOTO

擬議臨時康體文娛場所(休閒農場)(為期3年)
新界元朗丈量約份第109約地段第1353號
PROPOSED TEMPORARY PLACE OF RECREATION,
SPORTS OR CULTURE (HOBBY FARM)
FOR A PERIOD OF 3 YEARS
LOT 1353 IN D.D. 109, YUEN LONG, NEW TERRITORIES

規 劃 署
PLANNING
DEPARTMENT



參考編號
REFERENCE No.
A/YL-KTN/746

圖 PLAN
A-3



申請地點界線只作識別用 APPLICATION SITE BOUNDARY FOR IDENTIFICATION PURPOSE ONLY

實地照片 SITE PHOTOS

擬議臨時康體文娛場所（休閒農場）（為期 3 年）
 新界元朗丈量約份第109約地段第1353號
 PROPOSED TEMPORARY PLACE OF RECREATION,
 SPORTS OR CULTURE (HOBBY FARM)
 FOR A PERIOD OF 3 YEARS
 LOT 1353 IN D.D. 109, YUEN LONG, NEW TERRITORIES

規劃署
 PLANNING
 DEPARTMENT



參考編號
 REFERENCE No.
 A/YL-KTN/746

圖 PLAN
 A-4

本圖於2021年5月17日擬備，所根據的資料為攝於2021年5月12日的實地照片
 PLAN PREPARED ON 17.5.2021
 BASED ON SITE PHOTOS
 TAKEN ON 12.5.2021