

DEVELOPMENT PARAMETERS OF THE APPLICATION SITE

APPLICATION SITE AREA	: 3,565m ² (ABOUT)
COVERED AREA	: 332m ² (ABOUT)
UNCOVERED AREA	: 3,233m ² (ABOUT)
PLOT RATIO	: 0.09 (ABOUT)
SITE COVERAGE	: 9% (ABOUT)
NO. OF STRUCTURE	: 6
DOMESTIC GFA	: NOT APPLICABLE
NON-DOMESTIC GFA	: 332m ² (ABOUT)
BUILDING HEIGHT	: 2.8 TO 4.5m (ABOUT)
NO. OF STOREY	: 1

STRUCTURE	USE	COVERED AREA	GFA	BUILDING HEIGHT
B1	SITE OFFICE, MEETING ROOM AND COVERED CAR PARKING SPACES	197m ² (ABOUT)	197m ² (ABOUT)	4.5m (ABOUT)(1-STOREY)
B2	PORTABLE TOILET	9m ² (ABOUT)	9m ² (ABOUT)	3m (ABOUT)(1-STOREY)
B3	GREENHOUSE	54m ² (ABOUT)	54m ² (ABOUT)	3m (ABOUT)(1-STOREY)
B4	GREENHOUSE	54m ² (ABOUT)	54m ² (ABOUT)	3m (ABOUT)(1-STOREY)
B5*	STORAGE OF FERTILIZER & FARM TCOLS	15m ² (ABOUT)	15m ² (ABOUT)	2.8m (ABOUT)(1-STOREY)
B6	GUARDROOM	3m ² (ABOUT)	3m ² (ABOUT)	2.8m (ABOUT)(1-STOREY)
TOTAL		332m ² (ABOUT)	332m ² (ABOUT)	

*STRUCTURE B5 IS A CONTAINER-CONVERTED STRUCTURE

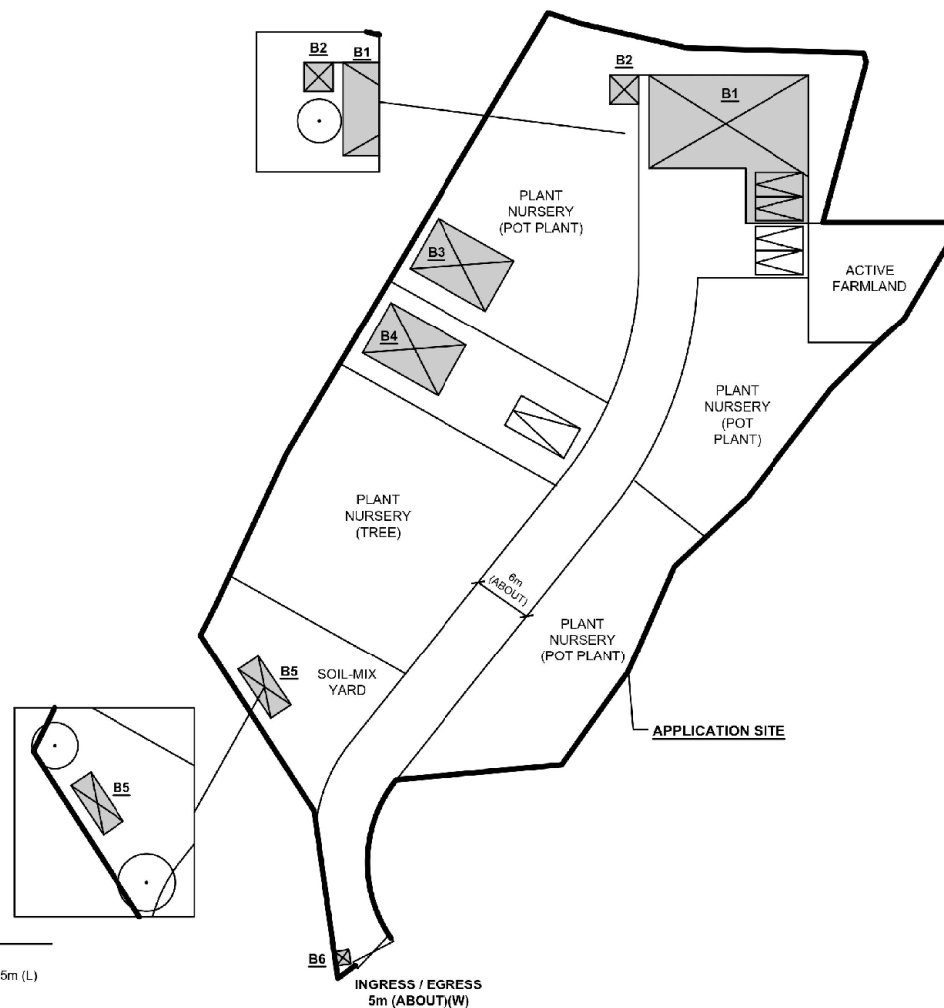
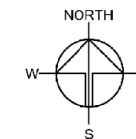

PARKING PROVISIONS

NO. OF PRIVATE CAR PARKING SPACE	: 4
DIMENSION OF PARKING SPACE	: 2.5m (W) X 5m (L)
NO. OF LULG SPACE FOR LGV	: 1
DIMENSION OF PARKING SPACE	: 3.5m (W) X 7m (L)

LEGEND

	APPLICATION SITE
	STRUCTURE
	PARKING SPACE
	INGRESS / EGRESS
	EXISTING TREE

Drawing No.	Ver.
PLAN 1	02
Project	
PROPOSED TEMPORARY OFFICE FOR PERMITTED AGRICULTURAL USE FOR A PERIOD OF 3 YEARS AND LAND FILLING	
VARIOUS LOTS IN D.D. 110, KAM TIN, YUEN LONG, NEW TERRITORIES	
Drawing Title	
LAYOUT PLAN	
Scale of A4	
1:700	
Drawn	Date
	25.1.2021
Revised	Date
	27.4.2021

(摘錄自申請人於7.5.2021呈交的進一步資料)
(Extract from Applicant's Further Information Submitted on 7.5.2021)

參考編號
REFERENCE No.
A/YL-KTN/760

繪圖 DRAWING
A-1

PAVED RATIO OF THE APPLICATION SITE

APPLICATION SITE AREA : 3,565m² (ABOUT)

SOILED GROUND AREA : 2,714m² (76%)(ABOUT)

- FOR CIRCULATION SPACE, FARMLAND, PLANT NURSERIES AND SOIL-MIX YARD

LAND FILLING AREA : 851m² (24%)(ABOUT)

- FOR SITE FORMATION OF STRUCTURE, CIRCULATION AND PARKING SPACES

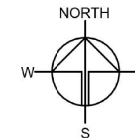
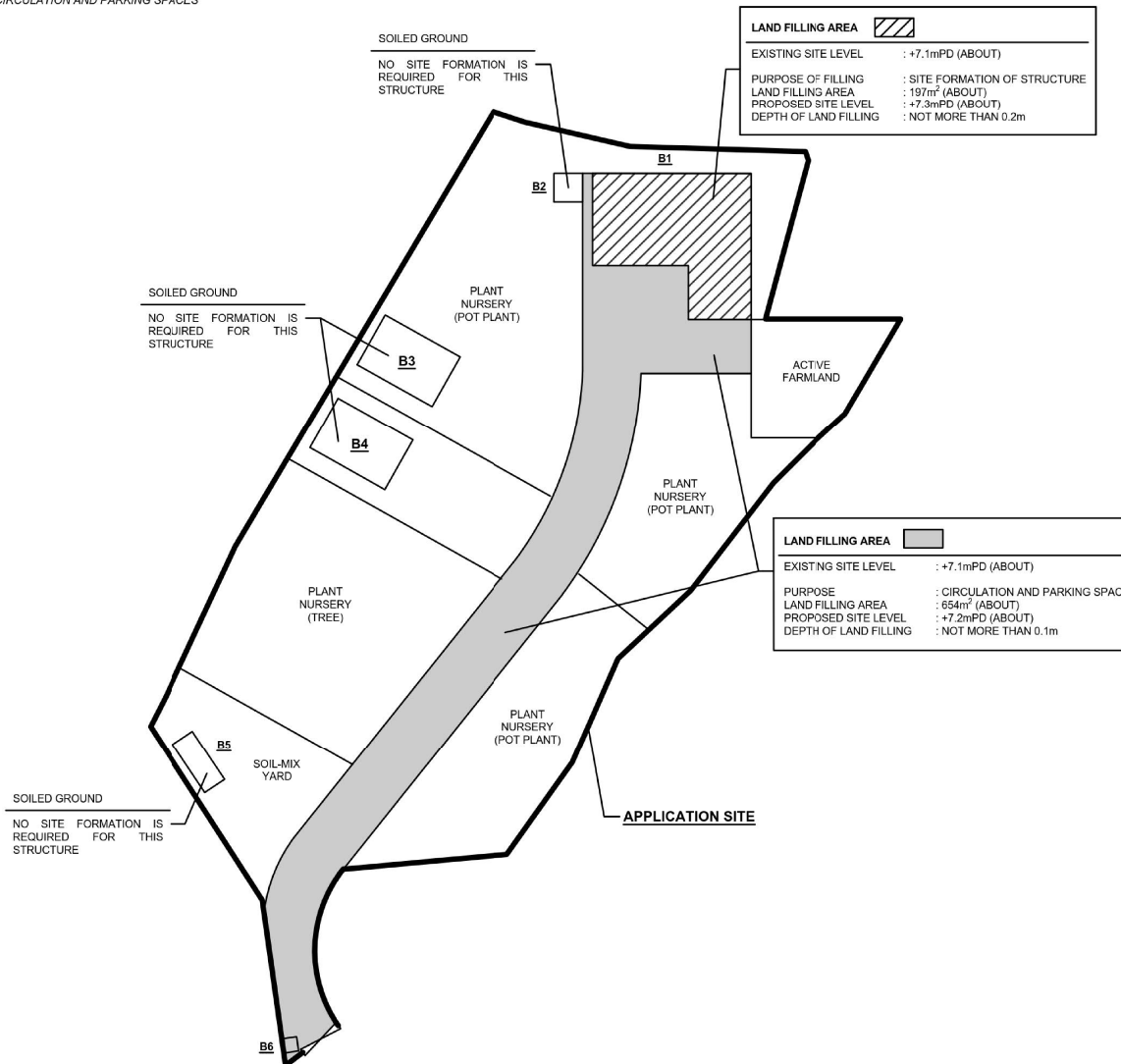

Drawing No. **PLAN 1** Ver. **03**

Project
PROPOSED TEMPORARY
OFFICE FOR PERMITTED
AGRICULTURAL USE FOR A
PERIOD OF 3 YEARS AND
LAND FILLING

VARIOUS LOTS IN D.D. 110,
KAM TIN, YUEN LONG, NEW
TERRITORIES

Drawing Title
PAVED RATIO OF THE SITE

Scale of A4

1:700

Drawn	Date
	9.3.2021
Revised	Date
	10.5.2021

LEGEND

- STRUCTURE
- ▤ INGRESS / EGRESS

(摘錄自申請人於10. 5. 2021呈交的進一步資料)
(Extract from Applicant's Further
Information Submitted on 10.5.2021)

參考編號
REFERENCE No.
A/YL-KTN/760

繪圖 **DRAWING**
A-2

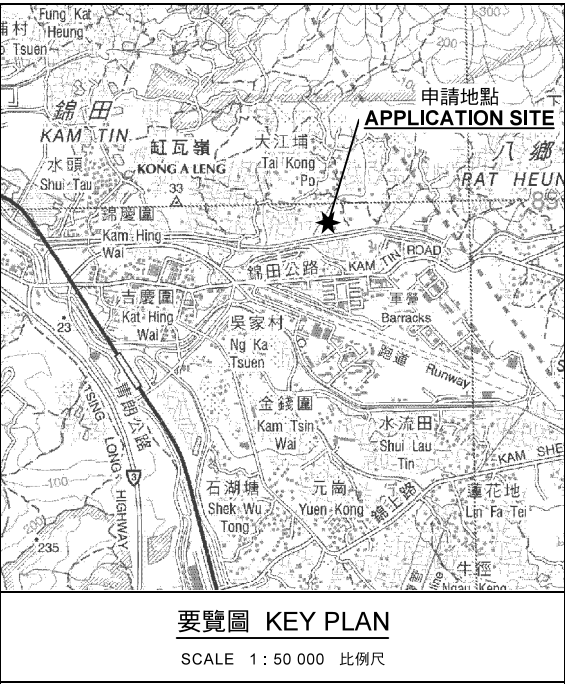
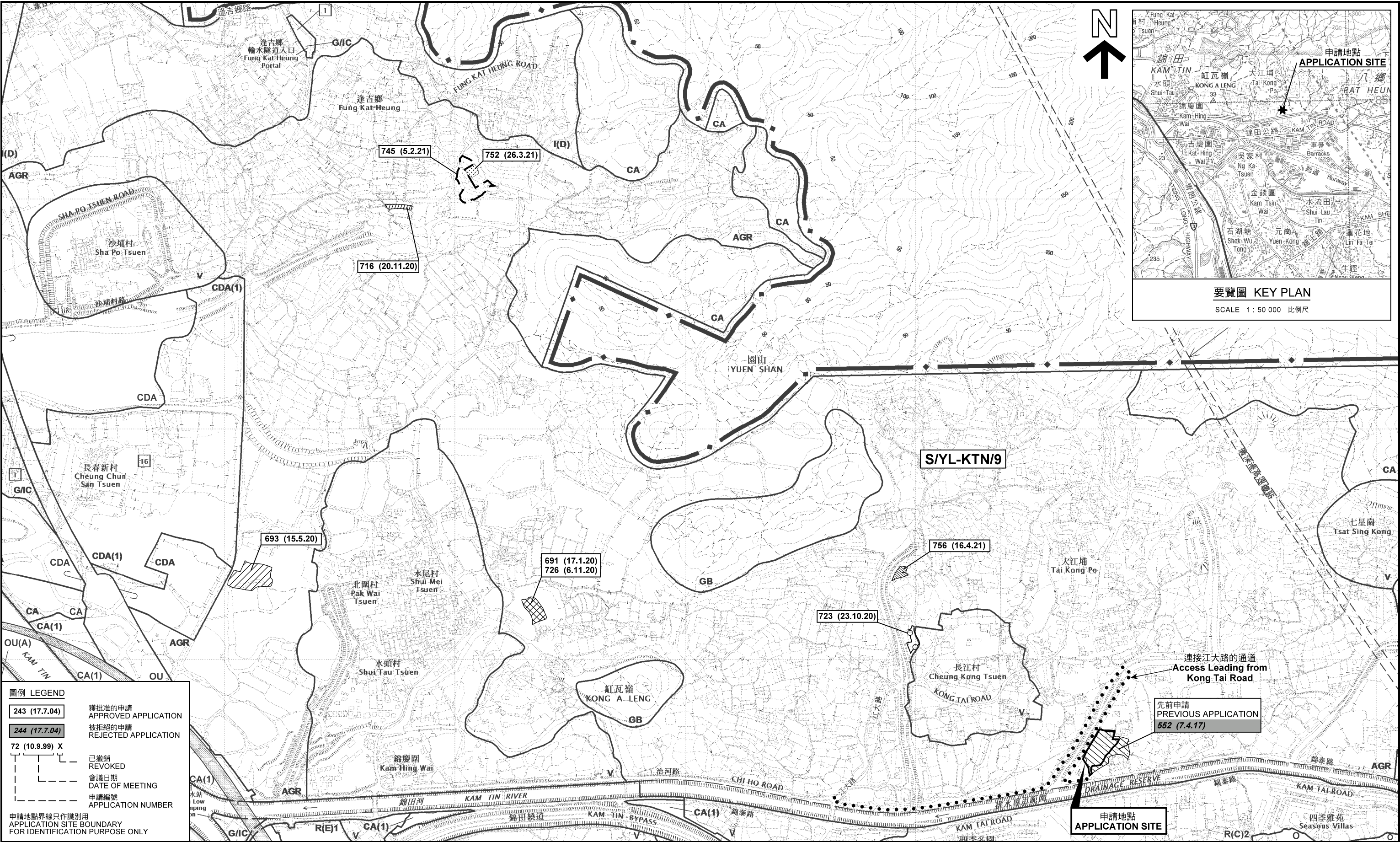

圖例 LEGEND

243 (17.7.04)	獲批准的申請 APPROVED APPLICATION
244 (17.7.04)	被拒絕的申請 REJECTED APPLICATION
72 (10.9.99) X	已撤銷 REVOKED
---	會議日期 DATE OF MEETING
---	申請編號 APPLICATION NUMBER

申請地點界線只作識別用
APPLICATION SITE BOUNDARY
FOR IDENTIFICATION PURPOSE ONLY

位置圖及同類申請 LOCATION PLAN WITH SIMILAR APPLICATIONS

擬議臨時辦公室以作准許的農業用途（為期 3 年）及填土
新界元朗錦田丈量約份第110約地段第84號（部分）、第85號A分段餘段（部分）、
第85號C分段（部分）、第86號餘段（部分）及第113號（部分）
PROPOSED TEMPORARY OFFICE FOR PERMITTED AGRICULTURAL USE
FOR A PERIOD OF 3 YEARS AND FILLING OF LAND
LOTS 84 (PART), 85 S.A RP (PART), 85 S.C (PART), 86 RP (PART)
AND 113 (PART) IN D.D. 110, KAM TIN, YUEN LONG, N.T.

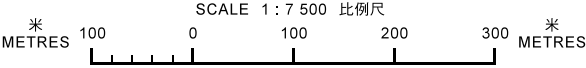

規劃署 PLANNING DEPARTMENT		
參考編號 REFERENCE No. A/YL-KTN/760	圖 PLAN A-1	

本摘要圖於2021年4月29日擬備，
所根據的資料為於2014年12月2日
核准的分區計劃大綱圖編號 S/YL-KTN/9
EXTRACT PLAN PREPARED ON 29.4.2021
BASED ON OUTLINE ZONING PLAN No.
S/YL-KTN/9 APPROVED ON 2.12.2014

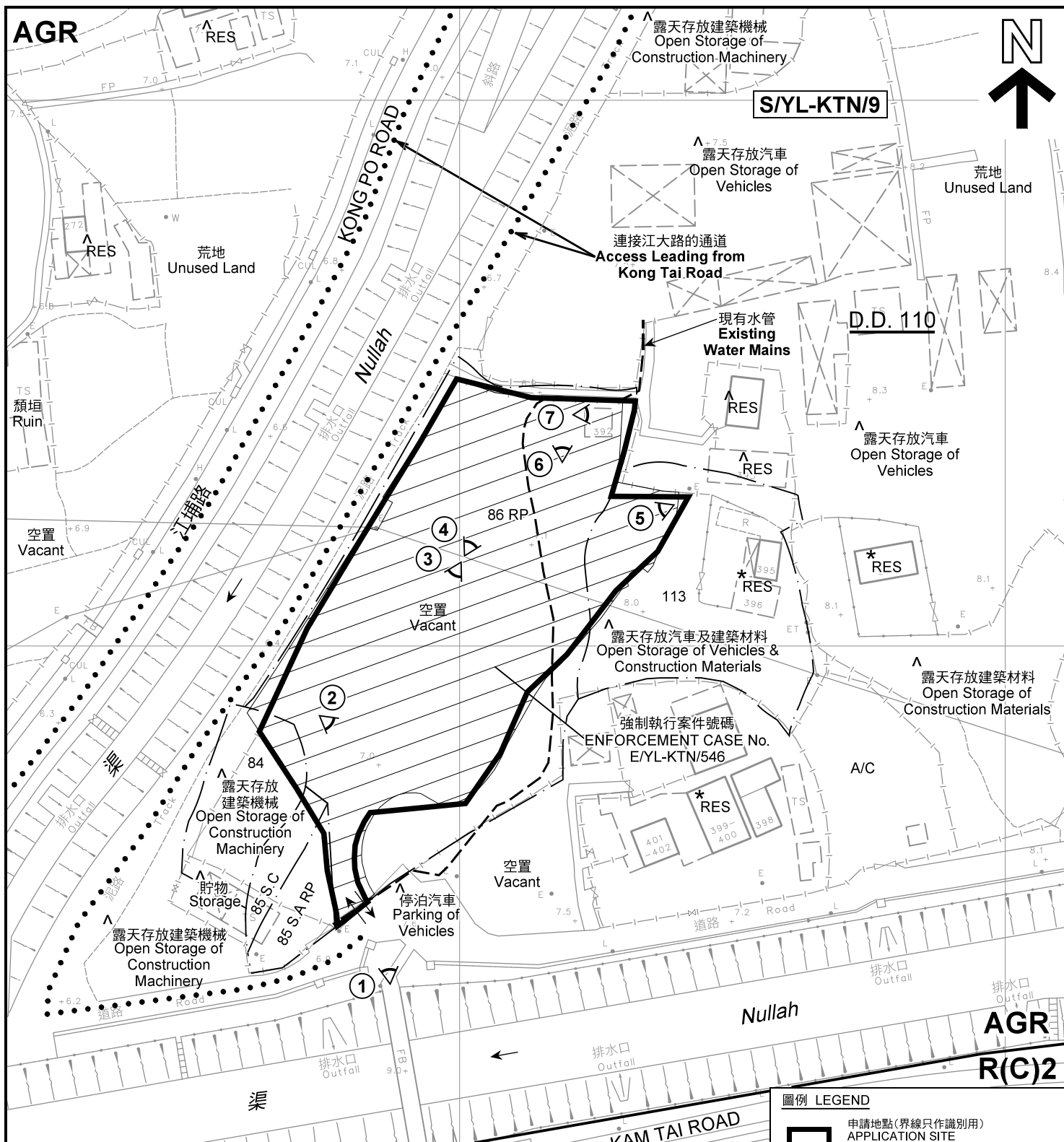

註釋 Notes :

- (1) 2021年3月23日及4月29日勘測的土地用途
Land uses shown on this plan are in accordance with the land use survey conducted by the Planning Department on 23.3.2021 & 29.4.2021
- (2) * 土地用途跟1992年2月勘測的土地用途一致
Indicates that the use is the same as that revealed by the land use survey conducted by the Planning Department in Feb 1992
- (3) ^ 土地用途跟1992年2月勘測的土地用途有別
Indicates that the use is different from that revealed by the land use survey conducted by the Planning Department on in Feb 1992

本摘要圖於2021年4月29日擬備，所根據的資料為測量圖編號 6-NE-8C
EXTRACT PLAN PREPARED ON 29.4.2021
BASED ON SURVEY SHEET No. 6-NE-8C

平面圖 SITE PLAN

擬議臨時辦公室以作准許的農業用途（為期 3 年）及填土
新界元朗錦田丈量約份第110約地段第84號（部分）、第85號A分段餘段（部分）、
第85號C分段（部分）、第86號餘段（部分）及第113號（部分）
PROPOSED TEMPORARY OFFICE FOR PERMITTED AGRICULTURAL USE
FOR A PERIOD OF 3 YEARS AND FILLING OF LAND
LOTS 84 (PART), 85 S.A RP (PART), 85 S.C (PART), 86 RP (PART)
AND 113 (PART) IN D.D. 110, KAM TIN, YUEN LONG, N.T.

SCALE 1 : 1 000 比例尺
米 METRES 20 0 20 40 米 METRES

圖例 LEGEND

- 申請地點(界線只作識別用)
APPLICATION SITE (BOUNDARY FOR IDENTIFICATION PURPOSE ONLY)
- R(C) 住宅(丙類)
RESIDENTIAL (GROUP C)
- AGR 農業
AGRICULTURE
- RES 住用構築物
RESIDENTIAL STRUCTURES
- A/C 常耕農地
CULTIVATED AGRICULTURAL LAND
- ① 實地照片的觀景點
VIEWING POINT OF SITE PHOTO
- 入口/出口
INGRESS / EGRESS

規劃署
PLANNING
DEPARTMENT



參考編號
REFERENCE No.
A/YL-KTN/760

圖 PLAN
A-2



圖例 LEGEND



申請地點(界線只作識別用)
APPLICATION SITE
(BOUNDARY FOR IDENTIFICATION
PURPOSE ONLY)

本摘要圖於2021年4月20日擬備，所根據的資料為地政總署於2020年11月25日拍得的航攝照片編號 E105141C
EXTRACT PLAN PREPARED ON 20.4.2021
BASED ON AERIAL PHOTO No.
E105141C TAKEN ON 25.11.2020
BY LANDS DEPARTMENT

航攝照片 AERIAL PHOTO

擬議臨時辦公室以作准許的農業用途(為期 3 年)及填土
新界元朗錦田丈量約份第110約地段第84號(部分)、第85號A分段餘段(部分)、
第85號C分段(部分)、第86號餘段(部分)及第113號(部分)
PROPOSED TEMPORARY OFFICE FOR PERMITTED AGRICULTURAL USE
FOR A PERIOD OF 3 YEARS AND FILLING OF LAND
LOTS 84 (PART), 85 S.A RP (PART), 85 S.C (PART), 86 RP (PART)
AND 113 (PART) IN D.D. 110, KAM TIN, YUEN LONG, N.T.

規劃署
PLANNING
DEPARTMENT



參考編號
REFERENCE No.
A/YL-KTN/760

圖 PLAN
A-3

1



2



3



4



申請地點界線只作識別用 APPLICATION SITE BOUNDARY FOR IDENTIFICATION PURPOSE ONLY

實地照片 SITE PHOTOS

本圖於2021年4月20日擬備，所根據的資料為攝於2021年3月23日的實地照片
PLAN PREPARED ON 20.4.2021
BASED ON SITE PHOTOS
TAKEN ON 23.3.2021

擬議臨時辦公室以作准許的農業用途（為期 3 年）及填土
新界元朗錦田丈量約份第110約地段第84號（部分）、第85號A分段餘段（部分）、
第85號C分段（部分）、第86號餘段（部分）及第113號（部分）
PROPOSED TEMPORARY OFFICE FOR PERMITTED AGRICULTURAL USE
FOR A PERIOD OF 3 YEARS AND FILLING OF LAND
LOTS 84 (PART), 85 S.A RP (PART), 85 S.C (PART), 86 RP (PART)
AND 113 (PART) IN D.D. 110, KAM TIN, YUEN LONG, N.T.

規 劃 署
PLANNING
DEPARTMENT



參考編號
REFERENCE No.
A/YL-KTN/760

圖 PLAN
A-4a

5



申請地點
APPLICATION SITE

6



申請地點
APPLICATION SITE

7



申請地點
APPLICATION SITE

申請地點界線只作識別用 APPLICATION SITE BOUNDARY FOR IDENTIFICATION PURPOSE ONLY

實地照片 SITE PHOTOS

擬議臨時辦公室以作准許的農業用途（為期 3 年）及填土
新界元朗錦田丈量約份第110約地段第84號（部分）、第85號A分段餘段（部分）、
第85號C分段（部分）、第86號餘段（部分）及第113號（部分）
PROPOSED TEMPORARY OFFICE FOR PERMITTED AGRICULTURAL USE
FOR A PERIOD OF 3 YEARS AND FILLING OF LAND
LOTS 84 (PART), 85 S.A RP (PART), 85 S.C (PART), 86 RP (PART)
AND 113 (PART) IN D.D. 110, KAM TIN, YUEN LONG, N.T.

本圖於2021年4月20日擬備，所根據的
資料為攝於2021年3月23日的實地照片
PLAN PREPARED ON 20.4.2021
BASED ON SITE PHOTOS
TAKEN ON 23.3.2021

規 劃 署
PLANNING
DEPARTMENT



參考編號
REFERENCE No.
A/YL-KTN/760

圖 PLAN
A-4b