

**Proposed Structures Details:**

**Electric Meter Room** (Only 1-storey)

Dimension: 2.5m x 6.1m (About)

Height: Not Exceeding 3.5m

Unit(s): 1

Non-Domestic GFA: 15.25m<sup>2</sup> (About)

**Reception and Learning Centre** (Only 1-storey)

Dimension: 3.1m x 6.1m (About)

Height: Not Exceeding 3.5m

Unit(s): 1

Non-Domestic GFA: 18.91m<sup>2</sup> (About)

**Storage** (On Farm Area, Only 1-storey)

Dimension: 2.5m x 6.1m (About)

Height: Not Exceeding 3.5m

Unit(s): 1

Non-Domestic GFA: 15.25m<sup>2</sup> (About)

**Storage** (On Paved Area, Only 1-storey)

Dimension: 1.3m x 1.3m (About)

Height: Not Exceeding 3.5m

Unit(s): 1

Non-Domestic GFA: 1.69m<sup>2</sup> (About)

**Farm Lounge** (Only 1-storey)

Dimension: 3m x 5m (About)

Height: Not Exceeding 3.5m

Unit(s): 1

Non-Domestic GFA: 15m<sup>2</sup> (About)

**Marquee**

Dimension: 2.8m x 4.5m (About)

Height: Not Exceeding 3.5m

Unit(s): 1

Non-Domestic GFA: 12.6m<sup>2</sup> (About)

**Private Car Parking Space**

Dimension: 5m x 2.5m

Unit(s): 8

**LGV L/UL Space**

Dimension: 7m x 3.5m

Unit(s): 1

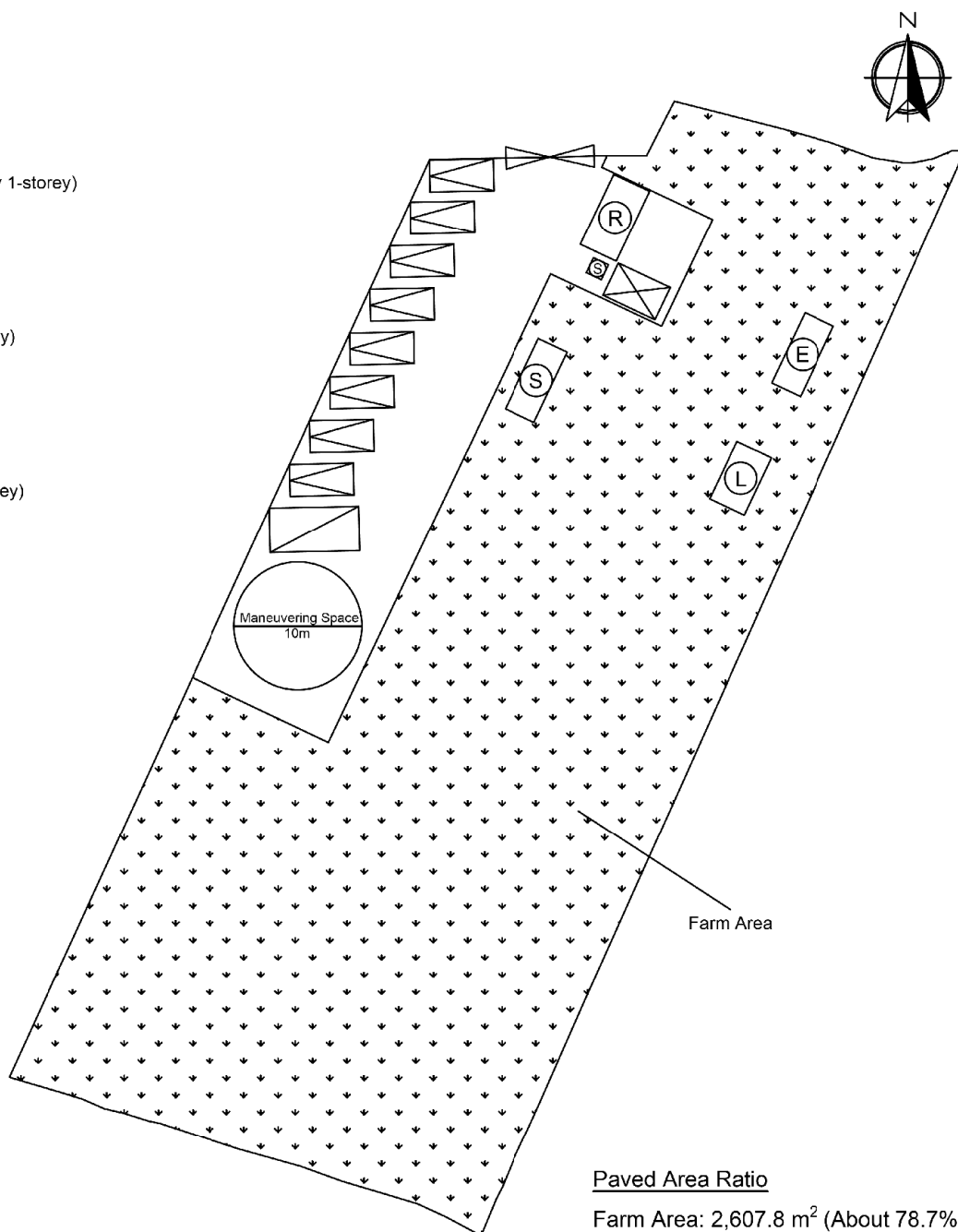

**Paved Area Ratio**

Farm Area: 2,607.8 m<sup>2</sup> (About 78.7%)

Paved Area: 704.7 m<sup>2</sup> (About 21.3%)

Total Area: 3,312.5 m<sup>2</sup> (About)

Covered Area: 78.7 m<sup>2</sup> (About)

Uncovered Area: 3,233.8 m<sup>2</sup> (About)

Non-Domestic GFA: 78.7 m<sup>2</sup> (About)

Nos. of Proposed Structures: 6

**Legend:**

- |  |                                  |  |                               |
|--|----------------------------------|--|-------------------------------|
|  | Ingress/egress (Width: About 7m) |  | Electric Meter Room           |
|  | Proposed Structures              |  | Farm Lounge                   |
|  | Private Car Parking Space        |  | Reception and Learning Centre |
|  | LGV U/UL Space                   |  | Storage                       |
|  | Marquee                          |  |                               |

**Appendix 4**

Location: DD 107 Lot 1750A2 RP  
Adjoining Government Land  
App. No.: A/YL-KTN/766

OZP: S/YL-KTN/9  
District: Kam Tin North  
Zoning: Agriculture

Date: 4 June 2021

**Proposed Layout Plan**

擬議平面圖

擬議臨時康體文娛場所  
(休閒農場)(為期3年)及填土

Proposed Temporary Place of Recreation,  
Sports or Culture (Hobby Farm)  
For a Period of 3 Years and Filling of Land

**SCALE**

—1:500—

@A4

For Identification Only

Drawing No.:

4-01

(摘錄自申請人於 7. 6. 2021 呈交的申請書)  
(Extract from Applicant's  
Submission of 7.6.2021)

參考編號

REFERENCE No.

A/YL-KTN/766

繪圖 DRAWING

A-1



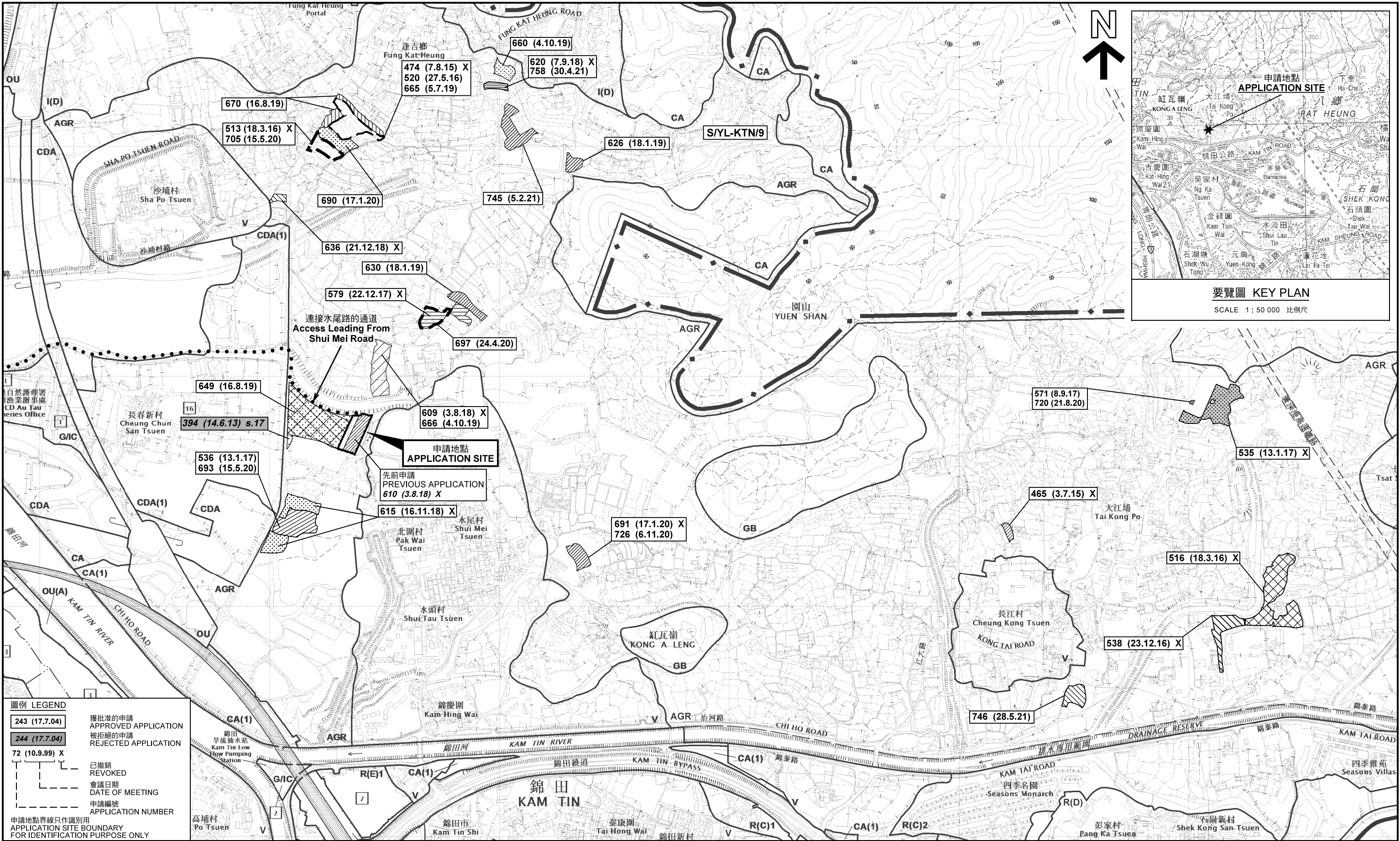

位置圖及同類申請 LOCATION PLAN WITH SIMILAR APPLICATIONS

臨時康體文娛場所（休閒農場）（為期 3 年）  
新界元朗錦田北丈量約份第107約地段第1750A2號餘段和毗連政府土地  
TEMPORARY PLACE OF RECREATION,  
SPORTS OR CULTURE (HOBBY FARM)  
FOR A PERIOD OF 3 YEARS  
LOT 1750A2 RP IN D.D. 107 AND ADJOINING GOVERNMENT LAND,  
KAM TIN NORTH, YUEN LONG, NEW TERRITORIES

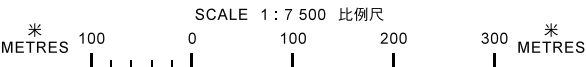

本摘要圖於2021年6月7日擬備，所根據的資料為於  
2014年12月2日核准的分區計劃大綱圖編號 S/YL-KTN/9  
EXTRACT PLAN PREPARED ON 7.6.2021  
BASED ON OUTLINE ZONING PLAN NO.  
S/YL-KTN/9 APPROVED ON 2.12.2014

規劃署  
PLANNING DEPARTMENT



參考編號 REFERENCE No.  
A/YL-KTN/766

圖 PLAN  
A-1



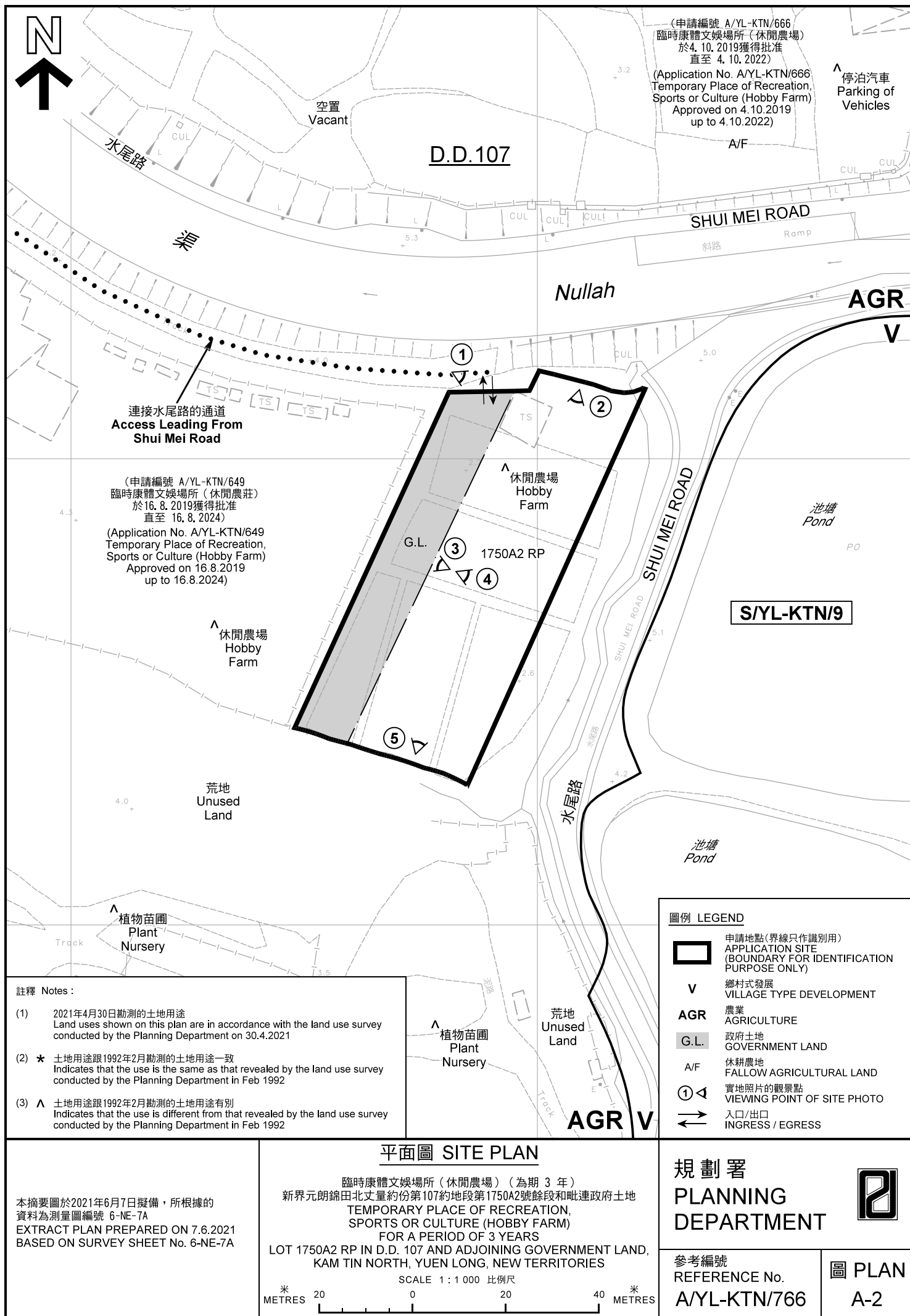



圖例 LEGEND



申請地點(界線只作識別用)  
APPLICATION SITE  
(BOUNDARY FOR IDENTIFICATION  
PURPOSE ONLY)

本摘要圖於2021年6月7日擬備，所根據  
的資料為地政總署於2020年11月25日拍得  
的航攝照片編號 E105564C  
EXTRACT PLAN PREPARED ON 7.6.2021  
BASED ON AERIAL PHOTO No.  
E105564C TAKEN ON 25.11.2020  
BY LANDS DEPARTMENT

航攝照片 AERIAL PHOTO

臨時康體文娛場所(休閒農場)(為期3年)  
新界元朗錦田北丈量約份第107約地段第1750A2號餘段和毗連政府土地  
TEMPORARY PLACE OF RECREATION,  
SPORTS OR CULTURE (HOBBY FARM)  
FOR A PERIOD OF 3 YEARS  
LOT 1750A2 RP IN D.D. 107 AND ADJOINING GOVERNMENT LAND,  
KAM TIN NORTH, YUEN LONG, NEW TERRITORIES

規劃署  
PLANNING  
DEPARTMENT



參考編號  
REFERENCE No.  
A/YL-KTN/766

圖 PLAN  
A-3



1



2



3



4

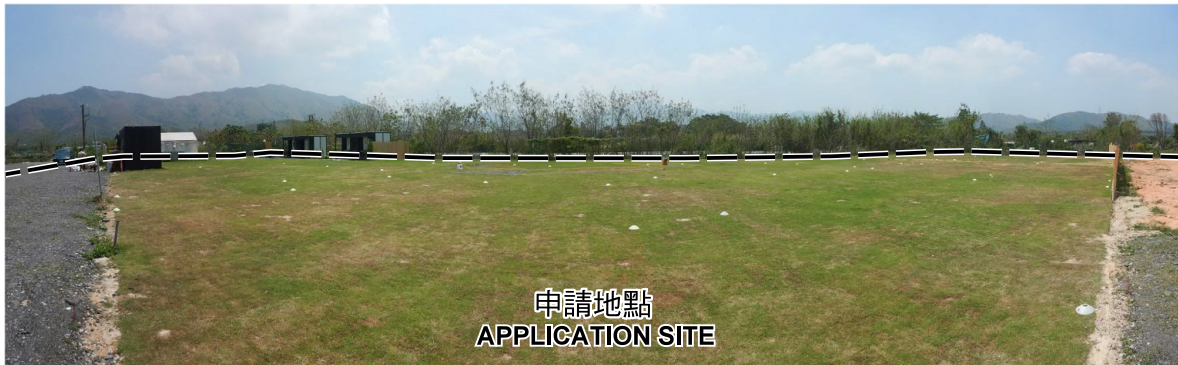

5



申請地點界線只作識別用 APPLICATION SITE BOUNDARY FOR IDENTIFICATION PURPOSE ONLY

### 實地照片 SITE PHOTOS

臨時康體文娛場所（休閒農場）（為期 3 年）  
新界元朗錦田北丈量約份第107約地段第1750A2號餘段和毗連政府土地  
TEMPORARY PLACE OF RECREATION,  
SPORTS OR CULTURE (HOBBY FARM)  
FOR A PERIOD OF 3 YEARS  
LOT 1750A2 RP IN D.D. 107 AND ADJOINING GOVERNMENT LAND,  
KAM TIN NORTH, YUEN LONG, NEW TERRITORIES

規劃署  
PLANNING  
DEPARTMENT



參考編號  
REFERENCE No.  
A/YL-KTN/766

圖 PLAN  
A-4

本圖於2021年6月7日擬備，所根據的資料為攝於2021年4月30日的實地照片  
PLAN PREPARED ON 7.6.2021  
BASED ON SITE PHOTOS  
TAKEN ON 30.4.2021