

2021年 5月 14日

Appendix I of RNTPC

Paper No. A/YL-KTN/769

此文件在...收到。城市規劃委員會  
只會在收到申請表格及所有必要資料後才正式處理。  
申請日期。

This document is received on 14 MAY 2021  
The Town Planning Board will formally acknowledge  
the receipt of the application only upon receipt  
of all the required information and documents.

Form No. S16-I  
表格第 S16-I 號

# APPLICATION FOR PERMISSION UNDER SECTION 16 OF THE TOWN PLANNING ORDINANCE (CAP.131)

根據《城市規劃條例》(第131章)  
第16條遞交的許可申請

**Applicable to proposals not involving or not only involving:**  
適用於建議不涉及或不祇涉及:

- (i) Construction of "New Territories Exempted House(s)";  
興建「新界豁免管制屋宇」;
- (ii) Temporary use/development of land and/or building not exceeding 3 years in rural areas; and  
位於鄉郊地區土地上及/或建築物內進行為期不超過三年的臨時用途/發展;及
- (iii) Renewal of permission for temporary use or development in rural areas  
位於鄉郊地區的臨時用途或發展的許可續期

Applicant who would like to publish the notice of application in local newspapers to meet one of the Town Planning Board's requirements of taking reasonable steps to obtain consent of or give notification to the current land owner, please refer to the following link regarding publishing the notice in the designated newspapers:  
[https://www.info.gov.hk/tpb/en/plan\\_application/apply.html](https://www.info.gov.hk/tpb/en/plan_application/apply.html)

申請人如欲在本地報章刊登申請通知，以採取城市規劃委員會就取得現行土地擁有人的同意或通知現行土地擁有人所指定的其中一項合理步驟，請瀏覽以下網址有關在指定的報章刊登通知：  
[https://www.info.gov.hk/tpb/tc/plan\\_application/apply.html](https://www.info.gov.hk/tpb/tc/plan_application/apply.html)

## General Note and Annotation for the Form 填寫表格的一般指引及註解

# "Current land owner" means any person whose name is registered in the Land Registry as that of an owner of the land to which the application relates, as at 6 weeks before the application is made  
「現行土地擁有人」指在提出申請前六星期，其姓名或名稱已在土地註冊處註冊為該申請所關乎的土地的擁有人的人

& Please attach documentary proof 請夾附證明文件

^ Please insert number where appropriate 請在適當地方註明編號

Please fill "NA" for inapplicable item 請在不適用的項目填寫「不適用」

Please use separate sheets if the space provided is insufficient 如所提供的空間不足，請另頁說明

Please insert a 「✓」 at the appropriate box 請在適當的方格內上加上「✓」號

For Official Use Only 請勿填寫此欄	Application No. 申請編號	A/YL-KTN/769
	Date Received 收到日期	14 MAY 2021

- The completed form and supporting documents (if any) should be sent to the Secretary, Town Planning Board (the Board), 15/F, North Point Government Offices, 333 Java Road, North Point, Hong Kong.  
申請人須把填妥的申請表格及其他支持申請的文件(倘有), 送交香港北角渣華道 333 號北角政府合署 15 樓城市規劃委員會(下稱「委員會」)秘書收。
- Please read the "Guidance Notes" carefully before you fill in this form. The document can be downloaded from the Board's website at <http://www.info.gov.hk/tph/>. It can also be obtained from the Secretariat of the Board at 15/F, North Point Government Offices, 333 Java Road, North Point, Hong Kong (Tel: 2231 4810 or 2231 4835), and the Planning Enquiry Counters of the Planning Department (Hotline: 2231 5000) (17/F, North Point Government Offices, 333 Java Road, North Point, Hong Kong and 14/F, Sha Tin Government Offices, 1 Sheung Wo Che Road, Sha Tin, New Territories). 請先細閱《申請須知》的資料單張, 然後填寫此表格。該份文件可從委員會的網頁下載(網址: <http://www.info.gov.hk/tph/>), 亦可向委員會秘書處(香港北角渣華道 333 號北角政府合署 15 樓 - 電話: 2231 4810 或 2231 4835)及規劃署的規劃資料查詢處(熱線: 2231 5000)(香港北角渣華道 333 號北角政府合署 17 樓及新界沙田上禾輋路 1 號沙田政府合署 14 樓)索取。
- This form can be downloaded from the Board's website, and obtained from the Secretariat of the Board and the Planning Enquiry Counters of the Planning Department. The form should be typed or completed in block letters. The processing of the application may be refused if the required information or the required copies are incomplete.  
此表格可從委員會的網頁下載, 亦可向委員會秘書處及規劃署的規劃資料查詢處索取。申請人須以打印方式或以正楷填寫表格。如果申請人所提交的資料或文件副本不齊全, 委員會可拒絕處理有關申請。

## 1. Name of Applicant 申請人姓名/名稱

(☐ Mr. 先生 / ☐ Mrs. 夫人 / ☐ Miss 小姐 / ☐ Ms. 女士 / ☒ Company 公司 / ☐ Organisation 機構)

Good Time Union Metal Works Company Limited

## 2. Name of Authorised Agent (if applicable) 獲授權代理人姓名/名稱 (如適用)

(☐ Mr. 先生 / ☐ Mrs. 夫人 / ☐ Miss 小姐 / ☐ Ms. 女士 / ☒ Company 公司 / ☐ Organisation 機構)

R-riches Property Consultants Limited

## 3. Application Site 申請地點

(a) Full address / location / demarcation district and lot number (if applicable) 詳細地址/地點/丈量約份及地段號碼(如適用)	Lot 1225 S.C, 1226 S.E and 1230 S.B in D.D.107, Fung Kat Heung, Kam Tin, Yuen Long, New Territories
(b) Site area and/or gross floor area involved 涉及的地盤面積及/或總樓面面積	<input checked="" type="checkbox"/> Site area 地盤面積 565 sq.m 平方米 <input checked="" type="checkbox"/> About 約 <input checked="" type="checkbox"/> Gross floor area 總樓面面積 120 sq.m 平方米 <input checked="" type="checkbox"/> About 約
(c) Area of Government land included (if any) 所包括的政府土地面積(倘有)	N/A sq.m 平方米 <input type="checkbox"/> About 約

(d) Name and number of the related statutory plan(s) 有關法定圖則的名稱及編號	Approved Kam Tin North Outline Zoning Plan No.: SYL-KTN/9
(e) Land use zone(s) involved 涉及的土地用途地帶	"Agriculture" Zone
(f) Current use(s) 現時用途	Vacant  (If there are any Government, institution or community facilities, please illustrate on plan and specify the use and gross floor area) (如有任何政府、機構或社區設施，請在圖則上顯示，並註明用途及總樓面面積)

#### 4. "Current Land Owner" of Application Site 申請地點的「現行土地擁有人」

The applicant 申請人 -

- ☐ is the sole "current land owner"<sup>1</sup> (please proceed to Part 6 and attach documentary proof of ownership).  
是唯一的「現行土地擁有人」<sup>1</sup> (請繼續填寫第 6 部分，並夾附業權證明文件)。
- ☐ is one of the "current land owners"<sup>1</sup> (please attach documentary proof of ownership).  
是其中一名「現行土地擁有人」<sup>1</sup> (請夾附業權證明文件)。
- ☒ is not a "current land owner"<sup>1</sup>.  
並不是「現行土地擁有人」<sup>1</sup>。

- ☐ The application site is entirely on Government land (please proceed to Part 6).  
申請地點完全位於政府土地上 (請繼續填寫第 6 部分)。

#### 5. Statement on Owner's Consent/Notification

就土地擁有人的同意/通知土地擁有人的陳述

- (a) According to the record(s) of the Land Registry as at ..... (DD/MM/YYYY), this application involves a total of ..... "current land owner(s)"<sup>1</sup>.  
根據土地註冊處截至 ..... 年 ..... 月 ..... 日的記錄，這宗申請共牽涉 ..... 名「現行土地擁有人」<sup>1</sup>。

(b) The applicant 申請人 -

- ☐ has obtained consent(s) of ..... "current land owner(s)"<sup>1</sup>.  
已取得 ..... 名「現行土地擁有人」<sup>1</sup>的同意。

Details of consent of "current land owner(s)" <sup>1</sup> obtained 取得「現行土地擁有人」 <sup>1</sup> 同意的詳情		
No. of 'Current Land Owner(s)' 「現行土地擁有人」數目	Lot number/address of premises as shown in the record of the Land Registry where consent(s) has/have been obtained 根據土地註冊處記錄已獲得同意的地段號碼/處所地址	Date of consent obtained (DD/MM/YYYY) 取得同意的日期 (日/月/年)

(Please use separate sheets if the space of any box above is insufficient. 如上列任何方格的空間不足，請另頁說明)

- ☐ has notified ..... "current land owner(s)"  
已通知 ..... 名「現行土地擁有人」。

Details of the "current land owner(s)" notified 已獲通知「現行土地擁有人」的詳細資料		
No. of 'Current Land Owner(s)' 「現行土地擁有人」數目	Lot number/address of premises as shown in the record of the Land Registry where notification(s) has/have been given 根據土地註冊處記錄已發出通知的地段號碼／處所地址	Date of notification given (DD/MM/YYYY) 通知日期(日/月/年)

(Please use separate sheets if the space of any box above is insufficient. 如上列任何方格的空間不足，請另買說明)

- ☒ has taken reasonable steps to obtain consent of or give notification to owner(s):  
已採取合理步驟以取得土地擁有人的同意或向該人發給通知。詳情如下：

Reasonable Steps to Obtain Consent of Owner(s) 取得土地擁有人的同意所採取的合理步驟

- ☐ sent request for consent to the "current land owner(s)" on ..... (DD/MM/YYYY)<sup>&</sup>  
於 ..... (日/月/年)向每一名「現行土地擁有人」郵遞要求同意書<sup>&</sup>

Reasonable Steps to Give Notification to Owner(s) 向土地擁有人發出通知所採取的合理步驟

- ☐ published notices in local newspapers on ..... (DD/MM/YYYY)<sup>&</sup>  
於 ..... (日/月/年)在指定報章就申請刊登一次通知<sup>&</sup>
- ☒ posted notice in a prominent position on or near application site/premises on  
29/04/2021 (DD/MM/YYYY)<sup>&</sup>  
於 ..... (日/月/年)在申請地點／申請處所或附近的顯明位置貼出關於該申請的通知<sup>&</sup>
- ☒ sent notice to relevant owners' corporation(s)/owners' committee(s)/mutual aid committee(s)/management office(s) or rural committee on 12/05/2021 (DD/MM/YYYY)<sup>&</sup>  
於 ..... (日/月/年)把通知寄往相關的業主立案法團／業主委員會／互助委員會或管理處，或有關的鄉事委員會<sup>&</sup>

Others 其他

- ☐ others (please specify)  
其他（請指明）

Note: May insert more than one 「✓」.

Information should be provided on the basis of each and every lot (if applicable) and premises (if any) in respect of the application.

註: 可在多於一個方格內加上「✓」號

申請人須就申請涉及的每一地段（倘適用）及處所（倘有）分別提供資料

## 6. Type(s) of Application 申請類別

- ☐ Type (i) Change of use within existing building or part thereof  
第(i)類 更改現有建築物或其部分內的用途
- ☒ Type (ii) Diversion of stream / excavation of land / filling of land / filling of pond as required under Notes of Statutory Plan(s)  
第(ii)類 根據法定圖則《註釋》內所要求的河道改道／挖土／填土／填塘工程
- ☐ Type (iii) Public utility installation / Utility installation for private project  
第(iii)類 公用事業設施裝置／私人發展計劃的公用設施裝置
- ☐ Type (iv) Minor relaxation of stated development restriction(s) as provided under Notes of Statutory Plan(s)  
第(iv)類 略為放寬於法定圖則《註釋》內列明的發展限制
- ☒ Type (v) Use / development other than (i) to (iii) above  
第(v)類 上述的(i)至(iii)項以外的用途／發展

Note 1: May insert more than one 「✓」.

註 1: 可在多於一個方格內加上「✓」號

Note 2: For Development involving columbarium use, please complete the table in the Appendix.

註 2: 如發展涉及靈灰安置所用途，請填妥於附件的表格。

(i) For Type (i) application 供第(i)類申請			
(a) Total floor area involved 涉及的總樓面面積	sq.m 平方米		
(b) Proposed use(s)/development 擬議用途／發展	(If there are any Government, institution or community facilities, please illustrate on plan and specify the use and gross floor area) (如有任何政府、機構或社區設施，請在圖則上顯示，並註明用途及總樓面面積)		
(c) Number of storeys involved 涉及層數		Number of units involved 涉及單位數目	
(d) Proposed floor area 擬議樓面面積	Domestic part 住用部分 .....		sq.m 平方米 □About 約
	Non-domestic part 非住用部分 .....		sq.m 平方米 □About 約
	Total 總計 .....		sq.m 平方米 □About 約
(e) Proposed uses of different floors (if applicable) 不同樓層的擬議用途(如適用) (Please use separate sheets if the space provided is insufficient) (如所提供的空間不足，請另頁說明)	Floor(s) 樓層	Current use(s) 現時用途	Proposed use(s) 擬議用途

(ii) For Type (ii) application 供第(ii)類申請	
(a) Operation involved 涉及工程	<div> <input type="checkbox"/> Diversion of stream 河道改道 </div> <div> <input type="checkbox"/> Filling of pond 填塘  Area of filling 填塘面積 ..... sq.m 平方米 <input type="checkbox"/> About 約  Depth of filling 填塘深度 ..... m 米 <input type="checkbox"/> About 約 </div> <div> <input checked="" type="checkbox"/> Filling of land 填土  Area of filling 填土面積 ..... 60 ..... sq.m 平方米 <input checked="" type="checkbox"/> About 約  Depth of filling 填土厚度 ..... not more than 0.2 ..... m 米 <input type="checkbox"/> About 約 </div> <div> <input type="checkbox"/> Excavation of land 挖土  Area of excavation 挖土面積 ..... sq.m 平方米 <input type="checkbox"/> About 約  Depth of excavation 挖土深度 ..... m 米 <input type="checkbox"/> About 約 </div> <p>(Please indicate on site plan the boundary of concerned land/pond(s), and particulars of stream diversion, the extent of filling of land/pond(s) and/or excavation of land) (請用圖則顯示有關土地/池塘界線, 以及河道改道、填塘、填土及/或挖土的細節及/或範圍))</p>
(b) Intended use/development 有意進行的用途/發展	Proposed Temporary Animal Boarding Establishment for a Period of 5 Years and Land Filling

(iii) For Type (iii) application 供第(iii)類申請													
(a) Nature and scale 性質及規模	<div> <input type="checkbox"/> Public utility installation 公用事業設施裝置 </div> <div> <input type="checkbox"/> Utility installation for private project 私人發展計劃的公用設施裝置 </div> <p>Please specify the type and number of utility to be provided as well as the dimensions of each building/structure, where appropriate 請註明有關裝置的性質及數量, 包括每座建築物/構築物(倘有)的長度、高度和闊度</p> <table border="1"> <thead> <tr> <th>Name/type of installation 裝置名稱/種類</th> <th>Number of provision 數量</th> <th>Dimension of each installation /building/structure (m) (LxWxH) 每個裝置/建築物/構築物的尺寸 (米) (長 x 闊 x 高)</th> </tr> </thead> <tbody> <tr> <td> </td> <td> </td> <td> </td> </tr> <tr> <td> </td> <td> </td> <td> </td> </tr> <tr> <td> </td> <td> </td> <td> </td> </tr> </tbody> </table> <p>(Please illustrate on plan the layout of the installation 請用圖則顯示裝置的布局)</p>	Name/type of installation 裝置名稱/種類	Number of provision 數量	Dimension of each installation /building/structure (m) (LxWxH) 每個裝置/建築物/構築物的尺寸 (米) (長 x 闊 x 高)									
Name/type of installation 裝置名稱/種類	Number of provision 數量	Dimension of each installation /building/structure (m) (LxWxH) 每個裝置/建築物/構築物的尺寸 (米) (長 x 闊 x 高)											

**(iv) For Type (iv) application 供第(iv)類申請**

(a) Please specify the proposed minor relaxation of stated development restriction(s) and also fill in the proposed use/development and development particulars in part (v) below –

請列明擬議略為放寬的發展限制並填妥於第(v)部分的擬議用途/發展及發展細節 –

- ☐ Plot ratio restriction 地積比率限制 From 由 ..... to 至 .....
- ☐ Gross floor area restriction 總樓面面積限制 From 由 .....sq. m 平方米 to 至 .....sq. m 平方米
- ☐ Site coverage restriction 上蓋面積限制 From 由 .....% to 至 .....%
- ☐ Building height restriction 建築物高度限制  
From 由 .....m 米 to 至 ..... m 米  
From 由 ..... mPD 米 (主水平基準上) to 至 .....mPD 米 (主水平基準上)  
From 由 ..... storeys 層 to 至 ..... storeys 層
- ☐ Non-building area restriction 非建築用地限制 From 由 .....m to 至 ..... m
- ☐ Others (please specify) 其他 (請註明) .....

**(v) For Type (v) application 供第(v)類申請**

(a) Proposed use(s)/development  
擬議用途/發展

Proposed Temporary Animal Boarding Establishment for a Period of 5 Years and Land Filling

(Please illustrate the details of the proposal on a layout plan 請用平面圖說明建議詳情)

**(b) Development Schedule 發展細節表**

Proposed gross floor area (GFA) 擬議總樓面面積	..... 120 ..... sq.m 平方米	<input checked="" type="checkbox"/> About 約
Proposed plot ratio 擬議地積比率	..... 0.2 .....	<input checked="" type="checkbox"/> About 約
Proposed site coverage 擬議上蓋面積	..... 11 ..... %	<input checked="" type="checkbox"/> About 約
Proposed no. of blocks 擬議座數	..... 1 .....	
Proposed no. of storeys of each block 每座建築物的擬議層數	..... 2 ..... storeys 層	
	<input type="checkbox"/> include 包括 ..... storeys of basements 層地庫	
	<input type="checkbox"/> exclude 不包括 ..... storeys of basements 層地庫	
Proposed building height of each block 每座建築物的擬議高度	..... mPD 米(主水平基準上)	<input type="checkbox"/> About 約
	..... 7 ..... m 米	<input checked="" type="checkbox"/> About 約

☐ Domestic part 住用部分

GFA 總樓面面積 ..... sq. m 平方米 ☐ About 約  
 number of Units 單位數目 .....  
 average unit size 單位平均面積 .....sq. m 平方米 ☐ About 約  
 estimated number of residents 估計住客數目 .....

☒ Non-domestic part 非住用部分

## GFA 總樓面面積

☐ eating place 食肆 ..... sq. m 平方米 ☐ About 約  
☐ hotel 酒店 ..... sq. m 平方米 ☐ About 約

(please specify the number of rooms

請註明房間數目) .....

☐ office 辦公室 ..... sq. m 平方米 ☐ About 約  
☐ shop and services 商店及服務行業 ..... sq. m 平方米 ☐ About 約

☐ Government, institution or community facilities (please specify the use(s) and concerned land  
 政府、機構或社區設施 area(s)/GFA(s) 請註明用途及有關的地面面積/總  
 樓面面積)

☒ other(s) 其他

(please specify the use(s) and concerned land  
 area(s)/GFA(s) 請註明用途及有關的地面面積/總  
 樓面面積)

STRUCTURE	USE	COVERED AREA	GFA	BUILDING HEIGHT
B1	ANIMAL BOARDING ESTABLISHMENT STORAGE OF PET GOODS	60m <sup>2</sup> (ABOUT)	120m <sup>2</sup> (ABOUT)	7m (ABOUT)(2-STOREY)
TOTAL		60m <sup>2</sup> (ABOUT)	120m <sup>2</sup> (ABOUT)	

☐ Open space 休憩用地

(please specify land area(s) 請註明地面面積)

☐ private open space 私人休憩用地 ..... sq. m 平方米 ☐ Not less than 不少於  
☐ public open space 公眾休憩用地 ..... sq. m 平方米 ☐ Not less than 不少於

## (c) Use(s) of different floors (if applicable) 各樓層的用途 (如適用)

[Block number] [座數]	[Floor(s)] [層數]	[Proposed use(s)] [擬議用途]		
STRUCTURE	USE	COVERED AREA	GFA	BUILDING HEIGHT
B1	ANIMAL BOARDING ESTABLISHMENT STORAGE OF PET GOODS	60m <sup>2</sup> (ABOUT)	120m <sup>2</sup> (ABOUT)	7m (ABOUT)(2-STOREY)
TOTAL		60m <sup>2</sup> (ABOUT)	120m <sup>2</sup> (ABOUT)	

## (d) Proposed use(s) of uncovered area (if any) 露天地方 (倘有) 的擬議用途

Circulation spaces .....

.....

.....

.....

.....



### 7. Anticipated Completion Time of the Development Proposal 擬議發展計劃的預計完成時間

Anticipated completion time (in month and year) of the development proposal (by phase (if any)) (e.g. June 2023)  
擬議發展計劃預期完成的年份及月份 (分期 (倘有)) (例: 2023 年 6 月)  
(Separate anticipated completion times (in month and year) should be provided for the proposed public open space and Government, institution or community facilities (if any))  
(申請人須就擬議的公眾休憩用地及政府、機構或社區設施 (倘有) 提供個別擬議完成的年份及月份)

Late 2022

.....

.....

.....

.....

.....

### 8. Vehicular Access Arrangement of the Development Proposal 擬議發展計劃的行車通道安排

Any vehicular access to the site/subject building? 是否有車路通往地盤/有關建築物?	Yes 是         No 否	<input checked="" type="checkbox"/> There is an existing access. (please indicate the street name, where appropriate) 有一條現有車路。(請註明車路名稱(如適用)) Accessible from Castle Peak Road - Tam Mei via a local access <input type="checkbox"/> There is a proposed access: (please illustrate on plan and specify the width) 有一條擬議車路。(請在圖則顯示, 並註明車路的闊度) <input type="checkbox"/>
Any provision of parking space for the proposed use(s)? 是否有為擬議用途提供停車位?	Yes 是         No 否	<input checked="" type="checkbox"/> (Please specify type(s) and number(s) and illustrate on plan) 請註明種類及數目並於圖則上顯示 Private Car Parking Spaces 私家車車位 2 Motorcycle Parking Spaces 電單車車位 / Light Goods Vehicle Parking Spaces 輕型貨車泊車位 / Medium Goods Vehicle Parking Spaces 中型貨車泊車位 / Heavy Goods Vehicle Parking Spaces 重型貨車泊車位 / Others (Please Specify) 其他 (請列明) /  <input type="checkbox"/>
Any provision of loading/unloading space for the proposed use(s)? 是否有為擬議用途提供上落客貨車位?	Yes 是         No 否	<input checked="" type="checkbox"/> (Please specify type(s) and number(s) and illustrate on plan) 請註明種類及數目並於圖則上顯示 Taxi Spaces 的士車位 / Coach Spaces 旅遊巴車位 / Light Goods Vehicle Spaces 輕型貨車車位 1 Medium Goods Vehicle Spaces 中型貨車車位 / Heavy Goods Vehicle Spaces 重型貨車車位 / Others (Please Specify) 其他 (請列明) /  <input type="checkbox"/>

## 9. Impacts of Development Proposal 擬議發展計劃的影響

If necessary, please use separate sheets to indicate the proposed measures to minimise possible adverse impacts or give justifications/reasons for not providing such measures.  
如需要的話，請另頁表示可盡量減少可能出現不良影響的措施，否則請提供理據/理由。

<p>Does the development proposal involve alteration of existing building? 擬議發展計劃是否包括現有建築物的改動?</p>	<p>Yes 是          No 否</p>	<p><input type="checkbox"/> Please provide details 請提供詳情 ..... ..... ..... ..... .....</p>																																				
<p>Does the development proposal involve the operation on the right? 擬議發展是否涉及右列的工程? (Note: where Type (ii) application is the subject of application, please skip this section. 註：如申請涉及第(ii)類申請，請跳至下一條問題。)</p>	<p>Yes 是          No 否</p>	<p><input type="checkbox"/> (Please indicate on site plan the boundary of concerned land/pond(s), and particulars of stream diversion, the extent of filling of land/pond(s) and/or excavation of land) (請用地盤平面圖顯示有關土地/池塘界線，以及河道改道、填塘、填土及/或挖土的細節及/或範圍)</p> <p><input type="checkbox"/> Diversion of stream 河道改道</p> <p><input type="checkbox"/> Filling of pond 填塘 Area of filling 填塘面積 ..... sq.m 平方米 <input type="checkbox"/> About 約 Depth of filling 填塘深度 ..... m 米 <input type="checkbox"/> About 約</p> <p><input type="checkbox"/> Filling of land 填土 Area of filling 填土面積 ..... sq.m 平方米 <input type="checkbox"/> About 約 Depth of filling 填土厚度 ..... m 米 <input type="checkbox"/> About 約</p> <p><input type="checkbox"/> Excavation of land 挖土 Area of excavation 挖土面積 ..... sq.m 平方米 <input type="checkbox"/> About 約 Depth of excavation 挖土深度 ..... m 米 <input type="checkbox"/> About 約</p>																																				
<p>Would the development proposal cause any adverse impacts? 擬議發展計劃會否造成不良影響?</p>	<p>On environment 對環境 On traffic 對交通 On water supply 對供水 On drainage 對排水 On slopes 對斜坡 Affected by slopes 受斜坡影響 Landscape Impact 構成景觀影響 Tree Felling 砍伐樹木 Visual Impact 構成視覺影響 Others (Please Specify) 其他 (請列明)</p> <p>..... ..... .....</p>	<table border="0"> <tr> <td>Yes 會</td><td><input type="checkbox"/></td> <td>No 不會</td><td><input checked="" type="checkbox"/></td> </tr> <tr> <td>Yes 會</td><td><input type="checkbox"/></td> <td>No 不會</td><td><input checked="" type="checkbox"/></td> </tr> <tr> <td>Yes 會</td><td><input type="checkbox"/></td> <td>No 不會</td><td><input checked="" type="checkbox"/></td> </tr> <tr> <td>Yes 會</td><td><input type="checkbox"/></td> <td>No 不會</td><td><input checked="" type="checkbox"/></td> </tr> <tr> <td>Yes 會</td><td><input type="checkbox"/></td> <td>No 不會</td><td><input checked="" type="checkbox"/></td> </tr> <tr> <td>Yes 會</td><td><input type="checkbox"/></td> <td>No 不會</td><td><input checked="" type="checkbox"/></td> </tr> <tr> <td>Yes 會</td><td><input type="checkbox"/></td> <td>No 不會</td><td><input checked="" type="checkbox"/></td> </tr> <tr> <td>Yes 會</td><td><input type="checkbox"/></td> <td>No 不會</td><td><input checked="" type="checkbox"/></td> </tr> <tr> <td>Yes 會</td><td><input type="checkbox"/></td> <td>No 不會</td><td><input checked="" type="checkbox"/></td> </tr> </table> <p>Please state measure(s) to minimise the impact(s). For tree felling, please state the number, diameter at breast height and species of the affected trees (if possible) 請註明盡量減少影響的措施。如涉及砍伐樹木，請說明受影響樹木的數目、及胸高度的樹幹直徑及品種(倘可)</p> <p>..... ..... ..... ..... .....</p>	Yes 會	<input type="checkbox"/>	No 不會	<input checked="" type="checkbox"/>	Yes 會	<input type="checkbox"/>	No 不會	<input checked="" type="checkbox"/>	Yes 會	<input type="checkbox"/>	No 不會	<input checked="" type="checkbox"/>	Yes 會	<input type="checkbox"/>	No 不會	<input checked="" type="checkbox"/>	Yes 會	<input type="checkbox"/>	No 不會	<input checked="" type="checkbox"/>	Yes 會	<input type="checkbox"/>	No 不會	<input checked="" type="checkbox"/>	Yes 會	<input type="checkbox"/>	No 不會	<input checked="" type="checkbox"/>	Yes 會	<input type="checkbox"/>	No 不會	<input checked="" type="checkbox"/>	Yes 會	<input type="checkbox"/>	No 不會	<input checked="" type="checkbox"/>
Yes 會	<input type="checkbox"/>	No 不會	<input checked="" type="checkbox"/>																																			
Yes 會	<input type="checkbox"/>	No 不會	<input checked="" type="checkbox"/>																																			
Yes 會	<input type="checkbox"/>	No 不會	<input checked="" type="checkbox"/>																																			
Yes 會	<input type="checkbox"/>	No 不會	<input checked="" type="checkbox"/>																																			
Yes 會	<input type="checkbox"/>	No 不會	<input checked="" type="checkbox"/>																																			
Yes 會	<input type="checkbox"/>	No 不會	<input checked="" type="checkbox"/>																																			
Yes 會	<input type="checkbox"/>	No 不會	<input checked="" type="checkbox"/>																																			
Yes 會	<input type="checkbox"/>	No 不會	<input checked="" type="checkbox"/>																																			
Yes 會	<input type="checkbox"/>	No 不會	<input checked="" type="checkbox"/>																																			

**10. Justifications 理由**

The applicant is invited to provide justifications in support of the application. Use separate sheets if necessary.  
現請申請人提供申請理由及支持其申請的資料。如有需要，請另頁說明。

The applicant seeks to use Lot 1225 S.C, 1226 S.E and 1230 S.B in D.D.107, Fung Kat Heung, Kam Tin, Yeung Long, New Territories (the Site) for 'Proposed Temporary Animal Boarding Establishment for a Period of 5 Years and Land Filling' (proposed development) (Plan P01). The applicant would like use the Site to operate new animal boarding establishment (dog kennel) to serve pet owner.

The Site falls within an area zoned as "Agriculture" ("AGR") on the Approved Kam Tin North Outline Zoning Plan No. S/YL-KTN/9 (Plan P02). According to the Notes of the OZP, 'animal boarding establishment' is a column 2 use within the "AGR" zone, which requires permission from the Board. Since the application is only on a temporary basis, it will not jeopardize the long term planning intention of the "AGR" zone.

The Site occupied an area of 565 sq.m (about) of private land (Plan P03). One structure is proposed at the Site for animal boarding establishment, site office and storage of pet goods with total GFA of 120 sq.m (about)(Plan P04). The Site involves of 60 sq.m filling of land of not more than 0.2m (about) in depth for site formation of structures (Plan P05). The applicant will reinstate the Site to a condition which is suitable for agricultural uses after the planning approval period.

The operation hours of the proposed development are 09:00 to 18:00 daily (including public holiday). The proposed development will not operate between 18:00 and 09:00 (except for overnight animal boarding establishment) during the planning approval period. The estimated number of staff working at the Site is four. Two staffs will stay at the Site overnight to handle potential complaints arising from the proposed development. No visitor is allowed at the Site.

A total of not more than 30 dogs will be kept at the Site. All dogs are kept in cages and placed inside enclosed structures fitted with soundproofing materials and mechanical ventilation and air-conditioning systems. No public announcement system, whistle blowing, portable loud speaker, or any form of audio amplification system is allowed on the Site during the planning approval period.

The Site is accessible from Castle Peak Road - Tam Mei via a local access (Plan P01). Two private car parking and one loading / unloading spaces for light goods vehicle are provided for the use of staff only. Sufficient maneuvering space is provided within the Site to ensure no queuing, turning back outside the Site and onto public road. Medium or heavy goods vehicles exceeding 5.5 tonnes, including container tractor/trailer are prohibited to parked/stored at the Site.

The applicant will strictly follow the 'Code of Practice on Handling the Environmental Aspects of Temporary Uses and Open Storage Sites' issued by Environmental Protection Department to minimize adverse environmental impacts and nuisance to the surrounding area. The applicant will strictly follow the Professional Persons Environmental Consultative Committee Practice Notes for sewage treatment at the Site.

The applicant will submit a Boarding Establishment License in accordance to The Public Health (Animals) (Boarding Establishment) Regulations to Agriculture, Fisheries and Conservation Department after planning approval has been granted by the Board.

The proposed development will not create significant adverse traffic, environmental, landscape and drainage impacts to the surrounding areas. Adequate mitigation measures will be provided after planning approval has been granted from the Board, i.e. submission of drainage and fire service installations proposals to mitigate any adverse impact arising from the proposed development.

In view of the above, the Board is hereby respectfully requested to approve the subject application for 'Proposed Temporary Animal Boarding Establishment for a Period of 5 Years and Land Filling'.

**11. Declaration 聲明**

I hereby declare that the particulars given in this application are correct and true to the best of my knowledge and belief.  
本人謹此聲明，本人就這宗申請提交的資料，據本人所知及所信，均屬真實無誤。

I hereby grant a permission to the Board to copy all the materials submitted in an application to the Board and/or to upload such materials to the Board's website for browsing and downloading by the public free-of-charge at the Board's discretion.  
本人現准許委員會酌將本人就此申請所提交的所有資料複製及/或上載至委員會網站，供公眾免費瀏覽或下載。

Signature  
簽署

☐ Applicant 申請人 / ☒ Authorised Agent 獲授權代理人

Michael WONG

Name in Block Letters  
姓名（請以正楷填寫）

Position (if applicable)  
職位（如適用）

Professional Qualification(s)  
專業資格

☐ Member 會員 / ☐ Fellow of 資深會員

☐ HKIP 香港規劃師學會 / ☐ HKIA 香港建築師學會 /

☐ HKIS 香港測量師學會 / ☐ HKIE 香港工程師學會 /

☐ HKILA 香港園境師學會 / ☐ HKIUD 香港城市設計學會 /

☐ RPP 註冊專業規劃師

Others 其他

on behalf of  
代表

R-riches Property Consultants Limited

☒ Company 公司 / ☐ Organisation Name and Chop (if applicable) 機構名稱及蓋章（如適用）

Date 日期

09/04/2021

(DD/MM/YYYY 日/月/年)

**Remark 備註**

The materials submitted in an application to the Board and the Board's decision on the application would be disclosed to the public. Such materials would also be uploaded to the Board's website for browsing and free downloading by the public where the Board considers appropriate.

委員會會向公眾披露申請人所遞交的申請資料和委員會對申請所作的決定。在委員會認為合適的情況下，有關申請資料亦會上載至委員會網頁供公眾免費瀏覽及下載。

**Warning 警告**

Any person who knowingly or wilfully makes any statement or furnish any information in connection with this application, which is false in any material particular, shall be liable to an offence under the Crimes Ordinance.

任何人在明知或故意的情況下，就這宗申請提出在任何要項上是虛假的陳述或資料，即屬違反《刑事罪行條例》。

**Statement on Personal Data 個人資料的聲明**

1. The personal data submitted to the Board in this application will be used by the Secretary of the Board and Government departments for the following purposes:

委員會就這宗申請所收到的個人資料會交給委員會秘書及政府部門，以根據《城市規劃條例》及相關的城市規劃委員會規劃指引的規定作以下用途：

(a) the processing of this application which includes making available the name of the applicant for public inspection when making available this application for public inspection; and

處理這宗申請，包括公布這宗申請供公眾查閱，同時公布申請人的姓名供公眾查閱；以及

(b) facilitating communication between the applicant and the Secretary of the Board/Government departments. 方便申請人與委員會秘書及政府部門之間進行聯絡。

2. The personal data provided by the applicant in this application may also be disclosed to other persons for the purposes mentioned in paragraph 1 above.

申請人就這宗申請提供的個人資料，或亦會向其他人士披露，以作上述第 1 段提及的用途。

3. An applicant has a right of access and correction with respect to his/her personal data as provided under the Personal Data (Privacy) Ordinance (Cap. 486). Request for personal data access and correction should be addressed to the Secretary of the Board at 15/F, North Point Government Offices, 333 Java Road, North Point, Hong Kong.

根據《個人資料(私隱)條例》(第 486 章)的規定，申請人有權查閱及更正其個人資料。如欲查閱及更正個人資料，應向委員會秘書提出有關要求，其地址為香港北角渣華道 333 號北角政府合署 15 樓。

**For Developments involving Columbarium Use, please also complete the following:**  
**如發展涉及靈灰安置所用途，請另外填妥以下資料：**

**Ash interment capacity 骨灰安放容量<sup>@</sup>**

Maximum number of sets of ashes that may be interred in the niches

在龕位內最多可安放骨灰的數量

Maximum number of sets of ashes that may be interred other than in niches

在非龕位的範圍內最多可安放骨灰的數量

**Total number of niches 龕位總數**

Total number of single niches

單人龕位總數

Number of single niches (sold and occupied)

單人龕位數目 (已售並佔用)

Number of single niches (sold but unoccupied)

單人龕位數目 (已售但未佔用)

Number of single niches (residual for sale)

單人龕位數目 (待售)

Total number of double niches

雙人龕位總數

Number of double niches (sold and fully occupied)

雙人龕位數目 (已售並全部佔用)

Number of double niches (sold and partially occupied)

雙人龕位數目 (已售並部分佔用)

Number of double niches (sold but unoccupied)

雙人龕位數目 (已售但未佔用)

Number of double niches (residual for sale)

雙人龕位數目 (待售)

Total no. of niches other than single or double niches (please specify type)

除單人及雙人龕位外的其他龕位總數 (請列明類別)

Number of niches (sold and fully occupied)

龕位數目 (已售並全部佔用)

Number of niches (sold and partially occupied)

龕位數目 (已售並部分佔用)

Number of niches (sold but unoccupied)

龕位數目 (已售但未佔用)

Number of niches (residual for sale)

龕位數目 (待售)

**Proposed operating hours 擬議營運時間**

<sup>@</sup> Ash interment capacity in relation to a columbarium means –

就靈灰安置所而言，骨灰安放容量指：

- the maximum number of containers of ashes that may be interred in each niche in the columbarium;  
每個龕位內可安放的骨灰容器的最高數目；
- the maximum number of sets of ashes that may be interred other than in niches in any area in the columbarium; and  
在該靈灰安置所並非龕位的範圍內，總共最多可安放多少份骨灰；以及
- the total number of sets of ashes that may be interred in the columbarium.  
在該靈灰安置所內，總共最多可安放多少份骨灰。

## Gist of Application 申請摘要

(Please provide details in both English and Chinese as far as possible. This part will be circulated to relevant consultees, uploaded to the Town Planning Board's Website for browsing and free downloading by the public and deposited at the Planning Enquiry Counters of the Planning Department for general information.)

(請盡量以英文及中文填寫。此部分將會發送予相關諮詢人士、上載至城市規劃委員會網頁供公眾免費瀏覽及下載及存放於規劃署規劃資料查詢處以供一般參閱。)

Application No. 申請編號	(For Official Use Only) (請勿填寫此欄)		
Location/address 位置/地址	Lot 1225 S.C, 1226 S.E and 1230 S.B in D.D.107, Fung Kat Heung, Kam Tin, Yuen Long, New Territories		
Site area 地盤面積	sq. m 平方米 <input type="checkbox"/> About 約 (includes Government land of 包括政府土地 sq. m 平方米 <input type="checkbox"/> About 約)		
Plan 圖則	Approved Kam Tin North Outline Zoning Plan No.: S/YL-KTN/9		
Zoning 地帶	"Agriculture" Zone		
Applied use/ development 申請用途/發展	Proposed Temporary Animal Boarding Establishment for a Period of 5 Years and Land Filling		
(i) Gross floor area and/or plot ratio 總樓面面積及/或地積比率		sq.m 平方米	Plot Ratio 地積比率
	Domestic 住用	/ <input type="checkbox"/> About 約 <input type="checkbox"/> Not more than 不多於	/ <input type="checkbox"/> About 約 <input type="checkbox"/> Not more than 不多於
	Non-domestic 非住用	120 <input checked="" type="checkbox"/> About 約 <input type="checkbox"/> Not more than 不多於	0.2 <input checked="" type="checkbox"/> About 約 <input type="checkbox"/> Not more than 不多於
(ii) No. of block 幢數	Domestic 住用	/	
	Non-domestic 非住用	1	
	Composite 綜合用途	/	

(iii) Building height/No. of storeys 建築物高度／層數	Domestic 住用	/	m 米 <input type="checkbox"/> (Not more than 不多於)
		/	mPD 米(主水平基準上) <input type="checkbox"/> (Not more than 不多於)
		/	Storeys(s) 層 <input type="checkbox"/> (Not more than 不多於) ( <input type="checkbox"/> Include 包括 <input type="checkbox"/> Exclude 不包括 <input type="checkbox"/> Carport 停車間 <input type="checkbox"/> Basement 地庫 <input type="checkbox"/> Refuge Floor 防火層 <input type="checkbox"/> Podium 平台)
	Non-domestic 非住用	7 (about)	m 米 <input type="checkbox"/> (Not more than 不多於)
		/	mPD 米(主水平基準上) <input type="checkbox"/> (Not more than 不多於)
		2	Storeys(s) 層 <input type="checkbox"/> (Not more than 不多於) ( <input type="checkbox"/> Include 包括 <input type="checkbox"/> Exclude 不包括 <input type="checkbox"/> Carport 停車間 <input type="checkbox"/> Basement 地庫 <input type="checkbox"/> Refuge Floor 防火層 <input type="checkbox"/> Podium 平台)
	Composite 綜合用途	/	m 米 <input type="checkbox"/> (Not more than 不多於)
		/	mPD 米(主水平基準上) <input type="checkbox"/> (Not more than 不多於)
		/	Storeys(s) 層 <input type="checkbox"/> (Not more than 不多於) ( <input type="checkbox"/> Include 包括 <input type="checkbox"/> Exclude 不包括 <input type="checkbox"/> Carport 停車間 <input type="checkbox"/> Basement 地庫 <input type="checkbox"/> Refuge Floor 防火層 <input type="checkbox"/> Podium 平台)
(iv) Site coverage 上蓋面積	11 % <input checked="" type="checkbox"/> About 約		
(v) No. of units 單位數目	/		
(vi) Open space 休憩用地	Private 私人	/	sq.m 平方米 <input type="checkbox"/> Not less than 不少於
	Public 公眾	/	sq.m 平方米 <input type="checkbox"/> Not less than 不少於

(vii) No. of parking spaces and loading / unloading spaces 停車位及上落客貨車位數目	Total no. of vehicle parking spaces 停車位總數	2
	Private Car Parking Spaces 私家車車位 Motorcycle Parking Spaces 電單車車位 Light Goods Vehicle Parking Spaces 輕型貨車泊車位 Medium Goods Vehicle Parking Spaces 中型貨車泊車位 Heavy Goods Vehicle Parking Spaces 重型貨車泊車位 Others (Please Specify) 其他 (請列明)	2 / / / / / /
	Total no. of vehicle loading/unloading bays/lay-bys 上落客貨車位／停車處總數	1
	Taxi Spaces 的士車位 Coach Spaces 旅遊巴車位 Light Goods Vehicle Spaces 輕型貨車車位 Medium Goods Vehicle Spaces 中型貨車車位 Heavy Goods Vehicle Spaces 重型貨車車位 Others (Please Specify) 其他 (請列明)	/ / 1 / / /

#### Submitted Plans, Drawings and Documents 提交的圖則、繪圖及文件

	Chinese 中文	English 英文
<b>Plans and Drawings 圖則及繪圖</b>		
Master layout plan(s)/Layout plan(s) 總綱發展藍圖／布局設計圖	<input type="checkbox"/>	<input checked="" type="checkbox"/>
Block plan(s) 樓宇位置圖	<input type="checkbox"/>	<input type="checkbox"/>
Floor plan(s) 樓宇平面圖	<input type="checkbox"/>	<input type="checkbox"/>
Sectional plan(s) 截視圖	<input type="checkbox"/>	<input type="checkbox"/>
Elevation(s) 立視圖	<input type="checkbox"/>	<input type="checkbox"/>
Photomontage(s) showing the proposed development 顯示擬議發展的合成照片	<input type="checkbox"/>	<input type="checkbox"/>
Master landscape plan(s)/Landscape plan(s) 園境設計總圖／園境設計圖	<input type="checkbox"/>	<input type="checkbox"/>
Others (please specify) 其他 (請註明)	<input type="checkbox"/>	<input checked="" type="checkbox"/>
Location plan, Plan showing the zoning of the application site, Plan showing the land status of the application site, Plan showing the paved ratio of the application site		
<b>Reports 報告書</b>		
Planning Statement/Justifications 規劃綱領/理據	<input type="checkbox"/>	<input type="checkbox"/>
Environmental assessment (noise, air and/or water pollutions) 環境評估 (噪音、空氣及／或水的污染)	<input type="checkbox"/>	<input type="checkbox"/>
Traffic impact assessment (on vehicles) 就車輛的交通影響評估	<input type="checkbox"/>	<input type="checkbox"/>
Traffic impact assessment (on pedestrians) 就行人的交通影響評估	<input type="checkbox"/>	<input type="checkbox"/>
Visual impact assessment 視覺影響評估	<input type="checkbox"/>	<input type="checkbox"/>
Landscape impact assessment 景觀影響評估	<input type="checkbox"/>	<input type="checkbox"/>
Tree Survey 樹木調查	<input type="checkbox"/>	<input type="checkbox"/>
Geotechnical impact assessment 土力影響評估	<input type="checkbox"/>	<input type="checkbox"/>
Drainage impact assessment 排水影響評估	<input type="checkbox"/>	<input type="checkbox"/>
Sewerage impact assessment 排污影響評估	<input type="checkbox"/>	<input type="checkbox"/>
Risk Assessment 風險評估	<input type="checkbox"/>	<input type="checkbox"/>
Others (please specify) 其他 (請註明)	<input type="checkbox"/>	<input type="checkbox"/>

Note: May insert more than one '✓'. 註：可在多於一個方格內加上「✓」號



**Note:** The information in the Gist of Application above is provided by the applicant for easy reference of the general public. Under no circumstances will the Town Planning Board accept any liabilities for the use of the information nor any inaccuracies or discrepancies of the information provided. In case of doubt, reference should always be made to the submission of the applicant.

**註：** 上述申請摘要的資料是由申請人提供以方便市民大眾參考。對於所載資料在使用上的問題及文義上的歧異，城市規劃委員會概不負責。若有任何疑問，應查閱申請人提交的文件。

此為空白頁。

This is a blank page.

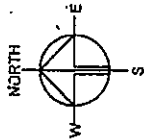

LOCATION OF THE APPLICATION SITE

APPLICATION SITE AREA : 555m<sup>2</sup> (ABOUT)

ACCESSIBLE FROM CASTLE PEAK ROAD - TAM MEI VIA A LOCAL ACCESS

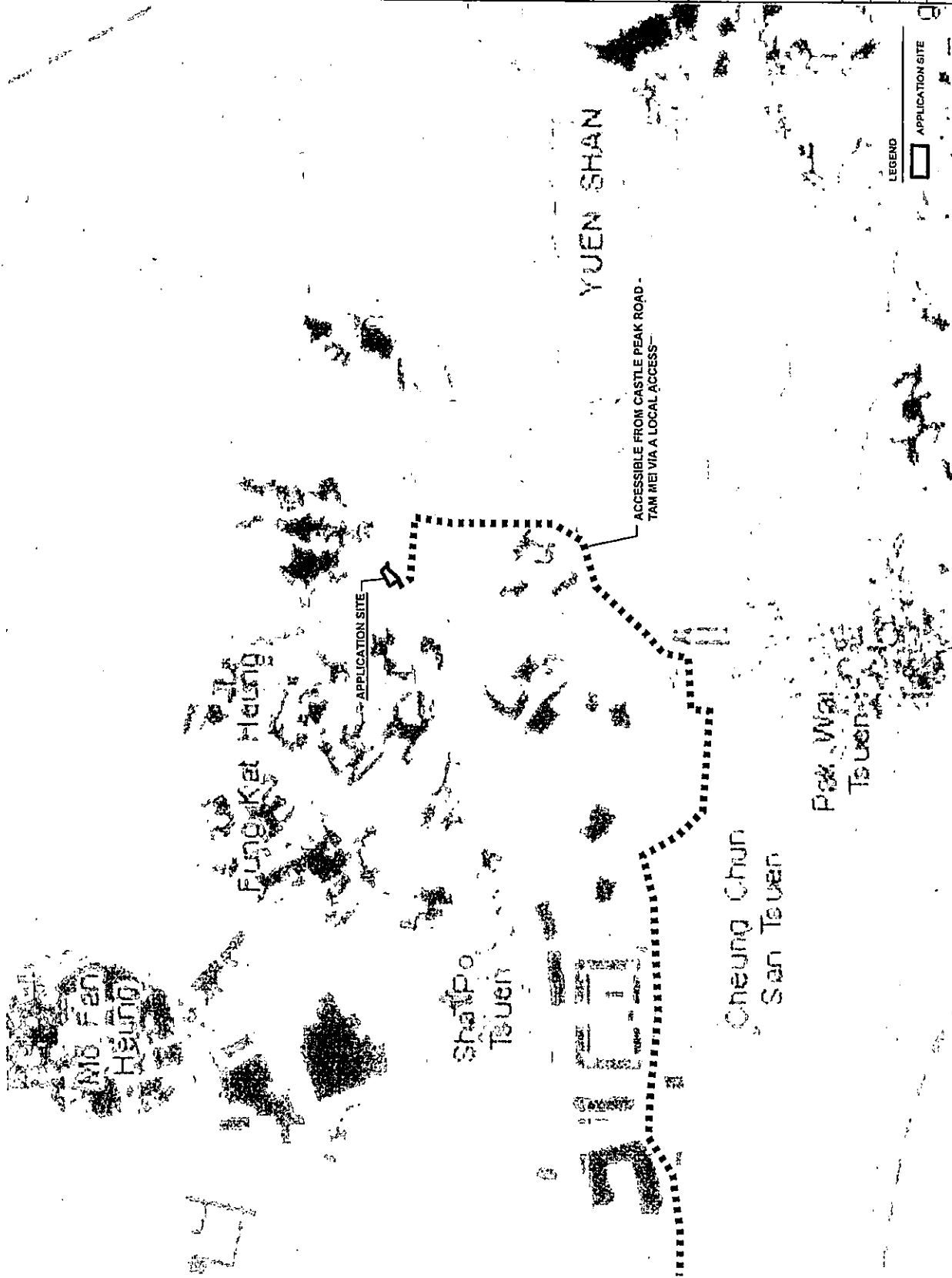

Drawing No.	P01	Vol.	01
Project	PROPOSED TEMPORARY ANIMAL BOARDING ESTABLISHMENT FOR A PERIOD OF 5 YEARS AND LAND FILLING		
Location	LOT 1225 S.C. & V.I. IN D.D. 107, FUNG KAT HEUNG, KAM TIN		
Drawing Title	LOCATION PLAN		
Scale of A4	1:10000		
Drawn	1.4.2021		
Revised			

LEGEND  
☐ APPLICATION SITE

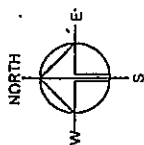

# ZONING OF THE APPLICATION SITE

APPLICATION SITE AREA : 565m<sup>2</sup> (ABOUT)  
 OUTLINE ZONING PLAN : APPROVED KAM TIN NORTH OZP  
 OZP PLAN NO. : SYL-KTN9  
 AREA ZONED AS "AGR" : 565m<sup>2</sup> (ABOUT) (100%)  
 AREA SHOWN AS "ID" : NOT APPLICABLE  
 AREA SHOWN AS "CA" : NOT APPLICABLE

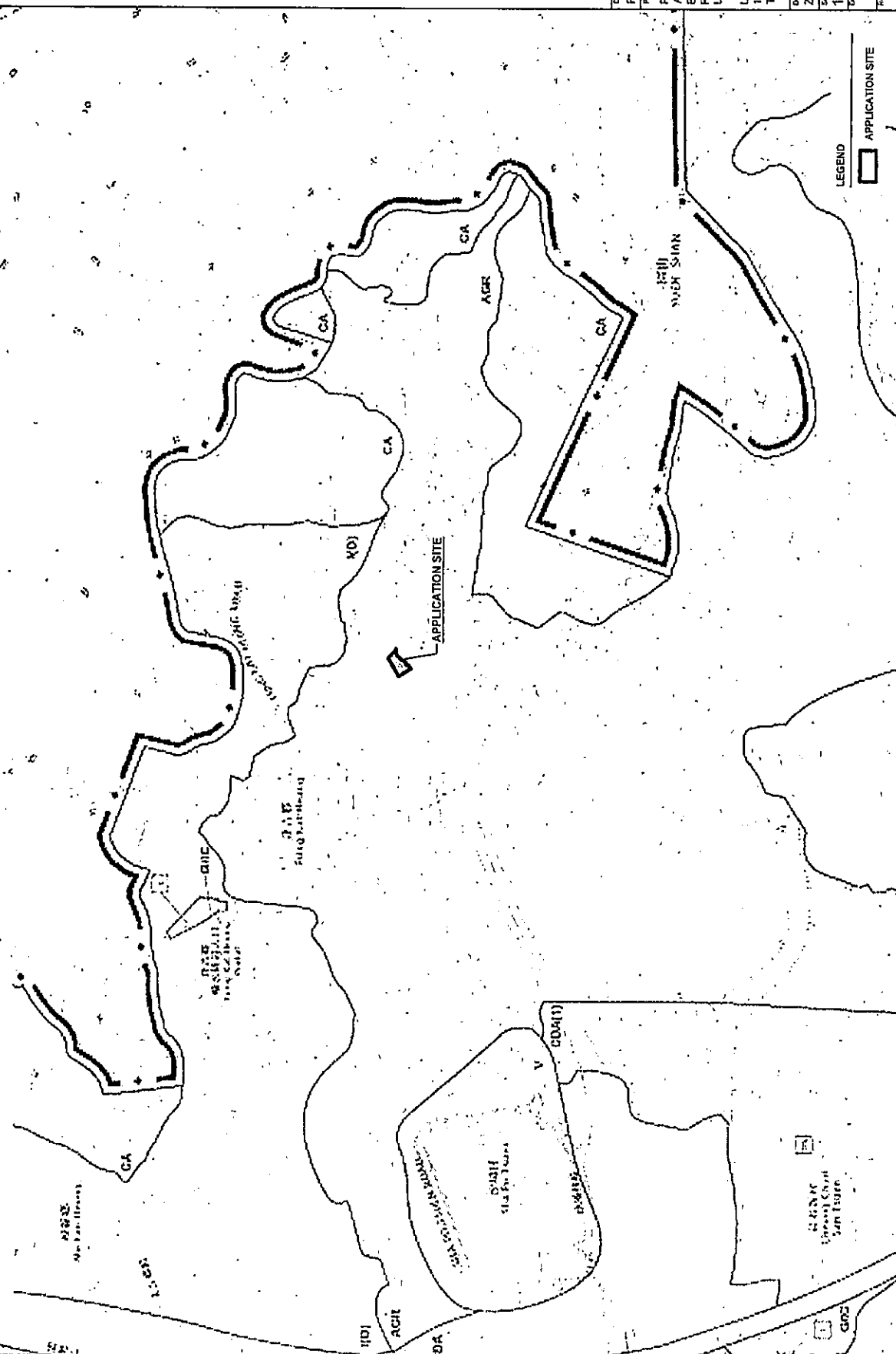

Drawing No.	P02	Vol.	01
Project	PROPOSED TEMPORARY BOARDING ANIMAL ESTABLISHMENT FOR A PERIOD OF 5 YEARS AND LAND FILLING		
Location	LOT 1225 S.C. & VL IN D.D. 107, FUNG KAT HEUNG, KAM TIN		
Drawing Scale	1 : 8000		
Zoning of the Site	1 : 8000		
Date	1.4.2021		
Drawn by			
Checked by			

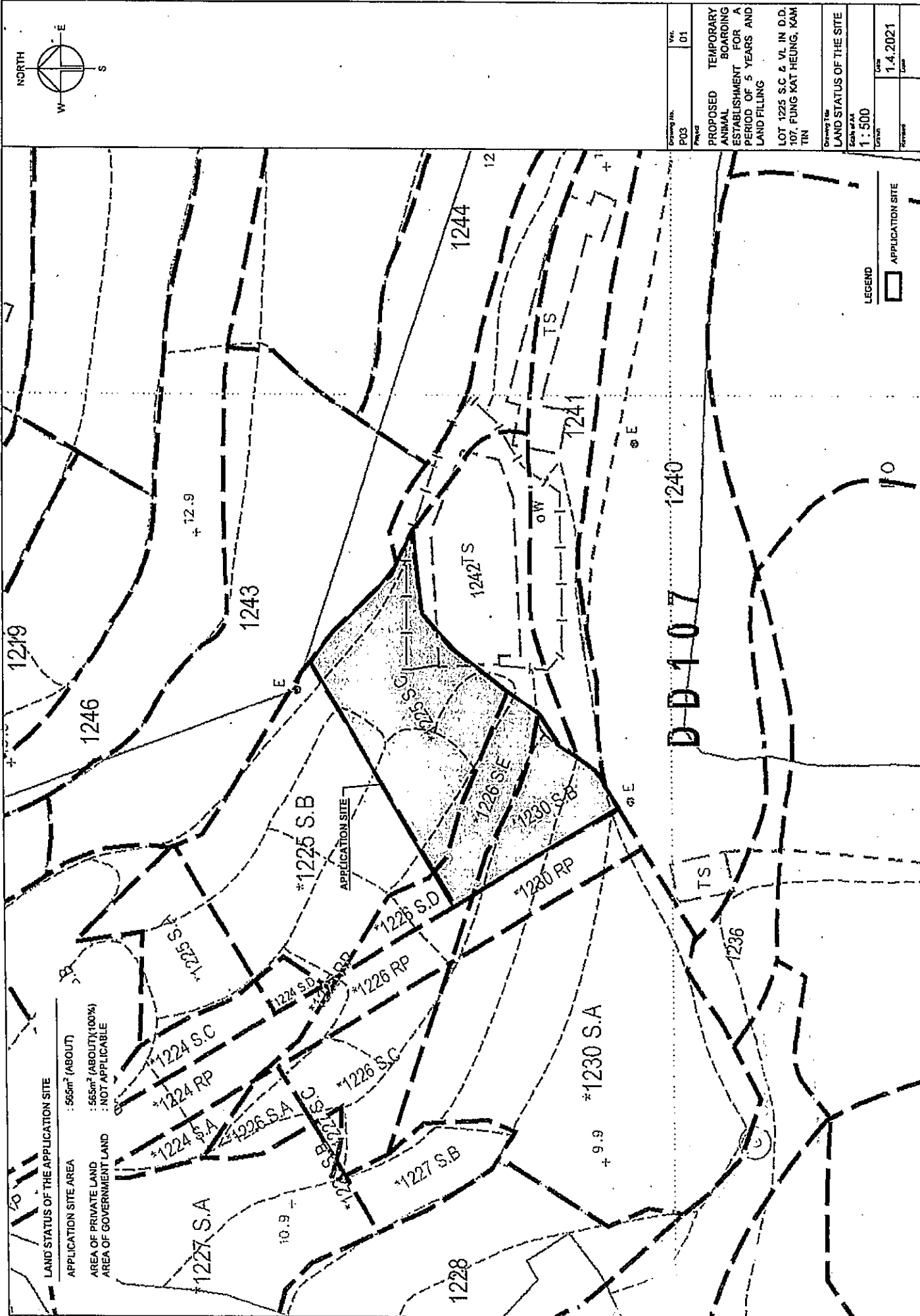

# DEVELOPMENT PARAMETERS OF THE APPLICATION SITE

APPLICATION SITE AREA	: 565m <sup>2</sup> (ABOUT)
COVERED AREA	: 60m <sup>2</sup> (ABOUT)
UNCOVERED AREA	: 505m <sup>2</sup> (ABOUT)
PLOT RATIO	: 0.2 (ABOUT)
SITE COVERAGE	: 11% (ABOUT)
NO. OF STRUCTURE	: 1
DOMESTIC GFA	: NOT APPLICABLE
NON-DOMESTIC GFA	: 120m <sup>2</sup> (ABOUT)
BUILDING HEIGHT	: 7m (ABOUT)
NO. OF STOREY	: 2

STRUCTURE	USE	COVERED AREA	GFA	BUILDING HEIGHT
B1	ANIMAL BOARDING ESTABLISHMENT STORAGE OF PET GOODS	60m <sup>2</sup> (ABOUT)	120m <sup>2</sup> (ABOUT)	7m (ABOUT)(2-STOREY)
TOTAL		60m <sup>2</sup> (ABOUT)	120m <sup>2</sup> (ABOUT)	

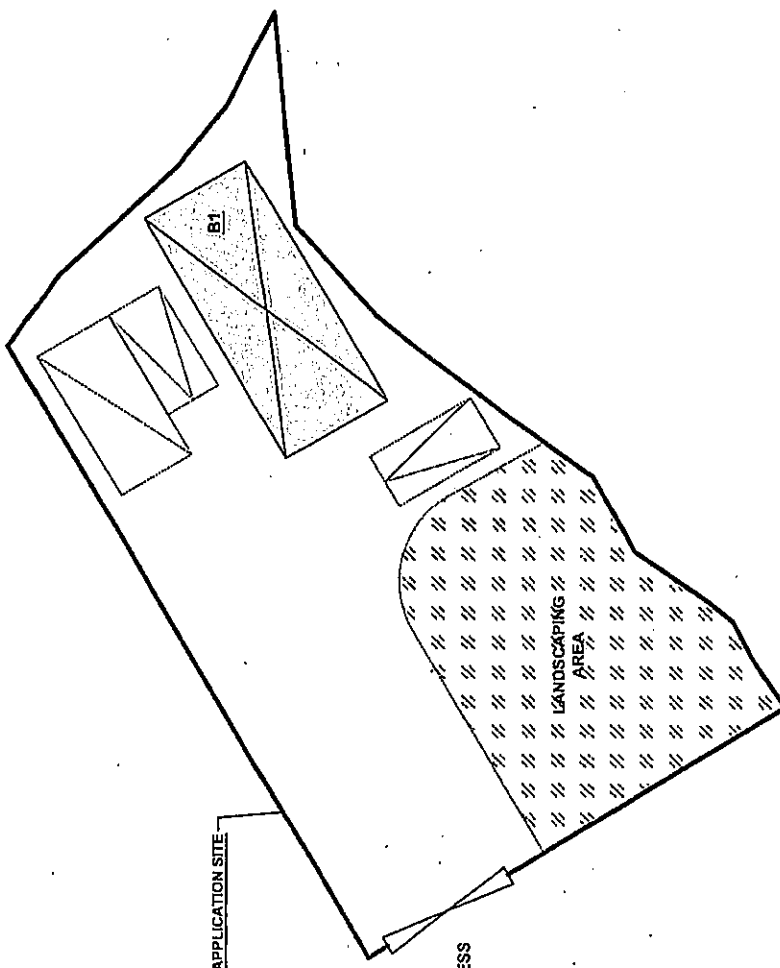
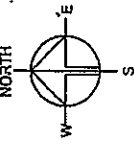

## PARKING PROVISIONS

NO. OF PRIVATE CAR PARKING SPACE	: 2
DIMENSION OF PARKING SPACE	: 2.5m (W) X 5m (L)
NO. OF LUL SPACE FOR LIGHT GOODS VEHICLE	: 1
DIMENSION OF LUL SPACE	: 3.5m (W) X 7m (L)

LEGEND
APPLICATION SITE
STRUCTURE
PARKING SPACE
LUL SPACE
INGRESS / EGRESS

Drawing No.	Ver	01
P04		
Project		
PROPOSED TEMPORARY ANIMAL BOARDING ESTABLISHMENT FOR A PERIOD OF 5 YEARS AND LAND FILLING		
LOT 1225 S.C. & V.L. IN D.D. 107, FUNG KAT HEUNG, KAM TIN		
Drawing Title		
LAYOUT PLAN		
Scale of A1		
1 : 300		
Drawn	Date	27.4.2021
Checked	UHF	

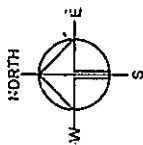

#### PAVED RATIO OF THE APPLICATION SITE

APPLICATION SITE AREA COVERED BY STRUCTURE	• 555m <sup>2</sup> (ABOUT)
GRASS PAVER AREA	• 60m <sup>2</sup> (11%)(ABOUT)
LANDSCAPING AREA	• 344m <sup>2</sup> (61%)(ABOUT)
LAND FILLING AREA	• 181m <sup>2</sup> (28%)(ABOUT)
LAND FILLING AREA	60m <sup>2</sup> (11%)(ABOUT)
DEPTH OF LAND FILLING	NOT MORE THAN 0.2m (ABOUT)
MATERIAL OF LAND FILLING	CONCRETE
PURPOSE OF LAND FILLING	• SITE FORMATION OF STRUCTURES

#### CIRCULATION AND PARKING / LUL SPACE

EXISTING SITE LEVEL : 10.2mPD (ABOUT)  
SURFACE : GRASS PAVER

\*NO LAND FILLING AT THIS PORTION OF THE SITE

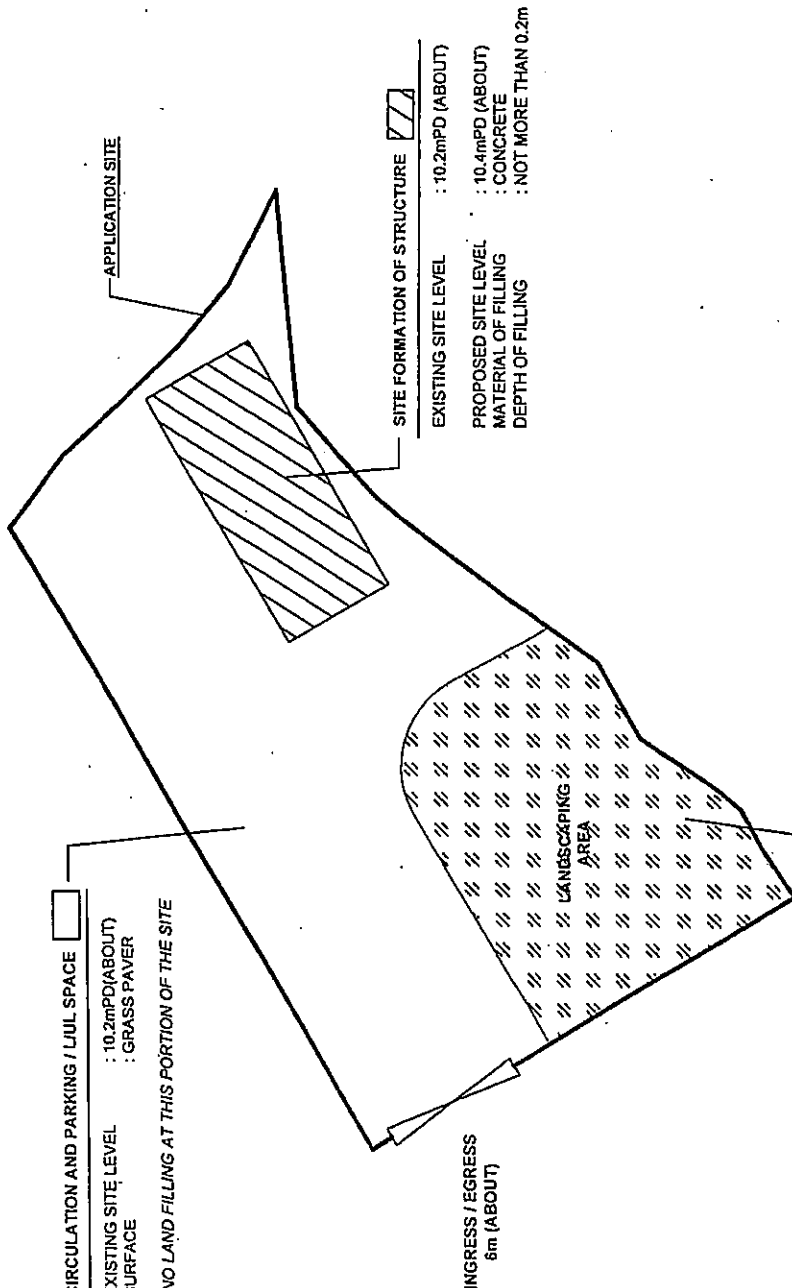

SITE FORMATION OF STRUCTURE  
EXISTING SITE LEVEL : 10.2mPD (ABOUT)  
PROPOSED SITE LEVEL : 10.4mPD (ABOUT)  
MATERIAL OF FILLING : CONCRETE  
DEPTH OF FILLING : NOT MORE THAN 0.2m

#### LANDSCAPING AREA

EXISTING SITE LEVEL : 10.2mPD (ABOUT)

\*NO LAND FILLING AT THIS PORTION OF THE SITE

#### LEGEND

	LAND FILLING AREA
	GRASS PAVER
	LANDSCAPING AREA

Drawing No.	Vol.	Page
P05	01	
PROPOSED TEMPORARY ANIMAL BOARDING ESTABLISHMENT FOR A PERIOD OF 5 YEARS AND LAND FILLING		
LOT 1225 S.C. & VL IN D.D. 107, FUNG KAT HEUNG, KAM TIN		
PAVED RATIO OF THE SITE		
Scale of 1:1	Scale of 1:1	Scale of 1:1
1:300	1:300	1:300
Date	Date	Date
1.4.2021	1.4.2021	1.4.2021
Drawn	Drawn	Drawn
Checked	Checked	Checked
Reviewed	Reviewed	Reviewed





Our Ref.: DD107 Lot 1225 S.C & VL  
Your ref.: TPB/A/YL-KTN/769

The Secretary  
Town Planning Board  
15/F, North Point Government office  
333 Java Road  
North Point, Hong Kong

**By Email**

2 July 2021

Dear Sir,

**1<sup>st</sup> Further Information**

**Proposed Temporary Animal Boarding Establishment for a Period of 5 Years  
and Land Filling in "Agriculture" Zone, Lots 1225 S.C, 1226 S.E  
and 1230 S.B in D.D.107, Fung Kat Heung, Kam Tin, Yuen Long, New Territories**

**(S.16 Planning Application No. A/YL-KTN/769)**

We are writing to submit further information to address departmental comments of the subject application (**Appendix I**).

Should you require more information regarding the application, please contact our Mr. Bon TANG at [redacted] or the undersigned at your convenience.

Yours faithfully,

For and on behalf of  
**R-riches Property Consultants Limited**



**Matthew NG**  
Town Planner

cc DPO/FSYLE, PlanD

(Attn.: Ms. Loree DUEN  
(Attn.: Mr. Vincent LAU

email: llyduen@pland.gov.hk )  
email: vkflau@pland.gov.hk )



## Responses-to-Comments

**Proposed Temporary Animal Boarding Establishment for a Period of 5 Years and Land Filling in "Agriculture" Zone,  
Lots 1225 S.C, 1226 S.E and 1230 S.B in D.D.107, Fung Kat Heung, Kam Tin, Yuen Long, New Territories**

**(Application No. A/YL-KTN/769)**

- (i) The application site (the Site) involves of a previous S.16 planning application (No. A/YL-KTN/745) for 'Proposed Temporary Place of Recreation, Sports or Culture (Hobby Farm) for a Period of 5 Years and Filling of Land', which was approved by the Town Planning Board (the Board) on 5.2.2021. As the Site falls within the application site of the approved application No. A/YL-KTN/745, mutual agreement has been reached by both applicants that only the animal boarding establishment will be implemented after planning approval has been obtained from the Board.
- (ii) Minor portion of the Site, i.e. 60m<sup>2</sup>, 11% (about) will be paved with concrete for site formation of structure B1. As heavy loading of structure B1 would compact the existing soiled ground and weaken the ground surface, concrete site formation is required to provide stronger ground reinforcement to stabilise the existing soiled ground and prevent erosion from surface run-off. The land filling area has been kept to minimal for the operation of the proposed development.
- (iii) A total area of 161m<sup>2</sup>, 28% (about) of the Site is proposed for landscaping area, which will also be used for outdoor dog activities area. Dog masks will be worn by dogs outdoor. All dogs will be kept indoor outside operation hours to minimise nuisance to the surroundings.
- (iv) A RtoC Table:

Departmental Comments		Applicant's Responses
<b>1. Comments of Commissioner for Transport (C for T) (Contact Person: Mr. Wilson LEE; Tel: 2399 2421)</b>		
(a)	The applicant should justify the proposed parking and loading / unloading considering the commute of staff / visitors and logistics;	The animal boarding establishment is a dog kennel (not open to the general public). Two private car parking spaces are provided for staff to commute to the application site (the Site). Dogs and goods to

		support the daily operation of the Site are transported by light goods vehicle, hence, one loading/unloading (L/UL) space for light goods vehicle is provide at the Site. Please be confirmed that <u>no</u> visitor is allowed to access the Site. Therefore, the parking and L/UL provisions are considered adequate for the operation of the proposed development.
(b)	The applicant should provide the trip generation and attraction due to the development and assess the traffic impact to Castle Peak Road – Tam Mi / San Tam Road and the local access;	The operation hours of the proposed development are from 09:00 to 18:00 daily. The proposed development will not operate between 18:00 and 09:00 (except for overnight animal boarding establishment) during the planning approval period. As vehicular trips generated by the proposed development is minimal, adverse traffic impact to Fung Kat Heung Road and the local access should not be anticipated ( <b>Annex I</b> ).
(c)	The applicant should demonstrate the smooth manoeuvring of vehicle to / from to Castle Park Road – Tam Mi / San Tam Road, along the local access and within the site;	Sufficient space is provided within the Site for vehicle to smoothly manoeuvre to / from Fung Kat Heung Road, along the local access and within the Site ( <b>Annex II</b> and <b>Plan 1</b> ).
(d)	The applicant should provide nearest public transport services and indicate on the layout plan; and	Plan showing the nearest public transport services is provided for your consideration ( <b>Plan 2</b> ).
(e)	The applicant should note the local access between Castle Peak Road – Tam Mi / San Tam Road and the site is not managed by this Department.	Noted



## Estimated Traffic Generation and Attraction

**Proposed Temporary Animal Boarding Establishment for a Period of 5 Years  
and Land Filling in "Agriculture" Zone, Lots 1225 S.C, 1226 S.E  
and 1230 S.B in D.D.107, Fung Kat Heung, Kam Tin, Yuen Long, New Territories**

**(Application No. A/YL-KTN/769)**

- (i) The operation hours of the proposed development are from 09:00 to 18:00 daily. The proposed development will not operate between 18:00 and 09:00 (except for overnight animal boarding establishment) during the planning approval period.
- (ii) Two private car parking spaces and one L/UL space for LGV are provided at the Site for staff. The breakdown of the estimated vehicular trips are as follows:

Time Period		Trip Generation				
		Private Car		Light Goods Vehicle		2-Way Total
		In	Out	In	Out	
<b>AM Peak</b>	09:00 – 10:00	2	0	0	0	2
	10:00 – 11:00	0	1	0	0	1
	11:00 – 12:00	0	0	1	0	1
	12:00 – 13:00	0	0	0	1	1
	13:00 – 14:00	1	1	0	0	2
	14:00 – 15:00	0	0	1	0	1
	15:00 – 16:00	0	0	0	1	1
	16:00 – 17:00	0	2	0	0	2
<b>PM Peak</b>	17:00 – 18:00	1	0	0	0	1

### Manoeuvring of Vehicles to / from Fung Kat Heung Road and along the Local Access

**Proposed Temporary Animal Boarding Establishment for a Period of 5 Years  
and Land Filling in "Agriculture" Zone, Lots 1225 S.C, 1226 S.E  
and 1230 S.B in D.D.107, Fung Kat Heung, Kam Tin, Yuen Long, New Territories**

(Application No. A/YL-KTN/769)

- (i) The Site is accessible from Fung Kat Heung Road via a local access. Sufficient space is provided for vehicle to smoothly manoeuvre to / from to Castle Peak Road – Tam Mi Road, along the local access, details are as follow:

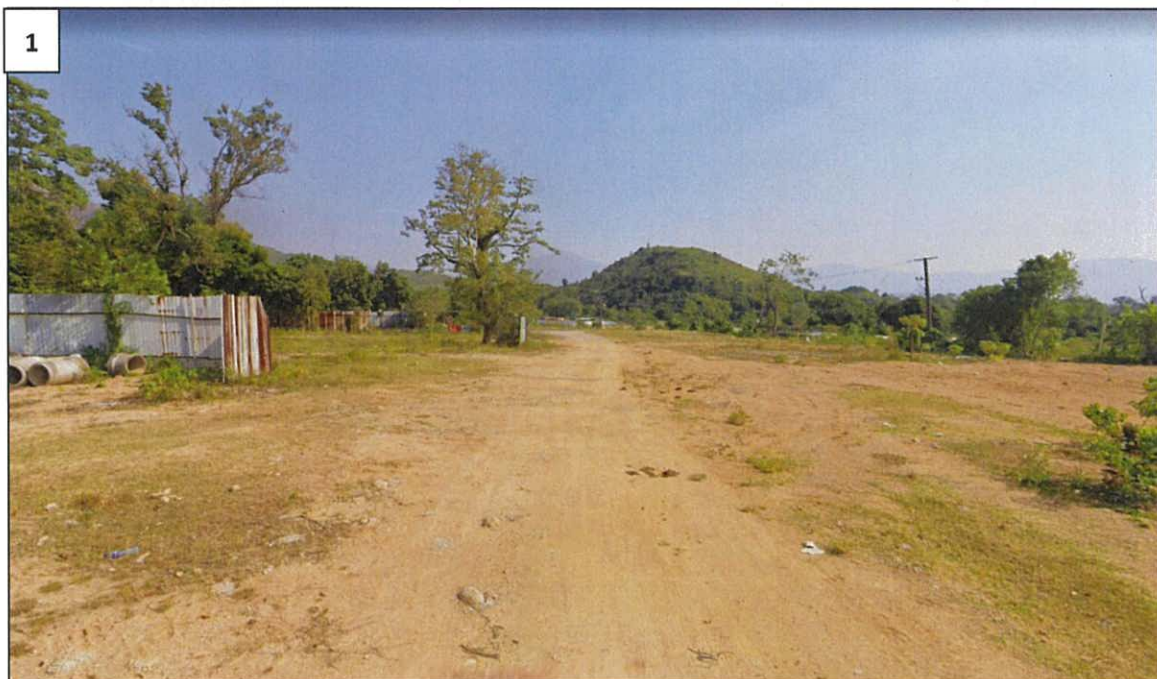
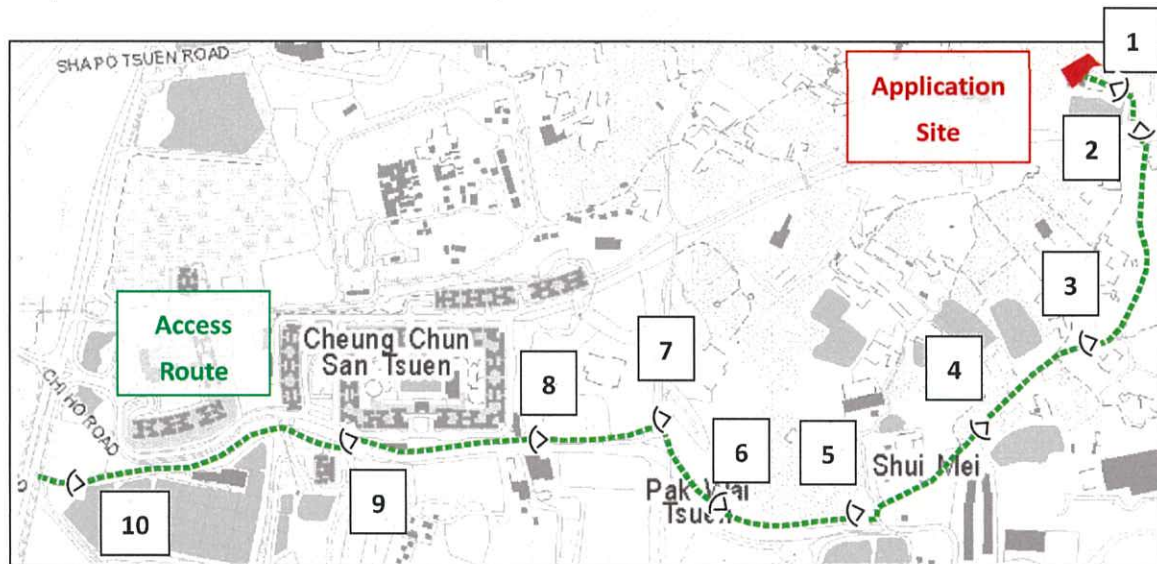



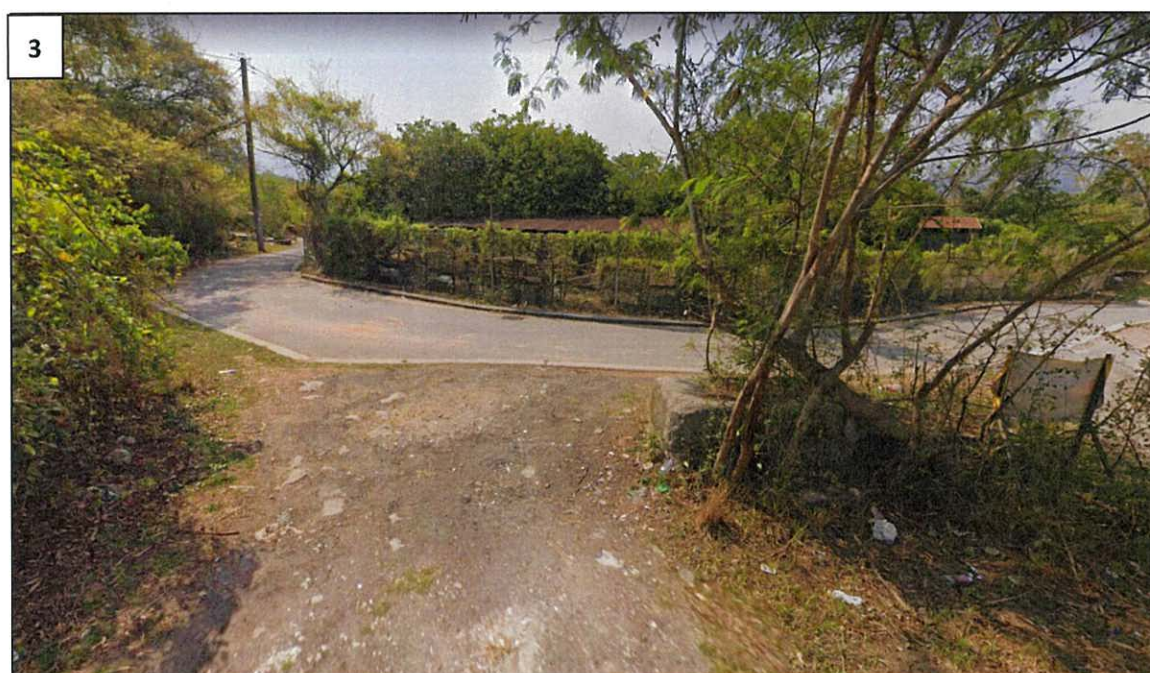
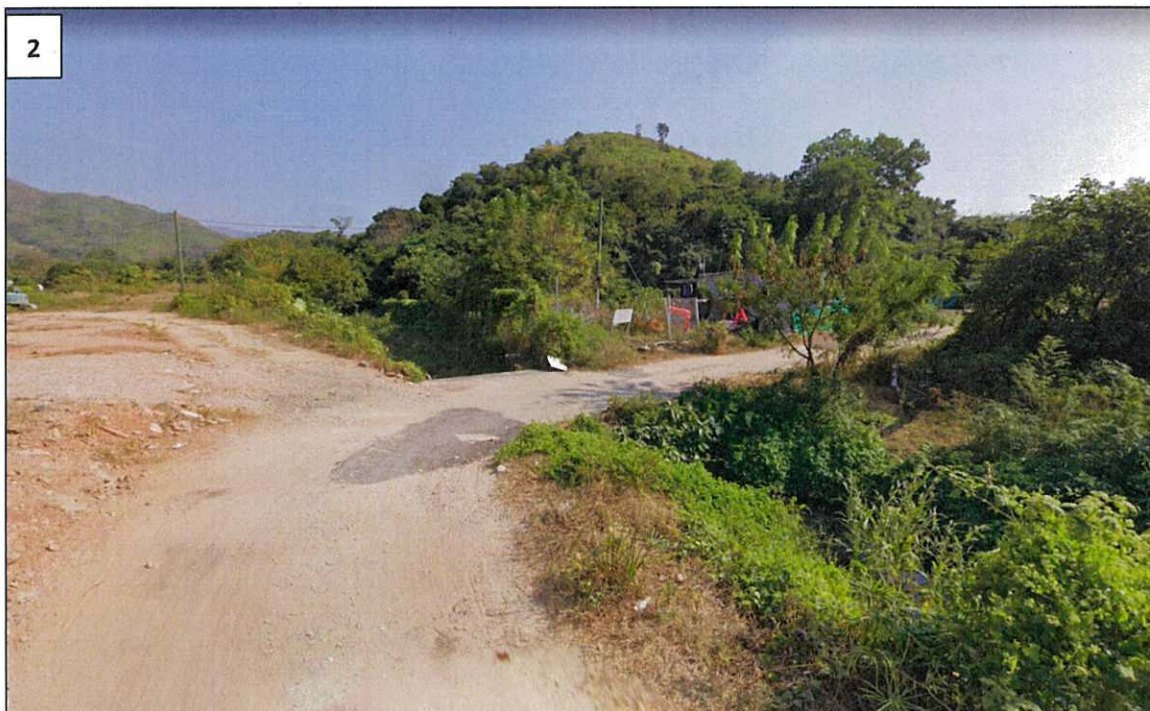







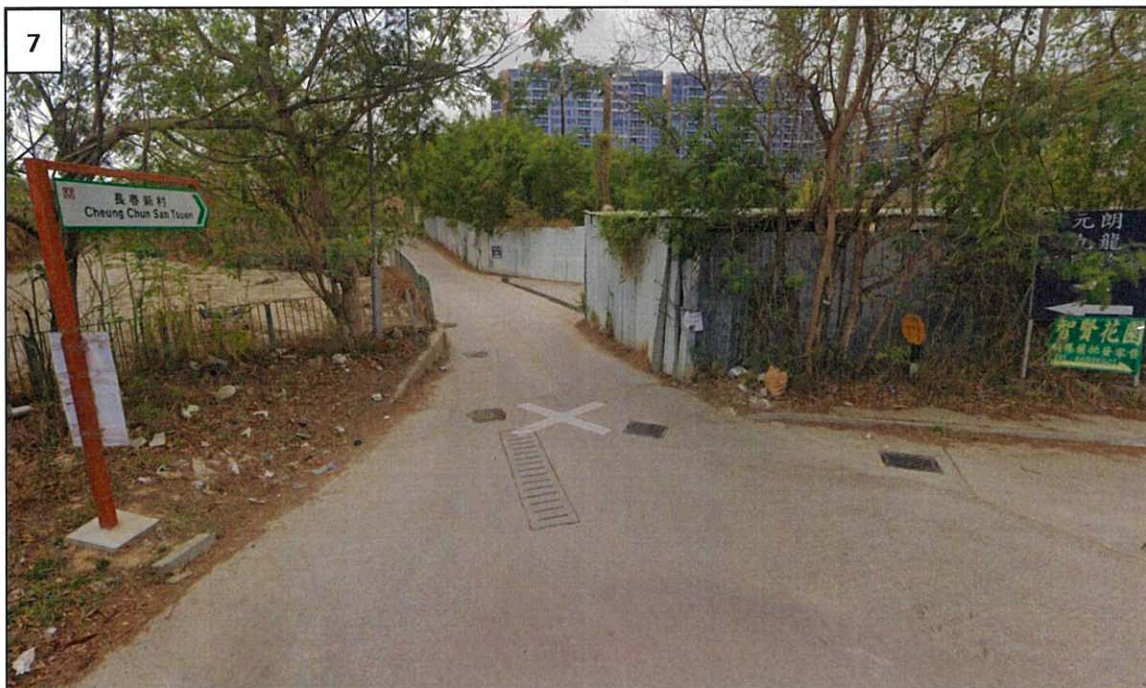
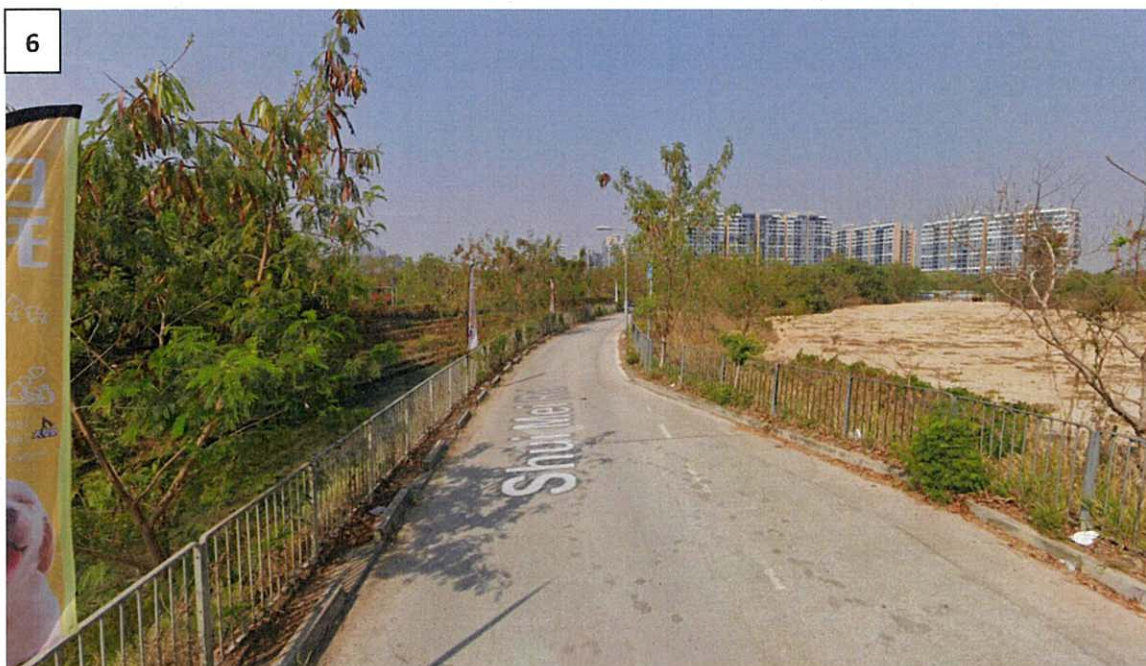



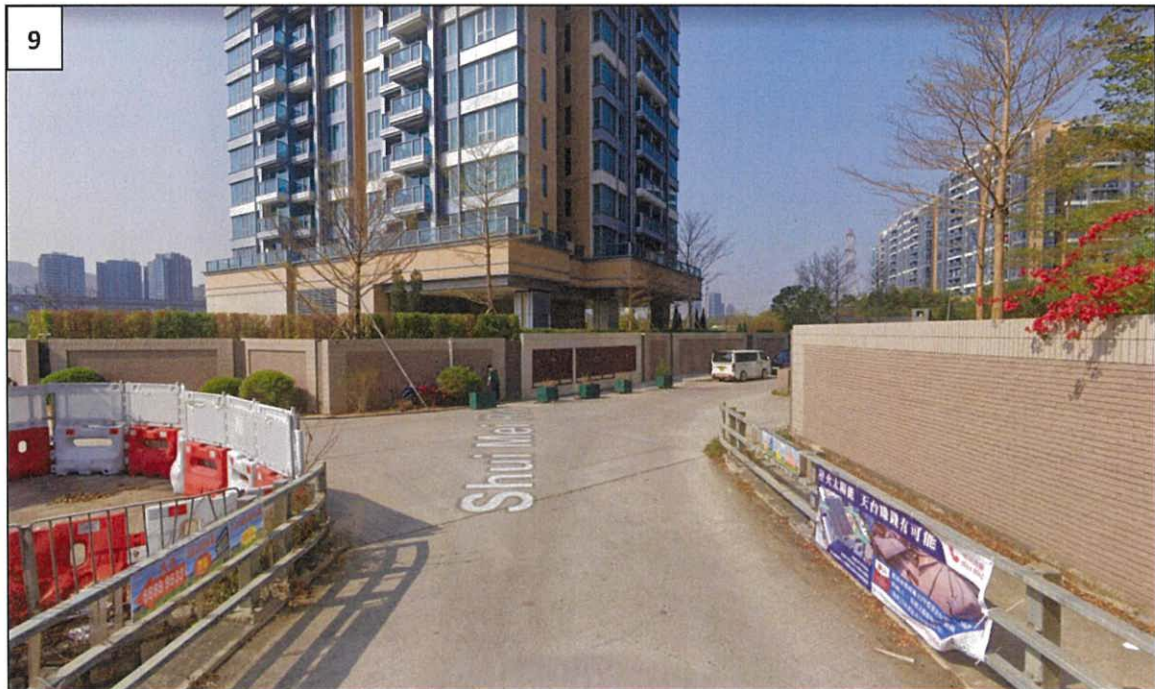
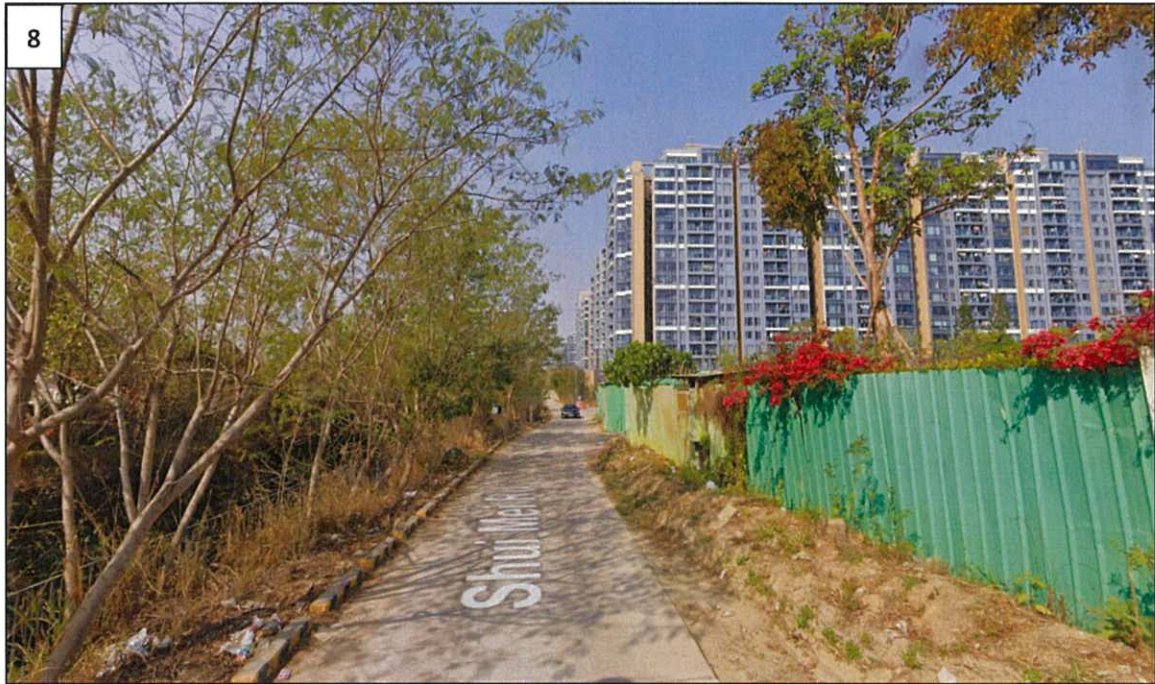





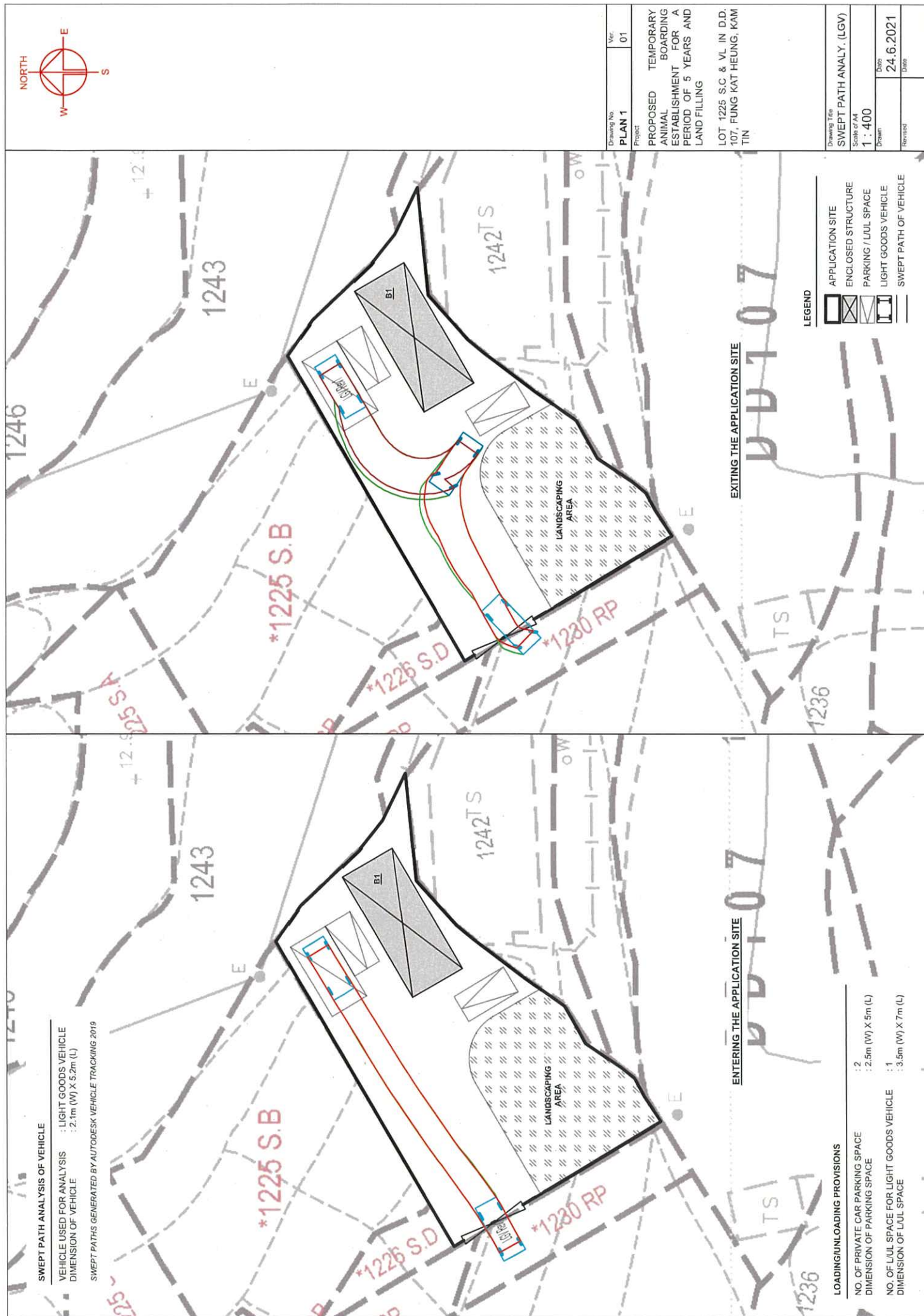

Project	PROPOSED ANIMAL BOARDING ESTABLISHMENT FOR A PERIOD OF 5 YEARS AND LAND FILLING
---------	---

LOT 1225 S.C & VL IN D.D.  
107, FUNG KAT HEUNG, KAM  
TIN

Drawing Title	SWEPT PATH ANALY. (LGV)
---------------	-------------------------

Scale of A4  
1 : 400

Drawn	Date
	24.6.2021

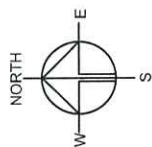

Drawing No.  
**PLAN 2**

Ver.  
**01**

PROPOSED  
ANIMAL  
BOARDING  
ESTABLISHMENT FOR A  
PERIOD OF 5 YEARS AND  
LAND FILLING  
  
LOT 1225 S.C & VL IN D.D.  
107, FUNG KAT HEUNG, KAM  
TIN

Drawing Title  
**PUBLIC TRANSPORT**

Scale of A4  
**1 : 2000**

Date  
**24.6.2021**

Drawn  
**XXXX**

Revised  
**XXXX**

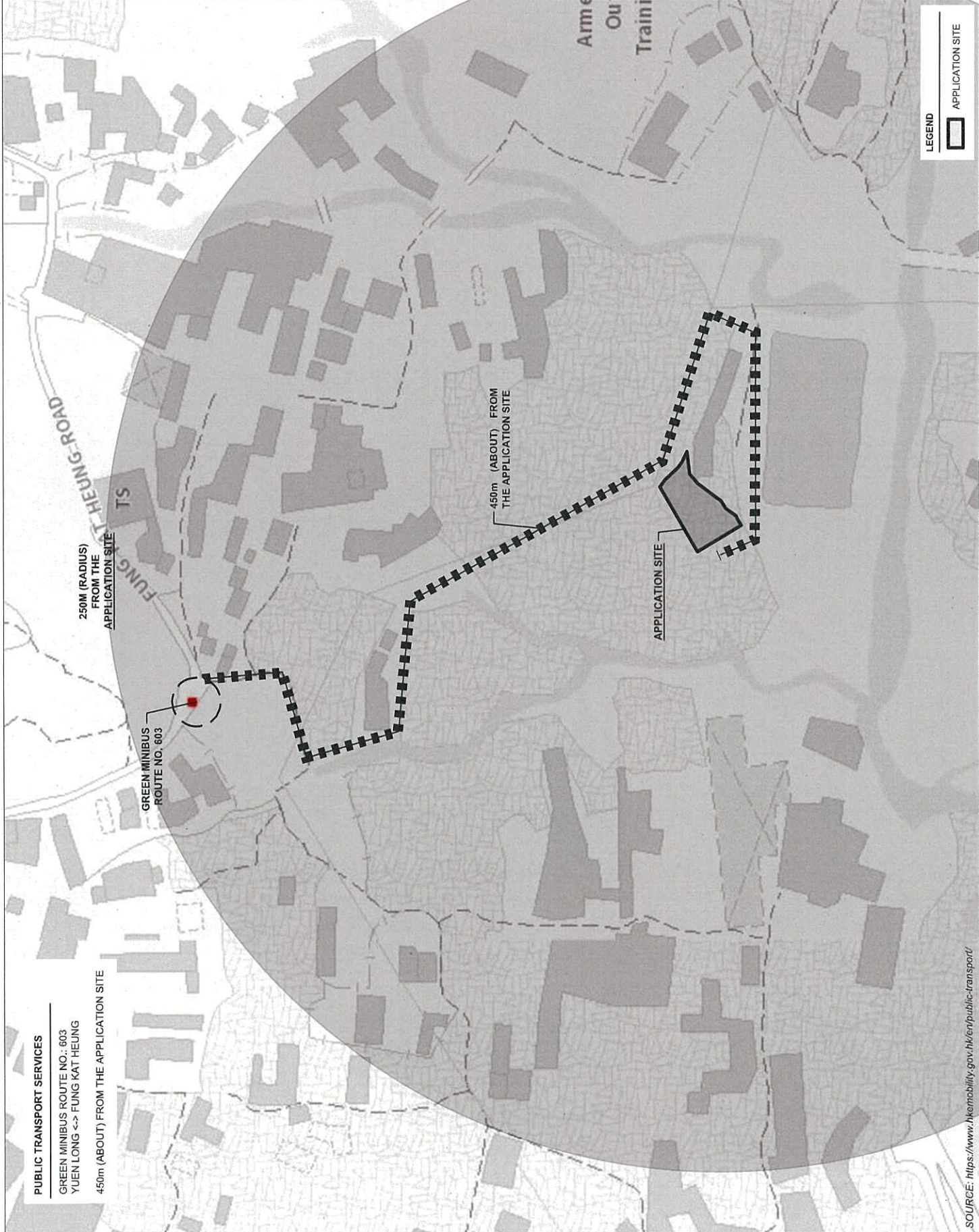

**PUBLIC TRANSPORT SERVICES**

GREEN MINIBUS ROUTE NO.: 603  
YUEN LONG <-> FUNG KAT HEUNG

450m (ABOUT) FROM THE APPLICATION SITE

250M (RADIUS)  
FROM THE  
APPLICATION SITE

GREEN MINIBUS  
ROUTE NO. 603

450m (ABOUT) FROM  
THE APPLICATION SITE

APPLICATION SITE

**LEGEND**





**Previous s.16 Application covering the Application Site**

**Approved Application**

	<b><u>Application No.</u></b>	<b><u>Proposed Use(s)</u></b>	<b><u>Date of Consideration (RNTPC)</u></b>	<b><u>Approval Condition(s)</u></b>
1	A/YL-KTN/745	Proposed Temporary Place of Recreation, Sports or Culture (Hobby Farm) for a Period of 5 Years and Land Filling	5.2.2021	(1), (2), (3), (4), (5), (6), (7)

**Approval Conditions**

- (1) Restriction on operation time
- (2) No public announcement system and whistle blowing at all times / no public announcement system, whistle blowing, portable loud speaker, or any form of audio amplification system on the site at any time
- (3) Submission / implementation / maintenance of drainage proposal / facilities / submission of drainage record
- (4) Submission / implementation of water supply for fire fighting and / or fire service installations proposal / provision of fire service installations and / or Emergency Vehicular Access
- (5) Revocation of planning approval for non-compliance with conditions by a specified date or during the planning approval period
- (6) Upon the expiry of the planning permission, the reinstatement of the site to an amenity area
- (7) No vehicle is allowed to queue back to or reverse onto/from public road at any time



**Similar Applications in the Same “Agriculture” Zone on the Kam Tin North OZP**

**Approved Applications for Animal Boarding Establishment (With/ Without Filling of Land)**

	<b><u>Application No.</u></b>	<b><u>Proposed Uses</u></b>	<b><u>Date of Consideration (RNTPC/TPB)</u></b>	<b><u>Approval Conditions</u></b>
1	A/YL-KTN/232	Animal Boarding Establishment (Kennel and Cattery)	29.7.2005 (on temporary basis for a period of 3 years) [revoked on 29.1.2006]	(1), (2), (4), (5)
2	A/YL-KTN/251	Animal Boarding Establishment and Ancillary Facilities (Kennel and Cattery)	7.7.2006 (on temporary basis for a period of 2 years)	(1), (2), (4), (5), (6)
3	A/YL-KTN/253	Animal Boarding Establishment (Kennel)	4.8.2006 (on temporary basis for a period of 3 years)	(1), (2), (3), (4), (5)
4	A/YL-KTN/304	Animal Boarding Establishment with Ancillary Facilities	19.9.2008 (on temporary basis for a period of 3 years) [revoked on 19.3.2010]	(4), (5), (6), (7), (8), (9)
5	A/YL-KTN/308	Temporary Animal Boarding Establishment (Kennel) and Breeding Area for a Period of 3 Years	5.9.2008 [revoked on 5.3.2009]	(1), (4), (6), (7)
6	A/YL-KTN/324	Temporary Animal Boarding Establishment (Kennel) and Breeding Area for a Period of 3 Years	22.5.2009 [revoked on 22.5.2011]	(2), (4), (6), (8)
7	A/YL-KTN/377	Temporary Animal Boarding Establishment with Ancillary Facilities for a Period of 5 Years	30.3.2012 (on temporary basis for a period of 3 years) [revoked on 30.9.2012]	(1), (2), (4), (5), (6), (9)
8	A/YL-KTN/410	Temporary Animal Boarding Establishment with Ancillary Facilities for a Period of 5 Years	17.1.2014 (on temporary basis for a period of 2 years) [revoked on 17.7.2014]	(1), (2), (4), (5), (6), (9)
9	A/YL-KTN/489	Temporary Animal Boarding Establishment with Ancillary Facilities for a Period of 3 Years	5.2.2016	(1), (2), (4), (5), (6), (9), (10), (13)
10	A/YL-KTN/562	Proposed Temporary Animal Boarding Establishment for a Period of 3 Years	11.8.2017 [revoked on 11.1.2020]	(1), (2), (4), (5), (6), (10), (14), (15), (16)

11	A/YL-KTN/588	Proposed Temporary Animal Boarding Establishment for a Period of 3 Years	16.3.2018 [revoked on 16.9.2018]	(1), (2), (4), (5), (6), (10), (14), (15), (16), (17)
12	A/YL-KTN/605	Proposed Temporary Animal Boarding Establishment for a Period of 3 Years	15.6.2018	(1), (2), (4), (5), (6), (10), (14), (15), (16)
13	A/YL-KTN/616	Proposed Temporary Animal Boarding Establishment for a Period of 3 Years	17.8.2018 [revoked on 17.1.2021]	(1), (4), (5), (6), (10), (14), (15), (16)
14	A/YL-KTN/617	Proposed Temporary Animal Boarding Establishment for a Period of 3 Years	17.8.2018 [revoked on 17.7.2020]	(1), (2), (4), (5), (6), (10), (14), (15), (16)
15	A/YL-KTN/623	Proposed Temporary Animal Boarding Establishment for a Period of 3 Years	21.9.2018	(1), (2), (4), (5), (6), (10), (14), (15), (16)
16	A/YL-KTN/639	Renewal of Planning Approval for Temporary "Animal Boarding Establishment with Ancillary Facilities" for a Period of 3 Years	1.2.2019	(2), (4), (5), (6), (8), (10), (14), (15), (16)
17	A/YL-KTN/642	Proposed Temporary Animal Boarding Establishment for a Period of 3 Years	22.2.2019	(2), (4), (5), (6), (10), (14), (15), (16)
18	A/YL-KTN/645	Proposed Temporary Animal Boarding Establishment for a Period of 3 Years	12.4.2019 [revoked on 12.10.2019]	(2), (4), (5), (6), (10), (12), (14), (15), (16)
19	A/YL-KTN/651	Proposed Temporary Animal Boarding Establishment for a Period of 5 Years	17.5.2019	(2), (4), (5), (6), (10), (14), (15), (16)
20	A/YL-KTN/659	Proposed Temporary Animal Boarding Establishment for a Period of 3 Years	16.8.2019	(2), (4), (5), (6), (7), (10), (14), (15), (16)
21	A/YL-KTN/695	Temporary Animal Boarding Establishment for a Period of 5 Years	15.5.2020	(2), (4), (5), (6), (10), (14), (15), (16)
22	A/YL-KTN/724	Temporary Animal Boarding Establishment with Ancillary Facilities for a Period of 3 Years	23.10.2020	(2), (4), (5), (6), (10), (14), (15), (16)
23	A/YL-KTN/713	Proposed Temporary Animal Boarding Establishment for a Period of 3 Years	6.11.2020	(2), (4), (5), (6), (10), (14), (15), (16)
24	A/YL-KTN/716	Proposed Temporary Animal Boarding Establishment for a Period of 3 Years and Filling of Land	20.11.2020	(2), (4), (5), (6), (10), (14), (15), (16)



25	A/YL-KTN/730	Proposed Temporary Animal Boarding Establishment for a Period of 3 Years	20.11.2020	(2), (4), (5), (6), (10), (14), (15), (16)
26	A/YL-KTN/743	Temporary Animal Boarding Establishment with Ancillary Office for a Period of 3 Years	22.1.2021	(2), (4), (5), (6), (10), (14), (15), (16)
27	A/YL-KTN/752	Proposed Temporary Animal Boarding Establishment for a Period of 5 Years and Filling of Land	26.3.2021	(2), (4), (5), (6), (10), (14), (15), (16)
28	A/YL-KTN/757	Temporary Animal Boarding Establishment for a Period of 5 Years	16.4.2021	(2), (4), (5), (6), (10), (14), (15), (16)

### **Approval Conditions**

- (1) Submission / implementation of landscaping / tree preservation proposals / replacement of tree planting
- (2) Submission / implementation / maintenance of drainage proposal / facilities / submission of drainage record
- (3) Provision of a 9-litre water type /3 kg dry powder fire extinguisher
- (4) Revocation of planning approval for non-compliance with conditions by a specified date or during the planning approval period
- (5) Reinstatement of the application site upon expiry of planning permission
- (6) Submission / implementation of water supply for fire fighting and / or fire service installations proposal / provision of fire service installations and / or Emergency Vehicular Access
- (7) Maintenance of existing drainage facilities
- (8) Maintenance of existing landscape planting / trees
- (9) Submission / implementation of appropriate mitigation measures in order not to cause any disturbance / contamination to the fish ponds nearby
- (10) Restriction on operation time
- (11) No activity that would generate dog barking noise shall be carried out in the outdoor area of the Site
- (12) The boundary fencing of the Site shall be provided / maintained at all times
- (13) No reversing of vehicles into or out of the Site is allowed at all times
- (14) No queuing back of vehicles to public road from the Site is allowed at any time / no vehicle is allowed to queue back to or reverse onto / from public road
- (15) No public announcement system and whistle blowing at all times / no public announcement system, whistle blowing, portable loud speaker, or any form of audio amplification system on the site at any time
- (16) All the dogs / animals shall be kept inside the enclosed structures at all time or at specific time
- (17) No vehicle exceeding 5.5 tonnes, including container tractors / trailers, as defined in the Road Traffic Ordinance are allowed to be parked / stored on or enter / exit the site

### **Approved Applications for Filling of Land for Temporary Hobby Farm**

	<b><u>Application No.</u></b>	<b><u>Proposed Uses</u></b>	<b><u>Date of Consideration (RNTPC/TPB)</u></b>	<b><u>Approval Conditions</u></b>
1	A/YL-KTN/691	Proposed Temporary Place of Recreation, Sports or Culture (Hobby Farm) for a Period of 3 Years and Filling of Land	17.1.2020	(1), (2), (3), (4), (5), (6)

2	A/YL-KTN/693	Temporary Place of Recreation, Sports or Culture (Hobby Farm and Caravan Holiday Camp) for a Period of 3 Years and Filling of Land	15.5.2020	(1), (2), (3), (4), (5), (6)
3	A/YL-KTN/726	Proposed Temporary Place of Recreation, Sports or Culture (Hobby Farm) for a Period of 3 Years and Filling of Land	6.11.2020	(1), (2), (3), (4), (5), (6)

#### **Approval Conditions**

- (1) Restriction on operation time
- (2) No public announcement system and whistle blowing at all times / no public announcement system, whistle blowing, portable loud speaker, or any form of audio amplification system on the site at any time
- (3) Submission / implementation / maintenance of drainage proposal / facilities / submission of drainage record
- (4) Submission / implementation of water supply for fire fighting and / or fire service installations proposal / provision of fire service installations and / or Emergency Vehicular Access
- (5) Revocation of planning approval for non-compliance with conditions by a specified date or during the planning approval period
- (6) Upon the expiry of the planning permission, the reinstatement of the site to an amenity area

#### **Rejected Application**

	<b><u>Application No.</u></b>	<b><u>Proposed Uses</u></b>	<b><u>Date of Consideration (RNTPC/TPB)</u></b>	<b><u>Main Reason(s) for Rejection</u></b>
1	A/YL-KTN/759	Proposed Temporary Animal Boarding Establishment for a Period of 3 Years and Filling of Land	14.5.2021	(1)

#### **Rejection Reason**

- (1) The site is fragmented with structures excluded. Approving the application would result in piecemeal development and is undesirable from land-use planning and planning control point of view.

tpbpd@pland.gov.hk

---

寄件者: [REDACTED]  
寄件日期: 2021年06月10日星期四 3:34  
收件者: tpbpd  
主旨: A/YL-KTN/769 DD 107 Fung Kat Hung

A/YL-KTN/769

Lots 1225 S.C, 1226 S.E and 1230 S.B in D.D.107, Fung Kat Heung, Kam Tin

Site area : About 565sq.m

Zoning : "Agriculture"

Applied use : Animal Boarding Establishment / 5 Years / Filling of Land / 3 Vehicle Parking

Dear TPB Members,

Strongly object. This is the southern section of the lots approved for Hobby Farm on 5 Feb despite a lengthy discussion re enforcement and Destroy to Build.

*The Site is currently subject to an on-going planning enforcement action against an unauthorised development (UD) involving filling of land. Enforcement Notice was issued on 9.4.2020 requiring discontinuation of the UD. Reinstatement Notice was issued on 21.4.2020 requiring removal of leftovers, debris and filled materials and to grass the land.*

This plan would reduce the area that was, supposedly, to be devoted to agriculture.

There are numerous ABEs in the district. There is no information provided with regard to the number of animals, disposal of waste, drainage, and the applicants track record in providing this service.

Is it animal boarding or animal breeding? The number of applications for animal boarding going through the system is disproportionate to the market for such facilities.

There are many media reports on animal cruelty and puppy farms. Members must ask questions.

Mary Mulvihill

---

From: [REDACTED]  
To: "tpbpd" <tpbpd@pland.gov.hk>  
Sent: Friday, January 8, 2021 4:13:58 AM  
Subject: A/YL-KTN/745 DD 107 Kam Tin near Armed Forces

A/YL-KTN/745

Various Lots in D.D. 107, Kam Tin

Site area : About 3,221sq.m

Zoning : "Agriculture"

Applied use : Hobby Farm / 5 Years / Land Filling / 9 Vehicle Parking

Dear TPB Members,

Another Hobby Farm, they are already dozens in the district.

Filling of land 740sq.m, is this Destroy to Build to turn the land into Open Storage in line with the adjacent lots to the right?

President Xi, who has a lot more access to data than lesser mortals, clearly believes that there will be shortfalls in food production in China in coming years. Apart from environmental degradation climate change is having an impact re flooding, crop failures, etc. This winter is the coldest for 50 years in some regions in the north and this will certainly destroy or delay production..

But here in Hong Kong we live in a bubble. Agriculture land is not for producing food but for storing construction waste and, when used for crops, is for selfie friendly plots for weekend farmers.

Once again the mindset here is way behind the curve. A large site of arable land should be used for serious food production not as a playground.

In line with most government departments, Ag and Fish appears to be in ignorance of the policy guidelines laid down by the Central Government. It should be pursuing a programme to address the issue that a certain amount of local agricultural production is a necessity. Lay members of the Board have a duty to question government depts with regards to issues where officials are not moving with the times.

Mary Mulvihill



嘉道理農場暨植物園公司  
Kadoorie Farm & Botanic Garden Corporation

The Secretary,  
Town Planning Board,  
15/F, North Point Government Offices,  
333, Java Road, North Point,  
Hong Kong.  
(Email: tpbpd@pland.gov.hk)



9th June, 2021.

Dear Sir/ Madam,

**Proposed Temporary Animal Boarding Establishment for a Period of 5 Years and  
Filling of Land  
(A/YL-KTN/769)**

1. We refer to the captioned.
2. We object to the captioned application as the proposed use is not in line with the planning intention of Agriculture (AGR) zone. This zone is *'intended primarily to retain and safeguard good quality agricultural land/farm/fish ponds for agricultural purposes. It is also intended to retain fallow arable land with good potential for rehabilitation for cultivation and other agricultural purposes'*. In addition, in our previous submissions, we should have repeatedly mentioned that the AGR zone in Kam Tin North contains many active farms.
3. According to the information from the Statutory Planning Portal 2 Website of the Town Planning Board, no application for animal boarding establishment was rejected between 2015 and 2020 (data retrieved on 18 Mar 2021) in the AGR zone under Kam Tin North OZP; however, many such applications had been approved in this zone in this period. We urge the Board to seriously consider whether it is appropriate to continue to approve application for animal boarding establishment in this zone, and whether the active farms in this zone would be impacted eventually (i.e., potential cumulative impacts) by such approval.
4. Thank you for your attention.

Ecological Advisory Programme  
Kadoorie Farm and Botanic Garden

香港新界大埔林錦公路  
Lam Kam Road, Tai Po, New Territories, Hong Kong  
Email: eap@kfbg.org



**Advisory Clauses**

- (a) note DLO/YL, LandsD's comments that the Site comprises Old Schedule Agricultural Lots held under the Block Government Lease which contains the restriction that no structures are allowed to be erected without the prior approval of the Government. The lots owners will need to apply to his office to permit the structures to be erected or regularize any irregularities on site, if any. Besides, given the proposed use is temporary in nature, only application for regularization or erection of temporary structure(s) will be considered. Applications for any of the above will be considered by LandsD acting in the capacity as the landlord or lessor at its sole discretion and there is no guarantee that such application will be approved. If such application(s) is approved, it will be subject to such terms and conditions, including among others the payment of rent or fee, as may be imposed by the LandsD;
- (b) note C for T's comments that the Site is connected to the public road network via a section of a local access road which is not managed by his department. The land status of the local access road should be checked with LandsD. Moreover, the management and maintenance responsibilities of the local access road should be clarified with the relevant lands and maintenance authorities accordingly;
- (c) note CHE/NTW, HyD's comments that his department shall not be responsible for the maintenance of any access connecting the Site and Castle Peak Road – Tam Mi. Adequate drainage measures should be provided to prevent surface water running from the Site to nearby public roads and drains;
- (d) note DEP's comments that the applicant is advised: (i) that the proposed structures for animal boarding establishment should be enclosed with soundproofing materials with provision of 24-hour mechanical ventilation and air-conditional system; (ii) to follow the requirements stipulated in "Code of Practice on Handling the Environmental Aspects of Temporary Uses and Open Storage Site"; (iii) to provide adequate supporting infrastructure/ facilities for proper collection, treatment and disposal of waste/ wastewater generated from the proposed use. If septic tank and soakaway system will be used in case of unavailability of public sewer, its design, construction and operation should follow the requirements of EPD's ProPECC PN 5/93 "Drainage Plans subject to Comment by the Environment Protection Department", including percolation test; and (iv) that it is the obligation of the applicant to meet the statutory requirements under relevant pollution control ordinances;
- (e) note CE/MN, DSD's comments that drainage proposal under relevant approval condition should demonstration on how part of the land with raised level will not obstruct the overland flow across it;
- (f) note DAFC's comments that under the Public Health (Animals) (Boarding Establishment) Regulations, Cap. 139I, any person who provides food and

accommodation for animals in return for a fee paid by the owner must apply for a Boarding Establishment Licence from his department;

- (g) note D of FS' comments that in consideration of the design/nature of the proposal, FSIs are anticipated to be required. Therefore, the applicant is advised to submit relevant layout plans incorporated with the proposed FSIs to his department for approval. The layout plans should be drawn to scale and depicted with dimensions and nature of occupancy. The location of where the proposed FSI to be installed should be clearly marked on the layout plans. The applicant is reminded that if the proposed structure(s) is required to comply with the BO (Cap. 123), detailed fire service requirements will be formulated upon receipt of formal submission of general building plans;
- (h) note CBS/NTW, BD's comments that if the existing structures (not being a New Territories Exempted House) are erected on leased land without the approval of the Building Authority, they are UBW under the BO and should not be designated for any proposed use under the application. For UBW erected on leased land, enforcement action may be taken by the BD to effect their removal in accordance with the prevailing enforcement policy against UBW as and when necessary. The granting of any planning approval should not be constructed as an acceptance of any existing building works or UBW on the Site under the BO. Before any new building works (including containers/ open sheds as temporary building, demolition and land filling, etc) are to be carried out on Site, prior approval and consent of the Building Authority should be obtained, otherwise they are UBW. An Authorized Person should be appointed as the co-ordinator for the proposed building works in accordance with the BO. The Site shall be provided with means of obtaining access thereto from a street and emergency vehicular access in accordance with Regulations 5 and 41D of the B(P)R respectively. The Site does not abut on a specified street of not less than 4.5m wide and its permitted development intensity shall be determined under Regulation 19(3) of the B(P)R at the building plan submission stage. If the proposed use under application is subject to issue of a license, the applicant should be reminded that any existing structures on the Site intended to be used for such purposes are required to comply with the building safety and other relevant requirements as may be imposed by the licensing authority. Any temporary shelters or converted containers for office, storage, washroom or other uses are considered as temporary buildings are subject to the control of Part VII of the B(P)R. Detailed checking under the BO will be carried out at building plan submission stage; and
- (i) note DFEH's comments that proper license/ permit issued by his department is required if there is any food business/ catering service/ activities regulated by the DFEH under the Public Health and Municipal Services Ordinance (Cap. 132) and any other relevant legislation for the public and the operation of any business should not cause any obstruction. If the proposal involves any commercial / trading activities, there should be no encroachment on the public place and no environmental nuisance should be generated to the surroundings. Its state should not be a nuisance or injurious or dangerous to health and surrounding environment. Any animal carcass/ parts shall be properly wrapped or bagged before disposal and in accordance with the relevant legislation. Also, for any



waste generated from the activities in the premises, the applicant should handle on their own / at their expenses. Any animal carcass/ parts shall be properly wrapped or bagged before disposal.

