

DEVELOPMENT PARAMETERS

APPLICATION SITE AREA	: 690 m ²	(ABOUT)
COVERED AREA	: 227 m ²	(ABOUT)
UNCOVERED AREA	: 463 m ²	(ABOUT)
PLOT RATIO	: 0.63	(ABOUT)
SITE COVERAGE	: 33 %	(ABOUT)
NO. OF STRUCTURE	: 2	
DOMESTIC GFA	: NOT APPLICABLE	
NON-DOMESTIC GFA	: 436 m ²	(ABOUT)
TOTAL GFA	: 436 m ²	(ABOUT)
BUILDING HEIGHT	: 3 - 8 m	(ABOUT)
NO. OF STOREY	: 1 - 2	

STRUCTURE	USE	COVERED AREA	GFA	BUILDING HEIGHT
B1 (G/F)	STORAGE OF GOODS	219 m ² (ABOUT)*	219 m ² (ABOUT)*	8m (ABOUT)(2-STOREY)
B2 (1/F)	OFFICE	8 m ² (ABOUT)	209 m ² (ABOUT)	3m (ABOUT)(1-STOREY)
	PORTABLE TOILET		8 m ² (ABOUT)	
*INCLUDE 10m ² STAIRCASE		TOTAL	227m ² (ABOUT)	436m ² (ABOUT)

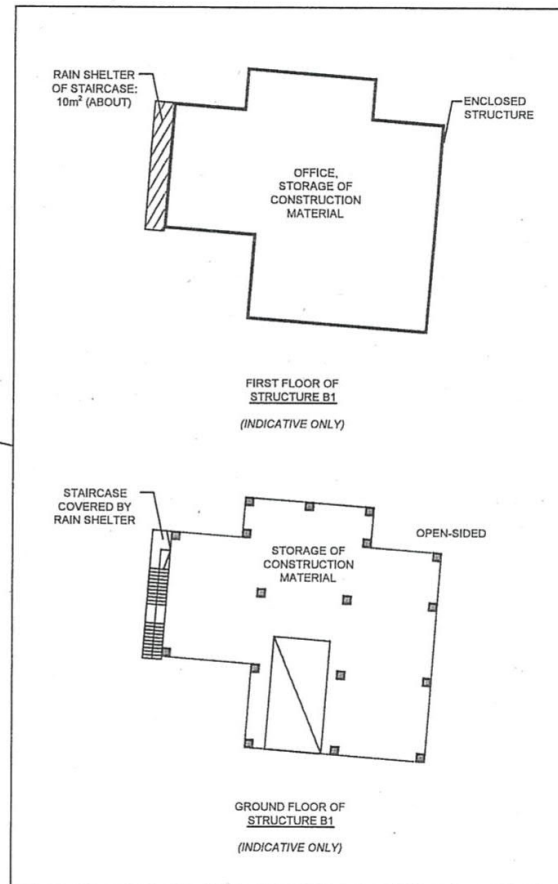
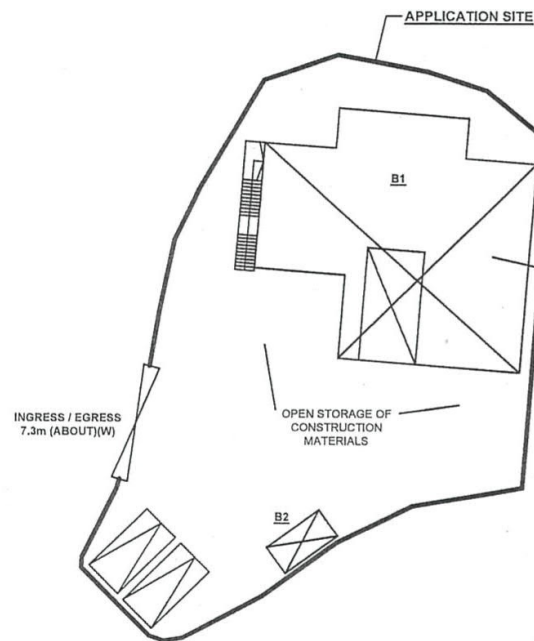
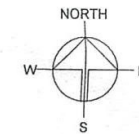

PARKING AND LOADING/UNLOADING PROVISIONS

NO. OF PRIVATE CAR PARKING SPACE	: 2
DIMENSION OF PARKING SPACE	: 5 m (L) X 2.5 m (W)
NO. OF L/U/L SPACE FOR LIGHT GOODS VEHICLE	: 1
DIMENSION OF L/U/L SPACE	: 7 m (L) X 3.5 m (W)
CLEAR HEADROOM	: 3.7 m

LEGEND

	APPLICATION SITE
	STRUCTURE
	STRUCTURE (CANOPY)
	PARKING SPACE
	LOADING / UNLOADING SPACE
	INGRESS / EGRESS

PLANNING CONSULTANT

R-RICHES PROPERTY CONSULTANTS LIMITED

PROJECT

PROPOSED TEMPORARY OPEN STORAGE OF CONSTRUCTION MATERIALS AND OFFICE FOR A PERIOD OF 3 YEARS

SITE LOCATION

LOT 4115 (PART) IN D.D. 104, FUNG KAT HEUNG, KAM TIN, YUEN LONG, NEW TERRITORIES

SCALE

1:400 @ A1

DRAWN BY	DATE
MN	3.5.2022
CHECKED BY	DATE
APPROVED BY	DATE

DWG. TITLE

LAYOUT PLAN

DWG NO.	VER.
P04	001

(摘錄自申請人於 9. 6. 2022 呈交的申請書)
(Extract from Applicant's Submission of 9.6.2022)

參考編號
REFERENCE No.
A/YL-KTN/841

繪圖
DRAWING
A - 1

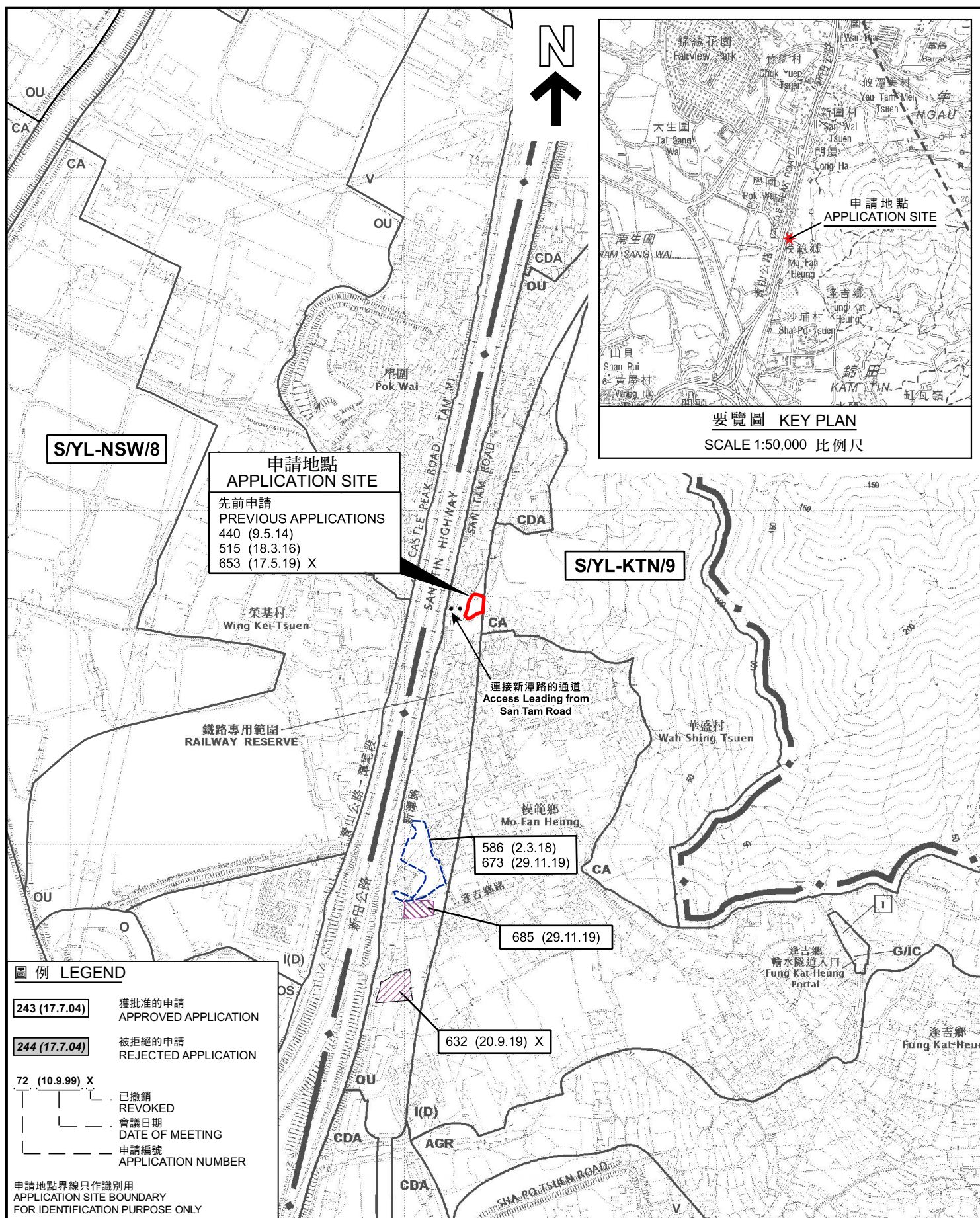

位置圖及同類申請 LOCATION PLAN WITH SIMILAR APPLICATIONS

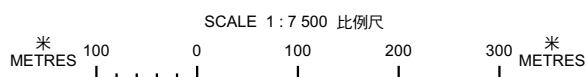

參考編號
REFERENCE No.
A/YL-KTN/841



圖例 LEGEND

 申請地點（界線只作識別用）
APPLICATION SITE (BOUNDARY FOR IDENTIFICATION PURPOSE ONLY)

本摘要圖於2022年7月19日擬備，所根據的資料為地政總署於2021年1月15日拍得的航攝照片編號E126816C
EXTRACT PLAN PREPARED ON 19.7.2022 BASED ON AERIAL PHOTO No.E126816C TAKEN ON 15.1.2021 BY LANDS DEPARTMENT

航攝照片 AERIAL PHOTO

臨時露天存放建築材料及辦公室（為期 3 年）
元朗錦田丈量約份第104約地段第4115號（部份）
TEMPORARY OPEN STORAGE OF CONSTRUCTION MATERIALS AND OFFICE FOR A PERIOD OF 3 YEARS
LOT 4115 (PART) IN D.D. 104, KAM TIN, YUEN LONG

規 劃 署 PLANNING DEPARTMENT		
參考編號 REFERENCE No. A/YL-KTN/841	圖 PLAN A-3	

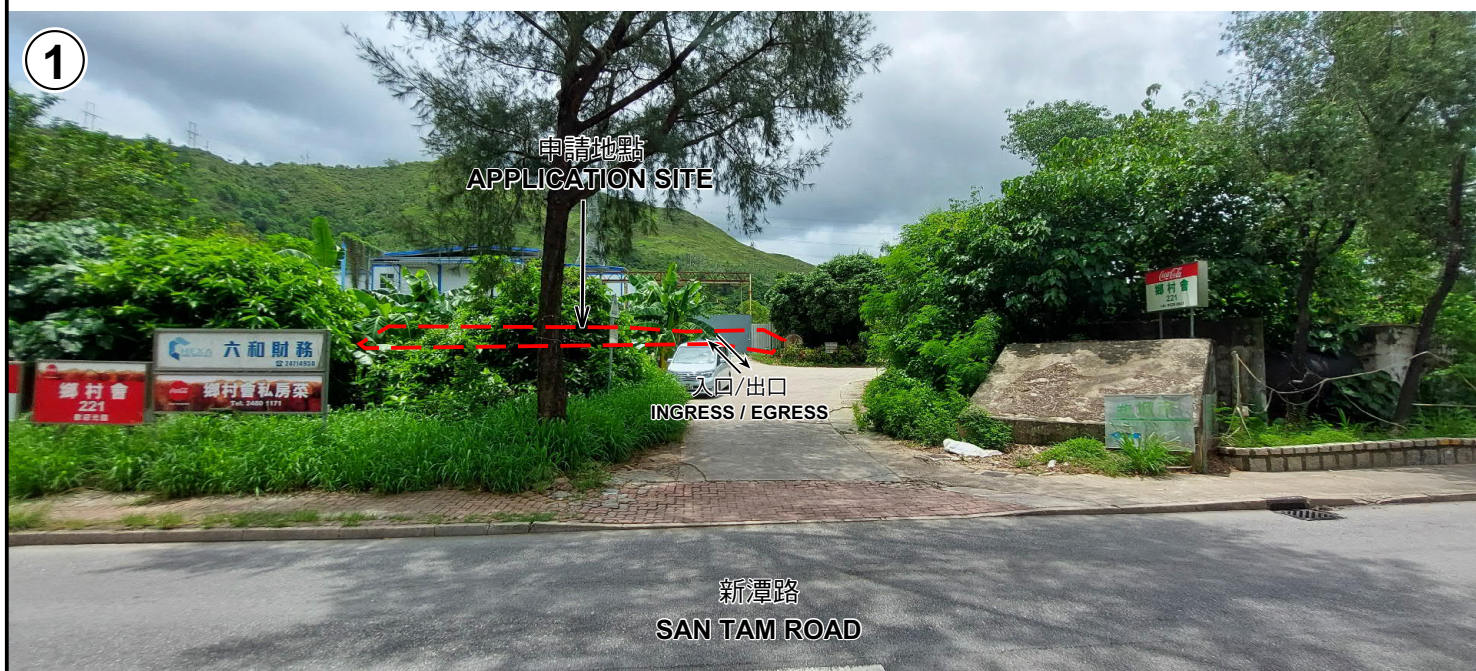

申請地點界線只作識別用
APPLICATION SITE BOUNDARY FOR IDENTIFICATION PURPOSE ONLY

實地照片 SITE PHOTOS

臨時露天存放建築材料及辦公室（為期 3 年）
元朗錦田丈量約份第104約地段第4115號（部份）
TEMPORARY OPEN STORAGE OF CONSTRUCTION MATERIALS AND
OFFICE FOR A PERIOD OF 3 YEARS
LOT 4115 (PART) IN D.D. 104, KAM TIN, YUEN LONG

規 劃 署
PLANNING
DEPARTMENT



參考編號
REFERENCE No.
A/YL-KTN/841

圖 PLAN
A-4a

本圖於2022年7月19日擬備，所根據的
資料為攝於2022年6月17日的實地照片
PLAN PREPARED ON 19.7.2022
BASED ON SITE PHOTOS
TAKEN ON 17.6.2022



申請地點界線只作識別用
APPLICATION SITE BOUNDARY FOR IDENTIFICATION PURPOSE ONLY

實地照片 SITE PHOTOS

本圖於2022年7月19日擬備，所根據的資料為攝於2022年6月17日的實地照片
PLAN PREPARED ON 19.7.2022
BASED ON SITE PHOTOS
TAKEN ON 17.6.2022

臨時露天存放建築材料及辦公室（為期 3 年）
元朗錦田丈量約份第104約地段第4115號（部份）
TEMPORARY OPEN STORAGE OF CONSTRUCTION MATERIALS AND
OFFICE FOR A PERIOD OF 3 YEARS
LOT 4115 (PART) IN D.D. 104, KAM TIN, YUEN LONG

規劃署
PLANNING
DEPARTMENT



參考編號
REFERENCE No.
A/YL-KTN/841

圖 PLAN
A-4b