

# Proposed Structures Details

	Structures	Gross Floor Area (GFA)	Height (Not Exceeding)	Storey
1	Animal Boarding Establishment	About 11m x 8m = 88 m <sup>2</sup>	3.5m	1 only
2	Animal Boarding Establishment	About 11m x 8m = 88 m <sup>2</sup>	3.5m	1 only
3	Animal Boarding Establishment	About 11m x 8m = 88 m <sup>2</sup>	3.5m	1 only
4	Animal Boarding Establishment	About 11m x 8m = 88 m <sup>2</sup>	3.5m	1 only
5	Animal Boarding Establishment	About 11m x 8m = 88 m <sup>2</sup>	3.5m	1 only
6	Animal Boarding Establishment	About 11m x 8m = 88 m <sup>2</sup>	3.5m	1 only
7	Ancillary Site Office	About 11m x 8m = 88 m <sup>2</sup>	3.5m	1 only
8	Ancillary Storage	About 11m x 8m = 88 m <sup>2</sup>	3.5m	1 only
9	Dog Function Room	About 6m x 6m = 36 m <sup>2</sup>	3.5m	1 only
⊗	Open Shed	About 12m x 6m = 72 m <sup>2</sup>	4.5m	
	Total	About 812 m <sup>2</sup>		

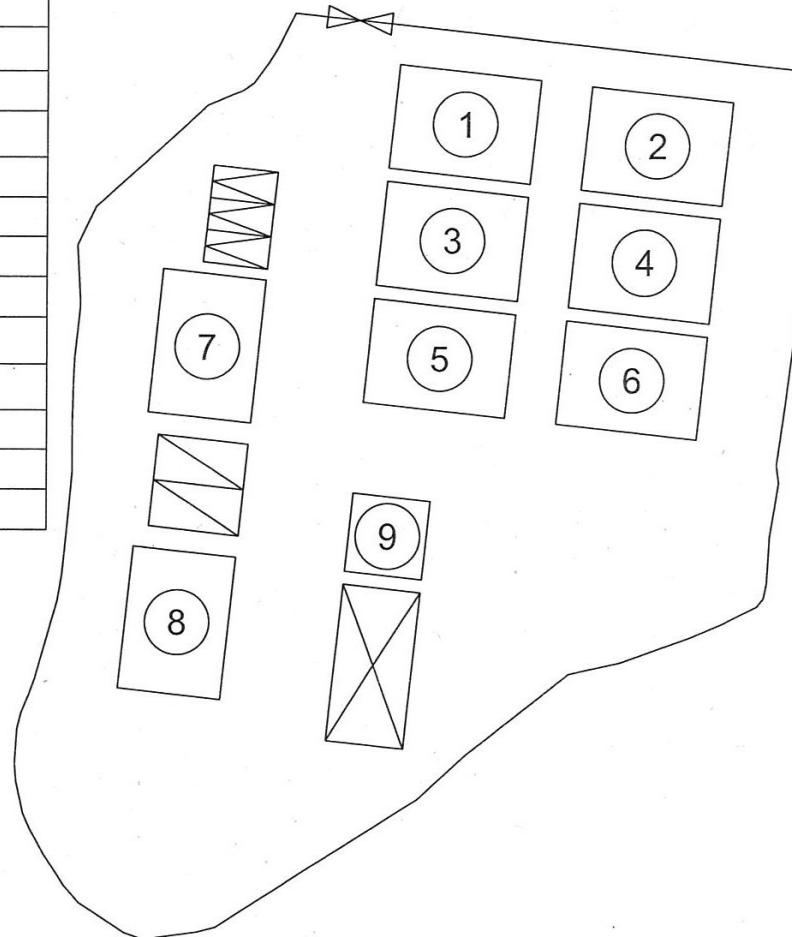

Covered Area: 812 m<sup>2</sup> (About)  
Uncovered Area: 2,286.6 m<sup>2</sup> (About)

\*Whole Application Site will be covered by concrete with about 0.3 m depth of filling of land.

Scale: 1:500 @A4

Appendix 2  Proposed Layout Plan	Location: DD 109 Lot 1356 (Part), 1359 (Part), 1360 (Part) and 1371 (Part)  OZP: S/YL-KTN/9 District: Kam Tin North Zoning: Agriculture	擬議臨時動物寄養所連附屬設置 (為期5年)及填土工程  Proposed Temporary Animal Boarding Establishment with Ancillary Facilities for a Period of 5 Years and Filling of Land	Legend: ⊗ Ingress / egress □ Proposed Structures ▤ Private Car Parking Space ▥ LGV U/UL Space ⊗ Open Shed	Drawing No.: 2-01
				For Identification Only  Date: 05/08/2022

(摘錄自申請人於 8.8.2022 呈交的申請書)  
(Extract from Applicant's  
Submission of 8.8.2022)

參考編號  
REFERENCE No.  
A/YL-KTN/856

繪圖  
DRAWING  
A - 1

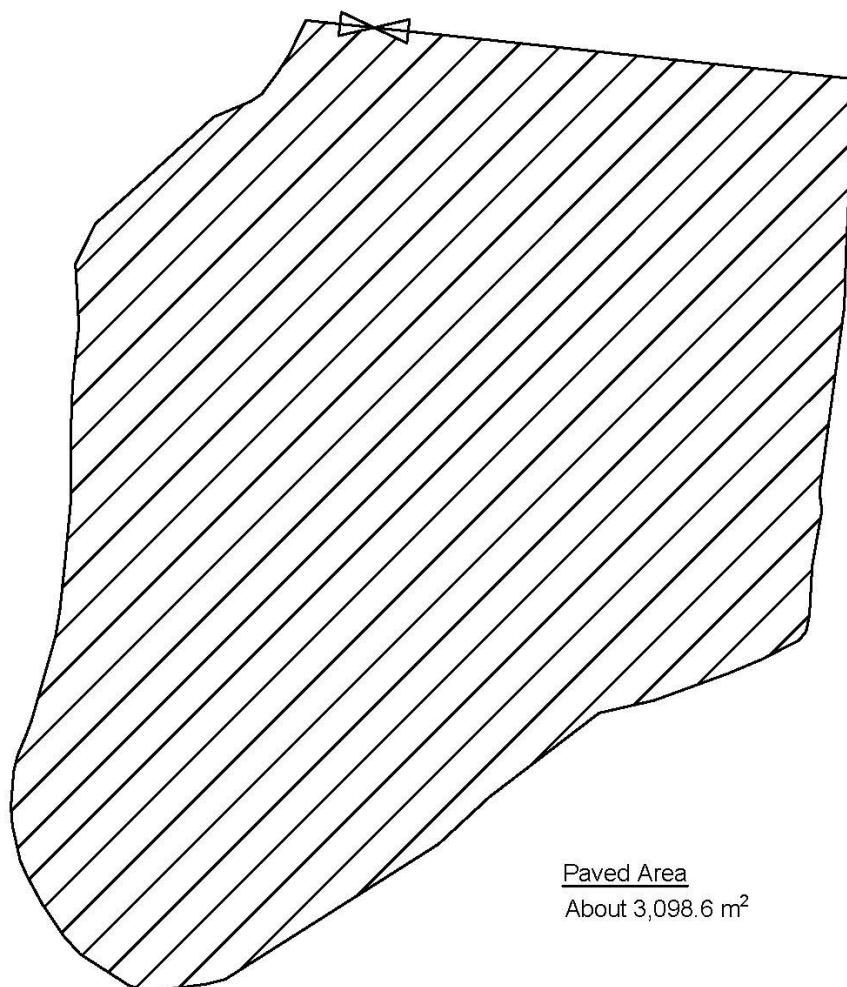

Paved Area  
About 3,098.6 m<sup>2</sup>

Legend:

 Paved Area 平整範圍

<p><b>Appendix 4</b></p> <p>Location: DD 109 Lot 1356 (Part) DD 109 Lot 1359 (Part) DD 109 Lot 1360 (Part) DD 109 Lot 1371 (Part)</p> <p>OZP: S/YL-KTN/9 District: Kam Tin North Zoning: Agriculture</p> <p>Date: 16 August 2022</p>	<p><b><u>Paved Area</u></b> <b>平整位置圖</b></p> <p>擬議臨時動物寄養所連附屬設施 (為期5年)及填土工程</p> <p><b>Proposed Temporary Animal Boarding Establishment with Ancillary Facilities for a Period of 5 Years and Filling of Land</b></p>	<p><b><u>SCALE</u></b></p> <p><del>1:500</del></p> <p>@A4</p>	
		For Identification Only	<p>Drawing No.:</p> <p>4-01</p>

(摘錄自申請人於 8. 8. 2022 呈交的申請書)  
(Extract from Applicant's  
Submission of 8.8.2022)

參考編號  
REFERENCE No.  
A/YL-KTN/856

繪圖  
DRAWING  
A - 2

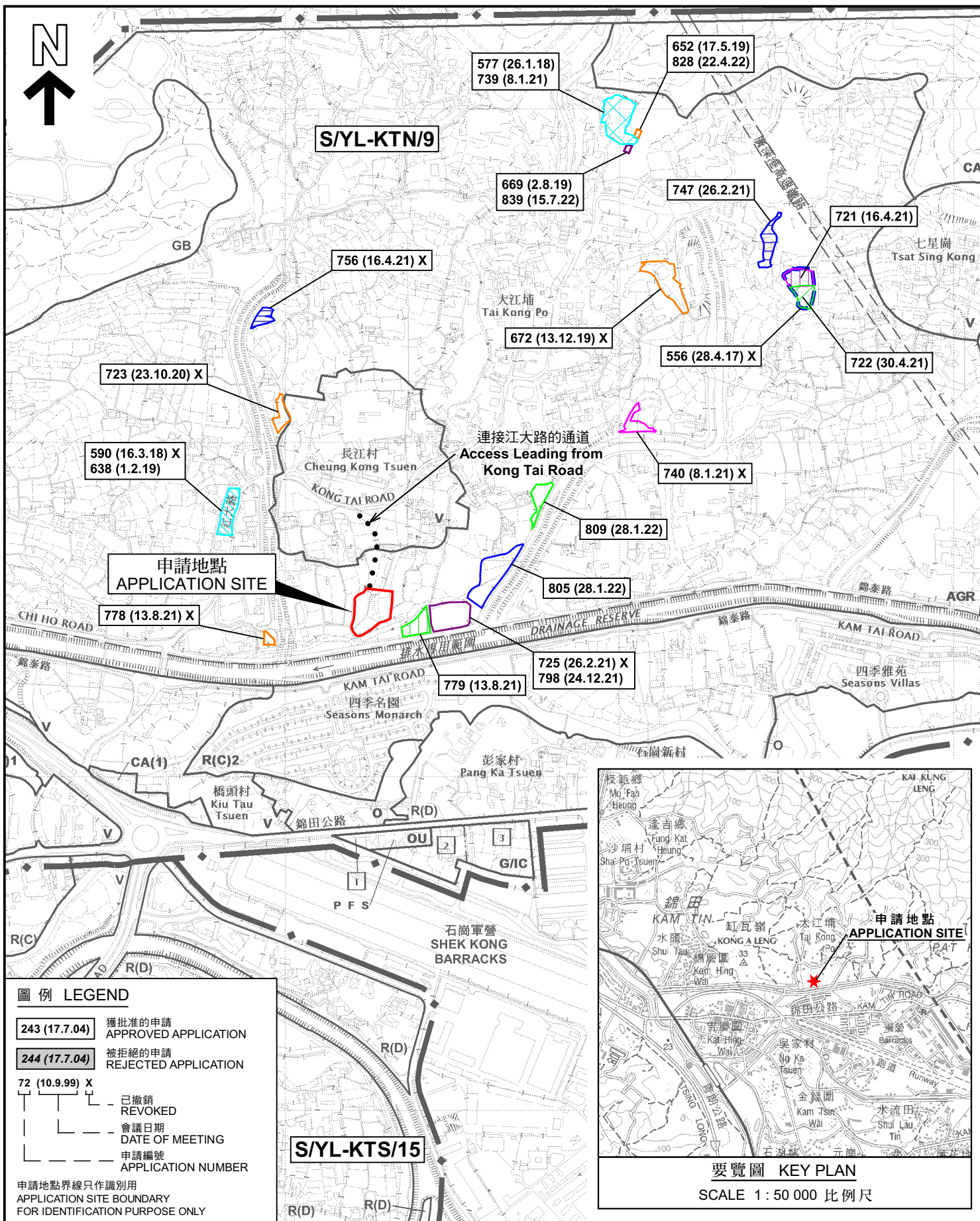

位置圖及同類申請 LOCATION PLAN WITH SIMILAR APPLICATIONS

擬議臨時動物寄養所（為期 5 年）及填土工程  
元朗錦田丈量約份第109約多個地段  
PROPOSED TEMPORARY ANIMAL BOARDING ESTABLISHMENT  
FOR A PERIOD OF 5 YEARS AND FILLING OF LAND  
VARIOUS LOTS IN D.D. 109, KAM TIN, YUEN LONG

SCALE 1: 7 500 比例尺  
米 METRES 100 0 100 200 300 米 METRES

規劃署  
PLANNING  
DEPARTMENT



參考編號  
REFERENCE No.  
A/YL-KTN/856

圖 PLAN  
A-1

本摘要圖於2022年9月15日擬備，  
所根據的資料為於2014年12月2日  
核准的分區計劃大綱圖編號 S/YL-KTN/9  
EXTRACT PLAN PREPARED ON 15.9.2022  
BASED ON OUTLINE ZONING PLAN No.  
S/YL-KTN/9 APPROVED ON 2.12.2014



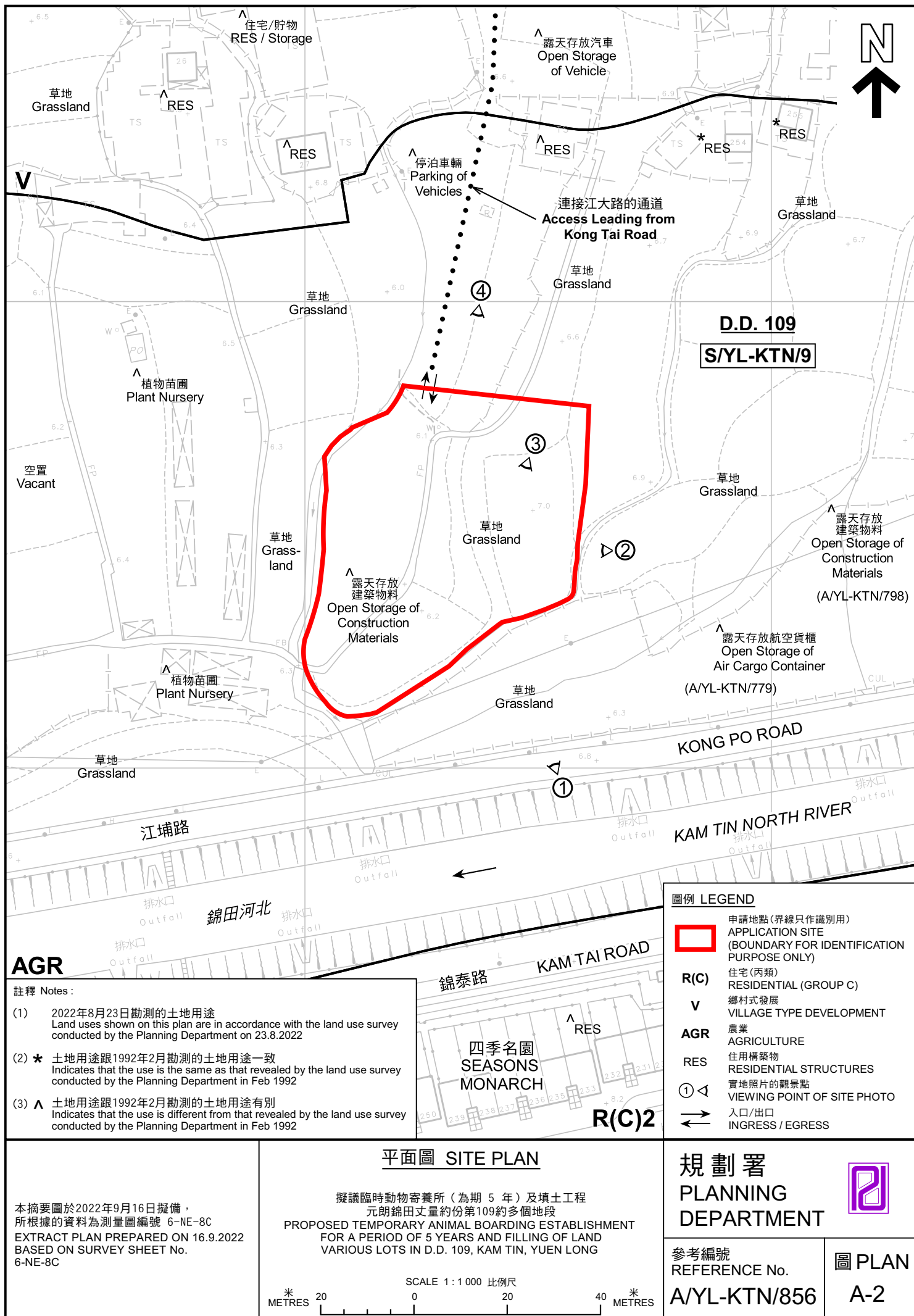





#### 圖例 LEGEND



申請地點 (界線只作識別用)  
APPLICATION SITE (BOUNDARY FOR  
IDENTIFICATION PURPOSE ONLY)

#### 航攝照片 AERIAL PHOTO

擬議臨時動物寄養所 (為期 5 年) 及填土工程  
元朗錦田丈量約份第109約多個地段  
PROPOSED TEMPORARY ANIMAL BOARDING ESTABLISHMENT  
FOR A PERIOD OF 5 YEARS AND FILLING OF LAND  
VARIOUS LOTS IN D.D. 109, KAM TIN, YUEN LONG

規劃署  
PLANNING  
DEPARTMENT



參考編號  
REFERENCE No.  
A/YL-KTN/856

圖 PLAN  
A-3

本摘要圖於2022年9月2日擬備，  
所根據的資料為地政總署於2021年7月23日  
拍得的航攝照片編號 E140017C  
EXTRACT PLAN PREPARED ON 2.9.2022  
BASED ON AERIAL PHOTO No.  
E140017C TAKEN ON 23.7.2021  
BY LANDS DEPARTMENT



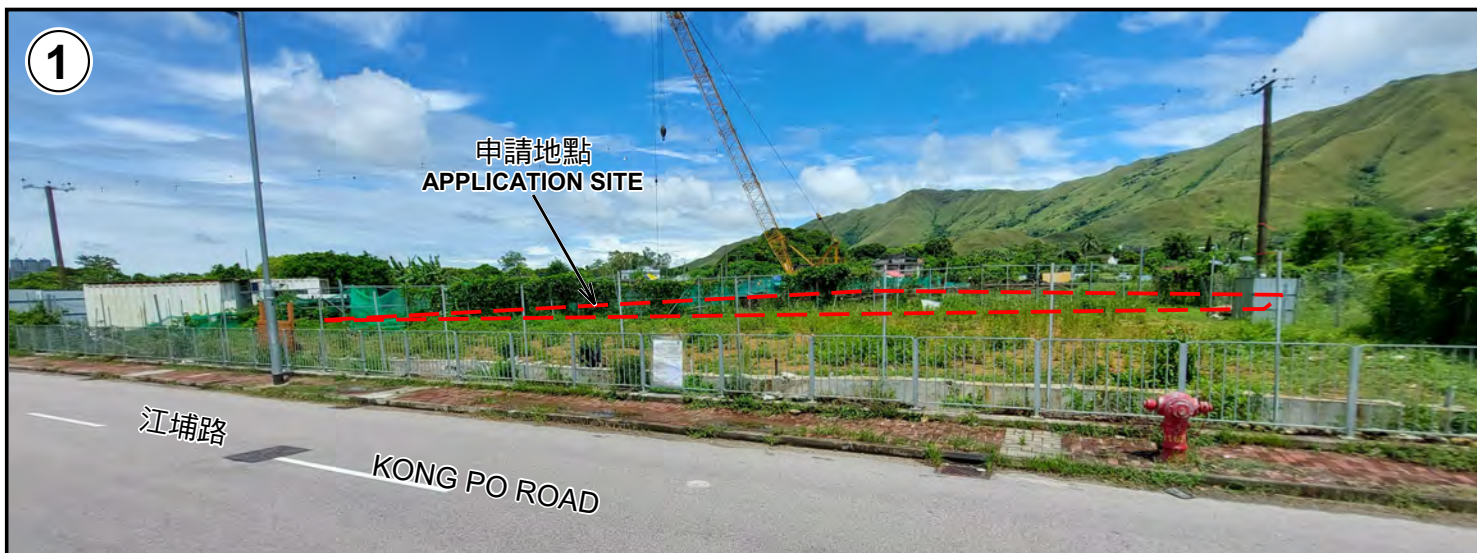

申請地點界線只作識別用 APPLICATION SITE BOUNDARY FOR IDENTIFICATION PURPOSE ONLY

### 實地照片 SITE PHOTOS

擬議臨時動物寄養所（為期 5 年）及填土工程  
元朗錦田丈量約份第109約多個地段  
PROPOSED TEMPORARY ANIMAL BOARDING ESTABLISHMENT  
FOR A PERIOD OF 5 YEARS AND FILLING OF LAND  
VARIOUS LOTS IN D.D. 109, KAM TIN, YUEN LONG

規劃署  
PLANNING  
DEPARTMENT



參考編號  
REFERENCE No.  
A/YL-KTN/856

圖 PLAN  
A-4

本圖於2022年9月19日擬備，所根據的資料為攝於2022年8月19日的實地照片  
PLAN PREPARED ON 19.9.2022  
BASED ON SITE PHOTOS  
TAKEN ON 19.8.2022