

2023年 3月 2 9日

Appendix I of RNTPC
Paper No. A/YL-KTN/904

此文件在 收到。城市規劃委員會
只會在收到所有必要的資料及文件後才正式確認收到
申請的日期。

29 MAR 2023

This document is received on
The Town Planning Board will formally acknowledge
the date of receipt of the application only upon receipt
of all the required information and documents.

Form No. S16-III
表格第 S16-III 號

**APPLICATION FOR PERMISSION
UNDER SECTION 16 OF
THE TOWN PLANNING ORDINANCE
(CAP.131)**

根據《城市規劃條例》(第131章)
第16條遞交的許可申請

**Applicable to Proposal Only Involving Temporary Use/Development of
Land and/or Building Not Exceeding 3 Years in Rural Areas or Renewal
of Permission for such Temporary Use or Development***

**適用於祇涉及位於鄉郊地區土地上及/或建築物內進行為期不超過三年的
臨時用途/發展或該等臨時用途/發展的許可續期的建議***

*Form No. S16-I should be used for other Temporary Use/Development of Land and/or Building (e.g. temporary use/developments in the Urban Area) and Renewal of Permission for such Temporary Use or Development.

*其他土地上及/或建築物內的臨時用途/發展 (例如位於市區內的臨時用途或發展) 及有關該等臨時用途/發展的許可續期，應使用表格第 S16-I 號。

Applicant who would like to publish the notice of application in local newspapers to meet one of the Town Planning Board's requirements of taking reasonable steps to obtain consent of or give notification to the current land owner, please refer to the following link regarding publishing the notice in the designated newspapers:
https://www.info.gov.hk/tpb/en/plan_application/apply.html

申請人如欲在本地報章刊登申請通知，以採取城市規劃委員會就取得現行土地擁有人的同意或通知現行土地擁有人所指定的其中一項合理步驟，請瀏覽以下網址有關在指定的報章刊登通知：
https://www.info.gov.hk/tpb/tc/plan_application/apply.html

General Note and Annotation for the Form

填寫表格的一般指引及註解

"Current land owner" means any person whose name is registered in the Land Registry as that of an owner of the land to which the application relates, as at 6 weeks before the application is made

「現行土地擁有人」指在提出申請前六星期，其姓名或名稱已在土地註冊處註冊為該申請所關乎的土地的擁有人的人

⌘ Please attach documentary proof 請夾附證明文件

^ Please insert number where appropriate 請在適當地方註明編號

Please fill "NA" for inapplicable item 請在不適用的項目填寫「不適用」

Please use separate sheets if the space provided is insufficient 如所提供的空間不足，請另頁說明

Please insert a 「✓」 at the appropriate box 請在適當的方格內上加上「✓」號

2300836 22/3 by hand

Form No. S16-III 表格第 S16-III 號

For Official Use Only 請勿填寫此欄	Application No. 申請編號	AML-KTN/904
	Date Received 收到日期	29 MAR 2003

- The completed form and supporting documents (if any) should be sent to the Secretary, Town Planning Board (the Board), 15/F, North Point Government Offices, 333 Java Road, North Point, Hong Kong.
申請人須把填妥的申請表格及其他支持申請的文件(倘有), 送交香港北角渣華道 333 號北角政府合署 15 樓城市規劃委員會(下稱「委員會」)秘書收。
- Please read the "Guidance Notes" carefully before you fill in this form. The document can be downloaded from the Board's website at <http://www.info.gov.hk/tpb/>. It can also be obtained from the Secretariat of the Board at 15/F, North Point Government Offices, 333 Java Road, North Point, Hong Kong (Tel: 2231 4810 or 2231 4835), and the Planning Enquiry Counters of the Planning Department (Hotline: 2231 5000) (17/F, North Point Government Offices, 333 Java Road, North Point, Hong Kong and 14/F, Sha Tin Government Offices, 1 Sheung Wo Che Road, Sha Tin, New Territories).
請先細閱《申請須知》的資料單張, 然後填寫此表格。該份文件可從委員會的網頁下載(網址: <http://www.info.gov.hk/tpb/>)。亦可向委員會秘書處(香港北角渣華道 333 號北角政府合署 15 樓 - 電話: 2231 4810 或 2231 4835)及規劃署的規劃資料查詢處(熱線: 2231 5000)(香港北角渣華道 333 號北角政府合署 17 樓及新界沙田上禾輦路 1 號沙田政府合署 14 樓)索取。
- This form can be downloaded from the Board's website, and obtained from the Secretariat of the Board and the Planning Enquiry Counters of the Planning Department. The form should be typed or completed in block letters. The processing of the application may be refused if the required information or the required copies are incomplete.
此表格可從委員會的網頁下載, 亦可向委員會秘書處及規劃署的規劃資料查詢處索取。申請人須以打印方式或以正楷填寫表格。如果申請人所提交的資料或文件副本不齊全, 委員會可拒絕處理有關申請。

1. Name of Applicant 申請人姓名/名稱	
<input type="checkbox"/> Mr. 先生 / <input type="checkbox"/> Mrs. 夫人 / <input type="checkbox"/> Miss 小姐 / <input checked="" type="checkbox"/> Ms. 女士 / <input type="checkbox"/> Company 公司 / <input type="checkbox"/> Organisation 機構	
CHAN Pui Ling	
2. Name of Authorised Agent (if applicable) 獲授權代理人姓名/名稱 (如適用)	
<input type="checkbox"/> Mr. 先生 / <input type="checkbox"/> Mrs. 夫人 / <input type="checkbox"/> Miss 小姐 / <input type="checkbox"/> Ms. 女士 / <input checked="" type="checkbox"/> Company 公司 / <input type="checkbox"/> Organisation 機構	
R-riches Property Consultants Limited 盈卓物業顧問有限公司	
3. Application Site 申請地點	
(a) Full address / location / demarcation district and lot number (if applicable) 詳細地址/地點/丈量約份及地段號碼(如適用)	Lots 1222 S.A (Part) and 1224 S.B in D.D. 107, Fung Kat Heung, Kam Tin, Yuen Long, New Territories
(b) Site area and/or gross floor area involved 涉及的地盤面積及/或總樓面面積	<input checked="" type="checkbox"/> Site area 地盤面積 516 sq.m 平方米 <input checked="" type="checkbox"/> About 約 <input checked="" type="checkbox"/> Gross floor area 總樓面面積 222 sq.m 平方米 <input checked="" type="checkbox"/> About 約
(c) Area of Government land included (if any) 所包括的政府土地面積(倘有)	NA sq.m 平方米 <input type="checkbox"/> About 約

(d) Name and number of the related statutory plan(s) 有關法定圖則的名稱及編號	Draft Kam Tin North Outline Zoning Plan : S/YL-KTN/10
(e) Land use zone(s) involved 涉及的土地用途地帶	"Agriculture" Zone
(f) Current use(s) 現時用途	Occupied by structure (If there are any Government, institution or community facilities, please illustrate on plan and specify the use and gross floor area) (如有任何政府、機構或社區設施，請在圖則上顯示，並註明用途及總樓面面積)

4. "Current Land Owner" of Application Site 申請地點的「現行土地擁有人」

The applicant 申請人 -

☒ is the sole "current land owner"^{##} (please proceed to Part 6 and attach documentary proof of ownership).
是唯一的「現行土地擁有人」^{##} (請繼續填寫第 6 部分，並夾附業權證明文件)。

☐ is one of the "current land owners"^{##} (please attach documentary proof of ownership).
是其中一名「現行土地擁有人」^{##} (請夾附業權證明文件)。

☐ is not a "current land owner"[#].
並不是「現行土地擁有人」[#]。

☐ The application site is entirely on Government land (please proceed to Part 6).
申請地點完全位於政府土地上 (請繼續填寫第 6 部分)。

5. Statement on Owner's Consent/Notification

就土地擁有人的同意/通知土地擁有人的陳述

(a) According to the record(s) of the Land Registry as at (DD/MM/YYYY), this application involves a total of "current land owner(s)"^{##}.
根據土地註冊處截至 年 月 日的記錄，這宗申請共牽涉 名「現行土地擁有人」^{##}。

(b) The applicant 申請人 -

☐ has obtained consent(s) of "current land owner(s)"^{##}.
已取得 名「現行土地擁有人」^{##}的同意。

Details of consent of "current land owner(s)" ^{##} obtained 取得「現行土地擁有人」 ^{##} 同意的詳情		
No. of 'Current Land Owner(s)' 「現行土地擁有人」數目	Lot number/address of premises as shown in the record of the Land Registry where consent(s) has/have been obtained 根據土地註冊處記錄已獲得同意的地段號碼/處所地址	Date of consent obtained (DD/MM/YYYY) 取得同意的日期 (日/月/年)

(Please use separate sheets if the space of any box above is insufficient. 如上述任何方格的空間不足，請另頁說明)

- ☐ has notified "current land owner(s)"[#]
已通知 名「現行土地擁有人」[#]。

Details of the "current land owner(s)" [#] notified 已獲通知「現行土地擁有人」 [#] 的詳細資料		
No. of 'Current Land Owner(s)' 「現行土地擁有人」數目	Lot number/address of premises as shown in the record of the Land Registry where notification(s) has/have been given 根據土地註冊處記錄已發出通知的地段號碼/處所地址	Date of notification given (DD/MM/YYYY) 通知日期(日/月/年)

(Please use separate sheets if the space of any box above is insufficient. 如上列任何方格的空間不足，請另頁說明)

- ☐ has taken reasonable steps to obtain consent of or give notification to owner(s):
已採取合理步驟以取得土地擁有人的同意或向該人發給通知。詳情如下：

Reasonable Steps to Obtain Consent of Owner(s) 取得土地擁有人的同意所採取的合理步驟

- ☐ sent request for consent to the "current land owner(s)" on _____ (DD/MM/YYYY)[#]
於 _____ (日/月/年)向每一名「現行土地擁有人」[#]郵遞要求同意書^{*}

Reasonable Steps to Give Notification to Owner(s) 向土地擁有人發出通知所採取的合理步驟

- ☐ published notices in local newspapers on _____ (DD/MM/YYYY)^{*}
於 _____ (日/月/年)在指定報章就申請刊登一次通知^{*}
- ☐ posted notice in a prominent position on or near application site/premises on _____ (DD/MM/YYYY)^{*}
於 _____ (日/月/年)在申請地點/申請處所或附近的顯明位置貼出關於該申請的通知^{*}
- ☐ sent notice to relevant owners' corporation(s)/owners' committee(s)/mutual aid committee(s)/management office(s) or rural committee on _____ (DD/MM/YYYY)^{*}
於 _____ (日/月/年)把通知寄往相關的業主立案法團/業主委員會/互助委員會或管理處，或有關的鄉事委員會^{*}

Others 其他

- ☐ others (please specify)
其他 (請指明)

Note: May insert more than one 「✓」.
Information should be provided on the basis of each and every lot (if applicable) and premises (if any) in respect of the application.
註: 可在多於一個方格內加上「✓」號
申請人須就申請涉及的每一地段(倘適用)及處所(倘有)分別提供資料

6. Type(s) of Application 申請類別

(A) Temporary Use/Development of Land and/or Building Not Exceeding 3 Years in Rural Areas

(位於鄉郊地區土地及/或建築物內進行為期不超過三年的臨時用途/發展)

(For Renewal of Permission for Temporary Use or Development in Rural Areas, please proceed to Part (B))

(如屬位於鄉郊地區臨時用途/發展的規劃許可續期, 請填寫(B)部分)

(a) Proposed use(s)/development
擬議用途/發展

Proposed Temporary Warehouse (Excluding Dangerous Goods Godown) with Ancillary Facilities for a Period of 3 Years and Associated Filling of Land

(Please illustrate the details of the proposal on a layout plan) (請用平面圖說明擬議詳情)

(b) Effective period of permission applied for
申請的許可有效期☒ year(s) 年 3☐ month(s) 個月

(c) Development Schedule 發展細節表

Proposed uncovered land area 擬議露天土地面積 294sq.m ☒ About 約

Proposed covered land area 擬議有上蓋土地面積 222sq.m ☒ About 約

Proposed number of buildings/structures 擬議建築物/構築物數目 1

Proposed domestic floor area 擬議住用樓面面積 /sq.m ☐ About 約

Proposed non-domestic floor area 擬議非住用樓面面積 222sq.m ☒ About 約

Proposed gross floor area 擬議總樓面面積 222sq.m ☒ About 約

Proposed height and use(s) of different floors of buildings/structures (if applicable) 建築物/構築物的擬議高度及不同樓層的擬議用途 (如適用) (Please use separate sheets if the space below is insufficient) (如以下空間不足, 請另頁說明)

STRUCTURE	USE	COVERED AREA	GFA	BUILDING HEIGHT
B1	WAREHOUSE (EXCLUDING D.G.G.) ANCILLARY OFFICE	222 m ² (ABOUT)	222 m ² (ABOUT)	8.23 m (ABOUT)(1-STORY)
TOTAL		222 m ² (ABOUT)	222 m ² (ABOUT)	

Proposed number of car parking spaces by types 不同種類停車位的擬議數目

Private Car Parking Spaces 私家車車位 1

Motorcycle Parking Spaces 電單車車位

Light Goods Vehicle Parking Spaces 輕型貨車泊車位

Medium Goods Vehicle Parking Spaces 中型貨車泊車位

Heavy Goods Vehicle Parking Spaces 重型貨車泊車位

Others (Please Specify) 其他 (請列明)

Proposed number of loading/unloading spaces 上落客貨車位的擬議數目

Taxi Spaces 的士車位

Coach Spaces 旅遊巴車位

Light Goods Vehicle Spaces 輕型貨車車位 1

Medium Goods Vehicle Spaces 中型貨車車位

Heavy Goods Vehicle Spaces 重型貨車車位

Others (Please Specify) 其他 (請列明)

Proposed operating hours 擬議營運時間 Monday to Saturday from 09:00 to 19:00, no operation on Sunday and public holiday			
(d) Any vehicular access to the site/subject building? 是否有車路通往地盤/ 有關建築物?	Yes 是	<input checked="" type="checkbox"/> There is an existing access. (please indicate the street name, where appropriate) 有一條現有車路。(請註明車路名稱(如適用)) Accessible from Fung Kat Heung Road via Mei Fung Road and a local access.....	
	No 否	<input type="checkbox"/> There is a proposed access. (please illustrate on plan and specify the width) 有一條擬議車路。(請在圖則顯示，並註明車路的闊度) <input type="checkbox"/>	
(e) Impacts of Development Proposal 擬議發展計劃的影響 (If necessary, please use separate sheets to indicate the proposed measures to minimise possible adverse impacts or give justifications/reasons for not providing such measures. 如需要的話，請另頁註明可盡量減少可能出現不良影響的措施，否則請提供理據/理由。)			
(i) Does the development proposal involve alteration of existing building? 擬議發展計劃是否包括現有建築物的改動?	Yes 是	<input type="checkbox"/> Please provide details 請提供詳情	
	No 否	<input checked="" type="checkbox"/>	
(ii) Does the development proposal involve the operation on the right? 擬議發展是否涉及右列的工程?	Yes 是	<input checked="" type="checkbox"/> (Please indicate on site plan the boundary of concerned land/pond(s), and particulars of stream diversion, the extent of filling of land/pond(s) and/or excavation of land) (請用地盤平面圖顯示有關土地/池塘界線，以及河道改道、填塘、填土及/或挖土的細節及/或範圍) <input type="checkbox"/> Diversion of stream 河道改道 <input type="checkbox"/> Filling of pond 填塘 Area of filling 填塘面積 sq.m 平方米 <input type="checkbox"/> About 約 Depth of filling 填塘深度 m 米 <input type="checkbox"/> About 約 <input checked="" type="checkbox"/> Filling of land 填土 Area of filling 填土面積 132 sq.m 平方米 <input checked="" type="checkbox"/> About 約 Depth of filling 填土厚度 ...not more than 0.1... m 米 <input type="checkbox"/> About 約 <input type="checkbox"/> Excavation of land 挖土 Area of excavation 挖土面積 sq.m 平方米 <input type="checkbox"/> About 約 Depth of excavation 挖土深度 m 米 <input type="checkbox"/> About 約	
	No 否	<input type="checkbox"/>	
(iii) Would the development proposal cause any adverse impacts? 擬議發展計劃會否造成不良影響?	On environment 對環境 On traffic 對交通 On water supply 對供水 On drainage 對排水 On slopes 對斜坡 Affected by slopes 受斜坡影響 Landscape Impact 構成景觀影響 Tree Felling 砍伐樹木 Visual Impact 構成視覺影響 Others (Please Specify) 其他 (請列明)		Yes 會 <input type="checkbox"/> No 不會 <input checked="" type="checkbox"/> Yes 會 <input type="checkbox"/> No 不會 <input checked="" type="checkbox"/> Yes 會 <input type="checkbox"/> No 不會 <input checked="" type="checkbox"/> Yes 會 <input type="checkbox"/> No 不會 <input checked="" type="checkbox"/> Yes 會 <input type="checkbox"/> No 不會 <input checked="" type="checkbox"/> Yes 會 <input type="checkbox"/> No 不會 <input checked="" type="checkbox"/> Yes 會 <input type="checkbox"/> No 不會 <input checked="" type="checkbox"/> Yes 會 <input type="checkbox"/> No 不會 <input checked="" type="checkbox"/> Yes 會 <input type="checkbox"/> No 不會 <input checked="" type="checkbox"/> Yes 會 <input type="checkbox"/> No 不會 <input checked="" type="checkbox"/>

	<p>Please state measure(s) to minimise the impact(s). For tree felling, please state the number, diameter at breast height and species of the affected trees (if possible)</p> <p>請註明盡量減少影響的措施。如涉及砍伐樹木，請說明受影響樹木的數目、及胸高度的樹幹直徑及品種(倘可)</p> <p>.....</p> <p>.....</p> <p>.....</p> <p>.....</p> <p>.....</p>
--	--

(B) Renewal of Permission for Temporary Use or Development in Rural Areas	
位於鄉郊地區臨時用途/發展的許可續期	
(a) Application number to which the permission relates 與許可有關的申請編號	A/ _____ / _____
(b) Date of approval 獲批給許可的日期 (DD 日/MM 月/YYYY 年)
(c) Date of expiry 許可屆滿日期 (DD 日/MM 月/YYYY 年)
(d) Approved use/development 已批給許可的用途/發展	
(e) Approval conditions 附帶條件	<p><input type="checkbox"/> The permission does not have any approval condition 許可並沒有任何附帶條件</p> <p><input type="checkbox"/> Applicant has complied with all the approval conditions 申請人已履行全部附帶條件</p> <p><input type="checkbox"/> Applicant has not yet complied with the following approval condition(s): 申請人仍未履行下列附帶條件：</p> <p>.....</p> <p>.....</p> <p>.....</p> <p>Reason(s) for non-compliance: 仍未履行的原因：</p> <p>.....</p> <p>.....</p> <p>.....</p> <p>(Please use separate sheets if the space above is insufficient) (如以上空間不足，請另頁說明)</p>
(f) Renewal period sought 要求的續期期間	<p><input type="checkbox"/> year(s) 年</p> <p><input type="checkbox"/> month(s) 個月</p>

7. Justifications 理由

The applicant is invited to provide justifications in support of the application. Use separate sheets if necessary.
現請申請人提供申請理由及支持其申請的資料。如有需要，請另頁說明。

Please refer to the attached supplementary statement.

8. Declaration 聲明

I hereby declare that the particulars given in this application are correct and true to the best of my knowledge and belief.
本人謹此聲明，本人就這宗申請提交的資料，據本人所知及所信，均屬真實無誤。

I hereby grant a permission to the Board to copy all the materials submitted in this application and/or to upload such materials to the Board's website for browsing and downloading by the public free-of-charge at the Board's discretion.
本人現准許委員會酌情將本人就此申請所提交的所有資料複製及/或上載至委員會網站，供公眾免費瀏覽或下載。

Signature
簽署

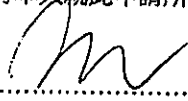

☐ Applicant 申請人 / ☒ Authorised Agent 獲授權代理人

Michael WONG

Name in Block Letters
姓名（請以正楷填寫）

Position (if applicable)
職位（如適用）

Professional Qualification(s)
專業資格

☐ Member 會員 / ☐ Fellow of 資深會員

☐ HKIP 香港規劃師學會 /

☐ HKIA 香港建築師學會 /

☐ HKIS 香港測量師學會 /

☐ HKIE 香港工程師學會 /

☐ HKILA 香港園境師學會 /

☐ HKIUD 香港城市設計學會

☐ RPP 註冊專業規劃師

Others 其他

on behalf of
代表

R-Riches Property Consultants Limited



☒ Company 公司 / ☐ Organisation Name and Chop (if applicable) 機構名稱及蓋章（如適用）

Date 日期

21/3/2023

(DD/MM/YYYY 日/月/年)

Remark 備註

The materials submitted in this application and the Board's decision on the application would be disclosed to the public. Such materials would also be uploaded to the Board's website for browsing and free downloading by the public where the Board considers appropriate.

委員會會向公眾披露申請人所遞交的申請資料和委員會對申請所作的決定。在委員會認為合適的情況下，有關申請資料亦會上載至委員會網頁供公眾免費瀏覽及下載。

Warning 警告

Any person who knowingly or wilfully makes any statement or furnish any information in connection with this application, which is false in any material particular, shall be liable to an offence under the Crimes Ordinance.

任何人在明知或故意的情況下，就這宗申請提出在任何要項上是虛假的陳述或資料，即屬違反《刑事罪行條例》。

Statement on Personal Data 個人資料的聲明

1. The personal data submitted to the Board in this application will be used by the Secretary of the Board and Government departments for the following purposes:

委員會就這宗申請所收到的個人資料會交給委員會秘書及政府部門，以根據《城市規劃條例》及相關的城市規劃委員會規劃指引的規定作以下用途：

(a) the processing of this application which includes making available the name of the applicant for public inspection when making available this application for public inspection; and

處理這宗申請，包括公布這宗申請供公眾查閱，同時公布申請人的姓名供公眾查閱；以及

(b) facilitating communication between the applicant and the Secretary of the Board/Government departments.

方便申請人與委員會秘書及政府部門之間進行聯絡。

2. The personal data provided by the applicant in this application may also be disclosed to other persons for the purposes mentioned in paragraph 1 above.

申請人就這宗申請提供的個人資料，或亦會向其他人士披露，以作上述第1段提及的用途。

3. An applicant has a right of access and correction with respect to his/her personal data as provided under the Personal Data (Privacy) Ordinance (Cap. 486). Request for personal data access and correction should be addressed to the Secretary of the Board at 15/F, North Point Government Offices, 333 Java Road, North Point, Hong Kong.

根據《個人資料(私隱)條例》(第486章)的規定，申請人有權查閱及更正其個人資料。如欲查閱及更正個人資料，應向委員會秘書提出有關要求，其地址為香港北角渣華道333號北角政府合署15樓。

Gist of Application 申請摘要

(Please provide details in both English and Chinese as far as possible. This part will be circulated to relevant consultees, uploaded to the Town Planning Board's Website for browsing and free downloading by the public and available at the Planning Enquiry Counters of the Planning Department for general information.)

(請盡量以英文及中文填寫。此部分將會發送予相關諮詢人士、上載至城市規劃委員會網頁供公眾免費瀏覽及下載及於規劃署規劃資料查詢處供一般參閱。)

Application No. 申請編號	(For Official Use Only) (請勿填寫此欄)		
Location/address 位置/地址	Lots 1222 S.A (Part) and 1224 S.B in D.D. 107, Fung Kat Heung, Kam Tin, Yuen Long, New Territories		
Site area 地盤面積	516	sq. m 平方米	<input checked="" type="checkbox"/> About 約
	(includes Government land of 包括政府土地	/	sq. m 平方米 <input type="checkbox"/> About 約)
Plan 圖則	Draft Kam Tin North Outline Zoning Plan No.: S/YL-KTN/10		
Zoning 地帶	"Agriculture" Zone		
Type of Application 申請類別	<input checked="" type="checkbox"/> Temporary Use/Development in Rural Areas for a Period of 位於鄉郊地區的臨時用途/發展為期 <input checked="" type="checkbox"/> Year(s) 年 <u>3</u> <input type="checkbox"/> Month(s) 月 <u> </u> <input type="checkbox"/> Renewal of Planning Approval for Temporary Use/Development in Rural Areas for a Period of 位於鄉郊地區臨時用途/發展的規劃許可續期為期 <input type="checkbox"/> Year(s) 年 <u> </u> <input type="checkbox"/> Month(s) 月 <u> </u>		
Applied use/ development 申請用途/發展	Proposed Temporary Warehouse (Excluding Dangerous Goods Godown) with Ancillary Facilities for a Period of 3 Years and Associated Filling of Land		

(i) Gross floor area and/or plot ratio 總樓面面積及／或地積比率		sq.m 平方米	Plot Ratio 地積比率
	Domestic 住用	/ <input type="checkbox"/> About 約 <input type="checkbox"/> Not more than 不多於	/ <input type="checkbox"/> About 約 <input type="checkbox"/> Not more than 不多於
	Non-domestic 非住用	222 <input checked="" type="checkbox"/> About 約 <input type="checkbox"/> Not more than 不多於	0.43 <input checked="" type="checkbox"/> About 約 <input type="checkbox"/> Not more than 不多於
(ii) No. of block 幢數	Domestic 住用	/	
	Non-domestic 非住用	1	
(iii) Building height/No. of storeys 建築物高度／層數	Domestic 住用	/ m 米 <input type="checkbox"/> (Not more than 不多於)	/ Storeys(s) 層 <input type="checkbox"/> (Not more than 不多於)
		/	/
	Non-domestic 非住用	8.23 (about) m 米 <input type="checkbox"/> (Not more than 不多於)	1 Storeys(s) 層 <input type="checkbox"/> (Not more than 不多於)
		1	1
(iv) Site coverage 上蓋面積	43 % <input checked="" type="checkbox"/> About 約		
(v) No. of parking spaces and loading / unloading spaces 停車位及上落客貨車位數目	Total no. of vehicle parking spaces 停車位總數 Private Car Parking Spaces 私家車車位 Motorcycle Parking Spaces 電單車車位 Light Goods Vehicle Parking Spaces 輕型貨車泊車位 Medium Goods Vehicle Parking Spaces 中型貨車泊車位 Heavy Goods Vehicle Parking Spaces 重型貨車泊車位 Others (Please Specify) 其他 (請列明) _____		1 1 (PC)
	Total no. of vehicle loading/unloading bays/lay-bys 上落客貨車位／停車處總數 Taxi Spaces 的士車位 Coach Spaces 旅遊巴車位 Light Goods Vehicle Spaces 輕型貨車車位 Medium Goods Vehicle Spaces 中型貨車車位 Heavy Goods Vehicle Spaces 重型貨車車位 Others (Please Specify) 其他 (請列明) Container Vehicle _____		1 1 (LGV)

Submitted Plans, Drawings and Documents 提交的圖則、繪圖及文件		
	Chinese 中文	English 英文
Plans and Drawings 圖則及繪圖		
Master layout plan(s)/Layout plan(s) 總綱發展藍圖／布局設計圖	<input type="checkbox"/>	<input checked="" type="checkbox"/>
Block plan(s) 樓宇位置圖	<input type="checkbox"/>	<input type="checkbox"/>
Floor plan(s) 樓宇平面圖	<input type="checkbox"/>	<input type="checkbox"/>
Sectional plan(s) 截視圖	<input type="checkbox"/>	<input type="checkbox"/>
Elevation(s) 立視圖	<input type="checkbox"/>	<input type="checkbox"/>
Photomontage(s) showing the proposed development 顯示擬議發展的合成照片	<input type="checkbox"/>	<input type="checkbox"/>
Master landscape plan(s)/Landscape plan(s) 園境設計總圖／園境設計圖	<input type="checkbox"/>	<input type="checkbox"/>
Others (please specify) 其他 (請註明)	<input type="checkbox"/>	<input checked="" type="checkbox"/>
Plan showing the zoning of the Site, Plan showing the land status of the Site		
Location Plan, Plan showing the land filling area, Swept path analysis		
Reports 報告書		
Planning Statement/Justifications 規劃綱領/理據	<input type="checkbox"/>	<input checked="" type="checkbox"/>
Environmental assessment (noise, air and/or water pollutions) 環境評估 (噪音、空氣及／或水的污染)	<input type="checkbox"/>	<input type="checkbox"/>
Traffic impact assessment (on vehicles) 就車輛的交通影響評估	<input type="checkbox"/>	<input type="checkbox"/>
Traffic impact assessment (on pedestrians) 就行人的交通影響評估	<input type="checkbox"/>	<input type="checkbox"/>
Visual impact assessment 視覺影響評估	<input type="checkbox"/>	<input type="checkbox"/>
Landscape impact assessment 景觀影響評估	<input type="checkbox"/>	<input type="checkbox"/>
Tree Survey 樹木調查	<input type="checkbox"/>	<input type="checkbox"/>
Geotechnical impact assessment 土力影響評估	<input type="checkbox"/>	<input type="checkbox"/>
Drainage impact assessment 排水影響評估	<input type="checkbox"/>	<input type="checkbox"/>
Sewerage impact assessment 排污影響評估	<input type="checkbox"/>	<input type="checkbox"/>
Risk Assessment 風險評估	<input type="checkbox"/>	<input type="checkbox"/>
Others (please specify) 其他 (請註明)	<input type="checkbox"/>	<input type="checkbox"/>
Note: May insert more than one 「✓」. 註：可在多於一個方格內加上「✓」號		

Note: The information in the Gist of Application above is provided by the applicant for easy reference of the general public. Under no circumstances will the Town Planning Board accept any liabilities for the use of the information nor any inaccuracies or discrepancies of the information provided. In case of doubt, reference should always be made to the submission of the applicant.

註：上述申請摘要的資料是由申請人提供以方便市民大眾參考。對於所載資料在使用上的問題及文義上的歧異，城市規劃委員會概不負責。若有任何疑問，應查閱申請人提交的文件。

Supplementary Statement

1) Background

- 1.1 The applicant seeks planning permission from the Town Planning Board (the Board) to use Lots 1222 S.A (Part) and 1224 S.B in D.D. 107, Fung Kat Heung, Kam Tin, Yuen Long, New Territories (the Site) for 'Proposed Temporary Warehouse (excluding Dangerous Goods Godown) with Ancillary Facilities for a Period of 3 Years and Associated Filling of Land' (proposed development) (Plan 1).
- 1.2 The applicant would like to erect a single-storey structure at the Site for storage of construction materials (tiles and pipes, etc.). No dangerous goods will be stored at the Site at any time during the planning approval period.

2) Planning Context

- 2.1 The Site falls within an area zoned as "Agriculture" ("AGR") on the Draft Kam Tin North Outline Zoning Plan No.: S/YL-KTN/10 (Plan 2). According to the Notes of the OZP, 'warehouse' use is not a column one nor column two use within the "AGR" zone, which requires planning permission from the Board. Although the Site is zoned as "AGR" zone, the Site has been operated as animal boarding establishment since the approval of planning application No. A/YL-KTN/814 and there is no active agricultural activities within the Site. The surrounding area is also dominated by temporary structures, open storage and workshop premises, therefore, the applied use is considered not incompatible with the surrounding area.
- 2.2 Despite the fact that the applied use is not in line with the planning intention of the "AGR" zone, similar S.16 planning applications (Nos. A/YL-KTN/824 and 852) for the 'warehouse' use within the same "AGR" zone were approved by the Board previously. As the application is small in scale and only on a temporary basis, approval of the application would therefore not jeopardize the long term planning intention of the "AGR" zone. It would also better utilize deserted agricultural land in order to meet pressing demand for warehouse use.

3) Development Proposal

- 3.1 The Site occupied an area of 516 m² (about) of private land (Plan 3). The operation hours are Monday to Saturday from 09:00 to 19:00. No operation on Sunday and public holiday. One

single-storey structure is proposed at the Site for warehouse and ancillary office with total GFA of 222 m² (about) (Plan 4). The site office is proposed to provide indoor space for administrative staff to support the daily operation of the Site. The Site would be able to accommodate not more than 5 staff. As the Site is for 'warehouse' use, no visitor is anticipated at the Site. Details of development parameters are shown at **Table 1** below:

Table 1 – Major Development Parameters

Application Site Area	516m ² (about)
Covered Area	222m ² (about)
Uncovered Area	294m ² (about)
Plot Ratio	0.43 (about)
Site Coverage	43% (about)
Number of Structure	1
Total GFA	222 m ² (about)
Domestic GFA	Not applicable
Non-Domestic GFA	222 m ² (about)
Building Height	8.23m (about)
No. of Storey	1

- 3.2 The Site has been filled with concrete and occupied by structures. The Site involves of additional 132 m² of filling of concrete of not more than 0.1m (about) in depth for site formation of structure (Plan 5). The proposed filling of land is to facilitate a flat surface for site formation of structures. Therefore, the associated filling of land area is considered necessary and has been kept to minimal for the operation of the proposed development. The applicant will reinstate the Site to an amenity area after the planning approval period.
- 3.3 The Site is accessible from Fung Kat Heung Road via Mei Fung Road and a local access (Plan 1). 1 private car parking space and 1 loading/unloading space for light goods vehicle are provided at the Site for staff to commute to the Site and for transportation of goods. Details of parking and L/UL spaces are shown at **Table 2** below:

Table 2 – Parking and L/UL Provision

Type of Space	No. of Space
Private Car Parking Space for Staff - 2.5m (W) x 5m (L)	1
L/UL Space for Light Goods Vehicle - 3.5m (W) x 7m (L)	1

- 3.4 Sufficient space is provided for vehicle to smoothly manoeuvre within the Site to ensure that no vehicle will turn back onto the local access (**Plan 6**). No medium or heavy goods vehicles exceeding 5.5 tonnes, including container tractors/trailers, as defined in the Road Traffic Ordinance are allowed to be parked/stored on or enter/exit the Site at any time during the planning approval period. As traffic generated and attracted by the proposed development as shown at **Table 3** below is minimal, adverse traffic impact should not be anticipated.

Table 3 - Trip Generation and Attraction of the Proposed Development

Time Period	Private Car		Light Goods Vehicle		2-Way Total
	In	Out	In	Out	
Trips at AM peak per hour (09:00 – 10:00)	1	0	0.5	0.5	2
Trips at PM peak per hour (18:00 – 19:00)	0	1	0.5	0.5	2
Traffic trip per hour (average, 10:00 – 18:00)	0.5	0.5	0.5	0.5	2

- 3.5 The applicant will strictly follow the 'Code of Practice on Handling the Environmental Aspects of Temporary Uses and Open Storage Sites' by the EPD to minimize all possible environmental impacts on the nearby sensitive receivers. The applicant will follow the Professional Persons Environmental Consultative Committee Practice Notes (ProPECCPNs) for sewage treatment at the Site. No recycling, cleaning, repairing, dismantling nor other workshop activities will be carried out at the Site at any time during the planning approval period.

4) Conclusion

- 4.1 The proposed development will not create significant nuisance to the surrounding area. Adequate mitigation measures will be provided by the applicant (i.e. submission of drainage and fire service installations proposals) in order to mitigate any adverse impact arising from the proposed development after planning approval has been granted by the Board.

- 4.2 In view of the above, the Board is hereby respectfully recommended to approve the subject application for **'Proposed Temporary Warehouse (excluding Dangerous Goods Godown) with Ancillary Facilities for a Period of 3 Years and Associated Filling of Land'**.

R-riches Property Consultants Limited

March 2023

LIST OF PLANS

Plan 1	Location Plan
Plan 2	Plan Showing the Zoning of the Application Site
Plan 3	Plan Showing the Land Status of the Application Site
Plan 4	Layout Plan
Plan 5	Land Filling Area of the Application Site
Plan 6	Swept Path Analysis

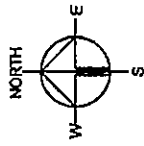

R Riches
Property Consultants Ltd.

**PROPOSED
WAREHOUSE
DANGEROUS GOODS GODOWN
FOR A PERIOD OF 3 YEARS AND
ASSOCIATED FILLING OF LAND**

**PROPOSED
WAREHOUSE
DANGEROUS GOODS GODOWN
FOR A PERIOD OF 3 YEARS AND
ASSOCIATED FILLING OF LAND**

**SCALE
1:3000 @ A4**

**DATE
15.3.2003**

DATE

DATE

DATE

DATE

DATE



LOCATION OF THE APPLICATION SITE
APPLICATION SITE AREA : 518 m² (ABOUT)
VEHICULAR ACCESS
ACCESSIBLE FROM FUNG KAT HEUNG ROAD VIA MEI FUNG
ROAD AND A LOCAL ACCESS

LEGEND
APPLICATION SITE

THIS PLAN IS FOR ILLUSTRATION PURPOSE ONLY.

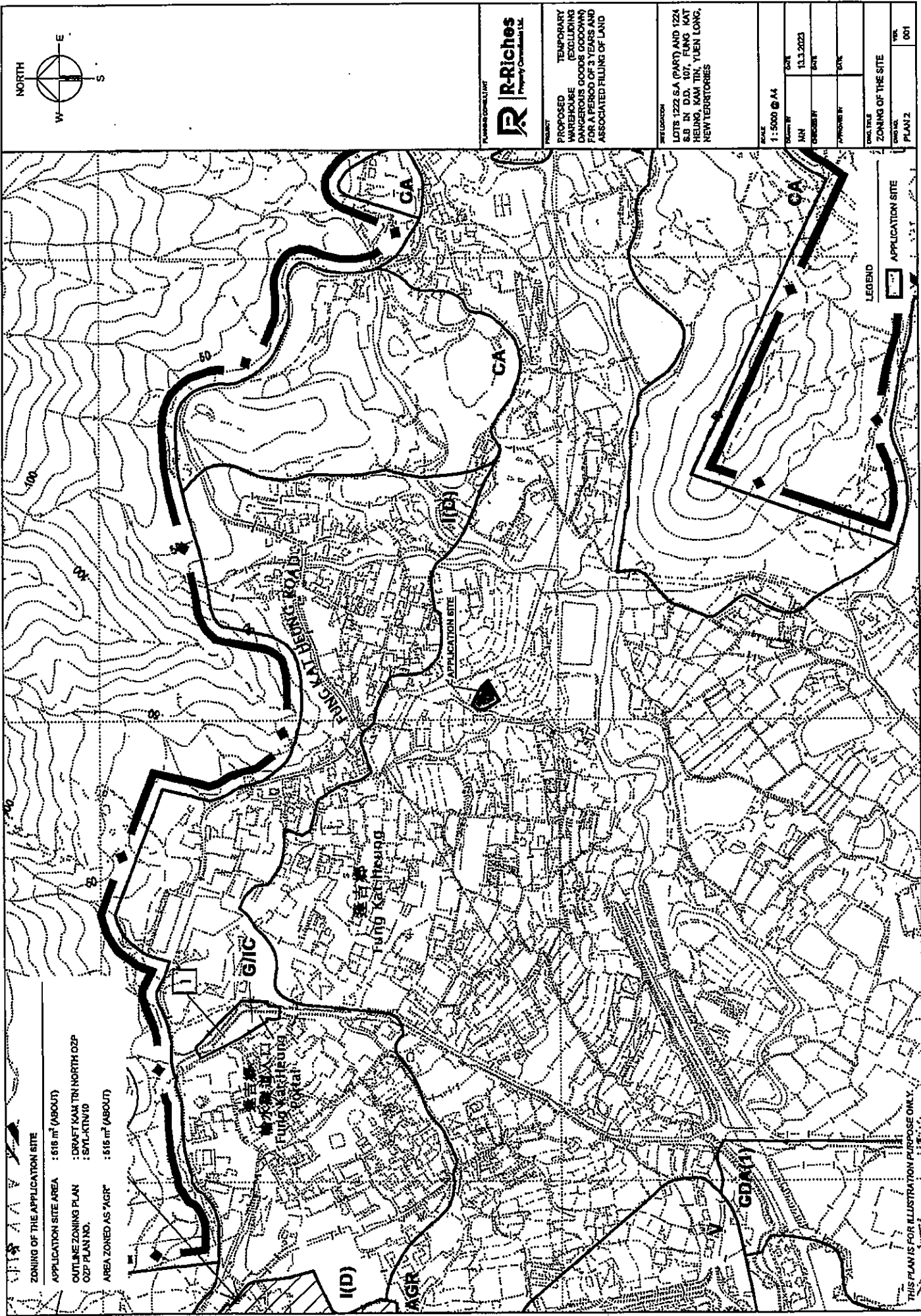

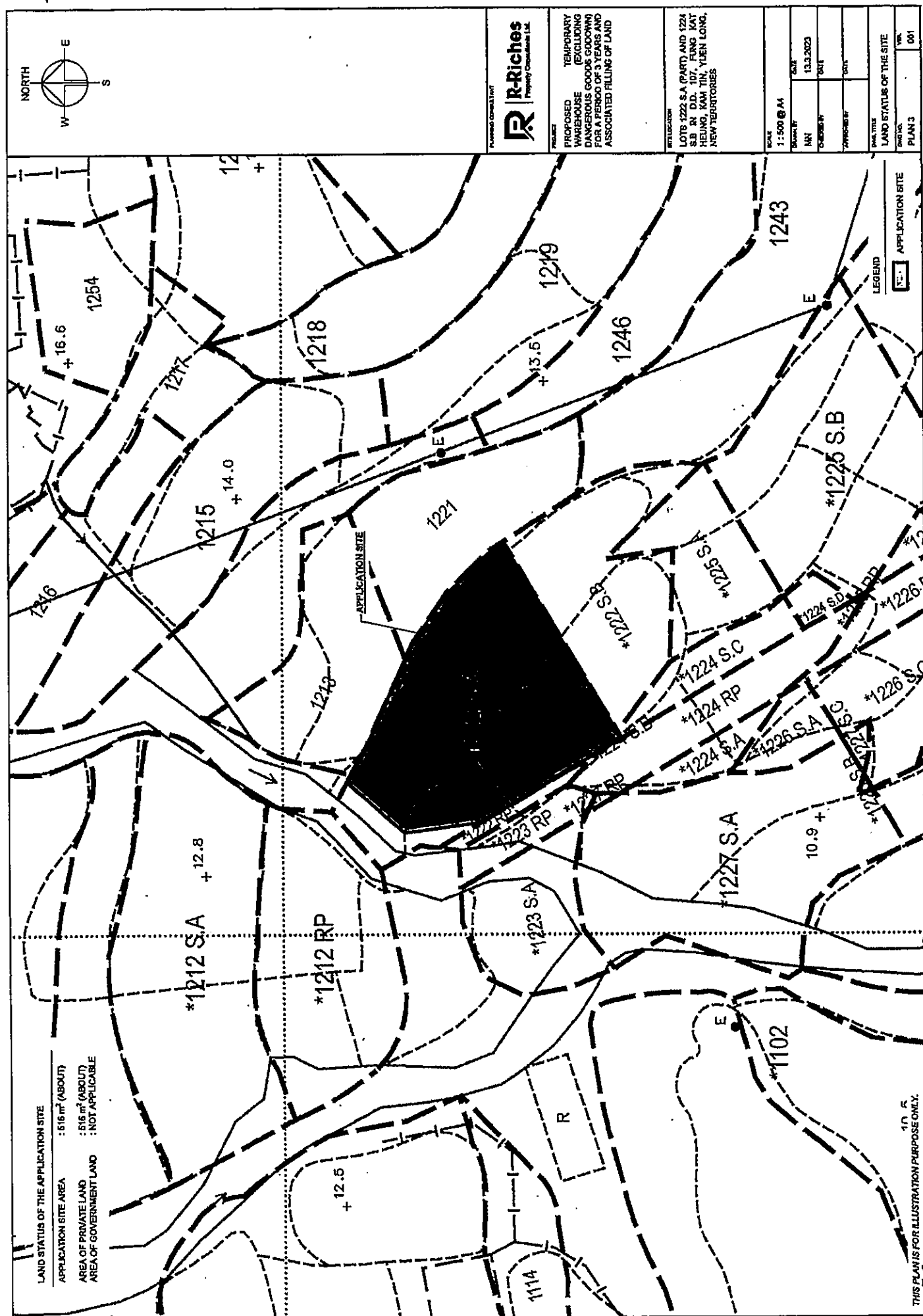

DEVELOPMENT PARAMETERS

APPLICATION SITE AREA	: 618 m ² (ABOUT)
COVERED AREA	: 222 m ² (ABOUT)
UNCOVERED AREA	: 284 m ² (ABOUT)
PLOT RATIO	: 0.43 (ABOUT)
SITE COVERAGE	: 43 % (ABOUT)
NO. OF STRUCTURE	: 1
DOMESTIC GFA	: NOT APPLICABLE (ABOUT)
NON-DOMESTIC GFA	: 222 m ² (ABOUT)
TOTAL GFA	: 222 m ² (ABOUT)
BUILDING HEIGHT	: 8.23 m (ABOUT)
NO. OF STOREY	: 1

STRUCTURE

USE

COVERED AREA

OFA

BUILDING HEIGHT

B1	WAREHOUSE (EXCLUDING D.O.G.) ANCILLARY OFFICE	222 m ² (ABOUT)	222 m ² (ABOUT)	8.23 m (ABOUT)
TOTAL		222 m ² (ABOUT)	222 m ² (ABOUT)	

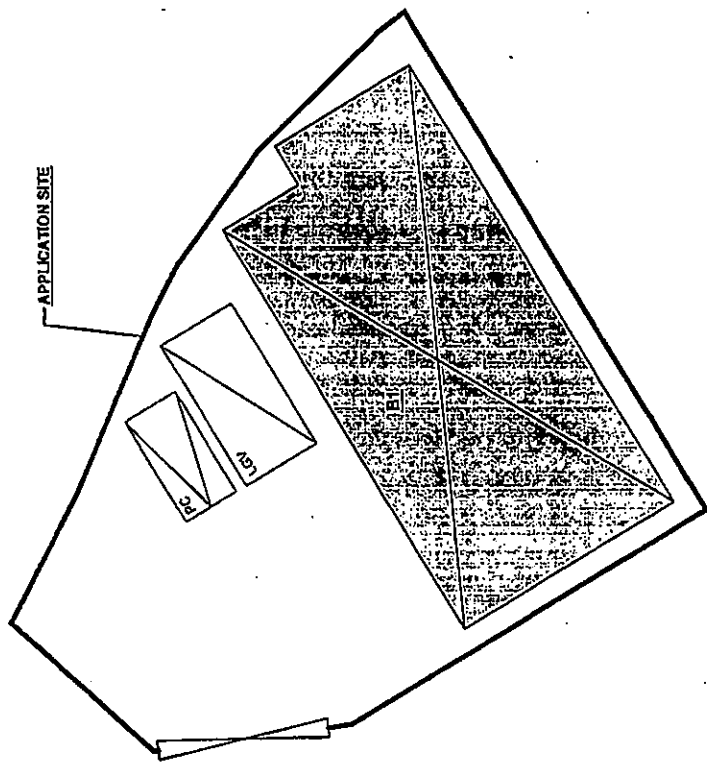

INGRESS / EGRESS
7.3m (ABOUT)(W)

PARKING AND LOADING/UNLOADING PROVISION

NO. OF PRIVATE CAR PARKING SPACE	: 1
DIMENSION OF PARKING SPACE	: 5 m (L) X 2.5 m (W)
NO. OF LIGHT GOODS VEHICLE PARKING SPACE	: 1
DIMENSION OF LOADING/UNLOADING SPACE	: 7 m (L) X 3.6 m (W)

LEGEND

	APPLICATION SITE
	STRUCTURE
	PARKING SPACE
	LOADING / UNLOADING SPACE
	INGRESS / EGRESS

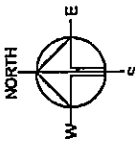

PLANNING CONSULTANT



PROJECT

PROPOSED
WAREHOUSE
(EXCLUDING
DANGEROUS GOODS GODOWN)
FOR A PERIOD OF 3 YEARS AND
ASSOCIATED FILLING OF LAND

SITE LOCATION

LOTS 1222 SA (PART) AND 1224
SLB IN D.D. 107, FUNG KAT
HEUNG, KAM TIN, YUEN LONG,
NEW TERRITORIES

SCALE

1:300 @ A4

DESIGN BY

MM

DATE

13.3.2023

DESIGN BY

MM

DATE

13.3.2023

DESIGN BY

MM

DATE

13.3.2023

DESIGN BY

MM

DATE

13.3.2023

DESIGN BY

MM

DATE

13.3.2023

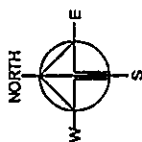

PLANNING CONSULTANT
R-Riches
Property Consultants Ltd.

PROJECT
PROPOSED TEMPORARY
WAREHOUSE (EXCLUDING
DANGEROUS GOODS GOODWAG)
FOR A PERIOD OF 3 YEARS AND
ASSOCIATED FILLING OF LAND

SITE LOCATION
LOTS 1222 S.A. (PART) AND 1224
S.B. IN D.D. 107 FUNG KAT
HEUNG, KAM TIN, YUEN LONG,
NEW TERRITORIES

SCALE
1:300 @ A4

DATE
15.3.2023
DRAWN BY
CHECKED BY
APPROVED BY

PROJECT TITLE
FILLING OF LAND AREA
DRAWING NO.
PLAN 5
YEA
001

FILLING OF LAND AREA OF THE APPLICATION SITE

APPLICATION SITE AREA	: 516 m ²	(ABOUT)
EXISTING HARD-PAVED AREA	: 516 m ²	(ABOUT)
EXISTING SITE LEVELS	: +10.3 mPD TO +10.4 mPD	(ABOUT)
ADDITIONAL FILLING OF LAND AREA	: 132 m ²	(ABOUT)
DEPTH OF LAND FILLING	: NOT MORE THAN 0.1 m	
MATERIAL OF LAND FILLING	: CONCRETE	
PURPOSE OF LAND FILLING	: SITE FORMATION OF STRUCTURE	
PROPOSED SITE LEVELS	: +10.3 mPD TO +10.4 mPD	(ABOUT)

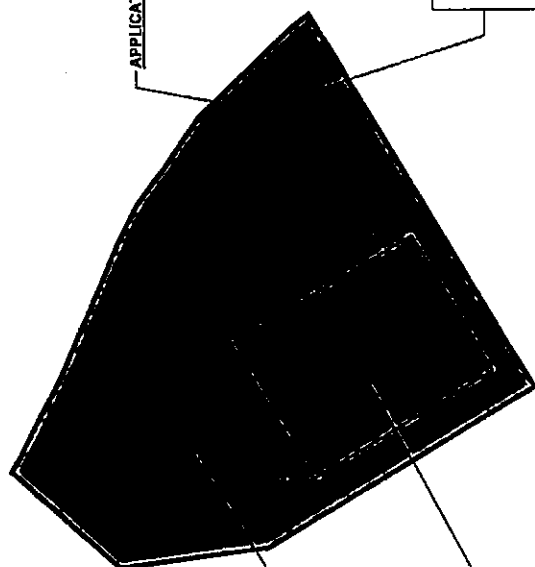

APPLICATION SITE

EXISTING HARD-PAVED AREA
EXISTING SITE LEVEL : +10.3 mPD (ABOUT)
EXISTING GROUND SURFACE : CONCRETE
PURPOSE OF FILLING : CIRCULATION SPACE

EXISTING HARD-PAVED AREA
OF THE APPLICATION SITE
(INDICATIVE ONLY)

EXISTING HARD-PAVED AREA
EXISTING SITE LEVEL : +10.3 mPD (ABOUT)
EXISTING GROUND SURFACE : CONCRETE
PURPOSE OF FILLING : CIRCULATION SPACE

EXISTING HARD-PAVED AREA
EXISTING SITE LEVEL : +10.4 mPD (ABOUT)
EXISTING GROUND SURFACE : CONCRETE
PURPOSE OF FILLING : SITE FORMATION OF STRUCTURE

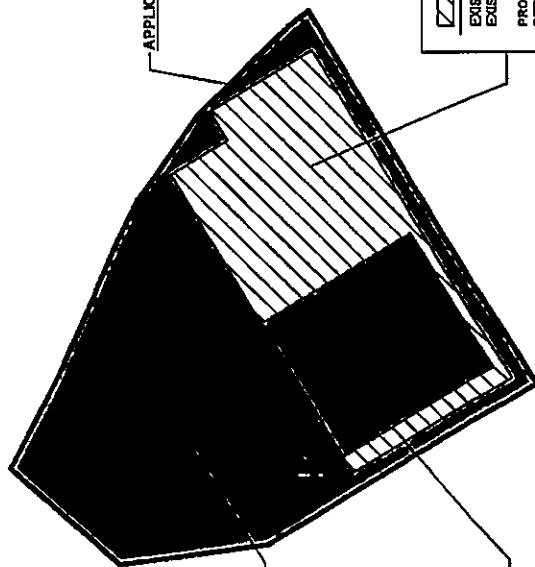

APPLICATION SITE

PROPOSED FILLING AREA
EXISTING SITE LEVEL : +10.3 mPD (ABOUT)
EXISTING GROUND SURFACE : CONCRETE
PROPOSED SITE LEVEL : +10.4 mPD (ABOUT)
DEPTH OF FILLING : NOT MORE THAN 0.1
PURPOSE OF FILLING : SITE FORMATION OF STRUCTURE

PROPOSED FILLING AREA
OF THE APPLICATION SITE
(INDICATIVE ONLY)

EXISTING HARD-PAVED AREA
EXISTING SITE LEVEL : +10.3 mPD (ABOUT)
EXISTING GROUND SURFACE : CONCRETE
PURPOSE OF FILLING : CIRCULATION SPACE
NO FURTHER FILLING IS PROPOSED EXCEPT FOR AREA
PROPOSED FOR SITE FORMATION OF STRUCTURE

PROPOSED FILLING AREA
EXISTING SITE LEVEL : +10.3 mPD (ABOUT)
EXISTING GROUND SURFACE : CONCRETE
PROPOSED SITE LEVEL : +10.4 mPD (ABOUT)
DEPTH OF FILLING : NOT MORE THAN 0.1
PURPOSE OF FILLING : SITE FORMATION OF STRUCTURE

LEGEND
☐ APPLICATION SITE

THIS PLAN IS FOR ILLUSTRATION PURPOSE ONLY.

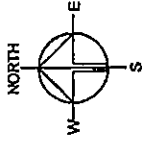

PLANNING CONSULTANT
R-Riches
 Property Consultants Ltd.

PROPOSED
 WAREHOUSE
 DANGEROUS GOODS (GOODS)
 FOR A PERIOD OF 3 YEARS AND
 ASSOCIATED FILLING OF LAND

SITE LOCATION
 LOTS 1222 SA (PART) AND 1224
 S.B. IN D.D. 107, FUNG KAT
 HEUNG, KAM TIN, YUEN LONG,
 NEW TERRITORIES

SCALE
 1:300 @ A1

DATE
 13.12.2023

CHECKED BY
 DATE

DRAWN BY
 DATE

DRAWN TITLE
 SWEEP PATH ANALYSIS

PLAN NO.
 001

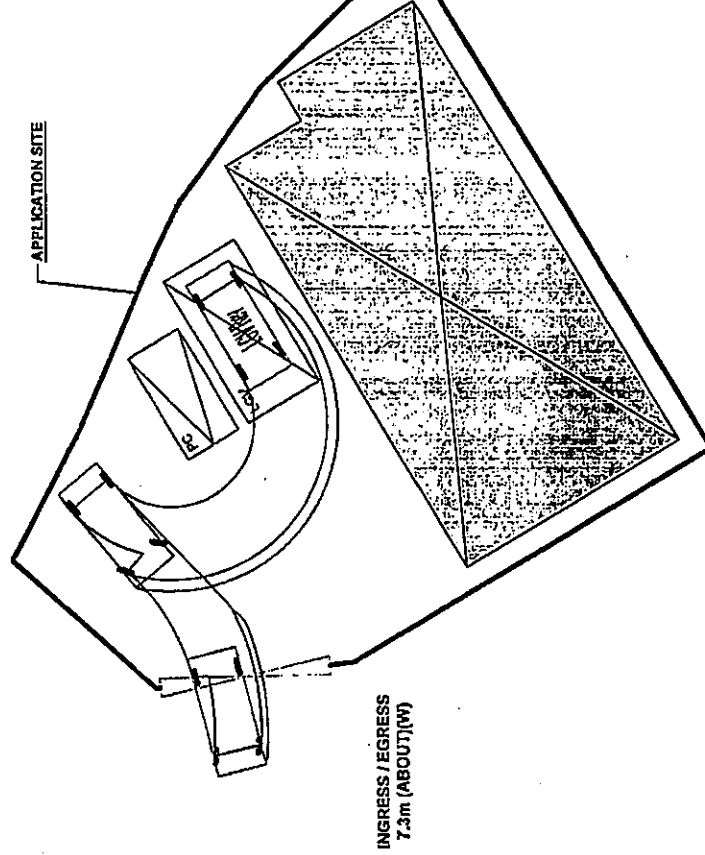

- LEGEND
- APPLICATION SITE
 - STRUCTURE
 - PARKING SPACE
 - LOADING / UNLOADING SPACE
 - INGRESS / EGRESS
 - LIGHT GOODS VEHICLE
 - SWEEP PATH OF VEHICLE

FROM THE APPLICATION SITE TO
 THE LOCAL ACCESS

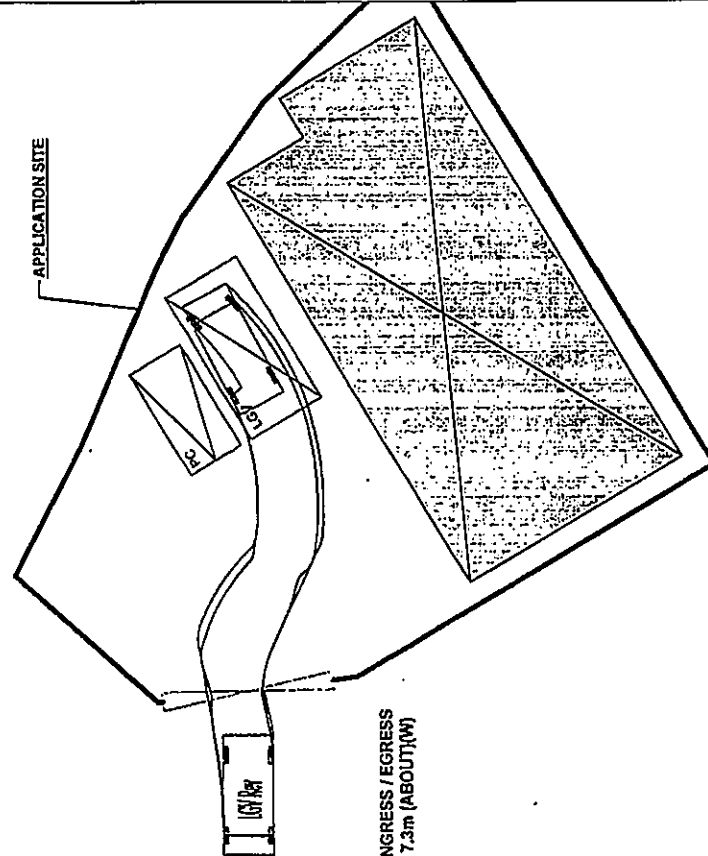

FROM THE LOCAL ACCESS TO
 THE APPLICATION SITE

THIS PLAN IS FOR ILLUSTRATION PURPOSE ONLY.

SWEEP PATH ANALYSIS
 TYPE OF VEHICLE : LIGHT GOODS VEHICLE
 DIMENSION OF VEHICLE : 2.1 m (W) X 5.2 m (L)
 SWEEP PATHS GENERATED BY AUTODESK VEHICLE TRACKING

Our Ref.: DD107 Lot 1222 S.A & 1224 S.B
Your Ref.: TPB/A/YL-KTN/904

The Secretary
Town Planning Board
15/F, North Point Government office
333 Java Road
North Point, Hong Kong

By Email

11 May 2023

Dear Sir,

1st Further Information

**Proposed Temporary Warehouse (excluding Dangerous Goods Godown) with Ancillary Facilities
for a Period of 3 Years and Filling of Land in "Agriculture" Zone, Lots 1222 S.A (Part)
and 1224 S.B in D.D. 107, Fung Kat Heung, Kam Tin, Yuen Long, New Territories**

(S.16 Planning Application No. A/YL-KTN/904)

We are writing to submit further information to address departmental comments of the subject application (**Appendix I**).

Should you require more information regarding the application, please contact our Mr. Orpheus LEE at _____ or the undersigned at your convenience. Thank you for your kind attention.

Yours faithfully,

For and on behalf of
R-riches Property Consultants Limited

Louis TSE
Town Planner

Responses-to-Comments

Proposed Temporary Warehouse (excluding Dangerous Goods Godown) with Ancillary Facilities for a Period of 3 Years and Filling of Land in "Agriculture" Zone, Lots 1222 S.A (Part) and 1224 S.B in D.D. 107, Fung Kat Heung, Kam Tin, Yuen Long, New Territories

(Application No. A/YL-KTN/904)

(i) A RtoC Table:

Departmental Comments		Applicant's Responses
1. Comments of Director of Agriculture, Fisheries and Conservation (DAFC) (Contact Person: Ms. Chelly WONG; Tel: 2150 6933)		
(a)	There is a watercourse located to the west of the subject site. The applicant shall clarify whether any measure will be implemented to avoid disturbance to the watercourse nearby.	The application site (the Site) is subject of a previously approved S.16 planning application (No. A/YL-KTN/814) for temporary animal boarding establishment, which was also submitted by the same applicant. The aforesaid development was approved by the Town Planning Board in early-2022. Since then, the applicant has erected fencing along the Site boundary to avoid the watercourse located to the west of the Site from reaching. The existing boundary fencing will be well-maintained by the applicant at any time during the planning approval period of the current application. Therefore, adverse impact to the existing watercourse should not be anticipated.

Previous s.16 Applications

Approved Applications

Application No.	Use / Development	Date of Consideration
A/YL-KTN/745	Proposed Temporary Place of Recreation, Sports or Culture (Hobby Farm) for a Period of 5 Years and Land Filling	5.2.2021 [revoked on 5.2.2022]
A/YL-KTN/814	Proposed Temporary Animal Boarding Establishment for a Period of 5 Years and Filling of Land	18.2.2022

Similar s.16 Applications in the vicinity of the Site within the same “AGR” Zone on the Kam Tin North OZP

Approved Applications

Application No.	Use / Development	Date of Consideration
A/YL-KTN/709	Renewal of Planning Approval for Temporary Warehouse for Musical Instruments, Posters, Documents and Ancillary Caretaker's Office for a Period of 3 Years	12.6.2020
A/YL-KTN/824	Proposed Temporary Warehouse (excluding Dangerous Goods Godown) for a Period of 3 Years and Filling of Land	6.5.2022
A/YL-KTN/852	Proposed Temporary Warehouse (excluding Dangerous Goods Godown) for a Period of 3 Years and Filling of Land	23.9.2022
A/YL-KTN/890	Proposed Temporary Warehouse (excluding Dangerous Goods Godown) for a Period of 3 Years and Filling of Land	31.3.2023

Government Departments' General Comments

1. Land Administration

Comments of the District Lands Officer/Yuen Long, Lands Department (DLO/YL, LandsD):

- the Site comprises Old Schedule Agricultural Lots held under the Block Government Lease which contains the restriction that no structures are allowed to be erected without the prior approval of the Government.

2. Traffic

Comments of the Commissioner for Transport (C for T):

- no comment on the application from traffic engineering perspective.

Comments of the Chief Highway Engineer/New Territories West, Highways Department (CHE/NTW, HyD):

- no objection to the application.

3. Drainage

Comments of the Chief Engineer/Mainland North, Drainage Services Department (CE/MN, DSD):

- no objection in-principle to the application from the public drainage point of view; and
- should the application be approved, approval conditions requiring (i) the submission of a drainage proposal to advise how the watercourse encroached by Lot 1222 S.A in D.D. 107 would be preserved and maintained, and demonstrate how the existing flow paths as well as the run-off falling onto and passing through the site could be intercepted and disposed of via proper discharge points; and (ii) the implementation and maintenance of the drainage proposal for the proposed development to the satisfaction the Director of Drainage Services or of the Town Planning Board should be included.

4. Fire Safety

Comments of the Director of Fire Services (D of FS):

- no objection in-principle to the application subject to fire service installations being provided to the satisfaction of his department.

5. Environment

Comments of the Director of Environmental Protection (DEP):

- no objection to the application; and

- there was no environmental complaint concerning the Site received in the past three years.

6. Landscape

Comments of the Chief Town Planner/Urban Design and Landscape, Planning Department (CTP/UD&L, PlanD):

- no objection to the application from the landscape planning perspective;
- the Site is located in a rural landscape character comprising of farmlands, vacant lands, temporary structures and scattered tree groups. The Site is hard paved without significant landscape resources. Significant adverse impact on the landscape character and landscape resources arising from the proposed use is not anticipated.

7. Building Matters

Comments of the Chief Building Surveyor/New Territories West, Buildings Department (CBS/NTW, BD):

- before any new building works (including containers / open sheds as temporary buildings, demolition and land filling) are to be carried out on the Site, prior approval and consent of the Building Authority should be obtained, otherwise they are unauthorised building works. An Authorised Person should be appointed as the co-ordinator for the proposed building works in accordance with the Buildings Ordinance (BO); and
- detailed checking under the BO will be carried out at building plan submission stage.

8. Food and Environmental Hygiene

Comments of the Director of Food and Environmental Hygiene (DFEH):

- no adverse comment on the application.

9. Electrical and Mechanical Matters

Comments of the Director of Electrical and Mechanical Services (DEMS):

- no objection to the application.

10. District Officer's Comments

Comments of the District Officer (Yuen Long), Home Affairs Department (DO(YL), HAD):

- his office has not received any locals' comment on the application and he has no comment on the application.

11. Other Departments

The following government departments have no objection to / no adverse comment / no comment on the application:

- Project Manager (West), Civil Engineering and Development Department (PM(W), CEDD);
- Chief Engineer/Construction, Water Supplies Department (CE/C, WSD); and
- Commissioner of Police (C of P).

Recommended Advisory Clauses

- (a) prior planning permission should have been obtained before commencing the proposed use at the application site (the Site);
- (b) the permission is given to the proposed development under application. It does not condone any other development currently exists on the Site which are not covered by the application. Immediate action should be taken to discontinue such development not covered by the permission;
- (c) to note the comments of the District Lands Officer/Yuen Long, Lands Department (DLO/YL, LandsD) that:
 - should the application be approved, the lot owner(s) will need to apply to his office to permit the structures to be erected or regularize any irregularities on site, if any. Besides, given the proposed use is temporary in nature, only application for regularization or erection of temporary structure(s) will be considered. Applications for any of the above will be considered by LandsD acting in the capacity as the landlord or lessor at its sole discretion and there is no guarantee that such application(s) will be approved. If such application(s) is approved, it will be subject to such terms and conditions, including among others the payment of rent or fee, as may be imposed by LandsD;
- (d) to note the comments of the Commissioner for Transport (C for T) that:
 - the Site is connected to the public road network via a section of a local access road which is not managed by Transport Department. The land status of the local access road should be checked with LandsD. Moreover, the management and maintenance responsibilities of the local access road should be clarified with the relevant lands and maintenance authorities accordingly. No vehicle is allowed to queue back to or reverse onto / from public road at any time during the planning approval period;
- (e) to note the comments of the Chief Highway Engineer/New Territories West, Highways Department (CHE/NTW, HyD) that:
 - Mei Fung Road and Fung Kat Heung Road are not maintained by HyD;
 - his department shall not be responsible for the maintenance of any access connecting the Site and San Tam Road; and
 - adequate drainage measures should be provided to prevent surface water running from the Site to nearby public road and drains;
- (f) to note the comments of the Director of Environmental Protection (DEP) that:
 - the applicant is advised to follow the relevant mitigation measures and requirements in the latest "Code of Practice on Handling the Environmental Aspects of Open Storage and Temporary Uses" issued by the DEP; and
 - public sewer connection is the most desirable engineering solution. If this option is limited by other site constraints, the applicant should consider other sewage disposal

infrastructure / facilities for proper collection, treatment and disposal of waste / wastewater generated from the proposed use, such as septic tank, portable toilet etc. The applicant is reminded to provide adequate supporting infrastructure / facilities for proper collection, treatment and disposal of waste / wastewater generated from the proposed use. If septic tank and soakaway system will be used, its design and construction shall follow the requirements of EPD's Practice Note for Professional Person (ProPECC) PN 5/93 "Drainage Plans subject to Comment by the Environmental Protection Department" including completion of percolation test and certification by Authorized Person;

- (g) to note the comments of the Director of Food and Environmental Hygiene (DFEH) that:
 - proper licence / permit issued by his department is required if there is any catering service / activities regulated by the DFEH under the Public Health and Municipal Services Ordinance (Cap. 132) and other relevant legislation for the public; and
 - for any waste generated from such activity / operation, the applicant should arrange disposal properly at their own expenses. The work and operation shall not cause any environmental nuisance, pest infestation and obstruction to the surrounding;
- (h) to note the comments of the Director of Fire Services (D of FS) that:
 - in consideration of the design/nature of the application, fire service installations (FSIs) are anticipated to be required. Therefore, the applicant is advised to submit relevant layout plans incorporated with the proposed FSIs to his department for approval. In addition, the applicant should also be advised on the following:
 - (i) the layout plans should be drawn to scale and depicted with dimensions and nature of occupancy; and
 - (ii) the location of where the proposed FSIs to be installed should be clearly marked on the layout plans; and
 - the applicant is reminded that if the proposed structure(s) are required to comply with the Buildings Ordinance (Cap. 123), detailed fire service requirements will be formulated upon receipt of formal submission of general building plans;
- (i) to note the comments of the Director of Electrical and Mechanical Services (DEMS) that:
 - in the interests of public safety and ensuring the continuity of electricity supply, the parties concerned with planning, designing, organizing and supervising any activity near the underground cable or overhead line under the mentioned works should approach the electricity supplier (i.e. CLP) for the requisition of cable plans (and overhead line alignment drawings, where applicable) to find out whether there is any underground cable and/or overhead line within and/or in the vicinity of the concerned site. The applicant is reminded to observe the Electricity Supply Lines (Protection) Regulation and the "Code of Practice on Working near Electricity Supply Lines" established under the Regulation when carrying out works in the vicinity of the electricity supply lines; and
- (j) to note the comments of the Chief Building Surveyor/New Territories West, Buildings Department (CBS/NTW, BD) that:

- the Site shall be provided with means of obtaining access thereto from a street and emergency vehicular access in accordance with Regulations 5 and 41D of the Building (Planning) Regulations (B(P)R) respectively;
- the Site does not abut on a specified street of not less than 4.5m wide and its permitted development intensity shall be determined under Regulation 19(3) of the B(P)R at building plan submission stage;
- before any new building works (including containers / open sheds as temporary buildings, demolition and land filling, etc.) are to be carried out on application site, prior approval and consent of the Building Authority should be obtained, otherwise they are unauthorized building works (UBW) under the Buildings Ordinance (BO). An Authorized Person should be appointed as the co-ordinator for the proposed building works in accordance with the BO;
- for UBW erected on leased land, enforcement action may be taken by the BD to effect their removal in accordance with the prevailing enforcement policy against UBW as and when necessary. The granting of any planning approval should not be construed as an acceptance of any existing building works or UBW on the application site under the BO;
- any temporary shelters or converted containers for office, storage, washroom or other uses are considered as temporary buildings are subject to the control of Part VII of the B(P)R; and
- detailed checking under the BO will be carried out at building plan submission stage.

☐ Urgent ☐ Return Receipt Requested ☐ Sign ☐ Encrypt ☐ Mark Subject Restricted ☐ Expand personal&publi



A/YL-KTN/904 DD 107 Fung Kat Hung
30/04/2023 03:26

From: [REDACTED]
To: tpbpd <tpbpd@pland.gov.hk>
File Ref:

Dear TPB Members,

So now we go full cycle, the road to brownfield, Hobby Farm, conditions not fulfilled, so then its Animal Boarding, again, surprise, surprise, conditions not fulfilled.

But plenty of time to trash the land and fill in.

So finally having exhausted the easy options that PlanD invariably supports and members endorse without asking any questions, we have the true intention, a warehouse and 2 vehicle parking.

Are you now going to reward the applicant despite the fact that there is no previous approval for storage and there is no justification in allowing it on 'AG' zone as the application does not comply with the Town Planning Board (TPB) Guidelines for Application for Open Storage and Port Back-up Uses under Section 16 of the Town Planning Ordinance (TPB PG-No.13E)

Mary Mulvihill

From: [REDACTED]
To: tpbpd <tpbpd@pland.gov.hk>
Date: Sunday, 23 January 2022 3:24 AM CST
Subject: Re: A/YL-KTN/771 DD 107 Fung Kat Hung

A/YL-KTN/814

Lots 1222 S.A (Part) and 1224 S.B in D.D.107, Fung Kat Heung, Kam Tin

Site area : About 516sq.m

Zoning : "Agriculture"

Applied use : Animal Boarding Establishment / 5 Years / **Filling of Land** / 3 Vehicle Parking

Dear TPB Members,

Another part of the jig-saw puzzle. Members **without asking any questions** approved

769 –and 771 : There were also 28 similar applications for temporary animal boarding establishment on 19 sites and four similar applications involving filling of land within the same “AGR” zone

This is despite all the reports about abuse of animals, puppy mills, and now we have Covid infections at caged animal facilities.

I heard how the members of the Appeal Board make site visits to check out the actual conditions.

It is high time that TPB members from time to time make random inspections of areas with a lot of suspect activities to ensure that they are not responsible for encouraging unacceptable operations.

Note that the previous approvals have not yet complied with conditions.

Mary Mulvihill

From: [REDACTED]
To: tpbpd <tpbpd@pland.gov.hk>
Date: Friday, 18 June 2021 3:48 AM CST
Subject: A/YL-KTN/771 DD 107 Fung Kat Hung

A/YL-KTN/771
Lots 1226 S.C, 1227 S.B, 1227 S.C and 1230 S.A in D.D.107, Fung Kat Heung, Kam Tin
Site area : About 1,270sq.m
Zoning : "Agriculture"
Applied use : Animal Boarding Establishment / 5 Years / **Filling of Land** / 4 Vehicle Parking

Dear TPB Members,

This is death by a thousand slices approach. Get approval for a Hobby Farm and then split the site into smaller sections. Each one diminishes the amount of arable land and increases the quota of filled land and area devoted to parking etc that is also rendered unsuitable for cultivation. 771 must be considered in tandem with 769

I would remind members that there was a long discussion on Destroy to Build during the consideration of Application 745.

https://www.info.gov.hk/tpb/en/meetings/RNTPC/Minutes/m665rnt_e.pdf
Ms Ivy C.W. Wong, STP/FSYLE, said that the application site was subject to an on-going planning enforcement action against an unauthorised

*development (UD) involving filling of land. Enforcement Notice (EN) was issued on 9.4.2020 requiring discontinuation of the UD and Reinstatement Notice (RN) was also issued on 21.4.2020 requiring **removal of leftovers, debris and filled materials and grassing the land.***

It was quite disturbing to read that strong suspicions of Destroy to Build activities were not deemed to be relevant to the factors to be considered by the members.

However you can question if ABE is suitable for the site and in view of the many applications for such in the area that there is already a more than adequate supply of such facilities.

Agricultural land is a valuable and essential commodity. Hong Kong is required to comply with the policies of the mainland government. President Xi has been quite clear on this point, it is essential that China become less dependent on importing food and good land must be ring fenced for the purpose of feeding the nation.

Mary Mulvihill

From: [REDACTED]
To: "tpbpd" <tpbpd@pland.gov.hk>
Sent: Thursday, June 10, 2021 3:33:39 AM
Subject: A/YL-KTN/769 DD 107 Fung Kat Hung

A/YL-KTN/769

Lots 1225 S.C, 1226 S.E and 1230 S.B in D.D.107, Fung Kat Heung, Kam Tin

Site area : About 565sq.m

Zoning : "Agriculture"

Applied use : Animal Boarding Establishment / 5 Years / **Filling of Land** / 3 Vehicle Parking

Dear TPB Members,

Strongly object. This is the southern section of the lots approved for Hobby Farm on 5 Feb despite a lengthy discussion re enforcement and Destroy to Build.

The Site is currently subject to an on-going planning enforcement action

against an unauthorised development (UD) involving filling of land. Enforcement Notice was issued on 9.4.2020 requiring discontinuation of the UD. Reinstatement Notice was issued on 21.4.2020 requiring removal of leftovers, debris and filled materials and to grass the land.

This plan would reduce the area that was, supposedly, to be devoted to agriculture.

There are numerous ABEs in the district. There is no information provided with regard to the number of animals, disposal of waste, drainage, and the applicants track record in providing this service.

Is it animal boarding or animal breeding? The number of applications for animal boarding going through the system is disproportionate to the market for such facilities.

There are many media reports on animal cruelty and puppy farms. Members must ask questions.

Mary Mulvihill

From: [REDACTED]
To: "tpbpd" <tpbpd@pland.gov.hk>
Sent: Friday, January 8, 2021 4:13:58 AM
Subject: A/YL-KTN/745 DD 107 Kam Tin near Armed Forces
A/YL-KTN/745
Various Lots in D.D. 107, Kam Tin
Site area : About 3,221sq.m
Zoning : "Agriculture"
Applied use : Hobby Farm / 5 Years / Land Filling / 9 Vehicle Parking

Dear TPB Members,

Another Hobby Farm, they are already dozens in the district.

Filling of land 740sq.m, is this Destroy to Build to turn the land into Open Storage in line with the adjacent lots to the right?

President Xi, who has a lot more access to data than lesser mortals, clearly believes that there will be shortfalls in food production in China in coming years. Apart from environmental degradation climate change is having an impact re flooding, crop failures, etc. This winter is the coldest for 50 years in some regions in the north and this will certainly destroy or delay production..

But here in Hong Kong we live in a bubble. Agriculture land is not for producing food but for storing construction waste and, when used for crops,

is for selfie friendly plots for weekend farmers.

Once again the mindset here is way behind the curve. A large site of arable land should be used for serious food production not as a playground.

In line with most government departments, Ag and Fish appears to be in ignorance of the policy guidelines laid down by the Central Government. It should be pursuing a programme to address the issue that a certain amount of local agricultural production is a necessity. Lay members of the Board have a duty to question government depts with regards to issues where officials are not moving with the times.

Mary Mulvihill

☐ Urgent ☐ Return Receipt Requested ☐ Sign ☐ Encrypt ☐ Mark Subject Restricted ☐ Expand personal&publi



KFBG's comments on five planning applications

02/05/2023 12:04

From: EAP KFBG <eap@kfbg.org>
 To: "tpbpd@pland.gov.hk" <tpbpd@pland.gov.hk>
 File Ref:

5 attachments



230502 s16 TKL 723.pdf 230502 s17 NSW 293.pdf 230502 s12a TM 24.pdf 230502 s16 TT 583.pdf



230502 s16 KTN 904.pdf

Dear Sir/ Madam,

Attached please see our comments regarding five applications. There are five pdf files attached to this email. If you cannot see/ download/ open these files, please notify us through email.

Thank You and Best Regards,

Ecological Advisory Programme
 Kadoorie Farm and Botanic Garden

Email Disclaimer:

The information contained in this e-mail (including any attachments) is confidential and is intended solely for the addressee. If you are not the intended recipient, please notify the sender immediately and delete this e-mail from your system. Any unauthorised use, disclosure, copying, printing, forwarding or dissemination of any part of this information is prohibited. KFBG does not accept responsibility and shall not be liable for the content of any e-mail transmitted by its staff for any reason other than bona fide official purposes. There is no warranty that this e-mail is error or virus free. You should not rely on any information that is not transmitted via secure technology.



嘉道理農場暨植物園公司
Kadoorie Farm & Botanic Garden Corporation

The Secretary,
Town Planning Board,
15/F, North Point Government Offices,
333, Java Road, North Point,
Hong Kong.
(Email: tpbpd@pland.gov.hk)

2nd May 2023.

By email only

Dear Sir/ Madam,

**Proposed Temporary Warehouse (excluding Dangerous Goods Godown) with
Ancillary Facilities for a Period of 3 Years and Filling of Land
(A/YL-KTN/904)**

1. We refer to the captioned.
2. We object to this application as the proposed use is not in line with the planning intention of Agriculture (AGR) zone. We also urge the Board to consider the potential cumulative impact of approving this application as the approval would set a precedent for similar cases in this AGR zone.
3. Thank you for your attention.

Ecological Advisory Programme
Kadoorie Farm and Botanic Garden

