

DEVELOPMENT PARAMETERS

APPLICATION SITE AREA	: 179 m ²	(ABOUT)
COVERED AREA	: 73 m ²	(ABOUT)
UNCOVERED AREA	: 106 m ²	(ABOUT)
PLOT RATIO	: 0.68	(ABOUT)
SITE COVERAGE	: 41 %	(ABOUT)
NO. OF STRUCTURE	: 1	
DOMESTIC GFA	: NOT APPLICABLE	
NON-DOMESTIC GFA	: 121 m ²	(ABOUT)
TOTAL GFA	: 121 m ²	(ABOUT)
BUILDING HEIGHT	: 5.5 m	(ABOUT)
NO. OF STOREY	: 2	

STRUCTURE	USE	COVERED AREA	GFA	BUILDING HEIGHT
B1	G/F 1/F	WAREHOUSE (EXCLUDING D.G.G.) ANCILLARY OFFICE & RAIN SHELTER	73 m ² (ABOUT) 48 m ² (ABOUT) 73 m ² (ABOUT)	5.5 m (ABOUT)(2-STOREY)
TOTAL		73 m ² (ABOUT)	121 m ² (ABOUT)	

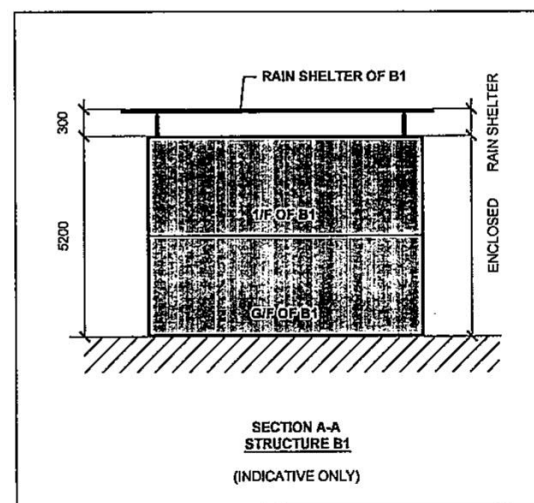
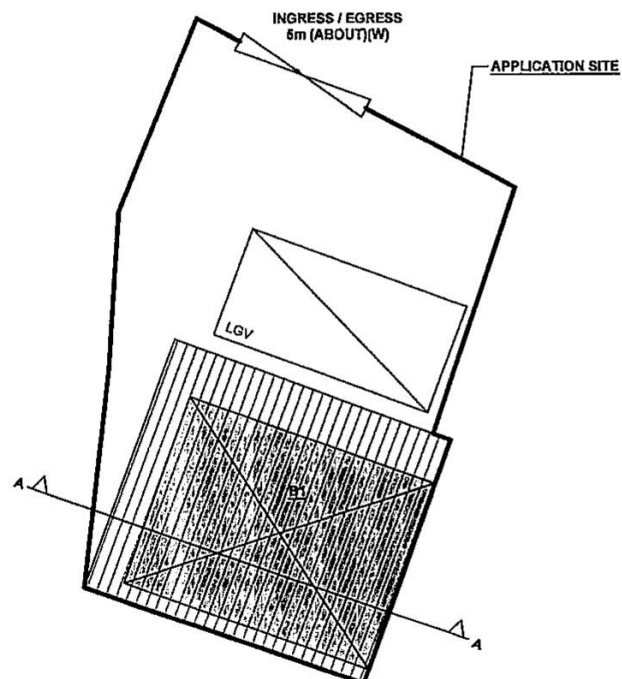
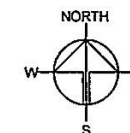

LEGEND	
	APPLICATION SITE
	STRUCTURE (ENCLOSED)
	STRUCTURE (RAIN SHELTER)
	LOADING / UNLOADING SPACE
	INGRESS / EGRESS

LOADING/UNLOADING PROVISION

NO. OF LIGHT GOODS VEHICLE PARKING SPACE	: 1
DIMENSION OF LOADING/UNLOADING SPACE	: 7 m (L) X 3.5 m (W)

PLANNING CONSULTANT



PROJECT

PROPOSED TEMPORARY
WAREHOUSE (EXCLUDING
DANGEROUS GOODS GODOWN)
WITH ANCILLARY FACILITIES
FOR A PERIOD OF 3 YEARS AND
ASSOCIATED FILLING OF LAND

SITE LOCATION

LOT 748 (PART) IN D.D. 107,
FUNG KAT HEUNG, KAM TIN,
YUEN LONG, NEW TERRITORIES

SCALE

1:200 @ A4

DRAWN BY	DATE
MN	21.3.2023
CHECKED BY	DATE
APPROVED BY	DATE

DWG. TITLE
LAYOUT PLAN

DWG. NO.	YER.
PLAN 4	001

(摘錄自申請人於 11.4.2023 呈交的申請書)
(Extract from Applicant's
Submission of 11.4.2023)

參考編號
REFERENCE No.
A/YL-KTN/907

繪圖
DRAWING
A - 1

APPLICATION SITE AREA	: 179 m ²	(ABOUT)
EXISTING HARD-PAVED AREA	: 179 m ²	(ABOUT)
EXISTING SITE LEVELS	: + 14.1 mPD TO +14.2 mPD	(ABOUT)

EXISTING HARD-PAVED AREA	
EXISTING SITE LEVEL	: +14.1 mPD (ABOUT)
EXISTING GROUND SURFACE	: CONCRETE
PURPOSED OF FILLING	: CIRCULATION SPACE

EXISTING HARD-PAVED AREA	
EXISTING SITE LEVEL	: +14.2 mPD (ABOUT)
EXISTING GROUND SURFACE	: CONCRETE
PURPOSE OF FILLING	: SITE FORMATION OF STRUCTURE

LEGEND

 APPLICATION SITE

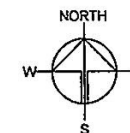

PLANNING CONSULTANT



PROJECT

PROPOSED WAREHOUSE WITH DANGEROUS GOODS GODOWN AND ASSOCIATED FILLING OF LAND

SITE LOCATION

LOT 748 (PART) IN D.D. 107,
FUNG KAT HEUNG, KAM TIN,
YUEN LONG, NEW TERRITORIES

SCALE

~~1-200-01A4~~

DRAWN BY	DATE
MN	15.3.2023

1975	10/22/2020
CHECKED BY	DATE

APPROVED BY	DATE
-------------	------

DWG. TITLE
FILLING OF LAND AREA

DWG NO.	VE
PLAN 5	D

(摘錄自申請人於 11.4.2023 呈交的申請書)
(Extract from Applicant's
Submission of 11.4.2023)

參考編號
REFERENCE No.
A/YL-KTN/907

繪圖
DRAWING
A - 2

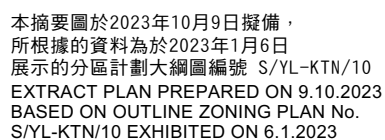

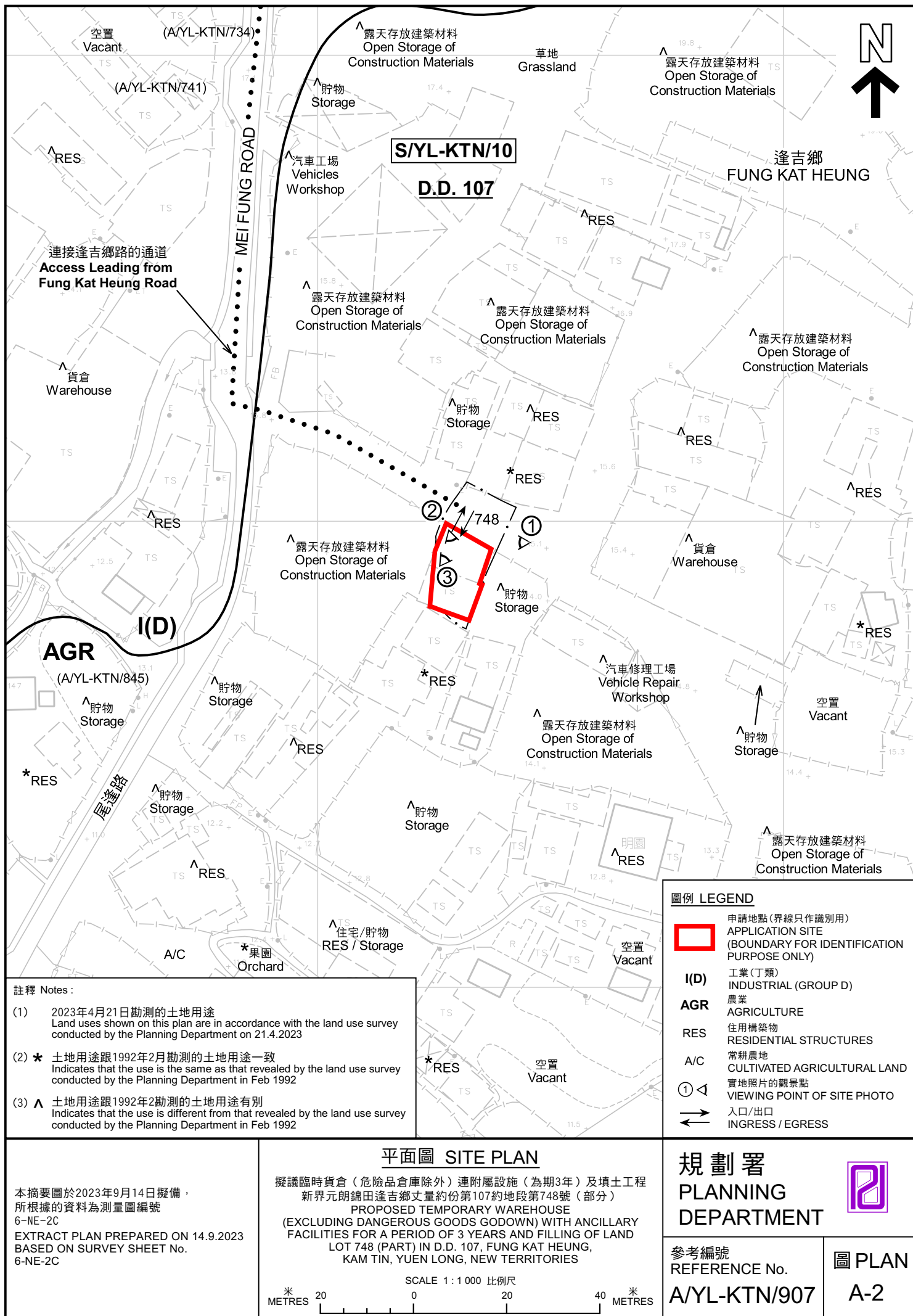

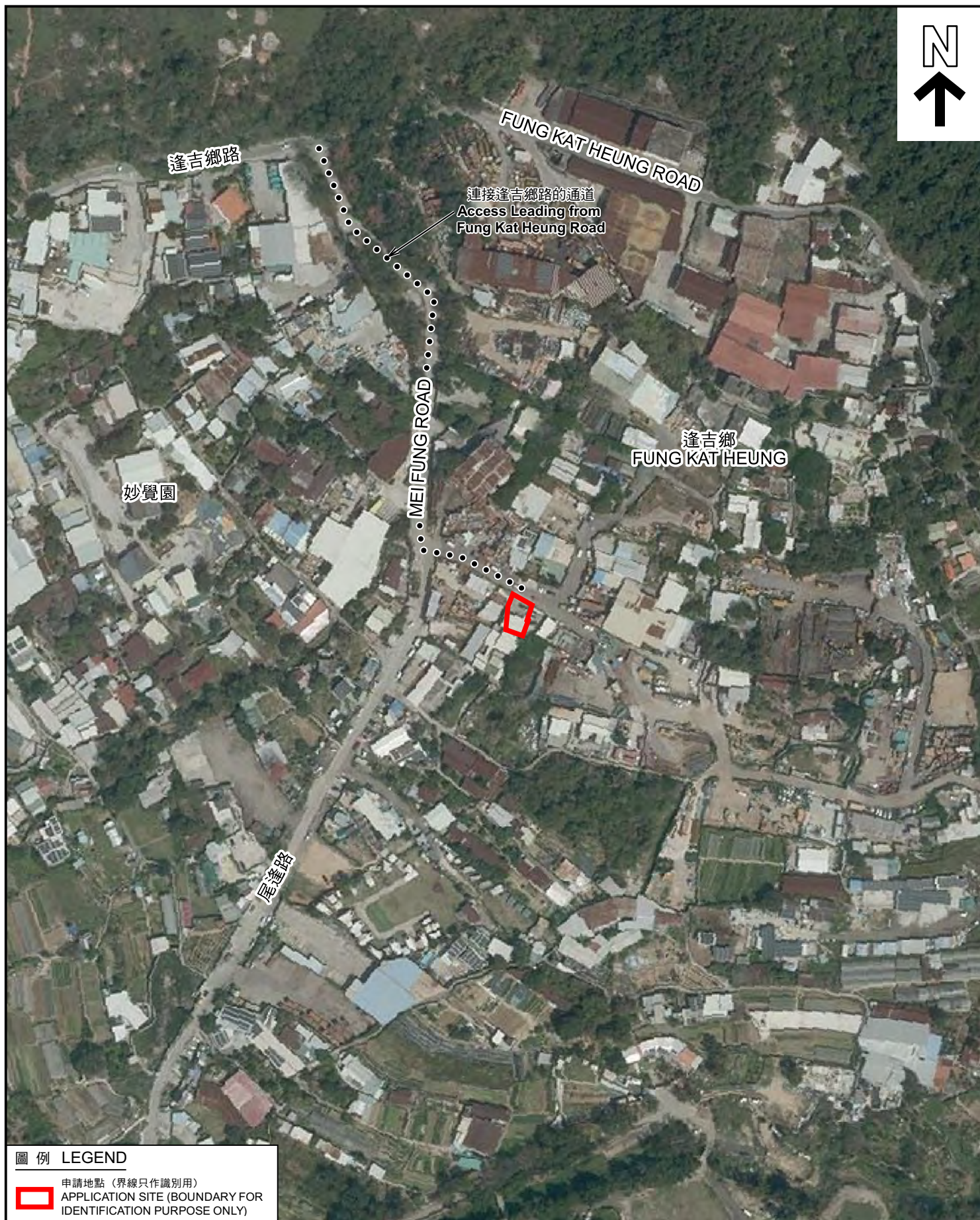

圖例 LEGEND



申請地點 (界線只作識別用)
APPLICATION SITE (BOUNDARY FOR
IDENTIFICATION PURPOSE ONLY)

本摘要圖於2023年9月14日擬備，
所根據的資料為地政總署於2022年3月10日
拍得的航攝照片編號 E154942C
EXTRACT PLAN PREPARED ON 14.9.2023
BASED ON AERIAL PHOTO No.
E154942C TAKEN ON 10.3.2022
BY LANDS DEPARTMENT

航攝照片 AERIAL PHOTO

擬議臨時貨倉 (危險品倉庫除外) 連附屬設施 (為期3年) 及填土工程
新界元朗錦田逢吉鄉丈量約份第107約地段第748號 (部分)
PROPOSED TEMPORARY WAREHOUSE
(EXCLUDING DANGEROUS GOODS GODOWN) WITH ANCILLARY
FACILITIES FOR A PERIOD OF 3 YEARS AND FILLING OF LAND
LOT 748 (PART) IN D.D. 107, FUNG KAT HEUNG,
KAM TIN, YUEN LONG, NEW TERRITORIES

規劃署
PLANNING
DEPARTMENT



參考編號
REFERENCE No.
A/YL-KTN/907

圖 PLAN
A-3



申請地點界線只作識別用 APPLICATION SITE BOUNDARY FOR IDENTIFICATION PURPOSE ONLY

實地照片 SITE PHOTOS

本圖於2023年9月14日擬備，所根據的資料為攝於2023年4月21日的實地照片
PLAN PREPARED ON 14.9.2023
BASED ON SITE PHOTOS
TAKEN ON 21.4.2023

擬議臨時貨倉（危險品倉庫除外）連附屬設施（為期3年）及填土工程
新界元朗錦田達吉鄉丈量約份第107約地段第748號（部分）
PROPOSED TEMPORARY WAREHOUSE
(EXCLUDING DANGEROUS GOODS GODOWN) WITH ANCILLARY
FACILITIES FOR A PERIOD OF 3 YEARS AND FILLING OF LAND
LOT 748 (PART) IN D.D. 107, FUNG KAT HEUNG,
KAM TIN, YUEN LONG, NEW TERRITORIES

規劃署
PLANNING
DEPARTMENT



參考編號
REFERENCE No.
A/YL-KTN/907

圖 PLAN
A-4