

N



Structure 1

Shop & services
(Real estate agency) & toilet
GFA: Not exceeding 100m²
Height: Not exceeding 4.5m
No. of storey: 1

Structure 2

Shop & services
(Conference room for
real estate agency) & toilet
GFA: Not exceeding 100m²
Height: Not exceeding 4.5m
No. of storey: 1

Toilet
(About 5m²
each)

6m wide
Ingress/Egress

Structure 3

Electricity meter room
GFA: Not exceeding 5m²
Height: Not exceeding 3m
No. of storey: 1

4 parking spaces of
5m x 2.5m for
private car

Project 項目名稱:

Proposed Temporary Shop and
Services (Real Estate Agency) for a
Period of 3 Years at Lot 291 (Part) in
D.D. 109, Kam Sheung Road, Kam
Tin, Yuen Long, N.T.

Drawing Title 圖目:

Proposed Layout Plan

Remarks 備註:

Drawing No. 圖號:

Figure 3

Scale 比例:

—1:1000—

(摘錄自申請人於 2.3.2021 呈交的申請書)
(Extract from Applicant's
Submission of 2.3.2021)

參考編號

REFERENCE No.

A/YL-KTS/884

繪圖 DRAWING

A-1

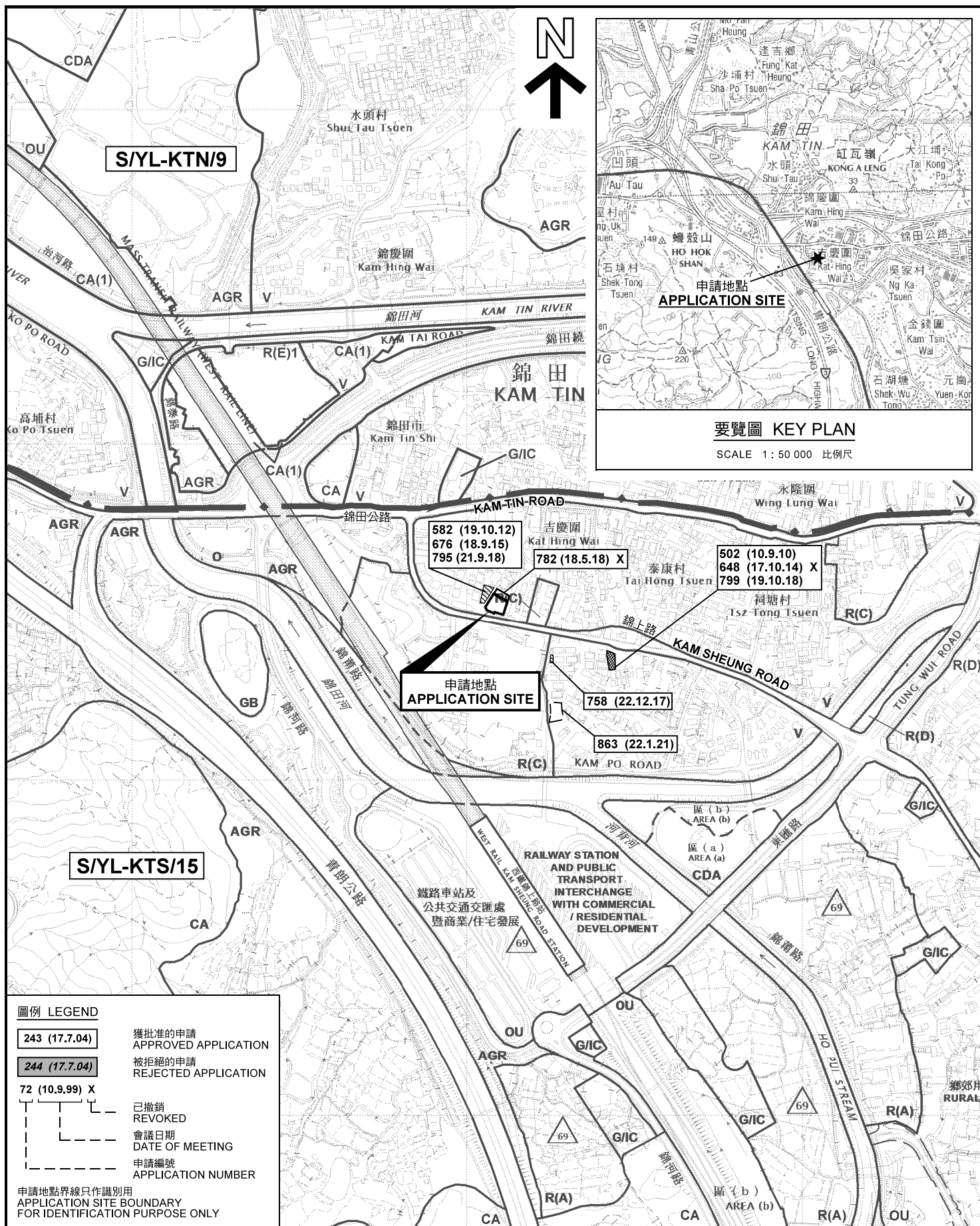

本摘要圖於2021年3月29日擬備，
所根據的資料為於2018年12月11日
核准的分區計劃大綱圖編號 S/YL-KTS/15
EXTRACT PLAN PREPARED ON 29.3.2021
BASED ON OUTLINE ZONING PLAN No.
S/YL-KTS/15 APPROVED ON 11.12.2018

位置圖及同類申請 LOCATION PLAN WITH SIMILAR APPLICATIONS

擬設臨時商店及服務行業(地產代理) (為期3年)
元朗錦田錦上路丈量約份第109約地段第291號 (部分)
PROPOSED TEMPORARY SHOP AND SERVICES
(REAL ESTATE AGENCY) FOR A PERIOD OF 3 YEARS
LOT 291 (PART) IN D.D. 109, KAM SHEUNG ROAD,
KAM TIN, YUEN LONG

SCALE 1 : 7 500 比例尺

米 100 0 100 200 300 米
METRES METRES

規劃署
PLANNING
DEPARTMENT



參考編號
REFERENCE No.
A/YL-KTS/884

PLAN
A-1a

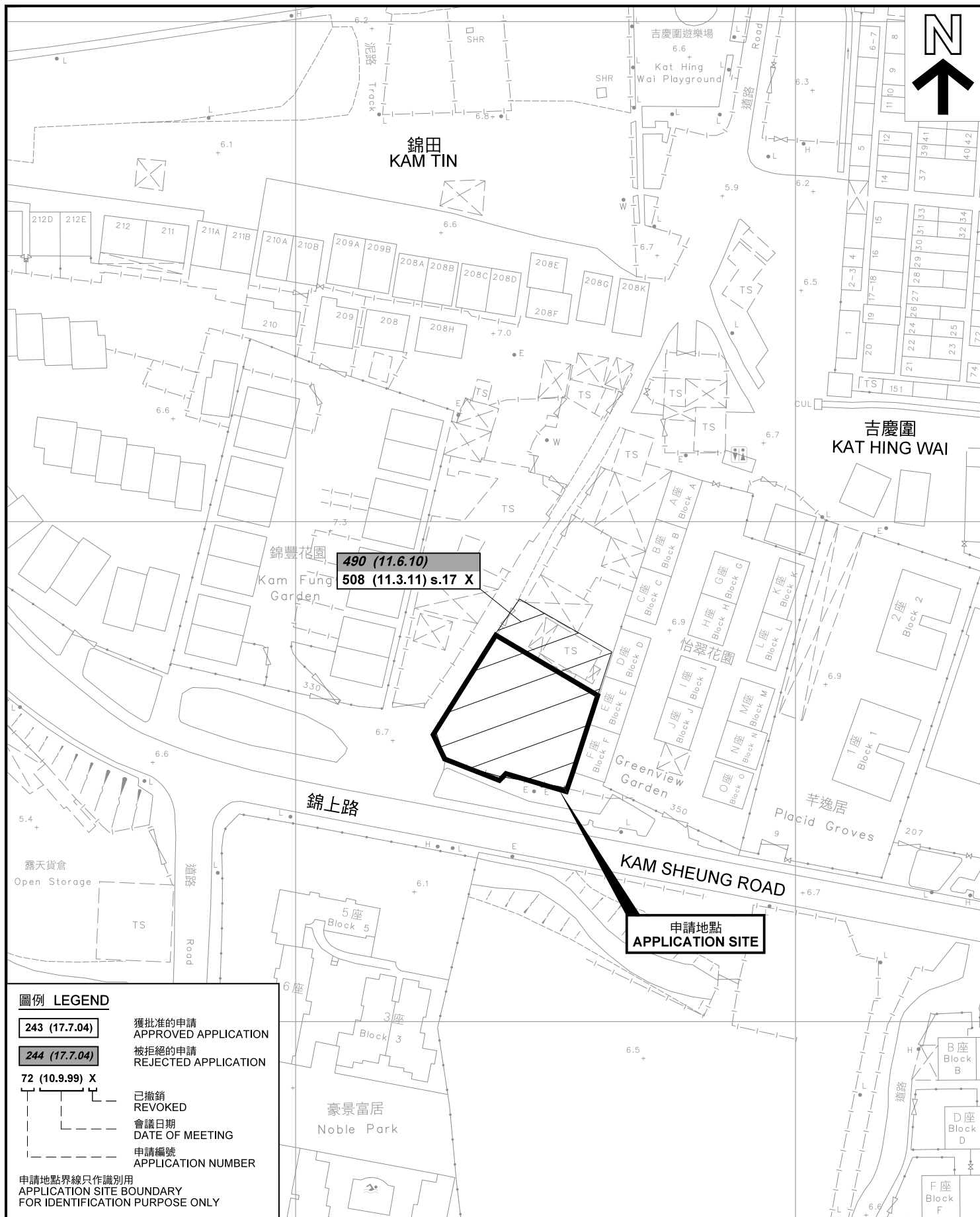

先前申請圖 PREVIOUS APPLICATION PLAN

擬議臨時商店及服務行業(地產代理)(為期3年)
元朗錦田錦上路丈量約份第109約地段第291號(部分)
PROPOSED TEMPORARY SHOP AND SERVICES
(REAL ESTATE AGENCY) FOR A PERIOD OF 3 YEARS
LOT 291 (PART) IN D.D. 109, KAM SHEUNG ROAD,
KAM TIN, YUEN LONG

SCALE 1:1 000 比例尺
米 20 0 20 40 米
METRES

規劃署
PLANNING
DEPARTMENT



參考編號
REFERENCE No.
AYL-KTS/884

圖 PLAN
A-1b

本摘要圖於2021年4月22日擬備，所根據的資料為測量圖編號 6-NE-12A
EXTRACT PLAN PREPARED ON 22.4.2021
BASED ON SURVEY SHEET No.
6-NE-12A

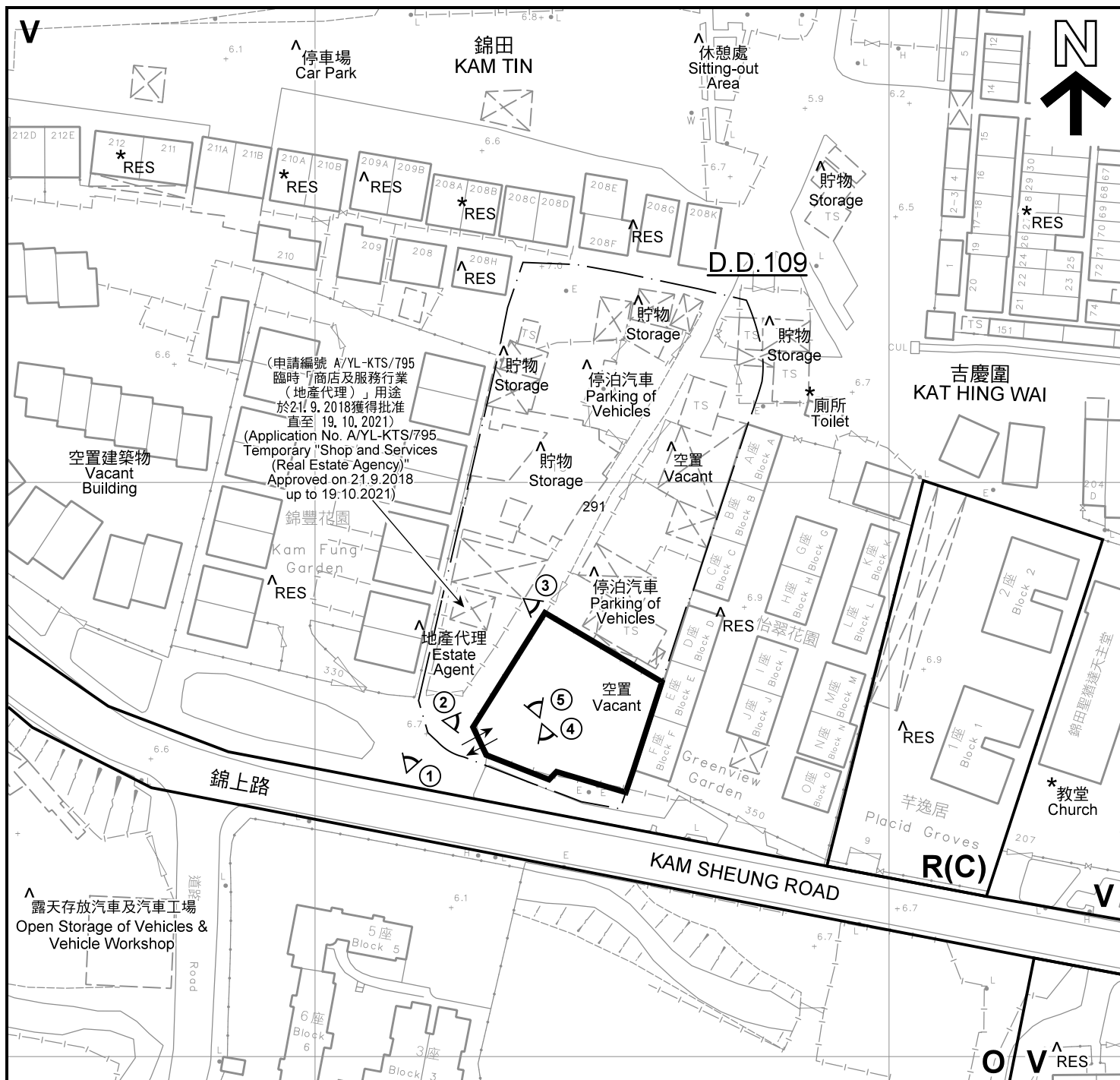

註釋 Notes:

- (1) 2021年3月9日勘測的土地用途
Land uses shown on this plan are in accordance with the land use survey conducted by the Planning Department on 9.3.2021
- (2) * 土地用途跟1991年10月勘測的土地用途一致
Indicates that the use is the same as that revealed by the land use survey conducted by the Planning Department in Oct 1991
- (3) ^ 土地用途跟1991年10月勘測的土地用途有別
Indicates that the use is different from that revealed by the land use survey conducted by the Planning Department in Oct 1991

平面圖 SITE PLAN

擬議臨時商店及服務行業(地產代理)(為期3年)
元朗錦田錦上路丈量約份第109約地段第291號(部分)
PROPOSED TEMPORARY SHOP AND SERVICES
(REAL ESTATE AGENCY) FOR A PERIOD OF 3 YEARS
LOT 291 (PART) IN D.D. 109, KAM SHEUNG ROAD,
KAM TIN, YUEN LONG

本摘要圖於2021年3月29日擬備, 所根據的
資料為測量圖編號 6-NE-12A
EXTRACT PLAN PREPARED ON 29.3.2021
BASED ON SURVEY SHEET No.
6-NE-12A

SCALE 1 : 1 000 比例尺
米 METRES 20 0 20 40 米 METRES

圖例 LEGEND

- 申請地點(界線只作識別用)
APPLICATION SITE
(BOUNDARY FOR IDENTIFICATION
PURPOSE ONLY)
- R(C) 住宅(丙類)
RESIDENTIAL (GROUP C)
- V 鄉村式發展
VILLAGE TYPE DEVELOPMENT
- O 休憩用地
OPEN SPACE
- RES 住用構築物
RESIDENTIAL STRUCTURES
- ① 實地照片的觀景點
VIEWING POINT OF SITE PHOTO
- 入口/出口
INGRESS / EGRESS

規劃署
PLANNING
DEPARTMENT



參考編號
REFERENCE No.
A/YL-KTS/884

圖 PLAN
A-2



圖例 LEGEND



申請地點(界線只作識別用)
APPLICATION SITE
(BOUNDARY FOR IDENTIFICATION
PURPOSE ONLY)

本摘要圖於2021年3月31日擬備，所根據的資料為地政總署於2020年2月18日拍得的航攝照片編號 E089237C
EXTRACT PLAN PREPARED ON 31.3.2021
BASED ON AERIAL PHOTO No.
E089237C TAKEN ON 18.2.2020
BY LANDS DEPARTMENT

航攝照片 AERIAL PHOTO

擬議臨時商店及服務行業(地產代理) (為期3年)
元朗錦田錦上路丈量約份第109約地段第291號(部分)
PROPOSED TEMPORARY SHOP AND SERVICES
(REAL ESTATE AGENCY) FOR A PERIOD OF 3 YEARS
LOT 291 (PART) IN D.D. 109, KAM SHEUNG ROAD,
KAM TIN, YUEN LONG

規劃署
PLANNING
DEPARTMENT



參考編號
REFERENCE No.
AYL-KTS/884

圖 PLAN
A-3

1



2



3



4



5



申請地點界線只作識別用 APPLICATION SITE BOUNDARY FOR IDENTIFICATION PURPOSE ONLY

實地照片 SITE PHOTOS

擬議臨時商店及服務行業(地產代理)(為期3年)
元朗錦田錦上路丈量約份第109約地段第291號(部分)
PROPOSED TEMPORARY SHOP AND SERVICES
(REAL ESTATE AGENCY) FOR A PERIOD OF 3 YEARS
LOT 291 (PART) IN D.D. 109, KAM SHEUNG ROAD,
KAM TIN, YUEN LONG

規劃署
PLANNING
DEPARTMENT



參考編號
REFERENCE No.
AYL-KTS/884

圖 PLAN
A-4

本圖於2021年4月7日擬備，所根據的資料為攝於2021年3月9日的實地照片
PLAN PREPARED ON 7.4.2021
BASED ON SITE PHOTOS
TAKEN ON 9.3.2021