



# DEVELOPMENT PARAMETERS

APPLICAITON SITE AREA: 46m<sup>2</sup> (ABOUT)  
COVERED AREA: 46m<sup>2</sup> (ABOUT)  
UNCOVERED AREA: N/A

NON-DOMESTIC GFA: 46m<sup>2</sup> (ABOUT)  
BUILDING HEIGHT: 3m (ABOUT)  
NO. OF STOREY: 1 (G/F OF EXISTING STRUCTURE)

APPLICAITON SITE

(PART OF AN EXISTING STRUCTURE) -  
STRUCTURE B3 UNDER THE APPROVED  
S.16 APPLICATION NO. A/YL-KTS/812

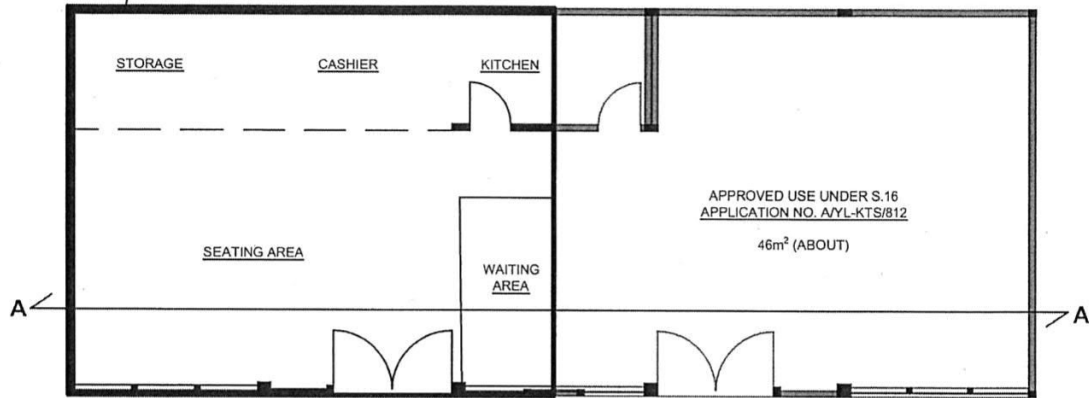

INTERNAL LAYOUT  
(INDICATIVE ONLY)

STRUCTURE B3 UNDER THE  
APPROVED S.16 APPLICATION  
NO. A/YL-KTS/812

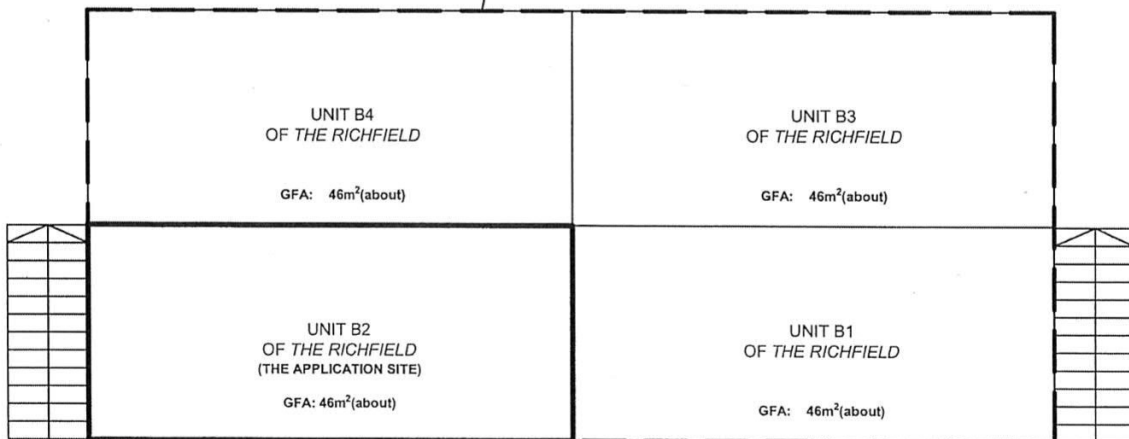

\*THE RICHFIELD - NAME OF THE APPLICATION SITE OF THE APPROVED S.16 APPLICATION NO. A/YL-KTS/812

SECTION A-A  
(INDICATIVE ONLY)

Drawing No.

P02

Ver

02

Project

PROPOSED TEMPORARY EATING PLACE FOR A PERIOD OF 3 YEARS

L'OT 341 (PART) IN D.D. 109

UNIT B2, THE RICHFIELD, 236 KAT HING WAI, KAM TIN, YUEN LONG, N.T.

Drawing Title

LAYOUT PLAN

Scale of AA

INDICATIVE ONLY

Drawn

Date

3.7.2019

Revised

Date

4.10.2019

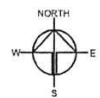

(摘錄自申請人於 10. 6. 2022 呈交的申請書)  
(Extract from Applicant's  
Submission of 10.6.2022)

參考編號  
REFERENCE No.  
A/YL-KTS/929

繪圖  
DRAWING  
A - 2



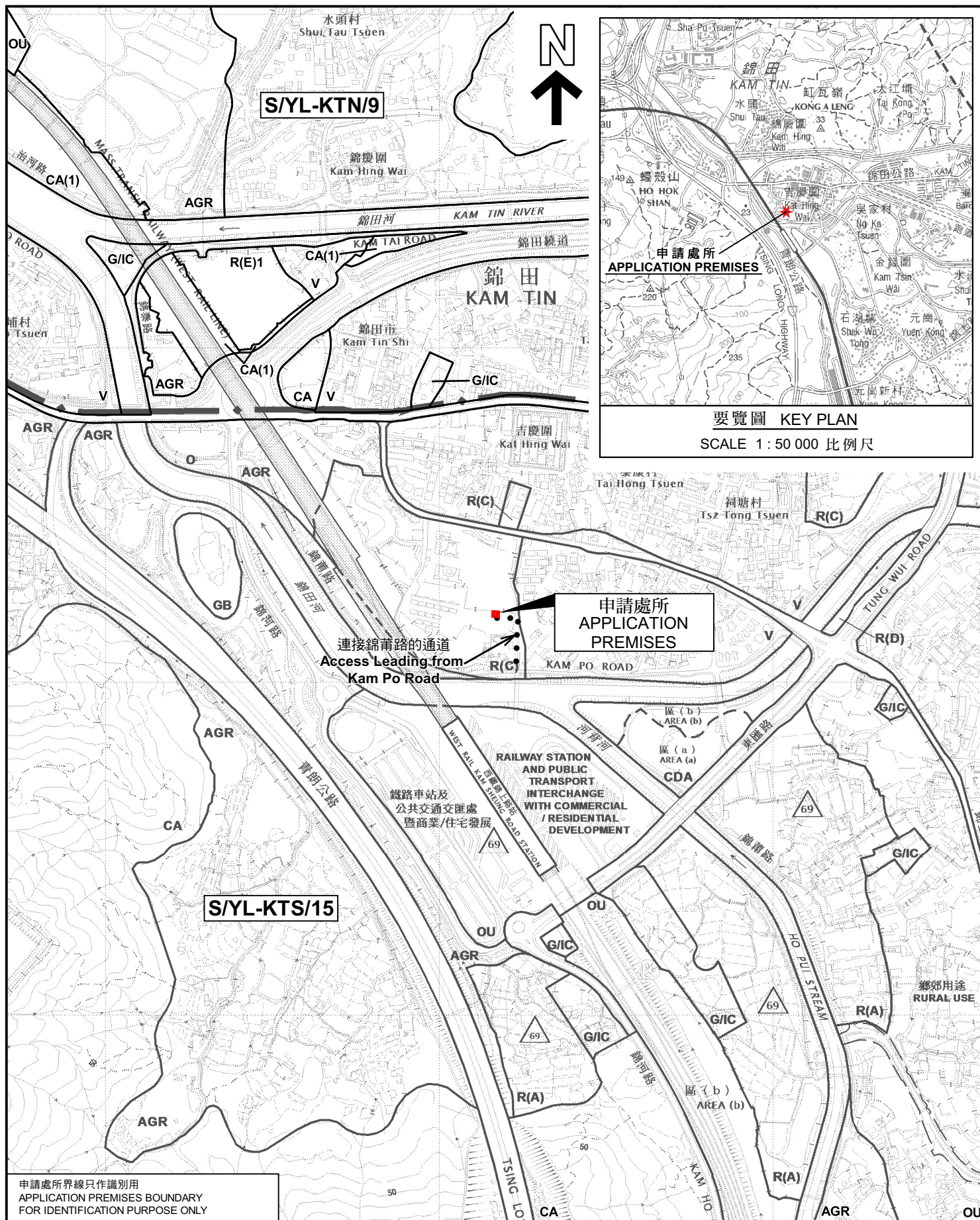

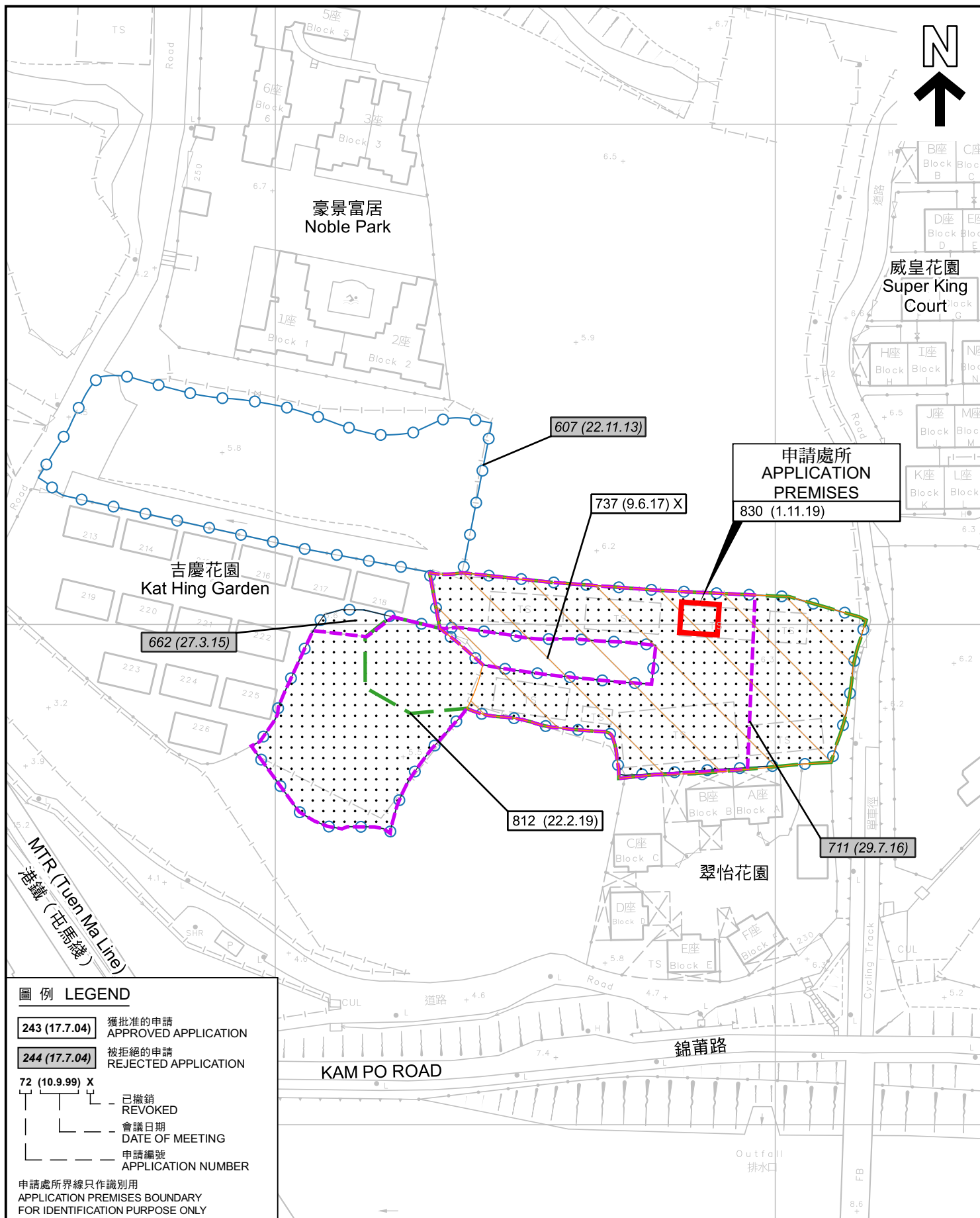

#### 圖例 LEGEND

- 243 (17.7.04)** 獲批准的申請  
APPROVED APPLICATION
- 244 (17.7.04)** 被拒絕的申請  
REJECTED APPLICATION
- 72 (10.9.99) X**  
已撤銷  
REVOKED
- 會議日期  
DATE OF MEETING
- 申請編號  
APPLICATION NUMBER

申請處所界線只作識別用  
APPLICATION PREMISES BOUNDARY  
FOR IDENTIFICATION PURPOSE ONLY

#### 先前申請圖 PREVIOUS APPLICATION PLAN

臨時食肆規劃許可續期（為期3年）  
元朗錦田吉慶園236號盈匯坊B2舖

RENEWAL OF PLANNING APPROVAL FOR TEMPORARY EATING PLACE  
FOR A PERIOD OF 3 YEARS  
UNIT B2, THE RICHFIELD, 236 KAT HING WAI, KAM TIN, YUEN LONG

SCALE 1 : 1 000 比例尺  
米 20 0 20 40 米  
METRES

規劃署  
PLANNING  
DEPARTMENT



參考編號  
REFERENCE No.  
A/YL-KTS/929

圖 PLAN  
A-1b

本摘要圖於2022年7月20日擬備，  
所根據的資料為測量圖編號  
6-NE-12A 及 6-NE-12C  
EXTRACT PLAN PREPARED ON 20.7.2022  
BASED ON SURVEY SHEETS No.  
6-NE-12A & 6-NE-12C



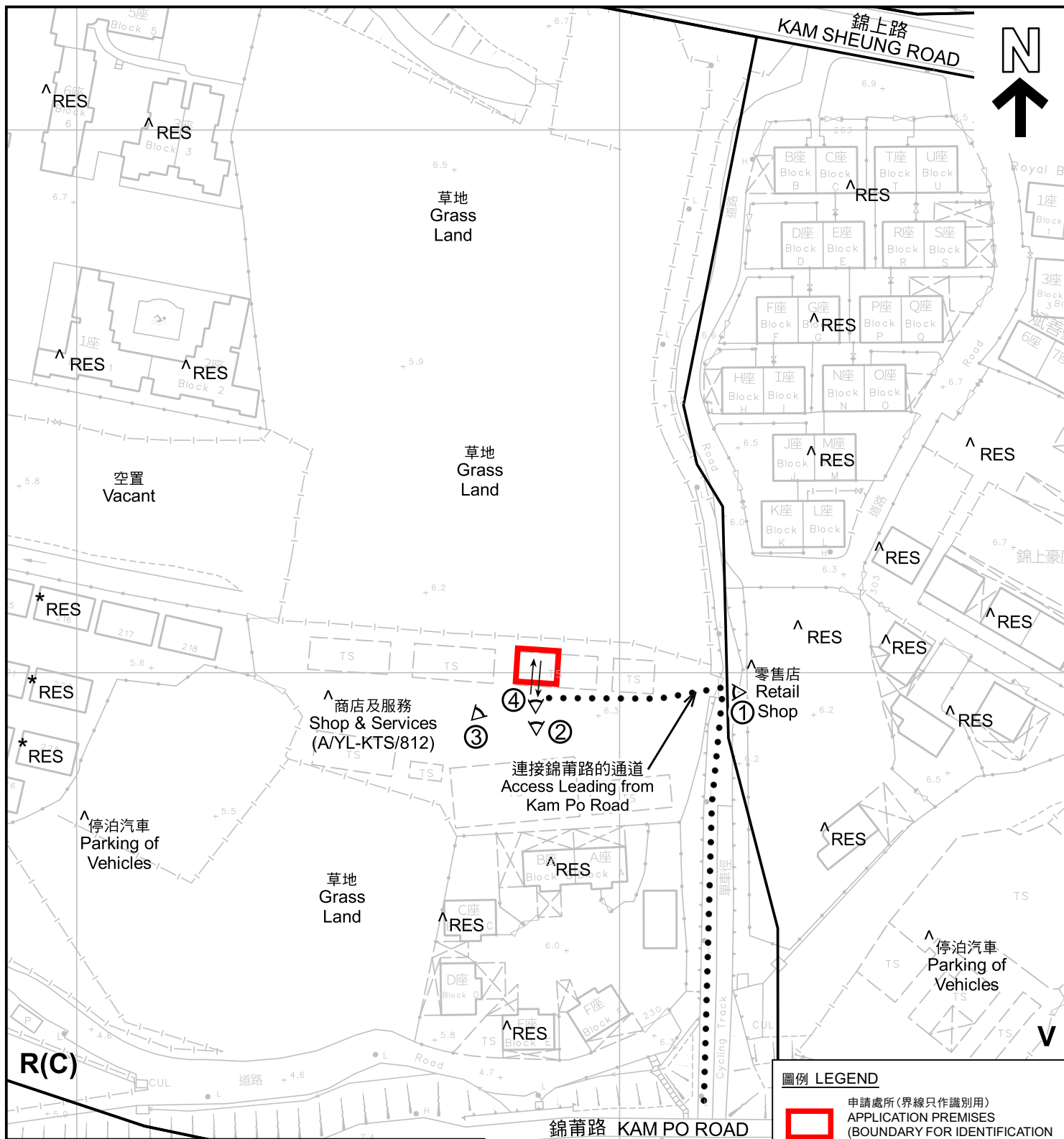

#### 註釋 Notes :

- (1) 2022年6月17日勘測的土地用途  
Land uses shown on this plan are in accordance with the land use survey conducted by the Planning Department on 17.6.2022
- (2) \* 土地用途跟1991年10月勘測的土地用途一致  
Indicates that the use is the same as that revealed by the land use survey conducted by the Planning Department in Oct 1991
- (3) ^ 土地用途跟1991年10月勘測的土地用途有別  
Indicates that the use is different from that revealed by the land use survey conducted by the Planning Department in Oct 1991

#### 圖例 LEGEND

- 申請處所 (界線只作識別用)  
APPLICATION PREMISES (BOUNDARY FOR IDENTIFICATION PURPOSE ONLY)
- R(C)** 住宅 (丙類)  
RESIDENTIAL (GROUP C)
- V** 鄉村式發展  
VILLAGE TYPE DEVELOPMENT
- RES** 住用構築物  
RESIDENTIAL STRUCTURES
- ① 實地照片的觀景點  
VIEWING POINT OF SITE PHOTO
- ↔ 入口/出口  
INGRESS / EGRESS

#### 平面圖 SITE PLAN

臨時食肆規劃許可續期 (為期3年)  
元朗錦田吉慶圍236號盈匯坊B2舖

RENEWAL OF PLANNING APPROVAL FOR TEMPORARY EATING PLACE  
FOR A PERIOD OF 3 YEARS  
UNIT B2, THE RICHFIELD, 236 KAT HING WAI, KAM TIN, YUEN LONG

本摘要圖於2022年7月20日擬備，  
所根據的資料為測量圖編號  
6-NE-12A 及 6-NE-12C

EXTRACT PLAN PREPARED ON 20.7.2022  
BASED ON SURVEY SHEETS No.  
6-NE-12A & 6-NE-12C

SCALE 1 : 1 000 比例尺  
米 METRES 20 0 20 40 米 METRES

規劃署  
PLANNING  
DEPARTMENT



參考編號  
REFERENCE No.  
A/YL-KTS/929

圖 PLAN  
A-2



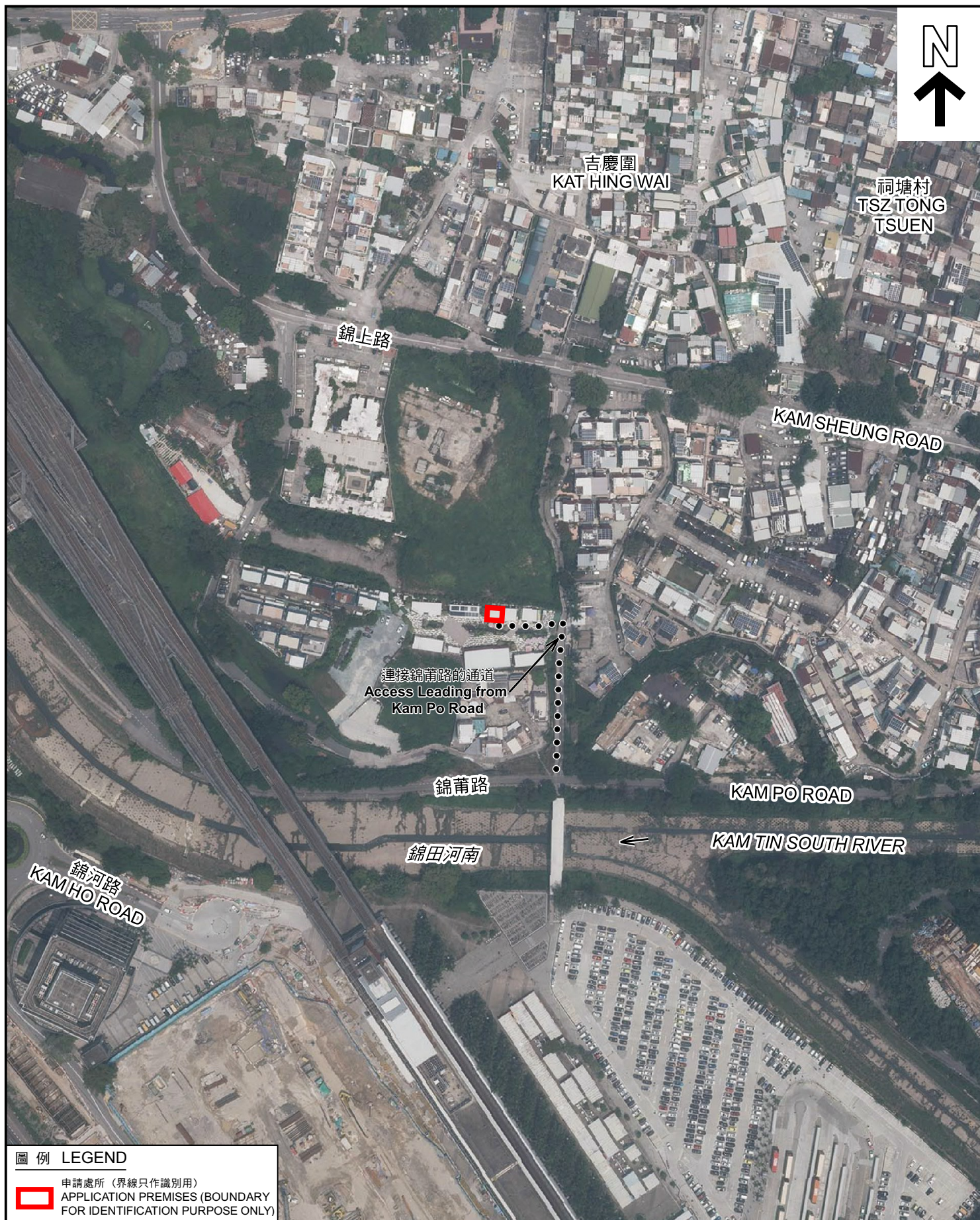

#### 圖例 LEGEND



申請處所 (界線只作識別用)  
APPLICATION PREMISES (BOUNDARY  
FOR IDENTIFICATION PURPOSE ONLY)

#### 航攝照片 AERIAL PHOTO

本摘要圖於2022年7月20日擬備，  
所根據的資料為地政總署於2021年7月23日  
拍得的航攝照片編號 E140083C  
EXTRACT PLAN PREPARED ON 20.7.2022  
BASED ON AERIAL PHOTO No.  
E140083C TAKEN ON 23.7.2021  
BY LANDS DEPARTMENT

臨時食肆規劃許可續期 (為期3年)  
元朗錦田吉慶圍236號盈匯坊B2舖  
RENEWAL OF PLANNING APPROVAL FOR TEMPORARY EATING PLACE  
FOR A PERIOD OF 3 YEARS  
UNIT B2, THE RICHFIELD, 236 KAT HING WAI, KAM TIN, YUEN LONG

規劃署  
PLANNING  
DEPARTMENT



參考編號  
REFERENCE No.  
A/YL-KTS/929

圖 PLAN  
A-3





申請處所界線只作識別用 APPLICATION PREMISES BOUNDARY FOR IDENTIFICATION PURPOSE ONLY

### 實地照片 SITE PHOTOS

本圖於2022年7月20日擬備，所根據的資料為攝於2022年6月17日的實地照片  
PLAN PREPARED ON 20.7.2022  
BASED ON SITE PHOTOS  
TAKEN ON 17.6.2022

臨時食肆規劃許可續期（為期3年）  
元朗錦田古慶園236號盈匯坊B2舖  
RENEWAL OF PLANNING APPROVAL FOR TEMPORARY EATING PLACE  
FOR A PERIOD OF 3 YEARS  
UNIT B2, THE RICHFIELD, 236 KAT HING WAI, KAM TIN, YUEN LONG

規劃署  
PLANNING  
DEPARTMENT



參考編號  
REFERENCE No.

A/YL-KTS/929

圖 PLAN

A-4