

Structure No.	Uses	No. of Storey	Floor Area(m ²)	Height(m)
1	Warehouse	1	228	11
2	Warehouse	1	228	11
3	Warehouse	1	228	11
4	Warehouse	1	228	11
5	Warehouse	1	166	11
6	Warehouse	1	228	11

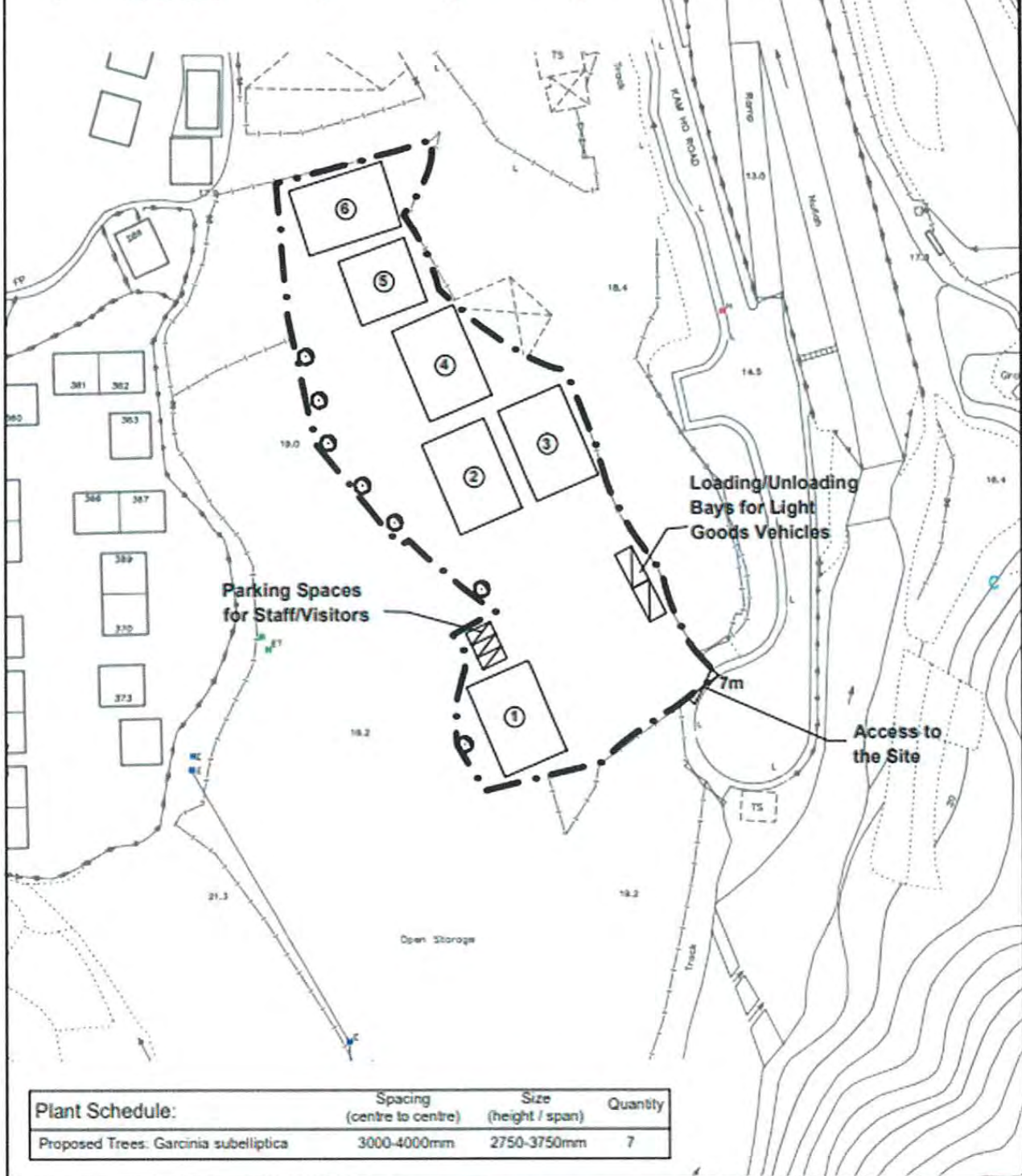

Top Bright Consultants Ltd.

Drawing No. :TB/23/815/06A

Landscape Plan

Various Lots in DD113, Kam Ho Road,
Kam Tin, Yuen Long, N.T.

FIGURE 6A

FOR IDENTIFICATION PURPOSE

Date: 22.5.2023

Scale: 1 : 1 000

(摘錄自申請人於22. 5. 2023呈交的進一步資料)
(Extract from Applicant's Further
Information Submitted on 22.5.2023)

參考編號
REFERENCE No.
A/YL-KTS/959

繪圖
DRAWING
A - 1

Structure No.	Uses	No. of Storey	Floor Area(m ²)	Height(m)
1	Warehouse	1	228	11
2	Warehouse	1	228	11
3	Warehouse	1	228	11
4	Warehouse	1	228	11
5	Warehouse	1	166	11
6	Warehouse	1	228	11

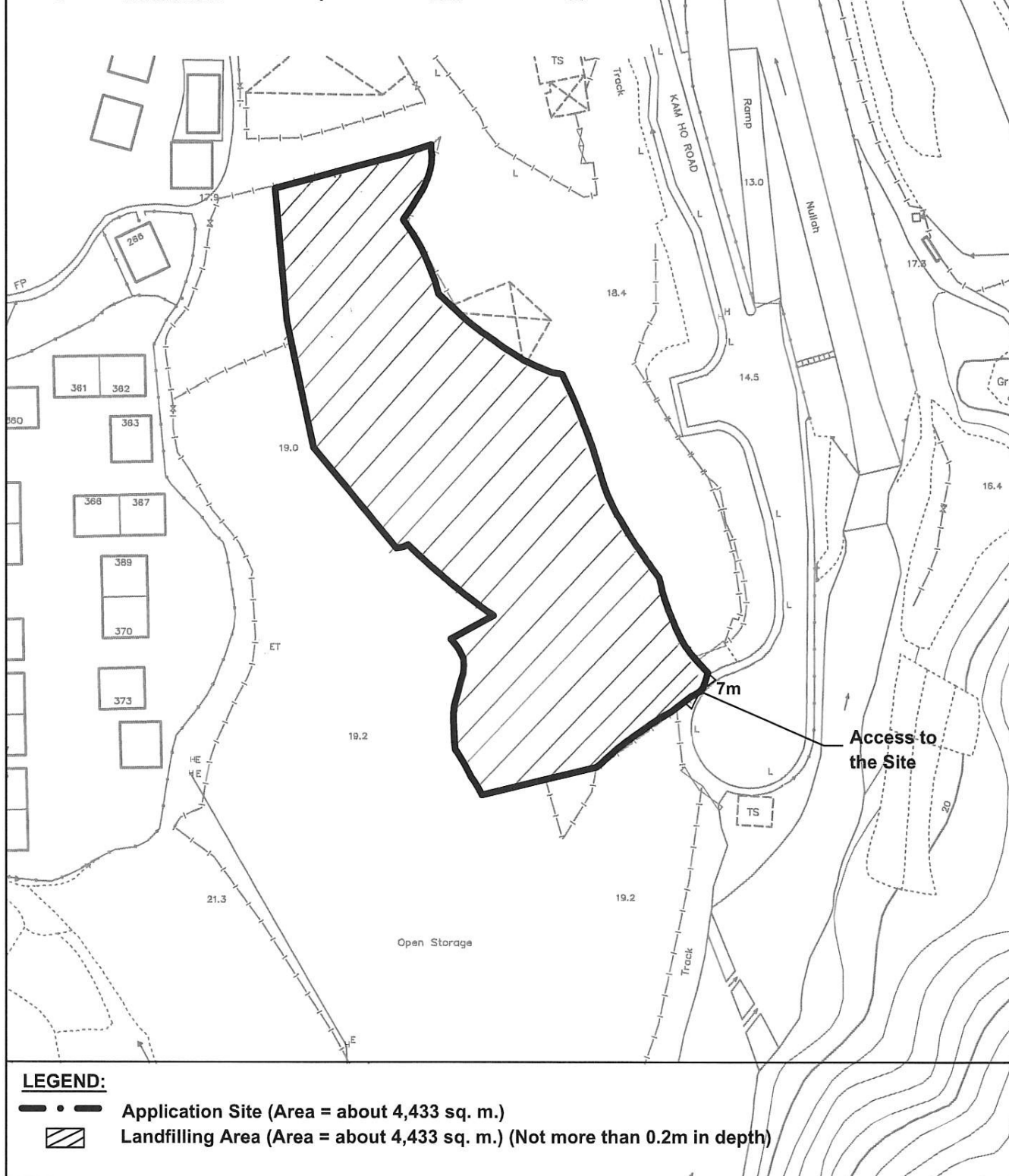

Top Bright Consultants Ltd.

Drawing No. :TB/23/815/07A

Landfilling Plan

Various Lots in DD113, Kam Ho Road,
Kam Tin, Yuen Long, N.T.

FIGURE 7A

FOR IDENTIFICATION PURPOSE

Date: 5.6.2023

Scale: 1:1000

(摘錄自申請人於5. 6. 2023呈交的進一步資料)
(Extract from Applicant's Further
Information Submitted on 5.6.2023)

參考編號
REFERENCE No.
A/YL-KTS/959

繪圖
DRAWING
A - 2



圖例 LEGEND



申請地點 (界線只作識別用)
APPLICATION SITE (BOUNDARY FOR
IDENTIFICATION PURPOSE ONLY)

本摘要圖於2023年4月28日擬備，
所根據的資料為地政總署於2022年4月8日
拍得的航攝照片編號 E162416C
EXTRACT PLAN PREPARED ON 28.4.2023
BASED ON AERIAL PHOTO No.
E162416C TAKEN ON 8.4.2022
BY LANDS DEPARTMENT

航攝照片 AERIAL PHOTO

擬議臨時貨倉存放建築材料 (為期3年) 及填土工程
新界元朗錦田丈量約份第113約多個地段
PROPOSED TEMPORARY WAREHOUSE
FOR STORAGE OF CONSTRUCTION MATERIALS
FOR A PERIOD OF 3 YEARS AND FILLING OF LAND
VARIOUS LOTS IN D.D. 113, KAM TIN,
YUEN LONG, NEW TERRITORIES

規劃署
PLANNING
DEPARTMENT



參考編號
REFERENCE No.
A/YL-KTS/959

圖 PLAN
A-3

1

申請地點
APPLICATION SITE



入口/出口
INGRESS /
EGRESS

通往申請地點的通道
Access Leading to the
Application Site

2



申請地點
APPLICATION SITE

申請地點界線只作識別用 APPLICATION SITE BOUNDARY FOR IDENTIFICATION PURPOSE ONLY

實地照片 SITE PHOTOS

擬議臨時貨倉存放建築材料（為期3年）及填土工程
新界元朗錦田丈量約份第113約多個地段
PROPOSED TEMPORARY WAREHOUSE
FOR STORAGE OF CONSTRUCTION MATERIALS
FOR A PERIOD OF 3 YEARS AND FILLING OF LAND
VARIOUS LOTS IN D.D. 113, KAM TIN,
YUEN LONG, NEW TERRITORIES

規劃署
PLANNING
DEPARTMENT



參考編號
REFERENCE No.
A/YL-KTS/959

圖 PLAN
A-4a

本圖於2023年5月8日擬備，所根據的
資料為攝於2023年4月18日的實地照片
PLAN PREPARED ON 8.5.2023
BASED ON SITE PHOTOS
TAKEN ON 18.4.2023

3



申請地點
APPLICATION SITE

4



申請地點
APPLICATION SITE

申請地點界線只作識別用 APPLICATION SITE BOUNDARY FOR IDENTIFICATION PURPOSE ONLY

實地照片 SITE PHOTOS

本圖於2023年5月8日擬備，所根據的資料為攝於2023年4月18日的實地照片
PLAN PREPARED ON 8.5.2023
BASED ON SITE PHOTOS
TAKEN ON 18.4.2023

擬議臨時貨倉存放建築材料（為期3年）及填土工程
新界元朗錦田丈量約份第113約多個地段
PROPOSED TEMPORARY WAREHOUSE
FOR STORAGE OF CONSTRUCTION MATERIALS
FOR A PERIOD OF 3 YEARS AND FILLING OF LAND
VARIOUS LOTS IN D.D. 113, KAM TIN,
YUEN LONG, NEW TERRITORIES

規劃署
PLANNING
DEPARTMENT



參考編號
REFERENCE No.
A/YL-KTS/959

圖 PLAN
A-4b