

只會在收到所有必要的資料及文件後才正式確認收到申請的日期。

This document is received on 28 JUL 2023.
The Town Planning Board will formally acknowledge the date of receipt of the application only upon receipt of all the required information and documents.

FORM NO. S16-III
表格第 S16-III 號

APPLICATION FOR PERMISSION UNDER SECTION 16 OF THE TOWN PLANNING ORDINANCE (CAP.131)

根據《城市規劃條例》(第131章)
第16條遞交的許可申請

Applicable to Proposal Only Involving Temporary Use/Development of Land and/or Building Not Exceeding 3 Years in Rural Areas or Renewal of Permission for such Temporary Use or Development*

適用於祇涉及位於鄉郊地區土地上及/或建築物內進行為期不超過三年的臨時用途/發展或該等臨時用途/發展的許可續期的建議*

*Form No. S16-I should be used for other Temporary Use/Development of Land and/or Building (e.g. temporary use/developments in the Urban Area) and Renewal of Permission for such Temporary Use or Development.
*其他土地上及/或建築物內的臨時用途/發展 (例如位於市區內的臨時用途或發展) 及有關該等臨時用途/發展的許可續期，應使用表格第 S16-I 號。

Applicant who would like to publish the notice of application in local newspapers to meet one of the Town Planning Board's requirements of taking reasonable steps to obtain consent of or give notification to the current land owner, please refer to the following link regarding publishing the notice in the designated newspapers:
https://www.info.gov.hk/tpb/en/plan_application/apply.html

申請人如欲在本地報章刊登申請通知，以採取城市規劃委員會就取得現行土地擁有人的同意或通知現行土地擁有人所指定的其中一項合理步驟，請瀏覽以下網址有關在指定的報章刊登通知：
https://www.info.gov.hk/tpb/tc/plan_application/apply.html

General Note and Annotation for the Form

填寫表格的一般指引及註解

"Current land owner" means any person whose name is registered in the Land Registry as that of an owner of the land to which the application relates, as at 6 weeks before the application is made
「現行土地擁有人」指在提出申請前六星期，其姓名或名稱已在土地註冊處註冊為該申請所關乎的土地的擁有人的人

& Please attach documentary proof 請夾附證明文件

^ Please insert number where appropriate 請在適當地地方註明編號

Please fill "NA" for inapplicable item. 請在不適用的項目填寫「不適用」

Please use separate sheets if the space provided is insufficient 如所提供的空間不足，請另頁說明

Please insert a 「✓」 at the appropriate box 請在適當的方格內上加上「✓」號

For Official Use Only 請勿填寫此欄	Application No. 申請編號	A/7C-KTS/973
	Date Received 收到日期	28 JUL 2023

- The completed form and supporting documents (if any) should be sent to the Secretary, Town Planning Board (the Board), 15/F, North Point Government Offices, 333 Java Road, North Point, Hong Kong.
申請人須把填妥的申請表格及其他支持申請的文件 (倘有), 送交香港北角渣華道 333 號北角政府合署 15 樓城市規劃委員會 (下稱「委員會」) 秘書收。
- Please read the "Guidance Notes" carefully before you fill in this form. The document can be downloaded from the Board's website at <http://www.info.gov.hk/tpb/>. It can also be obtained from the Secretariat of the Board at 15/F, North Point Government Offices, 333 Java Road, North Point, Hong Kong (Tel: 2231 4810 or 2231 4835), and the Planning Enquiry Counters of the Planning Department (Hotline: 2231 5000) (17/F, North Point Government Offices, 333 Java Road, North Point, Hong Kong and 14/F, Sha Tin Government Offices, 1 Sheung Wo Che Road, Sha Tin, New Territories).
請先細閱《申請須知》的資料單張, 然後填寫此表格。該份文件可從委員會的網頁下載 (網址: <http://www.info.gov.hk/tpb/>), 亦可向委員會秘書處 (香港北角渣華道 333 號北角政府合署 15 樓 - 電話: 2231 4810 或 2231 4835) 及規劃署的規劃資料查詢處 (熱線: 2231 5000) (香港北角渣華道 333 號北角政府合署 17 樓及新界沙田上禾輦路 1 號沙田政府合署 14 樓) 索取。
- This form can be downloaded from the Board's website, and obtained from the Secretariat of the Board and the Planning Enquiry Counters of the Planning Department. The form should be typed or completed in block letters. The processing of the application may be refused if the required information or the required copies are incomplete.
此表格可從委員會的網頁下載, 亦可向委員會秘書處及規劃署的規劃資料查詢處索取。申請人須以打印方式或以正楷填寫表格。如果申請人所提交的資料或文件副本不齊全, 委員會可拒絕處理有關申請。

1. Name of Applicant 申請人姓名/名稱		
(<input checked="" type="checkbox"/> Mr. 先生 / <input type="checkbox"/> Mrs. 夫人 / <input type="checkbox"/> Miss 小姐 / <input type="checkbox"/> Ms. 女士 / <input type="checkbox"/> Company 公司 / <input type="checkbox"/> Organisation 機構)		
PONG	WAI	CHU
PONG	WAI	KWONG

2. Name of Authorised Agent (if applicable) 獲授權代理人姓名/名稱 (如適用)	
(<input type="checkbox"/> Mr. 先生 / <input type="checkbox"/> Mrs. 夫人 / <input type="checkbox"/> Miss 小姐 / <input type="checkbox"/> Ms. 女士 / <input type="checkbox"/> Company 公司 / <input type="checkbox"/> Organisation 機構)	

3. Application Site 申請地點	
(a) Full address / location / demarcation district and lot number (if applicable) 詳細地址/地點/丈量約份及地段號碼 (如適用)	P.D. 106. Lot 467 R.P. Kam Sheung Road. Kam Tin. Yuen Long N.T.
(b) Site area and/or gross floor area involved 涉及的地盤面積及/或總樓面面積	<input checked="" type="checkbox"/> Site area 地盤面積 501 sq.m 平方米 <input checked="" type="checkbox"/> About 約 <input checked="" type="checkbox"/> Gross floor area 總樓面面積 45.5 sq.m 平方米 <input checked="" type="checkbox"/> About 約
(c) Area of Government land included (if any) 所包括的政府土地面積 (倘有)	N/A sq.m 平方米 <input type="checkbox"/> About 約

(d) Name and number of the related statutory plan(s) 有關法定圖則的名稱及編號	S/KL-KTS/15
(e) Land use zone(s) involved 涉及的土地用途地帶	Agriculture
(f) Current use(s) 現時用途	露天存渠為工程物料 (If there are any Government, institution or community facilities, please illustrate on plan and specify the use and gross floor area) (如有任何政府、機構或社區設施，請在圖則上顯示，並註明用途及總樓面面積)

4. "Current Land Owner" of Application Site 申請地點的「現行土地擁有人」

The applicant 申請人 -

- ☒ is the sole "current land owner" (please proceed to Part 6 and attach documentary proof of ownership).
是唯一的「現行土地擁有人」(請繼續填寫第 6 部分，並夾附業權證明文件)。
- ☐ is one of the "current land owners" (please attach documentary proof of ownership).
是其中一名「現行土地擁有人」(請夾附業權證明文件)。
- ☐ is not a "current land owner".
並不是「現行土地擁有人」。
- ☐ The application site is entirely on Government land (please proceed to Part 6).
申請地點完全位於政府土地上(請繼續填寫第 6 部分)。

5. Statement on Owner's Consent/Notification

就土地擁有人的同意/通知土地擁有人的陳述

- (a) According to the record(s) of the Land Registry as at (DD/MM/YYYY), this application involves a total of "current land owner(s)".
根據土地註冊處截至 年 月 日的記錄，這宗申請共牽涉 名「現行土地擁有人」。

(b) The applicant 申請人 -

- ☐ has obtained consent(s) of "current land owner(s)".
已取得 名「現行土地擁有人」的同意。

Details of consent of "current land owner(s)" obtained 取得「現行土地擁有人」同意的詳情		
No. of "Current Land Owner(s)" 「現行土地擁有人」數目	Lot number/address of premises as shown in the record of the Land Registry where consent(s) has/have been obtained 根據土地註冊處記錄已獲得同意的地段號碼/處所地址	Date of consent obtained (DD/MM/YYYY) 取得同意的日期 (日/月/年)

(Please use separate sheets if the space of any box above is insufficient. 如上列任何方格的空間不足，請另頁說明)

- ☐ has notified "current land owner(s)"#

已通知 名「現行土地擁有人」#。

Details of the "current land owner(s)"# notified 已獲通知「現行土地擁有人」#的詳細資料		
No. of 'Current Land Owner(s)' 「現行土地擁有人」數目	Lot number/address of premises as shown in the record of the Land Registry where notification(s) has/have been given 根據土地註冊處記錄已發出通知的地段號碼/處所地址	Date of notification given (DD/MM/YYYY) 通知日期(日/月/年)
	N.A	

(Please use separate sheets if the space of any box above is insufficient. 如上列任何方格的空間不足，請另頁說明)

- ☐ has taken reasonable steps to obtain consent of or give notification to owner(s):

已採取合理步驟以取得土地擁有人的同意或向該人發給通知。詳情如下：

Reasonable Steps to Obtain Consent of Owner(s) 取得土地擁有人的同意所採取的合理步驟

- ☐ sent request for consent to the "current land owner(s)" on _____ (DD/MM/YYYY)#[&]
於 _____ (日/月/年)向每一名「現行土地擁有人」#郵遞要求同意書[&]

Reasonable Steps to Give Notification to Owner(s) 向土地擁有人發出通知所採取的合理步驟

- ☐ published notices in local newspapers on _____ (DD/MM/YYYY)[&]
於 _____ (日/月/年)在指定報章就申請刊登一次通知[&]
- ☐ posted notice in a prominent position on or near application site/premises on _____ (DD/MM/YYYY)[&]
於 _____ (日/月/年)在申請地點/申請處所或附近的顯明位置貼出關於該申請的通知[&]
- ☐ sent notice to relevant owners' corporation(s)/owners' committee(s)/mutual aid committee(s)/management office(s) or rural committee on _____ (DD/MM/YYYY)[&]
於 _____ (日/月/年)把通知寄往相關的業主立案法團/業主委員會/互助委員會或管理處，或有關的鄉事委員會[&]

Others 其他

- ☐ others (please specify)
其他 (請指明)

N.A

Note: May insert more than one 「✓」.

Information should be provided on the basis of each and every lot (if applicable) and premises (if any) in respect of the application.

註：可在多於一個方格內加上「✓」號

申請人須就申請涉及的每一地段 (倘適用) 及處所 (倘有) 分別提供資料

6. Type(s) of Application 申請類別	
(A) Temporary Use/Development of Land and/or Building Not Exceeding 3 Years in Rural Areas 位於鄉郊地區土地上及/或建築物內進行為期不超過三年的臨時用途/發展 (For Renewal of Permission for Temporary Use or Development in Rural Areas, please proceed to Part (B)) (如屬位於鄉郊地區臨時用途/發展的規劃許可續期，請填寫(B)部分)	
(a) Proposed use(s)/development 擬議用途/發展	臨時露天存放渠務工程物料 (Please illustrate the details of the proposal on a layout plan) (請用平面圖說明擬議詳情)
(b) Effective period of permission applied for 申請的許可有效期	<input checked="" type="checkbox"/> year(s) 年 3 <input type="checkbox"/> month(s) 個月
(c) Development Schedule 發展細節表	
Proposed uncovered land area 擬議露天土地面積	455.5 sq.m <input checked="" type="checkbox"/> About 約
Proposed covered land area 擬議有上蓋土地面積	45.5 sq.m <input checked="" type="checkbox"/> About 約
Proposed number of buildings/structures 擬議建築物/構築物數目	1
Proposed domestic floor area 擬議住用樓面面積 sq.m <input type="checkbox"/> About 約
Proposed non-domestic floor area 擬議非住用樓面面積	45.5 sq.m <input checked="" type="checkbox"/> About 約
Proposed gross floor area 擬議總樓面面積	45.5 sq.m <input checked="" type="checkbox"/> About 約
Proposed height and use(s) of different floors of buildings/structures (if applicable) 建築物/構築物的擬議高度及不同樓層的擬議用途 (如適用) (Please use separate sheets if the space below is insufficient) (如以下空間不足，請另頁說明)	
一層高洗手間及什物房 約 2.9 米高	
Proposed number of car parking spaces by types 不同種類停車位的擬議數目	
Private Car Parking Spaces 私家車車位
Motorcycle Parking Spaces 電單車車位
Light Goods Vehicle Parking Spaces 輕型貨車泊車位
Medium Goods Vehicle Parking Spaces 中型貨車泊車位	2
Heavy Goods Vehicle Parking Spaces 重型貨車泊車位
Others (Please Specify) 其他 (請列明)
Proposed number of loading/unloading spaces 上落客貨車位的擬議數目	
Taxi Spaces 的士車位
Coach Spaces 旅遊巴車位
Light Goods Vehicle Spaces 輕型貨車車位
Medium Goods Vehicle Spaces 中型貨車車位
Heavy Goods Vehicle Spaces 重型貨車車位
Others (Please Specify) 其他 (請列明)

Proposed operating hours 擬議營運時間 星期一至星期六 0830 - 1900 時 星期日及公眾假期休息																																	
(d) Any vehicular access to the site/subject building? 是否有車路通往地盤/ 有關建築物？	Yes 是	<input checked="" type="checkbox"/> There is an existing access. (please indicate the street name, where appropriate) 有一條現有車路。(請註明車路名稱(如適用)) <div style="text-align: center; margin-top: 10px;">錦 上 路</div>																															
	No 否	<input type="checkbox"/> There is a proposed access. (please illustrate on plan and specify the width) 有一條擬議車路。(請在圖則顯示，並註明車路的闊度) <input type="checkbox"/>																															
(e) Impacts of Development Proposal 擬議發展計劃的影響 (If necessary, please use separate sheets to indicate the proposed measures to minimise possible adverse impacts or give justifications/reasons for not providing such measures. 如需要的話，請另頁註明可盡量減少可能出現不良影響的措施，否則請提供理據/理由。)																																	
(i) Does the development proposal involve alteration of existing building? 擬議發展計劃是否包括現有建築物的改動？	Yes 是 <input type="checkbox"/> Please provide details 請提供詳情 No 否 <input checked="" type="checkbox"/>																																
(ii) Does the development proposal involve the operation on the right? 擬議發展是否涉及右列的工程？	Yes 是 No 否 <input checked="" type="checkbox"/>	<input type="checkbox"/> (Please indicate on site plan the boundary of concerned land/pond(s), and particulars of stream diversion, the extent of filling of land/pond(s) and/or excavation of land) (請用地盤平面圖顯示有關土地／池塘界線，以及河道改道、填塘、填土及／或挖土的細節及／或範圍) <input type="checkbox"/> Diversion of stream 河道改道 <input type="checkbox"/> Filling of pond 填塘 Area of filling 填塘面積 sq.m 平方米 <input type="checkbox"/> About 約 Depth of filling 填塘深度 m 米 <input type="checkbox"/> About 約 <input type="checkbox"/> Filling of land 填土 Area of filling 填土面積 sq.m 平方米 <input type="checkbox"/> About 約 Depth of filling 填土厚度 m 米 <input type="checkbox"/> About 約 <input type="checkbox"/> Excavation of land 挖土 Area of excavation 挖土面積 sq.m 平方米 <input type="checkbox"/> About 約 Depth of excavation 挖土深度 m 米 <input type="checkbox"/> About 約																															
(iii) Would the development proposal cause any adverse impacts? 擬議發展計劃會否造成不良影響？	<table style="width:100%; border-collapse: collapse;"> <tr> <td style="width:60%;">On environment 對環境</td> <td style="width:10%;">Yes 會 <input type="checkbox"/></td> <td style="width:10%;">No 不會 <input checked="" type="checkbox"/></td> </tr> <tr> <td>On traffic 對交通</td> <td>Yes 會 <input type="checkbox"/></td> <td>No 不會 <input checked="" type="checkbox"/></td> </tr> <tr> <td>On water supply 對供水</td> <td>Yes 會 <input type="checkbox"/></td> <td>No 不會 <input checked="" type="checkbox"/></td> </tr> <tr> <td>On drainage 對排水</td> <td>Yes 會 <input type="checkbox"/></td> <td>No 不會 <input checked="" type="checkbox"/></td> </tr> <tr> <td>On slopes 對斜坡</td> <td>Yes 會 <input type="checkbox"/></td> <td>No 不會 <input checked="" type="checkbox"/></td> </tr> <tr> <td>Affected by slopes 受斜坡影響</td> <td>Yes 會 <input type="checkbox"/></td> <td>No 不會 <input checked="" type="checkbox"/></td> </tr> <tr> <td>Landscape Impact 構成景觀影響</td> <td>Yes 會 <input type="checkbox"/></td> <td>No 不會 <input checked="" type="checkbox"/></td> </tr> <tr> <td>Tree Felling 砍伐樹木</td> <td>Yes 會 <input type="checkbox"/></td> <td>No 不會 <input checked="" type="checkbox"/></td> </tr> <tr> <td>Visual Impact 構成視覺影響</td> <td>Yes 會 <input type="checkbox"/></td> <td>No 不會 <input checked="" type="checkbox"/></td> </tr> <tr> <td>Others (Please Specify) 其他 (請列明)</td> <td>Yes 會 <input type="checkbox"/></td> <td>No 不會 <input checked="" type="checkbox"/></td> </tr> </table>			On environment 對環境	Yes 會 <input type="checkbox"/>	No 不會 <input checked="" type="checkbox"/>	On traffic 對交通	Yes 會 <input type="checkbox"/>	No 不會 <input checked="" type="checkbox"/>	On water supply 對供水	Yes 會 <input type="checkbox"/>	No 不會 <input checked="" type="checkbox"/>	On drainage 對排水	Yes 會 <input type="checkbox"/>	No 不會 <input checked="" type="checkbox"/>	On slopes 對斜坡	Yes 會 <input type="checkbox"/>	No 不會 <input checked="" type="checkbox"/>	Affected by slopes 受斜坡影響	Yes 會 <input type="checkbox"/>	No 不會 <input checked="" type="checkbox"/>	Landscape Impact 構成景觀影響	Yes 會 <input type="checkbox"/>	No 不會 <input checked="" type="checkbox"/>	Tree Felling 砍伐樹木	Yes 會 <input type="checkbox"/>	No 不會 <input checked="" type="checkbox"/>	Visual Impact 構成視覺影響	Yes 會 <input type="checkbox"/>	No 不會 <input checked="" type="checkbox"/>	Others (Please Specify) 其他 (請列明)	Yes 會 <input type="checkbox"/>	No 不會 <input checked="" type="checkbox"/>
On environment 對環境	Yes 會 <input type="checkbox"/>	No 不會 <input checked="" type="checkbox"/>																															
On traffic 對交通	Yes 會 <input type="checkbox"/>	No 不會 <input checked="" type="checkbox"/>																															
On water supply 對供水	Yes 會 <input type="checkbox"/>	No 不會 <input checked="" type="checkbox"/>																															
On drainage 對排水	Yes 會 <input type="checkbox"/>	No 不會 <input checked="" type="checkbox"/>																															
On slopes 對斜坡	Yes 會 <input type="checkbox"/>	No 不會 <input checked="" type="checkbox"/>																															
Affected by slopes 受斜坡影響	Yes 會 <input type="checkbox"/>	No 不會 <input checked="" type="checkbox"/>																															
Landscape Impact 構成景觀影響	Yes 會 <input type="checkbox"/>	No 不會 <input checked="" type="checkbox"/>																															
Tree Felling 砍伐樹木	Yes 會 <input type="checkbox"/>	No 不會 <input checked="" type="checkbox"/>																															
Visual Impact 構成視覺影響	Yes 會 <input type="checkbox"/>	No 不會 <input checked="" type="checkbox"/>																															
Others (Please Specify) 其他 (請列明)	Yes 會 <input type="checkbox"/>	No 不會 <input checked="" type="checkbox"/>																															

	<p>Please state measure(s) to minimise the impact(s). For tree felling, please state the number, diameter at breast height and species of the affected trees (if possible)</p> <p>請註明盡量減少影響的措施。如涉及砍伐樹木，請說明受影響樹木的數目、及胸高度的樹幹直徑及品種(倘可)</p> <p>.....</p> <p>.....</p> <p>.....</p> <p>.....</p> <p>.....</p>
--	--

(B) Renewal of Permission for Temporary Use or Development in Rural Areas 位於鄉郊地區臨時用途/發展的許可續期	
(a) Application number to which the permission relates 與許可有關的申請編號	A/ _____ / _____
(b) Date of approval 獲批給許可的日期 (DD 日/MM 月/YYYY 年)
(c) Date of expiry 許可屆滿日期 (DD 日/MM 月/YYYY 年)
(d) Approved use/development 已批給許可的用途/發展	
(e) Approval conditions 附帶條件	<p><input type="checkbox"/> The permission does not have any approval condition 許可並沒有任何附帶條件</p> <p><input type="checkbox"/> Applicant has complied with all the approval conditions 申請人已履行全部附帶條件</p> <p><input type="checkbox"/> Applicant has not yet complied with the following approval condition(s): 申請人仍未履行下列附帶條件：</p> <p>.....</p> <p>.....</p> <p>.....</p> <p>Reason(s) for non-compliance: 仍未履行的原因：</p> <p>.....</p> <p>.....</p> <p>.....</p> <p>(Please use separate sheets if the space above is insufficient) (如以上空間不足，請另頁說明)</p>
(f) Renewal period sought 要求的續期期間	<p>year(s) 年:</p> <p>month(s) 個月:</p>

7. Justifications 理由

The applicant is invited to provide justifications in support of the application. Use separate sheets if necessary.
現請申請人提供申請理由及支持其申請的資料。如有需要，請另頁說明。

① 現時用途更改，相關編號是 A/YL-KTS 858。

② 此地段業權人沒有改變，了解使用
要求和各種情況。



③ 申請地段內種植樹木狀況依舊
良好，有 5 至 6 米高。

④ 現時存放建築材料簡潔，地方乾淨。



8. Declaration 聲明

I hereby declare that the particulars given in this application are correct and true to the best of my knowledge and belief.
本人謹此聲明，本人就這宗申請提交的資料，據本人所知及所信，均屬真實無誤。

I hereby grant a permission to the Board to copy all the materials submitted in this application and/or to upload such materials to the Board's website for browsing and downloading by the public free-of-charge at the Board's discretion.
本人現准許委員會酌情將本人就此申請所提交的所有資料複製及/或上載至委員會網站，供公眾免費瀏覽或下載。

Signature 簽署    ☒ Applicant 申請人 / ☐ Authorised Agent 獲授權代理人

PONG WA K WONG

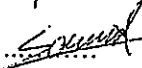
Name in Block Letters
姓名（請以正楷填寫）

Position (if applicable)
職位（如適用）

Professional Qualification(s) ☐ Member 會員 / ☐ Fellow of 資深會員

專業資格

☐ HKIP 香港規劃師學會 /

☐ HKIA 香港建築師學會 /

☐ HKIS 香港測量師學會 /

☐ HKIE 香港工程師學會 /

☐ HKILA 香港園境師學會 /

☐ HKIUD 香港城市設計學會

☐ RPP 註冊專業規劃師

Others 其他

on behalf of
代表

☐ Company 公司 / ☐ Organisation Name and Chop (if applicable) 機構名稱及蓋章（如適用）

Date 日期

18-07-2023

(DD/MM/YYYY 日/月/年)

Remark 備註

The materials submitted in this application and the Board's decision on the application would be disclosed to the public. Such materials would also be uploaded to the Board's website for browsing and free downloading by the public where the Board considers appropriate.

委員會會向公眾披露申請人所遞交的申請資料和委員會對申請所作的決定。在委員會認為合適的情況下，有關申請資料亦會上載至委員會網頁供公眾免費瀏覽及下載。

Warning 警告

Any person who knowingly or wilfully makes any statement or furnish any information in connection with this application, which is false in any material particular, shall be liable to an offence under the Crimes Ordinance.

任何人在明知或故意的情況下，就這宗申請提出在任何要項上是虛假的陳述或資料，即屬違反《刑事罪行條例》。

Statement on Personal Data 個人資料的聲明

1. The personal data submitted to the Board in this application will be used by the Secretary of the Board and Government departments for the following purposes:

委員會就這宗申請所收到的個人資料會交給委員會秘書及政府部門，以根據《城市規劃條例》及相關的城市規劃委員會規劃指引的規定作以下用途：

(a) the processing of this application which includes making available the name of the applicant for public inspection when making available this application for public inspection; and

處理這宗申請，包括公布這宗申請供公眾查閱，同時公布申請人的姓名供公眾查閱；以及

(b) facilitating communication between the applicant and the Secretary of the Board/Government departments.

方便申請人與委員會秘書及政府部門之間進行聯絡。

2. The personal data provided by the applicant in this application may also be disclosed to other persons for the purposes mentioned in paragraph 1 above.

申請人就這宗申請提供的個人資料，或亦會向其他人士披露，以作上述第1段提及的用途。

3. An applicant has a right of access and correction with respect to his/her personal data as provided under the Personal Data (Privacy) Ordinance (Cap. 486). Request for personal data access and correction should be addressed to the Secretary of the Board at 15/F, North Point Government Offices, 333 Java Road, North Point, Hong Kong.

根據《個人資料(私隱)條例》(第486章)的規定，申請人有權查閱及更正其個人資料。如欲查閱及更正個人資料，應向委員會秘書提出有關要求，其地址為香港北角渣華道333號北角政府合署15樓。

Gist of Application 申請摘要

(Please provide details in both English and Chinese as far as possible. This part will be circulated to relevant consultees, uploaded to the Town Planning Board's Website for browsing and free downloading by the public and available at the Planning Enquiry Counters of the Planning Department for general information.)
(請盡量以英文及中文填寫。此部分將會發送予相關諮詢人士、上載至城市規劃委員會網頁供公眾免費瀏覽及下載及於規劃署規劃資料查詢處供一般參閱。)

Application No. 申請編號	(For Official Use Only) (請勿填寫此欄)	
Location/address 位置/地址	D.D 106-Lot 467 RP. Kam Sheung Road Kam Tin. Yuen Long. N.T.	
Site area 地盤面積	501 (includes Government land of 包括政府土地	sq. m 平方米 <input checked="" type="checkbox"/> About 約 sq. m 平方米 <input type="checkbox"/> About 約)
Plan 圖則	S/KL-KTS/15	
Zoning 地帶	Agriculture	
Type of Application 申請類別	<input type="checkbox"/> Temporary Use/Development in Rural Areas for a Period of 位於鄉郊地區的臨時用途/發展為期 <input checked="" type="checkbox"/> Year(s) 年 <u>3</u> <input type="checkbox"/> Month(s) 月 _____ <input type="checkbox"/> Renewal of Planning Approval for Temporary Use/Development in Rural Areas for a Period of 位於鄉郊地區臨時用途/發展的規劃許可續期為期 <input type="checkbox"/> Year(s) 年 _____ <input type="checkbox"/> Month(s) 月 _____	
Applied use/ development 申請用途/發展	臨時露天存放渠務工程物料	

(i) Gross floor area and/or plot ratio 總樓面面積及／或地積比率	Domestic 住用	sq.m 平方米	Plot Ratio 地積比率
	Non-domestic 非住用	<input type="checkbox"/> About 約 <input type="checkbox"/> Not more than 不多於 45.5	<input type="checkbox"/> About 約 <input type="checkbox"/> Not more than 不多於 0.09
(ii) No. of block 幢數	Domestic 住用		
	Non-domestic 非住用	1	
(iii) Building height/No. of storeys 建築物高度／層數	Domestic 住用	m 米 <input type="checkbox"/> (Not more than 不多於)	
		Storeys(s) 層 <input type="checkbox"/> (Not more than 不多於)	
	Non-domestic 非住用	m 米 2.9 <input type="checkbox"/> (Not more than 不多於)	
		Storeys(s) 層 一層 <input type="checkbox"/> (Not more than 不多於)	
(iv) Site coverage 上蓋面積	9 % <input checked="" type="checkbox"/> About 約		
(v) No. of parking spaces and loading / unloading spaces 停車位及上落客貨車位數目	Total no. of vehicle parking spaces 停車位總數		2 中型貨車 約2輛
	Private Car Parking Spaces 私家車車位 Motorcycle Parking Spaces 電單車車位 Light Goods Vehicle Parking Spaces 輕型貨車泊車位 Medium Goods Vehicle Parking Spaces 中型貨車泊車位 Heavy Goods Vehicle Parking Spaces 重型貨車泊車位 Others (Please Specify) 其他 (請列明) 		
	Total no. of vehicle loading/unloading bays/lays 上落客貨車位／停車處總數		
	Taxi Spaces 的士車位 Coach Spaces 旅遊巴車位 Light Goods Vehicle Spaces 輕型貨車車位 Medium Goods Vehicle Spaces 中型貨車車位 Heavy Goods Vehicle Spaces 重型貨車車位 Others (Please Specify) 其他 (請列明) 		

Submitted Plans, Drawings and Documents 提交的圖則、繪圖及文件

	Chinese 中文	English 英文
Plans and Drawings 圖則及繪圖		
Master layout plan(s)/Layout plan(s) 總綱發展藍圖/布局設計圖	<input checked="" type="checkbox"/>	<input type="checkbox"/>
Block plan(s) 樓宇位置圖	<input type="checkbox"/>	<input type="checkbox"/>
Floor plan(s) 樓宇平面圖	<input type="checkbox"/>	<input type="checkbox"/>
Sectional plan(s) 截視圖	<input type="checkbox"/>	<input type="checkbox"/>
Elevation(s) 立視圖	<input type="checkbox"/>	<input type="checkbox"/>
Photomontage(s) showing the proposed development 顯示擬議發展的合成照片	<input type="checkbox"/>	<input type="checkbox"/>
Master landscape plan(s)/Landscape plan(s) 園境設計總圖/園境設計圖	<input type="checkbox"/>	<input type="checkbox"/>
Others (please specify) 其他 (請註明)	<input checked="" type="checkbox"/>	<input type="checkbox"/>
位置圖		
Reports 報告書		
Planning Statement/Justifications 規劃綱領/理據	<input type="checkbox"/>	<input type="checkbox"/>
Environmental assessment (noise, air and/or water pollutions) 環境評估 (噪音、空氣及/或水的污染)	<input type="checkbox"/>	<input type="checkbox"/>
Traffic impact assessment (on vehicles) 就車輛的交通影響評估	<input type="checkbox"/>	<input type="checkbox"/>
Traffic impact assessment (on pedestrians) 就行人的交通影響評估	<input type="checkbox"/>	<input type="checkbox"/>
Visual impact assessment 視覺影響評估	<input type="checkbox"/>	<input type="checkbox"/>
Landscape impact assessment 景觀影響評估	<input type="checkbox"/>	<input type="checkbox"/>
Tree Survey 樹木調查	<input type="checkbox"/>	<input type="checkbox"/>
Geotechnical impact assessment 土力影響評估	<input type="checkbox"/>	<input type="checkbox"/>
Drainage impact assessment 排水影響評估	<input type="checkbox"/>	<input type="checkbox"/>
Sewerage impact assessment 排污影響評估	<input type="checkbox"/>	<input type="checkbox"/>
Risk Assessment 風險評估	<input type="checkbox"/>	<input type="checkbox"/>
Others (please specify) 其他 (請註明)	<input type="checkbox"/>	<input type="checkbox"/>

Note: May insert more than one 「✓」. 註：可在多於一個方格內加上「✓」號

Note: The information in the Gist of Application above is provided by the applicant for easy reference of the general public. Under no circumstances will the Town Planning Board accept any liabilities for the use of the information nor any inaccuracies or discrepancies of the information provided. In case of doubt, reference should always be made to the submission of the applicant.

註：上述申請摘要的資料是由申請人提供以方便市民大眾參考。對於所備資料在使用上的問題及文義上的歧異，城市規劃委員會概不負責。若有任何疑問，應查閱申請人提交的文件。

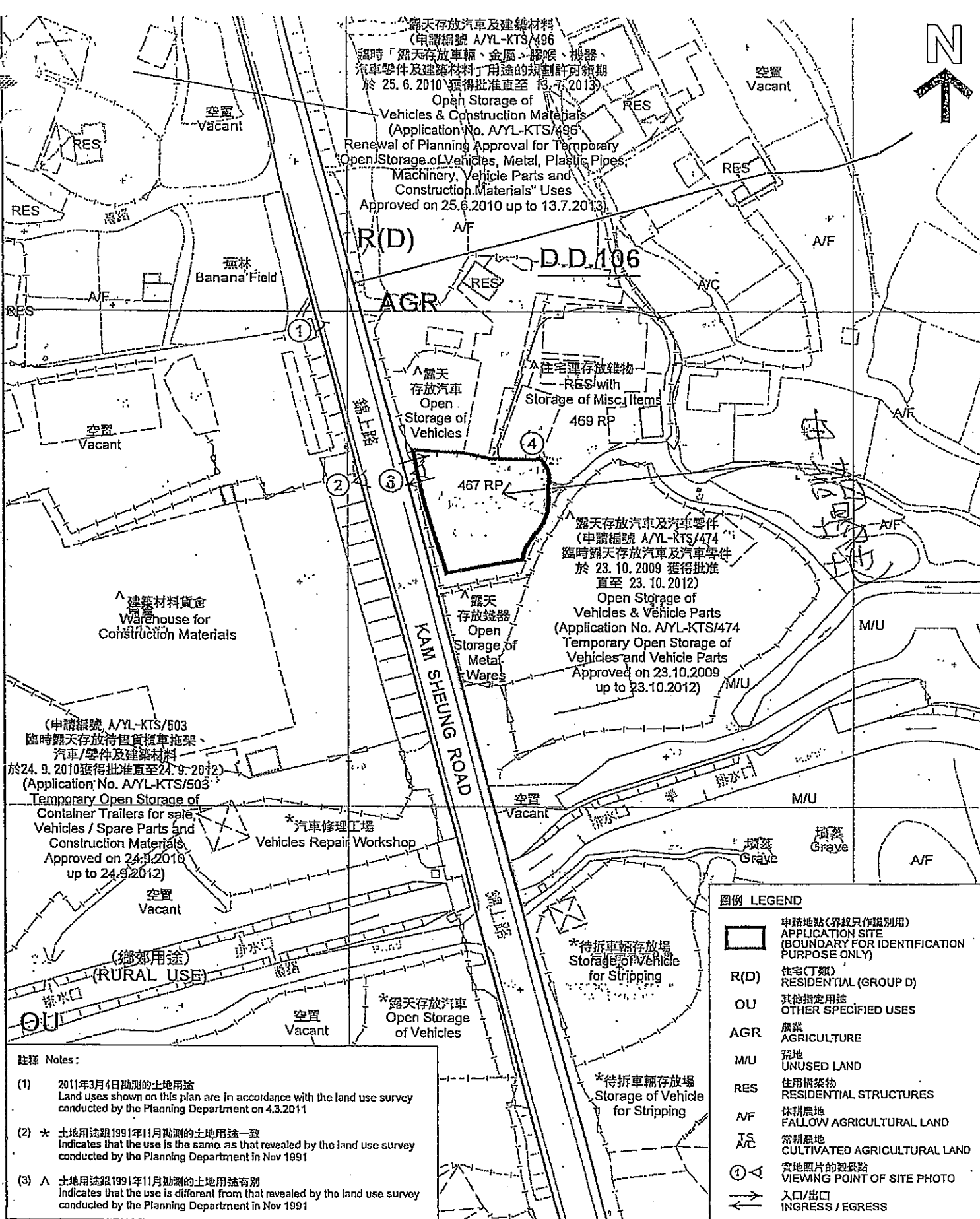

註釋 Notes:

- (1) 2011年3月4日勘測的土地用途
Land uses shown on this plan are in accordance with the land use survey conducted by the Planning Department on 4.3.2011
- (2) * 土地用途跟1991年11月勘測的土地用途一致
Indicates that the use is the same as that revealed by the land use survey conducted by the Planning Department in Nov 1991
- (3) A 土地用途跟1991年11月勘測的土地用途有別
Indicates that the use is different from that revealed by the land use survey conducted by the Planning Department in Nov 1991

圖例 LEGEND

- 申請地點(界線只作識別用)
APPLICATION SITE
(BOUNDARY FOR IDENTIFICATION
PURPOSE ONLY)
- R(D) 住宅(丁類)
RESIDENTIAL (GROUP D)
- OU 其他指定用途
OTHER SPECIFIED USES
- AGR 農業
AGRICULTURE
- M/U 荒地
UNUSED LAND
- RES 住用構築物
RESIDENTIAL STRUCTURES
- A/F 休耕農地
FALLOW AGRICULTURAL LAND
- A/C 常耕農地
CULTIVATED AGRICULTURAL LAND
- ① 實地照片的觀景點
VIEWING POINT OF SITE PHOTO
- 入口/出口
INGRESS / EGRESS

位置圖

大門口 2.4M高圍牆 469R.P 佈局設計圖(-)

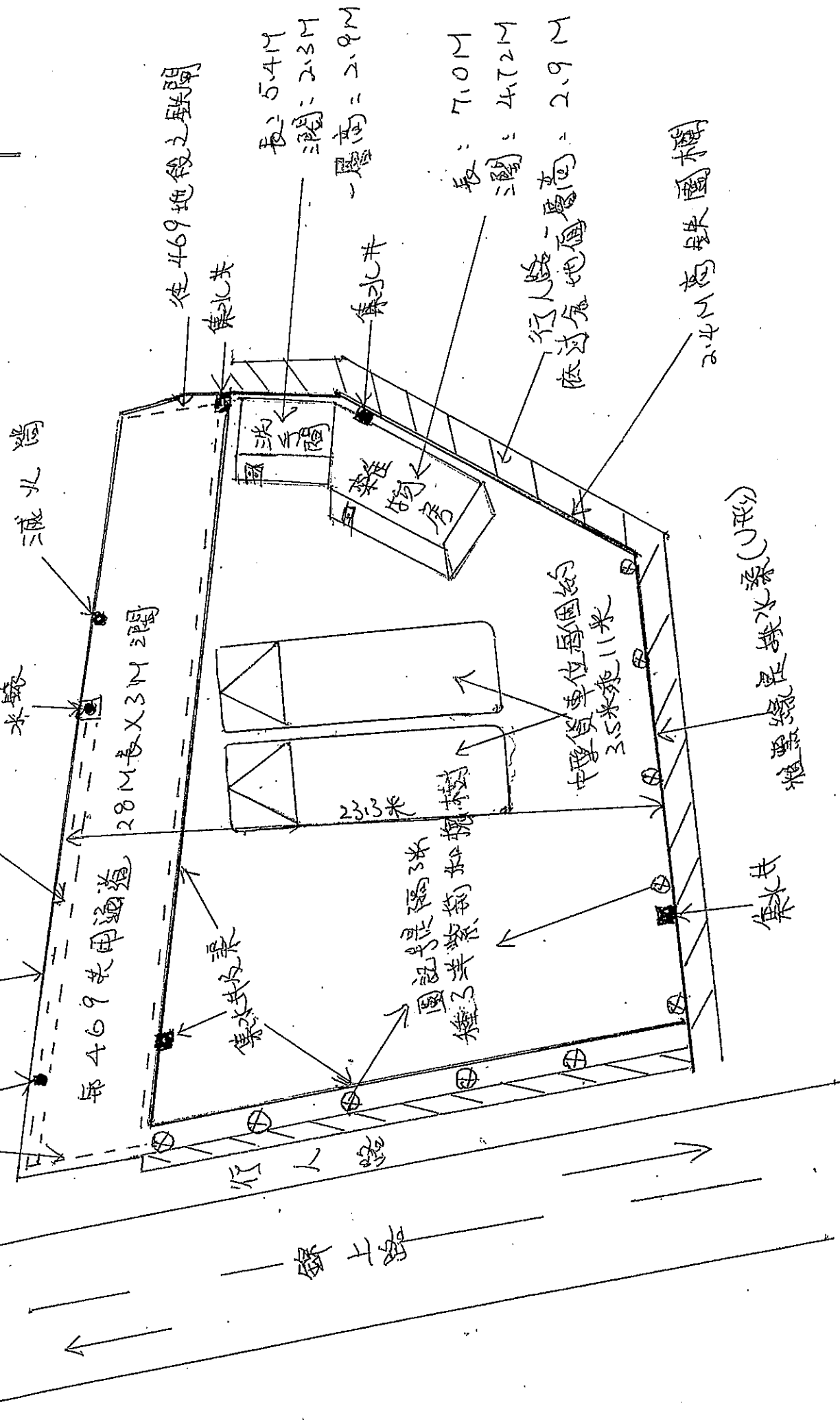

LOT 467 R.P 佈局設計圖 (二)

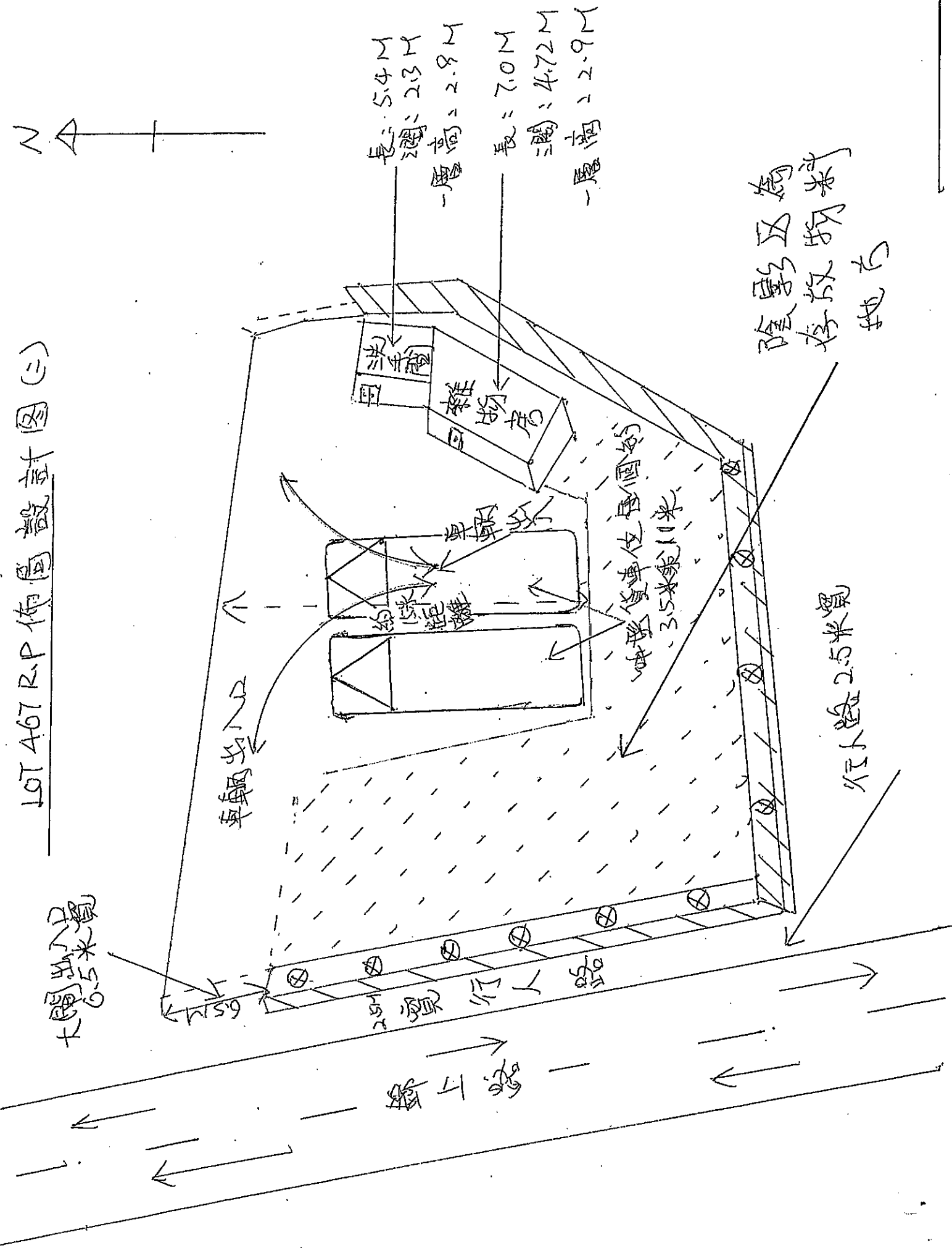
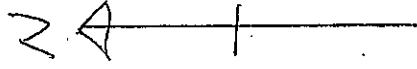

致城市規劃委員會

交運輸處

申請編號: A/YL-KTS/973

關於錦田錦上路 DD106 Lot 467 R.R. 的
規劃續期申請, 現付上平面圖一份及

① 上述地點早上只有約 1-2 輛
3.3 噸貨車出去工作, 至下午約
5:00 時收工才回來, 所以不會影響
錦上路的交通。

② 現付上門口圖 4 張以供參考。

申請人 龐偉賢上

25-9-2023

LOT 467 R.P. 平面圖 (二) 及運輸圖

申請編號 A/YL-KTS/973

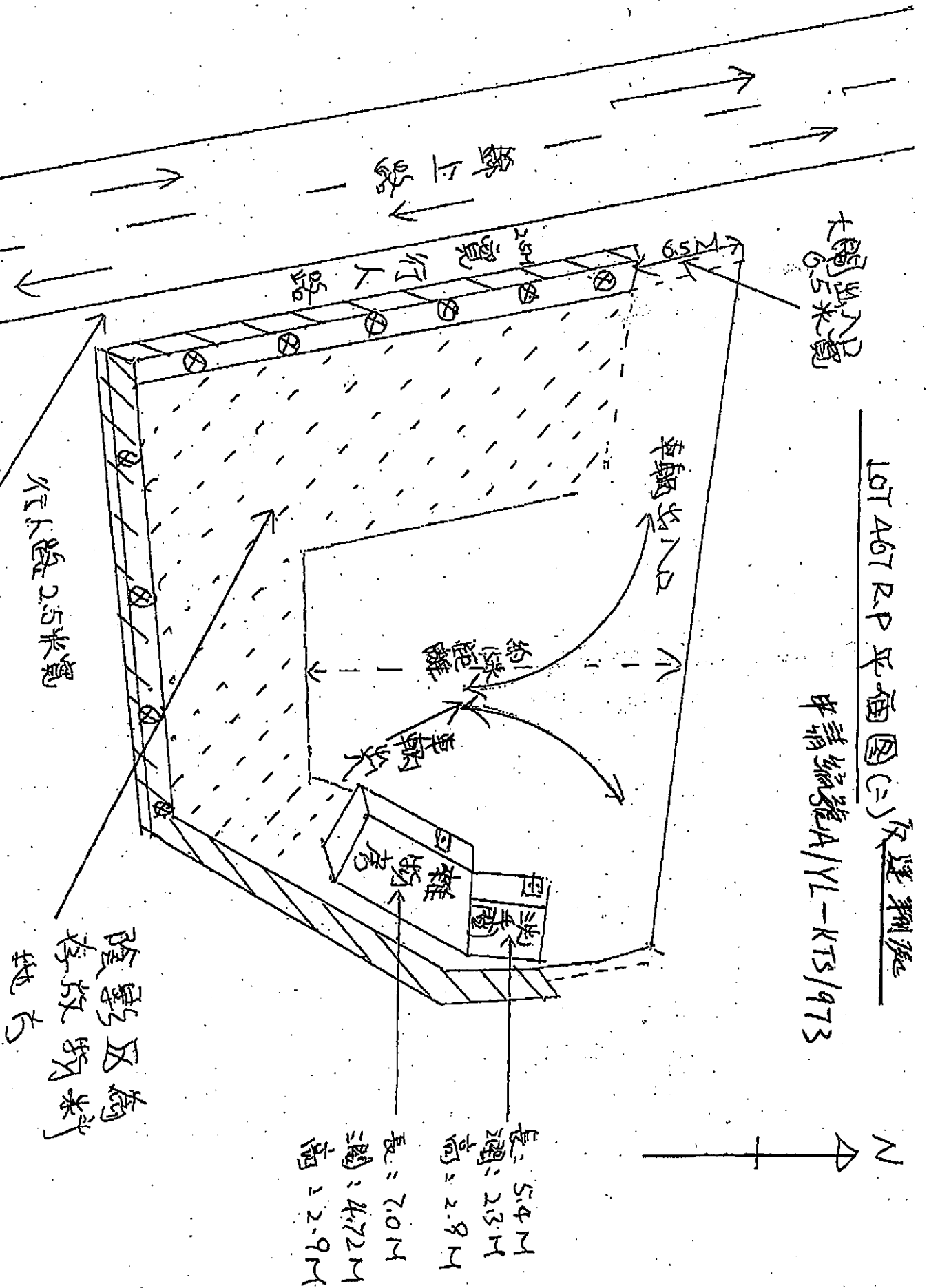

A/YL-KTS/973

交運輸處

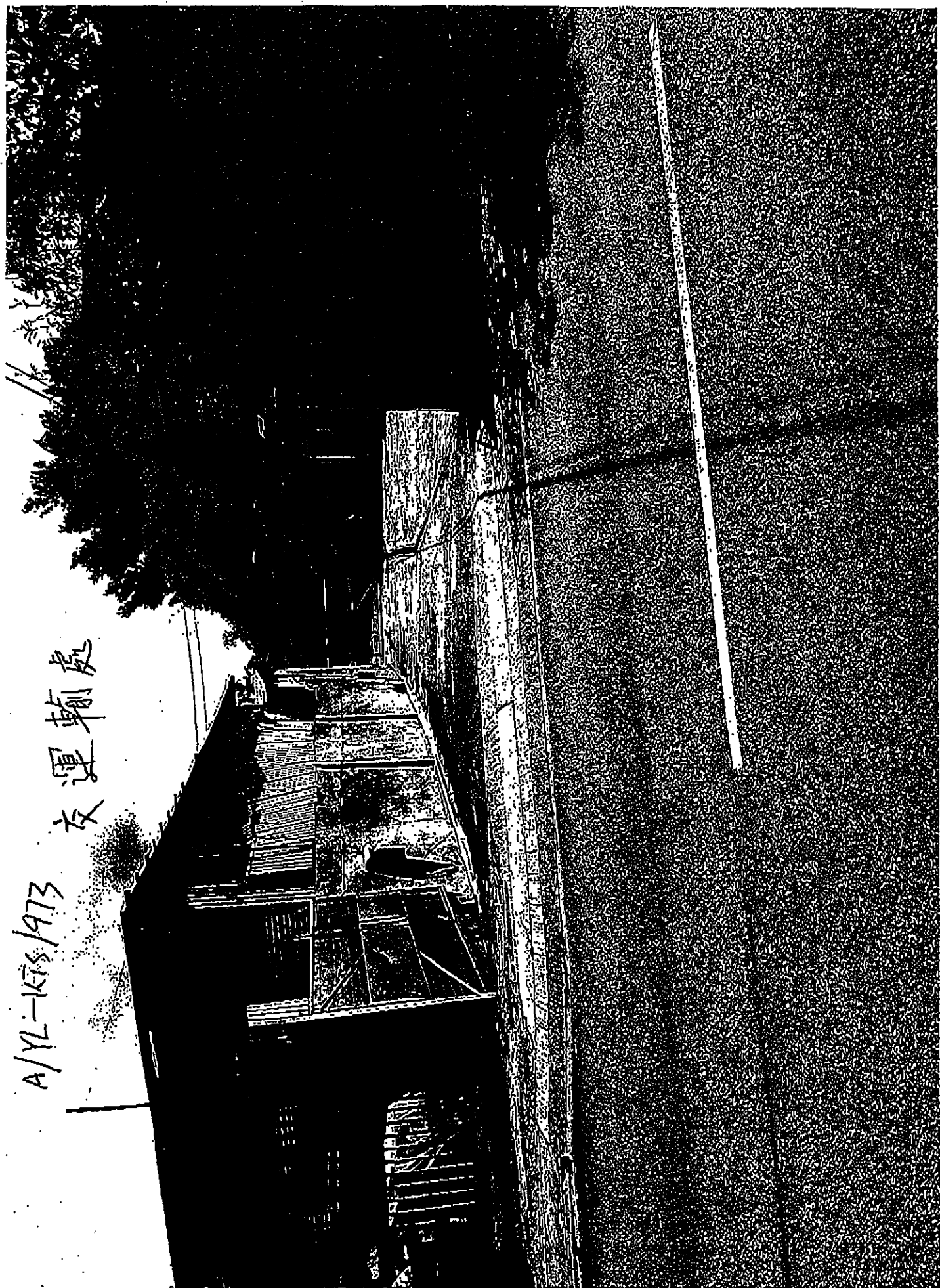

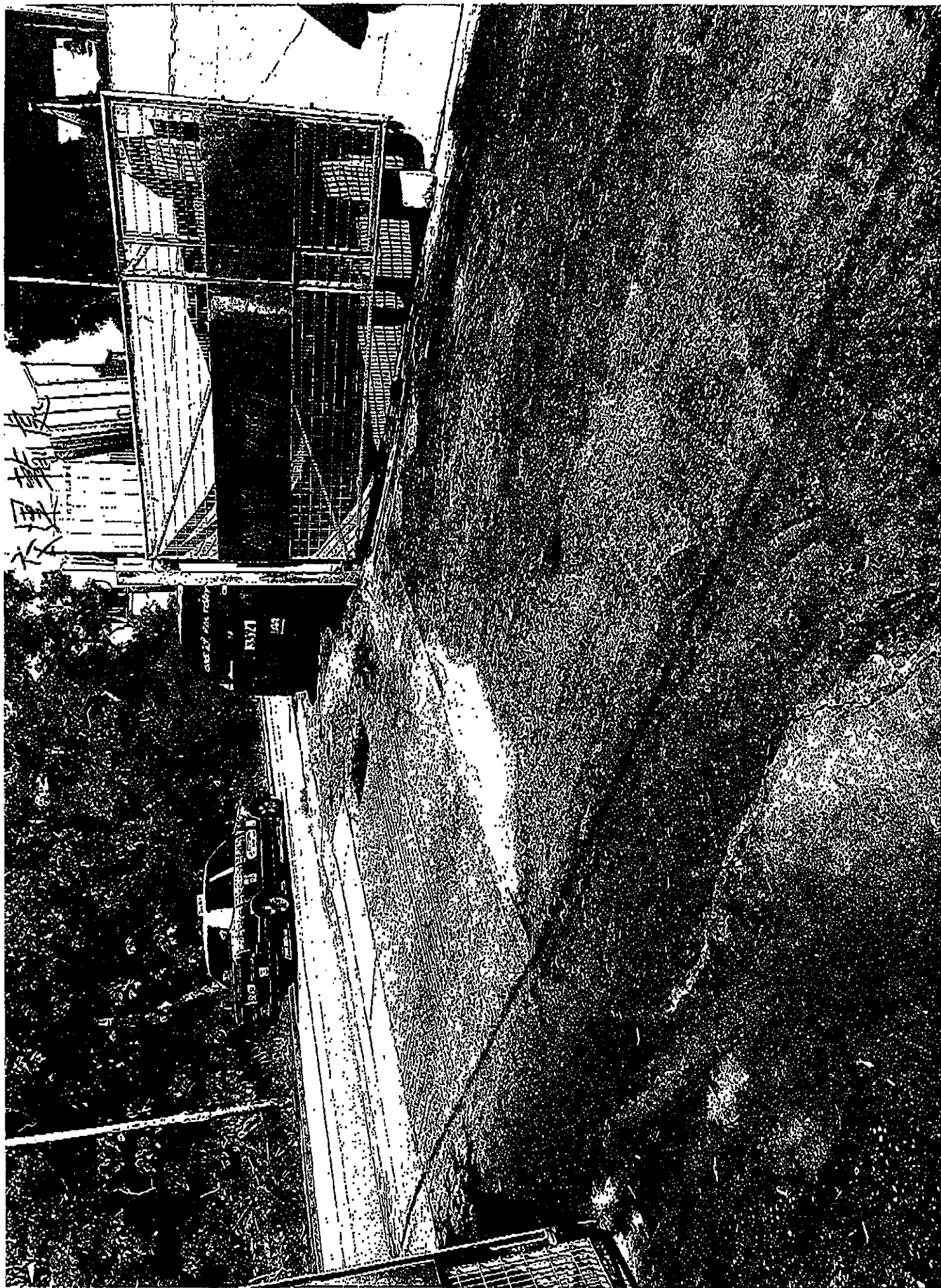

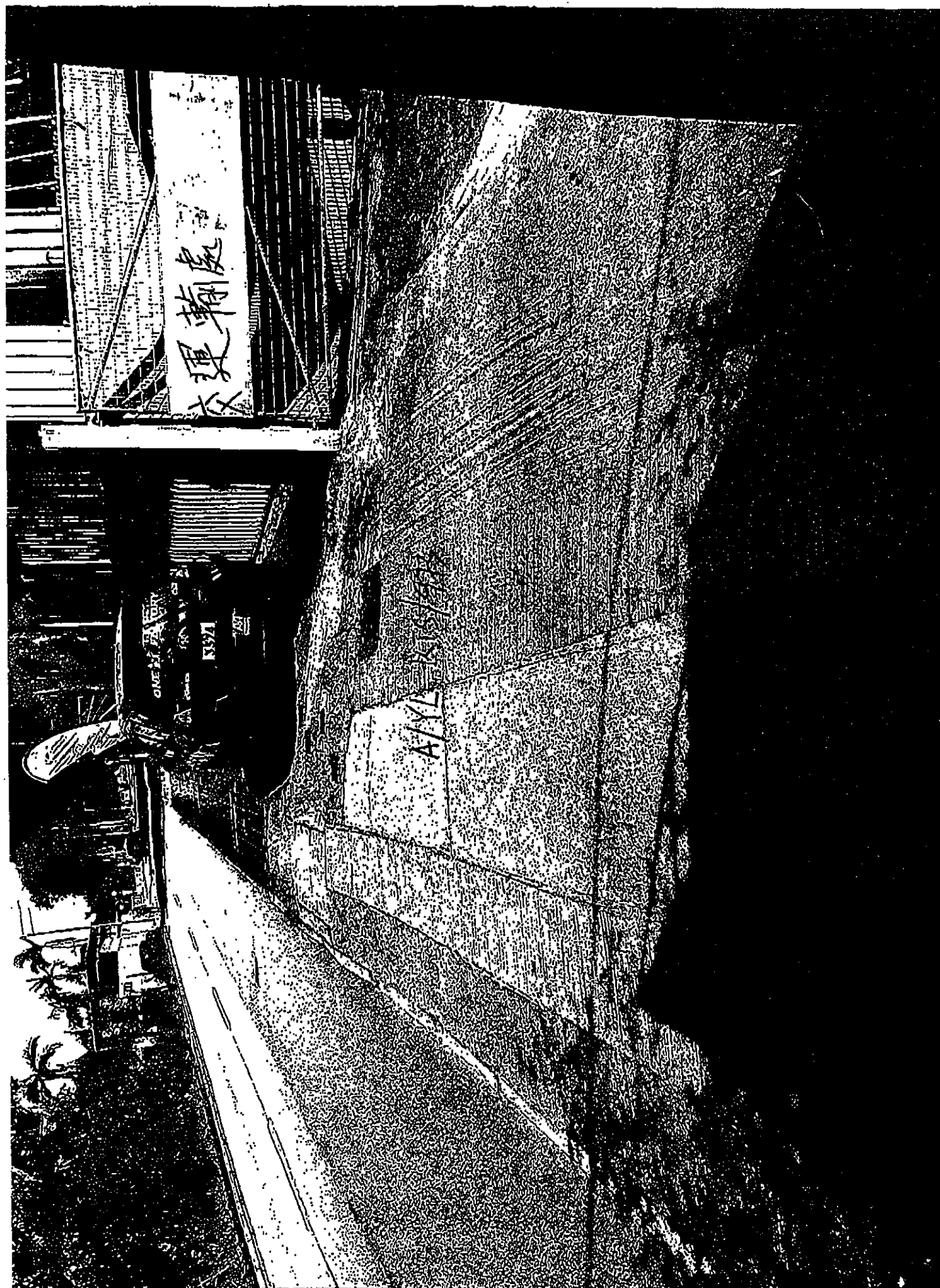



致城市規劃委員會

：交消防處

申請編號：A/YL-KTS/973

關於錦田錦上路 DD106 Lot 467 R.P 的規劃
續期申請。

- ① 現付上 Lot 467 R.P 平面圖一份，有滅火
筒的擺放位置及種類。
- ② F.S 251 一份
- ③ 幅地現時用途是露天存放有關渠務
工程的物料，如鐵圍欄，水馬，雪糕筒
水管設備……等。

申請人 龐偉賢 上

25-9-2023

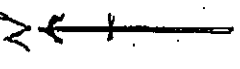

交通防處

A/YL-KTS/973

大園入口 24M高圍牆 防範土地

3條地下水管 不能種植

泡沫滅火筒 94AFF

水錶

泡沫滅火筒 94AFF

49千粉滅火筒

28M長X3M闊

水流火筒 94水

往469地段之鐵路

集水井

長= 5.4M
闊= 2.3M
高= 2.9M

集水井

長= 7.0M
闊= 4.72M
高= 2.9M

行人路 低過地地面

2.4M高鉄圍欄

植雲線區排水渠(U形)

集水井

圍記號隔3米 種3米紫荊如槐樹

錦上路

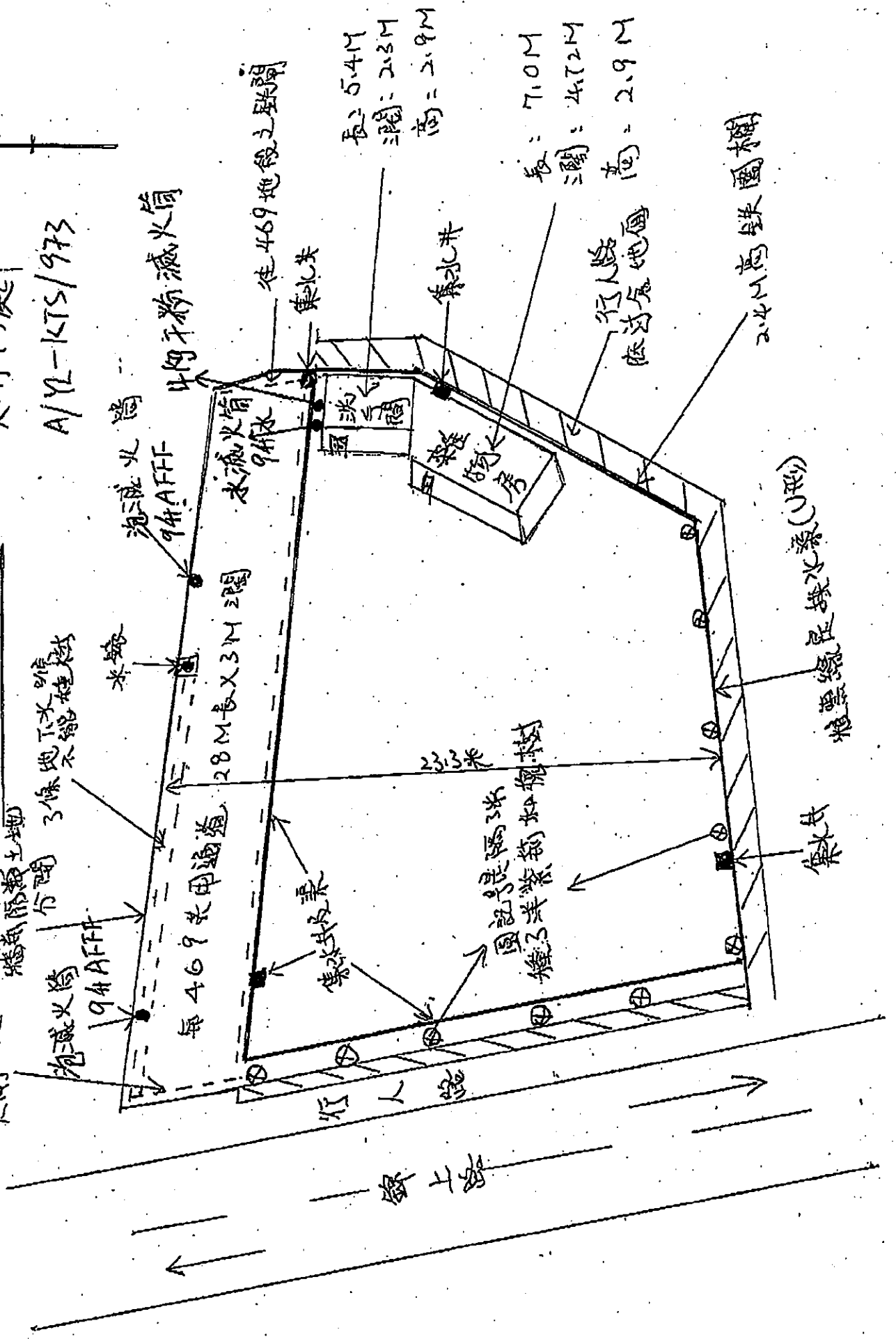

FSD Ref.: _____
消防處編號

FIRE SERVICE (INSTALLATIONS AND EQUIPMENT) REGULATIONS
消防(裝置及設備)規例
(Regulation 9(1))
(第九條(1)款)
CERTIFICATE OF FIRE SERVICE INSTALLATION AND EQUIPMENT
消防裝置及設備證書

Name of Client:

顧客姓名

恒通聚務有限公司

Name of Building:

樓宇名稱

Street No./Town Lot:

門牌號數/市地段

Lot 467 RP in D.D. 106

Street/Road/Estate Name:

街道/屋苑名稱

Kam Sheung Road

Block:

座

District:

分區

Yuen Long

Area:

地區

☐ HK

香港

☐ K

九龍

☒ NT

新界

Type of Building 樓宇類型:

☐ Industrial 工業

☐ Commercial 商業

☐ Domestic 住宅

☐ Composite 綜合

☐ Licensed premises 持牌處所

☐ Institutional 社團

Part 1 Annual Inspection ONLY
第一部 只適用於年檢事項

In accordance with Regulation 8(b) of Fire Service (Installations and Equipment) Regulations, the owner of any fire service installation or equipment which is installed in any premises shall have such fire service installation or equipment inspected by a registered contractor at least once in every 12 months. 根據消防(裝置及設備)規例第八條(b)款，屬有裝置在任何處所內的任何消防裝置或設備的人，須每隔12個月由一名註冊承辦商檢查該等消防裝置或設備至少一次。

Code/編號 (1-35)	Type of FSI 裝置類型	Location(s) 位置	Comment on Condition 狀況評述	Completion Date 完成日期(DD/MM/YY)	Next Due Date 下次到期日(DD/MM/YY)
			Nil		

Part 2 第二部 Installation / Modification / Repair / Inspection work 裝置/改裝/修理/檢查工作

Code/編號 (1-35)	Type of FSI 裝置類型	Location(s) 位置	Nature of Work Carried out 完成之工作內容	Comment on Condition 狀況評述	Completion Date 完成日期(DD/MM/YY)
24	2 x 9L Foam type F. E.	G/F	To replacement	Conforms with	15-8-2023
24	1 x 9L Water type F. E.	"	"	FSD requirement	"
24	1 x 4kg Dry Powder type F.E.	"	"	"	"

Part 3 第三部 Defects 損壞事項

Code/編號 (1-35)	Type of FSI 裝置類型	Location(s) 位置	Outstanding Defects 未修缺點	Comment on Defects 缺點評述
			Nil	

I/We hereby certify that the above installation/equipment have been tested and found to be in efficient working order in accordance with the Codes of Practice for Minimum Fire Service Installations and Equipment and Inspection, Testing and Maintenance of Installations and Equipment published to time by the Director of Fire Services. Defects are listed in Part 3.

本人特此證明以上之消防裝置及設備經試驗，證明性能良好，符合消防處處長不時公佈之最低限度之消防裝置及設備守則與該守則所載之裝置之檢查測試及保養守則的規格。損壞事項列於第三部。

Authorized
Signature:
授權人簽署

Name:

姓名

FSD/RC No.:

消防處註冊號碼

Company Name:
公司名稱

Telephone:
聯絡電話

Date:

日期

LAM KAI MING

MAN ON FIRE ENG. CO.

15-8-2023

For FSD
use only:

Inspected

Key-in

Verified

如證書涉及年檢事項，應張貼於大廈
或處所當眼處以供消防處人員查核

This certificate should be displayed at prominent location of the building or premises
for FSD's inspection if any annual maintenance work is involved.

**Relevant Extracts of Town Planning Board Guidelines on
Application for Open Storage and Port Back-up Uses
(TPB PG-No.13G)**

1. On 14.4.2023, the Town Planning Board Guidelines for Application for Open Storage and Port Back-up Uses under Section 16 of the Town Planning Ordinance (TPB PG-No. 13G) were promulgated, which set out the following criteria for the various categories of area:
 - (a) Category 1 areas: favourable consideration will normally be given to applications within these areas, subject to no major adverse departmental comments and local objections, or the concerns of the departments and local residents can be addressed through the implementation of approval conditions. Technical assessments should be submitted if the proposed uses may cause significant environmental and traffic concerns;
 - (b) Category 2 areas: planning permission could be granted on a temporary basis up to a maximum period of 3 years, subject to no adverse departmental comments and local objections, or the concerns of the departments and local residents can be addressed through the implementation of approval conditions. Technical assessments, where appropriate, should be submitted to demonstrate that the proposed uses would not have adverse drainage, traffic, visual, landscaping and environmental impacts on the surrounding areas;
 - (c) Category 3 areas: applications would normally not be favourably considered unless the applications are on sites with previous planning approvals (irrespective of whether the application is submitted by the applicant of previous approval or a different applicant). Sympathetic consideration may be given if genuine efforts have been demonstrated in compliance with approval conditions of the previous planning applications and/or relevant technical assessments/proposals have been included in the fresh applications, if required, to demonstrate that the proposed uses would not generate adverse drainage, traffic, visual, landscaping and environmental impacts on the surrounding areas. Planning permission could be granted on a temporary basis up to a maximum period of 3 years, subject to no adverse departmental comments and local objections, or the concerns of the departments and local residents can be addressed through the implementation of approval conditions; and
 - (d) Category 4 areas: applications would normally be rejected except under exceptional circumstances. For applications on sites with previous planning approvals (irrespective of whether the application is submitted by the applicant of previous approval or a different applicant), and subject to no adverse departmental comments and local objections, sympathetic consideration may be given if genuine efforts have been demonstrated in compliance with approval conditions of the previous planning applications and/or relevant technical assessments/proposals have been included in the fresh applications, if required, to demonstrate that the proposed uses would not generate adverse drainage, traffic, visual, landscaping and environmental impacts on the surrounding areas. The intention is however to encourage the phasing out of such non-conforming uses as early as possible. A maximum period of 3 years may be allowed for an applicant to identify suitable sites for relocation. Application for renewal of approval will be assessed on its individual merits.

2. In assessing applications for open storage and port back-up uses, the other major relevant assessment criteria are also summarized as follows:
 - (a) port back-up sites and those types of open storage uses generating adverse noise, air pollution, visual intrusion and frequent heavy vehicle traffic should not be located adjacent to sensitive receivers such as residential dwellings, hospitals, schools and other community facilities;
 - (b) port back-up uses are major generators of traffic, with container trailer/tractor parks generating the highest traffic per unit area. In general, port back-up sites should have good access to the strategic road network, or be accessed by means of purpose built roads;
 - (c) adequate screening of sites through landscaping and/or fencing should be considered where sites are located adjacent to public roads or are visible from surrounding residential areas;
 - (d) there is a general presumption against conversion of active or good quality agricultural land and fish ponds to other uses on an ad-hoc basis. For flood prone areas or sites which would obstruct natural drainage channels and overland flow, advice should be sought; and
 - (e) for applications involving sites with previous planning approvals, should there be no evidence to demonstrate that the applicants have made any genuine effort to comply with the approval conditions of the previous planning applications, planning permission may be refused notwithstanding other criteria set out in the Guidelines are complied with.

Previous s.16 Applications covering the Application Site

Approved Applications

Application No.	Use/Development	Date of Consideration
A/YL-KTS/145	Temporary Open Storage of Vehicles and Vehicle Parts for a Period of 12 months	8.1.1999
A/YL-KTS/209	Temporary Open Storage of Vehicles and Vehicle Parts for a Period of 3 Years	5.5.2000 (Revoked on 5.2.2001)
A/YL-KTS/262	Temporary Open Storage of Vehicles (Pending Repair and Insurance Compensation) and Spare Parts for a Period of 3 Years	11.1.2002
A/YL-KTS/339	Temporary Open Storage of Vehicles (Pending Repair and Insurance Compensation) and Spare Parts for a Period of 3 Years	18.3.2005
A/YL-KTS/419	Temporary Open Storage of Vehicles (Pending Repair and Insurance Compensation) and Spare Parts for a Period of 3 Years	18.4.2008
A/YL-KTS/530	Renewal of Planning Approval for "Temporary Open Storage of Vehicles (Pending Repair and Insurance Compensation) and Spare Parts" under Application No. A/YL-KTS/419 for a Period of 3 Years	15.4.2011
A/YL-KTS/636	Renewal of Planning Approval for "Temporary Open Storage of Vehicles (Pending Repair and Insurance Compensation) and Spare Parts" under Application No. A/YL-KTS/530 for a Period of 3 Years	4.4.2014 (Revoked on 30.5.2014)
A/YL-KTS/652	Temporary Open Storage of Vehicles (Pending Repair and Insurance Compensation) and Spare Parts for a Period of 3 Years	31.10.2014

Application No.	Use/Development	Date of Consideration
A/YL-KTS/750	Renewal of Planning Approval for "Temporary Open Storage of Vehicles (Pending Repair and Insurance Compensation) and Spare Parts" for a Period of 3 Years	22.9.2017
A/YL-KTS/858	Renewal of Planning Approval for Temporary Open Storage of Vehicles (Pending Repair and Insurance Compensation) and Spare Parts for a Period of 3 Years	23.10.2020

Similar s.16 Applications within the same "AGR" Zone in the vicinity of the Site in the past 5 years

Approved Applications

Application No.	Use/Development	Date of Consideration
A/YL-KTS/798	Renewal of Planning Approval for Temporary "Open Storage of Vehicles and Vehicle Parts" for a Period of 3 Years	19.10.2018
A/YL-KTS/905	Renewal of Planning Approval for Temporary Open Storage of Vehicles and Vehicle Parts for a Period of 3 Years	15.10.2021

Government Departments' General Comments

1. Land Administration

Comments of the District Lands Officer/Yuen Long, Lands Department (DLO/YL, LandsD):

- no adverse comment on the application;
- the application site (the Site) comprises an Old Schedule Agricultural Lot held under the Block Government Lease which contains the restriction that no structures are allowed to be erected without the prior approval of the Government; and
- within the Site, the private lot is covered by Short Term Waiver (STW) No. 2785 for the purpose of Ancillary Use to Open Storage of Vehicles and Spare Parts.

2. Traffic

Comments of the Commissioner for Transport (C for T):

- no comment on the application from traffic engineering perspective.

Comments of the Chief Highway Engineer/New Territories West, Highways Department (CHE/NTW, HyD):

- no comment on the application from highways maintenance perspective.

3. Drainage

Comments of the Chief Engineer/Mainland North, Drainage Services Department (CE/MN, DSD):

- no objection in-principle to the application; and
- should the application be approved, the applicants are required to maintain the existing drainage facilities implemented under the previous planning application and submit condition records of the existing drainage facilities to the satisfaction of the Director of Drainage Services or of the Town Planning Board.

4. Fire Safety

Comments of the Director of Fire Services (D of FS):

- no objection in-principle to the application subject to the existing fire service installations (FSIs) implemented on the Site being maintained in an efficient working order at all times.

5. **Landscape**

Comments of the Chief Town Planner/Urban Design and Landscape, Planning Department (CTP/UD&L, PlanD):

- no objection to the application from landscape planning perspective;
- the Site is located in an area of miscellaneous rural fringe landscape character comprising temporary structures, open storage, village houses and scattered tree groups. The proposed development is not incompatible with surrounding landscape character; and
- the Site is fenced off, hard paved with some temporary structures. Some existing trees of common species are observed within the application site boundary. According to the applicant, there are existing trees along the western and southern site boundary and no tree felling is involved. Significant adverse impact on landscape resources is not anticipated.

6. **Building Matters**

Comments of the Chief Building Surveyor/New Territories West, Buildings Department (CBS/NTW, BD):

- no objection to the applied use on the Site; and
- there is no record of approval by the Building Authority for the structures existing at the Site and BD is not in a position to offer comments on their suitability for the use related to the application.

7. **District Officer's Comments**

Comments of the District Officer (Yuen Long), Home Affairs Department (DO(YL), HAD):

- his office has not received any local's comment on the application and he has no particular comment on the application.

8. **Other Departments**

The following government departments have no objection to / no adverse comment / no comment on the application:

- the Project Manager (West), Civil Engineering and Development Department (PM(W), CEDD);
- the Chief Engineer/Construction, Water Supplies Department (CE/C, WSD);
- the Director of Electrical and Mechanical Services (DEMS); and
- the Commissioner of Police (C of P).

Recommended Advisory Clauses

- (a) to note the comments of the District Lands Officer/Yuen Long, Lands Department (DLO/YL, LandsD) that:
- should planning approval be given to the application, the Short Term Wavier (STW) holder(s) will need to apply to this office for modification of the STW conditions where appropriate, if any. Besides, given the proposed use is temporary in nature, only application for regularisation or erection of temporary structure(s) will be considered. Applications for any of the above will be considered by the LandsD acting in the capacity of the landlord or lessor at its sole discretion and there is no guarantee that such application will be approved. If such application is approved, it will be subject to such terms and conditions, including among others the payment of rent or fee, as may be imposed by the LandsD;
- (b) to note the comments of the Commissioner for Transport (C for T) that:
- the application site (the Site) is connected to the public road network via a section of a local access road which is not managed by Transport Department. The land status of the local access road should be checked with the LandsD. Moreover, the management and maintenance responsibilities of the local access road should be clarified with the relevant lands and maintenance authorities accordingly. Sufficient manoeuvring space shall be provided within the Site. No vehicle is allowed to queue back to or reverse onto / from public road at any time during the planning approval period;
- (c) to note the comments of the Chief Highway Engineer/New Territories West, Highways Department (CHE/NTW, HyD) that:
- HyD shall not be responsible for the maintenance of any access connecting the Site and Kam Sheung Road; and
 - adequate drainage measures should be provided to prevent surface water running from the Site to the nearby public road and drains;
- (d) to note the comments of the Director of Environmental Protection (DEP) that:
- the applicant is advised to follow the relevant mitigation measures and requirements in the latest “Code of Practice on Handling the Environmental Aspects of Temporary uses and Open Storage Sites” issued by DEP;
- (e) to note the comments of the Chief Building Surveyor/New Territories West, Buildings Department (CBS/NTW, BD) that:
- if the existing structures are erected on leased land without approval of the BD, they are unauthorised under the Buildings Ordinance (BO) and should not be designated for any approved use under the application;
 - before any new building works are to be carried out on the application site, the prior approval and consent of the Building Authority (BA) should be obtained, otherwise they are unauthorised building works (UBW). An Authorised Person (AP) should be appointed as the co-ordinator for the proposed building works in accordance with the BO;

- if the Site does not abut on a specified street having a width of not less than 4.5m wide, the development intensity shall be determined under the Building (Planning) Regulations (B(P)R) 19(3) at building plan submission stage. The Site shall be provided with means of obtaining access thereto from a street under the B(P)R 5 and emergency vehicular access shall be provided under the B(P)R 41D; and
- for UBW erected on leased land, enforcement action may be taken by the BA to effect their removal in accordance with BD's enforcement policy against UBW as and when necessary. The granting of any planning approval should not be construed as an acceptance of any existing building works or UBW on the Site under the BO.