

2024年 3月 1 23

Appendix I of RNTPC
Paper No. A/YL-PH/1001

此文件在 收到・城市規劃委員會
及文件後才正式確認收到
申請

The application received on 12 MAR 2024
The Planning Board will formally acknowledge
the date of receipt of the application only upon receipt
of all the required information and documents.

Form No. S16-III
表格第 S16-III 號

**APPLICATION FOR PERMISSION
UNDER SECTION 16 OF
THE TOWN PLANNING ORDINANCE
(CAP. 131)**

根據《城市規劃條例》(第131章)
第16條遞交的許可申請

**Applicable to Proposal Only Involving Temporary Use/Development of Land
and/or Building Not Exceeding 3 Years in Rural Areas or Regulated Areas,
or Renewal of Permission for such Temporary Use or Development***

**適用於祇涉及位於鄉郊地區或受規管地區土地上及/或建築物內進行
為期不超過三年的臨時用途/發展或該等臨時用途/發展的許可續期的建議***

**Form No. S16-I should be used for other Temporary Use/Development of Land and/or Building (e.g. temporary use/developments in the Urban Area) and Renewal of Permission for such Temporary Use or Development.*

**其他土地上及/或建築物內的臨時用途/發展 (例如位於市區內的臨時用途或發展) 及有關該等臨時用途/發展的許可續期，應使用表格第 S16-I 號。*

Applicant who would like to publish the notice of application in local newspapers to meet one of the Town Planning Board's requirements of taking reasonable steps to obtain consent of or give notification to the current land owner, please refer to the following link regarding publishing the notice in the designated newspapers:
https://www.tpb.gov.hk/en/plan_application/apply.html

申請人如欲在本地報章刊登申請通知，以採取城市規劃委員會就取得現行土地擁有人的同意或通知現行土地擁有人所指定的其中一項合理步驟，請瀏覽以下網址有關在指定的報章刊登通知：
https://www.tpb.gov.hk/tc/plan_application/apply.html

General Note and Annotation for the Form

填寫表格的一般指引及註解

"Current land owner" means any person whose name is registered in the Land Registry as that of an owner of the land to which the application relates, as at 6 weeks before the application is made

「現行土地擁有人」指在提出申請前六星期，其姓名或名稱已在土地註冊處註冊為該申請所關乎的土地的擁有人的人

& Please attach documentary proof 請夾附證明文件

^ Please insert number where appropriate 請在適當地方註明編號

Please fill "NA" for inapplicable item 請在不適用的項目填寫「不適用」

Please use separate sheets if the space provided is insufficient 如所提供的空間不足，請另頁說明

Please insert a 「✓」 at the appropriate box 請在適當的方格內上加上「✓」號

2400611 5/3 by hand

Form No. S16-III 表格第 S16-III 號

For Official Use Only 請勿填寫此欄	Application No. 申請編號	A/46-PH/1001
	Date Received 收到日期	12 MAR 2024

- The completed form and supporting documents (if any) should be sent to the Secretary, Town Planning Board (the Board), 15/F, North Point Government Offices, 333 Java Road, North Point, Hong Kong.
申請人須把填妥的申請表格及其他支持申請的文件 (倘有), 送交香港北角渣華道 333 號北角政府合署 15 樓城市規劃委員會(下稱「委員會」)秘書收。
- Please read the "Guidance Notes" carefully before you fill in this form. The document can be downloaded from the Board's website at <http://www.tpb.gov.hk/>. It can also be obtained from the Secretariat of the Board at 15/F, North Point Government Offices, 333 Java Road, North Point, Hong Kong (Tel: 2231 4810 or 2231 4835), and the Planning Enquiry Counters of the Planning Department (Hotline: 2231 5000) (17/F, North Point Government Offices, 333 Java Road, North Point, Hong Kong and 14/F, Sha Tin Government Offices, 1 Sheung Wo Che Road, Sha Tin, New Territories).
請先細閱《申請須知》的資料單張, 然後填寫此表格。該份文件可從委員會的網頁下載 (網址: <http://www.tpb.gov.hk/>), 亦可向委員會秘書處 (香港北角渣華道 333 號北角政府合署 15 樓 - 電話: 2231 4810 或 2231 4835) 及規劃署的規劃資料查詢處 (熱線: 2231 5000) (香港北角渣華道 333 號北角政府合署 17 樓及新界沙田上禾輋路 1 號沙田政府合署 14 樓) 索取。
- This form can be downloaded from the Board's website, and obtained from the Secretariat of the Board and the Planning Enquiry Counters of the Planning Department. The form should be typed or completed in block letters. The processing of the application may be refused if the required information or the required copies are incomplete.
此表格可從委員會的網頁下載, 亦可向委員會秘書處及規劃署的規劃資料查詢處索取。申請人須以打印方式或以正楷填寫表格。如果申請人所提交的資料或文件副本不齊全, 委員會可拒絕處理有關申請。

1. Name of Applicant 申請人姓名/名稱

(☐ Mr. 先生 / ☐ Mrs. 夫人 / ☐ Miss 小姐 / ☐ Ms. 女士 / ☒ Company 公司 / ☐ Organisation 機構)

志科有限公司 CHIEF FORCE LIMITED

2. Name of Authorised Agent (if applicable) 獲授權代理人姓名/名稱 (如適用)

(☐ Mr. 先生 / ☐ Mrs. 夫人 / ☐ Miss 小姐 / ☐ Ms. 女士 / ☐ Company 公司 / ☐ Organisation 機構)

3. Application Site 申請地點

(a) Full address / location / demarcation district and lot number (if applicable) 詳細地址/地點/丈量約份及地段號碼 (如適用)	元朗八鄉丈量約份第111約地段第2901號(部分)、第2902號(部分)、第2904號(部分)、第2905號(部分)、第2909號(部分)及第2911號(部分)和毗連政府土地	
(b) Site area and/or gross floor area involved 涉及的地盤面積及/或總樓面面積	<input checked="" type="checkbox"/> Site area 地盤面積 2162.31 sq.m 平方米 <input checked="" type="checkbox"/> About 約 <input checked="" type="checkbox"/> Gross floor area 總樓面面積 420 sq.m 平方米 <input checked="" type="checkbox"/> About 約	
(c) Area of Government land included (if any) 所包括的政府土地面積 (倘有)	298.5 sq.m 平方米	<input checked="" type="checkbox"/> About 約

(d) Name and number of the related statutory plan(s) 有關法定圖則的名稱及編號	S/YL-PH/11
(e) Land use zone(s) involved 涉及的土地用途地帶	住宅(丁類)
(f) Current use(s) 現時用途	臨時露天存放建築材料及汽車零件 (If there are any Government, institution or community facilities, please illustrate on plan and specify the use and gross floor area) (如有任何政府、機構或社區設施，請在圖則上顯示，並註明用途及總樓面面積)

4. "Current Land Owner" of Application Site 申請地點的「現行土地擁有人」

The applicant 申請人 -

- ☐ is the sole "current land owner" (please proceed to Part 6 and attach documentary proof of ownership).
是唯一的「現行土地擁有人」(請繼續填寫第 6 部分，並夾附業權證明文件)。
- ☐ is one of the "current land owners" (please attach documentary proof of ownership).
是其中一名「現行土地擁有人」(請夾附業權證明文件)。
- ☒ is not a "current land owner".
並不是「現行土地擁有人」。

- ☐ The application site is entirely on Government land (please proceed to Part 6).
申請地點完全位於政府土地上(請繼續填寫第 6 部分)。

5. Statement on Owner's Consent/Notification

就土地擁有人的同意/通知土地擁有人的陳述

- (a) According to the record(s) of the Land Registry as at (DD/MM/YYYY), this application involves a total of "current land owner(s)".
根據土地註冊處截至 年 月 日的記錄，這宗申請共牽涉 名「現行土地擁有人」。

(b) The applicant 申請人 -

- ☐ has obtained consent(s) of "current land owner(s)".
已取得 名「現行土地擁有人」的同意。

Details of consent of "current land owner(s)" obtained 取得「現行土地擁有人」同意的詳情		
No. of 'Current Land Owner(s)' 「現行土地擁有人」數目	Lot number/address of premises as shown in the record of the Land Registry where consent(s) has/have been obtained 根據土地註冊處記錄已獲得同意的地段號碼/處所地址	Date of consent obtained (DD/MM/YYYY) 取得同意的日期 (日/月/年)

(Please use separate sheets if the space of any box above is insufficient. 如上列任何方格的空間不足，請另頁說明)

- ☐ has notified "current land owner(s)"#
已通知 名「現行土地擁有人」#。

Details of the "current land owner(s)"# notified 已獲通知「現行土地擁有人」#的詳細資料		
No. of 'Current Land Owner(s)' 「現行土地擁有人」數目	Lot number/address of premises as shown in the record of the Land Registry where notification(s) has/have been given 根據土地註冊處記錄已發出通知的地段號碼／處所地址	Date of notification given (DD/MM/YYYY) 通知日期(日/月/年)

(Please use separate sheets if the space of any box above is insufficient. 如上列任何方格的空間不足，請另頁說明)

- ☒ has taken reasonable steps to obtain consent of or give notification to owner(s):
已採取合理步驟以取得土地擁有人的同意或向該人發給通知。詳情如下：

Reasonable Steps to Obtain Consent of Owner(s) 取得土地擁有人的同意所採取的合理步驟

- ☐ sent request for consent to the "current land owner(s)" on _____ (DD/MM/YYYY)#&
於 _____ (日/月/年)向每一名「現行土地擁有人」#遞送要求同意書&

Reasonable Steps to Give Notification to Owner(s) 向土地擁有人發出通知所採取的合理步驟

- ☐ published notices in local newspapers on _____ (DD/MM/YYYY)&
於 _____ (日/月/年)在指定報章就申請刊登一次通知&

- ☒ posted notice in a prominent position on or near application site/premises on _____ (DD/MM/YYYY)&
於 19/02/2024 (日/月/年)在申請地點／申請處所或附近的顯明位置貼出關於該申請的通知&

- ☒ sent notice to relevant owners' corporation(s)/owners' committee(s)/mutual aid committee(s)/management office(s) or rural committee on _____ (DD/MM/YYYY)&
於 19/02/2024 (日/月/年)把通知寄往相關的業主立案法團/業主委員會/互助委員會或管理處，或有關的鄉事委員會&

Others 其他

- ☐ others (please specify)
其他（請指明）

Note: May insert more than one 「✓」.

Information should be provided on the basis of each and every lot (if applicable) and premises (if any) in respect of the application.

註：可在多於一個方格內加上「✓」號

申請人須就申請涉及的每一地段（倘適用）及處所（倘有）分別提供資料

6. Type(s) of Application 申請類別	
(A) Temporary Use/Development of Land and/or Building Not Exceeding 3 Years in Rural Areas or Regulated Areas 位於鄉郊地區或受規管地區土地上及/或建築物內進行為期不超過三年的臨時用途/發展 (For Renewal of Permission for Temporary Use or Development in Rural Areas or Regulated Areas, please proceed to Part (B)) (如屬位於鄉郊地區或受規管地區臨時用途/發展的規劃許可續期，請填寫(B)部分)	
(a) Proposed use(s)/development 擬議用途/發展	(Please illustrate the details of the proposal on a layout plan) (請用平面圖說明擬議詳情)
(b) Effective period of permission applied for 申請的許可有效期	<input type="checkbox"/> year(s) 年 <input type="checkbox"/> month(s) 個月
(c) Development Schedule 發展細節表	
Proposed uncovered land area 擬議露天土地面積sq.m <input type="checkbox"/> About 約 Proposed covered land area 擬議有上蓋土地面積sq.m <input type="checkbox"/> About 約 Proposed number of buildings/structures 擬議建築物/構築物數目 Proposed domestic floor area 擬議住用樓面面積sq.m <input type="checkbox"/> About 約 Proposed non-domestic floor area 擬議非住用樓面面積sq.m <input type="checkbox"/> About 約 Proposed gross floor area 擬議總樓面面積sq.m <input type="checkbox"/> About 約	
Proposed height and use(s) of different floors of buildings/structures (if applicable) 建築物/構築物的擬議高度及不同樓層的擬議用途 (如適用) (Please use separate sheets if the space below is insufficient) (如以下空間不足，請另頁說明)	
Proposed number of car parking spaces by types 不同種類停車位的擬議數目 Private Car Parking Spaces 私家車車位 Motorcycle Parking Spaces 電單車車位 Light Goods Vehicle Parking Spaces 輕型貨車泊車位 Medium Goods Vehicle Parking Spaces 中型貨車泊車位 Heavy Goods Vehicle Parking Spaces 重型貨車泊車位 Others (Please Specify) 其他 (請列明)	
Proposed number of loading/unloading spaces 上落客貨車位的擬議數目 Taxi Spaces 的士車位 Coach Spaces 旅遊巴車位 Light Goods Vehicle Spaces 輕型貨車車位 Medium Goods Vehicle Spaces 中型貨車車位 Heavy Goods Vehicle Spaces 重型貨車車位 Others (Please Specify) 其他 (請列明)	

Proposed operating hours 擬議營運時間																																	
.....																																	
(d) Any vehicular access to the site/subject building? 是否有車路通往地盤/ 有關建築物?		Yes 是	<input type="checkbox"/> There is an existing access. (please indicate the street name, where appropriate) 有一條現有車路。(請註明車路名稱(如適用)) <input type="checkbox"/> There is a proposed access. (please illustrate on plan and specify the width) 有一條擬議車路。(請在圖則顯示, 並註明車路的闊度) <input type="checkbox"/>																														
		No 否																															
(e) Impacts of Development Proposal 擬議發展計劃的影響 (If necessary, please use separate sheets to indicate the proposed measures to minimise possible adverse impacts or give justifications/reasons for not providing such measures. 如需要的話, 請另頁註明可盡量減少可能出現不良影響的措施, 否則請提供理據/理由。)																																	
(i) Does the development proposal involve alteration of existing building? 擬議發展計劃是否包括現有建築物的改動?	Yes 是	<input type="checkbox"/> Please provide details 請提供詳情 No 否 <input type="checkbox"/>																															
(ii) Does the development proposal involve the operation on the right? 擬議發展是否涉及右列的工程?	Yes 是	<input type="checkbox"/> (Please indicate on site plan the boundary of concerned land/pond(s), and particulars of stream diversion, the extent of filling of land/pond(s) and/or excavation of land) (請用地盤平面圖顯示有關土地/池塘界線, 以及河道改道、填塘、填土及/或挖土的細節及/或範圍) <input type="checkbox"/> Diversion of stream 河道改道 <input type="checkbox"/> Filling of pond 填塘 Area of filling 填塘面積 sq.m 平方米 <input type="checkbox"/> About 約 Depth of filling 填塘深度 m 米 <input type="checkbox"/> About 約 <input type="checkbox"/> Filling of land 填土 Area of filling 填土面積 sq.m 平方米 <input type="checkbox"/> About 約 Depth of filling 填土厚度 m 米 <input type="checkbox"/> About 約 <input type="checkbox"/> Excavation of land 挖土 Area of excavation 挖土面積 sq.m 平方米 <input type="checkbox"/> About 約 Depth of excavation 挖土深度 m 米 <input type="checkbox"/> About 約 No 否 <input type="checkbox"/>																															
(iii) Would the development proposal cause any adverse impacts? 擬議發展計劃會否造成不良影響?	<table border="0"> <tr> <td>On environment 對環境</td> <td>Yes 會 <input type="checkbox"/></td> <td>No 不會 <input type="checkbox"/></td> </tr> <tr> <td>On traffic 對交通</td> <td>Yes 會 <input type="checkbox"/></td> <td>No 不會 <input type="checkbox"/></td> </tr> <tr> <td>On water supply 對供水</td> <td>Yes 會 <input type="checkbox"/></td> <td>No 不會 <input type="checkbox"/></td> </tr> <tr> <td>On drainage 對排水</td> <td>Yes 會 <input type="checkbox"/></td> <td>No 不會 <input type="checkbox"/></td> </tr> <tr> <td>On slopes 對斜坡</td> <td>Yes 會 <input type="checkbox"/></td> <td>No 不會 <input type="checkbox"/></td> </tr> <tr> <td>Affected by slopes 受斜坡影響</td> <td>Yes 會 <input type="checkbox"/></td> <td>No 不會 <input type="checkbox"/></td> </tr> <tr> <td>Landscape Impact 構成景觀影響</td> <td>Yes 會 <input type="checkbox"/></td> <td>No 不會 <input type="checkbox"/></td> </tr> <tr> <td>Tree Felling 砍伐樹木</td> <td>Yes 會 <input type="checkbox"/></td> <td>No 不會 <input type="checkbox"/></td> </tr> <tr> <td>Visual Impact 構成視覺影響</td> <td>Yes 會 <input type="checkbox"/></td> <td>No 不會 <input type="checkbox"/></td> </tr> <tr> <td>Others (Please Specify) 其他 (請列明)</td> <td>Yes 會 <input type="checkbox"/></td> <td>No 不會 <input type="checkbox"/></td> </tr> </table>			On environment 對環境	Yes 會 <input type="checkbox"/>	No 不會 <input type="checkbox"/>	On traffic 對交通	Yes 會 <input type="checkbox"/>	No 不會 <input type="checkbox"/>	On water supply 對供水	Yes 會 <input type="checkbox"/>	No 不會 <input type="checkbox"/>	On drainage 對排水	Yes 會 <input type="checkbox"/>	No 不會 <input type="checkbox"/>	On slopes 對斜坡	Yes 會 <input type="checkbox"/>	No 不會 <input type="checkbox"/>	Affected by slopes 受斜坡影響	Yes 會 <input type="checkbox"/>	No 不會 <input type="checkbox"/>	Landscape Impact 構成景觀影響	Yes 會 <input type="checkbox"/>	No 不會 <input type="checkbox"/>	Tree Felling 砍伐樹木	Yes 會 <input type="checkbox"/>	No 不會 <input type="checkbox"/>	Visual Impact 構成視覺影響	Yes 會 <input type="checkbox"/>	No 不會 <input type="checkbox"/>	Others (Please Specify) 其他 (請列明)	Yes 會 <input type="checkbox"/>	No 不會 <input type="checkbox"/>
On environment 對環境	Yes 會 <input type="checkbox"/>	No 不會 <input type="checkbox"/>																															
On traffic 對交通	Yes 會 <input type="checkbox"/>	No 不會 <input type="checkbox"/>																															
On water supply 對供水	Yes 會 <input type="checkbox"/>	No 不會 <input type="checkbox"/>																															
On drainage 對排水	Yes 會 <input type="checkbox"/>	No 不會 <input type="checkbox"/>																															
On slopes 對斜坡	Yes 會 <input type="checkbox"/>	No 不會 <input type="checkbox"/>																															
Affected by slopes 受斜坡影響	Yes 會 <input type="checkbox"/>	No 不會 <input type="checkbox"/>																															
Landscape Impact 構成景觀影響	Yes 會 <input type="checkbox"/>	No 不會 <input type="checkbox"/>																															
Tree Felling 砍伐樹木	Yes 會 <input type="checkbox"/>	No 不會 <input type="checkbox"/>																															
Visual Impact 構成視覺影響	Yes 會 <input type="checkbox"/>	No 不會 <input type="checkbox"/>																															
Others (Please Specify) 其他 (請列明)	Yes 會 <input type="checkbox"/>	No 不會 <input type="checkbox"/>																															

	<p>Please state measure(s) to minimise the impact(s). For tree felling, please state the number, diameter at breast height and species of the affected trees (if possible)</p> <p>請註明盡量減少影響的措施。如涉及砍伐樹木，請說明受影響樹木的數目、及胸高度的樹幹直徑及品種(倘可)</p> <p>.....</p> <p>.....</p> <p>.....</p> <p>.....</p> <p>.....</p>
--	--

(B) Renewal of Permission for Temporary Use or Development in Rural Areas or Regulated Areas	
位於鄉郊地區或受規管地區臨時用途/發展的許可續期	
(a) Application number to which the permission relates 與許可有關的申請編號	A/ YL-PH / 881
(b) Date of approval 獲批給許可的日期	11/06/2021 (DD 日/MM 月/YYYY 年)
(c) Date of expiry 許可屆滿日期	19/06/2024 (DD 日/MM 月/YYYY 年)
(d) Approved use/development 已批給許可的用途/發展	臨時露天存放建築材料及汽車零件
(e) Approval conditions 附帶條件	<p><input type="checkbox"/> The permission does not have any approval condition 許可並沒有任何附帶條件</p> <p><input checked="" type="checkbox"/> Applicant has complied with all the approval conditions 申請人已履行全部附帶條件</p> <p><input type="checkbox"/> Applicant has not yet complied with the following approval condition(s): 申請人仍未履行下列附帶條件：</p> <p>.....</p> <p>.....</p> <p>.....</p> <p>Reason(s) for non-compliance: 仍未履行的原因：</p> <p>.....</p> <p>.....</p> <p>(Please use separate sheets if the space above is insufficient) (如以上空間不足，請另頁說明)</p>
(f) Renewal period sought 要求的續期期間	<p><input checked="" type="checkbox"/> year(s) 年 3</p> <p><input type="checkbox"/> month(s) 個月</p>

7. Justifications 理由

The applicant is invited to provide justifications in support of the application. Use separate sheets if necessary.
現請申請人提供申請理由及支持其申請的資料。如有需要，請另頁說明）。

詳情請參閱附帶規劃文件。

8. Declaration 聲明

I hereby declare that the particulars given in this application are correct and true to the best of my knowledge and belief.
本人謹此聲明，本人就這宗申請提交的資料，據本人所知及所信，均屬真實無誤。

I hereby grant a permission to the Board to copy all the materials submitted in this application and/or to upload such materials to the Board's website for browsing and downloading by the public free-of-charge at the Board's discretion.

本人現准許委員會酌情將本人就此申請所提交的所有資料複製及/或上載至委員會網站，供公眾免費瀏覽或下載。

Signature
簽署

鄭嘉翔

☒ Applicant 申請人 / ☐ Authorised Agent 獲授權代理人

文員

Name in Block Letters
姓名（請以正楷填寫）

Position (if applicable)
職位（如適用）

Professional Qualification(s)
專業資格

☐ Member 會員 / ☐ Fellow of 資深會員

☐ HKIP 香港規劃師學會 /

☐ HKIA 香港建築師學會 /

☐ HKIS 香港測量師學會 /

☐ HKIE 香港工程師學會 /

☐ HKILA 香港園境師學會 /

☐ HKIUD 香港城市設計學會

☐ RPP 註冊專業規劃師

Others 其他

on behalf of
代表



志科有限公司

☒ Company 公司 / ☐ Organisation Name and Chop (if applicable) 機構名稱及蓋章（如適用）

Date 日期

04/03/2024

(DD/MM/YYYY 日/月/年)

Remark 備註

The materials submitted in this application and the Board's decision on the application would be disclosed to the public. Such materials would also be uploaded to the Board's website for browsing and free downloading by the public where the Board considers appropriate.

委員會會向公眾披露申請人所遞交的申請資料和委員會對申請所作的決定。在委員會認為合適的情況下，有關申請資料亦會上載至委員會網頁供公眾免費瀏覽及下載。

Warning 警告

Any person who knowingly or wilfully makes any statement or furnish any information in connection with this application, which is false in any material particular, shall be liable to an offence under the Crimes Ordinance.

任何人在明知或故意的情況下，就這宗申請提出在任何要項上是虛假的陳述或資料，即屬違反《刑事罪行條例》。

Statement on Personal Data 個人資料的聲明

1. The personal data submitted to the Board in this application will be used by the Secretary of the Board and Government departments for the following purposes:

委員會就這宗申請所收到的個人資料會交給委員會秘書及政府部門，以根據《城市規劃條例》及相關的城市規劃委員會規劃指引的規定作以下用途：

- (a) the processing of this application which includes making available the name of the applicant for public inspection when making available this application for public inspection; and
處理這宗申請，包括公布這宗申請供公眾查閱，同時公布申請人的姓名供公眾查閱；以及
- (b) facilitating communication between the applicant and the Secretary of the Board/Government departments.
方便申請人與委員會秘書及政府部門之間進行聯絡。

2. The personal data provided by the applicant in this application may also be disclosed to other persons for the purposes mentioned in paragraph 1 above.

申請人就這宗申請提供的個人資料，或亦會向其他人士披露，以作上述第1段提及的用途。

3. An applicant has a right of access and correction with respect to his/her personal data as provided under the Personal Data (Privacy) Ordinance (Cap. 486). Request for personal data access and correction should be addressed to the Secretary of the Board at 15/F, North Point Government Offices, 333 Java Road, North Point, Hong Kong.

根據《個人資料(私隱)條例》(第486章)的規定，申請人有權查閱及更正其個人資料。如欲查閱及更正個人資料，應向委員會秘書提出有關要求，其地址為香港北角渣華道333號北角政府合署15樓。

Gist of Application 申請摘要

(Please provide details in both English and Chinese as far as possible. This part will be circulated to relevant consultees, uploaded to the Town Planning Board's Website for browsing and free downloading by the public and available at the Planning Enquiry Counters of the Planning Department for general information.)

(請盡量以英文及中文填寫。此部分將會發送予相關諮詢人士、上載至城市規劃委員會網頁供公眾免費瀏覽及下載及於規劃署規劃資料查詢處供一般參閱。)

Application No. 申請編號	(For Official Use Only) (請勿填寫此欄)
Location/address 位置/地址	元朗八鄉丈量約份第111約地段第2901號(部分)、第2902號(部分)、第2904號(部分)、第2905號(部分)、第2909號(部分)及第2911號(部分)和毗連政府土地
Site area 地盤面積	2162.31 sq. m 平方米 <input checked="" type="checkbox"/> About 約 (includes Government land of 包括政府土地 298.5 sq. m 平方米 <input checked="" type="checkbox"/> About 約)
Plan 圖則	S/YL-PH/11
Zoning 地帶	住宅(丁類)
Type of Application 申請類別	<input type="checkbox"/> Temporary Use/Development in Rural Areas or Regulated Areas for a Period of 位於鄉郊地區或受規管地區的臨時用途/發展為期 <input type="checkbox"/> Year(s) 年 _____ <input type="checkbox"/> Month(s) 月 _____ <input checked="" type="checkbox"/> Renewal of Planning Approval for Temporary Use/Development in Rural Areas or Regulated Areas for a Period of 位於鄉郊地區或受規管地區臨時用途/發展的規劃許可續期為期 <input type="checkbox"/> Year(s) 年 <u>3</u> <input type="checkbox"/> Month(s) 月 _____
Applied use/ development 申請用途/發展	臨時露天存放建築材料及汽車零件

(i) Gross floor area and/or plot ratio 總樓面面積及／或地積比率		sq.m 平方米	Plot Ratio 地積比率
	Domestic 住用	<input type="checkbox"/> About 約 <input type="checkbox"/> Not more than 不多於	<input type="checkbox"/> About 約 <input type="checkbox"/> Not more than 不多於
	Non-domestic 非住用	420 <input checked="" type="checkbox"/> About 約 <input type="checkbox"/> Not more than 不多於	0.19 <input checked="" type="checkbox"/> About 約 <input type="checkbox"/> Not more than 不多於
(ii) No. of blocks 幢數	Domestic 住用		
	Non-domestic 非住用	3	
(iii) Building height/No. of storeys 建築物高度／層數	Domestic 住用	m 米 <input type="checkbox"/> (Not more than 不多於)	
		Storeys(s) 層 <input type="checkbox"/> (Not more than 不多於)	
	Non-domestic 非住用	6 m 米 <input type="checkbox"/> (Not more than 不多於)	
		2 Storeys(s) 層 <input type="checkbox"/> (Not more than 不多於)	
(iv) Site coverage 上蓋面積	13 % <input checked="" type="checkbox"/> About 約		
(v) No. of parking spaces and loading / unloading spaces 停車位及上落客貨車位數目	Total no. of vehicle parking spaces 停車位總數 Private Car Parking Spaces 私家車車位 Motorcycle Parking Spaces 電單車車位 Light Goods Vehicle Parking Spaces 輕型貨車泊車位 Medium Goods Vehicle Parking Spaces 中型貨車泊車位 Heavy Goods Vehicle Parking Spaces 重型貨車泊車位 Others (Please Specify) 其他 (請列明) _____ _____		
	Total no. of vehicle loading/unloading bays/lay-bys 上落客貨車位／停車處總數 Taxi Spaces 的士車位 Coach Spaces 旅遊巴車位 Light Goods Vehicle Spaces 輕型貨車車位 Medium Goods Vehicle Spaces 中型貨車車位 Heavy Goods Vehicle Spaces 重型貨車車位 Others (Please Specify) 其他 (請列明) _____ _____		1

Submitted Plans, Drawings and Documents 提交的圖則、繪圖及文件		
	Chinese 中文	English 英文
Plans and Drawings 圖則及繪圖		
Master layout plan(s)/Layout plan(s) 總綱發展藍圖／布局設計圖	<input checked="" type="checkbox"/>	<input type="checkbox"/>
Block plan(s) 樓宇位置圖	<input type="checkbox"/>	<input type="checkbox"/>
Floor plan(s) 樓宇平面圖	<input type="checkbox"/>	<input type="checkbox"/>
Sectional plan(s) 截視圖	<input type="checkbox"/>	<input type="checkbox"/>
Elevation(s) 立視圖	<input type="checkbox"/>	<input type="checkbox"/>
Photomontage(s) showing the proposed development 顯示擬議發展的合成照片	<input type="checkbox"/>	<input type="checkbox"/>
Master landscape plan(s)/Landscape plan(s) 園境設計總圖／園境設計圖	<input checked="" type="checkbox"/>	<input type="checkbox"/>
Others (please specify) 其他 (請註明)	<input checked="" type="checkbox"/>	<input type="checkbox"/>
美化環境圖則，渠務排水圖則，消防裝置圖則，行車通道圖則		
Reports 報告書		
Planning Statement/Justifications 規劃綱領/理據	<input checked="" type="checkbox"/>	<input type="checkbox"/>
Environmental assessment (noise, air and/or water pollutions) 環境評估 (噪音、空氣及／或水的污染)	<input type="checkbox"/>	<input type="checkbox"/>
Traffic impact assessment (on vehicles) 就車輛的交通影響評估	<input type="checkbox"/>	<input type="checkbox"/>
Traffic impact assessment (on pedestrians) 就行人的交通影響評估	<input type="checkbox"/>	<input type="checkbox"/>
Visual impact assessment 視覺影響評估	<input type="checkbox"/>	<input type="checkbox"/>
Landscape impact assessment 景觀影響評估	<input type="checkbox"/>	<input type="checkbox"/>
Tree Survey 樹木調查	<input type="checkbox"/>	<input type="checkbox"/>
Geotechnical impact assessment 土力影響評估	<input type="checkbox"/>	<input type="checkbox"/>
Drainage impact assessment 排水影響評估	<input type="checkbox"/>	<input type="checkbox"/>
Sewerage impact assessment 排污影響評估	<input type="checkbox"/>	<input type="checkbox"/>
Risk Assessment 風險評估	<input type="checkbox"/>	<input type="checkbox"/>
Others (please specify) 其他 (請註明)	<input type="checkbox"/>	<input type="checkbox"/>
Note: May insert more than one '✓'. 註：可在多於一個方格內加上「✓」號		

Note: The information in the Gist of Application above is provided by the applicant for easy reference of the general public. Under no circumstances will the Town Planning Board accept any liabilities for the use of the information nor any inaccuracies or discrepancies of the information provided. In case of doubt, reference should always be made to the submission of the applicant.

註：上述申請摘要的資料是由申請人提供以方便市民大眾參考。對於所載資料在使用上的問題及文義上的歧異，城市規劃委員會概不負責。若有任何疑問，應查閱申請人提交的文件。

附帶規劃文件

按城市規劃條例第 16 條於新界元朗八鄉丈量約份第 111 約地段第 2901 號(部分)、第 2902 號(部分)、第 2904 號(部分)、第 2905 號(部分)、第 2909 號(部分)及第 2911 號(部分)和毗連政府土地

續期申請作「臨時露天存放建築材料及汽車零件」用途，為期 3 年，

地帶：住宅(丁類)

地盤面積：約 2162.31 平方米

行政摘要

擬在新界元朗八鄉丈量約份第 111 約地段第 2901 號(部分)、第 2902 號(部分)、第 2904 號(部分)、第 2905 號(部分)、第 2909 號(部分)及第 2911 號(部分)和毗連政府土地，八鄉分區計劃大綱核准圖編號：S/YL-PH/11，「住宅(丁類)」地帶內申請作為「臨時露天存放建築材料及汽車零件」為期三年。

是次申請是作為上次規劃許可申請 A/YL-PH/881 的續期申請，今天的申請用途與前次的申請用途沒有任何重大的改變。上次申請期間都沒有任何政府部門及附近市民的反映和投訴，土地使用者一直使用良好，於上次規劃許可申請 A/YL-PH/881 中，申請人已完成所有附帶條件。

場地設計：



申請地點只為臨時性質，開放時間為星期一至星期六、上午9時至下午6時，星期日及公眾假期不會開放，申請地點內只會停泊私家車和輕型貨車，不會有重量超過5.5噸的重型貨車及貨櫃車出入，也不會進行拆卸、保養、修理、清潔、噴漆或其他工場活動。

申請地點內的臨時構築物只用作工作人員辦公和臨時休息的用途，並不會用作永久性居住用途，工作人員在下午6時下班後，就會離開申請地點，不會在場地內過夜和居住。

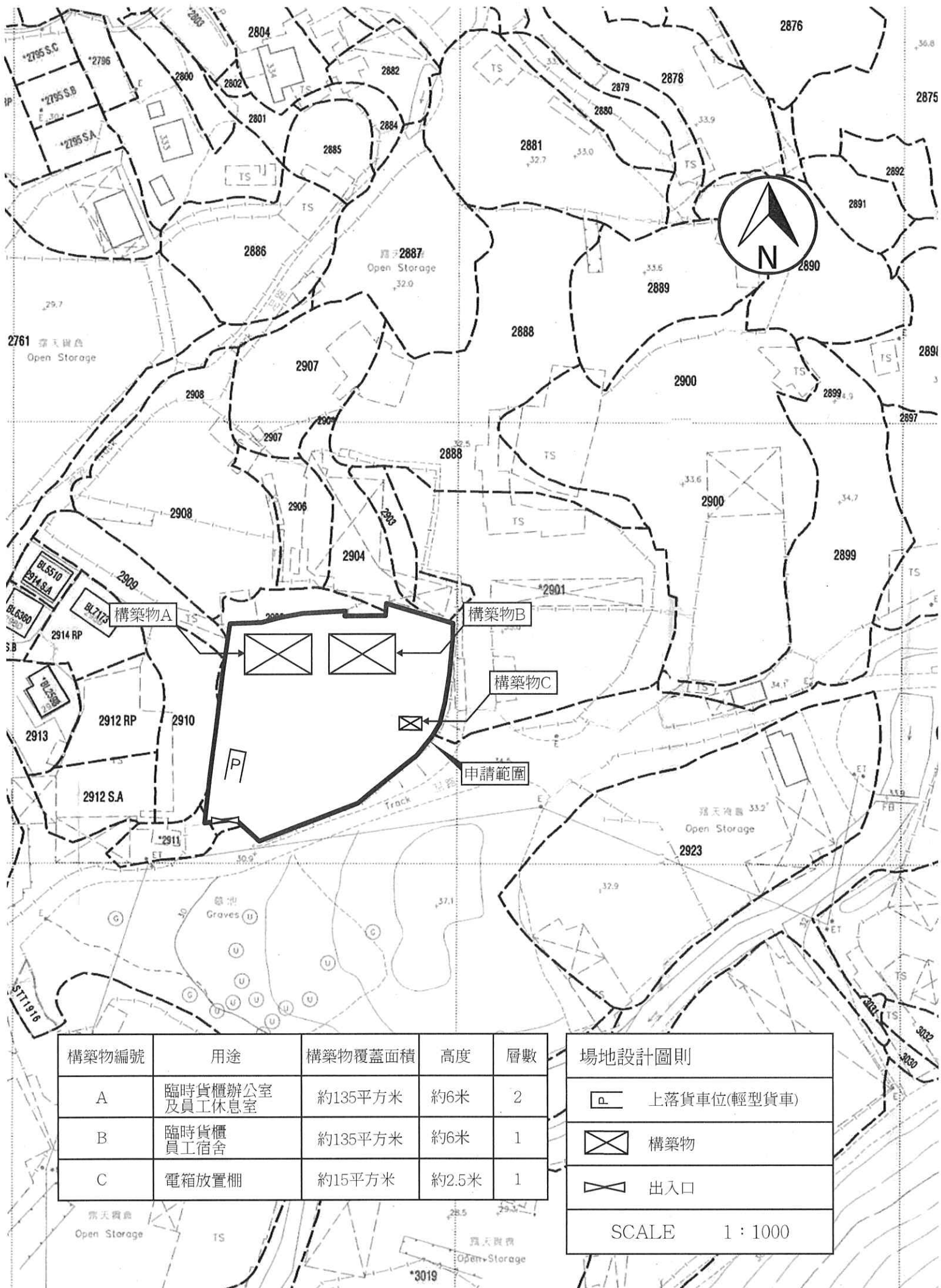
詳情請參閱以下圖則。



構造物編號	用途	構造物覆蓋面積	高度	層數
A	臨時貨櫃辦公室及員工休息室	約135平方米	約6米	2
B	臨時貨櫃員工宿舍	約135平方米	約6米	1
C	電箱放置棚	約15平方米	約2.5米	1

場地設計圖則	
	上落貨車位(輕型貨車)
	構造物
	出入口
SCALE 1 : 1000	

美化環境：

申請地點內的原有樹木和綠化植物會全部保留，申請人亦會依城市規劃委員會所提供的「有關為履行根據城市規劃條例第 16 條獲批准的露天貯物及港口後勤用途的附帶條件而提交及落實美化環境建議的技術摘要」，對申請地點內的現有的 16 棵綠化植物進行保存和保護。

申請人亦會依照城市規劃委員會所提供的「有關為履行根據城市規劃條例第16條獲批准的露天貯物及港口後勤用途的附帶條件而提交及落實美化環境建議的技術摘要」，為申請地點邊界所設置完成的綠色圍板和圍欄進行維護，令場地保持綠化、隔絕噪音，使場地與四周環境融為一體，美化環境。

詳情請參閱以下圖則。

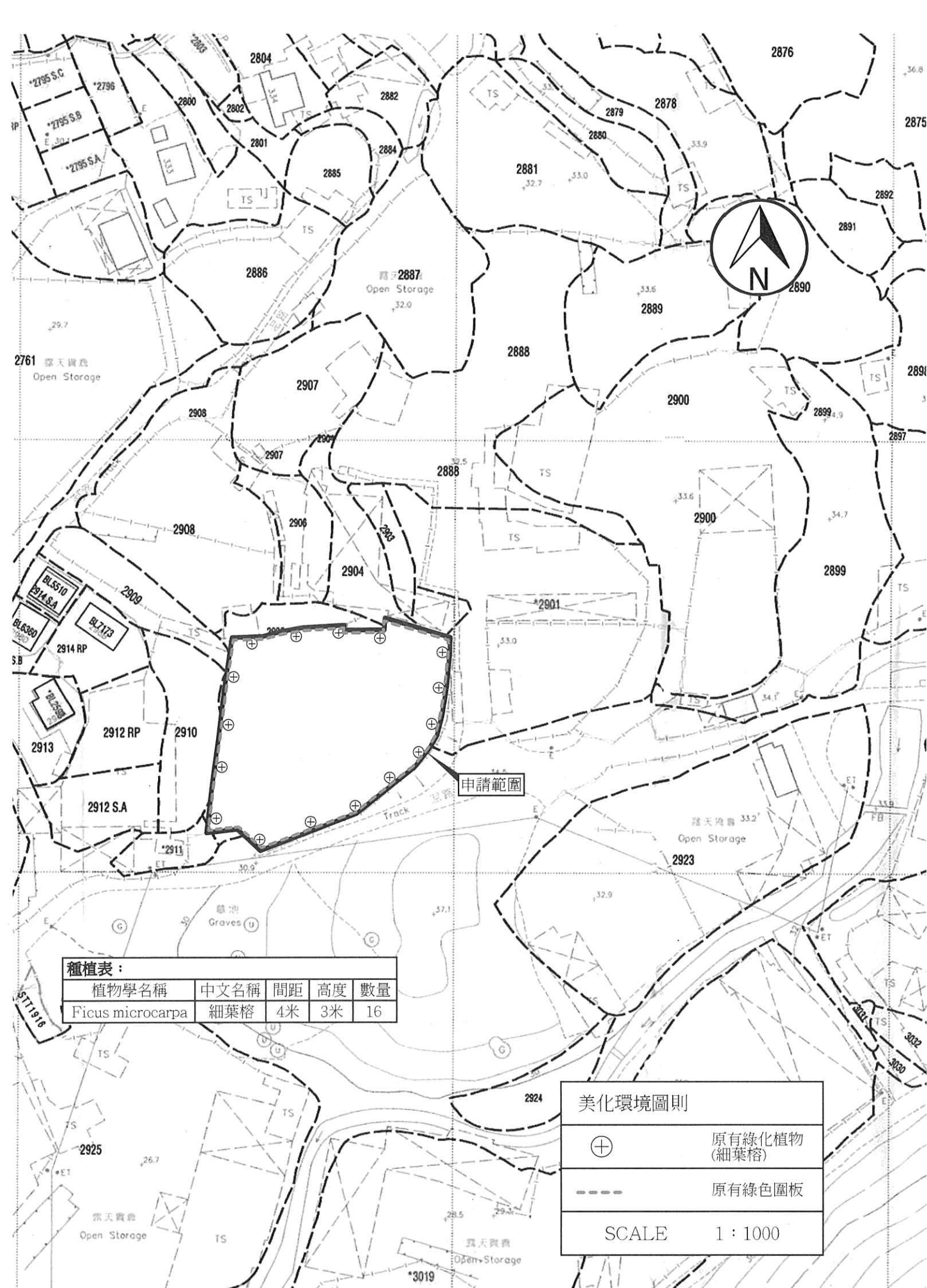

渠務排水：

申請人會依照渠務署所提供的排水系統設計建議書「有關城市規劃條例第16條申請臨時更改土地用途，如臨時貨倉、停車場、工場、小型工廠等」，對申請地點內的現有渠務排水設施進行維護及保養。

詳情請參閱以下圖則。

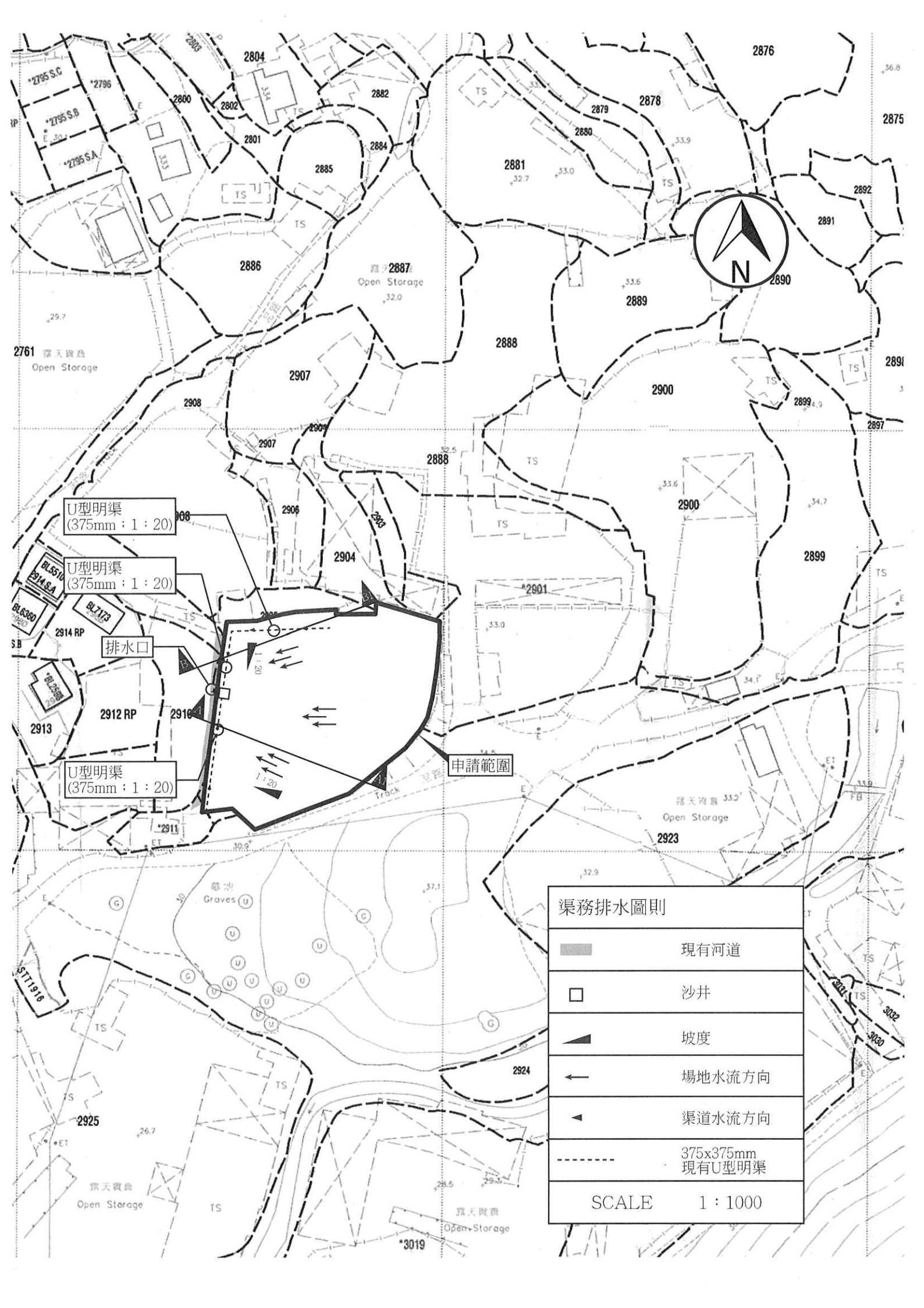

U型明渠
(375mm : 1 : 20)

U型明渠
(375mm : 1 : 20)

排水口

U型明渠
(375mm : 1 : 20)

申請範圍

渠務排水圖則	
	現有河道
	沙井
	坡度
	場地水流方向
	渠道水流方向
	375x375mm 現有U型明渠
SCALE 1 : 1000	

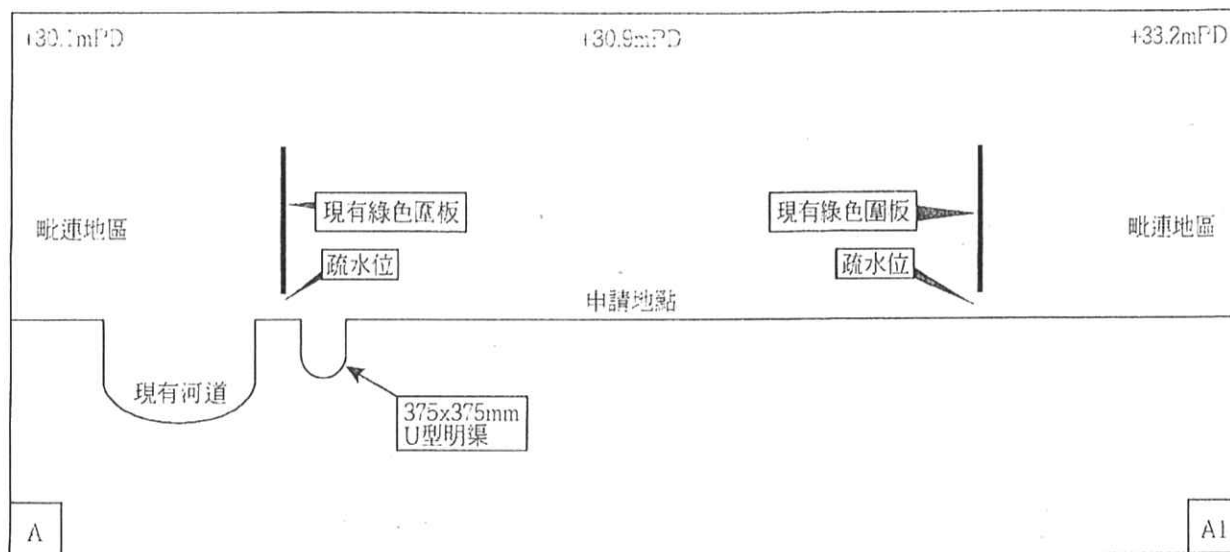

A—A1橫切面圖則

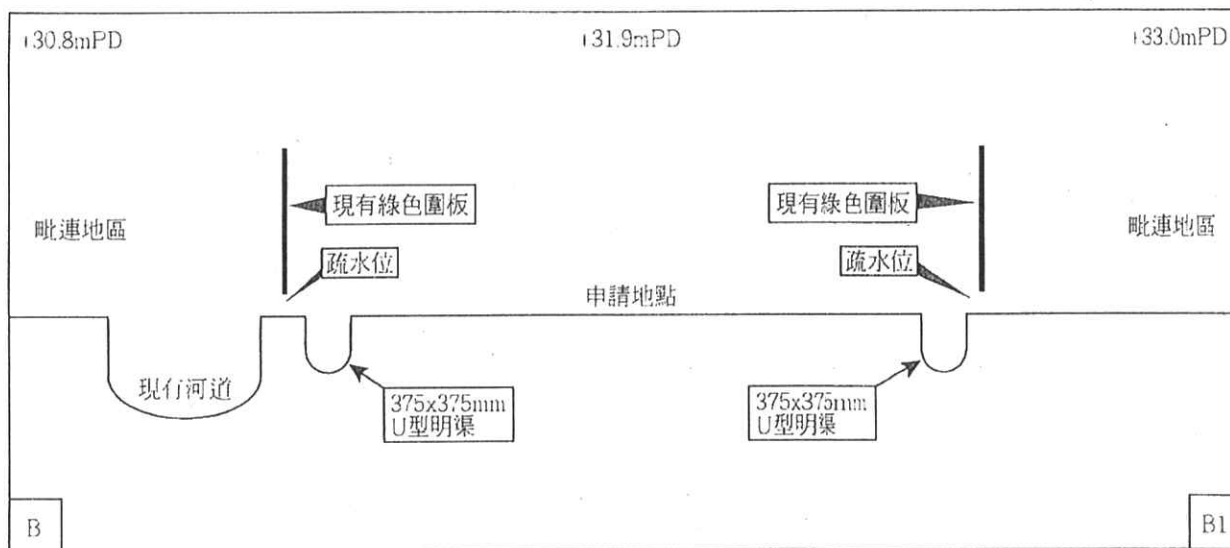

B—B1橫切面圖則

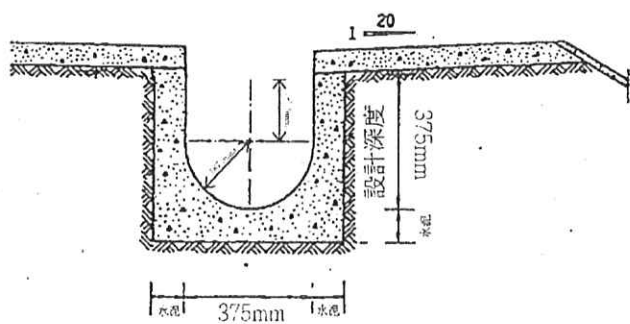
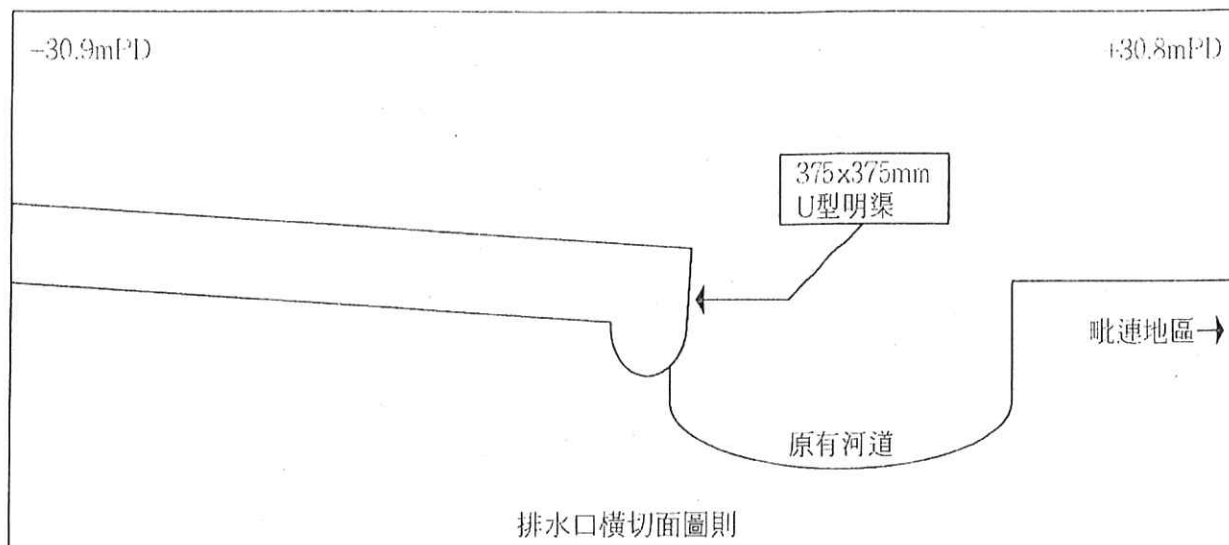

U型明渠切面圖

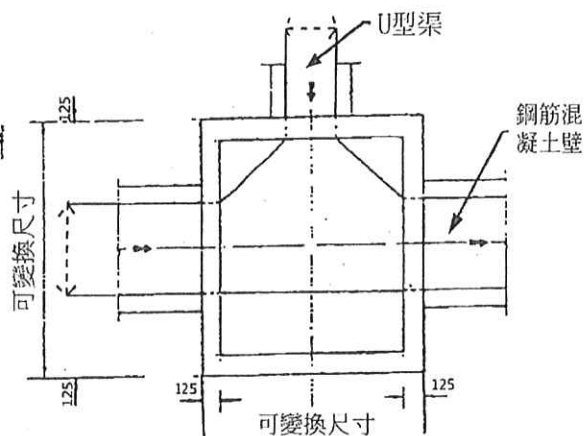

沙井俯視圖

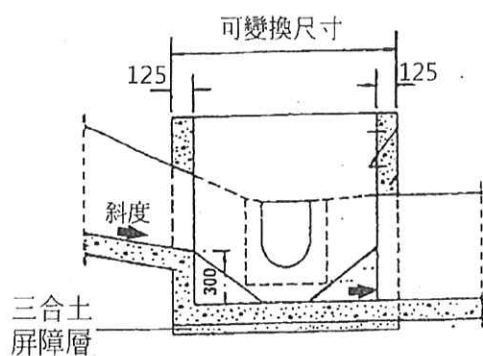

沙井切面圖

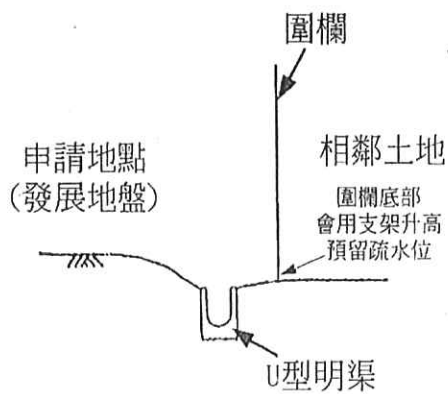

U型明渠切面略圖

Not To Scale

消防裝置：

申請地點內裝設有5公斤乾粉式滅火筒共8支，其中3支裝設於申請地點露天區域內。申請地點內裝設有出口指示燈/指示牌共4個，緊急照明系統4個，分別裝設於申請地點的各個構築物內。



是次規劃申請是作為上次規劃申請A/YL-PH/881的續期申請，相關申請地點的用途和上次規劃申請A/YL-PH/881時一致，沒有任何改變；消防設備的數目和種類與A/YL-PH/766時一致，沒有任何改變。

申請人亦會依照消防處所提供的意見，對申請地點內的現有消防裝置進行維護及保養，並會在定時為申請地點內的人員進行消防演習。

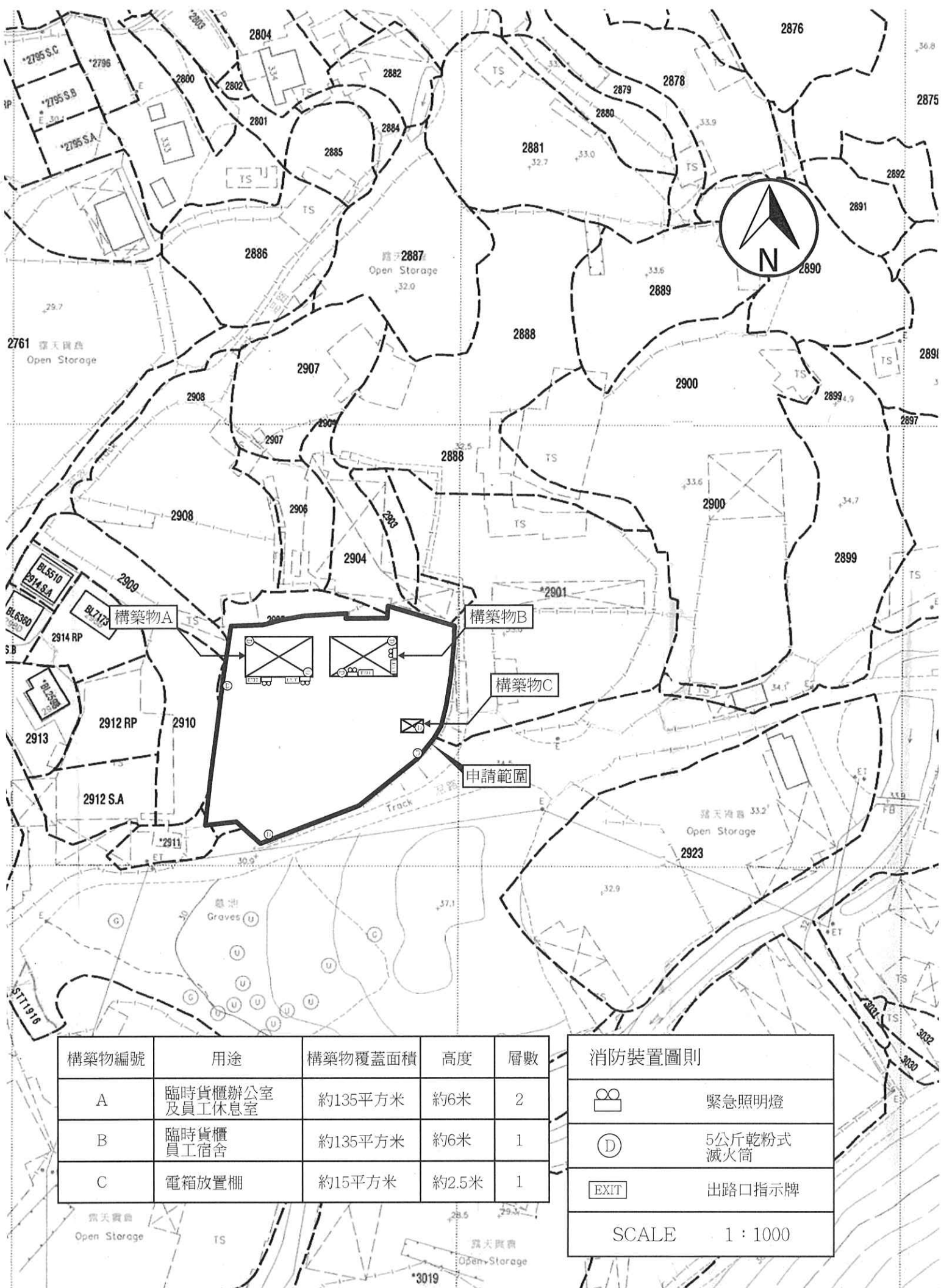
詳情請參閱以下圖則。



構造物編號	用途	構造物覆蓋面積	高度	層數
A	臨時貨櫃辦公室 及員工休息室	約135平方米	約6米	2
B	臨時貨櫃 員工宿舍	約135平方米	約6米	1
C	電箱放置棚	約15平方米	約2.5米	1

消防裝置圖則	
	緊急照明燈
	5公斤乾粉式滅火筒
	出口指示牌
SCALE 1 : 1000	

交通運輸：

申請地點南面有一個明確的出入口，出入口闊度為大約6米，可以直通錦田公路。

申請地點設有輕型貨車上落貨車位 1 個，尺寸約 7 米 x3.5 米，申請地點內沒有私家車泊車位。

由於申請地點附近有巴士站及小巴站，因此申請地點內並不會設有員工泊車位。

申請地點內有足夠的空間供車輛進行機動調轉。

申請地點預計平均每天進出輕型貨車架次大約 1 輛，不會提高申請地點附近的汽車流量，就整體而言，不會對錦田公路或附近交通造成影響，詳情請參閱下表：

預計申請地點內汽車流量時間表																								
時間	01 00	02 00	03 00	04 00	05 00	06 00	07 00	08 00	09 00	10 00	11 00	12 00	13 00	14 00	15 00	16 00	17 00	18 00	19 00	20 00	21 00	22 00	23 00	24 00
車輛數	0	0	0	0	0	0	0	0	0	0	1	0	0	0	1	0	0	0	0	0	0	0	0	0

申請地點西面有一個小巴站頭，距離申請地點約 311 米，南面有一個巴士站，距離申請地點約 445 米，工作人員可以透過乘坐巴士和小巴抵達申請地點附近後，再步行進入申請地點。

詳情請參閱以下圖則。

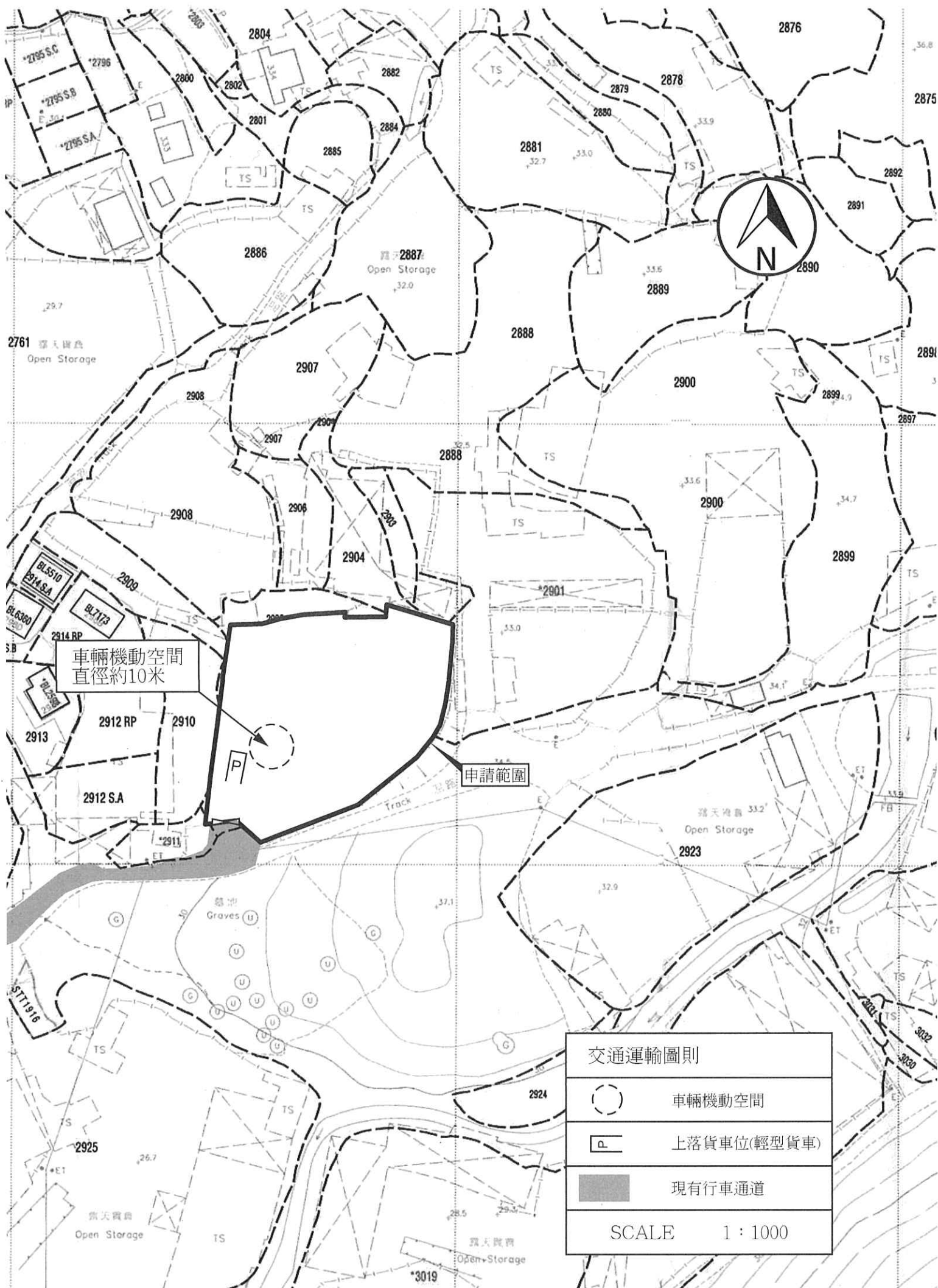

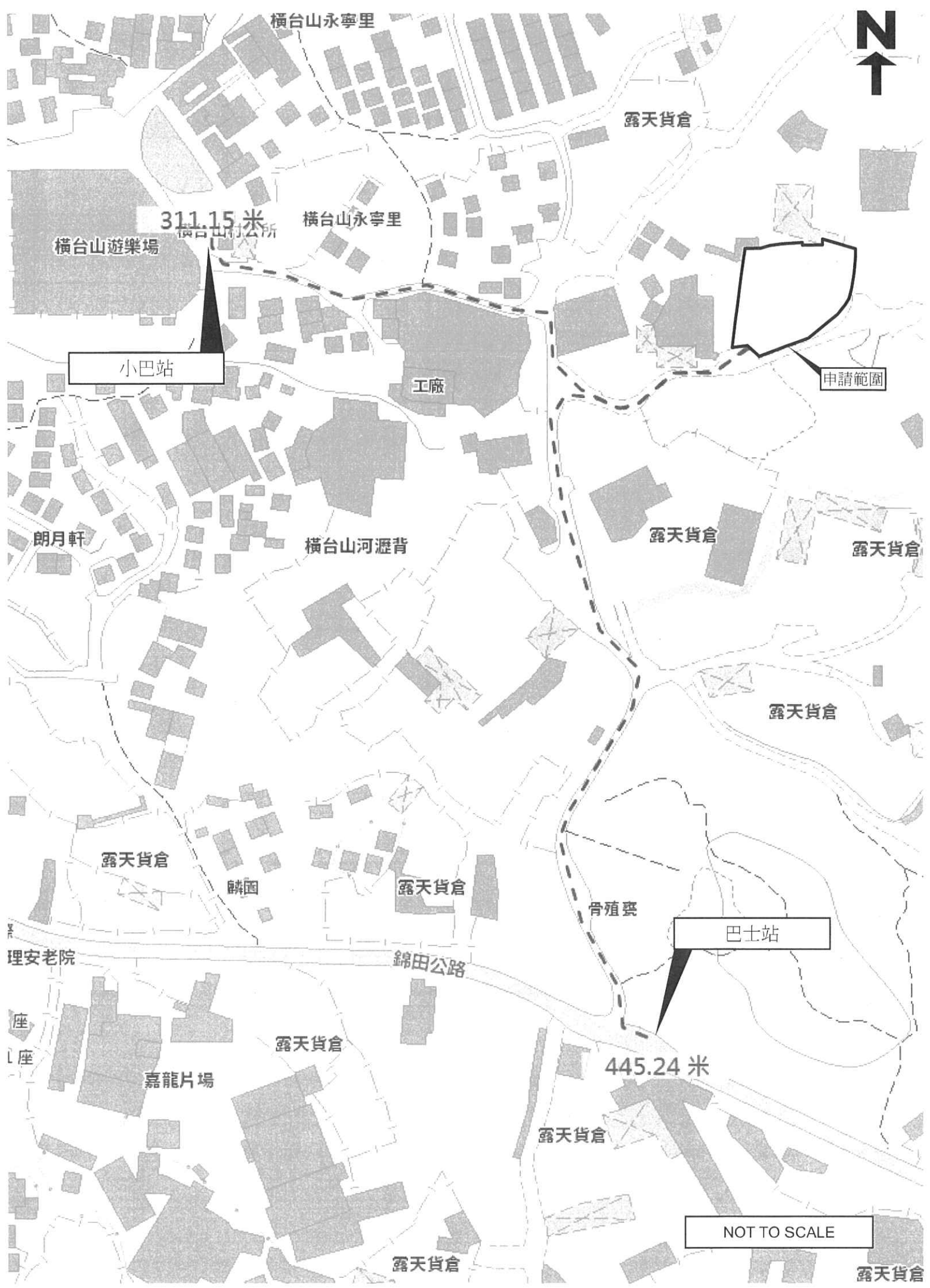

NOT TO SCALE

致： 城市規劃委員會
粉嶺、上水及元朗東規劃處

有關 A/YL-PH/1001 規劃申請之補充資料

申請人現就日前政府部門的意見/查詢，作出以下補充/修改：

1. 提供最新的現有排水設施記錄。
2. 提供最新的 FS251 消防裝置證書。

隨件附上相關文件以作參考，如造成不便，敬請原諒。

申請人： 志科有限公司

通訊地址： [REDACTED]

電郵： [REDACTED]

傳真號碼： [REDACTED]

聯絡電話： [REDACTED]

日期： 2024 年 03 月 18 日

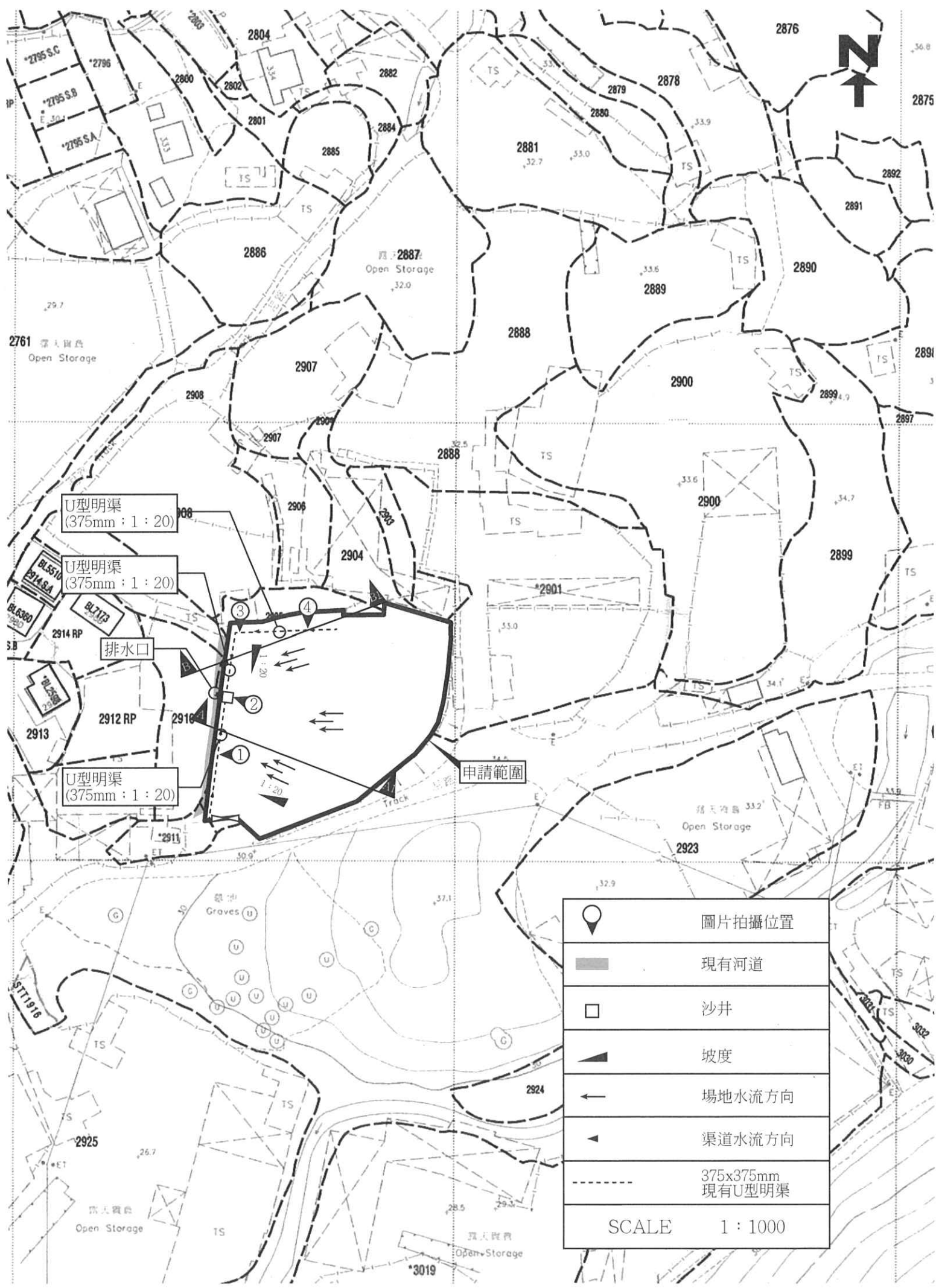

U型明渠
(375mm : 1 : 20)

U型明渠
(375mm : 1 : 20)

排水口

U型明渠
(375mm : 1 : 20)

申請範圍

	圖片拍攝位置
	現有河道
	沙井
	坡度
	場地水流方向
	渠道水流方向
	375x375mm 現有U型明渠
SCALE 1 : 1000	

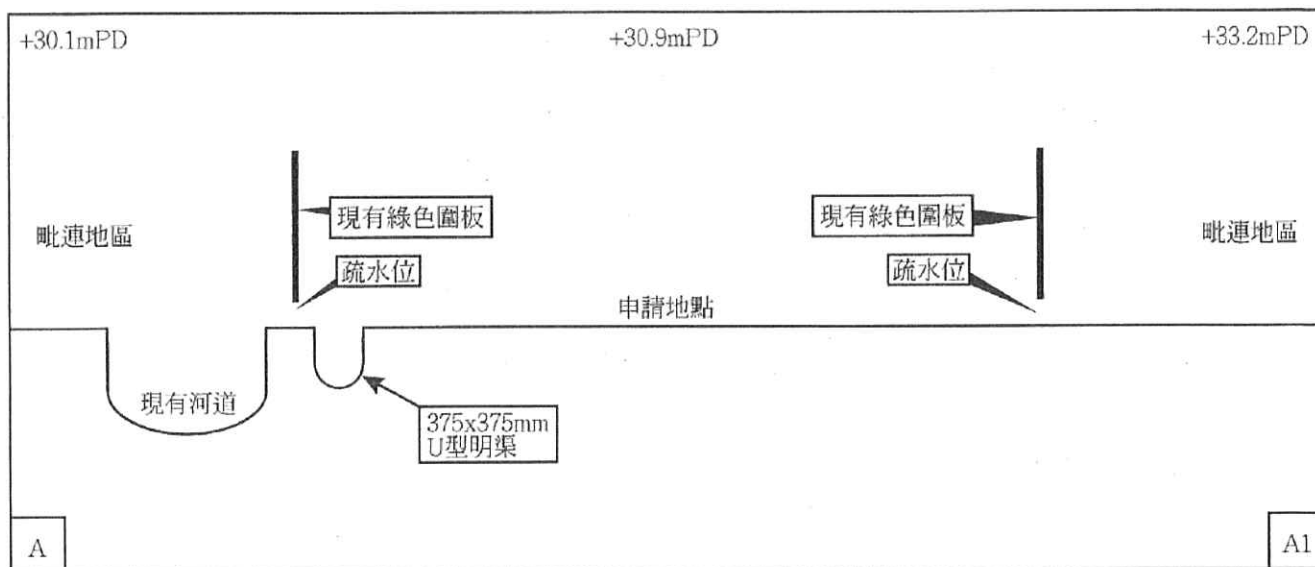

A—A1橫切面圖則

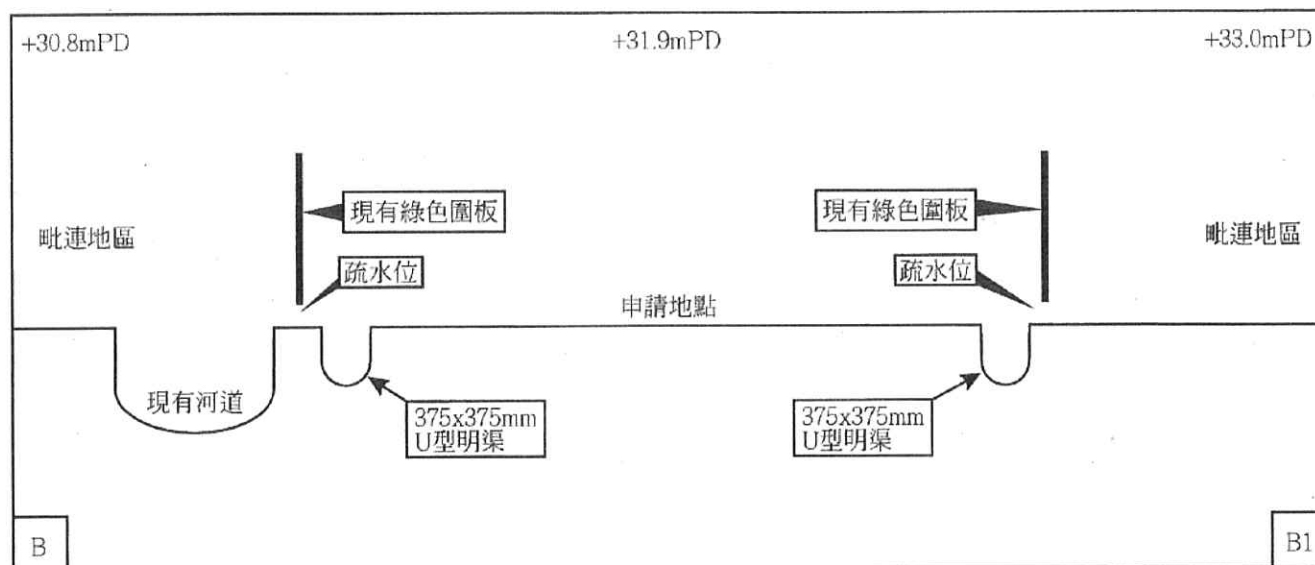

B—B1橫切面圖則

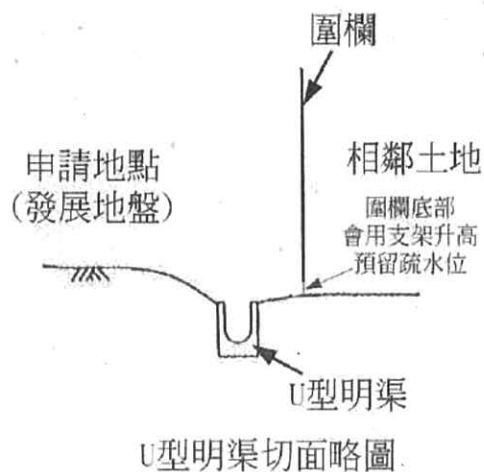
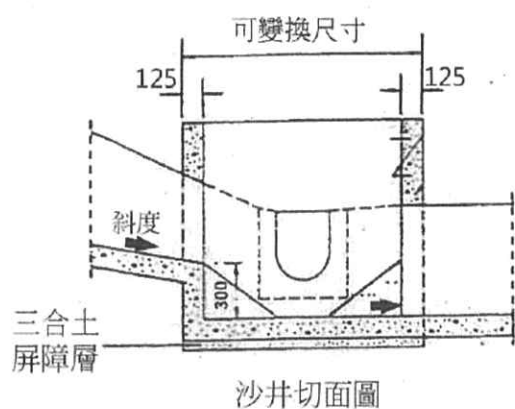
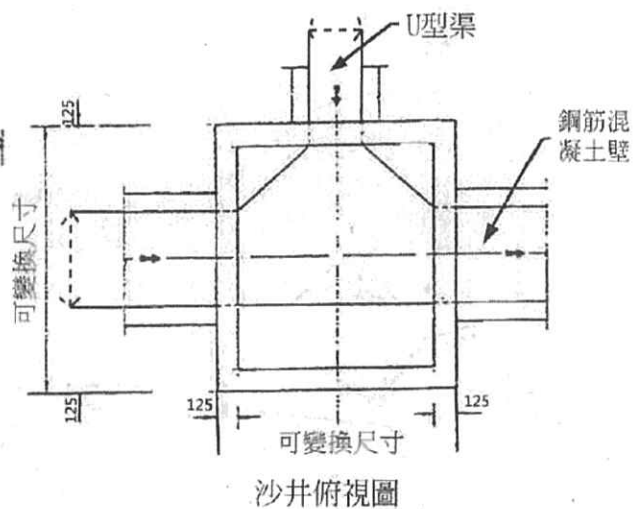
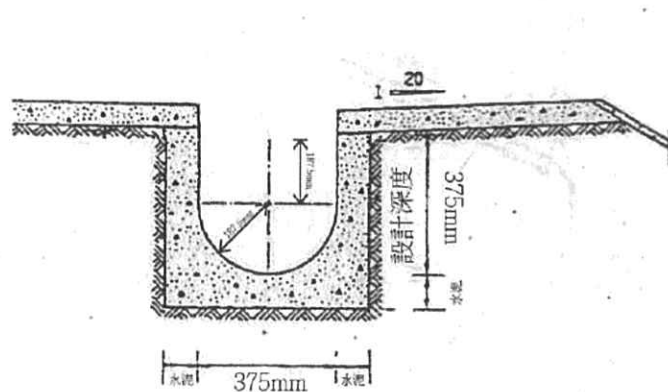
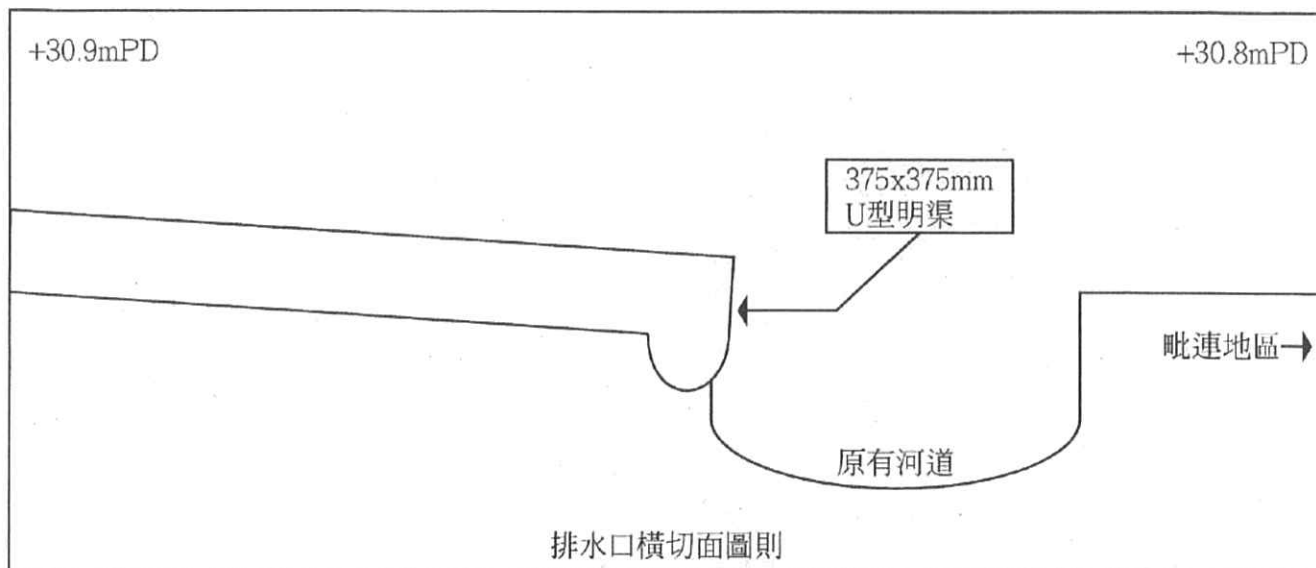

Not To Scale





FIRE SERVICE (INSTALLATIONS AND EQUIPMENT) REGULATIONS

消防(裝置及設備)規例

(Regulation 9(1))

(第九條(1)款)

CERTIFICATE OF FIRE SERVICE INSTALLATION AND EQUIPMENT

消防裝置及設備證書

FSD Ref.: _____
消防處編號

A

Name of Client :

顧客姓名

春和工程有限公司

Name of Building :

樓宇名稱

Street No./Town Lot :

門牌號數/市地段

DD111 LOT 2910

Street/Road/Estate Name :

街道/屋苑名稱

橫台山, 永寧里

Block :

座

District :

分區

元朗

Area :

地區

☐ HK

香港

☐ K

九龍

☒ NT

新界

Type of Building 樓宇類型:

☐ Industrial 工業☐ Commercial 商業☐ Domestic 住宅☐ Composite 綜合☐ Licensed premises 持牌處所☐ Institutional 社團Part 1 Annual Inspection ONLY
第一部 只適用於年檢事項

In accordance with Regulation 8(b) of Fire Service (Installations and Equipment) Regulations, the owner of any fire service installation or equipment which is installed in any premises shall have such fire service installation or equipment inspected by a registered contractor at least once in every 12 months. 根據消防(裝置及設備)規例第八條(b)款, 擁有裝置在任何處所內的任何消防裝置或設備的人, 須每12個月由一名註冊承辦商檢查該等消防裝置或設備至少一次。

Code 編碼 (1-35)	Type of FSI 裝置類型	Location(s) 位置	Comment on Condition 狀況評述	Completion Date 完成日期(DD/MM/YY)	Next Due Date 下次到期日(DD/MM/YY)

Part 2 第二部 Installation / Modification / Repair / Inspection work 裝置/改裝/修理/檢查工作

Code 編碼 (1-35)	Type of FSI 裝置類型	Location(s) 位置	Nature of Work Carried out 完成之工作內容	Comment on Condition 狀況評述	Completion Date 完成日期(DD/MM/YY)
24	8 NOS X 5KG DRY POWDER TYPE F.E.		TO SUPPLY	CONFORMS WITH FSD REQUIREMENTS	1/3/2024

Part 3 第三部 Defects 損壞事項

Code 編碼 (1-35)	Type of FSI 裝置類型	Location(s) 位置	Outstanding Defects 未修缺點	Comment on Defects 缺點評述

I/We hereby certify that the above installations/equipment have been tested and found to be in efficient working order in accordance with the Codes of Practice for Minimum Fire Service Installations and Equipment and Inspection, Testing and Maintenance of Installations and Equipment published from time to time by the Director of Fire Services. Defects are listed in Part 3.

本人藉此證明以上之消防裝置及設備經試驗, 證明性能良好, 符合消防處處長不時公佈的最低限度之消防裝置及設備守則與裝置及設備之檢查測試及保養守則的規格, 損壞事項列於第三部。

如證書涉及年檢事項, 應張貼於大廈
或處所當眼處以供消防處人員查核

This certificate should be displayed at prominent location of the building or premises
for FSD's inspection if any annual maintenance work is involved.

Authorized
Signature :

受權人簽署

Name :

姓名

FSD/RC No. :

消防處註冊號碼

Company Name :

公司名稱

Telephone :

聯絡電話

Date :

日期

For FSD
use only:

Inspected

Key-in

Verified

FIRE SERVICE (INSTALLATIONS AND EQUIPMENT) REGULATIONS

消防（裝置及設備）規例

(Regulation 9(1))

(第九條(1)款)

(CERT. NO. A 9407538 SUPERSEDED)

CERTIFICATE OF FIRE SERVICE INSTALLATION AND EQUIPMENT

消防裝置及設備證書

FSD Ref.: _____
消防處檔號

Name of Client :

顧客姓名

春和工程有限公司

Name of Building :

樓宇名稱

Street No./Town Lot :

門牌號數/市地段

DD111 LOT 2910

Street/Road/Estate Name :

街道/屋苑名稱

橫台山, 永寧里

Block :

座

District :

分區

元朗

Area :

地區

☐ HK

香港

☐ K

九龍

☒ NT

新界

Type of Building 樓宇類型: ☐ Industrial 工業 ☐ Commercial 商業 ☐ Domestic 住宅 ☐ Composite 綜合 ☐ Licensed premises 持牌處所 ☐ Institutional 社團Part 1 Annual Inspection ONLY
第一部 只適用於年檢事項

In accordance with Regulation 8(b) of Fire Service (Installations and Equipment) Regulations, the owner of any fire service installation or equipment which is installed in any premises shall have such fire service installation or equipment inspected by a registered contractor at least once in every 12 months. 根據消防（裝置及設備）規例第八條(b)款，擁有裝置在任何處所內的任何消防裝置或設備的人，須每12個月由一名註冊承辦商檢查該等消防裝置或設備至少一次。

Code 編碼 (1-35)	Type of FSI 裝置類型	Location(s) 位置	Comment on Condition 狀況評述	Completion Date 完成日期(DD/MM/YY)	Next Due Date 下次到期日(DD/MM/YY)
11	應急照明系統:- 2套X掛牆式緊急照明燈	*****	已符合消防處之規定	8/3/2024	7/3/2025
12	出口指示牌:- 2套X出路燈箱	*****	"	"	"

Part 2 第二部 Installation / Modification / Repair / Inspection work 裝置/改裝/修理/檢查工作

Code 編碼 (1-35)	Type of FSI 裝置類型	Location(s) 位置	Nature of Work Carried out 完成之工作內容	Comment on Condition 狀況評述	Completion Date 完成日期(DD/MM/YY)
11	應急照明系統:- 5套X牌子:A & B 型號: TS-EL2053	*****	供應及安裝	已符合消防處之規定	8/3/2024
12	出口指示牌:- 2套X牌子:A & B 型號: LED-B4	*****	"	"	"

Part 3 第三部 Defects 損壞事項

Code 編碼 (1-35)	Type of FSI 裝置類型	Location(s) 位置	Outstanding Defects 未修缺點	Comment on Defects 缺點評述
	*****		*****	*****

I/We hereby certify that the above installations/equipment have been tested and found to be in efficient working order in accordance with the Codes of Practice for Minimum Fire Service Installations and Equipment and Inspection, Testing and Maintenance of Installations and Equipment published from time to time by the Director of Fire Services. Defects are listed in Part 3.

本人藉此證明以上之消防裝置及設備經試驗，證明性能良好，符合消防處處長不時公佈之最低限度之消防裝置及設備守則與裝置及設備之檢查測試及保養守則的規格，損壞事項列於第三部。

如證書涉及年檢事項，應張貼於大廈
或處所當眼處以供消防處人員查核This certificate should be displayed at prominent location of the building or premises
for FSD's inspection if any annual maintenance work is involved.Authorized
Signature :
受權人簽署Name :
姓名FSD/RC No. :
消防處註冊號碼Company Name :
公司名稱Telephone :
聯絡電話Date :
日期

廖振書

LIU CHUN LUI

TAI HING FIRE ENGINEERING CO.

大興消防工程公司

11-3-2024

For FSD
use only:

Inspected

Key-in

Verified

Relevant Extracts of Town Planning Board Guidelines on
Application for Open Storage and Port Back-up Uses
(TPB PG-No.13G)

1. On 14.4.2023, the Town Planning Board Guidelines for Application for Open Storage and Port Back-up Uses under Section 16 of the Town Planning Ordinance (TPB PG-No. 13G) were promulgated, which set out the following criteria for the various categories of area:
 - (a) Category 1 areas: favourable consideration will normally be given to applications within these areas, subject to no major adverse departmental comments and local objections, or the concerns of the departments and local residents can be addressed through the implementation of approval conditions. Technical assessments should be submitted if the proposed uses may cause significant environmental and traffic concerns;
 - (b) Category 2 areas: planning permission could be granted on a temporary basis up to a maximum period of 3 years, subject to no adverse departmental comments and local objections, or the concerns of the departments and local residents can be addressed through the implementation of approval conditions. Technical assessments, where appropriate, should be submitted to demonstrate that the proposed uses would not have adverse drainage, traffic, visual, landscaping and environmental impacts on the surrounding areas;
 - (c) Category 3 areas: applications would normally not be favourably considered unless the applications are on sites with previous planning approvals (irrespective of whether the application is submitted by the applicant of previous approval or a different applicant). Sympathetic consideration may be given if genuine efforts have been demonstrated in compliance with approval conditions of the previous planning applications and/or relevant technical assessments/proposals have been included in the fresh applications, if required, to demonstrate that the proposed uses would not generate adverse drainage, traffic, visual, landscaping and environmental impacts on the surrounding areas. Planning permission could be granted on a temporary basis up to a maximum period of 3 years, subject to no adverse departmental comments and local objections, or the concerns of the departments and local residents can be addressed through the implementation of approval conditions; and
 - (d) Category 4 areas: applications would normally be rejected except under exceptional circumstances. For applications on sites with previous planning approvals (irrespective of whether the application is submitted by the applicant of previous approval or a different applicant), and subject to no adverse departmental comments and local objections, sympathetic consideration may be given if genuine efforts have been demonstrated in compliance with approval conditions of the previous planning applications and/or relevant technical assessments/proposals have been included in the fresh applications, if required, to demonstrate that the proposed uses would not generate adverse drainage, traffic, visual, landscaping and environmental impacts on the surrounding areas. The intention is however to encourage the phasing out of such non-conforming uses as early as possible. A maximum period of 3 years may be allowed for an applicant to identify suitable sites for relocation. Application for renewal of approval will be assessed on its individual merits.

2. In assessing applications for open storage and port back-up uses, the other major relevant assessment criteria are also summarized as follows:
 - (a) port back-up sites and those types of open storage uses generating adverse noise, air pollution, visual intrusion and frequent heavy vehicle traffic should not be located adjacent to sensitive receivers such as residential dwellings, hospitals, schools and other community facilities;
 - (b) port back-up uses are major generators of traffic, with container trailer/tractor parks generating the highest traffic per unit area. In general, port back-up sites should have good access to the strategic road network, or be accessed by means of purpose built roads;
 - (c) adequate screening of sites through landscaping and/or fencing should be considered where sites are located adjacent to public roads or are visible from surrounding residential areas;
 - (d) there is a general presumption against conversion of active or good quality agricultural land and fish ponds to other uses on an ad-hoc basis. For flood prone areas or sites which would obstruct natural drainage channels and overland flow, advice should be sought; and
 - (e) for applications involving sites with previous planning approvals, should there be no evidence to demonstrate that the applicants have made any genuine effort to comply with the approval conditions of the previous planning applications, planning permission may be refused notwithstanding other criteria set out in the Guidelines are complied with.

**Relevant Extracts of Town Planning Board Guidelines
on Renewal of Planning Approval and Extension of Time for Compliance with
Planning Conditions for Temporary Use or Development
(TPB PG-No. 34D)**

1. The criteria for assessing applications for renewal of planning approval include:
 - (a) whether there has been any material change in planning circumstances since the previous temporary approval was granted (such as a change in the planning policy/land-use zoning for the area) or a change in the land uses of the surrounding areas;
 - (b) whether there are any adverse planning implications arising from the renewal of the planning approval (such as pre-emption of planned permanent development);
 - (c) whether the planning conditions under previous approval have been complied with to the satisfaction of relevant government departments within the specified time limits;
 - (d) whether the approval period sought is reasonable; and
 - (e) any other relevant considerations.
2. Under normal circumstances, the approval period for renewal should not be longer than the original validity period of the temporary approval. In general, the Board is unlikely to grant an approval period exceeding three years unless there are strong justifications and the period is allowed for under the relevant statutory plans. Depending on the circumstances of each case, the Board could determine the appropriate approval period, which may be shorter than the time under request.

Previous s.16 Applications covering the Application Site

Approved Applications

	Application No.	Use/Development	Date of Consideration
1	A/YL-PH/302	Temporary Open Storage of Vehicle Parts and Construction Materials for a Period of Three Years	5.11.1999 [revoked on 5.8.2000]
2	A/YL-PH/382	Temporary Open Storage of Construction Materials for a Period of Three Years	18.1.2002 (on review)
3	A/YL-PH/440	Temporary Open Storage of Construction Materials with Ancillary Container Office for a Period of Three Years	15.8.2003
4	A/YL-PH/560	Temporary Open Storage of Construction Materials and Vehicle Parts for a Period of Three Years	18.4.2008 [revoked on 18.10.2008]
5	A/YL-PH/613	Temporary Open Storage of Construction Materials and Vehicle Parts for a Period of Three Years	24.9.2010 [revoked on 24.9.2011]
6	A/YL-PH/641	Temporary Open Storage of Construction Materials and Vehicle Parts for a Period of Three Years	6.7.2012
7	A/YL-PH/716	Temporary Open Storage of Construction Materials and Vehicle Parts for a Period of Three Years	19.6.2015
8	A/YL-PH/776	Renewal of Planning Approval for Temporary "Open Storage of Construction Material and Vehicle Parts" for a Period of Three Years	20.4.2018
9	A/YL-PH/881	Renewal of Planning Approval for Temporary Open Storage of Construction Material and Vehicle Parts for a Period of Three Years	11.6.2021

Rejected Application

Application No.	Use/Development	Date of Consideration	Rejection Reasons
A/YL-PH/161	Temporary Open Storage of Goods Vehicles and Goods Vehicle Repairing Workshop for a Period of 12 Months	16.1.1998	(1) to (4)

Rejection Reasons

- (1) The proposed development is not in line with the planning intention of the “Residential (Group D)” (“R(D)”) zone which is to improve and upgrade the existing temporary structures within this zone and to cater for low-rise, low-density residential development. There is no strong justification for a departure from the planning intention, even on a temporary basis;
- (2) There is no information in the submission to demonstrate that the development will not have adverse drainage impact on the surrounding areas;
- (3) As “Open Storage” zones have been reserved on the draft Pat Heung Outline Zoning Plan for the rational development of open storage of goods which cannot be accommodated in conventional godown premises, there is no justification to allow such open storage uses to proliferate in the “R(D)” zone even on a temporary basis; and
- (4) The approval of the application would set an undesirable precedent for similar applications, the cumulative effect of which would further degrade the environment of the area.

Similar s.16 Applications within/straddling the same “R(D)” Zone in the Vicinity of the Site in the Past Five Years

Approved Applications

	Application No.	Use/Development	Date of Consideration
1	A/YL-PH/810	Temporary Open Storage of Construction Materials and Machineries for a Period of Three Years	20.9.2019 [revoked on 20.12.2021]
2	A/YL-PH/814	Temporary Open Storage of Vehicles, Vehicle Parts and Construction Materials for a Period of Three Years	16.8.2019
3	A/YL-PH/831	Renewal of Planning Approval for Temporary Open Storage of Construction Materials, Machinery (Electricity Generator), Vehicle Parts, Temporary Transit Shipment Particles and Containers for Storage of Plastic Barriers for a Period of Three Years	26.5.2020

	Application No.	Use/Development	Date of Consideration
4	A/YL-PH/878	Temporary Open Storage of Construction Materials, Machinery, Second-Hand Vehicles, Vehicle Parts and Ancillary Office for a Period of Three Years	9.7.2021
5	A/YL-PH/910	Temporary Open Storage of Construction Materials and Machineries for a Period of Three Years	29.7.2022
6	A/YL-PH/923	Renewal of Planning Approval for Temporary Open Storage (Vehicles, Vehicle Parts and Construction Materials) for a Period of Three Years	29.7.2022 [revoked on 17.11.2022]
7	A/YL-PH/937	Temporary Open Storage of Vehicles, Vehicle Parts and Construction Materials for a Period of Three Years	3.3.2023
8	A/YL-PH/942	Renewal of Planning Approval for Temporary Open Storage of Construction Materials, Machinery (Electricity Generator), Vehicle Parts, Temporary Transit Shipment Particles and Containers for Storage of Plastic Barriers for a Period of Three Years	31.3.2023

Rejected Application

Application No.	Use/Development	Date of Consideration	Rejection Reasons
A/YL-PH/821	Temporary Open Storage of Scrap Vehicles for a Period of Three Years	29.11.2019	(1) to (3)

Rejection Reasons

- (1) The proposed development is not in line with the planning intentions of the “Agriculture” (“AGR”) and “R(D)” zones. The planning intention of the “AGR” zone is primarily to retain and safeguard good quality agricultural land/farm/fish ponds for agricultural purposes, and to retain fallow arable land with good potential for rehabilitation for cultivation and other agricultural purposes. The planning intention of the “R(D)” zone is primarily for improvement and upgrading of existing temporary structures within the rural areas through redevelopment of existing temporary structures into permanent buildings and for low-rise, low-density residential developments subject to planning permission from the Town Planning Board (TPB). There is no strong planning justification in the submission for a departure from the planning intentions, even on a temporary basis;

- (2) The application does not comply with the TPB Guidelines for Application for Open Storage and Port Back-up Uses under Section 16 of the Town Planning Ordinance in that there is no previous planning approval for open storage use granted at the Site and there are adverse departmental comments and local objections against the proposed development; and
- (3) The approval of the application, even on a temporary basis, would set an undesirable precedent for other similar applications within the “AGR” zone. The cumulative effect of approving such similar application would result in a general degradation of the rural environment of the area.

Government Departments' General Comments

1. Land Administration

Comments of the District Lands Officer/Yuen Long, Lands Department (DLO/YL, LandsD):

- the application site (the Site) comprises Government Land (GL) and Old Schedule Agricultural Lot Nos. 2901, 2902, 2904, 2905, 2909 and 2911 all in D.D. 111 held under the Block Government Lease which contains the restriction that no structures are allowed to be erected without the prior approval of the Government; and
- Lot No. 2901 in D.D. 111 is covered by Short Term Waiver (STW) No. 3931 for the purpose of temporary open storage of construction materials, machinery (electricity generator), vehicle parts, temporary transit shipment particles and containers for storage of plastic barriers. Lot No. 2902 in D.D. 111 and the adjoining GL are covered by STW No. 2916 and Short Term Tenancy (STT) No. 3033 for the purpose of storage of construction material as well as temporary open storage of construction materials and vehicle parts respectively.

2. Traffic

Comments of the Commissioner for Transport (C for T):

- no adverse comment on the application from traffic engineering perspective.

Comments of the Chief Highway Engineer/New Territories West, Highways Department (CHE/NTW, HyD):

- no adverse comment on the application from highways maintenance perspective.

3. Drainage

Comments of the Chief Engineer/Mainland North, Drainage Services Department (CE/MN, DSD):

- no objection in-principle to the application.

4. Environment

Comments of the Director of Environmental Protection (DEP):

- no objection to the application; and
- there was no environmental complaint concerning the Site received in the past three years.

5. **Fire Safety**

Comments of the Director of Fire Services (D of FS):

- no objection in-principle to the application subject to the existing fire service installations (FSIs) implemented on the Site being maintained in an efficient working order at all times.

6. **Landscape**

Comments of the Chief Town Planner/Urban Design and Landscape, Planning Department (CTP/UD&L, PlanD):

- the Site falls within “Residential (Group D)” zone, which is non-landscape sensitive zoning and no significant landscape impact arising from the applied use is anticipated.

7. **Building Matters**

Comments of the Chief Building Surveyor/New Territories West, Buildings Department (CBS/NTW, BD):

- there is no record of approval by the Building Authority for the existing structures at the Site.

8. **District Officer’s Comments**

Comments of the District Officer (Yuen Long), Home Affairs Department (DO/YL, HAD):

- his office has not received any local’s comment on the application and he has no particular comment on the application.

9. **Other Departments**

The following government departments have no objection to / no adverse comment / no comment on the application:

- the Project Manager (West), Civil Engineering and Development Department (PM(W), CEDD);
- the Chief Engineer/Construction, Water Supplies Department (CE/C, WSD).

**Appendix VI of RNTPC
Paper No. A/YL-PH/1001**

Recommended Advisory Clauses

- (a) to note the comments of the District Lands Officer/Yuen Long, Lands Department (DLO/YL, LandsD) that:
- the Short Term Wavier (STW) and Short Term Tenancy (STT) holder(s) will need to apply to his office for modification of the STWs and STT conditions where appropriate and the lots owners shall apply to this office for a STW to permit the structure(s) erected within Lot Nos. 2904, 2905, 2909 and 2911 all in D.D. 111. The application(s) for STWs and STT will be considered by the Government in its capacity as a landlord and there is no guarantee that it will be approved. The STWs and STT, if approved, will be subject to such terms and conditions including the payment of waiver fee, *rent* and administration fee as considered appropriate by LandsD. Besides, given the proposed use is temporary in nature, only erection of temporary structure(s) will be considered;
- (b) to note the comments of the Commissioner for Transport (C for T) that:
- the application site (the Site) is connected to the public road network via a section of a local access road which is not managed by Transport Department. The land status of the local access road should be checked with the LandsD. Moreover, the management and maintenance responsibilities of the local access road should be clarified with the relevant lands and maintenance authorities accordingly. Sufficient manoeuvring space shall be provided within the Site. No vehicle is allowed to queue back to or reverse onto/from public road at any time during the planning approval period;
- (c) to note the comments of the Chief Highway Engineer/New Territories West, Highways Department (CHE/NTW, HyD) that:
- HyD shall not be responsible for the maintenance of any access connecting the Site and Kam Tin Road; and
 - adequate drainage measures should be provided to prevent surface water running from the Site to the nearby public road and drains;
- (d) to note the comments of the Director of Environmental Protection (DEP) that:
- the applicant is advised to follow the relevant mitigation measures and requirements in the revised “Code of Practice on Handling the Environmental Aspects of Temporary uses and Open Storage Sites” issued by DEP;
- (e) to note the comments of the Chief Building Surveyor/New Territories West, Buildings Department (CBS/NTW, BD) that:
- if the existing structures are erected on leased land without the approval of the BD (not being a New Territories Exempted House), they are unauthorised under the Buildings Ordinance (BO) and should not be designated for any approved use under the captioned application;
 - before any new building works (including containers/open sheds as temporary buildings and land filling) are to be carried out on Site, the prior approval and consent of the BD should be obtained, otherwise they are Unauthorised Building Works

(UBW). An Authorised Person (AP) should be appointed as the co-ordinator for the proposed building works in accordance with the BO;

- for UBW erected on leased land, enforcement action may be taken by the BD to effect their removal in accordance with BD's enforcement policy against UBW as and when necessary. The granting of any planning approval should not be construed as an acceptance of any existing building works or UBW on the Site under the BO;
- the Site shall be provided with means of obtaining access thereto from a street and emergency vehicular access in accordance with Regulations 5 and 41D of the Building (Planning) Regulations respectively; and
- if the Site does not abut on a specified street of less than 4.5m wide and its permitted development intensity shall be determined under Regulation 19(3) of the Building (Planning) Regulations at the building plan submission stage.