

(摘錄自申請人於 18.2.2022 呈交的申請書)  
(Extract from Applicant's  
Submission of 18.2.2022)

參考編號  
REFERENCE No.  
A/YL-PH/909

繪圖 DRAWING  
A-1

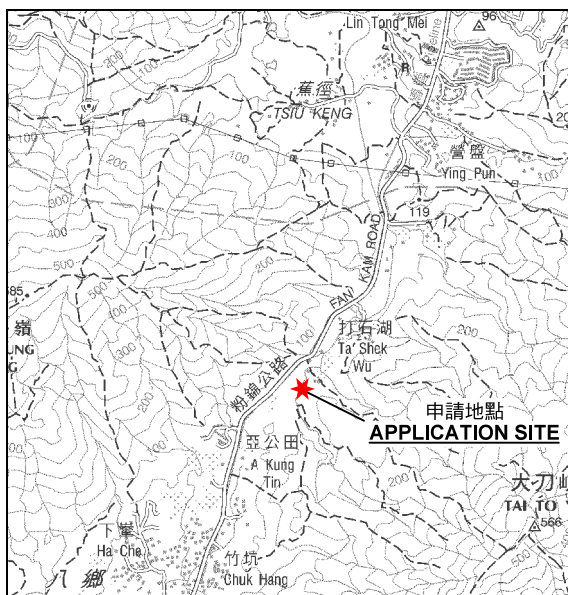



要覽圖 KEY PLAN

SCALE 1 : 50 000 比例尺

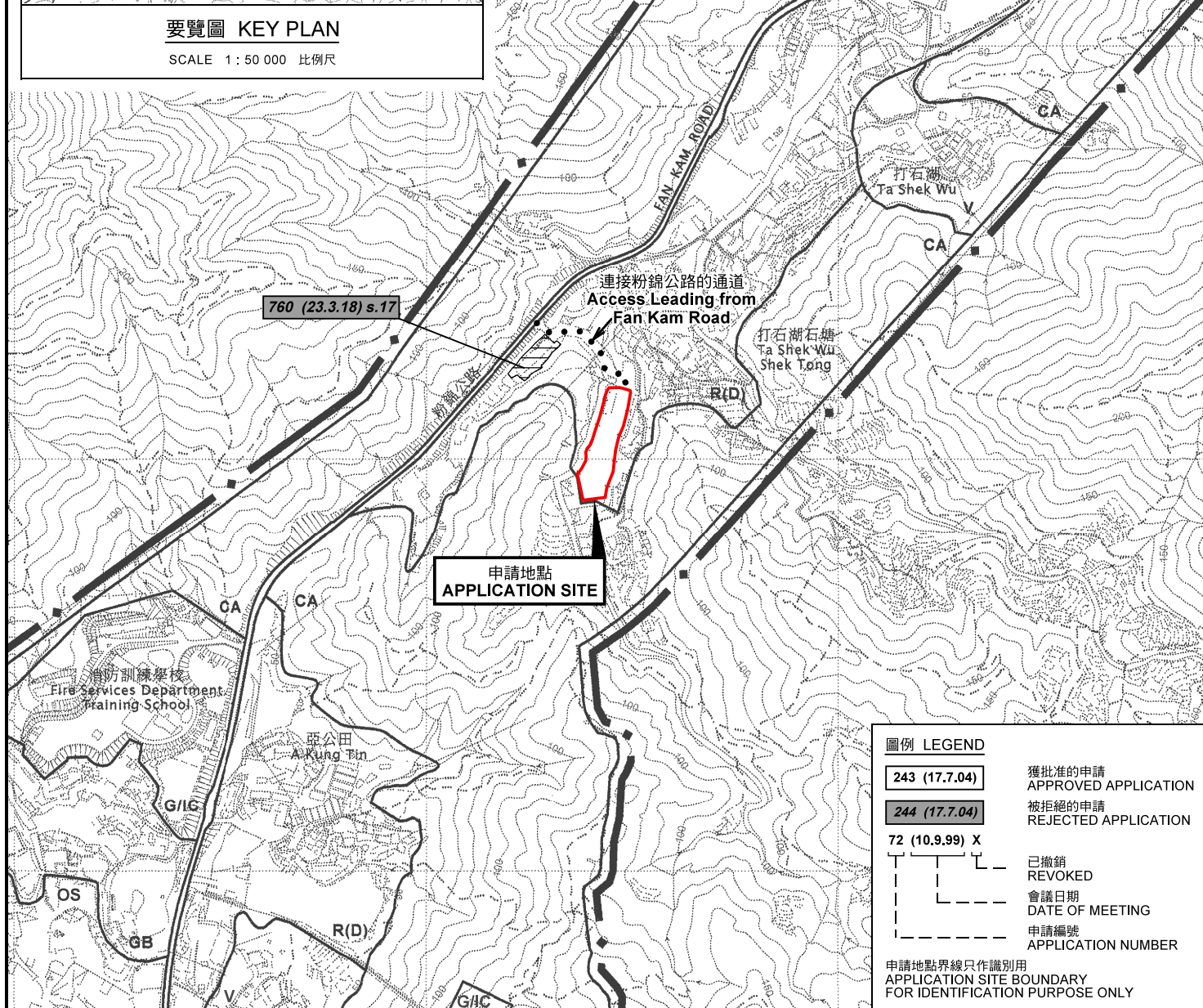

圖例 LEGEND

- |                       |                                |
|-----------------------|--------------------------------|
| <b>243 (17.7.04)</b>  | 獲批准的申請<br>APPROVED APPLICATION |
| <b>244 (17.7.04)</b>  | 被拒絕的申請<br>REJECTED APPLICATION |
| <b>72 (10.9.99) X</b> | 已撤銷<br>REVOKED                 |
| ---                   | 會議日期<br>DATE OF MEETING        |
| ---                   | 申請編號<br>APPLICATION NUMBER     |

申請地點界線只作識別用  
APPLICATION SITE BOUNDARY  
FOR IDENTIFICATION PURPOSE ONLY

位置圖及同類申請 LOCATION PLAN WITH SIMILAR APPLICATION

臨時露天存放挖泥機及起重機用途的規劃許可續期(為期3年)  
元朗八鄉打石湖丈量約份第108約多個地段  
RENEWAL OF PLANNING APPROVAL FOR  
TEMPORARY OPEN STORAGE OF EXCAVATORS AND  
LOADERS FOR A PERIOD OF 3 YEARS  
VARIOUS LOTS IN D.D. 108 AND ADJOINING  
GOVERNMENT LAND, TA SHEK WU, PAT HEUNG, YUEN LONG

SCALE 1 : 7 500 比例尺  
米 100 0 100 200 300 米  
METRES

本摘要圖於2022年4月27日擬備，  
所根據的資料為於2006年10月17日  
核准的分區計劃大綱圖編號 S/YL-PH/11  
EXTRACT PLAN PREPARED ON 27.4.2022  
BASED ON OUTLINE ZONING PLAN No.  
S/YL-PH/11 APPROVED ON 17.10.2006

規劃署  
PLANNING  
DEPARTMENT



參考編號  
REFERENCE No.  
A/YL-PH/909

圖 PLAN  
A-1a

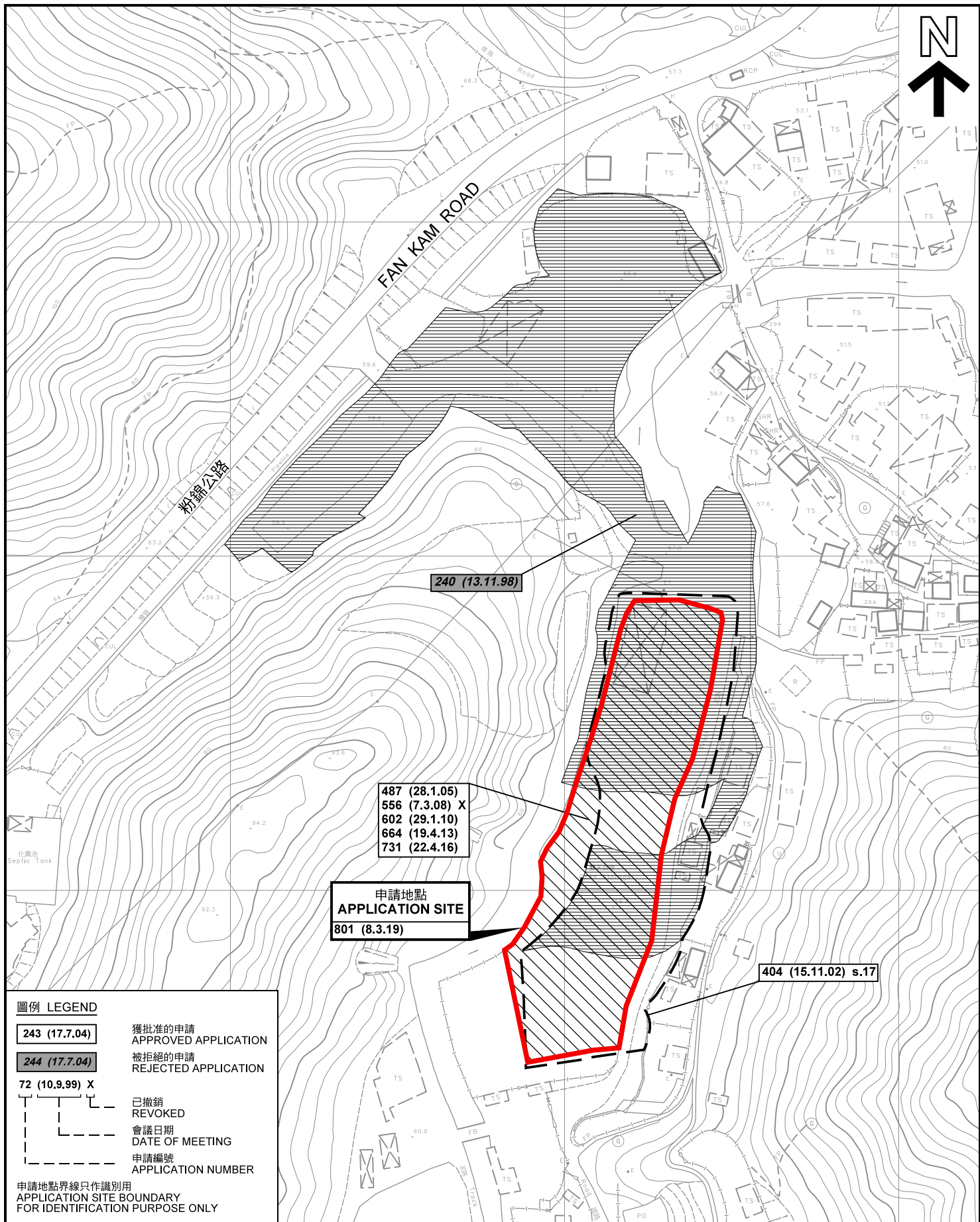

### 先前申請圖 PREVIOUS APPLICATION PLAN

臨時露天存放挖泥機及起重機用途的規劃許可續期(為期3年)  
元朗八鄉打石湖丈量約份第108約多個地段  
RENEWAL OF PLANNING APPROVAL FOR  
TEMPORARY OPEN STORAGE OF EXCAVATORS AND  
LOADERS FOR A PERIOD OF 3 YEARS  
VARIOUS LOTS IN D.D. 108 AND ADJOINING  
GOVERNMENT LAND, TA SHEK WU, PAT HEUNG, YUEN LONG

SCALE 1 : 1 500 比例尺  
米 20 0 20 40 60 米  
METRES

規劃署  
PLANNING  
DEPARTMENT



參考編號  
REFERENCE No.  
A/YL-PH/909

圖 PLAN  
A-1b

本摘要圖於2022年3月16日擬備，所根據的  
資料為測量圖編號 6-NE-5A  
EXTRACT PLAN PREPARED ON 16.3.2022  
BASED ON SURVEY SHEET No.  
6-NE-5A



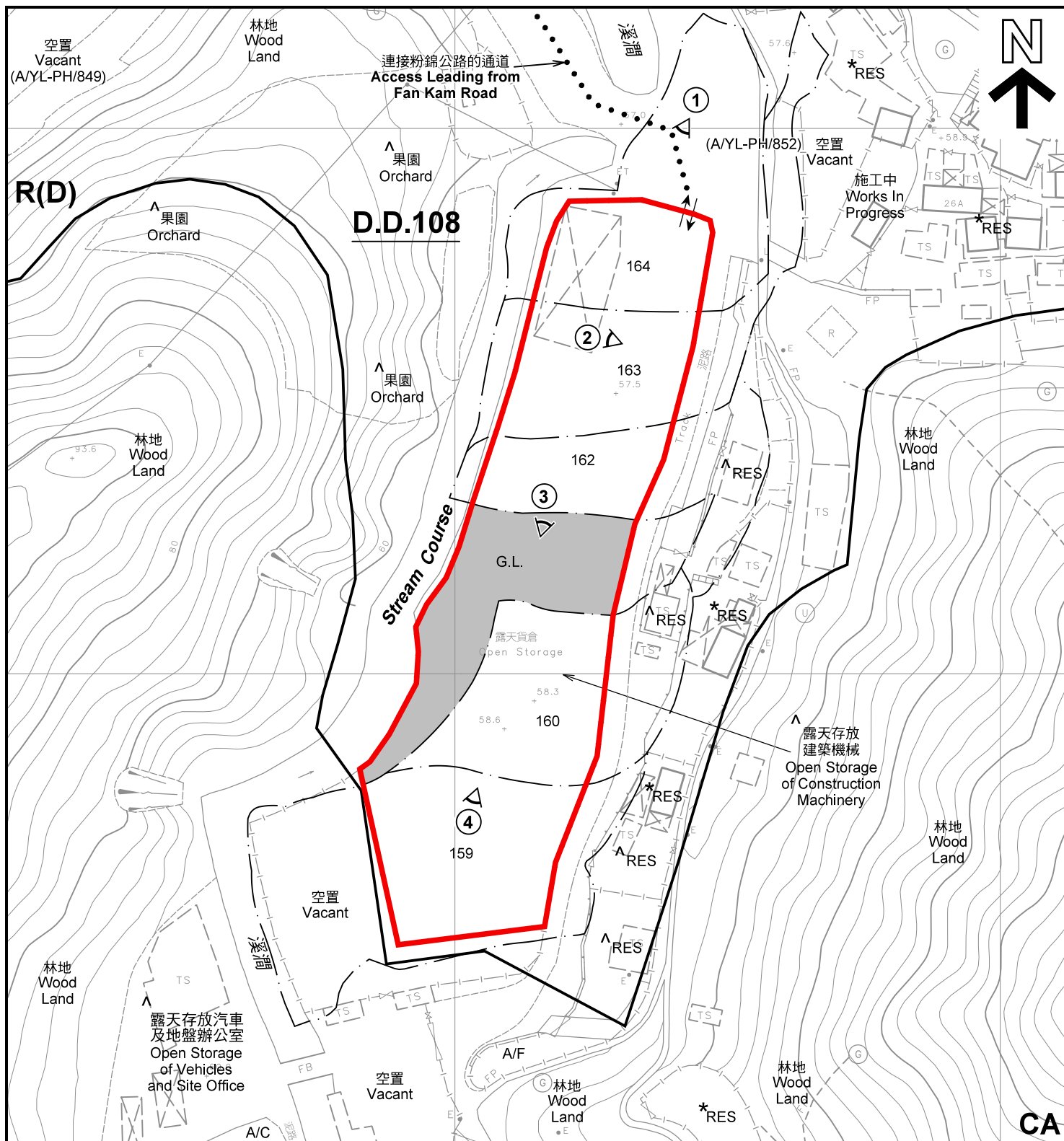

**註釋 Notes :**

- (1) 2022年4月12日及19日勘測的土地用途  
Land uses shown on this plan are in accordance with the land use survey conducted by the Planning Department on 12.4.2022 & 19.4.2022
- (2) \* 土地用途跟1991年12月勘測的土地用途一致  
Indicates that the use is the same as that revealed by the land use survey conducted by the Planning Department in Dec 1991
- (3) ^ 土地用途跟1991年12月勘測的土地用途有別  
Indicates that the use is different from that revealed by the land use survey conducted by the Planning Department in Dec 1991

**圖例 LEGEND**

- |      |   |     |   |
|------|---|-----|---|
|      | 申請地點(界線只作識別用)<br>APPLICATION SITE<br>(BOUNDARY FOR IDENTIFICATION PURPOSE ONLY) | RES | 住用構築物<br>RESIDENTIAL STRUCTURES         |
| R(D) | 住宅(丁類)<br>RESIDENTIAL (GROUP D)   | A/F | 休耕農地<br>FALLOW AGRICULTURAL LAND        |
| CA   | 自然保育區<br>CONSERVATION AREA  | A/C | 常耕農地<br>CULTIVATED AGRICULTURAL LAND    |
| G.L. | 政府土地<br>GOVERNMENT LAND   | ①   | 實地照片的觀景點<br>VIEWING POINT OF SITE PHOTO |
|      |   |     | 入口/出口<br>INGRESS / EGRESS               |

**平面圖 SITE PLAN**

臨時露天存放泥機及起重機用途的規劃許可續期(為期3年)  
元朗八鄉打石湖丈量約份第108約多個地段  
RENEWAL OF PLANNING APPROVAL FOR  
TEMPORARY OPEN STORAGE OF EXCAVATORS AND  
LOADERS FOR A PERIOD OF 3 YEARS  
VARIOUS LOTS IN D.D. 108 AND ADJOINING  
GOVERNMENT LAND, TA SHEK WU, PAT HEUNG, YUEN LONG

SCALE 1 : 1 000 比例尺

米 20 0 20 40 米  
METRES

本摘要圖於2022年4月27日擬備，所根據的資料為測量圖編號 6-NE-5A  
EXTRACT PLAN PREPARED ON 27.4.2022  
BASED ON SURVEY SHEET No. 6-NE-5A

**規劃署  
PLANNING  
DEPARTMENT**



參考編號  
REFERENCE No.  
A/YL-PH/909

圖 PLAN  
A-2



香港狗公園  
Hong Kong  
K-9 Club



FAN KAM ROAD

連接粉錦公路的通道  
Access Leading from  
Fan Kam Road

粉錦公路  
FAN KAM ROAD

圖例 LEGEND



申請地點(界線只作識別用)  
APPLICATION SITE  
(BOUNDARY FOR IDENTIFICATION  
PURPOSE ONLY)

本摘要圖於2022年4月27日擬備，所根據的資料為地政總署於2021年1月15日拍得的航攝照片編號 E126846C  
EXTRACT PLAN PREPARED ON 27.4.2022  
BASED ON AERIAL PHOTO No.  
E126846C TAKEN ON 15.1.2021  
BY LANDS DEPARTMENT

航攝照片 AERIAL PHOTO

臨時露天存放挖泥機及起重機用途的規劃許可續期(為期3年)  
元朗八鄉打石湖丈量約份第108約多個地段  
RENEWAL OF PLANNING APPROVAL FOR  
TEMPORARY OPEN STORAGE OF EXCAVATORS AND  
LOADERS FOR A PERIOD OF 3 YEARS  
VARIOUS LOTS IN D.D. 108 AND ADJOINING  
GOVERNMENT LAND, TA SHEK WU, PAT HEUNG, YUEN LONG

規劃署  
PLANNING  
DEPARTMENT



參考編號  
REFERENCE No.  
A/YL-PH/909

圖 PLAN  
A-3



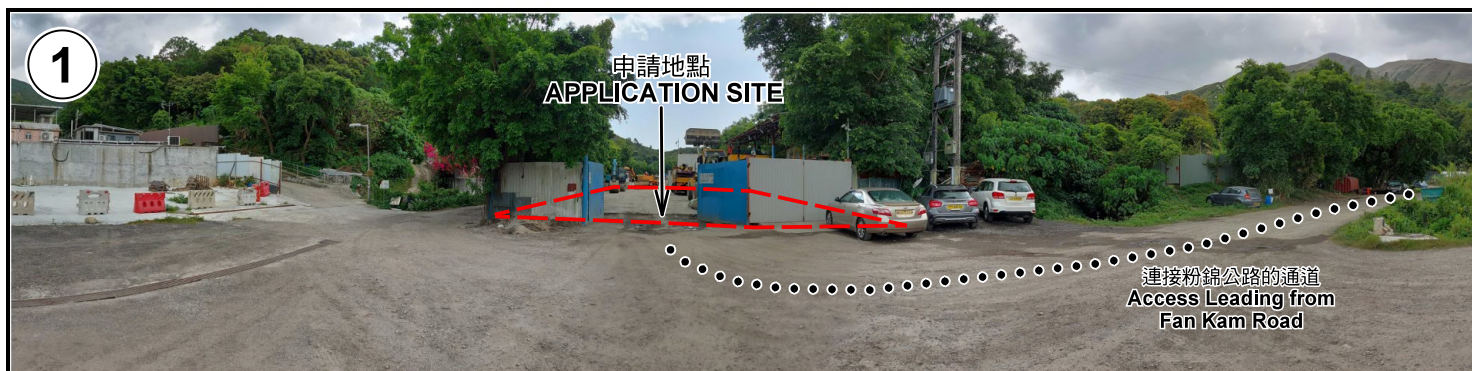

申請地點界線只作識別用 APPLICATION SITE BOUNDARY FOR IDENTIFICATION PURPOSE ONLY

### 實地照片 SITE PHOTOS

臨時露天存放挖泥機及起重機用途的規劃許可續期(為期3年)  
元朗八鄉打石湖丈量約份第108約多個地段  
RENEWAL OF PLANNING APPROVAL FOR  
TEMPORARY OPEN STORAGE OF EXCAVATORS AND  
LOADERS FOR A PERIOD OF 3 YEARS  
VARIOUS LOTS IN D.D. 108 AND ADJOINING  
GOVERNMENT LAND, TA SHEK WU, PAT HEUNG, YUEN LONG

規劃署  
PLANNING  
DEPARTMENT



參考編號  
REFERENCE No.  
A/YL-PH/909

圖 PLAN  
A-4

本圖於2022年4月27日擬備，所根據的  
資料為攝於2022年4月12日及4月19日的實地照片  
PLAN PREPARED ON 27.4.2022  
BASED ON SITE PHOTOS  
TAKEN ON 12.4.2022 & 19.4.2022