

| | |
|-----------------------|--------------------------------|
| APPLICATION SITE AREA | : 1,401 m ² (ABOUT) |
| COVERED AREA | : 617 m ² (ABOUT) |
| UNCOVERED AREA | : 784 m ² (ABOUT) |
| PLOT RATIO | : 0.46 (ABOUT) |
| SITE COVERAGE | : 44% (ABOUT) |
| NO. OF STRUCTURE | : 7 |
| DOMESTIC GFA | : NOT APPLICABLE |
| NON-DOMESTIC GFA | : 648 m ² (ABOUT) |
| TOTAL GFA | : 648 m ² (ABOUT) |
| BUILDING HEIGHT | : 7 m (NOT MORE THAN) |
| NO. OF STOREY | : 2 (NOT MORE THAN) |

| STRUCTURE | USE | COVERED AREA | GFA | BUILDING HEIGHT |
|-----------|---|----------------------------|----------------------------|----------------------------------|
| B1* | ANCILLARY OFFICE | 43 m ² (ABOUT) | 43 m ² (ABOUT) | 3.5 m (NOT MORE THAN) (1-STOREY) |
| B2* | ANCILLARY OFFICE | 31 m ² (ABOUT) | 62 m ² (ABOUT) | 7 m (NOT MORE THAN) (2-STOREY) |
| B3* | ANCILLARY OFFICE | 14 m ² (ABOUT) | 14 m ² (ABOUT) | 3.5 m (NOT MORE THAN) (1-STOREY) |
| B4 | SITE OFFICE | 18 m ² (ABOUT) | 18 m ² (ABOUT) | 3.5 m (NOT MORE THAN) (1-STOREY) |
| B5 | SHOP AND SERVICES (MOTOR VEHICLE SHOW ROOM) | 343 m ² (ABOUT) | 343 m ² (ABOUT) | 4.5 m (NOT MORE THAN) (1-STOREY) |
| B6 | RAIN SHELTER | 59 m ² (ABOUT) | 59 m ² (ABOUT) | 3.5 m (ABOUT) (1-STOREY) |
| B7 | RAIN SHELTER | 109 m ² (ABOUT) | 109 m ² (ABOUT) | 3.5 m (ABOUT) (1-STOREY) |
| TOTAL | | 617 m ² (ABOUT) | 648 m ² (ABOUT) | |

The site plan shows a proposed development with the following features:

- Buildings:** Seven buildings are labeled B1 through B7. B1, B2, and B3 are located in the bottom left corner. B4 is a small building in the top right. B5 is a large building at the top. B6 and B7 are located in the center, with B7 being a long, narrow building.
- Boundary:** A red line indicates the site boundary.
- Wall:** A 2.5m high solid metal wall is shown to fence the site boundary.
- Entrance/Exit:** An entrance/exit is located at the bottom left, with a width of approximately 6m.
- Orientation:** A north arrow is located in the top right corner.

NO. OF PRIVATE CAR PARKING SPACE : 2
DIMENSIONS OF PARKING SPACE : 5 m (L) X 2.5 m (W)

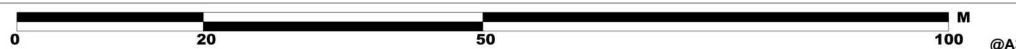

* ALL DIMENSIONS ARE IN MILLIMETER EXCEPT OTHERWISE NOTED
 * DO NOT SCALE DRAWING

LEGEND

| | |
|--|--|
| | APPLICATION SITE |
| | SITE OFFICE |
| | SHOP AND SERVICES (MOTOR VEHICLE SHOWROOM) |
| | RAIN SHELTER |
| | PARKING SPACE (PRIVATE CAR) <i>2.5 m (W) X 5 m (L)</i> |
| | DISPLAYING SPACE <i>2.5 m (W) X 5 m (L)</i> |
| | ENTRANCE / EXIT |

| A | LAYOUT PLAN | 12 FEB 2005 |
|--|-------------|-------------|
| - | LAYOUT PLAN | 06 JAN 2005 |
| REVISION | | |
| drawn | DATE | BY |
| Q. & LY | 06 JUN 2005 | |
| checked - | " | " |
| approved - | " | " |
| contract no. - | | |
| project no. | | |
| TITLE : | | |
| TEMPORARY SHOP AND SERVICES (MOTOR VEHICLE SHOWROOM) WITH ANCILLARY FACILITIES FOR A PERIOD OF 5 YEARS AND ASSOCIATED FILLING OF LAND. | | |
| SITE LOCATION : | | |
| LOT 698 (PART) AND 687 RP IN D.D. 112, SHEK KONG, YUEN LONG, NEW TERRITORIES | | |
| drawing title. | | |
| LAYOUT PLAN | | |
| drawing no. | rev. | scale |
| PLAN 1 | A | METERS |

參考編號
REFERENCE No.
A/YL-SK/409

繪圖
DRAWING
A - 1

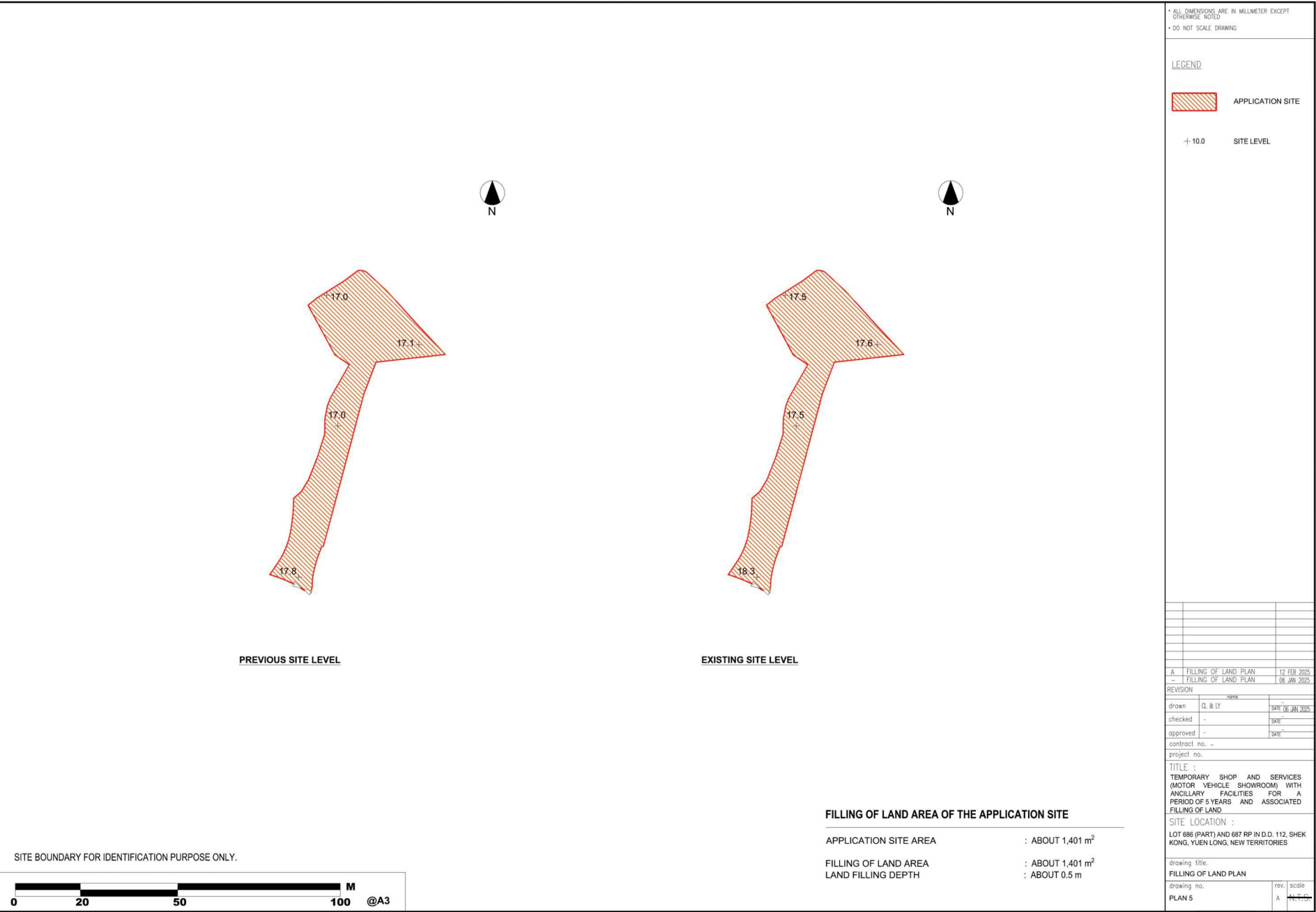

(摘錄自申請人於 12. 2. 2025 呈交的申請書)
(Extract from Applicant's
Submission of 12.2.2025)

參考編號
REFERENCE No.
A/YL-SK/409

繪圖
DRAWING
A - 2

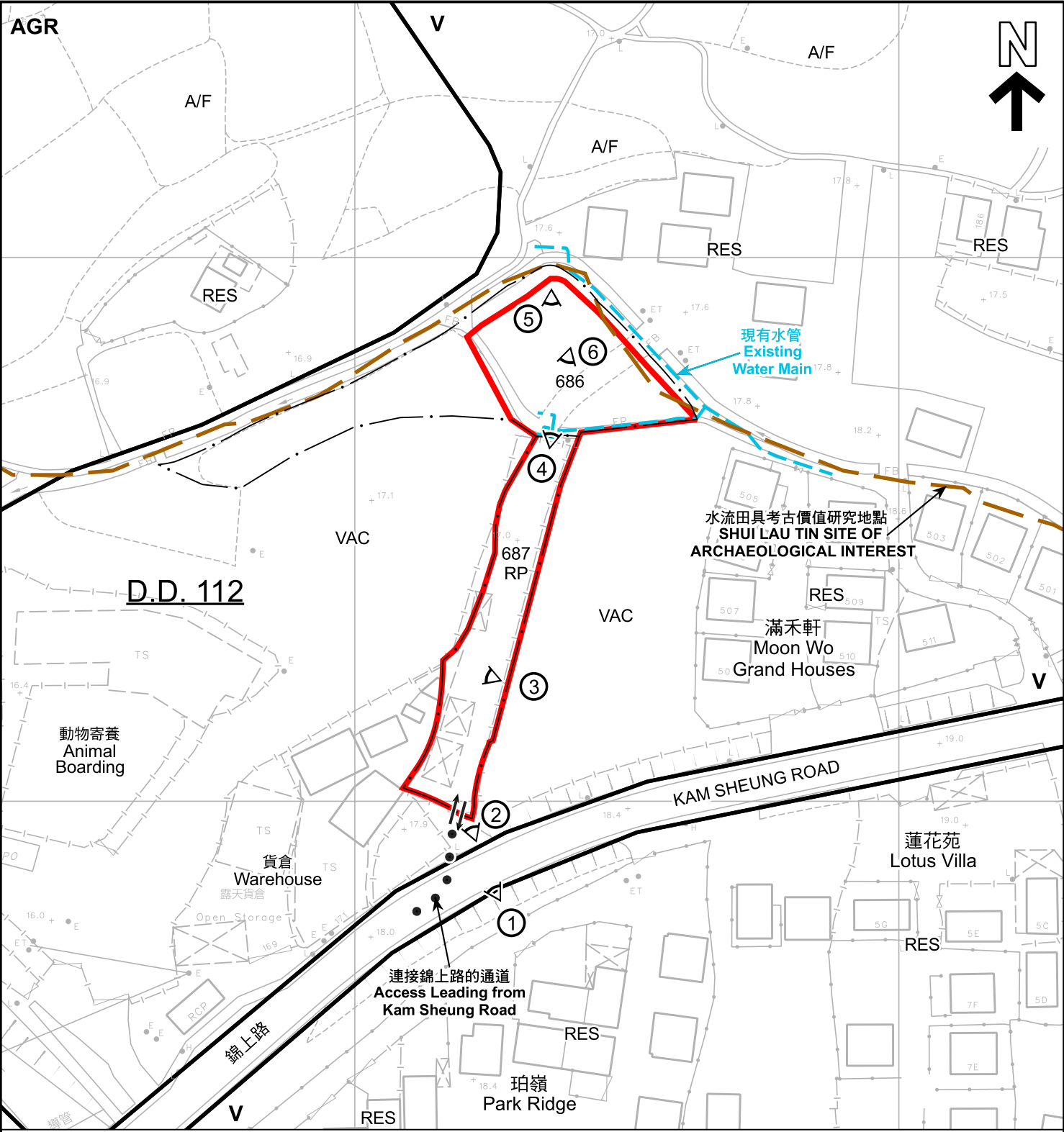

圖例 LEGEND

- 申請地點 (界線只作識別用)
APPLICATION SITE (BOUNDARY FOR IDENTIFICATION PURPOSE ONLY)
- V** 鄉村式發展
VILLAGE TYPE DEVELOPMENT
- AGR** 農業
AGRICULTURE

- A/F** 休耕農地
FALLOW AGRICULTURAL LAND
- RES** 住用構築物
RESIDENTIAL STRUCTURES
- VAC** 空置
VACANT

- ① 實地照片的觀景點
VIEWING POINT OF SITE PHOTO
- 入口/出口
INGRESS / EGRESS

註釋 Note :
2025年2月13日勘测的土地用途
Land uses shown on this plan are in accordance with the land use survey conducted by the Planning Department on 13.2.2025

平面圖 SITE PLAN

臨時商店及服務行業 (汽車陳列室) 連
附屬設施 (為期5年) 及相關的填土工程
新界元朗石崗丈量約份第112約地段第686號 (部分) 及第687號餘段
TEMPORARY SHOP AND SERVICES (MOTOR-VEHICLE SHOWROOM)
WITH ANCILLARY FACILITIES FOR A PERIOD OF 5 YEARS AND
ASSOCIATED FILLING OF LAND
LOTS 686 (PART) AND 687 RP IN D.D. 112, SHEK KONG, YUEN LONG,
NEW TERRITORIES
SCALE 1 : 1 000 比例尺

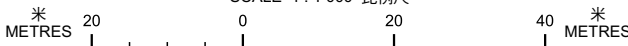

規劃署
PLANNING
DEPARTMENT



參考編號
REFERENCE No.
A/YL-SK/409

圖 PLAN
A-2

本摘要圖於2025年3月12日擬備，
所根據的資料為測量圖編號6-NE-18B
EXTRACT PLAN PREPARED ON 12.3.2025
BASED ON SURVEY SHEET No.
6-NE-18B



圖例 LEGEND

-  申請地點（界線只作識別用）
APPLICATION SITE (BOUNDARY FOR IDENTIFICATION PURPOSE ONLY)
-  入口/出口
INGRESS / EGRESS

航攝照片 AERIAL PHOTO

臨時商店及服務行業（汽車陳列室）連
附屬設施（為期5年）及相關的填土工程
新界元朗石崗丈量約份第112約地段第686號（部分）及第687號餘段
TEMPORARY SHOP AND SERVICES (MOTOR-VEHICLE SHOWROOM)
WITH ANCILLARY FACILITIES FOR A PERIOD OF 5 YEARS AND
ASSOCIATED FILLING OF LAND
LOTS 686 (PART) AND 687 RP IN D.D. 112, SHEK KONG, YUEN LONG,
NEW TERRITORIES

規劃署
PLANNING
DEPARTMENT



參考編號
REFERENCE No.
A/YL-SK/409

圖 PLAN
A-3

本摘要圖於2025年2月26日擬備，所根據的資料為地政總署於2023年10月5日拍得的航攝照片編號 E210223C

EXTRACT PLAN PREPARED ON 26.2.2025
BASED ON AERIAL PHOTO No. E210223C
TAKEN ON 5.10.2023
BY LANDS DEPARTMENT



申請地點界線只作識別用
APPLICATION SITE BOUNDARY FOR IDENTIFICATION PURPOSE ONLY

實地照片 SITE PHOTO

臨時商店及服務行業（汽車陳列室）連
附屬設施（為期5年）及相關的填土工程
新界元朗石崗丈量約份第112約地段第686號（部分）及第687號餘段
TEMPORARY SHOP AND SERVICES (MOTOR-VEHICLE SHOWROOM)
WITH ANCILLARY FACILITIES FOR A PERIOD OF 5 YEARS AND
ASSOCIATED FILLING OF LAND
LOTS 686 (PART) AND 687 RP IN D.D. 112, SHEK KONG, YUEN LONG,
NEW TERRITORIES

規劃署
PLANNING
DEPARTMENT



參考編號
REFERENCE No.
A/YL-SK/409

圖 PLAN
A-4a

本圖於2025年3月10日擬備，
所根據的資料為攝於
2025年2月14日的實地照片
PLAN PREPARED ON 10.3.2025
BASED ON SITE PHOTOS
TAKEN ON 14.2.2025



申請地點界線只作識別用
APPLICATION SITE BOUNDARY FOR IDENTIFICATION PURPOSE ONLY

實地照片 SITE PHOTO

臨時商店及服務行業（汽車陳列室）連
附屬設施（為期5年）及相關的填土工程
新界元朗石崗丈量約份第112約地段第686號（部分）及第687號餘段
TEMPORARY SHOP AND SERVICES (MOTOR-VEHICLE SHOWROOM)
WITH ANCILLARY FACILITIES FOR A PERIOD OF 5 YEARS AND
ASSOCIATED FILLING OF LAND
LOTS 686 (PART) AND 687 RP IN D.D. 112, SHEK KONG, YUEN LONG,
NEW TERRITORIES

規劃署
PLANNING
DEPARTMENT



參考編號
REFERENCE No.
A/YL-SK/409

圖 PLAN
A-4b

本圖於2025年3月10日擬備，
所根據的資料為攝於
2025年2月14日的實地照片
PLAN PREPARED ON 10.3.2025
BASED ON SITE PHOTOS
TAKEN ON 14.2.2025