

Project 項目名稱:

Proposed Temporary Public Vehicle  
 Park for Private Car and Shop &  
 Services (Convenient Store) for a  
 Period of 3 Years and Excavation of  
 Land at Lot 282 in D.D. 105, Tsing Lung  
 Tsuen, San Tin, Yuen Long, N.T.

Drawing Title 圖目:

Proposed Layout Plan

Drawing No. 圖號:

Figure 3

Remarks 備註:

Scale 比例:

1:1000

(摘錄自申請人於 28. 12. 2021 呈交的申請書)  
 (Extract from Applicant's  
 Submission of 28.12.2021)

參考編號

REFERENCE No.

A/YL-ST/608

繪圖 DRAWING

A-1

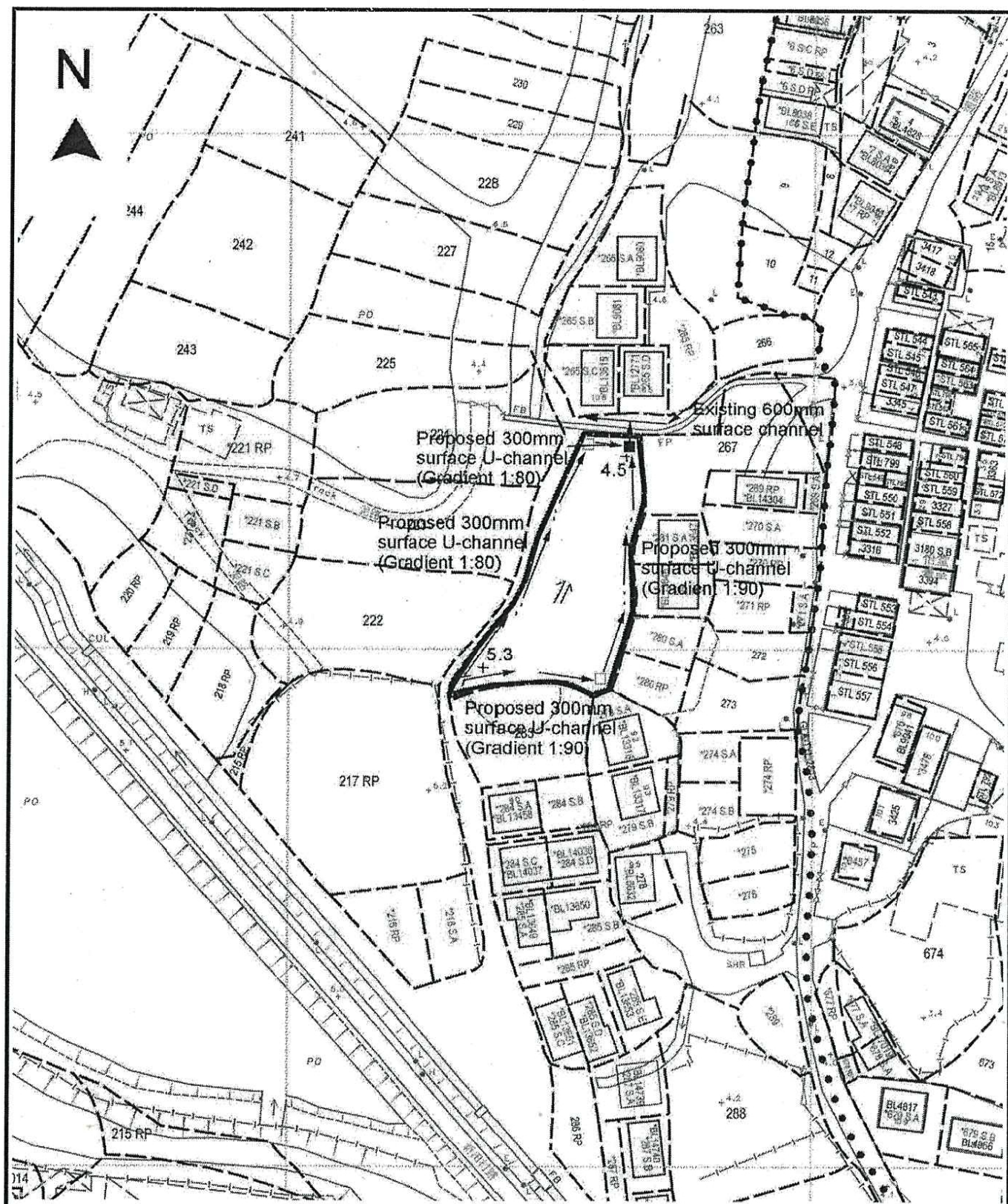

Project 項目名稱:

Proposed Temporary Public Vehicle Park for Private Car and Shop & Services (Convenient Store) for a Period of 3 Years and Excavation of Land at Lot 282 in D.D. 105, Tsing Lung Tsuen, San Tin, Yuen Long, N.T.

Drawing Title 圖目:

Proposed Drainage Plan

Drawing No. 圖號:

Figure 4

Remarks 備註:

+4.5 Level (in mPD)

← Flow of surface runoff

□ Proposed catchpit

■ Proposed Catchpit with sand trap

Scale 比例:

1:1000

(摘錄自申請人於 28.12.2021 呈交的申請書)  
(Extract from Applicant's  
Submission of 28.12.2021)

參考編號  
REFERENCE No.  
A/YL-ST/608

繪圖 DRAWING  
A-2









#### 圖例 LEGEND



申請地點 (界線只作識別用)  
APPLICATION SITE  
(BOUNDARY FOR IDENTIFICATION  
PURPOSE ONLY)

本摘要圖於2022年1月17日擬備，所根據的資料為地政總署於2021年1月14日拍得的航攝照片編號 E125509C  
EXTRACT PLAN PREPARED ON 17.1.2022  
BASED ON AERIAL PHOTO No.  
E125509C TAKEN ON 14.1.2021  
BY LANDS DEPARTMENT

#### 航攝照片 AERIAL PHOTO

擬議臨時公眾私家車停車場連附屬商店及服務行業 (為期 3 年) 和相關挖土工程  
元朗新田丈量約份第105約地段第282號  
PROPOSED TEMPORARY PUBLIC VEHICLE PARK  
FOR PRIVATE CAR AND ANCILLARY SHOP  
AND SERVICES FOR A PERIOD OF 3 YEARS  
AND ASSOCIATED EXCAVATION OF LAND  
LOT 282 IN D.D. 105, SAN TIN, YUEN LONG

規劃署  
PLANNING  
DEPARTMENT



參考編號  
REFERENCE No.  
A/YL-ST/608

圖 PLAN  
A-3



申請地點界線只作識別用 APPLICATION SITE BOUNDARY FOR IDENTIFICATION PURPOSE ONLY

本圖於2022年1月21日擬備，所根據的資料為攝於2022年1月4日的實地照片  
PLAN PREPARED ON 21.1.2022  
BASED ON SITE PHOTOS  
TAKEN ON 4.1.2022

**實地照片 SITE PHOTOS**

擬議臨時公眾私家車停車場連附屬商店及服務行業（為期 3 年）和相關挖土工程  
元朗新田丈量約份第105約地段第282號  
PROPOSED TEMPORARY PUBLIC VEHICLE PARK FOR PRIVATE CAR AND ANCILLARY SHOP AND SERVICES FOR A PERIOD OF 3 YEARS AND ASSOCIATED EXCAVATION OF LAND LOT 282 IN D.D. 105, SAN TIN, YUEN LONG

規 劃 署  
PLANNING  
DEPARTMENT



參考編號  
REFERENCE No.  
A/YL-ST/608

圖 PLAN  
A-4