

DEVELOPMENT PARAMETERS

APPLICATION SITE AREA	: 10,370m ² (ABOUT)
COVERED AREA	: 1,095.9m ² (ABOUT)
UNCOVERED AREA	: 9,274.1m ² (ABOUT)
NO. OF STRUCTURE	: 32
DOMESTIC GFA	: N/A
NON-DOMESTIC GFA	: 1,095.9m ² (ABOUT)
BUILDING HEIGHT	: 2.3m - 6m (ABOUT)
NO. OF STOREY	: 1

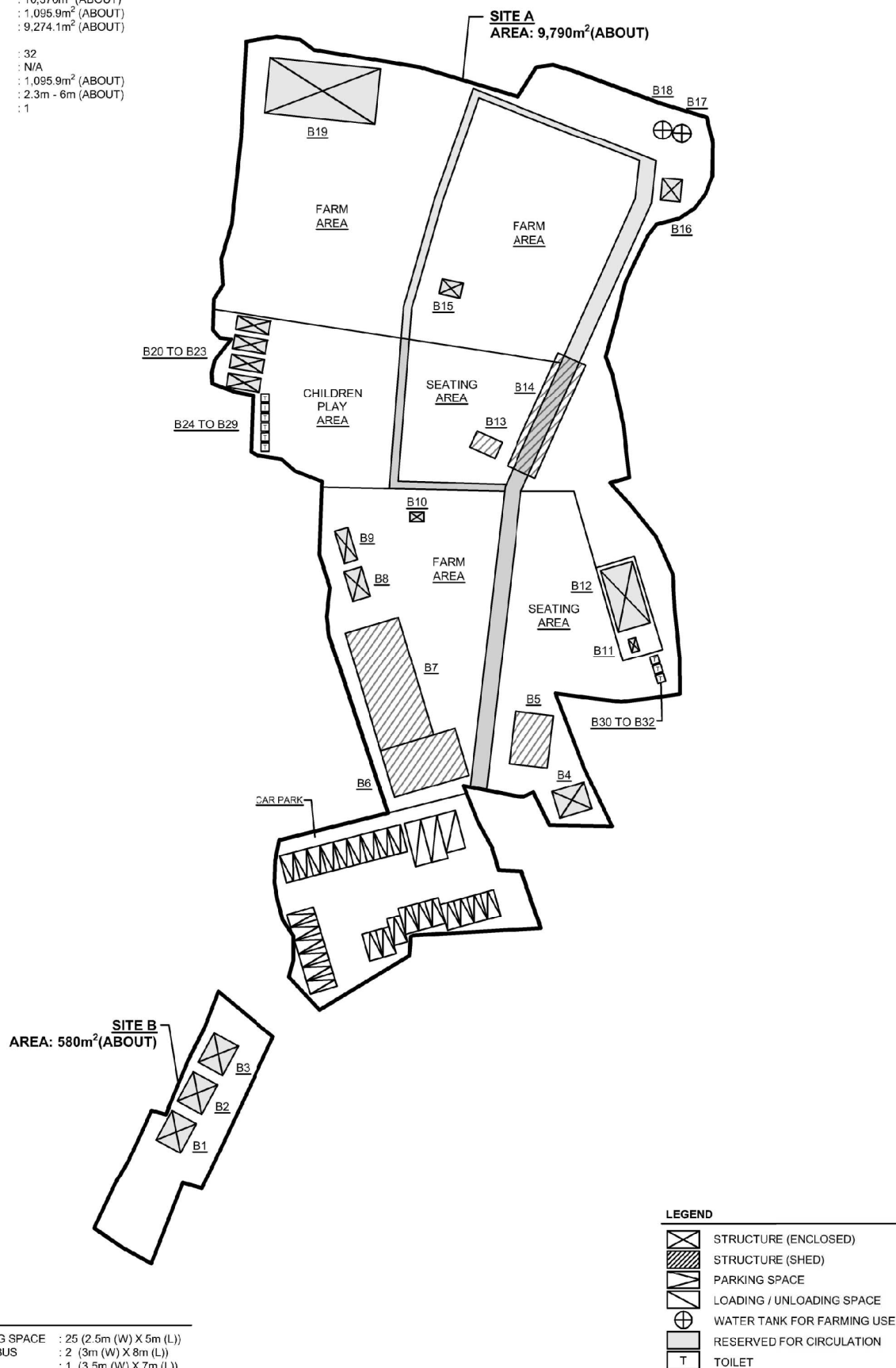

PARKING PROVISIONS

NO. OF PRIVATE CAR PARKING SPACE	: 25 (2.5m (W) X 5m (L))
NO. OF L/UL SPACE FOR MINIBUS	: 2 (3m (W) X 8m (L))
OF L/UL SPACE FOR LGV	: 1 (3.5m (W) X 7m (L))

Drawing No.
P04Ver.
01

Project
PROPOSED TEMPORARY PLACE OF RECREATION, SPORTS OR CULTURE (HOBBY FARM) FOR A PERIOD OF 3 YEARS AND LAND FILLING

LOT 1330 (PART) AND VARIOUS LOTS IN D.D. 117 AND ADJOINING GOVERNMENT LAND

Drawing Title

LAYOUT PLAN

Scale of A4

4:1000

Drawn

Date
2.7.2020

Revised

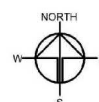
Date
8.4.2021

(摘錄自申請人於 8.4.2021 呈交的進一步資料)
(Extract from Applicant's Further
Information Submitted on 8.4.2021)

參考編號
REFERENCE No.
AYL-TT/505

繪圖 DRAWING
A-1

PAVED RATIO OF THE APPLICATION SITE

APPLICATION SITE AREA	: 10,370m ²	(ABOUT)
FARMLAND AREA	: 5,339m ²	(52%)(ABOUT)
SOILED GROUND AREA	: 2,448m ²	(23%)(ABOUT)
INCLUDING:		
MUD FLOOR	: 1,360m ²	(ABOUT)
GRAVEL FLOOR	: 1,088m ²	(ABOUT)
LAND FILLING AREA	: 2,092m ²	(20%)(ABOUT)
INCLUDING:		
CONCRETE FLOOR	: 1,218m ²	(ABOUT)
BRICK FLOOR	: 874m ²	(ABOUT)
LANDSCAPING AREA	: 491m ²	(5%)(ABOUT)

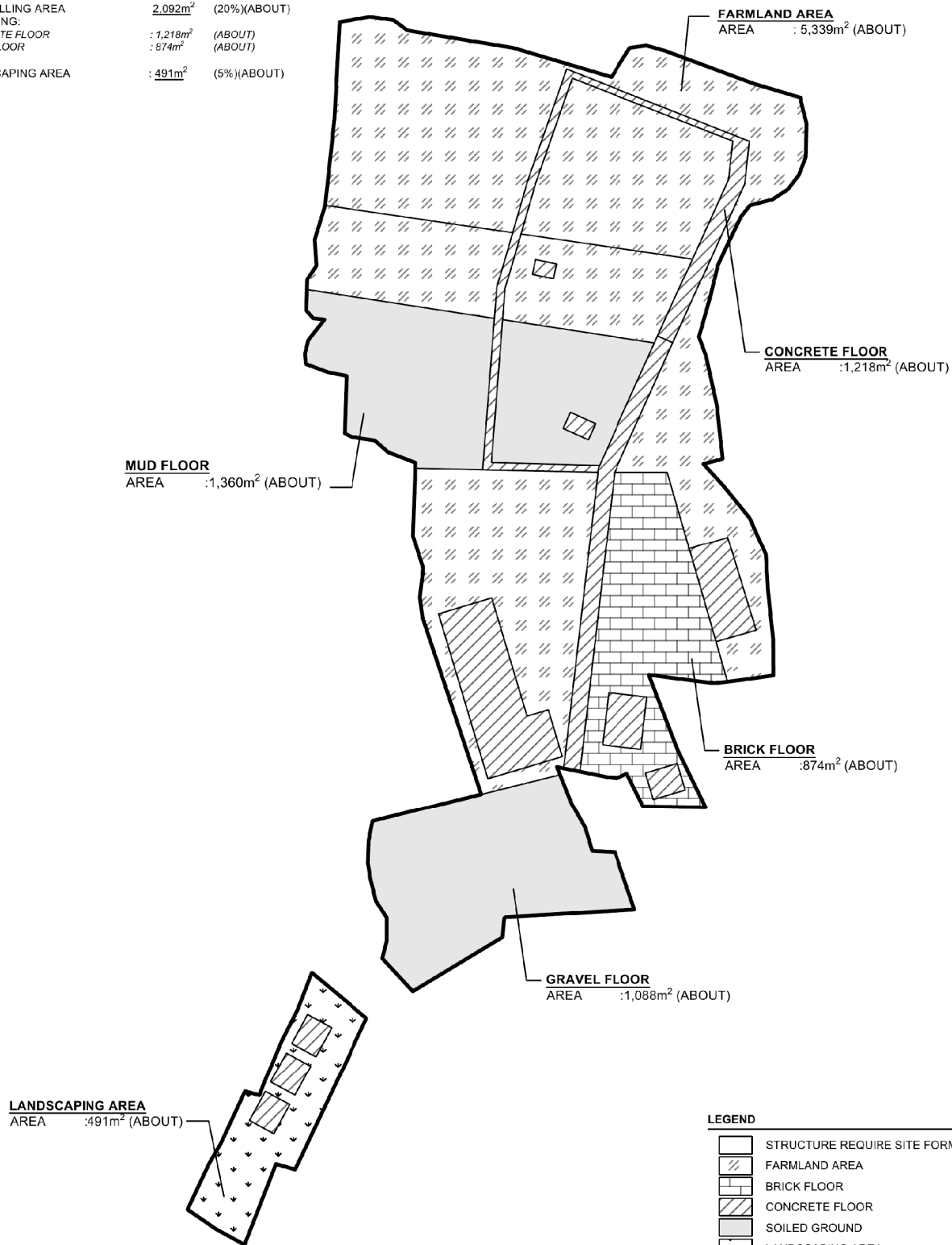

Drawing No.

PLAN 1

Ver.

03

Project

PROPOSED TEMPORARY PLACE OF RECREATION, SPORTS OR CULTURE (HOBBY FARM) FOR A PERIOD OF 3 YEARS AND LAND FILLING

LOT 1330 (PART) AND VARIOUS LOTS IN D.D. 117 AND ADJOINING GOVERNMENT LAND

Drawing Title

PAVED RATIO

Scale of A4

1:1000

Drawn

Date

2.7.2020

Revised

Date

21.5.2021

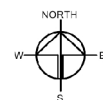

(摘錄自申請人於 21.5.2021 呈交的進一步資料)
(Extract from Applicant's Further
Information Submitted on 21.5.2021)

參考編號

REFERENCE No.
AYL-TT/505

繪圖 DRAWING
A-2

LANDSCAPE PROPOSAL

APPLICATION SITE AREA : 10,370m² (ABOUT)

NO. OF PROPOSED TREE : 89
 SPECIES OF TREE : *BAUHINIA BLAKEANA*
 SPACE OF TREE : 4m (ABOUT)
 HEIGHT OF TREE : 2.75m (ABOUT)
 DIMENSION OF TREE PIT : 1m (W) X 1m (L) X 1.2m (D)

ALL TREES ARE PLANTED AT LEAST 500MM AWAY FROM U-CHANNEL/FENCE/STRUCTURE/PAVING.

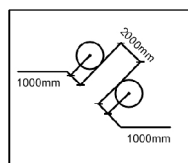
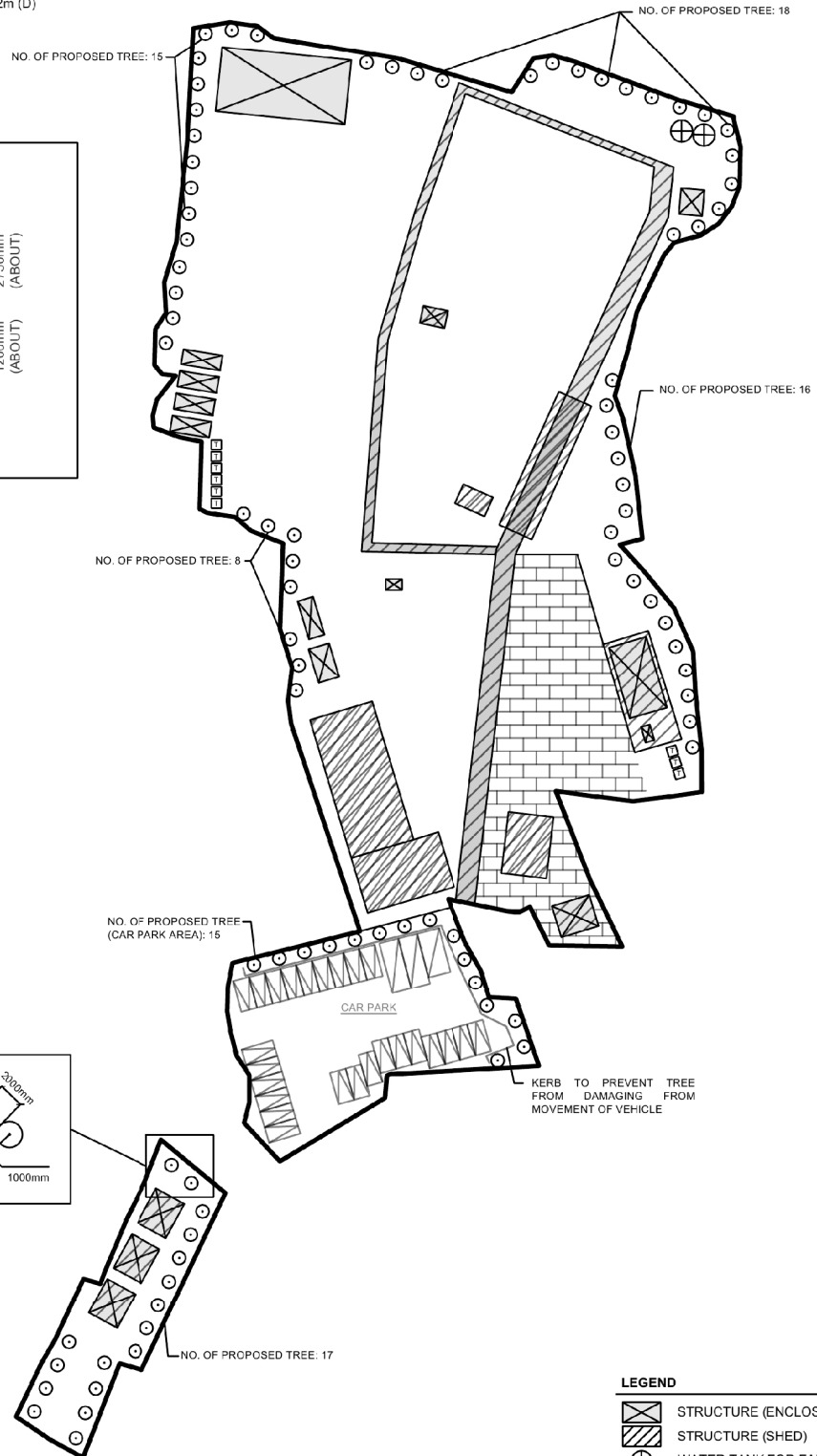
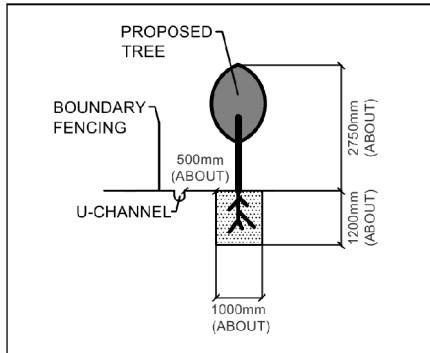

LEGEND

- STRUCTURE (ENCLOSED)
- STRUCTURE (SHED)
- WATER TANK FOR FARMING USE
- TOILET
- PROPOSED TREE

Drawing No.
APPENDIX I

Ver.
 04

Project
 PROPOSED TEMPORARY PLACE OF RECREATION, SPORTS OR CULTURE (HOBBY FARM) FOR A PERIOD OF 3 YEARS AND LAND FILLING

LOT 1330 (PART) AND VARIOUS LOTS IN D.D. 117 AND ADJOINING GOVERNMENT LAND

Drawing Title
LANDSCAPE PROPOSAL

Scale of A4

1:1000

Drawn Date
 21.5.2021

Revised Date
 29.6.2021

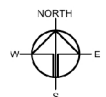

(摘錄自申請人於 29.6.2021 呈交的進一步資料)
 (Extract from Applicant's Further
 Information Submitted on 29.6.2021)

參考編號
 REFERENCE No.
A/YL-TT/505

繪圖 DRAWING
A-3

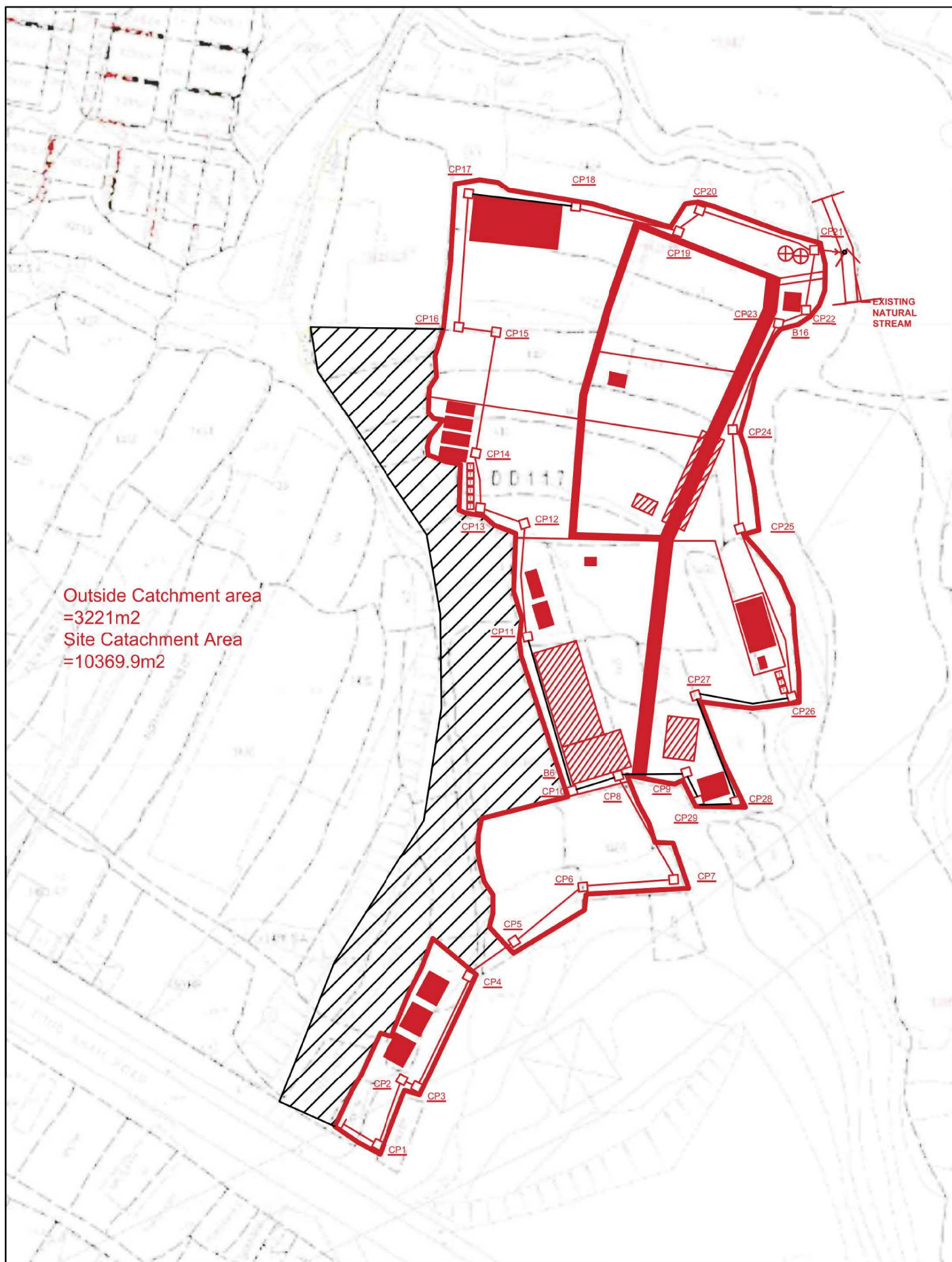

Drawing No. ANNEX	Ver. 02	Drawing Title Catchment Area	
Project PROPOSED TEMPORARY PLACE OF RECREATION, SPORTS OR CULTURE (HOBBY FARM) FOR A PERIOD OF 3 YEARS AND LAND FILLING		Scale of A4 1:1000	
LOT 1330 (PART) AND VARIOUS LOTS IN D.D. 117 AND ADJOINING GOVERNMENT LAND (Application No.: A/YL-TT/505)		Drawn Date 11.02.2021	
		Revised Date 11.02.2021	

(摘錄自申請人於 26.3.2021 呈交的進一步資料)
(Extract from Applicant's Further
Information Submitted on 26.3.2021)

參考編號
REFERENCE No.
A/YL-TT/505

繪圖 **DRAWING**
A-4

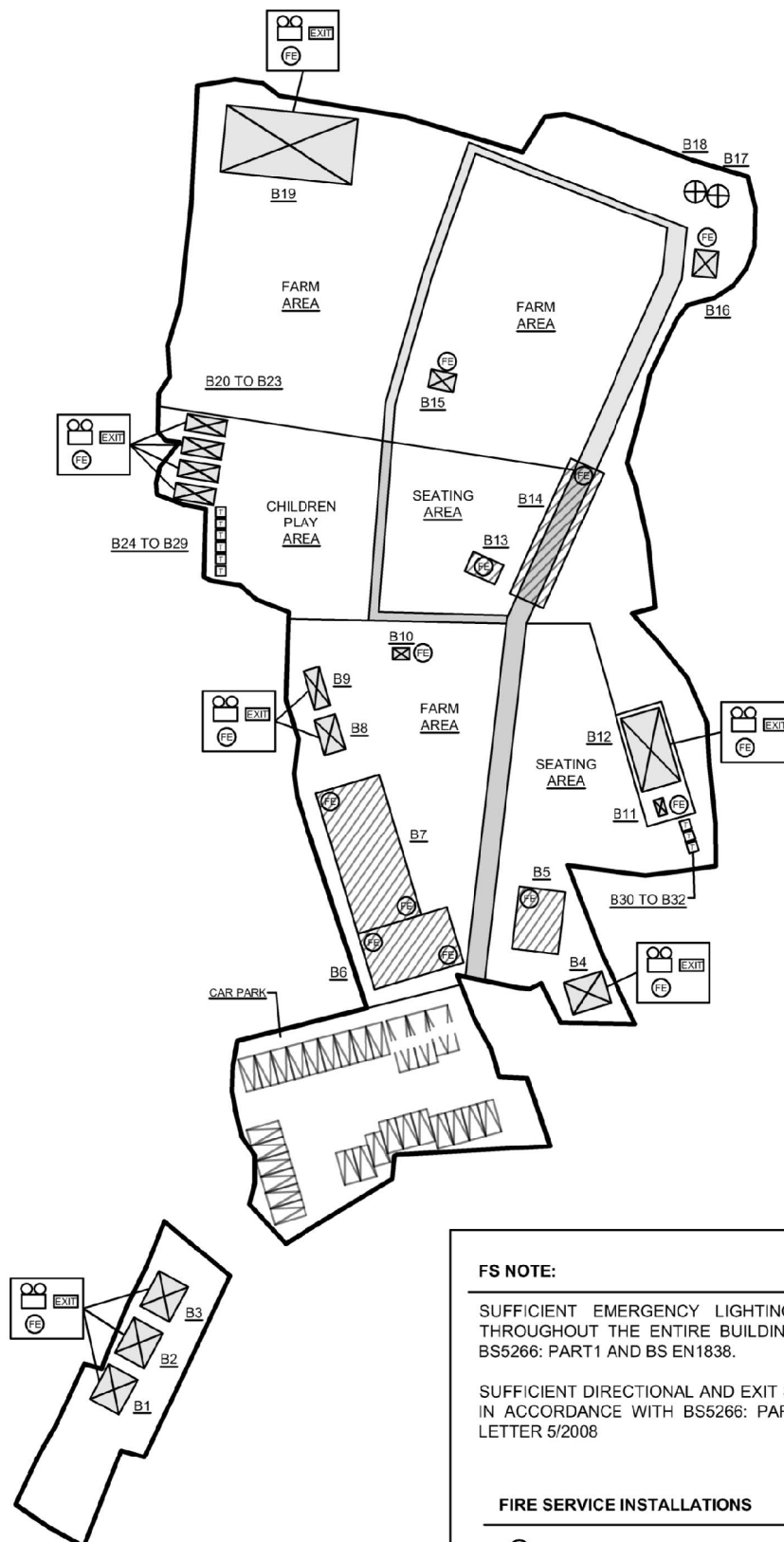
**FS NOTE:**

SUFFICIENT EMERGENCY LIGHTING SHALL BE PROVIDED THROUGHOUT THE ENTIRE BUILDING IN ACCORDANCE WITH BS5266: PART1 AND BS EN1838.

SUFFICIENT DIRECTIONAL AND EXIT SIGN SHALL BE PROVIDED IN ACCORDANCE WITH BS5266: PART 1 AND FSD CIRCULAR LETTER 5/2008

FIRE SERVICE INSTALLATIONS

- FE 4.5KG GAS TYPE FIRE EXTINGUISHER
- EL EMERGENCY LIGHTING
- EXIT EXIT SIGN

Drawing No. ANNEX	Ver. 01	Drawing Title FSIs PROPOSAL	
Project PROPOSED TEMPORARY PLACE OF RECREATION, SPORTS OR CULTURE (HOBBY FARM) FOR A PERIOD OF 3 YEARS AND LAND FILLING		Scale of A4 1:1000	
LOT 1330 (PART) AND VARIOUS LOTS IN D.D. 117 AND ADJOINING GOVERNMENT LAND		Drawn Date 8.12.2020	
		Revised Date	

(摘錄自申請人於 8.12.2020 呈交的進一步資料)
(Extract from Applicant's Further
Information Submitted on 8.12.2020)

參考編號
REFERENCE No.
AYL-TT/505

繪圖 DRAWING
A-5

RUN-IN/OUT PROPOSAL

THE DESIGN OF THE RUN-IN/OUT PROPOSAL WILL BE IN ACCORDANCE WITH THE LATEST VERSION OF HIGHWAY STANDARD DRAWING NO. 1113B AND 1114A.



LEGEND

- PARKING / LUL SPACE
- STRUCTURE

Drawing No.

Ver.
01

Project:

PROPOSED TEMPORARY PLACE OF RECREATION, SPORTS OR CULTURE (HOBBY FARM) FOR A PERIOD OF 3 YEARS AND LAND FILLING

LOT 1330 (PART) AND VARIOUS LOTS IN D.D. 117 AND ADJOINING GOVERNMENT LAND

Drawing Title

RUN-IN/OUT PROPOSAL

Scale of A4

1:500

Drawn

Date

29.12.2020

Revised

Date



(摘錄自申請人於 29. 12. 2020 呈交的進一步資料)
(Extract from Applicant's Further
Information Submitted on 29.12.2020)

參考編號

REFERENCE No.
AYL-TT/505

繪圖 DRAWING
A-6

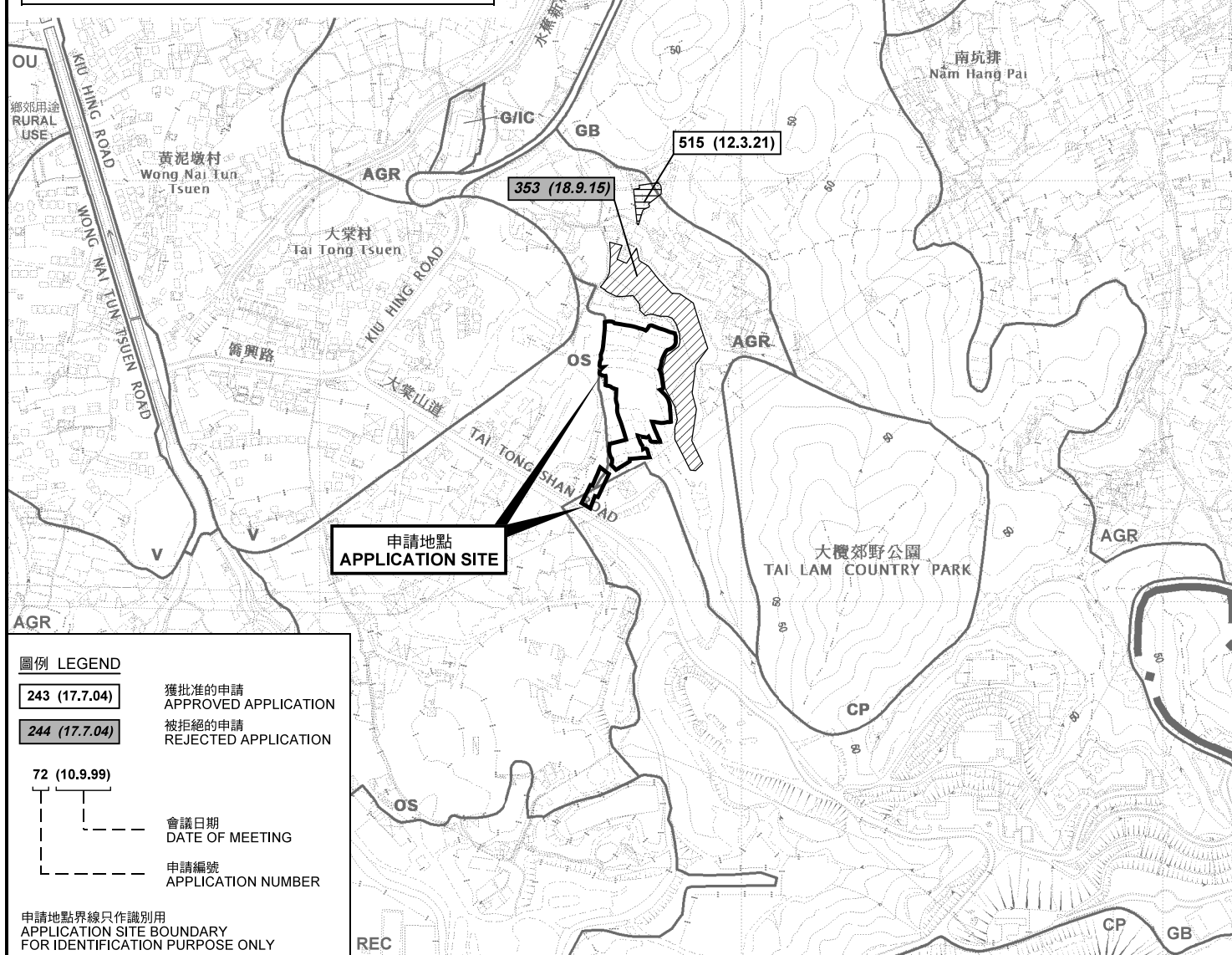
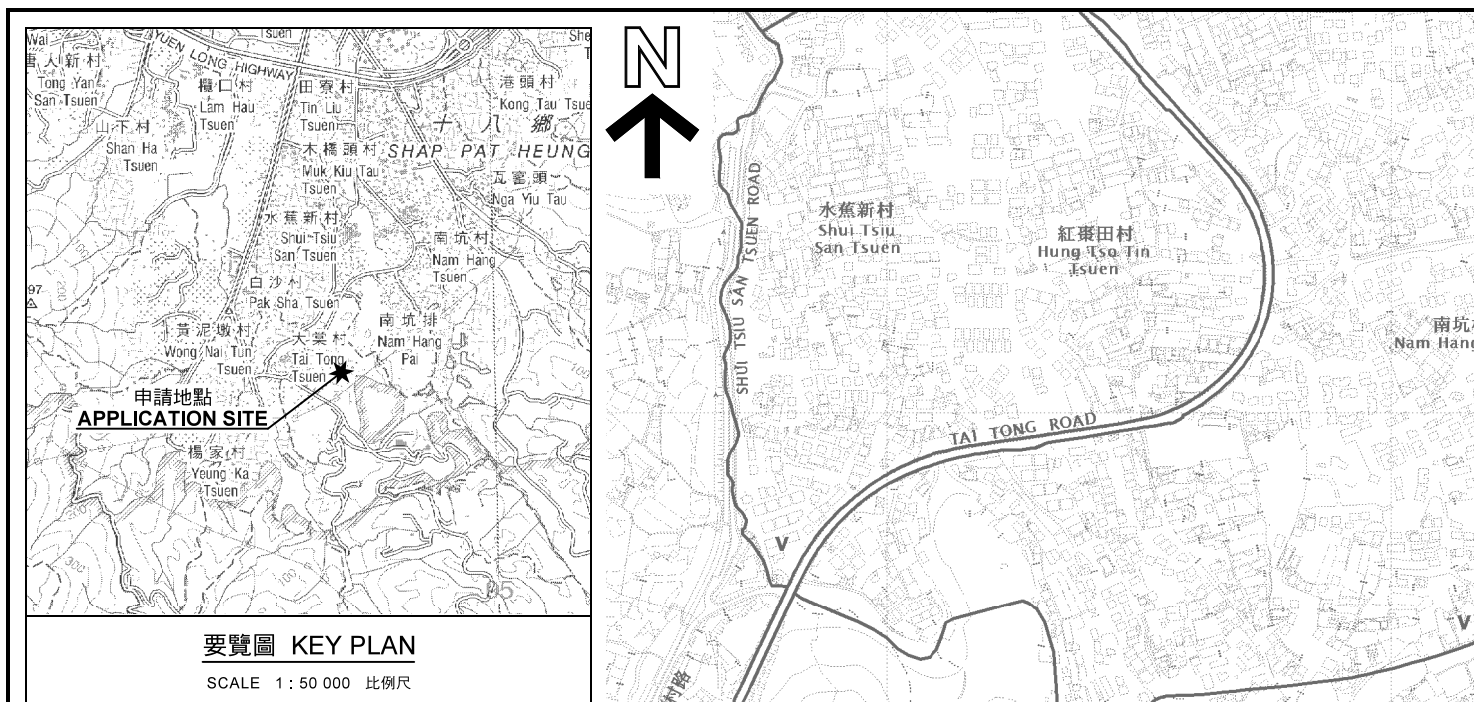

位置圖及同類申請 LOCATION PLAN WITH SIMILAR APPLICATIONS

臨時康體文娛場所（休閒農莊）（為期3年）及填土工程
元朗大棠丈量約份第117約多個地段和毗連政府土地
TEMPORARY PLACE OF RECREATION, SPORTS OR CULTURE (HOBBY FARM)
FOR A PERIOD OF 3 YEARS AND FILLING OF LAND
VARIOUS LOTS IN D.D.117 AND ADJOINING GOVERNMENT LAND,
TAI TONG, YUEN LONG

SCALE 1 : 7 500 比例尺

米 100 0 100 200 300 米
METRES

規劃署
PLANNING
DEPARTMENT



參考編號
REFERENCE No.
A/YL-TT/505

圖 PLAN
A-1a

本摘要圖於2021年6月23日擬備，
所根據的資料為於2020年7月10日
展示的分區計劃大綱圖編號 S/YL-TT/17
EXTRACT PLAN PREPARED ON 23.6.2021
BASED ON OUTLINE ZONING PLAN No.
S/YL-TT/17 EXHIBITED ON 10.7.2020

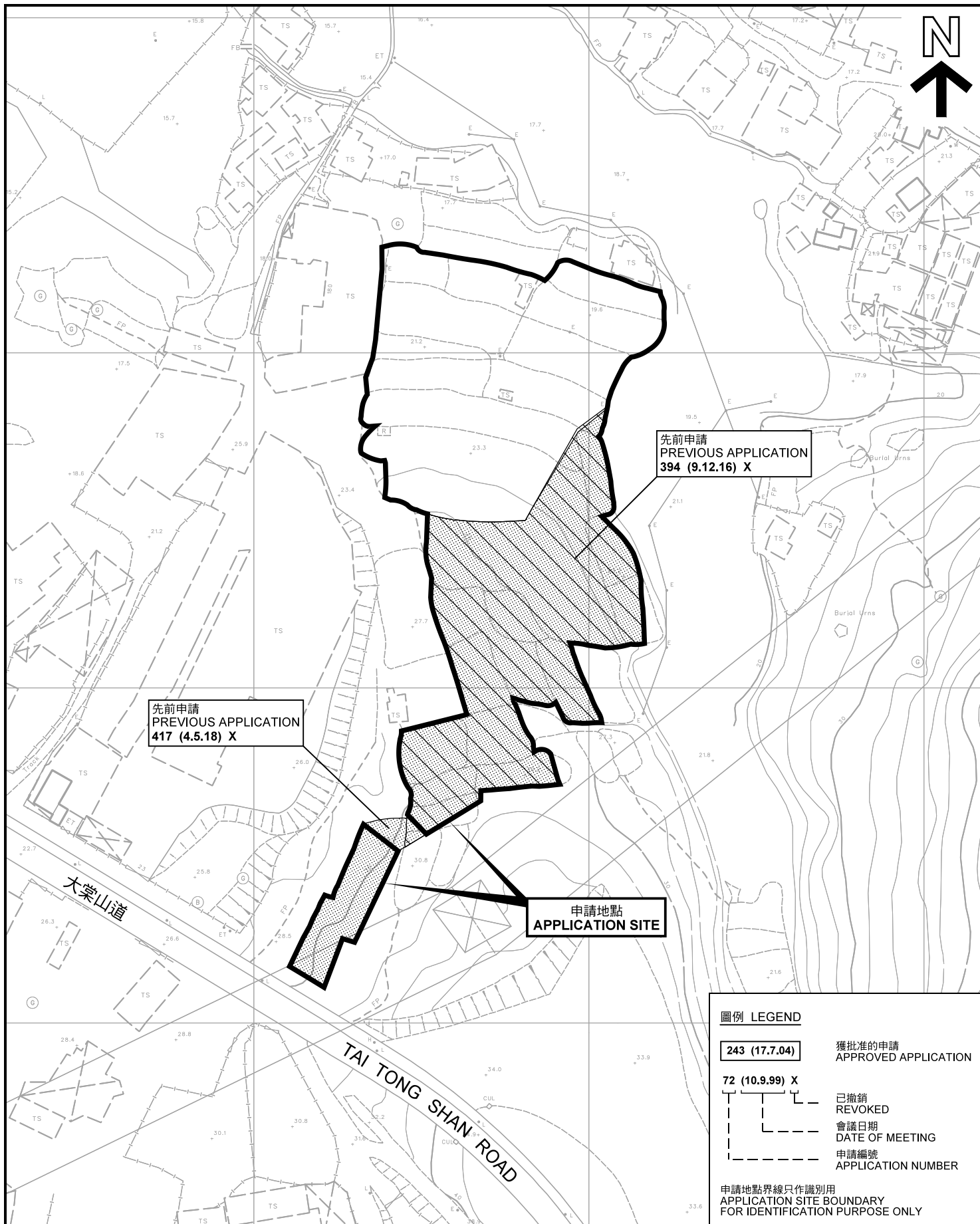

圖例 LEGEND

- | | |
|-----------------------|--------------------------------|
| 243 (17.7.04) | 獲批准的申請
APPROVED APPLICATION |
| 72 (10.9.99) X | 已撤銷
REVOKED |
| --- | 會議日期
DATE OF MEETING |
| --- | 申請編號
APPLICATION NUMBER |

申請地點界線只作識別用
APPLICATION SITE BOUNDARY
FOR IDENTIFICATION PURPOSE ONLY

先前申請圖 PREVIOUS APPLICATIONS PLAN

臨時康體文娛場所（休閒農莊）（為期3年）及填土工程
元朗大棠丈量約份第117約多個地段和毗連政府土地
TEMPORARY PLACE OF RECREATION, SPORTS OR CULTURE (HOBBY FARM)
FOR A PERIOD OF 3 YEARS AND FILLING OF LAND
VARIOUS LOTS IN D.D.117 AND ADJOINING GOVERNMENT LAND,
TAI TONG, YUEN LONG

SCALE 1 : 1 500 比例尺
米 20 0 20 40 60 米
METRES

本摘要圖於2021年6月23日擬備，所根據的資料為測量圖編號 6-NW-24B、24D、25A 及 25C
EXTRACT PLAN PREPARED ON 23.6.2021
BASED ON SURVEY SHEETS No.
6-NW-24B, 24D, 25A & 25C

規劃署
PLANNING
DEPARTMENT



參考編號
REFERENCE No.
A/YL-TT/505

圖 PLAN
A-1b

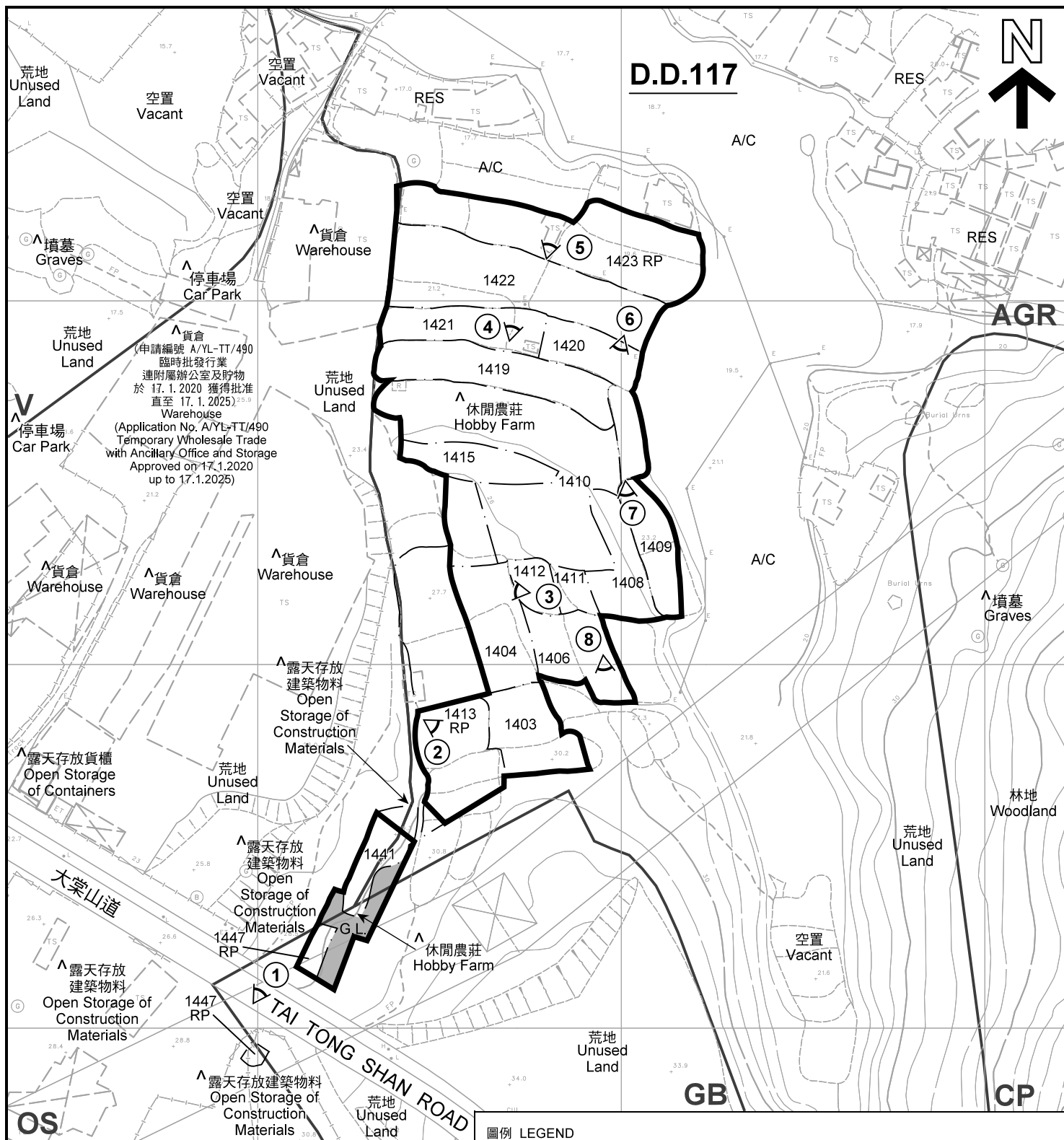

- 註釋 Notes :
- (1) 2021年6月1日勘測的土地用途
Land uses shown on this plan are in accordance with the land use survey conducted by the Planning Department on 1.6.2021
- (2) * 土地用途跟1991年11月勘測的土地用途一致
Indicates that the use is the same as that revealed by the land use survey conducted by the Planning Department in 11.1991
- (3) ^ 土地用途跟1991年11月勘測的土地用途有別
Indicates that the use is different from that revealed by the land use survey conducted by the Planning Department in 11.1991

圖例 LEGEND

- | | | | |
|------------|------------------------------------------------------------------------------------|-------------|-----------------------------------------|
| | 申請地點(界線只作識別用)
APPLICATION SITE
(BOUNDARY FOR IDENTIFICATION
PURPOSE ONLY) | CP | 郊野公園
COUNTRY PARK |
| V | 鄉村式發展
VILLAGE TYPE DEVELOPMENT | G.L. | 政府土地
GOVERNMENT LAND |
| OS | 露天貯物
OPEN STORAGE | RES | 住用構築物
RESIDENTIAL STRUCTURES |
| AGR | 農業
AGRICULTURE | A/C | 常耕農地
CULTIVATED AGRICULTURAL LAND |
| GB | 綠化地帶
GREEN BELT | ① | 實地照片的觀景點
VIEWING POINT OF SITE PHOTO |

平面圖 SITE PLAN

本摘要圖於2021年6月30日擬備，所根據的資料為測量圖編號 6-NW-24B 及 6-NW-24D
EXTRACT PLAN PREPARED ON 30.6.2021
BASED ON SURVEY SHEETS No. 6-NW-24B & 6-NW-24D

臨時康體文娛場所(休閒農莊)(為期3年)及填土工程
元朗大棠丈量約份第117約多個地段和毗連政府土地
TEMPORARY PLACE OF RECREATION, SPORTS OR CULTURE (HOBBY FARM)
FOR A PERIOD OF 3 YEARS AND FILLING OF LAND
VARIOUS LOTS IN D.D.117 AND ADJOINING GOVERNMENT LAND,
TAI TONG, YUEN LONG

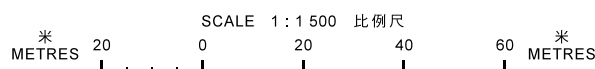

規劃署
PLANNING
DEPARTMENT



參考編號
REFERENCE No.
A/YL-TT/505

圖 PLAN
A-2



圖例 LEGEND



申請地點(界線只作識別用)
APPLICATION SITE
(BOUNDARY FOR IDENTIFICATION
PURPOSE ONLY)

本摘要圖於2021年6月23日擬備，所根據的資料為地政總署於2020年2月18日拍得的航攝照片編號 E088306C
EXTRACT PLAN PREPARED ON 23.6.2021
BASED ON AERIAL PHOTO No.
E088306C TAKEN ON 18.2.2020
BY LANDS DEPARTMENT

航攝照片 AERIAL PHOTO

臨時康體文娛場所(休閒農莊)(為期3年)及填土工程
元朗大棠丈量約份第117約多個地段和毗連政府土地
TEMPORARY PLACE OF RECREATION, SPORTS OR CULTURE (HOBBY FARM)
FOR A PERIOD OF 3 YEARS AND FILLING OF LAND
VARIOUS LOTS IN D.D.117 AND ADJOINING GOVERNMENT LAND,
TAI TONG, YUEN LONG

規劃署
PLANNING
DEPARTMENT



參考編號
REFERENCE No.
A/YL-TT/505

圖 PLAN
A-3



申請地點界線只作識別用 APPLICATION SITE BOUNDARY FOR IDENTIFICATION PURPOSE ONLY

實地照片 SITE PHOTOS

臨時康體文娛場所（休閒農莊）（為期3年）及填土工程
元朗大棠丈量約份第117約多個地段和毗連政府土地
TEMPORARY PLACE OF RECREATION, SPORTS OR CULTURE (HOBBY FARM)
FOR A PERIOD OF 3 YEARS AND FILLING OF LAND
VARIOUS LOTS IN D.D.117 AND ADJOINING GOVERNMENT LAND,
TAI TONG, YUEN LONG

規劃署
PLANNING
DEPARTMENT



參考編號
REFERENCE No.
A/YL-TT/505

圖 PLAN
A-4a

本圖於2021年6月23日擬備，所根據的
資料為攝於2021年6月1日的實地照片
PLAN PREPARED ON 23.6.2021
BASED ON SITE PHOTOS
TAKEN ON 1.6.2021



實地照片 SITE PHOTOS

臨時康體文娛場所（休閒農莊）（為期3年）及填土工程
元朗大棠丈量約份第117約多個地段和毗連政府土地
TEMPORARY PLACE OF RECREATION, SPORTS OR CULTURE (HOBBY FARM)
FOR A PERIOD OF 3 YEARS AND FILLING OF LAND
VARIOUS LOTS IN D.D.117 AND ADJOINING GOVERNMENT LAND,
TAI TONG, YUEN LONG

規劃署
PLANNING
DEPARTMENT



參考編號
REFERENCE No.
A/YL-TT/505

圖 PLAN
A-4b

本圖於2021年6月23日擬備，所根據的資料為攝於2021年6月1日的實地照片
PLAN PREPARED ON 23.6.2021
BASED ON SITE PHOTOS
TAKEN ON 1.6.2021