

地政總署測繪處 Survey and Mapping Office, Lands Department

比例尺 SCALE 1:1000
metres 10 0 10 20 30 40 50 metres

For Identification Purposes Only

Layout Plan

v.3

No.	Covered Area (sq. m)	Height (m)	Use	Storeys(s)	No.	Covered Area (sq. m)	Height (m)	Use	Storeys(s)
1	14.88 sq. m [6.1m x 2.44m]	3m	Security Room	1	4	61 sq. m [12.5m x 4.88m]	3m	Training Centre & Office	1
2	61 sq. m [12.5m x 4.88m]	3m	Training Centre	1	5	145 sq. m 29m x 5m (Metal Canopy)	8m	Storage Area	1
3	14.88 sq. m [6.1m x 2.44m]	3m	Toilet	1					
Grand Total		296.76 sq. m							
No.	Open Area (sq. m)	Qty	Use	No.	Open Area (sq. m)	Qty	Use		
A	12.5 sq. m [5m x 2.5m]	6	Parking (Private Car)	B	38.5 sq. m [11m x 3.5m]	1	Loading/Unloading (Medium/Heavy goods Vehicle)		

(摘錄自申請人於 22.3.2021 呈交的補充資料)
(Extract from Applicant's Supplementary
Information Submitted on 22.3.2021)

參考編號
REFERENCE No.
AYL-TT/520

繪圖 DRAWING
A-1

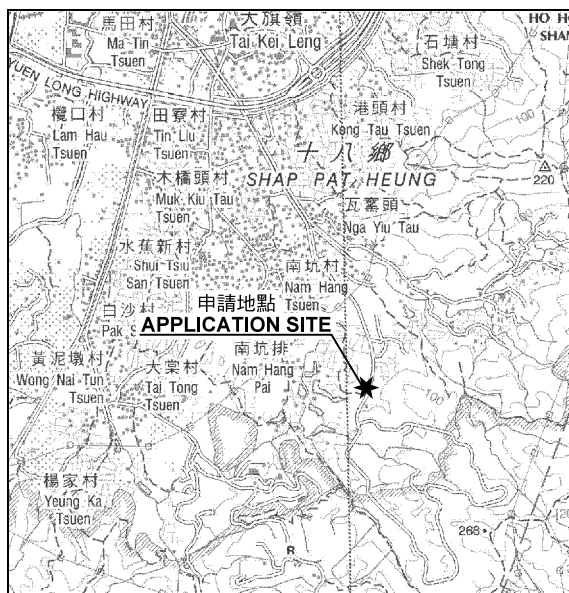

要覽圖 KEY PLAN

SCALE 1 : 50 000 比例尺

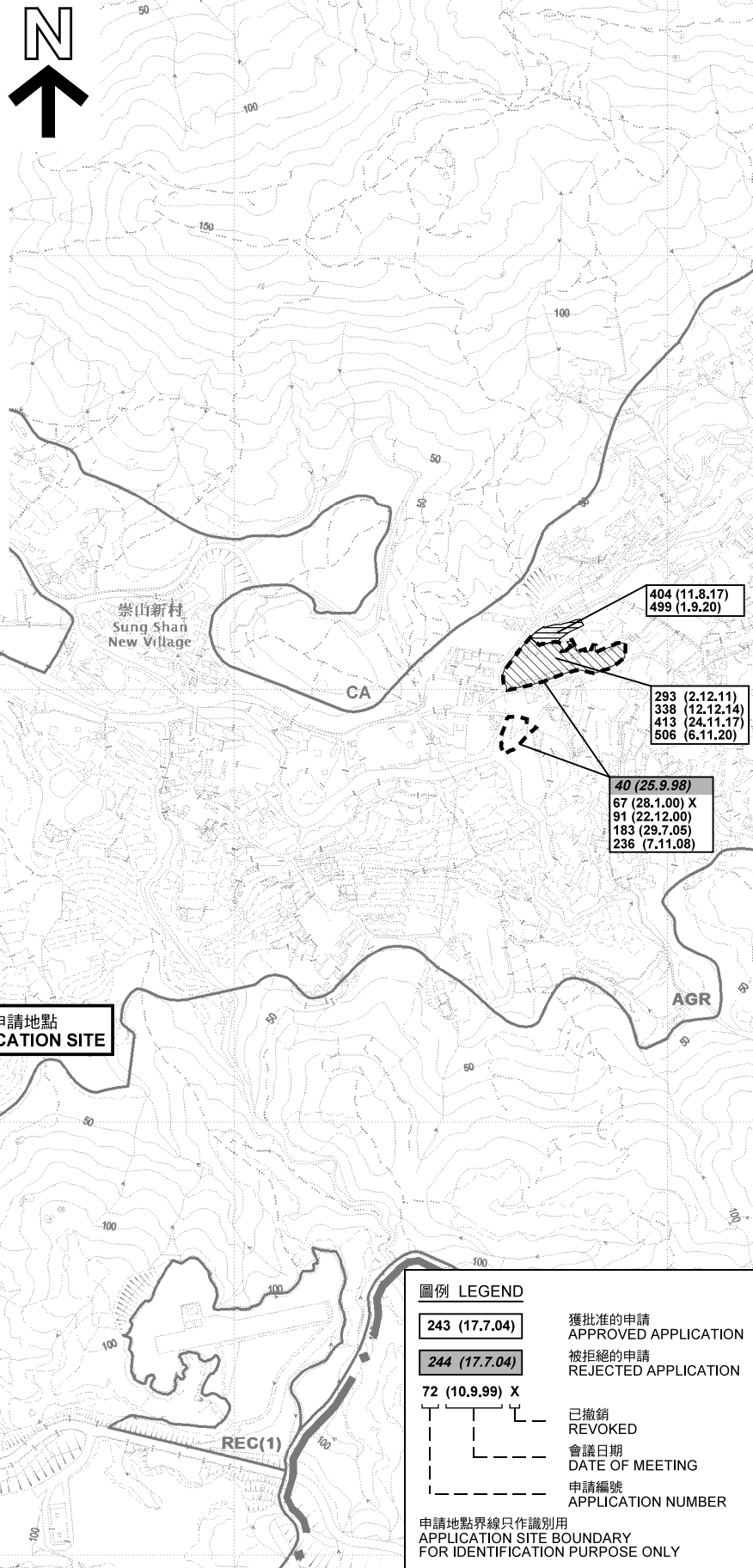

圖例 LEGEND

243 (17.7.04)

獲批准的申請
APPROVED APPLICATION

244 (17.7.04)

被拒絕的申請
REJECTED APPLICATION

72 (10.9.99) X

已撤銷
REVOKED

會議日期
DATE OF MEETING

申請編號
APPLICATION NUMBER

申請地點界線只作識別用
APPLICATION SITE BOUNDARY
FOR IDENTIFICATION PURPOSE ONLY

本摘要圖於2021年4月28日擬備，
所根據的資料為於2020年7月10日
展示的分區計劃大綱圖編號 S/YL-TT/17
EXTRACT PLAN PREPARED ON 28.4.2021
BASED ON OUTLINE ZONING PLAN No.
S/YL-TT/17 EXHIBITED ON 10.7.2020

位置圖及同類申請 LOCATION PLAN WITH SIMILAR APPLICATION

擬議臨時起重機訓練中心連附屬設施（為期3年）
元朗大棠丈量約份第118約地段第1463號餘段
及第1464號和毗連政府土地
PROPOSED TEMPORARY CRANE TRAINING CENTRE WITH
ANCILLARY FACILITIES FOR A PERIOD OF 3 YEARS
LOTS 1463 RP AND 1464 IN D.D.118 AND
ADJOINING GOVERNMENT LAND, TAI TONG, YUEN LONG

SCALE 1 : 7 500 比例尺
米 100 0 100 200 300 米
METRES

規劃署
PLANNING
DEPARTMENT



參考編號
REFERENCE No.
A/YL-TT/520

圖 PLAN
A-1

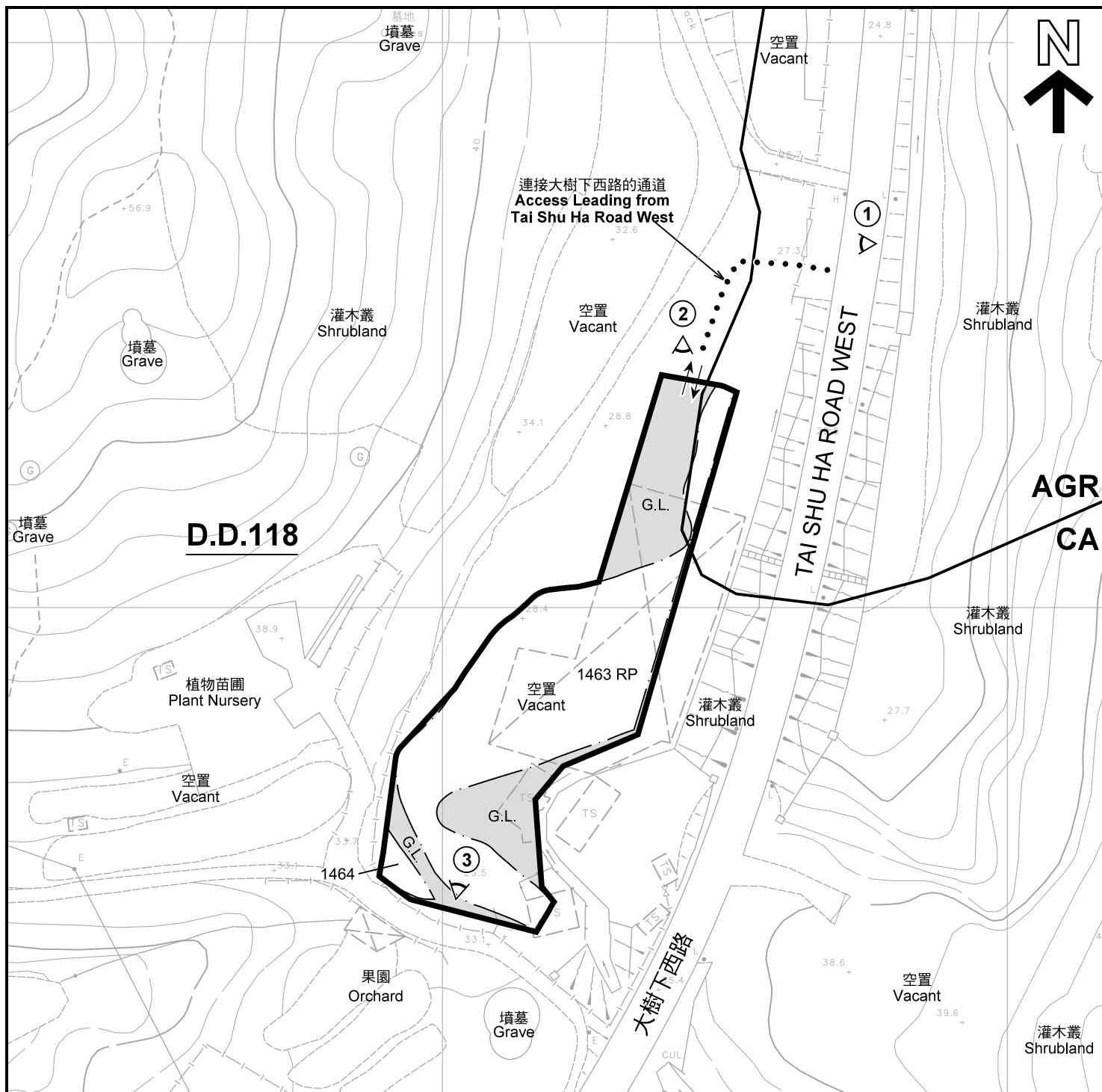

註釋 Notes:

- (1) 2021年3月26日勘測的土地用途
Land uses shown on this plan are in accordance with the land use survey conducted by the Planning Department on 26.3.2021
- (2) ★ 土地用途跟1991年11月勘測的土地用途一致
Indicates that the use is the same as that revealed by the land use survey conducted by the Planning Department on 11.1991
- (3) ▲ 土地用途跟1991年11月勘測的土地用途有別
Indicates that the use is different from that revealed by the land use survey conducted by the Planning Department on 11.1991

圖例 LEGEND

- 申請地點(界線只作識別用)
APPLICATION SITE
(BOUNDARY FOR IDENTIFICATION
PURPOSE ONLY)
- AGR** 農業
AGRICULTURE
- CA** 自然保育區
CONSERVATION AREA
- G.L.** 政府土地
GOVERNMENT LAND
- RES** 住用構築物
RESIDENTIAL STRUCTURES
- ① ▲ 實地照片的觀景點
VIEWING POINT OF SITE PHOTO
- ↔ 入口/出口
INGRESS / EGRESS

平面圖 SITE PLAN

擬議臨時起重機訓練中心連附屬設施(為期3年)
元朗大棠丈量約份第118約地段第1463號餘段
及第1464號和毗連政府土地

PROPOSED TEMPORARY CRANE TRAINING CENTRE WITH
ANCILLARY FACILITIES FOR A PERIOD OF 3 YEARS
LOTS 1463 RP AND 1464 IN D.D.118 AND
ADJOINING GOVERNMENT LAND, TAI TONG, YUEN LONG

SCALE 1 : 1 000 比例尺

米 20 0 20 40 米
METRES

本摘要圖於2021年4月28日擬備, 所根據的
資料為測量圖編號 6-NW-25B
EXTRACT PLAN PREPARED ON 28.4.2021
BASED ON SURVEY SHEET No.
6-NW-25B

規劃署
PLANNING
DEPARTMENT



參考編號
REFERENCE No.
A/YL-TT/520

圖 PLAN
A-2



連接大樹下西路的通道
Access Leading from
Tai Shu Ha Road West

TAI SHU HA ROAD WEST

大樹下西路

圖例 LEGEND



申請地點(界線只作識別用)
APPLICATION SITE
(BOUNDARY FOR IDENTIFICATION
PURPOSE ONLY)

本摘要圖於2021年4月28日擬備，所根據的資料為地政總署於2020年7月26日拍得的航攝照片編號 E102400C
EXTRACT PLAN PREPARED ON 28.4.2021
BASED ON AERIAL PHOTO No.
E102400C TAKEN ON 26.7.2020
BY LANDS DEPARTMENT

航攝照片 AERIAL PHOTO

擬議臨時起重機訓練中心連附屬設施（為期3年）
元朗大棠丈量約份第118約地段第1463號餘段
及第1464號和毗連政府土地
PROPOSED TEMPORARY CRANE TRAINING CENTRE WITH
ANCILLARY FACILITIES FOR A PERIOD OF 3 YEARS
LOTS 1463 RP AND 1464 IN D.D.118 AND
ADJOINING GOVERNMENT LAND, TAI TONG, YUEN LONG

規劃署
PLANNING
DEPARTMENT



參考編號
REFERENCE No.
A/YL-TT/520

圖 PLAN
A-3



申請地點界線只作識別用 APPLICATION SITE BOUNDARY FOR IDENTIFICATION PURPOSE ONLY

實地照片 SITE PHOTOS

擬議臨時起重機訓練中心連附屬設施（為期3年）
元朗大棠丈量約份第118約地段第1463號餘段
及第1464號和毗連政府土地

PROPOSED TEMPORARY CRANE TRAINING CENTRE WITH
ANCILLARY FACILITIES FOR A PERIOD OF 3 YEARS
LOTS 1463 RP AND 1464 IN D.D.118 AND
ADJOINING GOVERNMENT LAND, TAI TONG, YUEN LONG

規劃署
PLANNING
DEPARTMENT



參考編號
REFERENCE No.
A/YL-TT/520

圖 PLAN
A-4

本圖於2021年4月29日擬備，所根據的資料為攝於2021年3月26日的實地照片
PLAN PREPARED ON 29.4.2021
BASED ON SITE PHOTOS
TAKEN ON 26.3.2021