

(摘錄自申請人於 18.11.2022 呈交的申請書)
(Extract from Applicant's
Submission of 18.11.2022)

參考編號
REFERENCE No.
A/YL-TT/580

繪圖 DRAWING
A-1

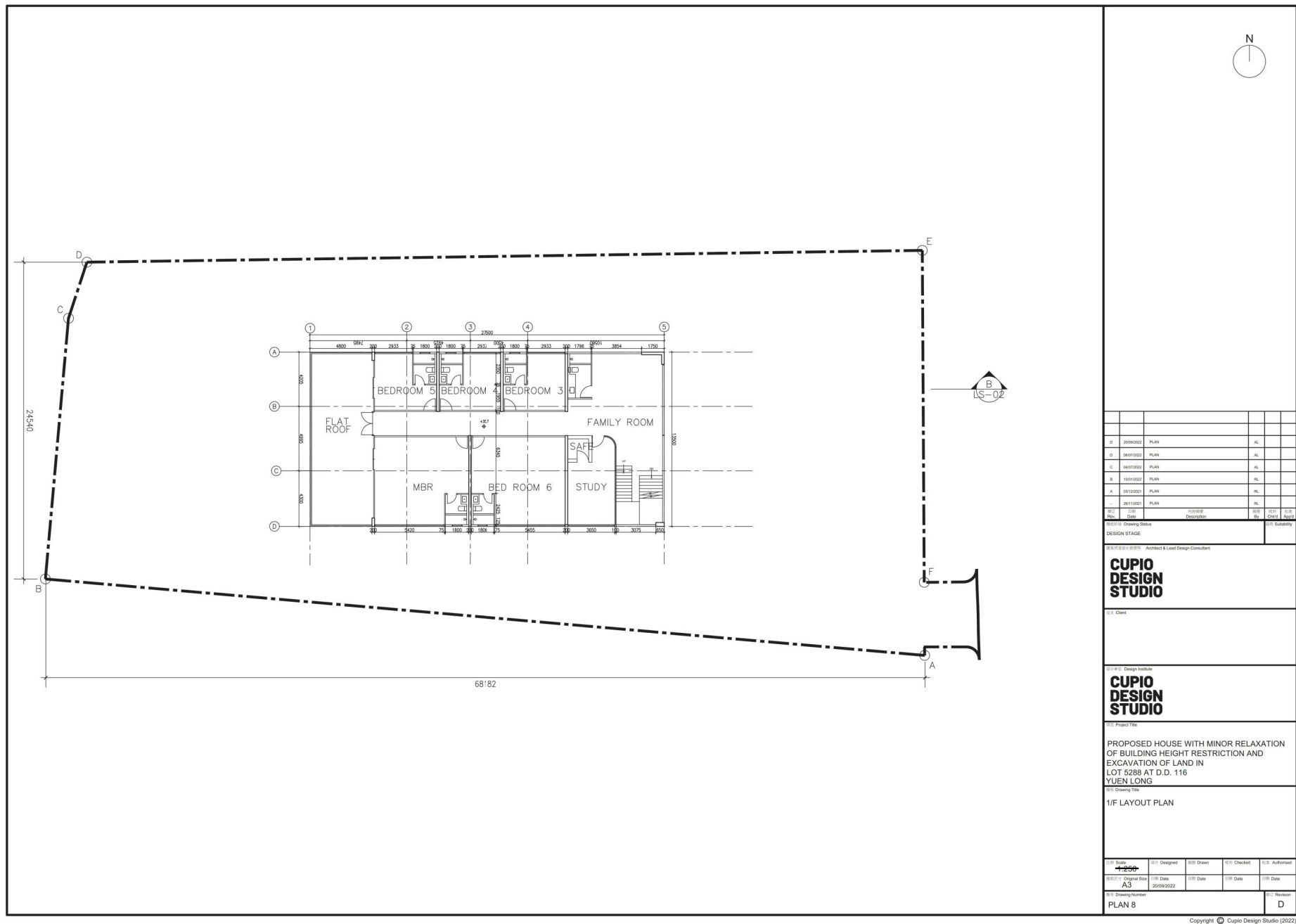

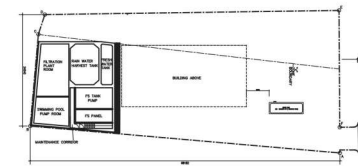

SECTION BB'

繪圖 DRAWING
A-5

LEGEND:

- SITE BOUNDARY
- T05 FINAL LOCATION OF THE TRANSPLANTED TREE
- PROPOSED HEAVY STANDARD TREE
- PROPOSED SHRUBS/GROUND COVER
- PROPOSED LAWN
- WATER AREA
- +0.00 PROPOSED LEVEL
- PROPOSED PAVING

- ## LEGEND:
- ① VEHICULAR ENTRANCE
 - ② PEDESTRIAN ENTRANCE
 - ③ CARETAKER OFFICE
 - ④ CAR PARKING
 - ⑤ SWIMMING POOL
 - ⑥ SWIMMING POOL DECK
 - ⑦ STEPPING STONE
 - ⑧ MULTI-FUNCTIONAL LAWN

Provision of Edge Planter and Ornamental Plants along the Building to soften the hard lines of the Building and to provide Visual Amenity to the Users and Visitors



Provision of Swimming Pool, Jacuzzi and Multi-functional Lawn to cater for the Active Recreational Need of the Users and Visitors

Provision of Transplanted Trees to retain the Important Landscape Resources on Site

REVISION 校訂	DESCRIPTION 內容摘要	DRAWN 繪圖	DATE 日期	CHECKED 審核	APPROVED 審批	DO NOT SCALE FROM THIS DRAWING 勿按圖量比例	DESIGNED 設計	COPYRIGHT RESERVED 保留版權
						PROJECT 工程項目 PROPOSED HOUSE, MINOR RELAXATION OF BUILDING HEIGHT RESTRICTION AND EXCAVATION OF LAND AT LOT 5288 IN D.D.116 AND ADJOINING GOVERNMENT LAND, TAI TONG ROAD, TAI TONG, YUEN LONG, NEW TERRITORIES DRAWING TITLE 圖紙名稱 LANDSCAPE MASTER PLAN DRAWING NUMBER 圖號 LMP01	SCALE 比例 1:200 DATE 日期 DEC. 2021 REVISION 校訂 — DRAWING NUMBER 圖號 LMP01	TEL TEL CAD TEL TEL TEL
LANDSCAPE LIMITED 景觀設計有限公司 LANDSCAPE PLANNING, DESIGN AND CONSTRUCTION 景觀規劃、設計及建造 FLAT A, 17/F, SHAN POI COMMERCIAL BUILDING, 5-11 THICKSON ROAD, WAI CHAI HONG KONG 香港灣仔區道5-11號山詩商業大廈17樓A座 TELEPHONE 2868 0860 FACSIMILE 2868 2203 傳真(4382) 2868 2203 傳真(4382) 2868 2203							LANDDes	CAD FILE NAME : C2137-LMP01

(摘錄自申請人於 18.11.2022 呈交的申請書)
(Extract from Applicant's
Submission of 18.11.2022)

參考編號
REFERENCE No.
A/YL-TT/580

繪圖 DRAWING
A-6

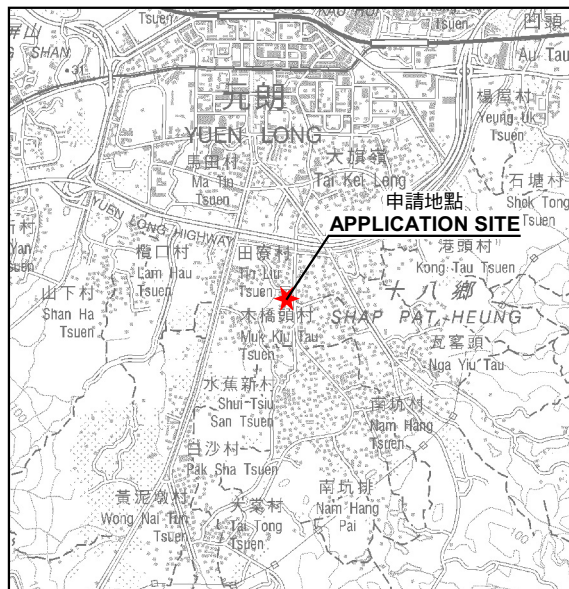
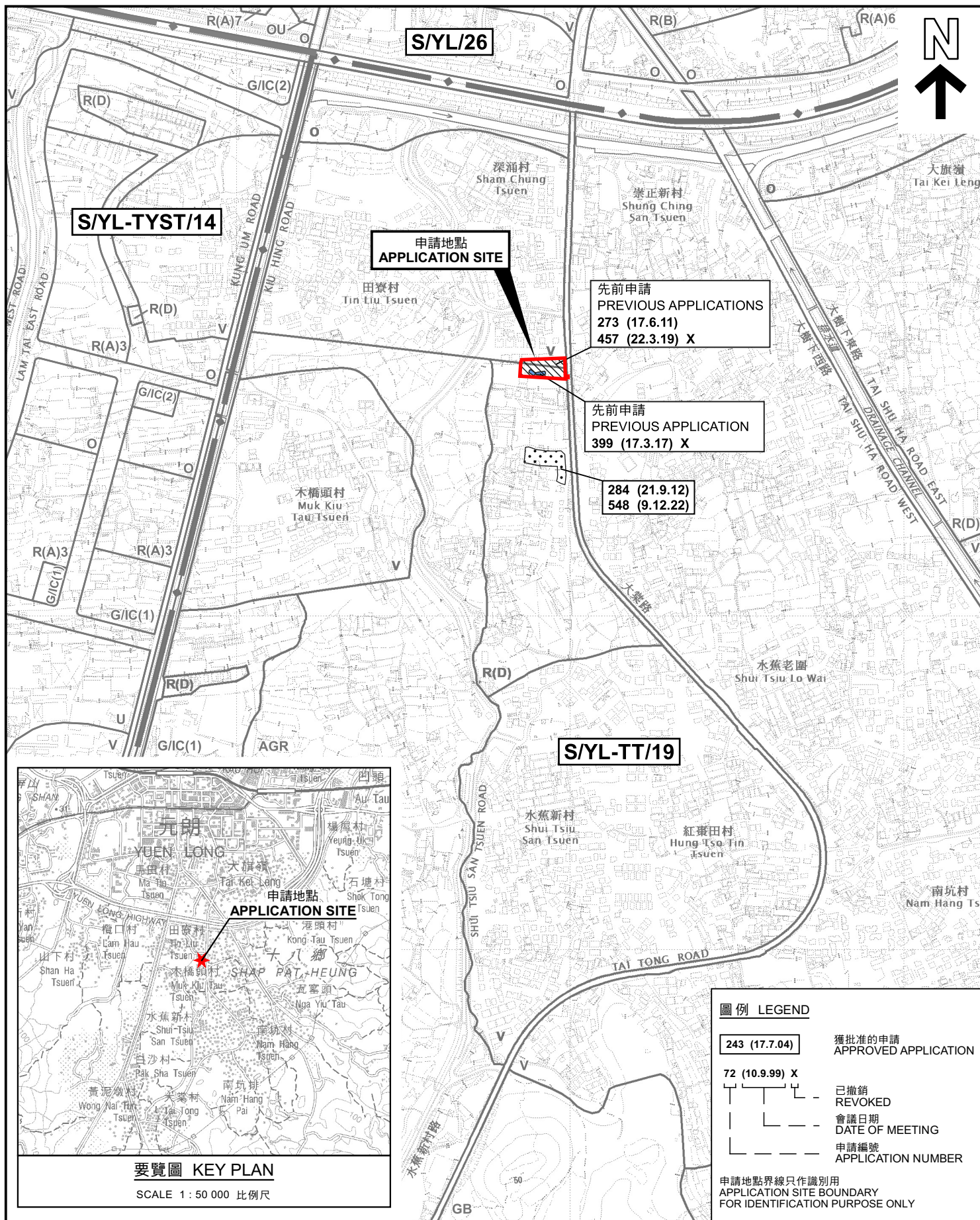

位置圖 LOCATION PLAN

擬議屋宇及略為放寬建築物高度限制
YUEN LONG PROPOSED HOUSE WITH MINOR RELAXATION OF
BUILDING HEIGHT RESTRICTION
LOT 5288 IN D.D.116 AND ADJOINING GOVERNMENT LAND,
TAI TONG ROAD, TAI TONG, YUEN LONG

SCALE 1 : 7 500 比例尺

米 100 0 100 200 300 米
METRES

規劃署
PLANNING
DEPARTMENT



參考編號
REFERENCE No.
A/YL-TT/580

圖 PLAN
A-1

本摘要圖於2023年1月6日擬備，
所根據的資料為於2023年1月6日
展示的分區計劃大綱圖編號 S/YL-TT/19
EXTRACT PLAN PREPARED ON 6.1.2023
BASED ON OUTLINE ZONING PLAN No.
S/YL-TT/19 EXHIBITED ON 6.1.2023

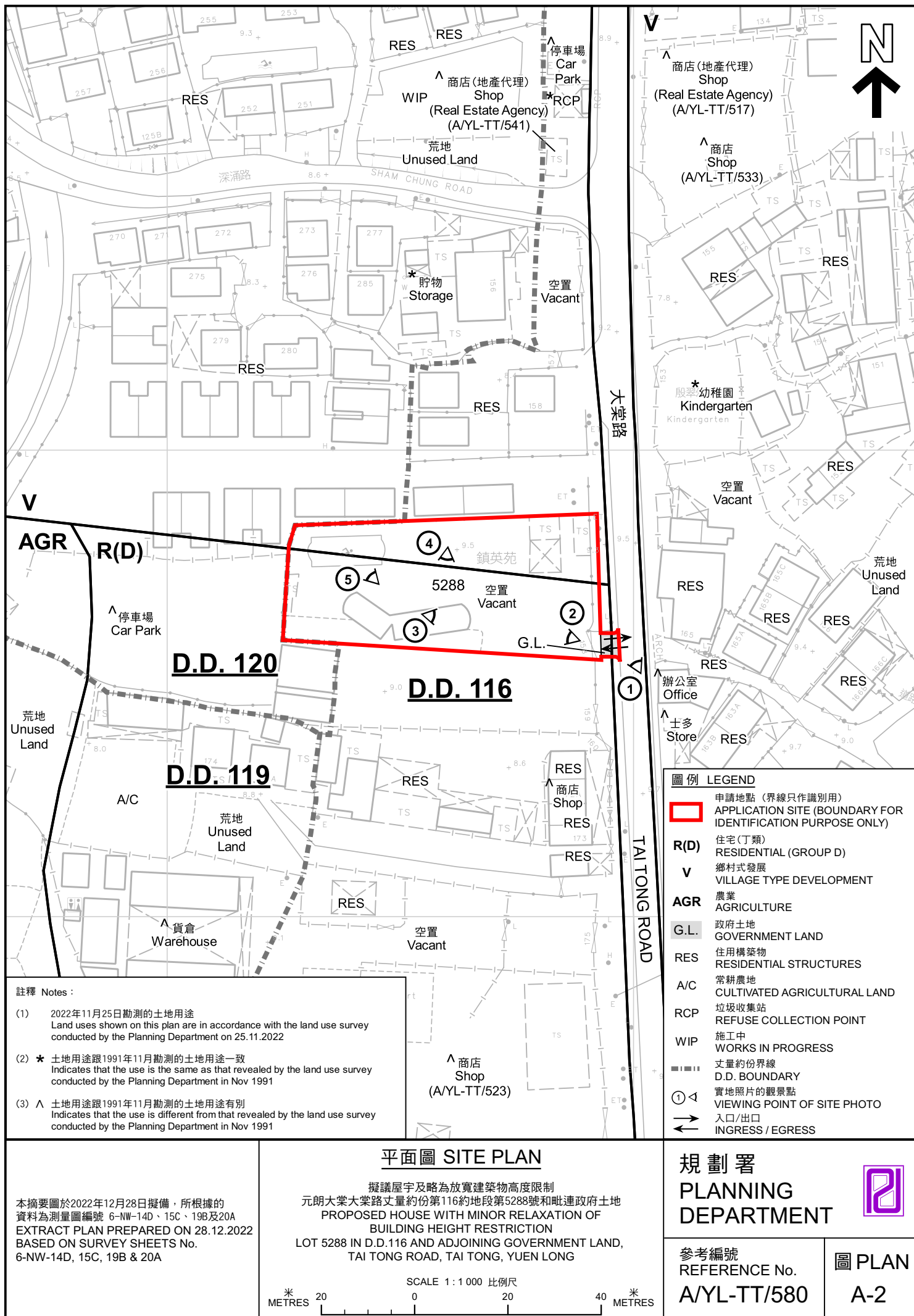



深涌村
Sham Chung Tsuen

深涌路

SHAM CHUNG ROAD

大棠路

崇正新村
Shung Ching San Tsuen

前崇正公立學校
Former Shung Ching
Public School

TAI TONG ROAD

水簕新木路
SHUI TSU SAN TSUEN ROAD

明渠
Nallah

圖例 LEGEND



申請地點(界線只作識別用)
APPLICATION SITE
(BOUNDARY FOR IDENTIFICATION
PURPOSE ONLY)

航攝照片 AERIAL PHOTO

本摘要圖於2022年12月29日擬備，所根據的資料為地政總署於2022年2月14日拍得的航攝照片編號 E149350C
EXTRACT PLAN PREPARED ON 29.12.2022
BASED ON AERIAL PHOTO No.
E149350C TAKEN ON 14.2.2022 BY
LANDS DEPARTMENT

擬議屋宇及略為放寬建築物高度限制
元朗大棠大棠路丈量約份第116約地段第5288號和毗連政府土地
PROPOSED HOUSE WITH MINOR RELAXATION OF
BUILDING HEIGHT RESTRICTION
LOT 5288 IN D.D.116 AND ADJOINING GOVERNMENT LAND,
TAI TONG ROAD, TAI TONG, YUEN LONG

規劃署
PLANNING
DEPARTMENT



參考編號
REFERENCE No.
A/YL-TT/580

圖 PLAN
A-3

1



2



實地照片 SITE PHOTOS

擬議屋宇及略為放寬建築物高度限制
元朗大棠大棠路丈量約份第116約地段第5288號和毗連政府土地
PROPOSED HOUSE WITH MINOR RELAXATION OF
BUILDING HEIGHT RESTRICTION
LOT 5288 IN D.D.116 AND ADJOINING GOVERNMENT LAND,
TAI TONG ROAD, TAI TONG, YUEN LONG

規 劃 署
PLANNING
DEPARTMENT



參考編號
REFERENCE No.
A/YL-TT/580

圖 PLAN
A-4a

本圖於2022年12月29日擬備，所根據的資料為攝於2022年11月25日的實地照片
PLAN PREPARED ON 29.12.2022
BASED ON SITE PHOTOS
TAKEN ON 25.11.2022

3



4



5



申請地點界線只作識別用 APPLICATION SITE BOUNDARY FOR IDENTIFICATION PURPOSE ONLY

實地照片 SITE PHOTOS

擬議屋宇及略為放寬建築物高度限制
元朗大棠大棠路丈量約份第116約地段第5288號和毗連政府土地
PROPOSED HOUSE WITH MINOR RELAXATION OF
BUILDING HEIGHT RESTRICTION
LOT 5288 IN D.D.116 AND ADJOINING GOVERNMENT LAND,
TAI TONG ROAD, TAI TONG, YUEN LONG

規劃署
PLANNING
DEPARTMENT



參考編號
REFERENCE No.
A/YL-TT/580

圖 PLAN
A-4b

本圖於2022年12月29日擬備，所根據的資料為攝於2022年11月25日的實地照片
PLAN PREPARED ON 29.12.2022
BASED ON SITE PHOTOS
TAKEN ON 25.11.2022