

**Relevant Extracts of Town Planning Board Guidelines on
Application for Open Storage and Port Back-up Uses
(TPB PG-No. 13G)**

1. On 14.4.2023, the Town Planning Board Guidelines for Application for Open Storage and Port Back-up Uses under Section 16 of the Town Planning Ordinance (TPB PG-No. 13G) were promulgated, which set out the following criteria for the various categories of area:
 - (a) Category 1 areas: Favourable consideration will normally be given to applications within these areas, subject to no major adverse departmental comments and local objections, or the concerns of the departments and local residents can be addressed through the implementation of approval conditions. Technical assessments should be submitted if the proposed uses may cause significant environmental and traffic concerns;
 - (b) Category 2 areas: Planning permission could be granted on a temporary basis up to a maximum period of 3 years, subject to no adverse departmental comments and local objections, or the concerns of the departments and local residents can be addressed through the implementation of approval conditions. Technical assessments, where appropriate, should be submitted to demonstrate that the proposed uses would not have adverse drainage, traffic, visual, landscaping and environmental impacts on the surrounding areas;
 - (c) Category 3 areas: Applications would normally not be favourably considered unless the applications are on sites with previous planning approvals (irrespective of whether the application is submitted by the applicant of previous approval or a different applicant). Sympathetic consideration may be given if genuine efforts have been demonstrated in compliance with approval conditions of the previous planning applications and/or relevant technical assessments/proposals have been included in the fresh applications, if required, to demonstrate that the proposed uses would not generate adverse drainage, traffic, visual, landscaping and environmental impacts on the surrounding areas. Planning permission could be granted on a temporary basis up to a maximum period of 3 years, subject to no adverse departmental comments and local objections, or the concerns of the departments and local residents can be addressed through the implementation of approval conditions;
 - (d) Category 4 areas: Applications would normally be rejected except under exceptional circumstances. For applications on sites with previous planning approvals (irrespective of whether the application is submitted by the applicant of previous approval or a different applicant), and subject to no adverse departmental comments and local objections, sympathetic consideration may be given if genuine efforts have been demonstrated in compliance with approval conditions of the previous planning applications and/or relevant technical assessments/proposals have been included in the fresh applications, if required, to demonstrate that the proposed uses would not generate adverse drainage, traffic, visual, landscaping and environmental impacts on the surrounding areas. The intention is however to encourage the phasing out of such non-conforming uses as early as possible. Planning permission for a maximum period of 3 years may be allowed for an applicant to identify suitable sites for relocation. Application for renewal of approval will be assessed on its individual merits; and

2. In assessing applications for open storage and port back-up uses, the other major relevant assessment criteria are also summarized as follows:
- (a) port back-up sites and those types of open storage generating adverse noise, air pollution, visual intrusion and frequent heavy vehicle traffic should not be located adjacent to sensitive receivers such as residential dwellings, hospitals, schools and other community facilities;
 - (b) port back-up uses are major generators of traffic, with container trailer/tractor parks generating the highest traffic per unit area. In general, port back-up sites should have good access to the strategic road network, or be accessed by means of purpose built roads;
 - (c) adequate screening of the sites through landscaping and/or fencing should be considered where sites are located adjacent to public roads or are visible from surrounding residential areas;
 - (d) there is a general presumption against conversion of active or good quality agricultural land and fish ponds to other uses on an ad-hoc basis. For flood prone areas or sites which would obstruct natural drainage channels and overland flow, advice should be sought; and
 - (e) for applications involving sites with previous planning approvals, should there be no evidence to demonstrate that the applicant have made any genuine effort to comply with the approval conditions of the previous planning applications, planning permission may be refused, notwithstanding other criteria set out in the Guidelines are complied with.

Previous Applications covering the Application Site

Rejected Applications

	<u>Application No.</u>	<u>Proposed Use(s)</u>	<u>Date of Consideration</u>	<u>Rejection Reason(s)</u>
1	A/YL-TT/89	Temporary Marble Workshop for a Period of 3 Years	23.2.2001 (TPB on review)	(1), (2), (3), (4)
2	A/YL-TT/226	Temporary Open Storage of Machinery for a Period of 3 Years	15.8.2008	(1), (2), (3), (4), (5), (6)
3	A/YL-TT/234	Temporary Warehouse (Construction Machinery and Materials) and Open Storage of Construction Machinery and Materials for a Period of 3 Years	6.3.2009 (TPB on review)	(1), (3), (4), (5), (6)

Rejection Reason(s):

- (1) Not in line with the planning intention.
- (2) Incompatible with the surrounding rural character.
- (3) No information to demonstrate why suitable sites within “Open Storage” zone in the same Outline Zoning Plan could not be made available for the proposed use.
- (4) Approval of the application could set an undesirable precedent for other similar uses.
- (5) Not in line with the then Town Planning Board Guidelines for “Application for Open Storage and Port Back-up Uses”.
- (6) Insufficient information to demonstrate no adverse environment and drainage impact on the surrounding areas.

**Similar s.16 Applications within the Same “AGR” Zone
on the Tai Tong Outline Zoning Plan since 2019**

Approved Applications

	<u>Application No.</u>	<u>Proposed Use(s)/Development(s)</u>	<u>Date of Consideration (RNTPC)</u>
1	A/YL-TT/575	Temporary Warehouse for Storage of Metal and Timber for a Period of 3 Years and Filling of Land	9.12.2022
2	A/YL-TT/583	Temporary Vehicles Repair Workshop and Open Storage for a Period of 3 Years	23.6.2023
3	A/YL-TT/608	Temporary Warehouse for Storage of Construction Materials for a Period of 3 Years	13.10.2023
4	A/YL-TT/617	Temporary Open Storage of Mobile Toilet for a Period of 3 Years and Associated Filling of Land	8.12.2023

Government Departments' General Comments

1. Land Administration

Comment of the District Lands Officer/Yuen Long, Lands Department:

No adverse comment on the application.

2. Traffic

(a) Comments of the Commissioner for Transport:

- No adverse comment on the application.
- The local track and footpath leading to the Site are not under Transport Department's purview.

(b) Comment of the Chief Highway Engineer/New Territories West, Highways Department:

No adverse comment on the application.

3. Environment

Comments of the Director of Environmental Protection:

- No objection to the application.
- No environmental complaint concerning the Site has been received in the past three years.

4. Drainage

Comments of the Chief Engineer/Mainland North of Drainage Services Department:

- No in-principle objection to the proposed use from drainage point of view and detailed comments on the submitted drainage proposal are in **Appendix V**.
- Should the Board approve the application, approval conditions requiring the submission, implementation and maintenance of a revised drainage proposal for the development to the satisfaction of the Director of Drainage Services or of the Town Planning Board should be stipulated.

5. Fire Safety

Comments of the Director of Fire Services:

- No in-principle objection to the proposal subject to the fire service installations being provided to the Site.

- Having considered the nature of the proposal, approval condition for ‘the provision of fire extinguisher(s) within 6 weeks from the date of planning approval to his satisfaction’ shall be added. To address this approval condition, the applicant is advised to submit a valid fire certificate (FS 251) to his department for approval.

6. Building Matters

Comment of the Chief Building Surveyor/New Territories West, Buildings Department (CBS/NTW, BD):

- No objection to the application. As there is no record of approval granted by the Building Authority (BA) for the existing structures at the Site, BD is not in a position to offer comments on the suitability for the proposed uses.
- It is noted that two structures are proposed in the application. Before any new building works (including containers/open sheds as temporary buildings, demolition and land filling etc.) are to be carried out on the Site, prior approval and consent of the Building Authority should be obtained, otherwise, they are unauthorized building works under the Buildings Ordinance (BO). An Authorized Person should be appointed as the co-ordinator for the proposed building works in accordance with the BO.

7. District Officer's Comments

Comment of the District Officer (Yuen Long), Home Affairs Department (DO(YL), HAD):

His office has not received any comments on the application from the village representatives in the vicinity of the Site.

8. Landscape

Comments of the Chief Town Planner/Urban Design & Landscape, Planning Department:

- The Site is situated in area of rural fringe landscape predominantly occupied by temporary structures, village houses, farmland, graveyard and scattered tree groups. And the Site is currently vacant and concrete-paved. The proposed uses are considered not incompatible to the landscape character of the surrounding areas, as similar temporary open storage use in the immediate vicinity (Application No. A/YL-TT/583) was approved by the Town Planning Board on 23.6.2023.
- The applicant has stated that “NO” Tree Felling and “NO” Landscape Impact would be caused under the proposed development. There are also similar temporary warehouse and/or open storage uses under Applications No. A/YL-TT/575 and 583 approved between 2022 and 2023 in the same “AGR” zone. The Site has been re-classified from Category 3 to Category 2 under the TPB PG-No. 13G promulgated on 14.4.2023. She has no comment on the application from the landscape planning perspective.

9. Other Departments

The following departments have no objection to/ no comment on the application:

- Chief Engineer/Construction of Water Supplies Department;
- Project Manager (West) of Civil Engineering and Development Department; and
- Commissioner of Police.

Recommended Advisory Clauses

- (a) to note the comments of the District Lands Officer/Yuen Long, Lands Department (DLO/YL, LandsD) that:
 - (i) the Site comprises Old Schedule Agricultural Lot 1302 RP in D.D. 118 held under the Block Government Lease which contains the restriction that no structures are allowed to be erected without the prior approval of the Government; and
 - (ii) the lot owner(s) shall apply to LandsD for a Short Term Waiver (STW) to permit the structure(s) erected within the Site. The application for STW will be considered by the Government in its capacity as a landlord and there is no guarantee that it will be approved. The STW, if approved, will be subject to such terms and conditions including the payment of waiver fee and administrative fee as considered appropriate by LandsD. Besides, given that the proposed use is temporary in nature, only erection of temporary structure(s) will be considered;
- (b) to note the comments of the Commissioner for Transport that:
 - (i) consent from the owners/managing departments of the local track and footpath should be obtained for using the local track and footpath as the access to the Site; and
 - (ii) sufficient manoeuvring space should be provided within the Site. No vehicles are allowed to queue back to public roads or reverse onto/from public roads;
- (c) to note the comments of the Chief Highway Engineer/New Territories West, Highways Department (CHE/NTW, HyD) that:
 - (i) the proposed access arrangement should be commented by Transport Department;
 - (ii) adequate drainage measures shall be provided to prevent surface water running from the Site to the nearby public roads and drains; and
 - (iii) the access road connecting the Site with Tai Shu Ha Road West is not and will not be maintained by HyD. HyD should not be responsible for maintaining any access connecting the Site with Tai Shu Ha Road West;
- (d) to note the comments of the Chief Engineer/Mainland North, Drainage Services Department (CE/MN, DSD) that:
 - (i) the full alignment of the discharge path from the Site all the way down to the ultimate discharge point (e.g. a well-established stream course/public drainage system) should be indicated clearly;
 - (ii) the existing watercourse proposed for discharging the stormwater from the Site is not maintained by DSD. The applicant should identify the owner(s) of the existing drainage facilities and shall demonstrate that the drainage facilities can be practicable implemented and maintained. In the case that it is a local village

drain, DO(YL) should be consulted;

- (iii) further to (i) above, since there is no record the said discharge path, site photos to demonstrate its presence and existing condition should be provided;
 - (iv) consideration should be given to provide grating for the surface channels;
 - (v) the cover levels and invert levels of the proposed u-channels, catchpits/sand traps should be shown on the drainage plan;
 - (vi) cross sections showing the existing and proposed ground levels of the Site with respect to the adjacent areas should be given; and
 - (vii) standard details should be provided to indicate the sectional details of the proposed u-channel and the catchpit/sand trap;
- (e) to follow the relevant mitigation measures and requirements in the latest “Code of Practice on Handling the Environmental Aspects of Temporary Uses and Open Storage Sites” issued by the Environmental Protection Department;
- (f) to note the comments of the Director of Fire Services that:
- (i) the layout plans should be drawn to scale and depicted with dimensions and nature of occupancy, and the location of where the proposed fire service installations to be installed should also be clearly marked on the layout plans. Good practice guidelines for open storage (**Appendix VI** of this RNTPC Paper) should be adhered to; and
 - (ii) if the proposed structure(s) is required to comply with the Buildings Ordinance (BO)(Cap. 123), detailed fire service requirements will be formulated upon receipt of formal submission of general building plans;
- (g) to note the comments of the Chief Building Surveyor/New Territories West, Buildings Department (CBS/NTW, BD) that:
- (i) the Site shall be provided with means of obtaining access thereto from a street and emergency vehicular access in accordance with Regulations 5 and 41D of the Building (Planning) Regulations (B(P)R) respectively;
 - (ii) the Site does not abut on a specified street of not less than 4.5m wide and its permitted development intensity shall be determined under Regulation 19(3) of the B(P)R at building plan submission stage;
 - (iii) before any new building works (including containers/open sheds as temporary buildings, demolition and land filling, etc.) are to be carried out on the Site, prior approval and consent of the Building Authority should be obtained, otherwise they are unauthorized building works (UBW) under BO. An Authorized Person should be appointed as the co-ordinator for the proposed building works in accordance with BO;
 - (iv) for UBW erected on leased land, enforcement action may be taken by the BD to effect their removal in accordance with the prevailing enforcement policy against UBW as and when necessary. The granting of any planning approval

should not be construed as an acceptance of any existing building works or UBW on the Site under BO;

- (v) any temporary shelters or converted containers for office, storage, washroom or other uses are considered as temporary buildings which are subject to the control of Part VII of B(P)R; and
 - (vi) detailed checking under BO will be carried out at building plan submission stage; and
- (h) to note the comments of the Director of Electrical and Mechanical Services that:

in the interests of public safety and ensuring the continuity of electricity supply, the parties concerned with planning, designing, organising and supervising any activity near the underground cable or overhead line under the application should approach the electricity supplier (i.e. CLP Power) for the requisition of cable plans (and overhead line alignment drawings, where applicable) to find out whether there is any underground cable and/or overhead line within and/or in the vicinity of the Site. They should also be reminded to observe the Electricity Supply Lines (Protection) Regulation and the “Code of Practice on Working near Electricity Supply Lines” established under the Regulation when carrying out works in the vicinity of the electricity supply lines.

Good Practice Guidelines for Open Storage Sites

		Internal Access for Fire Appliances	Lot Boundaries (Clear Width)	Distance between Storage Cluster and Temporary Structure	Cluster Size	Storage Height
1.	Open Storage of Containers		2m	4.5m		
2.	Open Storage of Non- Combustibles or Limited Combustibles	4.5m	2m	4.5m		
3.	Open Storage of Combustibles	4.5m	2m	4.5m	40m x 40m	3m

Remarks: Smoking and naked flame activities shall not be allowed within the open storage / recycling site.

☐ Urgent ☐ Return Receipt Requested ☐ Sign ☐ Encrypt ☐ Mark Subject Restricted ☐ Expand personal&publi



A/YL-TT/642 DD 118 Tai Shu Ha Road W, Yuen Long
24/04/2024 03:31

From:

To: "tpbpd" <tpbpd@pland.gov.hk>

Sent by: tpbpd@pland.gov.hk

File Ref:

A/YL-TT/642

Lot 1302 RP (Part) in D.D. 118, Tai Shu Ha Road West, Yuen Long

Site area: About 706sq.m

Zoning: "Agriculture"

**Applied use: Open Storage and Warehouse for Storage of Construction Materials / 1
Vehicle Parking / **Filling of Land****

Dear TPB Members,

No record of previous approvals but the site has been operated as a brownfield for a long time.

Perhaps one of the new members could ask how come there has been no enforcement?

Mary Mulvihill

2024年 3月 28日

此文件在_____收到。城市規劃委員會
只會在收到所有必要的資料及文件後才正式確認收到
申請的日期。

Appendix I of RNTPC
Paper No. A/YL-TT/642

This document is received on 28 MAR 2024
The Town Planning Board will formally acknowledge
the date of receipt of the application only upon receipt
of all the required information and documents.

Form No. S16-III
表格第 S16-III 號

**APPLICATION FOR PERMISSION
UNDER SECTION 16 OF
THE TOWN PLANNING ORDINANCE
(CAP.131)**

根據《城市規劃條例》(第131章)
第16條遞交的許可申請

**Applicable to Proposal Only Involving Temporary Use/Development of
Land and/or Building Not Exceeding 3 Years in Rural Areas or Renewal
of Permission for such Temporary Use or Development***

**適用於祇涉及位於鄉郊地區土地上及/或建築物內進行為期不超過三年
的臨時用途/發展或該等臨時用途/發展的許可續期的建議***

**Form No. S16-I should be used for other Temporary Use/Development of Land and/or Building (e.g. temporary use/developments in the Urban Area) and Renewal of Permission for such Temporary Use or Development.*

**其他土地上及/或建築物內的臨時用途/發展 (例如位於市區內的臨時用途或發展) 及有關該等臨時用途/發展的許可續期，應使用表格第 S16-I 號。*

Applicant who would like to publish the notice of application in local newspapers to meet one of the Town Planning Board's requirements of taking reasonable steps to obtain consent of or give notification to the current land owner, please refer to the following link regarding publishing the notice in the designated newspapers: https://www.info.gov.hk/tpb/en/plan_application/apply.html

申請人如欲在本地報章刊登申請通知，以採取城市規劃委員會就取得現行土地擁有人的同意或通知現行土地擁有人所指定的其中一項合理步驟，請瀏覽以下網址有關在指定的報章刊登通知：
https://www.info.gov.hk/tpb/tc/plan_application/apply.html

General Note and Annotation for the Form

填寫表格的一般指引及註解

* "Current land owner" means any person whose name is registered in the Land Registry as that of an owner of the land to which the application relates, as at 6 weeks before the application is made
「現行土地擁有人」指在提出申請前六星期，其姓名或名稱已在土地註冊處註冊為該申請所關乎的土地的擁有人的人

& Please attach documentary proof 請夾附證明文件

^ Please insert number where appropriate 請在適當地方註明編號

Please fill "NA" for inapplicable item 請在不適用的項目填寫「不適用」

Please use separate sheets if the space provided is insufficient 如所提供的空間不足，請另頁說明

Please insert a 「✓」 at the appropriate box 請在適當的方格內上加上「✓」號

For Official Use Only 請勿填寫此欄	Application No. 申請編號	A/YL-TT/642
	Date Received 收到日期	28 MAR 2024

- The completed form and supporting documents (if any) should be sent to the Secretary, Town Planning Board (the Board), 15/F, North Point Government Offices, 333 Java Road, North Point, Hong Kong.
申請人須把填妥的申請表格及其他支持申請的文件 (倘有), 送交香港北角渣華道 333 號北角政府合署 15 樓城市規劃委員會(下稱「委員會」)秘書收。
- Please read the "Guidance Notes" carefully before you fill in this form. The document can be downloaded from the Board's website at <http://www.info.gov.hk/tpb/>. It can also be obtained from the Secretariat of the Board at 15/F, North Point Government Offices, 333 Java Road, North Point, Hong Kong (Tel: 2231 4810 or 2231 4835), and the Planning Enquiry Counters of the Planning Department (Hotline: 2231 5000) (17/F, North Point Government Offices, 333 Java Road, North Point, Hong Kong and 14/F, Sha Tin Government Offices, 1 Sheung Wo Che Road, Sha Tin, New Territories).
請先細閱《申請須知》的資料單張, 然後填寫此表格。該份文件可從委員會的網頁下載 (網址: <http://www.info.gov.hk/tpb/>)。亦可向委員會秘書處 (香港北角渣華道 333 號北角政府合署 15 樓 - 電話: 2231 4810 或 2231 4835) 及規劃署的規劃資料查詢處 (熱線: 2231 5000) (香港北角渣華道 333 號北角政府合署 17 樓及新界沙田上禾輦路 1 號沙田政府合署 14 樓) 索取。
- This form can be downloaded from the Board's website, and obtained from the Secretariat of the Board and the Planning Enquiry Counters of the Planning Department. The form should be typed or completed in block letters. The processing of the application may be refused if the required information or the required copies are incomplete.
此表格可從委員會的網頁下載, 亦可向委員會秘書處及規劃署的規劃資料查詢處索取。申請人須以打印方式或以正楷填寫表格。如果申請人所提交的資料或文件副本不齊全, 委員會可拒絕處理有關申請。

1. Name of Applicant 申請人姓名/名稱

(☐ Mr. 先生 / ☐ Mrs. 夫人 / ☐ Miss 小姐 / ☐ Ms. 女士 / ☒ Company 公司 / ☐ Organisation 機構)

Men Fung Investment Limited (文豐投資有限公司)

2. Name of Authorised Agent (if applicable) 獲授權代理人姓名/名稱 (如適用)

(☐ Mr. 先生 / ☐ Mrs. 夫人 / ☐ Miss 小姐 / ☐ Ms. 女士 / ☒ Company 公司 / ☐ Organisation 機構)

Metro Planning & Development Company Limited (都市規劃及發展顧問有限公司)

3. Application Site 申請地點

(a) Full address / location / demarcation district and lot number (if applicable) 詳細地址/地點/丈量約份及地段號碼 (如適用)	Lot 1302 RP (Part) in D.D. 118, Tai Shu Ha Road West, Yuen Long, New Territories
(b) Site area and/or gross floor area involved 涉及的地盤面積及/或總樓面面積	<input checked="" type="checkbox"/> Site area 地盤面積 706 sq.m 平方米 <input checked="" type="checkbox"/> About 約 Not more than <input checked="" type="checkbox"/> Gross floor area 總樓面面積 270 sq.m 平方米 <input type="checkbox"/> About 約
(c) Area of Government land included (if any) 所包括的政府土地面積 (倘有)	Nil sq.m 平方米 <input type="checkbox"/> About 約

(d) Name and number of the related statutory plan(s) 有關法定圖則的名稱及編號	Approved Tai Tong Outline Zoning Plan No. S/YL-TT/20
(e) Land use zone(s) involved 涉及的土地用途地帶	'Agriculture' ("AGR")
(f) Current use(s) 現時用途	Vacant site (If there are any Government, institution or community facilities, please illustrate on plan and specify the use and gross floor area) (如有任何政府、機構或社區設施，請在圖則上顯示，並註明用途及總樓面面積)

4. "Current Land Owner" of Application Site 申請地點的「現行土地擁有人」

The applicant 申請人 -

- ☒ is the sole "current land owner"[#] (please proceed to Part 6 and attach documentary proof of ownership).
是唯一的「現行土地擁有人」[#] (請繼續填寫第 6 部分，並夾附業權證明文件)。
- ☐ is one of the "current land owners"[#] (please attach documentary proof of ownership).
是其中一名「現行土地擁有人」[#] (請夾附業權證明文件)。
- ☐ is not a "current land owner"[#].
並不是「現行土地擁有人」[#]。

- ☐ The application site is entirely on Government land (please proceed to Part 6).
申請地點完全位於政府土地上 (請繼續填寫第 6 部分)。

5. Statement on Owner's Consent/Notification

就土地擁有人的同意/通知土地擁有人的陳述

- (a) According to the record(s) of the Land Registry as at (DD/MM/YYYY), this application involves a total of "current land owner(s)"[#].
根據土地註冊處截至 年 月 日的記錄，這宗申請共牽涉 名「現行土地擁有人」[#]。

(b) The applicant 申請人 -

- ☐ has obtained consent(s) of "current land owner(s)"[#].
已取得 名「現行土地擁有人」[#]的同意。

Details of consent of "current land owner(s)" [#] obtained 取得「現行土地擁有人」 [#] 同意的詳情		
No. of 'Current Land Owner(s)' 「現行土地擁有人」數目	Lot number/address of premises as shown in the record of the Land Registry where consent(s) has/have been obtained 根據土地註冊處記錄已獲得同意的地段號碼/處所地址	Date of consent obtained (DD/MM/YYYY) 取得同意的日期 (日/月/年)

(Please use separate sheets if the space of any box above is insufficient. 如上列任何方格的空間不足，請另頁說明)

- ☐ has notified "current land owner(s)"[#]
已通知 名「現行土地擁有人」[#]。

Details of the "current land owner(s)" [#] notified 已獲通知「現行土地擁有人」 [#] 的詳細資料		
No. of 'Current Land Owner(s)' 「現行土地擁有人」數目	Lot number/address of premises as shown in the record of the Land Registry where notification(s) has/have been given 根據土地註冊處記錄已發出通知的地段號碼／處所地址	Date of notification given (DD/MM/YYYY) 通知日期(日/月/年)

(Please use separate sheets if the space of any box above is insufficient. 如上列任何方格的空間不足，請另頁說明)

- ☐ has taken reasonable steps to obtain consent of or give notification to owner(s):
已採取合理步驟以取得土地擁有人的同意或向該人發給通知。詳情如下：

Reasonable Steps to Obtain Consent of Owner(s) 取得土地擁有人的同意所採取的合理步驟

- ☐ sent request for consent to the "current land owner(s)" on _____ (DD/MM/YYYY)^{#&}
於 _____ (日/月/年)向每一名「現行土地擁有人」[#]郵遞要求同意書[&]

Reasonable Steps to Give Notification to Owner(s) 向土地擁有人發出通知所採取的合理步驟

- ☐ published notices in local newspapers on _____ (DD/MM/YYYY)[&]
於 _____ (日/月/年)在指定報章就申請刊登一次通知[&]
- ☐ posted notice in a prominent position on or near application site/premises on _____ (DD/MM/YYYY)[&]
於 _____ (日/月/年)在申請地點／申請處所或附近的顯明位置貼出關於該申請的通知[&]
- ☐ sent notice to relevant owners' corporation(s)/owners' committee(s)/mutual aid committee(s)/management office(s) or rural committee on _____ (DD/MM/YYYY)[&]
於 _____ (日/月/年)把通知寄往相關的業主立案法團/業主委員會/互助委員會或管理處，或有關的鄉事委員會[&]

Others 其他

- ☐ others (please specify)
其他（請指明）
- _____
- _____
- _____
- _____

Note: May insert more than one 「✓」:

Information should be provided on the basis of each and every lot (if applicable) and premises (if any) in respect of the application.

註: 可在多於一個方格內加上「✓」號

申請人須就申請涉及的每一地段（倘適用）及處所（倘有）分別提供資料

6. Type(s) of Application 申請類別

(A) Temporary Use/Development of Land and/or Building Not Exceeding 3 Years in Rural Areas
 位於鄉郊地區土地上及/或建築物內進行為期不超過三年的臨時用途/發展
 (For Renewal of Permission for Temporary Use or Development in Rural Areas, please proceed to Part (B))
 (如屬位於鄉郊地區臨時用途/發展的規劃許可續期，請填寫(B)部分)

(a) Proposed use(s)/development 擬議用途/發展	Proposed Temporary Open Storage and Warehouse for Storage of Construction Materials for a Period of 3 Years and Filling of Land (Please illustrate the details of the proposal on a layout plan) (請用平面圖說明擬議詳情)	
(b) Effective period of permission applied for 申請的許可有效期	<input checked="" type="checkbox"/> year(s) 年	3
	<input type="checkbox"/> month(s) 個月	
(c) Development Schedule 發展細節表		
Proposed uncovered land area 擬議露天土地面積	456sq.m <input checked="" type="checkbox"/> About 約
Proposed covered land area 擬議有上蓋土地面積	Not more than 250sq.m <input type="checkbox"/> About 約
Proposed number of buildings/structures 擬議建築物/構築物數目	2	
Proposed domestic floor area 擬議住用樓面面積	NAsq.m <input checked="" type="checkbox"/> About 約
Proposed non-domestic floor area 擬議非住用樓面面積	Not more than 270sq.m <input type="checkbox"/> About 約
Proposed gross floor area 擬議總樓面面積	Not more than 270sq.m <input type="checkbox"/> About 約
Proposed height and use(s) of different floors of buildings/structures (if applicable) 建築物/構築物的擬議高度及不同樓層的擬議用途 (如適用) (Please use separate sheets if the space below is insufficient) (如以下空間不足，請另頁說明)		
Structure 1: Warehouse (Not exceeding 8.5m, 1 storey), Structure 2: Site office and toilet (Not exceeding 6m, 2 storey)		
Proposed number of car parking spaces by types 不同種類停車位的擬議數目		
Private Car Parking Spaces 私家車車位	Nil	
Motorcycle Parking Spaces 電單車車位	Nil	
Light Goods Vehicle Parking Spaces 輕型貨車泊車位	Nil	
Medium Goods Vehicle Parking Spaces 中型貨車泊車位	Nil	
Heavy Goods Vehicle Parking Spaces 重型貨車泊車位	Nil	
Others (Please Specify) 其他 (請列明)	NA	
Proposed number of loading/unloading spaces 上落客貨車位的擬議數目		
Taxi Spaces 的士車位	Nil	
Coach Spaces 旅遊巴車位	Nil	
Light Goods Vehicle Spaces 輕型貨車車位	1 space of 7m x 3.5m	
Medium Goods Vehicle Spaces 中型貨車車位	Nil	
Heavy Goods Vehicle Spaces 重型貨車車位	Nil	
Others (Please Specify) 其他 (請列明)	NA	

Proposed operating hours 擬議營運時間 9:00a.m. to 7:00p.m. from Mondays to Saturdays. No operation will be carried out on Sundays & public holidays.			
(d) Any vehicular access to the site/subject building? 是否有車路通往地盤/ 有關建築物?	Yes 是	<input checked="" type="checkbox"/> There is an existing access. (please indicate the street name, where appropriate) 有一條現有車路。(請註明車路名稱(如適用)) Tai Shu Ha Road West	
	No 否	<input type="checkbox"/> There is a proposed access. (please illustrate on plan and specify the width) 有一條擬議車路。(請在圖則顯示, 並註明車路的闊度)	
(e) Impacts of Development Proposal 擬議發展計劃的影響 (If necessary, please use separate sheets to indicate the proposed measures to minimise possible adverse impacts or give justifications/reasons for not providing such measures. 如需要的話, 請另頁表示可盡量減少可能出現不良影響的措施, 否則請提供理據/理由。)			
(i) Does the development proposal involve alteration of existing building? 擬議發展計劃是否包括現有建築物的改動?	Yes 是	<input type="checkbox"/> Please provide details 請提供詳情	
	No 否	<input checked="" type="checkbox"/>	
(ii) Does the development proposal involve the operation on the right? 擬議發展是否涉及右列的工程?	Yes 是	<input checked="" type="checkbox"/> (Please indicate on site plan the boundary of concerned land/pond(s), and particulars of stream diversion, the extent of filling of land/pond(s) and/or excavation of land) (請用地盤平面圖顯示有關土地/池塘界線, 以及河道改道、填塘、填土及/或挖土的細節及/或範圍) <input type="checkbox"/> Diversion of stream 河道改道 <input type="checkbox"/> Filling of pond 填塘 Area of filling 填塘面積 sq.m 平方米 <input type="checkbox"/> About 約 Depth of filling 填塘深度 m 米 <input type="checkbox"/> About 約 <input checked="" type="checkbox"/> Filling of land 填土 Area of filling 填土面積 706 sq.m 平方米 <input checked="" type="checkbox"/> About 約 Depth of filling 填土厚度 0.2 m 米 <input checked="" type="checkbox"/> About 約 <input type="checkbox"/> Excavation of land 挖土 Area of excavation 挖土面積 sq.m 平方米 <input type="checkbox"/> About 約 Depth of excavation 挖土深度 m 米 <input type="checkbox"/> About 約	
	No 否	<input type="checkbox"/>	
(iii) Would the development proposal cause any adverse impacts? 擬議發展計劃會否造成不良影響?	On environment 對環境 Yes 會 <input type="checkbox"/> No 不會 <input checked="" type="checkbox"/> On traffic 對交通 Yes 會 <input type="checkbox"/> No 不會 <input checked="" type="checkbox"/> On water supply 對供水 Yes 會 <input type="checkbox"/> No 不會 <input checked="" type="checkbox"/> On drainage 對排水 Yes 會 <input type="checkbox"/> No 不會 <input checked="" type="checkbox"/> On slopes 對斜坡 Yes 會 <input type="checkbox"/> No 不會 <input checked="" type="checkbox"/> Affected by slopes 受斜坡影響 Yes 會 <input type="checkbox"/> No 不會 <input checked="" type="checkbox"/> Landscape Impact 構成景觀影響 Yes 會 <input type="checkbox"/> No 不會 <input checked="" type="checkbox"/> Tree Felling 砍伐樹木 Yes 會 <input type="checkbox"/> No 不會 <input checked="" type="checkbox"/> Visual Impact 構成視覺影響 Yes 會 <input type="checkbox"/> No 不會 <input checked="" type="checkbox"/> Others (Please Specify) 其他 (請列明) Yes 會 <input type="checkbox"/> No 不會 <input checked="" type="checkbox"/>		

	Please state measure(s) to minimise the impact(s). For tree felling, please state the number, diameter at breast height and species of the affected trees (if possible) 請註明盡量減少影響的措施。如涉及砍伐樹木，請說明受影響樹木的數目、及胸高度的樹幹直徑及品種(倘可)
--	---

(B) Renewal of Permission for Temporary Use or Development in Rural Areas

位於鄉郊地區臨時用途/發展的許可續期

(a) Application number to which the permission relates 與許可有關的申請編號	A/ _____ / _____
(b) Date of approval 獲批給許可的日期 (DD 日/MM 月/YYYY 年)
(c) Date of expiry 許可屆滿日期 (DD 日/MM 月/YYYY 年)
(d) Approved use/development 已批給許可的用途/發展	
(e) Approval conditions 附帶條件	<input type="checkbox"/> The permission does not have any approval condition 許可並沒有任何附帶條件 <input type="checkbox"/> Applicant has complied with all the approval conditions 申請人已履行全部附帶條件 <input type="checkbox"/> Applicant has not yet complied with the following approval condition(s): 申請人仍未履行下列附帶條件： Reason(s) for non-compliance: 仍未履行的原因： (Please use separate sheets if the space above is insufficient) (如以上空間不足，請另頁說明)
(f) Renewal period sought 要求的續期期間	<input type="checkbox"/> year(s) 年 <input type="checkbox"/> month(s) 個月

Part 6 (Cont'd) 第 6 部分(續)

7. Justifications 理由

The applicant is invited to provide justifications in support of the application. Use separate sheets if necessary.
現請申請人提供申請理由及支持其申請的資料。如有需要，請另頁說明。

1. The application site has been upgraded to 'Category 2 Areas' according to the Town Planning Board Guidelines No. 13G of which open storage activities would normally approve if there is no adverse comments from Government departments.
2. The proposed development is temporary in nature and it would not jeopardize the planning intention of "AGR" zone in the long run. Also, similar open storage use has been approved at adjacent land such as A/YL-TT/617.
3. The nature, layout, form and scale of the proposed development is not incompatible with the surrounding environment.
4. Similar precedence for open storage was approved in "AGR" zone within the same Outline Zoning Plan.
5. Minimal traffic impact as shown in the attached estimated traffic generation.
6. Insignificant environmental impact because no operation will be held between 7:00p.m. to 9:00a.m. The proposed development involves only open storage of construction materials which could be delivered by light goods vehicle.
7. Insignificant drainage impact as drainage proposal has been submitted in support of the application.
8. The applicant will comply with planning conditions if the Town Planning Board see fits.
9. The applicant will follow the relevant mitigation measures and requirements as shown in the revised "Code of Practice on Handling the Environmental Aspects of Temporary Uses and Open Storage Sites".
10. The application site is compatible to the approved port back-up use to the north of the application site.
11. In view of that the application site is undulated and uneven in topography, the applicant proposed to fill the land to make the site suitable for open storage use.
12. The construction materials to be stored at the application site include pvc pipes, handy tools, sanitary ware and alike.

8. Declaration 聲明

I hereby declare that the particulars given in this application are correct and true to the best of my knowledge and belief.
本人謹此聲明，本人就這宗申請提交的資料，據本人所知及所信，均屬真實無誤。

I hereby grant a permission to the Board to copy all the materials submitted in this application and/or to upload such materials to the Board's website for browsing and downloading by the public free-of-charge at the Board's discretion.
本人現准許委員會酌情將本人就此申請所提交的所有資料複製及/或上載至委員會網站，供公眾免費瀏覽或下載。

Signature
簽署

Patrick Tsui

Name in Block Letters
姓名（請以正楷填寫）

☐ Applicant 申請人 / ☒ Authorised Agent 獲授權代理人

Consultant

Position (if applicable)
職位（如適用）

Professional Qualification(s) ☐ Member 會員 / ☐ Fellow of 資深會員

專業資格

- ☐ HKIP 香港規劃師學會 / ☐ HKIA 香港建築師學會 /
☐ HKIS 香港測量師學會 / ☐ HKIE 香港工程師學會 /
☐ HKILA 香港園境師學會 / ☐ HKIUD 香港城市設計學會
☐ RPP 註冊專業規劃師

Others 其他

on behalf of Metro Planning & Development Company Limited (都市規劃及發展顧問有限公司)
代表

☒ Company 公司 / ☐ Organisation Name and Chop (if applicable) 機構名稱及蓋章（如適用）

Date 日期

21/3/2024

(DD/MM/YYYY 日/月/年)

Remark 備註

The materials submitted in this application and the Board's decision on the application would be disclosed to the public. Such materials would also be uploaded to the Board's website for browsing and free downloading by the public where the Board considers appropriate.

委員會會向公眾披露申請人所遞交的申請資料和委員會對申請所作的決定。在委員會認為合適的情況下，有關申請資料亦會上載至委員會網頁供公眾免費瀏覽及下載。

Warning 警告

Any person who knowingly or wilfully makes any statement or furnish any information in connection with this application, which is false in any material particular, shall be liable to an offence under the Crimes Ordinance.
任何人在明知或故意的情況下，就這宗申請提出在任何要項上是虛假的陳述或資料，即屬違反《刑事罪行條例》。

Statement on Personal Data 個人資料的聲明

- The personal data submitted to the Board in this application will be used by the Secretary of the Board and Government departments for the following purposes:
委員會就這宗申請所收到的個人資料會交給委員會秘書及政府部門，以根據《城市規劃條例》及相關的城市規劃委員會規劃指引的規定作以下用途：
(a) the processing of this application which includes making available the name of the applicant for public inspection when making available this application for public inspection; and
處理這宗申請，包括公布這宗申請供公眾查閱，同時公布申請人的姓名供公眾查閱；以及
(b) facilitating communication between the applicant and the Secretary of the Board/Government departments.
方便申請人與委員會秘書及政府部門之間進行聯絡。
- The personal data provided by the applicant in this application may also be disclosed to other persons for the purposes mentioned in paragraph 1 above.
申請人就這宗申請提供的個人資料，或亦會向其他人士披露，以作上述第 1 段提及的用途。
- An applicant has a right of access and correction with respect to his/her personal data as provided under the Personal Data (Privacy) Ordinance (Cap. 486). Request for personal data access and correction should be addressed to the Secretary of the Board at 15/F, North Point Government Offices, 333 Java Road, North Point, Hong Kong.
根據《個人資料(私隱)條例》(第 486 章)的規定，申請人有權查閱及更正其個人資料。如欲查閱及更正個人資料，應向委員會秘書提出有關要求，其地址為香港北角渣甸道 333 號北角政府合署 15 樓。

Gist of Application 申請摘要

(Please provide details in both English and Chinese as far as possible. This part will be circulated to relevant consultees, uploaded to the Town Planning Board's Website for browsing and free downloading by the public and deposited at the Planning Enquiry Counters of the Planning Department for general information.)
(請盡量以英文及中文填寫。此部分將會發送予相關諮詢人士、上載至城市規劃委員會網頁供公眾免費瀏覽及下載及存放於規劃署規劃資料查詢處以供一般參閱。)

Application No. 申請編號	(For Official Use Only) (請勿填寫此欄)
Location/address 位置/地址	Lot 1302 RP (Part) in D.D. 118, Tai Shu Ha Road West, Yuen Long, New Territories
Site area 地盤面積	706 sq. m 平方米 <input checked="" type="checkbox"/> About 約 (includes Government land of 包括政府土地 0 sq. m 平方米 <input type="checkbox"/> About 約)
Plan 圖則	Approved Tai Tong Outline Zoning Plan No. S/YL-TT/20
Zoning 地帶	'Agriculture' ('AGR')
Type of Application 申請類別	<input checked="" type="checkbox"/> Temporary Use/Development in Rural Areas for a Period of 位於鄉郊地區的臨時用途/發展為期 <input checked="" type="checkbox"/> Year(s) 年 3 <input type="checkbox"/> Month(s) 月 _____ <input type="checkbox"/> Renewal of Planning Approval for Temporary Use/Development in Rural Areas for a Period of 位於鄉郊地區臨時用途/發展的規劃許可續期為期 <input type="checkbox"/> Year(s) 年 _____ <input type="checkbox"/> Month(s) 月 _____
Applied use/ development 申請用途/發展	Proposed Temporary Open Storage and Warehouse for Storage of Construction Materials for a Period of 3 Years and Filling of Land

(i) Gross floor area and/or plot ratio 總樓面面積及／或地積比率		sq.m 平方米	Plot Ratio 地積比率
	Domestic 住用	NA <input type="checkbox"/> About 約 <input type="checkbox"/> Not more than 不多於	NA <input type="checkbox"/> About 約 <input type="checkbox"/> Not more than 不多於
	Non-domestic 非住用	270 <input type="checkbox"/> About 約 <input checked="" type="checkbox"/> Not more than 不多於	0.382 <input type="checkbox"/> About 約 <input checked="" type="checkbox"/> Not more than 不多於
(ii) No. of block 幢數	Domestic 住用	NA	
	Non-domestic 非住用	2	
(iii) Building height/No. of storeys 建築物高度／層數	Domestic 住用	NA	<input type="checkbox"/> (Not more than 不多於) m 米
		NA	<input type="checkbox"/> (Not more than 不多於) Storeys(s) 層
	Non-domestic 非住用	8.5	<input checked="" type="checkbox"/> (Not more than 不多於) m 米
		2	<input checked="" type="checkbox"/> (Not more than 不多於) Storeys(s) 層
(iv) Site coverage 上蓋面積	35.41 % <input checked="" type="checkbox"/> About 約		
(v) No. of parking spaces and loading / unloading spaces 停車位及上落客貨車位數目	Total no. of vehicle parking spaces 停車位總數		0
	Private Car Parking Spaces 私家車車位 0 Motorcycle Parking Spaces 電單車車位 0 Light Goods Vehicle Parking Spaces 輕型貨車泊車位 0 Medium Goods Vehicle Parking Spaces 中型貨車泊車位 0 Heavy Goods Vehicle Parking Spaces 重型貨車泊車位 0 Others (Please Specify) 其他 (請列明) NA		
(v) No. of parking spaces and loading / unloading spaces 停車位及上落客貨車位數目	Total no. of vehicle loading/unloading bays/lay-bys 上落客貨車位／停車處總數		1
	Taxi Spaces 的士車位 0 Coach Spaces 旅遊巴車位 0 Light Goods Vehicle Spaces 輕型貨車車位 1 Medium Goods Vehicle Spaces 中型貨車位 0 Heavy Goods Vehicle Spaces 重型貨車車位 0 Others (Please Specify) 其他 (請列明) NA		

Submitted Plans, Drawings and Documents 提交的圖則、繪圖及文件		
	Chinese 中文	English 英文
Plans and Drawings 圖則及繪圖		
Master layout plan(s)/Layout plan(s) 總綱發展藍圖／布局設計圖	<input type="checkbox"/>	<input checked="" type="checkbox"/>
Block plan(s) 樓宇位置圖	<input type="checkbox"/>	<input type="checkbox"/>
Floor plan(s) 樓宇平面圖	<input type="checkbox"/>	<input type="checkbox"/>
Sectional plan(s) 截視圖	<input type="checkbox"/>	<input type="checkbox"/>
Elevation(s) 立視圖	<input type="checkbox"/>	<input type="checkbox"/>
Photomontage(s) showing the proposed development 顯示擬議發展的合成照片	<input type="checkbox"/>	<input type="checkbox"/>
Master landscape plan(s)/Landscape plan(s) 園境設計總圖／園境設計圖	<input type="checkbox"/>	<input type="checkbox"/>
Others (please specify) 其他（請註明）	<input type="checkbox"/>	<input checked="" type="checkbox"/>
Proposed drainage plan, site plan		
Proposed land filling plan		
Reports 報告書		
Planning Statement/Justifications 規劃綱領/理據	<input type="checkbox"/>	<input type="checkbox"/>
Environmental assessment (noise, air and/or water pollutions) 環境評估（噪音、空氣及／或水的污染）	<input type="checkbox"/>	<input type="checkbox"/>
Traffic impact assessment (on vehicles) 就車輛的交通影響評估	<input type="checkbox"/>	<input type="checkbox"/>
Traffic impact assessment (on pedestrians) 就行人的交通影響評估	<input type="checkbox"/>	<input type="checkbox"/>
Visual impact assessment 視覺影響評估	<input type="checkbox"/>	<input type="checkbox"/>
Landscape impact assessment 景觀影響評估	<input type="checkbox"/>	<input type="checkbox"/>
Tree Survey 樹木調查	<input type="checkbox"/>	<input type="checkbox"/>
Geotechnical impact assessment 土力影響評估	<input type="checkbox"/>	<input type="checkbox"/>
Drainage impact assessment 排水影響評估	<input type="checkbox"/>	<input type="checkbox"/>
Sewerage impact assessment 排污影響評估	<input type="checkbox"/>	<input type="checkbox"/>
Risk Assessment 風險評估	<input type="checkbox"/>	<input type="checkbox"/>
Others (please specify) 其他（請註明）	<input type="checkbox"/>	<input checked="" type="checkbox"/>
Drainage proposal and estimated traffic generation		
Note: May insert more than one 「✓」. 註：可在多於一個方格內加上「✓」號		

Note: The information in the Gist of Application above is provided by the applicant for easy reference of the general public. Under no circumstances will the Town Planning Board accept any liabilities for the use of the information nor any inaccuracies or discrepancies of the information provided. In case of doubt, reference should always be made to the submission of the applicant.

註：上述申請摘要的資料是由申請人提供以方便市民大眾參考。對於所載資料在使用上的問題及文義上的歧異，城市規劃委員會概不負責。若有任何疑問，應查閱申請人提交的文件。

Proposed Temporary Open Storage and Warehouse for Storage of Construction Materials for a Period of 3 Years and Filling of Land at Lot 1302 RP (Part) in D.D. 118, Tai Shu Ha Road West, Yuen Long, New Territories

Annex 1 Drainage Proposal

1.1 Existing Situation

A. Site particulars

- 1.1.1 The application site occupies an area of about 706m².
- 1.1.2 The site is serviced by a vehicular access leading from Tai Shu Ha Road West. The area adjacent to the proposed development is mainly rural in nature.

B. Level and gradient of the subject site & proposed surface channel

- 1.1.3 It has a gradient sloping from southwest to northeast from about +22.0mPD to +21.8mPD. (**Figure 4**)

C. Catchment area of the proposed drainage provision at the subject site

- 1.1.4 The land to the north, west and east is found lower in level than the application site. The land to the south of the application site is found higher than the application site until it reaches a river which intercepts the stormwater from the higher land to the south. As such, an external catchment is identified in **Figure 5**.

D. Particulars of the existing drainage facilities to accept the surface runoff collected at the application site

- 1.1.5 As shown in **Figure 4**, a river is found to the northeast of the application site. The stormwater intercepted by the proposed surface channel at the application site will be dissipated to the said river.

1.2 Runoff Estimation

1.2.1 Rational method is adopted for estimating the designed run-off

$$Q = k \times i \times A / 3,600$$

Assuming that:

- i. The area of the catchment is approximately 3,500m²; (**Figure 4**)
- ii. Although the application site will be paved, the adjacent land within the external catchment are zoned for 'Agriculture' and all of them are unpaved. It is assumed that the value of run-off co-efficient (k) is taken as 0.9.

$$\text{Difference in Land Datum} = 23.6\text{m} - 21.8\text{m} = 1.8\text{m}$$

$$L = 93\text{m}$$

$$\therefore \text{Average fall} = 1.8\text{m in } 93\text{m} \text{ or } 1\text{m in } 51.67\text{m}$$

According to the Brandsby-Williams Equation adopted from the "Stormwater Drainage Manual – Planning, Design and Management" published by the Drainage Services Department (DSD),

$$\text{Time of Concentration (t}_c\text{)} = 0.14465 [L / (H^{0.2} \times A^{0.1})]$$

$$t_c = 0.14465 [93 / 1.94^{0.2} \times 3,500^{0.1}]$$

$$t_c = 5.21 \text{ minutes}$$

With reference to the Intensity-Duration-Frequency Curves provided in the abovementioned manual, the mean rainfall intensity (i) for 1 in 50 recurrent flooding period is found to be 275 mm/hr

By Rational Method,

$$Q_1 = 0.9 \times 275 \times 3,500 / 3,600$$

$$\therefore Q_1 = 240.63 \text{ l/s} = 14,437.5 \text{ l/min} = 0.24\text{m}^3/\text{s}$$

In accordance with the Chart or the Rapid Design of Channels in "Geotechnical Manual for Slopes", for an approximate gradient of about 1:100 in order to follow the gradient of the application site, 375mm surface U-channel along the site periphery is considered adequate to dissipate all the stormwater accrued by the application site and adjacent land.

1.3 Proposed Drainage Facilities

- 1.3.1 Subject to the calculations in 1.2 above, it is determined that proposed 375mm concrete surface U-channel along the site periphery is adequate to intercept storm water passing through and generated at the application site (**Figure 4**).
- 1.3.2 The collected stormwater will then be discharged directly to the river to the northeast of the application site as shown in **Figure 4**.
- 1.3.3 All the proposed drainage facilities will be provided and maintained at the applicant's own expense. Also, sand trap and surface U-channel will be cleaned at regular interval to avoid the accumulation of rubbish/debris which would affect the dissipation of storm water.
- 1.3.4 The provision of the proposed surface channel will follow the gradient of the application site. All the proposed drainage facilities will be constructed and maintained at the expense of the applicant.
- 1.3.5 Prior to the commencement of the drainage works, the applicant will seek consent from District Lands Office/Yuen Long and relevant land owners for the provision of drainage facilities outside the application site.
- 1.3.6 The proposed development would not affect the existing ditches, drains and obstruct the flow of the flow of surface runoff.
- 1.3.7 The provision of surface channel at site boundary is detailed hereunder:
- (a) Soil excavation at site periphery, is inevitably for the provision of surface channel. The accumulation of excavated soil at the site periphery would obstruct the free flow of the surface runoff from the surroundings. Hence, the soil will be cleared at the soonest possible after the completion of the excavation process.
 - (b) In view of that soil excavation may be continued for several working days, surface channel will be dug in short sections and all soil excavated will be cleared before the excavation of another short section.
 - (c) 100mm gap will be provided at the toe of site hoarding to allow unobstructed flow of surface runoff.

Annex 2 Estimated Traffic Generation

- 2.1 The application site is accessible via a vehicular track leading from Tai Shu Ha Road West. It is intended to serve the long term storage of mobile toilet at the site so that the traffic generated by the proposed development is insignificant.
- 2.2 The proposed parking space at the application site would only be opened to staff and no visitors is allowed to visit the proposed development.
- 2.3 There will be one loading/unloading bay for light goods vehicle not exceeding 5.5 tonnes. No medium/heavy goods vehicle and container trailer/tractor will access/park at the application site. The estimated traffic generation/attraction rate is shown below:

Type of Vehicle	<u>Average</u> Traffic Generation Rate (pcu/hr)	<u>Average</u> Traffic Attraction Rate (pcu/hr)	Traffic Generation Rate at <u>Peak Hours</u> (pcu/hr)	Traffic Attraction Rate at <u>Peak Hours</u> (pcu/hr)
Light goods vehicle	0.15	0.15	1.5	0

Note:

1. The operation hours of the proposed development is from 9:00a.m. to 7:00p.m. from Mondays to Saturdays. No operation will be carried out on Sundays and public holidays.
 2. The pcu of light goods vehicle is taken as 1.5; &
 3. Morning peak is defined as 7:00a.m. to 9:00a.m. whereas afternoon peak is defined as 5:00p.m. to 7:00p.m.
- 2.5 In association with the intended purpose, adequate space for manoeuvring would be provided within the application site. Sufficient space within the application site is provided so that no queueing up of vehicle would be occurred outside the application site.

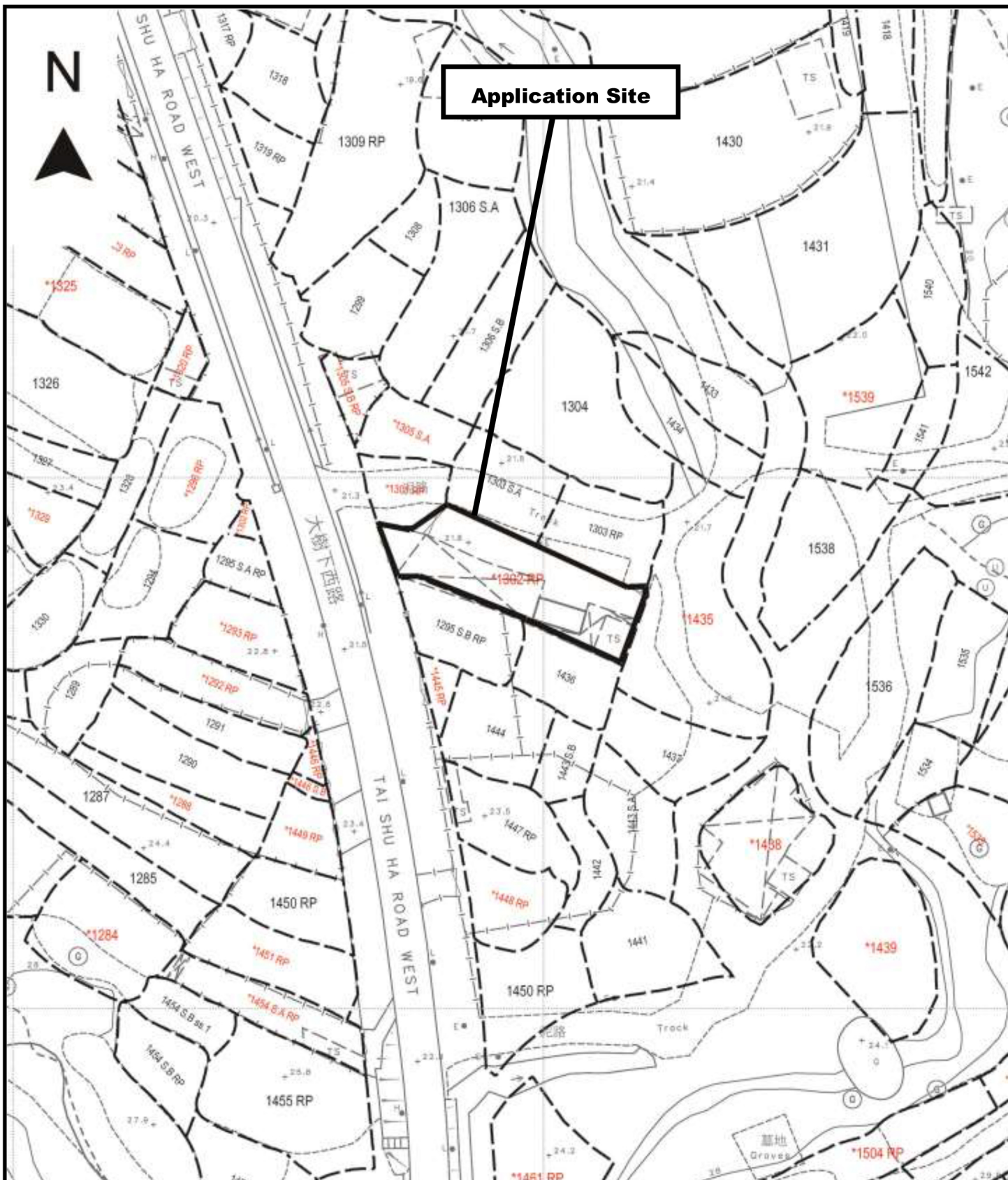

Project 項目名稱:

Proposed Temporary Open Storage and Warehouse for Storage of Construction Materials for a Period of 3 Years and Filling of Land at Lot 1302 RP (Part) in D.D. 118, Tai Shu Ha Road West, Yuen Long, New Territories

Drawing Title 圖目:

Site Plan

Drawing No. 圖號:

Figure 1

Remarks 備註:

Scale 比例:

1:1000

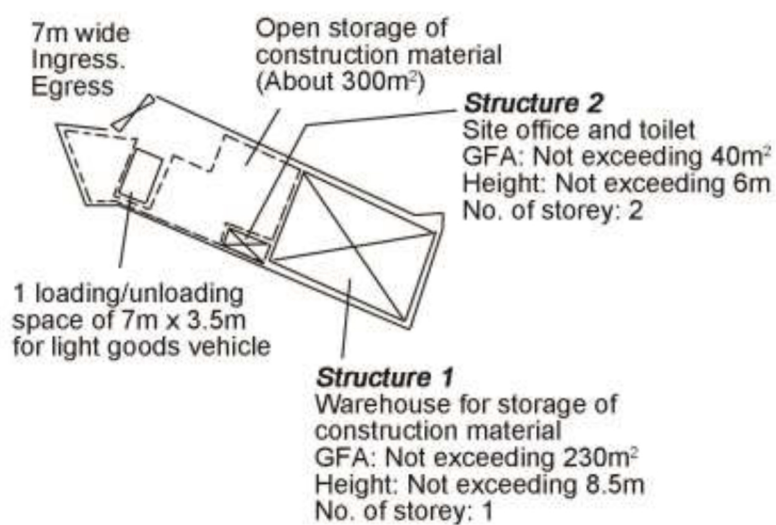

Project 項目名稱:

Proposed Temporary Open Storage and Warehouse for Storage of Construction Materials for a Period of 3 Years and Filling of Land at Lot 1302 RP (Part) in D.D. 118, Tai Shu Ha Road West, Yuen Long, New Territories

Drawing Title 圖目:

Proposed Layout Plan

Drawing No. 圖號:

Figure 2

Remarks 備註:

Scale 比例:

1:1000

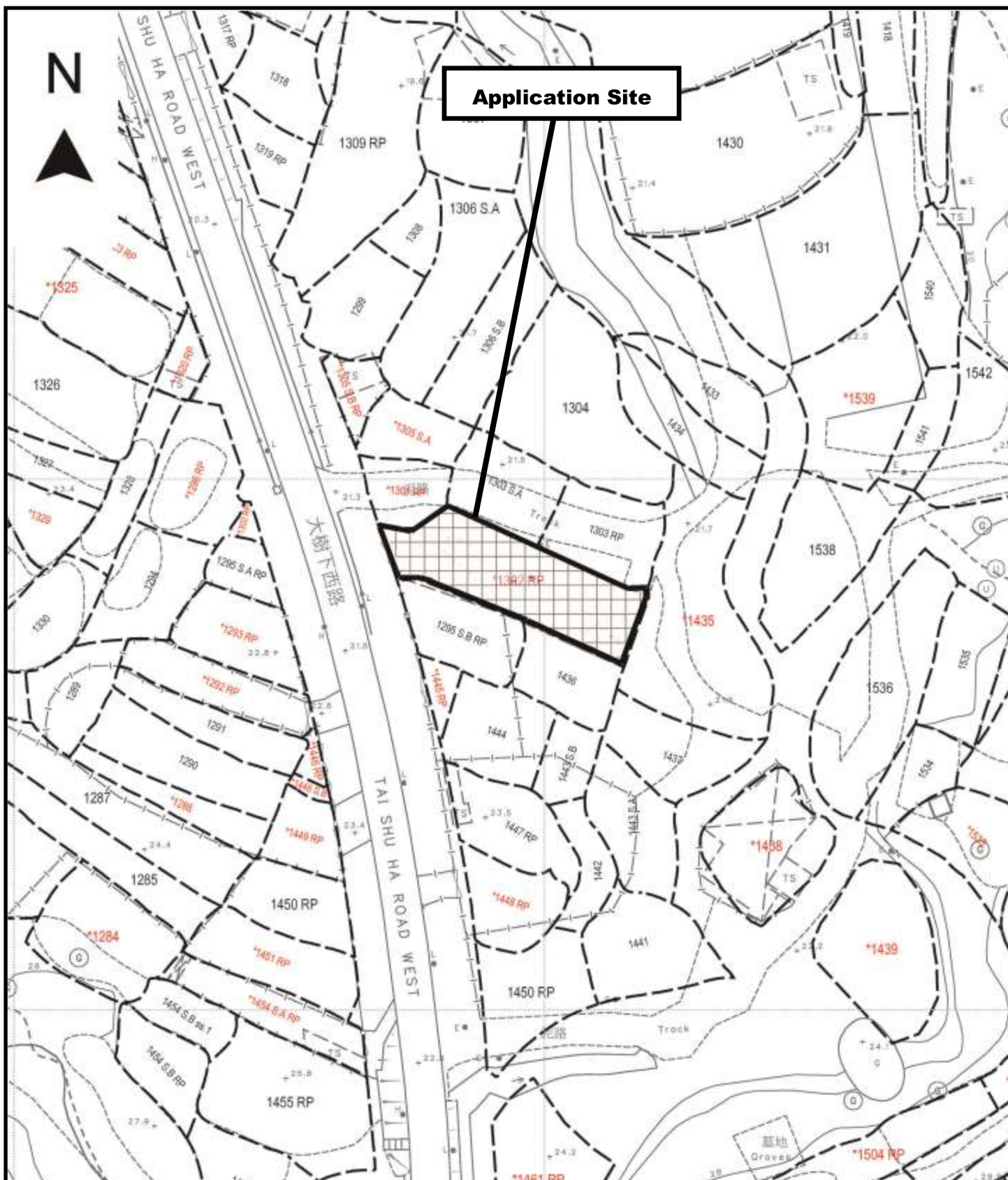

Project 項目名稱:

Proposed Temporary Open Storage and Warehouse for Storage of Construction Materials for a Period of 3 Years and Filling of Land at Lot 1302 RP (Part) in D.D. 118, Tai Shu Ha Road West, Yuen Long, New Territories

Drawing Title 圖目:

Proposed Land Filling Plan

Drawing No. 圖號:

Figure 3

Remarks 備註:



Proposed Filling of 200mm thick concrete

Scale 比例:

1:1000

