

This document is received on 2024-12-17  
The Town Planning Board will formally acknowledge  
the date of receipt of the application only upon receipt  
of all the required information and documents.

Form No. S16-I  
表格第 S16-I 號

**APPLICATION FOR PERMISSION  
UNDER SECTION 16 OF  
THE TOWN PLANNING ORDINANCE  
(CAP. 131)**

根據《城市規劃條例》(第131章)  
第16條遞交的許可申請

**Applicable to proposals not involving or not only involving:**  
適用於建議不涉及或不祇涉及:

- (i) **Construction of “New Territories Exempted House(s)”;**  
興建「新界豁免管制屋宇」;
- (ii) **Temporary use/development of land and/or building not exceeding 3 years in rural areas or Regulated Areas; and**  
位於鄉郊地區或受規管地區土地上及/或建築物內進行為期不超過三年的臨時用途/發展;及
- (iii) **Renewal of permission for temporary use or development in rural areas or Regulated Areas**  
位於鄉郊地區或受規管地區的臨時用途或發展的許可續期

Applicant who would like to publish the notice of application in local newspapers to meet one of the Town Planning Board's requirements of taking reasonable steps to obtain consent of or give notification to the current land owner, please refer to the following link regarding publishing the notice in the designated newspapers:  
[https://www.tpb.gov.hk/en/plan\\_application/apply.html](https://www.tpb.gov.hk/en/plan_application/apply.html)

申請人如欲在本地報章刊登申請通知,以採取城市規劃委員會就取得現行土地擁有人的同意或通知現行土地擁有人所指定的其中一項合理步驟,請瀏覽以下網址有關在指定的報章刊登通知:  
[https://www.tpb.gov.hk/tc/plan\\_application/apply.html](https://www.tpb.gov.hk/tc/plan_application/apply.html)

**General Note and Annotation for the Form**  
**填寫表格的一般指引及註解**

# “Current land owner” means any person whose name is registered in the Land Registry as that of an owner of the land to which the application relates, as at 6 weeks before the application is made  
「現行土地擁有人」指在提出申請前六星期,其姓名或名稱已在土地註冊處註冊為該申請所關乎的土地的擁有人的人

& Please attach documentary proof 請夾附證明文件

^ Please insert number where appropriate 請在適當地地方註明編號

Please fill “NA” for inapplicable item 請在不適用的項目填寫「不適用」

Please use separate sheets if the space provided is insufficient 如所提供的空間不足,請另頁說明

Please insert a 「✓」 at the appropriate box 請在適當的方格內上加上「✓」號

For Official Use Only 請勿填寫此欄	Application No. 申請編號	A1YL-TT / 687
	Date Received 收到日期	2024-12-17

- The completed form and supporting documents (if any) should be sent to the Secretary, Town Planning Board (the Board), 15/F, North Point Government Offices, 333 Java Road, North Point, Hong Kong.  
申請人須把填妥的申請表格及其他支持申請的文件 (倘有), 送交香港北角渣華道 333 號北角政府合署 15 樓城市規劃委員會(下稱「委員會」)秘書收。
- Please read the "Guidance Notes" carefully before you fill in this form. The document can be downloaded from the Board's website at <http://www.tpb.gov.hk/>. It can also be obtained from the Secretariat of the Board at 15/F, North Point Government Offices, 333 Java Road, North Point, Hong Kong (Tel: 2231 4810 or 2231 4835), and the Planning Enquiry Counters of the Planning Department (Hotline: 2231 5000) (17/F, North Point Government Offices, 333 Java Road, North Point, Hong Kong and 14/F, Sha Tin Government Offices, 1 Sheung Wo Che Road, Sha Tin, New Territories).  
請先細閱《申請須知》的資料單張, 然後填寫此表格。該份文件可從委員會的網頁下載 (網址: <http://www.tpb.gov.hk/>), 亦可向委員會秘書處 (香港北角渣華道 333 號北角政府合署 15 樓 - 電話: 2231 4810 或 2231 4835) 及規劃署的規劃資料查詢處 (熱線: 2231 5000) (香港北角渣華道 333 號北角政府合署 17 樓及新界沙田上禾輦路 1 號沙田政府合署 14 樓) 索取。
- This form can be downloaded from the Board's website, and obtained from the Secretariat of the Board and the Planning Enquiry Counters of the Planning Department. The form should be typed or completed in block letters. The processing of the application may be refused if the required information or the required copies are incomplete.  
此表格可從委員會的網頁下載, 亦可向委員會秘書處及規劃署的規劃資料查詢處索取。申請人須以打印方式或以正楷填寫表格。如果申請人所提交的資料或文件副本不齊全, 委員會可拒絕處理有關申請。

### 1. Name of Applicant 申請人姓名/名稱

(☐ Mr. 先生 / ☐ Mrs. 夫人 / ☐ Miss 小姐 / ☒ Ms. 女士 / ☐ Company 公司 / ☐ Organisation 機構)

Kwok WA MUI

### 2. Name of Authorised Agent (if applicable) 獲授權代理人姓名/名稱 (如適用)

(☐ Mr. 先生 / ☐ Mrs. 夫人 / ☐ Miss 小姐 / ☐ Ms. 女士 / ☐ Company 公司 / ☐ Organisation 機構)

### 3. Application Site 申請地點

(a) Full address / location / demarcation district and lot number (if applicable) 詳細地址/地點/丈量約份及地段號碼 (如適用)	新界元朗丈量約份 DD119 lot 1750, DD119 lot 1780 (部份), DD119 lot 1840 (部份), DD119 lot 1845
(b) Site area and/or gross floor area involved 涉及的地盤面積及/或總樓面面積	<input checked="" type="checkbox"/> Site area 地盤面積 1570 sq.m 平方米 <input checked="" type="checkbox"/> About 約 <input checked="" type="checkbox"/> Gross floor area 總樓面面積 810 sq.m 平方米 <input checked="" type="checkbox"/> About 約
(c) Area of Government land included (if any) 所包括的政府土地面積 (倘有)	N/A sq.m 平方米 <input type="checkbox"/> About 約

(d) Name and number of the related statutory plan(s) 有關法定圖則的名稱及編號	8/AL-T7/20
(e) Land use zone(s) involved 涉及的土地用途地帶	AGR
(f) Current use(s) 現時用途	STORAGE USE  (If there are any Government, institution or community facilities, please illustrate on plan and specify the use and gross floor area) (如有任何政府、機構或社區設施，請在圖則上顯示，並註明用途及總樓面面積)

#### 4. "Current Land Owner" of Application Site 申請地點的「現行土地擁有人」

The applicant 申請人 –

- ☐ is the sole "current land owner"<sup>#&</sup> (please proceed to Part 6 and attach documentary proof of ownership).  
是唯一的「現行土地擁有人」<sup>#&</sup> (請繼續填寫第 6 部分，並夾附業權證明文件)。
- ☐ is one of the "current land owners"<sup>#&</sup> (please attach documentary proof of ownership).  
是其中一名「現行土地擁有人」<sup>#&</sup> (請夾附業權證明文件)。
- ☒ is not a "current land owner"<sup>#</sup>.  
並不是「現行土地擁有人」<sup>#</sup>。

- ☐ The application site is entirely on Government land (please proceed to Part 6).  
申請地點完全位於政府土地上 (請繼續填寫第 6 部分)。

#### 5. Statement on Owner's Consent/Notification 就土地擁有人的同意/通知土地擁有人的陳述

- (a) According to the record(s) of the Land Registry as at ..... (DD/MM/YYYY), this application involves a total of ..... "current land owner(s)"<sup>#</sup>.  
根據土地註冊處截至 ..... 年 ..... 月 ..... 日的記錄，這宗申請共牽涉 ..... 名「現行土地擁有人」<sup>#</sup>。

(b) The applicant 申請人 –

- ☐ has obtained consent(s) of ..... "current land owner(s)"<sup>#</sup>.  
已取得 ..... 名「現行土地擁有人」<sup>#</sup>的同意。

Details of consent of "current land owner(s)" <sup>#</sup> obtained 取得「現行土地擁有人」 <sup>#</sup> 同意的詳情		
No. of 'Current Land Owner(s)' 「現行土地擁有人」數目	Lot number/address of premises as shown in the record of the Land Registry where consent(s) has/have been obtained 根據土地註冊處記錄已獲得同意的地段號碼/處所地址	Date of consent obtained (DD/MM/YYYY) 取得同意的日期 (日/月/年)

(Please use separate sheets if the space of any box above is insufficient. 如上列任何方格的空間不足，請另頁說明)

- ☐ has notified ..... "current land owner(s)"#  
已通知 ..... 名「現行土地擁有人」#。

Details of the "current land owner(s)"# notified 已獲通知「現行土地擁有人」#的詳細資料		
No. of 'Current Land Owner(s)' 「現行土地擁有人」數目	Lot number/address of premises as shown in the record of the Land Registry where notification(s) has/have been given 根據土地註冊處記錄已發出通知的地段號碼／處所地址	Date of notification given (DD/MM/YYYY) 通知日期(日/月/年)

(Please use separate sheets if the space of any box above is insufficient. 如上列任何方格的空間不足，請另頁說明)

- ☒ has taken reasonable steps to obtain consent of or give notification to owner(s):  
已採取合理步驟以取得土地擁有人的同意或向該人發給通知。詳情如下：

Reasonable Steps to Obtain Consent of Owner(s) 取得土地擁有人的同意所採取的合理步驟

- ☐ sent request for consent to the "current land owner(s)" on \_\_\_\_\_ (DD/MM/YYYY)#&  
於\_\_\_\_\_ (日/月/年)向每一名「現行土地擁有人」#郵遞要求同意書&

Reasonable Steps to Give Notification to Owner(s) 向土地擁有人發出通知所採取的合理步驟

- ☐ published notices in local newspapers on \_\_\_\_\_ (DD/MM/YYYY)&  
於\_\_\_\_\_ (日/月/年)在指定報章就申請刊登一次通知&

- ☒ posted notice in a prominent position on or near application site/premises on \_\_\_\_\_ (DD/MM/YYYY)&  
於 30-10-2024 (日/月/年)在申請地點／申請處所或附近的顯明位置貼出關於該申請的通知&

- ☒ sent notice to relevant owners' corporation(s)/owners' committee(s)/mutual aid committee(s)/management office(s) or rural committee on \_\_\_\_\_ (DD/MM/YYYY)&  
於 15-11-2024 (日/月/年)把通知寄往相關的業主立案法團/業主委員會/互助委員會或管理處，或有關的鄉事委員會&

Others 其他

- ☐ others (please specify)  
其他（請指明）

---



---



---



---

Note: May insert more than one 「✓」.

Information should be provided on the basis of each and every lot (if applicable) and premises (if any) in respect of the application.

註：可在多於一個方格內加上「✓」號

申請人須就申請涉及的每一地段（倘適用）及處所（倘有）分別提供資料

**6. Type(s) of Application 申請類別**

- ☐ Type (i) Change of use within existing building or part thereof  
第(i)類 更改現有建築物或其部分內的用途
- ☒ Type (ii) Diversion of stream / excavation of land / filling of land / filling of pond as required under Notes of Statutory Plan(s)  
第(ii)類 根據法定圖則《註釋》內所要求的河道改道／挖土／填土／填塘工程
- ☐ Type (iii) Public utility installation / Utility installation for private project  
第(iii)類 公用事業設施裝置/私人發展計劃的公用設施裝置
- ☐ Type (iv) Minor relaxation of stated development restriction(s) as provided under Notes of Statutory Plan(s)  
第(iv)類 略為放寬於法定圖則《註釋》內列明的發展限制
- ☒ Type (v) Use / development other than (i) to (iii) above  
第(v)類 上述的(i)至(iii)項以外的用途／發展

Note 1: May insert more than one 「✓」.

註 1: 可在多於一個方格內加上「✓」號

Note 2: For Development involving columbarium use, please complete the table in the Appendix.

註 2: 如發展涉及靈灰安置所用途，請填妥於附件的表格。

**(i) For Type (i) application 供第(i)類申請**

(a) Total floor area involved 涉及的總樓面面積	sq.m 平方米		
(b) Proposed use(s)/development 擬議用途/發展	(If there are any Government, institution or community facilities, please illustrate on plan and specify the use and gross floor area) (如有任何政府、機構或社區設施，請在圖則上顯示，並註明用途及總樓面面積)		
(c) Number of storeys involved 涉及層數		Number of units involved 涉及單位數目	
(d) Proposed floor area 擬議樓面面積	Domestic part 住用部分 .....		sq.m 平方米 <input type="checkbox"/> About 約
	Non-domestic part 非住用部分 .....		sq.m 平方米 <input type="checkbox"/> About 約
	Total 總計 .....		sq.m 平方米 <input type="checkbox"/> About 約
(e) Proposed uses of different floors (if applicable) 不同樓層的擬議用途(如適用) (Please use separate sheets if the space provided is insufficient) (如所提供的空間不足，請另頁說明)	Floor(s) 樓層	Current use(s) 現時用途	Proposed use(s) 擬議用途

**(ii) For Type (ii) application 供第(ii)類申請**

(a) Operation involved 涉及工程	<input type="checkbox"/> Diversion of stream 河道改道		
	<input type="checkbox"/> Filling of pond 填塘		
	Area of filling 填塘面積 .....	sq.m 平方米	<input type="checkbox"/> About 約
	Depth of filling 填塘深度 .....	m 米	<input type="checkbox"/> About 約
	<input checked="" type="checkbox"/> Filling of land 填土		
Area of filling 填土面積 .....	1570 sq.m 平方米	<input checked="" type="checkbox"/> About 約	
Depth of filling 填土厚度 .....	0.15 m 米	<input checked="" type="checkbox"/> About 約	
<input type="checkbox"/> Excavation of land 挖土			
Area of excavation 挖土面積 .....	sq.m 平方米	<input type="checkbox"/> About 約	
Depth of excavation 挖土深度 .....	m 米	<input type="checkbox"/> About 約	

(Please indicate on site plan the boundary of concerned land/pond(s), and particulars of stream diversion, the extent of filling of land/pond(s) and/or excavation of land)  
(請用圖則顯示有關土地/池塘界線, 以及河道改道、填塘、填土及/或挖土的細節及/或範圍))

(b) Intended use/development  
有意進行的用途/發展

擬議臨時動物寄養所連附屬設施  
(為期五年)及相關填土工程

**(iii) For Type (iii) application 供第(iii)類申請**

(a) Nature and scale 性質及規模	<input type="checkbox"/> Public utility installation 公用事業設施裝置												
	<input type="checkbox"/> Utility installation for private project 私人發展計劃的公用設施裝置												
	Please specify the type and number of utility to be provided as well as the dimensions of each building/structure, where appropriate 請註明有關裝置的性質及數量, 包括每座建築物/構築物(倘有)的長度、高度和闊度												
	<table border="1"> <thead> <tr> <th>Name/type of installation 裝置名稱/種類</th> <th>Number of provision 數量</th> <th>Dimension of each installation /building/structure (m) (LxWxH) 每個裝置/建築物/構築物的尺寸 (米) (長 x 闊 x 高)</th> </tr> </thead> <tbody> <tr><td> </td><td> </td><td> </td></tr> <tr><td> </td><td> </td><td> </td></tr> <tr><td> </td><td> </td><td> </td></tr> </tbody> </table>	Name/type of installation 裝置名稱/種類	Number of provision 數量	Dimension of each installation /building/structure (m) (LxWxH) 每個裝置/建築物/構築物的尺寸 (米) (長 x 闊 x 高)									
	Name/type of installation 裝置名稱/種類	Number of provision 數量	Dimension of each installation /building/structure (m) (LxWxH) 每個裝置/建築物/構築物的尺寸 (米) (長 x 闊 x 高)										
(Please illustrate on plan the layout of the installation 請用圖則顯示裝置的布局)													

**(iv) For Type (iv) application 供第(iv)類申請**

- (a) Please specify the proposed minor relaxation of stated development restriction(s) and also fill in the proposed use/development and development particulars in part (v) below –  
請列明擬議略為放寬的發展限制並填妥於第(v)部分的擬議用途/發展及發展細節 –

- ☐ Plot ratio restriction 地積比率限制 From 由 ..... to 至 .....
- ☐ Gross floor area restriction 總樓面面積限制 From 由 .....sq. m 平方米 to 至 .....sq. m 平方米
- ☐ Site coverage restriction 上蓋面積限制 From 由 .....% to 至 .....%
- ☐ Building height restriction 建築物高度限制  
From 由 .....m 米 to 至 ..... m 米  
From 由 ..... mPD 米 (主水平基準上) to 至 .....mPD 米 (主水平基準上)  
From 由 ..... storeys 層 to 至 ..... storeys 層
- ☐ Non-building area restriction 非建築用地限制 From 由 .....m to 至 ..... m
- ☐ Others (please specify) 其他 (請註明) .....

**(v) For Type (v) application 供第(v)類申請**

(a) Proposed use(s)/development  
擬議用途/發展

擬議臨時動物寄養所連附屬設施  
(為期五年)及相關填土工程

(Please illustrate the details of the proposal on a layout plan 請用平面圖說明建議詳情)

**(b) Development Schedule 發展細節表**

Proposed gross floor area (GFA) 擬議總樓面面積

810 ..... sq.m. 平方米 ☒ About 約

Proposed plot ratio 擬議地積比率

0.52 ..... ☒ About 約

Proposed site coverage 擬議上蓋面積

52 ..... % ☒ About 約

Proposed no. of blocks 擬議座數

5 .....

Proposed no. of storeys of each block 每座建築物的擬議層數

1 ..... storeys 層

☐ include 包括 ..... storeys of basements 層地庫

☐ exclude 不包括 ..... storeys of basements 層地庫

Proposed building height of each block 每座建築物的擬議高度

5 ..... mPD 米(主水平基準上) ☐ About 約

5 ..... m 米 ☒ About 約

☐ Domestic part 住用部分GFA 總樓面面積 ..... sq. m 平方米 ☐ About 約

number of Units 單位數目 .....

average unit size 單位平均面積 .....sq. m 平方米 ☐ About 約

estimated number of residents 估計住客數目 .....

☒ Non-domestic part 非住用部分

GFA 總樓面面積

☐ eating place 食肆 ..... sq. m 平方米 ☐ About 約☐ hotel 酒店 ..... sq. m 平方米 ☐ About 約

(please specify the number of rooms

請註明房間數目) .....

☒ office 辦公室 ..... 80 sq. m 平方米 ☒ About 約☐ shop and services 商店及服務行業 ..... sq. m 平方米 ☐ About 約☐ Government, institution or community facilities (please specify the use(s) and concerned land area(s)/GFA(s) 請註明用途及有關的地面面積/總樓面面積)

政府、機構或社區設施

☒ other(s) 其他

(please specify the use(s) and concerned land area(s)/GFA(s) 請註明用途及有關的地面面積/總樓面面積)

儲物室約 230 m<sup>2</sup>  
動物寄養設施約 500 m<sup>2</sup>☐ Open space 休憩用地

(please specify land area(s) 請註明地面面積)

☐ private open space 私人休憩用地 ..... sq. m 平方米 ☐ Not less than 不少於☐ public open space 公眾休憩用地 ..... sq. m 平方米 ☐ Not less than 不少於

## (c) Use(s) of different floors (if applicable) 各樓層的用途 (如適用)

[Block number] [座數]	[Floor(s)] [層數]	[Proposed use(s)] [擬議用途]
樓宇 ①	1	辦公室 約 80 m <sup>2</sup>
樓宇 ②	1	儲物室 約 230 m <sup>2</sup>
樓宇 ③	1	動物寄養所 約 200 m <sup>2</sup>
樓宇 ④	1	動物寄養所 約 200 m <sup>2</sup>
樓宇 ⑤	1	動物寄養所 約 100 m <sup>2</sup>

## (d) Proposed use(s) of uncovered area (if any) 露天地方 (倘有) 的擬議用途

通道及動物活動範圍

**7. Anticipated Completion Time of the Development Proposal****擬議發展計劃的預計完成時間**

Anticipated completion time (in month and year) of the development proposal (by phase (if any)) (e.g. June 2023)

擬議發展計劃預期完成的年份及月份 (分期 (倘有)) (例: 2023 年 6 月)

(Separate anticipated completion times (in month and year) should be provided for the proposed public open space and Government, institution or community facilities (if any))

(申請人須就擬議的公眾休憩用地及政府、機構或社區設施 (倘有) 提供個別擬議完成的年份及月份)

June 2025

.....

.....

.....

.....

.....

**8. Vehicular Access Arrangement of the Development Proposal****擬議發展計劃的行車通道安排**

Any vehicular access to the site/subject building? 是否有車路通往地盤/有關建築物?	Yes 是          No 否	<input checked="" type="checkbox"/> There is an existing access. (please indicate the street name, where appropriate) 有一條現有車路。(請註明車路名稱(如適用)) 由僑興路轉入小路到達 <input type="checkbox"/> There is a proposed access. (please illustrate on plan and specify the width) 有一條擬議車路。(請在圖則顯示, 並註明車路的闊度) <input type="checkbox"/>
Any provision of parking space for the proposed use(s)? 是否有為擬議用途提供停車位?	Yes 是          No 否	<input checked="" type="checkbox"/> (Please specify type(s) and number(s) and illustrate on plan) 請註明種類及數目並於圖則上顯示) Private Car Parking Spaces 私家車車位 <u>4</u> Motorcycle Parking Spaces 電單車車位 _____ Light Goods Vehicle Parking Spaces 輕型貨車泊車位 _____ Medium Goods Vehicle Parking Spaces 中型貨車泊車位 _____ Heavy Goods Vehicle Parking Spaces 重型貨車泊車位 _____ Others (Please Specify) 其他 (請列明) _____ _____ _____
Any provision of loading/unloading space for the proposed use(s)? 是否有為擬議用途提供上落客貨車位?	Yes 是          No 否	<input type="checkbox"/> (Please specify type(s) and number(s) and illustrate on plan) 請註明種類及數目並於圖則上顯示) Taxi Spaces 的士車位 _____ Coach Spaces 旅遊巴車位 _____ Light Goods Vehicle Spaces 輕型貨車車位 _____ Medium Goods Vehicle Spaces 中型貨車車位 _____ Heavy Goods Vehicle Spaces 重型貨車車位 _____ Others (Please Specify) 其他 (請列明) _____ _____ _____ <input checked="" type="checkbox"/>

## 9. Impacts of Development Proposal 擬議發展計劃的影響

If necessary, please use separate sheets to indicate the proposed measures to minimise possible adverse impacts or give justifications/reasons for not providing such measures.

如需要的話，請另頁註明可盡量減少可能出現不良影響的措施，否則請提供理據/理由。

<p>Does the development proposal involve alteration of existing building? 擬議發展計劃是否包括現有建築物的改動?</p>	<p>Yes 是  No 否</p>	<p><input type="checkbox"/> Please provide details 請提供詳情</p> <p>.....</p> <p>.....</p> <p>.....</p> <p>.....</p> <p><input checked="" type="checkbox"/> No 否</p>																																				
<p>Does the development proposal involve the operation on the right? 擬議發展是否涉及右列的工程? (Note: where Type (ii) application is the subject of application, please skip this section. 註：如申請涉及第(ii)類申請，請跳至下一條問題。)</p>	<p>Yes 是  No 否</p>	<p><input type="checkbox"/> (Please indicate on site plan the boundary of concerned land/pond(s), and particulars of stream diversion, the extent of filling of land/pond(s) and/or excavation of land) (請用地盤平面圖顯示有關土地/池塘界線，以及河道改道、填塘、填土及/或挖土的細節及/或範圍)</p> <p><input type="checkbox"/> Diversion of stream 河道改道</p> <p><input type="checkbox"/> Filling of pond 填塘 Area of filling 填塘面積 ..... sq.m 平方米 <input type="checkbox"/> About 約 Depth of filling 填塘深度 ..... m 米 <input type="checkbox"/> About 約</p> <p><input type="checkbox"/> Filling of land 填土 Area of filling 填土面積 ..... sq.m 平方米 <input type="checkbox"/> About 約 Depth of filling 填土厚度 ..... m 米 <input type="checkbox"/> About 約</p> <p><input type="checkbox"/> Excavation of land 挖土 Area of excavation 挖土面積 ..... sq.m 平方米 <input type="checkbox"/> About 約 Depth of excavation 挖土深度 ..... m 米 <input type="checkbox"/> About 約</p> <p><input type="checkbox"/> No 否</p>																																				
<p>Would the development proposal cause any adverse impacts? 擬議發展計劃會否造成不良影響?</p>	<p>On environment 對環境 On traffic 對交通 On water supply 對供水 On drainage 對排水 On slopes 對斜坡 Affected by slopes 受斜坡影響 Landscape Impact 構成景觀影響 Tree Felling 砍伐樹木 Visual Impact 構成視覺影響 Others (Please Specify) 其他 (請列明)</p> <p>.....</p> <p>.....</p>	<table border="0"> <tr> <td>Yes 會</td> <td><input type="checkbox"/></td> <td>No 不會</td> <td><input checked="" type="checkbox"/></td> </tr> <tr> <td>Yes 會</td> <td><input type="checkbox"/></td> <td>No 不會</td> <td><input checked="" type="checkbox"/></td> </tr> <tr> <td>Yes 會</td> <td><input type="checkbox"/></td> <td>No 不會</td> <td><input checked="" type="checkbox"/></td> </tr> <tr> <td>Yes 會</td> <td><input type="checkbox"/></td> <td>No 不會</td> <td><input checked="" type="checkbox"/></td> </tr> <tr> <td>Yes 會</td> <td><input type="checkbox"/></td> <td>No 不會</td> <td><input checked="" type="checkbox"/></td> </tr> <tr> <td>Yes 會</td> <td><input type="checkbox"/></td> <td>No 不會</td> <td><input checked="" type="checkbox"/></td> </tr> <tr> <td>Yes 會</td> <td><input type="checkbox"/></td> <td>No 不會</td> <td><input checked="" type="checkbox"/></td> </tr> <tr> <td>Yes 會</td> <td><input type="checkbox"/></td> <td>No 不會</td> <td><input checked="" type="checkbox"/></td> </tr> <tr> <td>Yes 會</td> <td><input type="checkbox"/></td> <td>No 不會</td> <td><input checked="" type="checkbox"/></td> </tr> </table>	Yes 會	<input type="checkbox"/>	No 不會	<input checked="" type="checkbox"/>	Yes 會	<input type="checkbox"/>	No 不會	<input checked="" type="checkbox"/>	Yes 會	<input type="checkbox"/>	No 不會	<input checked="" type="checkbox"/>	Yes 會	<input type="checkbox"/>	No 不會	<input checked="" type="checkbox"/>	Yes 會	<input type="checkbox"/>	No 不會	<input checked="" type="checkbox"/>	Yes 會	<input type="checkbox"/>	No 不會	<input checked="" type="checkbox"/>	Yes 會	<input type="checkbox"/>	No 不會	<input checked="" type="checkbox"/>	Yes 會	<input type="checkbox"/>	No 不會	<input checked="" type="checkbox"/>	Yes 會	<input type="checkbox"/>	No 不會	<input checked="" type="checkbox"/>
Yes 會	<input type="checkbox"/>	No 不會	<input checked="" type="checkbox"/>																																			
Yes 會	<input type="checkbox"/>	No 不會	<input checked="" type="checkbox"/>																																			
Yes 會	<input type="checkbox"/>	No 不會	<input checked="" type="checkbox"/>																																			
Yes 會	<input type="checkbox"/>	No 不會	<input checked="" type="checkbox"/>																																			
Yes 會	<input type="checkbox"/>	No 不會	<input checked="" type="checkbox"/>																																			
Yes 會	<input type="checkbox"/>	No 不會	<input checked="" type="checkbox"/>																																			
Yes 會	<input type="checkbox"/>	No 不會	<input checked="" type="checkbox"/>																																			
Yes 會	<input type="checkbox"/>	No 不會	<input checked="" type="checkbox"/>																																			
Yes 會	<input type="checkbox"/>	No 不會	<input checked="" type="checkbox"/>																																			
	<p>Please state measure(s) to minimise the impact(s). For tree felling, please state the number, diameter at breast height and species of the affected trees (if possible) 請註明盡量減少影響的措施。如涉及砍伐樹木，請說明受影響樹木的數目、及胸高度的樹幹直徑及品種(倘可)</p> <p>不屬砍伐樹木</p> <p>.....</p> <p>.....</p> <p>.....</p> <p>.....</p> <p>.....</p>																																					

## 10. Justifications 理由

The applicant is invited to provide justifications in support of the application. Use separate sheets if necessary.  
現請申請人提供申請理由及支持其申請的資料。如有需要，請另頁說明。

①申請地點面積約1570m<sup>2</sup>，根據大棠分區計劃大綱核准圖編號：S1YL-TT/20被劃分為「農業」地帶，發展屬臨時性質，不會影響申請地點長遠規劃意向。

②申請目的用於流浪動物寄養服務，收容被遺棄動物，並作動物中途宿舍向大眾推廣愛護動物，傳播領養不棄養信息，並為毛孩尋找合適家庭領養。

③申請地點佈局、形式及用途均與周圍環境協調。

④於2012至2014年間動物寄養所於農業地帶都獲城規層批出許可，申請地點附近同類型個案A1YL-TT551, 570, 573, 582, 584, 616, 621也得到城規層批准，本人懇請城規層批准這宗申請。

**11. Declaration 聲明**

I hereby declare that the particulars given in this application are correct and true to the best of my knowledge and belief.  
本人謹此聲明，本人就這宗申請提交的資料，據本人所知及所信，均屬真實無誤。

I hereby grant a permission to the Board to copy all the materials submitted in this application and/or to upload such materials to the Board's website for browsing and downloading by the public free-of-charge at the Board's discretion. 本人現准許委員會酌情將本人就此申請所提交的所有資料複製及/或上載至委員會網站，供公眾免費瀏覽或下載。

Signature  
簽署

☒ Applicant 申請人 / ☐ Authorised Agent 獲授權代理人

  
.....  
Kwok Wa Mui

Name in Block Letters  
姓名（請以正楷填寫）

Position (if applicable)  
職位（如適用）

Professional Qualification(s) ☐ Member 會員 / ☐ Fellow of 資深會員

專業資格

- ☐ HKIP 香港規劃師學會 / ☐ HKIA 香港建築師學會 /  
☐ HKIS 香港測量師學會 / ☐ HKIE 香港工程師學會 /  
☐ HKILA 香港園境師學會 / ☐ HKIUD 香港城市設計學會  
☐ RPP 註冊專業規劃師  
Others 其他 .....

on behalf of  
代表

☐ Company 公司 / ☐ Organisation Name and Chop (if applicable) 機構名稱及蓋章（如適用）

Date 日期

18 - 11 - 2014 (DD/MM/YYYY 日/月/年)

**Remark 備註**

The materials submitted in this application and the Board's decision on the application would be disclosed to the public. Such materials would also be uploaded to the Board's website for browsing and free downloading by the public where the Board considers appropriate.

委員會會向公眾披露申請人所遞交的申請資料和委員會對申請所作的決定。在委員會認為合適的情況下，有關申請資料亦會上載至委員會網頁供公眾免費瀏覽及下載。

**Warning 警告**

Any person who knowingly or wilfully makes any statement or furnish any information in connection with this application, which is false in any material particular, shall be liable to an offence under the Crimes Ordinance.

任何人在明知或故意的情況下，就這宗申請提出在任何要項上是虛假的陳述或資料，即屬違反《刑事罪行條例》。

**Statement on Personal Data 個人資料的聲明**

1. The personal data submitted to the Board in this application will be used by the Secretary of the Board and Government departments for the following purposes:

委員會就這宗申請所收到的個人資料會交給委員會秘書及政府部門，以根據《城市規劃條例》及相關的城市規劃委員會規劃指引的規定作以下用途：

- (a) the processing of this application which includes making available the name of the applicant for public inspection when making available this application for public inspection; and  
處理這宗申請，包括公布這宗申請供公眾查閱，同時公布申請人的姓名供公眾查閱；以及  
(b) facilitating communication between the applicant and the Secretary of the Board/Government departments.  
方便申請人與委員會秘書及政府部門之間進行聯絡。

2. The personal data provided by the applicant in this application may also be disclosed to other persons for the purposes mentioned in paragraph 1 above.

申請人就這宗申請提供的個人資料，或亦會向其他人士披露，以作上述第 1 段提及的用途。

3. An applicant has a right of access and correction with respect to his/her personal data as provided under the Personal Data (Privacy) Ordinance (Cap. 486). Request for personal data access and correction should be addressed to the Secretary of the Board at 15/F, North Point Government Offices, 333 Java Road, North Point, Hong Kong.

根據《個人資料(私隱)條例》(第 486 章)的規定，申請人有權查閱及更正其個人資料。如欲查閱及更正個人資料，應向委員會秘書提出有關要求，其地址為香港北角渣華道 333 號北角政府合署 15 樓。

**For Developments involving Columbarium Use, please also complete the following:**  
**如發展涉及靈灰安置所用途，請另外填妥以下資料：**

Ash interment capacity 骨灰安放容量<sup>@</sup>

Maximum number of sets of ashes that may be interred in the niches

在龕位內最多可安放骨灰的數量

Maximum number of sets of ashes that may be interred other than in niches

在非龕位的範圍內最多可安放骨灰的數量

Total number of niches 龕位總數

Total number of single niches

單人龕位總數

Number of single niches (sold and occupied)

單人龕位數目 (已售並佔用)

Number of single niches (sold but unoccupied)

單人龕位數目 (已售但未佔用)

Number of single niches (residual for sale)

單人龕位數目 (待售)

Total number of double niches

雙人龕位總數

Number of double niches (sold and fully occupied)

雙人龕位數目 (已售並全部佔用)

Number of double niches (sold and partially occupied)

雙人龕位數目 (已售並部分佔用)

Number of double niches (sold but unoccupied)

雙人龕位數目 (已售但未佔用)

Number of double niches (residual for sale)

雙人龕位數目 (待售)

Total no. of niches other than single or double niches (please specify type)

除單人及雙人龕位外的其他龕位總數 (請列明類別)

Number of niches (sold and fully occupied)

龕位數目 (已售並全部佔用)

Number of niches (sold and partially occupied)

龕位數目 (已售並部分佔用)

Number of niches (sold but unoccupied)

龕位數目 (已售但未佔用)

Number of niches (residual for sale)

龕位數目 (待售)

Proposed operating hours 擬議營運時間

<sup>@</sup> Ash interment capacity in relation to a columbarium means –

就靈灰安置所而言，骨灰安放容量指：

- the maximum number of containers of ashes that may be interred in each niche in the columbarium;  
每個龕位內可安放的骨灰容器的最高數目；
- the maximum number of sets of ashes that may be interred other than in niches in any area in the columbarium; and  
在該靈灰安置所並非龕位的範圍內，總共最多可安放多少份骨灰；以及
- the total number of sets of ashes that may be interred in the columbarium.  
在該骨灰安置所內，總共最多可安放多少份骨灰。

## Gist of Application 申請摘要

(Please provide details in both English and Chinese as far as possible. This part will be circulated to relevant consultees, uploaded to the Town Planning Board's Website for browsing and free downloading by the public and available at the Planning Enquiry Counters of the Planning Department for general information.)

(請盡量以英文及中文填寫。此部分將會發送予相關諮詢人士、上載至城市規劃委員會網頁供公眾免費瀏覽及下載及於規劃署規劃資料查詢處供一般參閱。)

Application No. 申請編號	(For Official Use Only) (請勿填寫此欄)		
Location/address 位置/地址	新界元朗丈量約份 DD119 lot 1750, DD119 lot 1780 (部份), DD119 lot 1840 (部份), DD119 lot 1845		
Site area 地盤面積	1570	sq. m 平方米	<input checked="" type="checkbox"/> About 約
	(includes Government land of 包括政府土地	sq. m 平方米	<input type="checkbox"/> About 約)
Plan 圖則	S/KL-TT/20		
Zoning 地帶	AGR		
Applied use/ development 申請用途/發展	擬議臨時動物寄養所連附屬設施 (為期五年)及相關填土工程		
(i) Gross floor area and/or plot ratio 總樓面面積及/或 地積比率		sq.m 平方米	Plot Ratio 地積比率
	Domestic 住用	<input type="checkbox"/> About 約 <input type="checkbox"/> Not more than 不多於	<input type="checkbox"/> About 約 <input type="checkbox"/> Not more than 不多於
	Non-domestic 非住用	810 <input checked="" type="checkbox"/> About 約 <input type="checkbox"/> Not more than 不多於	0.52 <input checked="" type="checkbox"/> About 約 <input type="checkbox"/> Not more than 不多於
(ii) No. of blocks 幢數	Domestic 住用		
	Non-domestic 非住用	5	
	Composite 綜合用途		

(iii) Building height/No. of storeys 建築物高度／層數	Domestic 住用	m 米 <input type="checkbox"/> (Not more than 不多於)	
		mPD 米(主水平基準上) <input type="checkbox"/> (Not more than 不多於)	
		Storeys(s) 層 <input type="checkbox"/> (Not more than 不多於) ( <input type="checkbox"/> Include 包括 <input type="checkbox"/> Exclude 不包括 <input type="checkbox"/> Carport 停車間 <input type="checkbox"/> Basement 地庫 <input type="checkbox"/> Refuge Floor 防火層 <input type="checkbox"/> Podium 平台)	
	Non-domestic 非住用	5	m 米 <input checked="" type="checkbox"/> (Not more than 不多於)
			mPD 米(主水平基準上) <input type="checkbox"/> (Not more than 不多於)
		1	Storeys(s) 層 <input checked="" type="checkbox"/> (Not more than 不多於) ( <input type="checkbox"/> Include 包括 <input type="checkbox"/> Exclude 不包括 <input type="checkbox"/> Carport 停車間 <input type="checkbox"/> Basement 地庫 <input type="checkbox"/> Refuge Floor 防火層 <input type="checkbox"/> Podium 平台)
	Composite 綜合用途		m 米 <input type="checkbox"/> (Not more than 不多於)
			mPD 米(主水平基準上) <input type="checkbox"/> (Not more than 不多於)
			Storeys(s) 層 <input type="checkbox"/> (Not more than 不多於) ( <input type="checkbox"/> Include 包括 <input type="checkbox"/> Exclude 不包括 <input type="checkbox"/> Carport 停車間 <input type="checkbox"/> Basement 地庫 <input type="checkbox"/> Refuge Floor 防火層 <input type="checkbox"/> Podium 平台)
(iv) Site coverage 上蓋面積	52 % <input checked="" type="checkbox"/> About 約		
(v) No. of units 單位數目			
(vi) Open space 休憩用地	Private 私人	sq.m 平方米 <input type="checkbox"/> Not less than 不少於	
	Public 公眾	sq.m 平方米 <input type="checkbox"/> Not less than 不少於	

(vii) No. of parking spaces and loading / unloading spaces 停車位及上落客貨車位數目	Total no. of vehicle parking spaces 停車位總數 Private Car Parking Spaces 私家車車位 Motorcycle Parking Spaces 電單車車位 Light Goods Vehicle Parking Spaces 輕型貨車泊車位 Medium Goods Vehicle Parking Spaces 中型貨車泊車位 Heavy Goods Vehicle Parking Spaces 重型貨車泊車位 Others (Please Specify) 其他 (請列明) <hr/>	4 4
	Total no. of vehicle loading/unloading bays/lay-bys 上落客貨車位／停車處總數 Taxi Spaces 的士車位 Coach Spaces 旅遊巴車位 Light Goods Vehicle Spaces 輕型貨車車位 Medium Goods Vehicle Spaces 中型貨車車位 Heavy Goods Vehicle Spaces 重型貨車車位 Others (Please Specify) 其他 (請列明) <hr/>	

Submitted Plans, Drawings and Documents 提交的圖則、繪圖及文件		
	Chinese 中文	English 英文
<b>Plans and Drawings 圖則及繪圖</b>		
Master layout plan(s)/Layout plan(s) 總綱發展藍圖／布局設計圖	<input checked="" type="checkbox"/>	<input type="checkbox"/>
Block plan(s) 樓宇位置圖	<input type="checkbox"/>	<input type="checkbox"/>
Floor plan(s) 樓宇平面圖	<input type="checkbox"/>	<input type="checkbox"/>
Sectional plan(s) 截視圖	<input type="checkbox"/>	<input type="checkbox"/>
Elevation(s) 立視圖	<input type="checkbox"/>	<input type="checkbox"/>
Photomontage(s) showing the proposed development 顯示擬議發展的合成照片	<input type="checkbox"/>	<input type="checkbox"/>
Master landscape plan(s)/Landscape plan(s) 園境設計總圖／園境設計圖	<input type="checkbox"/>	<input type="checkbox"/>
Others (please specify) 其他 (請註明) 化省圖, 行車路線圖, 填土範圍圖	<input checked="" type="checkbox"/>	<input type="checkbox"/>
<b>Reports 報告書</b>		
Planning Statement/Justifications 規劃綱領/理據	<input type="checkbox"/>	<input type="checkbox"/>
Environmental assessment (noise, air and/or water pollutions) 環境評估 (噪音、空氣及／或水的污染)	<input type="checkbox"/>	<input type="checkbox"/>
Traffic impact assessment (on vehicles) 就車輛的交通影響評估	<input type="checkbox"/>	<input type="checkbox"/>
Traffic impact assessment (on pedestrians) 就行人的交通影響評估	<input type="checkbox"/>	<input type="checkbox"/>
Visual impact assessment 視覺影響評估	<input type="checkbox"/>	<input type="checkbox"/>
Landscape impact assessment 景觀影響評估	<input type="checkbox"/>	<input type="checkbox"/>
Tree Survey 樹木調查	<input type="checkbox"/>	<input type="checkbox"/>
Geotechnical impact assessment 土力影響評估	<input type="checkbox"/>	<input type="checkbox"/>
Drainage impact assessment 排水影響評估	<input type="checkbox"/>	<input type="checkbox"/>
Sewerage impact assessment 排污影響評估	<input type="checkbox"/>	<input type="checkbox"/>
Risk Assessment 風險評估	<input type="checkbox"/>	<input type="checkbox"/>
Others (please specify) 其他 (請註明)	<input type="checkbox"/>	<input type="checkbox"/>
Note: May insert more than one '✓'. 註：可在多於一個方格內加上「✓」號		

Note: The information in the Gist of Application above is provided by the applicant for easy reference of the general public. Under no circumstances will the Town Planning Board accept any liabilities for the use of the information nor any inaccuracies or discrepancies of the information provided. In case of doubt, reference should always be made to the submission of the applicant.

註：上述申請摘要的資料是由申請人提供以方便市民大眾參考。對於所載資料在使用上的問題及文義上的歧異，城市規劃委員會概不負責。若有任何疑問，應查閱申請人提交的文件。

此為空白頁。  
This is a blank page.

申請位置:DD119 LOT 1750,DD119 LOT 1780(部份),  
DD119 LOT 1840(部份),DD119 LOT 1845

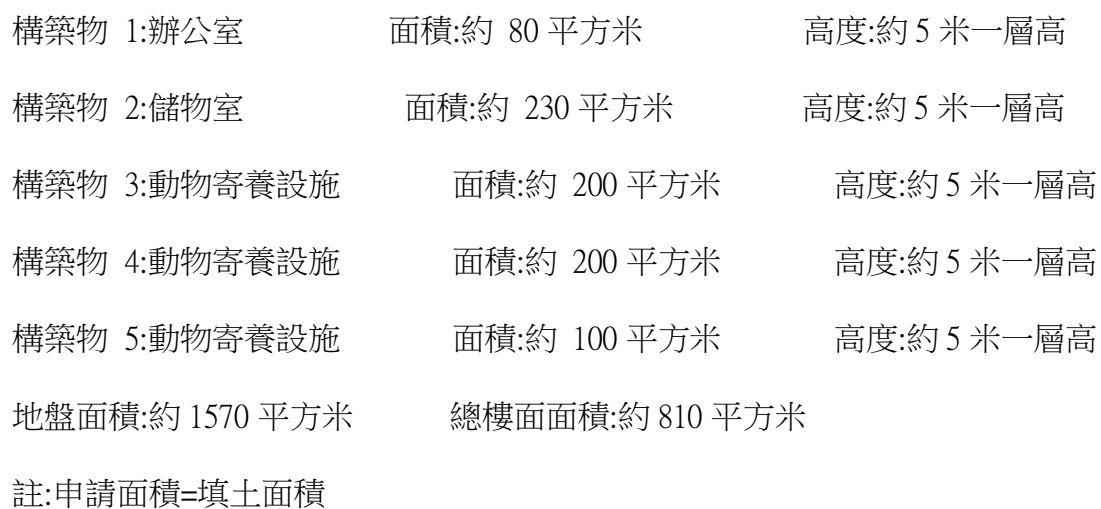

## 行車路線圖

申請位置

位置圖

申請地點

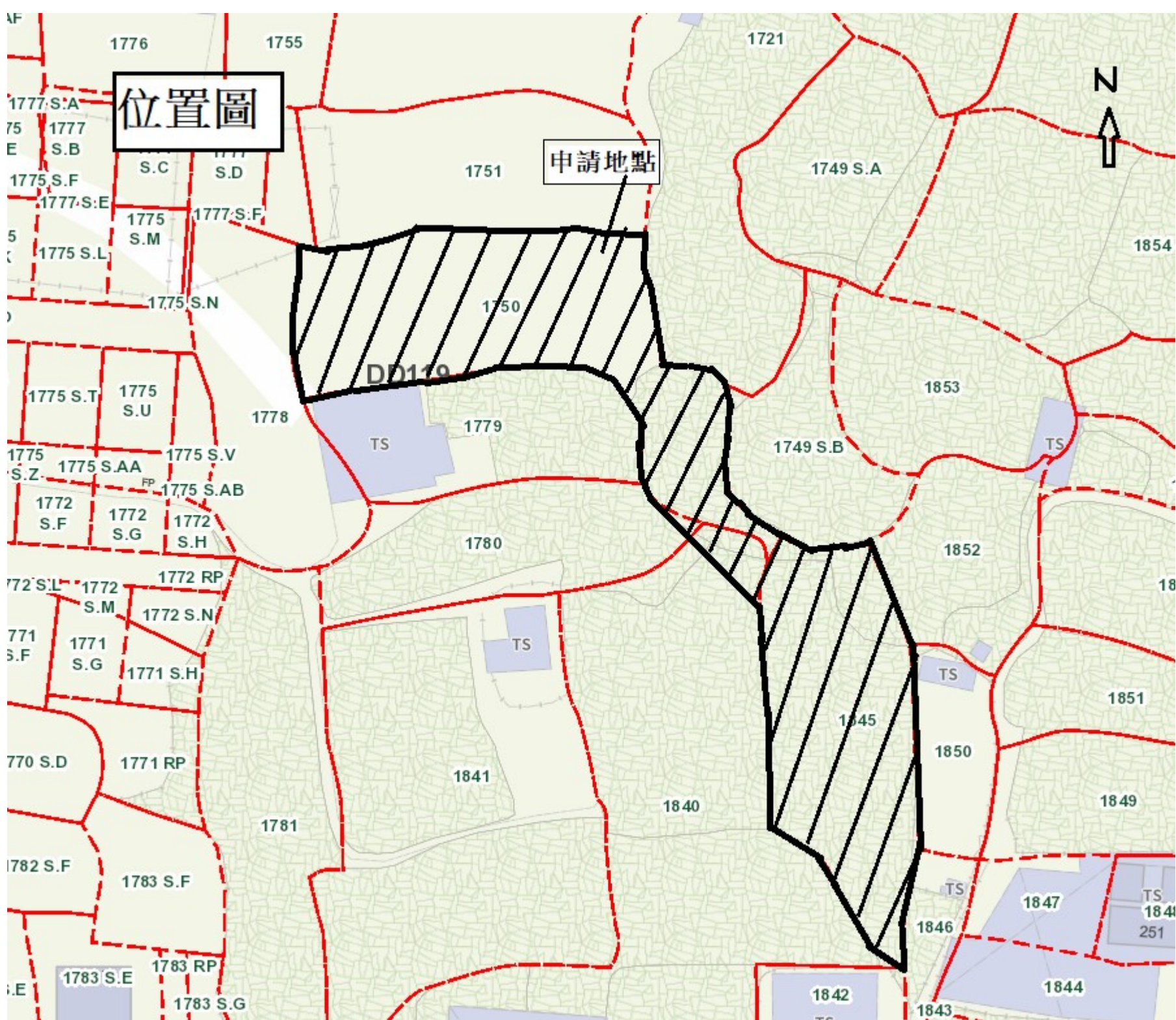

# 填土範圍圖

申請位置: dd119 lot 1750,  
dd119 lot 1780(部份),  
dd119 lot 1840(部份),  
dd119 lot 1845

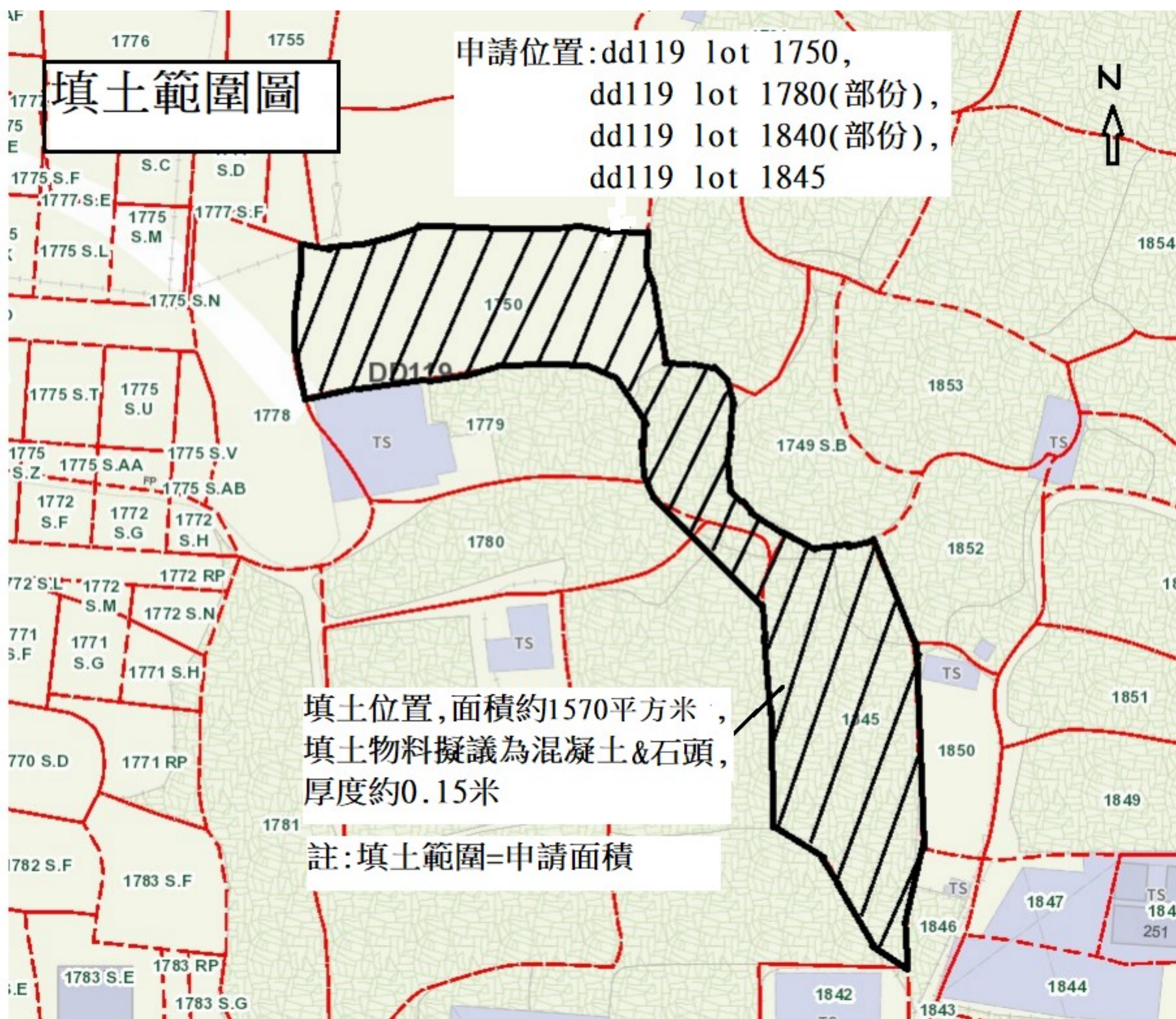

填土位置,面積約1570平方米,  
填土物料擬議為混凝土&石頭,  
厚度約0.15米

註:填土範圍=申請面積

Additional information:A/YL-TT687

1) The application site is on Lot Nos. 1750, Lot 1780(部份),

Lot 1840(部份),Lot 1845 in DD119 Yuen Long,N.T

2) About 20 nos of animals(including dogs and cats)

will be staying in the Proposed Development.

3)All kennels will be enclosed with sound -proofing materials,

equipped with mechanical ventilation and air-conditioning,

and kept in sanitary conditions. No environment nuisance is

expected to be arisen from the proposed development.

4)No vegetation clearance and tree felling will be carried

out at the site.As such,adverse visual and landscape impacts

to the surrounding areas should not be anticipated.

5)No public announcement systems,whistle blowing or portable

loundspeaker will be allowed within the site.All animals will be staying

in the kennels during sensitive hours to avoid any potential noise

nuisance to nearby sensitive receivers.

寄件者: [REDACTED]  
寄件日期: 2025年02月17日星期一 15:46  
收件者: Momo Hei Ching CHOW/PLAND  
主旨: Re: A/YL-TT/687 (Departmental Comments)

回應環保署意見：

- a) 本人會於申請場地設置化糞池及滲水系統。相關設施會邀請合資格人士依照環保署的 ProPECC PN 1/23 要求設計&建造。
- b) 擬議營運時間早上 9：00 至下午 6：00
- c) 敏感時段指：下午 6:00  
至早上 9：00。這時段內所有動物都會留左封閉的結構內。以減少滋擾。

**Previous Application covering the Application Site**

**Rejected Application**

	<b>Application No.</b>	<b><u>Development(s)/Use(s)</u></b>	<b>Date of Consideration (RNTPC)</b>	<b>Rejection Reason(s)</b>
1	A/YL-TT/629	Proposed Temporary Warehouse and Open Storage for a Period of 3 Years and Associated Filling of Land	10.5.2024	(1), (2)

**Rejection Reason(s):**

- (1) Not in line with the planning intention.
- (2) No compatible with the surroundings.

**Similar Applications within/straddling the Subject “Agriculture” Zone  
on the Tai Tong Outline Zoning Plan in the Past Five Years**

**Approved Applications**

	<b><u>Application No.</u></b>	<b><u>Development(s)/Use(s)</u></b>	<b><u>Date of Consideration (RNTPC)</u></b>
1	A/YL-TT/666	Proposed Temporary Animal Boarding Establishment with Ancillary Office for a Period of 5 Years and Filling of Land	28.2.2025
2	A/YL-TT/699	Proposed Temporary Animal Boarding Establishment (Cattery) for a Period of 3 Years and Associated Filling of Land	14.3.2025

**Government Departments' General Comments**

**1. Traffic**

(a) Comments of the Commissioner for Transport:

- No adverse comment on the application.
- Advisory comments as detailed in **Appendix IV**.

(b) Comments of the Chief Highway Engineer/New Territories West, Highways Department:

- No adverse comment on the application.
- Advisory comments as detailed in **Appendix IV**.

**2. Agricultural, Nature Conservation and Animal Management**

Comments of the Director of Agriculture, Fisheries and Conservation:

- The Site falls within the “Agriculture” zone and is generally vacant with some structures. There are some agricultural activities in the vicinity and agricultural infrastructures such as road access and water source are available in the area. The Site can be rehabilitated for agricultural activities such as open-field cultivation, greenhouses, plant nurseries, etc., though whether there will be agricultural activities on a specific site will hinge on a lot of factors.
- He has no strong view against the application from agricultural perspective.
- No comment on the application from the perspective of nature conservation.
- Advisory comments as detailed in **Appendix IV**.

**3. Environment**

Comments of the Director of Environmental Protection:

- No objection to the application.
- No substantiated environmental complaint concerning the Site has been received in the past three years.
- Advisory comments as detailed in **Appendix IV**.

#### **4. Drainage**

Comments of the Chief Engineer/Mainland North, Drainage Services Department:

- No objection to the application from the public drainage point of view.
- Should the application be approved, conditions should be included to request the applicant to submit a drainage proposal and to implement and maintain the drainage proposal for the proposed use to the satisfaction of the Director of Drainage Services or of the Town Planning Board.

#### **5. Fire Safety**

Comments of the Director of Fire Services:

- No in-principle objection to the proposal subject to the fire service installations being provided to the Site.
- Advisory comments as detailed in **Appendix IV**.

#### **6. Food and Environmental Hygiene**

Comments of the Director of Food and Environmental Hygiene:

- No adverse comment on the application.
- Advisory comments as detailed in **Appendix IV**.

#### **7. Urban Design and Landscape**

Comment of the Chief Town Planner/Urban Design and Landscape, Planning Department:

- No comment on the application from landscape planning perspective as the Site is occupied by temporary structures and paved and no existing vegetation/trees within the Site is observed.

#### **8. Building Matters**

Comments of the Chief Building Surveyor/New Territories West, Buildings Department:

- No objection to the application.
- Advisory comments as detailed in **Appendix IV**.

#### **9. District Officer's Comments**

Comment of the District Officer (Yuen Long), Home Affairs Department:

His office has not received any comments on the application from the village representatives in the vicinity of the Site.

## **10. Other Departments**

The following departments have no objection to/no comment on the application:

- Director of Electrical and Mechanical Services;
- Chief Engineer/Construction, Water Supplies Department;
- Project Manager (West), Civil Engineering and Development Department; and
- Commissioner of Police.

**Recommended Advisory Clauses**

- (a) to resolve any land issues relating to the development with the concerned owner(s) of the application site (the Site);
- (b) the planning permission is given to the development/use under application. It does not condone any other developments/uses (i.e. warehouse, vehicle repair workshop and open storage of vehicles) which currently exist on the Site but not covered by the application. Immediate action should be taken to discontinue such developments/uses not covered by the permission;
- (c) failure to reinstate the Site as required under the relevant approval condition upon expiry of the planning permission might constitute an authorized development under the Town Planning Ordinance and be subject to enforcement and prosecution actions;
- (d) to note the comments of the District Lands Officer/Yuen Long, Lands Department (DLO/YL, LandsD) that:
  - (i) the Site comprises Old Schedule Agricultural Lots 1750, 1780, 1840 and 1845 in D.D. 119 held under the Block Government Lease which contains the restriction that no structures are allowed to be erected without the prior approval of the Government;
  - (ii) there is/are unauthorized structure(s) and/or uses on Lots 1750 and 1845 in D.D. 119 which are already subject to lease enforcement actions according to case priority. The lot owner(s) should rectify/apply for regularization on the lease breaches as demanded by LandsD;
  - (iii) the lot owner(s) shall apply to LandsD for a Short Term Waiver (STW) to permit the structure(s) erect within the private lot(s). The application(s) for STW will be considered by the Government in its capacity as a landlord and there is no guarantee that the application(s) will be approved. The STW, if approved, will be subject to such terms and conditions including the payment of waiver fee and administrative fee as considered appropriate by LandsD. Besides, given that the proposal is temporary in nature, only erection of temporary structure(s) will be considered; and
  - (iv) the applicant should take into account of the programme of Yuen Long South Development when drawing up the STW boundary and layout of structures to be built on the Site. All STWs affected will have to be terminated upon land resumption and the Site will be cleared in accordance with the Civil Engineering and Development Department's scheduled programme;
- (e) to note the comments of the Commissioner for Transport that:
  - (i) to obtain consent of the owners/managing departments of the local track and footpath for using the local track and footpath as the access to the Site; and
  - (ii) sufficient manoeuvring space shall be provided within the Site. No vehicles are allowed to queue back to public roads or reverse onto/from public roads;

- (f) to note the comments of the Chief Highway Engineer/New Territories West, Highways Department (CHE/NTW, HyD) that:
  - (i) adequate drainage measures shall be provided to prevent surface water running from the Site to the nearby public roads and drains; and
  - (ii) the access road connecting the Site with Kiu Hing Road is not and will not be maintained by HyD. HyD should not be responsible for maintaining any access connecting the Site with Kiu Hing Road;
- (g) to note the comments of the Director of Environmental Protection that:
  - (i) all animals shall be kept inside the kennel with soundproofing materials, mechanical ventilation and air conditioning system, as proposed by the applicant, outside the operation hours (i.e. 6pm to 9am) during the planning approval period;
  - (ii) no public announcement system, whistle blowing, portable loudspeaker or any form of audio amplification system is allowed to be used on the Site during the planning approval period;
  - (iii) to provide adequate supporting infrastructure/facilities for proper collection, treatment and disposal of waste/wastewater generated from the proposed use. If septic tank and soakaway system will be used in case of unavailability of public sewer, its design and construction shall follow the requirements of Environmental Protection Department's Practice Note for Professional Person (ProPECC) PN 1/23 "Drainage Plans subject to Comment by the Environmental Protection Department" including completion of percolation test and certification by Authorized Person;
  - (iv) to follow the relevant mitigation measures and requirements in the latest "Code of Practice on Handling the Environmental Aspects of Temporary uses and Open Storage Sites" issued by Environmental Protection Department to minimise the potential environmental nuisances on the surrounding areas; and
  - (v) the applicant is obliged to meet the statutory requirements under relevant pollution control ordinances;
- (h) to note the comments of the Director of Agriculture, Fisheries and Conservation that:
  - (i) from animal management perspective, the Site does not associate with any licence granted or any application received by his department;
  - (ii) under the Public Health (Animals) (Boarding Establishment) Regulations, Cap. 139I (the Regulations), any person who provides food and accommodation for animals in return for a fee paid by the animal owner must apply for a Boarding Establishment Licence from his department. The establishment and ancillary facilities licensed under the Regulations must always fulfil the criteria listed in the Regulations;
  - (iii) the dogs kept by the applicant should also be properly licensed in accordance with the Rabies Ordinance (Cap. 421) and the applicant should to observe the Prevention of Cruelty to Animals Ordinance (Cap. 169) at all times; and

- (iv) detailed information and guidance on Animal Boarding Establishment would be provided upon receipt of the licence application;
- (i) to note the comments of the Director of Food and Environmental Hygiene (DFEH) that:
  - (i) no Food and Environmental Hygiene Department (FEHD)'s facilities will be affected by the proposed use;
  - (ii) proper license/permit issued by FEHD is required if there is any food business /catering service/activities regulated by DFEH under the Public Health and Municipal Services Ordinance (Cap. 132) and other relevant legislation for the public and the operation of any business should not cause any obstruction; and
  - (iii) if the proposal involves any commercial/trading activities, there should be no encroachment on the public place and no environmental nuisance should be generated to the surroundings. Its state should not be a nuisance or injurious or dangerous to health and surrounding environment. Any animal carcass/parts shall be properly wrapped or bagged before disposal and in accordance with the relevant legislation. Also, for any waste generated from the activities in the premises, the applicant should handle on his/her own expenses;
- (j) to note the comments of the Director of Fire Services that:
  - (i) the layout plans for the proposed fire service installations (FSI) should be drawn to scale and depicted with dimensions and nature of occupancy;
  - (ii) the location of the proposed FSI to be installed should be clearly marked on the layout plans; and
  - (iii) if the proposed structure is required to comply with the Buildings Ordinance (BO) (Cap 123), detailed fire services requirements will be formulated upon receipt of formal submission of general building plans; and
- (k) to note the comments of the Chief Building Surveyor/New Territories West, Buildings Department (CBS/NTW, BD) that:
  - (i) the Site shall be provided with means of obtaining access thereto from a street and emergency vehicular access in accordance with Regulations 5 and 41D of the Building (Planning) Regulations (B(P)R) respectively;
  - (ii) the Site does not abut on a specified street of not less than 4.5m wide and its permitted development intensity shall be determined under Regulation 19(3) of the B(P)R at building plan submission stage;
  - (iii) for unauthorized building works (UBW) erected on leased land, enforcement action may be taken by BD to effect their removal in accordance with the prevailing enforcement policy against UBW as and when necessary. The granting of any planning approval should not be construed as an acceptance of any existing building works or UBW on the Site under the BO;
  - (iv) five structures are proposed in the application. Before any new building works (including containers / open sheds as temporary buildings, demolition and land filling, etc.) are to be carried out on the Site, prior approval and consent of

Building Authority should be obtained, otherwise they are UBW under the BO. An Authorized Person should be appointed as the coordinator for the proposed building works in accordance with the BO;

- (v) if the proposed use is subject to issue of a license, any existing structures on the Site intended to be used for such purposes are required to comply with the building safety and other relevant requirements as may be imposed by the licensing authority;
- (vi) any temporary shelters or converted containers for office, storage, washroom or other uses are considered as temporary buildings which are subject to the control of Part VII of the B(P)R; and
- (vii) detailed checking under the BO will be carried out at building plan submission stage.

☐Urgent ☐Return receipt ☐Expand Group ☐Restricted ☐Prevent Copy

---

**From:**  
**Sent:** 2025-01-16 星期四 02:59:15  
**To:** tpbpd/PLAND <tpbpd@pland.gov.hk>  
**Subject:** A/YL-TT/687 DD 119, Tai Tong FAKE ABE

A/YL-TT/687

Lots 1750, 1780 (Part), 1840 (Part) and 1845 in D.D. 119, Tai Tong, Yuen Long

Site area: 1,570sq.m

Zoning: "Agriculture"

Applied use: Animal Boarding Establishment / 4 Vehicle Parking / **5 Years / Associated Filling of Land**

Dear TPB Members,

**The application should be considered in tandem with 684. Objection both relevant and upheld.**

**NOTE THAT THE APPLICANTS ARE THE SAME PERSON**

**THESE ARE FAKE ABE APPLICATIONS. MEDIA HAS EXPOSED THE TRICKERY INVOLVED.**

**THERE IS NO JUSTIFICATION FOR ANY VARIATION FROM THE REJECTED BROWNFIELD APPLICATION.**

**Has there been application for requisite licences?**

Mary Mulvihill

---

**From:**  
**To:** tpbpd <tpbpd@pland.gov.hk>  
**Date:** Friday, 3 January 2025 2:50 AM HKT  
**Subject:** A/YL-TT/684 DD 119, Tai Tong FAKE ABE

A/YL-TT/684

Lot 1751 in D.D. 119, Tai Tong, Yuen Long

Site area: 590sq.m

Zoning: "Agriculture"

---

**Applied use: Animal Boarding Establishment / ?? Vehicle Parking / 5 Years / Associated Filling of Land**

Dear TPB Members,

**Application 629 rejected 10 May**

*Majority of the Site is the subject of a planning enforcement case (No. E/YL-TT/700) against an unauthorized development (UD) involving filling of land. Reinstatement Notice (RN) was issued on 6.11.2023 requiring the concerned parties to remove the leftover materials and to grass the land by 6.2.2024. **However, the requirements of the RN have not been complied with and prosecution action may be taken.***

*Comments of the Chief Town Planner/Urban Design & Landscape, Planning Department (CTP/UD&L, PlanD):*

*There are active farmlands within the same "AGR" zone either in close proximity or right next to the Site (Plan 3). The applied uses are considered incompatible with the surrounding landscape resources (active farmland) and character (rural landscape) from the landscape planning perspective.*

*Two individuals object to the application on the grounds that there is no proper road serving the Site directly; the applied uses will generate adverse traffic and safety concerns on the surrounding area and the applied uses are not compatible with the nearby agricultural activities. Another objection is raised by a group of three indigenous residents of Pak Sha Tsuen on the grounds that the applied uses would increase the threat of flooding and cause adverse air, noise, drainage and traffic impacts on the surrounding residential area whereas the remaining public comment from Kadoorie Farm & Botanic Garden Corporation questions the appropriateness of approving the application if the Site is the subject of an ongoing enforcement case.*

**SOLUTION**

Split the site into two, Application 687 deadline for 17/1 to ensure that the applications would be heard separately

**THESE ARE FAKE ABE APPLICATIONS WITH THE PURPOSE OF SECURING APPROVAL FOR 5 YEARS SO THAT 3 YEARS UNHINDERED BROWNFIELD USE**

**Media reports have recently exposed the collusion between operators and government depts supported by the failure of TPB members to properly enquire into matters that have encourage this backdoor avenue to trashing farmland to convert it to brownfield use.**

**The Ombudsman has also issue a reprimand with regard to failure to ensure that the planning process is not manipulated.**

There is no justification to approve the application.

Mary Mulvihill

---

**From:**

**To:** tpbpd <[tpbpd@pland.gov.hk](mailto:tpbpd@pland.gov.hk)>

**Date:** Sunday, 7 January 2024 3:33 AM HKT

**Subject:** A/YL-TT/629 DD 119, Tai Tong

A/YL-TT/629

Lots 1750, 1751 and 1845 in D.D. 119, Tai Tong, Yuen Long

Site area: About 2,095sq.m

Zoning: "Agriculture"

Applied use: Warehouse / 3 Vehicle Parking / **Filling of Land**

Dear TPB Members,

Strong Objections.

No previous applications and the lots are in an area with substantial agricultural activity, including a number of organic farms, strawberry production and green houses.

Recently the government pledged that, in line with the policy of the Central Government, there should be an increase in local production to meet at least 10% of demand for fresh produce.

With so much farmland and green belt rezoned to accommodate residential development, it is essential that fertile land with the appropriate zoning be protected from filling in as this destroys the quality of the soil and renders it unsuitable for farming.

Members should reject the application.

Mary Mulvihill

A/YL-TT/687

☐Urgent ☐Return receipt ☐Expand Group ☐Restricted ☐Prevent Copy

2

---

**From:**  
**Sent:** 2025-01-17 星期五 14:16:11  
**To:** tpbpd/PLAND <tpbpd@pland.gov.hk>  
**Subject:** (A/YL-TT/687), (A/YL-TT/688), (A/YL-TT/690), (A/YL-TT/693)  
**Attachment:** 687.pdf; 688.pdf; 690.pdf; 693.pdf

在 2024 年 10 月 13 日星期日 下午 01:05:32 [GMT+8] 寫道：

致城市規劃委員會秘書:

專人送遞或郵遞:

香港北角渣華道 333 號北角政府合署 15 樓

傳真: 2877 0245 或 2522 8426

電郵: tpbpd@pland.gov.hk

有關的規劃申請編號: (A/YL-TT/687)

本人反對原因如下:

- 一、 不符合區內農業地帶的規劃
- 二、 不符合區內鄉村式發展地帶的規劃
- 三、 農業及鄉村式發展地帶變成棕地或工業用途污染環境
- 四、 填土工程導致水浸威脅村民的生命財產
- 五、 貨車佔用行人路對村民生命構成威脅
- 六、 火警時威脅本村安危

**「提意見人」姓名 / 名稱: [注意: 以下部份是提意見人的個人資料, 不可以公開予公眾查閱。]**

---

簽署:

日期: 17-1-2025

The Secretary,  
Town Planning Board,  
15/F, North Point Government Offices,  
333, Java Road, North Point,  
Hong Kong.  
(Email: tpbpd@pland.gov.hk)

17th January, 2025.

Dear Sir/ Madam,

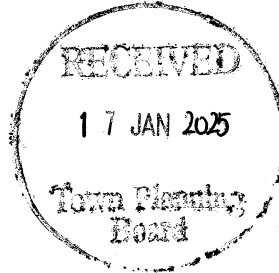

By email only

**Proposed Temporary Animal Boarding Establishment with Ancillary Facilities and  
Associated Filling of Land for a Period of 5 Years  
(A/YL-TT/687)**

1. We refer to the captioned.
2. There is a rejected application (A/YL-TT/629; Proposed Temporary Warehouse and Open Storage, for a Period of 3 Years and Associated Filling of Land; rejected in 2024) covering the application site; the reasons for rejection are as follows:

*(a) the applied uses and associated filling of land are not in line with the planning intention of the "Agriculture" zone which is primarily to retain and safeguard good quality agricultural land/farm/fish ponds for agricultural purposes, and to retain fallow arable land with good potential for rehabilitation for cultivation and other agricultural purposes. No strong planning justification has been given in the submission for a departure from the planning intention, even on a temporary basis; and*

*(b) the applied uses and associated filling of land are not compatible with the surrounding rural character.*

3. We also urge the Board to look at the below photo extracted from the Town Planning Board Planning Portal 3, which shows the application site (bounded by the red line).



4. We urge the Board to investigate with relevant authorities as to what is going on within the site and to investigate whether there are any unauthorised activities/ ongoing enforcement case covering the site; if yes, then to consider whether it is appropriate to approve this application.

5. We would also like to remind the Board that the government proposed to designate 37 sites as Agricultural Priority Areas (APAs) in early December 2024<sup>1</sup>. One of these proposed APAs is located at Tai Tong<sup>2</sup>. According to the relevant government document<sup>3</sup>, the objectives of this APA policy are as follows:

- *To promote the overall sustainable development and industrial diversification of the local agriculture industry, the Government proposed to delineate some quality farmland as Agricultural Priority Areas (APAs) through administrative means to achieve the policy objective of putting the relevant land into active agricultural use, and to roll out support measures to facilitate long-term active farming use for APAs.*

<sup>1</sup> [https://www.afcd.gov.hk/english/agriculture/agr\\_apo/agr\\_apo.html](https://www.afcd.gov.hk/english/agriculture/agr_apo/agr_apo.html)

<sup>2</sup> [https://www.afcd.gov.hk/tc\\_chi/agriculture/agr\\_apo/files/APA\\_Tai\\_Tong.pdf](https://www.afcd.gov.hk/tc_chi/agriculture/agr_apo/files/APA_Tai_Tong.pdf)

<sup>3</sup> <https://www.legco.gov.hk/yr2024/english/panels/fseh/papers/fseh20241210cb2-1591-1-e.pdf>

6. The document<sup>3</sup> also states:

- *To implement the proposal on APAs, the Government plans to promulgate a “Policy Statement” to set out, through administrative means, its policy objective of delineating APAs to preserve quality farmland for long-term agricultural development and their relevant locations. This serves to inform the public of the Government’s policy to prioritise agriculture use on the relevant land, and provide a guiding direction for the Government and the private sector on the future planning of the relevant land use.*

7. We urge the Board to investigate with relevant authorities as to whether the current application site is located within one of the proposed APAs (e.g., Tai Tong). If it is not within APA, we also urge the Board to investigate the boundary of the Tai Tong APA and to see how close it is to the current application site, and then to consider with relevant authorities as to whether the proposed use would cause potential impacts to affect this APA. Although the relevant government paper for APA<sup>3</sup> mentions the followings: ‘As for planning applications for non-agricultural use of farmland outside APAs, objections will normally not be raised by AFCD from agricultural perspective’, we still would like the Board to consider our concern as stated above.

8. However, if the site is within APA (even not the entire site is within APA), we urge the Board to consider, after consulting relevant authorities, as to whether it is appropriate to approve this application. We urge the Board to consider whether the approval of this application would affect the APA policy proposed by the government (e.g., if this application is approved eventually, what kind of message will be sent to the public regarding this government policy?). Please note that this application involves associated filling of land with cement and gravel covering the entire site (as stated in Drawing Plan 5 attached to this application).

9. Finally, regarding Animal Boarding Establishment, we also urge the Board to read the relevant news article <sup>(at 4)</sup>.

10. We urge the Board to reject this application as we consider the proposed use is not in line

---

<sup>4</sup> <https://news.mingpao.com/pns/港聞/article/20240702/s00002/1719858304310/本研-5年批60狗場用地-半不符實-疑作跳板-至少15幅兩年內申棕地作業>



3

**嘉道理農場暨植物園公司**  
**Kadoorie Farm & Botanic Garden Corporation**

with the planning intention of the Agriculture zone.

11. Thank you for your attention.

Ecological Advisory Programme  
Kadoorie Farm and Botanic Garden