

(摘錄自申請人於 15. 11. 2024 呈交的進一步資料)
(Extract from Applicant's Further
Information Submitted on 15.11.2024)

參考編號
REFERENCE No.
A/YL-TYST/1285

繪圖 DRAWING
A-1

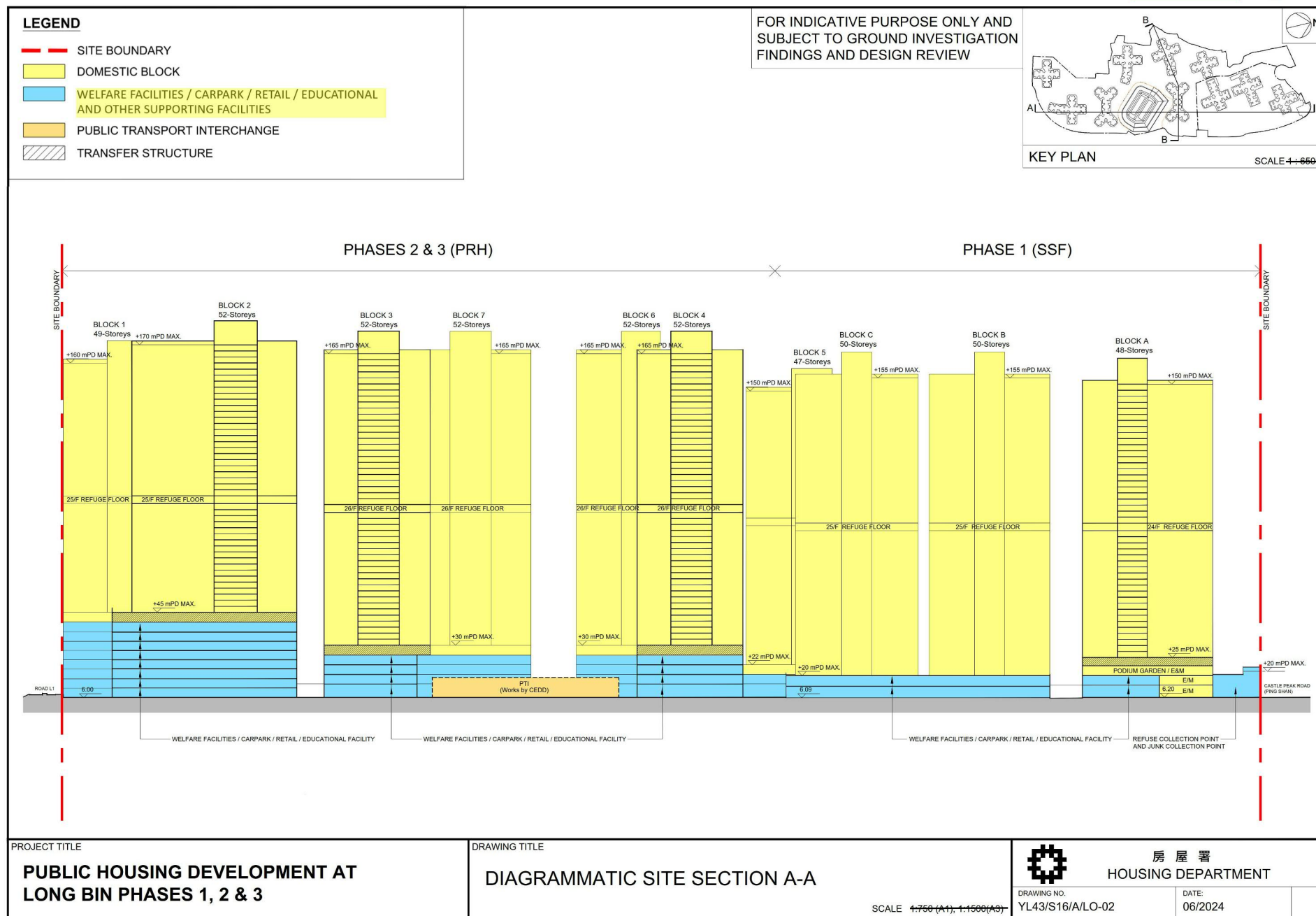

(摘錄自申請人於 15. 11. 2024 呈交的進一步資料)
(Extract from Applicant's Further
Information Submitted on 15.11.2024)

參考編號
REFERENCE No.
A/YL-TYST/1285

繪圖 DRAWING
A-2

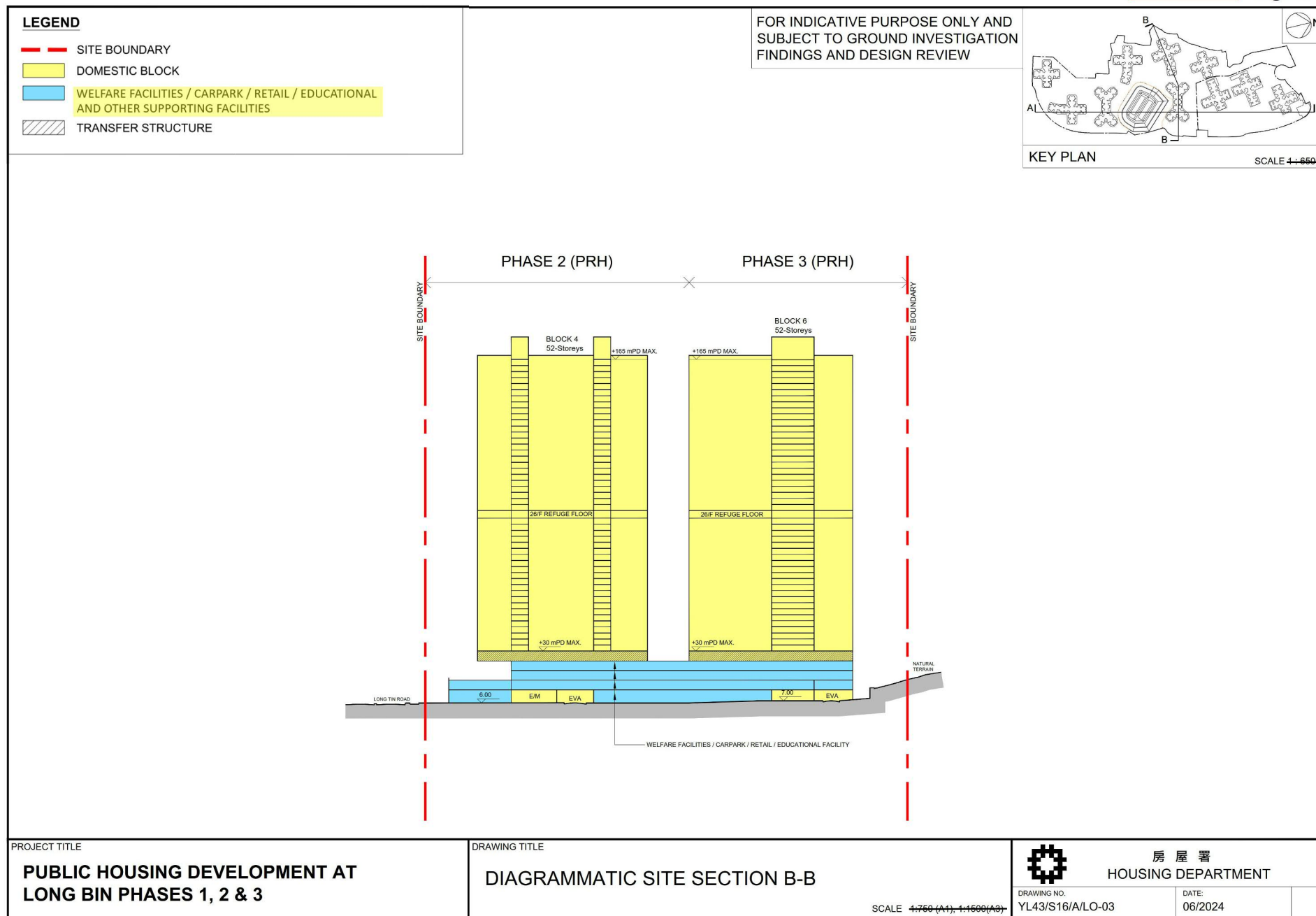

(摘錄自申請人於 15. 11. 2024 呈交的進一步資料)
(Extract from Applicant's Further
Information Submitted on 15.11.2024)

參考編號
REFERENCE No.
A/YL-TYST/1285

繪圖 DRAWING
A-3

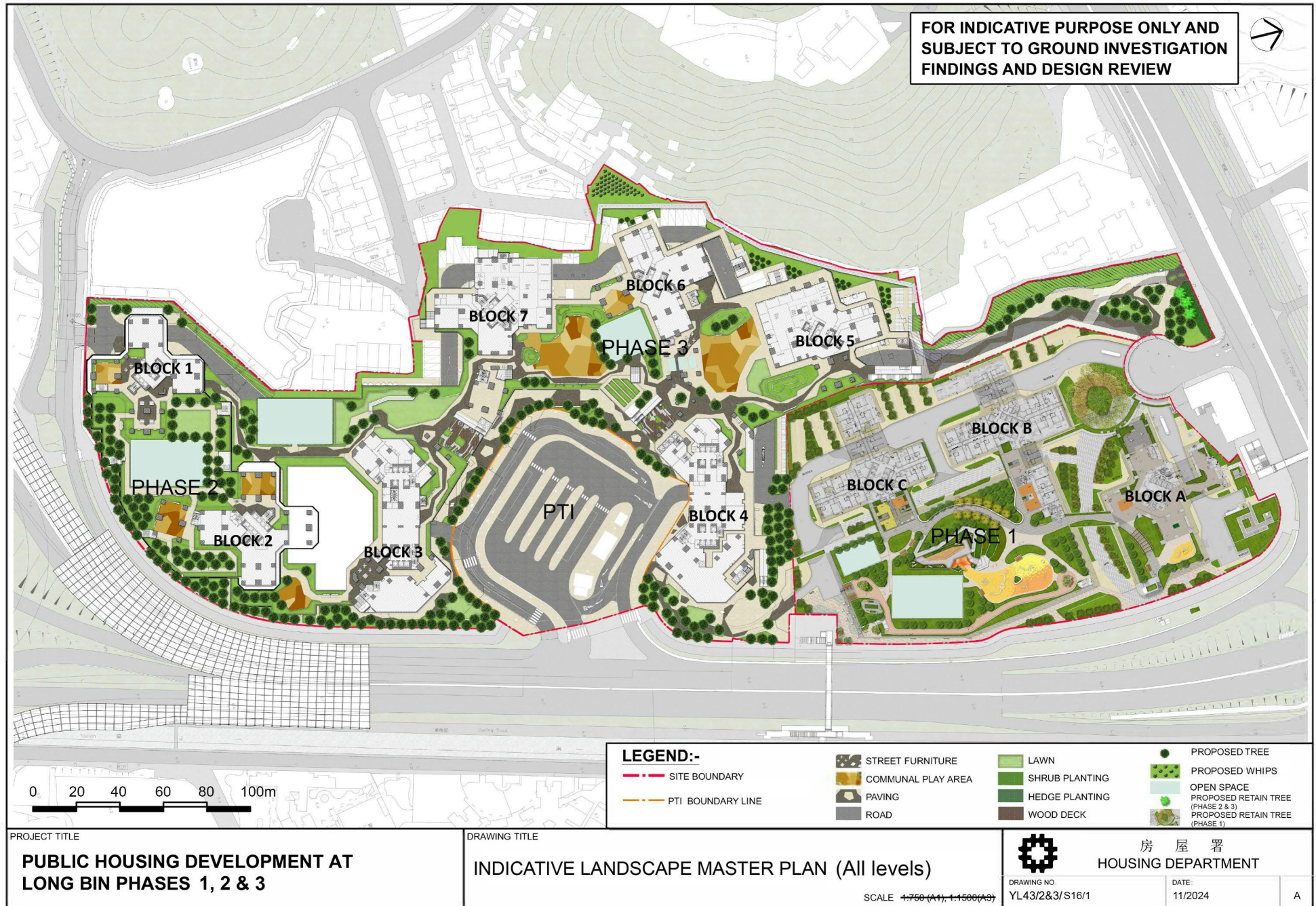

(摘錄自申請人於 15. 11. 2024 呈交的進一步資料)
(Extract from Applicant's Further
Information Submitted on 15.11.2024)

參考編號
REFERENCE No.
A/YL-TYST/1285

繪圖 DRAWING
A-4

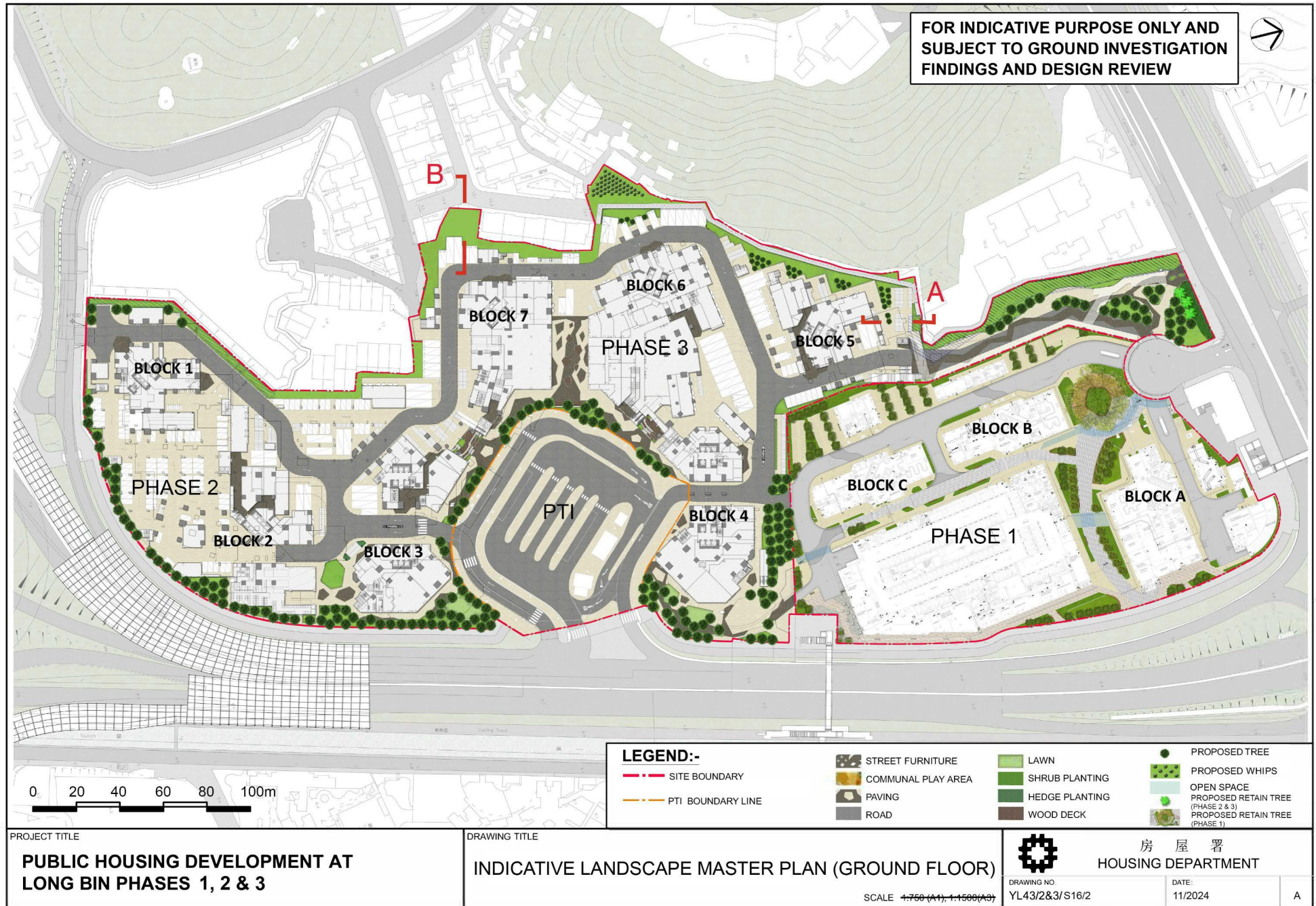

(摘錄自申請人於 15. 11. 2024 呈交的進一步資料)
(Extract from Applicant's Further
Information Submitted on 15.11.2024)

參考編號
REFERENCE No.
A/YL-TYST/1285

繪圖 DRAWING
A-5

FOR INDICATIVE PURPOSE ONLY AND
SUBJECT TO GROUND INVESTIGATION
FINDINGS AND DESIGN REVIEW



LEGEND:-

--- SITE BOUNDARY
--- PTI BOUNDARY LINE

STREET FURNITURE
COMMUNAL PLAY AREA
PAVING
ROAD

LAWN
SHRUB PLANTING
HEDGE PLANTING
WOOD DECK

PROPOSED TREE
PROPOSED RETAIN TREE (PHASE 1)
OPEN SPACE

PROJECT TITLE

**PUBLIC HOUSING DEVELOPMENT AT
LONG BIN PHASES 1, 2 & 3**

DRAWING TITLE

INDICATIVE LANDSCAPE MASTER PLAN (1ST FLOOR)

SCALE 1:750 (A1), 1:1500 (A3)



房屋署
HOUSING DEPARTMENT

DRAWING NO.
YL43/2&3/S16/3

DATE:
11/2024

A

(摘錄自申請人於 15. 11. 2024 呈交的進一步資料)
(Extract from Applicant's Further
Information Submitted on 15.11.2024)

參考編號
REFERENCE No.
A/YL-TYST/1285

繪圖 DRAWING
A-6

FOR INDICATIVE PURPOSE ONLY AND
SUBJECT TO GROUND INVESTIGATION
FINDINGS AND DESIGN REVIEW

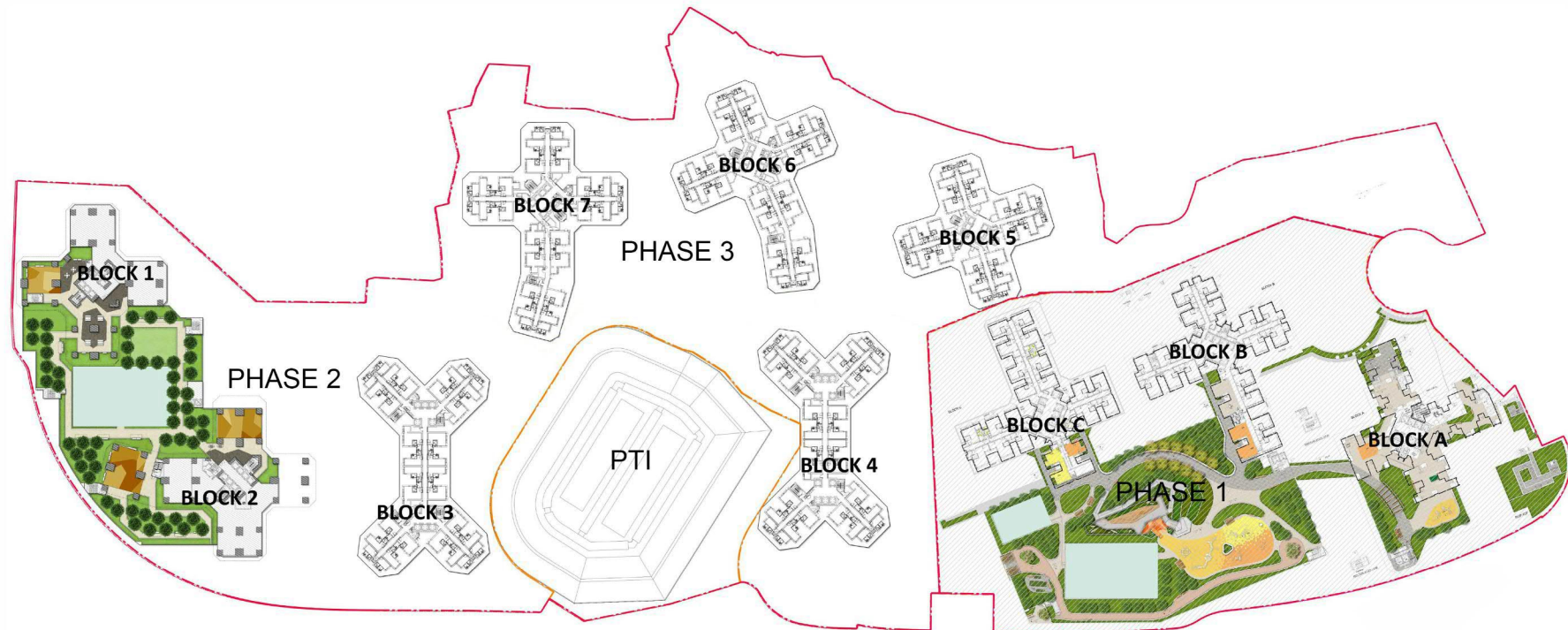

0 20 40 60 80 100m

LEGEND:-

--- SITE BOUNDARY
--- PTI BOUNDARY LINE

STREET FURNITURE
COMMUNAL PLAY AREA
PAVING
ROAD

LAWN
SHRUB PLANTING
HEDGE PLANTING
WOOD DECK

PROPOSED TREE
OPEN SPACE

PROJECT TITLE

**PUBLIC HOUSING DEVELOPMENT AT
LONG BIN PHASES 1, 2 & 3**

DRAWING TITLE

INDICATIVE LANDSCAPE MASTER PLAN (PODIUM FLOOR)

SCALE 1:750 (A1), 1:1500 (A3)



房屋署
HOUSING DEPARTMENT

DRAWING NO.
YL43/2&3/S16/4

DATE:
11/2024

A

(摘錄自申請人於 15. 11. 2024 呈交的進一步資料)
(Extract from Applicant's Further
Information Submitted on 15.11.2024)

參考編號
REFERENCE No.
A/YL-TYST/1285

繪圖 DRAWING
A-7

FOR INDICATIVE PURPOSE ONLY AND
SUBJECT TO GROUND INVESTIGATION
FINDINGS AND DESIGN REVIEW

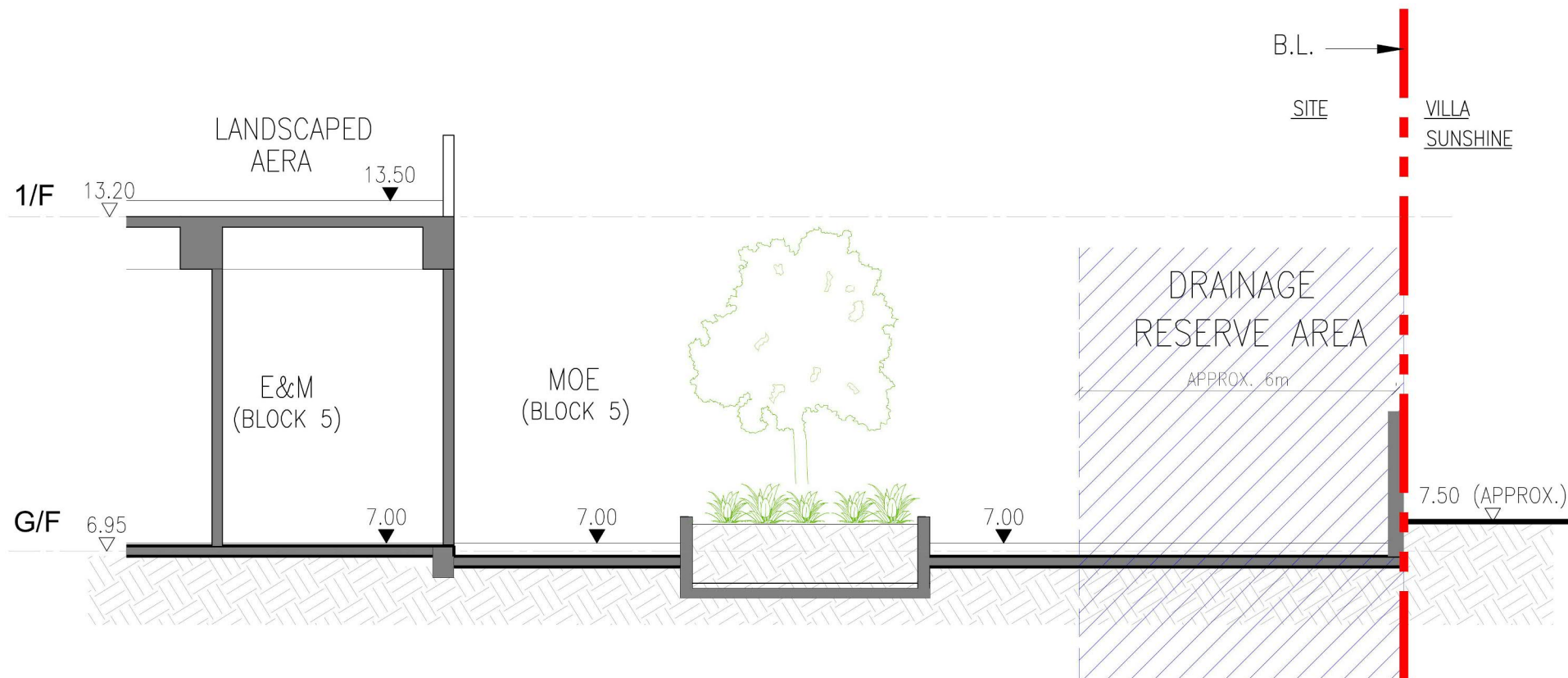

PROJECT TITLE

**PUBLIC HOUSING DEVELOPMENT AT
LONG BIN PHASES 1, 2 & 3**

DRAWING TITLE

INDICATIVE SECTION A

SCALE

1:75 (A3)



房屋署
HOUSING DEPARTMENT

DRAWING NO.

DATE:
11/2024

-

(摘錄自申請人於 15. 11. 2024 呈交的進一步資料)
(Extract from Applicant's Further
Information Submitted on 15.11.2024)

參考編號
REFERENCE No.
A/YL-TYST/1285

繪圖 DRAWING
A-8

FOR INDICATIVE PURPOSE ONLY AND
SUBJECT TO GROUND INVESTIGATION
FINDINGS AND DESIGN REVIEW

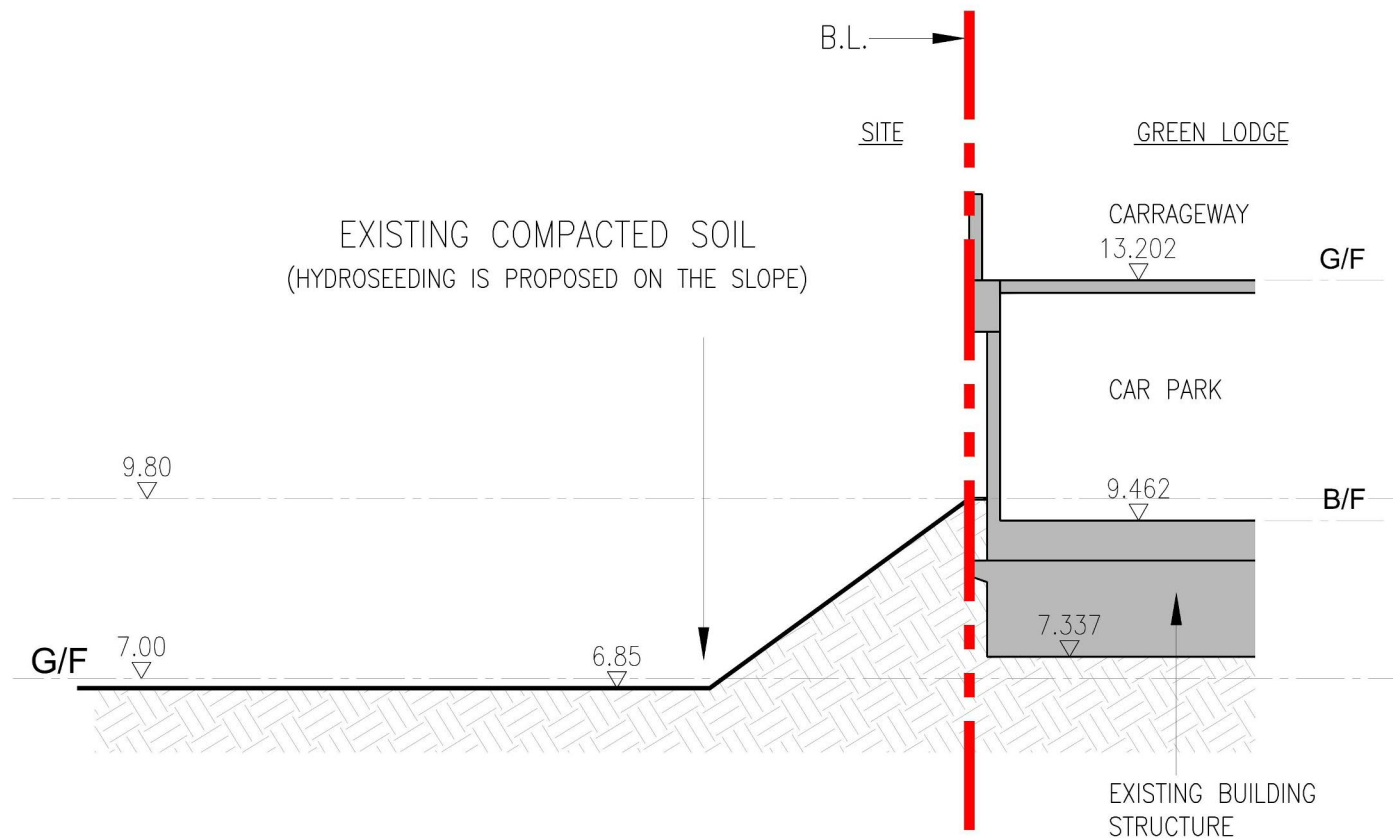

PROJECT TITLE

**PUBLIC HOUSING DEVELOPMENT AT
LONG BIN PHASES 1, 2 & 3**

DRAWING TITLE

INDICATIVE SECTION B

SCALE

1:75 (A3)



房屋署
HOUSING DEPARTMENT

DRAWING NO.

DATE:
11/2024

-

(摘錄自申請人於 15. 11. 2024 呈交的進一步資料)
(Extract from Applicant's Further
Information Submitted on 15.11.2024)

參考編號
REFERENCE No.
A/YL-TYST/1285

繪圖 DRAWING
A-9

Approved s.16 Application No. A/YL-TYST/1074 (Current Scheme)

Application Site

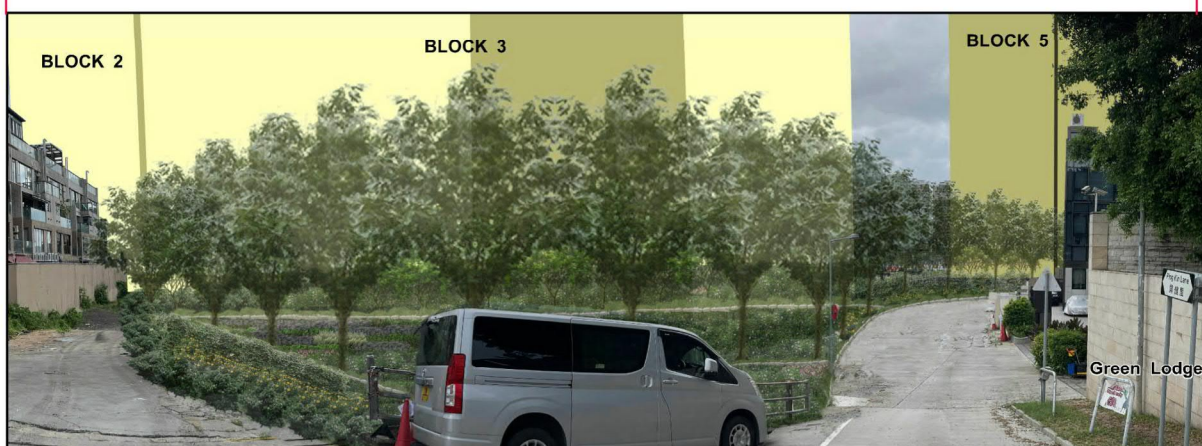

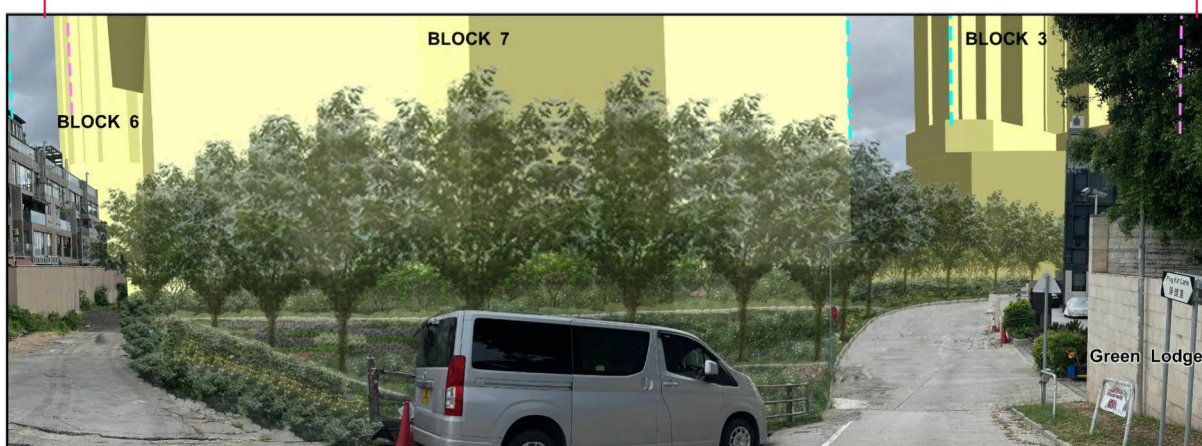

Proposed Scheme

Application Site



LEGEND:

-  Approved s.16 Application No. A/YL-TYST/1074 (Current Scheme)
-  The OZP Compliance Scheme
-  Application Site

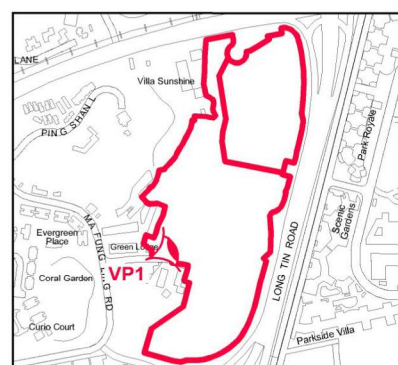

PHOTOMONTAGE OF VIEWPOINT 1
(VIEW FROM PING KIN LANE)



HOUSING DEPARTMENT
PLANNING SECTIONS

PLAN 2

DATE :
14. 11. 2024

(摘錄自申請人於 15. 11. 2024 呈交的進一步資料)
(Extract from Applicant's Further
Information Submitted on 15.11.2024)

參考編號
REFERENCE No.
A/YL-TYST/1285

繪圖 DRAWING
A-10

24_0854YL_VP1

Approved s.16 Application No. A/YL-TYST/1074 (Current Scheme)

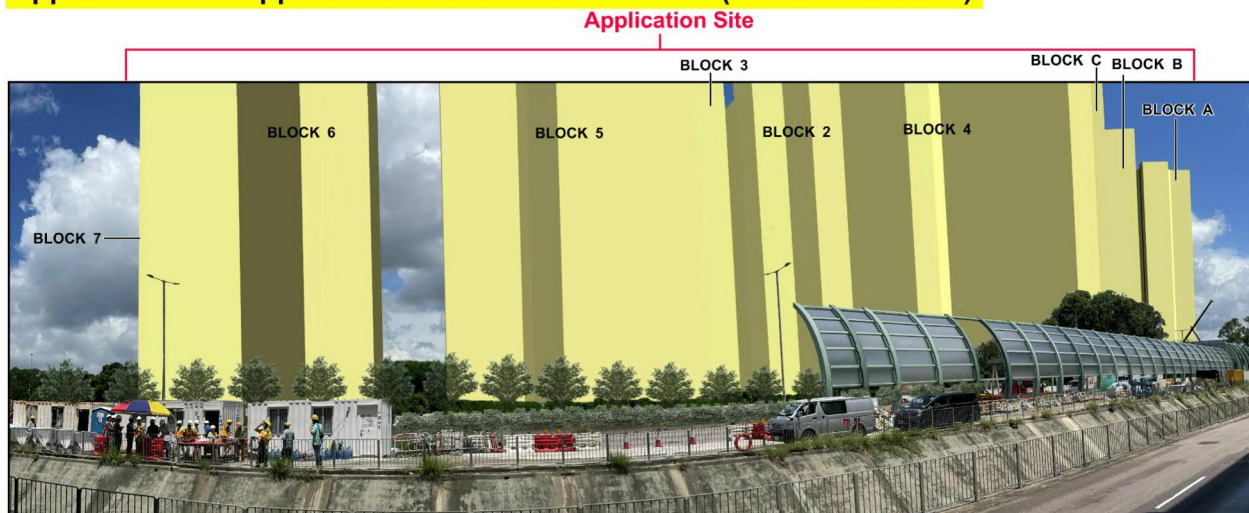

Proposed Scheme

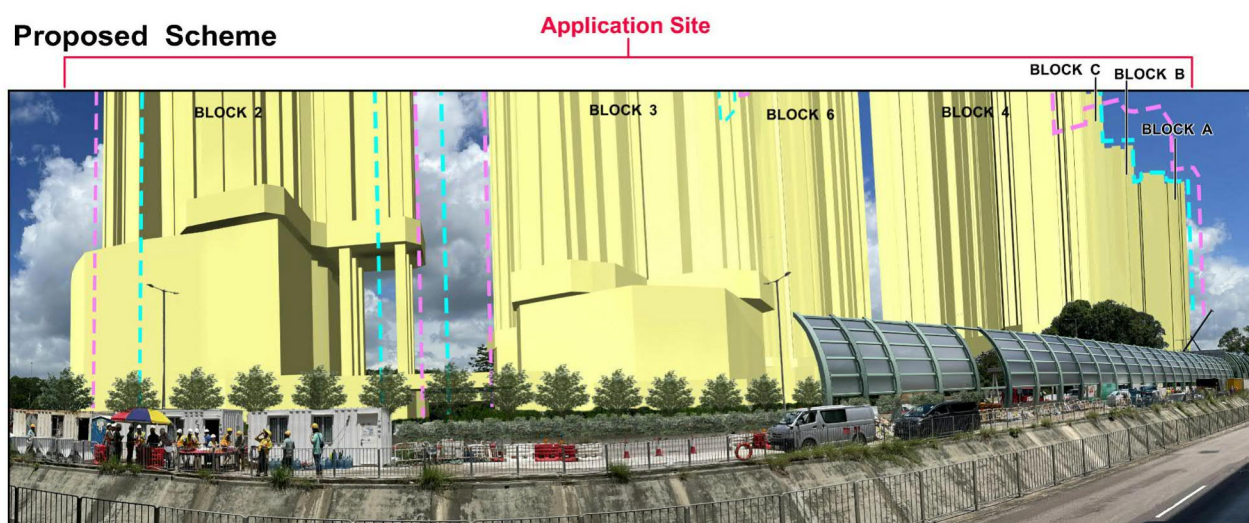

LEGEND:

- Approved s.16 Application No. A/YL-TYST/1074 (Current Scheme)
- The OZP Compliance Scheme
- Application Site

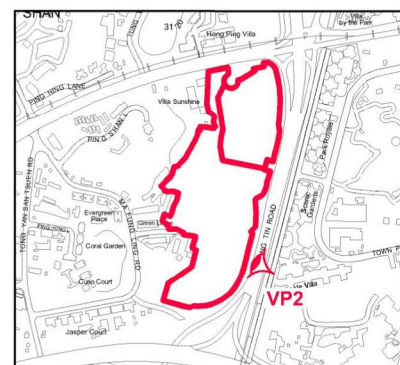

PHOTOMONTAGE OF VIEWPOINT 2 (VIEW FROM LONG TIN ROAD)



**HOUSING DEPARTMENT
PLANNING SECTIONS**

PLAN 3

**DATE :
14. 11. 2024**

(摘錄自申請人於 15. 11. 2024 呈交的進一步資料)
(Extract from Applicant's Further
Information Submitted on 15.11.2024)

參考編號
REFERENCE No.
A/YL-TYST/1285

繪圖 DRAWING
A-11

24_0854YL_VP2

Approved s.16 Application No. A/YL-TYST/1074 (Current Scheme)

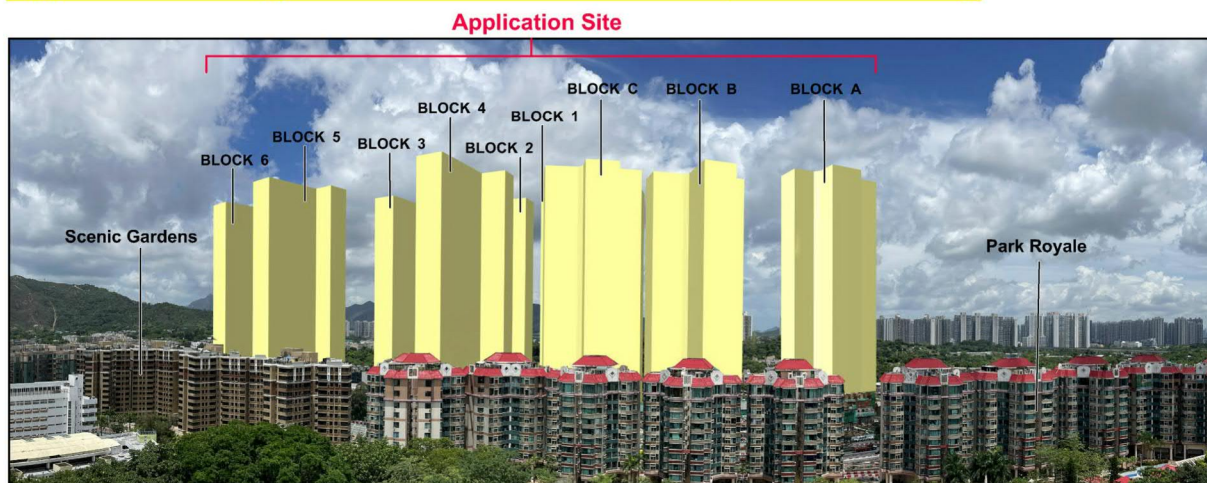

Proposed Scheme

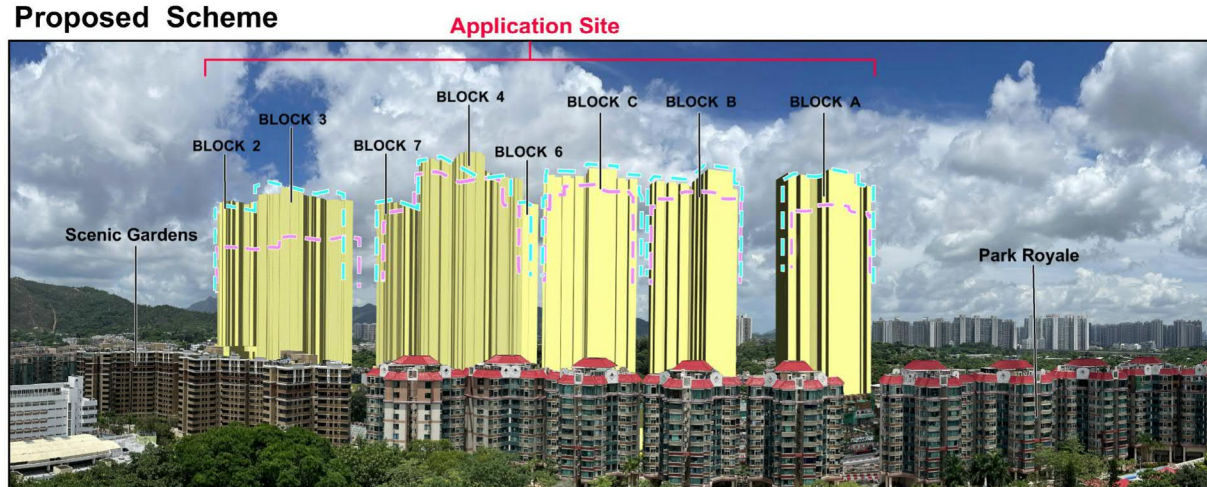

LEGEND:



Approved s.16 Application No. A/YL-TYST/1074
(Current Scheme)



The OZP Compliance Scheme



Application Site

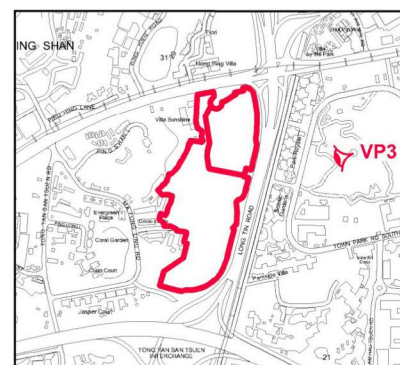

**PHOTOMONTAGE OF VIEWPOINT 3
(VIEW FROM YUEN LONG PARK AVIARY PAGODA)**



**HOUSING DEPARTMENT
PLANNING SECTIONS**

PLAN 4

**DATE :
14. 11. 2024**

(摘錄自申請人於 15. 11. 2024 呈交的進一步資料)
(Extract from Applicant's Further
Information Submitted on 15.11.2024)

參考編號
REFERENCE No.
A/YL-TYST/1285

繪圖 DRAWING
A-12

24_0854YL_VP3

Approved s.16 Application No. A/YL-TYST/1074 (Current Scheme)

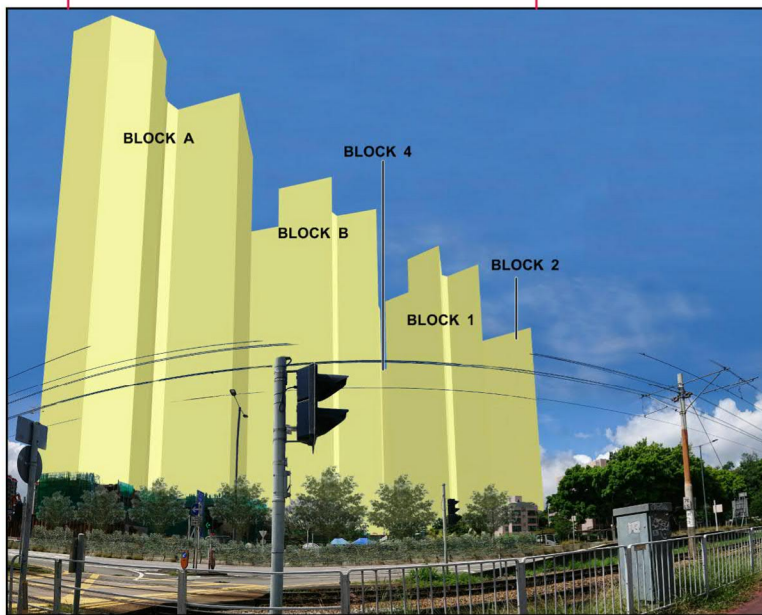

Application Site

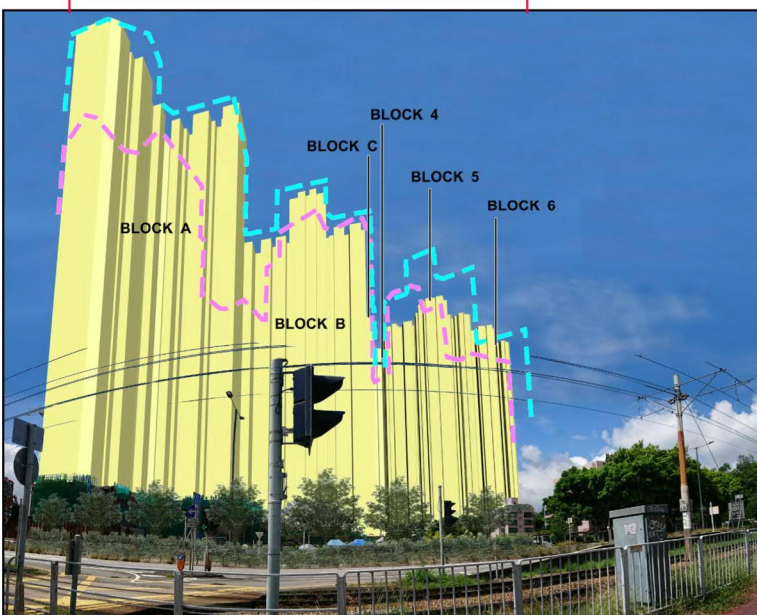

Proposed Scheme Application Site



LEGEND:

-  Approved s.16 Application No. A/YL-TYST/1074 (Current Scheme)
-  The OZP Compliance Scheme
-  Application Site

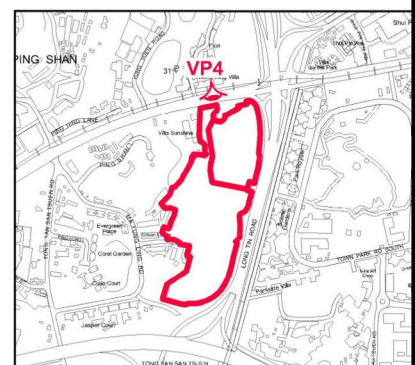

PHOTOMONTAGE OF VIEWPOINT 4 (VIEW FROM CASTLE PEAK ROAD - PING SHAN)



HOUSING DEPARTMENT
PLANNING SECTIONS

PLAN 5

DATE :
14. 11. 2024

24_0854YL_VP4

(摘錄自申請人於 15. 11. 2024 呈交的進一步資料)
(Extract from Applicant's Further
Information Submitted on 15.11.2024)

參考編號
REFERENCE No.
A/YL-TYST/1285

繪圖 DRAWING
A-13

Approved s.16 Application No. A/YL-TYST/1074 (Current Scheme)

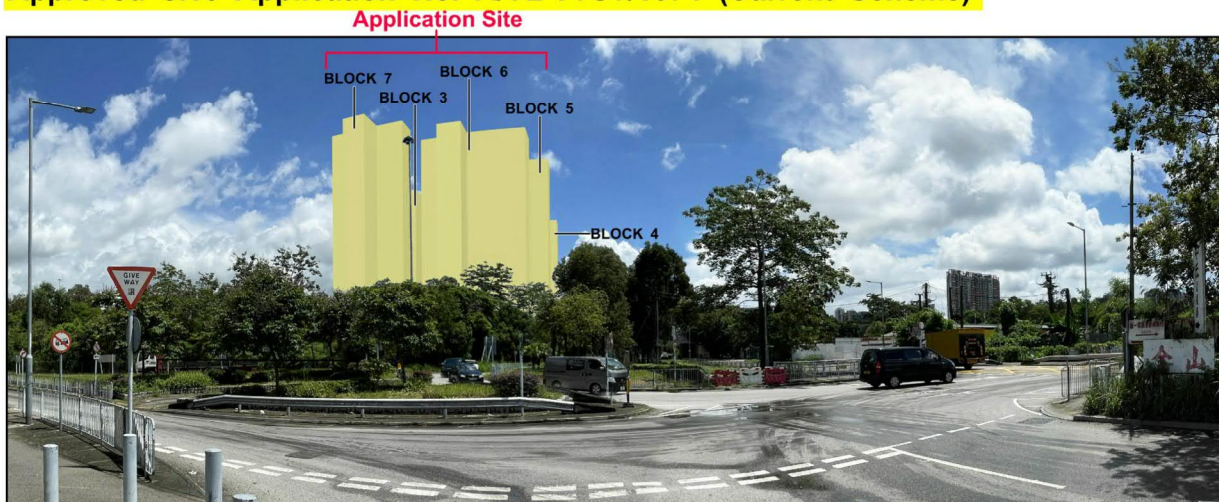

Proposed Scheme

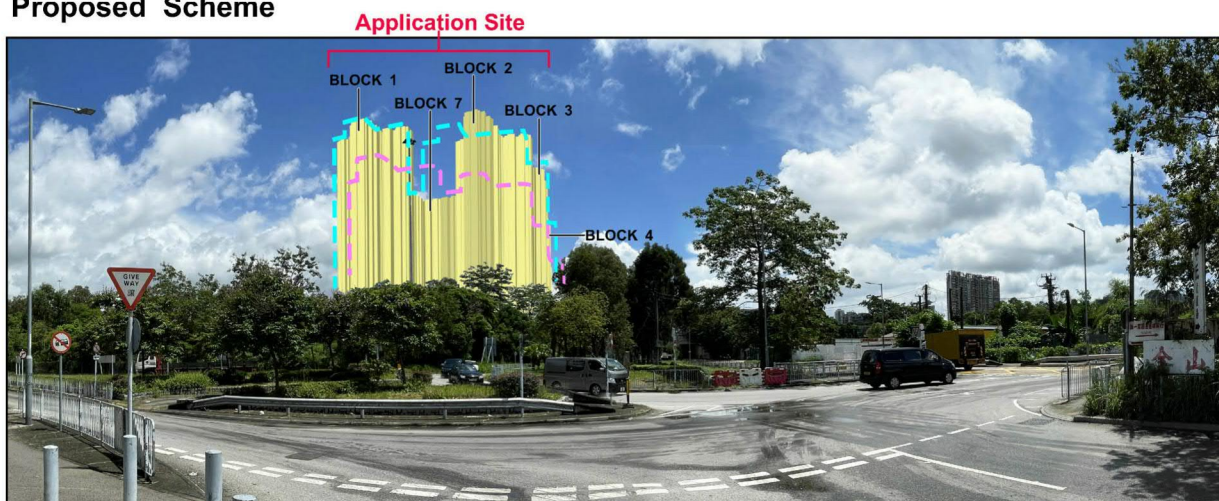

LEGEND:



Approved s.16 Application No. A/YL-TYST/1074
(Current Scheme)



The OZP Compliance Scheme



Application Site

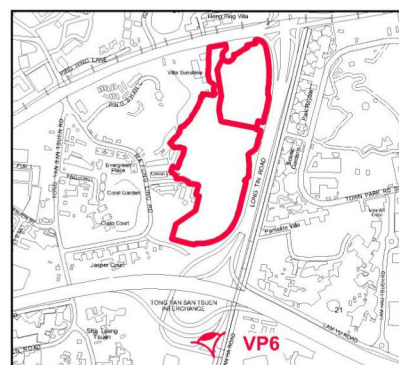

**PHOTOMONTAGE OF VIEWPOINT 6
(VIEW FROM TONG YAN SAN TSUEN
INTERCHANGE)**



**HOUSING DEPARTMENT
PLANNING SECTIONS**

PLAN 7

DATE :

14. 11. 2024

24_0854YL_VP6

(摘錄自申請人於 15. 11. 2024 呈交的進一步資料)
(Extract from Applicant's Further
Information Submitted on 15.11.2024)

參考編號
REFERENCE No.
A/YL-TYST/1285

繪圖 DRAWING
A-14

Approved s.16 Application No. A/YL-TYST/1074 (Current Scheme)

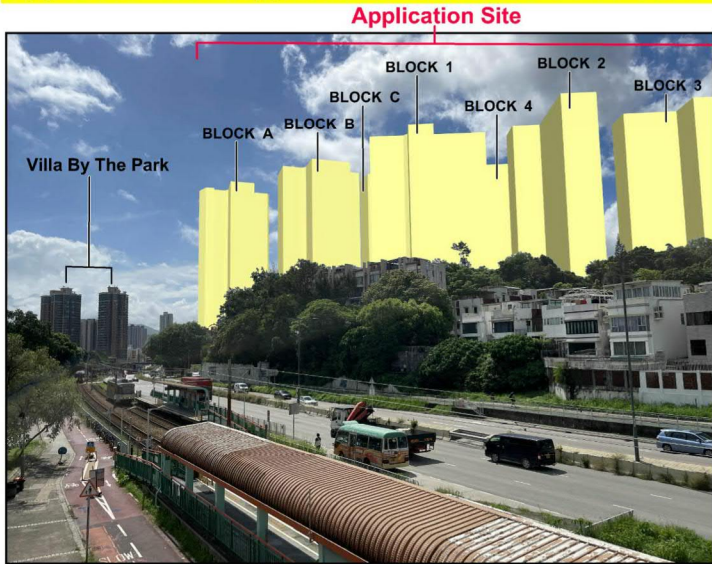

Proposed Scheme	Application Site
-----------------	------------------

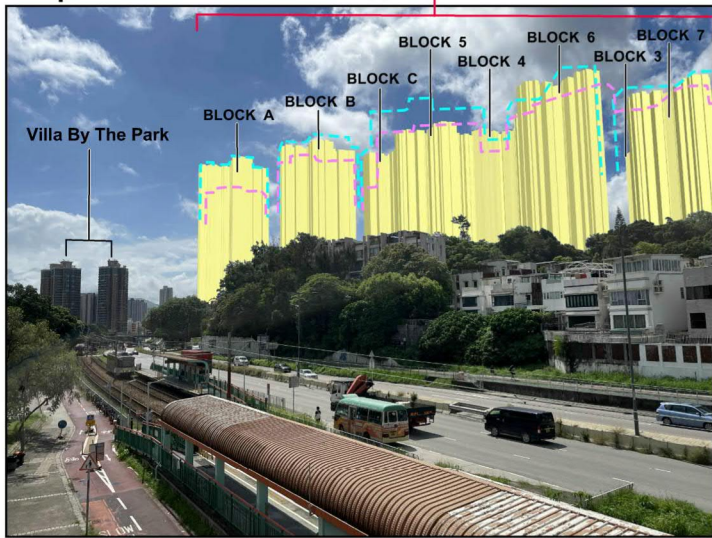

LEGEND:



**Approved s.16 Application No. A/YL-TYST/1074
(Current Scheme)**



The OZP Compliance Scheme



Application Site

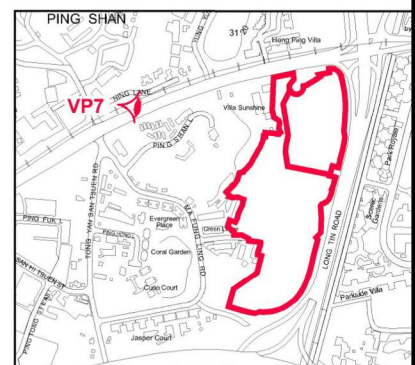

**PHOTOMONTAGE OF VIEWPOINT 7
(VIEW FROM PING SHAN LIGHT RAIL STATION)**



HOUSING DEPARTMENT PLANNING SECTIONS

PLAN 8

DATE :
14. 11. 2024

(摘錄自申請人於 15. 11. 2024 呈交的進一步資料)
(Extract from Applicant's Further
Information Submitted on 15.11.2024)

參考編號
REFERENCE No.
A/YL-TYST/1285

繪圖 DRAWING
A-15

24 0854YL VP7

Approved s.16 Application No. A/YL-TYST/1074 (Current Scheme)



Tsui Sing Lau Pagoda

Proposed Scheme

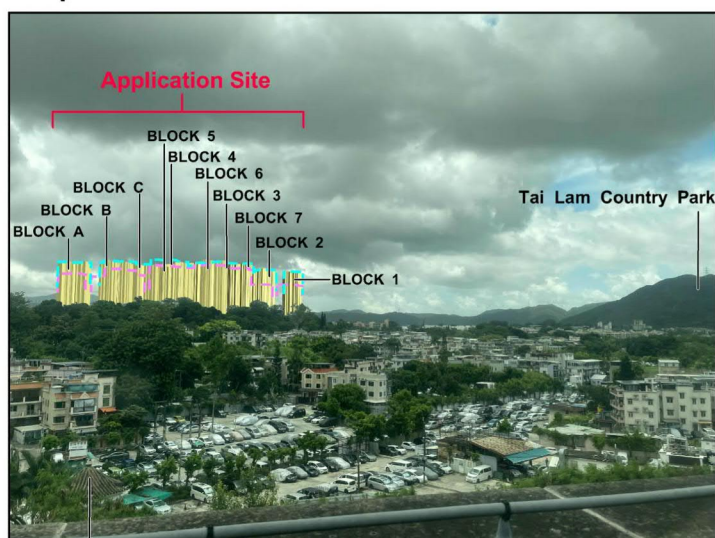

Tsui Sing Lau Pagoda

LEGEND:



Approved s.16 Application No. A/YL-TYST/1074
(Current Scheme)



The OZP Compliance Scheme



Application Site

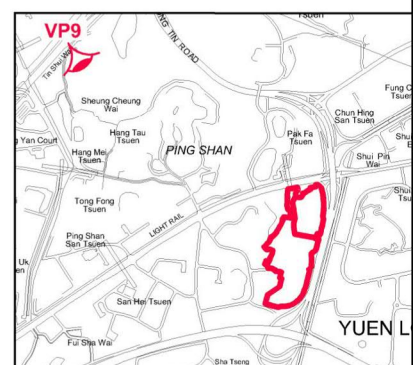

PHOTOMONTAGE OF VIEWPOINT 9 (VIEW FROM TSUI SING LAU PAGODA)



HOUSING DEPARTMENT
PLANNING SECTIONS

PLAN 10

DATE :
14. 11. 2024

24_0854YL_VP9

(摘錄自申請人於 15. 11. 2024 呈交的進一步資料)
(Extract from Applicant's Further
Information Submitted on 15.11.2024)

參考編號
REFERENCE No.
A/YL-TYST/1285

繪圖 DRAWING
A-16

Figure 1

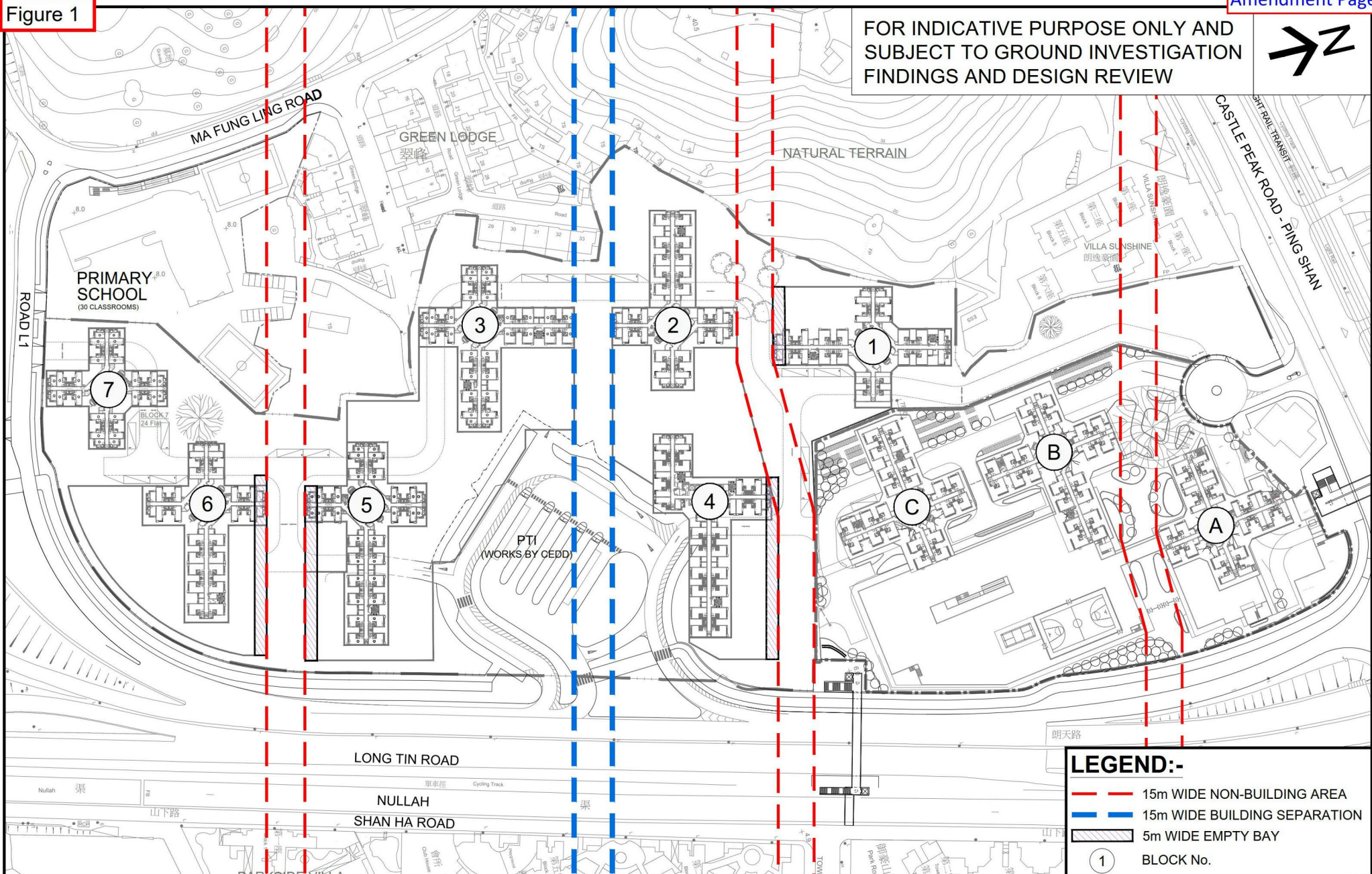

Approved s.16 Application No. A/YL-TYST/1074(Current Scheme)

SCALE 1:2000

- NNE Wind
- E Wind
- SSE/S Wind
- SSW Wind

Figure 2a

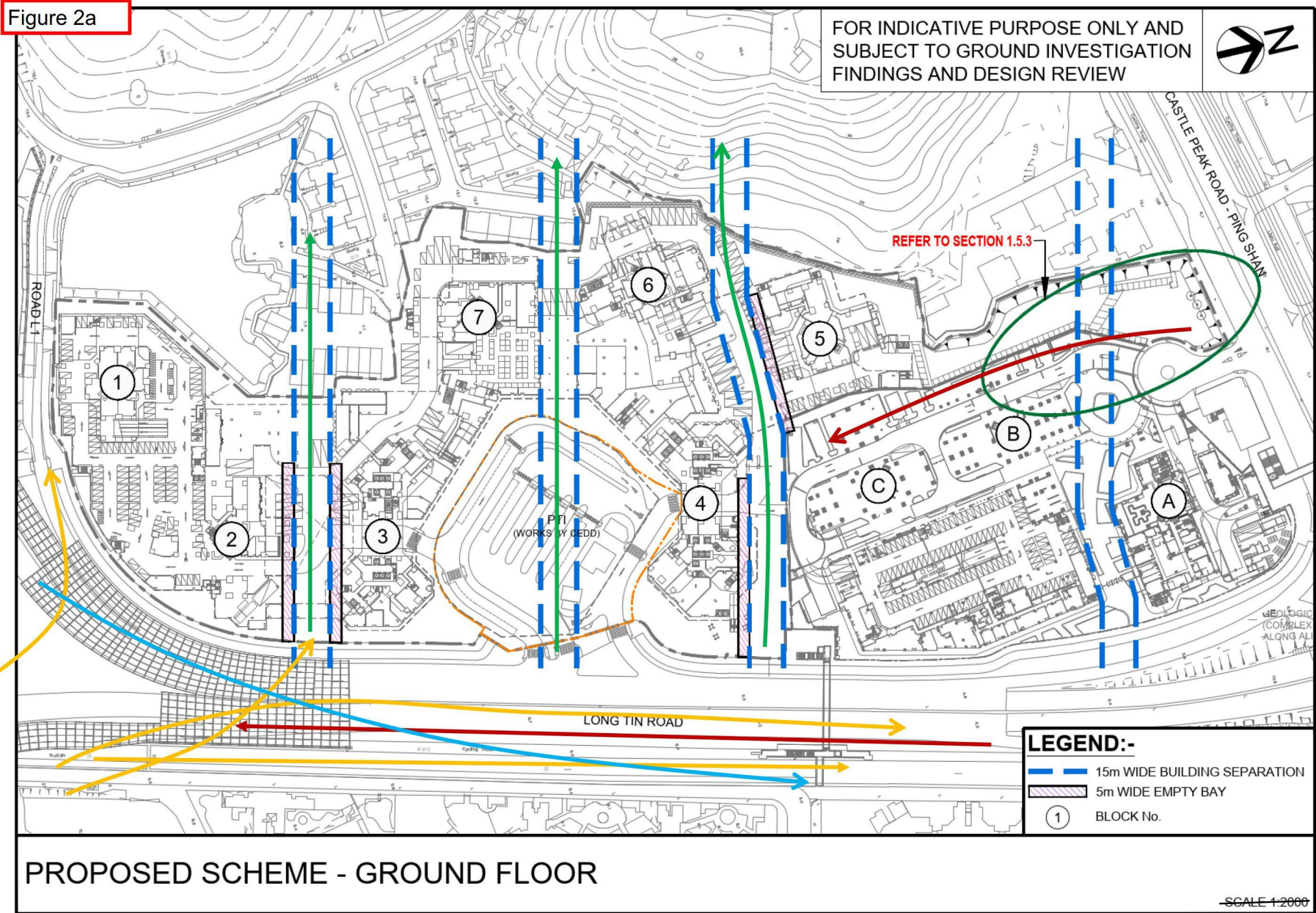

Ramboll

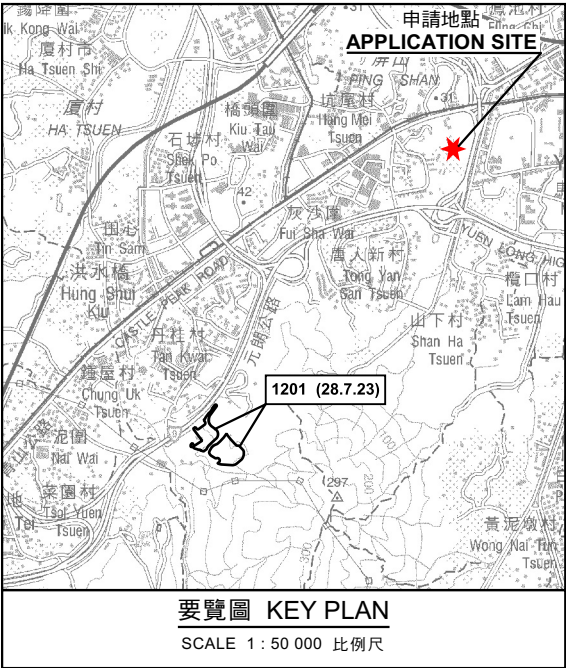
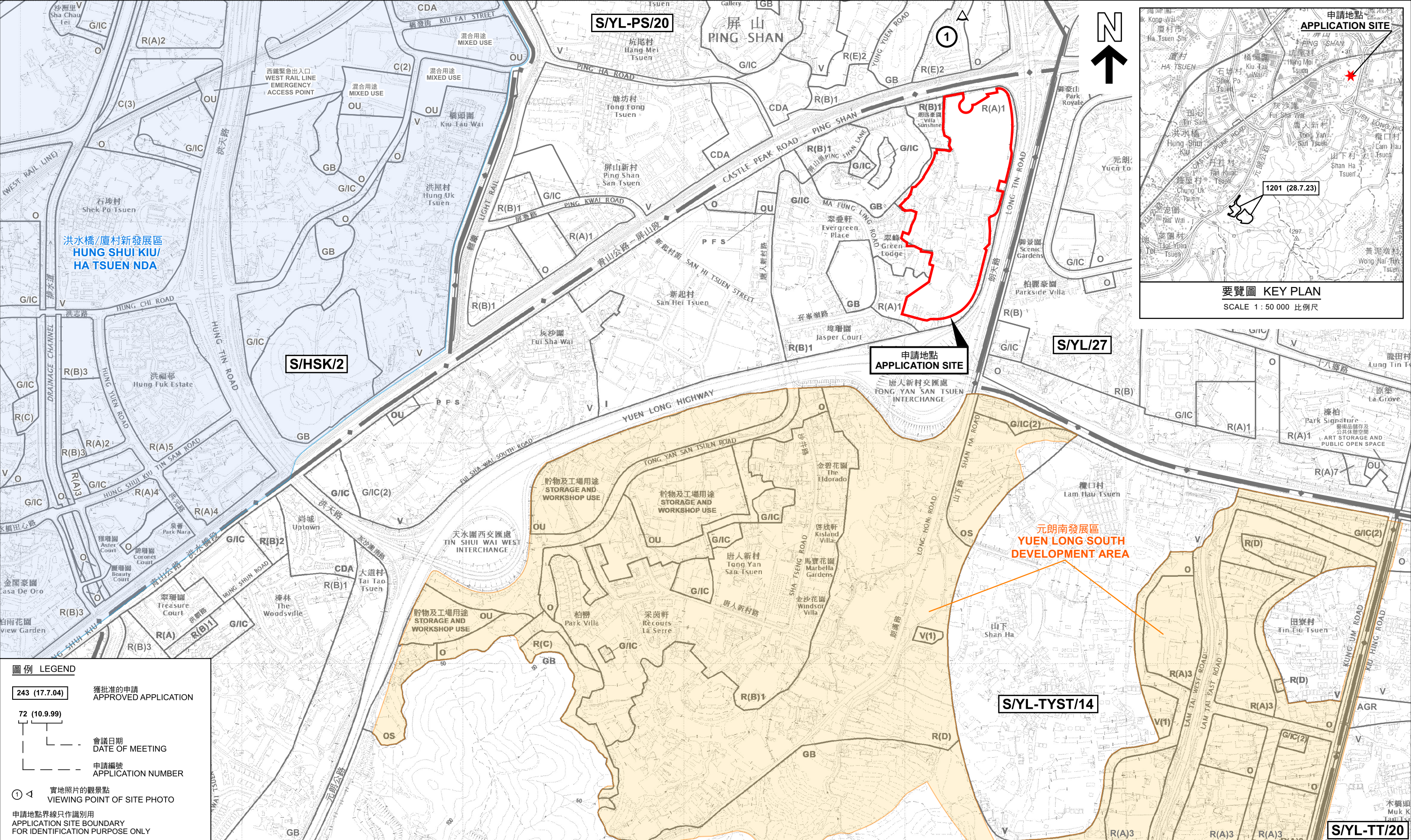

圖例 LEGEND

243 (17.7.04) 獲批准的申請
APPROVED APPLICATION

72 (10.9.99) 會議日期
DATE OF MEETING

申請編號
APPLICATION NUMBER

① 實地照片的觀景點
VIEWING POINT OF SITE PHOTO

申請地點界線只作識別用
APPLICATION SITE BOUNDARY
FOR IDENTIFICATION PURPOSE ONLY

本摘要圖於2024年11月18日擬備。
所根據的資料為於2021年8月10日
核准的分區計劃大綱圖編號 S/YL-TYST/14
EXTRACT PLAN PREPARED ON 18.11.2024
BASED ON OUTLINE ZONING PLAN No.
S/YL-TYST/14 APPROVED ON 10.8.2021

位置圖及同類申請 LOCATION PLAN WITH SIMILAR APPLICATION

擬議略為放寬地積比率及建築物高度限制以作准許的公共房屋發展
元朗朗邊丈量約份第122約地段第1768號和毗連政府土地
PROPOSED MINOR RELAXATION OF PLOT RATIO AND BUILDING HEIGHT RESTRICTIONS
FOR PERMITTED PUBLIC HOUSING DEVELOPMENT
LOT 1768 IN D.D. 122 AND ADJOINING GOVERNMENT LAND,
LONG BIN, YUEN LONG

SCALE 1:8 000 比例尺

米 100 0 100 200 300 400 500 600 700 米
METRES

規劃署
PLANNING DEPARTMENT

參考編號
REFERENCE No.
A/YL-TYST/1285

圖 PLAN
A-1a

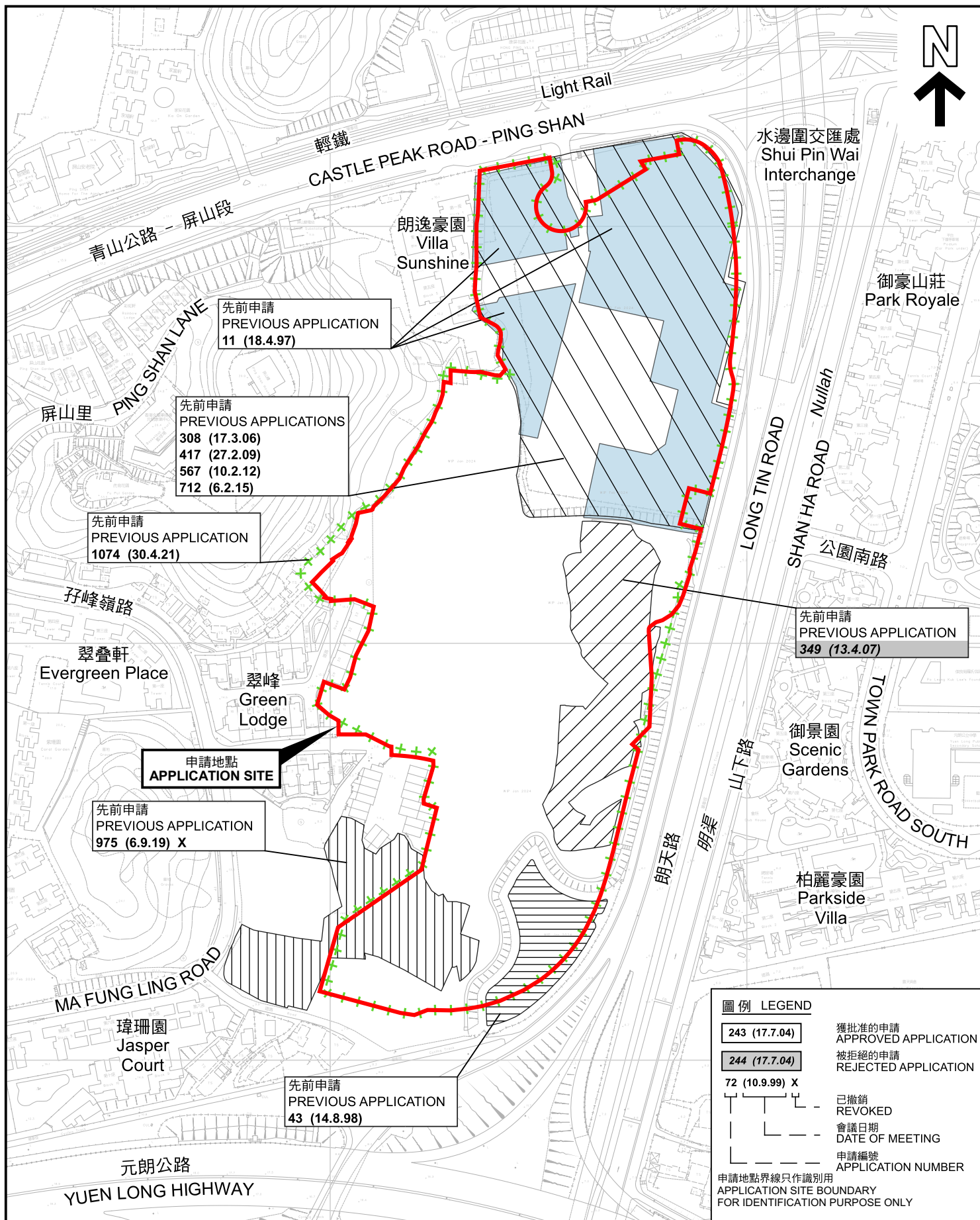

先前申請圖 PREVIOUS APPLICATIONS PLAN

擬議略為放寬地積比率及建築物高度限制以作准許的公共房屋發展
元朗朗邊丈量約份第122約地段第1768號和毗連政府土地
PROPOSED MINOR RELAXATION OF PLOT RATIO
AND BUILDING HEIGHT RESTRICTIONS
FOR PERMITTED PUBLIC HOUSING DEVELOPMENT
LOT 1768 IN D.D. 122 AND ADJOINING GOVERNMENT LAND,
LONG BIN, YUEN LONG

SCALE 1:3 000 比例尺
50 0 50 100
METRES METRES

規劃署
PLANNING
DEPARTMENT



參考編號
REFERENCE No.
AYL-TYST/1285

圖 PLAN
A-1b

本摘要圖於2024年11月18日擬備，
所根據的資料為測量圖編號
6-NW-8D, 9C, 13B 和 14A
EXTRACT PLAN PREPARED ON 18.11.2024
BASED ON SURVEY SHEETS No.
6-NW-8D, 9C, 13B and 14A

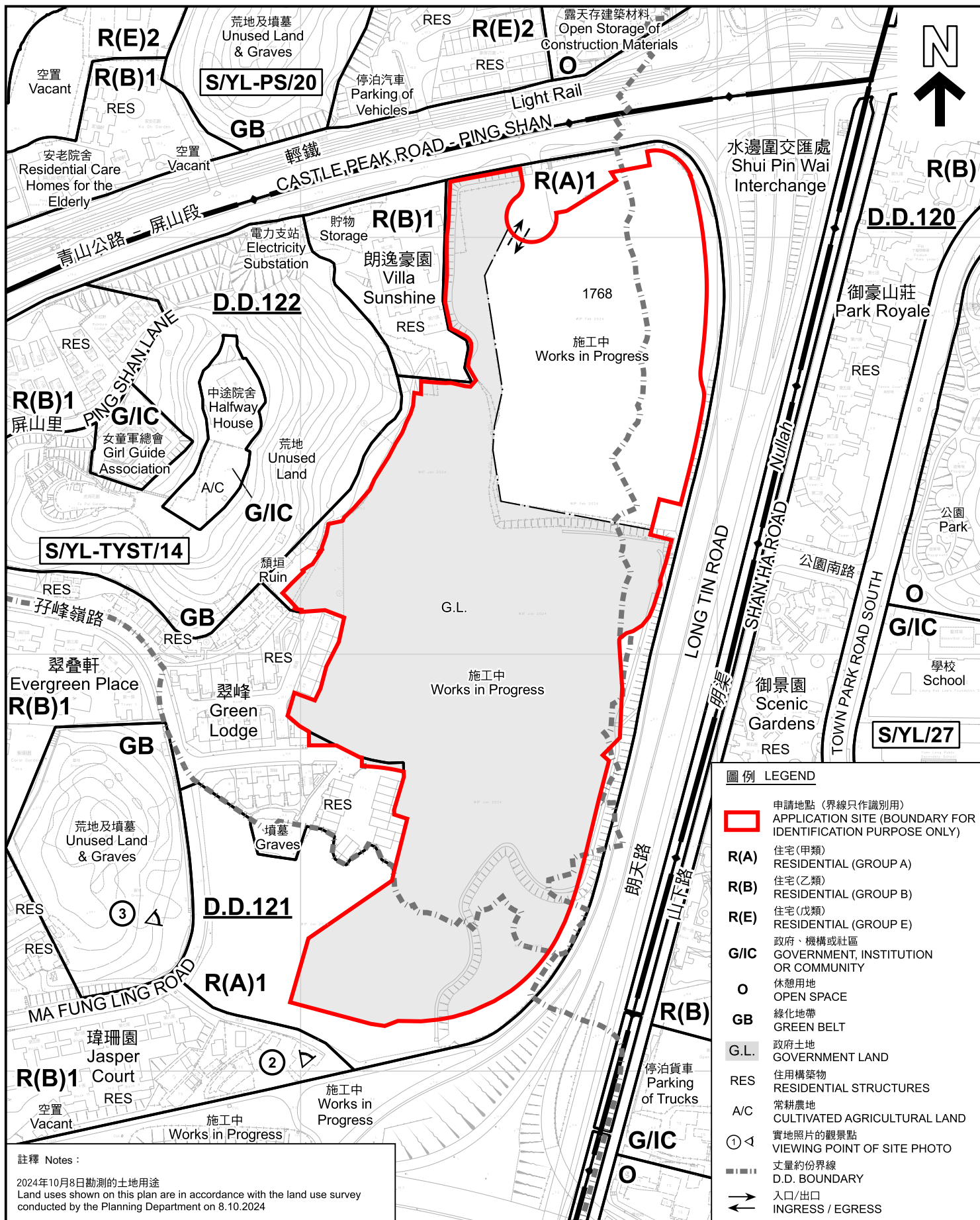

註釋 Notes :

2024年10月8日勘測的土地用途
Land uses shown on this plan are in accordance with the land use survey conducted by the Planning Department on 8.10.2024

本摘要圖於2024年11月18日擬備，所根據的資料為測量圖編號 6-NW-8D, 9C, 13B 和 14A
EXTRACT PLAN PREPARED ON 18.11.2024
BASED ON SURVEY SHEETS No. 6-NW-8D, 9C, 13B and 14A

平面圖 SITE PLAN

擬議略為放寬地積比率及建築物高度限制以作准許的公共房屋發展
元朗朗邊丈量約份第122約地段第1768號和毗連政府土地
PROPOSED MINOR RELAXATION OF PLOT RATIO
AND BUILDING HEIGHT RESTRICTIONS
FOR PERMITTED PUBLIC HOUSING DEVELOPMENT
LOT 1768 IN D.D. 122 AND ADJOINING GOVERNMENT LAND,
LONG BIN, YUEN LONG

SCALE 1 : 3 000 比例尺

米 50 0 50 100 米
METRES

圖例 LEGEND

- 申請地點 (界線只作識別用)
APPLICATION SITE (BOUNDARY FOR IDENTIFICATION PURPOSE ONLY)
- R(A) 住宅 (甲類)
RESIDENTIAL (GROUP A)
- R(B) 住宅 (乙類)
RESIDENTIAL (GROUP B)
- R(E) 住宅 (戊類)
RESIDENTIAL (GROUP E)
- G/I/C 政府、機構或社區
GOVERNMENT, INSTITUTION OR COMMUNITY
- O 休憩用地
OPEN SPACE
- GB 綠化地帶
GREEN BELT
- G.L. 政府土地
GOVERNMENT LAND
- RES 住用構築物
RESIDENTIAL STRUCTURES
- A/C 常耕農地
CULTIVATED AGRICULTURAL LAND
- ① 實地照片的觀景點
VIEWING POINT OF SITE PHOTO
- 丈量約份界線
D.D. BOUNDARY
- 入口/出口
INGRESS / EGRESS

規劃署
PLANNING
DEPARTMENT



參考編號
REFERENCE No.
A/YL-TYST/1285

圖 PLAN
A-2



圖例 LEGEND

 申請地點(界線只作識別用)
APPLICATION SITE
(BOUNDARY FOR IDENTIFICATION
PURPOSE ONLY)

本摘要圖於2024年11月18日擬備，所根據的資料為地政總署於2023年2月24日拍得的航攝照片編號 E188280C
EXTRACT PLAN PREPARED ON 18.11.2024
BASED ON AERIAL PHOTO No.
E188280C TAKEN ON 24.2.2023
BY LANDS DEPARTMENT

航攝照片 AERIAL PHOTO

擬議略為放寬地積比率及建築物高度限制以作准許的公共房屋發展
元朗朗邊丈量約份第122約地段第1768號和毗連政府土地
PROPOSED MINOR RELAXATION OF PLOT RATIO
AND BUILDING HEIGHT RESTRICTIONS
FOR PERMITTED PUBLIC HOUSING DEVELOPMENT
LOT 1768 IN D.D. 122 AND ADJOINING GOVERNMENT LAND,
LONG BIN, YUEN LONG

規劃署
PLANNING
DEPARTMENT



參考編號
REFERENCE No.
AYL-TYST/1285

圖 PLAN
A-3

1



申請地點界線只作識別用 APPLICATION SITE BOUNDARY FOR IDENTIFICATION PURPOSE ONLY

本圖於2024年11月18日擬備，所根據的資料為攝於2024年10月8日的實地照片
PLAN PREPARED ON 18.11.2024
BASED ON SITE PHOTOS
TAKEN ON 8.10.2024

實地照片 SITE PHOTOS

擬議略為放寬地積比率及建築物高度限制以作准許的公共房屋發展
元朗朗邊丈量約份第122約地段第1768號和毗連政府土地
PROPOSED MINOR RELAXATION OF PLOT RATIO
AND BUILDING HEIGHT RESTRICTIONS
FOR PERMITTED PUBLIC HOUSING DEVELOPMENT
LOT 1768 IN D.D. 122 AND ADJOINING GOVERNMENT LAND,
LONG BIN, YUEN LONG

規劃署
PLANNING
DEPARTMENT



參考編號
REFERENCE No.
A/YL-TYST/1285

圖 PLAN
A-4a

2



申請地點界線只作識別用 APPLICATION SITE BOUNDARY FOR IDENTIFICATION PURPOSE ONLY

實地照片 SITE PHOTOS

本圖於2024年11月18日擬備，所根據的資料為攝於2024年10月8日的實地照片
PLAN PREPARED ON 18.11.2024
BASED ON SITE PHOTOS
TAKEN ON 8.10.2024

擬議略為放寬地積比率及建築物高度限制以作准許的公共房屋發展
元朗朗邊丈量約份第122約地段第1768號和毗連政府土地
PROPOSED MINOR RELAXATION OF PLOT RATIO
AND BUILDING HEIGHT RESTRICTIONS
FOR PERMITTED PUBLIC HOUSING DEVELOPMENT
LOT 1768 IN D.D. 122 AND ADJOINING GOVERNMENT LAND,
LONG BIN, YUEN LONG

規劃署
PLANNING
DEPARTMENT



參考編號
REFERENCE No.
AYL-TYST/1285

圖 PLAN
A-4b

3



申請地點界線只作識別用 APPLICATION SITE BOUNDARY FOR IDENTIFICATION PURPOSE ONLY

本圖於2024年11月18日擬備，所根據的資料為攝於2024年10月8日的實地照片
PLAN PREPARED ON 18.11.2024
BASED ON SITE PHOTOS
TAKEN ON 8.10.2024

實地照片 SITE PHOTOS

擬議略為放寬地積比率及建築物高度限制以作准許的公共房屋發展
元朗朗邊丈量約份第122約地段第1768號和毗連政府土地
PROPOSED MINOR RELAXATION OF PLOT RATIO
AND BUILDING HEIGHT RESTRICTIONS
FOR PERMITTED PUBLIC HOUSING DEVELOPMENT
LOT 1768 IN D.D. 122 AND ADJOINING GOVERNMENT LAND,
LONG BIN, YUEN LONG

規劃署
PLANNING
DEPARTMENT



參考編號
REFERENCE No.
A/YL-TYST/1285

圖 PLAN
A-4c