

(摘錄自申請人於 30. 1. 2024 呈交的申請書)
(Extract from Applicant's
Submission of 30.1.2024)

參考編號 REFERENCE No. A/YL/316	繪圖 DRAWING A-1
-----------------------------------	----------------------

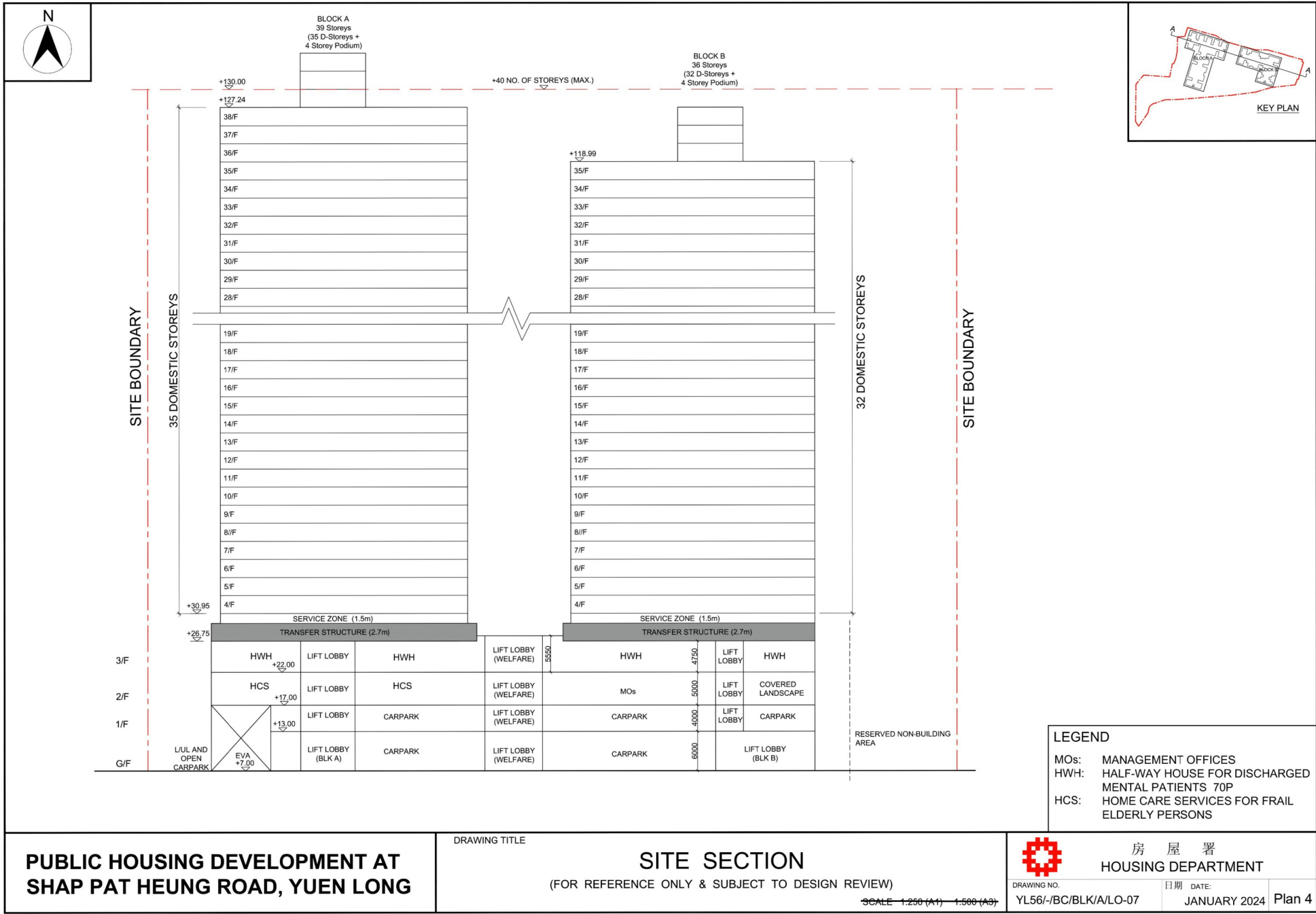

(摘錄自申請人於 30. 1. 2024 呈交的申請書)
(Extract from Applicant's Submission of 30.1.2024)

參考編號
REFERENCE No.
A/YL/316

繪圖
DRAWING
A-2

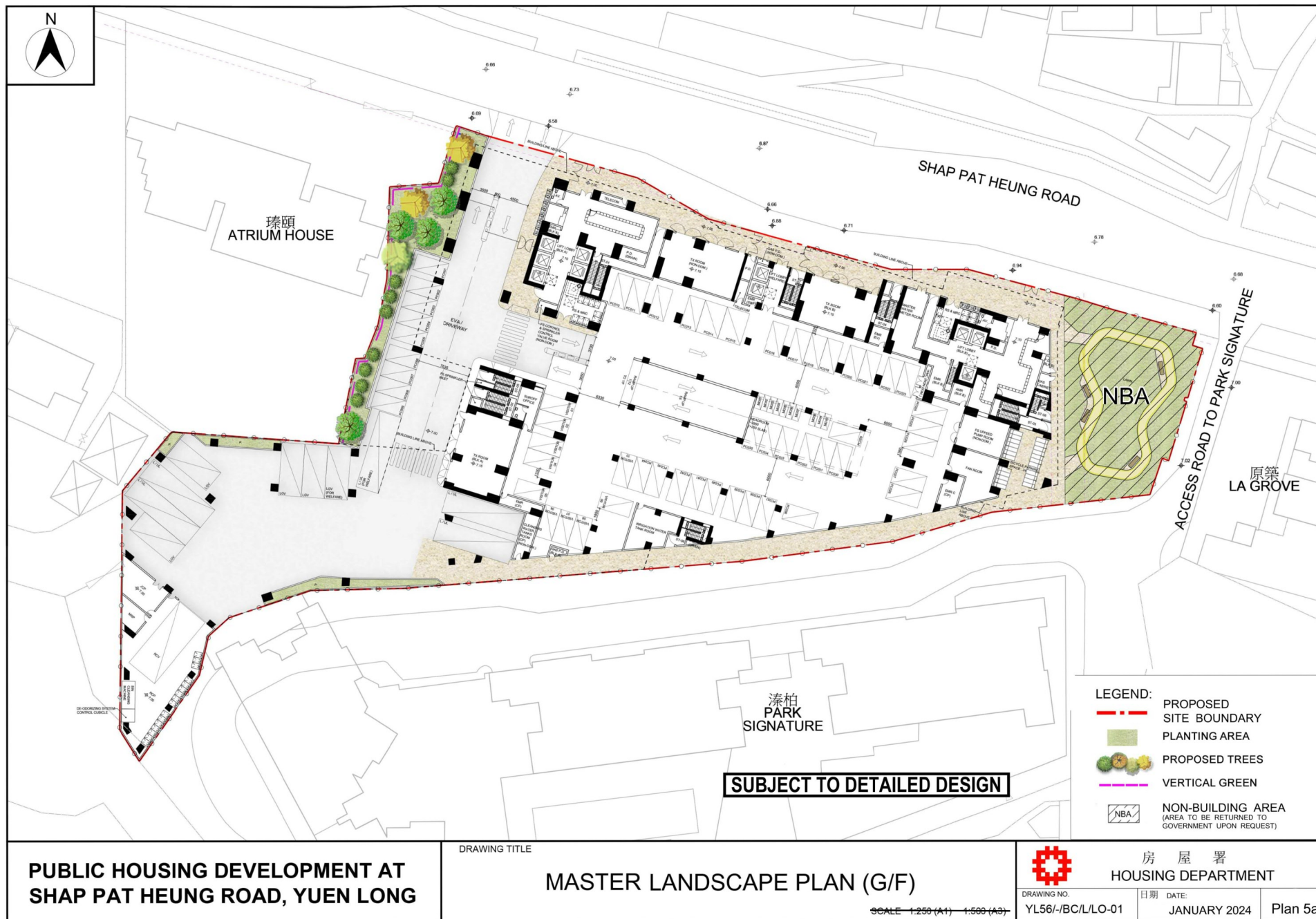

24_0058YL_Plan5a

(摘錄自申請人於 30.1.2024 呈交的申請書)
(Extract from Applicant's
Submission of 30.1.2024)

參考編號
REFERENCE No.
A/YL/316

繪圖 DRAWING
A-3



(摘錄自申請人於 30. 1. 2024 呈交的申請書)
(Extract from Applicant's
Submission of 30.1.2024)

參考編號 REFERENCE No. A/YL/316	繪圖 DRAWING A-4
-----------------------------------	-------------------

100
0 10
Meters



BEFORE

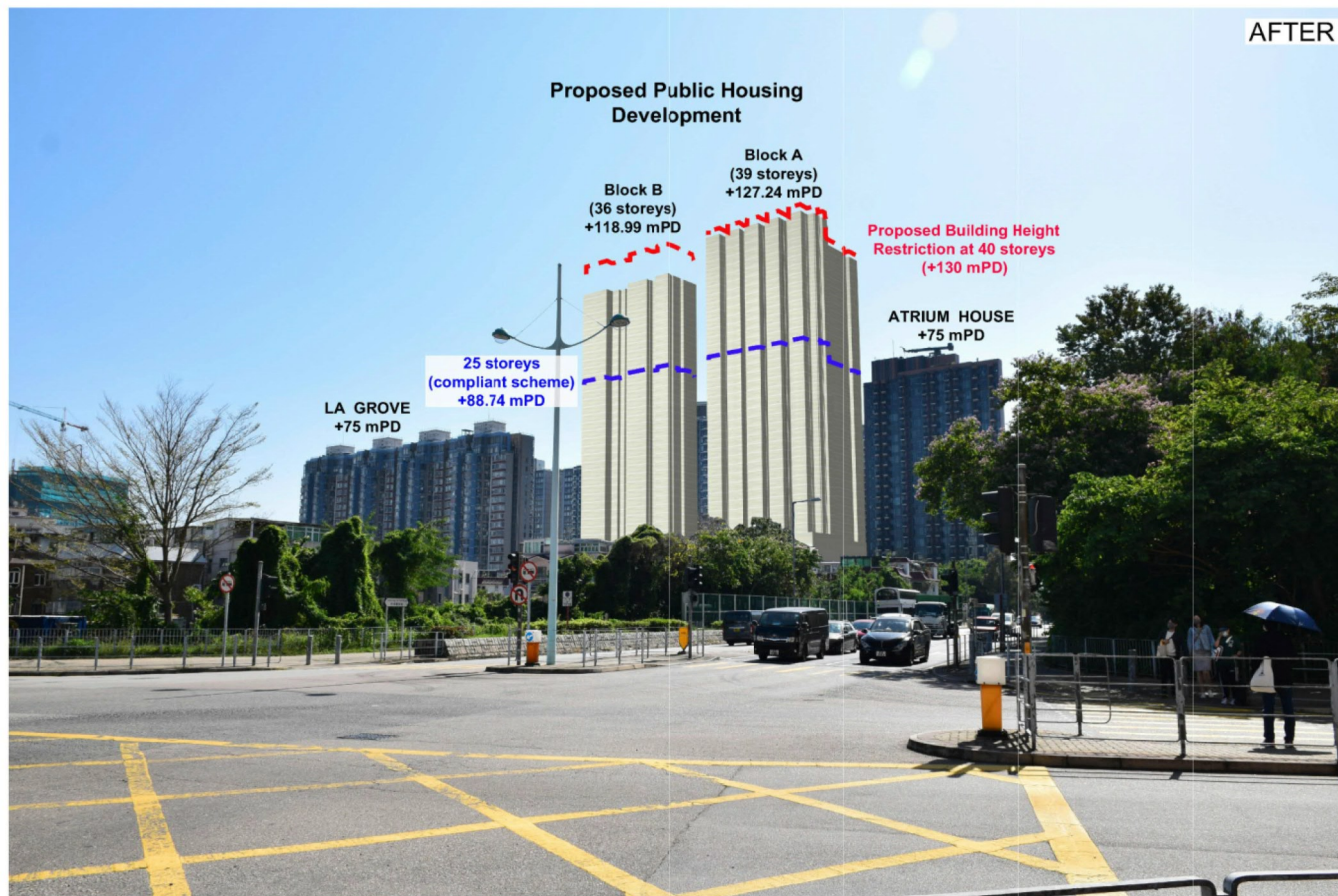

AFTER

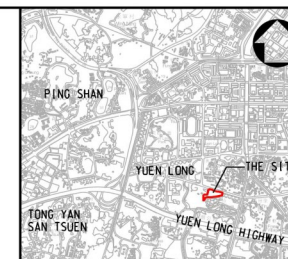

KEY PLAN
N.T.S.

D	OCT 2022	PHOTOMONTAGE REVIEWED	AW	WL	SW
C	AUG 2022	PHOTOMONTAGE REVIEWED	AW	WL	SW
B	APR 2022	PHOTOMONTAGE REVIEWED	AW	WL	SW
A	MAR 2022	FIRST ISSUED	AW	KL	DL

Rev. Date Description By Check Appr.

Drawing Status Submittal

FEASIBILITY STUDY

AtkinsRéalis

Client
土木工務拓展署
Civil Engineering and
Development Department

土木工程處
房屋工程3部
Civil Engineering Office
Housing Projects 3 Division

Project Title
AGREEMENT NO. 46/2020 (CE)
TERM CONSULTANCY FOR SITE FORMATION
AND INFRASTRUCTURE WORKS FOR
PROPOSED HOUSING DEVELOPMENT IN
ZONE 1 (2021-2024) - FEASIBILITY STUDY
(TASK ORDER 4 - SHAP PAT HEUNG ROAD)

Drawing Title
PHOTOMONTAGES (2 OF 4)
VP2 - FROM THE INTERSECTION OF
YUEN LONG TAI YUK ROAD AND
MA TIN ROAD

Scale	Designed	Drawn	Checked	Authorised
1:500	AW	CAD	KL	DL
Original Size	Date	Date	Date	Date
A3	11/03/2022	11/03/2022	11/03/2022	11/03/2022

Drawing Number Revision

FIGURE 9B

D

Copyright © Atkins Limited

(摘錄自申請人於 30. 1. 2024 呈交的申請書)
(Extract from Applicant's
Submission of 30.1.2024)

參考編號
REFERENCE No.
A/YL/316

繪圖 DRAWING
A-5

User name: LAUK4827 Date: 18-Oct-23 Time: 11:32:43 AM
Filename: \\atkins.com\proj\CD\CHINA\Project\02\1056_C2-6-20_104\20.00 Project Deliverables\20.10 Report\CD\011 - LVACD011.05 Final_A4\Figures\CD\Figure 9D.dgn
100
50
0
Metres
0 10 20 30 40 50 60 70 80 90 100
Metres

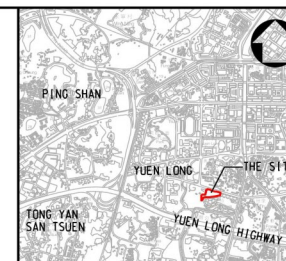
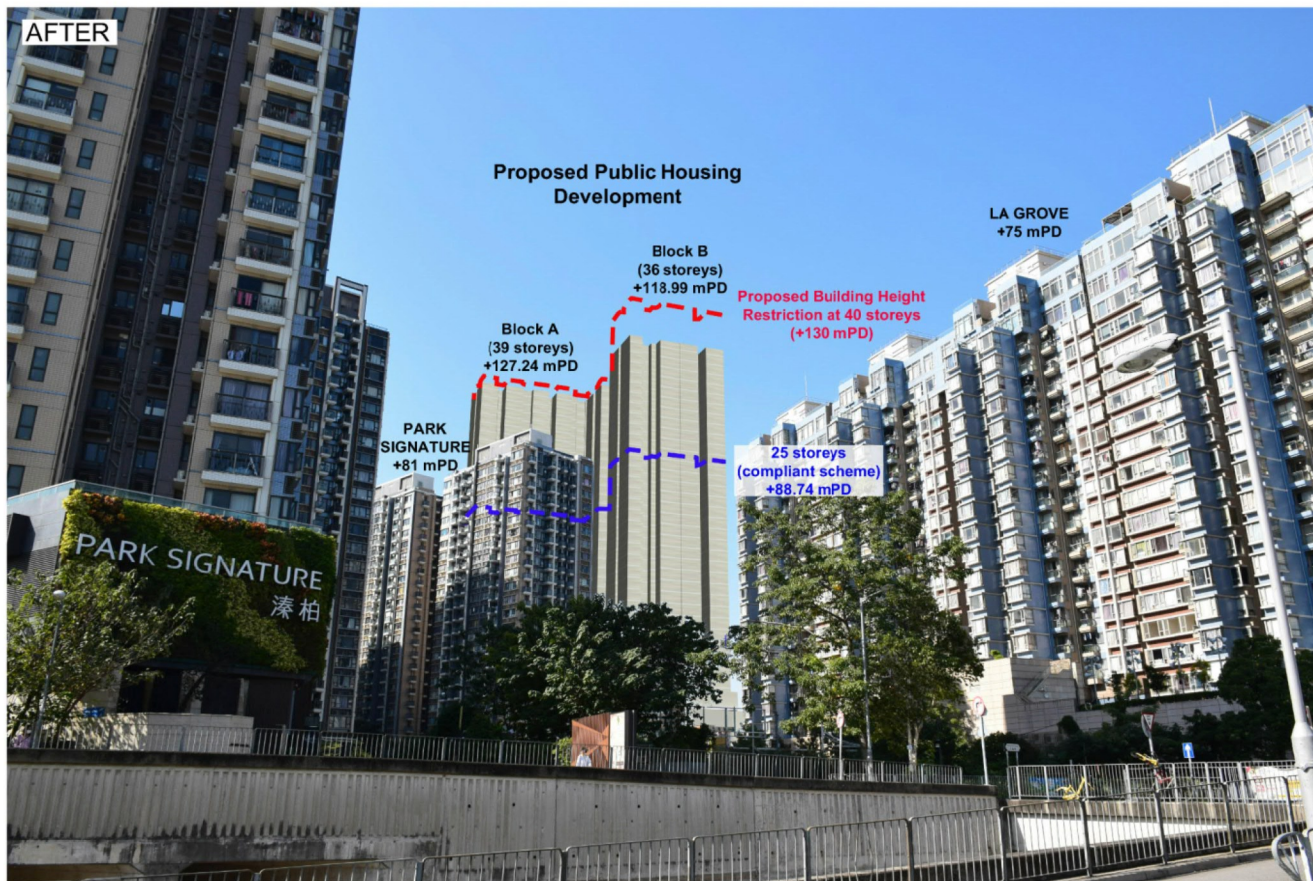

KEY PLAN
N.T.S.

D	OCT 2023	PHOTOMONTAGE REVIEWED	AW	WL	SW
C	AUG 2023	PHOTOMONTAGE REVIEWED	AW	WL	SW
B	APR 2023	PHOTOMONTAGE REVIEWED	AW	WL	SW
A	MAR 2022	FIRST ISSUED	AW	KL	DL

Rev: Date: Description: By: Check: Appr:

FEASIBILITY STUDY

AtkinsRéalis

Client: 土木工程拓展署
Civil Engineering and
Development Department

土木工程處
房屋工程3部
Civil Engineering Office
Housing Projects 3 Division

Project Title: AGREEMENT NO. 46/2020 (CE)
TERM CONSULTANCY FOR SITE FORMATION
AND INFRASTRUCTURE WORKS FOR
PROPOSED HOUSING DEVELOPMENT IN
ZONE 1 (2021-2024) - FEASIBILITY STUDY
(TASK ORDER 4 - SHAP PAT HEUNG ROAD)

Drawing Title: PHOTOMONTAGES (4 OF 4)
VP4 - FROM THE EAST OF
THE SITE AT THE NULLAH

Scale: 1:1000	Designed: AW	Drawn: CAD	Checked: KL	Authorised: DL
Original Date: A3	Date: MAR 2022	Date: MAR 2022	Date: MAR 2022	Date: MAR 2022

FIGURE 9D

D

Copyright © Atkins Limited

(摘錄自申請人於 30. 1. 2024 呈交的申請書)
(Extract from Applicant's
Submission of 30.1.2024)

參考編號
REFERENCE No.
A/YL/316

繪圖 DRAWING
A-6

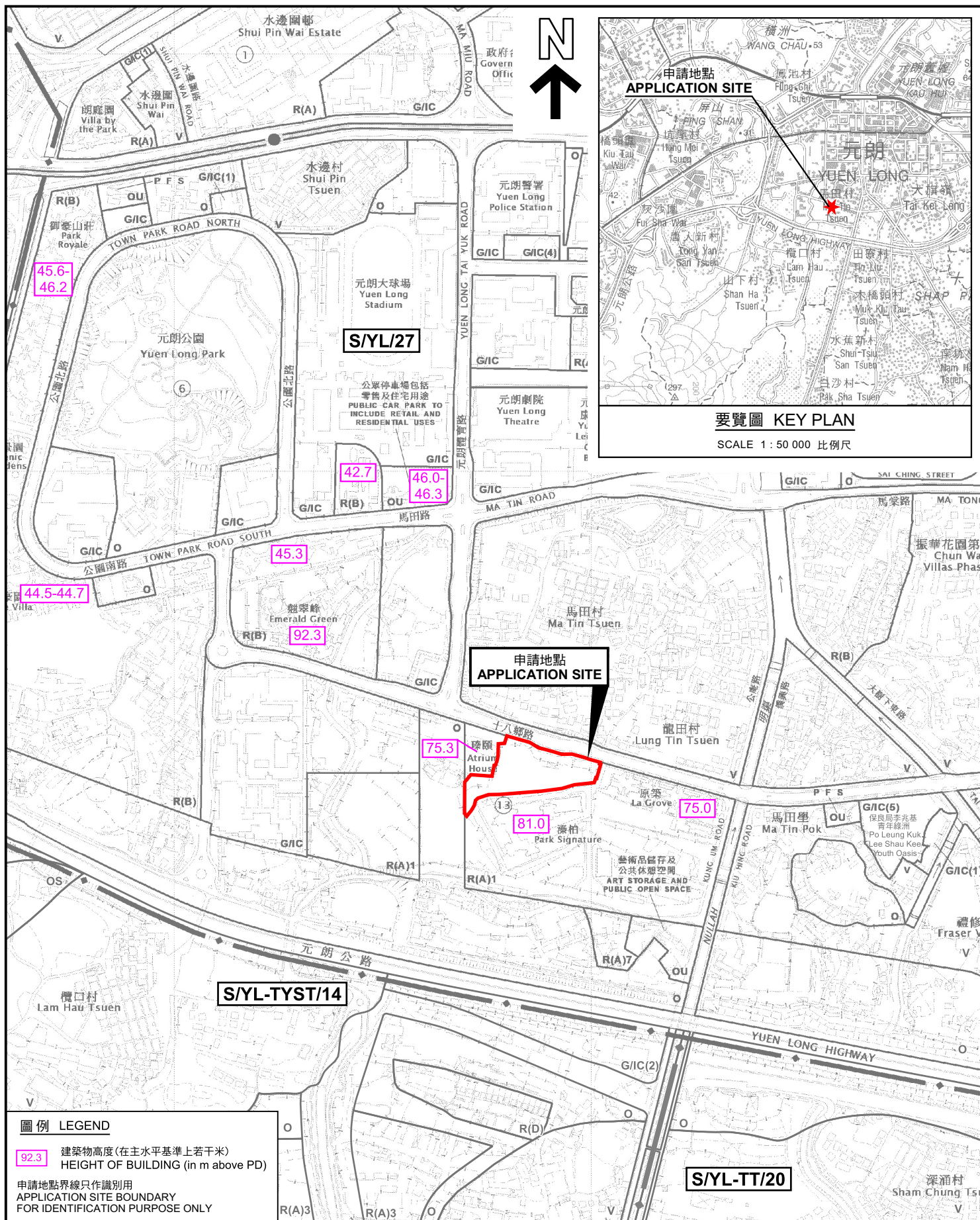

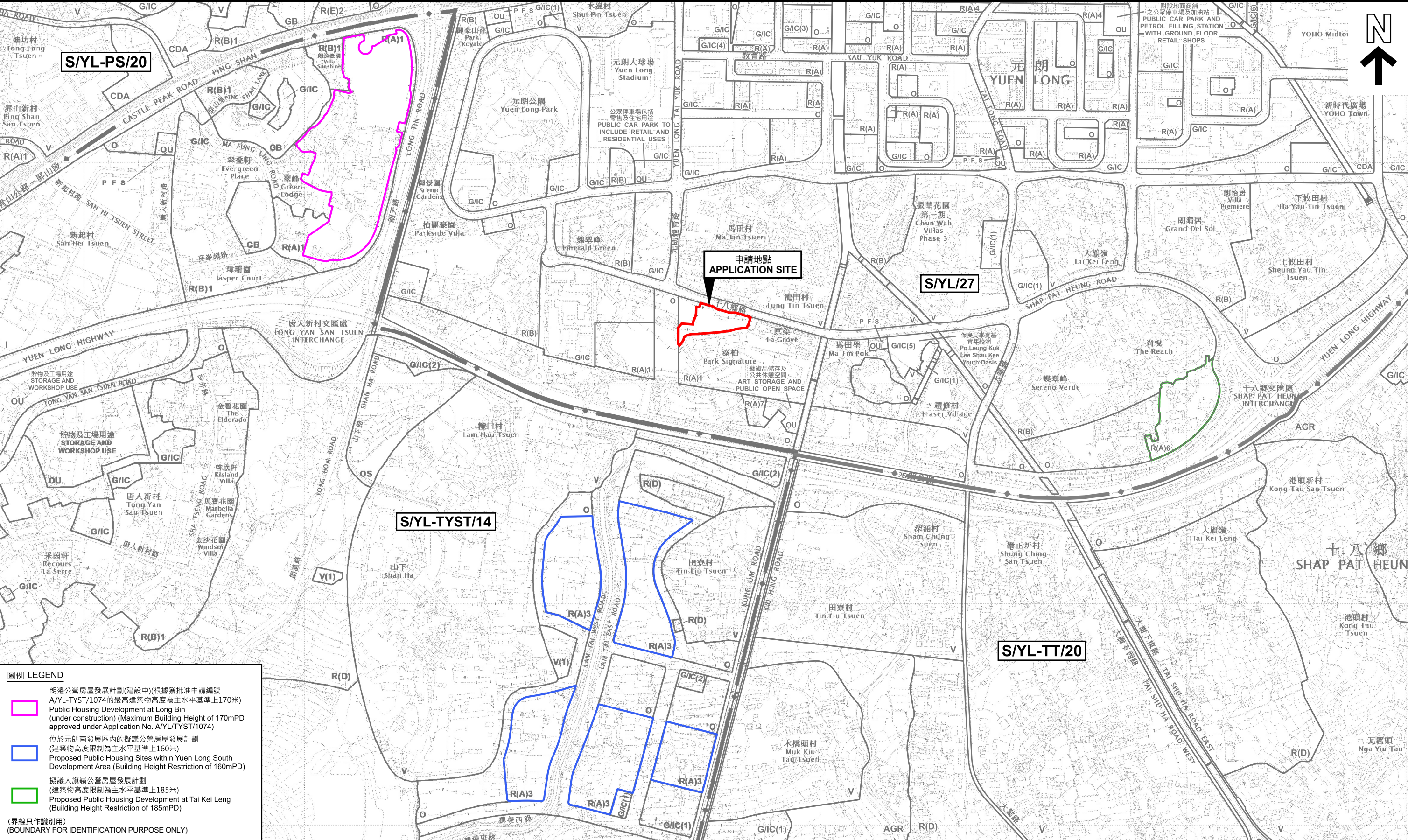

圖例 LEGEND

朗邊公營房屋發展計劃(建設中)(根據獲批准申請編號 A/YL-TYST/1074的最高建築物高度為主水平基準上170米)
Public Housing Development at Long Bin (under construction) (Maximum Building Height of 170mPD approved under Application No. A/YL-TYST/1074)

位於元朗南發展區內的擬議公營房屋發展計劃 (建築物高度限制為主水平基準上160米)
Proposed Public Housing Sites within Yuen Long South Development Area (Building Height Restriction of 160mPD)

擬議大旗嶺公營房屋發展計劃 (建築物高度限制為主水平基準上185米)
Proposed Public Housing Development at Tai Kei Leng (Building Height Restriction of 185mPD)

(界線只作識別用)
(BOUNDARY FOR IDENTIFICATION PURPOSE ONLY)

<p>位置圖 LOCATION PLAN</p> <p>擬議略為放寬地積比率及建築物高度限制，以作准許的公營房屋發展及社會福利設施用途 PROPOSED MINOR RELAXATION OF PLOT RATIO AND BUILDING HEIGHT RESTRICTIONS FOR PERMITTED PUBLIC HOUSING DEVELOPMENT AND SOCIAL WELFARE FACILITY USES</p> <p>位於元朗十八鄉路路旁的政府土地 GOVERNMENT LAND ALONG SHAP PAT HEUNG ROAD, YUEN LONG</p> <p>SCALE 1 : 8 000 比例尺</p> <p>米 100 0 100 200 300 400 500 600 700 米 METRES METRES</p>		<p>規劃署 PLANNING DEPARTMENT</p>
<p>本摘要圖於2024年5月16日擬備，所根據的資料為於2021年8月10日核准的分區計劃大綱圖編號 S/YL-TYST/14 EXTRACT PLAN PREPARED ON 16.5.2024 BASED ON OUTLINE ZONING PLAN No. S/YL-TYST/14 APPROVED ON 10.8.2021</p>	<p>參考編號 REFERENCE No. A/YL/316</p>	<p>圖 PLAN A-1b</p>



圖例 LEGEND

 申請地點(界線只作識別用)
APPLICATION SITE
(BOUNDARY FOR IDENTIFICATION
PURPOSE ONLY)

本摘要圖於2024年2月20日擬備，所根據
的資料為地政總署於2022年12月18日拍得
的航攝照片編號 E174623C
EXTRACT PLAN PREPARED ON 20.2.2024
BASED ON AERIAL PHOTO No.
E174623C TAKEN ON 18.12.2022
BY LANDS DEPARTMENT

航攝照片 AERIAL PHOTO

擬議略為放寬地積比率及建築物高度限制，
以作准許的公營房屋發展及社會福利設施用途
位於元朗十八鄉路旁的政府土地
PROPOSED MINOR RELAXATION OF PLOT RATIO AND
BUILDING HEIGHT RESTRICTIONS FOR PERMITTED PUBLIC
HOUSING DEVELOPMENT AND SOCIAL WELFARE FACILITY USES
GOVERNMENT LAND ALONG SHAP PAT HEUNG ROAD, YUEN LONG

規劃署
PLANNING
DEPARTMENT



參考編號
REFERENCE No.
A/YL/316

圖 PLAN
A-3

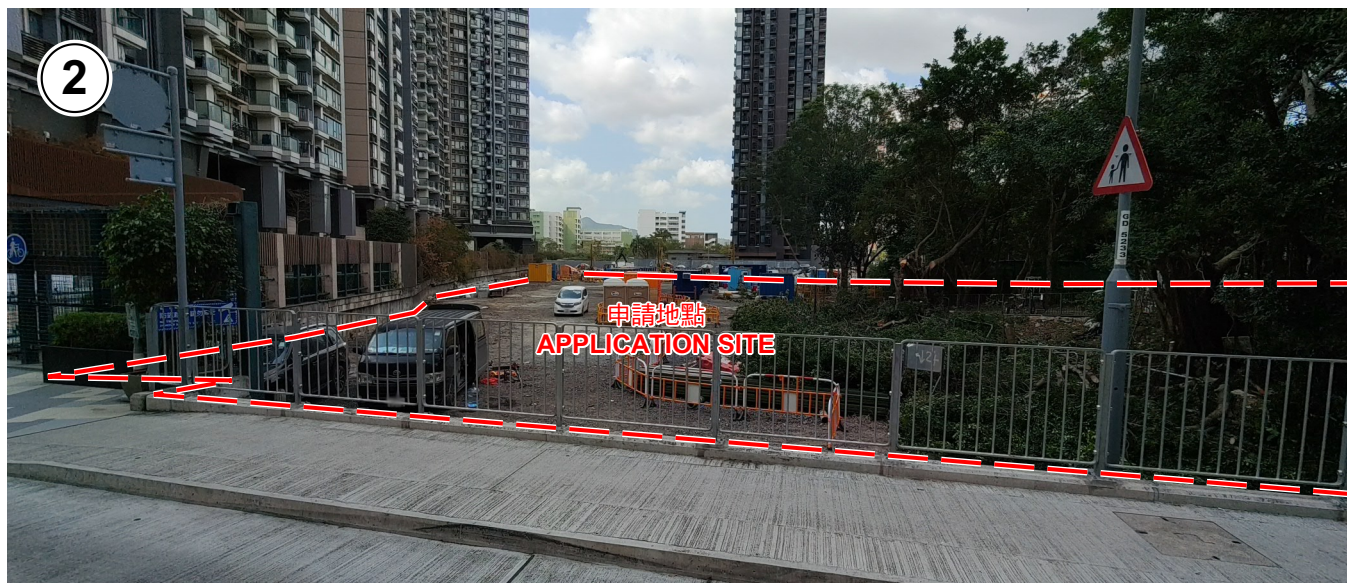

申請地點界線只作識別用 APPLICATION SITE BOUNDARY FOR IDENTIFICATION PURPOSE ONLY

實地照片 SITE PHOTOS

擬議略為放寬地積比率及建築物高度限制，
以作准許的公營房屋發展及社會福利設施用途
位於元朗十八鄉路路旁的政府土地
PROPOSED MINOR RELAXATION OF PLOT RATIO AND
BUILDING HEIGHT RESTRICTIONS FOR PERMITTED PUBLIC
HOUSING DEVELOPMENT AND SOCIAL WELFARE FACILITY USES
GOVERNMENT LAND ALONG SHAP PAT HEUNG ROAD, YUEN LONG

規劃署
PLANNING
DEPARTMENT



參考編號
REFERENCE No.
A/YL/316

圖 PLAN
A-4a

本圖於2024年2月20日擬備，所根據的
資料為攝於2024年2月2日的實地照片
PLAN PREPARED ON 20.2.2024
BASED ON SITE PHOTOS
TAKEN ON 2.2.2024

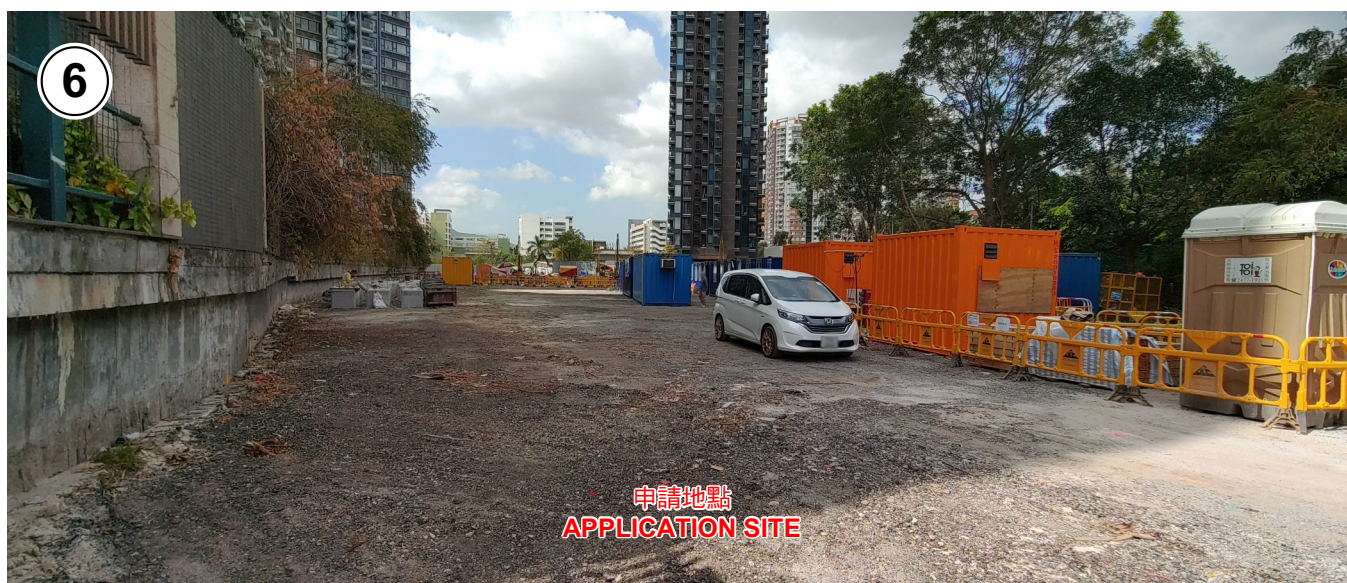

實地照片 SITE PHOTOS

擬議略為放寬地積比率及建築物高度限制，
以作准許的公營房屋發展及社會福利設施用途
位於元朗十八鄉路路旁的政府土地
PROPOSED MINOR RELAXATION OF PLOT RATIO AND
BUILDING HEIGHT RESTRICTIONS FOR PERMITTED PUBLIC
HOUSING DEVELOPMENT AND SOCIAL WELFARE FACILITY USES
GOVERNMENT LAND ALONG SHAP PAT HEUNG ROAD, YUEN LONG

規 劃 署
PLANNING
DEPARTMENT



參考編號
REFERENCE No.
A/YL/316

圖 PLAN
A-4b

本圖於2024年2月20日擬備，所根據的
資料為攝於2024年2月2日的實地照片
PLAN PREPARED ON 20.2.2024
BASED ON SITE PHOTOS
TAKEN ON 2.2.2024